

San Angela, Texas, Dec. 24th 91.

To the Honorable Commissioners Court of
Tom Green County,

Gentlemen; By virtue of an
order of your Honorable Court made on the 8th
day of Sept. A.D. 1891 appointing me Special
Surveyor for Tom Green County to begin at
the S.E. corner of said County on Nov. 16th 1891
and survey and establish the South boundary
line of Tom Green County so far as the same
joins Schleicher County, I surveyed as follows
to-wit;

Beginning at the S.E. corner of Tom Green
Co. the S.W. corner of Concho Co., the N.W. cor. of
Menard Co. and the N.E. corner of Schleicher Co. a
large stone monument capped with a stone marked
"Corner of M'D, C'HO, SCH. & T.G. Counties June
8th 1891." from which a L.O. 10' mtd. $\frac{S}{|||}$ brs. S. 30° W. 37 $\frac{1}{2}$
vrs. a double L.O. each prong 12' in dia. mtd. $\frac{MD}{|||}$ brs. S
59° E. 148 $\frac{4}{5}$ vrs. a L.O. 6' mtd. $\frac{C}{|||}$ brs. N. 27 $\frac{1}{4}$ ° E. 77 $\frac{1}{4}$ vrs.
a L.O. 12' mtd. $\frac{T}{|||}$ brs. S. 81 $\frac{1}{2}$ ° W. 20 $\frac{1}{2}$ vrs. a L.O. 12' mtd.
 $\frac{TG}{|||}$ brs. N. 34 $\frac{1}{2}$ ° W. 121 $\frac{1}{5}$ vrs. said Monument is on
Sur. No. 139 E.L. & R.R.R. Co. 95 vrs. West and 111 vrs.
South from its N.E. corner.

1. Thence West at 1080 vrs. cross a creek causeway
North, at 1380 vrs. cross "old wire road" at 1805 vrs
cross West line of said Sur. No. 139 and the East
line of Sur. No. 141 E.L. & R.R.R. Co. 111 vrs.
South from their N. common corner, 1900 vrs.
stone monument on ridge marked "1 MILE T.G.
& S. Co. LINE" from which a L.O. 20' brs. S. 25° W. 37 vrs.
a do. 16' brs. N. 44 $\frac{3}{4}$ ° W. 23 vrs.

2. Thence West at 1780 vrs. cross a creek
 at 1805 vrs. cross the West line of said Sur. No. 141
 111 vrs South from its N.W. corner, 1900 vrs. stone
 monument in a draw marked "2 MILES T.G. &
 S. Co. LINE" fr. wh. a L.O. 8' bears N. $22\frac{1}{2}$ E. 31 vrs. a
 forked Spanish Oak bears N. 78° E. 37 vrs.
3. Thence West at 399 vrs. cross the East
 line of Surry No. 6 & N. & S. A. R. Co. Block H
 212 vrs. North from its S.E. corner 1900 vrs. stone
 monument on E. slope marked "3 MILES T.G. &
 S. Co. LINE" fr. wh. a L.O. 10' bears S. $11\frac{1}{2}$ N. $28\frac{3}{5}$ vrs. do. 10'
 N. $19\frac{1}{4}$ E. 44 vrs.
4. Thence West at 402 vrs. cross the N. line of
 said Sur. No. 6 and East line of surry No. 7 Bk. H.
 200 vrs. North from their South common corner. at
 1800 vrs. cross branch 1900 vrs. stone monument on
 East bank of a branch marked "4 MILES T.G.
 & S. Co. LINE".
5. Thence West at 405 vrs. cross the West
 line of Surry No. 7 & E. line of Sur. No. 18 Bk. H.
 188 vrs. N. from their S. common corner 1900 vrs.
 stone monument on E. slope of ridge mtd. "5
 MILES T.G. & S. Co. LINE" from which a L.O. 10' bears
 S. $3\frac{1}{2}$ E. 79 vrs. a do. bears S. 42 E. 95 vrs.
6. Thence West at 403 vrs. cross the N. line
 of said Sur. No. 18 & E. line of Sur. No. 19 Block H.
 176 vrs. North from their South common corner
 1900 vrs. stone monument in cove marked "6
 MILES T.G. & S. Co. LINE" fr. wh. a L.O. 13' in
 bears S. $26\frac{1}{4}$ E. 71 vrs. a do. 17' bears N. $8\frac{1}{4}$ E. 63 vrs.
7. Thence West at 411 vrs. cross the N. line
 of Sur. No. 19 & E. line of Sur. No. 31 Block H. 164

1
2
3
4
5
6
7
8
9
10
11
12
13
14
15
16
17
18
19
20
21
22
23
24
25
26
27
28
29
30
31
32

1000 yds. N. from their S. common corner. at 880 yds.
cross branch at 1027 yds. set a rock on West side
of road from Duggan's ranch to San Angela
marked "County LINE" 1900 yds. stone monument
marked "7 MILES T.G. & S. Co. LINE fr. wh. a L.O. 10'
brs. S. 82° E. $38\frac{3}{5}$ yds. a do S. $11\frac{3}{4}^{\circ}$ W. $32\frac{4}{5}$ yds.

8. Thence West at 414 yds. cross the W. line
of Sur. No. 31 & E. line of Sur. No. 32 Block H.
152 yds. North from their South common corner
at 1265 yds. cross a branch, at 1900 yds. stone
monument on S. slope marked "8 MILES
T.G. & S. Co. LINE" fr. wh. a double L.O. brs. S. $3\frac{1}{2}^{\circ}$
W. $8\frac{1}{5}$ yds. a L.O. 7' brs. N. $36\frac{1}{2}^{\circ}$ E. 7 yds.

9. Thence West at 417 yds. cross the W.
line of said Sur. No. 32. 140 yds. North from its
S.W. corner at 1575 yds. cross a branch 1900 yds.
stone monument marked "9 MILES T.G. & S. Co.
LINE" from wh. a L.O. 7' brs. S. 15 W. 12 yds. a do
brs. S. $6\frac{1}{4}^{\circ}$ E. 10 yds.

10. Thence West at 39 yds. cross East line of
Sur. No. 8 G. C. & S. F. R. R. Co. 1249 yds. S. from
its N. E. cor. at 1239 yds. cross West line of said
Sur. No. 8 and E. line of Sur. No. 7 G. C. & S. F. Ry. Co.
Scrip. No. 3647, 728 yds. North from the S. E. cor.
of said Sur. No. 7. 1900 yds. stone monument
in prairie marked "10 MILES T.G. & S. Co. LINE."

11. Thence West at 1239 yds. cross the W.
line of said Sur. No. 7. 728 yds. N. from its S.
W. cor. at 1639 yds. cross the E. line of Sur. No.
68 Blk. # 25 H. & S. F. R. R. Co. 665 yds. North
from its S. E. corner. 1900 yds. stone monument in
flat prairie marked "11 MILES T.G. & S. Co. LINE."

12. 1 Thence West at 1580 vrs. cross Saw Angola
 2 + Poor Wallow road at 1626 vrs cross N. line of
 3 of said Sur. No. 68 and East line of Sur. No. 67.
 4 Block No. 25. 657 vrs. North from their South
 5 common corner. 1900 vrs. stone monument marked
 6 "12 MILES T.G. & S. Co. LINE" fr. wh. a L.O. 14' fr.
 7 N. 85° E. 53 vrs. a do. frs N. $36\frac{1}{4}^{\circ}$ W. $54\frac{1}{5}$ vrs.

13. 8 Thence West at 1614 vrs. cross the N.
 9 line of said Sur. No. 67 + E. line of Sur. No. 66 Pt.
 10 25. 649 vrs. North from their South common
 11 cor. 1900 vrs. stone monument on N. slope
 12 marked "13 MILES T.G. & S. Co. LINE."

14. 13 Thence West at 1120 vrs. cross a branch
 14 at 1380 vrs. cross another branch at 1612 vrs.
 15 cross the N. line of said Sur. No. 66 + E. line
 16 of Sur. No. 65 Pt. 25. 640 vrs. North from their
 17 South common corner. 1900 vrs stone monument
 18 marked. "14 MILES T.G. & S. Co. LINE" fr. wh.
 19 a L.O. 18' frs. $S 45\frac{1}{4}^{\circ}$ E $72\frac{4}{5}$ vrs.

15. 20 Thence West at 1610 vrs. cross the
 21 N. line of said Sur. No. 65 + E. line of Sur. No.
 22 64 Block. No. 25. 630 vrs. North from their S.
 23 common cor. 1900 vrs. stone monument marked
 24 "15 MILES T.G. & S. Co. LINE" fr. wh. a L.O. 12' fr. S
 25 59° E vrs.

16. 26 Thence West at 1607 vrs cross the N. line
 27 of said Sur. No. 64 and the E. line of Sur. No. 3
 28 C. W. McNeese 620 vrs. North from S. common
 29 cor. at 1720 vrs. cross the West line of said
 30 McNeese survey + E. line of Sur. No. 38 Block
 31 No. 24 N. + S. C. R. R. Co. 620 vrs. N. from their
 32 S. common corner. 1900 vrs. stone monument

17. ¹ in Dry Creek marked "16 MILES T.G. & S. Co. LINE"
² Thence West at 2100 rs. cross fence at 193
³ rs. cross road at 1717 rs. cross the N. line of
⁴ said Sur. No. 38 and E. line of Sur. No. 37 Block
⁵ 25, 608 rs North from their South common
⁶ cor. at 1870 rs. cross creek course North. 1900
⁷ rs. stone monument in valley marked "17
⁸ MILES T.G. & S. Co. LINE."
18. ⁹ Thence West at 1392 rs. cross a
¹⁰ branch course N 60° E. at 1713 rs. cross the N.
¹¹ line of said sur. No. 37 + E. line of Sur. No. 36
¹² Block 24. 595 rs. North from their S. common
¹³ cor. 1900 rs. stone monument on E. slope
¹⁴ marked "18 MILES T.G. & S. Co. LINE."
19. ¹⁵ Thence West at 1115 rs. cross branch
¹⁶ at 1710 rs. cross the N. line of said Sur. No.
¹⁷ 36. + E. line of Sur. No. 35 Block 24. 582
¹⁸ rs. North from their S. common cor. 1900 rs.
¹⁹ stone monument ^{on N. slope} marked "19 MILES T.G. & S. Co.
²⁰ LINE"
20. ²¹ Thence West at 1534 rs cross a road
²² at 1710 rs. cross a creek, and the N. line of
²³ said Sur. No. 35 and E. line of Sur. No. 34 Bk. 24
²⁴ 570 rs. North from their S. common corner.
²⁵ 1900 rs. stone monument marked "20 MILES
²⁶ T.G. & S. Co. LINE" fr. wh. a L.O. 5' bears S 86° E.
²⁷ 36 1/5 rs. a do. 4' brs. N. 87 1/2° E. 35 1/5 rs.
21. ²⁸ Thence West at 1710 rs cross the N. line
²⁹ of said sur. No. 34 and E. line of Sur. No. 33 Bk. 24
³⁰ 567 rs N. from their S. common cor. 1900 rs
³¹ stone monument marked "21 MILES T.G. &
³² S. Co. LINE."

22.

Thence West at 764 vrs. cross a branch
 at 1265 vrs cross a branch at 1710 vrs. cross
 the W. line of said Sur. No. 33 and the E. line of
 Mrs. Amanda Owens Survey 544 vrs. North from
 the S.W. cor. of said sur. No. 33 at 1721 vrs. the
 N.W. cor. of Sur. No. 1 G.C. & S.F.R. Co. Scrip
 No. 3644 bears S. 62° 9' vrs. 1900 vrs stone monument
 marked "22 MILES T.G. & S.C. LINE" from
 which the North fork of a 4 pronged L.O. bears
 S. 85 1/2° W. 140 2/5 vrs. a forked L.O. bears N. 87 1/2°
 W. 163 1/4 vrs.

23.

Thence West at 510 vrs. cross a branch
 at 1396 vrs. the W. line of said Amanda Owens
 Sur. & E. line of Sur. No. 1891 Sea Border.
 1579 vrs. N. from the S.W. cor. of said Owens
 sur. at 1570 vrs. cross fence at 1808 vrs. E. bank
 of South Concho river, 1900 vrs. stone monument
 in bed of South Concho marked "23 MILES
 T.G. & S.C. LINE." from wh. a L.O. 16' bears
 S 77 1/2° E. 89 vrs. a do. 13' brs. S 78 1/2° E. 89 1/2 vrs.

24.

Thence West at 565 vrs. the West line
 of said Sur. No. 1891 and the E. line of G.W.
 Kirkpatrick's Homestead survey 1004 vrs. North
 from the S.W. cor. of said Sur. No. 1891 at 719
 vrs. set a stone on N. side of San Angelo and
 Sonora road marked "County LINE" at 841 vrs.
 the West line of said Kirkpatrick survey and
 the E. line of Sur. No. 3 Tom Green Co. School
 Land 2908 vrs. S. from its N.E. corner. 1900 vrs.
 stone monument on E. slope, marked "24
 MILES T.G. & S.C. LINE" fr. wh. a L.O. 10' brs.
 N. 86 3/4° W. 52 vrs. a do. 12' brs. S. 53 1/4° W. 45 vrs.

25. 1 Thence West at 1254 vrs. cross a branch
2 1900 vrs. stone monument marked "25 MILES
3 T.G. & S. Co. LINE" fr. wh. a 5 pronged L.O.
4 30' lvs. S. 10° E. $31\frac{1}{2}$ vrs. a L.O. 6' lvs. S. $87\frac{1}{4}^{\circ}$ E. $53\frac{3}{5}$ vrs.

26. 5 Thence West 1900 vrs. stone monument
6 on E. slope marked "26 MILES T.G. & S. Co. LINE."

27. 7 Thence West at 404 vrs. the N. line of
8 said Sur. No. 3 and E. line of Sur. No. 1182 S. Co.
9 R.R. Co. 1058 vrs. S. of its N.E. corner 1900 vrs.
10 stone monument marked "27 MILES T.G. & S. Co. LINE."

28. 11 Thence West at 428 vrs. cross the N.
12 line of said survey No. 1182 + E. line of survey
13 No. 1184 S. Co. R.R. Co. 855 vrs. North from the
14 S.W. corner of said survey No. 1182 at 600 vrs.
15 cross Bois d'arc Creek. 1900 vrs. stone monu-
16 ment in farm, marked "28 MILES T.G. &
17 S. Co. LINE" from which a L.O. 12' on brow of hill
18 lvs. N. $36\frac{1}{4}^{\circ}$ W. 85 vrs. a do. 14' on hill side, bears
19 N. $70\frac{1}{2}$ W. 128 vrs.

29. 20 Thence West at 425 vrs cross the N. line
21 of Sur. No. 1184 + E. line of Sur. No. 1185 G. Co.
22 S. Co. R.R. Co. 100 vrs. S. from their N. common
23 corner. 1900 vrs. stone monument marked
24 "29 MILES T.G. & S. Co. LINE" fr. wh. a L.O. 24'
25 bears N. $49\frac{1}{4}^{\circ}$ W. 116 vrs.

30. 26 Thence West at 200 vrs enter bed of
27 Bois d'arc creek at 427 vrs. the West line of
28 said Sur. No. 1185 + E. line of survey No. 1188
29 G. Co. + S. Co. R.R. Co. 121 vrs. South from their
30 N. common corner. at 640 vrs. South bank
31 of a N. prong of Bois d'arc. Creek. at 1300 vrs.
32 cross same at 1680 vrs. recross same branch

1001 Green Co. Blk. line #5

1 1900 vrs. stone monument marked "30 MILES
2 T.G. & S. Co. LINE."

31.

3 Thence West at 424 vrs. cross the W.
4 line of Sur. No. 1188 & E. line of Survey No.
5 1189 G. & S. F. R. R. Co. 129 vrs. South from
6 their N. common cor. 1900 vrs. stone monument
7 on E. slope marked "31 MILES T.G. & S.
8 Co. LINE." fr. wh. a L.O. 15' bears $S 73 \frac{3}{4}^{\circ} E. 210$
9 vrs. a do. 22' fr. S. $114^{\circ} E. 218 \frac{3}{5}$ vrs.

32

10 Thence West a 425 vrs. cross the W.
11 line of Sur. No. 1188 and E. line of Sur. No. 1192
12 G. & S. F. R. R. Co. 162 vrs. S. from their
13 North common corner. at 1840 vrs. cross a
14 branch 1900 vrs. stone monument marked
15 "32 MILES T.G. & S. Co. LINE" fr. wh. a L.O.
16 18' bears $S. 46^{\circ} E. 127 \frac{1}{2}$ vrs. a do. 9' fr. N. $35 \frac{1}{4} E.$
17 73 vrs. a do. 9' fr. N. $52 \frac{1}{2} W. 100 \frac{2}{5}$ vrs.

33.

18 Thence West at 432 vrs. cross the W. line
19 of Sur. No. 1192 & the E. line of Sur. No. 1193
20 G. & S. F. R. R. Co. 189 vrs. S. from their North
21 common corner at 1060 vrs. cross a branch
22 1900 vrs. stone monument marked "33 MILES
23 T.G. & S. Co. LINE" from which a L.O. 12' bears
24 $N. 24 \frac{1}{2}^{\circ} E. 257$ vrs. a do. 10' bears $N. 25 \frac{1}{2}^{\circ} E. 265$ vrs.

25 Thence West at 434 vrs. cross the West
26 line of said Sur. No. 1193 209 vrs. S. from its
27 N. N. cor. & the E. line of Survey No. 1198 S. F.
28 R. R. Co. 970 vrs. South from its N. E. corner
29 1672 vrs. stone monument marked on S. side
30 "N. LINE S. Co. 33 MILES. & 1672 vrs." and
31 on N. side "S.W. Cor T.G. Co. S.E. Cor I Co."
32 from which the N. E. corner of Survey No. 1193

1 790 on Dove Creek bears North 18600 vrs. the
2 S. E. cor. of Said Sec. No. 1198 bears East 1238
3 vrs and South 941 vrs. a L. O. 30' marked T. G. Co.
4 bears N. 87° E. 348 vrs. a L. O. 10' marked I. Co.
5 bears N. 26³/₄° W. 55 vrs.

6 All monuments are at least 2 feet
7 high and marked as described

8 All bearings marked Σ unless otherwise
9 described. All line marks thus I.

10 Surveyed Nov. 16th to 23rd 1891 inclusive.

11 S. H. Ryan } Chain
12 O. C. Lane } Carriers.

13 I, Louis L. Farr Special Surveyor for
14 Tom Green County, Texas, do hereby certify
15 that the foregoing field notes and attached
16 sketch correctly describe the South boundary
17 line of Tom Green County Texas as the
18 same was actually surveyed and marked
19 by me, on the ground, on the dates and
20 with the chain-carriers aforesaid.

21 Witness my hand at San Angelo
22 Texas, this, the 24th day of December
23 A. D. 1891

24 Louis L. Farr
25 Special Surveyor.

26
27 The State of Texas
28 County of Tom Green I, Ed. Ruggan, Clerk
29 of the County Court of Tom Green County
30 Texas do hereby certify that foregoing
31 report, field notes and attached sketch are
32 true and correct copies of the originals

Tom Green Co. Bldg. No. 45

1 now on file and of record in my office
2 in Minutes of Commissioners Court Vol. 3
3 on page 387 et seq.

4 Given under my hand and
5 seal of office at San Angelo, Tex
6 this the 8th day of January A.D. 1892
7 E. Duggan
8 Clerk County Court,
9 Tom Green County, Texas

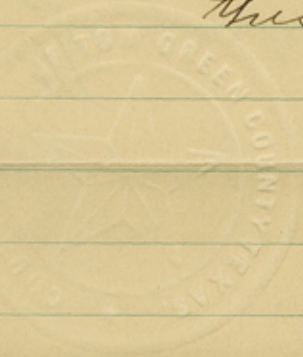

The State of Texas I Ed Suggan
County of Tom Green Clerk of the County
Court in and for Tom Green County
Texas, do hereby certify that in the
matter of surveying and establishing
the boundary line between Tom
Green and Slicked Counties, the
County Court of Menard County, to
which Slicked County is attached
for judicial purposes, was duly
notified of the time and place, at
which to meet the Special Surveyor
appointed by Tom Green County to
make said survey.

In testimony whereof witness my
hand and official seal this the
9th day of January 1894.

Ed Suggan Clerk
County Court Tom Green

South Line

of Tom Green County
Report of
Lauris L. Farr
Special Surveyor

Filed Dec'r. 24th 1891.

Ed. Duggan
Clk. Co. Court.
Tom Green Co.

Filed in Genl. Sd office
January 11th 1892

Wm Braullette
Chief Clerk

Examined, approved and
affixed

Jan'y 12th 1892 *Reasman*

Abstract corrected
April 2nd 1892

Reasman

Leion Co.

Tom Green Co.

Concho Co.

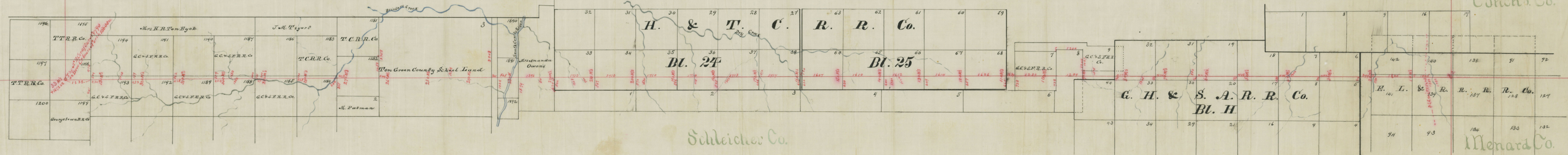

Schleicher Co.

Menard Co.