

2 File No. 55

Plat 2nd Field Notes
of the Boundary of
Trinity County,

Filed Feby 28th 1855

Houston

F/N missing 10/24/34

Beginning Corner of County line between
Houston and Trinity Counties on a Wilde
Cherry 4 in D from which a Hickory 12 in D
bears S 86° W 40 paces Marked **H.C.** and a Hackberry
6 in D Marked **I.C.** bears S 32° E 40 paces
The above corner being the S E corner of Henry Goldman
Survey of 980 acres or lower corner

Corner on West bank of the Neches River
on Spanish Oak 36 in D Marked **C.L.** from which
a Hickory Marked **C.L.** bears S 83° W 50 paces and a
White Oak 36 in D Marked **C.L.** bears S 12° W 130 paces dist

J. H. Colvard
D. J. H. Dis

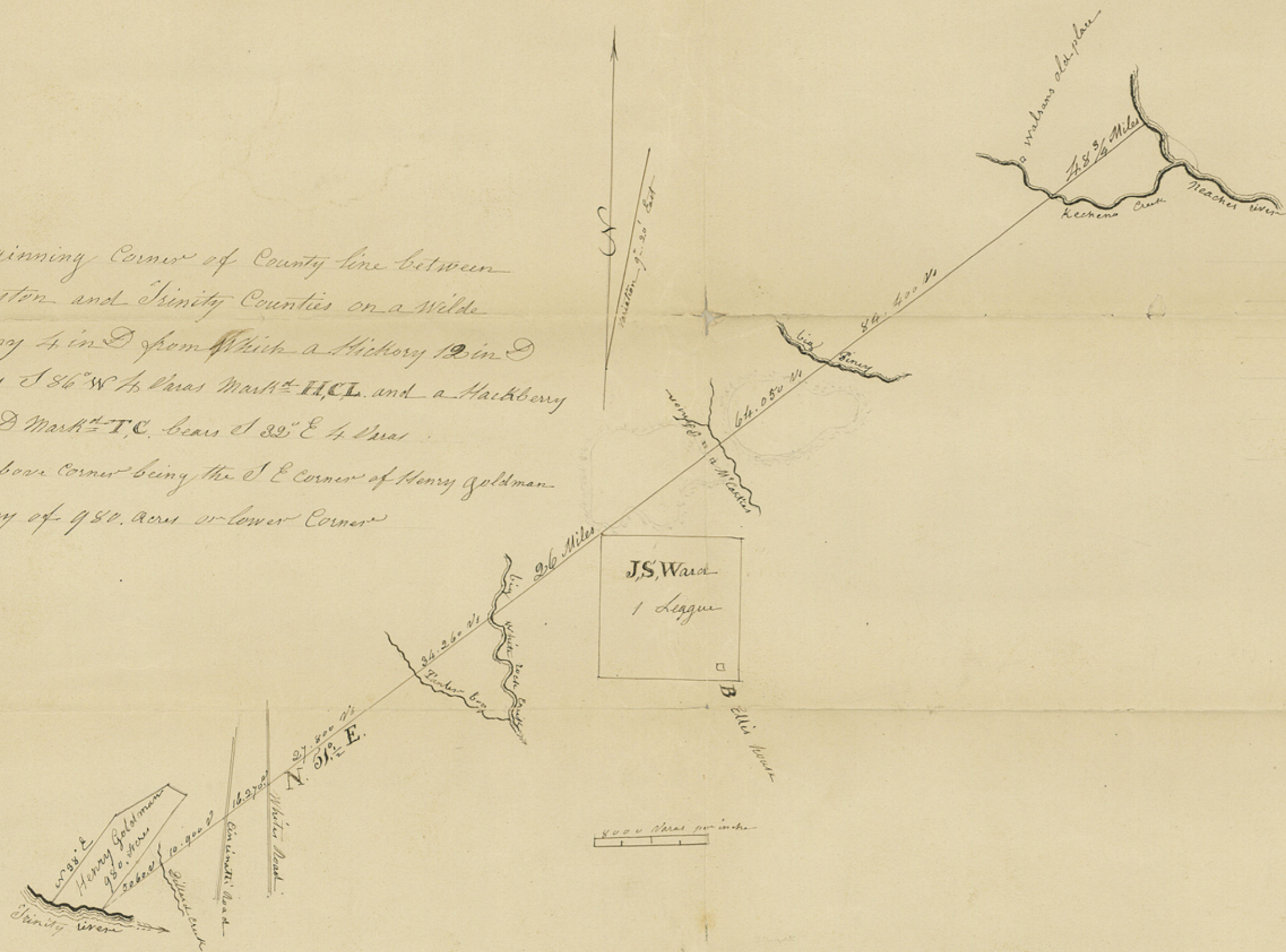

COUNTY LINES

Trinity Co. Bdry Lines

Plot of the Countyline
between Davidson &
Trinity County

Recd February 6th 1855

X
—

off