

The acres in red with mark thru them are Surveyor's figures, and unmarked figures are total acres shown on Files.
 The J.M. Cowden tract, S.F. 12948, shows by corrected f.n. to contain 182.8 acs, while the 3dly. line shows only 67 1/2 acs.

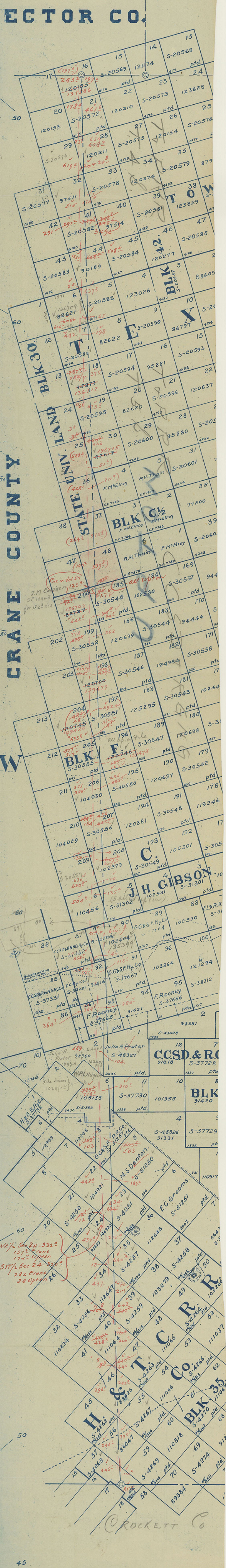

45

ECTOR CO.

CRANE COUNTY

TEXAS

45

59534

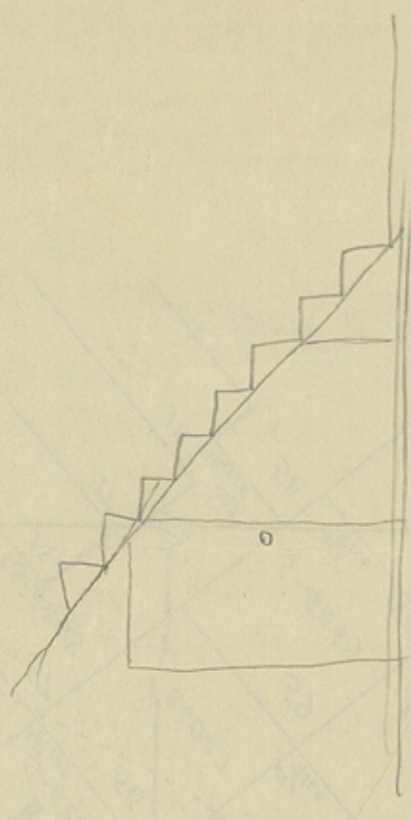

Upton Co Bdry Line 53

(Vol. 56)

Boundary Line
between Crane & Upton Co's.
Abstracted May 27, 1933.

Co. Line Filed 3/8/33.

a-lv 59535

CRANE CO