

No. 103

County of ...  
at ... Co.

1

received & filed May 12/87

motions applied  
May 2<sup>nd</sup> 1887  
by M. ...

For protest see  
letterfile { 209 278.  
              { 209 725.

59577



The State of Texas  
County of Val Verde  
Field notes of Val Verde County's. County line. East line.

Beginning at a pile of rock the N. E. corner of Survey No 201. Bear corner School Land from which a sycamore tree 6" in Dia. bears S. 71° E. 38 1/2 varas. another 12" in Dia marked V. V. C. bears N 87 1/4° E. 500 varas. a big Live Oak marked X. bears N 7° E. 360 varas. {said corner was established by running N 45° W. 505 varas from the S. corner of Survey No 202.}

Thence North at 62 varas on bank of sycamore creek. a rock mound. at 362 varas passing 1 ft east of a sycamore mound = at 390 varas a 10" sycamore mound = 1 ft west at 405 varas on East bank of draw at 498 var. passing L. O. = 1' E. at 566 1/2 var. a Live tree mound = at 600 var in L. O. brush at 820 var in a nother L. O. grove at 960 on elevated ground at 1166 3/4 var. crossing N. E. line of Survey No 202 at a marked tree = said tree is a Live tree of said survey at 1900 a stake 6" in Dia. the 1st mile. At 360 varas in bottom of dry drain at 940 var. crossing the same drain at 1100 a pile of rock on top of Hill from which a lone L. Oak. bears N 66° E. 200 var a mound of L. O. bears N 38° E. 400 varas at (3800). 1900 = 2nd mile mound of rock on slope of Hill 300 var. W. of creek. At 900 varas the head of one of the sycamore prongs at 1900 the 3rd mile mound on slope of Hill. At 1900 the 4th mile mound.

At 1004 var. due east 74 1/2 var of a rock. Survey corner near a large L. O. grove on creek. at 1900 = 5th mile mound on rocky Hill.

At 1345 a road leading S. W. to Del Rio a rock mound

Val Verde Co Bdry Line 103



Val Verde Co. Plat. line # 103

at 1700 a wire fence at 1900 var = 6 mile mount from which a rock pile on top of mountain bears S 43 1/2 E, 237 var. another pile of rock on foot of mountain bears S. 62 E. 152 varas. at 850 varas a road direction SW. at 1900 the 7th mile. a hack-berry post a rock and earth mount in a water grass flatt at 630 varas west of a Hack-berry marked at 1900 = 8th mile mount on Hill, 30 var. S.E. of a unfinished well.

at 100 var. to a rocky draw of Sycamore at 807 var. crossing fence at 1900 = 9 mile mount in a swag at 1900 = 10 mile mount, a stake and earth mount in mesquite brush flat.

at 1900 var = 11 mile mount in rocky flat.

at 1600 varas in bed of Sycamore running W. at 1900 = 12th mile post and rock mount

at 1800 passing east of a 3 pronged Cedar mbd = at 1900 = 13th mile mount. on foot of mountain chain near the the bank of a Sycamore prong

at 80 varas in bed of said prong at 1760 on top of mountain at 1900 a rock mount on N. slope of said mountain = 14th mile at 200 var in a gravelly valey at 1720 on slope of mountain at 1740 on N. bank of said mount at 1900 = 15th mile mount in valey.

at 720 on top of mountain at 800 in canyon at 1020 on Hill 20 varas west of a 3 pronged Cedar tree marked = at 1200 N. slope of said mountain at 1500 on top of another at 1900 = 16th mile in mount on plateau or table mountain.

at 360 the N. slope of mountain at 420 in bed of canyon at 600 on mountain at 640 on N. slope at 800 on top of another at 1000 on N. slope of said mountain at 1100 var in canyon at

15

16

2



- 1600 on mountain at 1800 var. on N. brink of  
 17 mountain at 1900 var = 17<sup>th</sup> mile mount in canyon  
 on foot of a long sloping mountain at 300 on  
 steep bluff of mountain at 400 in canyon, for  
 18 1500 var in valley crossing creek at 1900 = 18<sup>th</sup> mile  
 mount on East slope of mountain. (Offset)  
 (Thence East 160 var) North at 200 var top of mountain  
 at 400 in canyon at 1370 var offset west 160 var at  
 1474 of sett. West 160 var. at 1900 (+100) var of sett. East  
 19 160 var to 19<sup>th</sup> mile mount inside a horse shoe  
 bluff and cedar brake. at 120 on top of mountain  
 at 320 the brink of a very deep steep bluff at  
 400 in creek at 520 on slope of Hill, always on  
 East slope of 3 different mountain about 1/2  
 60 ft high from the level of a canyon running  
 N. S at 1820 var. crossing a canyon running E. W.  
 20 at 1900 var = 20<sup>th</sup> mile mount on S. slant of a steep  
 mountain marked XX, V.V.C.L.  
 at 100 var on top of mountain at 420 going down at  
 500 var in canyon at 680 passing 20 var East of a  
 cypress tree mkd = at 820 on top of said mountain  
 21 at 1900 = 21<sup>st</sup> mile mount on table mountain  
 near flat rock marked XXI, V.V.C.L. at 600 in  
 Carter valley at 1835 passing a L. O. mkd = at 1900  
 22 = 22<sup>d</sup> mile mount mkd XXII, V.V.C.L. a L. O. mkd  
 = East 20 var at 55 var passing East of L. O. mkd  
 23 = at 1900 = 23<sup>rd</sup> mile in brush flat. at 1900 var =  
 24 = 24<sup>th</sup> mile mount a rock mount on slope of ridge  
 25 mkd. XXIV, V.V.C.L. at 1900 var = 25 mile mount  
 on brink of rocky ridge a rock mount mkd. XXV  
 V.V.C.L. at 1080 in bed of creek South of a white of  
 26 bluff at 1900 var = 26<sup>th</sup> mile mount on west ridge  
 of mountain [ connection with Survey N<sup>o</sup> 2.  
 I & G. R. R. Co. Beginning at N. E. cor. of said Survey  
 Thence N 50° W. 247 var East 254 var. to County line



5  
Vol Verde Co. Aug. 1873

28

29

30

31

32

33

South 1040 var to the 25<sup>th</sup> mile mount<sup>n</sup>, at 400 var  
 going down Hill at 520 in canyon at 800 on  
 ridge at 920 in bed of creek at 1400 on high  
 ridge thence on west slope of said ridge at  
 1640 going down into a canyon at 1900 a rock  
 mount in bed of canyon 100 var. North of a Cedar  
 brook about 40 var square the 27<sup>th</sup> M. Mount mtd  
 XXVII. V.V.C.L. after passing over several mounta-  
 in ridges at 1900 - 28<sup>th</sup> mile M. mtd. XXVIII  
 V.V.C.L. on west slope of white rocky ridge  
 at 600 on high mountain north of chalk  
 bluff, thence down said mountain on west  
 ridge at 1900 - 29<sup>th</sup> M. mtd. XXIX. V.V.C.L.  
 Thence up and and down three mountain  
 at 800 var in a horse shoe bend canyon  
 at 1300 on high mountain at 1320 going  
 down the North slant at 1900 - 30<sup>th</sup> mile moun-  
 nt from which a round mount bears S. 15°  
 E corner mtd xxx. V.V.C.L. at 165<sup>var</sup> a rocky  
 branche thence on west slope of mountain 50'  
 above the canyon at 450 var in canyon at 1340  
 on East slope of mount on west bank of said  
 branche at 1820 on high ridge at 1900 - 31<sup>th</sup>  
 mile moun<sup>t</sup>. XXXI. V.V.C.L. at 110 var in canyon  
 at 235 on mount at 625 in canyon at 865 going  
 down Hill at 1000 on N.W. runner of ridge at  
 1200 in canyon at 1665 on mount at 1900 - 32<sup>nd</sup> mile  
 mount mtd. XXXII. V.V.C.L. at 1900 the 33<sup>rd</sup> mile moun<sup>t</sup>  
 XXXIII. V.V.C.L. after crossing several small ridge  
 at 1080 on high mountain at 1245 going down  
 Hill at 1400 passing a stone oak grove in a  
 head of horse shoe bend, Tree's 12" in Dia at  
 1545 over west slope of mount into a canyon  
 at 1850 in bed of def creek in front of a 30ft

103



- 34 high bluff at 1900 = 34 mile mount. XXXIV. V.V. C.L. on S. brink of mountain ridge. at 1550 vs. in rocky creek at 300 on West. slope of mount at 415 in creek and valey leading to Mail-trail hollow. at 600 in creek. at 775 in bed of a deep creek running S. E. & N. W. at 790 another drain. at 1000 in drain at 1060 in same drain at 1125 South of a bluff in said creek running E. & W. going through 6 Live Oak trees standing +++:+++ E & W. at 1425 in scrub. Mesq. flat 65 var. East of a white bluff on west bank of creek on foot of round mount, at 1620 east of shin oak grove at 1890 crossing the mail trail at 1900 = 35<sup>th</sup> mile mount near 4. span. daggers from which a round mount. top bears S 48<sup>1</sup>/<sub>2</sub>° W. a steep rocky bluff in gap of trail hollow bears N. 51° W. The mountaintop in said gap bears N 54<sup>1</sup>/<sub>2</sub>° W. another round mount top bears S. 68<sup>1</sup>/<sub>2</sub>° W. and 4 big L. Oaks on foot of slanting mount. bear S 54° W. Thence North at 456 in bed of creek South of steep bluff at 476 on West. brink of said mount at 600 in canyon at 860 on mountain. after crossing several out-runners at 1820 on high mountain at 1900 = 36<sup>th</sup> mile mount on North brink close to 2 dead cedar trees. XXX.VI. V.V.C.L. at 380 passing 6 L. Oaks = one big one only living at 420 in creek at 470 in another at 500 in fine broad valey running E & W. at 920 on West. brink of mountain at 1000 var. in valey at 1212 in creek at 1450 in another at 1900 = 37<sup>th</sup> mile mount XXXVII. V.V.C.L. on N. slant. at 540 crossing a deep ravine at 620 on small mountain at 1400 var. on high mountain at 1900 = 38<sup>th</sup> mile mount XXXVIII. V.V.C.L. on foot of West runner of mountain on East bank of creek at 480 passing West of a 18" L. O. on



2  
Val Verde Co. Bluff line # 103

West. bank of creek at 760 crossing creek running  
E & W. at 1120 on East brink of mountain at 1720  
1900 = 39<sup>th</sup> mile mount. XXXIX. V.V.C.L. at 680 on mountain top  
on top of high mountain at 1400 in flat leading  
to Buffalo head hollow at 1600 in Creek at  
1900 = 40<sup>th</sup> mile mount. XL. V.V.C.L. on E. slope of  
mount. and west. bank of creek

at 840 on west. slant of a big round Hill at  
1000 var. in valey of East. prong of Dry Devils river  
(Buffalo head hollow) at 1100 in creek at 1200 in  
Cedar flat on N.W. bank the 41<sup>st</sup> mile mount. at  
1900 var. in North valey of said Buffalo head hol-  
low near foot of mountain chain an umbrella  
shaped L. O. bears S 16 3/4° W. 610 var. XL I V.V.C.L.

at 860 crossing a deep ravine at 940 on East. ridge  
of mountain at 1580 on Hill at 1616 on N. brink  
of said mount. E. offset west 175 1/2 var North at  
1900 var offset East 175 1/2 var. the 42<sup>nd</sup> mile mount.

XLII. V.V.C.L. on East outcumber of a high mount-  
ain at 1480 var. at N. prong of long table mount  
at 1900 = 43<sup>d</sup> mile mount XLIII. V.V.C.L. on North brink  
of mount.

Thence through canyon at 817 offset west 800  
var. into valey of Dry Devils River North at 1617  
var. offset East 800 var. to County line North at  
1900 var = 44<sup>th</sup> mile mount in Dry Devils River valey  
XLIV. V.V.C.L.

at 483 var. 10 var. West of a L. O. mkt = V.V.C.L. 2 1/2'  
in Dia on the brink of Dry Devils River the  
river making a bend S L.

at 920 in Dry Devils river at 1060 on N. Bank  
of creek at 1380 in Dry Devils river at 1600 on  
bank at 1640 a rock mount on Dry Devils river  
Road from which a 2 pronged L. O. 8' in Dia  
bears S 76 1/2° E. 40 var. V.V.C.L. a 6 pronged L. O. motto



- 45 mhd. V.V.C.L. bears  $N 35 \frac{1}{4}^{\circ} E$ . 65 var. at 1900 = 45<sup>th</sup> mount  
mount. XLV V.V.C.L. a L.O. post and earth mount.
- 47 at 720 on high mountain at 1900 = 47<sup>th</sup> mile  
mount XLVI V.V.C.L. at 300 in canyon at 650 on  
mountain. thence going down said mount at  
800 crossing several outrunners at 1400 on  
mountain at 1600 on N. brink of another at  
1900 on top of mountain = 47<sup>th</sup> mile mount  
XLVII. V.V.C.L.
- 48 at 600 in valey at 1200 on mountain plateau  
at 1900 = 48<sup>th</sup> mile mount XLVIII. V.V.C.L.
- 49 at 1900 var. = 49<sup>th</sup> mile mount XLIX. V.V.C.L.  
at 1800 passing through a cedar brake at 1900
- 50 = 50<sup>th</sup> mile mount L. V.V.C.L.  
at 713 passing 4 L.O. = at 800 on small elevation  
at 855 going down in a valey at 1550 through  
cedar brake at 1900 = 51<sup>th</sup> mile mount. LI. V.V.C.L.
- 51 thence through rolling prairie at 1900 var. =  
52 52<sup>nd</sup> mile mount LII. V.V.C.L.
- 53 at 1900 = 53<sup>rd</sup> mile mount. LIII. V.V.C.L. on rocky ridge  
at 50 var going into a valey at 816 passing 5 var.  
East of a L.O. 10" in Dia. mhd. V.V.C.L. at 1320 on  
rocky ridge at 1820 in valey at 1900 the 54<sup>th</sup> mile  
mount on East bank of creek running S.W.  
LIV. V.V.C.L. at 1320 var. crossing said creek at 600 var.  
passing 6 var West of a double. L. Oak 18" in Dia. one dead  
one mhd. V.V.C.L. at 1200 on rocky ridge at 1300
- 55 through cedar brake at 1900 var. = 55<sup>th</sup> mile mount  
in 10 var. of 2 L. Oaks V.V.C.L.  
thence passing a cedar brake at 864 $\frac{1}{4}$  var (1010  
var West of a rock corner from which a cedar  
mhd B bears  $N 41^{\circ} E$ . 2 var. another mhd C bears  
 $N 88^{\circ} E$ . 36 $\frac{1}{2}$  var.) at 1767 $\frac{1}{4}$  var. a post-marked V.V.C.L.  
N.E.C. and earth and rock mount set for the  
N. E. cor. of Val Verde County from which a



Val Verde Co. Balley. Line # 103

10" Red Oak mhd. V.V.C.L. bears N 34° E. 27 1/4 var.  
a 6" L. Oak mhd = bears N 23° E. 42 var.  
a 6" L. O. mhd = bears N 23 3/4° E. 45 var. a 6" L. Oak.  
mhd = bears N 26° E. 42 1/2 var. a 6" L. O. mhd = bears  
N 27° E. 42 1/2 var.

Connection with corner on mouth of mail trail  
hollow and Bradford spring and County line  
Beginning at a rock amount found in bed of  
Dry-Devils River at the confluence of the mail-  
trail hollow and Dry-Devils River thence North  
at 4 var. on bank of creek at 200 var. Thence N 25 1/8° E  
1300 var. N 8° W. at 20 var. in bed of main Dry-Devils  
river at 293 var in public road N 15° E 21 1/3 var. N 14° E.  
4600 var. to the mouth of Bradford spring canyon N 21 3/4°  
W. 11 var. N 26 1/2° E 7200 var. N 27° E. 1400 var. North 800  
var. East 800 var. North 283 var. to the 44<sup>th</sup> mile mount

Connection with the road leading from Bearer  
Lake past Buckley-tank to Mackensie Lake and  
said Buckley tank.

Beginning at the established N. E. corner thence  
North at 670 3/4 var. said road at 830 var. a point  
300 var. East of the Centre of the North Wall of  
Buckley tank.

North County Line

Beginning at the aforesaid N. E. corner thence west  
at 30 var. 800 var. South of the South wall of Buck-  
ley tank at 450 var. passing 2 ft south of a 4" L. O. mhd  
= at 1760 in Buckley draw at 1895 crossing public  
road at 1900 = 1<sup>st</sup> mile mount I. V. V. C. L. from which  
3 L. O. 10" in Dia. bear N 23 1/2° E. 57 var. on East bank of  
creek

at 50 var. in creek at 60 var. W. of a L. O. mhd. = at 900  
in a drain at 1040 on Hill, thence through a small  
valley at 1400 on another Hill at 1900 = 2<sup>d</sup> mile mount

103



II. V.V.C.L. on slant of Hill. at 2800rs. north of cedar tree  
 on Hill at 400 in valey at 560 passing 100rs. N. of 15" L.O.  
 = burned at the bottom at 1000rs. on Hill at 1900. = 3<sup>d</sup>  
 mile mount III. V.V.C.L. on N. slant of Hill at 1400 in broad  
 valey at 1900 = 4<sup>th</sup> mile mount. a post; and rock mount-  
 mhd. IV. V.V.C.L. in said valey at 1240 in a gap 2 var. N.  
 of 6" L.O. = at 1900 = 5<sup>th</sup> mile mount V. V.V.C.L. from which  
 a 24" L.O. = bears N. 18° W. 44 var. another 10" L.O. = bears  
 N. 60° E. 15<sup>3</sup>/<sub>4</sub> var. at 227 var. 130rs. S. of a forked L.O. = at  
 207 var. <sup>100rs</sup> S. of double L.O. = at 1900 = 6<sup>th</sup> mile mount  
 VI. V.V.C.L. on N. slant of rocky Hill  
 thence over rocky Hill at 1900 = 7<sup>th</sup> mile mount mhd VII. V.V.C.L.  
 at " " " " 1900 = 8<sup>th</sup> mile mount mhd. VIII. V.V.C.L.  
 at 600rs. in broad valey of a Draw running into Devils  
 river at 1900 = 9<sup>th</sup> mile mount in said valey. IX. V.V.C.L.  
 at 1000 on Hill at 1010 var. passing 100rs. N. of a 3 prong  
 ed cedar = at 1900 = 10<sup>th</sup> mile mount X. V.V.C.L. in head of  
 rocky canyon <sup>at 1000rs. on Hill at 1400 through a cedar</sup>  
<sup>1550 var. on crest of Hill or 750 var. down a rocky canyon at</sup>  
 brake canyon at 1900 = XI. mile mount. XI. V.V.C.L. on  
 West slant of rocky ridge from which the right-  
 hand prong of a double cedar mhd = bears west-  
 19<sup>1</sup>/<sub>2</sub> var. the left hand prong bears S 88<sup>1</sup>/<sub>2</sub>° W. 200rs.  
 at 200rs. in valey at 780 on high ridge at 800 going  
 down in valey at 1900 = 12<sup>th</sup> mile mount. XII. V.V.C.L. in West-  
 prong of said valey at 1000rs. on N. ridge of Hill  
 at 1120 in same valey at 1900 = 13<sup>th</sup> mile mount. XIII. V.V.  
 C.L. at 240 on Hill at 400rs. going down at 1880 cross-  
 -sing a rocky drain at 1900 = the 14<sup>th</sup> mile mount. XIV. V.V.C.L.  
 N. E. of Cedar-brake. at 600rs. in Creek at 200 on N.  
 slant of Hill at 400 in valey of Devils. river at 1220  
 crossing Devils river road <sup>at 1230 var</sup> a rock 3 ft square mhd. V.V.C.L.  
 in County line at 1250 var. on foot of mountain at  
 1280 var. on said mountain at 1900 var. = 15<sup>th</sup> mile mount XV.  
 V.V.C.L. in Canyon on foot of a high mount.  
 at 100rs. on top of said mountain at 1040 var. on another



Val Verde Co. Geol. Surv. No. 103

at 17600rs a L.O. tree 12" in Dia  $\equiv \equiv$  at 1900 = 16<sup>th</sup> mile mount  
XVI, V.V.C.L. in valey from which a 8" L.O.  $\equiv$  bears N 18°  
E. 560rs. another 6" L.O.  $\equiv$  bears N 20 1/4° E.

570rs.

at 17600rs passing a L.O. mott in canyon at 1900 = 17<sup>th</sup>  
mile mount - XVII, V.V.C.L. on flat rock 100rs. S of 3 scrub  
L.O. tree. on mountain thence down said mount. for  
1900rs in valey = 18<sup>th</sup> mile mount XVIII, V.V.C.L. from  
which a 12" L.O.  $\equiv$  bears S. 23 3/4° W. 600rs. another mhd  
 $\equiv$  bears S. 27 3/4° W. 600rs. at 5800rs on mountain South of

3 L.O.  $\equiv$  at 14000rs on top of small Hill at 1900 the  
19<sup>th</sup> mile mount XIX, V.V.C.L. on S. slant of Hill from  
which an 8 pronged Cedar  $\equiv$  bears S 76 1/4° W. 600rs.

at 2000rs in valey at 12500rs. crossing a rocky ridge at  
14000rs. on top of mount at 19000rs. = 20<sup>th</sup> mile mount on  
Dr. edge of L.O. bush in flat; XX, V.V.C.L.

thence through flat at 6000rs. on Hill at 16000rs. on another  
at 19000rs the 21<sup>st</sup> mile mount in valey on East side of creek,  
XXI, V.V.C.L. which a 24" L.O.  $\equiv$  in bed of said creek and S of  
a bluff bears S 55 1/2° W. 3200rs

at 4000rs. on S. slant of Hill at 6000rs in left-hand  
valey leading to Bears. Lake at 1900 = 22<sup>nd</sup> mile mount:

XXII, V.V.C.L. on N. slant of Hill thence crossing the  
N. ou'runner of several rock canyons at 1900 = 23<sup>rd</sup>

mile mount XXIII, V.V.C.L. consisting of 8 plat-rocks  
on Divide at 6000rs. passing N. of 4 L.O.  $\equiv$  thence trough

the N. the end of a L.O. canyon at 1900 = 24<sup>th</sup> mile mount:  
XXV, V.V.C.L. on Divide at 19000rs. = 25<sup>th</sup> mile mount XXIV,

V.V.C.L. at 17400rs crossing a road leading from Beaver  
Lake to Howard's Well. a rock mount at 1900 the 26<sup>th</sup>

mile mount XXVI, V.V.C.L. at 19000rs. the 27<sup>th</sup> mile mount  
XXVII, V.V.C.L. at 16000rs crossing a Draw running S, E +

N. Dr. at 19000rs. = 28<sup>th</sup> mile mount XXVIII, V.V.C.L. on N. brink  
of Hill at 1900 = 29<sup>th</sup> mile mount XXIX, V.V.C.L. in Draw

running S + Dr thence crossing the head of several

103



canyon running S. at 1900 = 30<sup>th</sup> mile mount XXXV. V.V.C.L.  
ct. on Hill thence crossing 3 canyons running S & N.  
at 1800 vs on top of high Hill thence down a steep  
bluff at 1900 = 31<sup>th</sup> mile mount in vally of Indian  
run XXXI. V.V.C.L. thence crossing on a rocky ridge in  
left-hand draw of said Indian run at 1900 vs  
the 32<sup>d</sup> mile mount 60 var. East of a light red bluff  
in creek from which a sugarloaf and very sharp  
peaked mount bears S 2 1/2 W. about 1 1/2 mile

Thence south 60 var at 1600 vs. on top of high Hill  
North 60 var at 1900 vs. = 33<sup>d</sup> mile mount. XXXIII V.V.C.L.,  
at 250 vs. crossing a deep ravine at 540 vs. on top of  
ridge at 1800 vs. going down into a canyon running  
S. W & E. into the Johnson draw at 1900 = 34<sup>th</sup> mile mount  
XXXIV. V.V.C.L. on rocky-ridge at 1600 vs in canyon at  
270 vs. on Hill at 320 vs. on brink of Hill at 420 vs. in  
broad vally at 1240 vs. on high Divide at 1900 vs. 35<sup>th</sup>  
mount XXXV. V.V.C.L.

thence on Divide at 1900 vs. = 36<sup>th</sup> mile mount XXXVI V.V.C.L.

" " " " 1900 vs = 37 mile mount XXXVII V.V.C.L.

" " " " 1900 vs = 38 mile mount XXXVIII. V.V.C.L.

at 1400 vs crossing a public road former military  
trail at 1900 vs = 39<sup>th</sup> mile mount on N. brink of  
canyon V.V.C.L. XXXIX. at 680 vs. on mountain thence  
crossing two broad canyons running N & S. at 1900  
vs = 40<sup>th</sup> mile mount on Divide XL. V.V.C.L. between  
two canyons at 200 vs in canyon at 1000 vs going  
into another at 1600 vs. on mount - at 1900 = 41<sup>th</sup> mile  
mount XL I. V.V.C.L. at 1900 vs = 42<sup>d</sup> mile mount XL II. V.V.C.L.  
from which a cedar bush bears N 5 E. 4 var.

at 1900 vs. the 43<sup>d</sup> mile mount. XL III. V.V.C.L. in head of  
canyon running South at 622 var. passing South  
of a cedar tree = at 1900 vs. the 44<sup>th</sup> mile mount XL IV. V.V.  
C.L. at 800 vs going down into a canyon at a place  
where 3 canyons meet in form of a star at 1040 crossing

11



Val Verde Co. Range Line #103

12

the W. prong of said canyon at 11200 var. on Hill at 1900 var. =  
 46<sup>th</sup> mile mount XLV. V.V.C.L. on East brink of a deep canyon  
 covered with cedar-brakes Thence South 80 var East 180 var  
 South 400 var West 400 var. North 480 var. = 220 var. on  
 County line at 6260 var. on brink of deep canyon  
 Thence <sup>Thence N. 72° W. 520 var. S 66° W. 600 var. = 1527 var. crossing line</sup> North of a cedar tree = Thence South 139 var.  
 Thence West 377 var. = 1900 var. = 46<sup>th</sup> mile mount XLVI. V.V.C.L.  
 on Foot of high mountain at 200 on said mount  
 at 7200 var. on brink of mount at 1900 var. = 47<sup>th</sup> mile  
 mount XLVII V.V.C.L. on the East-foot of a high mount.  
 at 2400 var on said mount at 1400 var. going down into a  
 canyon at 1900 var. = 48<sup>th</sup> mile mount XLVIII. V.V.C.L.  
 at 1200 var. a point 400 var. South of a sife-spring in rocky canyon  
 Thence crossing said canyon at 1900 = 49<sup>th</sup> mile mount on West-brink  
 of Hill 600 var. East of Howards run valley. XLIX. V.V.C.L. at 600 var. in  
 Howards run at 2200 var. in gravel bed at 400 in valley at 735  
 var. a public road at 740 var. a rock mount V.V.C.L. Thence N 13°  
 W. 514 var. S 85° W. 700 var. = 1570 var. County line at 1900 var. = 50<sup>th</sup>  
 mile mount L. V.V.C.L. in head of a rough canyon running  
 North at 72 var. a deep ravine. N 47° W. 340 var. S 69 1/4° W. 570 var. = 1481  
 var on County line at 1800 going down into a canyon at  
 1900 var. = 51<sup>th</sup> mile mount LI. V.V.C.L. in creek of said canyon  
 Thence S. 23° W. 600 var. West 254 var. N. 70° W. 970 var. North 212 var.  
 1166 var. on County line in the right-hand prong of a canyon  
 at 1900 var. = 52<sup>d</sup> mile mount LII. V.V.C.L. on S side of creek of  
 the left-hand prong of said canyon  
 at 2000 var. on Divide at 1050 var. going down into a canyon  
 with heavy cedar-break at 1700 var. crossing creek in said  
 canyon at 1900 var. the 53<sup>d</sup> mile mount on East-brink of  
 steep Hill LIII. V.V.C.L. at 2400 var. on Divide at 960 var. on  
 brink of Divide Thence North 1000 var. West 940 var. South  
 1000 var. = 1900 var. = 54<sup>th</sup> mile mount on Divide LIV. V.V.C.L.  
 at 800 var. crossing a canyon at 920 var. on Divide at 1020  
 crossing canyon at 1900 = 55<sup>th</sup> mile mount LV. V.V.C.L. in  
 Cedar track at 1000 var. on Divide at 1400 going down

103



into a canyon at 1900 var. the 36<sup>th</sup> mile mount- on E. brink  
of said canyon LXI. V.V.C.L. thence across a mount- at 1200  
var. on deep canyon thence N 31° W. 410 var. S 73½° W. 900 var.  
East 400 var. the 37<sup>th</sup> mile mount- LVII. V.V.C.L. on West- brink  
of Canyon (said mount- is 87 var. West of the exact spot  
on account of impossibility to build a monument  
in said canyon at 1140 var. going down into a deep  
canyon North 600 var. West 640 var = 1867 var on Line  
South 600 var. at 1900 var. 38<sup>th</sup> mile mount- on moun-  
tain outcrops. LVIII. V.V.C.L. at 1000 var. going down  
a steep canyon North 750 var. West (at 600 var. on  
Hill at 750 var. in canyon at 1800 var. on another  
mountain) at 1900 var. South 750 var. the 39<sup>th</sup> mile  
mount- on West- brink of Mountain LIX. V.V.C.L.  
thence back North 750 var. <sup>West</sup> at 1200 var. on Divide South  
750 var. at 1900 var. the 40<sup>th</sup> mile mount- LX. V.V.C.L. in canyon  
at 1290 var. on East- slope of high mountain on West- side  
of Live Oak branch thence S 15¾° W. 1020 var. West-  
1636 var. North 981 var. East 1000 var. the 41<sup>th</sup> mile mount-  
LXI. V.V.C.L. on West- slope of Hill foot- Hill to the  
Pecos River thence West- at 870 var. the water edge of the  
River- edge from which a Garder. the bank of the  
River just- above a cedar tree on bluff bears S 88¼°  
W. 3 caves = bear N 88° W. another round cave bears N 39¾°  
W. the South point- of an island in the River bears  
N 12° W. 60 var. the river coming from N 12° W. <sup>S 32° W</sup> running  
Established the permanent N.W. corner 200 var. East-  
of the water edge on the first- rising ground on  
account of the liability of any monument- being  
washed away close to the River. a large rock mount-  
mkd. V.V.C.L. N.W.C.

Connection with Beaver Lake survey Beginning  
at the S.E. cor. of Survey N° 160. for T. & G. R.R. Co.  
thence North 233 var. crossing Devils river to a rocky  
pile on public road thence East 1900 var. N 42° E.



5- Val Verde Co. Boundary Line #103

1800 var. N 2° E 420 var. N 64° E. 1000 var N 18 1/2° E. 200 var  
N 13 1/2° E. 2000 var. N 38 1/2° E. 1020 var N 88 1/2° E. 140 var. N 14 1/2° E.  
200 var N 9° E. 600 var. N 23° E. 540 var. N 23° E 640 var. N 47°  
E. 600 var N 11 1/2° E. 780 var. N 2 1/4° W. 1260 N 30 1/2° W. 496 to the 18<sup>th</sup>

mile mount Connection with survey corners  
found on the ~~you may~~ River Beginning at the N.W.  
corner on the watershed thence South 360 var S 30°  
E. 293 1/2 var N 7 1/4° E. 480 var a rock corner on Hill from  
which another corner bears East 430 var

Beginning at a point S 15 3/4° W. 1020 var of the 129 var.  
West of the 60<sup>th</sup> mile mount thence S 34° E. 47 var S 76°  
E. 1340 var. S 85 1/4° E. 340 var. to a rock corner on bank  
of River Pacos, where the River comes from due West  
and runs S 26° E for 110 var. thence due East 100 var thence  
S. E. said corner is S 20° E of a big white rock on river  
bank and N 45° E from a bluff

### West County Line

Beginning at the established N.W. corner at the  
watershed of the River Pacos thence South at 360 var  
(crossing the river) S. 00° E. 293 1/2 var. S. 25 1/4° W. at 330 var  
County line = 911 var thence on the West bank of  
mountain at 1900 var. the 1<sup>st</sup> mile mount - on top of  
said mountain I. V.V.C.L. thence on Divide at 1900 var =  
2<sup>d</sup> mile mount II V.V.C.L. at 68 var S 73° E 320 var S 9° E  
820 var S 34° W 250 var West 160 var S 13° W. 140 var  
West 98 var. = 1314 var on County line South at 1720 var  
on brink of first broad canyon at 1900 var in  
valley 3<sup>d</sup> mile mount III. V.V.C.L. thence at 180 var S 50° E  
600 var. South 84 var. S 36° W. <sup>West 10 var. South</sup> 600 var at 1900 the 4<sup>th</sup> mile  
mount on Divide between 2 prongs of a big hollow  
from which a cedar tree bears South 46 var another  
one 173 var on brink of Divide at 173 var West 890  
var. South 1200 var. East 890 var. South at 1760 var going



down into canyon at 1900 var. = 5<sup>th</sup> mile mount V. V. V. C. L. in bed of said canyon at 2000 var on divide at 2300 var a cedar tree = at 2400 var. another tree = in line at 1900 = 6<sup>th</sup> mile mount VI. V. V. C. L. in flat - thence through open flats at 1900 = VII mile mount V. V. C. L. at 1200 var crossing a creek in said flat at 1880 crossing another creek at 1900 = the 8<sup>th</sup> mile mount on South bluff of said creek. VIII V. V. C. L. thence at 200 var through a cedar break, thence in open prairie at 1900 var = 9<sup>th</sup> mile mount IX. V. V. C. L.

at 1900 var. = 10<sup>th</sup> mile mount X. V. V. C. L.  
 at 1900 var. = 11<sup>th</sup> mile mount XI. V. V. C. L.  
 at 1900 var. = 12<sup>th</sup> mile mount XII. V. V. C. L.  
 at 1900 var. = 13<sup>th</sup> mile mount XIII. V. V. C. L.  
 at 1900 var. = 14<sup>th</sup> mile mount XIV. V. V. C. L.  
 at 1900 var. = 15<sup>th</sup> mile mount XV. V. V. C. L.  
 at 1900 var. = 16<sup>th</sup> mile mount XVI. V. V. C. L.  
 at 1900 var. = 17<sup>th</sup> mile mount XVII. V. V. C. L.  
 at 1900 var. = 18<sup>th</sup> mile mount XVIII. V. V. C. L.  
 at 1900 var. = 19<sup>th</sup> mile mount XIX. V. V. C. L.

Flat covered with small brush. No grass or tree

at 200 crossing a creek running S. W. at 1900 var. = 20<sup>th</sup> mile mount V. V. C. L. XX. at 600 var elevation at 1640 going into a swag at 1900 var. = 21<sup>th</sup> mile mount XXI. V. V. C. L.

at 1850 crossing drain at 1860 track of S. P. & A. S. R. R. Co. at 1900 var. = 22<sup>nd</sup> mile mount XXII. V. V. C. L. from which No. 220 bears N 13° 30' W 30 var. Connection at this place with the Rail road track. Beginning at ~~curve stake~~ 1413.0 + 019 = E. C. 3° L. - No. 415. thence S 20½° E. 41 var a rock pile S. 74° E. 92 var. the 22<sup>nd</sup> mile mount Beginning at half mile post on South side of track 14138 + 33 thence N 58° W at 80 var. bridge No. 221 at 139 var. a curve stake on ~~side~~ side of track 14142 + 241 = B. C. 3° L. No. 415. at 200 crossing track at 248 var. a point from which the 22<sup>nd</sup> mile mount bears S 68° W. 69 var.



Val Verde Co. Bluff line #103

South at 140 var. an elevation at 420 var on a high one at 800 var on west slope of Hill just below the brink thence crossing the heads of several canyons at 1260 var on the top of said Hill at 1750 on another Hill at 1900 the 23<sup>rd</sup> mile mount. XXIII V.V.C.L. on East outrunner of said Hill on South side of the head of a small canyon running East-

at 1900 var. = 24<sup>th</sup> mile mount XXIV V.V.C.L.

at 1900 var. = 25<sup>th</sup> " " XXV V.V.C.L. in head of a hollow

at 920 var. public road a rock mound at 1900 var. = 26<sup>th</sup> mile mount V.V.C.L. XXVI at 1700 var. in flat of a big creek at 1800 crossing gravel bar of said creek at 1900 var. = 27<sup>th</sup> mile mount XXVII V.V.C.L. in flat on South side of said gravel bar

at 580 var. on Hill thence crossing the heads of several small hollows running W into said creek at 1900 var. the 28<sup>th</sup> mile mount: XXVIII V.V.C.L. at 1000 var. crossing creek running E & W. at 2000 var. on Hill (about 600 var East of Mr H. Roach & Mahon's rancho house on Antonio creek) at 1900 var. = 29<sup>th</sup> mile mount on South slope of Hill. N. of a rocky bluff on S. side of creek

V.V.C.L. XXIX at 160 var. in deep rocky creek at 175 the afore said bluff at 360 on top of Hill at 400 going down into a canyon at 470 crossing drain at 600 on foot of Hill at 780 on Hill from which a rock corner on said Hill. bears N 17 1/2 W. 760 var. at 1600 going down into a drain at 1900 var. = 30<sup>th</sup> mile mount on small Hill. 600 var. East of sife springs in said drain. XXX V.V.C.L. at 800 var. crossing creek at 680 on Hill at 800 var. on second Hill at 1000 var. crossing a Drain at 1300 on top of Hill at 1550 crossing a big hollow at 1900 var. 31<sup>st</sup> mile mount XXXI V.V.C.L. in hollow thence crossing several rocky hollow at 1900 var. = 32<sup>d</sup> mile mount XXXII V.V.C.L. in head of small drain at 1200 var. on top of Hill thence on the East slope of



said Hill along side a hollow running N + S. at 1900 var.  
 = 33<sup>d</sup> mile mount XXXIII, V.V.C.L. at 1240 var. crossing a deep  
 ravine at 1400 on mountain at 1500 going into another  
 deep canyon at 1700 going up Hill a 1900 var. = 34<sup>th</sup>  
 mile mount on slant of said Hill XXXIV, V.V.C.L.  
 at 700 var. a deep ravine at 240 on top of ridge at 280  
 going into another deep canyon at 590 var. on flat +  
 small table. Hill established the permanent S.W.  
 corner of Val Verde Co. a rock mount mkd V.V.C.L. S.W.C.,  
 thence at 1130 var. the water edge of the Rio Grande a  
 rock in the water mkd V.V.C.L. S.W.C. thence a Limestone  
 bluff bears N 72° E. 1 mile, another one N 39° W. 600 var.  
 another one on the Mexican side S. 9° E. 500 var. another  
 round top one bears S 30½° E. 800 var. The Rio Grande coming  
 from N 53½° W. for 600 var. runs S 53½° E. about 400 var. at  
 the point 600 var. N 53½° W. from the corner the river comes  
 from N 63° W. building a long island. the aforesaid  
 S.W. corner is about 1 mile East of the mouth of  
 Myers Spring canyon

Finis

Variation 9° 30' E.

Bearings marked. V.V.C.L. = X. Roman figures  
 Surveyed from the 23<sup>d</sup> of Nov. 1886 to the 20<sup>th</sup> of February  
 1887. Swoon flag and chain carriers: Tom Mc Coy,  
 Allen Pullin, Jack Sling all three of Mc Mullen Co  
 Texas. William Sourmilk J. M. Jernison, John Hall  
 of Val Verde Co. S. Frank H. Burmeister. Surveyor  
 of the aforesaid County. - line. Do hereby certify  
 under my official oath that said County. lines were  
 actually run on top the ground according to law that  
 the fore going field notes contain a true and correct dis-  
 cription of the said line <sup>and corners</sup> and that the corners and bea-  
 rings and marks, natural and artificial are on the grou-  
 nd and truly described in said field notes

Frank H. Burmeister



Subscribed + sworn to before me this the 1<sup>st</sup> day of March a.d. 1887

G. W. Brown  
Co clk Val Verde Co Texas

The State of Texas  
County of McMullen E. F. Frank H. Burmeister  
Surveyor of Val Verde Co line Do hereby certify  
that I established the North East Corner of said  
Val Verde Co by running due West from the N. W.  
corner of Kear. County and N. E. corner on the  
ground at established by Survey Viceroy (I believe)  
that I run due West from said corner passing the  
point where the S. W. corner of Kimble Co would  
be if established on the ground and that I inter-  
sected the East line of Val Verde Co at the point at  
shown in the field notes and map

Witness the 26<sup>th</sup> of March 1887  
Frank H. Burmeister

Sworn to and subscribed before me this day 26<sup>th</sup>  
of March A. D. 1887

R. A. Lowe  
Clerk Co. of McMullen Co  
By F. P. Dickinson Deputy  
Texas

The State of Texas  
County of Val Verde } I G. W. Brown  
Clerk of the County do hereby certify that the  
above & foregoing (18) Eighteen pages  
of writing is a true and correct copy

Val Verde Co. Bdry. Line #103



of the field notes of Val Verde County  
series as surveyed & filed by Francis  
H. Burmeister, said field notes  
now on file in my office & duly recorded  
in Deed Book N<sup>o</sup> 2, pgs. 100. & the  
above field notes compared & entered  
before making this certificate of  
entering on 6<sup>th</sup> pg between 2<sup>d</sup> & 3<sup>d</sup> line from  
top of page "1900 = 39<sup>th</sup> inch mount xxxix. vcl. at  
680. on mountain at"

entering on 9<sup>th</sup> pg between 18 & 19<sup>th</sup> line from  
top of page "1550 m on entrance of hill at 1750 going  
down a rocky canyon at"

entering on 12<sup>th</sup> pg. between 5<sup>th</sup> & 6<sup>th</sup> pg. from the  
top of page "Elevations N. 42<sup>1</sup>/<sub>2</sub> or 520. or 566<sup>o</sup> or 600 m  
= 1523. on corner line"

entering on 14<sup>th</sup> pg. between 21 & 22<sup>o</sup> pg. from  
top of page "(Crossing the River) S. 30.0 29<sup>3</sup>/<sub>4</sub> or S  
25<sup>1</sup>/<sub>2</sub><sup>o</sup> W at 330. ors." the enterings  
made by me,

Witness my hand and the  
Seal of the County of  
in & for Val Verde County  
Texas at office in Del Rio  
this 28<sup>th</sup> day of April A.D. 1887  
J. W. Brown, Clerk  
County of Val Verde



59592

No 103

County Boundary Lines  
of Val Verde County.  
2

Received and filed in  
the Genl. L'd Office, May  
2<sup>nd</sup> 1887 R. H. Hickey  
Chf Clerk

Corrections made on Map  
of Val Verde Co May 2<sup>nd</sup> 1887  
G. W. Beaman

No 103

Val Verde Co. Bdry. Line #103



20



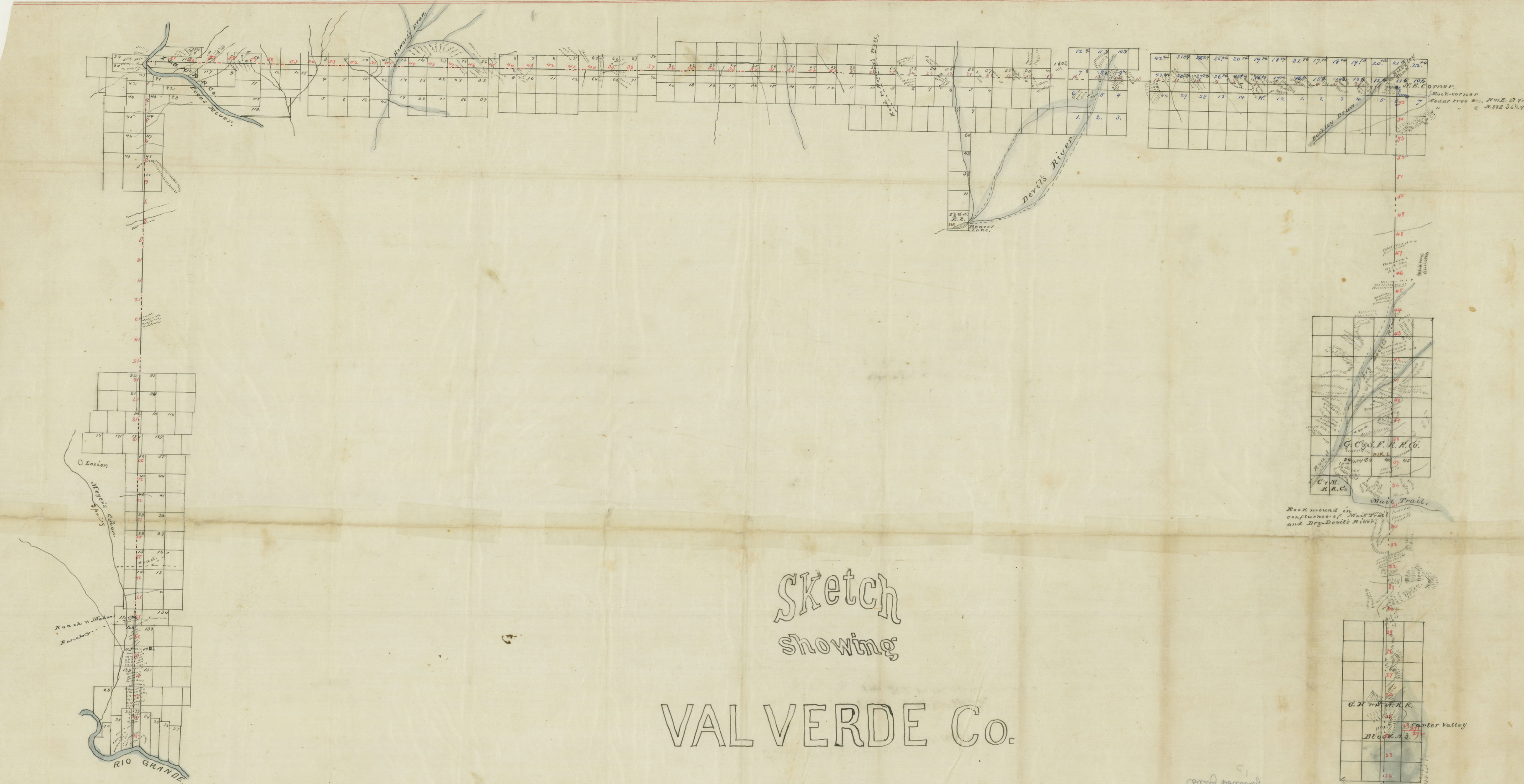

Sketch  
showing  
VAL VERDE Co.  
LINE

The State of Texas }  
County of Val Verde }  
I, G. W. Brown, Clerk  
of the County Court of Val Verde County,  
Texas, do hereby certify that this tracing  
is a true and correct copy of the original  
Sketch of Val Verde County lines now  
on file in my office  
Given under my hand and the  
Seal of the said court at office  
in Del Rio, Texas, this 22<sup>d</sup> day of  
April A.D. 1887  
G. W. Brown  
Clerk Co. Court Val Verde Co., Texas

I, Frank H. Burnette, Surveyor of Val Verde Co. line  
do hereby certify that the above is a true and correct  
Sketch of said county line as surveyed by me from the  
23<sup>d</sup> November 1886 to the 25<sup>th</sup> February 1887  
Frank H. Burnette  
Surveyor Val Verde Co., Tex.  
Sworn to and subscribed before me  
this the 26<sup>th</sup> day of March A.D. 1887  
W. A. Fowe  
Clerk Co. Ct. Val Verde Co.  
By F. P. Dickinson, Deputy.

Handwritten notes in blue ink, including the number '3' and some illegible scribbles.

Handwritten notes at the bottom right, including 'S.E. Corner', 'Line tree', and 'Rock mound'.



This is a sketch of the  
 land owned by the  
 company in the  
 year 1881 and is  
 intended to show  
 the location of the  
 land in relation  
 to the river and  
 the other land  
 owned by the  
 company.

This is a sketch of the  
 land owned by the  
 company in the  
 year 1881 and is  
 intended to show  
 the location of the  
 land in relation  
 to the river and  
 the other land  
 owned by the  
 company.

THE  
 VAL VERDE CO.  
 Survey  
 Sketch

Received and filed  
 in the General Land  
 Office May 2nd 1887  
 R. H. Sherry  
 Chief Clerk.  
 Val Verde  
 County Boundary

