

No. 2

South rd West line
of
Wichita Co

Filed Aug. 8th 1887

Examined, approved and
affixed

Dec 23rd /87 G. W. Beaumont

Field Notes of the South Boundary Line of Wichita County Texas

Beginning at the N. E. corner of Archer
county a rock mk. W. C. S. E. Cor. A. C.
N. E. cor. Thence West at 1900.8 varas a rock
mk. A. 29 at 3801.6 us. a rock mk. A. 28
at 5702.4 us. a rock mk. A. 27
at 7603.2 us. a rock mk. A. 26
at 9504 us. a rock mk. A. 25
at 9806 us. the S. W. corner of survey No. 8
patented to John A. Scott bears North 2388 us.
at 11404.8 us. a rock mk. A. 24
at 13305.6 us. a rock mk. A. 23
Crossing Holliday Creek several times
at 15206.4 us. a rock mk. A. 22
Still crossing and recrossing Holliday Cr.
at 17107.2 us a rock mk. A. 21
at 19008 us. a rock mk. A. 20,
at 20908.8 us. a rock mk. A. 19
at 22809.6 us. a rock mk. A. 18
at 24710.4 us. a rock mk. A. 17
at 25105 us the S. W. corner of survey
No. 1 patented to E. Fitzgerald bears
South 5390 us.
at 26611.2 us. a rock mk. A. 16
at 28512 us a rock mk. A. 15
at 30412.8 us a rock mk. A. 14
at 32313.6 us. a rock mk. A. 13
at 34214.4 us. a rock mk. A. 12
at 36115.2 us. a rock mk. A. 11
at 38016 us. a rock mk. A. 10

at 39916.8 us. a rock mk. A. 9
 at 41474 us. the N. W. corner of the
 Moses F. Roberts survey bears North 5988 us.
 At 41817.6 us. a rock mk A. 8
 at 43718.4 us. a rock mk A. 7
 at 45619.2 us. a rock mk A. 6
 at 47520 us. a rock mk A. 5
 at 49420.8 us. a rock mk A. 4
 at 51321.6 us a rock mk A. 3
 at 51741 us cross Big Wichita River
 at 52954 us. the S. W. corner of the W.
 H. Spillars survey bears South 2130 us.
 At 53222.4 us. a rock mk A. 2
 at 55123.2 us. a rock mk A. 1
 at 57024 us. a rock in rock mound
 marked A. Co. N. W. cor., B. Co. N. E. cor.
 and W. Co. S. W. cor

Surveyed July 28th 1887 Variation 10° E.

A. Warren Surveyor
for Wichita Co. Texas

I J. P. Hart Co. Surveyor of Archer Co.
 Texas having been appointed by the
 Commissioner's Court of said county
 to assist in surveying the North Bound-
 ary line of Archer and South Boundary
 line of Wichita county do hereby
 certify that the above field notes are
 true and correct and that the land
 marks at the corners named therein.

are all the marks now to be found
by which the location of the surveys
upon or near said line can be
determined.

J. P. Hart
Surveyor for Archer co

State of Texas $\frac{3}{3}$ J. C. Reid Clerk
Wichita County $\frac{3}{3}$ of the County Court in and
for Wichita County, Texas, Certify that the
foregoing 2 pages of Field Notes and Plat of
~~South~~ Boundary line of Wichita County con-
tain a true and correct copy as it appears
of Record in Book K page 20~~th~~ of Deed
Records of Wichita County.

Given under my hand and seal of office
this 5th day of August A. D. 1887

C. E. Reid Clerk
County Court Wichita Co Texas

2/ Wichita County

Southern Line

Filed Aug. 8th 1887

Examined, approved and
applied

Filed for Record August
4th 1887 at 11 o'clock A.M.

C. B. Reid c.c.c.
Wichita County Texas

Examined and found correct
but only 4 surveys connected
with the line

\$4.00

copy 5904

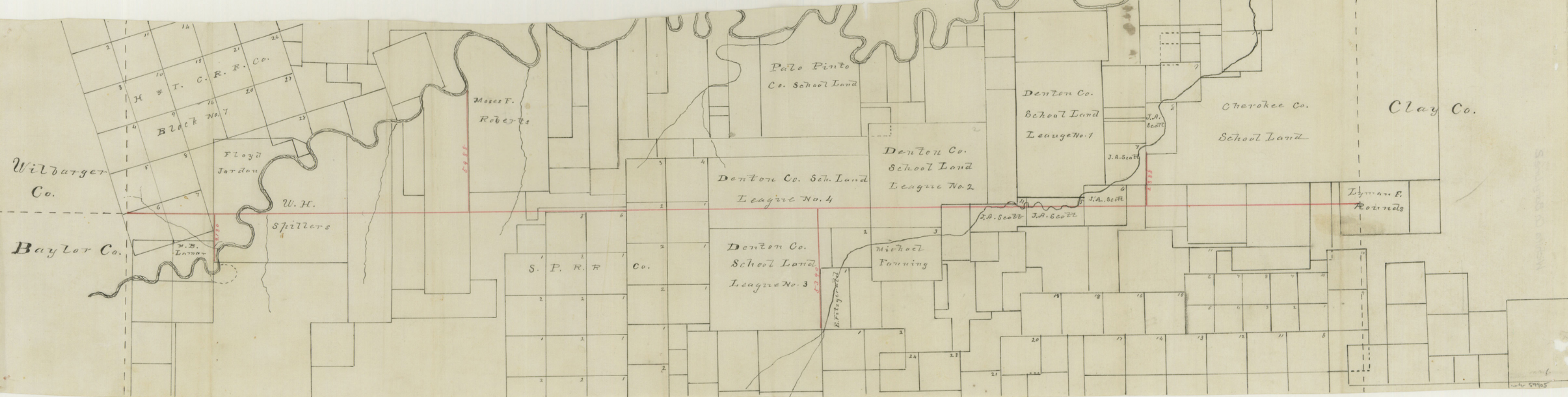

Wilbarger Co.

Baylor Co.

Palo Pinto Co. School Land

Denton Co. School Land League No. 1

Cherokee Co. School Land

Clay Co.

H. I. C. R. R. Co. Block No. 7

Floyd Jordan

W. H. Spillers

Moses F. Roberts

Denton Co. Sch. Land League No. 4

Denton Co. School Land League No. 2

Lynn E. Rownds

M. B. Lomar

S. P. R. R. Co.

Denton Co. School Land League No. 3

Michael Fanning

J. A. Scott

J. A. Scott

E. Fitzgerald

Survey of 1855

59905