



1 Report of a survey of the County line between
2 Willbarger and Foard and between Willbarger
3 and Hardeman Counties, made by order of the
4 Commissioners Court of Willbarger County at its
5 special term July 7th 1893.

6 Begin at the established N.W. corner of Baylor
7 County a large sand stone rock 3 feet x 3 feet
8 facing North and South and situated in the
9 valley of South Beaver Creek marked $N \frac{E}{X} | N. \frac{W}{T}$
10 on the south side and H! W on the north side
11 a large hackberry tree br. N. $25\frac{3}{4}^{\circ}$ E 128 vs.
12 and another br. N. $21\frac{1}{2}^{\circ}$ E 131 vs and a round
13 lone mound br. S. $57\frac{3}{4}^{\circ}$ W. 212 vs. All of the
14 above bearings are found at the course and
15 distance called for in the field notes but the
16 trees are not marked.

17 Thence North at 375 vs. the South bank of
18 Beaver Creek at 1281 vs. the South line of Sec.
19 64 Blk. 18 T. & J. C. R. Co. 583 vs. from its S. E.
20 corner at $1900\frac{8}{10}$ vs a sand stone marked 1 W.
21 on the E. side and F on the west side.

1-22 Thence North at 1367 vs cross the south line
23 of No. 59 Blk. 18, 2 vs. from its S. E. corner
24 at $1900\frac{8}{10}$ vs a red sand stone marked
25 2 W on the E. side and F on the west.

2-26 Thence North at 1453 vs. cross the south
27 line of sec. 55, 579 vs. from its S. W. corner
28 at $1900\frac{8}{10}$ vs. a red sand stone marked
29 3 W on the E. side and F on the West.

3-30 Thence North at 1539 vs. cross the south line
31 of sec. 54, Blk. 18, 740 vs from its S. E. corner
32 at $1900\frac{8}{10}$ vs. a red sand stone marked



- 1 4th on the E. side and F on the west
- 2 side.
- 4-5 Thence North at 1625 vs cross the S. line of
- 4 sec. 49, Blk. 18, 159 vs. from its S.E. corner at
- 5 1900 ⁸/₁₀ vs. a red sand stone marked 5th.
- 6 on the E. side and F on the west.
- 5-7 Thence North at 1711 vs cross the South line
- 8 of sec. 47 Blk. 18, 421 vs. from its S.W. corner
- 9 at 1900 ⁸/₁₀ vs. a red sand stone, marked 6th
- 10 on the E. side and F on the west.
- 6-11 Thence North at 1797 vs. cross the North line
- 12 of sect. 47 Blk. 18 at 1003 vs from its N.W.
- 13 corner at 1900 ⁸/₁₀ vs. a red sand stone
- 14 marked 7th on the E. side and F on the
- 15 west side.
- 7-16 Thence North at 1883 vs. cross the south
- 17 line of sec. 32 Blk. 18, 116 vs, from its
- 18 S.E. corner at 1900 ⁸/₁₀ vs. a red sand stone
- 19 marked 8th on the E. side and F. on the
- 20 West.
- 8-21 Thence North at 1900 ⁸/₁₀ vs. a red sand stone
- 22 marked 9th on the E. side and F on the
- 23 west side.
- 9-24 Thence North at 68 vs. cross the S. line of sec.
- 25 28 Blk. 18, 454 vs, from its S.W. corner at
- 26 1900 ⁸/₁₀ vs. a red sand stone marked 10th.
- 27 on the E. side and F on the West side.
- 10-28 Thence North at 154 vs. cross the North line
- 29 of 28 Blk. 18, 1035 vs. from its N.W. corner
- 30 at 1900 ⁸/₁₀ vs. a red sand stone marked
- 31 11th on the E. side and F on the west side.
- 11-32 Thence North at 1604 vs. the S. line of sect.

Wibauger co. Boring line # 16



- 1 17 Blk. 8, 135 vs. from its S.W. corner, at
2 1900 $\frac{8}{10}$ vs. a red sand stone marked 12 $\frac{1}{2}$.
3 on the E side and F on the west side.
- 12 4 Thence North at 1698 vs. cross the S. line of
5 sec. 16 Blk. 8 $\frac{1}{2}$ + T. & P. Co. 741 vs. from
6 its S.W. corner at 1900 $\frac{8}{10}$ vs. a red sand
7 stone marked 13 $\frac{1}{2}$ on the E side and F on
8 the west.
- 13 9 Thence North at 1792 vs. cross the S. line of
10 sec. 15 Blk. 8, 1374 vs. from its S.W. corner
11 at 1900 $\frac{8}{10}$ vs. a red sand stone marked
12 14 $\frac{1}{2}$ on the E side and F on the west side.
- 14 13 Thence North at 1886 vs. cross the south
14 line of No. 11 Blk. 8, 53 vs. from its S.W. corner
15 at 1900 $\frac{8}{10}$ vs. a red sand --- marked 15 $\frac{1}{2}$.
16 on the E side and F on the west side.
- 15 17 Thence North at 1900 $\frac{8}{10}$ vs. a red sand
18 stone marked 16 $\frac{1}{2}$ on the E side and F on
19 the west side.
- 16 20 Thence North at 80 vs. cross the north line
21 of sec. 11 Blk. 8, 659 vs. from its N.W.
22 corner at 1900 $\frac{8}{10}$ vs. a red sand stone 3
23 feet high marked 17 $\frac{1}{2}$ on the E side and
24 F on the west side. This stone is on the
25 East side of a sandy high bluff on the
26 South side of Pease River, from which
27 a Chittum brs. S $49\frac{1}{4}^{\circ}$ E. 25 vs. and 2
28 Chittum 5" chain. brs. N. $54\frac{1}{2}$ $\frac{1}{2}$ $\frac{1}{2}$ vs.
29 from the 2 Chittum trees, the end of a
30 red ridge brs. N. $73\frac{1}{2}^{\circ}$ $\frac{1}{2}$ $\frac{1}{2}$ $\frac{1}{2}$ vs.
- 17 31 Thence North at 40 vs. the South bank of
32 Pease River on a high bluff at 1131 vs.

W. Berger Co. Survey. line # 1 b



1 pass the N.E. corner of Ford county in
2 the middle of Peas River from which
3 a cottonwood marked X on the north
4 side brs. N. 54° 38' W. 360 vs. and a forked
5 cotton wood both prongs marked X on
6 the north side brs. N. 31° 58' W. 408 vs.
7 This corner is 26 vs. west of where J. A.
8 Nabers and E. D. Flynt located it in
9 Febry 18927 continue North at 1900 ⁸/₁₀ vs.
10 a point in the bed of the river.

18 11 Thence North at 200 vs the north bank of
12 the River at 318 vs. cross S. line of Sect. 8 &
13 Blk. 16 T. & J. C. R. R. Co. 539 vs. from its S.W.
14 corner, at 1900 ⁸/₁₀ vs. a red sand stone
15 marked 19 W. on the East side and H on the
16 west.

19 17 Thence North at 1123 vs. cross the S. line of
18 Sec. 62 Blk. 16, 50 vs. from its S.W. corner
19 at 1900 ⁸/₁₀ vs. a red sand stone marked
20 20 W. on the E. side and H on the west.

20 21 Thence North at 1180 vs. cross the S. line
22 sec. 61 Blk. 16, 525 vs. from its S.W. corner
23 at 1900 ⁸/₁₀ vs. a red sand stone marked
24 21 W. on the E. side and H on the west
25 side.

21 26 Thence North at 1237 vs. cross the S. line
27 of sec. 60 Blk. 16, 1000 vs. from its S.W. corner
28 at 1900 ⁸/₁₀ vs. a red ^{sand} stone marked 22 W
29 on the E. side and H on the west side.

22 30 Thence North at 1294 vs. cross the S. line
31 of 59 Blk. 16 - 425 vs. from its S.E. corner
32 at 1900 ⁸/₁₀ vs. a red sand stone



1 marked 23th on the E. side and H on the
2 west.

23 3 Thence North at 1351⁰⁰ vs. cross the S. line
4 of sec. 53 - 50⁰⁰ vs. from its S.W. corner at
5 1900^{8/10} vs. a red sand stone marked
6 24th on the E. side and H on the west.

24 7 Thence North at 1408⁰⁰ vs. cross the S. line of
8 sec. 54 - 525⁰⁰ vs. from its S.W. corner at
9 1900^{8/10} vs. a red sand stone marked
10 25th on the E. side and H on the west.

25 11 Thence North at 1465⁰⁰ vs. cross the S. line
12 of 55 - 900⁰⁰ vs. from its S.E. corner at 1900^{8/10}
13 vs. a red sand stone marked 26th on the
14 E. side and H on the west.

26 15 Thence North at 1522⁰⁰ vs. cross the North
16 line of 55 - Blk. 16 - 425⁰⁰ vs. from N.E. corner
17 at 1900^{8/10} vs. a red sand stone marked
18 27th on the E. side and H on the west
19 side.

27 20 Thence North at 336⁰⁰ vs. cross the S. line
21 of sec. 41 Blk. 10 G. & T. C. R. R. Co. 525⁰⁰ vs
22 from its S.E. corner at 1900^{8/10} vs. a red
23 sand stone marked 28th on the E. side and
24 H on the west side.

28 25 Thence North at 423⁰⁰ vs. cross the S. line of
26 No 29 - 60⁰⁰ vs. from its S.W. corner at 1311⁰⁰ vs
27 Center Ft. W. + D. C. R. R. at 1900^{8/10} vs a red
28 sand stone marked 29th on the E. side and
29 H on the west side.

29 30 Thence North at 510⁰⁰ vs. cross the S. line of
31 sec 30 - 645⁰⁰ vs. from its S.W. corner at 1900^{8/10}
32 vs. a red sand --- marked 30th on the E.



1 side and H on the west side.

30 2 Thence North at 597 vs. cross the S. line of
3 31, 1230 vs. from its S.W. corner at 1900 $\frac{8}{10}$
4 vs. a red sand stone marked 31 $\frac{1}{2}$ on the E.
5 side and H on the West.

31 6 Thence North at 130 vs. a branch at 215 vs.
7 S. bank Manders creek at 684 vs. cross
8 the North line of sec. 31- 147 vs. from the
9 N.E. corner at 1900 $\frac{8}{10}$ vs., sand stone marked
10 32 $\frac{1}{2}$ on the E. side and H on the west
11 side.

32 12 Thence North at 771 vs. cross the North line
13 of sect. 23, 438 vs. from its N.W. corner at
14 1900 $\frac{8}{10}$ vs. a red sand stone marked 33 $\frac{1}{2}$
15 on the E. side and H on the west.

33 16 Thence North at 858 vs. cross the North line
17 of 22- 1023 vs. from its N.W. corner at 1900 $\frac{8}{10}$
18 vs. a sand stone marked 34 $\frac{1}{2}$ on the East
19 side and H on the west side.

34 20 Thence North at 945 vs. cross the North
21 line of sec. 21 T. 10 - 276 vs. from its N.E.
22 corner at 1900 $\frac{8}{10}$ vs. a red sand stone
23 marked 35 $\frac{1}{2}$ on the E side and H on
24 the west side.

35 25 Thence North at 692 vs. cross the S. line
26 of sec. 3, $\frac{1}{2}$ + N. W. R. R. Co. 778 vs. from its
27 S.W. corner at 1642 vs. cross the S. line of
28 No. 2 N + N. W. R. R. Co. 756 vs. from its
29 S.W. corner at 1900 $\frac{8}{10}$ vs. a sand stone
30 marked 36 $\frac{1}{2}$ on the E. side and H on the
31 west side.

36 32 Thence North at 1676 vs. cross the North

Wilbarger Co. Bdry. line # 16



1 line of No. 2, N. & S. N. 710 vs. from its
2 N. W. corner at 1900 $\frac{8}{10}$ vs. a red sand stone
3 marked 37 N. on the E side and H on the
4 west side.

37 5 Thence North at 725 vs. cross the North
6 line of the T. R. Bailey and the S. line of the
7 M. A. Sams survey at 1900 $\frac{8}{10}$ vs. a red
8 sand stone rock marked 38 N. on the E.
9 side and H on the west side at the foot
10 of bluff entering river valley from which
11 a leaning cotton wood br. N. 53° N. 28 vs.

38 12 Thence North at 1126 vs. pass $40\frac{1}{2}$ vs
13 west of a rock marked 22 placed there
14 by Nabers and Flynt in running the
15 line between Wilbarger and Hardeman
16 Counties, from this stone (22) a hackberry
17 marked X br. N. $35\frac{1}{2}^{\circ}$ N. $16\frac{1}{2}$ vs. and a
18 cottonwood br. N. $37\frac{1}{2}^{\circ}$ N. 51 vs. at 1680
19 vs. a point in center of Main Red River
20 the N. W. corner of Wilbarger, and N. E.
21 corner of Hardeman Counties from which
22 a round red peak on the north bank
23 of the river br. S. $66^{\circ} 49'$ E. The extreme
24 S. E. end of a sharp ridge that runs to the
25 river on the North side br. S. $60^{\circ} 38'$ E.
26 and the extreme S. W. end of a ridge
27 that runs to the river on the North side
28 br. N. $61^{\circ} 12'$ N. a cotton wood snag on S.
29 bank of present channel of river br. S. $1^{\circ} 05'$
30 E. 514 vs.

31 Begun survey Aug 30th 1893 and finished Sept.
32 9th 1893

Wilbarger Co. Entry Line # 16



1 Va. 10' 10' E.

2 V. R. Kenney
3 G. T. Douglass & Chamberlain.

4
5 I R. M. Kenney Surveyor of Wilbarger ---
6 and duly appointed by the Commissioners
7 Court of Wilbarger to locate establish and
8 mark the west line of Wilbarger and the
9 East line of Foord and Hardeman Counties
10 do hereby certify that the foregoing survey
11 was made in the field according to law
12 and the lines boundaries marked, natural
13 and artificial, are truly described in the
14 foregoing plat and field notes.

15 The Commissioners Court of Wilbarger duly
16 notified the Comrs. Court of Hardeman County
17 but said Court failed to send a surveyor
18 to represent Hardeman County.

19 This Nov. 17th 1893.

20 R. M. Kenney Surveyor for
21 Wilbarger Co. Texas.

22 Examined and approved in open
23 Commissioners Court this 17th day of
24 November A. D. 1893.

25 J. P. Orr,
26 County Judge

Wilbarger co. Bldg line # 16



1 The State of Texas (County of Wilbarger I M D Dants clerk of
2 the County Court in and for Wilbarger
3 County Texas Do hereby certify that the fore
4 going Eight Pages contain a true and
5 correct transcript of the Report of a survey
6 made by P M Kenney County surveyor of
7 Wilbarger County Texas of the County line
8 between, Wilbarger County and Hardeman
9 County, as the same appears of Record in
10 Vol. # 2, Pages 591-592-593-594 & 595, Record of
11 Commissioners Court for said County, also hereto
12 attached plat of said survey.

13 Given under my hand and seal of
14 office, at Venus Texas this the 30th day
15 of January 1894.

16 I M D Dants clk Co Court
17 Wilbarger Co Texas
18
19
20
21
22
23
24
25
26
27
28
29
30
31
32

Wilbarger Co - Bldg. No # 16

Wilbarger Co ~~4~~ Bdry Line 1b

West ~~bdy~~ of Wil-
barger Co.

Copy of Field
Notes and Plat of
a Survey of County
line between
Wilbarger & Hood
Counties of Wilbar-
ger and Haldeman
Counties.

Filed in the Land
Office Feby
7th 1894.

There is only 26 ors differ-
-ence between this and the
the Haldeman Co line run
in 1892, by Dyant & neighbors
but not reported until 1893

This line is approved
and Abstract corrected
in conformity thereto.

4/2/94 G. W. Beaumont
Separate 2^d Det from 2/2/94

cat. 59952

610

met. D. 1/2 m. 1/2

N.W. corner Willbarger Co.

Red River
Island
N.W. corner Willbarger Co.

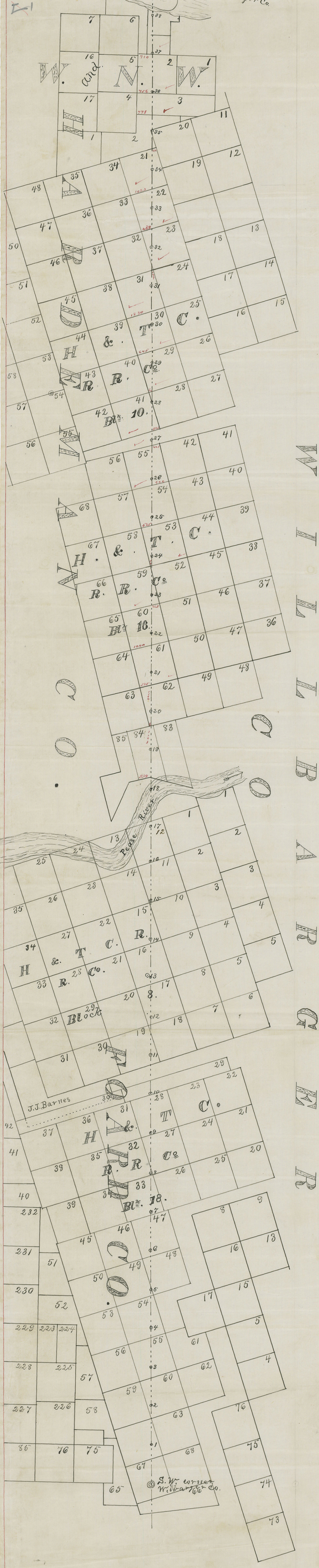

N
T
B
A
R
N
E
S

S.W. corner Willbarger Co.