

REPORT OF G. W. COWAN AND JOSEPH BRASHEAR, *Special*
SURVEYORS OF WOOD AND HOPKINS COUNTIES.

200
200

THE STATE OF TEXAS | To the Commissioners Courts of
COUNTIES OF WOOD & HOPKINS | Wood & Hopkins Counties, Texas.

In obedience to an order of Wood County Commissioners Court at the Aug Term thereof A D 1909 directing me to retrace and remark by actual survey the boundary line between Wood and Hopkins Counties as run by D O Norton in the year 1848, I proceeded with a legally qualified surveyor, to-wit: Joseph Brashear, appointed by the Commissioners Court of Hopkins County, Texas, to comply with the above cited order and submit the following as our report of said work:

We located upon the ground the original S W corner of Hopkins County as set up by D O Norton in the year 1848, said corner being 330 varas West and 200 varas South from the S W corner of a survey of 320 acres made by virtue of Samuel Paschal Warrant Bounty and find some of the marks of record. From thence running East with said Norton line on a reading of 8° and 9 minutes East at 19287 varas, said Norton's 10th mile on East bank of Elm Creek; From this point continuing East with said Norton line at 2758 varas to a bois D'arc post 8 inches in dia set three feet in ground and marked on East face "Cor Co", on South face "W", on West face "R", and on North face "H", on said line at the point where the E B line of Rains County as run by G W Cowan and S J Stewart in May and June 1909, crosses the same in McAlister's land 298 varas North and 847 varas West from the S E corner of the G. Jones survey, continuing East from this point on the same reading at 847 varas G. Jones' E B line and Neal Ard's W B line 298 varas North from their joint corner on the South at 888 varas Briar branch at 1043 varas Norton's 12th mile in Montgomery's field a post marked 12 M and 19 M.

13th MILE: At 1400 varas branch course Northeast at 1676

varas Neal Ard's E B line, 302 varas North from S E corner of same, and S W corner of Thos. Lee survey, at 1820 varas cross Linn Creek at Mouth of branch, at Norton's 13th mile, a post in Hale's field marked 13M and 18M.

14th MILE: At 1440 varas Burk's Creek, course South, at 1610 varas E B line of the Thos. Lee survey and W B line of the John Fuller survey, 322 varas North from their joint corner on the South, at Norton's 14th mile a post in Suttles' field marked 14M and 17M.

15th MILE: At 390 varas old road leading from Tarrant to Jordan's Saline, at 800 varas public road and post in line on E B line John Fuller survey and W B line Berry West survey 706 varas South from their joint corner on the North, at Norton's 15th mile a post in Mrs. Grubbs' field marked 15M and 16M.

16th Mile: At 170 varas branch, course South, at Norton's 16th mile a post in R M Stone's field marked 16M and 15M.

17th MILE: Passing about 5 feet south of R M Stone's residence, which is on West side of Sulphur Springs and Yantis road, at 470 varas post in line in East line of said road, at Norton's 17th mile a post marked 17M and 14M.

18th MILE: At 560 varas E B line Berry West survey and W B line H Arnold survey 673 varas South from Berry West's N E corner and 1517 varas North from H Arnold's S W corner, at 1080 varas post in line on E B line Yantis and Reilly Springs public road at bridge on branch, at 1600 varas Glade Creek, at Norton's 18th mile a post in Coker's field marked 18M and 13M.

19th MILE: At Norton's 19th mile a post in G W Swindle's field marked 19M and 12M.

20th MILE: At 730 varas branch, course South, at 1518 varas Running Creek, course South at Norton's 20th mile a post in Askew's field marked 20M and 11M.

21st MILE: At 105 varas the Quitman and Sulphur Springs

Public road , on the H Arnold E B line a post in line on West side of said road 1650 varas North from Arnold's S E corner and 1028 varas North from S W corner Nacogdoches University Survey No. 16, at 1277 varas branch, course South, at Norton's 21st mile a post in field marked 21M and 10M.

22nd MILE: At 675 varas Coffey Creek, at 1500 varas branch, course North, at Norton's 22nd mile a post in Charlie Ables' field marked 22M and 9M.

23rd MILE: At 1670 varas branch, course South crossing E B line Nacogdoches University Survey No. 17 1118 varas North from S E corner of same and 64 varas South from S W corner Calvin Musgrove's 137 acre survey and crossing a vacancy to West Boundary line Ybarbo survey 2463 varas South from N W corner of same, at Norton's 23rd mile post marked 23M and 8M.

24th MILE: Crossing Coke and Como Public road a post in line on the west side of same, at 1170 varas Big Caney Creek, at Norton's 24th mile a post marked 24M and 7M.

25th MILE: At 1180 varas Quitman and Black Oak Public road a post in line on East side of said road at 1230 varas Ybarbo E B line 2463 varas South from N E corner of same and 78 varas South from E Alvarado N W corner, at Norton's 25th mile a post marked 25M and 6M.

26th MILE: At 1440 varas Pleasant Grove Public road a post in line on East side of said road, at Norton's 26th mile a post marked 26M and 5M.

27th MILE: At 360 varas branch, at Norton's 27th mile post in C M Wilsons' field marked 27M and 4M.

28th MILE: At 657 varas E. Alvarado E B line 25 varas South from N E corner of same and 383 varas South from John Shaw N W corner, at Norton's 28th mile a post in Frank Browning's field marked 28M and 3M.

29th MILE: At 1140 varas E B line John Shaw survey and W B line of B. M. Mays survey 418 varas South from their joint corner on the North, at 1750 varas a post in line on South side Cumby and Winsboro Public road, at Norton's 29th mile post marked 29M and 2M.

30th MILE: At 1350 varas branch, at Norton's 30th mile a post in W M Watkins field marked 30M and 1M.

31st MILE: At 110 varas E B line B M Mays survey and W B line Wm. Poe survey 438 varas south from Mays' N E corner and 319 varas South from Poe's Northwest corner, at 470 varas Big Sandy Creek, at 1397 varas Poe's E B line and Tankersly's W B line 313 varas South from their joint corner on the North, at Norton's 31st mile a post in the Hay old field marked 31M and 94/100M.

32nd MILE: At 80 varas branch, at 160 varas another, at 840 varas another, at 990 varas another, at 1100 varas Tankersly's E B line and J M Clay W B line 305 varas South from their joint corner on the North, at 1263 varas old Mill road, at 1605 varas E B line J M Clay survey and W B line W H Summerlin survey 301 varas South from their joint corner on the North, at 1765 varas the S E corner of Hopkins County and S W corner Franklin County 301 varas South and 160 varas East from the W H Summerlin Northwest corner,

Total length of line between Wood and Hopkins Counties, 20 miles 908 varas. Said corner post, last above mentioned, marked "Co Co" on North side F on East side, "W" on South side and "H" on West side in Williams' field.

All mile and corner posts being Bois D'arc 8 inches in dia 5 feet long, set three feet in ground.

The area of each survey through which said line passes is found to be divided as follows, to-wit:

	WOOD COUNTY	HOPKINS COUNTY
G. JONES SURVEY	44 acres	250 acres
NEIL ARD "	105½ "	534½ "
THOMAS LEE "	96 "	692 "
JOHN PULLER"	56 "	124 "
BERRY WEST "	3940 "	665 "
H ARNOLD "	1396 "	3209 "
NACOGDOCHES UNIVERSITY	16, 474 "	633 "
NACOGDOCHES "	17, 475 "	632 "
M. YBARBO SURVEY	3201 "	1404 "
E. ALVARADO "	692 "	46 "
JOHN SHAW "	608½ "	161½ "
B. M. MAYS "	428 "	212 "
WILLIAM POE "	248 "	72 "
B. S. TANKERSLY	221 "	88 "
J. M. CLAY "	35 "	27 "
W. H. SUMMERLIN	243 "	8½ "

As will more clearly appear from Map attached hereto and made a part of this report.

Commencing on the 15th day of November, 1909 and ending on 20th day of January A D 1910.

Respectfully submitted

Oce Speed
Folto Williams
W M Chamness
L Montgomery

CHAIN CARRIERS

G. W. Cowan
Special Surveyor for Wood County, Texas

Joseph Brashear
Special Surveyor for Hopkins Co, Texas

THE STATE OF TEXAS

COUNTIES OF WOOD & HOPKINS

We, G W Cowan and Joseph Brashear, appointed and qualified as Special Surveyors, do hereby certify

that the Survey described and set out in the foregoing field notes and Plat was actually made by us on the ground according to law, with

chainmen duly qualified and that the marks both natural and artificial are truly described and that the area of each and every survey through which the line runs is properly credited respectively to Wood and Hopkins Counties.

Witness our hands and official signatures this the 20th day of January A D 1910.

E. W. Cameron
Special Surveyor for Wood County, Texas

Joseph Brasher
Special Surveyor for Hopkins Co, Texas

...

*Examined and approved in open court
This 14 day of Feby 1910.*

R. M. Smith,
County Judge Wood Co

CERTIFICATE OF TRUE COPY---Class 6.

McDaniel Printing Co., Printers and Stationers, Sulphur Springs, Texas.

THE STATE OF TEXAS,
COUNTY OF HOPKINS.

Jno A Cox Clerk of the

County Court in and for Hopkins County, Texas, do hereby certify that the foregoing is a TRUE and CORRECT COPY of the Boundary Line of Wood & Hopkins Counties as appears of record in Vol. 8 of Commissioners Court of Hopkins County on pages 10, 11, 12, 13 & 14. Records of Said Court

In testimony whereof, I hereby set my hand and official seal, this 4th day of June 1910.

By _____ Deputy.

Jno A Cox
Clerk County Court, Hopkins County, Texas.

of *June* A. D. 1910 at *10* o'clock *A*.M. and duly recorded this *17th* day of *July* A. D. 1910 at *4* o'clock *P*.M. in the *Commissioners Court* Records of said County in Volume *8*, on pages *121-2-3 + 4*.

Witness my hand and the seal of the County Court of said County, at office in Quitman, the day and year last above written.

[L. S.]

W. C. Corley
Clerk County Court, Wood County, Texas.
By _____ Deputy.

Books of
Pages 121 to 124

Copy of report
of Joseph ¹²Prather
and G. W. Carran
Special Surveyors
for Mead & Hopkins
Counties

abstracted in Vol. 33

Filed in Commissioners
Court this Feby
14-1910.

J. W. Corley
County Clerk
Wood County,

Filed for Record
at 10 o'clock a.m.
June 30th 1910,
J. W. Corley,
County Clerk

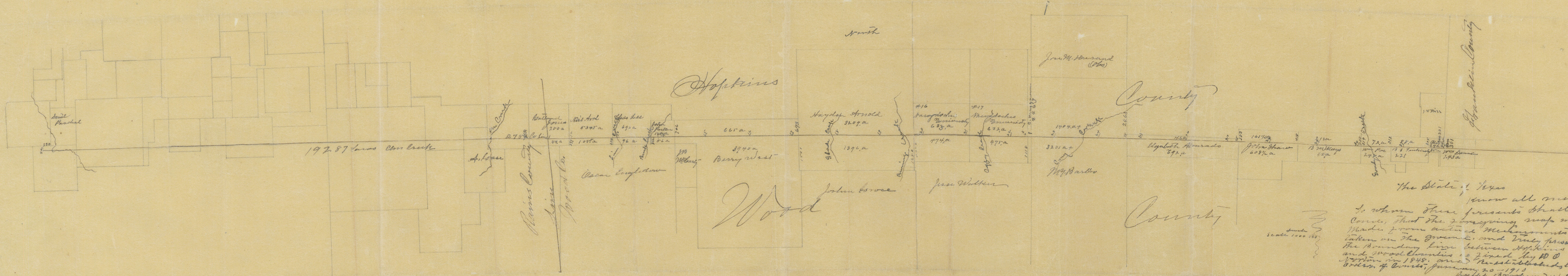

The State of Texas
 know all men
 to whom these presents shall
 come, that the foregoing map was
 made from actual measurements
 taken on the ground, and truly presents
 the boundary line between Hopkins
 and Wood Counties as fixed by P. O.
 Wilson in 1848, and re-established by
 Order of Courts, January 20-1912
 Ralph B. Brown J. G. Boyce
 G. W. Cowan

Scale 1000 feet