

No 25

County boundaries  
between the County of  
Zavalla  
and Counties of  
Frio and Maverick

---

Filed in Genl Sd Office  
Jan'y 21/88

---

Abstract Corrected and  
copy furnished the Comptroller  
of Pub Accts,  
Feb'y 4/88 Beaumont

---

Zavalla Co Bdry Line 2

A Survey of the Western Boundary line of Zavalla County  
same being the Eastern Boundary of Maverick by Oth J  
Hector appointed by the County of Maverick and Geo. Myers  
appointed by the County of Zavalla to run and mark  
said Line.

Beginning at a post set in a mound  
set by the surveyors of Uvalde & Kinney Counties for the  
SW Cor of Uvalde and the SE Cor of Kinney  
New Cor of Zavalla and NE Cor of Maverick  
from a C. C. brs S 61 1/4 E 6 3/4 vs mound L. Mabry  
S 35 1/2 W 18 3/4 vs mound M Mos 5' N 31 1/4 E 41 vs mound U  
C. C. 2660 W 32 vs <sup>1535</sup> ~~1250~~ N E 1350 S 89 W of SE Cor 10

Thence South at a variation  
of 90 15' East at 1465 vs road at 1585 vs on N line  
of No 97 S W 1/4 Block 3 1350 vs S 89 W of its  
N E Cor at 1600 vs Mueller at 1900 vs being a  
well West 10' by 4 ft high

Thence South at 177 vs on N line of  
No 3 1/2 S Has Westan 1540 vs 2660 vs E of its N W Cor  
at 310 vs Mueller on 470 left creek at 1900 vs being  
two miles from said 470 vs 379 vs 20 2650 3 1/2 vs <sup>N</sup>

Thence South at 460 vs S line of  
No 3 1/2 S Has Westan 460 vs for its SW Cor at 755 vs  
crossed N W line of No. 9. 1450 vs for its NE Cor  
in the name of Ed Wiley at 960 vs N E line of  
No 14 135 vs S 47 E of its N Cor at 1900 vs being  
(3) three miles West 8' by 4 1/2 high

Thence South at 200 vs Eagle Pass  
and Uvalde road at 271 vs S E line of No 12 95 vs N 43 E  
of its S Cor at 401 vs N Line of No 11 S 47 E  
of its N Cor same being a line of No 101 Morris  
& Cummings notes of said No 101 not in the survey or

Zavalla Co. Bdry Line 2

1B

office of Nevada County at 580 vs Chapperson Creek  
 at 755 vs records same at 870 vs crossed it (3) third time  
 at 1627 vs N Line of Survey No 63 D G M 455 vs 1689 E  
 of its N W cor at 1900 vs being 4 miles W by 7' by 5 ft  
 high  
 Thence South at 1627 vs N line of No 48 452 vs  
 1689 E of its N W cor at 1900 vs being 5 miles  
 post 8' by 5 ft high  
 Thence South at 1900 vs being 6 miles  
 post 8' by 5 ft high  
 Thence South at 1345 vs old wood fence  
 at 1900 vs being 7 miles pt 6' by 4 ft high  
 Thence South at 1900 vs being 8 miles  
 post 8' by 5 ft high  
 Thence South at 1900 vs Creek 1430  
 vs Creek at 1900 vs being 9 miles pt 12' by 4 ft high  
 Thence South at ~~1872~~ <sup>162</sup> ~~1872~~ <sup>Swiss Peak</sup> ~~1010~~ vs  
 crossed a line running East from the SE cor of  
 J. Truelock ~~xxxxxx~~ ~~xxxx~~ 1310 vs N line of 18014  
 State at 1460 vs travel at 1850 vs quit travel at  
 1900 vs being 10 miles post 8' by 4 ft high  
 Thence South at 614 vs the N Line  
 of survey No 394 J. J. Robinson 654 1/10 vs for its N E cor  
~~at 1070~~ ~~vs road~~ ~~at 1010~~ vs S Line of said survey 646 1/10 vs for its SE cor  
 at 1740 vs Palo Blanco Creek at 1900 vs being  
 11 miles a spring W by post 8' by 5 ft high  
 Thence South at 614 vs crossing the  
 S line of survey No 393 1/2 Lewis James 638 vs for its  
 SE cor same being N line of survey No 391 G. W. Daniel  
 1138 vs for its N E cor creating a wire fence on this  
 line at 930 vs Mule Creek at 1011 1/2 vs crossing  
 N line of survey No 390 G. R. Foster 1129 1/10 vs for

2B

to N E Cor at 1900 vs being 13 miles post 8' by 4 ft high  
Thence South at 6 1/2 vs crossing N Line  
of No 4 State 221 1/10 vs for the N W Cor of said No 389 of Buff  
at 10 1/2 vs crossing line of No 3 G.W.P. 2137 1/10  
for S E Cor of said Buff survey at 1375 vs road at 1900 vs  
being 13 miles post 7' by 4 ft high

Thence South at 1600 vs road  
971 feet 10 1/2 vs crossing N Line of E. Woolley  
196 1/10 vs for its N E Cor at 1900 vs being 14 miles post  
Thence South at 1645 vs road at  
1900 vs being 15 miles post 8' by 3 ft high.

Thence South at 985 vs S Line of  
No 376 & Peyton 163 vs for its S E Cor same being  
N E Cor of survey No 637 G.W.P. at 1900 vs post  
7' by 4 ft high being 16 miles

Thence South at 863 1/2 vs the N Line of No  
611 A B X W 1563 vs from its N E Cor at 915 vs S Line  
of survey No 637 158 vs for its S E Cor at 1840 vs Road  
at 1900 being 17 miles post 8' by 4 1/2 ft high

Thence South at 480 vs Cheam Creek at a point  
where the road for Burkes Lane to his dipping pen crosses  
at the mouth of a slough at 780 vs slough 1036 1/2 vs  
N Line of No 112 1581 vs for its N E Cor at 1310 vs  
Batesville & Eagle Pass road at 1900 vs being 18 miles  
post 7' by 4 1/2 ft high 2 1/4 W 10' 580 E. v. with 7 au both prop

Thence South at 976 vs intersected S  
line of No 612 1597 vs for its S E Cor at 1206 N Line of  
184 A B X W 1654 vs for its N E Cor at 1900 vs being 19  
miles post 7' by 4 1/2 ft high

Thence South at 1020 vs Gibley Creek  
at 1206 vs S Line of No 184 A B X W 1687 vs for its S E Cor  
same being N Line of No 603 A B X W 1677 vs for its N E Cor  
at 1900 vs being 20 miles post 8' by 3 ft high

ZAVIN 11th Co. Bldg. Lm #2

Thence South at 620 vs branch at 767 vs S line of said No  
603 same being N line of No 595 & M A Jones 125 2/10 vs  
N 69 1/2 E of its NE Cor at 1109 1/2 vs at 1109 1/2 vs passing. Tree  
that stands N 74 W 8 1/2 S vs for the SW Cor of said M A Jones  
at 1474 vs Chacaut Eagle Pass road at 1900  
vs being 21 miles past 8' by 4 1/2 ft high

Thence South at 25 vs S line of survey  
No 600 281 9/10 vs S 69 1/2 W of its SE Cor at 400 vs  
S bank of Cepaula Creek at 1900 vs being 27 miles  
past 8' by 3 ft high

Thence South at 154 vs S line of 599  
991 9/10 vs S 69 1/2 W of its SE Cor at 374 vs N  
line of N S P Kingston 1902 vs N 69 1/2 E of its NE Cor  
at 1700 vs being 23 miles past 6' by 4 1/2 ft high

Thence South at 1000 vs Picoosa Creek  
at 1617 vs N line of G H A Meyer run No 598  
1099 vs S 69 1/2 W of its NE Cor at 1785 vs road  
at 1900 vs being 24 miles past 6' by 5 ft high

Thence South at 784 vs cross the fork  
line of 594 state 478 vs N 69 1/2 E of its NE Cor at  
984 vs branch at 1884 vs S line of said state  
survey No 594 43 vs from its SW corner at 1900 vs  
being 25 miles past 8' in the Cammauch Creek  
and Eagle Pass road 8' by 4 1/2 ft high

Thence South at 620 vs Dault Creek  
at 970 vs road 1214 7/10 vs S line of survey No 2  
N S 1/2 RR Co 335 2/10 vs S 59 W of the SW Cor  
of survey No. 1. N S 1/2 of 13 vs S 89 W of the  
NE Cor of survey No 648 state at 1900 vs  
being 26 miles past 8' by 4 ft high

Thence South at 1000 vs a branch  
at 1214 7/10 vs S line of No 648 State 46 vs S 89 W

4B  
1/2

of its SE Cor at 1900 vs being 27 miles past 7' by 4' high  
Thence South at 700 vs N Line of 650  
state 620 vs N 69 1/2 E to its NE Cor at 1795 vs creek  
at 1900 vs being 28 miles past 6' by 4' high  
Thence South at 570 vs W Line of  
Sun No 650 1657 vs S 20 1/2 E of its NE Cor at  
1570 vs Creek at 1670 vs N Line of Survey No 574  
S L Nobles 383 1/2 vs S 69 1/2 W to its NE Cor  
at 1900 vs a post 8' by 4' high being 29 miles

Thence South at 697 vs Pendencia  
and Eagle Pass road at 710 vs set a post 8' by 4' high  
high being a point 31 miles south of a rock  
and erected on the West Line of Walds of East  
Line of Kinney Counties said rock mound  
erected by the Surveyors of the said Walds of  
Kinney Counties for the 35 mile post. The above  
mentioned post blazed on N & S sides & marked  
7 on East side and 11 on west side at 1097 vs  
wire fence at 1136 vs crossed S Line of said  
Nobles survey 861 1/2 vs S 69 1/2 W of its SE Cor  
and 1138 1/2 vs N 69 1/2 E of its SW Cor at 1260 vs  
Branch at 1390 vs Slough at 1900 vs being 30 miles

L.O. post 10' by 4' high L.O. 18' 7' bro N 85 E 3075 vs  
L.O. 11' 1/2 bro N 81 E 31 vs Spruce 14' 1/2 N 89 1/2  
W 51 vs this post is set 3500 West of Camanche  
Creek down in a ravine that leads about  
50 yds West of post. Began the above line  
E Towns old chain Dec 2<sup>nd</sup> 1887 & finished  
J Wortkitch Carriers Dec 7<sup>th</sup>  
Eloye Truitt markers Geo Myers  
Patricis Surveyor appointed  
by Falls County

Zavalla Co. Ord. No. #2

1 The State of Texas } J. B. Rob. Clerk  
 2 County of Zavalla } of the County Court  
 3 of Zavalla County hereby certify that the foregoing  
 4 is a true copy of the Field notes and map  
 5 of the Western boundary line of Zavalla County  
 6 now on Record in my office, as surveyed by  
 7 Geo. Myers appointed by Zavalla Co. and O. H.  
 8 Hoster appointed by Maverick County, and Reported  
 9 to the Commissioners Court of Zavalla County Texas.  
 10 by Geo. Myers -

11 Given under my hand and Seal of office  
 12 this 10<sup>th</sup> day of January A.D. 1888  
 13 J. B. Rob. Co. Clerk  
 14 Zavalla Co Texas  
 15  
 16  
 17  
 18  
 19  
 20  
 21  
 22  
 23  
 24  
 25  
 26  
 27  
 28  
 29  
 30  
 31  
 32

6B

1/2

703

Zavalla Co Bary Line 2

County Bdy line between  
Zavalla

~~4~~  
Maverick

Filed in Genl Sd Office  
July 21<sup>st</sup> 1888

Abstract Comsted and  
Copy furnished the Comp-  
troller.

Febry 4<sup>th</sup> /88 Beaumont



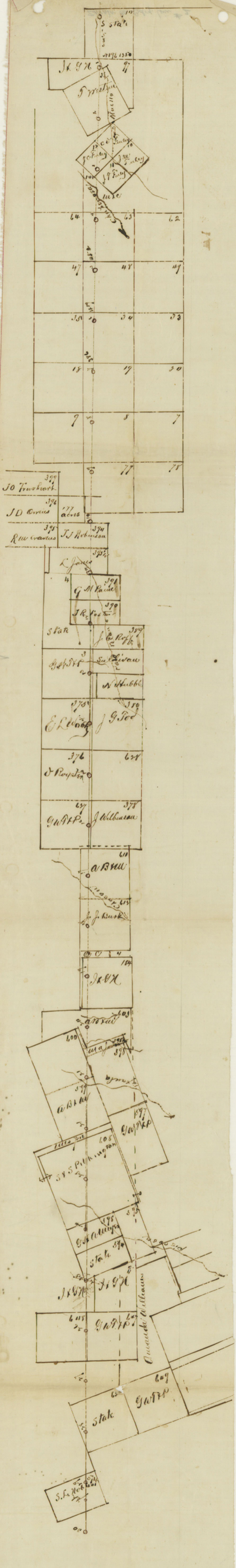

8E