

Hardin County
Rolled Sketch T. M. H.

Report

(Sketch in
Flattened Rolled Skis
T.M.H. #6093)

COUNTER 83317

(Hobart Minton)
 11-22-36
 11-22-36
 11-22-36
 11-22-36
 11-22-36
 11-22-36

Tyler County
Hardin County

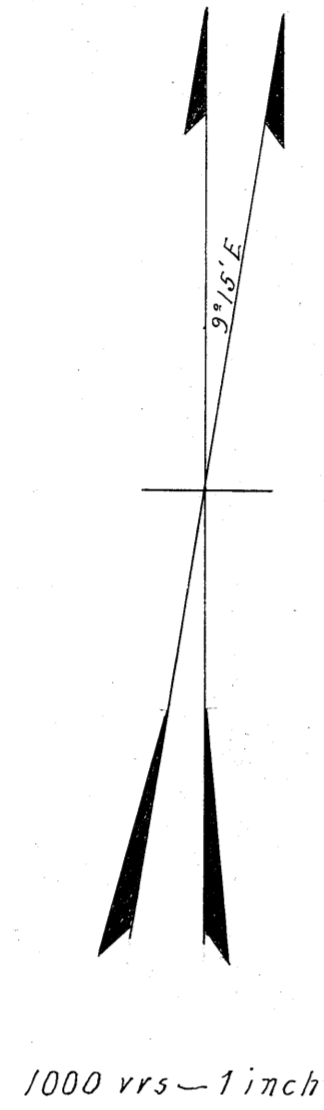

MAP OF A
RESURVEY OF A PORTION
OF
HARDIN COUNTY
TEXAS

Note:—
 The measurements shown on this map were actually made by me on the ground and the heavy dots represent the original corners found and identified by field notes of the respective surveys.

I, T.M. Hyde, Licensed State Land Surveyor, do hereby certify that this map correctly shows the lines and corners as determined by me from an actual resurvey made upon the ground.

This the 7th day of May A.D. 1936.
T.M. Hyde
 Licensed State Land Surveyor.

Received and filed in General Land
 Office on June 27th, 1936.
 J.H. Walker, Comm.
 C.F. Blauder, clk.

RECEIVED
 JUN 27 1936
 RECORDED TO MAP

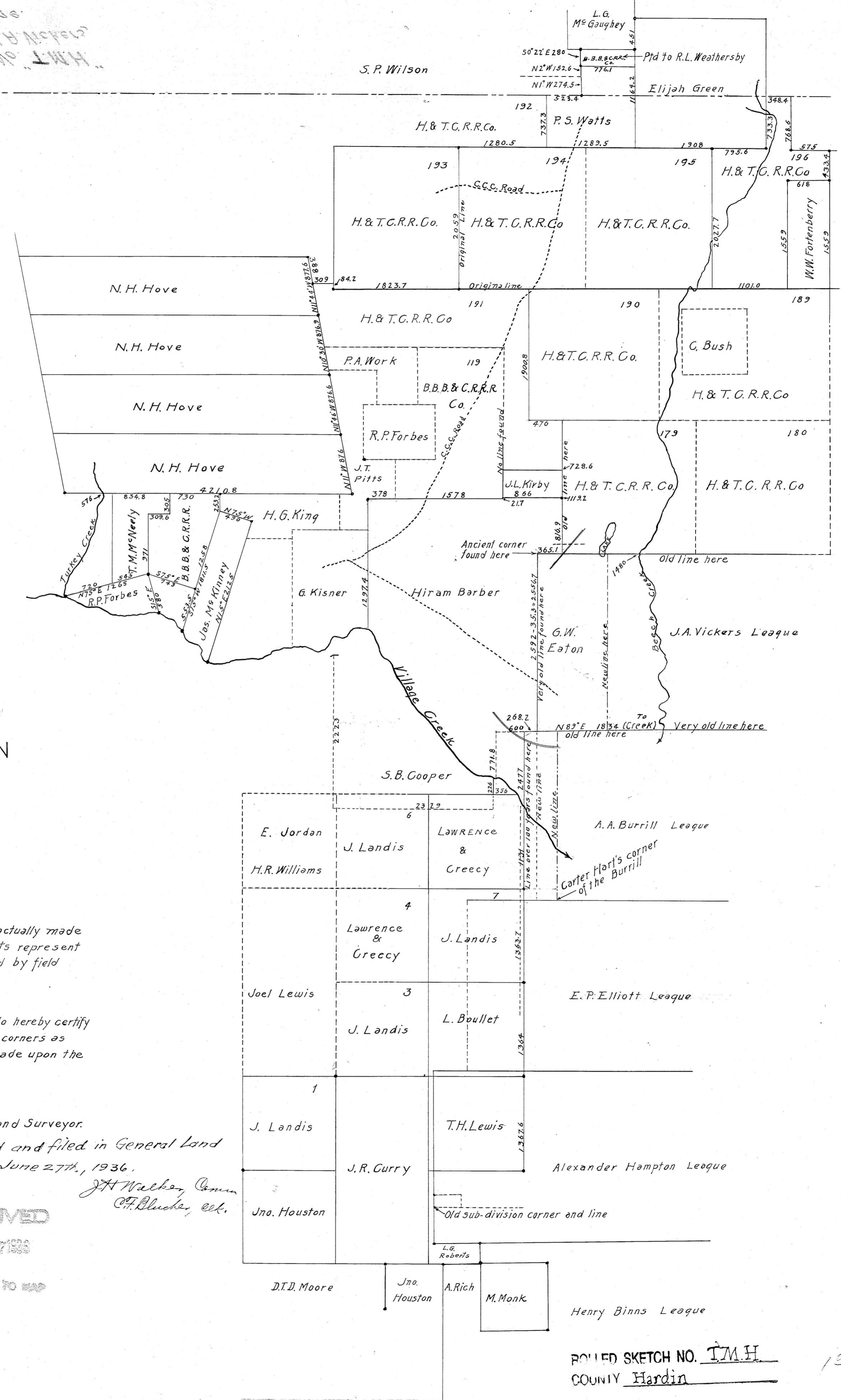

ROLLED SKETCH NO. T.M.H.
 COUNTY Hardin

139

Beaumont, Texas.
June 26 th 1936.

Hon. J.H.Walker, Commisioner.
Austin, Texas.

Dear Sir :-

We enclose herewith next attached Mr T.M. Hyde's report to you covering the re*survey of the Hiram Barber, J.A.Vickers, P.S.Watts and H&TCry Co., Survey No. 196., which all are lo cated in Hardin County, with exception of the P.S.Watts of which portion of this survey extends into Tyler County. We are also mailing to you a tube containing the traacing covering the above surveys under seperate cover.

Mr Hyde will in few days be able to mail you the corrected field notes of the P.S.Watts as required by your office.

Yours very truly.

Olive-Sternenberg & Co.,

Per Chas A Sternenberg.
Chas.A.Sternenberg..

Olive-Sternenberg & Co.,
1460 Craig Street.
Beaumont, Texas.

RECEIVED

JUN 27 1936

REFERRED TO MAP

"HMT" do better A. Mitchell May 1936

COUNTER 83318

107

Beaumont, Texas.
June 28th 1936.

Hon. J.H. Walker, Commissioner.
Austin, Texas.

Dear Sir :-

We enclose herewith next attached Mr. T.M. Hyde's report to us covering the resurvey of the Hiram Barber, J.A. Vickers, F.S. Watts and HATCOY Co., Survey No. 196., which all are located in Hardin County, with exception of the F.S. Watts of which portion of this survey extends into Tyler County. We are also mailing to you a tube containing the tracing covering the above surveys under separate cover. Mr Hyde will in few days be able to mail you the corrected field notes of the F.S. Watts as required by your office.

Yours very truly,

Olive-Steenberg & Co.,
Per Chas. A. Steenberg
Chas. A. Steenberg..

Olive-Steenberg & Co.,
1480 Craig Street,
Beaumont, Texas.

RECEIVED

JUN 2 1936

RETURNED TO MAIL

Keep with Hardin Co. rolled sk. "TMH"

COUNTER 83319

Kountze, Texas.

May 7th, 1936.

Mr. Chas A. Sternenberg,

Beaumont, Texas.

Dear Sir:-

Herewith hand you map showing the condition of the surveys in the Northeastern portion of Hardin County as I ascertained them to be in a resurvey of the Hiram Barber and other lands in that vicinity.

On April 6th, 1936 with R.E. Vickers, rodman, J.L. Brackin and C.W. Daniel, chainmen, I began at the S.E. corner of the most Southern N.H. Hove survey where on a previous survey I had determined this corner to be in order to get a starting point for the Hiram Barber.

From this corner we ran a random line South for a distance of 628 ^{vars} to a point from which we ran a random East 202 varas to the point from which the original location of the Hiram Barber was located by E.S. Pitts in 1858. We failed to find Pitts corner as described by him so we started from this point and ran South to Village creek to look for the corner that Pitts described there for the Southwest corner of the Barber. No evidence of corner was found. The line to this point is over cutover lands and no trees old enough to bear the original marks found. Our distance to the creek is 1297 varas while Pitts called the distance 1245. The creek has changed ^{its} run here and is 75 varas further South than it was many years ago. We tried to check up the meanders of the creek as given in the various fieldnotes of the Barber survey but find they do not remotely conform to the actual meanders of the creek and in many instances we find we are a quarter of a mile away from the creek. I have found this condition prevails in ^{some} of the surveys of early date in this and other counties.

Finding nothing conclusive on the creek we returned to point for Pitts N.W. corner of the Barber and ran a line North to look for the N.W. corner of the Barber as set forth in the correction of same. At a distance of 108 varas we pass a stake set by some surveyor for the Geo. Kisner and J.T. Pitts surveys. We failed to identify the place as the corner so continued our course and at 567.5 varas ^{furnished by} we found the N.W. corner of the H. Barber survey as set out on working sketch ^{you} the General Land Office. The witness trees had been cut but the stumps of same were found. We also found 2 other corner stakes set by other surveyors for this corner but ^{at} neither of them was any remote evidence of the real corner. The working sketch just referred to gives the West line of the H. Barber as 1731 varas but actually it is 1858.9 varas giving an excess of 127.9 varas over the call for the West line.

From the N.W. corner of the H. Barber just found we ran a line East through very dense undergrowth for a distance of 1956 varas to a point. We failed to find any corner or even a mark old or new on the line or near it. There was plenty of timber suitable to have the marks of the original survey on them showing either the line of the B.B.B. & C.R.R.R. Co. No. 119 or the H. Barber so it may be possible the line of neither survey was ever marked out on the ground as it frequently happened the locators did not close these surveys upon the ground but closed them in the office especially when the lines carried them through dense brush and swamps such as exist in the greater part of this county.

County, Texas

May 17th, 1930

Mr. Frank A. Stephens

San Antonio, Texas

Dear Sir:-

Reference is made to your letter of the 11th of the month in the
concerning location of Hardin County as I ascertained them to be in a
vicinity of the river Barber and other lands in that vicinity.

On April 23rd, 1928 with R. W. Flicker, Robert L. J. Franklin and G. W.
Doriel, on land I began at the S. W. corner of the tract containing W. H. Love
survey where on a previous survey I had determined this corner to be in
order to get a starting point for the river Barber.

From this corner we ran a section line north for a distance of 250
feet to a point from which we ran a random east 200 feet to the point from
which the original location of the river Barber was located by R. W. Flicker
in 1852. We failed to find this corner as described by him so we started
from this point and ran south to V. L. Rice creek to look for the corner that
this described there for the southeast corner of the Barber. No evidence
of corner was found. The line to this point is over copper fains and no
ground was shown to bear the original mark found. Our distance to the creek
in 1927 was 211 feet called the distance 1852. The creek has changed
its bed and is 70 feet further south than it was many years ago. We tried
to check up the bearings of the creek as given in the various platitudes
of the Barber survey but they do not roughly conform to the actual
bearings of the creek and in many instances we find we are a quarter of a
mile away from the creek. I have found this condition prevails in some of the
surveys of early date in this and other counties.

During our trip on the creek we returned to point for
P. L. Barber and ran a line north to look for the S. W.
corner of the Barber as set forth in the correction of same. At a dis-
tance of 108 feet we passed a stake set by some surveyor for the Barber
and J. T. Pitts surveys. We failed to identify this place as the corner so
continued our course and at 207.5 feet we found the S. W. corner of the
Barber survey as set out on working sketch. You the General Land Office
witness trees had been cut but the stumps of same were found. We also found
a other corner stakes set by other surveyors for this corner but neither
of them was any reliable evidence of the real corner. The working sketch just
referred to gives the west line of the Barber as 173.5 feet and actually
it is 168.9 feet giving an excess of 17.9 feet over the call for the
west line.

From the S. W. corner of the Barber just found we ran a line east
through very dense undergrowth for a distance of 185 feet to a point
failed to find any corner or even a mark and to run on the line of survey
there was plenty of timber suitable to have the marks of the original survey
on them showing either the line of the S. R. R. or the line of the
Barber as it may be possible the line of Barber survey was ever marked
out on the ground as it frequently happened the locators did not close
these surveys upon the ground but closed them in the office especially when
the lines crossed them through dense brush and swamps such as exist in
the greater part of this county.

Having failed in finding any evidence of the North line of the H.Barber we returned to the N.W.corner as we find it and ran East for a distance of 378 varas as called for in the J.T.Pitts field notes as the lower S.W.corner of the B.B.B.& C.R.R.R.Co.No.119 and the S.E.corner of the J.T.Pitts survey.This point will be found in an old field which was cultivated for a long time many years ago and all evidence consequently gone. We ran a line North for a distance of 570 varas as set forth in the field notes of these surveys to try and locate the corner on the South line of R.P.Forbes survey which is a senior survey to either the Pitts or Sec.119 and failed in finding any evidence whatever of a line or corner of either of the surveys mentioned.This line also leads through dense brush which is extremely hard to get about in to look for marks.

After making a close search for marks of the R.P.Forbes and the B.B.B.& C.R.R.R.Co.No.119 without results we then tried for the East lines of the H.Barber so went to a stake that had been set on a previous survey for the N.E.corner of H.& T.C.R.R.Co.191 and the N.W.corner of Sec.No.190 and ran a line South therefrom 1900.8 varas to look for the S.W.corner of Section No.190,H.& T.C.R.R.Co. As this corner was witnessed by only one witness tree we made no attempt to find it as one witness tree is not sufficient to identify a corner.We ran East 476 varas to look for the N.W.corner of Section No.179,H.& T.C.R.R.Co.This corner being originally witnessed by two pin oaks which are not found as we did not take up time looking for them but turned South and at 122.6 varas we found the old line of Section No.179 to be 17.1 varas to the East of our line and set over to old line and continued our course for a distance of 728.6 varas pass a corner made for J.L.Kirby,at 1119.2 varas we find a corner set up for the N.E.corner of the H.Barber with an old line leading West therefrom which we retraced for a distance of 866 varas and fell North of our mark set for the S.E.corner of B.B.B.& C.R.R.R.Co.No.119,21.9 varas.The patent to the H.Barber calls this offset line to be 65 varas long.Still no evidence could be found of the line and corner for the Section so we returned to the corner on the West line of No.179 and were able to identify the corner of the H.Barber at that point by the stumpholes and logs of the old witness trees which had fallen.

We then continued our course South along the old West line of Section No.179 for a total distance thereon of 1900.8 varas but found nothing called for in notes to same nor did we find any line here for the J.A.Vickers as called for in notes of this section.We set a mark and ran West 350 varas to look for the Vickers league N.W.corner but nothing found to indicate same.

We ran South from this point 2592 varas to look for something to indicate where the corner of the Vickers league should be.On this course we were ^{between} two lines one of which was a very old line and the other a later one. At 2500 we set a mark for the S.W.corner of the Vickers league and at 2592 varas we fell East of a large stake which had been set for the N.W.corner of the A.A.Burrill league by the surveyor in locating the G.W.Eaton survey.A line of recent survey runs South from the stake and witness trees are marked,however it is all new work.

We then returned to our mark at 2500 varas and ran West 600 varas to look for evidence of the N.W.corner of the A.A.Burrill league as shown on the working sketch referred to above.The point falls in open space and nothing was found here.We turned South and at 771.8 varas we intersect the North bank of Village creek.The creek here is South of the old run of same and shows to ~~be~~ be constantly shifting South.When we entered the creek bottom we found a new line which had been made for the West line of Eaton

Having failed in finding any evidence of the North line of the H. Barber we returned to the N.W. corner as we find it and ran East for a distance of 378 varas as called for in the J.T. Pitts field notes as the lower S.W. corner of the B.B. & G.R.R. Co. No. 119 and the S.E. corner of the J.T. Pitts survey. This point will be found in an old field which was out-letted for a long time many years ago and all evidence consequently gone. We ran a line North for a distance of 570 varas as set forth in the field notes of these surveys to try and locate the corner on the South line of R.P. Forbes survey which is a senior survey to either the Pitts or No. 119 and failed in finding any evidence whatever of a line or corner of either of the surveys mentioned. This line also leads through dense brush which is extremely hard to get about in to look for marks.

After making a close search for marks of the R.P. Forbes and the B.B. & G.R.R. Co. No. 119 without results we then tried for the East line of the H. Barber so went to a stake that had been set on a previous survey for the N.E. corner of H. & T. G. R. Co. 191 and the N.W. corner of Sec. No. 190 and ran a line South therefrom 1900.8 varas to look for the S.W. corner of Section No. 190, H. & T. G. R. Co. As this corner was witnessed by only one witness tree we made no attempt to find it as one witness tree is not sufficient to identify a corner. We ran East 476 varas to look for the N.W. corner of Section No. 179, H. & T. G. R. Co. This corner being originally witnessed by two pin oaks which are not found as we did not take up time looking for them but turned South and at 122.8 varas we found the old line of Section No. 179 to be 171.1 varas to the East of our line and set over to old line and continued our course for a distance of 738.6 varas pass a corner made for J.L. Kirby, at 1119.2 varas we find a corner set up for the N.E. corner of the H. Barber with an old line leading West therefrom which we retraced for a distance of 888 varas and fell North of our mark set for the S.E. corner of B.B. & G.R.R. Co. No. 119, 21.9 varas. The patent to the H. Barber calls this offset line to be 65 varas long. Still no evidence could be found of the line and corner for the section so we returned to the corner on the West line of No. 179 and were able to identify the corner of the H. Barber at that point by the stumps and logs of the old witness trees which had fallen.

We then continued our course South along the old West line of Section No. 179 for a total distance thereon of 1900.8 varas but found nothing called for in notes as we find any line here for the J.A. Vickers as called for in notes of this section. We set a mark and ran West 350 varas to look for the Vickers league N.W. corner but nothing found to indicate same.

We ran South from this point 2522 varas to look for something to indicate where the corner of the Vickers league should be. On this course we were two lines one of which was a very old line and the other a later one. At 2500 we set a mark for the S.W. corner of the Vickers league and at 2522 varas we fell East of a large stake which had been set for the N.W. corner of the A.A. Burtill league by the surveyor in locating the G.W. Eaton survey. A line of recent survey runs South from the stake and witness are marked however it is all new work.

We then returned to our mark at 2500 varas and ran West 600 varas to look for evidence of the N.W. corner of the A.A. Burtill league as shown on the working sketch referred to above. The point falls in open space and nothing was found here. We turned South and at 771.8 varas we intersect the North bank of Village creek. The creek here is South of the old run of same and shows to be constantly shifting South. When we entered the creek bottom we found a new line which had been made for the West line of Eaton

The working sketch calls for this corner of the Eaton to be directly North of the N.E. corner of the S.B. Cooper survey located on the South bank of creek. Being unable to cross the creek we set a signal marker for observation from the South bank and temporarily abandoned investigation in this locality.

We returned to the mark set for the N.W. corner of the Vickers league and made a careful search for evidence of same and found a very old corner marked and an old stake. The witness trees were a large sweet gum and a large black gum, both marked with X marks of various ages. The oldest of which indicated to be old enough for the Vickers league.

From this old corner we ran East through brush and cut over land for a distance of 1480 varas and intersect the West bank of Beech creek where an old line crosses same. We crossed over to the East side of ~~the~~ the creek and traced the old line for a distance finding marks old enough to correspond with the marks on the witness trees at the N.W. of the Vickers league as we found it. We then returned to our marker set for the S.W. corner of Section No. 179, H. & T.C.R.R. Co. and prolonged the line South to intersection with line from the old corner just mentioned. The distance from the marker to the line is 35.3 varas and is East of the old corner 365.1 varas.

The Hiram Barber field notes for line calls it 350 varas from Section corner to the corner. This is a calculated distance by the surveyor in locating the Barber as shown by adding the distances from the river to the corner of the Vickers league as set forth in field notes of the Rafferty league and the H. & T.C.R.R. Co. sections along the North lines of the O.C. Nelson and J.A. Vickers leagues which ^{is} 20150 varas while the length of the combined Nelson and Vickers leagues is 20500 varas making a difference of 350 varas. We then ran a line South from the old corner of Vickers league following a very old marked line and at ~~1200~~₂₅₅₈ varas we find a rooted stake standing a little East of the large stake mentioned as set for the N.W. corner of the Burrill league.

From here we ran a line to Beech creek crossing a newly marked line at 382.9 varas, at 816.5 Bakers House brs S 19 deg E, at 876.2 vrs house ^{brs} S 15 deg W, at 1029 varas pass a corner, at 1152 varas pass another corner all new work and at 1834 varas intersect the West bank of Beech creek. We fell to the South of where an old line from the creek crosses same. We cross to the East side of the creek and find an old line which had been rerun several times and the oldest mark we could find thereon seemed to suit the age for the Burrill and Vickers leagues. We retraced the old line back to the creek where we find a continuation of same to be on a course of one degree to the left of the course of same line on East side of creek. We retraced the line back West on a course S 89 deg W to the stake last set for the S.W. corner of the Vickers league.

Thence we ran West along a newly marked line 600 varas where we found a marked corner for either the Burrill league or a corner of the Eaton survey which had only recently been resurveyed. This new corner bears N 74-3/4 deg W 30.8 varas from the corner where our measurement put us.

We abandoned our investigation of the surveys North of Village creek and the next day went to the upper N.E. corner of the Lawrence & Creecy survey which is on the South bank of the creek, this corner being also the East corner of a small survey of 10 acres in the name of G.W. Eaton.

The working sketch calls for this corner of the site to be a nearly north-south line of the S.E. corner of the 8.5. Cooper survey located on the back of creek being unable to cross the creek we set a signal marker for observation from the south bank and temporarily abandoned investigation in this locality.

We returned to the creek set for the S.E. corner of the Vickers survey and made a general search for evidence of same and found a very old corner marked and in its place. The witness trees were a large white gum and a large black gum, both marked with X marks of various ages. The object of this indicated to be old enough for the Vickers survey.

From this old corner we ran West through brush and out over land for a distance of 1482 yards and intersected the West bank of Beech creek where an old line crossed same. We crossed over to the West side of the creek and located the old line for a distance of 1000 yards and then corresponded with the corner on the witness trees at the N.E. of the Vickers survey we found it to then returned to our marker set for the S.E. corner at section 30, T. 2. S., R. 1. E., N. 10. and prolonged the line South to station 1000 yards from the old corner just mentioned. The distance from the corner to the line is 1482 yards and is East of the old corner 882.1 yards.

The lines Barber field notes for line 250 yards from section corner to the corner. This is a calculated distance by the surveyor in locating the Barber as shown by skirting the distance from the river to the corner of the Vickers survey as set forth in field notes of the latter by Barber and the S.E. corner of the Vickers survey while the survey of 8.5. Cooper and 8.5. Vickers surveys which 2010 yards while the distance the combined Nelson and Vickers surveys is 2000 yards having a difference of 110 yards. We then ran a line North from the old corner of Vickers survey following a very old marked line and at 1000 yards set a signal stake standing a little West of the large stake mentioned as set for the N.E. corner of the Bartill survey.

From here we ran a line to Beech creek crossing a newly marked line at 200.0 yards, at the E. Baker's House Mrs. E. Judge, at 450.0 yards and 1.18 deg. W. at 1020 yards pass a corner at 1182 yards past another corner. All new work and at 1482 yards intersected the West bank of Beech creek. We then to the South of where an old line from the creek crosses same. We cross to the East side of the creek and find an old line which had been run several times and the object here we could find thereon seemed to suit the case for the Bartill and Vickers surveys. We retraced the old line back to the creek where we find a continuation of same to be on a course of one degree to the left of the course of same line on East side of creek. We retraced the line back West on a course of 89 deg. W. to the signal stake set for the S.E. corner of the Vickers survey.

Thence we ran West along a newly marked line 600 yards where we found a marked corner for either the Bartill survey or a corner of the Nelson survey which had only recently been retrace. This new corner bears 54-1/2 deg. S. 22.4 west from the corner where our measurement put us.

We abandoned our investigation of the surveys North of Vickers creek and the next day went to the upper N.E. corner of the Lawrence & Brown survey which is on the South bank of the creek. This corner being also the East corner of a small survey of 10 acres in the year of 8.5. Cooper.

Keep with Hardin Co. rolled sk. "TMH"

From here we ran West 356 varas and intersect a line that runs North. The sketch from the Land Office that we were using gives the South line of the Eaton as 354.6 varas. We turned here and ran North 226 and intersect the South bank of Village creek at a point 36.5 varas West of a ^{point} South of the marker set for observation on the North bank where the H. Barber line should intersect same. No evidence found of witness trees of the S.B. Cooper survey although the line we retraced to the creek appears old enough to be the Cooper line but if its distance from its S.E. corner to the creek is only approximately correct there is a conflict of lines of the Cooper and Lawrence and Creecy surveys amounting to 240 varas. I am inclined to believe that J.J. Copley in locating the S.B. Cooper survey in 1890 was mistaken as to his location and used the lower N.E. corner of the Lawrence and Creecy survey as that will make his measurements come out nearer to the distances given on the sketch. We made no check of these lines however at the time to see if such was the case.

We then go to the lower N.E. corner of the Lawrence and Creecy survey on the South bank of the creek and set a signal in line on North of same and go to the S.E. corner of the Lawrence and Creecy and measure along a random line to look for Carter Hart's S.E. corner of the G.W. Eaton but no corner as described by him in field notes to the Eaton was found altho we do find a new line blazed out for this survey at the distance set out in field notes of the Eaton. Hart calls the S.E. corner of the Eaton to be also the S.W. corner of the A.A. Burrill league. In this connection he is mistaken. While I have never discussed the location of the Eaton surveys with Carter Hart I have been advised that he did not make the surveys himself but they were made by another surveyor and Hart approved the field notes.

It seems that the locating surveyor acting upon the theory that these leagues coming out from the river were not actually surveyed on the ground at the time the titles were issued began his work at the S.E. corner of the O.C. Nelson league and ran the course and distance called for in the field notes of the Nelson and Burrill leagues and from that measurement placed the G.W. Eaton surveys in conflict with the Burrill and Vickers leagues.

During the year just passed I surveyed the East lines of the Lawrence & Creecy, J. Landis No. 7, Louis Boulett and T.H. Lewis surveys and in doing so found all the original corners along the East lines of these surveys which I found to be in excess over their calls for distance and on this work I found indisputable evidence of the West line of the Burrill league showing it had been actually marked out on the ground.

The block of 320 acre surveys in that territory were located by M.W. Bumstead and dated 1840. While he does not mention any old lines adopted by him I find the Lawrence & Creecy and part of Landis No. 7 to follow a very old marked line that was marked before Bumstead ever went there.

At a point 20 varas South of the S.E. corner of the Lawrence & Creecy survey we found a large beech tree marked with 2 sets of very ^{old} marks denoting that it was a line tree. We sawed out a block from the North side of this tree and counted the growth rings and find one set to be 97 years old and the other set to be 104 years old. This indicates that Bumstead did his work out there in 1838 and David Brown who located the Burrill league was on the ground in 1832 or 1833. David Brown and Jno. A. Veatch worked together out there and located these leagues alternately.

From here we ran West 255 yards and intersected a line of the
 North. The station from the land office that we were using gives the
 line of the station as 255.6 yards. We turned here and ran North 255
 intersect the south bank of Village creek at a point 25.5 yards east of a
 south of the water set for observation on the North bank where the
 for the south interest same. No evidence found of witness trees of the
 2.5 Cooper survey although the line we retraced to the creek appears old
 enough to be the Cooper line but if its distance from the S.E. corner to
 the creek is only approximately correct there is a conflict of lines of
 Cooper and Lawrence and Greasy surveys amounting to 240 yards. I am inclined
 to believe that 4.1 Cooper is locating the S.E. corner survey in 1850 was
 mistaken as to his location and used the lower W.K. corner of the Lawrence
 and Greasy survey as that will make his measurements come out better to
 the distances given on the station. We made no check of these lines however
 at the time to see if such was the case.

We then go to the lower W.K. corner of the Lawrence and Greasy
 survey on the south bank of the creek and set a signal in line on north of
 side and go to the S.E. corner of the Lawrence and Greasy and secure a
 a person line to look for Carter Hart's S.E. corner of the W.K. station and
 no corner as described by him in field notes to the station and found that
 we do find a new line placed out for this survey at the distance of 240
 in field notes of the station. That calls the S.E. corner of the station to be
 also the S.W. corner of the A.A. Burdell league. In this connection I
 mistake. While I have never discussed the location of the station survey
 with Carter Hart I have been advised that he did not make the survey and
 said that they were made by another surveyor and Hart approved the field
 notes.

It seems that the locating surveyor set out upon the survey that
 these leagues coming out from the river were not actually surveyed on the
 ground at the time the titles were issued began his work at the S.E. corner
 of the C.C. Nelson league and ran the course and distance called for in the
 field notes of the Nelson and Burdell leagues and from that measurement
 placed the S.W. station survey in conflict with the Burdell and Nelson
 leagues.

During the year just passed I surveyed the West line of the
 Lawrence & Greasy, J. Landis & V. Louis Bonsett and T.H. Lewis surveys and
 in doing so found all the original corners along the West line of these
 surveys which I found to be in excess over their calls for distance and on
 this work I found indistinct evidence of the West line of the Burdell
 league showing it had been actually marked out on the ground.

The block of 320 acre survey in that territory was located by
 K.W. Bunsford and dated 1843. While he does not mention any old lines whatever
 by him I find the Lawrence & Greasy and part of Lewis & V. to follow a
 very old marked line that was marked before Bunsford ever went there.

At a point 20 yards south of the S.E. corner of the Lawrence &
 Greasy survey we found a large peach tree marked with 2 sets of very
 denoting that it was a line tree. We sawed out a block from the North side
 of this tree and counted the growth rings and find one set to be 47 years
 old and the other set to be 104 years old. This indicates that Bunsford did
 his work out there in 1858 and David Brown who located the Burdell league
 was on the ground in 1853 or 1852. David Brown and the A. Nelson survey
 together out there and located these leagues alternately.

Each of them had a system of marking their lines peculiar to himself, I suppose for future identification and the marks on the beech just referred to had the marks of David Brown which the working sketch shows that he located the Burrill league.

We next return to the signal set on North bank of Village creek from the lower N.E. corner of the Lawrence & Creecy survey and ran East to look for the East line of the Eaton survey and found a newly marked line which we retraced to the North bank of Village creek where we found the corner called for in field notes to the Eaton at that point. This corner is witnessed by two large cypress trees both of which are still green and standing. We made no attempt to resurvey the lines of the Eaton surveys but find they have been recently resurveyed and corners marked.

We next return to the N.W. corner of the Barber as we find it and ran a line North 550 varas to a point and West 161 varas where we identified the S.W. and beginning corner of the R.P. Forbes survey from which we ran a line East through the dense growth but were unable to find anything so we ceased investigation.

From the evidence I find on the ground it is my belief that the G.W. Eaton surveys are located in error and that there is no space for them anywhere in this county. It is also my belief that the Hiram Barber had only two lines ever marked out on the ground, these being the North line between Sec. 179, H. & T. C. R. R. Co. and B. B. B & C. R. R. R. Co. 119 and the West line to Village creek, the rest being supplied in the office from maps and field notes of surveys previously located. Such surveys have often been made.

The G.W. Eaton surveys also seem made without sufficient investigation as will appear from the map herewith which shows the original lines and corners that I have been able to identify on the ground and reaches from Tyler County half way across Hardin County.

Yours very truly,

T. M. Hyde

Licensed State Land Surveyor.

Received and filed in General Land Office on June 27th, 1936.

J. H. Walker, Comm.

C. F. Blucher, Clk.

Hardin County Report covering the 95 survey of the Hiram Barber, J. A. Hickers, P. S. Wolff's contest, by T. M. Hyde filed June 27 1936

...of them had a system of marking their lines...
...I suppose for future identification and the marks on the ground...
...had the marks of David Brown when the working sketch shows...
...had he looked the survey features.

We next return to the signal set on north bank of Village creek
from the lower N.E. corner of the Lawrence & Greasy survey and ran east to
look for the east line of the Eaton survey and found a newly marked line
which we returned to the north bank of Village creek where we found the
corner set for in field notes to the Eaton at that point. This corner
is witnessed by two largeypress trees both of which are still green and
standing. We made no attempt to re-survey the line of the Eaton survey but
the line has been recently re-surveyed and corners marked.

We next return to the N.W. corner of the Barber as we find it and
run a line north 880 yards to a point and East 121 yards where we identify
of the S.W. and beginning corner of the H.S. survey from which we
run a line east through the dense growth but were unable to find anything
so we ceased investigation.

From the evidence I find on the ground it is my belief that the
S.E. corner surveys are located in error and that there is no space for them
anywhere in this county. It is also my belief that the Hiram Barber had only
two lines ever marked out on the ground, these being the North line between
Sec. 122, N. 20. N. 20. and R. 8. E. 8. & S. R. W. 119 and the West line to
Village creek, the rest being supplied in the office from maps and field
notes of surveys previously located. Such surveys have often been made.

The H.S. Eaton survey also seem made without sufficient investi-
gation as will appear from the map herewith which shows the original lines
and corners that I have been able to identify on the ground and reaches
from Taylor nearly half way across Hardin County.

Yours very truly,

T. M. Hyde

Assistant State Land Surveyor

Keep With
Hardin County Rolled Sketch No. "T.M.H."
Report covering the Re-survey of the
Hiram Barber, J. A. Vickers, P. S. Watts and ect.,
By T. M. Hyde
Filed June 27, 1936

11-23-37
W.L.H.