

~~No 34~~

Return

Martin Duwall

Field Book of

Martin Duwall
State Agent

Wilbarger County
Texas

4/4/1
4/4/1
3/2/1
2/2/1
031

In

502

Block 13

From page 14 to 74 not all
classified

Block 4

From page 88 to page 146

61432

61433

2 Section 118 Block 14

Soil Grass Timber Water Cor marks

Willsboro County 3

General description of surface Topography

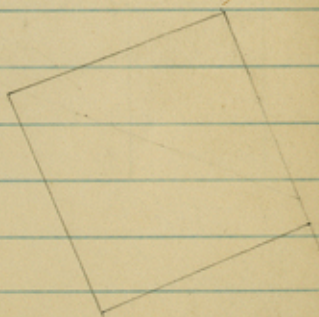

4 Section 120 Block 14 or
Beatty shale +

Wilberger County 5

Soil Grass Timber Water Air marks ^{Forward} geol description of surface Topography

Grey sandy and occasionally
rich

Good set of prairie

none

none

Smooth level prairie
good agricultural land
description applies to
whole section

Loc	Soil	Grass	Timber	Water	Ar markers	Gen description of surface	Topography
	Dark	Gamma	-	-	Stake mound and 4 pits	Smooth + level	good agricultural land
N E	red sandy loam	mesq well set	-	-	Stake and 4 pits		
N W	partly red sandy loam partly nothing but sand	Gamma mesq + Sedge	Some small hackberry	-	Stake and 4 pits		
S E	Dark red sandy loam	Gamma mesquite well set	-	-	1 Stake mound and 4 pits	Smooth with a gentle slope to the north	
S W	Red sandy loam	Gamma mesquite	-	-	Stake and 4 pits	Smooth and nearly level good agricultural land	

is fenced and about 60 acres in cultivation water can be had in wells at a depth of 25 feet

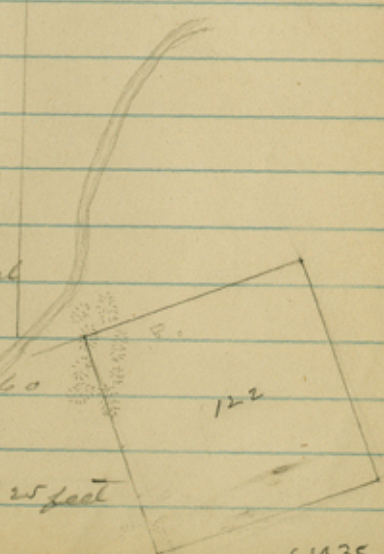

8

9

61436

10

11

61437

NE Soil Grass Timber Water Cor marks
 Red Gamma - -
 loam

Red Gamma Cottonwood Water
 and and in creek
 Messy Elm on at present
 creek time and
 has the
 appearance
 of being
 permanent

Red needle -
 Messy
 SE loam

Red needle Taken + Plenty of Old Stone
 loam Messy Cottonwood water in mound
 on creek creek run and it is an old
 probably witness
 permanent on Elm
 Standing

gent description surface Topography &
 Rolling Field notes of Sect 2
 suitable for grazing, Requiring at least 200
 only

Smooth valley land
 good agricultural
 except breaks near
 the creek shown in
 topography

Rolling and broken
 in places by
 ravines and washes
 suitable for grazing
 only

About 100 acres
 in creek valley
 a smooth pretty
 lay of land
 suitable for farming

and form an

There is a small residence
 The SW 1/4 of this sect

Variation 6° 18' E

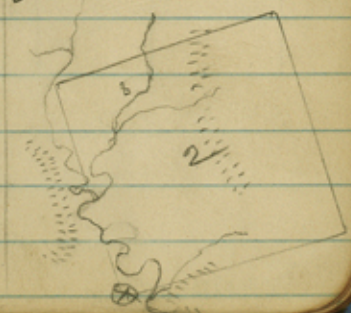

16 Section 4 Block 13 Surveyed by H + J C. R.R. Co in Milberger Co

17

Soil	Grass	Timber	Water	Cor Mark	Gen description	Topography	Field notes of Sect 4/-	acres
							Beginning at corner this	
							then course distance landmarks	

18 Section 6 Block 13 Surveyed by

N + Z C R R Co in Willbarger Co

19

Soil Grass Timber Water Air marks

gent description surface Topography &

Field notes of Sect 6 =

beginning at cor. N. this

Section 8 Block 13 Surveyed by

Soil Grass Timber Water Course

H + Y R R Co in Hilburger Co

Gen description surface Topography

Field notes of Section

beginning at corner

then course distance landmarks

Sec	Soil	Grass	Timber	Water	Corner marks Stake and	Soil description Surface	Topography &
N E	Red loam and gravel	needle Grass	-	-	4 pits	Generally too rolling and soil unfit for agriculture but a plot of probably 20% or so acres can be had suitable for farming	field notes of sect 10 = regarding at corner this Hance Course distant landmarks
N W	Red loam and gravel	needle grass	-	-		Rolling and broken grading land	
P E	Red loam but a great deal of gravel intermixed	needle Mesquite	-	-	a solid stone set in ground also old stone and	Rolling and broken by drains suitable for grazing only	
S W	Red loam with gravel	needle Mesquite	-	-		Rolling and broken grazing land	

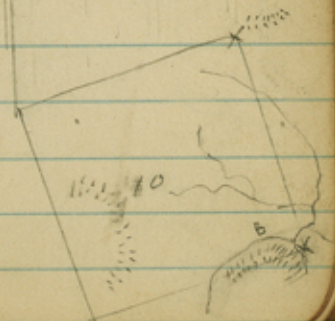

Soil	Grass	Timber	Water	Cor marks
Dark red loam	mesquite	-	-	-
Dark red loam	mesquite	-	-	Stake md + 4 pits
Red loam	mesquite	some elm + cottonwood	-	-
Very gravelly				Stake md + 4 pits

General description of Surface

Etopography +

Reasonably smooth fields with a few

walley land beginning at corner

suitable for farming with but little wash
some course distance

generally smooth but rolling near the NW cor of the 9th

principally smooth nearly level land some breaks near creek

Broken, 2nd class grazing land

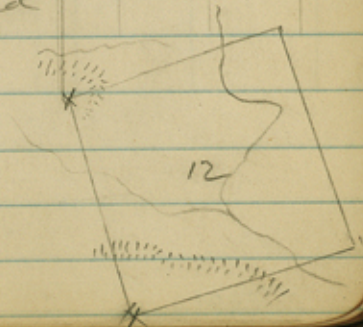

26 Section 14 Block 13 Surveyed by H & C R R Co in Willbarger Co

27

26 Section 14 Block 13 Surveyed by
26 Soil Grass Timber Water Cor Marks

27
Genl description Surface Topography &

Field notes of Sect 14

beginning at corner

Then Course	Distance	Land marks
-------------	----------	------------

28 Section 16 Block 13 Surveyed by

Soil Grass Timber Water Cor Marks

H & C R R Co in Willberger Co. 29

General description Surface Topography +

Field notes of section

beginning at corner

then course distance landmarks

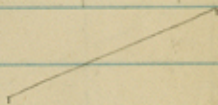

Sec	Soil	Grass	Timber	Water	Cor marks	General description surface	Topography +
-----	------	-------	--------	-------	-----------	-----------------------------	--------------

Field notes of Sect 18

beginning at corner this

then course distance landmarks

20	Soil	Grass	Timber	Water	Remarks	General description of surface	Topography & field notes of Section 20
N E	Red loam	Good	-	-	-	Smooth prairie	except a few small breaks a fair grade of agricultural land
N W	Gravelly Red loam	but not well set	-	-	Old Stone mound found	Very broken 2nd class grazing land	beginning at corner this course distance land marks
S E	Red loam	Heavy	-	-	-	Smooth valley except small breaks at drains, good agricultural land	
S W	Red loam	heavy good set	-	-	Stone mark 4 feet	Undulating but smooth 2nd class agricultural land	

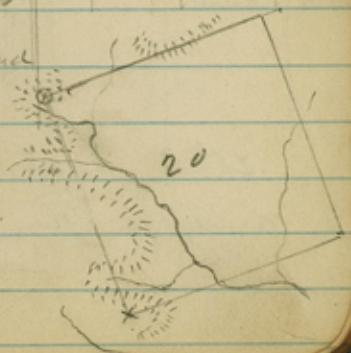

Soil	Grass	Timber	Water	Cor marks
Dark Gamma old N.E. Loam				

Red Gamma N.W. Loam	-	-		
------------------------	---	---	--	--

Red Gamma O.E. Loam	-	-	old Stone and	
------------------------	---	---	------------------	--

Red Gamma but thin O.W. Loam	-	-		
------------------------------------	---	---	--	--

This sect is fenced and
and a farm of about 50 acres

gent description before Topography +
Smooth prairie field with best in acres
good agricultural remaining crops This
land

Smooth prairie with
gentle undulations
fine agricultural
land

About 40 acres on
N.W. cor smooth and
gently sloping to S.W.
remainder rough
and broken

North $\frac{1}{2}$ of 90 smooth
and gently sloping
to the North good
agricultural land,
South $\frac{1}{2}$ on a steep
slope growing timber
only

There is a residence
on N.W. 90

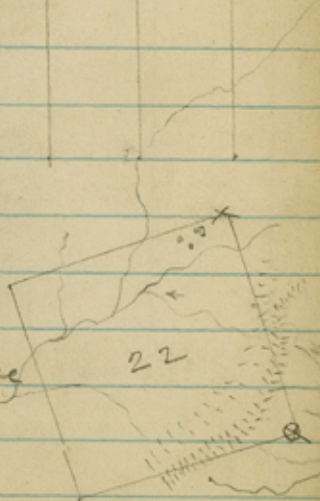

Section 24 Block 13 Surveyed by The

Per	Soil	Grass	Timber	Water	Cor marks
-----	------	-------	--------	-------	-----------

H & J C R R Co in Willbarger County

Genl description	Surface	Topography
------------------	---------	------------

Field notes of Section

beginning at corner

then Course distance landmarks

38 Section 26 Block 13 Surveyed by the N & W R R Co in Wilberforce County 39

Per	Soil	Grass	Timber	Water	Co. Marks	General description	Surface	Topography	+
-----	------	-------	--------	-------	-----------	---------------------	---------	------------	---

Field notes of Sect 26 - area

beginning at corner of

these Course distance Landmarks

40 Section 28 Block 13 Surveyed by The H+J C RR Co in Willbarger County 41

20	Soil	Grass	Timber	Water	Co marks	Geol description	Surface	Topography	+
----	------	-------	--------	-------	----------	------------------	---------	------------	---

Field notes of Sect 28

beginning at corner this

the course between landmarks

Section 30 Block 13 Surveyed by the

No	Soil	Grass	Timber	Water	C&M marks
----	------	-------	--------	-------	-----------

W + J C RR Co in Wilbarger County

Genl descriptive surface	Topography +
--------------------------	--------------

Field notes of Sect 30

Beginning	Course	Th
-----------	--------	----

Area	Course	Distance	Landmarks
------	--------	----------	-----------

Dir	Soil	Grass	Timber	Water	Corner marks
	dark loam	mesq	-	-	
NE	red loam				
	dark				14 pits
NW	red loam	mesq, gold set	-	-	
	dark				
SE	red loam	mesq well set			
	dark				
SW	red loam	mesquite	-	-	

Soil description Surface Topography
 Smooth prairie Field notes of Section
 good agricultural beginning at corner This
 land

Slopes -
 Smooth - gently
 to the east good
 agricultural land

Gently sloping to the
 north but unbroken
 a fine tract of
 agricultural land

Gently undulating
 but smooth
 fine agricultural
 land

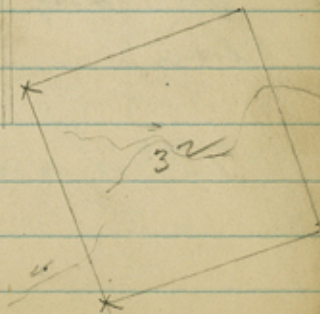

Cor	Soil	Grass	Timber	Water	Co marks
	Red				
NE	loam	mes	-	-	ma
	Red	mes	-	-	
NW	loam				
	silt	good	-	-	Stake
SE	red loam	mesy			rod + 4 pits
	silt	good	-	-	
SW	red loam	mesy			

Genl description surface Topography
 Field notes of Sect 34
 beginning at corner
 three course distance
 land marks

Broken
 Broken, grading
 land only

Smooth with a
 gentle slope to
 the east

Smooth land
 and good soil,
 except about 60 acres
 on west side which
 is broken

There is a house on this sec

no other improvements



48 Section 36 Block 13 Surveyed by the H + T Co. in Walbarger County 49

Sex	Soil	Grass	Timber	Water	Crops	General description of surface	Topography +
							field notes of Sect 36 - course
							beginning at cross
							thence
							Course Distance Landmarks

50 Section 38 Block 18 Surveyed by the N.Y.C.R.R. Co. in Millbarger County

51

Sec	Soil	Grass	Timber	Water	Cr marks	Genl description of soil	Topography		

52

Section 40 Block 13 Surveyed by the

Loc	Soil	Grass	Timber	Water	Cor marks
-----	------	-------	--------	-------	-----------

N + Y C RR Co in Willbarger County

53

Genl description of place	Topography +
---------------------------	--------------

Field notes of Sect 40

beginning at Cor 98 This

Thence	Course	Distance	Landmarks
--------	--------	----------	-----------

54

Section 42 Block 13 Surveyed by the

Gr	Soil	Grass	Timber	Water	Corner markers
----	------	-------	--------	-------	----------------

H+J Co RR Co in Willbarger County

55

General description	Surface
---------------------	---------

Topography +

Field notes of Section	acc
------------------------	-----

beginning at	Cord 28°	This
--------------	----------	------

thence Course	Distance	Corner marker
---------------	----------	---------------

56 Section 44 Block 13 Surveyed by the H & C RR Co in Wilberforce County, 57

Order Soil Grass Timber Water Crops or marks Geol description Surface Topography +

Field notes of Section 44
Beginning at Cor of RR
thence Course distance landmarks

Per	Soil	Grass	Timber	Water	Or marks
-----	------	-------	--------	-------	----------

	Grey loam	Mesquite but not well set	-	-	-
--	-----------	---------------------------	---	---	---

	Grey loam	Mesquite but not well set	-	-	-
--	-----------	---------------------------	---	---	---

	Grey loam	Mesq but thin	-	-	-
--	-----------	---------------	---	---	---

	Red loam	Mesquite grass	-	-	-
--	----------	----------------	---	---	---

General description of land
 Smooth and nearly level, good agricultural land
 Beginning at corner this

Smooth prairie
 sloping gently to the S E good agricultural land

Smooth prairie
 nearly level, good agricultural land

Rolling, and in places broken
 1/2 2nd class agricultural land

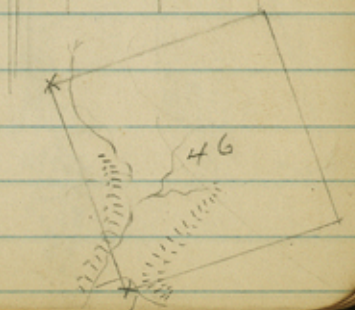

Color	Soil	Grass	Timber	Water	Cor marks
	Grey	mesquite	-	-	-
N.E.	loam	mesquite	-	-	-
	Grey	Good	-	-	-
N.W.	loam	Gommit	-	-	-
		Mesq	-	-	-
	Grey	Good	-	-	Stone med
S.E.	loam	Set Mesquite	-	-	-
	Grey	Good	-	-	-
S.W.	loam	Mesq	-	-	-

Genl description surface Topography +
Rolling but not broken. Good notes of soil on one
2nd class agricultural requiring at least 2000 lbs
land

Rolling but unbroken
surface 2nd class
agricultural land

Gently undulating
but smooth, good
agricultural
land

Smooth and
nearly level,
good agricultural
land.

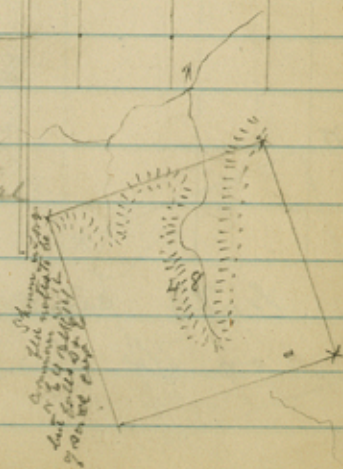

Sec	Soil	Grass	Timber	Water	Co roads
46	Red loam	mesq	-	-	
47	Red loam	mesq & ground good	-	-	
48					
49					

gentle description of topography & smooth undulating prairie good agricultural land
 Field notes of Sect 50
 showing cross
 These courses distance landmarks

Somewhat broken from drain shown in topography but is good arable land

Smooth prairie slightly rolling but not enough to impair its value good agricultural land

Generally smooth but slightly rolling on east side good agricultural land with a small her lease of waste

Water could be had in on the low ground

wells at 25 feet

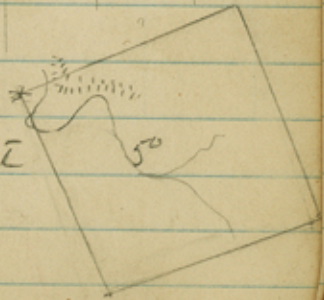

64

Section 5-2 Block 3 Surveyed by the
 Soil Grass Timber Water Cor marks

N.Y. C. R.R. Co in Millbarger County

65

Geol description	Surface	Topography +
		Field notes of section area
		Beginning at Cor. of the
		Line Course & distance Landmarks

Per Soil Grass Timber Water Cor marks

Grey loam
Gouner
and
shes

Timber Water Cor marks

Geol description Surface

Topography +

Field notes of Sect 54 =

beginning at cross this

then Course distance landmarks

Slight breaks in the line on the 1000 ft. line
 + 200 on the 1000 ft. line
 + 100 on the 1000 ft. line
 + 100 on the 1000 ft. line
 + 100 on the 1000 ft. line

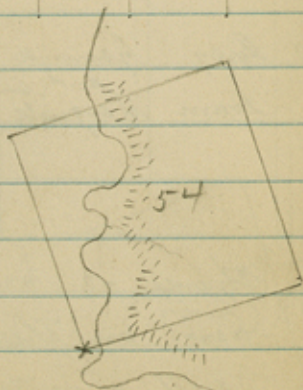

Sec	Soil	Grass	Timber	Water	Cor marks
	Dark	Good	-	-	Farm NE 36 an old bottomwood stump was found which corresponds as to distance but not
N E	Grey loam	Gamma and Mesquite	-	-	-
	Dark	Good	-	-	-
N W	Grey loam	Gamma Mesquite	-	-	-
	Red loam	Gamma and Mesquite	-	-	-
S E					
	Red loam	Gamma and Mesquite	-	-	-
20 W	Grey loam	Gamma and Mesquite	-	-	-

There is a residence and a
acres on the N E 1/4 also a
depth of 15 feet. This is about
I have seen in the County. to
July 24th 1987

Genl description Surface Topography +
Smooth and level Field notes of Section area
a very fine tract beginning at corner
of agricultural land

Smooth but gently
undulating fine
agricultural land

Rolling and in
places broken, but
a considerable per
cent on S E cor can
be used for
agricultural purposes
probably 2/3 of the pt

Smooth prairie
but gently rolling,
fine agricultural
land, some waste
along drain shown
in Topography

Farm of about 30
well of water at a
The best section that
date



Section 58 Block 13 Surveyed by the

No	Soil	Grass	Timber	Notes	Cor marks

N + S 6 RR Co in Milberger County

General description of Surface Topography +

Field notes of Sect 58 area

Beginning at corner this

then course distance landmarks

72 Section 60 Block 13 Surveyed by The N & W RR Co in Halberger county 73

Soil	Grass	Timber	Water	Cor marks
Dark	Gamma and			
Grey	Mesa			
Loam	well set			

gent description of surface Topography &
 Beautiful smooth field notes of Sect 60 are
 prairie fire beginning at corner this
 agricultural land has course distance landmarks

72
 side of road
 at
 72

The sect is irregular and
 divided regularly

can not be

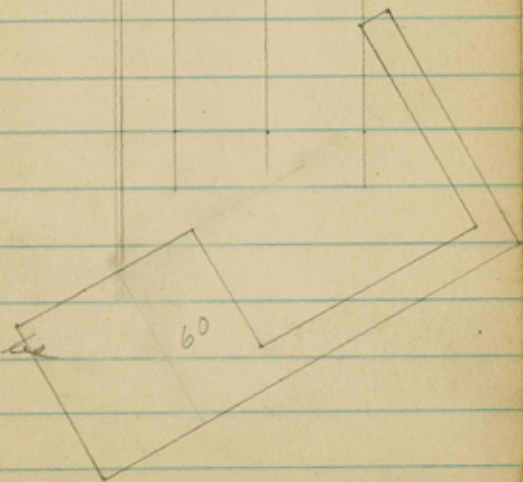

74

75

61469

76

77

61470

78

79

61471

80

81

G1472

84

85

61474

86

87

61475

Dir	Soil	Grass	Timber	Water	Cor marks
	Very gravelly & rocky	mesq but not good	A few blue	-	Stone monument 2' high on stone mks. SE 7
NW	loam with considerable gravel	Mesquite and a fair set	-	-	not existing
SE	pale red loam with some gravel	Mesquite grabs but not well set	-	-	Stone m. + 4 pits located from original calls for 3 per 100 1/87 2/8 5/2 5/2 5/2 This is the m. at SW 1/4
SW	Red loam with spots of gravel	Good Mesquite	-	-	Stone monument 4' tall peak 0.75 11 0 38 1/2 2 2 1/2

gent description Surface Topography & Rough and broken Field Notes of Sect 2 = 640 acres Suitable for grazing only Beginning at N E Cor 1 for N W this

Course distant landmarks
 1914 200
 not run
 coming
 Cor to N E Cor then
 + S E 40° 7'
 To S E Cor then
 + N W 40° 3'
 1914 " To S W Cor then
 + S E 40° 1'

Rolling and on north side runs into breaks grazing land only

Rolling and in places broken grazing land only

partly rolling partly unimproved about 1/2 3rd class arable land remainder by grazing land



Dir	Soil	Grass	Timber	Water	Cor marks
N E	Red loam	Thin set of Mesquite	Elm Hackberry + Chiny on South	Some water in South	Some water in South
N W	Red loam	Thin set of Mesquite	Elm Fly chiny + Cottonwood	Some water in South	Stone mound
S E	Red loam with gravel in place	Fair set of Mesquite	-	-	-
S W	Red loam in valley with gravel on hills	Fair set of Mesquite	Elm Fly chiny + cottonwood on creek	-	-

March 12th 1887

Gen description	Surface	Etopography
Considerably broken by creek and drain but where there is any, body together and is good		field notes of Sect 4-66000 Beginning at SW cor N 53 N W this true course distance landmarks " N 72° E 1900 m to N E cor " S 18° E 1900 m to S E cor " S 72° W 1900 m to S W cor " N 18° W 1900 m to the place of beginning
Generally smooth valley but some waste land at the creek good agricultural land		
Rolling + broken grazing land only		

about 1/2 of 91 is
in with valley and
good agricultural
land, 1/2 is broken
and is grazing land
only



61477

Sect 6 Block 4 Surveyed by
 20 Soil Grass Timber Water Cor marks

2/20
 No apphed
 fluted or lost probably

H+JG RR Co in Wilberger Co

gent description surface Topography

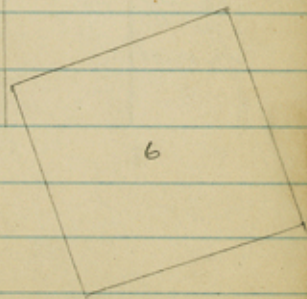

Cor	Soil	Gross	Timber	Water	Air	marks
	Very	Fair	-	-	-	A Stone set in the ground 7 4 feet
N E	gravelly + rock	set of massy	-	-	-	Stone set in ground 7 4 feet part on 35000 E " 35670 E " 860 45 E
N W	pale red loam	Very thin set of needle grass	-	-	-	Stone set in ground 7 4 feet
S E	Rock + Gravelly	Fair set of massy	-	-	-	
S W	pale red loam with gravel	Needle grass Fair set	-	-	-	A Stone set in the ground 7 4 feet

Get description	Surface	Topography &		
	Very broken	Field notes of Sects. 6453 acres		
	2nd class grazing	beginning at NW corner of this		
	land	then Course	Distance	Landmarks
		" S12° E	1916 m	to S E cor
		" S72° W	1900 "	to S W cor
		" N12° W	1916 "	to N W cor
		" N72° E	1900 "	to the
				place of beginning
	Rolling with occasional breaks suitable for grazing only			
	Rolling and broken 2nd class grazing land			

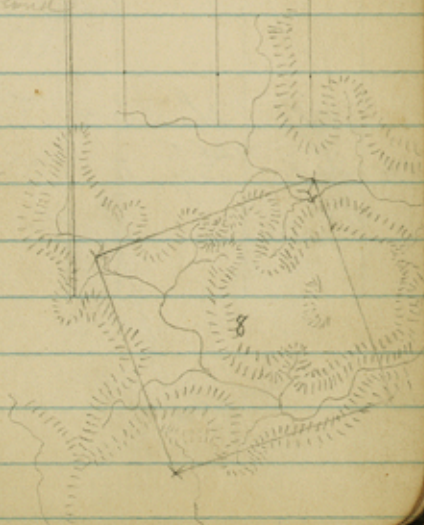

Dir	Soil	Grass	Timber	Water	Cor Marks
N E	Red loam but gravelly	Good Wes on parts of the gr	-	-	1 Stone set in ground + 4 pits mid on ridge 30' N W 20' S W
N W	Gravelly	Very thin set of mesquite	-	-	Stone set in ground + 4 pits
N E	Red loam	Thin set of mesquite	-	-	1 Stake and + 4 pits
S W	Red loam	Thin set of mesquite	-	-	1 Stake and + 4 pits

March 12th 1887

Genl description	Surface	Topography &		
Rolling with some breaks, grazing land with small water	2nd class agricultural near centre of gr	Beginning at NW cor of 9 & 6	Thin Course	Distance Landmark
Rolling & broken	2nd class grazing land	S 18° E	1916 m	to S E cor
		S 72° W	2044.	to S W cor
		N 18° W	1916.	to N W cor
		N 72° W	2044.	to the

place of
beginning

About 1/2 of this gr is broken but there is valleys of considerable width or the drains that lay well, probably 1/2 the gr is 2nd class stable land but does not lay in one body

Undulating but no breaks
2nd class arable land



Dir	Soil	Grass	Timber	Water	Cor marks
	Red	Good	-	-	A stone set
NE	loam	needle			in the ground
	good	grass			+ 4 pits
	Red	Good set	-	-	Stone set in
NW	loam	needle			the ground
		grass			Wk 2 SW 13 0-1. 975 1/2 E " 270 1/2 E " 272 1/2 E
	Red	needle			
SE	loam	grass	-	-	Stake ma
		good			+ 4 pits small one N 73 1/2 W small " S 45 1/2 W
	Red	Good set	-	-	Stake ma
SW	loam with gravelly spots	needle grass			+ 4 pits

There is a residence on SE 1/4
well at a depth of 30 feet

pieces of iron ore found near
has the appearance of being rich ore
March 11th 1887

Genl description	Surface	Topography	
Smooth land but	gently sloping	Field notes of Sect 12 - 645 1/2 a.c.	beginning at NW cor of NW 1/4 to this
good agricultural		Land Course	distance landmarks
		" S 18° E	1916 2m to S E Cor
Some breaks near		" S 72° W	1900 " to SW Cor
SW cor of gr. but the		" N 13° W	1916 " to NW "
greater part of gr is		" N 72° W	1900 " to the
smooth and is good			place of
agricultural land			beginning
Smooth pretty land			
good for agricultural			
purposes			

Rolling and some
breaks, about 1/2 of
the gr is 2nd class
arable land
remainder grazing
land

of this sect also a
small farm -
There has been small
dig holes and some outcrops

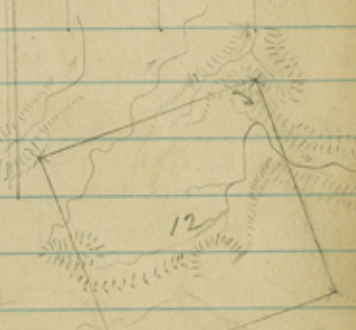

No	Soil	Grass	Timber	Water	Air marks
	pale red loam	thin set of Mesquite	Good Elm on drain + small heavy brush on top of land		
N 70	Generally gravelly small valleys of good soil	Thin set of Mesquite	Some Elm on drain		
S 6	Red loam	Heavy but not good	A few Elm		Stone set in ground + 11 pits mid on ridge S 71 W 24 Elm set S 46 W 76
S 71	Red loam but generally set of on point and ridges deep	Thin set of Mesquite			Stake mid + 4 pits

Water could be had in the
20 to 25 feet

March 17th 1887

Soil description Surface Topography &
 about $\frac{1}{2}$ of it is
 High land and gentle undulating with local
 near drain, about $\frac{1}{2}$ of the grass good
 agricultural land running down into valley

Beginning at N 6 Cor #12 N 71
 Hence local distance landmarks

" N 72 E 1900 200 to N 6 Cor

" S 18 E 1916 " to S 6 Cor

" S 72 W 1900 " to S 71 Cor

" N 18 W 1916 " to the place of beginning

Rolling, but there is small valleys of smooth land soil valleys are good agricultural land remainder grazing land only

South half smooth valley. North half upland and rolling the good agricultural land to grazing land

Rolling, with small valleys of smooth land the grazing land only agricultural land not on the body

valley at about

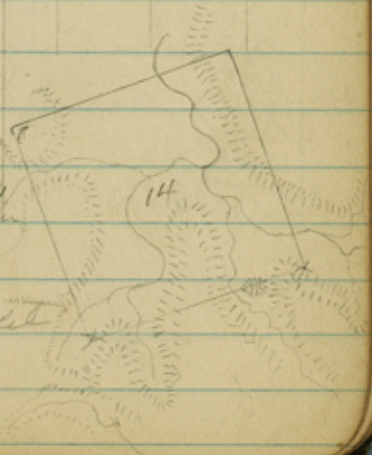

Soil	Grass	Timber	Water	Cor Marks
pale red loam	Good needle Grass	-	-	-
NW pale red loam + places gravelly	Fair set of needle Grass + Hay	Small Hops brush	-	-
SE pale red loam	Good needle Grass	-	-	Stone set in ground + 4 pits gent. 3 1/2' x 1 1/2' E " 5 60' 40' E
SW pale red loam with gravelly spots	Fair set of needle Grass	Small Hay brush	-	Stone set in ground + 4 pits

General description of surface

Generally smooth
but some breaks
near West side -
greater part of SW
2nd class crable
land

Topography &

field notes of Sec 16-6452, 2nd

beginning at N. Co. of N. 15 N. W. 1/4

These courses distance land marks

" N 72° E 1900 200 to N E cor

Very broken, grading " S 12° E 1916 " to S E "

land only " S 71° W 1900 " to S W "

" N 18° W 1916 " to the

place of

beginning

undulating but
smooth 3rd class
crable land

South to undulating
North to broken
South to 2nd class
crable land N 1/2
grading land

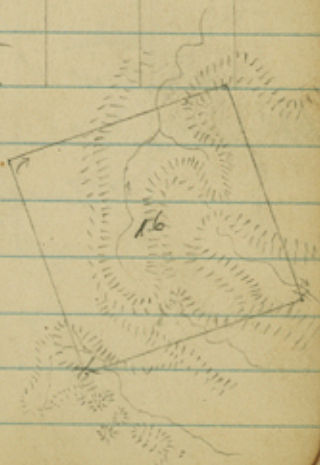

Dir	Soil	Grass	Timber	Water	Air marks
	gray loam and generally gravelly one good spot near center	Hay sedge	-	-	
NE	very gravelly	Hay sedge	-	-	
SE	Gravelly and rocky	Hay and sedge	-	-	Stone mixed NE? on east side of branch a fly 107° W 86 1/2 200 a small chitten 835° 20 W 91 200
DW	Rocky gravelly	Hay sedge			A Stone set in the ground + 4 pits

Nov 12th 1867

Soil description	Surface	Topography	Direction	Distance	Landmarks
Rolling and broken one spot of smooth out would do for farming		field water sheet No 649 20000			
balanced grazing land			N 72° E	1914 200	to NE cor
Rolling and broken			S 18° E	1916 200	to SE cor
2nd class grazing land			S 72° W	1914	to SW cor
			N 12° W	1916	to the place of beginning
Rolling and broken					beginning

Rolling + broken
grazing land
only

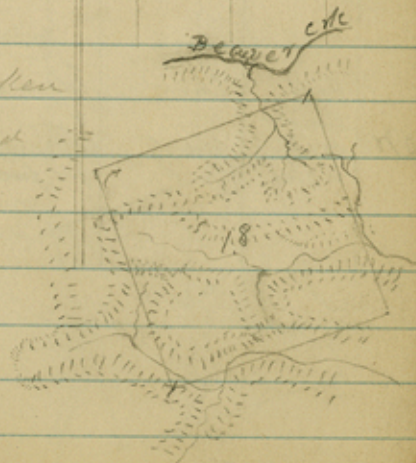

61484

Dir	Soil	Grass	Timber	Water	Co. Marks
	Gravelly except a small tract at SW cor in valley	Mesq, but not good	Some elm, on drain and some Mesq	-	-
NE	Rich red loam	Very little of any kind Tramped out	Good Mesquite	-	Stake ma + 4 pits
NW	Red loam with some gravel	Fair lot of Mesq	-	-	-
SE	Red loam soil rich	Thin mesq	Elm, Hwy + Cottonwood for fuel	Never boiling water in beaver creek	Stake ma + 4 pits

gent description Surface Topography &
 Generally broken field notes of Sect 20-645th 25000
 a small tract of good smooth land beginning at NE cor of NE 19 NW then
 near SW cor of gr.

Course	Distance	Landmarks
N 72° E	1900 m	to NE cor
S 18° E	1916 "	to SE cor
S 72° W	1900 "	to SW "
N 18° W	1916 "	to the place of beginning

Generally rolling
 small parcels lay
 well enough to be
 cultivated, and
 is 2nd class,
 remainder grassland

Valley land,
 smooth except
 breaks at drain
 the smooth land is good
 agricultural with

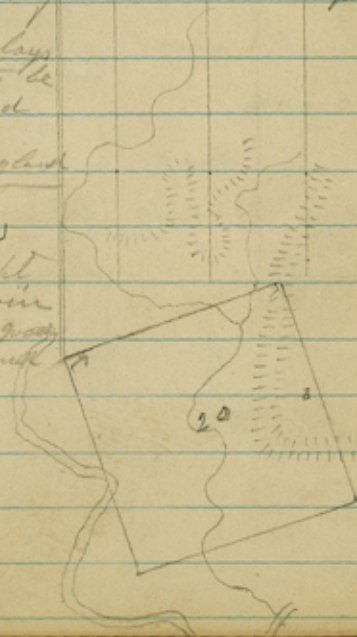

Dir	Soil	Grass	Timber	Water	Cor. Marks
	Red	mesquite	Cottonwood	for	Stone ma
NE	loam	but thin	Hackberry + Elm good timber are plentiful	Bever creek + 4 feet near east bank of creek	
	Red	Mesquite	Cottonwood	for	
NW	loam	but not good	Hackberry + Elm are plentiful	slower creek permanent	
	Very	Heavy	plenty of	near	
SE	gravelly	ledge	timber for fuel for many years	in Bever creek	
	very	Heavy & sdy	Some		
NW	gravelly		Mesquite		

There is a dwelling and
this sect

Finished Nov 2nd 1891

gent description Surface Topography &
Creek valley badly field notes of Sect 22-645^{1/2} acres
cut to pieces by creeks
and drains but
good land

the principal part of
the gr is valley and
lays well except that
it is cut up badly
by creek & small drains
although part runs
into hills

The greater part of
this quarter is
situated in Bever
creek valley and
is good land but
badly cut in pieces
by creek & drains

Rolling and broken
grazing land only

farm on



Loc of the farm near former old Carr
Chickfords NW 1/4 + 29 072 W
of peak call

Soil	Grass	Timber	Water	Cor	Markers
Soil throughout the section is rocky and gravelly. Neoprene, deep and wide but not good.		Some Elm and Hackberry on drains shown in topography.	There is some very pretty tubs of water at the present time, on a small creek on the edge of these deep, and which are probably permanent.		

Geol description Surface Topography &

field notes of Sect 24. 64th 6th 1880

beginning at NW cor of N 23 N E Thir

then Course distance landmarks

" S 18° E 1916 200 to S E Cor

" S 72° W 1900 " to S W "

" N 12° W 1916 " to N W "

" N 72° E 1900 " to the

place of beginning

The surface of the entire section is very broken hilly & rocky. The section as a whole should class 2nd rate grading land.

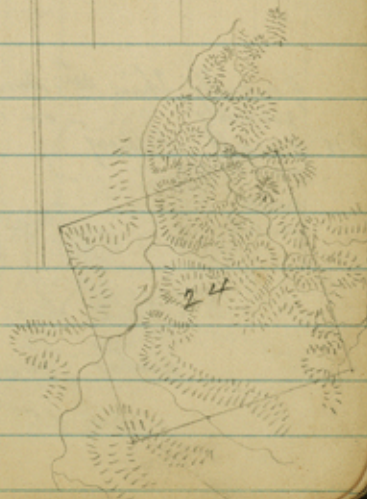

Sec	Soil	Grass	Timber	Water	Cor Marks
N 6	pale red loam with gravel on breaks	Thin set of heavy	Some brush	-	Stone set in the ground about 100 ms south from two small mounds under marks of cleared oak
N 7	pale red soil with gravel on breaks small valley & gravel	Thin set of heavy	Some Elm on stream	-	Stake and 4 pits are 4 pm hrs 0 33 1/2 x 0 1 20 large cottonwood hrs 0 75 W 1 29 20
S 6	very gravelly heavy	Thin	-	-	-
S 7	generally gravelly small valley good soil	Thin set of heavy	Some Elm on stream	-	-

There has been a ranch on water can be had in the
20 ft

Nov 2nd 1897

Genl description	Surface	Topography	Other
High land and considerable breaks about 1/2 2nd class agricultural land 1/2 2nd class grazing		field notes of sect 26-693 across beginning at N range 25 N E	Thin
		these Course	Distance Landmarks
		" S 15° E	1916 m to S E Cor
Small valley of smooth good land remainder broken		" S 72° W	2044. to S W "
		" N 18° W	1916. to NW "
		" N 72° E	2044. to the place of beginning
Very broken, getting land only			
Small valley of smooth land remainder broken.			



This sect valleys at

Dir	Soil	Grass	Timber	Water	Remarks
	Very	Thin set	A few Elm	-	Stone
NE	Gravelly	mesquite	Wych		Set in
	Grey	Thin set	Small	-	Stone
NW	loam	mesquite	mesquite		set +
			bush		4 feet
	Grey	Good	Thick		
SE	loam	mesquite	small		
			mesquite		
			bush		
	Red	scattered			A Stone
SW	loam	patches of			set in
	but	mesquite			the ground
	gravelly				

March 11th 1907

Geol description Surface Topography +
Badly broken field notes of Sect 28 - 645 1/3 acres
and washed, 2nd beginning at NW Cor of 27 NE This

Here	Course	Distance	Landmarks
	S 18° E	1916	to SE cor
	S 72° W	1900	to SW "
	N 18° W	1916	to NW cor
	N 72° E	1900	to the

NW part of grounds
on a hill S E 3/4
across valley
and good
agricultural land

Sur with mesquite
flat sloping gently
to the West

Broken + washed
2nd class grazing
land

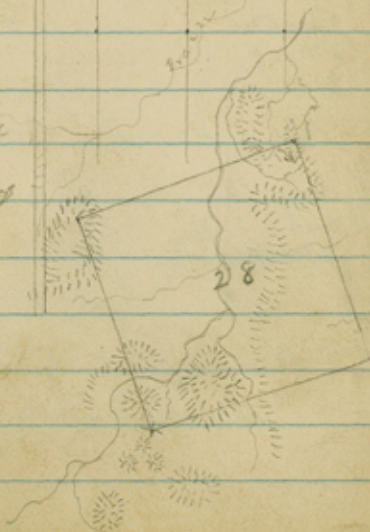

61489

Loc	Soil	Grass	Timber	Water or marks
	Rich	mesquite	afew elm and hly	great Stake md quantity in Beaver creek and good water
N E	red loam but not well set			+ 4 pits
	Rich	thin	scattering	plenty of good water Stake md + 4 pits
N W	red loam	mesq	hackberry	in Beaver creek
	Red	thin	-	plenty of water in Beaver creek
S E	loam, mesquite with gravel on or 1/2 of it			Stake md + 4 pits on line and S 33° W 85° 20' N large cottonwood S 20° 13' W 179° 20'
	Red	mesquite	-	=
S W	loam with gravel			Stake set in the ground in ravine

There is plenty of water in the
this survey, there is also a fountain

Genl description	Surface	Topography +
Smooth level valley	field water of lot 30-645 2/3 acre	
fine rich agricultural land	beginning at NW cor of 10 31 1/2 Sec	these course distance landmarks
		" S 15° E 1916 mo to S E cor
Smooth valley land except waste at creek		" S 72° W 1900 " to S W cor
good agricultural land		" N 15° W 1916 " to NW "
		" N 72° W 1900 " to the

Smooth valley,
good agricultural
land on N E 1/4 of 30
or 1/2 broken

Very broken and
gravelly grading
land on 1/4

creek entirely through
and home on this section



Loc	Soil	Gross	Timber	Water	Cor	Notes
	Red	Thin set	plenty	never		
NE	loam	mesquite	elm + hly + china	foiling water		
						shown in beaver sp.
	Red	Thin set of		never		
NW	loam	mesquite	elm and hly on creeks	foiling and good		
			plenty for fuel			
	grey	Thin set	some	never		
SE	loam	mesquite	elm hly + cottonwood	foiling on beaver creek		
	grey	fair	Scattering			
SW	loam	heavy	Elms			
						Stone set in ground about 100 or 150 of two or three mounds under banks of Beaver creek

General description surface
General surface
smooth but badly
cut in places by
creek

Topography &
Field notes of Sect 32-69274 2000
beginning at NE cor of 31 NW 1/4

Course	Distance	Landmarks
N 72° E	1900 m	to NE Cor
S 18° E	2060	to SE "
S 72° W	1900	to SW "
N 18° W	2060	to the

See with valley
good agricultural
land except
loss at creek &
drains

generally rolling
& broken
grating land
only

place of
beginning

Rolling and broken
suitable for
grating early



Soil	Grass	Timber	Water	Gr marks
Rich	Thin	Elm Hwy China + Cottonwood	plentiful in River creek	Stake ma + 4 pits
46 red loam	mesquite	plenty for fuel		

Rich	Thin	Elm Hwy China + Cottonwood	never failing in plenty for fuel	Rock set in ground an old Elm witness stand N 62° W 38 200
47 red loam	mesquite		Rever creek	

Rich	Thin	Elm Hwy Cottonwood	never failing in plenty for fuel	Rock set in ground an old Elm witness stand N 62° W 38 200
48 red loam	mesquite	China + abundant	Rever creek	

Spavelly rocky	Fair mesquite	Some Elm + Paddyberry	-	
57				

There is a residence and
of this section

Mar 2nd 1897

gent description surface topography &
Level valley but baby field notes of Sect 34-62°
cut in pieces by creeks
good agricultural beginning to the
begin only objection
being from and waste
foul meanders of creeks

Level valley land and waste from creeks and drains not serious good agricultural land	112° E	1914 m	to N E corner
	118° E	2045	to S E "
	122° W	1914 "	to S W "
	118° W	2045	to the place of beginning

principally on upland
south of Beaver creek
about 60 feet higher than
valley a small part near
south side legs well but
the greater part of the
next to the creek is broken

principally broken
but small parcels
of agricultural
land

from on the 47th

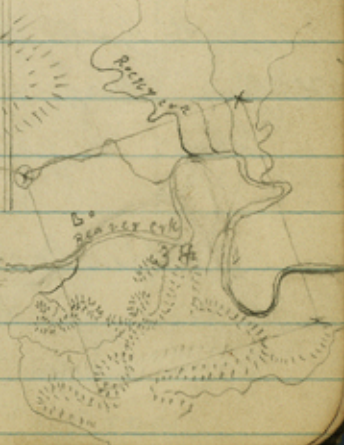

Dir	Soil	Grass	Timber	Water	Cor marks	Genl description surface topography &
NE	Grey loam	Good Mesq	plenty of Talm, Hvy and Chiny on creeks as shown in topography		Large Stone with a pile of stones around it	Rolling and broken field surface cut up & badly by creeks Some small water beginning at NE corner of 36 of good land
NW	Grey loam	Good Mesquite	plenty for fire Talm & Hackberry		Stake and + 4 pits	Rolling but reasonably smooth and soil good can be used for farming
SE	Grey loam with considerable gravel	Mesq	-	-	Stone mound on a rocky hill east of a drain	Rolling and broken grading land only
SW	Good Grey loam	Good Mesq	Hackberry Talm & Cottonwood on creeks plentiful		Stake and + 4 pits near east bank of Talmas cr.	General surface badly cut up by creeks and drains but all smooth land good

True Course	Distance	Landmarks
N 76° E	1904 m	To NE cor
S 19° E	1916 "	To SE "
S 72° W	1900 "	To SW "
N 18° W	2045 "	To the

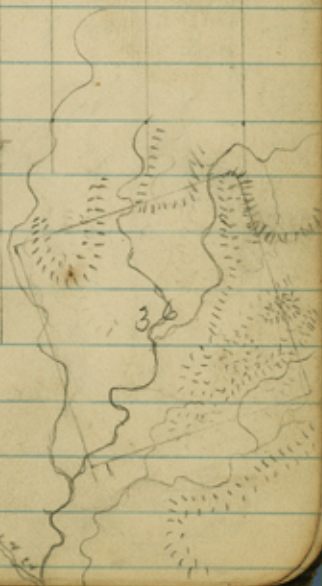

This Sect is fenced
fine for Western Texas,
in wells at a depth of

61493

March

The timber is
water could be had
20 feet
end 1893

Soil	Grass	Timber	Water	Cor marks	Genl description	Surface	Topography
Red loam but light mixed with gravel and in places there is rock	Very good grass	None except a few clumps near the S E cor of the sect		NE cor Stone set and 4 pits			Field notes of sect 38-595 ⁶ acres Beginning at NW cor of 1237 NE this place beginning
				SW cor Stone set in ground + 4 pits			

The section is the same throughout and is exactly described in a party

Very quite ground and ledge

None except a few clumps near the S E cor of the sect

SW cor
Stone set
in ground
+ 4 pits

The whole section is broken and very rough but is a good grazing section

Running from West 1/2 sec 38
South and crop growth
commenced April at 1877-80



SW	Soil	Gross	Timber	Water	Cor marks
		Thin set	-	-	

NW	gravelly	of sedge			
----	----------	----------	--	--	--

	Very	thin set	-	-	Stakes
		of sedge			
NW	gravelly				md &
					4 pits

SE	Red loam	Heavy but thin	elm, hly & cottonwood on creek	Old Cor found on elm N 8° E 35 m standing 218° 215°
----	----------	----------------------	--------------------------------------	--

	Red loam	Heavy	good timber elm hly & cottonwood	Old Cor found old hly standing 218° to 145° 200 etc
SW			plenty in creek, permanent good quality	hly standing 218° to 145° 200 etc correspond good quality

There is a farm and dugout
The dugout is the residence
The timber is fine on south

Genl description of place Topography &
Very rolling 2nd field notes of Sect 40-593 area
cross grazing beginning at NW Cor of R 39 N 5 E this

True Course	Distance	Landmarks
-------------	----------	-----------

"	S 18° E	1771 m To S E Cor
---	---------	-------------------

"	S 72° W	1900 " To S W "
---	---------	-----------------

"	N 18° W	1750 " To NW "
---	---------	----------------

"	N 72° E	1900 " To The
---	---------	---------------

place of

beginning

principally smooth
valley some waste
from creeks & ditches
good agricultural
land

Badly cut to pieces
with creek but
where valley ad
large enough fine
agricultural land

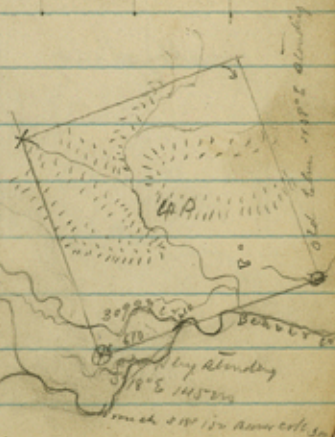

on this survey,
of this country,
port of survey

Dir	Soil	Grass	Timber	Water	Remarks
	Red	Heavy	-	-	
N E	loam				
	Gravelly Heavy	Heavy	Some Elm	-	Stake and + 4 pits
N W	except a small valley of red loam				
	Rich	Heavy	Some Elm	-	
S E	red loam				
	Gravelly Heavy				Stake and 4 pits
S W					

Mar 3rd 1887

General description Surface Topography &
A ridge of high broken hills, rest of line
remainder about 1/2
smooth valley and
fine land

very broken except
a small valley
of fine land

Smooth valley
good agricultural
land

Rolling, but a
considerable part
of 2nd class
arable land

Direction	Distance	Landmark
beginning at NW corner 41, SE this		
" S 18° E	1750	to SE cor
" S 68° W	2050	to SW "
" N 18° W	1900	to NW "
" N 72° W	2040	to the place beginning

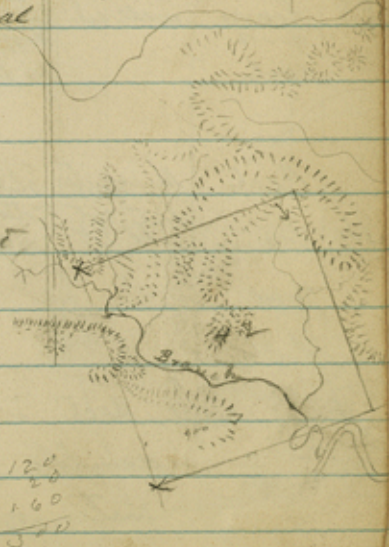

1200
160
500

Soil	Grass	Timber	Water	Co. marks
201 pale red loam with quartz spots of gravel near well set N of the line				
477 Red loam	mesquite sedge but not well set	Some Elm Hwy Cottonwood on creek		Stake
88 Red loam good soil	mesquite but not well set	Elm Hwy Cottonwood sufficient for fuel		
177 Red loam good soil	mesquite but not well set	Elm Hwy Cottonwood water in on creek Beaver creek		Stake.

The sect is fenced and considerable farm on it water could be had at although there is many drains

Soil description surface Topography &
Smooth with gentle undulations, good
2nd class arable land
Smooth level valley except waste land at and near creek good agricultural land

Course	Distance	Landmark
S 18° E	1900 m	To S E Cor
S 72° W	1900 "	To E W "
N 18° W	1900 "	To N W "
N 72° E	1900 "	To The place of beginning

Smooth valley

there is a also a dug well a depth of about 30 feet on this survey there is but little waste

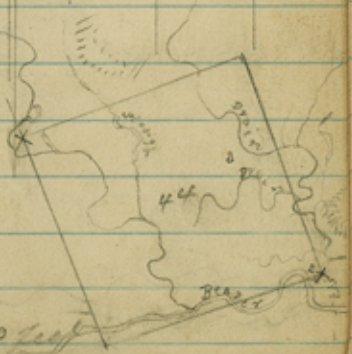

Dir	Soil	Grass	Timber	Water	Remarks
	Red	Mesquite	Small	-	Stake
N E	loam	scarcely good	mesq brush		md + 4 pits
	Red	Mesquite	Scrubby	-	Stake
N W	loam	thin	Mesquite		
	Red		Scattering	-	Stake md
S E	loam	thin	scrubby Mesquite		7 1/2 pits
	Red	Mesquite	Some	-	-
S W	loam	a fair set	Mesquite brush		

Gen description Surface Topography +
 Rolling and in field notes of Sect 46 = 640 acres
 places broken growing land with small
 parcels suitable for farming
 beginning at N E Cor of N 45 R 11 T 11 S
 " N 72 E 19000 to + 2 cor
 " S 18 W 1900. to S E
 " S 72 W 1900. to S W
 " N 18 W 1900. to the

place of
 beginning
 this quarter
 is good agricultural
 land and slopes with a
 gentle slope only to the
 west.

Rolling and broken
 suitable for grazing
 with 60 acres on
 west side agricultural
 land

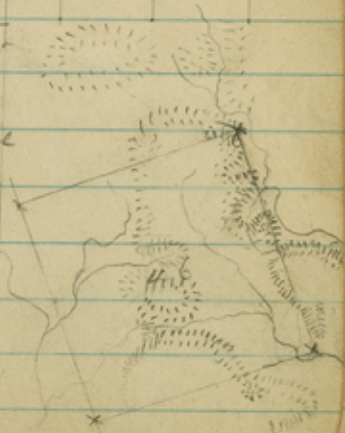

Sec	Soil	Grass	Timber	Water	Cor marks
	Red	weeds	-	-	Stake
NE	loam	grass			
		good			
	Red	Heavy and other varieties	Fine Elm Hackberry & Chink and plentiful on a valley 300 x 200 wild	-	Stake
NW	loam	rich rock good valley			

	Red	Mesquite a fair set	Elm and Hackberry on creek		Stake and 4 pits
SE	loam				

	Red	Fair set of Mesq	Good Elm and Hackberry on creek		
SW	loam				

Also for stone for building on this survey

The timber is very fine on this country and there is an abundance of water can be had in creek. There is a house on S W

Genl description Surface Topography & Elevation

Very broken and badly washed grading land

The valley is so cut to pieces by the creek and numerous small drains that it is worthless for agriculture but very valuable for timber and grazing

beginning at E Cor of NW 47 NW 14 the

Course	Distance	Landmarks
N 72° E	1900	to NE Cor
S 18° E	1900	to SE "
S 72° W	1900	to SW "
N 18° W	1900	to the place of beginning

Broken and rolling with small parcels of good land near creek

The western part broken remainder creek valley badly cut up by creek and drains valuable for timber and grazing

Set for this valley at 20 feet
gr 61499

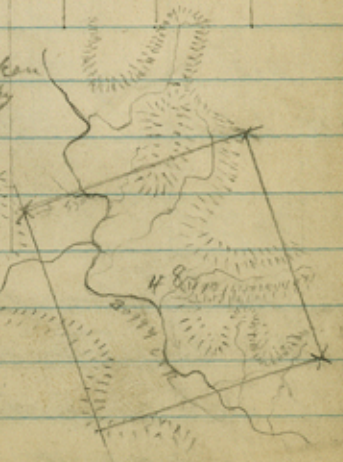

21	Soil	Grass	Timber	Water or mofs.	
	Red	needle	sun	-	Stake
NE	loam	grass	scattering		
		good	mesq		
	Red	needle	-	-	Stake
		good			
NE	loam	Curly			
		mesq			
	Red	Mesquite	elm and	stands	-
SE	loam		hackberry	through	
			on rocky	ordinary	
			creek	seasons	
				in Rocky	
				creek	
	Red	Mesquite	A few	-	-
SW	loam		Mesquite		
			timber		

The timber on Rocky creek in this country, there is a small NE or water can be had in 25 feet

March 1st 1887

gent description Surface Topography &
Broken by drains Field notes of spot 50. 6000 ft
suitable for grazing with small lots suitable for farming near drains
beginning at 126° 0' 0" N 22° W to the
true course distance to boundary
" N 72° E 1914 m to NE cor
" S 18° E 1900 " to SE
" S 72° W 1914 " to SW
" N 18° W 1900 " to the

Badly cut to pieces with creek and branches but where lots are large enough to be used the land is good

Rough and broken

Suitable for grazing but a small farm can be put in also on a plot of reasonably good land

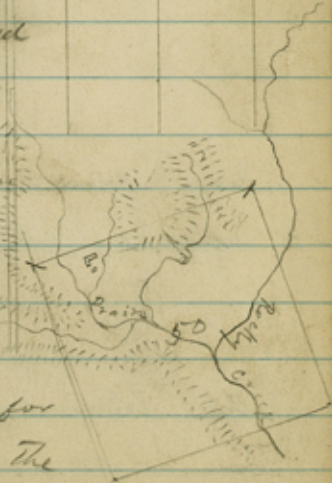

This survey is good for house and farm on the creek valley at a depth of

Dir	Soil	Grass	Timber	Water	Cornworks
	Red	mesquite	few scattering		Stone mch SE 53
NE	loam	good set	mesq brushes		point of Red 53 E peak 5 11° 50' E dip " 5 11° 50' E " 3 13% E
	Red		few		Stone mch
NW	loam but badly mixed with gravel and 1/2 pebb	mesq and sedge	mesquite brush		
SE	Red loam	mesq well set	small mesq		scipits a stone mch a peak S 10 3/4 E
	Red	good	some		
SW	loam	mesquite	small mesq		

There is about one acre
on NW cor of this survey

March 3rd 1897

Genl description Surface Topography &
Smooth and pretty field notes of sect 52 - 640 ac
good agricultural beginning at NE cor of SW 1/4 NW 1/4
loam

These courses distance Landmarks

" N 72 E 1900 to NE cor

N 72 E very broken " S 18 E 1900 to SE

remainder only " S 72 W 1900 to SW
rolling and is
2nd class arable
land

place of
beginning

Undulating and
in places slight
breaks the greater
part of the 6 is 2nd
class arable land

Undulating, good

2nd class agricultural
land

of broke land

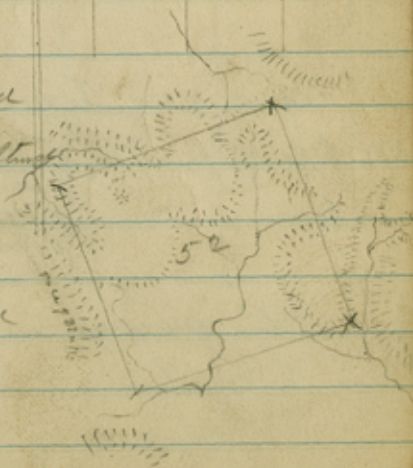

61501

SE	Soil	Grass	Timber	Water	Cor marks
	Red	Mesq +	Elm +	Stems	Stake
N E	Loam	Grass	Hackberry	in creek mound +	unless pits
		good	on creek	very dry	
	Red	Mesq	Elm	Stems	Stone
NW	Loam	will cut	Hackberry + Cottonwood	in creek	Set in the ground at left very dry seasons

SE	Red loam with oak and good	Mesq and sage	-	-	Stone mca
----	----------------------------------	------------------	---	---	-----------

	Red	Mesquite	good	in	Stake
NW	heavy loam	fairly set	creek timber Cottonwood Hackberry + Elm	rocky creek in ordinary seasons	

This survey is partly fenced
and has a house and small

Soil description surface Topography +
Rolling and broken Field notes of Sect 54. 640 ac
by creeks, good in beginning at NW cor of 54th N 1/2
land

	SE	1900	to SE cor
	S 72° W	1900	to SE "
	N 18° W	1900	to NW "
	N 72° W	1900	to the

Rolling and badly
cut by meanders of
creek small
parcels only of
agricultural land
very broken,
worthless except for
the little grass that
grows on it

The greater part of
the gr is smooth except
channel of the creek
but runs into breaks
on the east side
good land where it
flows well

form on it



Dir	Soil	Grass	Timber	Water	Cor marks
	Red	Hesquite	-	-	Stake and + 4 pits
N E	loam	good			
	Red	Hesquite	Scattering	-	Stake and + 4 pits
N W	loam	well set	Hesq		
	Red	Hesquite	-	-	Stake
S E	loam	but thin			
	Red	Hesq	Some	-	Stake
S W	loam	well set	Hesq on or 75 feet		

There is a small zone
S W 1/4, water could
at 40 feet

Level description	Surface	Elevation	Topography
Rolling and in places slight breaks principally grazing land only	Beginning at NW cor of Sec 56 to the		
	Course	distance	Landmarks
	S 18° E	1900	to S E cor
Undulating but	S 72° W	1900	to S W "
Smooth, a	N 18° W	1900	to N W "
fair grade of agricultural land	N 72° E	1900	to the
			place of
			Beginning
principally broken and suitable for grazing only with small lots of 2nd class agricultural land			

Undulating
good 2nd class
agricultural
land except
about 30 acres
on west side

broken on the
probably be had

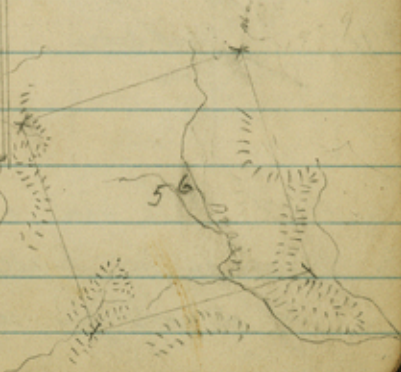

20	Soil	Grass	Timber	Water	Cor marks
	Red	None	Scrubby	Some	Stake mid
NE	loam		None	Elm on drain near N to cor	4 ft near bank of drain
	Red loam with gravel	Sedge	Scrubby Mesquite		
SE	Very gravelly	Mesquite and sedge	Some Mesquite brush		Stake mid + 4 ft
SW	Gravelly loam and sedge				Stake mid and 4 ft

There is a dugout on
used as a dwelling, also a well
at NE cor depth from surface

Genl description	Surface	Topography	
			There is considerable field water of Sect 58-687 acre
	Smooth good land	Beginning at NNE cor of 1057 N to the	
	on this gr probably	1/2 or 3/4 balance	
	rough		
		Stake Course	Distance Landmarks
		S 18° E	1900 rods to SE cor
		S 72° W	2044 to SW "
	Rough and broken	N 48° W	1900 to NW "
		N 72° E	2044 to the
			place of beginning
	Rough + broken		

Rough + broken

Rough + broken

N to gr of this sect
in bank of drain
about 5 feet

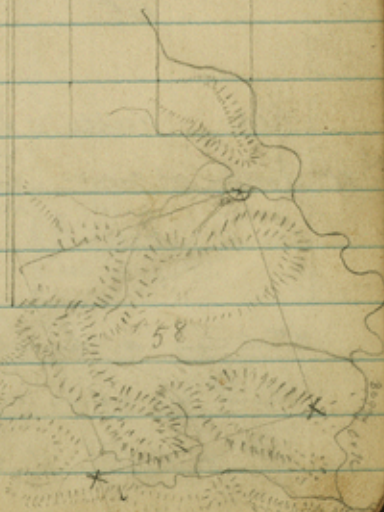

Dir	Soil	Grass	Timber	Water	Co marked
	Red	Gonna and Mesquite well set	A few Mesq bushes	-	A stone set in ground with NW 50 stone set on a creek 60 039 1/2 W
NE	loam	Gonna and Mesq well set	A few Mesq bushes	-	A stone with NW 60 A stone set on peak S 8° 50' E
	Red	Gonna and Mesq a good set	-	-	
SE	loam	Needle grass and Mesquite well set	Some Cottonwood and albu on creek	-	Stake mid + 4 pits - old witness Cottonwood 071° E found

There is a house on NE gr of this
about 40 acres on SW gr water can
at a depth of 30 feet

Geol description	Surface	Topography
Rolling and in places broken suitable for grazing only		Field notes of Sect 60-640222 beginning at NW Cor of 1577 x E then thru Course Distance landmarks Th S 15° E 1900 on to S E Cor S 22° W 1900 " to S W " rolling 2nd class " N 18° E 1900 " to N W " agricultural land " N 72° E 1900 " to the

Very broken except
about 40 acres in SW
for which is a fair
grade of agricultural
land

Smooth and only
gently undulating
good agricultural
land

Set and a farm of
be had in wells



148

149

61506

150

151

61507

Beg at S 84° 30' E 2
 Thence N 72° E 7 miles
 Thence S 18° E 3 miles

Beg at peaks supposed N 81° 15' W
 Thence S 72° E 1 mile
 Thence N 18° W 4 miles strike
 206 vs N 72° E + 43 m S 18° E

Continuing this work S 72° W
 2 miles + N 18° W 1 mile strike
 170 m S 18° E + 100 vs S 72° W from
 old cut at N 63° 33'

Beg at N 63° 33' as found
 Thence S 72° W 1 mile find old
 cut + Beaver creek corresponding
 with old cuts

Thence N 18° W 2 miles
 Thence S 72° W 2 miles
 Thence S 18° E 2 miles 1058 vs
 Beaver creek but creek should
 be 993 m

3718
Peak 207 2
" 48 2
" 46 2