

REV	DATE	DESCRIPTION	APP
0	8/05/99	ORIGINAL ISSUE	
1	1/05/01	ADJUSTED COORDINATE SYSTEM	

NOTES:

- COORDINATES SHOWN ARE BASED ON LAMBERT GRID, TEXAS SOUTH CENTRAL ZONE, NAD '83 (1993).
- MONUMENTS USED FOR HORIZONTAL CONTROL WERE:
 A RA7-1 N 13,762,514.30 E 3,395,323.60
 B RA-8 N 13,766,079.23 E 3,403,488.32
- ELEVATIONS AND CONTOURS SHOWN ARE BASED ON NAVD '88.
- MONUMENTS USED FOR VERTICAL CONTROL WERE:
 C LUB 0971 D 1994 ELEV. 6.73' NAVD '88
 D NOS #5 1993 ELEV. 4.94' NAVD '88
 E 0971 E 1994 ELEV. 2.05' NAVD '88
 F Z171 1936 (RESET 1954) ELEV. 6.50' NAVD '88
- MEAN HIGHER HIGH WATER (MHHW) = 1.40' NAVD '88 BASED ON GALVESTON PLEASURE PIER TIDAL INFORMATION PROVIDED BY NOAA.

DATUM ELEVATIONS
 (NOAA TIDAL DATUM ELEVATIONS PROVIDED FOR GALVESTON PLEASURE PIER, U.N.O.)

MEAN HIGHER HIGH WATER (MHHW) = 2.09 FEET
 MEAN HIGH WATER (MHW) = 1.92 FEET
 MEAN TIDE LEVEL (MTL) = 1.17 FEET
 MEAN SEA LEVEL (MSL) = 1.16 FEET
 * NAVD '88 = 0.89 FEET
 MEAN LOW WATER (MLW) = 0.43 FEET
 MEAN LOWER LOW WATER (MLLW) = 0.00 FEET

* NOT NOAA TIDAL DATUM

- LEGEND:**
- HOUSE FOOTPRINT
 - EXIST. HOUSE/FOUNDATION TO BE REMOVED
 - CONCRETE SLABS
 - DUNE WALKOVERS/STAIRS
 - FENCE
 - SHEET PILING
 - PALM TREE
 - HAY BALE DUNE
 - SEPTIC TANKS/MANHOLES
 - TIMBER POST
 - POWER POLE
 - WATER TANKS
 - GUY WIRE
 - NATURAL GROUND ELEVATIONS
 - SURVEY CONTROL POINT
 - MHHW COORDINATES (SEE SCHEDULE)

MHHW POINT	X-COORDINATE	Y-COORDINATE
1-1	3,389,092.06	13,754,212.37
1-2	3,389,536.01	13,754,463.13
1-3	3,389,759.32	13,754,589.58
1-4	3,390,142.36	13,754,785.09
1-5	3,390,417.62	13,754,917.85
1-6	3,390,687.61	13,755,063.84
1-7	3,391,039.02	13,755,245.01
1-8	3,391,128.86	13,755,282.63
1-9	3,391,361.89	13,755,419.28
1-10	3,391,671.77	13,755,582.00
1-11	3,391,768.92	13,755,618.45
1-12	3,391,939.32	13,755,692.95
1-13	3,392,117.58	13,755,777.70
1-14	3,392,291.59	13,755,875.99
1-15	3,392,561.41	13,756,005.13
1-16	3,392,817.89	13,756,142.87
1-17	3,393,002.34	13,756,230.50
1-18	3,393,181.42	13,756,313.21
1-19	3,393,287.16	13,756,378.25
1-20	3,393,587.42	13,756,514.01
1-21	3,393,843.70	13,756,647.44

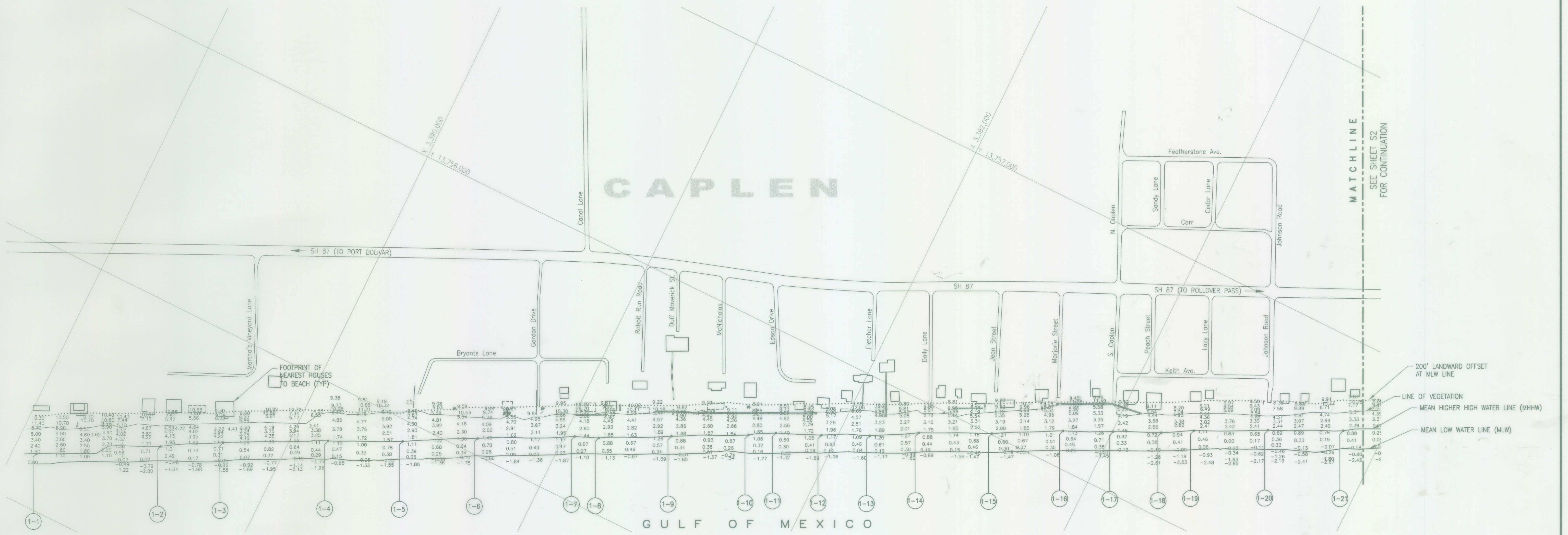

Station	Elevation	Station	Elevation	Station	Elevation	Station	Elevation
1-1	11.40	1-12	0.88	1-23	-0.80	1-34	-2.42
1-2	10.70	1-13	0.87	1-24	-0.76	1-35	-2.42
1-3	10.30	1-14	0.86	1-25	-0.76	1-36	-2.42
1-4	9.80	1-15	0.85	1-26	-0.76	1-37	-2.42
1-5	9.30	1-16	0.84	1-27	-0.76	1-38	-2.42
1-6	8.80	1-17	0.83	1-28	-0.76	1-39	-2.42
1-7	8.30	1-18	0.82	1-29	-0.76	1-40	-2.42
1-8	7.80	1-19	0.81	1-30	-0.76	1-41	-2.42
1-9	7.30	1-20	0.80	1-31	-0.76	1-42	-2.42
1-10	6.80	1-21	0.79	1-32	-0.76	1-43	-2.42
1-11	6.30	1-22	0.78	1-33	-0.76	1-44	-2.42

TEXAS GENERAL LAND OFFICE
 Art. 33.136, Natural Resources Code
 County GALVESTON, Sk. No. 2-A
 File Date 4-11-92 by D.J.H.

WE, SHINER, MOSELEY AND ASSOCIATES, INC. WITH THE ASSISTANCE OF WM. W. GREEN, A LICENSED STATE LAND SURVEYOR IN THE STATE OF TEXAS, HEREBY STATE THAT THIS DRAWING REPRESENTS THE CONDITIONS THAT EXISTED AT THE TIME OF THE BEACH SURVEY CONDUCTED ON MAY 18 THROUGH JULY 16, 1999.

NOTICE: THIS SURVEY WAS PERFORMED IN ACCORDANCE WITH SECTION 33.136, NATURAL RESOURCES CODE, FOR THE PURPOSE OF EVIDENCING THE LOCATION OF THE SHORELINE IN THE AREA DEPICTED IN THIS SURVEY AS THAT SHORELINE EXISTED BEFORE COMMENCEMENT OF EROSION RESPONSE ACTIVITY ON THE PUBLIC BEACH, AS REQUIRED BY CHAPTER 33, NATURAL RESOURCES CODE. THE LINE DEPICTED ON THIS SURVEY FIXES THE SHORELINE FOR THE PURPOSE OF LOCATING A SHORELINE BOUNDARY, SUBJECT TO EROSION LANDWARD AS PROVIDED BY SECTION 33.136, NATURAL RESOURCES CODE.

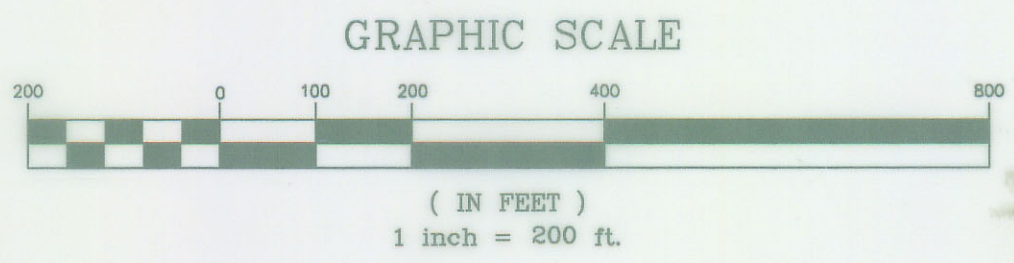
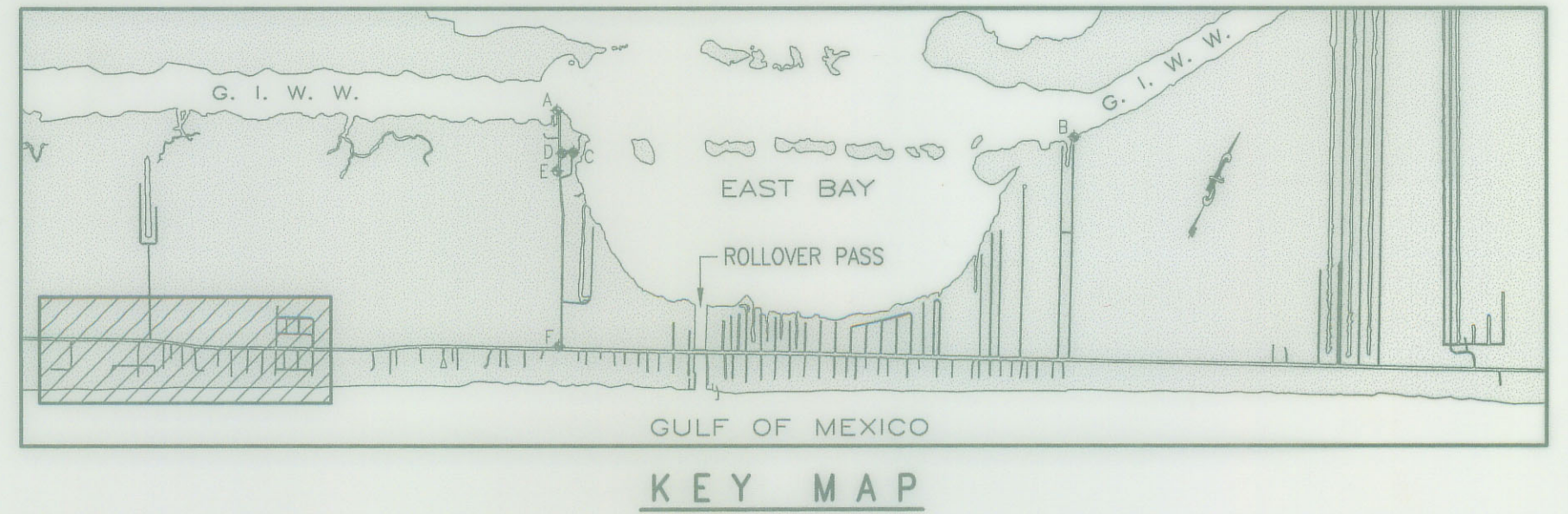

GEORGE RUBALCABA
 REGISTERED PROFESSIONAL LAND SURVEYOR



WM. W. GREEN P.E., R.P.L.S.
 LICENSED STATE LAND SURVEYOR



SHINER MOSELEY AND ASSOCIATES, INC. ENGINEERS & CONSULTANTS 2620 South Padre Island Drive, Suite 210 Corpus Christi, Texas 78416-1818		COUNTY OF GALVESTON	
SMA JOB NO.: 90157		SURVEY OF CAPLEN, ROLLOVER PASS, & GILCHRIST AREA BEACHES	
DRN DEG DATE 07/99		BOLIVAR PENINSULA TEXAS	
DES DATE		SITE PLAN	
CHK DATE 7-21-01		SCALE 1" = 200'	
APP DATE		SHEET NO. S1	
		REV 1	

REV	DATE	DESCRIPTION	APP
0	8/05/99	ORIGINAL ISSUE	
1	1/05/01	ADJUSTED COORDINATE SYSTEM	

NOTES:

- COORDINATES ARE BASED ON LAMBERT GRID, TEXAS SOUTH CENTRAL ZONE, NAD '83 (1993).
- MONUMENTS USED FOR HORIZONTAL CONTROL WERE:
 RA-1 RA-8
 N 13,762,514.30 N 13,766,079.23
 E 3,395,323.60 E 3,403,488.32
- ELEVATIONS AND CONTOURS SHOWN ARE BASED ON NAVD '88.
- MONUMENTS USED FOR VERTICAL CONTROL WERE:
 LUB 0971 D 1994 NOS #5 1993
 ELEV. 6.73' NAVD '88 ELEV. 4.94' NAVD '88
 0971 E 1994 Z171 1936 (RESET 1954)
 ELEV. 2.05' NAVD '88 ELEV. 6.50' NAVD '88
- MEAN HIGHER HIGH WATER (MHHW) = 1.40' NAVD '88 BASED ON GALVESTON PLEASURE PIER TIDAL INFORMATION PROVIDED BY NOAA.

DATUM ELEVATIONS
 (NOAA TIDAL DATUM ELEVATIONS PROVIDED FOR GALVESTON PLEASURE PIER, U.N.O.)
 MEAN HIGHER HIGH WATER (MHHW) = 2.09 FEET
 MEAN HIGH WATER (MHW) = 1.92 FEET
 MEAN TIDE LEVEL (MTL) = 1.17 FEET
 MEAN SEA LEVEL (MSL) = 1.16 FEET
 * NAVD '88 = 0.69 FEET
 MEAN LOW WATER (MLW) = 0.43 FEET
 MEAN LOWER LOW WATER (MLLW) = 0.00 FEET
 * NOT NOAA TIDAL DATUM

LEGEND:

- HOUSE FOOTPRINT
- EXIST. HOUSE/FOUNDATION TO BE REMOVED
- CONCRETE SLABS
- DUNE WALKOVERS/STAIRS
- FENCE
- SHEET PILING
- PALM TREE
- HAY BALE DUNE
- SEPTIC TANKS/MANHOLES
- TIMBER POST
- POWER POLE
- WATER TANKS
- GUY WIRE
- NATURAL GROUND ELEVATIONS
- SURVEY CONTROL POINT
- MHHW COORDINATES (SEE SCHEDULE)

MHHW POINT	X-COORDINATE	Y-COORDINATE
2-1	3,393,961.38	13,756,713.14
2-2	3,394,809.86	13,751,047.54
2-3	3,394,882.01	13,757,179.22
2-4	3,395,157.34	13,757,323.90
2-5	3,395,430.05	13,757,451.19
2-6	3,395,862.32	13,757,865.43
2-7	3,396,032.56	13,757,778.21
2-8	3,396,757.95	13,758,144.07
2-9	3,396,924.01	13,758,240.13
2-10	3,397,287.46	13,758,418.48
2-11	3,397,853.37	13,758,558.81
2-12	3,398,375.91	13,758,909.38
2-13	3,398,751.99	13,759,064.78
2-14	3,398,848.08	13,759,096.70
2-15	3,399,029.71	13,759,187.80
2-16	3,399,305.64	13,759,265.74
2-17	3,399,397.19	13,759,295.80

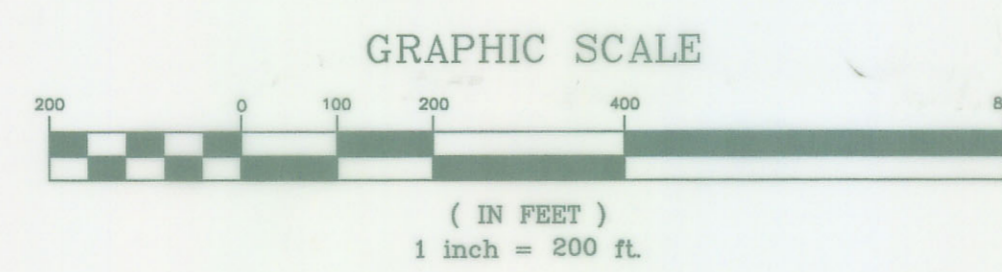
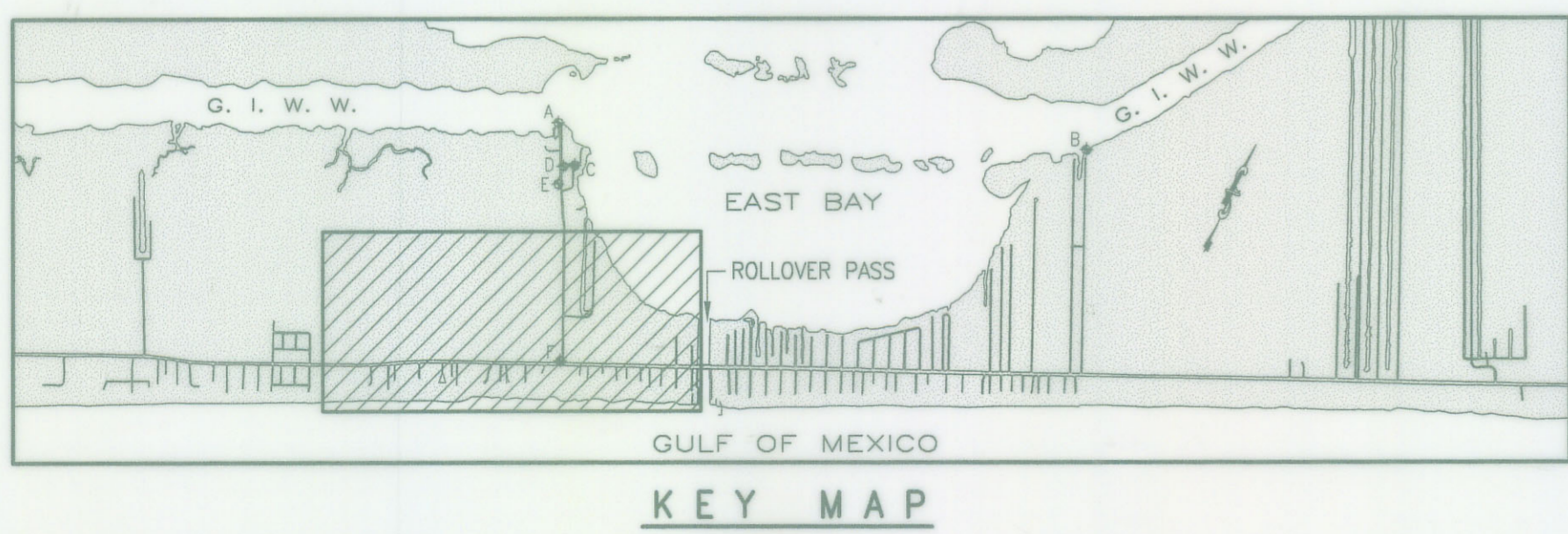

TEXAS GENERAL LAND OFFICE
 Art. 33.136, Natural Resources Code
 County GALVESTON, Sk. No. 1-B
 File Date 4-11-2002 by D.J.H.

WE, SHINER, MOSELEY AND ASSOCIATES, INC., WITH THE ASSISTANCE OF WM. W. GREEN, A LICENSED STATE LAND SURVEYOR IN THE STATE OF TEXAS, HEREBY STATE THAT THIS DRAWING REPRESENTS THE CONDITIONS THAT EXISTED AT THE TIME OF THE BEACH SURVEY CONDUCTED ON MAY 18 THROUGH JULY 16, 1999.

NOTICE: THIS SURVEY WAS PERFORMED IN ACCORDANCE WITH SECTION 33.136, NATURAL RESOURCES CODE, FOR THE PURPOSE OF EVIDENCING THE LOCATION OF THE SHORELINE IN THE AREA DEPICTED IN THIS SURVEY AS THAT SHORELINE EXISTED BEFORE COMMENCEMENT OF EROSION RESPONSE ACTIVITY ON THE PUBLIC BEACH, AS REQUIRED BY CHAPTER 33, NATURAL RESOURCES CODE. THE LINE DEPICTED ON THIS SURVEY FIXES THE SHORELINE FOR THE PURPOSE OF LOCATING A SHORELINE BOUNDARY, SUBJECT TO EROSION LANDWARD AS PROVIDED BY SECTION 33.136, NATURAL RESOURCES CODE.

George Rubalcaba
 GEORGE RUBALCABA
 REGISTERED PROFESSIONAL LAND SURVEYOR

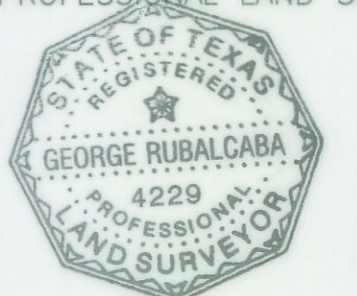

Wm. W. Green
 WM. W. GREEN P.E., R.P.L.S.
 LICENSED STATE LAND SURVEYOR



SHINER MOSELEY AND ASSOCIATES, INC. ENGINEERS & CONSULTANTS 2820 South Pacific Island Drive, Suite 210 Corpus Christi, Texas 78416-1818		COUNTY OF GALVESTON SURVEY OF CAPLEN, ROLLOVER PASS, & GILCHRIST AREA BEACHES BOLIVAR PENINSULA TEXAS	
SMA JOB NO.: 90157	DRN DEG DATE 07/99	SITE PLAN	
CHK DATE 1-22-01	APP DATE 1-22-01	SCALE 1" = 200'	SHEET NO. S2
DWG NO 90157S02	REV 1		

J:\SMA\proj\90157\Draw\90157S02.dwg 01/05/01 08:00:41 AM CST

REV	DATE	DESCRIPTION	APP
0	8/05/99	ORIGINAL ISSUE	
1	1/05/01	ADJUSTED COORDINATE SYSTEM	

NOTES:

- COORDINATES SHOWN ARE BASED ON LAMBERT GRID, TEXAS SOUTH CENTRAL ZONE, NAD '83 (1993).
- MONUMENTS USED FOR HORIZONTAL CONTROL WERE:
 - A \odot RA7-1 N 13,762,514.30 E 3,395,323.60
 - B \odot RA-8 N 13,766,079.23 E 3,403,488.32
- ELEVATIONS AND CONTOURS SHOWN ARE BASED ON NAVD '88.
- MONUMENTS USED FOR VERTICAL CONTROL WERE:
 - C \odot LUB 0971 D 1994 ELEV. 6.73' NAVD '88
 - D \odot NOS #5 1993 ELEV. 4.94' NAVD '88
 - E \odot 0971 E 1994 ELEV. 2.05' NAVD '88
 - F \odot Z171 1936 (RESET 1954) ELEV. 6.50' NAVD '88
- MEAN HIGHER HIGH WATER (MHHW) = 1.40' NAVD '88 BASED ON GALVESTON PLEASURE PIER TIDAL INFORMATION PROVIDED BY NOAA.

DATUM ELEVATIONS
(NOAA TIDAL DATUM ELEVATIONS PROVIDED FOR GALVESTON PLEASURE PIER, U.S.O.)

MEAN HIGHER HIGH WATER (MHHW) = 2.09 FEET
 MEAN HIGH WATER (MHW) = 1.92 FEET
 MEAN TIDE LEVEL (MTL) = 1.17 FEET
 MEAN SEA LEVEL (MSL) = 1.16 FEET
 * NAVD '88 = 0.69 FEET
 MEAN LOW WATER (MLW) = 0.43 FEET
 MEAN LOWER LOW WATER (MLLW) = 0.00 FEET

* NOT NOAA TIDAL DATUM

- LEGEND:**
- HOUSE FOOTPRINT
 - EXIST. HOUSE/FOUNDATION TO BE REMOVED
 - CONCRETE SLABS
 - DUNE WALKOVERS/STAIRS
 - FENCE
 - SHEET PILING
 - PALM TREE
 - HAY BALE DUNE
 - SEPTIC TANKS/MANHOLES
 - TIMBER POST
 - POWER POLE
 - WATER TANKS
 - GUY WIRE
 - NATURAL GROUND ELEVATIONS
 - SURVEY CONTROL POINT
 - MHHW COORDINATES (SEE SCHEDULE)

MHHW POINT	X-COORDINATE	Y-COORDINATE
3-1	3,399,802.27	13,759,417.88
3-2	3,399,965.50	13,759,541.17
3-3	3,400,062.41	13,759,576.79
3-4	3,400,241.92	13,759,676.51
3-5	3,400,435.20	13,759,776.47
3-6	3,400,676.05	13,759,926.60
3-7	3,400,845.19	13,760,015.45
3-8	3,400,934.01	13,760,038.90
3-9	3,401,282.47	13,760,239.45
3-10	3,401,384.75	13,760,272.58
3-11	3,401,544.35	13,760,380.08
3-12	3,401,725.12	13,760,440.14
3-13	3,401,913.50	13,760,553.70
3-14	3,402,197.25	13,760,664.86
3-15	3,402,283.03	13,760,711.43
3-16	3,402,555.04	13,760,836.51
3-17	3,402,817.84	13,760,990.63
3-18	3,402,921.19	13,761,010.97
3-19	3,403,108.79	13,761,095.32
3-20	3,403,272.99	13,761,199.12
3-21	3,403,459.54	13,761,260.30
3-22	3,403,708.74	13,761,423.38
3-23	3,403,801.86	13,761,447.00
3-24	3,404,059.81	13,761,609.21
3-25	3,404,149.52	13,761,623.79
3-26	3,404,349.72	13,761,717.04
3-27	3,404,516.67	13,761,826.29
3-28	3,404,610.08	13,761,849.95
3-29	3,405,049.93	13,762,083.59
3-30	3,405,234.87	13,762,163.68
3-31	3,405,308.86	13,762,216.45

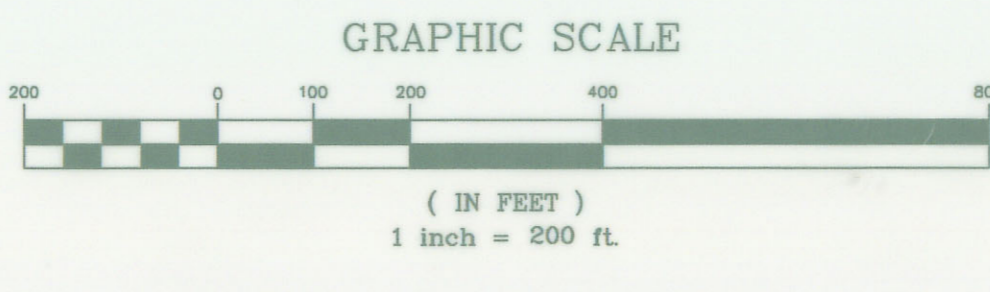
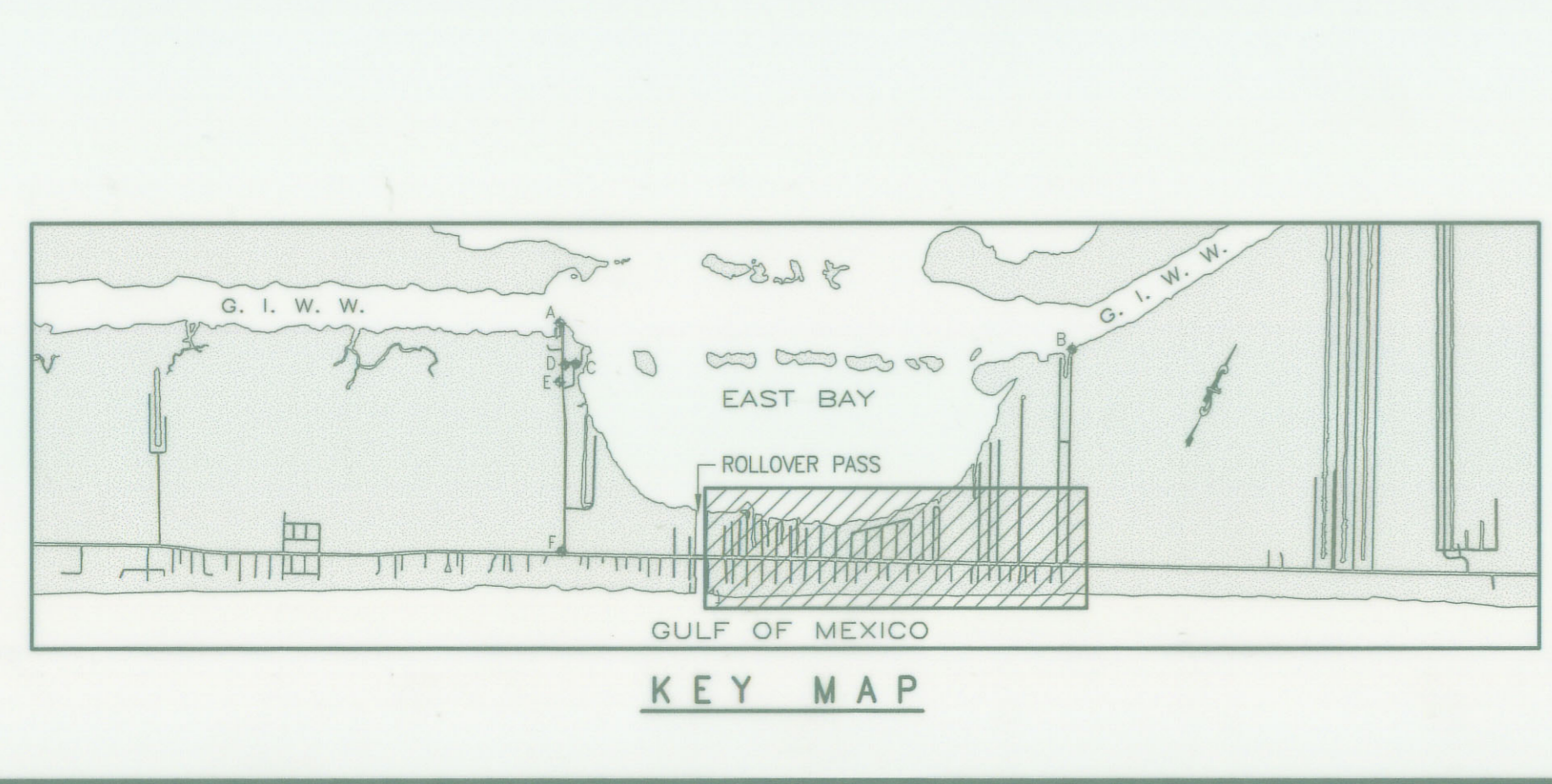
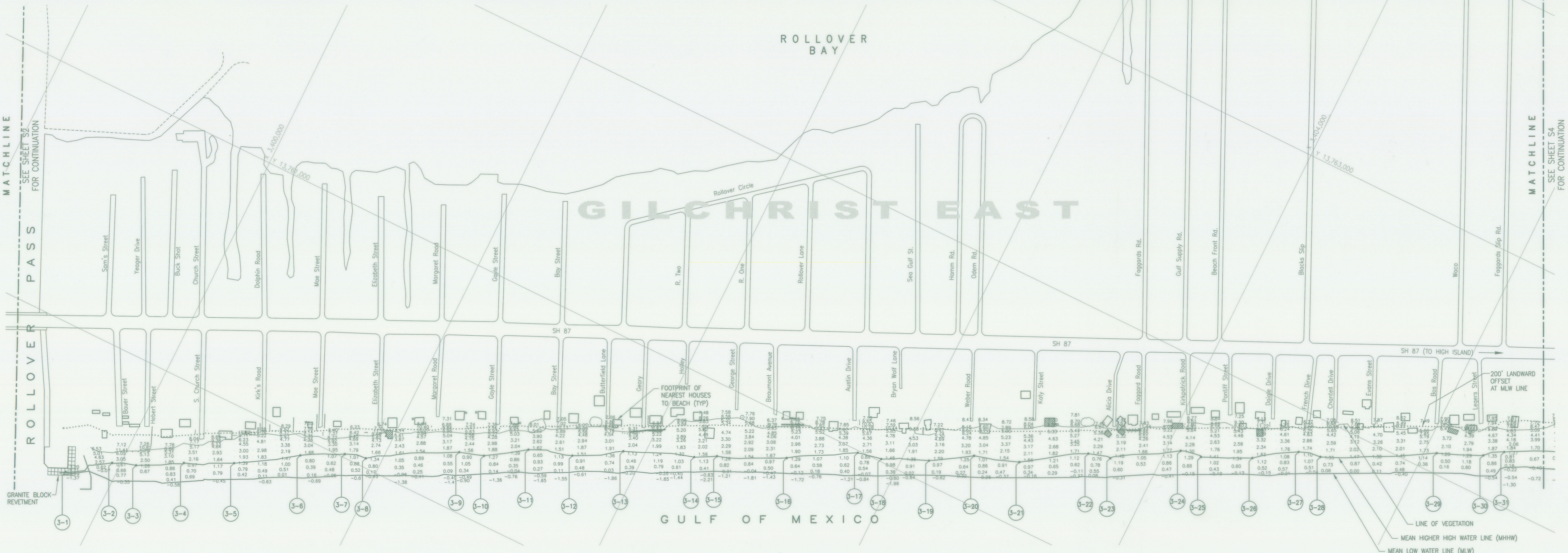

TEXAS GENERAL LAND OFFICE
 Art. 33.136, Natural Resources Code
 County GALVESTON, Sk. No. 1-6
 File Date 4-11-2002 by D.J.H.

WE, SHINER, MOSELEY AND ASSOCIATES, INC., WITH THE ASSISTANCE OF WM. W. GREEN, A LICENSED STATE LAND SURVEYOR IN THE STATE OF TEXAS, HEREBY STATE THAT THIS DRAWING REPRESENTS THE CONDITIONS THAT EXISTED AT THE TIME OF THE BEACH SURVEY CONDUCTED ON MAY 18 THROUGH JULY 16, 1999.

NOTICE: THIS SURVEY WAS PERFORMED IN ACCORDANCE WITH SECTION 33.136, NATURAL RESOURCES CODE, FOR THE PURPOSE OF EVIDENCING THE LOCATION OF THE SHORELINE IN THE AREA DEPICTED IN THIS SURVEY AS THAT SHORELINE EXISTED BEFORE COMMENCEMENT OF EROSION RESPONSE ACTIVITY ON THE PUBLIC BEACH, AS REQUIRED BY CHAPTER 33, NATURAL RESOURCES CODE. THE LINE DEPICTED ON THIS SURVEY FIXES THE SHORELINE FOR THE PURPOSE OF LOCATING A SHORELINE BOUNDARY, SUBJECT TO EROSION LANDWARD AS PROVIDED BY SECTION 33.136, NATURAL RESOURCES CODE.

George Rubalcaba
 GEORGE RUBALCABA
 REGISTERED PROFESSIONAL LAND SURVEYOR

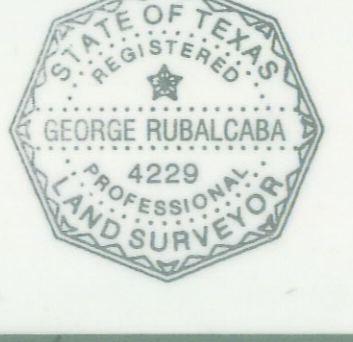

Wm. W. Green
 WM. W. GREEN P.E., R.P.L.S.
 LICENSED STATE LAND SURVEYOR



 SHINER MOSELEY AND ASSOCIATES, INC. ENGINEERS & CONSULTANTS 2820 South Padre Island Drive, Suite 210 Corpus Christi, Texas 78416-1818		COUNTY OF GALVESTON SURVEY OF CAPLEN, ROLLOVER PASS, & GILCHRIST AREA BEACHES BOLIVAR PENINSULA TEXAS	
SMA JOB NO.: 90157		SHEET NO. S3	
DRN	DEG	DATE	REV
		07/99	1
DES		DATE	
CHK		DATE	
APP		DATE	
	SCALE	DWG NO.	
	1" = 200'	90157S03	

REV	DATE	DESCRIPTION	APP
0	8/05/99	ORIGINAL ISSUE	
1	1/05/01	ADJUSTED COORDINATE SYSTEM	

NOTES:

- COORDINATES SHOWN ARE BASED ON LAMBERT GRID, TEXAS SOUTH CENTRAL ZONE, NAD '83 (1993).
- MONUMENTS USED FOR HORIZONTAL CONTROL WERE:

A	RA-1	B	RA-8
N 13,762,514.30		N 13,765,079.23	
E 3,395,323.60		E 3,403,486.32	
- ELEVATIONS AND CONTOURS SHOWN ARE BASED ON NAVD '88.
- MONUMENTS USED FOR VERTICAL CONTROL WERE:

C	LUB 0971 D 1994	D	NOS #5 1993
ELEV. 6.73' NAVD '88		ELEV. 4.94' NAVD '88	
E	0971 E 1994	F	Z171 1936 (RESET 1954)
ELEV. 2.05' NAVD '88		ELEV. 6.50' NAVD '88	
- MEAN HIGHER HIGH WATER (MHHW) = 1.40' NAVD '88 BASED ON GALVESTON PLEASURE PIER TIDAL INFORMATION PROVIDED BY NOAA.

DATUM ELEVATIONS
(NOAA TIDAL DATUM ELEVATIONS PROVIDED FOR GALVESTON PLEASURE PIER, U.N.O.)

MEAN HIGHER HIGH WATER (MHHW) = 2.09 FEET
 MEAN HIGH WATER (MHW) = 1.92 FEET
 MEAN TIDE LEVEL (MTL) = 1.17 FEET
 MEAN SEA LEVEL (MSL) = 1.16 FEET
 * NAVD '88 = 0.89 FEET
 MEAN LOW WATER (MLW) = 0.43 FEET
 MEAN LOWER LOW WATER (MLLW) = 0.00 FEET

* **NOT** NOAA TIDAL DATUM

LEGEND:

- HOUSE FOOTPRINT
- EXIST. HOUSE/FOUNDATION TO BE REMOVED
- CONCRETE SLABS
- DUNE WALKOVERS/STAIRS
- FENCE
- SHEET PILING
- PALM TREE
- HAY BALE DUNE
- SEPTIC TANKS/MANHOLES
- TIMBER POST
- POWER POLE
- WATER TANKS
- GUY WIRE
- 2.51 NATURAL GROUND ELEVATIONS
- SURVEY CONTROL POINT
- MHHW COORDINATES (SEE SCHEDULE)

MHHW POINT	X-COORDINATE	Y-COORDINATE
4-1	3,405,569.09	13,762,340.23
4-2	3,405,940.21	13,762,519.31
4-3	3,406,837.90	13,762,860.96
4-4	3,407,184.36	13,763,123.49
4-5	3,407,657.42	13,763,332.47
4-6	3,407,832.97	13,763,428.96
4-7	3,408,219.99	13,763,606.08
4-8	3,409,094.81	13,764,011.85
4-9	3,409,855.81	13,764,257.22

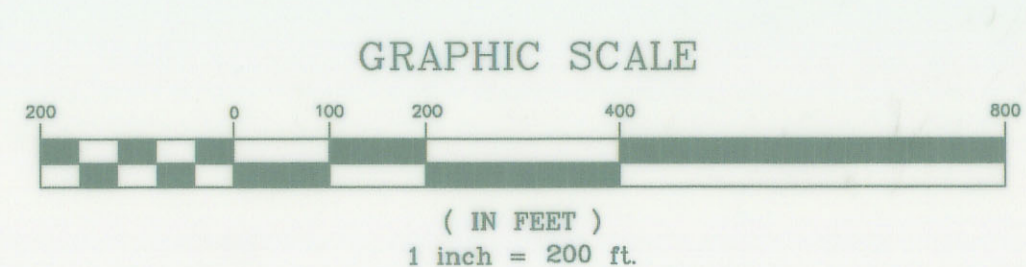
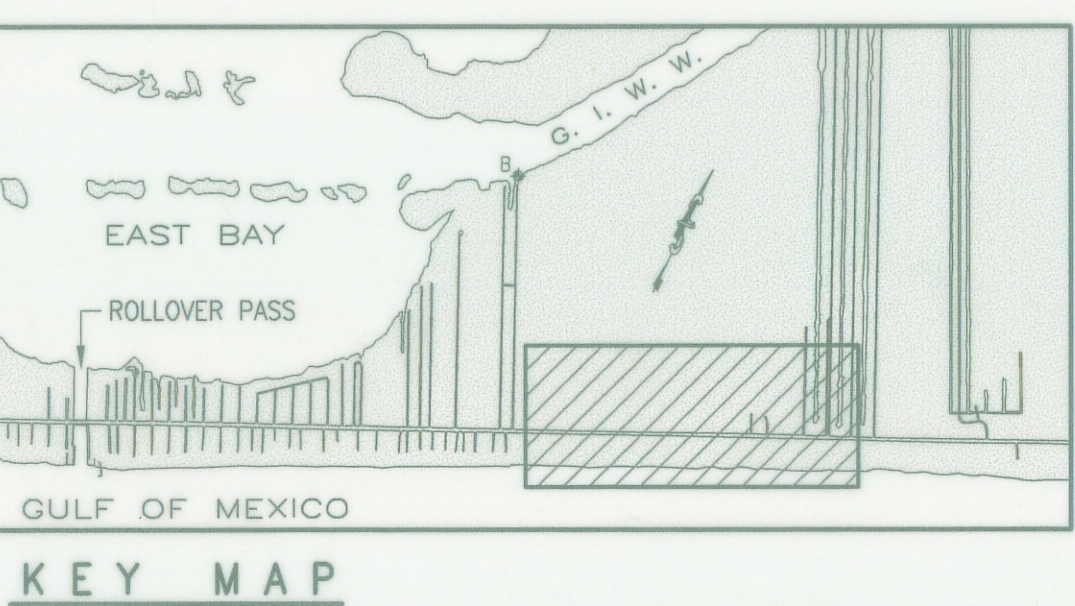
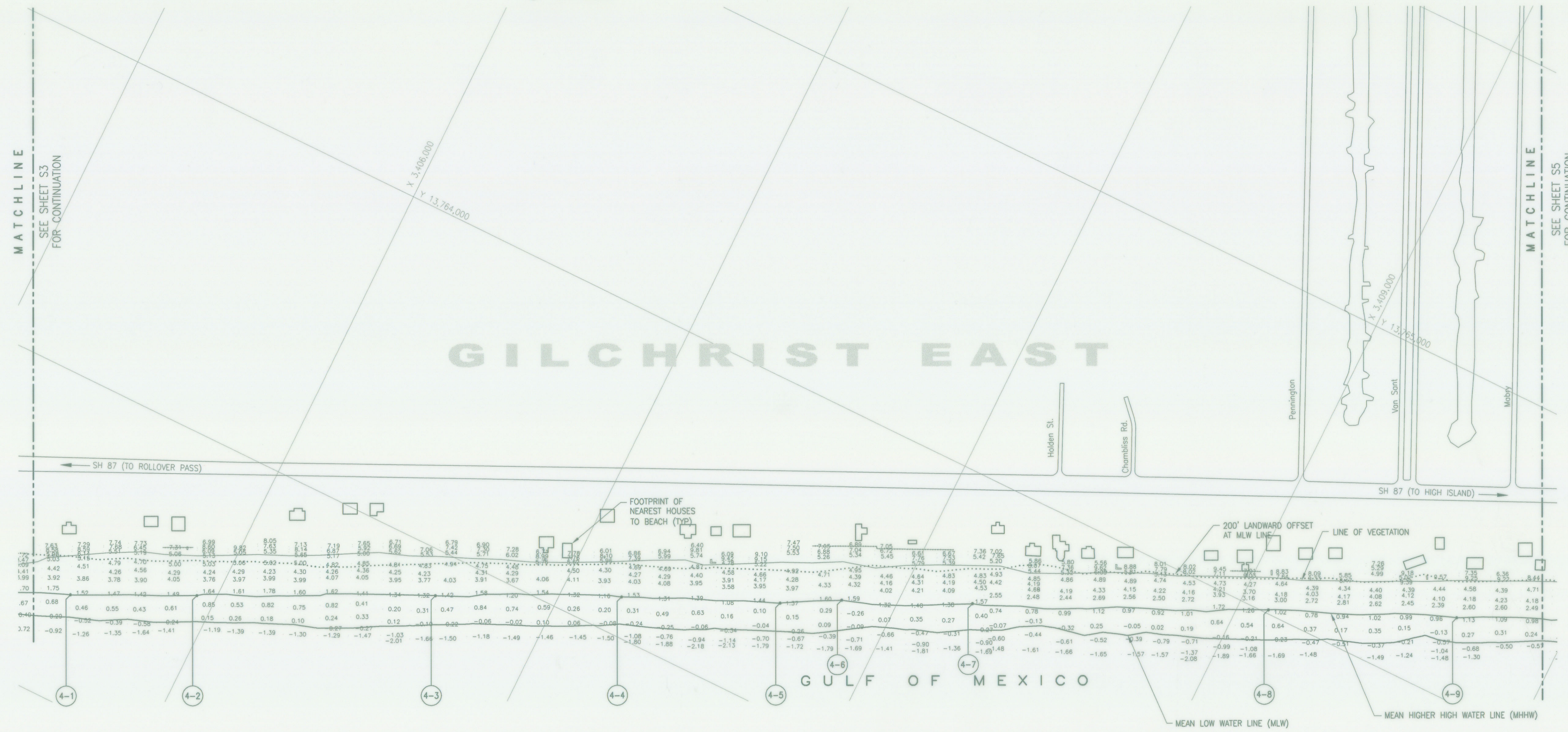

TEXAS GENERAL LAND OFFICE
 Art. 33.136, Natural Resources Code
 County GALVESTON, Sk. No. 1-D
 File Date 4-1-2002 by D.J.H.

WE, SHINER, MOSELEY AND ASSOCIATES, INC., WITH THE ASSISTANCE OF WM. W. GREEN, A LICENSED STATE LAND SURVEYOR IN THE STATE OF TEXAS, HEREBY STATE THAT THIS DRAWING REPRESENTS THE CONDITIONS THAT EXISTED AT THE TIME OF THE BEACH SURVEY CONDUCTED ON MAY 18 THROUGH JULY 16, 1999.

NOTICE: THIS SURVEY WAS PERFORMED IN ACCORDANCE WITH SECTION 33.136, NATURAL RESOURCES CODE, FOR THE PURPOSE OF EVIDENCING THE LOCATION OF THE SHORELINE IN THE AREA DEPICTED IN THIS SURVEY AS THAT SHORELINE EXISTED BEFORE COMMENCEMENT OF EROSION RESPONSE ACTIVITY ON THE PUBLIC BEACH, AS REQUIRED BY CHAPTER 33, NATURAL RESOURCES CODE. THE LINE DEPICTED ON THIS SURVEY FIXES THE SHORELINE FOR THE PURPOSE OF LOCATING A SHORELINE BOUNDARY, SUBJECT TO EROSION LANDWARD AS PROVIDED BY SECTION 33.136, NATURAL RESOURCES CODE.

George Rubalcaba
 GEORGE RUBALCABA
 REGISTERED PROFESSIONAL LAND SURVEYOR

Wm. W. Green
 WM. W. GREEN P.E., R.P.L.S.
 LICENSED STATE LAND SURVEYOR

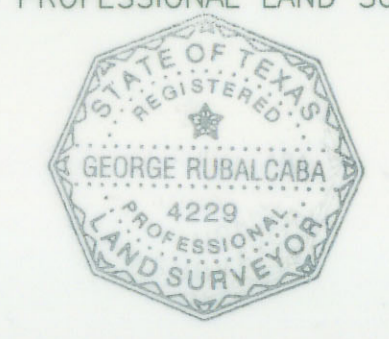

 SHINER MOSELEY AND ASSOCIATES, INC. ENGINEERS & CONSULTANTS 2820 South Padon Island Drive, Suite 210 Corpus Christi, Texas 78416-1816		COUNTY OF GALVESTON SURVEY OF CAPLEN, ROLLOVER PASS, & GILCHRIST AREA BEACHES BOLIVAR PENINSULA TEXAS	
SMA JOB NO.: 90157		SITE PLAN	
DRN	DEG	DATE	07/99
DES		DATE	
CHK		DATE	1-22-01
APP		DATE	
SCALE 1" = 200'		SHEET NO.	S4
DWG NO 90157S04		REV	1

A:\SMA\proj\1999\90157\view\90157s04.dwg 01/05/01 08:07:31 AM CST

REV	DATE	DESCRIPTION	APP
0	8/05/99	ORIGINAL ISSUE	
1	1/05/01	ADJUSTED COORDINATE SYSTEM	

NOTES:

- COORDINATES SHOWN ARE BASED ON LAMBERT GRID, TEXAS SOUTH CENTRAL ZONE, NAD '83 (1993).
- MONUMENTS USED FOR HORIZONTAL CONTROL WERE:
 A RA7-1 N 13,762,514.30 E 3,395,323.60
 B RA-8 N 13,766,079.23 E 3,403,488.32
- ELEVATIONS AND CONTOURS SHOWN ARE BASED ON NAVD '88.
- MONUMENTS USED FOR VERTICAL CONTROL WERE:
 C LUB 0971 D 1994 ELEV. 6.73' NAVD '88
 D NOS #5 1993 ELEV. 4.94' NAVD '88
 E 0971 E 1994 ELEV. 2.05' NAVD '88
 F Z171 1936 (RESET 1954) ELEV. 6.50' NAVD '88
- MEAN HIGHER HIGH WATER (MHHW) = 1.40' NAVD '88 BASED ON GALVESTON PLEASURE PIER TIDAL INFORMATION PROVIDED BY NOAA.

DATUM ELEVATIONS
 (NOAA TIDAL DATUM ELEVATIONS PROVIDED FOR GALVESTON PLEASURE PIER, U.N.O.)

MEAN HIGHER HIGH WATER (MHHW) = 2.09 FEET
 MEAN HIGH WATER (MHW) = 1.92 FEET
 MEAN TIDE LEVEL (MTL) = 1.17 FEET
 MEAN SEA LEVEL (MSL) = 1.16 FEET
 NAVD '88 = 0.69 FEET
 MEAN LOW WATER (MLW) = 0.43 FEET
 MEAN LOWER LOW WATER (MLLW) = 0.00 FEET

* NOT NOAA TIDAL DATUM

LEGEND:

- HOUSE FOOTPRINT
- EXIST. HOUSE/FOUNDATION TO BE REMOVED
- CONCRETE SLABS
- DUNE WALKOVERS/STAIRS
- FENCE
- SHEET PILING
- PALM TREE
- HAY BALE DUNE
- SEPTIC TANKS/MANHOLES
- TIMBER POST
- POWER POLE
- WATER TANKS
- GUY WIRE
- NATURAL GROUND ELEVATIONS
- SURVEY CONTROL POINT
- MHHW COORDINATES (SEE SCHEDULE)

MHHW POINT	X-COORDINATE	Y-COORDINATE
5-1	3,409,937.82	13,764,386.49
5-2	3,410,117.40	13,764,485.95
5-3	3,410,305.47	13,764,559.81
5-4	3,410,765.30	13,764,793.71
5-5	3,411,144.85	13,764,934.87
5-6	3,411,230.51	13,764,994.95
5-7	3,411,304.90	13,765,025.81
5-8	3,411,404.49	13,765,048.98
5-9	3,411,591.82	13,765,126.37
5-10	3,412,061.79	13,765,305.31

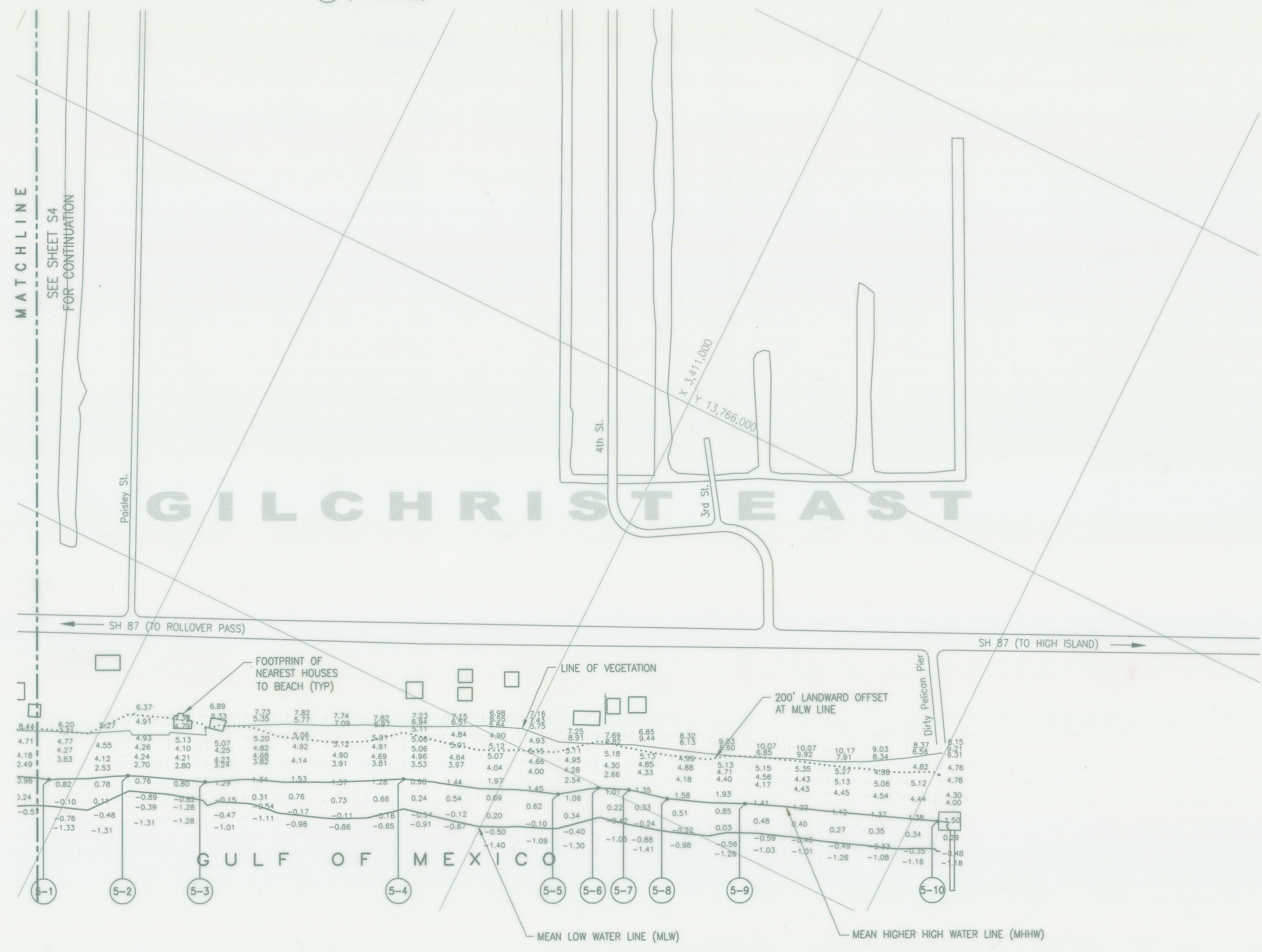

TEXAS GENERAL LAND OFFICE
 Art. 33.136, Natural Resources Code,
 County GALVESTON, Sk. No. 4-E
 File Date 2-11-2002 by D.J.H.

WE, SHINER, MOSELEY AND ASSOCIATES, INC., WITH THE ASSISTANCE OF WM. W. GREEN, A LICENSED STATE LAND SURVEYOR IN THE STATE OF TEXAS, HEREBY STATE THAT THIS DRAWING REPRESENTS THE CONDITIONS THAT EXISTED AT THE TIME OF THE BEACH SURVEY CONDUCTED ON MAY 18 THROUGH JULY 16, 1999.

NOTICE: THIS SURVEY WAS PERFORMED IN ACCORDANCE WITH SECTION 33.136, NATURAL RESOURCES CODE, FOR THE PURPOSE OF EVIDENCING THE LOCATION OF THE SHORELINE IN THE AREA DEPICTED IN THIS SURVEY AS THAT SHORELINE EXISTED BEFORE COMMENCEMENT OF EROSION RESPONSE ACTIVITY ON THE PUBLIC BEACH, AS REQUIRED BY CHAPTER 33, NATURAL RESOURCES CODE. THE LINE DEPICTED ON THIS SURVEY FIXES THE SHORELINE FOR THE PURPOSE OF LOCATING A SHORELINE BOUNDARY, SUBJECT TO EROSION LANDWARD AS PROVIDED BY SECTION 33.136, NATURAL RESOURCES CODE.

George Rubalcaba
 GEORGE RUBALCABA
 REGISTERED PROFESSIONAL LAND SURVEYOR

Wm. W. Green
 WM. W. GREEN P.E., R.P.L.S.
 LICENSED STATE LAND SURVEYOR

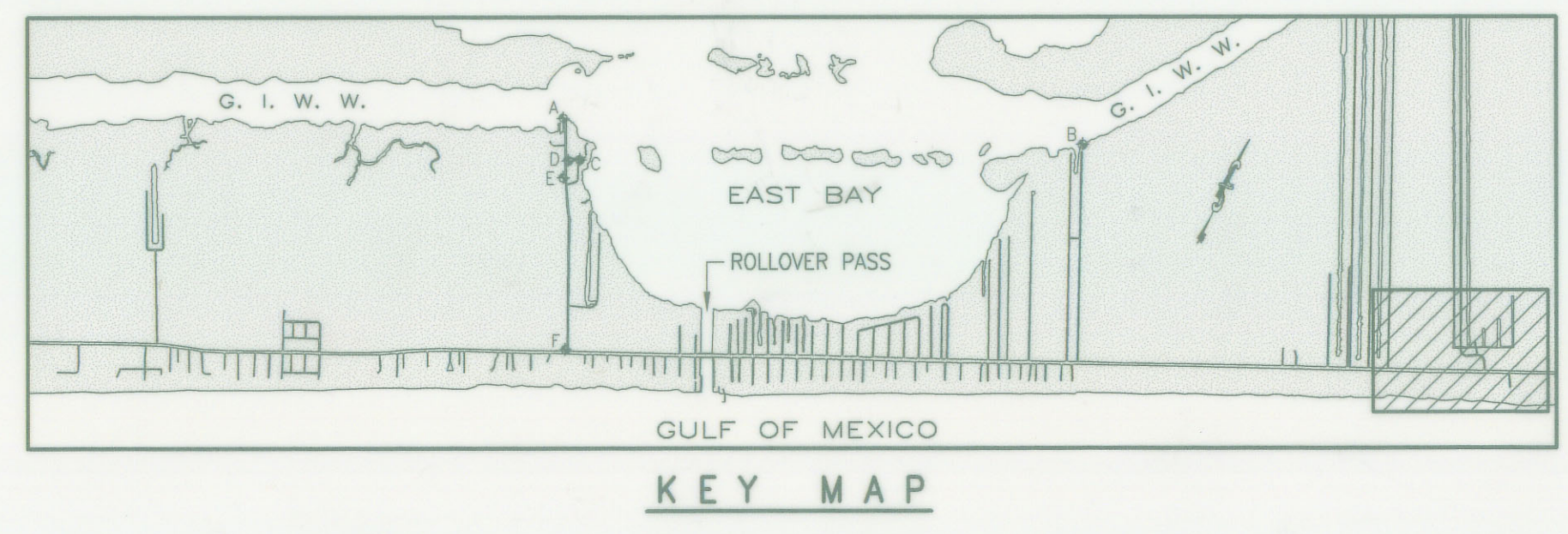
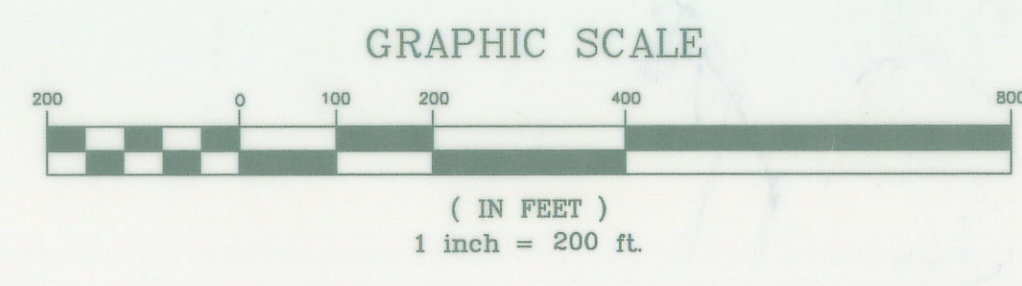

 SHINER MOSELEY AND ASSOCIATES, INC. ENGINEERS & CONSULTANTS 2820 South Padre Island Drive, Suite 210 Corpus Christi, Texas 78416-1816		COUNTY OF GALVESTON SURVEY OF CAPLEN, ROLLOVER PASS, & GILCHRIST AREA BEACHES BOLIVAR PENINSULA TEXAS	
SMA JOB NO.: 90157		DATE: 07/99	
DRN: DEG		DATE	
DES: DEG		DATE	
CHK: <i>AK</i>		DATE: 1-22-01	
APP: <i>AK</i>		DATE	
SCALE: 1" = 200'		SHEET NO.: S5	
DWG NO: 90157S05		REV: 1	

J:\SMA\proj\Projects\1999\90157\dwg\90157s05.dwg 01/05/01 08:10:39 AM CST



March 28, 2001

J90146/J90157
J90310.02
J200.00047

Mr. Bill Grimes
Texas General Land Office
1700 N. Congress Avenue
Austin, Texas 78701-1495

RE: COASTAL SURFACE LEASE NO. 19990016 AND COASTAL BOUNDARY SURVEYS (BOLIVAR PENINSULA, GALVESTON COUNTY) PERFORMED IN ACCORDANCE WITH SECTION 33.136, NATURAL RESOURCES CODE

Dear Mr. Grimes

During construction of the Nourishment of Gilchrist Beach project, it became evident that the project coordinate system did not correlate properly with the Lambert Grid (NAD'27) coordinate system referenced on Exhibit C1 of the coastal surface lease and coastal boundary surveys of the area. However, the relation between existing improvements and topographic features was unaffected. All proposed improvements, dredging, geotube dunes, and beach fill, were constructed in the proper location as shown by these documents. Attached is revised Exhibit C1 that shows the adjusted NAD'27 coordinates. Also enclosed are corrected coastal boundary surveys previously submitted to GLO by Galveston County in accordance with Section 33.136 of Natural Resources Code.

We trust that the information provided satisfies GLO requirements. Please do not hesitate to call should there be any questions.

Sincerely,

SHINER MOSELEY AND ASSOCIATES, INC.

Gerald J. Hauske, P.E.
Project Manager

TEXAS GENERAL LAND OFFICE
Art. 33.136, Natural Resources Code
County Galveston, Report Sketch
File Date 4-11-2002 by D.J.H.
See flattened sketches

Enclosures: Permit Exhibit – Sheet 2 of 8 (Revised 12/00)
Bolivar Peninsula Dune Restoration, Phase 2 – Sheet S1, Rev. 1 (mylar)
Survey of Caplin, Rollover Pass & Gilchrist Beach – Sheet Nos. S1 Through S5,
Rev. 1 (mylars)

Cc: Tesa Duffey, EM Coordinator
Office of Emergency Management
County of Galveston
1301 Farm Road 646
Dickinson, Texas 77539

Michael Fitzgerald, P.E.
County Engineer
County of Galveston
123 Rosenberg, Suite 4157
Galveston, TX 77550

Co. No. 61797