

J:\SMAcad\Projects\2000\00085\dwg\construction\00085c01.dwg 03/09/01 05:55:38 PM CST

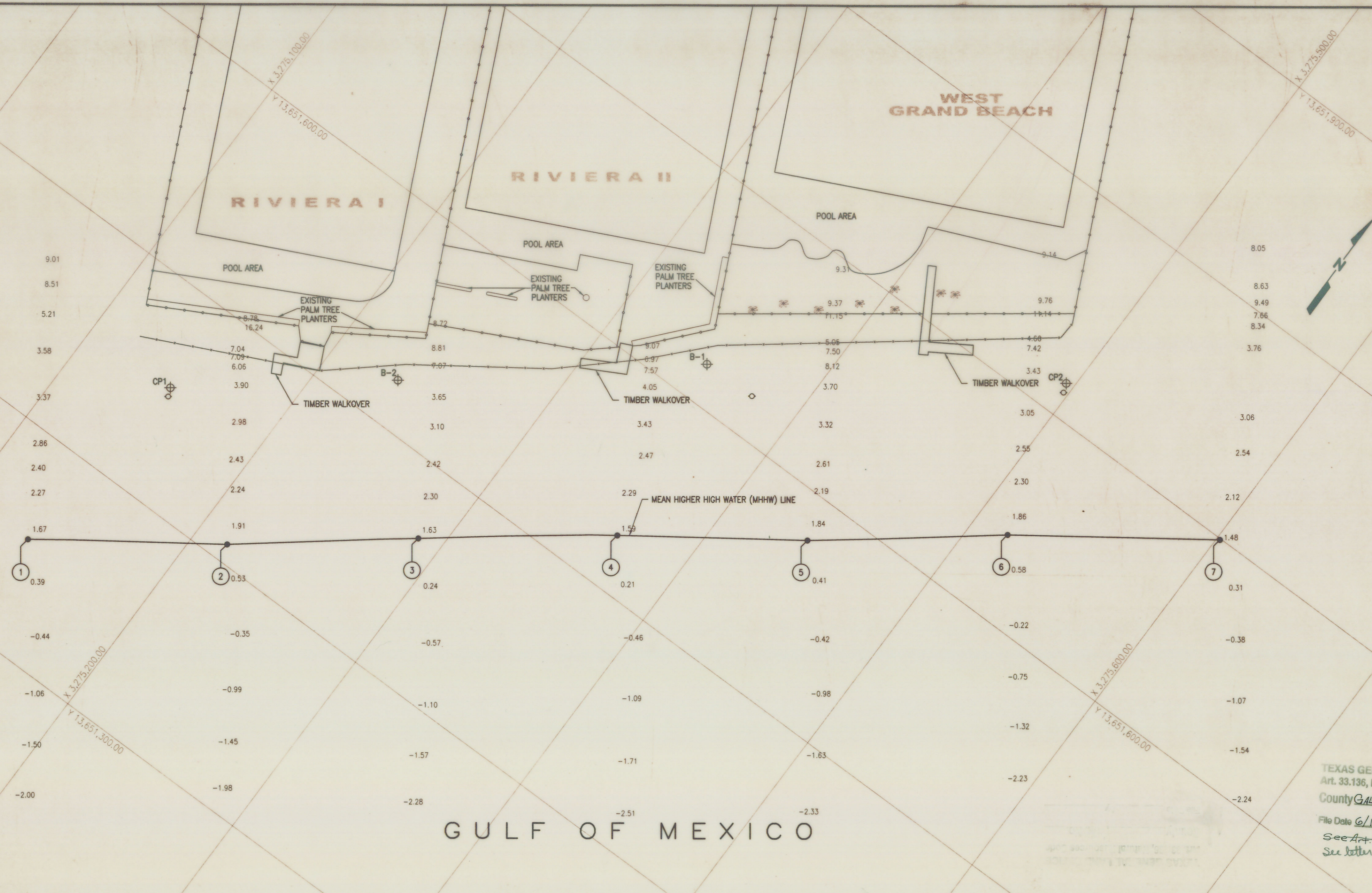

DATUM ELEVATIONS
 (NOAA TIDAL DATUM ELEVATIONS PROVIDED FOR GALVESTON PLEASURE PIER, U.N.O.)
 MEAN HIGHER HIGH WATER (MHHW) = 2.09 FEET
 MEAN HIGH WATER (MHW) = 1.92 FEET
 MEAN TIDE LEVEL (MTL) = 1.17 FEET
 MEAN SEA LEVEL (MSL) = 1.16 FEET
 * NAVD '88 = 0.89 FEET
 MEAN LOW WATER (MLW) = 0.43 FEET
 MEAN LOWER LOW WATER (MLLW) = 0.00 FEET
 * NOT NOAA TIDAL DATUM

STATE COASTAL BOUNDARY		
MHHW POINT	X-COORDINATE	Y-COORDINATE
1	3,275,136.40	13,651,352.71
2	3,275,215.66	13,651,408.65
3	3,275,288.48	13,651,466.68
4	3,275,365.23	13,651,525.70
5	3,275,440.82	13,651,579.05
6	3,275,517.36	13,651,639.59
7	3,275,601.64	13,651,699.44

1 EXISTING SITE PLAN
 SCALE: 1" = 30'

- LEGEND:**
- DECORATIVE FENCE
 - SAND FENCE
 - H1 CP1 SURVEY CONTROL POINT (SEE KEY MAP)
 5/8" I.R. CP2
 X = 3,275,147.84 X = 3,275,496.08
 Y = 13,651,453.45 Y = 13,651,715.96
 ELEV. 3.73' NAVD '88 ELEV. 3.40' NAVD '88
 - TRASH BARREL
 - ☼ PALM TREE
 - 2.06 NATURAL GROUND ELEVATION (NAVD '88)
 - ① MHHW COORDINATES (SEE SCHEDULE)
 - B-1 SOIL BORING LOCATION (APPROXIMATE)

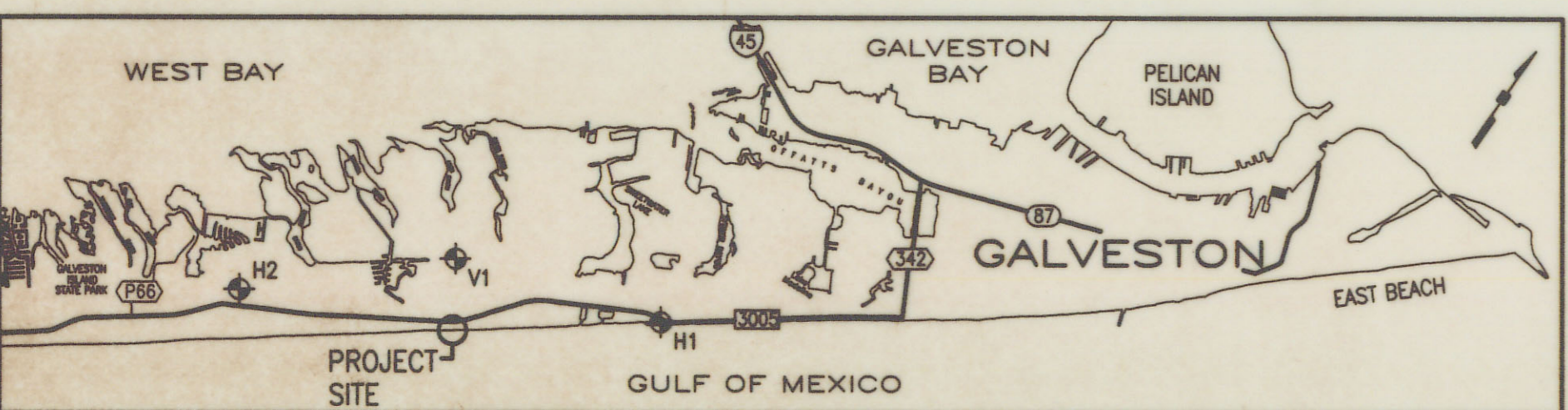
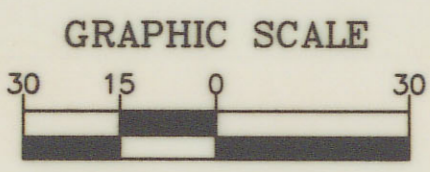

KEY MAP

- NOTES:**
- COORDINATES SHOWN ARE BASED ON LAMBERT GRID, TEXAS SOUTH CENTRAL ZONE, NAD '83 (1993).
 - MONUMENTS USED FOR HORIZONTAL CONTROL WERE:
 H1 162+87.6 H2 HGCS
 X 3,285,708.91 X 3,264,124.31
 Y 13,658,765.39 Y 13,645,727.17
 - ELEVATIONS AND CONTOURS SHOWN ARE BASED ON NAVD '88.
 - MONUMENT USED FOR VERTICAL CONTROL WAS:
 V1 F 1186
 ELEV. 5.46' NAVD '88
 - MEAN HIGHER HIGH WATER (MHHW) = 1.40' NAVD '88 BASED ON GALVESTON PLEASURE PIER TIDAL INFORMATION PROVIDED BY NOAA.
 - TEMPORARY SURVEY CONTROL POINTS USED FOR SURVEY ARE CP1 AND CP2. THESE CONTROL POINTS ARE PROVIDED FOR CONTRACTOR'S CONVENIENCE ONLY AND SHALL BE VERIFIED WITH RESPECT TO SURVEY CONTROL POINTS.
 - ALL SURVEYING WAS PERFORMED BY SHINER MOSELEY AND ASSOCIATES, INC., DURING MAY OF 2000
 - SOIL INVESTIGATION DATA WAS ACQUIRED BY ROCK ENGINEERING & TESTING LABORATORY, INC. AND PRESENTED IN GEOTECHNICAL STUDY REPORT DATED AUGUST 28, 2000 (RETL JOB NO. 0000649).
 - EXISTING FACILITIES ARE PRESENT AT THIS SITE. THE CONTRACTOR SHALL VERIFY ALL EXISTING CONDITIONS PRIOR TO COMMENCING CONSTRUCTION ACTIVITIES. THE CONTRACTOR SHALL NOTIFY THE ENGINEER IMMEDIATELY OF ANY CONFLICTS OR DISCREPANCIES.
 - REFER TO ② FOR SCHEDULED WORK AND IMPROVEMENTS.

NOTICE:
 THIS SURVEY WAS PERFORMED IN ACCORDANCE WITH SECTION 33.136, NATURAL RESOURCES CODE, FOR THE PURPOSE OF EVIDENCING THE LOCATION OF THE SHORELINE IN THE AREA DEPICTED IN THIS SURVEY AS THAT SHORELINE EXISTED BEFORE COMMENCEMENT OF EROSION RESPONSE ACTIVITY ON THE PUBLIC BEACH, AS REQUIRED BY CHAPTER 33, NATURAL RESOURCES CODE. THE LINE DEPICTED ON THIS SURVEY FIXES THE SHORELINE FOR THE PURPOSE OF LOCATING A SHORELINE BOUNDARY, SUBJECT TO EROSION LANDWARD AS PROVIDED BY SECTION 33.136, NATURAL RESOURCES CODE.

WE, SHINER MOSELEY AND ASSOCIATES, INC., WITH THE ASSISTANCE OF WM. W. GREEN, A LICENSED STATE LAND SURVEYOR IN THE STATE OF TEXAS, HEREBY STATE THAT THIS DRAWING REPRESENTS THE CONDITIONS THAT EXISTED AT THE TIME OF THE BEACH SURVEY CONDUCTED IN MAY 2000 AT RIVIERA I & II, AND WEST GRAND BEACH CONDOMINIUMS.

George Rubalcaba
 GEORGE RUBALCABA
 REGISTERED PROFESSIONAL LAND SURVEYOR

Wm. W. Green
 WM. W. GREEN P.E., R.P.L.S.
 LICENSED STATE LAND SURVEYOR

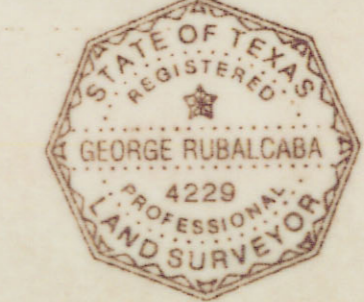

TEXAS GENERAL LAND OFFICE
 Art. 33.136, Natural Resources Code
 County GALVESTON, Sk. No. 2
 File Date 6/11/2001 by D. J. H.
 See Art. 33.136 Report I
 See letter in book.

REV	DATE	DESCRIPTION	APP
0	8/7/00	ISSUED FOR REVIEW	
1	9/11/00	ISSUED FOR BIDS	
2	1/19/01	ADDED CERTIFICATION NOTE	
3	3/09/01	REMOVED LOV DESIGNATION	

REV	JUL	07/2000	391
REV	DATE	DESCRIPTION	APP
0	07/2000	ISSUED FOR REVIEW	
1	07/2000	ISSUED FOR BIDS	
2	07/2000	ADDED CERTIFICATION NOTE	
3	07/2000	REMOVED LOV DESIGNATION	

SHINER MOSELEY AND ASSOCIATES, INC.
 ENGINEERS & CONSULTANTS
 555 North Caracachua Street, Suite 1650
 Corpus Christi, Texas 78478

CITY OF GALVESTON
DUNE RESTORATION FOR RIVIERA I & II/ WEST GRAND BEACH CONDOMINIUMS
 TEXAS
EXISTING SITE PLAN

SHEET
C1
 OF 5 REV 3

Galveston Co. Art. 33.136
 Sketch No. 2

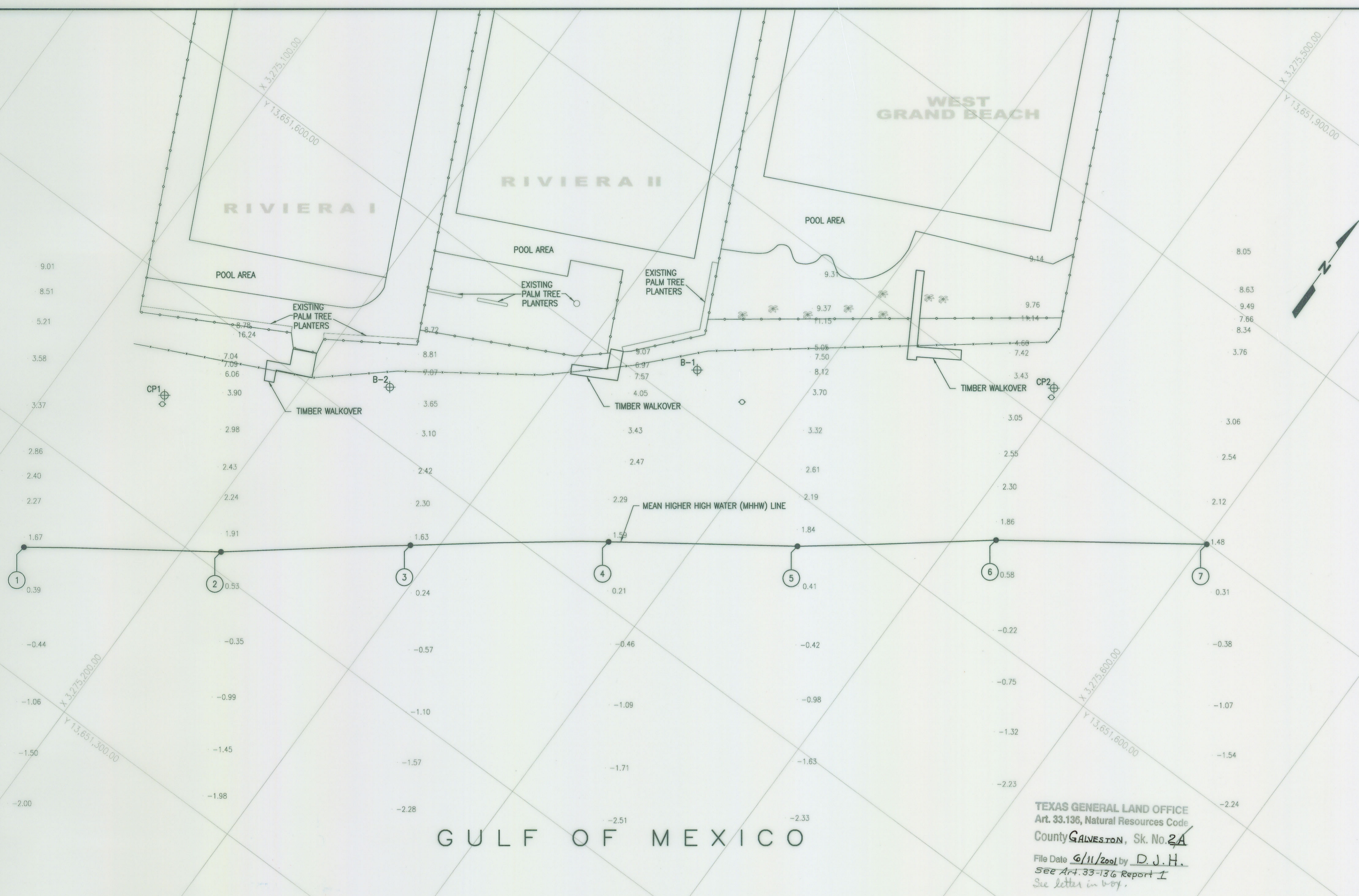

REV	DATE	DESCRIPTION	APP
0	8/7/00	ISSUED FOR REVIEW	
1	9/11/00	ISSUED FOR BIDS	
2	1/19/01	ADDED CERTIFICATION NOTE	
3	3/09/01	REMOVED LOY DESIGNATION	



SHINER MOSELEY AND ASSOCIATES, INC.
ENGINEERS & CONSULTANTS
555 North Caranacahn Street, Suite 1650
Corpus Christi, Texas 78478

RECEIVED
MAR 14 2001
GENERAL LAND OFFICE

DATUM ELEVATIONS
(NOAA TIDAL DATUM ELEVATIONS PROVIDED FOR GALVESTON PLEASURE PIER, U.N.O.)

MEAN HIGHER HIGH WATER (MHHW) = 2.09 FEET
MEAN HIGH WATER (MHW) = 1.92 FEET
MEAN TIDE LEVEL (MTL) = 1.17 FEET
MEAN SEA LEVEL (MSL) = 1.16 FEET
* NAVD '88 = 0.69 FEET
MEAN LOW WATER (MLW) = 0.43 FEET
MEAN LOWER LOW WATER (MLLW) = 0.00 FEET

* NOT NOAA TIDAL DATUM

MHHW POINT	X-COORDINATE	Y-COORDINATE
1	3,275,136.40	13,651,352.71
2	3,275,215.66	13,651,408.65
3	3,275,288.48	13,651,466.68
4	3,275,365.23	13,651,525.70
5	3,275,440.82	13,651,579.05
6	3,275,517.36	13,651,639.59
7	3,275,601.84	13,651,699.44

1 EXISTING SITE PLAN

SCALE: 1" = 30'

- LEGEND:
- DECORATIVE FENCE
 - SAND FENCE
 - H1 CP1 SURVEY CONTROL POINT (SEE KEY MAP)
5/8" I.R. CP2
5/8" I.R.
X = 3,275,147.84 X = 3,275,496.08
Y = 13,651,453.45 Y = 13,651,715.96
ELEV. 3.73' NAVD '88 ELEV. 3.40' NAVD '88
 - TRASH BARREL
 - ☼ PALM TREE
 - 2.06 NATURAL GROUND ELEVATION (NAVD '88)
 - ① MHHW COORDINATES (SEE SCHEDULE)
 - B-1 SOIL BORING LOCATION (APPROXIMATE)

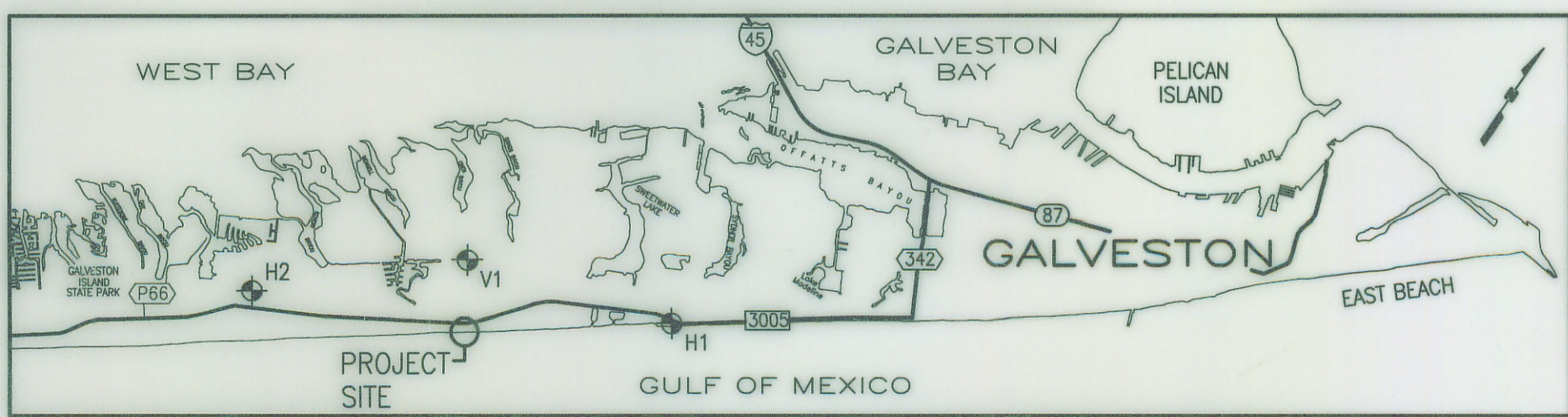
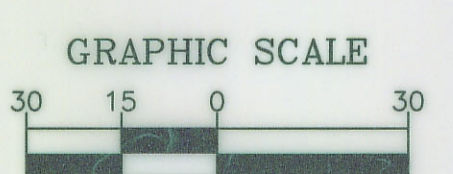

- NOTES:
- COORDINATES SHOWN ARE BASED ON LAMBERT GRID, TEXAS SOUTH CENTRAL ZONE, NAD '83 (1993).
 - MONUMENTS USED FOR HORIZONTAL CONTROL WERE:
H1 162+87.6 H2 HGCS
X 3,285,708.91 X 3,264,124.31
Y 13,658,765.39 Y 13,645,727.17
 - ELEVATIONS AND CONTOURS SHOWN ARE BASED ON NAVD '88.
 - MONUMENT USED FOR VERTICAL CONTROL WAS:
V1 F 1186
ELEV. 5.46' NAVD '88
 - MEAN HIGHER HIGH WATER (MHHW) = 1.40' NAVD '88 BASED ON GALVESTON PLEASURE PIER TIDAL INFORMATION PROVIDED BY NOAA.
 - TEMPORARY SURVEY CONTROL POINTS USED FOR SURVEY ARE CPI AND CP2. THESE CONTROL POINTS ARE PROVIDED FOR CONTRACTOR'S CONVENIENCE ONLY AND SHALL BE VERIFIED WITH RESPECT TO SURVEY CONTROL POINTS.
 - ALL SURVEYING WAS PERFORMED BY SHINER MOSELEY AND ASSOCIATES, INC., DURING MAY OF 2000.
 - SOIL INVESTIGATION DATA WAS ACQUIRED BY ROCK ENGINEERING & TESTING LABORATORY, INC. AND PRESENTED IN GEOTECHNICAL STUDY REPORT DATED AUGUST 28, 2000 (RETL JOB NO. 0000649).
 - EXISTING FACILITIES ARE PRESENT AT THIS SITE. THE CONTRACTOR SHALL VERIFY ALL EXISTING CONDITIONS PRIOR TO COMMENCING CONSTRUCTION ACTIVITIES. THE CONTRACTOR SHALL NOTIFY THE ENGINEER IMMEDIATELY OF ANY CONFLICTS OR DISCREPANCIES.
 - REFER TO 2 FOR SCHEDULED WORK AND IMPROVEMENTS.

TEXAS GENERAL LAND OFFICE
Art. 33.136, Natural Resources Code
County GALVESTON, Sk. No. 2A
File Date 6/11/2001 by D.J.H.
See Art. 33-136 Report I
See letter in 4-04.

NOTICE:
THIS SURVEY WAS PERFORMED IN ACCORDANCE WITH SECTION 33.136, NATURAL RESOURCES CODE, FOR THE PURPOSE OF EVIDENCING THE LOCATION OF THE SHORELINE IN THE AREA DEPICTED IN THIS SURVEY AS THAT SHORELINE EXISTED BEFORE COMMENCEMENT OF EROSION RESPONSE ACTIVITY ON THE PUBLIC BEACH, AS REQUIRED BY CHAPTER 33, NATURAL RESOURCES CODE. THE LINE DEPICTED ON THIS SURVEY FIXES THE SHORELINE FOR THE PURPOSE OF LOCATING A SHORELINE BOUNDARY, SUBJECT TO EROSION LANDWARD AS PROVIDED BY SECTION 33.136, NATURAL RESOURCES CODE.

WE, SHINER MOSELEY AND ASSOCIATES, INC., WITH THE ASSISTANCE OF WM. W. GREEN, A LICENSED STATE LAND SURVEYOR IN THE STATE OF TEXAS, HEREBY STATE THAT THIS DRAWING REPRESENTS THE CONDITIONS THAT EXISTED AT THE TIME OF THE BEACH SURVEY CONDUCTED IN MAY 2000 AT RIVIERA I & II, AND WEST GRAND BEACH CONDOMINIUMS.

George Rubalcaba
REGISTERED PROFESSIONAL LAND SURVEYOR



Wm. W. Green
WM. W. GREEN P.E., R.P.L.S.
LICENSED STATE LAND SURVEYOR



CITY OF GALVESTON
DUNE RESTORATION FOR
RIVIERA I & II/ WEST GRAND BEACH
CONDOMINIUMS
TEXAS
GALVESTON
EXISTING SITE PLAN

SHEET
C1
OF 5 REV 3

Galveston Co. Art. 33.136
Sketch 2A

J:\SMAcad\Projects\2000\00085.dwg (construction)\00085c01.dwg 03/09/01 05:55:38 PM CST

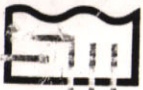

March 12, 2001

J200.00085.01

Ms. Barbara Deane, Director
Environmental Law Section
Texas General Land Office
1700 N. Congress Avenue
Austin, TX 78701-1495

**RE: STATE COASTAL BOUNDARY SURVEY AT RIVIERA I & II,
AND WEST GRAND BEACH CONDOMINIUMS**

Dear Ms. Deane:

I appreciate you taking time to meet with me last Thursday to discuss the State coastal boundary survey for the referenced project. Attached is the drawing/survey depicting the State coastal boundary revised in accordance with our discussions. In past weeks, Monica Franke (City of Galveston) and Ashley Wadick (GLO) have requested information and instructed us to modified the project as follows:

1. The required "Notice" has been added to drawing Sheet No. C1 in accordance with §33.136 of the TNRC. Additionally, the survey was prepared under the direction of the Licensed State Land Surveyor (LSLS) indicated on the drawing/survey.
2. The geotube dune has been constructed as far landward as physically possible with respect to existing improvements. The line of vegetation is not shown; it is not required to be shown under the statute.
3. By reviewing the actual survey shots on drawing Sheet No. C1 and the proposed dune alignment, approximately 25 to 30 feet width of existing fill will be removed. This equates to approximately 2,200 CY.

We trust that we have satisfied your requirements. Please do not hesitate to call should there be any questions.

Sincerely,

SHINER MOSELEY AND ASSOCIATES, INC.

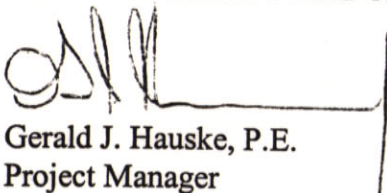
Gerald J. Hauske, P.E.
Project Manager

TEXAS GENERAL LAND OFFICE
Art. 33.136, Natural Resources Code
REPORT
County GALVESTON, # No. 2 Sketch 2
File Date 6/11/2001 by D. J. H.
Report: Galveston Co. Art. 33.136 No. 2, 2A
accompanying sketch
See flattened sketches.

Enclosure: Revised Drawing - Sheet No. C1, Revision 3 (blueline print)

Ms. Barbara Deane
Texas General Land Office
March 12, 2001
Page 2 of 2

J200.00085.01

Cc: (w/ vellum drawing/survey)
Ms. Monica Franke, Director
Department of Planning and Community Development
City of Galveston
823 Rosenberg, Room 401
Galveston, Texas 77553

(w/ mylar drawing/survey)
Mr. Bill Grimes
Texas General Land Office
1700 N. Congress Avenue
Austin, TX 78701-1495

DATE

Abilene Co. NRC article 33.136 sketch 2

counter 61517

PLEASE FOLD THIS SHIPPING DOCUMENT IN HALF AND PLACE IT IN A WAYBILL POUCH AFFIXED TO YOUR SHIPMENT SO THAT THE BAR-CODE PORTION OF THE LABEL CAN BE READ AND SCANNED.
***WARNING: USE ONLY THE PRINTED ORIGINAL LABEL FOR SHIPPING. USING A PHOTOCOPY OF THIS LABEL FOR SHIPPING PURPOSES IS FRAUDULENT AND COULD RESULT IN ADDITIONAL BILLING CHARGES, ALONG WITH THE CANCELLATION OF YOUR FEDEX ACCOUNT NUMBER.

FROM: Lois Hoots (361)857-2211
Shiner Moseley & Assoc inc
555 N. Carancahua
1650
Corpus Christi, TX 78478

SHIPPER'S FEDEX ACCOUNT NUMBER



TO: Bill Grimes (512)475-1464
TEXAS GENERAL LAND OFFICE
1700 N. CONGRESS AVENUE

SHIP DATE: 13MAR01
MAN-WGT: 2 LBS

REF: AUSTIN, TX 78701-
J200.00085.01



DELIVERY ADDRESS BARCODE (FEDEX-EDR)

CAD # 4355473

STANDARD OVERNIGHT

WED

TUBE

A1

TRK # 7919 9856 7402 FORM 0201

AUS

Deliver By:
14MAR01

78701-TX-US
DROP OFF

44 AUSA



Resource

RECEIVED

MAR 14 2001

GENERAL LAND OFFICE

Mgmt