



Connecting Line from N.W. Cor of the Wise Co. School Land
 Va 9+45' 2 2 1 0

Wise. County School Land.

The State of Texas }
 Knox Land District } J. A. C. Tackitt Surveyor of Knox

Land District, do hereby certify that the above and foregoing Plat or sketch show truly the Relative position of the NW Cor of the wise County School Land in Haskell County to the SW Cor of Knox County as established by me on the 24th day of May 1888. and also the position of the SW Cor of the Geo Alford No 48 and NW Cor of the Geo Dibrell Survey No 47. also the position of the Ruthy Campbell Sur No 50 and the mouth of Craton creek as found by actual survey done on the ground with R.C. Goree and A.M. Corcutters duly sworn and qualified chain carriers Given under my hand and official signature at Benjamin Tex Sept 24 1889
 A C Tackitt Sur Knox La Dist

11020 J. A. Tackitt

Counter 65010

County 65011

East 5000000 1/2

Bridge

1000000 1/2

T. 2000000 1/2
T. 2000000 1/2

Handwritten notes in the upper right quadrant, including the number '2281' and various illegible cursive text.

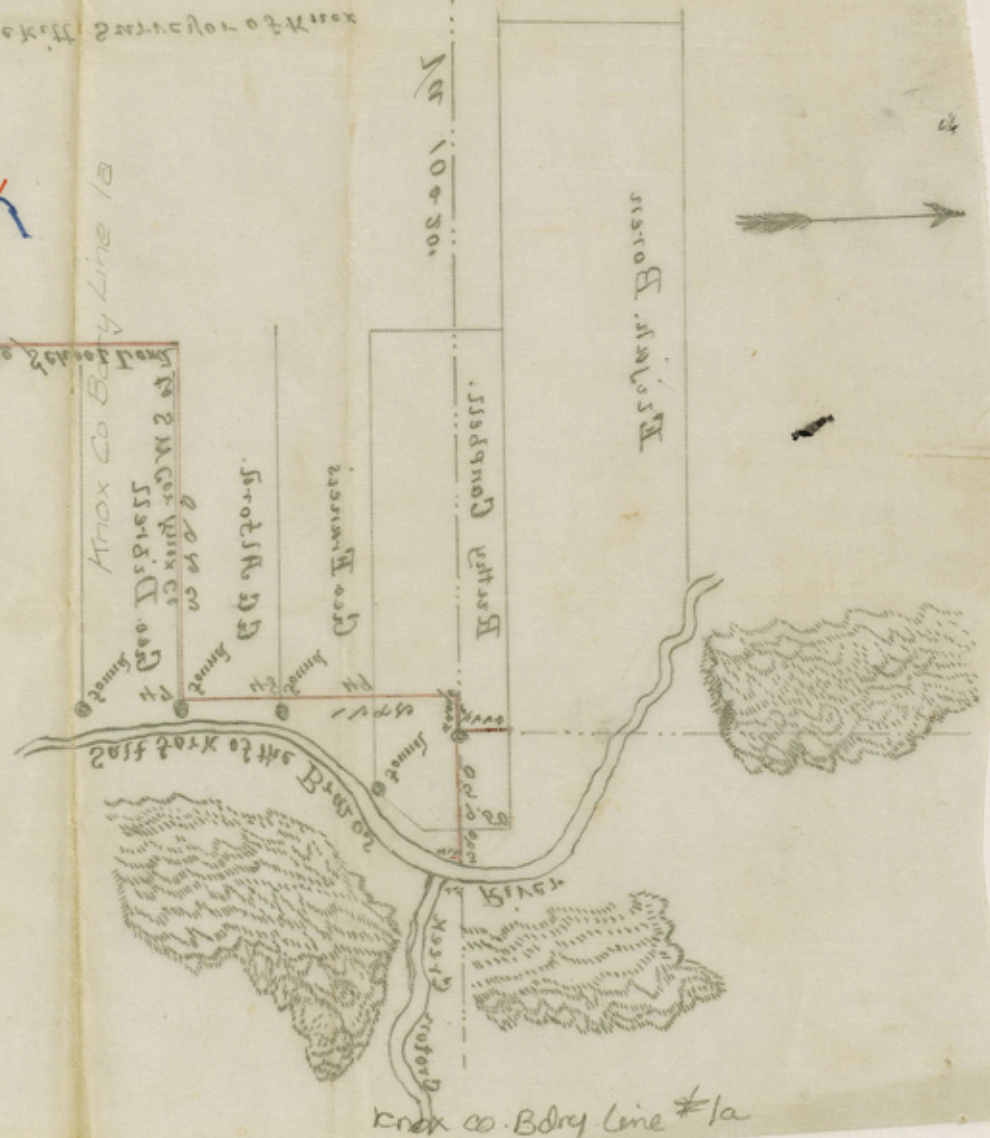

Handwritten mark resembling a stylized 'S' or '5'.

Knox Co. Dry Line #1a

AND KING COUNTY
Benjamin, Texas, Sept 2^d 1889

To the Hon Courts Court of Knox County
Gentlemen

In compliance with an Order of your
Honorable Court to make Connections.
from the NW Cor of the Wise County
School Land in Haskell County
and the one or more of the River surveys.
as requested by Hon R M Hall Comm
I proceeded on the 19th day of August, 189
as ordered and made the Connections
as required by said Order. I began
at the NW Cor of the Wise Co School Land
and Connected with the S.W. Cor of Knox Co
also Beg at S W Cor of Knox Co and Connected
with mouth of Croton Creek and the Geo.
G Alford Geo Dibrell and Ruthy Campbell
surveys, as Indicated by red line on
plat of sketch Very Respectfully
A. C. Tackitt Sur Knox Co Dist

~~5~~ approved in
open Court - Court this the
2nd day of Sept AD 1889
J. J. Truscott
C. J. Kelly

Knox Co. Bdry Line 1a

A. C. TACKETT,
—SURVEYOR OF—
KNOX LAND DISTRICT.

Benjamin, Tex.,188

I, A C Tackett Surveyor
of Knox Land District do hereby certify that I made
the following Runns to wit
Beg. at the NW Cor of the wise County School Land
in Haskell County.
Thence West 1900 vs. Thence N 45 W 960 vs.
Thence West 400 vs. Thence North 832 vs Thence N 20 W
950 vs. Thence North at 6716 1/2 vs. pass 7 vs E of the
SW Cor of Sur No 48. G G Alford and NW Cor of Sur
No 47. Geo Dibrell at 8000 vs point. Thence N 15 1/2
W 1647 vs to the SW Cor of Knox Co.
I then Beg and ran North 477 1/2 vs to the NB line
of the Rusty Campbell Sur No 50
Thence Beg at SW Cor of Knox Co Thence West
at 950 vs. Cross WB Line of the said Rusty Campbell No 50
and at 1340 vs channel of the Brazos River 312 vs
North of the mouth of Croton Creek

(A C Tackett Surveyor
Knox Land Dist

5

Knox Co.

Connection of the
S. W. corner of said Court
ty with adjoining
surveys.

Filed in the Gen. Land Off.
Octob. 9/ 89

A. S. Shelley
Chief Clerk.

Superseded by later
surveys - See field notes
of the Northern of Bushell Co.

188

Deputy Clerk

KNOX LAND DISTRICT

REGISTER OF

A. C. LUCKEILL

KNOX LAND DISTRICT
REGISTER
COMMISSIONER

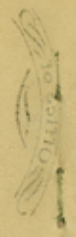



A. C. TACKETT,
—SURVEYOR OF—
KNOX LAND DISTRICT.

Benjamin, Tex., Sept 2^d 1889

Hon R M Hall

Cour Austin Tex

Dear Sir

I herewith Enclose you Sketch with Connection from
NW Cor of the Wise County School Land in Haskell Co.
to SW Cor of Knox County as Established by me in May 1888.
also Connection from the Dibrell and Alford Surveys
and The Mouth of Croton Creek. also Copy of an Order
of Commissioners Court. Ordering me to make the Connections
as required by your letter of May the 11th 1889.

Please file sketch and cert with Field Notes
of The S.B. Line of Knox County. and act on
them at your Earliest Convenience

Very Respectfully

A C Tackett Sur

Knox Land Dist