



General  
Land Office

AUSTIN, TEXAS 78701  
BOB ARMSTRONG, COMMISSIONER

Field Notes of The National Road fr.  
Dallas at the mouth of Elm Fork of  
Trinity to mouth of Kiamechi on Red  
River. July 15, 1845.

Geo. W. State, Sur.

K - 7 - 75 (Stell)

SEE HARTLEY'S DIGEST OF THE LAWS OF TEXAS  
ART. 2114 p. 653

Counter 65469

AN ACT

To open and establish a National Road.

*Yearey*  
Section 1. Be it enacted by the Senate and House of Representatives of the Republic of Texas in Congress assembled, That Jason Wilson, William M. Williams, of the county of Lamar, John Yearey, of the county of Fannin, Rowland W. Box, of the county of Harrison, and James Bradshaw, of the county of Nacogdoches, be, and they are hereby, appointed commissioners to view, mark, and lay out, a road to be called "The Central National Road of the Republic of Texas," from the main Trinity River, beginning at, or within, fifteen miles below the mouth of the Elm Fork of said stream; thence the nearest and best route to the bank of Red River, opposite the mouth of the Kiamisha.

Sec. 2. Be it further enacted, That George W. Stell, of the county of Lamar, be, and he is hereby, appointed a surveyor to survey and measure said road agreeable to the provisions of this act, and the directions of said commissioners.

Sec. 3. Be it further enacted, That it shall be the duty of said commissioners, so soon as they complete the marking of said road, or during the time they are performing that duty, to notify the surveyor of the same, whereupon it shall be the duty of said surveyor, so soon as he may receive such information, to proceed to survey and measure said road; beginning and measuring from the bank of said Trinity River, and shall erect mile-posts of good size, and number the same, and shall also note all water-courses over which said road shall pass, giving their width and general course; and when completed, it shall be the duty of said surveyor, or as soon thereafter as may be convenient, make out a complete map of said road, to be delivered to the said commissioners, and shall also transmit a copy of the same to the Commissioner of the General Land-Office, and it shall be the duty of said commissioners so soon as the said surveyor shall deliver to them a map of said road, to proceed to let out the cutting and opening said road by contract, and for the completion of which the said contractors or undertakers shall be paid in the public lands of the Government, in the manner hereinafter to be spe-

*See P. 1169*

*See P. 1167*

cified; provided, the whole amount for opening and superintending the opening of the road shall not exceed one hundred and sixty acres of land for each mile.

Sec. 4. Be it further enacted, That it shall be the duty of every person, or persons, who may take a contract, or contracts, upon said road to enter into bond and security in a sum equal to the supposed value of the land, which he, she or they shall be entitled to, for said work, payable to said commissioners and their successors, conditioned for the faithful performance of the contracts, on their respective parts, and provided, said contractors, or undertakers, should fail to comply with the contract, so made, he, she or they, shall forfeit and pay said amount, to be recovered before any court having jurisdiction thereof, and all such forfeitures shall, when collected, be appropriated to the use and benefit of the said road, but said bonds to be void upon condition that said undertaker, or contractors, do well and truly execute the work, agreeably to contract, in which event, it shall be the duty of the commissioners to issue a certificate to the one having completed the same, which shall be authority to the Commissioner of the General Land-Office to issue a patent for the same.

Sec. 5. Be it further enacted, That so soon as said road shall be viewed and marked, as heretofore provided, it shall not be lawful for any person, or persons, to locate any lands within five miles of said road, for the space of six months, except those who are engaged in the opening or superintending the same, and they shall only be entitled to locate such as they shall be entitled to, under the provisions of this act.

Sec. 6. Be it further enacted, That the surveyor shall be entitled to twelve hundred and eighty acres of land for surveying and performing other duties as heretofore required, to be located upon any of the unappropriated lands of this Republic, and a certificate assigned by a majority of said commissioners of his having performed all the duties of surveyor, as is by this act required, shall be full and legal authority for the Commissioner of the General Land-Office to issue a patent, or patents, for the same.

Sec. 7. Be it further enacted, That each hand, or assistant surveyor, engaged in the surveying said road, shall be entitled to six hundred and forty acres of land; provided, not more than five hands or assistants shall be engaged in said work,

to be located and patented in the same manner as provided for the principal surveyors; provided, that the principal surveyor shall certify to said commissioners that said assistant or claimant did well and truly perform the duties of assistant surveyor.

1872, 1911

Sec. 8. Be it further enacted, That each commissioner appointed or who may be appointed under the provisions of this act, shall be entitled to six hundred and forty acres of land; provided, that none but those who actually serve shall be entitled to the benefits of this section, to be located and patented in the same manner as provided in the preceding section, for the surveyor and his assistants: provided, they shall, before the Chief Justice of some of the counties of this Republic, make oath that he or they have performed the duties required of them, agreeably to the provisions of this act, in which case, the said Chief Justice shall certify to the facts as stated, or deposed, officially, which certificate, together with the certificate of at least one of the commissioners, shall be full authority for the issuing of patents for the same.

Sec. 9. Be it further enacted, That should either of the commissioners appointed by this act, fail or refuse to perform the duties, as herein required of him or them by this act, it shall be lawful for a majority of the same to appoint one in his stead, and should more than two fail or refuse to perform said duties, it shall be the duty of the Chief Justice of the county in which said defaulter resides, to appoint one in his stead, who shall have all the benefits and privileges that would, otherwise, have accrued to the original.

Sec. 10. Be it further enacted, That should the surveyor appointed by this act fail or refuse to perform the duties herein required, it shall be the duty of said commissioners to appoint one in his stead to perform the same, in which event he shall be entitled to all the benefits and privileges that would otherwise have accrued to the original.

Sec. 11. Be it further enacted, That in all cases, a majority of said Commissioners shall be deemed sufficient to transact any business, appertaining to the provisions of this act.

Sec. 12. Be it further enacted, That it may be lawful for said surveyor to make any survey, upon application, upon any claim, originating, under the provisions of this act, and

none other, and provided that said survey be connected to said road.

Sec. 13. Be it further enacted, That every person or persons taking a contract for the opening of said road, shall have a preference to locations, on one side of the road within the limits of their respective precincts, or contracts, but in no case shall any of the surveys, made under the provisions of this act, extend across said road, and provided also, that no survey made under the provisions of this act shall be for less than six hundred and forty acres.

Sec. 14. Be it further enacted, That it shall be the duty of the commissioners to specify in all contracts, made with individuals, for the opening of said road, to specify how said road shall be cleared out, the width of the same, which shall be at least thirty feet wide, and all stumps shall be cut within twelve inches of the surface of the earth, and that all bridges shall be at least fifteen feet wide, and built of good substantial materials, and all contracts shall be completed by the first day of January, one thousand eight hundred and forty-five.

Sec. 15. Be it further enacted, That no patents shall issue for any lands, granted under the provisions of this act, until all the work shall be completed as provided by this act, and a certificate of the fact, certified to by a majority of the commissioners, and deposited in the General Land-Office, shall be sufficient evidence of the work having been completed.

Sec. 16. Be it further enacted, That the foregoing section shall not be so construed as to prevent those who may be engaged in the opening, or superintending the surveying, marking and opening said road, from having the lands to which they would be entitled to, located; provided said work shall be completed, and that this act take effect from and after its passage.

Approved, February 5th, 1844.

Scale 4000 Vars pr inch

K-7-75

1

Central National Road

April 26<sup>th</sup> 1844 Beginning on a cedar on the East bank of the Trinity (said by Surveyor Lewis to be 5 miles below the mouth of the Elm Fork) Course  $N 41^{\circ} E$  470. Vars. Thence  $N 78^{\circ} E$  1165 N. Thence  $E 266$  V. to Post oak marked 1 mile. Course continued  $N 74^{\circ} N$  Thence  $N 30^{\circ} E$  crossing a large branch 8 feet wide at 594 N. Course  $S. E$  into Prairie at 600 V. in all  $1426 N$  to cedar post 2. Thence  $E 1901$  V. to cedar post  $N^{\circ} 3$  Thence  $S 84^{\circ} E$  1901 V. to cedar post  $N^{\circ} 4$ . Course continued into timber of White Rock at 523 V. crossing White Rock at 1260 V. 30 feet wide course nearly  $S$  into Prairie at 1616 V. in all  $1901 N$  to cedar post  $N^{\circ} 5$ . Thence  $N 30^{\circ} E$  crossing a small spring branch at 1117 V. course nearly  $S$ . Thence  $N 69^{\circ} E$  in all  $1901$  V. to cedar p  $N^{\circ} 6$ . Course continued  $1901$  V. to b. p  $N^{\circ} 7$ . continued  $1901$  V. to b. p  $N^{\circ} 8$  Course continued.  $1901$  V. to b. p  $N^{\circ} 9$  continued  $1901$  V. to b. p  $N^{\circ} 10$  continued  $1901$  V. to b. p  $N^{\circ} 11$ . continued  $1901$  V. to b. p  $N^{\circ} 12$  continued  $1901$  V. to b. p  $N^{\circ} 13$ . continued runs through a pine bushes near the west end of this mile in all  $1901$  V. to Mulberry post  $N^{\circ} 14$ . near the edge of the timber of a creek. Thence  $N 49^{\circ} E$  crossing a creek 20 feet wide <sup>into Prairie at 950 N</sup> course  $S. E$  \* at 600 V. in all  $1184$  V. Thence  $E 713$  V. to cedar p. 15. Course into  $975$  V. Thence  $S 85^{\circ} E$  926 V. to Locust post 16 in the edge of the timber off the East, or Bois d'arc fork, into timber and course continued to China tree <sup>75 feet wide course  $S. S. W.$</sup>  17. Thence  $E$  crossing the Bois d'arc fork at 1390. V. Thence  $S. 82^{\circ} E$  511 V. to an ash tree marked 18. near the edge of Prairie and on the bank of a small branch course  $S$ . Thence  $S. 45^{\circ} E$  285 V. Thence  $S. 78^{\circ} E$  368 V. Thence  $N 45^{\circ} E$  1284 to Elm post 19 this line crosses two small wet rather branches and runs toward the thickets. Course continued  $N 74^{\circ} N$ . Thence  $N 57^{\circ} E$  1426 V. to cedar post 20. Thence  $N 45^{\circ} E$  950 V. Thence  $S. 950$  V. to b. p. 21. continued  $N 1901$  V. to b. p 22. ~~this line crosses a wet rather stream~~ Thence  $N 10^{\circ} E$  677 V. Thence  $N 30^{\circ} E$  1214 V. to b. p 23. this line crosses 2 small wet rather streams. course  $S. W$  course continued  $1901$  V. to b. p 24. continued  $1901$  V. to b. p 25. continued  $1901$  V. to b. p 26. continued crosses two wet rather streams course  $S. W$  in all  $1901$  V. to b. p 27. ~~Thence  $N 33^{\circ} E$~~  continued  $N 74^{\circ} N$ . Thence  $N. 33^{\circ} E$  1426 V. to b. p. 28 This crosses two small wet rather streams. continued crossing a wet rather branch in all  $1901$  V.

\* This is not Rowlett's creek as marked on the Map. but is one known. Rowlett's creek mouth near the road and Middle fork 6 or 8 miles above

to C.P. 29. Continued crossing two small nut rather decays course S.W. in all 1901  
N to C.P. 30 Cont. 1901 N. to C.P. 31. Cont. 1901 N. to C.P. 32 each of the last miles  
cross two small nut rather decays course S.W. Cont. 1901 N to C.P. 33 Cont.  
crossing two small decays course S.E. in all 1901 N. to Mulberry post 34 Cont.  
crossing two small decays in all 1901 N to M.P. 35. Continued crossing small  
decays course S.E. in all 1901 N to M.P. 36. Continued 1901 N to M.P. 37  
with a narrow strip of timber 500 N including bushes  
Continued crossing a branch, 8 foot wide course S.E. in all 1901 N to M.P. 38  
Continued 380 N. Thence N 18° E 1527 N to M.P. 39. Cont. 1545 N near a branch  
8 foot wide course S.S.E. Thence N 45° E crosses the branch in all 1901 N. to  
M.P. 40. Cont. 71 N. Thence N 30° E 844 N. Thence N 22° E 986 N to M.P. 41  
the latter part of 40 and fore part of 41. is thick undergrowth but no good  
timber the hollow prairie continued in prairie course N 22° E 594  
Thence N 65° E <sup>1307</sup> 1397 to M.P. 42. Continued 1901 N. to M.P. 43 course cont.  
enters timber at 620 N. crossing a creek at 800 N. water 20 feet course S.S.  
E enters prairie at 950 N. in all 1901 N. to M.P. 44 Thence N 45° E  
crossing a small creek course N 22° S. at 1010 N timber about 200 yards  
wide in all 1901 N to C.P. 45. Continued open prairie to C.P. 46 Cont. to  
C.P. 47 Cont. 452 N Thence N 80° E enters timber at 345 N. crossing a nut  
rather branch at 293 N crossing a creek at 975 N course nearly S. water  
20 feet in all 1901 N to Louspost 48 in edge of prairie. Thence N 42° E  
1901 N to L.P. 49 Continued 1901 to L.P. 50 this line crosses a nut rather branch  
and runs through bushy prairie. course cont. 1901 N to C.P. 51 Thence N  
45° E through bushes and patches of prairie crosses a nut rather branch  
at 600 N in all 1901 N to a Fleckey tree mark 52 in the timber of the  
low back fork of the Sabine. Cont. crossing the low back fork at  
236 N. water 25 feet course S.S.E. crosses a creek at 950 N. water 15 feet course  
nearly S. enters prairie at 1426 N. in all 1901 N to P.O. P. 53 Thence N 38°  
E. 1901 N to 54 Thence N 1901 N to L.P. 55 Continued 1901 N to L.P. 56 continue  
crossing 3 small nut rather decays course S.E. in all 1901 N to C.P. 57 Thence  
N 45° E crosses a nut rather branch at 1200 N, in all 1901 N to Slipping Elm P  
58. Continued 1343 N. Thence N 65° E 558 N to C.P. 59. Cont. 4940. Thence N 45° E  
enters timber at 605 N in all  
1307 N to Post oak tree 60. Cont. 475 N N 10° E crosses South sufferer at 910  
water 20 feet course S.E.  
in all 1901 N to Post oak tree 61. Thence N 45° E crosses a small creek  
at 950 N water 10 feet course nearly S. enters prairie at 1723 N. in all 1901 N to P.O. P. 62  
K 7.75 course 65475

Course continued into timber at 700 N crossing a small creek at 940  
 N water 6 feet course nearly S. into Prairie at 975 N in all 1901 N to P.O.P. 63  
 Cont. into timber at 1307 N crossing a large branch at 6 feet wide course nearly  
 S. at <sup>1550</sup> 1550 N. into small Prairie at 1780 N in all 1901 N to P.O.P. 64 Cont.  
 into timber at 130 N. crossing a large branch course nearly S. 7 feet wide at 590  
 N into Prairie at 700 N. timber at 1190 N crossing a large branch 5 feet wide.  
 course nearly S. at 1320 N into Prairie at 1400 N. in all 1901 N to P.O.P.  
 65 Cont. in Prairie 1901 N to China Post 66. Cont. into timber at 960 N crossing  
 a large branch 6 feet wide course nearly S. at 1260 N on other the size and  
 course the same at 1806 N in all 1901 N. to Red oak 67. Cont. crossing on other  
 large branch about the same size and course of the other two at 90 N  
 into Prairie at 360 N. in all 1901 N to Gum Elastic Post 68. Thence  
 N 70° E crossing a small branch course S. E. at 1664 N in all 1901 N to Slipping  
 Elm Post 69. Cont. crossing a nuttallian branch at 1000 N. narrow strip of  
 timber course S. in all 1901 N. to Red oak post 70. continued 1901 N. to P.O.P.  
 71. continued crossing a nuttallian branch at 1200 N. course S. E. in all 1901 N  
 to Elm post 72. (3 or 4 of the last branches are only nuttallian decous with  
 narrow skirts of timber otherwise it is open Prairie from M.P. 67 to 76.)  
 continued 1901 N. to Slipping Elm Post. 73. continued 1901 N. to P.O.P. 74. Cont.  
 1901 N to Dogwood Post 75. Cont. 1343 N. Thence N 55° E to Elm Post 76. near  
 the edge of timber of the N. Sulphur. Thence N 10° E passing some timber and  
 small Prairie in all 1901 N to Spanish oak 77. Thence N 13° E crossing the  
 N. Sulphur at 785 N. course nearly East water 25 feet (Bridge over 90 feet)  
 in all 1901 N. to Black oak marked 78. Thence N 25° E crossing two nut  
 tallian branches ~~and into~~ into Prairie 1200 N in all 1901 N. to P.O.P. 79. Course  
 continued in Prairie crossing a nuttallian branch at 590 N. course S. E. has  
 a narrow skirt of timber. in all 1901 N to P.O.P. 80. continued into a  
 thicket at 1780 N. in all 1901 N to Pepperwood marked 81. continued 428 N.  
 N 45° E crossing Carby's Creek 18 feet wide at 594 N. course E. S. E. in  
 all 1901 N. to Hackberry marked 82. Cont. crossing a nuttallian branch at 430 N  
 into Prairie at 610 N. in all this course 1474 N. Thence N 60° E into timber  
 1832 in all 1901 N to a Boisdore tree N 83. Cont. crossing Richland Creek 18 feet wide  
 Course S. E. at 660 N crossing a nuttallian branch at 1200 N. in all 1901 N. to an  
 Ash tree marked 84. Cont. 226 N. at which we strike Prairie. Thence N 58° E 1901 N to  
 K-7-75 coursed 65476



Bois d arc post 85. Cont. into timber at 226 N. crosses others. Crk at 430  
 N. course nearly S. 12 ft wide. into Prairie at 785 N. in all this course 1575

Thence N 65° E in all 1901 N. to S.O. p 86. Cont. into timber at 357 N. crosses  
 Woods Crk at 500 N. course nearly S. 10 ft wide. into Prairie at 574 N  
 at 1000 N. a small Prairie course nearly S. and small strip of timber in all  
 1901 N. to Bois d arc post 87. Cont. at 536 N. a branch 6 ft wide course nearly  
 S timber here 238 N wide in all 1901 N. to Mulberry post 88. Cont. 1901 N. to Louis  
 post 89. (some thickets in this mile) Cont. crosses Thimbles Crk 8 ft wide  
 course nearly S. at 1272 into Prairie 1569 in all 1901 N. to Slipping Elm post  
 90. (3/4 of this mile is thickets) Cont. crosses a small crk or large branch  
 at 1327 N course nearly S. a smaller one at 1604 N. in all 1901 N. to an Elm  
 tree 91. (this mile all thickets some lumber) Cont. into Prairie at 416 N in  
 all 1901 N. to S.O. p 92. Cont. 1901 N. to S.O. p. 93. Cont. crosses a mt within branch at  
 1462 N. in all 1901 N. to S.O. p 94. Cont. crosses two mt within branches in all 1901 N  
 to S.O. p 95. Cont. 1070 S. Thence N 48° E. in all 1901 N. to S.O. p 96 (some bushes and  
 small Row. in this mile) Cont. 1901 N. to S.O. p 97 continued crosses a branch at  
 547 N course S. E (small mt within with a remnant strip of timber) in all 1901 N  
 S.O. p 98. Cont. 1901 N. to S.O. p 99. Cont. 1794 N. Thence N 75° E 103 N. in all 1901 N  
 to Red oak marker 100. Thence N. 81° E 679 N. Thence due E 832. Thence N 68° E  
 391 N to a black oak marked 101. Cont. 535 N. Thence N 59° E 962 N. Thence  
 N 50° E 404 N in all 1901 N. to a Red oak 102. Cont. 1901 N. to Post oak Post  
 in a narrow strip of Prairie. Cont. crosses a small branch at 550 N. course nearly S  
 and into a small Prairie at 594 N in all 1901 N. to Black Lacks near the  
 edge of Prairie. Marker 104. Cont. cross 3 small drains course nearly E in  
 all 1901 N. to Post oak 105. continued crosses several small Prairies course E  
 to N.E. in all 1901 N. to Post oak 106. Thence N 65° E 832 N. Thence 55° E  
 950 N. Thence N 50° E 119 N in all 1901 N. to Red oak 107. This line crosses a  
 Slough at 300 N. a crk at 360 N. course N.W. to N.E. 15 ft wide. Cont.  
 713 N. Thence N 45° E 511 N Thence N 40° E 677 N. to P.O. 108. This crosses  
 B. cal's crk at 1220 N. course N.W. to N.E. 15 ft wide. Thence N 64° E  
 1290 N Thence N 48° E 606. to Fleckey 109. <sup>Thence N 50° E</sup> Cont. and 1354 N. crosses Matthews  
 crk at 317 N. course N.W. to N.E. 15 ft wide. into Prairie at 1354 N. in all 1901  
 N. to post oak post 110. <sup>Thence N 45° E</sup> Cont. in Prairie 1901 N. to P.O. P. 111. Cont. into timber  
 at 400 N in all 1901 N. to a P.O. tree 112. Cont. crosses 3 small Prairies line  
 nearly E. in all 1901 N. to P.O. tree 113. Cont. 416 N. Thence N 40° E in all 1901 N  
 to Red oak 114. This crosses Grog branch 4 ft wide course nearly East at 220 N.



You will observe, there are 7 assistants instead of 5 allowed by Law. The reason is this, some of them could not remain on the Road all the time, and therefore got others to aid them a part of the time, and agreed to divide time and load, and they are considered jointly as making one hand. And the certificates are issued jointly, making five whole hands in all.

Geo. W. Still S. C. N. D.

K-7-75

7.  
Map of the work done on the National Road

Explanations, The surveys are marked with the initials of the men names, and the Commissioners, Assistant hands, and the undertakers of the Road are distinguished thus Commissioners N.C. and goes on to N.4. The hands are numbered separate and are marked N.1st for assistant hands and goes on to N.5. The undertakers of the Road are marked N.1 for undertaker and continues to the number of surveys made for them

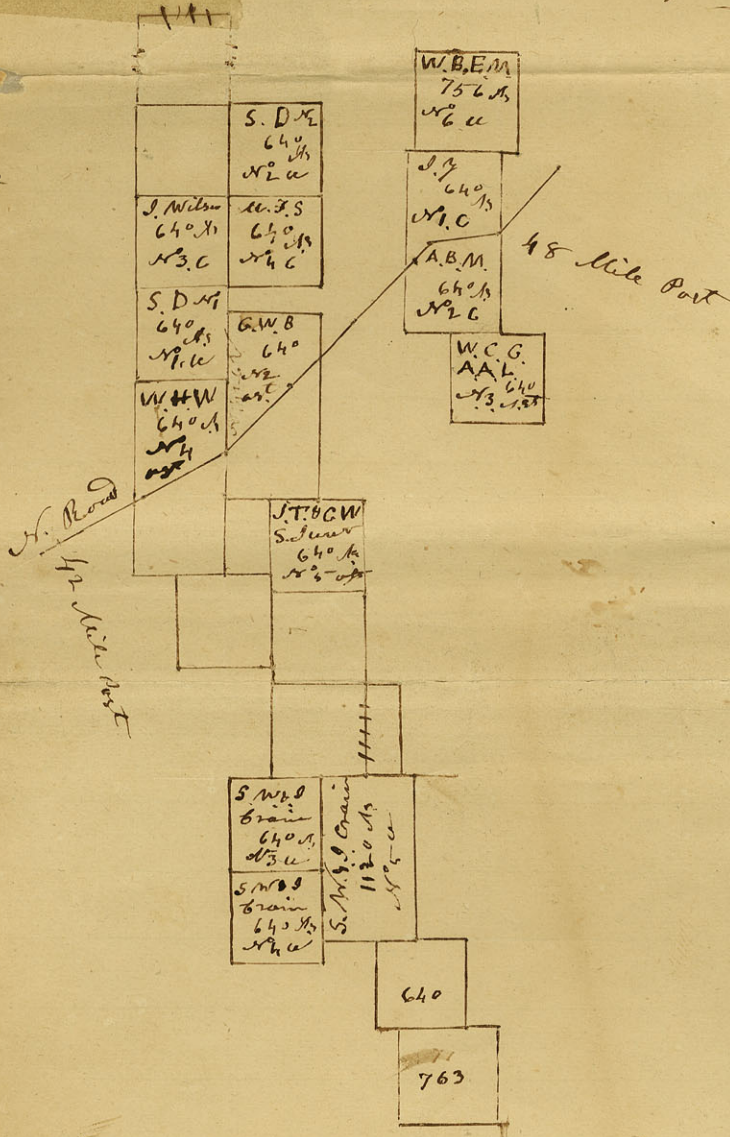

I believe this Map contains all the surveys made near this place, for Comrs hands and undertakes, But they are so widely scattered, I cannot at this moment mark all the surveys with the owners names. The Colony line crosses the Road some where near the 4 1/2 Mile post, this line cuts off some 12 miles of Lawrence City and some of the surveys on the N. of the Road had been surveyed, as we all believe after we drew the Road and as that was illegal we surveyed for the hand &c

Explanation each mile post is marked with the kind of timber

Thus C.P. Cedar Post

M.P. Mulberry Post

L.P. Locus Post &c

Scale 4000 Bars per inch

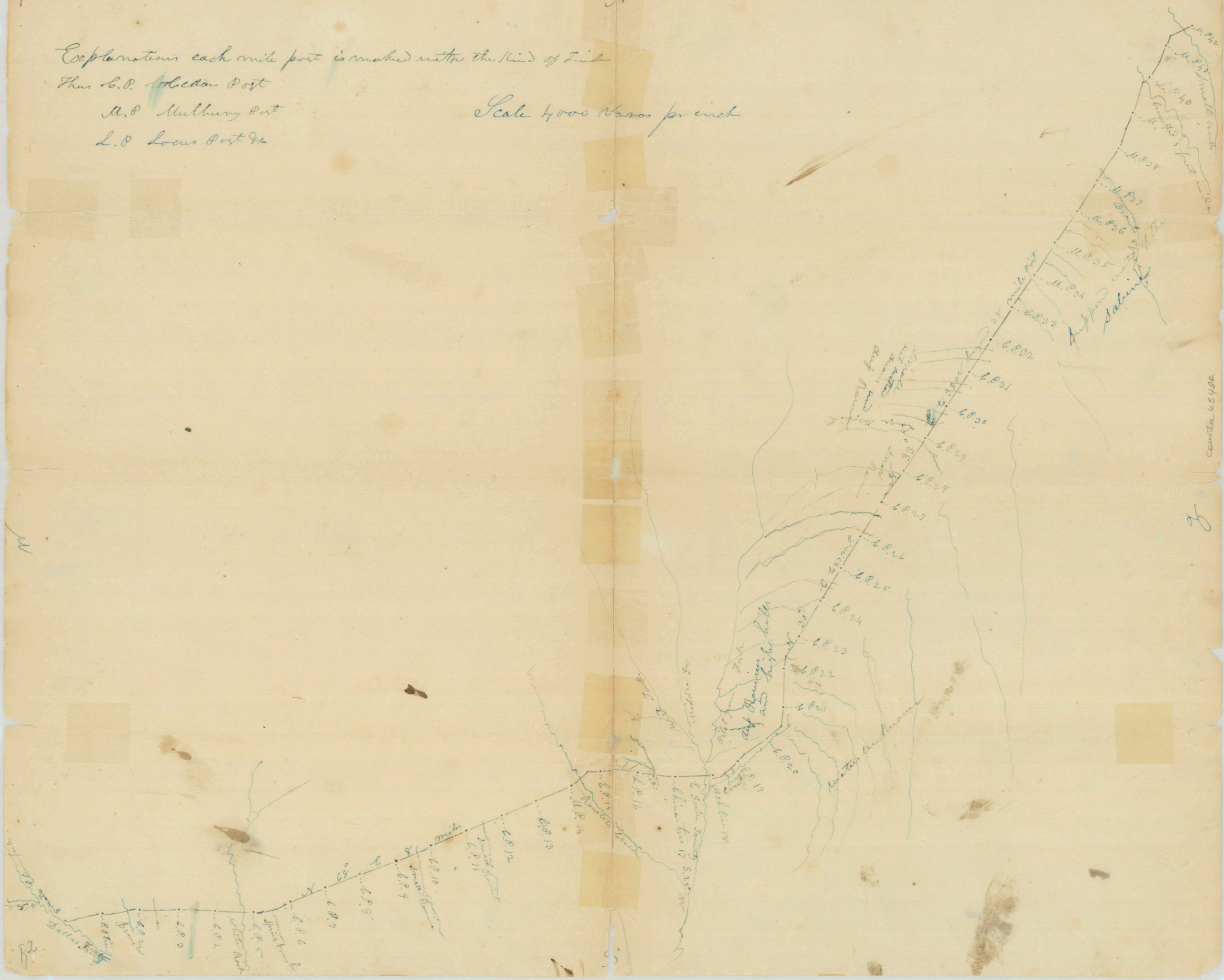

W 2

course continued from M.P. 43.64. E to M.P. 44 Thence N 45° E to 452 N beyond  
 M.P. 47 Thence N 80° E to Clin Post 48 Thence N 42° E to M.P. 51. Thence N 45° E to M.P.  
 52 Thence N 38° E to L.P. 54. Thence N. to M.P. 57. Thence N 45° E to 1343 N. beyond 58 M.P.  
 Thence N 65° E to 594 N. beyond 57 M.P. Thence N 45° E 1307 N to Post oak tree 60. Cont'd N 70°  
 E Thence N 10° E to P.O. tree 61. Thence N 45° E. to Gunclaster P. 68. Thence N 70° E  
 to 1343 N beyond M.P. 75. Thence N 55° N. Thence N 50° W 1901 N to ~~Point~~ oak  
 77 Thence N 13° E 1901 to B.O. 78. Thence N 25° E to P.O. 79. Cont'd to 80 M.P.

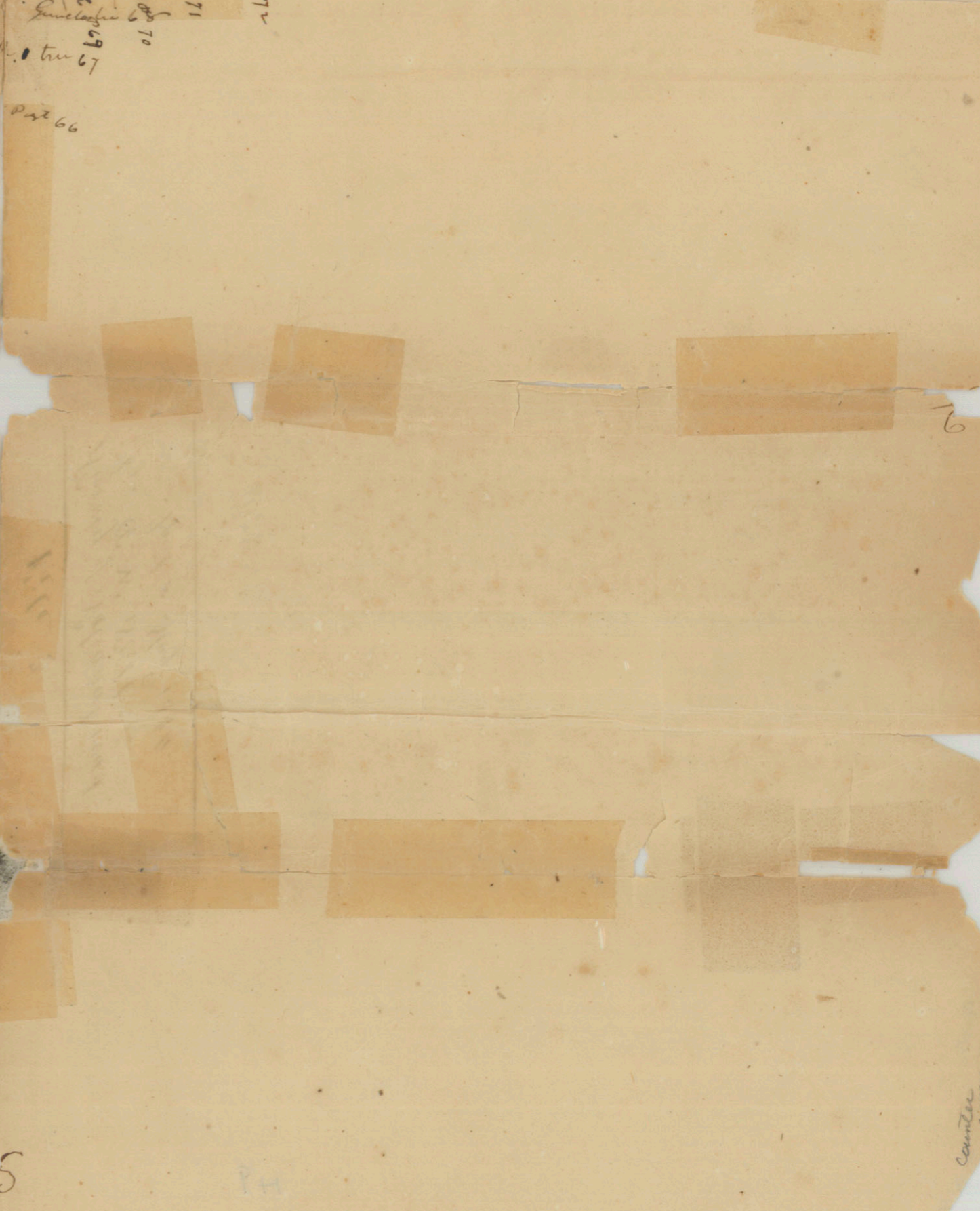
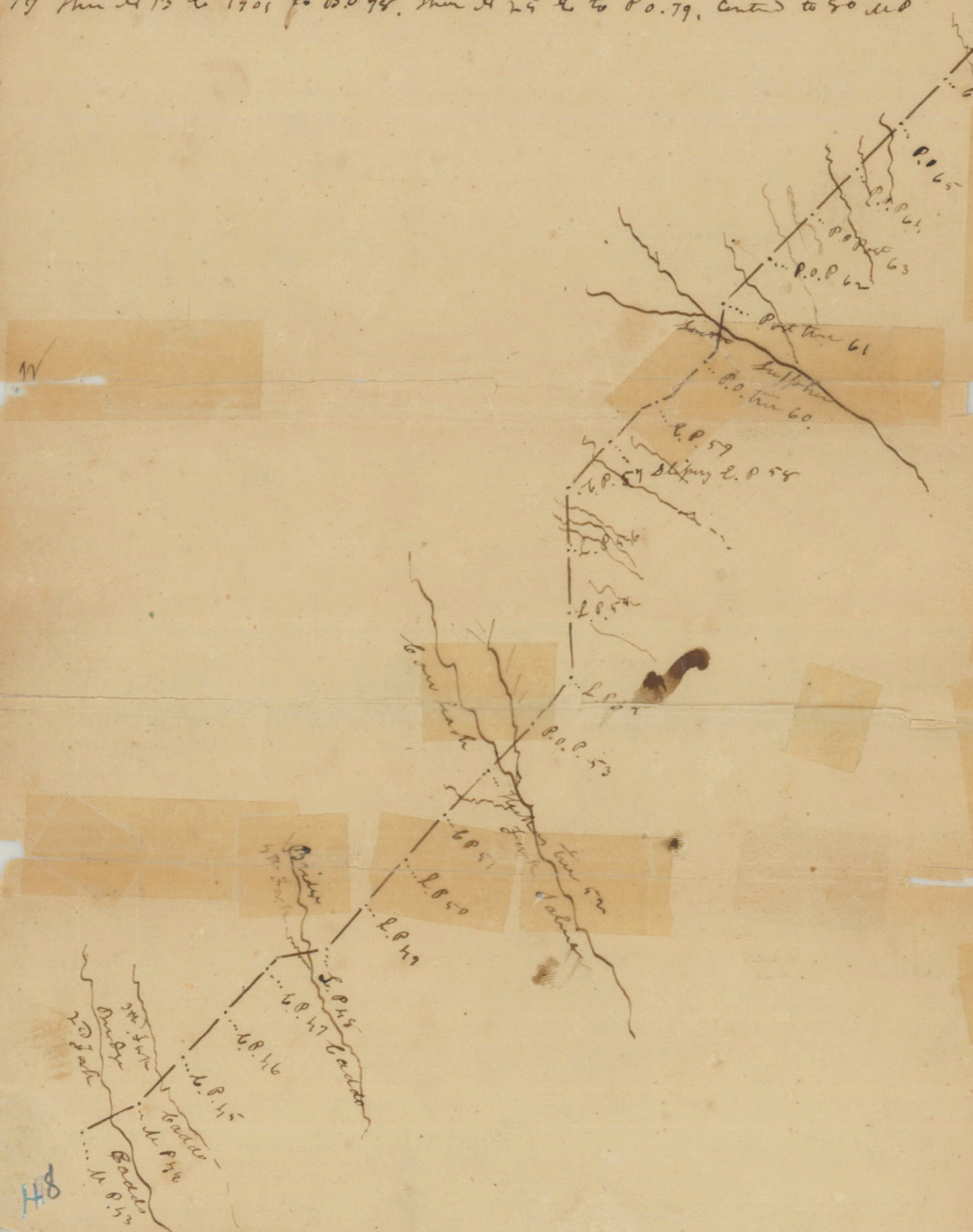

H8

Counten 68804

W  
ca. 1848



3

8



Counter 65485

3

5

R3



*[Faint handwritten notes, possibly bleed-through from the reverse side]*

*File-3.*

*Survey of National road  
by G. W. Still  
April & May 1844.*

K-7-75

69

12

Count  
65485