

OF
2008
08-05-15
CONV. LOTTED & RECH. NO.
M16662

SECTION 5
LAURELES FARM TRACTS
VOL. 3 PG. 15
SECTION 6
LAURELES FARM TRACTS
VOL. 3 PG. 15

GRADED ROAD
COUNTY ROAD
2640.00'

NORTH HALF - SECTION 6
LAURELES FARM TRACTS
VOL. 3 PG. 15

SOUTH HALF - SECTION 6
284.84 ACRES

NORTH HALF - SECTION 7
LAURELES FARM TRACTS
VOL. 3 PG. 15

OWNER:
WILLIAM B. NICHOLSON
BANK TRUST TOWER
CORPUS CHRISTI, TEXAS

I, GEORGE M. PYLE, LICENSED STATE LAND SURVEYOR, DO HEREBY
CERTIFY THAT THE FOREGOING SURVEY WAS MADE BY ME ON THE
GROUND AND THAT THE LIMITS, BOUNDARIES AND CORNERS, NATURAL
AND ARTIFICIAL ARE TRULY DESCRIBED HEREON TO THE BEST OF MY
KNOWLEDGE THERE IS NO ARTIFICIAL FILL OR ACRETION LOCATED
WITHIN THE BOUNDARY SURVEYED.
BY: George M. Pyle
GEORGE M. PYLE
R.P.S., L.S.L.S., P.E.

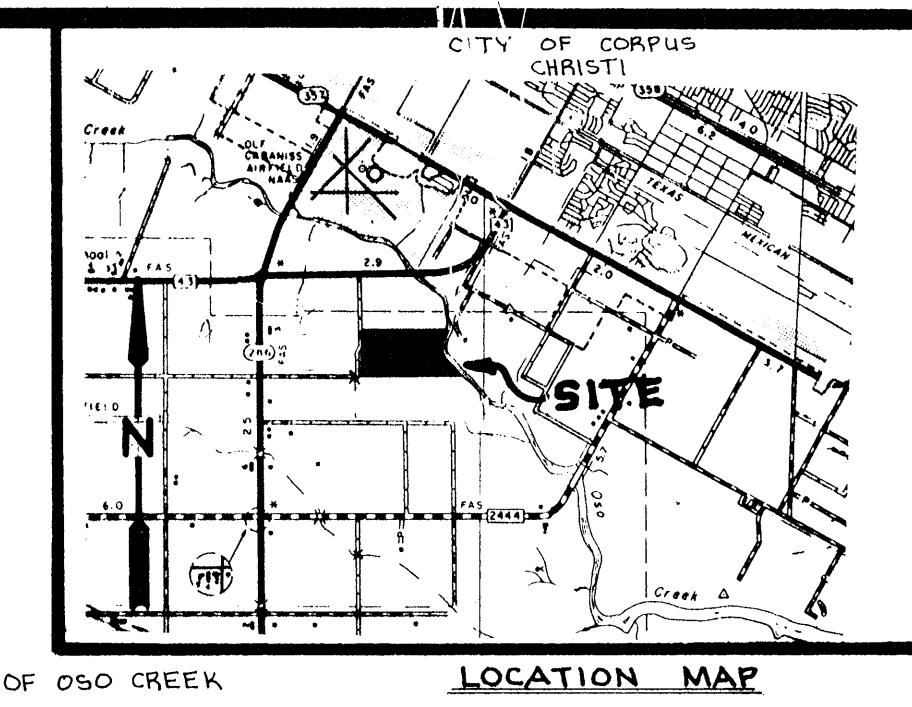

MAP NORTH
(FROM MAP OF
LAURELES FARM TRACTS)

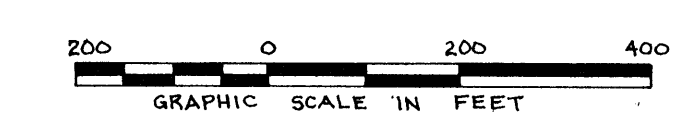

REV. BY	DATE	DESCRIPTION	APPROVED
URBAN ENGINEERING CORPUS CHRISTI, TEXAS			
BOUNDARY SURVEY OF			
THE SOUTH HALF OF SECTION 6, LAURELES FARM TRACTS, A MAP OF WHICH IS RECORDED IN VOLUME 3, PAGE 15, MAP RECORDS OF NUECES COUNTY, TEXAS.			
DRAWN BY: J.S.		SCALE: 1" = 200'	JOB NO: 16020-01
CHKD BY: [Signature]		DATE: 2-27-20	SHEET: 1 OF 1

ROLLED SKETCH NO. 70
COUNTY: NUECES

BIRY 2

BIRY 2

1" = 200' F

31 X

D-17





ROAD CLASSIFICATION
 Primary highway, all weather, Light-duty road, all weather,
 Improved surface, Improved surface,
 Secondary highway, all weather, Unimproved road, fair or dry
 weather, weather,
 hard surface, hard surface,
 State Route State Route

QUADRANGLE LOCATION

OSO CREEK NW, TEX.
 NW 1/4 OSO CREEK, IS QUADRANGLE
 N2737.3—W9722.377.5
 1968

AMS 6559 III NW—SERIES 1682

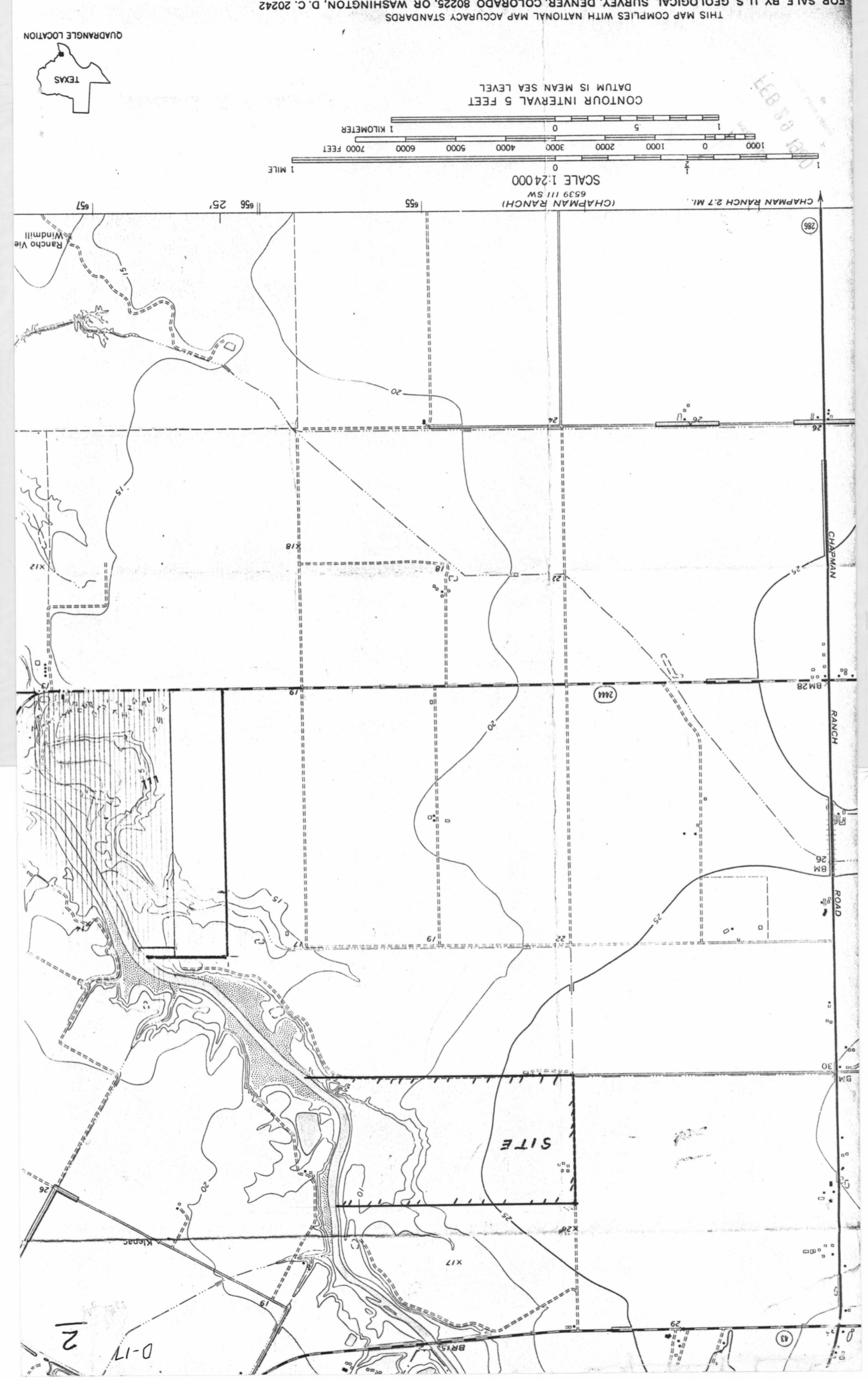

ROAD CLASSIFICATION
 Heavy-duty, Light-duty, Improved dirt
 Medium-duty, U.S. Road, State Road

OSO CREEK, TEX.
 N2730-9715/15
 1961

Nixon Blue Print Co.
 Phone T92-6891, P. O. Box 407
 Corpus Christi, Texas

DEPT. QUARTER AND SOUNDINGS IN FEET—ELEVATION IS MEAN LOW WATER
 SHOWING THE WATERSHED OF THE AREA AND THE LOCATION OF THE
 POINTS OF INTEREST AND THE LOCATION OF THE QUADRANGLE

FOR SALE BY U. S. GEOLOGICAL SURVEY, FEDERAL CENTER, DENVER, COLORADO OR WASHINGTON 25, D. C.

