

2881, 1, 180100
 2881, 1, 180100
 2881, 1, 180100

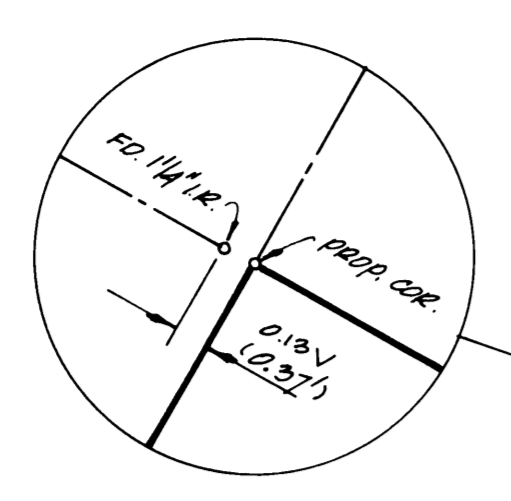

BUCKINGHAM
 ESTATES UNIT 1
 VOL. 48, PAGES 37-39

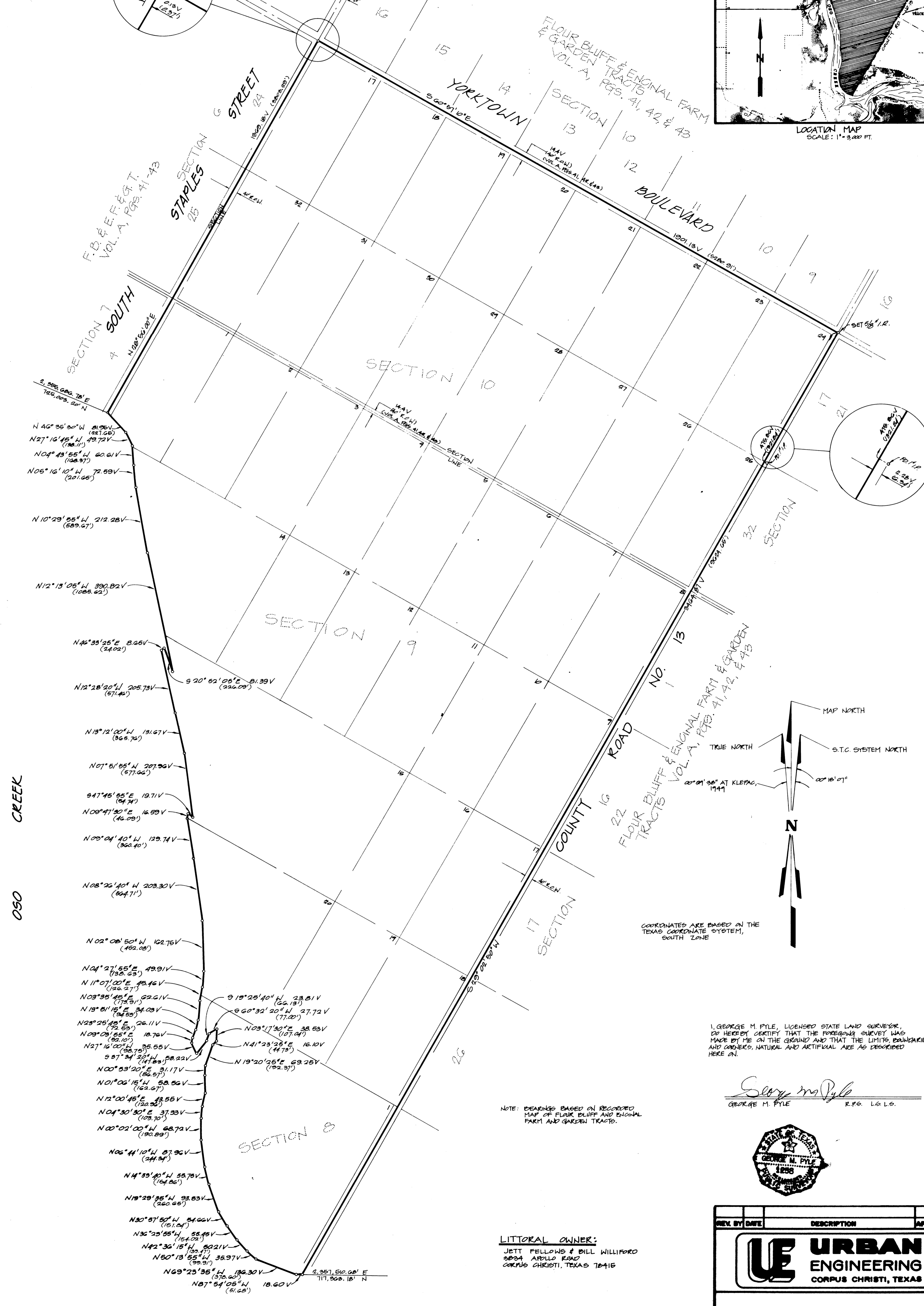
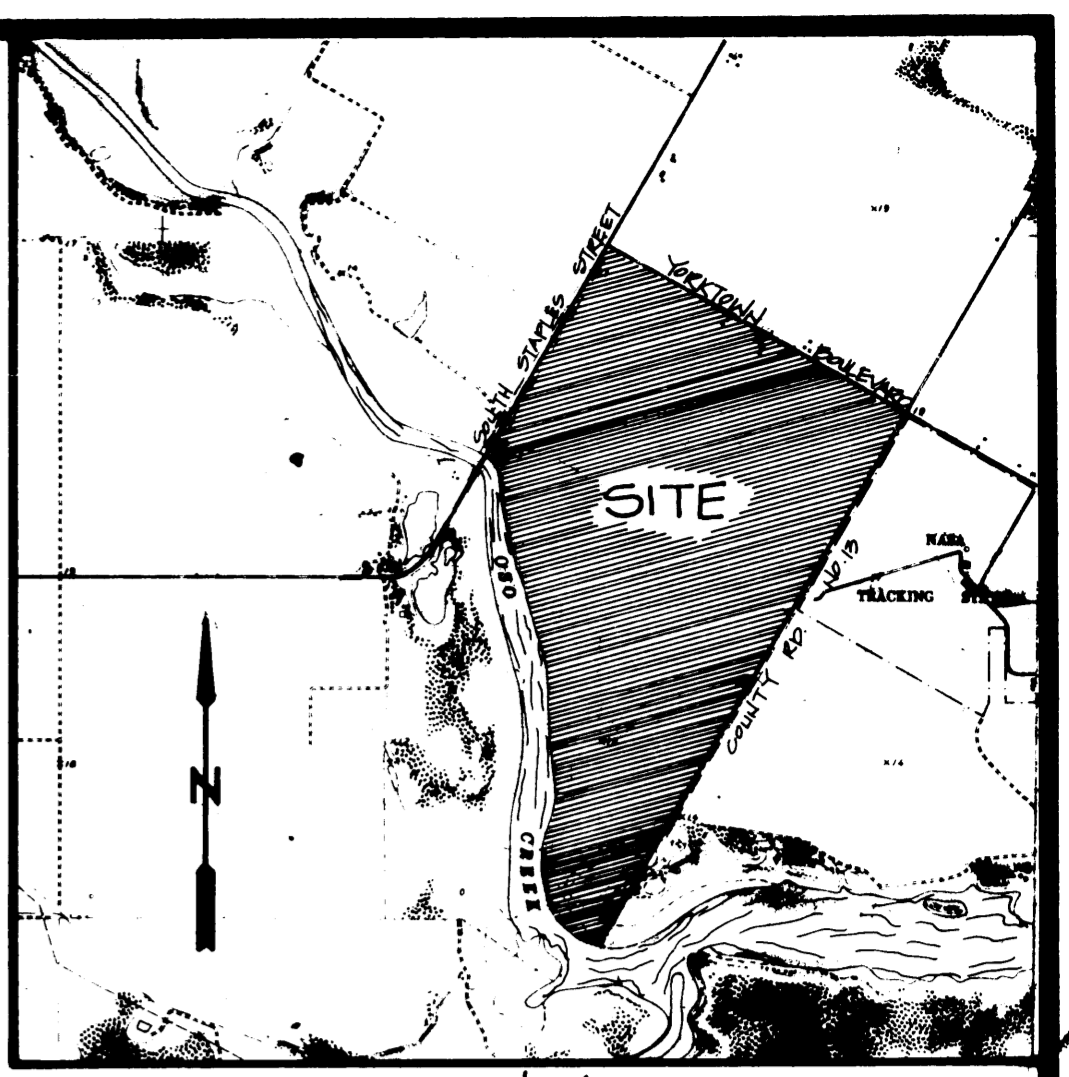

CREEK
 OSO

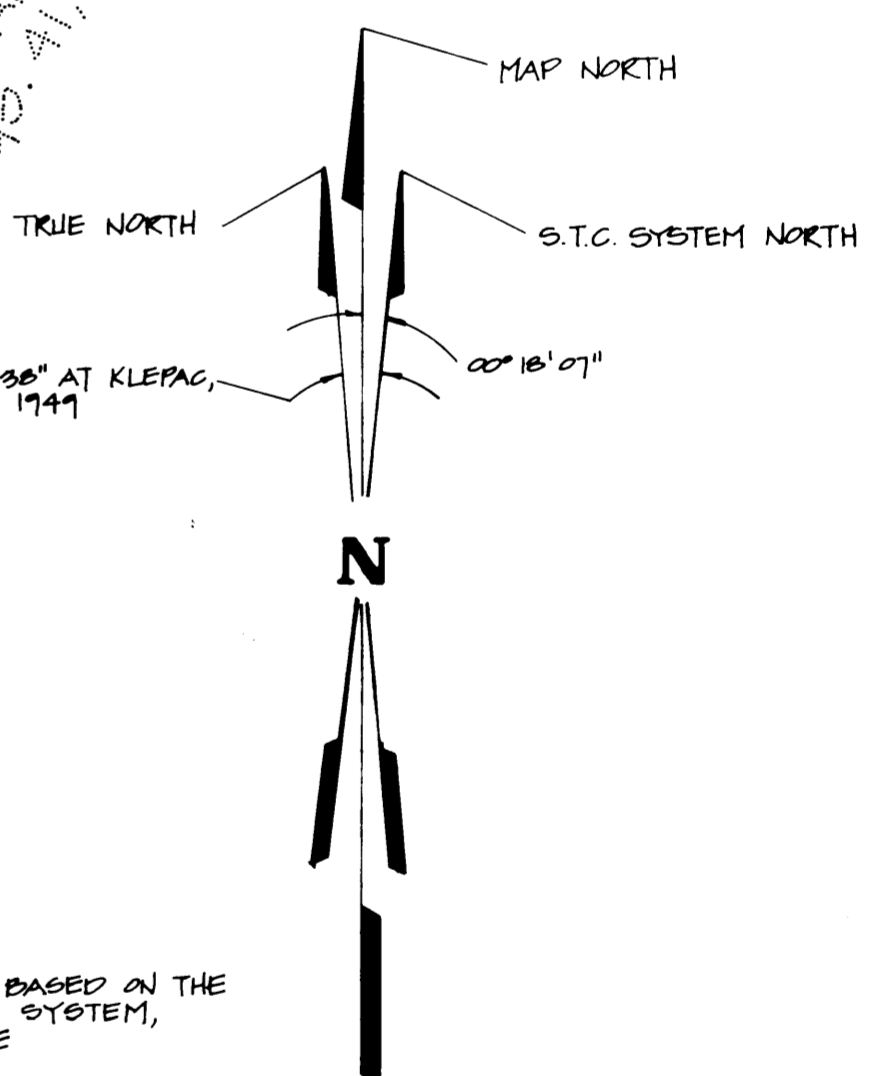

COORDINATES ARE BASED ON THE TEXAS COORDINATE SYSTEM, SOUTH ZONE

I, GEORGE M. PYLE, LICENSED STATE LAND SURVEYOR, DO HEREBY CERTIFY THAT THE FOREGOING SURVEY WAS MADE BY ME ON THE GROUND AND THAT THE LIMITS, BOUNDARIES AND CORNERS, NATURAL AND ARTIFICIAL ARE AS DESCRIBED HERE ON.

George M. Pyle
 GEORGE M. PYLE R.P.S. L.S.



NOTE: BEARINGS BASED ON RECORDED MAP OF FLOUR BLUFF AND ENONAL FARM AND GARDEN TRACTS.

LITTORAL OWNER:
 JETT FELLOWS & BILL WILLIFORD
 2804 ARELLO ROAD
 CORPUS CHRISTI, TEXAS 78416

REV. BY	DATE	DESCRIPTION	APPROVED
 URBAN ENGINEERING CORPUS CHRISTI, TEXAS			
SURVEY OF			
643.94 ACRES OF LAND OUT OF LOTS 17-32, SECTION 10, ALL OF FRACTIONAL SECTION 9, AND ALL OF FRACTIONAL SECTION 8 FLOUR BLUFF AND ENONAL FARM AND GARDEN TRACTS, A MAP OF WHICH IS RECORDED IN VOLUME A, PAGES 41, 42, & 43, MAP RECORDS OF NUECES COUNTY, TEXAS.			
DRAWN BY	D.G.	SCALE: 1" = 400'	JOB NO: 2284.02
CHECKED BY	D.W./A.E.	SHEET: 1	OF: 1

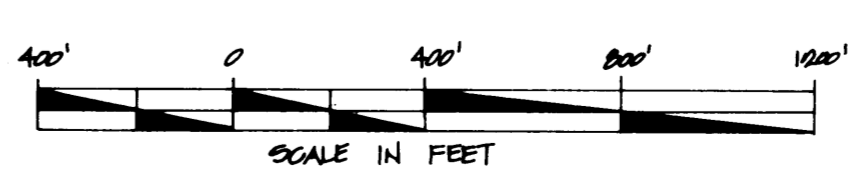

Received 10-7-1983 Rolled Sheet 93 D-134

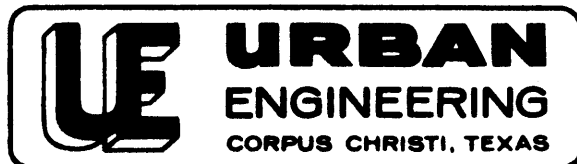

854-3101 P. O. BOX 6365 78411 2726 SWANTNER

141
RECEIVED
NOV 5 1980

Job No.

General Land Office

November 4, 1980

Mr. Herman Forbes
General Land Office
Austin, Texas 78701

Dear Herman:

I have been requested to perform a Gulf shoreline survey on the property hatched or crosshatched in red on the accompanying sketch.

Larry Urban has told me that he talked to you about this property sometime during the summer of 1980 and that at that time you told him that the State Land Office has no interest in any portion of this land. If that is the position of the Land Office, I am requesting to be so informed. The cross-hatched area on the accompanying sketch is accreted land and some of it has water on it.

The owners have instructed me to submit a survey showing the Gulf shoreline boundary only, which I do not feel I can do without knowing the Land Office position on the accreted land to the west of the William Bryan Survey line.

Respectfully yours,

URBAN ENGINEERING

George M. Pyle, L.S.L.

GMP:ak
Enc.

and
11-5-80

11-6-80
talked with Geo. Pyle.

10-05-83

HERMAN:

I have not been able to get a copy of Exhibit 7 as shown on page 1 in leaving for vacation on Thursday and will not have it. You already have a copy of it in the last survey I sent you.

OO- Job 20229-01. It is Glassa Lamm 9882-17
I will forward copy and end of Newark to this file.

Jay

141

October 21, 1983

Urban Engineering
P. O. Box 6355
Corpus Christi, Texas 78411

Attention: George Pyle

Re: Your job No. 20354.02 - Gradient
boundary survey of portion of
N. bank Cayo del Oso, Tract
F, Nueces County.

Gentlemen:

The gradient boundary survey along a portion of Cayo del Oso, Tract F, fronting on Fractional Sections eight and nine, Flour Bluff & Encinal Farm & Garden Tracts, as shown on the plat and exhibits submitted with your letter and report dated October 3, 1983, is accepted as the correct location for the gradient boundary.

The papers and plats are filed in this office as Rolled Sketch No. 93 in Nueces County.

Sincerely yours,

Herman Forbes
Director, Surveying Division

HF/dc

D-134

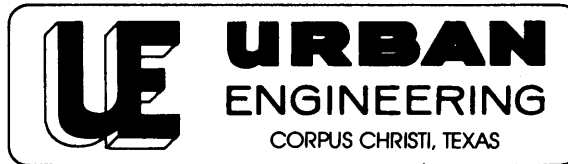

Job No. 20354.02

P.O. BOX 6355, 2725 SWANTNER
CORPUS CHRISTI, TEXAS 78411 PHONE 854-3101

October 3, 1983

Gary Mauro, Commissioner
General Land Office
1700 North Congress Avenue, Room 812
Austin, Texas 78701

Attention: Herman Forbes, Director
Surveying Department

Report on shoreline survey of 843.96 acres of land out of Section 10 and Fractional Sections 9 and 8, Flour Bluff and Encinal Farm and Garden Tracts, Nueces County, Texas.

This tract adjoins Cayo Del Oso, Tract F and this report and the accompanying survey with exhibits are being submitted for the purpose of obtaining General Land Office approval of the gradient boundary of Oso Creek.

EXHIBITS

1. Portion of recorded plat of Flour Bluff & Encinal Farm & Garden Tracts.
2. ASCS Aerial Photo BRE-2G-193 dated February 7, 1950
3. ASCS Aerial Photo BRE-3G-19 dated February 13, 1950
4. Portion of Oso Creek Northwest Texas, Quadrangle, 1951
5. ASCS Aerial Photo BRE-5P-191, dated March 16, 1956
6. ASCS Aerial Photo BRE-3BB-57, dated January 15, 1961
7. Glasson Lammon Photo 9882-13 dated October 14, 1982

This survey is East of and adjoining a Survey of 267.49 acres of land which was submitted to you on September 7, 1983. You have not approved the 267.49 acre tract as yet and have requested an explanation of how I established the gradient boundary. I am herewith submitting an addendum to this report which applies also to the abovementioned 267.49 acre tract, a 315.20 acre tract which you approved on August 26, 1983 and filed as Nueces County Rolled Sketch No. 89 and a survey which you approved by letter dated March 4, 1980 and filed as Nueces County Rolled Sketch No. 70.

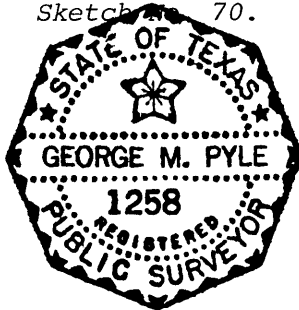

URBAN ENGINEERING
George M. Pyle

George M. Pyle,
R.P.S. L.S.L.S.

D-134

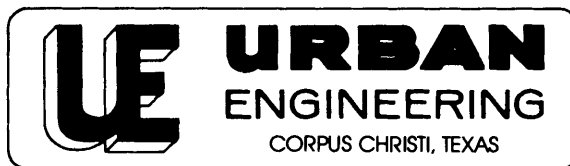

Job No. 20354.02

P.O. BOX 6355, 2725 SWANTNER
CORPUS CHRISTI, TEXAS 78411 PHONE 854-3101

October 3, 1983

ADDENDUM

Addendum to report on shoreline survey of 843.96 acres of land out of Section 10, and Fractional Sections 9 and 8, Flour Bluff and Encinal Farm and Garden Tracts, Nueces County, Texas.

[This addendum also applies to Urban Engineering Job 16030 (approved by the General Land Office by letter dated March 4, 1980 filed as Nueces County Rolled Sketch No. 70), Urban Engineering Job 19780 (approved by General Land Office by letter dated August 26, 1983, filed as Nueces County Rolled Sketch No. 89) and Urban Engineering Job 20229.01 submitted to General Land Office by letter dated September 7, 1983 but awaiting approval pending the submission of this addendum].

The report for the survey filed as Nueces County Rolled Sketch No. 70 states that I found 4 typical banks measuring from 0.6 feet to 1.0 foot high and the locations were spotted on one of the exhibits. These banks are almost vertical with the water being close to the toe of the bank. The water level through this area is fairly constant at elevation 2.2 feet N.G.V.D. with very little fall through the four surveys. (On July 11, 1982 water level at upper end on Weber was 2.34 feet and on August 16, 1982 water level was 2.1 at lower end by Rodd Field) On Job 16030 I used Bank "D" which was 0.8 high with water at the toe and gradient 0.4 above the water. The gradient for Job 19780 was established from Bank "B" which was 1.0 foot high with the water at the toe. The elevation of this line was found to be 2.7 feet, N.G.V.D. and the other surveys were run at this elevation since there is practically no fall in the gradient.

URBAN ENGINEERING

George M. Pyle
R.P.S. L.S.L.S.

GMP/crm

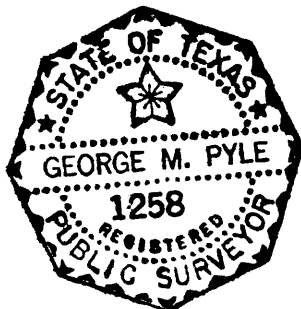

D-134

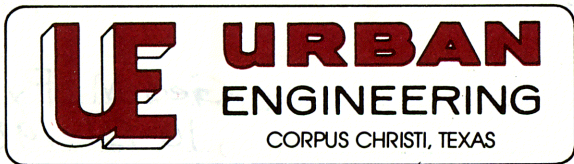

Job No. 20354.02

P.O. BOX 6355, 2725 SWANTNER
CORPUS CHRISTI, TEXAS 78411 PHONE 854-3101

October 3, 1983

Gary Mauro, Commissioner
General Land Office
1700 North Congress Room 812
Austin, Texas 78701

Attention: Herman Forbes, Director
Surveying Division

Dear Herman:

I am herewith transmitting a survey of 843.96 acres out of Sections 10, 9 and 8, Flour Bluff and Encinal Farm and Garden Tracts in Nueces County, Texas, along with a report and 7 exhibits. Also attached is an addendum to this survey and to three others previously submitted, one of which you already approved. They are Job 16030, filed as Nueces County Rolled Sketch No. 70, Job 19780 filed as Nueces County Rolled Sketch No. 89 and Job 20229.01, a survey of 267.49 acres submitted by letter dated September 7, 1983.

Sincerely,

URBAN ENGINEERING

George M. Pyle
R.P.S. L.S.L.S.

GMP/crm
Enclosures

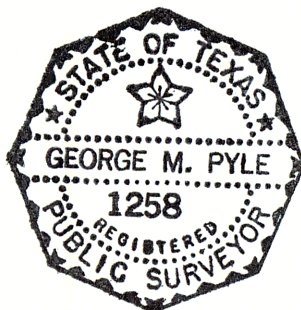

D-134

2-7-'50

45

BRE-2G-193

NO. 2
1"=1320'

843.96 AC.



2-13-'50

45

BRE-3G-19

D-134

NO. 3

1"=1320

843.96 AC.



3-16-56

BRE-5P-191

NO. 5

45

41-583

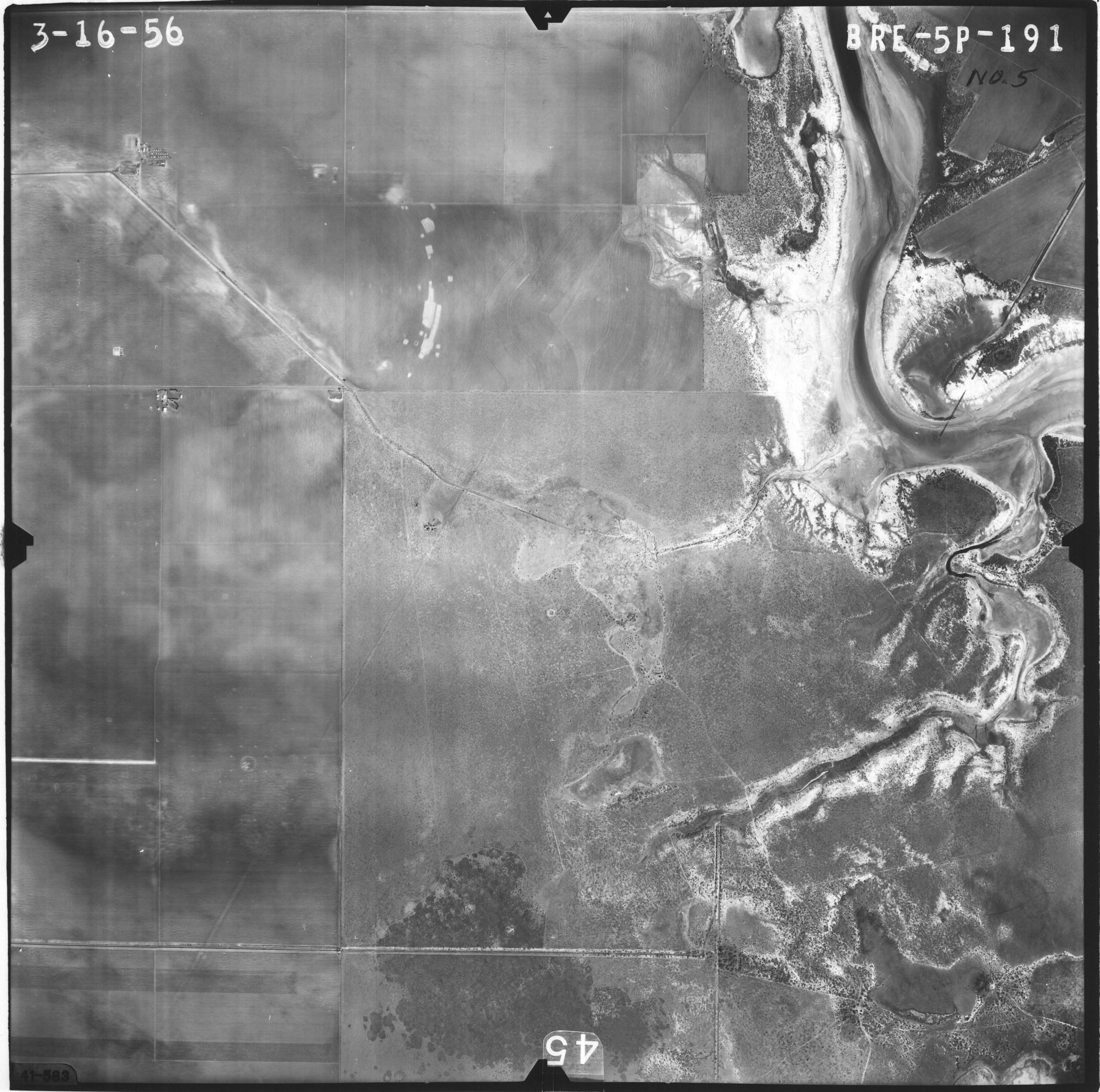

1-15-61

BRE-3BB-57

NO 6
1" = 1320'

843.96 AC.

45

D-134



NO. 4

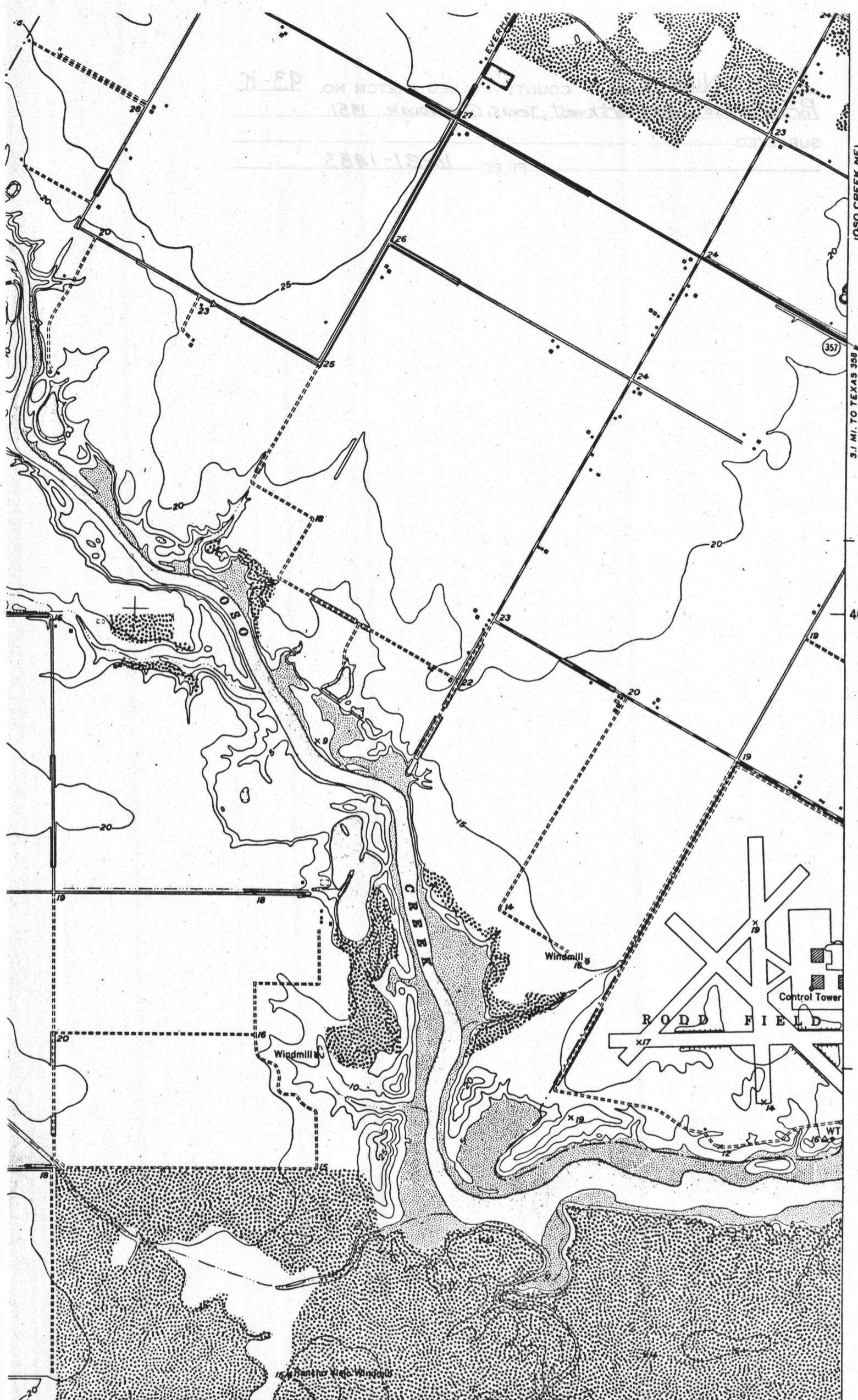

OSO CREEK NE
3.1 MI. TO TEXAS 398

27°37'30"
97°22'30"

OSO CREEK 1:62500

1 MILE
ET

INTERIOR-GEOLOGICAL SURVEY, WASHINGTON, D. C., 1958

ROAD CLASSIFICATION

Heavy-duty	4 LANE 16 LANE	Light-duty	
Medium-duty	4 LANE 16 LANE	Unimproved dirt	
	U. S. Route		State Route

OSO CREEK NW, TEX.
NW/4 OSO CREEK 15' QUADRANGLE
N2737.5—W9722.5/7.5

NGTON 25, D. C.

1951

D-134

FLOUR BLUFF AND ENCINAL FARM AND GARDEN TRACTS

NO. 1

NUECES COUNTY, TEXAS

SURVEYED AND DRAWN FOR

THE TEXAS LAND AND CATTLE COMPANY, LIMITED

By J. S. Peter, C. E.

July 1894

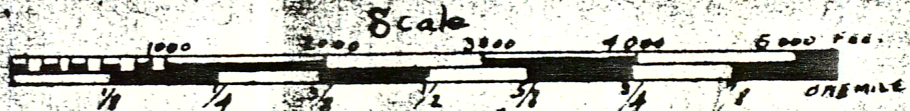

NOTE
All roads are 40 feet wide - 20 feet on each side of section and half section lines as shown.
Full lots contain 20 acres inclusive of road.
Full inside lots contain 19 1/2 acres - inclusive of road.
Full corner " " 19 1/4 " " " "

REFERENCE
Section line roads are indicated thus
Half section " " " "
Lot lines " " " "
Buildings " " " "
Cultivated lands " " " "

Filed this the 20th day of
January A. D. 1895

H. E. Luter, Clerk
County Court, Nueces County,
Texas

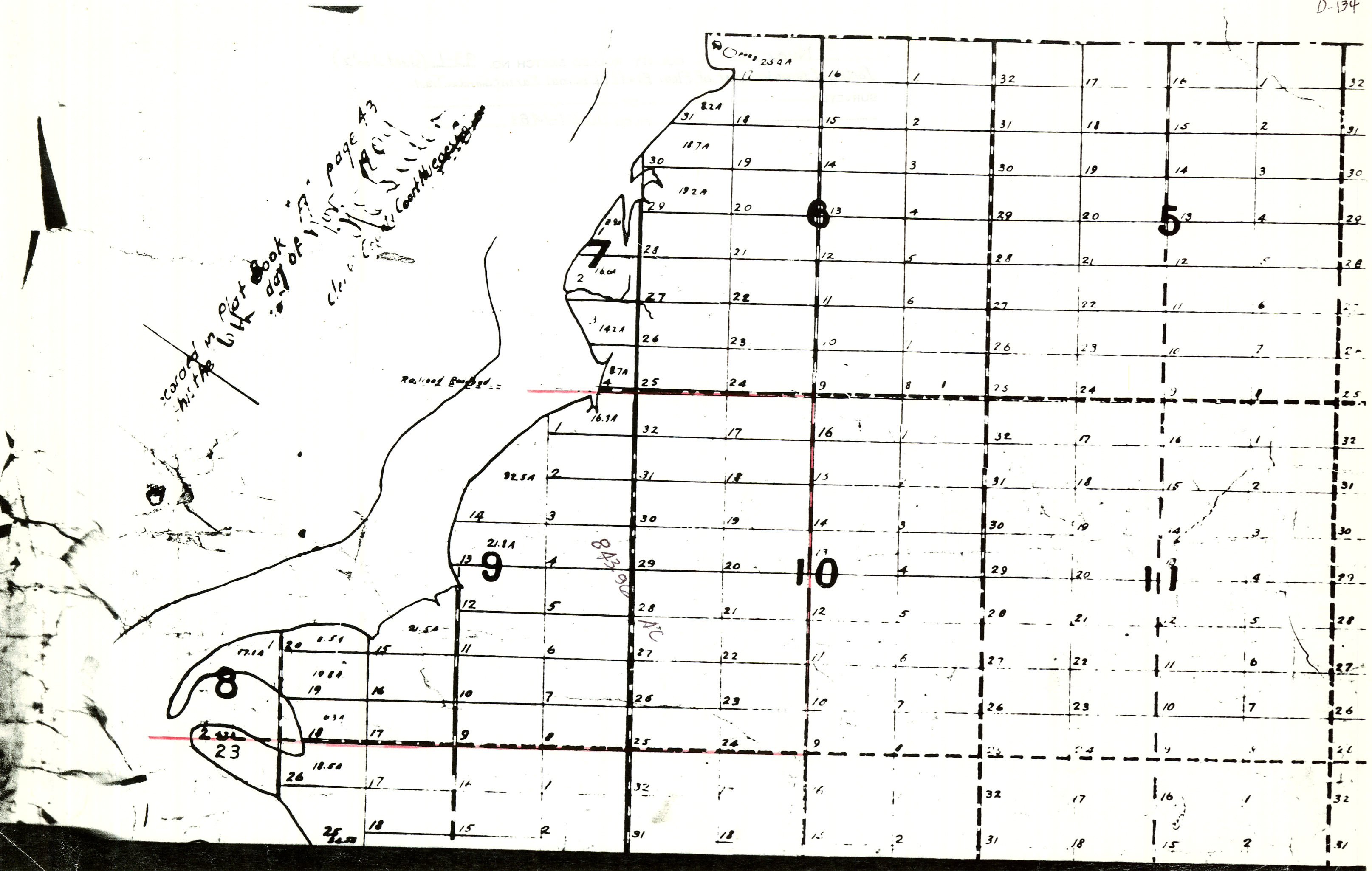
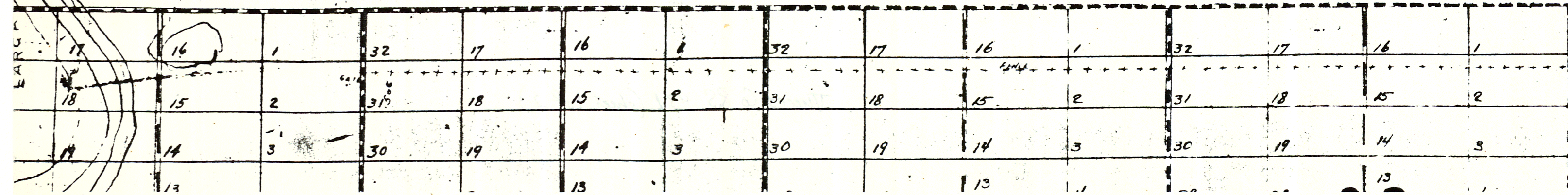

NO. 7

9882-13

843.96 ACRES



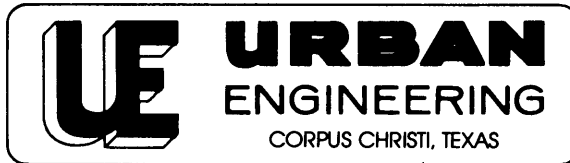

Job No. 20354.02

P.O. BOX 6355, 2725 SWANTNER
CORPUS CHRISTI, TEXAS 78411 PHONE 854-3101

October 26, 1983

GENERAL LAND OFFICE
1700 North Congress, Room 812
Austin, Texas 78701

Attention: Herman Forbes, Director
Surveying Division

Dear Herman:

I am herewith submitting Exhibit No. 7 which I failed to include in the original submission of Job No. 20354.02 (843.96 acres) on October 3, 1983.

Sincerely,

URBAN ENGINEERING

A handwritten signature in cursive script, appearing to read 'George M. Pyle', is written over the typed name.

George M. Pyle,
R.P.S. L.S.L.S.

P.S. I talked to Sheryl Pfeifer of the Nueces County Tax Office about the survey of Section 40 in Flour Bluff & Encinal Farm & Garden Tracts which you inquired about by telephone this morning. I mailed her a plat of the survey and your approval of the shoreline which will answer her questions and she said there is no need for you to respond to her letter.

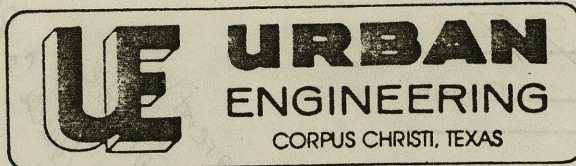

D-10
JAN 17 '88 '84

Job No. 20354.02

P.O. BOX 6355, 2725 SWANTNER
CORPUS CHRISTI, TEXAS 78411 PHONE 854-3101

October 3, 1983

ADDENDUM

Addendum to report on shoreline survey of 843.96 acres of land out of Section 10, and Fractional Sections 9 and 8, Flour Bluff and Encinal Farm and Garden Tracts, Nueces County, Texas.

[This addendum also applies to Urban Engineering Job 16030 (approved by the General Land Office by letter dated March 4, 1980 filed as Nueces County Rolled Sketch No. 70), Urban Engineering Job 19780 (approved by General Land Office by letter dated August 26, 1983, filed as Nueces County Rolled Sketch No. 89) and Urban Engineering Job 20229.01 submitted to General Land Office by letter dated September 7, 1983 but awaiting approval pending the submission of this addendum].

The report for the survey filed as Nueces County Rolled Sketch No. 70 states that I found 4 typical banks measuring from 0.6 feet to 1.0 foot high and the locations were spotted on one of the exhibits. These banks are almost vertical with the water being close to the toe of the bank. The water level through this area is fairly constant at elevation 2.2 feet N.G.V.D. with very little fall through the four surveys. (On July 11, 1982 water level at upper end on Weber was 2.34 feet and on August 16, 1982 water level was 2.1 at lower end by Rodd Field) On Job 16030 I used Bank "D" which was 0.8 high with water at the toe and gradient 0.4 above the water. The gradient for Job 19780 was established from Bank "B" which was 1.0 foot high with the water at the toe. The elevation of this line was found to be 2.7 feet, N.G.V.D. and the other surveys were run at this elevation since there is practically no fall in the gradient.

URBAN ENGINEERING

George M. Pyle

George M. Pyle
R.P.S. L.S.L.S.

GMP/crm

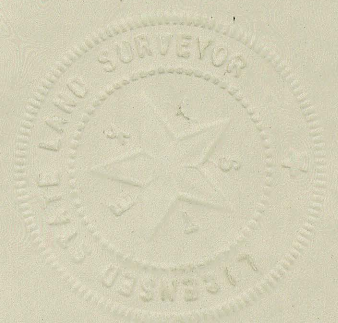
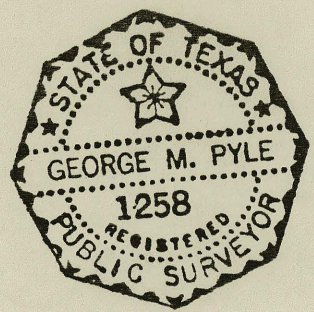

coaster 41520

File No. Rolled Sk. 973
Nueces County

Filed Jan. 17 1984

GARRY MAURO, Com'r

By J. Forbes

apparently
a duplicate
of Nueces Co RS 93-E

NUECES COUNTY ROLLED SKETCH NO. 973
Addendum

SURVEYED BY George M. Pyle
FILED 1-17-1984

This addendum also applies to Urban Engineering Job 16030 (approved by the General Land Office by letter dated March 4, 1983 filed as Nueces County Rolled Sketch No. 70), Urban Engineering Job 15780 (approved by General Land Office by letter dated August 28, 1981, filed as Nueces County Rolled Sketch No. 59) and Urban Engineering Job 30229.01 submitted to General Land Office by letter dated September 7, 1983 but awaiting approval pending the submission of this addendum.

The report for the survey filed as Nueces County Rolled Sketch No. 70 states that I found 4 typical banks measuring from 0.6 feet to 1.0 foot high and the locations were spotted on one of the exhibits. These banks are almost vertical with the water being close to the top of the bank. The water level through this area is fairly constant at elevation 2.2 feet A.G.L.D. with very little fall through the four surveys. On July 11, 1983 water level at upper end on water was 2.34 feet and on August 18, 1983 water level was 2.1 at lower end by root field. On job 16030 I used bank "D" which was 0.8 high with water at the top and gradient 0.4 above the water. The gradient for job 15780 was established from bank "B" which was 1.0 foot high with the water at the toe. The elevation of this line was found to be 2.7 feet, N.G.V.D. and the other surveys were run at this elevation since there is practically no fall in the gradient.

George M. Pyle
George M. Pyle
P.S.S. P.S.S.

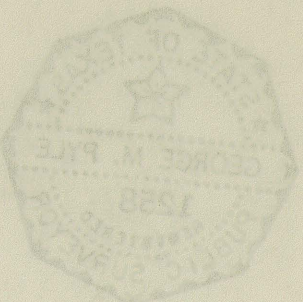
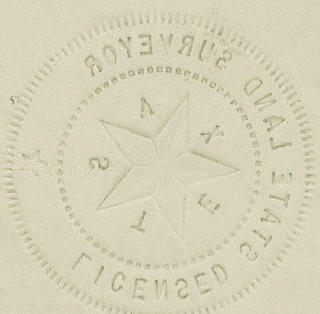

counter 11521