

No. 106 Polled Sketch 106
 N.U.C. 85
 Plat of 20.86 ac. along Oso Creek
 May 13
 D. Howard

I, GEORGE M. PYLE, LICENSED STATE LAND SURVEYOR, DO HEREBY CERTIFY THAT THE FOREGOING SURVEY WAS MADE ON THE GROUND AND THAT THE LIMITS, BOUNDARIES AND CORNERS, NATURAL AND ARTIFICIAL ARE AS DESCRIBED HEREON. THERE IS NO ARTIFICIAL FILL WITHIN THE BOUNDARY OF THE 20.86 ACRE TRACT.

GEORGE M. PYLE R.P.S. L.S. L.S.

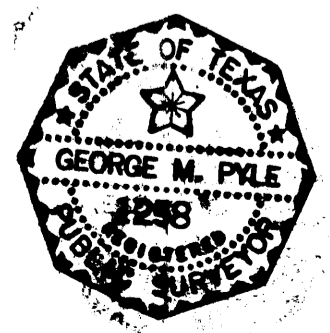

LINE	BEARING	DISTANCE
L1	S 62°13'14" E	11.03 ^v (30.65)
L2	S 67°21'55" E	27.23 ^v (75.63)
L3	S 71°20'49" E	39.68 ^v (110.22)
L4	S 77°38'13" E	39.02 ^v (108.40)
L5	S 81°54'04" E	35.55 ^v (98.75)
L6	S 71°42'57" E	34.65 ^v (96.25)
L7	S 68°17'50" E	35.94 ^v (99.75)
L8	S 71°59'48" E	35.64 ^v (98.99)
L9	S 83°21'15" E	33.23 ^v (92.30)
L10	N 88°25'46" E	44.95 ^v (124.86)
L11	S 67°49'42" E	32.40 ^v (89.99)
L12	N 89°38'04" E	42.14 ^v (117.06)
L13	S 68°50'54" E	29.06 ^v (80.73)
L14	S 69°56'01" E	38.2 ^v (105.88)
L15	S 78°44'07" E	38.15 ^v (105.98)
L16	S 82°38'32" E	28.79 ^v (79.98)
L17	S 82°18'12" E	30.96 ^v (86.00)
L18	N 81°22'57" E	34.10 ^v (94.72)
L19	S 84°24'22" E	29.69 ^v (82.47)
L20	S 88°35'05" E	28.02 ^v (77.83)
L21	N 81°15'02" E	29.71 ^v (82.52)
L22	N 79°38'13" E	29.49 ^v (81.91)
L23	N 70°03'43" E	31.41 ^v (87.24)
L24	N 45°58'04" E	27.6 ^v (76.69)
L25	N 89°31'18" E	29.14 ^v (80.94)
L26	N 74°39'55" E	27.30 ^v (75.84)
L27	S 86°06'49" E	33.91 ^v (94.19)
L28	S 77°46'56" E	36.27 ^v (100.75)
L29	N 84°11'49" E	28.36 ^v (78.78)
L30	S 89°45'42" E	30.64 ^v (85.11)
L31	S 88°24'25" E	22.91 ^v (63.63)
L32	S 88°26'34" E	28.72 ^v (79.79)

LINE	BEARING	DISTANCE
L33	S 48°10'21" E	34.87 ^v (96.87)
L34	S 49°49'32" E	35.37 ^v (98.26)
L35	S 0°15'50" W	13.96 ^v (38.78)
L36	S 42°59'00" E	56.24 ^v (156.22)
L37	S 38°59'40" E	36.66 ^v (101.84)
L38	S 80°53'41" E	6.62 ^v (18.39)
L39	S 29°01'40" W	25.81 ^v (71.70)
L40	N 84°03'10" W	17.49 ^v (48.59)
L41	N 89°50'27" W	55.57 ^v (154.35)
L42	N 79°16'22" W	67.15 ^v (186.54)
L43	N 84°01'38" W	70.40 ^v (195.55)
L44	N 78°52'27" W	49.53 ^v (137.58)
L45	S 11°07'33" W	6.97 ^v (19.35)
L46	S 63°24'31" W	10.39 ^v (28.87)
L47	N 84°31'32" W	61.93 ^v (172.03)
L48	N 85°27'59" W	33.04 ^v (91.79)
L49	N 76°07'18" W	84.74 ^v (235.39)
L50	N 78°42'12" W	70.00 ^v (194.45)
L51	N 80°20'14" W	67.43 ^v (187.32)
L52	S 89°26'23" W	54.81 ^v (152.24)
L53	N 87°48'21" W	74.59 ^v (207.20)
L54	N 77°18'21" W	56.35 ^v (156.54)
L55	N 61°05'09" W	85.29 ^v (236.91)
L56	S 84°54'40" W	23.45 ^v (65.14)
L57	S 52°01'27" W	30.00 ^v (83.33)
L59	S 85°12'56" W	39.68 ^v (110.22)
L60	S 85°46'03" W	36.18 ^v (100.50)
L61	S 48°14'35" W	25.75 ^v (71.53)
L62	S 62°03'01" W	47.95 ^v (133.19)
L63	S 78°46'18" W	21.63 ^v (60.08)
L64	N 78°34'54" W	54.46 ^v (151.28)
L65	N 89°31'42" W	94.86 ^v (262.95)
L66	S 79°57'48" W	6.79 ^v (18.87)

RIPIANIAN OWNER:
 HENRY TUCKER
 P.O. BOX 210170
 CORPUS CHRISTI, TEXAS 78421

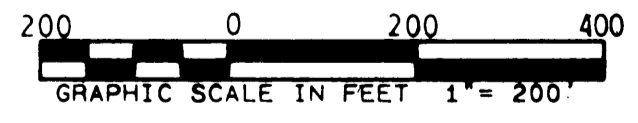

NOTE:
 BEARINGS BASED ON THE RECORDED MAP OF FLOUR BLUFF & ENCINAL FARM & GARDEN TRACTS.

REV. BY	DATE	DESCRIPTION	APPROVED
 URBAN ENGINEERING CORPUS CHRISTI, TEXAS			
SURVEY OF			
20.86 ACRES OF LAND OUT OF LOTS 21 THRU 25, SECTION 22, FLOUR BLUFF & ENCINAL FARM & GARDEN TRACTS, A MAP OF WHICH IS RECORDED IN VOLUME A, PAGES 41 THRU 43, MAP RECORDS OF NUECES COUNTY, TEXAS.			
DRAWN BY: MAX SCALE: 1" = 200' JOB NO: 23850.02			
CHECK BY: DATE: 3/28/85 SHEET: 1 OF 1			

201
 200
 199
 198
 197
 196
 195
 194
 193
 192
 191
 190
 189
 188
 187
 186
 185
 184
 183
 182
 181
 180
 179
 178
 177
 176
 175
 174
 173
 172
 171
 170
 169
 168
 167
 166
 165
 164
 163
 162
 161
 160
 159
 158
 157
 156
 155
 154
 153
 152
 151
 150
 149
 148
 147
 146
 145
 144
 143
 142
 141
 140
 139
 138
 137
 136
 135
 134
 133
 132
 131
 130
 129
 128
 127
 126
 125
 124
 123
 122
 121
 120
 119
 118
 117
 116
 115
 114
 113
 112
 111
 110
 109
 108
 107
 106
 105
 104
 103
 102
 101
 100
 99
 98
 97
 96
 95
 94
 93
 92
 91
 90
 89
 88
 87
 86
 85
 84
 83
 82
 81
 80
 79
 78
 77
 76
 75
 74
 73
 72
 71
 70
 69
 68
 67
 66
 65
 64
 63
 62
 61
 60
 59
 58
 57
 56
 55
 54
 53
 52
 51
 50
 49
 48
 47
 46
 45
 44
 43
 42
 41
 40
 39
 38
 37
 36
 35
 34
 33
 32
 31
 30
 29
 28
 27
 26
 25
 24
 23
 22
 21
 20
 19
 18
 17
 16
 15
 14
 13
 12
 11
 10
 9
 8
 7
 6
 5
 4
 3
 2
 1

DATE: MAY 13 1986
DRAWN FOR AERIAL PHOTOGRAPHY
NUECES
MAY 13 1986
GEORGE M. PYLE

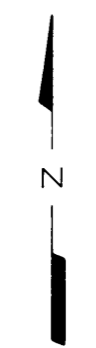
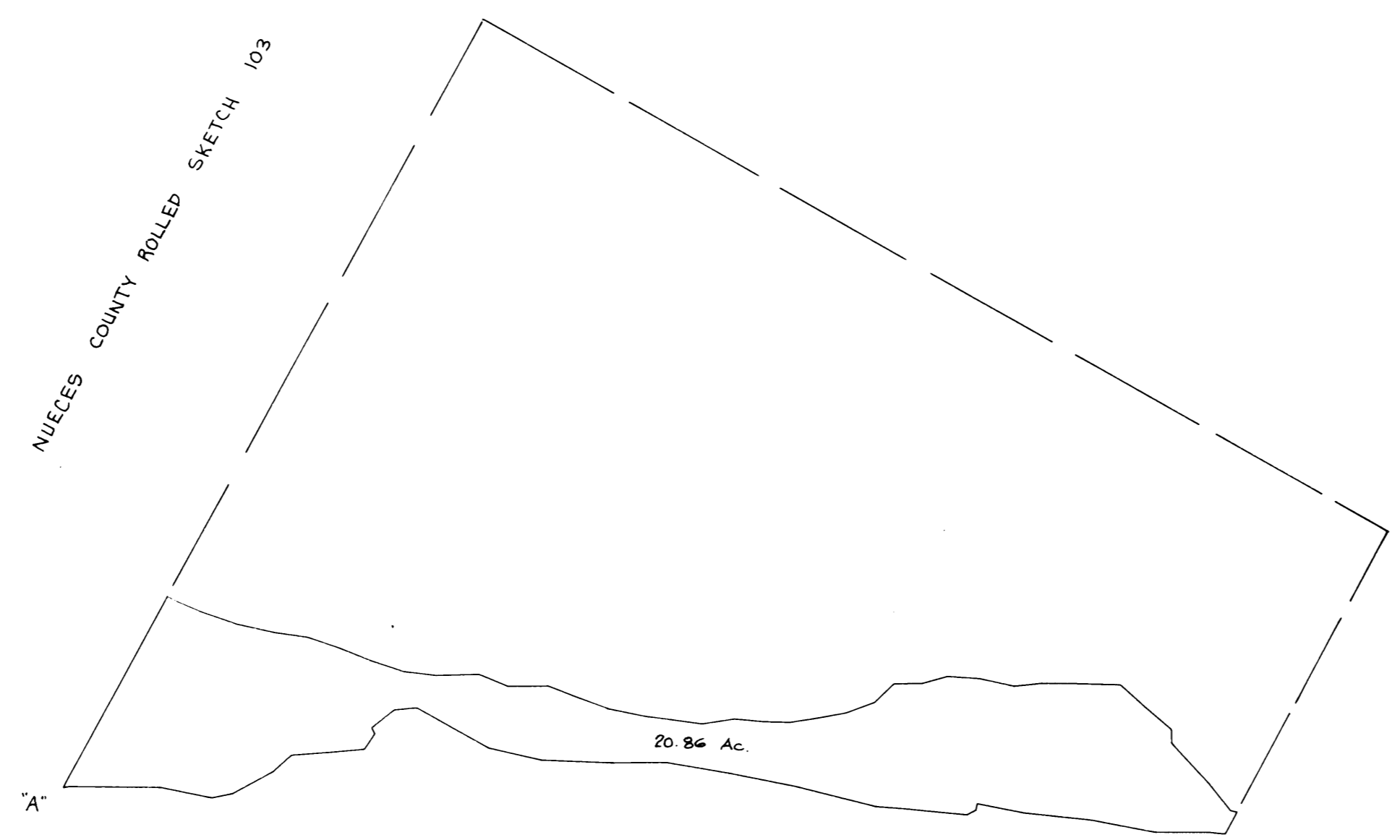

MAY 13 1986
GEORGE M. PYLE
DRAWN FOR AERIAL PHOTOGRAPHY
NUECES

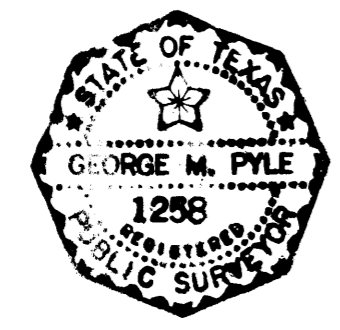

File No. Rolled Sketch 106
Nueces
Overlay for aerial photo
Filed May 13 86
By D. Howard

REV. BY	DATE	DESCRIPTION	APPROVED
DRAWN BY: <u>MAX</u> SCALE: <u>1" = 400'</u> JOB NO: <u>23850.02</u>			
CHK'D BY: _____ DATE: <u>5-7-86</u> SHEET: <u>1</u> OF: <u>1</u>			

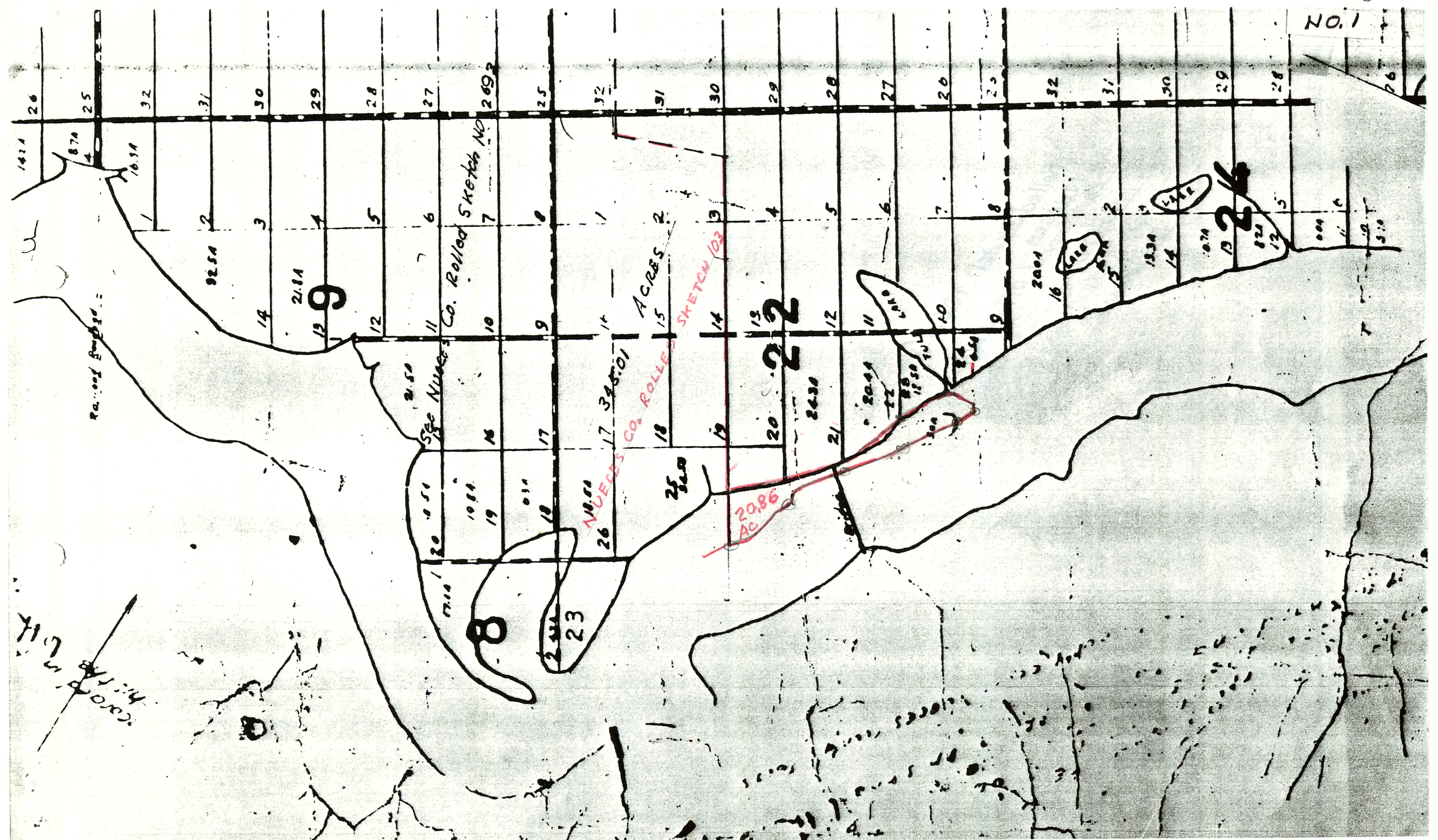

FLOUR BLUFF AND ENCINAL FARM AND GARDEN TRACTS

NUECES COUNTY, TEXAS

SURVEYED AND DRAWN FOR

THE TEXAS LAND AND CATTLE COMPANY, LIMITED

By J. S. PETERSON, C. E.

July 1894



NOTE
 Roads 20 feet on each side of Section and 20 feet Section
 20 acres inclusive of road
 contain 19 2/3 acres on usage of road
 19 1/2 "

Filed this the 20th day of
 January A D 1895

H. E. Luter Clerk
 County Court Nueces County
 Texas

REFERENCE
 Section Line Roads are indicated thus
 This Section
 Lot Lines
 Buildings
 Cultivated Lands

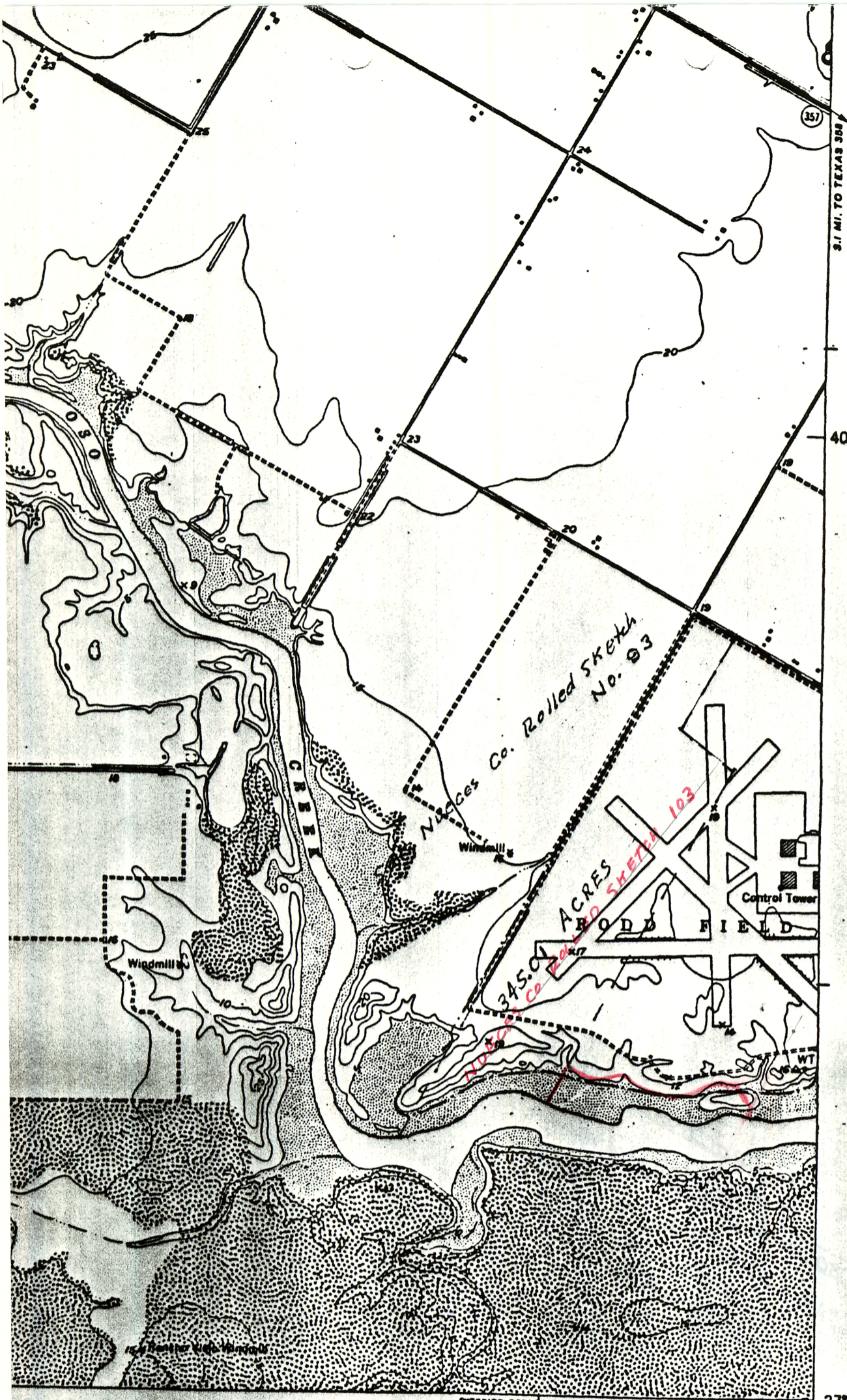

3.1 MI. TO TEXAS 388

40'

N. Jones Co. Rolled Sketch No. 83

345.0 ACRES
103

Control Tower

FIELD

Windmill

INTERIOR GEOLOGICAL SURVEY, WASHINGTON, D. C. 1950

27°37'30"
97°22'30"

OSO CREEK 1:62500

ROAD CLASSIFICATION

- Heavy-duty 4 LANE 16 LANE Light-duty
- Medium-duty 4 LANE 16 LANE Unimproved dirt
- U. S. Route State Route

OSO CREEK NW, TEX.
NW/4 OSO CREEK 15' QUADRANGLE
N2737.5—W9722.5/7.5

1951

NUECES CO. ROLLED SKETCH 103

20.86
ACRES

LANMON AERIAL
PHOTOGRAPHY, INC.
Rt. # 2 - Box 902-B
CORPUS CHRISTI, TX 78410

Date: JAN 18 1985

Scale: 1/400

0985-35

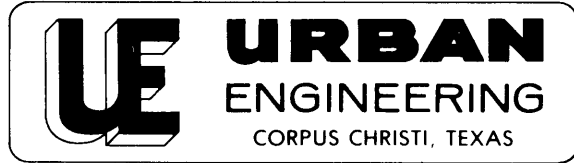

Job No. 23850.02

P. O. BOX 6355, 2725 SWANTNER
CORPUS CHRISTI, TEXAS 78411 PHONE 854-3101

May 6, 1986

Gary Mauro, Commissioner
General Land Office
1700 N. Congress Avenue, Room 812
Austin, Texas 78701

Attention: Herman Forbes, Director, Survey Division

Dear Herman:

I am herewith submitting a survey and report with exhibits of a 20.86 acre tract of land adjoining State owned Cayo Del Oso Tracts E and F in Nueces County, Texas. The owner desires General Land Office approval of the gradient boundary in order to plat the property.

Sincerely,

URBAN ENGINEERING

George M. Pyle, R.P.S., L.S.L.S.

GMP/ds
Enclosure

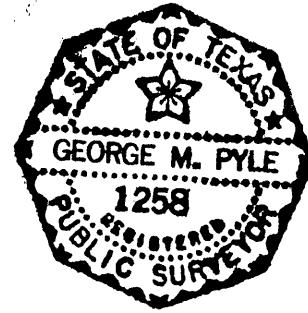

*Rolled Sketch 106-D (Sheet 1 of 2)
Nueces
Cover Sheet
May 13
D. Howard*

86

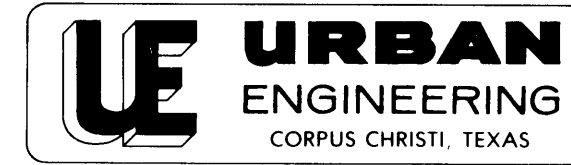

Job No. 23850.02

P. O. BOX 6355, 2725 SWANTNER
CORPUS CHRISTI, TEXAS 78411 PHONE 854-3101

May 6, 1986

Gradient Boundary Survey Report

The property surveyed consists of 20.86 acres of land out of Lots 21 thru 25, Section 22, Flour Bluff and Encinal Farm and Garden Tracts, a map of which is recorded in Volume A, Pages 41 thru 43, Map Records of Nueces County, Texas.

This tract adjoins the East boundary of a 345.01 acre tract of land for which you approved the boundary between public and private ownership by letter dated October 14, 1985 and filed as Nueces County Rolled Sketch 103.

Attached Exhibits:

1. Portion of recorded plat of Flour Bluff and Encinal Farm and Garden Tract.
2. Portion of Oso Creek NW, Tex, Quadrangle, 1951.
3. Glesson Lammon Aerial Photo No. 0985-35, dated Jan. 18, 1985, with a computer drawn film overlay of the 20.86 acre tract.

On the aerial photo (Exhibit No. 3) there is a narrow channel in the dark area close to the mark "X". This channel appears as a dark line on the photo and, although narrow, is fairly deep.

The main channel lies on the South side of the island created by two channels.

The entire shoreline of this survey is a nearly vertical bank and it was not necessary to establish the gradient from the water surface.

Signed:

George M. Pyle, R.P.S.-L.S.L.S.

GMP/ds

*Rolled Sketch 106-D (Sheet 2 of 2)
Nueces
Gradient Boundary Survey Report
May 13
D. Howard*

86

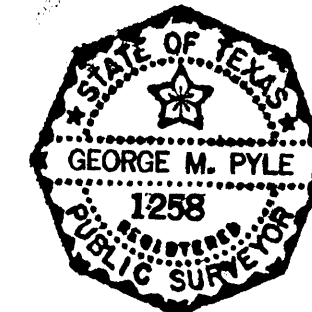

Garry Mauro
Commissioner
General Land Office



May 19, 1986

Urban Engineering
P. O. Box 6355
2725 Swantner
Corpus Christi, TX 78411

Attention: Mr. George Pyle

RE: Gradient Boundary Line along Oso Creek
of Lots 21 thru 25, Sec. 22, Flour
Bluff & Encinal Farm & Garden Tracts,
Urban Job No. 23850.02, Nueces County.

Dear Mr. Pyle:

The survey of the current gradient boundary line along Oso Creek is approved as the line between private and State ownership.

Your letter, report and exhibits have been filed as Nueces County Rolled Sketch No. 106.

Sincerely,

Herman Forbes

Herman Forbes
Director, Surveying Division

HF:sjr

FILED Rollled Sketch 106-E
Nueces County
Correspondence
May 13 19 86
GARRY MAURO Com'r
By D. Howard