

P-577

H. L. GEORGE ✓
OFFICE PHONE 5112
ROOM 207 CENTRAL NATIONAL BANK BLDG.

SAN ANGELO, TEXAS ✓

July 22, 1955

8
196
\$25.50

Mr. William Shirriffs
General Land Office
Austin, Texas

Dear Bill:

As I promised you, I am enclosing, herewith, a copy of a map showing a part of W. D. Twichell's field book, from the Northwest corner of Block C-26 to Monument No. 26 on the Texas-New Mexico line.

This map is self-explanatory, and I am sure you will find it very interesting. We checked the platting several times, and I am certain it sets out exactly what is stated in the field book.

You will note, with particular interest, what he probably used as Monument No. 27, although he does not state that he considers this to be the original monument.

I will see you the morning of August 2.

With kindest personal regards, I remain

Sincerely yours,

Hugh L. George

HLG:hp
Enc.

RECEIVED
JUL 25 1955
GENERAL LAND OFFICE

74042

PLAT OF W.D. TWICHELL'S FIELD BOOK NOTATIONS AS COPIED FROM HIS FIELD BOOK
 BY HIM, APRIL 12-13-14, 1938.
 MADE IN THE OFFICE OF H. L. GEORGE, LICENSED STATE LAND SURVEYOR OF TEXAS, JUNE 16-17, 1952.
 SCALE: 1" = 1000 VS.

H. L. GEORGE
 207 CENT. NTL. BLDG., SAN ANGELO, TEX. PHO. 5112

LOVING COUNTY
 TEXAS

NEW MEXICO

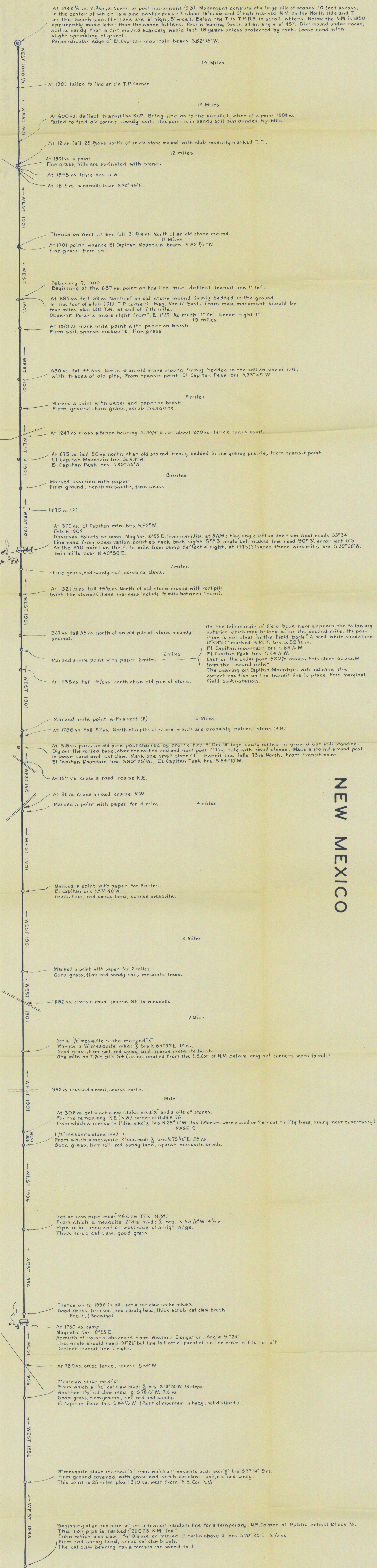

At 1048 1/2 vs. 2 2/10 vs. North of post monument (5B) Monument consists of a large pile of stones, 10 feet across, in the center of which is a pine post (circular) about 15" in dia and 5' high marked NM on the North side and T on the South side. (Letters are 6" high, 5" wide). Below the T is T.P.R.R. in scroll letters. Below the NM is 1850 apparently made later than the above letters. Post is leaning South at an angle of 45°. Dirt mound under rocks, soil so sandy that a dirt mound scarcely would last 18 years unless protected by rock. Loose sand with slight sprinkling of gravel. Perpendicular edge of El Capitan mountain bears S.82°15' W.

At 1901 failed to find an old T.P. Corner

At 600 vs. deflect transit line Rt 2. Bring line on to the parallel, when at a point 1901 vs. Failed to find old corner, sandy soil. This point is in sandy soil surrounded by hills.

At 12 vs. fall 25 3/10 vs north of an old stone mound with slab recently marked T.P.,

At 1901 vs. a point
 Fine grass, hills are sprinkled with stones.

At 1848 vs. fence brs. S.W.

At 1815 vs. windmills bear S42°45'E.

Thence on West at 6 vs. fall 31 2/10 vs. North of an old stone mound.

At 1901 point whence El Capitan Mountain bears S.82 3/4° W.
 Fine grass, firm soil.

February 7, 1902
 Beginning at the 687 vs. point on the 11th. mile, deflect transit line 1' left.

At 687 vs. fall 39 vs. North of an old stone mound firmly bedded in the ground at the foot of a hill (Old T.P. corner). Mag. Var. 11° East. From map, monument should be four miles plus 130 T.W. at end of 7th mile. Observe Polaris angle right from "E. 1°27' Azimuth 1°26'. Error right 1"

At 1901 vs. mark mile point with paper on brush
 Firm soil, sparse mesquite, fine grass.

680 vs. fall 44 vs. North of an old stone mound firmly bedded in the soil on side of hill, with traces of old pits, From transit point El Capitan Peak brs. S.83°45' W.

Marked a point with paper and paper on brush.
 Firm ground, fine grass, scrub mesquite.

At 1247 vs. cross a fence bearing S 139 1/4° E., at about 200 vs. fence turns south

At 675 vs. fall 50 vs. north of an old stone mound. Firmly bedded in the grassy prairie, from transit point El Capitan Mountain brs. S.83° W.
 El Capitan Peak brs. S.83°55' W.

Marked position with paper
 Firm ground, scrub mesquite, fine grass.

At 370 vs. El Capitan mtn. brs. S.82° W.
 Feb. 6, 1902
 Observed Polaris at camp. Mag Var. 10°55' E. from meridian at 8AM; Flag angle left on line from West reads 33°34'
 Line read from observation point as back back sight 55°3' angle Left makes line read 90°3', error left 0°3'
 At the 370 point on the fifth mile from camp deflect 4' right, at 1475(?) varas three windmills brs S.39°20' W.
 Twin mills bear N 40°50' E.

At 1321 1/2 vs. fall 49 1/2 vs. North of old stone mound with root pile (with the stone) (These markers include 1/2 mile between them).

367 vs. fall 58 vs. north of an old pile of stone in sandy ground.

Marked a mile point with paper 6 miles

At 1438 vs. fall 19 1/2 vs. north of an old pile of stone.

Marked mile point with a root (F)

At 1788 vs. fall 52 vs. North of a pile of stone which are probably natural stone (4B)

At 1518 vs. pass an old pine post charred by prairie fire 5" Dia 18" high badly rotted in ground but still standing. Dig out the rotted base, clear the rotted end and reset post, filling hole with small stones. Made a stone mound around post in loose sand and catclaw. Mark one small stone "T". Transit line falls 73 vs. North. From transit point El Capitan Mountain brs. S.83°25' W., El Capitan Peak brs. S.84°10' W.

At 1157 vs. cross a road course NE.

At 86 vs. cross a road course NW.

Marked a point with paper for 4 miles

Marked a point with paper for 3 miles.
 El Capitan brs. S.83°40' W.
 Grass fine, red sandy land, sparse mesquite.

Marked a point with paper for 2 miles.
 Good grass, firm red sandy soil, mesquite trees.

1182 vs. cross a road course NE. to windmills

Set a 1/2" mesquite stake marked "X"
 Whence a 1/2" mesquite mkd: X brs. N.84°30' E. 12 vs.
 Good grass, firm soil, red sandy land, sparse mesquite brush.
 One mile on T & P Blk 54 (as estimated from the S.E. Cor. of N.M. before original corners were found.)

982 vs. crossed a road, course north.

At 306 vs. set a cat claw stake mkd: "X" and a pile of stones.
 For the temporary NE (NW) corner of BLOCK 76
 From which a mesquite 1" dia. mkd: X brs. N.28° 11' W 11 vs. (Markes were placed on the most thrifty trees, having most expectancy)
 PAGE 9

1/2" mesquite stake mkd: X
 From which a mesquite 2" dia. mkd: X brs. N.75 1/2° E. 25 vs.
 Good grass, firm soil, red sandy land, sparse mesquite brush.

Set an iron pipe mkd: "26 C 26 TEX. N.M."
 From which a mesquite 2" dia. mkd: X brs. N.63 1/2° W. 4 1/2 vs.
 Pipe is in sandy soil on west side of a high ridge.
 Thick scrub catclaw, good grass.

Thence on to 1996 in all, set a cat claw stake mkd: X
 Good grass, firm soil, red sandy land, thick scrub catclaw brush.
 Feb. 4, (Snowing)

At 1750 vs. camp
 Magnetic Var. 10°55' E
 Azimuth of Polaris observed from Western Elongation, Angle 91°24'.
 This angle should read 91°26' but line is 1' off of parallel, so the error is 1' to the left.
 Deflect transit line 1' right.

At 780 vs. cross fence, course S.54° W.

2" catclaw stake mkd: "X"
 From which a 1 1/2" catclaw mkd: X brs. S.13°35' W. 18 steps.
 Another 1 1/2" catclaw mkd: X brs. S.78 1/2° W. 7 1/2 vs.
 Good grass, firm ground, soil red and sandy.
 El Capitan Peak brs. S.84 1/2° W. (Point of mountain is hazy, not distinct)

3" mesquite stake marked "X" from which a 1" mesquite bush mkd: X brs. S.33 1/4° 9 vs.
 Firm ground covered with grass and scrub catclaw. Soil, red and sandy.
 This point is 26 miles plus 1310 vs. west from S.E. Cor. N.M.

Beginning of an iron pipe set on a transit random line for a temporary NE. Corner of Public School Block 76.
 This iron pipe is marked: "26 C 25 N.M. Tex."
 From which a catclaw 1 3/4" Diameter marked 2 hacks above X brs. S.70°20' E. 12 1/2 vs.
 Firm red sandy land, scrub catclaw brush.
 The catclaw bearing has a tomato can wired to it

U.S. 8

No 54
CURRENT MISCELLANEOUS
INFORMATION
PART OF W.D. TRICHELLS
FIELD BOOK FROM
N.W. COR. BLOCK C-26
TO MONUMENT NO 26.
TEXAS NEW MEXICO

RECEIVED
GENERAL LAND OFFICE
JUL 22 1956

LINE
PRESENTED BY H.A. GEORGE
July 22-1956

N.S.

Counter 77508

TEXAS
COUNTY

NEW MEXICO