

Plat

Showing part of Township 26 South in Ranges 23 and 24 East New Mexico P. M.

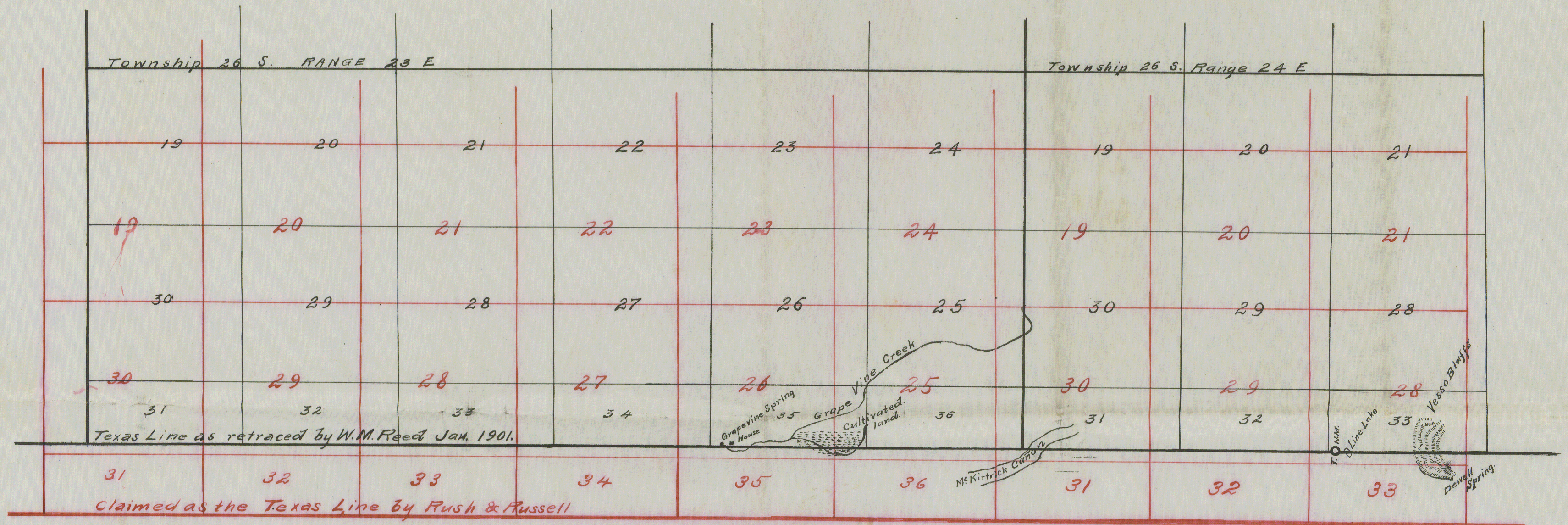

JOINT RESOLUTION.

(S. J. R. No. 12.) Joint Resolution confirming the location of the boundary line established by the United States Commissioner between No Man's Land and Texas, and Texas and New Mexico, under an act of Congress of June 5, 1858.

Section 1. Whereas an act of Congress approved June 5, 1858, provided for Commissioners to locate and mark the boundary lines between the territories of the United States and the State of Texas; and

Whereas in accordance with said act, a survey was made of the boundary line between the Public Strip -- otherwise known as No Man's Land -- and between Texas and New Mexico by John H. Clark, U. S. Commissioner appointed under said act, A. D. 1858; And

Whereas, it appears from the report of the said Commissioner to the General Land Office at Washington, that said surveying was carefully done, consuming over two years on the ground in making the same; and

Whereas, said boundary line so located has been acquiesced in by the State of Texas and the United States Government by surveying up to it and selling the lands so surveyed, or parts of it; and

Whereas, until recently no part of said boundary lines have ever been officially agreed upon or accepted by the General government or the State of Texas, as contemplated by the act of Congress, authorizing the survey; and Whereas, on the 4th day of March A. D. 1891, the Congress of the United States confirmed the boundary lines as surveyed by said Commissioner, John H. Clark, between No Man's Land and Texas, and between Texas and New Mexico established under the act of Congress of June 5, 1858;

Therefore, be it resolved by the Senate and House of Representatives of the State of Texas: That the boundary line between the Public Land Strip -- otherwise known as No Man's Land -- and Texas, and between Texas and New Mexico, established by John H. Clark, Commissioner under the act of the United States Congress, approved June 5, 1858, be and the same is hereby accepted, ratified and confirmed on the part of the State of Texas, as the true boundary line between said Public Land Strip

Texas State Boundary Line 5

and Texas, and between Texas and New Mexico.

Sec. 2. And, whereas, the near approach of the close of the present session of the Legislature renders it unlikely that this resolution can be passed in the regular way, and the fact that there is much uncertainty as to the location of said boundary line, creates an emergency and an imperative public necessity which requires that the constitutional rule requiring bills to be read on three several days be suspended, and the same is so suspended, and this resolution take effect from and after its passage, and it is so enacted.

(Note.-- The foregoing joint resolution originated in the Senate and passed the same -- vote not given; and passed the House by a vote of 71 yeas and no nays.)

(Note.-- The foregoing joint resolution was presented to the Governor of Texas for his approval on the twenty-fifth day of March, 1891, but was not signed by him, nor returned to the house in which it originated with his objections thereto within the time prescribed by the constitution, and thereupon became a law without his signature.--Geo. W. Smith, Secretary of State.)

Texas State Boundary Lines

Joint Resolution
Texas Legislature
Confirming line established
by U. S. Commissioners
between New Mexico Land & Texas
and Texas & New Mexico

Fractional Range line between Ranges 23 & 24 E., in

T. 26 S.,

Chains. From the Cor. to secs. 19, 24, 25 & 30, which is a Limestone 14x11x9 ins. $\frac{2}{3}$ in the ground, marked with 4 notches on N. and 2 on S. edges mound of stone alongside,

South on a true line bet. Secs. 25 & 30

Va. $11^{\circ} 27'$ E.

- 26.50 Road bears N.E. & S.W.
- 28.45 Grapevine Creek 40 lks. wide, course N.E.
- 40.00 Set Limestone 15x12x9 ins. $\frac{2}{3}$ in the ground for $\frac{1}{4}$ sec. cor. marked $\frac{1}{4}$ on W. face and raised a mound of stone alongside.
- 40.60 Grapevine Creek 41 lks. wide, course N.W.
- 44.00 Grapevine Creek 50 lks. wide course N.E.
- 80.00 Set Limestone 16x10x9 ins $\frac{2}{3}$ in the ground for Cor. to secs. 25, 30, 31 & 36 and marked with five notches on N. and 1 on S. edges and raised a mound of stone alongside.

Land rolling and broken.

Soil 4th rate.

Good grass.

No timber.

Brush dense.

Latitude at this point $32^{\circ} 13'$ N. Instrument in adjustment.

South on a true line bet. Secs. 31 & 36

Va. $11^{\circ} 44'$ E.

- 31.02 Intersect line bet. Texas and New Mexico 3.22 W. of mound recently established by me 33 miles W. of monument on W. side Rio Pecos.

Set a sandstone 18x11x4 ins. $\frac{2}{3}$ in the ground for closing cor. to fractional Tp. 26 S., marked C.C.N.M. on N. and T.L. on S. with 6 notches on N.E. & W. edges and raised a mound of stone alongside.

Land rough and broken.

Soil 4th. rate.

Fractional Range line bet. Ranges 23 & 24 E., in T. 26 S.

Chains.

Good grass.

No timber.

Brush dense, 31.02 chs.

Oct 26th 1883.

Texas State Boundary line 5-

Retracement of the boundry line bet. Texas and New Mexico through
a portion of R. 23 E.

Chains. -----

From the mound recently established 33 miles W. of monument on
W. side of the Rio Puerco, (see preceeding pages)

N. 89° 54' W.

Va. 11° 32' E.

- 40.00 Raised mound of earth from two pits.
71.75 Wire fence N. & S.
72.00 Spring on line.
80.00 Set sand stone 15x12x8, 2/3 in ground, marked T. on S., N.M. on
N. and raised mound of stone alongside.

Surface rolling.

Soil 3rd rate.

Good Grama Grass.

Dense Catclaw and Mesquite undergrowth.

N. 89° 54' W.

Va. 11.32' E.

- 4.00 Enter cultivated land.
10.00 Acequia, N.E. 20 lks.
24.00 Acequia, S.E. 20 lks.
24.85 Wire fence S.E. & N.W., and leave cultivated land.
40.00 Raised mound of earth from two pits.
54.00 Grapevine Creek, 25 lks. N.E.
68.00 House 10 lks N.
69.00 Wire fence N. & S.
72.50 Head of Grapevine Creek, course S. E.
80.00 Set Limestone 14x11x8, 2/3 in ground, marked T. on S., and N.M.
on N. & raised a mound of stone alongside.

Surface rolling.

Soil 3rd. rate.

Good Grama Grass.

Texas State Boundary line S

Timber, scattering oak.

N. 89° 54' W.

Va. 11° 32' E.

Retracement of the boundry line bet. Texas and New Mexico,
through a portion of Range 23 E.

Chains.

40.00 Raised mound of earth from two pits.

80.00 Set Limestone 18x10x9, 2/3 in ground, marked T. on S. and N.M.
on N. and raised mound of stone alongside.

Surface rolling and rocky.

Soil 3rd. rate.

Good Grama Grass.

Timber, none.

N. 89° 54' W.

Va. 11° 32' E.

40.00 Raised mound of earth from two pits.

XXXXXXXXXXXXXXXXXXXXXXXXXXXX

Texas State Boundary line 5.

Subdivision of a portion of T. 26., S., R. 23 E.

Chains. From the cor. to secs. 23, 24, 25 & 26 which is a Limestone 17x10x9 ins. $\frac{2}{3}$ in ground, marked with two notches on S. and 1 on E. edges and raised mound of stone alongside.

East on a random line between Secs. 24 & 25.

Variation $11^{\circ} 31'$ East.

40.00 Set temporary $\frac{1}{4}$ sec. corner.

79.92 Intersect E. boundry, Tp. 18 lks. N. of cor. to secs. 19, 24, 25, & 30, recently established by me.

Thence I run N. $89^{\circ} 52'$ W. on a true line with same Va.

20.00 Arroyo 101 lks. wide, course N.E.

39.96 Set limestone 16x12x9 ins. $\frac{2}{3}$ in the ground for $\frac{1}{4}$ sec. Cor. marked $\frac{1}{4}$ on N. face, and raised a mound of stone alongside.

79.92 At cor. to secs. 23, 24, 25 & 26.

Land rolling.

Soil 3rd rate.

Good grass.

No timber, brush dense.

South on a true line bet. secs 25 & 26.

Va. 11. $31'$ E.

40.00 Set Limestone 11x10x10 ins. $\frac{2}{3}$ in the ground for $\frac{1}{4}$ sec. Cor. marked $\frac{1}{4}$ on W. face, and raised a mound of stone alongside.

44.00 Arroyo 50 lks. wide, course N.E.

72.50 Road, course N.E. & S.W.

75.50 Grapevine Creek 30 lks. wide, course N.E.

80.00 Set Limestone 14x11x7 ins. $\frac{2}{3}$ in the ground for cor. to secs. 25, 26, 35 & 36, and marked with 1 notch on south and 1 on E. edges and raised a mound of stone alongside.

Land rolling and broken.

Soil 3rd. rate.

Counter # 74967

B5

Texas State Boundary line 5

Subdivision of a portion of T. 26 S.R. 23 E.

Chains. Good Grass.
 No timber.
 Brush dense.

East on a random line bet Secs. 25 & 36.

Variation $11^{\circ} 31'$ East.

40.00 Set temporary $1/4$ Sec. corner.

80.20 Intersect east boundry Tp., 22 lks N. of cor. to secs. 25, 30, 31,
& 36, recently established by me.

Thence I run

N. $89^{\circ} 51'$ W on a true line with same Va.

40.10 Set Limestone $14 \times 12 \times 9$ ins. $2/3$ in the ground for $1/4$ Sec. Cor.
marked $1/4$ on W. face and raised a mound of stone alongside.

80.20 At corner to Secs. 25, 26, 35 & 36.

Land rolling.

Soil 3rd rate.

Good grass.

No timber.

Brush dense.

South on a true line bet. Secs. 35 & 36.

Va. $11^{\circ} 31'$ E.

31.00 Intersect line bet. Texas and New Mexico, 2.97 W. of mound recently
established by me 34 miles W. of monument on W. side of Rio Pecos.

Set Limestone $12 \times 12 \times 11$ ins $2/3$ in gorund for closing corner to
fractional secs. 35 & 36, marked C.C. T.L. on S. and N.M. on N.,
with 5 notches on W. and 1 on E. edges and raised a mound of stone
alongside.

Land Rolling.

Soil 3rd rate.

Good grass.

No timber- brush dense.

Counter # 74768

Texas State Boundary Line 5

B6

Subdivision of a portion of T. 26 S., R 23 E.

Chains. Frome the Corner to Secs 22, 23, 26 & 27, which is a Limestone 15x12x9 ins $\frac{2}{3}$ in the ground, marked with W notches on S. and 2 on E. edges mound of stone alongside.

East on a random line bet. Secs 23 & 26.

Varaition $11^{\circ} 31'$ E.

40.00 Set temporary $\frac{1}{4}$ sec corner.

79.78 Intersect N. and S. lines 18 lks. S. of cor. to secs. 23° , 24, 25 & 25. Thence I run

S. $89^{\circ} 52'$ W. on a true line with same Va.

39.891 Set Limestone 16x10x8 ins. $\frac{2}{3}$ in the ground for $\frac{1}{4}$ sec. cor, marked $\frac{1}{4}$ on N. face and raised a mound of stone alongside.

61.25 Arroyo 50 lks wide, cource N.E.

79.78 At Cor. to secs 22, 23, 26 & 27

Land rolling.

Soil 3rd rate.

Good grass.

No timber- brush dense.

South on a true line bet. Secs. 26 & 27.

Va. $11^{\circ} 31'$ E.

16.40 Arroyo 40 lks. wide, c ource N.E.

39.00 Arroyo 100 lks. wide, course N.E.

40.00 Set limestone 18x12x9 ins. $\frac{2}{3}$ in the ground for $\frac{1}{4}$ - sec. cor. marked $\frac{1}{4}$ on E face, and raised a mound of stone alongside.

80.00 Set Limestone 18x16x8 ins. $\frac{2}{3}$ in the ground for Corner to Secs. 26, 27, 34 & 35, and marked with 1 notch on S. and 2 on E. edges, and raised a mound of stone alongside.

Land rolling.

Soil 3rd rate.

Good grass.

No timber- Brush dense.

Texas State Boundary line 5

Subdivision of portion of T. 26 S. R. 23 E.

Chains. East on a random line bet. Secs. 26 & 35.

Va. $11^{\circ} 33'$ E.

40.00 Set temporary $1/4$ ~~XXXXX~~ ~~XXXX~~ Sec. Corner.

80.09 Intersect N. & S. line 24 links N. of Cor. to Secs. 25, 26, 35
& 36, thence I run

N. $89^{\circ} 50'$ W with same Va on a true line.

.25 Grapevine Creek, 20 lks wide, course N. E.

7.65 Wire fence N.W. & S.E.

40.04 Set Limestone $16 \times 12 \times 9$ ins. $2/3$ in the ground for $1/4$ Sec. Cor. marked
 $1/4$ on N. face and raised a mound of stone alongside.

67.25 Road N.E & S.W.

80.09 At corner to Secs 26, 27, 34 & 35.

Land rolling.

Soil 3rd rate.

Good grass.

No timber- Brush dense.

South on a true line bet. Sec 34 & 35.

Va. $11^{\circ} 30'$ E.

30.89 Intersect line bet, Texas and New Mexico, 3.00 chs. W of mound
recently established by me 35 miles W. of monument on W. side of
Rio Pecos.

Set a Limestone $14 \times 14 \times 6$ ins. $2/3$ in the ground for closing corner
to frac. secs 34&35 marked C.C.T.L. on S and N.M. on N. with 4 notches
on W. and 2 on E edges, and raised a mound of stone alongside.

Land rolling and broken.

Soil 3rd rate.

Good grass.

No timber- brush dense.

From the Cor. to Sec. 21, 22, 27 & 28, which is a Limestone
 $18 \times 14 \times 6$ ins $2/3$ in the ground marked with 2 notches.

Texas State Boundary line 5

Subdivision of portion of T. 26., S. R. 23 E.

Chains. On S. and 3 on E. edges, with mound of stone,

East on a random line between Secs 22 & 27

variation $11^{\circ} 33'$ East.

40.00 Set temporary $1/4$ Sec. Cor.

79.90 Intersect N. & S. line 18 links N. of Cor. to Secs. 22, 23, 26 & 27,
thence I run N. $89^{\circ} 52'$ W. on a true line with the same Va.

39.95 Set limestone $14 \times 11 \times 7$ ins., $2/3$ in the ground for $1/4$ Sec. Cor.
marked $1/4$ on N. face and raised a monument of stone alongside.

79.90 At Cor. to Secs. 21, 22, 27 & 28

Land rolling.

Soil 3rd rate.

Good Grass.

No timber- brush dense.

South on a true line bet. Secs 27 & 28.

Va. $11^{\circ} 33'$ E.

40.00 Set Limestone $14 \times 9 \times 6$ ins $2/3$ in the ground for $1/4$ Sec. Cor. marked
 $1/4$ on W. face, and raised a monument of stone alongside.

80.00 Set Limestone $18 \times 12 \times 4$ ins. $2/3$ in the ground for Cor. to Secs. 27,
28, 33 & 34, and marked with 1 notch on S. and 3 on E. edges and
raised a mound of stone alongside.

Land rolling.

Soil 3rd rate.

Good grass.

No timber- brush dense.

East on a random line bet. Secs 27 & 34.

Va. $11^{\circ} 33'$ E.

40.00 Set temporary $1/4$ Sec. corner.

Texas State Boundary line 5

Subdivision of a portion of T. 26. S.R. 23.

Chains.

80.20 Intersect N.& S. line 19 links N. of Cor. to Secs. 26, 27, 34
& 35, Thence I run

N. $89^{\circ} 52'$ W., on a true line with same Va.

40.10 Set Limestone $20 \times 18 \times 12$ ins. $\frac{3}{4}$ in the ground for $\frac{1}{4}$ Sec. Cor.
marked $\frac{1}{4}$ on N. face, and raised a mound of stone alongside.

80.20 At corner to Secs. 27, 28, 33 & 34.

Land rolling

Soil 3rd rate.

Good grass.

No timber-brush dense.

South on a true line bet. Sec. 33 & 34.

Va. $11^{\circ} 35'$ E.

30.53 Intersect line bet, Texas and New Mexico, 3.18 chs. W. of mound
recently established by me, 36 miles west of Monumnet on W side of
the Rio Pecos.

Set a Limestone $14 \times 14 \times 6$ ins $\frac{2}{3}$ in the ground for closing corner,
to fractional Secs. 33 & 34, marked C.C.N.M. on N.. T.L. on S.
with 3 notches on E.& W. edges and raised a mound of stone
alongside.

Land rolling.

Soil 3rd rate.

Good grass.

No timber.

Brush dense.

L-----

Texas State Boundary line 5

Texas State Boundary Line 5

Chains.

80.20 Intersect N. & S. line 19 links N. of cor. to Secs. 26, 27, & 34

& 35. Thence I run

N. 89° 52' W. on a true line with same Va.

40.10 Set limestone 20x18x12 ins. 3/4 in the ground for 1/4 Sec. Cor.

marked 1/4 on N. face, and raised a mound of stone alongside.

80.20 At corner to Secs. 27, 28, 33 & 34.

Land rolling

Soil 3rd rate.

Good grass.

No timber-brush dense.

Copied by
Marked by
Read on the bench
line of N. 77° 22'

South on a true line bet. Secs. 33 & 34.

Va. 11° 35' E.

30.58 Intersect line bet. Texas and New Mexico. S. 18 chs. W. of mound

recently established by me. 36 miles west of Monument on W side of

the Rio Pecos.

Set a limestone 14x14x6 ins 2/3 in the ground for closing corner.

to fractional Secs. 33 & 34, marked G.G.N.M. on N. T.L. on S.

with 3 notches on E. & W. edges and raised a mound of stone

alongside.

Land rolling.

Soil 3rd rate.

Good grass.

No timber.

Brush dense.

Counter # 74973

1883

B''