

Memoranda in Estate of Owen Shannon. W. Pattersons league
New Survey, has run into the north side of Shannons league 150 or 160
 varas thus

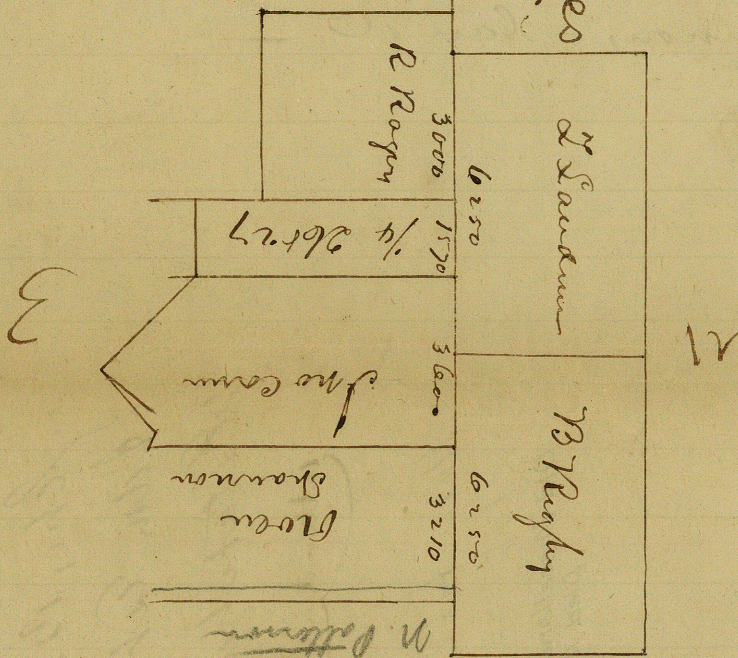

Raleigh Rogers league 2000 varas from S ^{or} West corner hits S.E. J. Sandams
 corner -- the sum of Sandam & Rigby leagues is 12500 - the sum
 of Rogers, Quarter 26027, John Canns league, and Owen Shannons
 league is 11380 - falling short of attaining Rigbys S.E. corner 1120
 varas - the survey for Patterson commences at Rigbys S.W. corner
 thence to his S.E. corner - thence down Rigbys East boundary
 line 1280 varas - which is going too far South and into Shannons
 land 160 varas - and the next line East 1800 varas
 gives a body of land 160 by 1800 varas taken out of
 Shannons in Pattersons survey. The difficulty can be

only adjusted by turning the East North line of
Cannons league and South ~~Bound~~ North boundary
of Oliver Shannon's - Jan 10 1

Minute to Mr Budd
of invasion of Shannon's
league by W Patt-
ersons League Survey
by Geo, B Steward
Adm Estate. J. Taylor
Estate having half of Shannon's league
attended to.

May file 139

Old Miscellaneous File 3
filed 12-13-1984