

The surveyor furnishes only fieldnotes and map of the sections of the subdivisions of the University lands, which is not in accordance with the act, one acted in relation to it.

According to the act, entitled "An Act authorizing the disposition and sale of the University Lands" the County- and District Surveyors in whose County or District any part of the Fifty leagues may be situated, are required to divide the same into tracts of one hundred and sixty acres each, but if there shall be any fractional balance of less than one hundred and sixty acres, the same shall be attached to the adjoining tract (of 160 acres).

He shall make a map of said work and fieldnotes in which each tract shall be numbered, and the quantity thereof stated; the lines and corners shall be fully described, and the point or points at which they may intersect any line; and the quantity of timber and prairie land, and the character of the same in each tract shall be stated as near as the same can be estimated, provided: that dividing said lands in 160 acre tracts shall consist in running sectionlines one mile apart, and establishing corners at the end of every half mile.

From the above it is evident, that the Surveyor is required to furnish fieldnotes of each 160 acre tract, though the act remits to him the running of the subdivisional lines of the sections, and requires only the sectional lines to be actually run. On the map every tract has to be delineated and regularly numbered, corresponding with the number, as given in the fieldnotes.

C. W. Trevelin

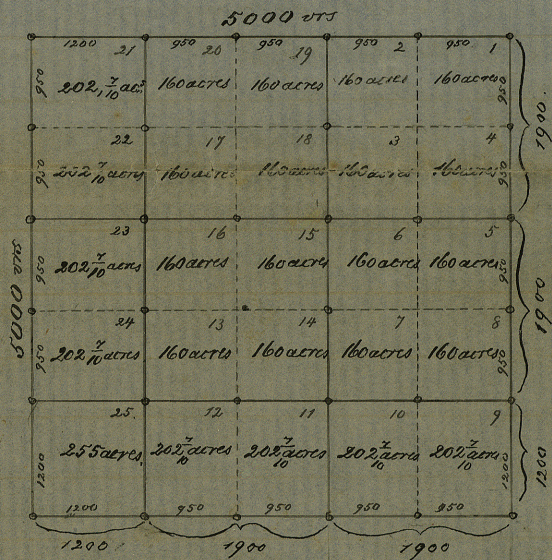

The above shows a square league, divided agreeably to the act.
 The full lines representing the sectional lines, one mile apart, which are required to be actually run.
 The dashed lines denote the subdivisional lines of the sections.
 The circular marks represent the corners to be established at every half mile.

Old Miscellaneous File 10
 Filed 12-13-1984

Counter # 75436