



Copy
12

Camp. Ringold.

Filed for record on this 3rd day
of August A.D. 1853, at 9 o'clock
A.M.

(Sgd.) J. N. Norton, Clerk
C. C. S. C.
Texas.

Recorded
8¹⁵ - on this 3rd day of August
A. D. 1853 -

(Sgd.) J. N. Norton, Clerk
C. C. S. C.

A true copy

Engelmann

Bohler & Co.

Charleston, W. Va.

The State of Texas,
County of Starr

J. A. N. Norton, Clerk of the County Court of
said County and State, do hereby certify that the within instru-
ment was filed & Recorded as hereon endorsed.

Witness my hand and the seal of said Court at
Rio Grande City on this 3rd day of August A.D.
1853.

(Sgd.) J. A. N. Norton, Clerk
C. C. S. C.
Texas.

State of Texas

County of Starr } At the request of Capt. H. C. Davis
I have surveyed four hundred yards square fronting
on the Rio Grande and enclosing as in the annexed figure
lettered A. B. C. & D. Camp Ringold containing 33. Ac.
O. R. S. P.

Commencing at A a post. Thence N. 30° 00' E.
266 yds. = 798 feet the big road leading from Rio Grande
City to Brownsville and at 1200 feet the corner B a post.
Thence S. 60° 00' E. at 640 feet the East boundary line of
Porcion N. 50. and at 1200 feet a post from whence a
Mousquite marked + bears N. 23° 00' W. 13 yds. 10 in.
in dia. at C. - Thence S. 30° 00' W. 798 feet big road
at 910 feet the East boundary line of Porcion N. 50. and
at 1200 yds. a little house on banks of river
thence up said River N. 60° 00' W. to the place
of beginning. - Other particulars given in the
notes of reference under the figure.

Procurencia Garza Chain
H. C. Davis } Carriers.

(Sgt.) R. C. Trimble. Surv.

The State of Texas } Before me A. N. Norton Clerk of
County of Starr } the County Court of said County,
on this 5th day of August A. D. 1853, personally appeared
Robert C. Trimble, who acknowledged to me that he
had signed and executed the above and foregoing in-
strument in his capacity of surveyor. -

Witness my hand and the seal of said
Court at Rio Grande City on this day
and date above written



(Sgt.) A. N. Norton Clerk
C. C. S. C.
Texas

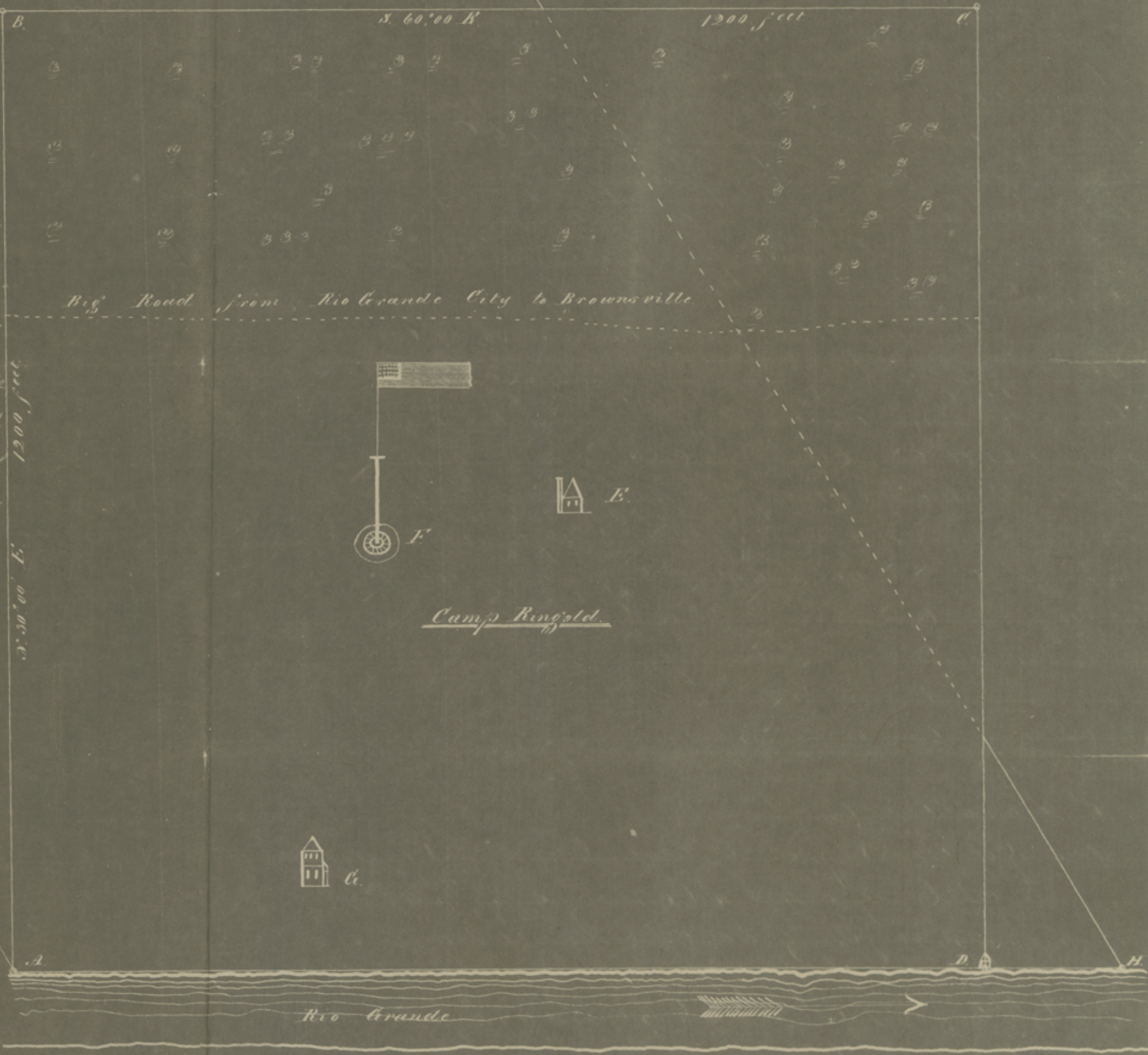

Notes of Reference

- E. Maj. Paul's Quarters
 - F. Flag Pole
 - G. Quarter Master's House, Office &c.
 - H. S. E. corner of Porcion N. 50. on the River.
- (Sgt.) R. C. Trimble
Surv.

D

2
2469
LD. QRS. MIL. DIV. HQ
CHIEF QRS. OFFICE
Received

OFFICE MILITARY
SECRETARY.

11/6
21850

DEPT. OF TEXAS.

COOPER 15963
D



U S MILITARY RESERVATION
FORT RINGGOLD, TEXAS.

SCALE 250 FEET TO ONE INCH.

References

- 1-9 Officers' Quarters
- 10 Chapel
- 11 Hospital
- 12 Hospital Steward's Quarters
- 13 Old Post Traders
- 14-17 Barracks
- 14a Bath house
- 16a Incubation Room
- 17a Bath house
- 18a Unoccupied
- 18b Bath house 15 ft } Unoccupied.
- 18c Unoccupied 16 ft }
- 18d Unoccupied 17 ft }
- 19-20 Stables
- 19a Bake house
- 20a Hospital men's Qrs. (255th) S.A. Scouts.
- 21 Quarters House
- 22 Adjutant's Office
- 23 Wash House
- 24 Livery House
- 25 Q.S. Officers' Qrs. (Old Line) Now Telegraph Station
- 26 Commissary Storehouse
- 27-28 U.S. Quarters
- 29 Magazine
- 30 Oil House
- 31 Q.S. Storehouse
- 32 Old Q.M. Storehouse
- 33 Pumping Station and Ice Plant
- 34 Cavalry Shop
- 35 Tailor Shop
- 36 Blacksmith's Shop. 41 Married Sould. Qrs. To Unused Esmin Sup.
- 37 Saddlery Shop
- 38 Wash House
- 39 Water Tanks
- 40 Vegetable Storehouse
- 41 Hospital Storehouse
- 42 Q.M. Stables
- 43 Cavalry Stables
- 44 U.S. Qrs.
- 45-48 Post Traders Residence and Storehouse
- 49 Hospital Storehouse (Abandoned Ice Plant)
- 50 Wash House
- 51 Tool House
- 52 Shed for mounted patrol
- 53 Officers' Qrs.
- 54 Genery
- 55 Engr. and Qrs.

Completed to Feb 6, 1903
J. S. [Signature]
Capt. U.S.A.

Line Perched 30

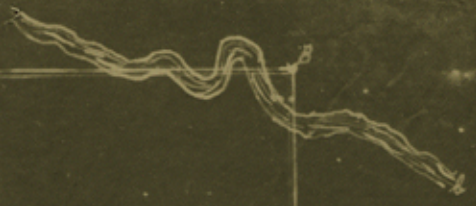
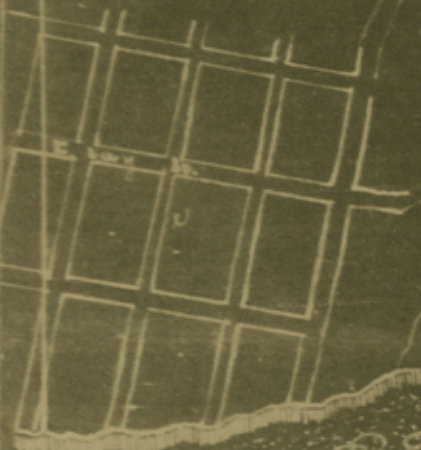

Domingo Garza
Cherish

Rio Grande present bed.

Vertical line with arrow pointing down

Scale 1000 feet

Plot
Ringgold Barracks
Texas.

(Sgd.) J. C. Girt
Dist. Surveyor
Starr Co. Tex.

114

12/31

Legend

n	to	m	N. 70° 45' W. 500 feet. magnetic = N 61° 30' W True
m		Co	N. 50° 15' W. 1035 " magnetic = N 41° W "
Co		A	N. 9° 15' E. 1900 "
A		B	S. 80° 45' E. 4166.7 "
B		D	S. 9° 15' W. 5224.7 "
D		n	N. 40° W. 3828.7 "
C			Stake on E. line M.R. intd. Co Sur. Morgan March 10 th 1879
D			" in Field on old bank of River
E			Carpenter Shop in Reservation
F			Quartermaster's Corral "
G			Iron pipe 2 inch in diameter 1900 feet from Por. line 80
a			Military Cemetery
b			Creek called " Arroyo de los Olmos "
c			Coast Road from Rio Grande City
d			Corpus Christi Road " " "
e			Rio Grande City
g			Rattle Land made by River
m			Nail in rear of G. M. Corral. at high water mark
n			" " " " Carpenter Shop in seam of Ignitic Rock
h			Fields.

(Signed) J. C. Ewert
Dist. Surveyor
Harris Co. Tex.

Note The courses as given in the Decree of Court touch N 70° 45' W and N 50° 15' W have reference to the magnetic meridian and are magnetic courses. and on the ground actually read N 61° 30' W and N 41° W

J. C. Ewert

Dist. Surveyor Harris Co. Tex.
COUNT 26132

State of Texas
County of Starr

Field notes of a survey made for the heirs and legal assigns of D. Antonio de la Garza. P. Alon original grantee under the Crown of Spain of that Tract of land lying and being in said County of Starr called Porcion 80. originally of the jurisdiction of Camargo Mexico.

Said survey was made to determine the bounding line between said Porcion and the Military Reservation of the United States known and called "Ringgold Barracks" agreeably to and in conformity with a Decree of the Hon. Dist. Court of Starr Co. which said decree is recorded in Book of the Minutes of the District Court pages 421 and 422. and for a more particular description of which, reference is hereby made.

Beginning at a large nail in a seam of Igneous Rock at low water mark on the Rio Grande in rear of the Carpenter Shop of the U. S. Mil. Reservation for the initial point of this survey.

magnetic

Thence N 70° 45' W 500 feet to a large nail at high water mark in rear of G. H. Coual

magnetic

Thence N 50° 15' W 1035 feet across large gulley or "Arroyo" to a Stake. said Stake

(1953)

bearing S 70° 45' E 1953 feet from the intersection of Clay Street in Rio Grande City with the west boundary line of Porcion 80.

Thence N 9° 15' E on west boundary of said Reservation.

(974)

at 474 feet a 2 inch Iron pipe set on north side of Rio Grande City and Brownville public Road at 974 feet crossed Corpus Christi and R. G. C. Road

(1085)

at 1085 crossed southern fence of fields

(1900)

at 1900 feet set Stake for N.W. corner of said Military Reservation.

Thence S 80° 45' E with northern boundary line of Reservation.

1942.5

at 1942.5 feet crossed center of Coast Road

2414.2

" 2414.25 " " " " Small bayou

3885

" 3885 " to bank of Creek called Los Olmos General Direction of Creek S.S.E.

4050

" 4050 " again crossed center of Arroyo

4166.7

" 4166.7 " set Stake for N.E. cor of Reservation

Thence S $9^{\circ} 15' W$ with East line of Reservation at 55.5 feet to northern bank of Arroyo.

General width of Arroyo. 30 feet.

2442 at 2442.0 feet intersected. Brownsville County Road

3091.3 " 3091.3 " set 2 inch Iron pipe on side of old Road mhd. to San-Maryon -

March 10th 1879.

Said pipe bears N $64^{\circ} 15' W$. 341.3 feet from S.E. corner of U.S. Cemetery.

4033.75 at 4033.75 feet crossed center of old Road

(4435) " 4435 " to high water mark on River

(5224.7) " 5224.7 " to low water mark on River where placed Stake

(4693) " 4693 " main bank of River

Thence with general course of River N $40^{\circ} 00' W$. 3828.7 feet to place of beginning comprising an area of 334 Acres. of Road and $11\frac{2}{10}$ Poles. -

J. C. Cirt
Hilario Contreras } Chain
beared

Survey concluded Mch 10th 1879
Instrument used a Survey Transit
Declination of Needle $9^{\circ} 15' E$.

State of Texas }
Dist. Starr Co. }

I J. C. Cirt Dist. Surveyor for Starr County do hereby certify that Nat. Calculation and Field-notes designates a Survey of the Military Reservation known as Ringgold Barracks, concluded on the 10th day of March A.D. 1879, and I further certify that the limits bounds, corners &c. together with all marks natural and artificial are therein truly described. Said Survey is recorded in my Office in Book _____ pages of the Record of Surveys of Starr Co.

(sgd.) J. C. Cirt
Dist. Surveyor Starr Co.

+

Calculations of Content

Pinggold Barracks Texas

Station	Bearing	Distance	Latitudes		Departures		Double Longitude	Double Areas		
			N	S	E	W		N	S	
1	N 61° 30' W	5000	237			439	7041	1668	717	
2	N 41° W	1035	782			679	8159	6380	338	
3	N 9° 15' E	1900	1875		306		8532	15997	3000	
4	S 80° 45' E	4167		670	4113		4113		2755	710
5	S 9° 15' W	5225		5157		840	840		4331	880
6	N 40° W	3829	2933			2461	4141	12145	553	

5827

5827

4419

4419

34 feet

Acres

R

P

Content = 14.552.159 = 334 - 0 - 11.2

March 10/1879

J. C. Smith
Dist. Surveyor
Star Co. Tex

(over)

Fork Briggall Texas
April 1st 1879

The above field notes correspond in
bearings and distances with survey
of the Military Reservation of Fork
Briggall Texas as plotted by myself
during the month of March 1879

J. A. Morgan
Capt. 24th Inf.

1605

1

9

3580
 3/30 RECEIVED
 DIV. 1579
 DR. WAR. GEN'S OFFICE
 1879

7099
 WAR DEPT.
 1880

Survey of the Military Reservation of Fort Ringgold Texas made by Capt. James H. Morgan (assisted by J. C. Bird Dist. Surveyor Starr County Texas) 1875

March 15/79

225603

5596 1st REGIMENT.

2

3580 2907879

Starr Rolled sk. No. X

COUNTY # 9939 - ~~W. H. Dodds~~ (HOLD FOR NOW)

Starr Rolled sk. No. X

Copies of Plats
from General Land Office
WASHINGTON, D.C.

Showing
Fort RING GOLD and
adjacien territory in

STARR COUNTY-

These Plats precured in person by
Hon J.T. Robison, Com'r., General
Land Office, Texas, December 1920
for use of Capt R.S. Dod, in making
resurvey of PORCIONS Nos 80 to 90 and
adjacent territory north - see his
Report and Plat filed Feby 8th 1921
"Rolls Sketches" Starr County -

Starr COUNTY ROLLED SKETCH NO. "X"

Copies of Plats from G.L.O. at Washington D.C. showing
Fort Ring Gold and adjacent Territory
SURVEYED BY

FILED Dec. 1920

5/9/58 - J.L.W.

11 small sheets
4 large sheets

Starr Rolled sk. No. X

COUNTER 76138

Starr Rolled sk. No. X

N 80° 45' W. 1500 Varas = 41667 Feet.



RIO GRANDE CITY

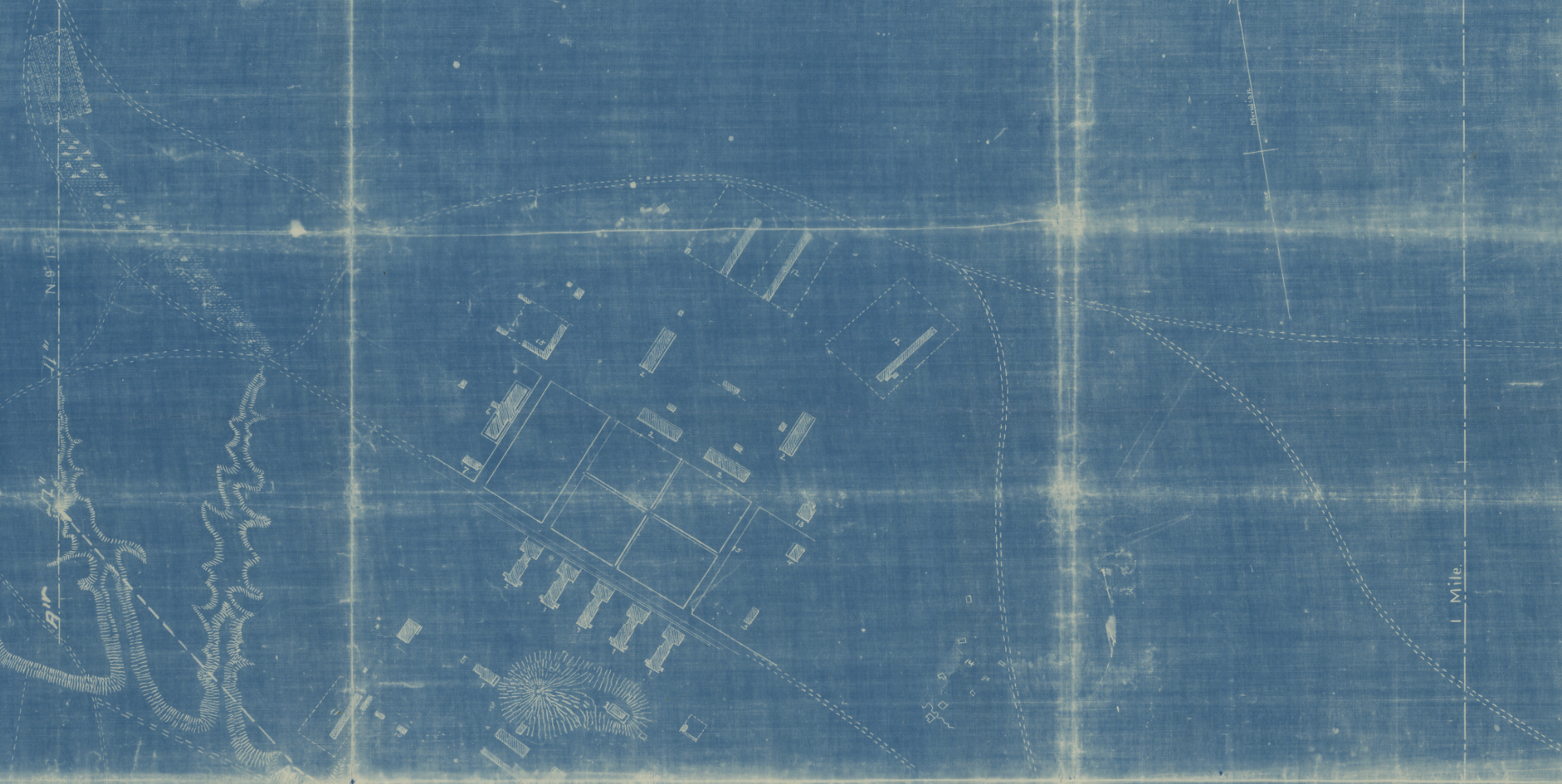

DEPARTMENT OF TEXAS
BRIG. GEN. E. O. CORD, COMD'G

POST OF
RINGGOLD BARRACKS
TEXAS

Surveyed and drawn
under the direction of
CAPT. JAMES F. GREGORY
Corps of Engineers.
by
O. S. WILSON, C. E.

1877.

Scale: 1:5000



Note: Proposed reservation lines
Line dividing portions 79 and 80
General height of bluff above low water about 23 feet
Latitude of sun dial 25° 22' 37"

- Legend.
- | | |
|------------------------|------------------------------|
| 1. Officers' quarters. | 2. Barracks. |
| 2. Adjutant's office. | 3. Prison House. |
| 3. Sun dial. | 4. Hospital. |
| 4. Chapel. | 5. G. M. Store House. |
| 5. Carpenter Shop. | 6. Blacksmith Shop. |
| 6. Corral. | 7. Cavalry Stables. |
| 7. Bakery. | 8. Quartermaster's quarters. |
| 8. Sutter's Store. | 9. Cemetery. |
| 9. Brick Kilns. | 10. Storehouse. |

Ad. Gen. Dept. of Texas
Chief of Artillery Office
July 21, 1877.
Keogh by permission
for use in the Department
for the purpose of

R
I
O
G
R
A
N
D
E
R
I
V
E
R
M
E
X
I
C
O

1 Mile
N 89° 15' E

23577666 61000000

James F. Gregory
Chief of Artillery
July 21, 1877

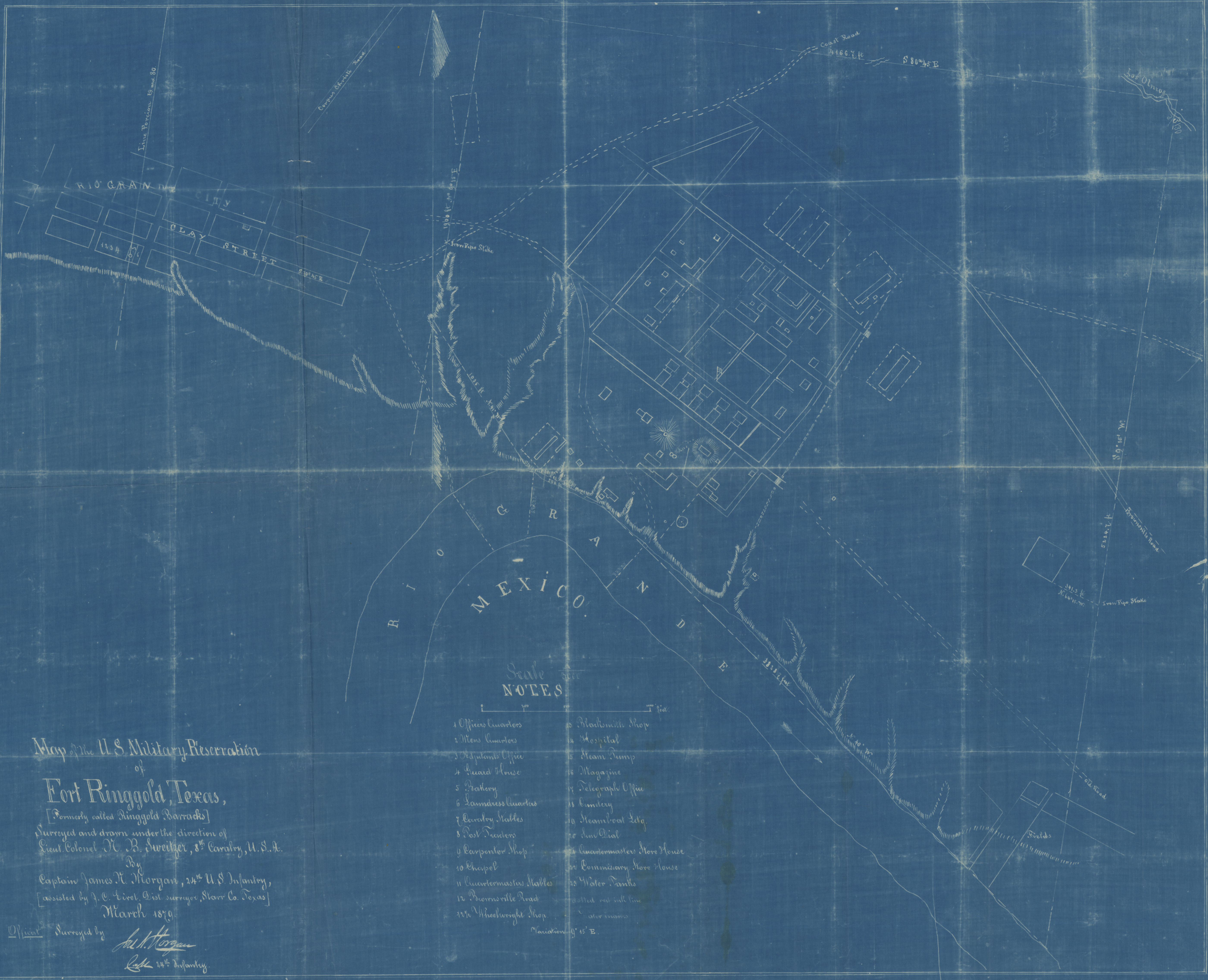

Map of the U.S. Military Reservation
of

Fort Ringgold, Texas,
[Formerly called Dinggold Barracks]

Surveyed and drawn under the direction of
Lieut. Colonel H. B. Sweitzer, 8th Cavalry, U. S. A.

By
Captain James H. Morgan, 24th U. S. Infantry,
[assisted by J. C. E. Dist. surveyor, Starr Co. Texas]
March 1879.

Official Surveyed by
J. H. Morgan
Lieut. 24th Infantry.

Scale
NOTES

- | | |
|--------------------------|------------------------------|
| 1 Officers Quarters | 10 Millwright Shop |
| 2 Mens Quarters | 11 Hospital |
| 3 Adjutant's Office | 12 Steam Pump |
| 4 Guard House | 13 Magazine |
| 5 Bakery | 14 Telegraph Office |
| 6 Saddlers Quarters | 15 Cemetery |
| 7 Cavalry Stables | 16 Steam Boat Ldg. |
| 8 Post Trainers | 17 Saw Mill |
| 9 Carpenter Shop | 18 Quartermaster Store House |
| 10 Chapel | 19 Commissary Store House |
| 11 Quartermaster Stables | 20 Water Tanks |
| 12 Drumsville Road | 21 Colled red salt line |
| 13 Wheelwright Shop | 22 Water Tanks |
- Location of 15th E.