

R0001270

FIELD NOTES-SURVEY REPORT

J N NEWTON

To

THE PUBLIC-TR SCS 23,18 BK A-9 PSL

Filed For Record

On

Apr 16, 2002

At

03:58PM

Honorable Pat Lacy
County Clerk
Gaines County
By Connie Curtis

Total

15.00

J.N. NEWTON & ASSOCIATES
215 SW 2ND STREET
SEMINOLE, TX 79360

STATE OF TEXAS COUNTY OF GAINES

I hereby certify that this instrument was
filed on the date and time stamped hereon
by me and was duly recorded in the volume and
page of ~~the~~ *Field Notes* records of Gaines County,
Texas as stamped hereon by me.

APR 16 2002



Pat Lacy
PAT LACY, County Clerk
GAINES COUNTY, TEXAS

Counter # 76362

J.N. NEWTON & ASSOCIATES

Land Surveying and Mapping
1-800-284-2607
Fax 915-758-9090

J.N. Newton
215 S.W. 2nd Street
Seminole, Texas 79360
915-758-2015

Michel J. Newton
1215 Belaire
Andrews, Texas 79714
915-524-2015

SURVEY REPORT

At the request of the owners, we have been employed to make a survey for the purpose of obtaining a patent on the N/2 of Section 18, E/2 and NW/4 of Section 23, Block A-9, Public School Land, Gaines County, Texas.

Block A-9 was originally laid out by surveyor D. Boone in 1900. In the vicinity of our project, none of the original monuments survive today. Patents have been issued on the surrounding surveys on either the original Boone notes, or corrected notes by A.L. Harris, Sylvan Sanders, or C.A. Tubbs, all longtime surveyors in the county.

Several patent corners, or the perpetuated position thereof, have been recovered as indicated on our plat. The centerline of State Farm Road 3306, bordering our project on the East, was built on these surveys. The 1" iron pipe found at the common corner to Sections 22 and 23, Block A-9, and Sections 2 and 3, Block A-10, agrees with the Southerly right-of-way line of Highway 62 and 180 as deeded. The Southwest corner of Section 25, Block A-9, can be ascertained from the 1911 resurvey of the 103rd Meridian by the U.S. Boundary Commission, in which they make a passing call to D. Boone's iron pipe. The line between said Blocks A-9 and A-10, can then be located by connecting the two corners with a straight line.

The accompanying plat and field notes reflect of our construction of the subject property, allowing for the position of the prior patents.

Respectfully submitted,

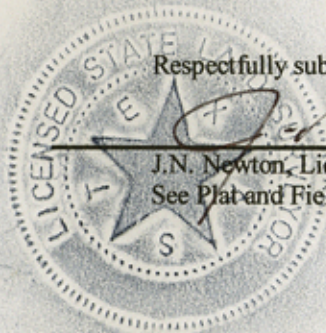

9556RPT

J.N. Newton, Licensed State Land Surveyor

See Plat and Field Notes

File No. Sketch File 24

GAINES

N/2 Sect. 18; E/2 & NW/4 Sect. 23 County
Blk. A-9 PSL

Date Filed: 4-30-2002

David Dewhurst, Commissioner

Douglas Howard

See Pld. SK. 33*

Sheet 1 of 2



J.N. NEWTON & ASSOCIATES

Land Surveying and Mapping
1-800-284-2607
Fax 915-758-9090

J.N. Newton
215 S.W. 2nd Street
Seminole, Texas 79360
915-758-2015

Michel J. Newton
1215 Belaire
Andrews, Texas 79714
915-524-2015

SURVEY REPORT

At the request of the owners, we have been employed to make a survey for the purpose of obtaining a patent on the N/2 of Section 18, E/2 and NW/4 of Section 23, Block A-9, Public School Land, Gaines County, Texas.

Block A-9 was originally laid out by surveyor D. Boone in 1900. In the vicinity of our project, none of the original monuments survive today. Patents have been issued on the surrounding surveys on either the original Boone notes, or corrected notes by A.L. Harris, Sylvan Sanders, or C.A. Tubbs, all longtime surveyors in the county.

Several patent corners, or the perpetuated position thereof, have been recovered as indicated on our plat. The centerline of State Farm Road 3306, bordering our project on the East, was built on these surveys. The 1" iron pipe found at the common corner to Sections 22 and 23, Block A-9, and Sections 2 and 3, Block A-10, agrees with the Southerly right-of-way line of Highway 62 and 180 as deeded. The Southwest corner of Section 25, Block A-9, can be ascertained from the 1911 resurvey of the 103rd Meridian by the U.S. Boundary Commission, in which they make a passing call to D. Boone's iron pipe. The line between said Blocks A-9 and A-10, can then be located by connecting the two corners with a straight line.

The survey was made upon the ground in 1995, and we have visited the site again this year. N.G.S. Station "BETTIE" has now been either plowed out or covered up, as the land has now been placed in cultivation.

The accompanying plat and field notes reflect of our construction of the subject property, allowing for the position of the prior patents, and was tied to said Station "BETTIE", using published coordinates of N.156,015.716 varas, E.109,686.031 varas, theta (mapping angle) = $-3^{\circ}00'30''$, Texas Coordinate System of 1927, North Central Zone.

Respectfully submitted,

J.N. Newton, Licensed State Land Surveyor
See Plat and Field Notes

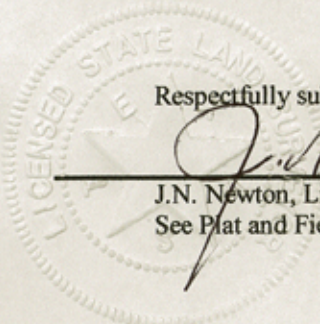

9556RPT

Sheet 2 of 2

Counter # 76364