

RECEIVED
 OCT 3 2002

LINE	DISTANCE	BEARING
L1	92.96'	S 00°37'37" E
L2	90.14'	S 02°02'11" E
L3	89.98'	S 01°12'38" E
L4	76.97'	S 07°10'04" E
L5	84.81'	S 08°08'59" E
L6	91.44'	S 08°47'39" E
L7	85.21'	S 05°35'17" E
L8	22.90'	S 01°22'07" E
L9	35.80'	S 10°54'51" E
L10	109.42'	S 12°15'31" E
L11	97.89'	S 18°23'33" E
L12	97.50'	S 18°38'44" E
L13	89.29'	S 14°55'18" E
L14	90.40'	S 16°43'09" E
L15	88.64'	S 14°34'19" E
L16	96.08'	S 14°17'15" E
L17	88.65'	S 15°01'15" E
L18	80.87'	S 18°26'41" E
L19	87.86'	S 17°10'46" E
L20	83.51'	S 16°39'32" E
L21	105.72'	S 16°46'30" E
L22	89.49'	S 14°52'44" E
L23	121.63'	S 15°12'32" E
L24	26.85'	S 11°21'05" W
L25	79.75'	S 27°51'16" E
L26	83.65'	S 30°52'45" E
L27	7.76'	N 65°00'10" E
L28	55.79'	S 24°01'32" E
L29	82.53'	S 13°04'20" E
L30	85.59'	S 09°56'34" E
L31	79.93'	S 10°32'25" E
L32	68.66'	S 20°30'03" E
L33	87.47'	S 37°41'24" E
L34	49.17'	S 61°31'32" E
L35	89.18'	S 83°30'09" E
L36	103.85'	S 83°47'25" E
L37	102.75'	S 80°16'28" E
L38	84.06'	S 82°32'26" E
L39	85.32'	N 76°02'23" E
L40	77.88'	N 75°48'33" E
L41	77.80'	S 78°52'41" E
L42	39.44'	S 74°05'07" E

Survey of a portion of
Pelican Island
 City of Galveston
 Gammel's Law of Texas Volume 8, Page 1490
 Galveston County, Texas

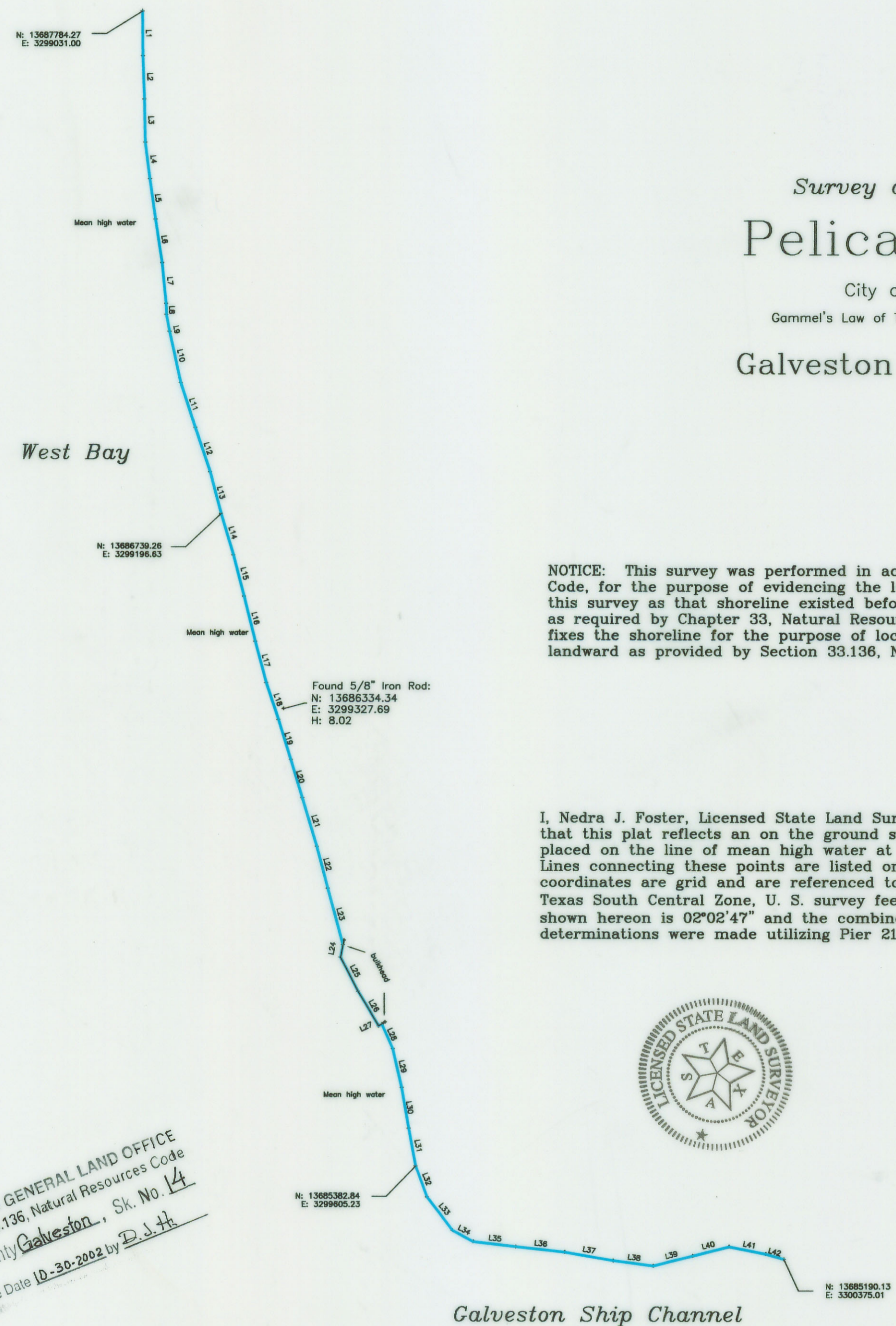

NOTICE: This survey was performed in accordance with Section 33.136, Natural Resources Code, for the purpose of evidencing the location of the shoreline in the area depicted in this survey as that shoreline existed before commencement of erosion response activity, as required by Chapter 33, Natural Resources Code. The line depicted on this survey fixes the shoreline for the purpose of locating a shoreline boundary, subject to movement landward as provided by Section 33.136, Natural Resources Code.

I, Nedra J. Foster, Licensed State Land Surveyor in the State of Texas, do hereby certify that this plat reflects an on the ground survey performed by me and all points were placed on the line of mean high water at the time of the survey, August 30, 2002. Lines connecting these points are listed on the map and are meander lines. All coordinates are grid and are referenced to the State Plane Coordinate System, NAD 83, Texas South Central Zone, U. S. survey feet. The gamma correction at the 5/8" iron rod shown hereon is 02°02'47" and the combined scale factor is 0.999862912. Tidal determinations were made utilizing Pier 21 as primary gauge.

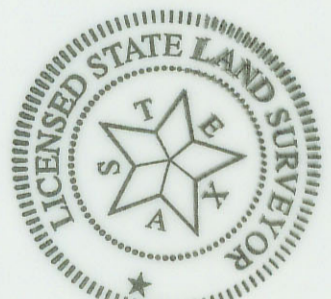

Nedra J. Foster
 Nedra J. Foster
 Licensed State Land Surveyor



TEXAS GENERAL LAND OFFICE
 Art. 33.136, Natural Resources Code
 County Galveston, Sk. No. 14
 File Date 10-30-2002 by D. J. H.

Shine & Associates
 330 North 4th Street
 P. O. Box 305
 Seabree, Texas 77656
 409-385-9383