

JOHNSON HUNTER SURVEY ABSTRACT NO. 35

LINE	BEARING	DISTANCE
L1	N66°20'58"E	57.46'
L2	N28°09'34"E	275.06'
L3	N52°07'10"E	74.15'
L4	N07°45'13"E	78.33'
L5	N19°41'19"E	98.26'
L6	N22°58'53"E	142.04'
L7	N23°08'02"E	217.97'
L8	N24°47'50"E	149.68'
L9	N22°53'18"E	138.66'
L10	N24°40'50"E	133.21'
L11	N18°47'50"E	124.18'
L12	N26°04'45"E	156.40'
L13	N26°15'36"E	210.04'
L14	N24°02'40"E	198.58'
L15	N26°27'54"E	96.07'
L16	N20°25'42"E	103.90'
L17	N23°44'01"E	114.59'
L18	N26°52'50"E	93.14'
L19	N17°23'48"E	34.82'
L20	N36°52'38"W	64.33'
L21	N15°51'14"W	16.02'

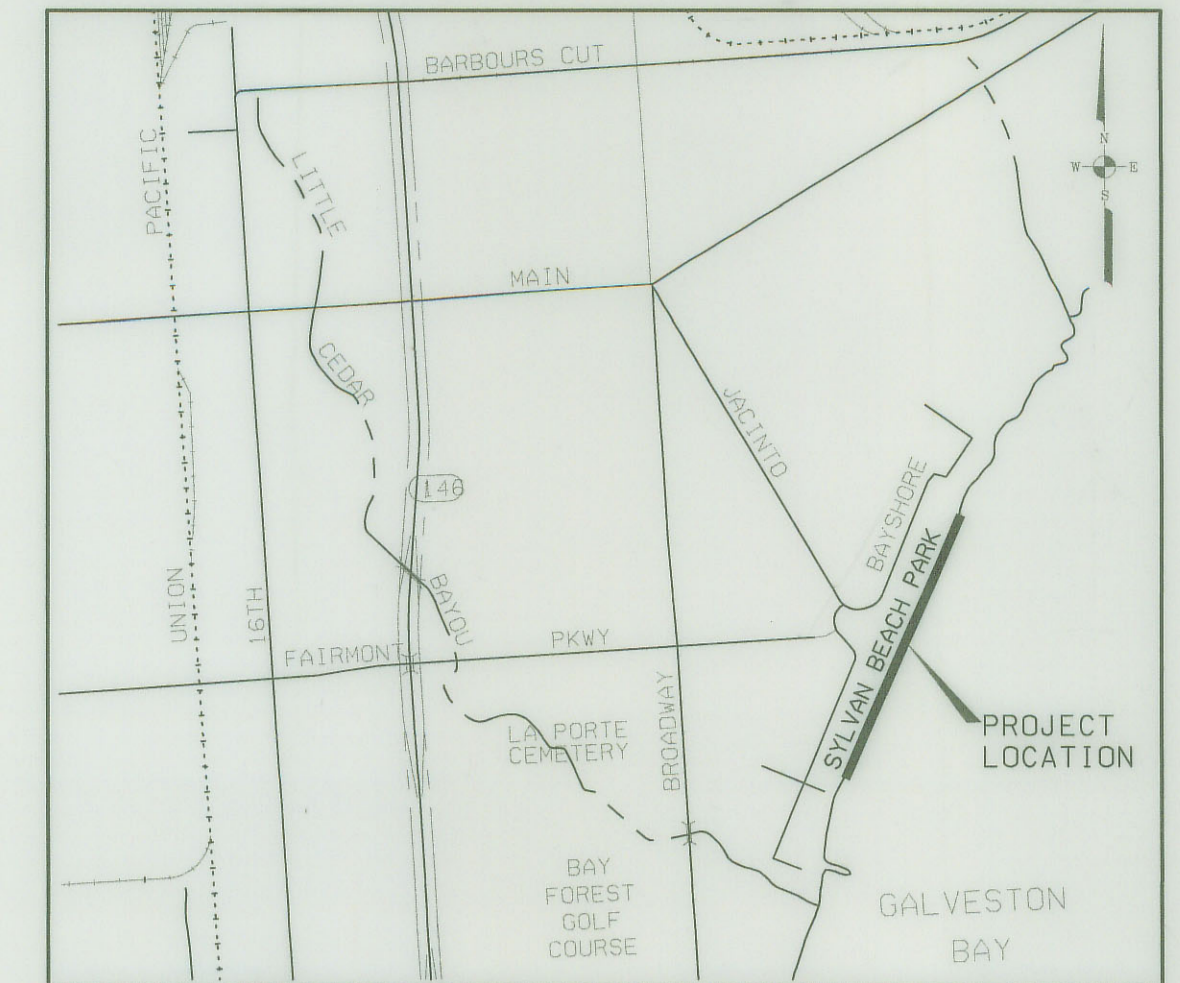
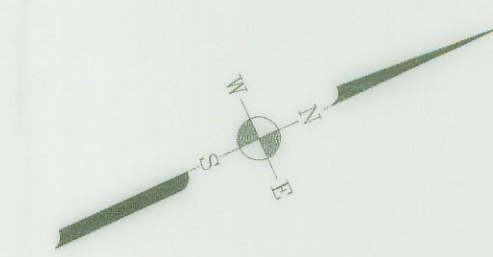

LOCATION MAP
NOT TO SCALE

SYLVAN BEACH PARK

HARRIS COUNTY
VOLUME 2629, PAGE 19
JUNE 1, 1953
VOLUME 2941, PAGE 188
APRIL 4, 1955
HARRIS COUNTY DEED RECORDS

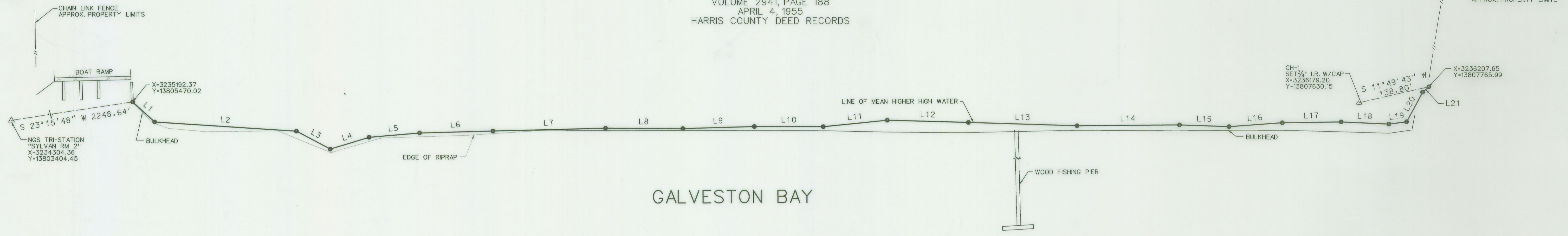

GALVESTON BAY

NOTICE: This survey was performed in accordance with Section 33.136, Natural Resources Code, for the purpose of evidencing the location of the shoreline in the area depicted in this survey as that shoreline existed before commencement of erosion response activity, as required by Chapter 33, Texas Natural Resources Code. The line depicted on this survey fixes the shoreline for the purpose of locating a shoreline boundary, subject to movement landward as provided by Section 33.136, Natural Resources Code.

TEXAS GENERAL LAND OFFICE
Art. 33.136, Natural Resources Code
County HARRIS, Sk. No. 5
File Date 9/11/2002 by D. J. H.

SURVEY OF A PORTION OF GALVESTON BAY ADJACENT TO THE JOHNSON HUNTER SURVEY, ABSTRACT NO. 35 HARRIS COUNTY, TEXAS

I, Robert L. Pounds, Licensed State Land Surveyor in the State of Texas, hereby certify that this plat reflects an on the ground survey and that the meander lines shown hereon connect points placed on the line of mean higher high water at the time of the survey on July 12, 2002. All bearings and coordinates shown hereon are grid (U.S. survey feet) and are referenced to the Texas Coordinate System, NAD 83, South Central Zone and NGS tri-station "SYLVAN RM 2." Distances shown hereon are surface. To convert surface distances to grid distances, multiply surface values by the project combined factor at survey control point CH-1 (mapping angle = 1°57'19") of 0.999878525. Tidal determinations were based on NOAA tidal benchmark "Morgans Point, Barboours Cut."

Robert L. Pounds
Robert L. Pounds
Licensed State Land Surveyor

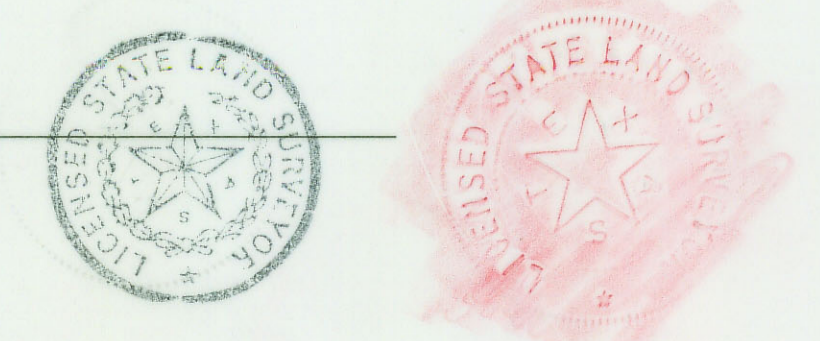

LANDTECH CONSULTANTS, INC.
Civil Engineering * Land Surveying
2627 North Loop West
Suite 224
Houston, Texas 77008
Tel. (713) 861-7068 Fax (713) 861-4131

DATE: July 23, 2002
SCALE: 1" = 100'
DRAWING No.: 1242-D-1960
JOB No.: 02-1-0148
SHEET No.: 1 OF 1