

Chambers Galveston County NRC Art. 33.136 Sketch 21

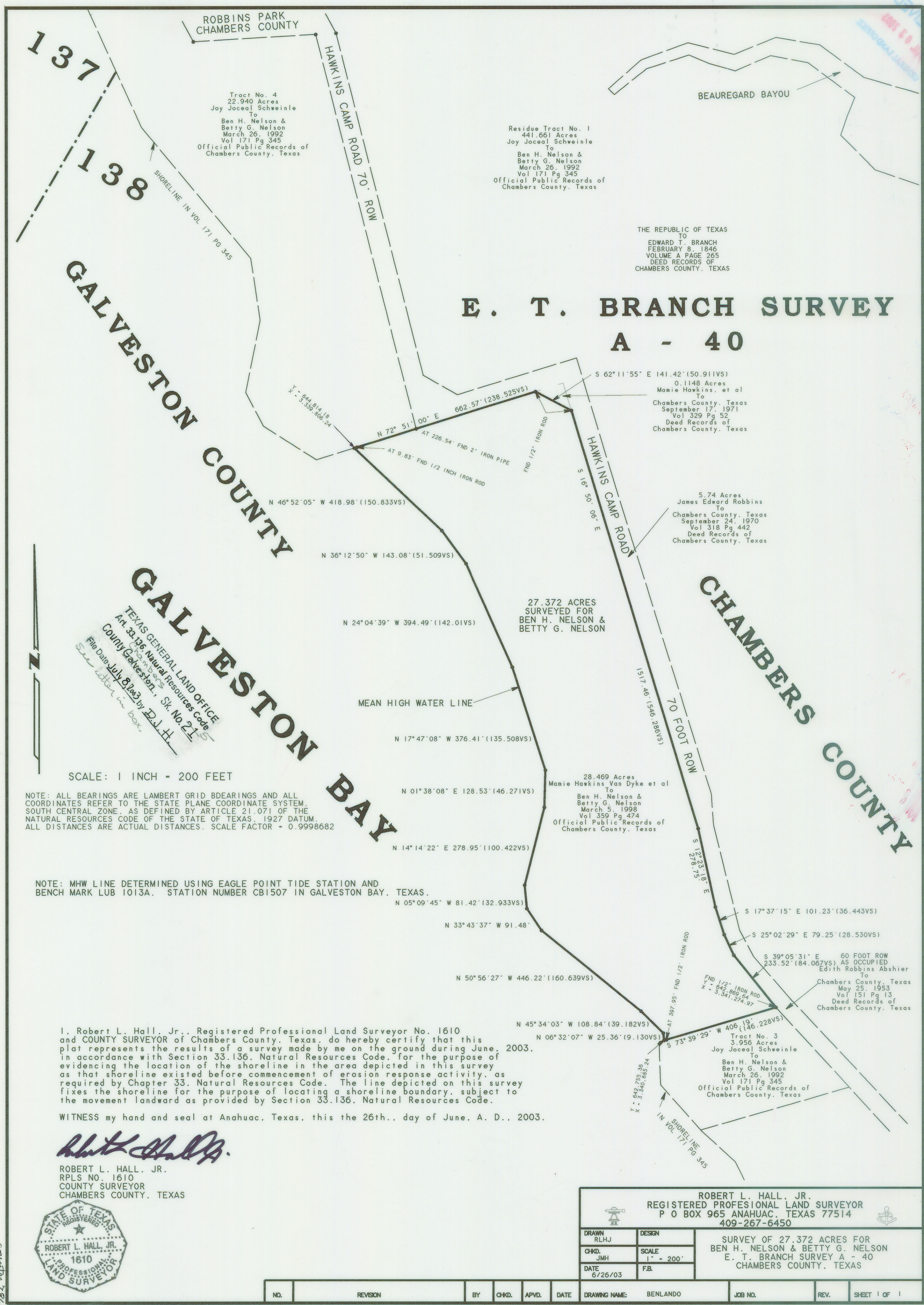

E. T. BRANCH SURVEY A - 40

TEXAS GENERAL LAND OFFICE
 Art. 33.136, Natural Resources Code
 County Galveston, Sk. No. 215
 File Date July 8, 2003 by R.L.H.
 See letter in box

SCALE: 1 INCH = 200 FEET

NOTE: ALL BEARINGS ARE LAMBERT GRID BEARINGS AND ALL COORDINATES REFER TO THE STATE PLANE COORDINATE SYSTEM, SOUTH CENTRAL ZONE, AS DEFINED BY ARTICLE 21.071 OF THE NATURAL RESOURCES CODE OF THE STATE OF TEXAS, 1927 DATUM. ALL DISTANCES ARE ACTUAL DISTANCES. SCALE FACTOR = 0.9998682

NOTE: MHW LINE DETERMINED USING EAGLE POINT TIDE STATION AND BENCH MARK LUB 1013A. STATION NUMBER CB1507 IN GALVESTON BAY, TEXAS.

I, Robert L. Hall, Jr., Registered Professional Land Surveyor No. 1610 and COUNTY SURVEYOR of Chambers County, Texas, do hereby certify that this plat represents the results of a survey made by me on the ground during June, 2003, in accordance with Section 33.136, Natural Resources Code, for the purpose of evidencing the location of the shoreline in the area depicted in this survey as that shoreline existed before commencement of erosion response activity, as required by Chapter 33, Natural Resources Code. The line depicted on this survey fixes the shoreline for the purpose of locating a shoreline boundary, subject to the movement landward as provided by Section 33.136, Natural Resources Code.

WITNESS my hand and seal at Anahuac, Texas, this the 26th.. day of June, A. D., 2003.

Robert L. Hall, Jr.

ROBERT L. HALL, JR.
RPLS NO. 1610
COUNTY SURVEYOR
CHAMBERS COUNTY, TEXAS

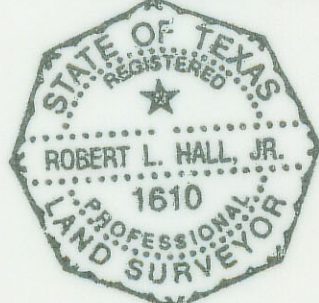

ROBERT L. HALL, JR.
REGISTERED PROFESSIONAL LAND SURVEYOR
P O BOX 965 ANAHUAC, TEXAS 77514
409-267-6450

DRAWN RLHJ	DESIGN	SURVEY OF 27.372 ACRES FOR BEN H. NELSON & BETTY G. NELSON E. T. BRANCH SURVEY A - 40 CHAMBERS COUNTY, TEXAS
CHKD. JMH	SCALE 1" = 200'	
DATE 6/26/03	F.B.	

NO.	REVISION	BY	CHKD.	APVD.	DATE	DRAWING NAME: BENLANDO	JOB NO.	REV.	SHEET 1 OF 1
-----	----------	----	-------	-------	------	------------------------	---------	------	--------------

R. L. HALL, JR. SURVEYOR, INC.

PO BOX 994
ANAHUAC, TX 77514
409-267-6450
409-267-3461 FAX

June 26, 2003

Mr. Ben Thompson
Survey Division
General Land Office
State of Texas
1700 North Congress
Austin, TX 78701

Dear Ben,

Enclosed is one mylar of the plat showing the boundary of Galveston Bay at Smith Point Texas. The shoreline along this 27.372 acre tract of land is the only area that Ben Nelson proposes to try to impede the erosion along the shore line. He is working with the Corps of Engineers on this project.

Gary McMahan is with the Land Office in La Porte, Texas. His number is 281-471-0391 extension 113. He is working with Ben Nelson and the Corps.

If you need additional information or I need to add an item to the plat, please let me know.

Thanks,



Bobby

