

NOTES:

- COORDINATES SHOWN ARE BASED ON LAMBERT GRID, TEXAS SOUTH CENTRAL ZONE, NAD '83 (1993), U.S. SURVEY FEET.
- MONUMENTS USED FOR HORIZONTAL CONTROL WERE:
 - A FADDEN N 13,818,416.56 E 3,519,789.27
 - B LONE N 13,836,523.18 E 3,571,685.29
 - E TAMU1 N 13,823,287.69 E 3,532,369.45
- MONUMENTS USED FOR VERTICAL CONTROL WERE:
 - C E1015 ELEV. 6.02' NAVD '88
 - D X1014 ELEV. 6.40' NAVD '88
 - E TAMU1 ELEV. 5.81' NAVD '88
- MEAN HIGHER HIGH WATER (MHHW) DETERMINED FROM TIDAL OBSERVATIONS FROM SABINE PASS GAUGE AND GALVESTON PLEASURE PIER GAUGE.

LEGEND:

- A SURVEY CONTROL POINT
- 1 MHHW COORDINATES (SEE SCHEDULE)

MHHW POINT	X-COORDINATE	Y-COORDINATE
1	3,519,754.98	13,817,733.94
2	3,520,211.96	13,817,937.03
3	3,520,674.99	13,818,147.23
4	3,521,126.56	13,818,344.00
5	3,521,587.23	13,818,553.81
6	3,522,039.43	13,818,743.27
7	3,522,503.26	13,818,935.64
8	3,522,960.70	13,819,136.31
9	3,523,424.36	13,819,337.51
10	3,523,877.74	13,819,542.07



McFADDIN NATIONAL WILDLIFE REFUGE

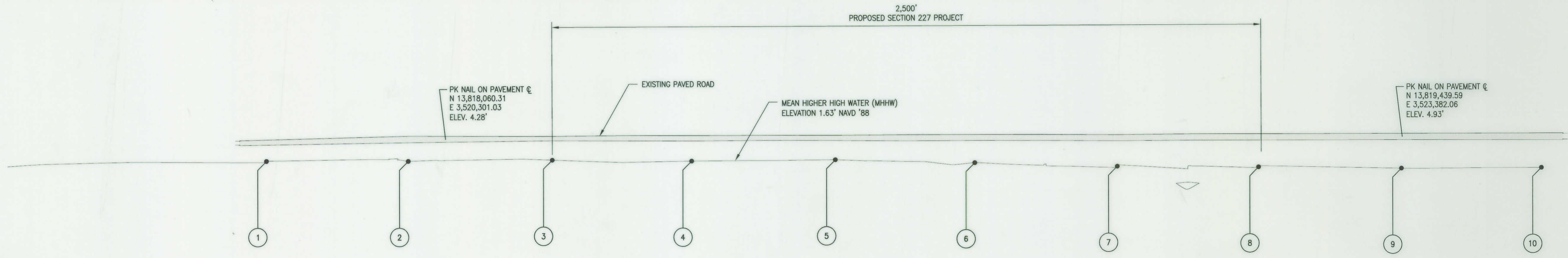

GULF OF MEXICO
 TEXAS GENERAL LAND OFFICE
 Art. 33.136, Natural Resources Code
 County Jefferson, Sk. No. 3
 File Date July 7, 2003 by D.J.H.
 See Report 1
 See Report in book

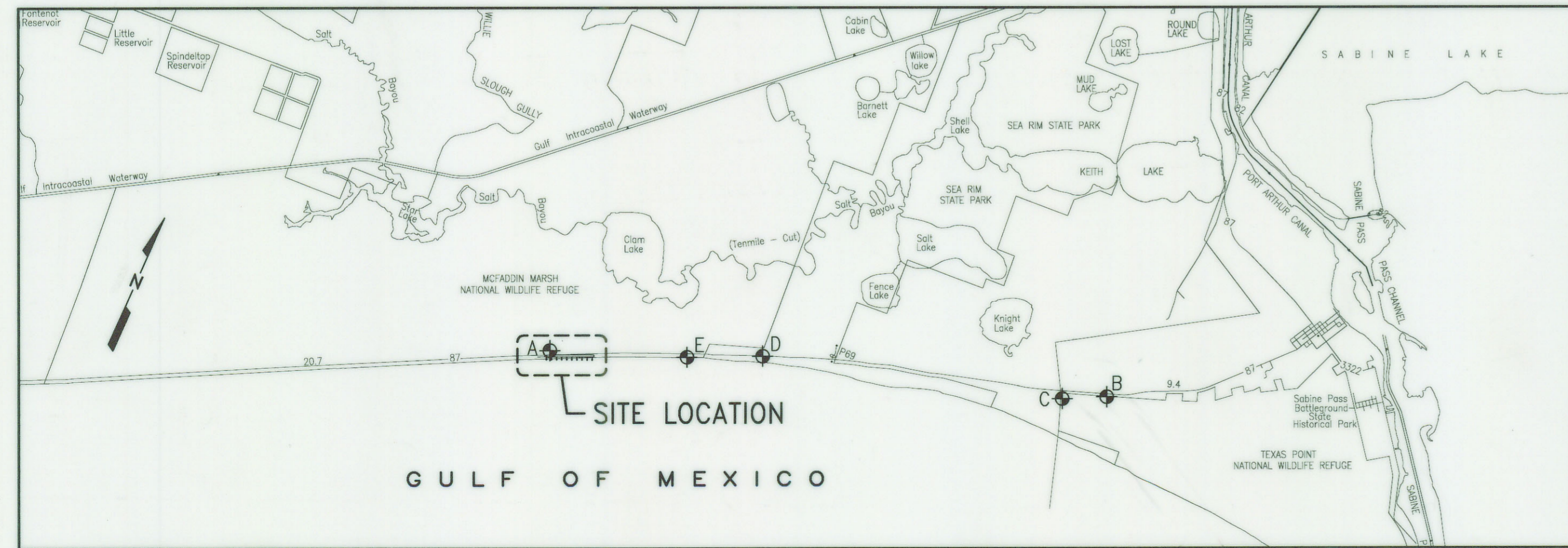
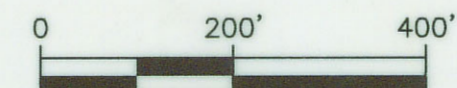

WE, SHINER MOSELEY AND ASSOCIATES, INC., WITH THE ASSISTANCE OF MICHAEL HAAS, A LICENSED STATE LAND SURVEYOR IN THE STATE OF TEXAS, HEREBY STATE THAT THIS DRAWING REPRESENTS THE CONDITIONS THAT EXISTED AT THE TIME OF THE BEACH SURVEY CONDUCTED ON DECEMBER 19, 2002.

NOTICE: THIS SURVEY WAS PERFORMED IN ACCORDANCE WITH SECTION 33.136, NATURAL RESOURCES CODE, FOR THE PURPOSE OF EVIDENCING THE LOCATION OF THE SHORELINE IN THE AREA DEPICTED IN THIS SURVEY AS THAT SHORELINE EXISTED BEFORE COMMENCEMENT OF EROSION RESPONSE ACTIVITY, AS REQUIRED BY CHAPTER 33, NATURAL RESOURCES CODE. THE LINE DEPICTED ON THIS SURVEY FIXES THE SHORELINE FOR THE PURPOSE OF LOCATING A SHORELINE BOUNDARY, SUBJECT TO EROSION LANDWARD AS PROVIDED BY SECTION 33.136, NATURAL RESOURCES CODE.

THIS SURVEY DOES NOT NOR IS IT INTENDED TO BE USED TO IDENTIFY, DELINEATE, OR FIX THE LINE OF VEGETATION OR THE LANDWARD BOUNDARY OF THE PUBLIC BEACH.

STATE OF TEXAS REGISTERED PROFESSIONAL LAND SURVEYOR
 GEORGE RUBALCABA
 229
 2-21-03
 REGISTERED PROFESSIONAL LAND SURVEYOR

Michael Haas
 MICHAEL HAAS, RPLS
 LICENSED STATE LAND SURVEYOR



REV	DATE	DESCRIPTION	APP
0	10-22-01	ORIGINAL ISSUE	
1	08/30/02	REISSUED TO CLIENT	
2	2/17/03	NEW AREA SURVEY	

DCC	DATE	DESCRIPTION
GR	2/03	
GRAPHIC		
		10115-01-C1.DWG
		200.10115.01

SHINER MOSELEY AND ASSOCIATES, INC.
 ENGINEERS & CONSULTANTS
 555 North Carancahua Street, Suite 1650
 Corpus Christi, Texas 78478

GULF ENGINEERS & CONSULTANTS
LSLS SURVEY FOR SECTION 227 PROJECT
 TEXAS
 JEFFERSON COUNTY
SITE PLAN

SHEET
C1
 OF 1 REV 0

J:\SMAcad\Projects\2001\10115\dwg\01\10115-01-C1.dwg 2/20/2003 3:35:50 PM CST



February 20, 2003

J200.10115.02

Mr. Ben Thompson
Texas General Land Office
1700 N. Congress Avenue
Austin, Texas 78701-1495

**RE: BEACH SURVEY AT JEFFERSON COUNTY
(STATE COASTAL BOUNDARY SURVEY)**

Dear Mr. Thompson:

Enclosed is the revised State Coastal Boundary Survey drawing depicting the survey conducted by us with the assistance of Mr. Mike Haas, R.P.L.S., L.S.L.S. The Mean Higher High Water Line was determined based on the tidal information obtained from the Galveston Pleasure Pier Gauge and the Sabine Pass North Gauge.

State plane coordinates were arrived at from the monumentation shown on the drawing. Elevations were looped from monuments, shown on the drawing. Elevations were referenced to NAVD '88.

Thanks again for your time and assistance on this project. If you should have any questions, please call me at (361) 857-2211.

Sincerely,

SHINER MOSELEY AND ASSOCIATES, INC.

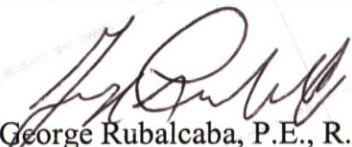
George Rubalcaba, P.E., R.P.L.S.
Manager of Surveys

GR/djp

Enclosure

TEXAS GENERAL LAND OFFICE
Art. 33.136 Natural Resources Code
County Jefferson, Report SR 3
File Date July 7, 2003 by D. J. H.
See Sketch 3
SR NO. 3
counter 78611