

FIELD NOTES OF SURVEYS IN TRAVIS DISTRICT

200

3/4

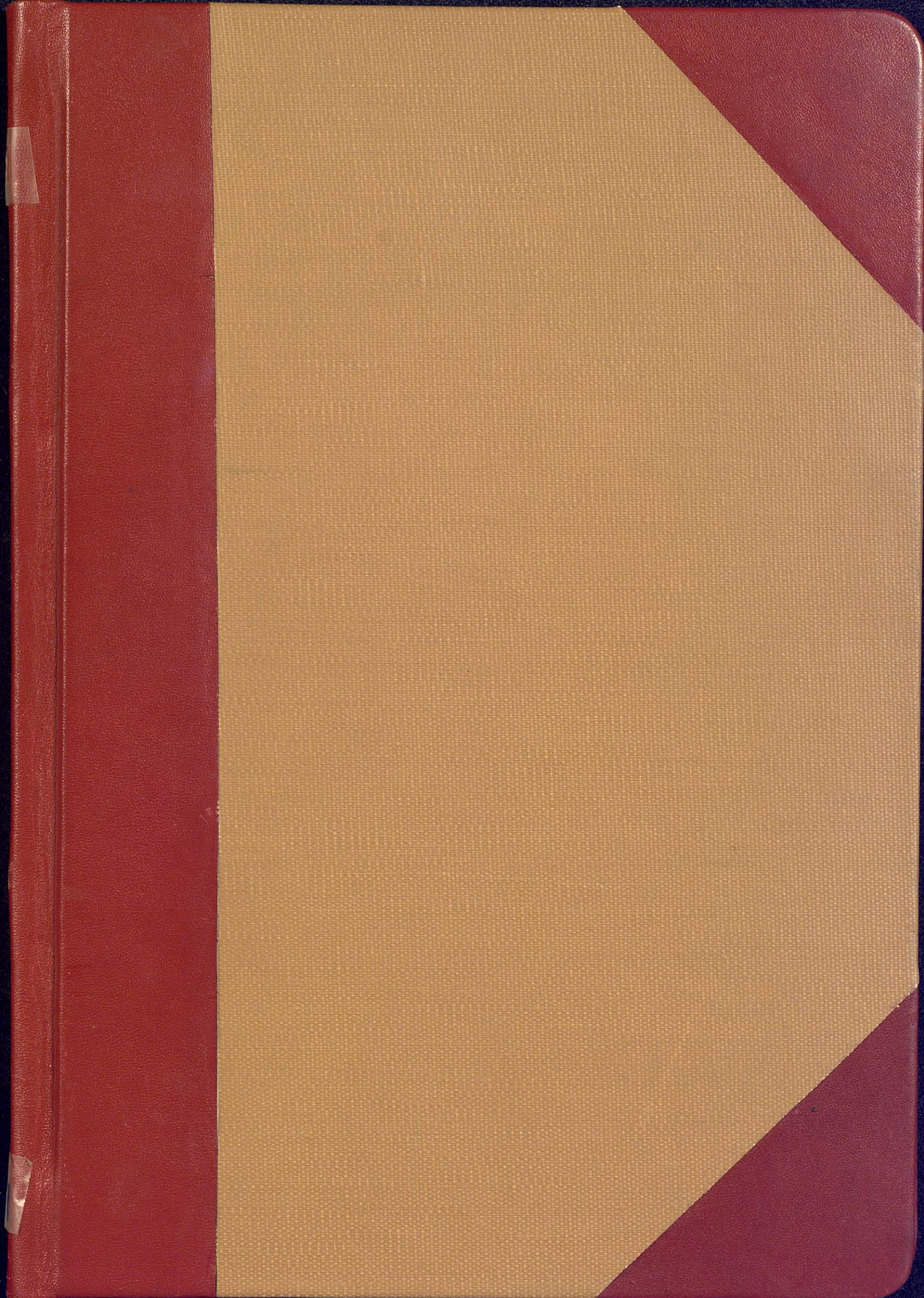

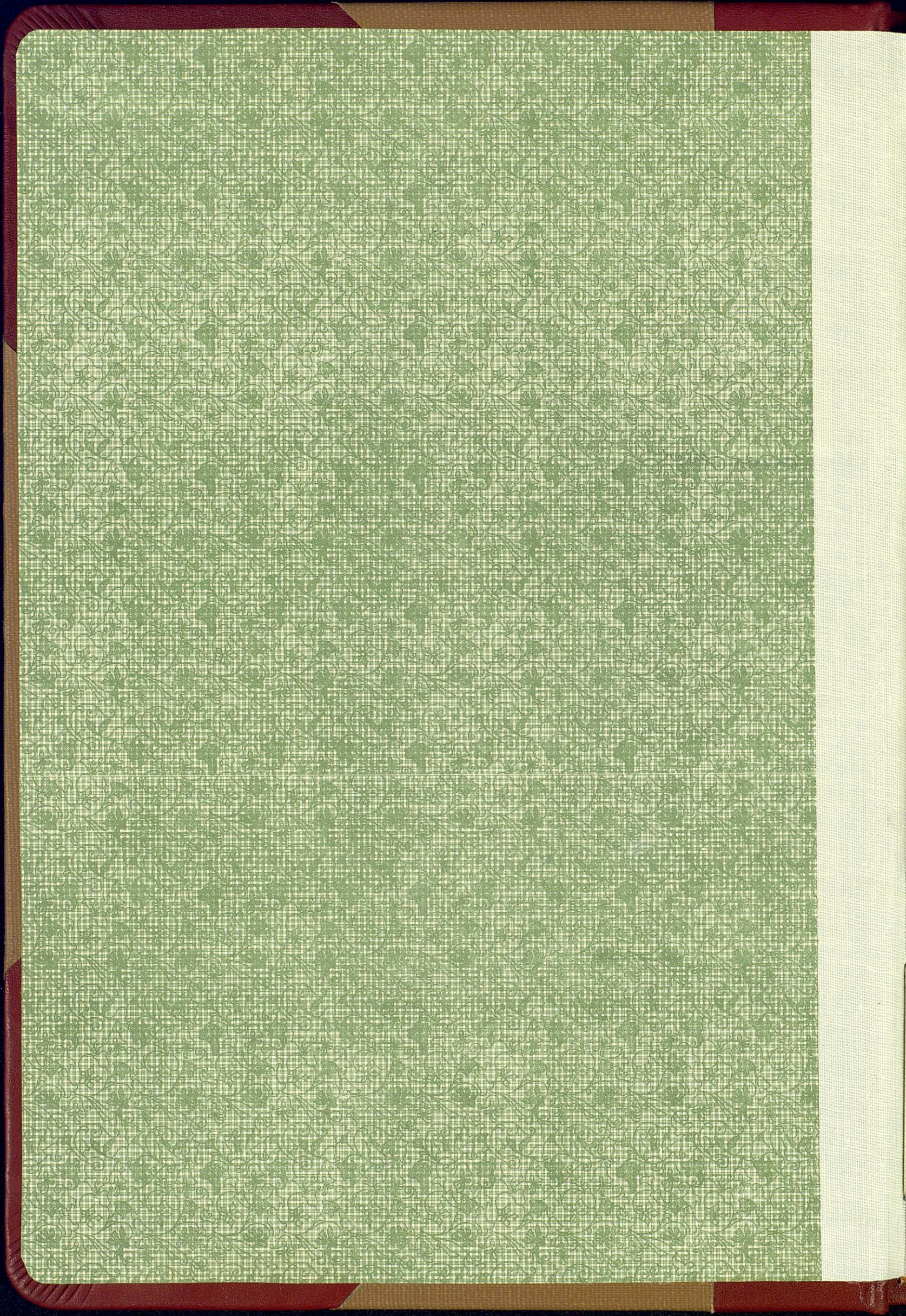

81675

Field Notes

of Surveys

in Iowa District



1
3

The State of Texas,
District of Travis, Survey No. 44
Field Notes of a Survey of 320 acres

of Land made for the Houston and Texas Central Rail way Company it being the quantity to which they are entitled by virtue of Certificate No. 1142 issued by the Commissioners of Claims.

Said Survey is No. 44 situated in Coleman & Callahan Counties on Jim Red Creek a tributary of Pecan Bayou about 26 miles S. 37° W of Santa Ana's Peak.

Beginning at a stone mound for the S. E. cor. of Survey No. 43 by virtue of the same Certificate on North line of Survey No. 36 made for the Texas & New Orleans Rail way Company 900 paces East of the N. W. cor. from which a Mesquite bears N. 36° W.

Thence North with East line of No. 43 at 1344 vs to a stone mound the N. E. cor. of same from which a Mesquite bears S. 13° W. 65 vs do N. 33° E. 33 vs. Thence East 1344 vs to the N. E.

Thence South 1344 vs to a stone mound for S. E. cor. from which a Live Oak bears S. 21° W. 47 vs.

Thence West at 344 vs passed the N. E. cor. of No. 36 at 1344 vs to the place of beginning. Surveyed July 29th 1871

Bearings marked X. W. A. Nabor. W. ^{2d} Ling beton, Chain carriers.

J. R. G. Armstrong, Depty. Surveyor of Travis District do hereby certify that the foregoing Survey was made according to law, and that the limits, boundaries and corners with the marks, natural and artificial are truly described in the foregoing plat and field notes. J. R. G. Armstrong
Depty. Surveyor of Travis District.

I the undersigned District Surveyor of Travis District do hereby certify that I have examined the foregoing plat and field notes and find them correct, and that they are recorded in my office in Book 7, page 116

Witness my hand in office at Austin Nov. 10th 1871

James H. Pace

Dist. Surveyor Travis District

T.M.C.
R.R.Co43 44
36

The State of Texas }
 District of Travis } Survey N^o 43

Field Notes of a survey of 320 acres of Land made for the Houston and Texas Central Railroad Company, it being the quantity of Land to which they are entitled by virtue of Certificate N^o 1142 issued by the Commissioners of Claims.

Said survey is N^o 43, situated in Coleman and Ballou Counties on the waters of Jim Ned creek, a tributary of Peam Bayou, about 26½ miles N 39° W of Santa Ana Pass. Beginning at a stone mound in valley on the North boundary line of N^o 36 made for the Texas & New Orleans Railway Company 900 vs East of the N.W. cor. of the same and the N.E. corner of N^o 35 from which a Mesquite brs West 86 vs. Thence North 1344 vs to stone mound for N.E. cor from which a Mesquite brs S 13 N 65 vs, another Mesquite brs N 33 E 39 vs. Thence West 1344 vs to the N.W. cor. Thence South crossing North prong of Jim Ned creek 1344 vs to a stone mound for S.W. cor of the North line of N^o 35 from which a Live Oak brs S 63 E 67 vs. Thence East at 444 vs passed the N.E. cor of N^o 35 and the S.W. cor of N^o 36 at 924 vs crossed Jim Ned creek, North prong 1344 vs to the place of beginning.

Surveyed July 29th 1871 W. A. Nabers }
 Bearings marked by James Merrill } Chain carriers.

R. G. Armstrong Deputy Surveyor of Travis District do hereby certify that the foregoing Survey was made according to law, and that the limits, boundaries and corners, with the marks, natural and artificial are truly described in the foregoing plat and field notes R. G. Armstrong

Deputy Surveyor of Travis District

I the undersigned District Surveyor of Travis District do hereby certify, that I have examined the foregoing plat and field notes and find them correct, and that they are recorded in my office in Book I, page 115. Given under my hand at office in the City of Austin, this 10th Nov. 1871

James R. Pace Dist. Survy. Travis Dist.

The State of Texas

District of Travis, Survey No. 124.

Field notes of a survey of 640 acres of Land made for Eastern Texas Rail R^o, it being the quantity of Land to which he is entitled by virtue of Land Scrip No. 91 issued by W. S. Holch Kipp, Com. of Claims on 19th of August 1861

Said Survey is No. 124 in Coleman & Humboldt County situated on the waters of Clear Creek a tributary of Colorado river, about 2 1/2 miles N 85 W of Camp Colorado.

Beginning at the S W cor of Sur. No. 123 made for the Eastern T. R. R. Co. Thence South 1900 vs a stake in the prairies. Thence East crossing a branch 1900 vs a stone mound from which a Mesquite 10 in dia brs S 81 E 135 vs. Thence North 1900 vs to the S E cor. of said sur. No. 123 a stone mound from which a Mesquite 4 1/2 brs S 90 vs & a Live Oak 20 in N 80 1/2 E 120 vs.

Thence West with the South line of said No. 123 crossing a br. S W, 1900 vs to the place of beginning

Bearings marked by David Bigau Surveyed 5 Nov. 1871 by Peter Davis, Chain Carrier.

I J. H. Suckett, Dep. Surveyor Travis Dist do hereby certify that the foregoing survey was made according to law and that the limits, boundaries and corners with the marks, natural and artificial are truly described in the foregoing plat and field notes

J. H. Suckett

Deputy Surveyor Travis District

I J. R. Pace District Surveyor, Travis District, do hereby certify that I have examined the foregoing plat and field notes and find them correct as shown by the calculation on the back hereof and that they are recorded in my office in Book 2 page 146.

Given under my hand, at Austin this 2^d day Dec A D 1871,

James R. Pace

Dist. Surveyor Travis District.

The State of Texas
 District of Travis Survey No. 123.

Field Notes of a survey of 64 Acres of Land, made for Eastern T. & B. R. Co. it being the quantity of Land to which he is entitled by virtue of Land Cert. No. 91 issued by W. S. Holch King Com. of Claims on 19 Aug. 1861

Said Survey is No. 123 in Coleman & Brunell County situated on the waters of Clear Creek a tributary of Colorado river about 29 miles N 80 W of Sp. Colorado.

Beginning at the S E cor of Survey No. 18 made for the Houston T. & B. R. Co. from which a Live Oak 9 in dia brs S 48 E 2000 & a d. N 30 E 10000.

Thence South 1590 is a branch a crop on Island 1880 is same branch W 1900 is a stone mound from which a Mesquite 4 in dia brs S 90 W and Live Oak 20 in N 80 1/2 E 1200 Thence W crossing a branch 1900 is a corner in the prairies Thence North 1890 is a branch (C) 1900 is a stone mound & S W cor of said No. 18. Thence East 19000 to the place of beginning. Bearings marked X. David L. Gault Chain Surveyed 5 No. 18 1/2 Peter L. Gault 5 carriers.

J. H. Duckett, Deputy Surveyor, Travis District do hereby certify that the foregoing survey was made according to law and that the limits, boundaries and corners, with the marks, natural and artificial, are truly described in the foregoing plat and field notes.

J. H. Duckett, Depty. Surveyor Travis Dist.

J. H. Pace, District Surveyor Travis Dist do hereby certify that I have examined the foregoing plat and field notes and find them correct and that they are recorded in my office in Book 2 page 145

Given under my hand at Austin this 22^d day of Decr 1871

James R. Pace
 District Surveyor Travis District.

The State of Texas
 District of Travis } Survey No. 81.

Field Notes of a survey of 640 acres of Land, made for Eastern T. R. Co. it being the quantity of land to which he is entitled by virtue of Land Scrip No. 114 issued by W. S. Holck Kip Com. of Claims on 19th Aug. 1861. Said Survey is No. 81 in Coleman County, situated on the waters of Horno creek a tributary of Colorado river about 22 miles S 13 W of Cap Colorado.

Beginning at a stone mound 585 South of the S W cor. of W. S. Hollock Sur. No. 280 from which a Mesquite 4 in dia brs S 65 1/2 W 50. Thence South 19000 a corner. Thence West 19000 to a stone mound from which a Live Oak 26 in dia brs S 24 W 12000 and a Post Oak 15 in dia brs S 33 W 10000. Thence North 19000 to a stone mound from which a Post Oak 10 in dia brs E 12 1/2 S & a do 10 in dia brs S 75 E 5000. Thence East 19000 to the place of beginning.

Bearings marked David Sigurd Chain
 Surveyed 9th Oct. 1871 Peter Lewis } Carriers.

I L. H. Duckett Deputy Surveyor Travis District do hereby certify that the foregoing survey was made according to law, and that the limits, boundaries and corners with the marks, natural and artificial are truly described in the foregoing plat & field notes.

I L. H. Duckett, Dep. Surveyor Travis Dist.
 I J. R. Pace, District Surveyor Travis Dist., do hereby certify that I have examined the foregoing plat and field notes and find them correct and that they are recorded in my office in Book 2 page 119.

Given under my hand at Austin this 21 day of
 Decr 1871

James R. Pace
 District Surveyor Travis District.

The State of Texas }
 District of Travis } Survey No. 82

Field Notes of a survey of 640 acres of Land, made for Eastern P. R. R. Co. it being the quantity of Land to which he is entitled by virtue of Land Scrip No. 114 issued by W. J. Holch Kip Com. of Claims on 19th Aug. 1861. Said Survey is No. 82 in Coleman County, situated on the waters of Home Creek a tributary of Colorado river about 21 miles S 1/4 W of Camp Colorado.

Beginning at the S. W. cor. of W. J. Bullock No. 280 a Mesquite 12 in dia brs S 39 1/2 W 2200 vs marked X an old bearing the other could not find. Thence South 585 vs a Stone mound a Mesquite 7 in brs S 65 1/2 W 400. thence S. W. cor. of Eastern P. R. Co. sur No. 81. Thence West with North line of No. 81 & 83, 3800 vs to S. E. cor. of Survey No. 90 a P. O. 25 in brs S 22 W 200 vs & a d. 25 in S 10 W 200 vs, all 3 surveys made for Eastern P. R. Co. Thence North with the East line of said No. 90 crossing a branch (C) 1857 vs a stake a P. O. 7 in dia brs N. 16 1/2 E 90 vs & a d. 12 in N 45 1/4 E 92 vs Thence East 1100 vs to a cor. on N. line of Rob. Wilson Sur No. 337. Thence South 1262 vs to S. W. cor. of said No. 337. Thence East with the S. line of said No. 337 - 2699 vs to the place of beginning.

Bearings marked X David Ligan } Chain
 Surveyed 1st Nov. 1871. Peter Davis } Carriers.

J. H. Lockett, Dep. Surveyor Travis District do hereby certify that the foregoing survey was made according to law, and that the limits, boundaries and corners with the marks, natural and artificial are truly described in the foregoing plat & field notes.

J. H. Lockett, Dep. Surveyor Travis Dist.
 J. R. Pace Dist. Surveyor Travis Dist. do hereby certify that I have examined the foregoing plat & field notes and find them correct & that they are recorded in my office in Book I, page 120. Given under my hand as Justice this 21 day of Decr. 1871. James R. Pace Dist. Sur. Travis Dist.

The State of Texas
District of Travis) Survey N^o 41.

Field Notes of a survey of 640 acres of Land, made for the B B B & C R R Co. it being the quantity of Land to which he is entitled by virtue of Certificate No 3103 issued by the Commissioners of Claims March 4th 1853.

Said Survey is N^o 41 situated in Coleman County on the waters of Boards Creek, a tributary of Pecan Bayou about 22 miles N 65^o W of Santa Anas Peak

Beginning at a Post Oak for S E cor. of this survey on West line of Section N^o 9. made for the Texas & N. O. R. R. Co. Texas Division 940 vs south of the N^o W cor. of same from which a Post Oak 10 in in dia brs N 47^o W 15 vs and a Post Oak 6 in in dia brs S 72 1/2^o E 19 vs. Thence W 1900 vs to a stone mound a Post Oak 7 in in dia brs S 17^o W 6 vs, another P. O. brs S 73^o W 10 vs. Thence South crossing Boards Creek 1900 vs to N^o W corner. Thence East 1900 vs to a stake for N E cor from which a Post Oak brs S 10^o E 6 vs, another P. O. brs N 47^o E 8 vs.

Thence South 960 vs passed the N^o W cor of said survey at 1820 vs crossed Boards Creek 1900 vs to the place of beginning.

Bearings marked X W A Nabers
Surveyed July 28th 1871 Wm Singletons Chain Carriers.

S R G Armstrong, Deputy Surveyor Travis District do hereby certify, that the foregoing survey was made according to law, and that the limits, boundaries and corners with the marks, natural and artificial are truly described in the foregoing plat and field notes.

S R G Armstrong
Deputy Surveyor, Travis District.

I the undersigned District Surveyor of Travis District do hereby certify that I have examined the foregoing plat and field notes and find them correct and that they are recorded in my office in Book 1, N^o 1 page 113 Given under my hand at office this 4th day of Nov. A D 1871 James B Pace

District Surveyor Travis District.

The State of Texas
 District of Travis } Survey No. 42

Field Notes of a Survey of 640 acres of Land, made for the B. B. B. & C. R. Co. it being the quantity of Land, to which he is entitled by virtue of Certificate No. 116 issued by the Commissioners of Claims April 19th 1859

Said Survey is No. 42, situated in Coleman County on the waters of Hoard Creek, a tributary of Pecan Bayou about 19 miles N 73rd W of Santa Ana's Peak.

Beginning at a Stake for the S E cor of Sec No 12 made for the Texas & O R R Co. (Texas Division) and on the West line of Survey No. 1 made for said Company, from which a P Oak 12 in in dia brs S 41 $\frac{1}{2}$ W 50 s & a P. O. 8 in in dia brs N 42 $\frac{1}{2}$ W 40 s. Thence South with said line at 1250 s passed the S W cor of Survey No. 1 and the S W cor. of Survey No. 2 at 1900 s to a stone mound on West line of Survey No. 2 from which a Live Oak 12 in in dia brs S 55 $\frac{1}{2}$ W 25 s & a Live Oak 7 in in dia brs N 82 E 25 s

Thence West 1900 s to the S W cor. Thence North 1900 s to the S W cor of Survey No. 12. Thence East with the South line of No. 12 at 1870 s crossed branch 1900 s to the place of Beginning. Bearings marked by S M Alexander's Chain

Surveyed July 28th 1871 } James Merrill Surveyor
 R. G. Armstrong, Deputy Surveyor Travis District, do hereby certify, that the foregoing Survey was made according to law, and that the limits, boundaries & corners, with the marks, natural and artificial are truly described in the foregoing plat & field notes R. G. Armstrong
 Deputy Surveyor Travis District

I James R Pace, District Surveyor of Travis District do hereby certify, that I have examined the foregoing plat and field notes and find them correct and that they are recorded in my office in Book L No. 1 page 114 Given under my hand at Austin, this 4th day of Nov.

1871

James R Pace
 District Surveyor Travis District.

The State of Texas }
District of Travis } Survey No 66

Field Notes of a survey of 640 acres of Land, made for Buffalo B B & C R Co, it being the quantity of Land to which he is entitled by virtue of Land Scrip No 494 issued by W S Hatchky Com. of Claims 30th March 1860.

Said Survey is No 66 in Coleman County, situated on the waters of Branch, a tributary of Colorado river, about 24 miles South 73 W of Camp Colorado.

Beginning at a stake the N W cor of No 65 made for the Buffalo Boyow B B & C R Co. from which a Mesquite 10 in in dia brs N 88 1/4 W 42 vs & a do 3 in in dia brs N 18 3/4 W 37 1/2 vs

Thence South with West line of said No 65. 1887 vs to the S W cor of said No 65. Thence West 280 vs to the N W cor of No 307 for F J Goodroom from which a Mesquite 10 in in dia brs N 85 E 49 vs & a do 5 in N 72 vs.

Thence South 127 brs to a cor on W line of said No 307. Thence West 975 a corner Thence North passing the S E cor of No 67 made for the B B B & C R Co. 3163 is a stake on the S line of No 58 a P Oak brs N 73 1/2 W 68 vs & a S Oak. - S 18 W 35 vs. Thence E 1255 vs to the place of beginning.

Bearings marked X. Jacob Lutz }
Surveyed 13th June 1871 } David Ligon } Chain Carriers.

J L Suckett, Dep. Surveyor Travis Dist do hereby certify, that the foregoing survey was made according to law, and that the limits, boundaries and corners, with the marks, natural & artificial are truly described in the foregoing plat & field notes. J L Suckett

Dep Surveyor Travis Dist.

J R Pace, Dist. Surveyor Travis District, do hereby certify that I have examined the foregoing plat & field notes and find them correct, and that they are recorded in my office in Book 2, page 62

Given under my hand at Austin this 27 day of July 1871

James R Pace
Dist. Surveyor Travis District

The State of Texas)
 District of Travis) Survey N^o 65

Corrected Field Notes of a survey of 640 acres of Land, made for Buffalo B B & C R R Co. it being the quantity of Land to which he is entitled by virtue of Land Scrip N^o 494 issued by W S Scholchkip Com of Claims on 30th March 1860

Said survey is N^o 65 in Coleman County, situated on the waters of Branch, a tributary of Colorado river about 23 miles S 75 W of Camp Colorado Beginning at a Stake & S E cor. of Sur. N^o 309 made for G W Morgan from which a P. Oak 10 in in dia brs N 66 1/2 W 48 vs & a do 12 in N 39 W 50 vs.

Thence West 1240 vs a Branch 1900 vs a stake on the S. line of said N^o 309
 Thence South 1900 vs to a cor on N line of T S Goodman N^o 307
 Thence E 1900 vs to a Stake & N E cor of said N^o 307 from which 3 Live Oaks brs S 80 E 20 vs. Thence North 1900 vs to the place of beginning.

Bearings marked X

Jacob Lutz

Surveyed (Rebury) 22 Jan. 1872 David Ligon) Chain carrier

L S Duckett, Dep Surveyor, Travis Dist. do hereby certify that the foregoing survey was made according to law, and that the limits, boundaries and corners, with the marks, natural and artificial, are truly described in the foregoing plat and field notes

L S Duckett

Dep Surveyor Travis Dist.

I - District Surveyor - Dist do hereby certify that I have examined the foregoing plat and field notes and find them correct, and that they are recorded in my office in Book I, page 61. Given under my hand at Austin this 24th day of Jan'y A D 1872

James R Pace

District Surveyor Travis District

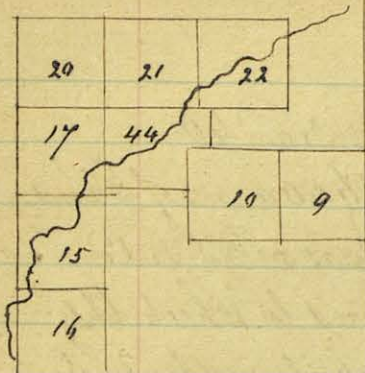

The State of Texas }
 District of Travis } Survey N^o 45

Field Notes of a Survey of 640 acres of Land, made for the Buffalo R. R. & Colorado R. R. Co. it being the quantity to which they are entitled by virtue of Certificate No. 3/102 issued by the Com. of Claims March 4th 1859.

Said Survey is N^o 45, situated in Coleman County, on the waters of Rough Creek, a tributary of Pecan Bayou, about 22 miles N 45° W from Santa Ana's Peak. Beginning at a stake on the East line of N^o 17 made for the Texas & N.O. R. R. Co. 80 or N of the S E cor. and at the N W cor of survey N^o 40 made for the Houston Tap & R. R. Co from which a Live Oak 12 in dia brs N 87° E 57 or.

Thence North at 2400 or crossed Rough Creek 1380 or to a Live Oak line tree 14 in dia 1820 or to a stake from N E cor of N^o 17 from which a Live Oak 16 in in dia brs N 72° W 119 or a Live Oak 12 in in dia brs N 81° W 118. Thence East with the South line of Sur N^o 21 at 1500 or crossed Rough Creek 1900 or passed the S E cor of Sur. N^o 21 and the S W cor of Sur. N^o 22 at 2226 to cor on the S line of Sur. N^o 22. Thence South 900 or to a cor of this Survey on the North line of Sur N^o 10 made for the S E & P R. R. Co. Thence West 476 or to the N W cor of same. Thence South 920 or to a stake for N E cor of N^o 40 from which a P. O. brs S 33° W 9 or. Thence West 1750 or to the place of beginning.

Bearings marked X W A Nabers }
 Surveyed July 28th 1871 W^m Singleton } Chain Carrier.

I R B Armstrong Dep Surveyor of Travis Dist. do hereby certify that the foregoing survey was made according to law, and that the limits, boundaries and corners, with the marks, natural and artificial, are truly described in the foregoing plat and field notes. R B Armstrong Dist Sur. of Travis Dist.

I the undersigned District Surveyor of Travis District do hereby certify that I have examined the foregoing field note and find them correct and that they are recorded in my office in Book L page 117 Given under my hand in office at Austin this 10th day of Nov. 1871.

James B Pace
 District Surveyor Travis District.

17		State
15	HT & BR R Co. 40	
16	HT & BR R Co. 39	

The State of Texas }
District of Travis } Survey No. 40.

Field Notes of a Survey of 640 acres of Land
made for the Houston Texas & P. R. Co.

it being the quantity of Land to which they
are entitled by virtue of Land Scrip No 346 issued by W. S.
Schleichers Com. of Claims February 6th 1861

Said survey is No. 40, situated in Coleman County, on the
waters of Rough creek, a tributary of Texas Bayou, about 19
miles N 75 W of Camp Colorado. Beginning at a Stake for
the N W cor of No. 39 and the N E cor of No. 6 and the S E cor
of No. 15 from which a P. O. 11 in india brs N 57 W 4 1/2, another
P. O. 11 in india brs E 13 W. Thence East 1900 W to a stone mound
for the S E cor and the N E cor of No. 39 from which a P. O. 14 in
india brs N 32 1/2 E 2 1/2 W. Another P. O. 10 in india brs N 7 3/4 W 23 W.
Thence North 1000 W to corner South line of No. 10 made for Texas
& Brazoria R. R. Co. Thence West with said line 1500 W to S. W.
cor of same. Thence North with W line of same 980 W to a stake
for cor in said line, a P. O. brs S 33 W 9 W. Thence West 1750 W
to a stake for N W cor of East line of No. 17 from which a
Live O. 12 in india brs N 87 E 5 1/2 W. Thence South at 80 W passed
the N E cor of No. 15 & S E cor of No. 17 at 1980 W to the place of beginning
Bearings marked \times W. L. M. Singletow

Surveyed July 27th 1871 James Merrill, Chain Carrier.
J. P. G. Armstrong, Dep Surveyor Travis Dist. do hereby certify
that the foregoing survey was made according to law
and that the limits, boundaries and corners, with the
marks, natural and artificial are truly described in
the foregoing plat and field notes. J. P. G. Armstrong.

Dep Surveyor Travis District.

I the undersigned authority, do hereby certify that I have
examined the foregoing field notes and find them
correct, and they are recorded in my office in Book E
page 112. Given under my hand in Office at the City
of Austin Nov 4th 1871

James P. Pace
County Surveyor Travis County

17		
15	HTSBR R Co 40	Stair
16	HTSBR Co 39	

The State of Texas
District of Travis, Survey No 39.

Field Notes of a survey of 640 acres of Land, made for the Houston & P. & G. R. Co. it being the quantity of Land to which they are entitled by virtue of Land Scrip No. 346 issued by W. S. Holchiff Com. of Claims, February 6th 1861.

Said Survey is No 39, situated in Bolivar County, on the waters of Pough Creek, a tributary of Pecan Bayou, about 19 miles N 78° W of Camp Colorado.

Beginning at a stake for the N. E. cor of No. 16 and the S. E. cor of No. 15 for Texas N. O. R. R. Co. from which a Post Oak 7 in dia brs N 57° W 40 vs. a P. O. 11 in dia brs E 13 vs. Thence South 1900 vs to the S. E. cor of No. 16 for the S. W. cor of this survey. Thence East 1900 vs to the S. E. cor. Thence North 1900 vs to the N. E. cor a stone mound from which a Post O. 14 in in dia brs N 32½ E 26 vs. a P. O. 10 in in dia brs N 7¾ W 23 vs. Thence West 1900 vs to the place of beginning.

Bearings marked X James Merrill

Surveyed July 27th 1871 Wm Singleton Chain Carrier

P. G. Armstrong, Dep Surveyor of Travis District, do hereby certify, that the foregoing survey was made according to law, and that the limits, boundaries and corners with the marks, natural and artificial are truly described in the foregoing plat and field notes P. G. Armstrong
Dep Surveyor Travis District.

I the undersigned Dist. Surveyor, Travis District do hereby certify, that I have examined the foregoing plat and field notes and find them correct, and that they are recorded in my office in Book I page 111

James R. Pace
County Surveyor Travis County

The State of Texas }
 District of Travis } Survey No. 84

Field Notes of a survey of 640 acres of Land, made for Eastern T R R Co., it being the quantity of Land, to which they are entitled by virtue Land Decree No 115 issued by W. P. Hall's Com of Claims on 19th August 1861

Said Survey is No 84 in Colman County, situated on the waters of Home Creek, a tributary of Colorado river, about 22 1/2 miles S 16 W of Camp Colorado.

Beginning at a stone mound and S E cor of Sur. No 83 made for Eastern T R R Co. from which a S Oak 26 in dia brs N 24 W 120 or. & a S Oak 15 in N 33 W 100 or.

Thence South 1900 or a corner. Thence West 1900 or a corner. Thence North 1900 or a stone mound the S W cor of sur. No 83 from which a S Oak 12 in brs N 6 1/2 W 18 or. & a d. 14 in S 30 E 60 or. Thence East with South line of sur. No 83 1900 or. to the place of beginning.

Bearing & marked by David Ligon & Surveyed 29th Oct. 1871 Peter Lewis & Chain Carrier. I L H Duckett, Dep Surveyor Travis Dist do hereby certify that the foregoing survey was made according to law and that the limits boundaries & corners with the marks, natural and artificial are truly described in the foregoing plat & field notes.

L H Duckett, Dep Sur. Travis Dist
 J J R Pace, District Surveyor, Travis District do hereby certify that I have examined the foregoing plat and field notes and find them correct and that they are recorded in my office in Book 1, page 122.

Given under my hand, at Austin this 22 day of Decr. 1871

James R Pace
 Dist Surveyor Travis District

The State of Texas }
 District of Travis } Survey No 83.

Field notes of a survey of 64 Acres of Land, made for Eastern T. R. Co., it being the quantity of Land, to which he is entitled by virtue of Land Scrip No 115 issued by W. J. Holcomb, Com of Claims on 19th of August 1861

Said Survey is No 83 in Coleman County, situated on the waters of Horns Creek a tributary of Colorado river, about 2 1/2 miles S 15 W of Camp Colorado.

Beginning at a stone mound from which a Post C. 10 in dia br. C. 1200. and a do 10 N 15 E 500. The S W corner of Sur. No 81 made for the Eastern T. R. Co. Thence South with the West line of said E. T. R. Co. survey No 81 1900 or a stone mound from which a Live Oak 26 in dia br. N 24 W 1200. & a P. O. 15 in dia N 33 W 1000. Thence West 1900 or a stone mound from which a Live Oak 12 in dia br. N 6 1/2 W 1800. & a do 14 in dia 3000. Thence North 1900 or a stake from which a P. O. 25 in dia br. S 22 1/2 W 2000 & a do 25 in dia 10 W 2000. Thence East 1900 or to the place of beginning

Bearings marked X David Sigow }
 Surveyed 29th Oct. 1871 Peter Lewis } Chain Carrier,
 J. H. Duckett, Dep Surveyor Travis District, do hereby certify, that the foregoing survey was made according to law and that the limits boundaries and corners with the marks, natural and artificial are truly described in the foregoing plat and field notes J. H. Duckett
 Dep Surveyor Travis Dist

J. R. Pace District Surveyor, Travis District, do hereby certify that I have examined the foregoing plat and field notes and find them correct and that they are recorded in my office in Book 5, page 121

Given under my hand at Austin, this 21 day of Dec. 1871

James R. Pace
 District Surveyor Travis District

The State of Texas,
 District of Travis, Survey No 93.

Field Notes of a Survey of 640 acres of Land, made for Eastern T. R. Co. It being the land to which he is entitled by virtue of Land Scrip No 118 issued by W. S. Holch, his Com of Claims on 19th of August 1861. Said Survey is No 93 in Coleman County, situated on the waters of Horns creek, a tributary of Colorado river about 17 miles S 20 W of Camp Colorado.

Beginning at the N West cor of Sur No 92 made for the E. T. R. Co. on the S W lines of of Sur No 276 made for James West. Thence South with the W line of said No 92. 1856 or to a stake @ S West cor of said No 92. from which a Live Oak 12 in dia brs N 83/4 E 180 or a Mesquite 10 in N 1 3/4 E 230 or. Thence West 1210 a branch S E. 1852 or a stone mound from which a Live Oak 9 in in dia brs S 87 E 300 or. Thence North 220 or a branch crossed it several times 2172 or a stake in prairie. Thence East 556 or a stake on W line of said No 276. Thence South 316 or to S West cor of said No 276. Thence East 1296 or to the place of beginning.

Bearings marked X David Egan,
 Surveyed 2 Nov 1872. Peter Lewis, Chain Carrier
 J. H. Luckett, Dep. Surveyor, Travis District, do hereby certify, that the foregoing survey was made according to law, and that the limits, boundaries and corners, with the marks, natural and artificial are truly described in the foregoing plat and field notes. J. H. Luckett

Dep Surveyor Travis District
 J. R. Pace, District Surveyor Travis District do hereby certify, that I have examined the foregoing plat and field notes, and find them correct, and that they are recorded in my office in Book L page 131. Given under my hand at Austin this 21 day of Dec 1871. James R. Pace, Dist Survey Travis Dis

The State of Texas }
 District of Travis } Survey No 94.

Field notes of a survey of 640 acres of Land, made for
 E. J. R. Co. it being the quantity of Land, to which he
 is entitled by virtue of Land Scrip No 118 issued by W S
 Holch Kipp, Com of Placino on 19th of August 1861.

Said Survey is No 94 in Coleman County, situated
 on the waters of Home creek, a tributary of Colorado
 river, about 18 miles S 20 W of Camp Colorado

Beginning at a stake N W cor of Sur. No 91 made for
 E. J. R. Co. from which a L. O. 12 in in dia br N 5 W 18000.
 To Mesquite W in dia br N 2 1/2 E 18000. Thence South
 with the West line of said No 91 19000 to the S W cor of
 said No 91 & on N line of No 95 made for E. J. R. Co. a stone
 mound, which a L. O. 10 in br S 78 E 8000 & a do 12 in S 69 1/2
 W 10000. Thence West with N line of No 95 19000 to S W
 cor of same a stone mound a L. O. 9 in dia br S 33 W 12000.

Thence North 19000 to a stone mound & S W cor of No 93
 made for the same E. J. R. Co. a L. O. 9 in dia br S 87 E 30000.
 Thence East 66000 a br. & with S line of No 93. 19000 to the place of
 beginning. Bearings marked by David Lyon.

Surveyed 1st Nov 1871 Peter Lewis } Chain Carrier.

S. H. Duckett, Dep Surveyor, Travis Dist do hereby certify
 that the foregoing survey was made according to law
 and that the limits, boundaries and corners, with the
 markers, natural and artificial are truly described
 in the foregoing plat and field notes S. H. Duckett.

Dep Surveyor, Travis District

J. R. Pace, District Surveyor, Travis District, do
 hereby certify, that I have examined the foregoing
 plat and field notes and find them correct and
 that they are recorded in my office in Book 1,
 page 132. Given under my hand at Austin this 21st
 day of Decr 1871

James R. Pace,
 District Surveyor Travis District.

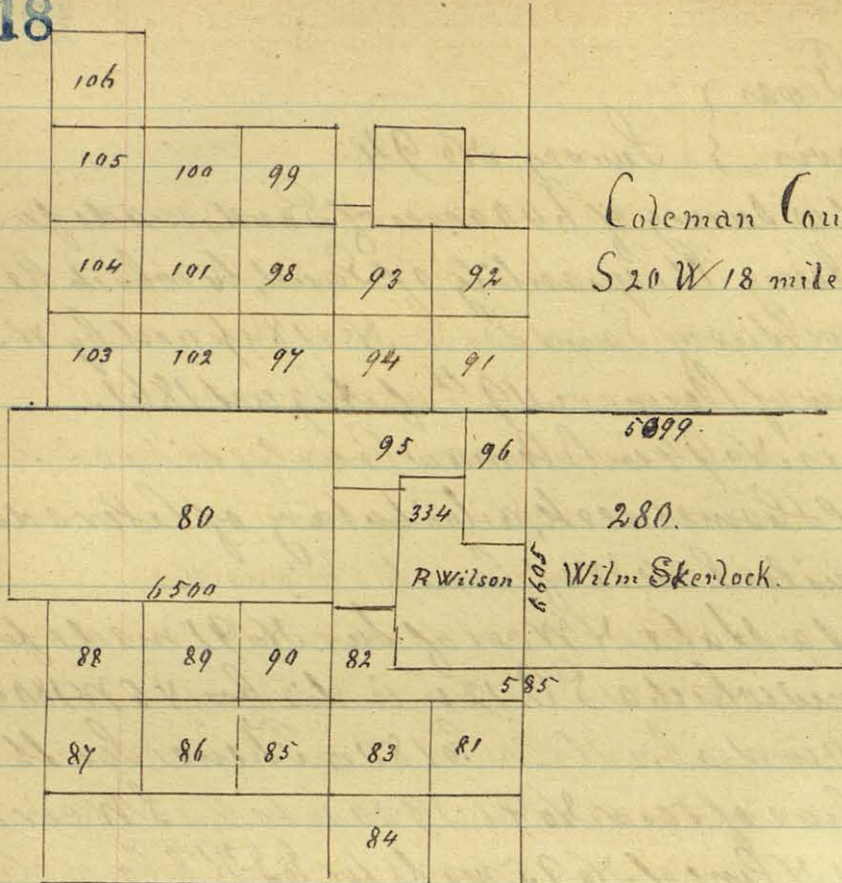

Coleman County
 S 20 W 18 miles from Camp Colorado.

I L S Suckett Dep Surveyor Travis District do hereby certify that from the SW cor of Wm Skerlock Sur No 280 is South 585° to the NW cor of No 81. That the NW and SW cor's of said survey No 280 now found by me on the ground and identified by the descriptions in the field notes and that the distance from the NW cor of No 88 to the SW cor of No 103 is 4000 or by two measurements by me. That the courses and distances given are from actual measurement running by line on the ground done in October and Novbr last.

27th December 1871 } L S Suckett
 } Dep. Surveyor Travis District.

The State of Texas

District of Travis } Survey No 98

Field notes of a survey of 640 acres of Land, made for the East T R R Co, it being the quantity of Land to which he is entitled by virtue of Land Scrip No 119 issued by W S Scotchless, Com of Claims on 19th of Aug, 1861. Beginning Said Survey is No 98 in Coleman County, situated on the waters of Home creek a tributary of Colorado river, about 17 1/2 miles S 1/4 W of Cap Colorado.

Beginning at a stone mound from which a Live Oak grows in dia brs S 87 E 3000. the N E cor of ser. No 97 & N W cor of No 94 both made for the E T R R Co. Thence north with W line of No 93 made for said E T R R Co 2600 a branch S E crossed it several times 1900 or a stake from which a Mesquite 10 in dia brs S 45 W 200 or a do 7 in S 26 1/2 W 2500. Thence West 1900 or a corner in the prairie. Thence South, crossing a branch (E) 1900 or a stone mound from which a S O. 12 in brs S 62 E 400 or a do. S 60 1/4 E 4000. the N W cor of said No 97. Thence East with No 97, 1900 or to the place of beginning

Bearings marked by David Ligon

Surveyed 1 Nov. 1871 Peter Lewis } Chain carriers.

J. H. Duckett, Dep Surveyor, Travis Dist do hereby certify that the foregoing survey was made according to law, and that the limits, boundaries and corners with the marks, natural and artificial are truly described in the foregoing plat and field notes.

J. H. Duckett,

Dep Surveyor Travis District

J. R. Paer, Dist Surveyor Travis District do hereby certify that I have examined the foregoing plat and field notes and find them correct and that they are recorded in my office in Book 3 page 136.

Given under my hand at Austin this 21 day of Decr 1871

James R Paer

District Surveyor Travis District.

The State of Texas
 District of Travis; Survey No. 94
 Field Notes of a survey of 640 acres of Land, made for
 the E. T. R. Co. it being the quantity of Land, to which
 they are entitled by virtue of Land Scrip No. 119 issued by
 H. P. Henshkip Comr of Claims on 19th of Aug. 1861
 Said survey is No. 94 in Coleman County, situated on the waters
 of Horns creek, a tributary of Colorado river about 19 1/2
 miles S 21 W of Camp Colorado.

Beginning at a stone mound S W cor of sur No. 94
 made for the Eastern T. R. Co. from which a S Oak 7 in dia br.
 S 33 W 130 v. Thence West 1900 v. a stone mound from
 which a Live 12 in dia br. N 62 E 400 v. edo. N 60 1/2 E 400 v.
 Thence North 1900 v. Thence East 1900 v. a stone mound
 the N W cor of said No. 94 & S W cor of No. 92 made for said
 E. T. R. Co, a Live Oak 9 in dia br. S 87 E 300 v. Thence South with
 W line of said No. 94, 1900 v. to the place of beginning
 Bearings marked X David Sigon

Surveyed Nov 1871 Peter Lewis & Chain Carrier.

J. L. Duckett, Dep Surveyor Travis Dist do hereby
 certify that the foregoing survey was made according
 to law, and that the limits, boundaries and corners
 with the marks, natural and artificial are truly
 described in the foregoing plat and field notes.

J. L. Duckett, Dep Surveyor Travis Dist

J. L. Duckett, Dist Surveyor Travis District do
 hereby certify, that I have examined the foregoing plat
 and field notes and find them correct and that they
 are recorded in my office in Book I, page 138

Given under my hand at Austin this 21 day of Dec 1871

James R Pace

Distric Surveyor Travis Dist

The State of Texas
 District of Travis } Survey No 101

Field Notes of a survey of 640 acres of Land, made for
 C. S. R. Co it being the quantity of Land to which he is
 entitled by virtue of Land Scrip No 121 issued by W. S. Holdrege,
 Comr of Claims on 17 Aug 1871.

Said Survey is No 101 in Coleman County, situated on the
 waters of Home Creek, a tributary of Colorado river, about
 15 miles S 25 W of Comps Colorado.

Beginning at the S E cor of Sur No 100 & the N W cor of No 98,
 both made for the C. S. R. Co. Thence South crossing a Branch
 (C) 1900 or to S W cor of said No 98 a stone mound from
 which S Oak 12 in dia br N 62 E 400 or 8 a do N N 60 1/4 E 400 or.

Thence West with the N line of No 102 made for C. S. R. Co
 1900 or the N W cor of said No 102, a stone mound from which
 a Magn 12 in dia br S 73 3/4 W 60 or 2 a S O 12 in dia br S 38 3/4
 E 120 or. Thence North 1900 or to the S W cor of said No 100.

Thence East with S line of said No 100, 1900 or to the place of beginning
 Bearings marked X David Sigon

Surveyed 2 Nov 1871 Peter Lewis } Chain Carrier.

I H Luckett, Dep Surveyor Travis District do hereby
 certify that the foregoing survey was made according
 to law and that the limits, boundaries and corners
 with the marks, natural and artificial are truly
 described in the foregoing plat and field notes.

I H Luckett Dep Surveyor Travis District.

I J R Pace, District Surveyor, Travis District do hereby
 certify that I have examined the foregoing plat and
 field notes and find them correct and that they are
 recorded in my office in Book L page 139.

Given under my hand at Austin this 22 day of Dec
 1871

James R Pace

District Surveyor Travis District.

The State of Texas
 District of Travis } Survey No 102

Field notes of a survey of 640 acres of Land, made for
 East T R R Co it being the quantity of Land, to which he is entitled
 by virtue of Land Pervis No 121, issued by W S Scotchlip Com of Claims,
 on 19th of Aug 1861. Said survey is No 102 in Coleman
 County situated on the waters of Horns creek a tributary
 of Colorado river, about 19 miles S 20 W of Camp Colorado.

Beginning at the N W cor of Sur. No 97 & S E cor of No
 100 both made for the Eastern T R R Co.

Thence South 1900 or to the S W cor of Sur No 97 a stone mound
 Thence West 1900 or a stone mound from which a Merquits Br S
 7 1/2 E 50 or Thence North with the East line of No 103, 1900 or
 to the N E cor of same and S W cor of said 101 a stone
 mound from which a Merquits 12 in Br S 73 3/4 W 60 or.
 and a Oak 12 in S 38 3/4 E 120 or. Thence East with the
 South line of No 101, 1900 or to the place of beginning
 Bearings marked X David Ligon?

Surveyed 2 Nov 1871 Peter Lewis } Chain Carrier.

J H Duckett, Dep Surveyor Travis District, do hereby
 certify, that the foregoing survey was made according
 to law, and that the limits, boundaries, and corners, with
 the marks, natural and artificial are truly described
 in the foregoing plat and field notes J H Duckett
 Dep Surveyor Travis District.

J R Pace, District Surveyor Travis District, do hereby
 certify, that I have examined the foregoing plat and
 field notes and find them correct, and that they are
 recorded in my office in Book I, page 146

Given under my hand at Austin this 22 day of Dec
 1871

James R Pace
 District Surveyor Travis District.

The State of Texas
 District of Travis Survey No 80.

Field notes of a survey of 26,000 000 square or of Land made for S C Mauson, it being the quantity of Land to which he is entitled by virtue of Dup Certificate Plat 1st No 29/326 issued by Jacob Kuehler Com. on 14th Nov 1871. Said Survey is No 80 in Coleman County, situated on the waters of Home creek a tributary of Colorado river, about 21 miles S 25 W of Camp Colorado.

Beginning at the S W cor of Sur No 94 & N W cor of Sur No 95 both made for the C S R R Co. from which a S Oak & a dia brs S 33 W 120 or. Thence West with South line of No 94, 102 & 103 - 5700 or to S W cor of No 103 all made for said C S R R Co. 4500 or a stake in preparation. Thence South crossing a branch (S W) 4000 or a stake in preparation. Thence East crossing a branch 800 or N W cor of Sur No 88 made for C S R R Co. 6500 or to the N E cor of Sur No 90 made for said C S R R Co. a S Oak brs N 30 E 50 or & a dia 12 in N 71 1/2 E 70 or. Thence North crossing 2 branches 4000 or to the place of beginning. Bearings marked X David Sizer

Surveyed 2^d Nov 1871 Peter Lewis, Chain Carrier

J H Duckett, Dep Surveyor Travis District, do hereby certify that the foregoing survey was made according to law, and that the limits, boundaries and corners, with the marks, natural and artificial are truly described in the foregoing plat and field notes. J H Duckett.

Dep Surveyor Travis District.

J J R Pace Dist Surveyor Travis District do hereby certify that I have examined the foregoing plat and field notes and find them correct and that they are recorded in my office in Book II page 286 Given under my hand at Austin this 21 day of Decr 1871

James R Pace

District Surveyor Travis District.

The State of Texas,
District of Travis; Survey No. 139.

Field notes of a survey of ~~8,888~~ 3,333 sup of Land, made for P. Wallace, it being the quantity of Land, to which he is entitled by virtue of Head Right Cert. No 231, issued by W. S. Hatch Kiff Gov of Texas on 11 July 1860. Said Survey is No 139 in Coleman County, situated on the waters of Claim Creek a tributary of Colorado river, about 25 miles West of Camp Colorado.

Beginning 225 or South from the NW cor of Sur No 320 made for J. W. Bayley at a stake from which a fork S. O. br S 82 1/2 E 30 or a side 15 in dec brs S 18 1/4 N 95 or.

Thence North crossing two branches & with the line of No 320, 321 & 322 & 323, 4230 or a stake on the W line of No 323 made for J. M. Hall. Thence West 1970 or a stake in the prairie on the East line of No 124 made for C. T. R. R. to 803 or N from his S E cor. Thence South 1620 or a branch (SW) 4100 or a branch (SW) 4230 or a stone mound or Mesquite bin br S 68 1/2 E 200 or. Thence East ^{crossing a branch} 1970 or to the place of beginning.

Bearing marked X David Ligon

Surveyed 7 Nov 1871 Peter Lewis } Chain Carrier.

J. H. Luckett, Dep Surveyor Travis Dist do hereby certify, that I have examined the foregoing survey was made according to law, and that the limits boundaries and corners with the marks, natural and artificial are truly described in the foregoing plat and field notes. J. H. Luckett

Dep Surveyor Travis District.

J. R. Pace, Dist Surveyor Travis Dist do hereby certify that I have examined the foregoing plat & field notes and find them correct and that they are recorded in my office in Book II page 287.

Given under my hand at Austin this 21 day of Decr. 1871

James R. Pace
Dist Surveyor Travis District.

The State of Texas
 District of Travis } Survey No 23

Field notes of a survey of 640 acres of Land, made for
 Buffalo Br Br (B. B. Co.) it being the quantity of Land, to which
 he is entitled by virtue of Land Scrip No 485 issued by
 W S Holch Kip, Com of Claims on 30 March 1860

Said Survey is No 23 in Coleman County, situated on the
 waters of Hoods creek, a tributary of Colorado river,
 about $1\frac{1}{2}$ miles S 88 W of Camp Colorado

Beginning at a stake 220 South of W^m Youngs Sur. No 356
 Thence North passing his S W cor with his W line at 15640
 to his N W cor. Thence West 2210 to a stake on E line
 of J P McLeod's Survey. Thence South 9740 to his S E cor
 from which a L. O. 18 in dia br S 17 W 250 and a do 8 in br S
 2 E 320. Thence West 2520 to a cor. Thence South crossing a
 branch 5940 a stone mound from which a L. O. 17 in br N 17
 E 350 and a do N 72 W 500. Thence East with N line of
 Nos 24 & 25, ^{Sec Richardson} 24660 to the place of beginning.

Bearing, marked X Jacob Lutz
 Surveyed 12 June 1871 David Ligon } Chain Carrier
 S L H Luckett, Dep Surveyor, Travis Dist do hereby
 certify, that the foregoing survey was made according
 to law, and that the limits, boundaries and corners
 with the marks, natural and artificial are truly
 described in the foregoing plat and field notes

L H Luckett, Dep Surveyor Travis Dist.
 J R Paer, District Surveyor Travis Dist do hereby
 certify, that I have examined the foregoing plat and
 field notes and find them correct, and that they
 are recorded in my office in Book 2 page 23

Given under my hand at Austin 27 day of July 1871

James R Paer
 District Surveyor Travis District.

The State of Texas,
District of Travis, Survey No 24

Field notes of a survey of 640 acres of Land, made for Buffalo B B & C B R Co, it being the quantity of Land to which he is entitled by virtue of Land Serip No 485 issued by W S Hotchkiss, Com of Claims on 30 March 1860. Said Survey is No 24 in Coleman County, situated on the waters of Boards creek, a tributary of Colorado river, about 14 miles S 83 W of Camp Colorado.

Beginning at a stone mound the S W cor of Sur No 23 made for the B B B & C B R Co. from which a L. O. 17 in in dia br N 17 E 33 or 2 a do N 7 1/2 W 50 or. Thence East with L line of Nos. 31 & 23. 1400 or a branch 1900 or a stone mound S W cor of No 25 from which a L. O. 12 in dia br. 284 E 33 or 2 a Live Oak 15 in in dia br N 88 E 34 or.

Thence South 260 or same branch 1115 or a branch 1900 or a stone mound. Thence West 1900 or a stake S W cor of No 27 & N E cor of No 28 from whence a Live Oak. br 273 E 110 or 2 a do 276 1/2 E 115. Thence North 1900 or to the place of beginning.

Bearing marked X Jacob Lutz,
Surveyed 12 June 1871 David Ligan, Chain Carrier
J L Duckett, Dep Surveyor Travis Dist do hereby certify that the foregoing survey was made according to law, and that the limits, boundaries & corners with the marks, natural & artificial are truly described in the foregoing plat & field notes.

J L Duckett, Dep Surveyor, Travis Dist.

J R Paer, Dist Surveyor of Travis Dist do hereby certify that I have examined the foregoing plat and field notes and find them correct, and that they are recorded in my office in Book 2 page 24.

Given under my hand at Austin this 27 day of July 1871

James R Paer

Dist Surveyor Travis Dist.

The State of Texas }
 District of Travis } Survey No 25

Field Notes of a survey of 640 acres of Land, made for
 Buffalo P R & C R R Co, it being the Land to which he is
 entitled by virtue of Land Scrip No 459 issued by W S
 Scholchiff Com of Claims on 31st March 1860

Said Survey is No 25 in Coleman County, situated on the
 waters of Hobbs creek, a tributary of Colorado river, about
 13 miles S 86 W of Camp Colorado.

Beginning about 13 miles Stone mound from which a S. O.
 15 in diameter N 88 E 340 r & a P. O. S 84 E 330 r. the N. E. cor of No
 24 made for the P R R & C R R Co. Thence South with E. line
 of No 24. 260 r a branch 1115 r a branch 1746 r a Stone mound
 N. W. cor of No 26. Thence East with N. line of No 26, 1900 r
 a Stone mound from which a S. O. 12 in dia S 39 E 800 r.

Thence North 6400 r a branch 1966 r a Stone mound S. E.
 cor of W Young survey from which a S. O. 6 r S 7 W 200 r & a
 P. O. 25 in dia S 62 W 260 r. Thence West 1344 r to the S. W.
 cor of said Young survey. Thence South 2200 r a corner. Thence
 West 556 r to the place of beginning.

Bearings marked by Jacob Lutz }
 Surveyed 12 June 1871 David Ligon } Chain Carrier
 J. H. Duckett, Dep Surveyor Travis Dist do hereby certify
 that the foregoing survey was made according to law, and
 that the limits, boundaries and corners, with the marks
 natural and artificial are truly described in the foregoing
 plat and field notes J. H. Duckett

Dep Surveyor Travis District

I James R Pace, District Surveyor, Travis District do
 hereby certify, that I have examined the foregoing
 survey and find them correct and that they are
 recorded in my office in Book 2 page 22

Given under my hand at Austin this 27 day of July
 1871

James R Pace

District Surveyor Travis District

The State of Texas,
District of Travis, Survey No 26

Field notes of a survey of 640 acres of Land, made for Buffalo B B & L R R Co. it being the quantity of Land to which he is entitled by virtue of Land Grant No 454 issued by W S Hooleh Kiplom of Claims on 30 March 1860. Said Survey is No 26 in Coleman County, situated on the waters of Hord's creek, a tributary of Colorado river about 13 miles S 80 W of Camp Colorado.

Beginning at a stone mound from which a L. O 12 in dia br S 39 E 80 or the S E cor of No 25 made for the B B B & L R R Co.

Thence South 840 or a branch 1900 or a stone mound from which a Mesquite 10 in dia br S 84 W 60 or a 3 prong L. O. br N 38 1/2 W 200 or. Thence West 1900 or a stone mound on the E line of No 27 made for B B B & L R R Co. Thence North with the E line of No. 27 & 24. 1900 or a stone mound & S W cor of No 25. Thence East 1900 or to the place of beginning

Bearings marked X Jacob Dutz

Surveyed 12th June 1871 David Ligon & Chas. Barrin

I J H Duckett, Dep Surveyor, Travis District, do hereby certify that the foregoing survey was made according to law, and that the limits, boundaries & corners, with the marks, natural and artificial are truly described in the foregoing plat & field notes.

I J H Duckett, Dep Surveyor, Travis Dist.

I J R Paer, District Surveyor, Travis Dist, do hereby certify, that I have examined the foregoing plat and field notes and find them correct, and that they are recorded in my office in Book 2 page 26

Given under my hand at Austin this 27th day of July 1871

James R Paer
District Surveyor Travis District.

The State of Texas }
 District of Travis } Survey No 30

Field notes of a Survey of 640 acres of Land, made for Buffalo B B & C R R Co. it being the quantity of Land to which he is entitled by virtue of Land Scrip No 487 issued by W. S. Holchkip Com of Claims on 30th March 1860

Said Survey is No 30 in Coleman County, situated on the waters of Hords Creek a tributary of Colorado river, about 18 miles S 86 W of Camp Colorado.

Beginning at a stake the S E cor of No 29 made for the B B & C R R Co. from whence a Post Oak 9 in dia brs S 9 E 2 or 2 a do 12 in brs S 24 E 7 or. Thence North 1800 or a stake cor of No 31 from which a P. O. 12 in dia br W 1/2 or 2 a do N 1 W 3 or. Thence West passing the S W cor of No 31, 223 brs to a corner. Thence South passing the N E cor of A Marshall No 702 & with the E line of same 1600 or to S E cor of said No 702. from whence a P. O. 11 in dia br S 84 1/2 E or 2 a do 9 in N 27 1/2 E 9 or. Thence East 199 brs to N E cor of No 693. Thence South 200 or to N W cor No 28 Thence East 2400 or to the place of beginning.

Bearings marked X Geol. Sutz }
 Surveyed 12 June 1871 David Ligon } Chain carriers

I L H Duckett, Dep Surveyor Travis Dist, do hereby certify that the foregoing survey was made according to law and that the limits, boundaries and corners, with the marks, natural and artificial are truly described in the foregoing plat and field notes L H Duckett
 Dep Surveyor Travis District

I J R Pace, Dist. Surveyor Travis Dist do hereby certify that I have examined the foregoing plat & field notes and find them correct and that they are recorded in my office in Book 2 page 30

Given under my hand at Austin this 27 day of July 1871

James R Pace
 District Surveyor Travis District

The State of Texas,
District of Travis, Survey No. 29.

Field notes of a survey of 640 acres of Land, made for Buffalo, B. B. & C. R. R. Co, it being the quantity of Land to which he is entitled by virtue of Land Scrip No. 487 issued by W. S. Holch Kipp Com of Claims on 30th March 1860.

Said survey is No. 29 in Coleman County, situated on the waters of Hoods creek, a tributary of Colorado river, about 15 1/2 miles S 84° W of Camp Colorado. Beginning at a Stake the N. W. corner No. 27 & E. cor of No. 28 both made for the B. B. & C. R. R. Co.

Thence West with the N. line of said No. 28. 1900 or a Stake from whence a P. O. 9 in dia brs S 9 E 2 or 90 do 12 in dia brs S 24 E 7 or. Thence North with E. line of No. 30. 1900 or a Stake from whence a P. O. 9 in dia brs S 82 1/2 E 5 or 9 do 10 in S 41 3/4 E 13 or an inside corner of No. 31. Thence East with S. line of No. 31. 1900 or a Stone bounded the N. W. cor of No. 24 from whence a P. O. brs N 17 E 13 or 9 do S 41 3/4 E 13 or. Thence South 1900 or to the place of beginning.

Bearings marked X Jacob Lutz,
Surveyed 12th June 1871 David Ligon, Chain Carrier.

I L. H. Suckett, Dep Surveyor, Travis District, do hereby certify, that the foregoing survey was made according to law and that the limits boundaries & corners with the marks natural and artificial are truly described in the foregoing plat and field notes. L. H. Suckett, Dep Surveyor, Travis Dist.

I James R. Paer, Dist Surveyor Travis Dist, do hereby certify, that I have examined the foregoing plat and field notes and find them correct and that they are recorded in my office in Book 2 page 29.

Given under my hand at Austin this 27 day of July 1871

James R. Paer
District Surveyor Travis District

The State of Texas }
 District of Travis } Survey No 27.

Field notes of a survey of 640 acres of Land, made for
 B B B & C R R Co. it being the quantity of Land to which he is entitled
 by virtue of Land Serip No 486 issued by W S Holch Kip Com of Claims
 on 30th March 1860.

Said Survey is No 27 in Coleman County, situated on the
 waters of Lords creek a tributary of Colorado river, about
 14 1/2 miles S 80 W of Camp Colorado.

Beginning at a stone mound S E cor of No 24 made for the
 B B B & C R R Co. Thence South with the West line of No 26 made
 for same Co. 1740 or S W cor of said 26. 1900 or a stone mound.
 Thence West 40 or a branch 1900 or a stone mound from which
 a S. O. 14 in brs N 69. W 35 & a do 8 in N 50 W 40 or. Thence North
 1900 or a stake & S W cor of said No 24 & S E cor of No 29.
 Thence East 1900 or to the place of beginning.

Bearings marked X Jacob Lutz }
 Surveyed 12th June 1871 David Ligon Chain Carrier.

I J H Luckett, Dep Surveyor Travis Dist. do hereby certify
 that the foregoing survey was made according to law, and
 that the limits, boundaries & corners, with the marks,
 natural and artificial are truly described in the
 foregoing plat and field notes J H Luckett

Dep Surveyor Travis District

I J R Pice, Dist Surveyor, Travis District, do hereby certify
 that I have examined the foregoing survey and find
 it correct and that they are recorded in my office
 in book 2 page 27.

Given under my hand at Austin, this 27 day of July 1871

James R Pice

District Surveyor Travis District.

The State of Texas
 District of Travis) Survey No 28.

Field Notes of a Survey of 640 acres of Land, made for B B B & C R Co., it being the quantity of Land to which he is entitled by virtue of Land Serip No 486 issued by W S Holch kips, Com of Claims on 30 March 1860

Said Survey is No 28 in Coleman County, situated on the waters of Hords creek, a tributary of Colorado river, about 17 miles S 84 W of Camp Colorado.

Beginning at a Stake & N W cor of No 27 SW of No 29, both made for the B B B & C R Co. from whence a L. O. 6 in br S 73 E 10 or & a do S 76 1/2 E 115 or Thence South 1688 or to a Stake on W line of No 27. Thence West 2140 or a stone mound on E line of No 695 made for

Thence North crossing a branch 1688 or a stake from whence a L. O. 8 in br S 81 1/2 W 20 or & a do 10 S 77 1/2 W 28 or. Thence East 240 or SW cor of No 29 & with line of same 2140 or to the place of beginning.

Bearings marked X Jacob Lutz }
 Surveyed 12 June 1871. David Ligon } Chain carriers.

I L H Luckett, Dep Surveyor, Travis Dist, do hereby certify that the foregoing survey was made according to law, and that the limits, boundaries and corners, with the marks, natural and artificial are truly described in the foregoing plat and field notes. L H Luckett

Dep Surveyor, Travis District.

I J H Paer, Distr. Surveyor, Travis District, do hereby certify, that I have examined the foregoing plat and field notes and find them correct, and that they are recorded in my office in Book 2 page 28.

Given under my hand at Austin this 27th day of July 1871

James P. Paer
 District Surveyor Travis District.

The State of Texas,
 District of Travis, Survey No 31

Field Notes of a Survey of 640 acres of Land, made for
 B B B & C R R Co. it being the quantity of Land, to which they
 are entitled by virtue of Land Scrip No 488 issued by W S
 Holch Kip Gov of Claims, on 30th March 1860.

Said Survey is No 31 in Coleman County, situated on the
 waters of Floods creek a tributary of Colorado river, about
 15¹/₄ miles S 88 W of Camp Colorado.

Beginning at a Stone mound N W cor of No 24 made for
 the B B B & C R R Co. Thence North 594 or a stake on the S line
 of No 687 for J M Leau. Thence West 2085 or to his S W cor
 a P. O. brs S 10 or a double N 62¹/₂ W 1 or. Thence North 1216 or a stake
 a P. O. brs 11³/₄ W 23 or a double S 69¹/₄ W 12 or. Thence West 1233 or
 a stake on S line of No 32 a P. O. brs N 12 W 25 or. a double
 P. O. brs S 59 E 16 or. Thence South 1910 or a stake on N line of
 No 30. Thence East 1480 or a stake on W line of No 29. a P. O.
 brs N 3¹/₂ W 3 or a double N 25 W 4 or. Thence North 700 or to the
 N W cor of No 29. a P. O. brs S 82¹/₂ E 5 or. a double S 41³/₄ E 13 or.

Thence East with N line of No 29. 1900 or to the beginning
 Bearings marked X Jacob Lutz

Surveyed 22 June 1871 David Ligon, Chain Carrier.

I L H Suckett, Dep Surveyor, Travis Dist. do hereby certify
 that the foregoing survey was made according to law,
 and that the limits, boundaries and corners with
 the marks, natural and artificial are truly described
 in the foregoing plat and field notes L H Suckett.

Dep Surveyor Travis District.

I J R Pace, District Surveyor Travis Dist. do hereby
 certify, that I have examined the foregoing plat & field
 notes and find them correct, and that they are
 recorded in my office in book 2 page 31

Given under my hand at Austin, this 27 day of July 1871

James R Pace

Dist. Surveyor Travis District.

The State of Texas
 District of Travis } Survey No 32.

Field Notes of a Survey of 640 acres of Land, made for B.B. & P.R. Co., is being the quantity of Land, to which he is entitled by virtue of Land Scrip No 488 issued by W.S. Holch Kip, Com of Claims on 30th March 1860.

Said Survey is No 32 in Coleman County, situated on the waters of Hords creek, a tributary of Colorado river, about 18 miles West of Camp Colorado.

Beginning at a Stake N.E. cor of No 31 made for the J. B. & P. R. Co. on the West line of McLean Survey No 62, from whence S. O. brs S $11\frac{3}{4}$ W $23\frac{1}{2}$ or a do. brs S $69\frac{1}{4}$ W $12\frac{1}{2}$. Thence West with N line of said No. 2586 or a stone mound or S. O. brs N $24\frac{3}{4}$ E $80\frac{1}{2}$ or a Spanish O. brs S $48\frac{1}{2}$ E $80\frac{1}{2}$. Thence North $970\frac{1}{2}$ or a branch $2095\frac{1}{2}$ or a Stake a S. O. brs S $86\frac{1}{2}$ W $2\frac{1}{2}$ or a do. S $89\frac{3}{4}$ E $2\frac{1}{2}$. Thence East $1242\frac{1}{2}$ or to N.W. cor of No 701. for J. P. McLean a S. O. brs S 34 E $12\frac{1}{2}$ or a do N $3\frac{1}{2}$. Thence South $1344\frac{1}{2}$ or to a stake & S.W. cor of said No 701. Thence East $1344\frac{1}{2}$ or to S.E. cor of No 701. Thence South with West line of No 687 or crossing a branch $757\frac{1}{2}$ to the place of beginning.

Beginning marked X Jacob Lutz }
 surveyed 22 Jun 1871. David Ligon } Chain Carriers
 J. H. Luckett. Dep Sur. Travis Dist, do hereby certify that the foregoing Survey was made according to law, and that the limits boundaries & corners, with the marks, natural and artificial, are truly described in the foregoing plat & field notes J. H. Luckett
 Dep Surveyor Travis District.

J. R. Pace, Dist Surveyor, Travis Dist. do hereby certify that I have examined the foregoing plat and field notes and find them correct, and that they are recorded in my office in Book L N 32. Given under my hand at Austin this 27th day of July 1871

James R. Pace
 Dist Surveyor Travis District.

The State of Texas }
 District of Travis } Survey No. 37

Field's lot of a survey of 640 acres of Land, made for
 Buffalo & B. & C. R. Co. it being the quantity of Land to
 which he is entitled by order of Land Scrip No. 492 issued
 by W. L. Holchiff, Com. of Claims on 30th March 1860.
 Said survey is No. 37 in Coleman County, situated on
 the waters of Hood's creek, a tributary of Colorado
 river, about 16 miles S 75 W of Camp Colorado.

Beginning at a stake 190 or South of the N E cor of N 35
 made for the B. B. & C. R. Co. from which a P. 11 in dia br
 S 33 40 or. Thence East 800 or a branch 190 or a stone mound
 from whence a P. 13 in dia br. S 10. E 45 or. Thence South
 900 or a stake on the N line of N 39. made for said. R. R.
 Co. from whence a P. O. 14 in dia br. N 22 E 55 or a do 9 in
 N 30. E 55 or. Thence West. 457. or to the N E cor of Burnet
 Co School Land (2 of the witness trees standing & with its
 N line 190 or. stake from whence a P. O. br. S. 45 1/2 W 8 or
 a do South 7 or. Thence N 190 or S E cor of N 35. 190 or
 to the place of beginning

Bearings marked & Jacob Dutz }
 Surveyed 1871 David Ligon } Chain Carriers.
 I L. H. Suckell Dep. Sur. Travis Dist. do hereby certify that
 the foregoing survey was made according to law, & that the
 limits, boundaries & corners, with the marks, natural &
 artificial are truly described in the foregoing plat and
 field notes. L. H. Suckell, Dep. Sur. Travis District.
 J. R. Paer, Dist. Surveyor Travis Dist, do hereby certify that I have
 examined the foregoing plat & field notes, and find
 them correct, and that they are recorded in my office
 in Book 2 page 37. Given under my hand at Austin
 this 27 day of July 1871 James R. Paer
 District Surveyor Travis District.

The State of Texas,
District of Travis } Survey No 38.

* Said Survey is No 38 in Coleman County, situated on the waters of Hords creek, a tributary of Colorado river, about 16 miles S 70 W of Camp Colorado.

Beginning at a stake and E cor of No 37 made for the B B B & C R R Co, from whence a P. O. 14 in dir. br. N 22 E 55 or 2 a do 9 N 30 E 55 or. Thence East 1800 or a brand, 1900 or a stone mound. Thence North 1900 or a stake.

Thence West 1900 or a stone mound & N E cor of same No 37. from whence a P. O. 13 in br. 60 E 45 or. Thence South with the E line of said No 37. 1900 or to the place of beginning.

Field notes of a survey of 1640 acres of Land made for the B B B & C R R Co, it being the quantity of Land to which he is entitled by virtue of Land Scrip No 492 issued by W. S. Holch Kip Com of Claims on 30th March 1860.

Bearings marked & Jacob Lutz
Surveyed 1871, David Ligon } Chain Carriers.

J. L. Luckell, Dep. Sur. Travis Dist., do hereby certify that the foregoing survey was made according to law & that the limits, boundaries & corners with the marks, natural & artificial are truly described in the foregoing plat & field notes. J. L. Luckell
Dep. Surveyor Travis District.

J. J. R. Paer, Dist. Surveyor, Travis District do hereby certify that I have examined the foregoing plat and field notes and find them correct, and that they are recorded in my office in Book L page 638. Given under my hand at Austin this 27 day of July 1871 James R. Paer
District Surveyor Travis District.

The State of Texas
 District of Travis ; Survey No 90

Field notes of a survey of 640 acres of Land, made for the Eastern
 T R R Co, it being the quantity of Land to which he is entitled
 by virtue of Land Scrip No 125 issued by H S Hutchkiss Comr
 Claims on 19th of August 1861

Said Survey is No 90 in Coleman County, situated on the
 waters of Horns creek, a tributary of Colorado river, about
 22 miles S 20 W of Camp Colorado.

Beginning at a stake of E Cor Sur No 89, @ N W cor of No 85
 both made for the Eastern T R R Co. from which a L.O. 16 in
 dia brs S 20 1/2 W 400 or @ a do 12 in N 25 1/2 W 450 or. Thence
 North with E line of said No 89. 1900 or to the N E cor of same
 a stone mound from which a Mesquite 6 in dia brs N 29 1/2 E 150
 @ a L.O. 14 in N 88 W 200 or. Thence East 1900 or a Stake
 from which a L.O. 7 in dia brs N 30 E 500 or @ a do 12 in N 71 1/4
 E 700 or. Thence South crossing a branch (S E) 1900 or to the
 N E cor of said No 85 @ L.O. brs S 22 1/2 W 200 or @ a do S 10 W
 200 or. Thence West with line of said No 400 or a br.
 1900 or to the place of beginning.

Bearings marked X ; David Ligon
 Surveyed 1st Nov. 1871 ; Peter Lewis ; Chain Carrier
 J H Luckett, Dep Surveyor, Travis Dist, do hereby certify
 that the foregoing survey was made according to law
 and that the limits, boundaries & corners, with the marks,
 natural & artificial are truly described in the foregoing
 plat & field notes. J H Luckett

Dep Surveyor Travis District
 J J P. Pace, Dist Surveyor Travis Dist. do hereby certify
 that I have examined the foregoing plat & field notes
 & find them correct, and that they are recorded in
 my office in Book 2 page 128.

Given under my hand at Austin, this 21st day of Dec 1871

James R Pace
 District Surveyor Travis District.

The State of Texas
 District of Travis } Survey No 89

Field notes of a survey of 640 acres of Land, made for the
 Eastern P. R. R. Co, it being the quantity of Land, to which he
 is entitled by virtue of Land Scrip No 120, issued by W. H. Holbeck,
 Comr of Claims on 19th of Aug. 1871

Said Survey is No 89 in Coleman County, situated on the
 waters of Home Creek, a tributary of Colorado river,
 about 22 miles S 23 W of Camp Colorado.

Beginning at a stake, the S E cor of Sur No 88 made
 for the E. T. R. R. Co from which a L. P. 7 in dia brs N 6 to 300
 & a dot 0 in N 1 3/4 E 3000. Thence North with E line
 of said No 88 crossing a branch (S W) 1900 to N E cor of
 said No 88 a stone mound. Thence East 1900 to a
 stone mound a Mesquite in dia brs N 29 1/2 E 1500 &
 L. P. 1 1/2 in N 88 W 2000. Thence South 1900 to the N E cor
 of No 86 made for the E. T. R. R. Co, a stake from which a
 L. P. 1 1/2 in dia brs S 20 1/2 W 4000 & a dot 12 in N 25 1/2 W 750.
 Thence West 600 to a branch, 1900 to the place of beginning.

Bearing & marked X David Ligon }
 Surveyed 1 Nov 1871 Peter Lewis } Chain Carriers.

I J. H. Luckett, Dep Sur. Travis Dist, do hereby certify, that the
 foregoing survey was made according to law, and that
 the limits, boundaries & corners, with the marks, natural
 and artificial are truly described in the foregoing plat
 & field notes. J. H. Luckett

Deputy Surveyor Travis District.

I J. P. Paer, Dist Surveyor Travis Dist, do hereby certify that
 I have examined the foregoing plat & field notes and find
 them correct, and that they are recorded in my office
 in Book 2 page 127. I witness under my hand and
 seal this 21 day of Decr 1871

James P. Paer
 District Surveyor Travis District.

The State of Texas
 District of Travis } Survey No 107

Field Notes of a survey of 640 acres of Land, made for Eastern T. R. Co. it being the quantity of Land, to which he is entitled by virtue of Land Scrip No 128, issued by W. H. Keith lessor of Claims on 19th Aug. 1861.

Said survey is No 107 in Coleman County, situated on the waters of Branch, a tributary of Colorado river, about 24 miles S 70 W of Camp Colorado.

Beginning at a Stone mound on NW cor of Sec No 301 made for J B Beal on the S line of No 307 made for Goodwin. Thence South 1020 or a branch 1351 or a stake from which a Mesquite 4 in dia br. N 26 1/4 E 210 or 2 rods 6 in N 31 E 200 or. Thence West 2011 or a stone mound from which a Mesquite 4 in br N 34 W 275 or 2 rods 4 in N 45 3/4 W 30 or. Thence North with the East line of No 108 made for said E T R Co. 1650 or a branch 2270 or a corner. Thence East 975 or to cor on W line of said No 307. Thence South with said 307. - 919 or to its SW cor. Thence East 1036 or to the place of beginning.

Bearings marked X. L. Lewis & L. J. G. over

Surveyed 2^d Nov 1871 Peter Lewis } Chain Carrier.

I J. H. Luckett, Dep Surveyor Travis Dist, do hereby certify that the foregoing survey was made according to law & that the limits, boundaries & corners with the marks, natural and artificial are truly described in the foregoing plat & field notes. J. H. Luckett.

Dep Surveyor Travis District.

I J. R. Pace, District Surveyor Travis Dist do hereby certify, that I have examined the foregoing plat & field notes and find them correct, and that they are recorded in my office in Book 2 page 163.

Given under my hand at Austin this 5 day of Febr.

James R. Pace.

District Surveyor Travis District.

1872?

1871

The State of Texas }
 District of Travis } Survey No 108.

Field notes of a Survey of 640 acres of Land, made for Eastern T B Co, it being the quantity of Land to which he is entitled by virtue of Land Scrip No. 128 issued by W S Holdriff Com of Claims on 19 Aug 1861. Said Survey is No. 108 in Coleman County, situated on the waters of Branch a tributary of Colorado river about 24 miles S 73 W of Camp Colerado.

Beginning at a stone mound 265 or South of the S W cor of Sur. No. 107 made for the E T B Co. Thence North with the West line of said No. 107. 1900 or a stone mound on the S bank of Branch. Thence West 1900, a stone mound. Thence South 1900 or a stone mound. Thence East 200 or a branch (S W) 1900 or to the place of beginning.

Bearings marked & David Lion }
 Surveyed 187. Peter Lewis } Chain Carriers.

I J H Luckett, Dep Surveyor Travis Dist, do hereby certify that the foregoing survey was made according to law and that the limits, boundaries and corners with the marks, natural and artificial are truly described in the foregoing plat and field notes.

J H Luckett

Dep Surveyor Travis District

I J R Paer, Dep Surveyor Travis Dist do hereby certify that I have examined the foregoing plat and field notes and find them correct and that they are recorded in my office in Book 2 page 164 Given under my hand at Austin this 29 day of January 1872

James R Paer

Distric Surveyor Travis District

The State of Texas
 District of Travis } Survey No 113.

Field notes of a Survey of 640 acres of Land made for Eastern T R R Co, it being the quantity of Land to which he is entitled by virtue of Land Scrip No 129 issued by W S Hottelkip Com of Plains on 19th Aug 1861.

Said Survey is No 113 in Colman County, situated on the waters of a branch, a tributary of Colorado river about 23 1/2 miles S 70 W of Camp Colorado.

Beginning at a Stone marker 150 S of a branch (W) the N E cor of Sur. made for the E T R R Co. No 108. Thence North with the West line of No 107 & No 66 19000 to a stake & S E cor of Sur No 67 made for B B B & P R R Co. from which a Quarry is 4 in brs N 41 1/2 E 2500 & a clo 5 in S 52 1/2 E 5500. Thence West 19000 to the S W cor of said No. 67 a Stone marker and a Hill brs S 79 1/2 E about 5000. Thence South 19000 to a Stone marker & N W cor of said No 108. Thence East 19000 to the place of beginning.

Bearings marked X David Ligon
 Surveyed 187 Peter Lewis } Chain Carrier.

L H Duckett, Dep Sur Travis Dist, do hereby certify that the foregoing Survey was made according to law and that the limits, boundaries and corners, with the marks natural and artificial are truly described in the foregoing plat & field notes L H Duckett

Dep Surveyor Travis District.

J R Pece, Dist Surveyor Travis Dist do hereby certify that I have examined the foregoing plat & field notes and find them correct, and that they are recorded in my office in Book 1 page 165

Given under my hand at Austin this 6th day of Feb
 1872.

James R Pece
 District Surveyor Travis District.

The State of Texas }
 District of Travis } Survey No 114

Field notes of a Survey of 640 acres of Land, made for the Eastern T. R. R. Co., it being the quantity of Land to which he is entitled by virtue of Land Scrip No 129, issued by W. H. Goldkrip, Com of Claims on 19 Aug 1861. Said Survey is No 114 in Coleman County, situated on the waters of a branch, a tributary of Colorado river, about 25 miles S 72 W of Camp Colorado.

Beginning at a stake mound the NW cor of No 108 & the SW cor of Sur No 113 both made for the E. T. R. Co. Thence North 1900 or a stone mound & NW cor of Sur No 113 from which a stone mound & a Hill br S 79 1/2 E about 5000. Thence West 1900 or a corner in the prairie Thence South 1900 or to the NW cor of No 109. Thence East 1900 or to the place of beginning.

Bearings, marked & David Ligon }
 Surveyed 3 Nov 1871 Peter Lewis } Chain Carriers.

L. H. Luckett, Dep Sur Travis Dist, do hereby certify, that the foregoing survey was made according to law, and that the limits, boundaries and corners, with the marks, natural and artificial are truly described in the foregoing plat and field notes

L. H. Luckett

Dep Surveyor Travis District

J. R. Pace, Dist Surveyor Travis District, do hereby certify that I have examined the foregoing plat and field notes and find them correct, and that they are recorded in my office in Book 2 page 166 Given under my hand at Austin this 6 day of Febr, 1872

James R. Pace

District Surveyor Travis District

The State of Texas
District of Travis } Survey No 117.

Field Notes of a Survey of 640 acres of Land, made for East
T R R Co. it being the quantity of Land, to which he is entitled
by virtue of Land Scrip No 130 issued by W S Hatch Rep Com
of Claims on 19th Aug 1861

Said Survey is No 117 in Coleman County, situated on the
waters of a branch a tributary of Colorado River, about 25 miles,
S 75 W of Camp Colorado. Beginning at the NW cor of
Sur No 113 made for E T R R Co. & S Mer of N 67 made for
B B B & R R Co. a stone mound from which a stone mound
on the top of a hill br S 79 1/2 E about 5000. Thence North
about 19000. a stake from which a S. O. 15 in br N 67 W 120,
& a do. 14 in N 67 1/2 W 1220. Thence West 3170 to the
S E cor of Sur No 118 made for said E T R R Co 19000. a stake
in the prairie on the South line of said No 117. Thence
South 19000 a cor. Thence East 19000 to the place of beginning
Bearings on as Recd & David Ligon

Surveyed 3 Nov 1871, Peter Lewis, Chain Carrier.

L H Luckett, Dep Sur Travis Dist, do hereby certify that the
foregoing survey was made according to law, and that the
limits, boundaries and corners, with the marks, natural &
artificial are truly described in the foregoing plat and
field notes. L H Luckett

Dep Surveyor Travis District.

J R Pace, Dist Surveyor Travis Dist, do hereby certify
that I have examined the foregoing plat and field
notes and find them correct, and that they are recorded
in my office in Book 2 page 167.

Given under my hand at Austin this 6 day of Feby 1872.

James R Pace

District Surveyor Travis District.

The State of Texas }
District of Travis } Survey No 118

Field notes of a survey of 640 acres of Land, made for East. T. R. Co. it being the quantity of Land, to which he is entitled by virtue of Land Scrip No 130, issued by W. S. Hatchkrip, Com of Claims on 19th Aug. 1861.

Said Survey is No 118 in Coleman county, situated on the waters of a branch, a tributary of Colorado river, about 25 miles S 7/8 W of Camp Colorado. Beginning at a stake the S. W. cor of No 68 made for B. B. B. & C. R. Co. 3170. W of the N. E. cor of Sur No 117 made for E. T. R. Co. Thence West with the North line of No 117 passing the N. W. cor of same 3827.00 a stone mound. From which an Elm 5 in to N 10 1/2 W 295.00. Thence North crossing a branch 944.00 a corner. Thence East 3827.00 a stone mound. N. W. cor of Sur No 68 made for B. B. B. & C. R. Co. and on the S. line of N 67 made for E. T. R. Co. Thence South with the West line of said No 68. 944.00 to the place of beginning.

Bearings marked & David Ligon }
Surveyed 4 Nov. 1871 } Peter Lewis } Chain carrier,
J. L. Luckett, Dep Sur. Travis Dist, do hereby certify that the foregoing survey was made according to law; and that the limits, boundaries and corners, with the marks natural and artificial are truly described in the foregoing plat and field notes. J. L. Luckett
Dep Sur. Travis District.

J. R. Pace, Dist Sur Travis Dist, do hereby certify, that I have examined the foregoing plat and field notes and find them correct and that they are recorded in my office in Book L page 168. Given under my hand and seal, this 6th day of Febr. 1872.

James R. Pace
District Surveyor Travis District.

The State of Texas }
 District of Travis } Survey No 122.
 Field Notes of a Survey of 640 acres of Land, made for E T R R
 Co it being the quantity of Land, to which he is entitled by
 virtue of Land Scrip No 132 issued by W L Holch Kipp Com of
 Claims on 19 Aug 1861. ^{a Runnel}
 Said Survey is No 122 in Colman County, situated on the waters
 of Clear creek, a tributary of Colorado river, about 12 ^{miles}
 miles S 27 E of Table Mt Beginning at the N W cor of Sur.
 No 70 made for N O R R Co & the S E cor of Sur. No 121 made
 for E T R R Co a stone mound from which a Mesquite 4 in
 brs S 4 3/4 E 85 or a do 6 in S 2 3/4 W 110 or. Thence East with
 the N line of said No 70. 1900 or a stake in the prairie
 Thence North 1900 or a corner on W line of N 312 made
 for B G Gillon Thence West crossing a branch 1900 or to
 the N E cor of said N 121 a stone mound from which
 a Mesquite 5 in dia br. S 3 1/2 E 50 or a do 4 in N 68 1/2 E 60 or
 Thence South with E line of said No 121 1900 or to the
 place of beginning.

Bearings marked by David Ligon }
 Surveyed 4 Nov. 1871 Peter Lewis } Chain Carrier.
 J L H Luckett, Dep Sur. Travis Dist, do hereby certify that
 the foregoing survey was made according to law, and
 that the limits, boundaries and corners, with the marks
 natural and artificial are truly described in the
 foregoing plat and field notes J L H Luckett
 Dep Surveyor Travis District.

J R Paer, Dist Surveyor, Travis Dist, do hereby certify
 that I have examined the foregoing plat & field
 notes and find them correct, and that they are
 recorded in my office in Book 2. pag 172
 Given under my hand at Austin this 6th day of Feb, 1872.

James R Paer
 District Surveyor Travis District.

The State of Texas }
 District of Travis } Survey No. 121
 Field Notes of a Survey of 640 acres of Land, made for Easton
 F. R. Co, it being the Land, to which he is entitled by virtue
 of Land Scrip No. 132, issued by W. S. Holchkip, Com. of
 Claims on 19 Aug 1861.

Said Survey is No. 121 in Pinnell County, situated
 on the waters of Clearcreek, a tributary of Colorado
 river, about 12 miles S 25 E of Taber Mt.

Beginning at the N E cor of Sur No. 120, made for
 E. F. R. Co. a stone mound from which a Mesquite
 4 in dia brs S 4 3/4 E 85 or @ a do 6 in S 2 3/4 W 100 or.
 the N W cor of Sur. No. 70, made for the N. O. R. Co.

Thence North 1900 or a stone mound from which a
 Mesquite 5 in dia brs S 3 3/4 E 50 or @ a do 4 in N 68 1/2
 E 60 or. Thence West crossing a branch a 1900 or a stone
 mound from which a 20. 12 in brs N 8 1/2 E 92 or @ a do
 12 in N 50 1/2 W 140 or. Thence South crossing a branch
 1900 or a stone mound from which a Mesquite 10 in
 brs N 57 E 94 or @ a do 6 in S 2 3/4 W 110 or. Thence East
 with the N line of No. 120, 1900 or to the place of beginning.

Bearings marked. X David Ligon }
 Survey 187 Peter Lewis } Chain carrier.

I J. H. Luckett, Dep Sur Travis Dist, do hereby certify
 that the foregoing survey was made according to law
 and that the limits, boundaries and corners, with the
 marks, natural and artificial are truly described
 in the foregoing plat and field notes J. H. Luckett
 Dep Surveyor Travis District.

I J. P. Pace, Dist Surveyor Travis Dist, do hereby certify
 that I have examined the foregoing plat and field
 notes and find them correct, and that they are recorded
 in my office in Book 2 page 171

Given under my hand at Austin this 6 day of Feby 1872.

James P. Pace
 District Surveyor Travis District.

The State of Texas }
 District of Travis } Survey No 126

Field notes of a survey of 640 acres of Land, made for East
 T R R Co, it being the quantity of Land to which he is entitled
 by virtue of Land Scrip No 92, issued by W S Holchkip, Com of Claims
 on 19th August 1861

Said Survey is No 126 in Runnels County, situated in the
 waters of Clear Creek, a tributary of Colorado river, about 27
 miles N 87° W of Camp Colorado.

Beginning at the SW cor of Sur No 125 made for E T R R Co
 from which a Mesquite 12 in dia br S 35° E 65 or 0 a do 10 in
 S 2 3/4° E 60 or. Thence South crossing two branches 1900 or a
 cor on the N line of No 127. Thence East 1900 or to the N E cor
 of said No 127, made for the E T R R Co. a stone mound from
 which a Mesquite 8 in br N 70 1/2° E 165 or 0 a do 6 N 77 3/4° E 70 or
 Thence North 410 or a branch (SW) 1900 or a stone mound
 from which a L. O. br N 17 1/2° E 160 or 0 a Mesquite 10 in N 38 1/2°
 W 285 or. Thence West 520 or a branch 1680 or a branch 1900 or
 to the place of beginning.

Bearings marked X David Lygou }
 Surveyed 5 Nov 1871 Peter Lewis } Chain Carrier.

J L H Duckett, Dep. Surveyor, Travis Dist, do hereby certify
 that the foregoing survey was made according to law, and
 that the limits, boundaries and corners, with the marks,
 natural and artificial, are truly described in the foregoing
 plat and field notes. J L H Duckett

Dep Surveyor Travis District.

J J R Paer, Dist. Surveyor Travis Dist do hereby certify, that
 I have examined the foregoing plat and field notes and
 find them correct, and that they are recorded in my office
 in Book 2 page 148. Given under my hand at Austin
 this 22 day of Decr 1871

James R Paer
 District Surveyor Travis District.

The State of Texas }
 District of Travis } Survey No 125

Field notes of a Survey of 640 acres of Land, made for E. T. R. Co. it being the quantity of Land to which he is entitled by virtue of Land Scrip No 92, issued by W. S. Holch Kip Gov of Texas 19 Aug 56. Said Survey is No 125 in Coleman & Runnels County, situated on the water of Clearcreek, a tributary of Colorado river, about 27 miles N 85 W of Camp Colorado.

Beginning at the S. Cor of Sur. No 124 made for the E. T. R. Co. a stone mound from which W. Meropite 10 in dia br S 81 E 135 v. Thence West 1900 v. to the S. W. cor of said Survey No 124. Thence South 1900 v. a stone mound in the prairie Thence East cropping a branch 1900 v. a stone mound from which a Meropite 10 in dia br N 35 1/2 W 285 v. & a L. O. 5 in dia N 17 1/2 E 160 v. Thence North 1070 v. a branch 1900 v. to the place of beginning.

Boundaries marked by David Ligon

Surveyed 5 Nov 1871 Peter Lewis } Chain carriers

J. L. H. Lockett, Dep Surveyor, Travis Dist do hereby certify, that the foregoing survey was made according to law, and that the limits, boundaries and corners, with the marks, natural and artificial are truly described in the foregoing plat and field notes. J. L. H. Lockett

Dep. Surveyor Travis District.

J. P. Paer, Dist Surveyor Travis Dist, do hereby certify, that I have examined the foregoing plat and field notes and find them correct, and that they are recorded in my office in Book 2 page 147 Given under my hand at Austin this 22 day of Decr 1871

James P. Paer

District Surveyor Travis District.

The State of Texas)
 District of Travis) Survey No 34.

Field notes of a survey of 640 acres of land, made for Buffalo
 B B & P R Co, it being the quantity of land to which he is entitled
 by virtue of Land Scrip No 489, issued by W D Hodge Kip Com of Claims
 on 30 March 1861

Said Survey is No 34 in Coleman county, situated on the waters of
 Woods creek, a tributary of Colorado river, about 17 miles S 70 W of Camp
 Colorado. Beginning at a stake and S W cor of Sur No 33 made for
 B B & P R Co. from whence a Black Jack 10 in br S 3 1/2 W 30 or
 & a do S 29 E 27 or. Thence East with a line of No 33 - 1900 is a stone
 mound, from whence a P. O. 11 in dia br S 23 1/2 W 7 or & a do S 48
 W 35 or Thence South 1900 is a stone mound, from whence a
 Spr Oak br N 81 W 30 or & a S. O. br S 70 E 40 or. Thence West
 1900 is a corner Thence North 1900 is to the place of beginning.

Bearings marked X Jacob Lutz)
 Surveyed 20 June 1871 David Ligo) Chain Carrier.

I L H Lockett, Dep Sur. Travis Dist, do hereby certify, that the foregoing
 survey was made according to law, and that the limits, boundaries,
 and corners, with the marks, natural and artificial as truly
 described in the foregoing plat and field notes L H Lockett.

Dep Surveyor Travis District.

I J R Pace, Dist Surveyor Travis Dist, do hereby certify, that I
 have examined the foregoing plat and field notes and
 find them correct, and that they are recorded in my office
 in Book L page 34. Given under my hand at Austin this
 27 day of July 1871

JAMES R. PACE

District Surveyor Travis District.

The State of Texas,
 District of Travis) Survey No. 33.

Field Notes of a survey of 640 acres of Land, made for Duffek BB & CA Co
 is being the quantity of Land to which he is entitled by virtue of Land Grant
 No. 489, issued by W. J. Holch Kip, Gov. of Texas on 30th March 1860

Said Survey is No. 33 in Coleman County, situated on the waters of
 Hords creek, a tributary of Colorado river, about 17 miles S 45° W of Ft. Colorado.
 Beginning at a Stake 2090 or No. 1908 E from the N W cor of Burnett
 Co School Land, from whence a Black Jack 10 in to S 36° W 30 v.
 & do S 29 & 27 v. Thence East 1853 v a stone mound from whence
 a Black Jack 9 in dia br N 12 W br & a do 12 in S 33° W 30 v.
 Thence North 1950 v a stone mound on S line of N 68 for F
 Prangler, a S. O. 9 in to N 65° W 8 v & a do 9 in S 80° W 12 v.
 Thence West 1853 v to a cor. on E line of Spague Sur. No. 688
 Thence South 1950 v to the place of beginning

Boundaries marked X In Oct July
 Surveyed 20 June 1871 David Eigen } Chain Carrier.

I J. H. Luckell, Dep Surveyor Travis Dist, do hereby certify
 that the foregoing survey was made according to law,
 and that the limits, boundaries & corners, with the marks
 natural and artificial are truly described in the
 foregoing plat and field notes. J. H. Luckell

Dep Surveyor Travis District

I J. R. Pace, Dist Surveyor Travis Dist, do hereby certify
 that I have examined the foregoing plat and field notes
 and find them correct, and that they are recorded in
 my office in Book 9 page 33.

Given under my hand in Austin this 27 day of July 1871

James R. Pace
 District Surveyor Travis District.

The State of Texas }
 District of Travis } Survey No 35.

Field notes of a survey of 640 acres of Land, made for Buffalo
 P. B. & C. R. R. Co. it being the quantity of Land to which he is entitled
 by virtue of Land Scrip No 490, issued by W. L. Hoodkiss Com.
 of Claims on 30 March, 1860.

Said Survey is No 35 in Coleman County, situated on the waters
 of Herds Creek a tributary of Colorado river, about 18 miles S 75 W
 of Camp Colorado. Beginning at a stone mound and S. E.
 corner of Land No 34 made for the B. B. & C. R. R. Co. from whence a
 P. O. 14 in dia br N 81 W 30 or 2 a do S 70 E 40 or. Thence North 1900 or
 a stone mound on S line of No 36 a stone mound from whence
 a P. O. 11 in dia br, S 23 1/2 W 75 or 2 a do 12 in S 24 W 35 or. Thence
 East 1900 or a stake on S line of said No 36 from whence a P. O.
 12 in dia br N 9 E 35 or 2 a do 95 in N 32 E 40 or. Thence South
 crossing a branch 1900 or a stake from whence a P. O. 12 in in
 dia br S 19 E 10 or 2 a do 9 in S 61 1/2 E 8 or. Thence West 1900 or.
 to the place of beginning

Bearings marked X Jacob Lutz }
 Surveyed 187. David Ligon } Chain Carriers.

L. H. Luckell, Dep. Sur. Travis Dist, do hereby certify, that the
 foregoing survey was made according to law, and that the
 limits, boundaries and corners, with the marks, natural
 and artificial are truly described in the foregoing plat
 and field notes

L. H. Luckell

Dep. Surveyor Travis District

J. R. Pace, Dist. Surveyor, Travis Dist, do hereby certify, that I have
 examined the foregoing plat and field notes and find them
 correct, and that they are recorded in my office in Book
 L page 35. Given under my hand at Austin this 27 day of July
 1871

J. R. Pace

District Surveyor Travis District.

The State of Texas,
District of Travis } Survey No 36

Field Notes of a survey of 640 acres of Land, made for the Buffalo B B & C R Co. it being the Land, to which he is entitled by virtue of Land Scrip No 490, issued by W S Henshiff, Com of Claims on 30th March 1860.

Said Survey is No 36 in Polkman County, situated on the waters of Birch creek, a tributary of Colorado river, about 18 miles S 7 2 W of Camp Colorado.

Beginning at a stone mound, the S E cor of N 33 & 47 or W cor of the N W cor of N 35 both made for the B B & C R Co from whence a P. O. 11 in dia br S 23 1/2 W 70 or do 12 in S 48 or 35 or

Thence East 1947 or the N W cor of said 35 - 2325 or a stake from whence a P. O. 8 in dia br N 4 W 25 or @ a do 10 in N 25 or

Thence North 1486 or a stone mound on S line of N made for Richard Young. Thence West with S line of said N 674 @ N 680 for J Wilder 2006 or a stone mound a P. O. br S.

75 1/2 @ 66 or. Thence North 464 or to S E cor of N 681 made for T Gonzales to a stake. Thence West 319 or a stone mound

the N E cor of N 33 a P. O. br N 65 1/2 W 8 or @ a do S 80 1/2 W 12 or

Thence South with E line of N 33 - 1950 or to the place of beginning.

Bearings marked X Jacob Lutz }

Surveyed 1871 David Ligoan } Chain Carrier.

L H Luckett, Dep Surveyor, Travis Dist do hereby certify, that the foregoing survey was made according to law, and that the limits, boundaries and corners, with the marks, natural and artificial are truly described in the foregoing plat and field notes

L H Luckett

Dep Surveyor Travis District

J J Pace, Dist Surveyor, Travis Dist, do hereby certify, that I have examined the foregoing plat and field notes and find them correct, and that they are recorded in my office in Book 2 page 36 Given under my hand at Austin this 27 day of July, 1871

J J Pace

District Surveyor Travis District.

The State of Texas
 Historical of Travis Survey No. 39
 Field notes of a survey of 640 acres of Land, made for Buffalo B B & C R R Co.
 it being the quantity of Land, to which he is entitled by virtue of Land Scrip
 No. 493, issued by W. S. Holch Kipp, Com. of Claims on 30th March 1860
 Said Survey is No. 39 in Coleman county, situated on the waters of the
 Horns creek, a tributary of Colorado river, about 16 miles S 66 W of Sp
 Colorado. Beginning at a stone mound at E cor of Purnell Co.
 School Land, a P. O. 5 in dia br N 8 E 5 or 2 w 16 in S 62 W 5 or. Thence
 East with S line of No. 37, 457 or to its S E cor 1800 or a branch, 1900 or,
 a stone mound on S line of No. 38 made for B B & C R R Co. Thence
 South 400 or same br 1400 or a branch, 1900 or a stone mound a L. O.
 9 in br S 85 W 80 or & a c 12 in S 6 E 130 or. Thence West 1900 or a cor
 on the E line of Purnell Co School Land. Thence North with its
 E line 1900 or to the place of beginning

Bearings marked X. Jacob Lutz
 Surveyed 1871 David Lizon & Chas. Carrier.

I L. H. Luckett, Dep Surveyor Travis Dist, do hereby certify that
 the foregoing survey was made according to law, and that the
 limits, boundaries and corners, with the marks, natural
 and artificial, are truly described in the foregoing plat
 and field notes. L. H. Luckett

Dep Surveyor Travis District.

J. R. Pace, Dist. Surveyor Travis District, do hereby certify that
 I have examined the foregoing plat and field notes and find
 them correct, and that they are recorded in my office in
 Book 2 page 39.

Done under my hand at Austin, this 27 day of July 1871

James R. Pace
 District Surveyor, Travis District.

The State of Texas,
District of Travis } Survey No 40.

Field notes of a survey of 640 acres of Land, made for
P. B. & P. Co., it being the quantity of Land, to which he
is entitled by virtue of Land Scrip No 493, issued by W. S.
Hutchins, Com of Plains, on 30th March 1860.

Said survey is No 40, in Coleman County, situated
on the water of Horns creek, a tributary of Colorado
river, about 15 miles S 60 W of Camp Colorado.

Beginning at a stone mound, the N E cor of No 39,
on S line of No 38, both made for the P. B. & P. Co. Thence
South 400 w a branch 1400 w a branch 1900 w a stone
mound the S E cor of said No 39 a P. O. 9 in in dia br S
85 W 80 @ a d. 12 in S 60 E 130 w. Thence East 400 w a
branch 1900 w a stone mound a P. O. 3 in dia br S 35 E.
135 w @ a d. 20 in S 35 1/2 E 135 w. Thence North 820 w
a branch 1900 w a stone mound, a Mesquite 5 in dia
br S 41 1/2 E 80 w Thence West 1900 w to the place of beginning
Bearings marked X Jacob Lutz.

Surveyed 1871 David Ligon & Chas. Carrier.

J. H. Luckell, Dep Surveyor, Travis District do hereby certify
that the foregoing survey was made according to law,
and that the limits, boundaries and corners, with the
marks, natural and artificial are truly described in
the foregoing plat and field notes J. H. Luckell

Dep Surveyor Travis District
J. R. Pace, Dist Surveyor Travis Dist, do hereby certify
that I have examined the foregoing plat and field notes
and find them correct, and that they are recorded
in my office in Book 2 page 40.

Given under my hand at Austin, this 27 day of July
1871

James R. Pace
District Surveyor Travis District.

The State of Texas,
 District of Travis, Survey No 67.

Field notes of a survey of 640 acres of Land, made for Puffal
 P. B. & C. P. R. Co, it being the quantity of Land to which he is
 entitled by virtue of Land Scrip No 491 issued by W. S. Holchley
 Com of Claims on 30th March 1860

Said Survey is No 67 in Coleman County, situated on the
 western Branch a tributary of Colorado river, about 24 1/2
 miles S 76° W of Camp Colorado.

Beginning at a stake, the N.W. cor of No 66 made for
 the P. B. & C. P. R. Co from whence a S. P. 20 in dia br. N 73 1/2
 W 68 or a S. O. 12 in S 18 W 35 or. Thence South with the West line
 of No 66 1900 or a stake, from whence a Mesquite 4 in dia
 br S 4 1/2 E 25 or a wd 5 in S 52 1/2 E 55 or. Thence West 1900 or
 a stone mound from whence a larger stone mound on top
 of a Mt. known as Pilot Knob. br S 79 1/2 E about 500 or.
 Thence North 1230 or a branch, 1900 or a stone mound from
 whence a S. O. 15 in dia br N 67 W 120 or a do 14 in N 67 1/2
 W 122 or. Thence East 1900 or to the place of beginning.

Bearings marked X Jacob Lutz
 Surveyed 3 June 1871 David Ligon } Chain Carrier

J. H. Luckell, Dep Surveyor Travis Dist. do hereby certify
 that the foregoing survey was made according to law
 and that the limits, boundaries and corners, with the marks
 natural and artificial are truly described in the
 foregoing plat and field notes J. H. Luckell

Dep Surveyor Travis District

J. R. Paer, Dist Surveyor Travis Dist. do hereby certify
 that I have examined the foregoing plat and field notes
 and find them correct, and that they are recorded in
 my office in Book 2 page 63.

Given under my hand, at Austin this 27 day of July 1871

James R. Paer,
 District Surveyor Travis District.

The State of Texas,
 District of Travis, Survey No 68.

Field notes of a survey of 640 acres of Land, made for P. B. Beal & Co. it being the quantity of Land to which he is entitled by virtue of Land Scrip No 491, issued by W. S. Holch Kip, Gov of Texas on 30th March 1860.

Said Survey is No 68 in Coleman County, situated on the water of Branch a tributary of Camp Colorado river about 26 miles S 70 W of Camp Colorado.

Beginning at a stake 482¹/₂ E of the N E cor of No 67 on the N line of No 66 both made for the P. B. Beal & Co. and S W cor of W. G. Morgan Sur No 309 from whence a L. O. brs N 87¹/₂ E 100¹/₂ rods N 71¹/₄ E 85¹/₂ Thence North with the West line of said No 309 - 2288¹/₂ a corner

Thence West 793¹/₂ to the N E cor of No 310 made for T. Owen a stake & mound. Thence South 1344¹/₂ to the S E cor of said No 310 a L. O. brs N 3 E 48¹/₂ rods.

Thence West passing the S W cor of said No 310. 1908¹/₂ a stone mound. Thence South 944¹/₂ a corner Thence East 317¹/₂ N W cor of No 67 with N line of same 2699¹/₂ to the place of beginning

Bearings marked X Jacob Lutz

Surveyed 13th June 1871 David Sigow, Chain Carrier

J. H. Luckett, Dep Surveyor Travis Dist, do hereby certify that the foregoing survey was made according to law and that the limits, boundaries and corners, with the marks, natural and artificial are truly described in the foregoing plat and field notes J. H. Luckett correction of 27 Decr 1871 Dep Surveyor Travis District

J. R. Pace Dist Surveyor Travis Dist, do hereby certify that I have examined the foregoing plat and field notes and find them correct, and that they are recorded in my office in Book 2 page 64 Given under my hand at Austin this 27th day of July 1871

James R. Pace
 District Surveyor Travis District

The State of Texas }
 District of Travis } Survey No 78

Field notes of a survey of 640 acres of Land, made for
 Houston T & B R R Co, it being the quantity of Land, to which
 he is entitled by virtue of Land Scrip No 51155 issued by Joseph
 Lee, Com of Placens on 30th Aug. 1859.

Said Survey is No 78 in Coleman County, situated on
 the water of Jim Ned creek, a tributary of Colorado river
 about 14 miles S 75 W of Camp Colorado.

Beginning at a stone mound on N E cor of sur No 77 made
 for Houston T & B R R Co. on E cor of N. 40 a Merquits 5 in br
 S 41 1/2 E 900. Thence North 19000. a stone mound a Merquits
 9 in br N 71 1/2 E 1000. Thence East 19500 a stake in the
 prairie Thence North 19000 to the N E cor of sur No 77.
 Thence West 19000 to the place of beginning.

Bearings marked X Jacob Lutz }

Surveyed 5 July 1871 David Ligon } Chain Carrier
 J. H. Luckett, Dep Surveyor Travis Dist, do hereby certify
 that the foregoing survey was made according to law,
 and that the limits, boundaries and corners, with the
 marks, natural and artificial are truly described
 in the foregoing plat & field notes J. H. Luckett

Dep Surveyor Travis District.

J. R. Pacl Dist Surveyor Travis Dist, do hereby certify
 that I have examined the foregoing plat & field
 notes and find them correct and that they are
 recorded in Book 2 page 74

Given under my hand at Austin this 27 day of
 July 1871

James R Pacl
 District Surveyor Travis District.

The State of Texas
 District of Travis } Survey No 77
 Field Notes of a survey of 640 acres of Land, made for
 Houston T. R. R. Co. it being the quantity of Land, to which
 he is entitled by virtue of Land Scrip N 5/155 issued by
 Joseph Lee, Com of Claims on 30 Aug. 1859.

Said Survey is N 77 in Coleman County, situated
 on the western of Home creek, a tributary of Colorado
 river about 13 miles S 70 W of Camp Colorado.

Beginning at a stone mound S E cor of Sur. No 40.
 made for B B B & C R R Co. a L. O. 30 in dia br. S 36 1/2
 E 125 or a do 20 in S 35 1/2 E 135 or. Thence North 82 W
 a branch 1900 or to N E cor of said N 40 a stone
 mound, a Mesquite 5 in S 41 1/2 E 90 or. Thence East
 1900 or a stake in the prairie Thence South 1900 or
 a stake in prairie. Thence West 1900 or to the
 place of beginning.

Bearings marked X Jacob Lutz
 Surveyed July 5 1871 David Ligon } Chain Carrier.
 J. H. Luckett, Dep Surveyor Travis Dist, do hereby certify
 that the foregoing survey was made according to
 law, and that the limits, boundaries and corners
 with the marks, natural and artificial are
 truly described in the foregoing plat & field notes
 J. H. Luckett.

Dep Surveyor Travis District.

I James R. Paer, District Surveyor Travis Dist. do hereby certify, that I have examined the foregoing
 plat and field notes and find them correct and
 that they are recorded in my office in Book 2
 page 73 Given under my hand at Austin
 this 27th day of July 1871

James R. Paer
 District Surveyor Travis District

The State of Texas }
 District of Travis } Survey No. 69.

Field notes of a Survey of 640 acres of Land, made for Texas
 & N.O. R.R. Co, it being the quantity of Land, to which he is
 entitled by virtue of Land Scrip No 920. issued by W.S. Haddock,
 Com of Claims on 13th Feby 1861.

Said Survey is No 69 in Runnels Co, situated on the waters
 of Rock Creek, a tributary of Colorado river, about 15 1/2 miles
 S 20 E of Table Mountain

Beginning at a Stone mound the S.W. cor of F Owen
 N 310 Thence North 40 or a branch 5600 or Camp Colorado
 & Chadburns road 1900 or a Stone mound a Mesquite 4 in
 diam N 50 W 50 or. Thence West 1900 or a stake in
 prairie Thence South 1900 or a stake in prairie
 Thence East crossing a branch 1900 or to the place of beginning
 Bearings marked X Jacob Lutz }

Surveyed June 1871 David Lygon } Chain Carrier.

L. H. Luckett, Dep Sur Travis Dist, do hereby certify that
 the foregoing survey was made according to law, and
 that the limits, boundaries and corners, with the
 marks, natural and artificial are truly described
 in the foregoing plat and field notes L. H. Luckett
 Dep Surveyor Travis District.

J. R. Pace, Dist Sur Travis Dist, do hereby certify that I
 have examined the foregoing plat and field notes
 and find them correct, and that they are recorded
 in my office in Book 2 page 65

Given under my hand at Austin this 27th day of July 1871

James R. Pace

District Surveyor Travis District

The State of Texas }
 District of Travis } Survey No 70
 Field notes of a Survey of 640 acres of Land, made for
 Texas & O. R.R Co it being the quantity of Land, to which
 he is entitled by virtue of Land Scrip No 920 issued
 by W. S. Hatch King Com of Claims on 3rd Feb'y 1861
 Said Survey is No 70 in Runnels County, situated
 on the waters of Keehey a tributary of Colorado
 river, about 15 1/2 miles S 18 E of Table Mountain
 Beginning at a Stone mound the N E cor of No 69
 made for Texas & O. R.R Co. Thence North 1900 or a stake
 in the prairies Thence West 1900 or a stake in the
 prairies Thence South 1900 or a stake in the prairies
 & S W cor of said No 69. Thence East 1900 or with
 N line of No 69 to the place of beginning.

Bearing marked by Jacob Lutz
 Surveyed. David Ligon & Chain Carrier

J. L. Luckell, Dep Sur Travis Dist, do hereby certify
 that the foregoing Survey was made according to law
 and that the limits, boundaries and corners, with
 the marks, natural and artificial are truly
 described in the foregoing plat and field notes
 J. L. Luckell

Dep Surveyor Travis District.
 J. R. Pace, Dist Surveyor, Travis Dist do hereby
 certify, that I have examined the foregoing
 plat and field notes and find them correct
 and that they are recorded in my office in Book
 L page 16. Given under my hand at Austin this
 27 day of July 1871 James R Pace
 District Surveyor Travis District.

The State of Texas }
 District of Travis } Survey N 87

Field Notes of a Survey of 640 acres of Land, made for C. S. R. Co. it being the quantity of Land, to which he is entitled by virtue of Land Scrip No 117, issued by W. S. Cook, Secy, Com. of Texas on 19th Aug. 1861

Said Survey is N 87 in Coleman County, situated on the westerly bank of Stone Creek, a tributary of Colorado river, about 22 1/2 miles S 24 W of Cap. Colorado.

Beginning at a stake N W cor of Sur. No 86 made for C. S. R. Co. from which a L. O. in dia. br. N 6 E 3000 s. & w. d. 10 N 114 E 3000 s. Thence South with the W line of N 86, made for C. S. R. Co. 1900 s. a stone mound. Thence West 1900 s. a stone mound, Thence North 130 s. a branch S W 1900 s. a stone mound at L. O. br. N 6 1/2 E 4000 s. Thence East 1650 s. a branch (S W) 1900 s. to the place of beginning.

Bearings marked by David Ligon

Surveyed 29 Oct 1871 Peter Lewis & Chauncy Carrien.

L. H. Luckett, Dep. Sur. Travis Dist, do hereby certify, that the foregoing Sur. was made according to law, and that the limits, boundaries & corners with the marks, natural & artificial are truly described in the foregoing plat and field notes. L. H. Luckett

Dep. Surveyor Travis District

J. P. Pace, Dist. Surveyor Travis Dist, do hereby certify, that I have examined the foregoing plat and field notes and find them correct, and that they are recorded in my office in Book 2 page 125. Given under my hand at Austin, this 21 day of Decr 1871

James P. Pace

District Surveyor Travis District

The State of Texas
 District of Travis } Survey No. 88.

Field Notes of a Survey of 145 acres of Land, made for E. F. R. Co. it being the quantity of Land, to which he is entitled by virtue of Land Scrip No. 117 issued by W. S. Holchlip, Com of Plains on 9 Aug 1861. Said Survey is No. 88 in Coleman County, situated on the waters of Home creek, a tributary of Colorado river, about 22 miles S 25 W of Camp Colorado. Beginning at a stake mound @ N W cor of Sur No. 87, made for the E. F. R. Co. from which a L. O. br N 62 $\frac{1}{2}$ E 400 $\frac{1}{2}$. Thence North 1900 $\frac{1}{2}$ a stone mound from which a L. O. 13 in dia br N 65 E 35 $\frac{1}{2}$ a do Thence East 1900 $\frac{1}{2}$ a stone mound. Thence South, crossing a branch (SW) 1900 $\frac{1}{2}$ a stake from which a L. O. 27 in dia br N 6 E 300 $\frac{1}{2}$ a do 10 in dia br N 1 $\frac{1}{4}$ E 300 $\frac{1}{2}$ the N E cor of No. 87 - 240 $\frac{1}{2}$ a branch 1900 $\frac{1}{2}$ to the place of beginning. Bearings marked X. David Sigow }
 Surveyed 1 Nov 1871 Peter Lewis } Chain carriers.

L. H. Luckett, Dep. Sur. Travis Dist, do hereby certify, that the foregoing survey was made according to law, and that the limits, boundaries and corners, with the marks, natural and artificial are truly described in the foregoing plat and field notes. L. H. Luckett

Dep. Surveyor Travis District
 J. P. Paer, Dist. Surveyor Travis Dist, do hereby certify that I have examined the foregoing plat & field notes and find them correct, and that they are recorded in my office in Book 2 page 125.

Given under my hand at Austin this 21 day of Decr 1871

James P. Paer
 District Surveyor Travis District.

The State of Texas }
 District of Travis } Survey No 99.

Field Notes of a survey of 640 acres of Land made for C. S. R. R. Co. it being the quantity of Land to which he is entitled by virtue of Land Scrip No 122 issued by W. S. Holchkip Com of Claims on 19th Aug 1861. Said Survey is No 99 in Coleman County, situated on the waters of Home Creek, a tributary of Colorado river, about 16 1/2 miles S 23 W of Camp Colorado.

Beginning at a stake from which a Mesquite 10 in dia to S 45 W 200000 and S 2 1/2 W 250000 the N E cor of Sur No 98 made for C. S. R. R. Co. Thence North 190000 to a stone mound in the head of a hollow (course N) and E 1/4 8 in N 14 E 335000.

Thence West 174000 to a brand (N) 190000 to a stone mound from which a Mesquite 10 in dia N 7 1/2 E 500000 and S 12 in S 89 E 800000. Thence South 190000 to the N W cor of said No 98.

Thence East with the N line of said No 98, 190000 to the place of beginning.

Bearings marked by David Sigou }
 Surveyed 2 Nov 1871 Peter Lewis } Chain Carrier.

J. R. Pace, Dist. Surveyor Travis Dist, do hereby certify that I have examined the foregoing plat and field notes and find them correct and that they are recorded in my office in Book 3 page 137 Given under my hand this 21 day of Decr 1871 James R. Pace

District Surveyor Travis District }
 J. L. Luckell, Dep Surveyor Travis Dist, do hereby certify that the foregoing survey was made according to law and that the limits, boundaries and corners, with the marks, natural and artificial are truly described in the foregoing plat and field notes. J. L. Luckell Deputy Surveyor Travis District.

The State of Texas
 District of Travis, Survey No 100.

Field Notes of a survey of 640 acres of Land, made for Eastern T. R. R. Co., it being the quantity of Land, to which he is entitled by virtue of Land Scrip No 122, issued by W. S. Holchek, Com of Claims, on 19th August 1861

Said Survey is No 100 in Coleman County, situated on the waters of Home creek, a tributary of Colorado river, about $1\frac{1}{2}$ miles S $2\frac{1}{4}$ W of Lamp Colorado.

Beginning at the S W cor of Sur No 99. & N W cor of No 98 both made for the E T R R Co. Thence North with N line of No 99, 1900 vs a stone mound, from which a Mesquite 10 in dia brs N 70 E 50 vs & a Mesquite 12 in S 89 E 80 vs. Thence West 1400 vs a branch (N) 1900 vs a stone mound from which a Mesquite 12 in dia brs S 30 W 130 vs & a do 12 in S 81 $\frac{1}{4}$ W 130 vs. Thence South 1900 vs to the N W cor of No 101. Thence East with N line of No 101, 1900 vs to the place of beginning

Bearings marked X David Ligon
 Surveyed 2 Nov 1871 Peter Lewis, Chain Carrier.

I L. H. Lockett, Dep Surveyor, Travis Dist, do hereby certify that the foregoing survey was made according to law, and that the limits, boundaries and corners, with the marks, natural and artificial are truly described in the foregoing plat and field note. L. H. Lockett

Dep Surveyor Travis District.

I J. P. Pace, Dist Surveyor, Travis Dist, do hereby certify that I have examined the foregoing plat and field notes and find them correct, and that they are recorded in my office in Book 2 page 138

Given under my hand, at Austin, this 21 day of Decr 1871

James P. Pace

District Surveyor, Travis District

The State of Texas
 District of Travis } Survey N^o 104

Field Notes of a survey of 640 acres of Land, made for E. J. R. Co., it being the quantity of Land, to which he is entitled by virtue of Land Scrip N^o 123, issued by W. H. Colch Kip, Comr of Claims, on 19th Aug 1861. Said Survey is N^o 104 in Coleman County, situated on the waters of Home creek, a tributary of Colorado river, about 18 1/2 miles S 28 W of Camp Colorado.

Beginning at the S W cor of Sur N^o 101 & N. E. cor of N^o 103, both made for E. J. R. Co. at Stone mound, from which a Mesquite 12 in dia brs S 38 3/4 E 1200 v. Thence North 1900 v to the N W cor of said N^o 101. Thence West 1900 v to the S W cor of N^o 103. Thence South 1900 v to the N W cor of N^o 103, at Stone mound from which a Mesquite 10 in dia brs S 4 1/4 W 1000 v. Thence West with N line of N^o 103 - 1900 v to the place of beginning.

Bearings marked X David Ligon
 Surveyed 2 Nov 1871 Peter Lewis } Chain Carriers.

S. L. H. Lockett, Dep Surveyor, Travis Dist, do hereby certify, that the foregoing Survey was made according to law, and that the limits, boundaries and corners, with the marks, natural and artificial are truly described in the foregoing plat and field notes

L. H. Lockett

Dep Surveyor Travis District

S. J. R. Pace, Dist. Surveyor Travis Dist, do hereby certify, that I have examined the foregoing plat and field notes and find them correct, and that they are recorded in my office, in Book I page 141

Given under my hand, at Austin, this 21 day of Decr 1871

James R. Pace

District Surveyor Travis District

The State of Texas,
District of Travis, Survey No. 103.

Field Notes of a survey of 640 acres of Land, made for C. T. R. Co. it being the quantity of Land, to which, C. T. R. Co. is entitled by virtue of Land Scrip No. 123, issued by W. S. Hotchkiss, Com. of Claims on 19th August 1861.

Said Survey is No. 103 in Coleman County, situated on the waters of Home creek, a tributary of Colorado river, about 20 miles S 27 W of Camp Colorado.

Beginning at the SW cor of Sur No. 102 made for C. T. R. Co. at stone mound from which a Mesquite br S $71\frac{1}{2}$ E 50 vs.

Thence West 1900 vs a stake from which a Mesquite hindia br S 30 W 140 vs a d. 10 in N 31 E 110 vs. Thence North 240 vs a branch (SW) 1900 vs a stone mound, a Mesquit 10 in dia br S $64\frac{1}{2}$ W 100 vs Thence East with the line of No. 104 made for C. T. R. Co. 1900 vs a stone mound, from which a Mesquit 12 in dia br S $43\frac{3}{4}$ W 60 vs a d. 12 in S $38\frac{1}{4}$ E 120 vs.

Thence South with W line of No. 102, 1900 vs to the place of beginning.

Bearings marked X David Ligon
Surveyed 1 Novr 1871 Peter Lewis Chain Carriers

S. L. H. Lockett, Dep Surveyor Travis Dist, do hereby certify that the foregoing survey was made according to law, and that the limits, boundaries and corners, with the marks, natural and artificial, are truly described in the foregoing plat and field notes

L. H. Lockett
Dep. Surveyor, Travis District

S. J. R. Pace, Dist Surveyor, Travis Dist, do hereby certify, that I have examined the foregoing plat and field notes and find them correct, and that they are recorded in my office in Book I, page 141

Given under my hand in Austin this 21 day of Decr 1871

James R. Pace
District Surveyor Travis District.

The State of Texas,
District of Travis, Survey No 91

Field Notes of a survey of 640 acres of Land, made for E. S. R. Co. it being the quantity of Land to which he is entitled by virtue of Land Scrip No 126, issued by W. S. Hotchkiss, Com of Claims on 19th of August 1861

Said Survey is No 91 in Coleman County, situated on the waters of Home creek, a tributary of Colorado river, about 18 miles S 13 W of Camp Colorado.

Beginning at a stone mound N W cor of Sur No 280 made for Wm Shirlock & Co cor of No 96 made for E. S. R. Co. from which a L. 40 in dia brs N 6 3/4 E 6000. Thence North with W line of No 279 made for W Farris, crossing a branch (E) 1900 or a stone mound, a 999 feet 14 in dia brs S 31 3/4 E 89 or a do 12 in S 36 3/4 E 920. Thence West 1900 or a stake from which a L. 12 in dia brs S 5 W 180 or a do Mesquits 10 N 2 1/4 E 1800 Thence South crossing a branch 1900 or a stone mound on W line of Sur No 85 made for said E. S. R. Co. a L. 10 in dia brs S 78 E 800 or a do 12 in S 69 1/2 W 1000. Thence East 1900 or to the place of beginning

Bearings marked X David Ligoon
Surveyor 1 Nov 1871 Peter Lewis & Chain Carrier
J. H. Lockett, Dep Surveyor Travis Dist, do hereby certify that the foregoing survey, was made according to law, and that the limits, boundaries and corners, with the marks, natural and artificial are truly described in the foregoing plat and field notes J. H. Lockett

Dep Surveyor Travis District
S. J. R. Pace, Dist Surveyor Travis Dist, do hereby certify that I have examined the foregoing plat and field notes and find them correct, and that they are recorded in my office in Book I, page 129.

Given under my hand at Austin this 21 day of Decr 1871

Dist Surveyor Travis District

The State of Texas,
 District of Travis } Survey N^o 92

Field notes of a survey of 640 acres of Land, made for E. F. R. Co.
 it being the quantity of Land, to which he is entitled by virtue
 of Land Scrip N^o 121, issued by W. S. Holch Kip, Com of Claims
 on 19th Aug 1861

Said Survey is N^o 92, in Coleman County, situated on the
 waters of Home creek, a tributary of Colorado river, about
 17 miles S 15 W of Camp Colorado.

Beginning at a stone mound N^o E cor of Sur N^o 91, made
 for E. F. R. Co. from which a Mesquite 14 in dia br S 31³/₄ E 84⁰
 and a cu 12 in S 36³/₄ E 92⁰ v. Thence West with N line of said
 N^o 91 - 1948⁰ v a stake from which a L. O. 12 in dia br N 8³/₄
 E 180⁰ v a Mesquite 10 in N 11³/₄ E 23⁰ v. Thence North
 1856⁰ v to a cor on the S line of Sur N^o 276 made for James
 West. Thence East crossing Home creek twice 1948⁰ v to
 S E cor of Sur N^o 277 for Abraham Mace on W line of N
 279. for W Tarris. Thence South with W line of said
 N 279 - 1856⁰ v to the place of beginning
 Bearings marked X David Ligon

Surveyed 1 Nov 1871 Peter Lewis } Chain carrier

I L. H. Luckett, Dep Surveyor Travis Dist, do hereby certify
 that the foregoing survey was made according to law,
 and that the limits, boundaries and corners, with the
 marks, natural and artificial are truly described
 in the foregoing plat and field notes L. H. Luckett

Dep Surveyor Travis District

I James R. Pacer, Dist Surveyor Travis Dist, do hereby
 certify, that I have examined the foregoing plat and field
 notes and find them correct, and that they are recorded
 in my office in Book L page 130

Given under my hand at Austin this 21st day of Dec
 1871

James R. Pacer

District Surveyor Travis District

The State of Texas }
 District of Travis } Survey N^o 86

Field Notes of a survey of 640 acres of Land, made for C. S. R. R. Co. it being the quantity of Land, to which he is entitled by virtue of Land Scrip N^o 116, issued by W. S. Hotchkiss, Comr of Claims on 9 Aug 1861.

Said Survey is N^o 86, in Coleman County, situated on the waters of Home creek, a tributary of Colorado river, about 22 miles S 22 W of Camp Colorado.

Beginning at a stake and N W cor of sur N 85 for the C. S. R. R. Co. from which a L. O. 16 in dia brs S 20 1/2 W 400 vs a do 1/2 in N 25 1/2 W 500.

Thence South crossing a branch & with the W line of said N 85.

for C. S. R. R. Co. 1900 is a stone mound, from which a L. O. 12 in S 78 1/2 W 300 vs a do 1/2 in S 73 1/2 W 310 vs. Thence West 1900 is a stone mound.

Thence North 1900 is a stake from which a L. O. 2 1/4 in dia brs N 6 E 300 vs a do 10 in N 7 3/4 E 300 vs Thence East 1830 is a branch

(S.E.) 1900 is to the place of beginning.

Bearings marked X David Zigou }

Surveyed 29 Oct 1871 Peter Lewis } Chain Carrier.

I L. H. Lockett, Dep Surveyor Travis Dist, do hereby certify, that the foregoing survey was made according to law, and that the limits, boundaries and corners, with the marks, natural & artificial are truly described in the foregoing plat and field note.

L. H. Lockett

Dep Surveyor Travis District

I. J. R. Pace, Dist Surveyor Travis Dist, do hereby certify, that I have examined the foregoing plat and field notes and find them correct, and that they are recorded in my office in Austin in Book L, page 124.

Given under my hand, at Austin, this 21 day of Decr 1871

James R. Pace

District Surveyor Travis District

The State of Texas,
District of Travis } Survey No. 85

Field notes of a survey of 640 acres of Land, made for C. S. R. R. Co. it being the quantity of Land, to which he is entitled by virtue of Land Scrip No. 116, issued by W. S. Scotchkief, Com of Claims on 19 Aug 1861. Said Survey is No. 85 in Coleman County, situated on the waters of Home creek, a tributary of Colorado river, about 22 miles S 19 W of Camp Colorado.

Beginning at a stake and N W cor of No. 83, made for C. S. R. R. Co. from which a P. O. 25 in dia brs S 22 1/2 W 200 is & a do 25 in S 10 W 200 is.

Thence South with the W line of said No. 83, made for C. S. R. R. Co. 1900 is a stone mound from which a P. O. 12 in dia brs N 6 1/2 W 18 is & a do 14 in S. 30 E 60 is.

Thence West 810 is a branch (S) 1900 is a stone mound, a P. O. 12 in dia brs S 78 1/2 W 300 is & a do 12 in S 73 1/2 W 310 is.

Thence North crossing a branch (S E) 1900 is a stake, a P. O. 16 in dia brs S 20 1/2 W 40 is & a do 12 in N 25 1/2 W 25 is.

Thence East 1490 is a branch (S) 1900 is to the place of beginning.

Bearings are as marked David Sigow }

Surveyed 29 Oct 1871 Peter Lewis } Chain Carriers.

I L H Lockett, Dep Surveyor Travis Dist. do hereby certify that the foregoing survey was made according to law, and that the limits, boundaries and corners, with the marks, natural and artificial are truly described in the foregoing plat & field notes.

L H Lockett

Dep Surveyor Travis District.

I J R Paer, Dist Surveyor Travis Dist. do hereby certify, that I have examined the foregoing plat and field notes and find them correct, and that they are recorded in my office in Book L, page 123.

Given under my hand at Austin this 21st day of Decr 1871

James R Paer

District Surveyor Travis District.

The State of Texas)
 District of Travis) Survey N^o. 105

Field Notes of a survey of 640 acres of Land, made for C. S. R. R. Co.,
 it being the Land to which it is entitled by virtue of Land Scrip N^o. 127
 issued by W. S. Holchkip, Com of Claims, on 19th Aug 1871

Said Survey is N^o. 105 in Coleman County, situated on the waters of
 Horns creek, tributary of Colorado river, about 18 miles S 30 W of Cap Colorado

Beginning at the N E cor of sur. N^o. 104 & S W cor of sur. N^o. 100, both
 made for the C. S. R. R. Co. Thence North 19000 to the N W cor of said
 N^o. 100, a stone mound from which a Mesquite 12 in dia brs S 30 W 1300
 and a do 12 in S 81 1/4 W 1300. Thence West 8000 to a branch (X)
 19000 a stone mound, from which a Mesquite 12 in brs S 60 3/4 W 1800
 & a do 9 S 55 1/2 W 2000. Thence South 19000 to the S W cor
 of said N^o. 104. Thence East with the N line of said N^o. 104
 19000 to the place of beginning

Bearings marked X David Ligon

Surveyed 2^d Nov 1871 Peter Lewis } Chain carriers.

L. S. Luckett Dep Surveyor Travis Dist. do hereby certify, that the
 foregoing survey was made according to law, and that the limits,
 boundaries and corners, with the marks, natural and artificial
 are truly described in the foregoing plat and field notes

L. S. Luckett.

Dep Surveyor Travis District

J. R. Paer, Dist. Surveyor Travis Dist, do hereby certify, that I
 have examined the foregoing plat and field notes and find them
 correct, and that they are recorded in my office, in Book 2 pag
 #43. Given under my hand at Austin, this 22^d day of Dec 1871

James R. Paer

District Surveyor Travis District

The State of Texas,
District of Travis, Survey No 106.

Field Notes of a survey of 640 acres of Land, made for C. T. R. Co.
it being the quantity of Land, to which he is entitled by virtue of
Land Scrip No 127, issued by W. S. Hoatchkip, Com of Claims 19 Aug, 1871
Said Survey is No 106 in Coleman County, situated on the waters
of Home creek, a tributary of Colorado river, about 16 miles S 31 W of
Camp Colorado

Beginning at the N E cor of Sur No 105 made for C. T. R. Co.
a stone mound, from which a Mesquite 12 in dia brs S 30 W 130 or a do
12 in S 81 1/4 W 130 or. Thence North 1900 or a corner.

Thence West crossing a branch 1900 or a corner. Thence South
1900 or to the N W cor of said No 105 a stone mound from which
a Mesquite 12 in dia brs S 60 3/4 W 180 or a Mesquite 9 in brs S 55 1/2
W 200 or. Thence East with N line of said No 105 - 1900 or
to the place of beginning

Bearings marked X David Ligoor
Surveyed 2^d Nov 1871 Peter Lewis 1 Chain Carriers.
S. L. H. Luckett, Dep Surveyor Travis Dist. do hereby certify, that
the foregoing survey was made according to law, and that the
limits, boundaries and corners, with the marks, natural and
artificial, are truly described in the foregoing plat and field notes
S. L. H. Luckett.

Dep Surveyor, Travis District.

S. J. R. Pace, Dist. Surveyor Travis Dist. do hereby certify, that
I have examined the foregoing plat and field notes and find them
correct, and that they are recorded in my office in book 2, page 144
Given under my hand at Austin, this 22 day of Dec 1871

James R. Pace
District Surveyor Travis District

The State of Texas,
 District of Travis, Survey No. 95.
 Field Notes of a survey of 640 acres of Land, made for E. S. P. Co. it
 being the quantity of Land to which he is entitled by order of Land
 Scrip No 125, issued by W. S. Holchkip, Com. of Claims on 19th Aug 1861
 Said Survey is No. 95 in Coleman County, situated on the waters of
 Home creek, a tributary of Colorado river, about 19 miles S 17 W of Camp
 Colorado.

So beginning at the N. W. cor of Sur. No. 96, made for E. S. P. Co.
 thence South with the W. line of said No. 96 - 1344 or to the N. E. cor
 of Sur. No. 337 for R. Wilson, a stake from which a L. P. in clump of
 3 brs S $77\frac{1}{2}$ W 136 or a Mesquite 10 in N 37 W 280 or.

Thence West 1355 or a corner, the N. W. cor of said No. 337 for Rob.
 Wilson. Thence South 284 or a stake Thence West 1101 or
 a stake. Thence North, 162 or a stone mound, from which a
 L. P. in dia brs S 33 W 120 or. Thence East 245 brs to the place
 of beginning.

Bearings marked X David Ligo
 Surveyed 1st Nov 1871 Peter Lewis } Chain Carriers.

J. L. Luckett Dep Surveyor Travis Dist. do hereby certify, that the
 foregoing survey was made according to law, and that the limits,
 boundaries and corners, with the marks, natural and artificial
 are truly described in the foregoing plat and field notes.

J. L. Luckett.

Dep Surveyor Travis District

J. P. Pace, Dist Surveyor Travis Dist. do hereby certify, that I
 have examined the foregoing plat and field notes and
 find them correct, and that they are recorded in my office
 in Book 2 page 133.

Given under my hand, at Austin, this 21 day of Decr 1871.

James P. Pace
 District Surveyor Travis District.

The State of Texas,
 District of Travis, Survey No. 96.

Field notes of a survey of 640 acres of Land, made for E. F. R. Co. it being the quantity of Land, to which he is entitled by virtue of Land Scrip No. 125, issued by W. S. Holch Kip, Com of Claims on 19th Aug 1861. Said Survey is No. 96 in Coleman County, situated on the waters of Stonecreek, a tributary of Colorado river, about 19 miles S 14 W of Cp Colorado. Beginning at a stone mound @ N W cor of W Skirlocks Sur No. 280, from which a L. O. 40 in dia brs of 6 3/4 in marked X, an old bearing - the other could not find.

Thence South with W line of said No. 280 - 2688 or a stone mound
 Thence West 1344 or a stake from which a L. O. 12 in dia brs No. 88 & 52 or
 and a do 10 in S 81 & 55 or.

Thence North with the line of Rob Wilson sur. 2688 or a cor
 Thence East 1344 or to the place of beginning.

Bearings marked X David Ligon,
 Surveyed 1 Nov 1871 Peter Lewis } Chain carriers.

I L. H. Luckett, Dep Surveyor Travis Dist, do hereby certify, that the foregoing survey was made according to law, and that the limits, boundaries and corners, with the marks, natural and artificial are truly described in the foregoing plat and field notes

L. H. Luckett,

Dep Surveyor Travis District.

I J. R. Pace, Dist Surveyor Travis District, do hereby certify that I have examined the foregoing plat and field notes, and find them correct, and that they are recorded in my office in Book 2 page 134.

Given under my hand at Austin, this 21 day of Decr 1871

James R. Pace

District Surveyor Travis District

