

SHELF 5

PLATS OF THE RESURVEY
OF
CLARK'S TEXAS NEW MEXICO BOUNDARY
BY THE
U. S. BOUNDARY COMMISSION
1911

8



R. B. STANFORD
SECRETARY OF STATE

Department of State
State of Texas
Austin, Texas

June 9th
Texas Centennial Year

1072
M. E. SANDLIN
ASSISTANT SECRETARY OF STATE
D. LEON HARP
SECURITIES COMMISSIONER
W. C. CASON
HEAD OF FRANCHISE TAX DEPARTMENT
W. W. HALCOMB
HEAD OF EXECUTIVE DEPARTMENT
LLOYD ARMSTRONG
HEAD OF CHARTER DIVISION

Hon. J. H. Walker
Land Commissioner
General Land Office
Austin, Texas

Attention Mr. C. F. Blucher

Dear Sir:

We are transmitting to you copies of the field notes, plats and other information, relative to the retracement of the Texas-Oklahoma boundary. These papers were received in my office from the United States Department of the Interior and we believe they should be filed for permanent record in your office.

Additional material on the same subject was filed in this office by Governor Pat M. Neff, July 31, 1924. We are also transmitting these papers to you for permanent record.

Yours respectfully

R. B. Stanford
R. B. Stanford
Secretary of State.

encl
cml

RECEIVED

JUN 9 1936

REFERRED TO MAP

6-12-36

*Acknowledged
6-11-36
C.F. Blucher*

June 12, 1936

Hon. R. B. Stanford,
Secretary of State,
Austin, Texas

Dear Sir:

I wish to thank you for your letter of June 9th in connection with copies of field notes, plats and other information relative to the retracement of the Texas-Oklahoma boundary. These papers were received in this office from the General Land Office, U. S. Department of Interior. There are also certain maps showing part of this same State boundary line, which were filed in this office by Governor Pat M. Neff, on July 31, 1924. I am very glad to get this information, as it gives boundary data which we have occasion to use ever-once-in-awhile.

The error of the General Land Office occurs thru the fact that the Secretary of State's office in most of the other States is the depository or office of record for such information. Texas, on the other hand, retained her own lands when she entered the Union, and has her own Land Office, where such papers are now properly filed.

Let me thank you again for the courtesies extended.

Very truly yours,

Commissioner

Blucher:eb

PLATS
OF THE
RESURVEY OF
CLARK'S
TEXAS-NEW MEXICO
BOUNDARY LINES

BY THE
U.S. BOUNDARY COMMISSION
1911

Plat of the Resurvey of the Clark Boundary Line Between Texas and New Mexico,
One Hundred and Third Meridian West from Greenwich,
from the SE. Cor. of New Mexico to Mile Cor. No. 60.



Approved.

Francis M. Cockrell
Commissioner for the United States.

Sam R. Scott
Commissioner for Texas.

Wm. H. Wetzel, Draftsman

- LEGEND**
- Large concrete monument
 - Small
 - Fence
 - Road
 - Windmill
 - Houses
 - Cultivation
 - Arroyo, wash or draw
 - Dry pond or basin
 - Sand hills
 - Loose, shifting sand

Scale: 1 Mile to 1 Inch



I hereby certify that the above plat is a correct representation of so much of the boundary line between the State of Texas and the Territory of New Mexico, originally surveyed as the One Hundred and Third Meridian West from Greenwich, by John H. Clark, in 1859, as extends from the SE. COR. of NEW MEXICO to MILE COR. N^o 60, as surveyed and marked by me during the period from April 17 to July 18, 1911, under the direction of the U. S. Boundary Commission, and in accordance with instructions from the Commissioner of the General Land Office, dated March 29, 1911.

T. D. Kirkpatrick
U. S. Surveyor.

Plat of the Resurvey of the Clark Boundary Line Between Texas and New Mexico,
One Hundred and Third Meridian West from Greenwich,
from Mile Cor. No. 60 to Mile Cor. No. 120.

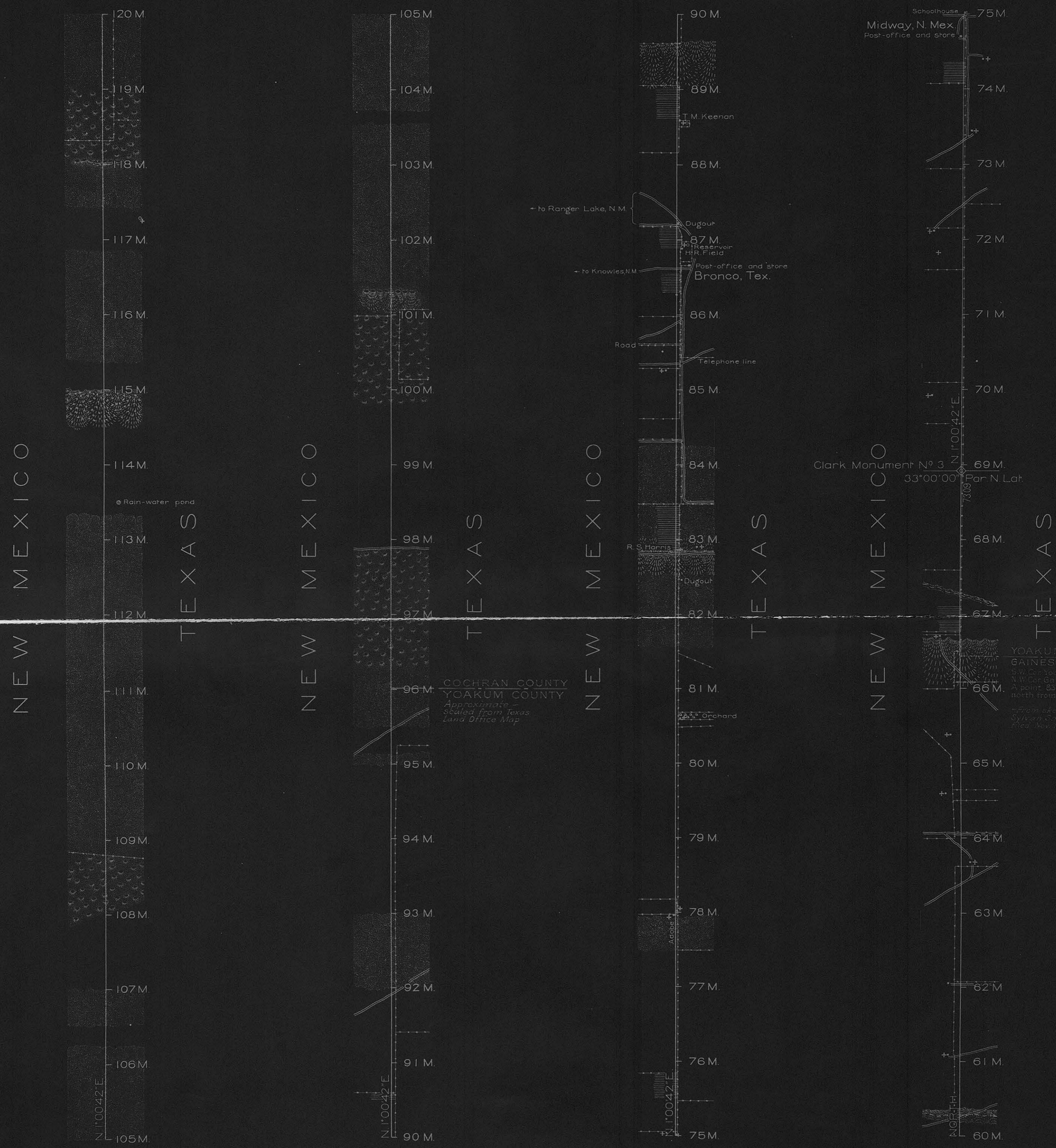

Approved,
Francis M. Cockrell
Commissioner for the United States.
Smith Scott
Commissioner for Texas.

- LEGEND
- ◆ Large concrete monument
 - Fence
 - Road
 - + Windmill
 - Reservoir
 - Houses
 - ||||| Cultivation
 - Arroyo, wash or draw
 - ∩ Sand hills
 - ⊞ Loose, shifting sand
 - ⊞ Heavy undergrowth

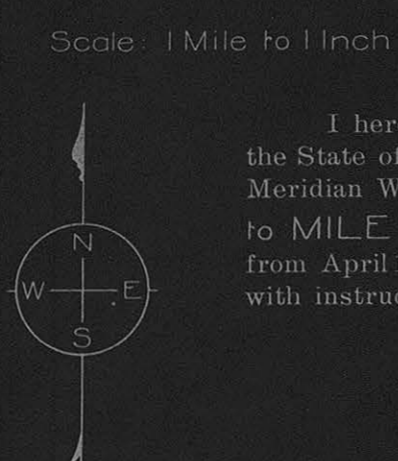

I hereby certify that the above plat is a correct representation of so much of the boundary line between the State of Texas and the Territory of New Mexico, originally surveyed as the One Hundred and Third Meridian West from Greenwich, by John H. Clark, in 1859, as extends from MILE COR N° 60 to MILE COR N° 120, as surveyed and marked by me during the period from April 17 to July 18, 1911, under the direction of the U. S. Boundary Commission, and in accordance with instructions from the Commissioner of the General Land Office, dated March 29, 1911.

G. D. Kirkpatrick
U. S. Surveyor.

Wm. H. Wetzel, Draftsman

Plat of the Resurvey of the Clark Boundary Line Between Texas and New Mexico,
One Hundred and Third Meridian West from Greenwich,
from Mile Cor. No. 120 to Mile Cor. No. 180.

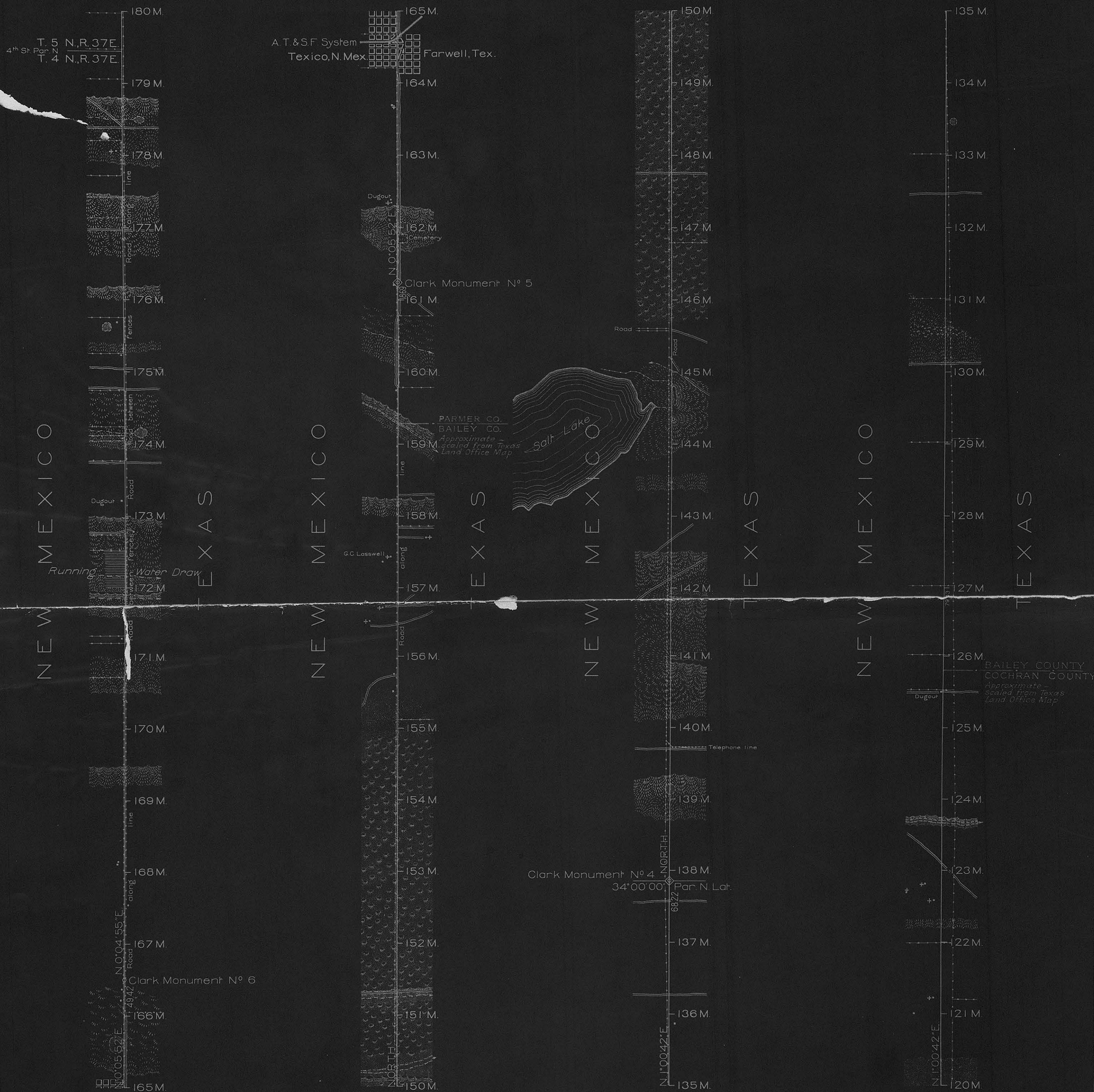

- LEGEND**
- ◆ Large concrete monument
 - ◊ Small
 - Fence
 - Road
 - ⊕ Windmill
 - ⋄ Houses
 - ||||| Cultivation
 - ~ Arroyo, wash or draw
 - Dry pond or basin
 - ⊙ Sand hills
 - ⊙ Loose, shifting sand
 - ⊙ Dense undergrowth

Scale: 1 Mile to 1 Inch



I hereby certify that the above plat is a correct representation of so much of the boundary line between the State of Texas and the Territory of New Mexico, originally surveyed as the One Hundred and Third Meridian West from Greenwich, by John H. Clark, in 1859, as extends from MILE COR. N° 120 to MILE COR. N° 180, as surveyed and marked by me during the period from April 17 to July 18, 1911, under the direction of the U. S. Boundary Commission, and in accordance with instructions from the Commissioner of the General Land Office, dated March 29, 1911.

W. D. ...
U. S. Surveyor.

Approved,
Francis M. Cockrell
Commissioner for the United States.
Wm H. Wetzel
Commissioner for Texas.
Wm H. Wetzel, Draftsman

Plat of the Resurvey of the Clark Boundary Line Between Texas and New Mexico,
Thirty Second Parallel of North Latitude,
from the SE. Cor. of New Mexico to Mile Cor. No. 60.



- LEGEND
- ◆ Large concrete monument
 - Small
 - Fence
 - Road
 - Arroyo, wash or draw
 - Sand hills
 - Loose, shifting sand
 - Rock bluff or rim rock
 - Heavy undergrowth

Scale: 1 Mile to 1 Inch



We hereby certify that the above plat is a correct representation of so much of the boundary line between the State of Texas and the Territory of New Mexico, originally surveyed as the Thirty Second Parallel of North Latitude, by John H. Clark, in 1859, as extends from the SE. COR. of NEW MEXICO to MILE COR. N^o 60, as surveyed and marked by us during the period from Apr. 17 to Sept. 26, 1911, under the direction of the U. S. Boundary Commission, and in accordance with instructions from the Commissioner of the General Land Office.

Approved,
Francis M. Cockrell
Commissioner for the United States.

Samuel R. ...
Commissioner for Texas.

Lee S. Miller
U. S. Surveyors.

Wm. H. Wetzel, Draftsman

