

○ DENOTES 1/2" STEEL ROD SET UNLESS OTHERWISE NOTED
● DENOTES 1/2" STEEL ROD FOUND

TANGENT	BEARING	LENGTH
T1	N09°16'17"W	96.90'
T2	N37°07'41"W	49.36'
T3	N42°13'02"W	42.12'
T4	N47°09'43"W	88.96'
T5	N58°43'18"W	81.21'
T6	N61°50'07"W	332.58'
T7	N64°18'33"W	218.64'
T8	N59°01'25"W	95.30'
T9	N50°24'11"W	241.20'
T10	N67°35'19"W	173.52'
T11	N73°10'05"W	377.41'
T12	N76°16'12"W	66.83'
T13	N79°40'31"W	94.31'
T14	N84°05'57"W	63.21'
T15	S88°01'31"W	46.82'
T16	S76°10'06"W	54.51'
T17	S59°52'59"W	91.30'
T18	S54°16'33"W	83.81'
T19	S51°12'38"W	301.20'
T20	S49°39'15"W	67.89'
T21	S47°31'47"W	102.09'
T22	S45°26'25"W	277.02'
T23	S34°38'01"W	41.34'
T24	S24°15'14"W	36.09'
T25	S18°05'54"W	52.03'
T26	S16°17'50"W	143.01'
T27	S36°17'56"W	175.45'
T28	N48°43'47"W	166.10'

NOTE:
Bearings based on NAD83 Grid State Plane
Coordinates, Texas Central Zone. Coordinates
shown hereon are Grid Coordinates for
Texas Central Zone in meters.

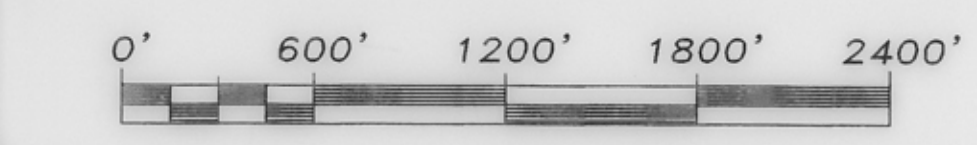
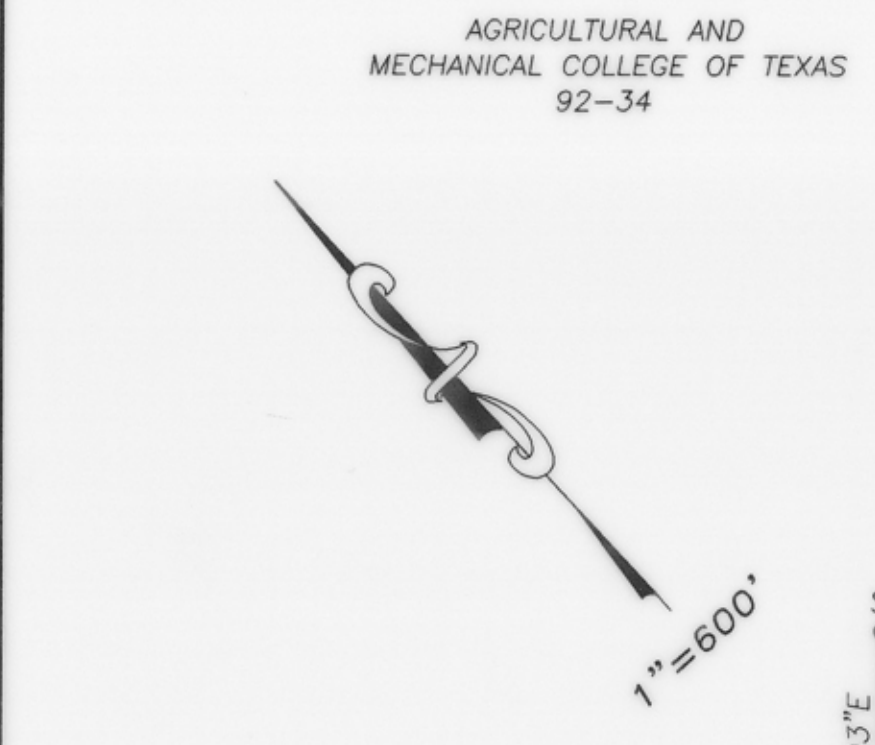

The plat as shown hereon was prepared from an on-the-ground survey performed under my supervision during the month of July, 2003; there are no visible encroachments, encroachments or protrusions except as shown hereon.
August 26, 2003

Ramshaw
Ray L. Vannoy
R.P.L.S. No. 1988

BOUNDARY SURVEY
11002.1 ACRES
J. P. COLES 7-1/2 LEAGUE, A-12
BURLESON COUNTY, TEXAS

G. F. No. 03-07001

Sheet 1 of 14
Drawn By: SG
Vannoy Job No.: 0307-018

PREPARED FOR:
Brazos Enterprises Corp.
P. O. Box 610
Bedford Hills, NY 10607

Vannoy & Assoc., Inc.
Surveyors/Planners
100 Jordan Road, Suite 107
500 N. Willey, Dallas, Texas 75241
Tel: (972) 342-1111
Fax: (972) 342-1112
www.vannoy.com



TANGENT BEARING LENGTH

T1	N89°36'17"E	4.77'
T2	N89°12'28"E	282.94'
T3	N75°03'02"E	84.47'
T4	N71°54'45"E	143.42'
T5	N59°02'20"E	167.21'
T6	N58°04'25"E	120.15'
T7	N70°31'15"E	368.53'
T8	N70°00'23"E	286.51'
T9	N46°36'28"E	152.83'
T10	N79°00'08"E	333.36'
T11	S77°56'19"E	306.36'
T12	S52°09'09"E	366.19'
T13	S47°46'41"E	228.33'
T14	S19°48'28"E	253.98'
T15	S10°59'45"E	210.25'
T16	S20°31'17"E	116.59'
T17	S26°38'45"E	210.72'
T18	S43°08'18"E	368.01'
T19	S58°18'13"E	702.31'
T20	S70°10'44"E	223.72'
T21	S61°33'08"E	148.70'
T22	S66°38'15"E	108.15'
T23	S72°52'19"E	258.82'
T24	S80°10'26"E	226.74'
T25	S77°54'10"E	210.49'
T26	S78°04'28"E	338.02'
T27	S81°09'43"E	63.25'
T28	S83°15'01"E	180.56'
T29	S81°37'36"E	305.48'
T30	S71°40'27"E	637.53'
T31	S78°20'38"E	423.78'
T32	S78°56'52"E	658.37'
T33	S86°17'37"E	246.35'
T34	S86°26'55"E	205.86'
T35	N82°29'38"E	272.18'
T36	N78°27'10"E	362.37'
T37	N63°40'13"E	143.06'
T38	N55°21'17"E	374.17'
T39	N35°50'01"E	236.24'
T40	N21°40'28"E	202.22'
T41	N14°34'00"E	235.23'
T42	N11°23'03"E	133.17'
T43	N17°36'45"E	40.93'
T44	N07°43'28"E	285.68'
T45	N04°56'48"E	407.65'
T46	N17°10'07"W	321.15'
T47	N63°48'14"W	412.37'
T48	N56°49'06"W	834.22'
T49	N46°05'46"W	431.78'
T50	N06°59'12"W	445.48'
T51	N05°38'10"E	298.91'
T52	N23°26'17"E	207.35'
T53	N41°19'15"E	125.24'
T54	N44°25'34"E	151.41'
T55	N53°37'11"E	206.34'
T56	S82°03'25"E	158.93'
T57	S80°30'36"E	151.91'
T58	N89°10'38"E	176.16'
T59	N86°54'33"E	106.43'
T60	S86°48'51"E	137.72'
T61	S83°33'04"E	190.23'
T62	N87°34'13"E	116.72'
T63	S83°39'56"E	347.06'
T64	S35°01'25"E	363.45'
T65	S18°40'32"E	411.56'
T66	S04°17'50"E	317.60'
T67	S05°51'40"E	556.51'
T68	S05°34'51"E	511.10'
T69	S33°07'06"E	631.86'
T70	S55°23'51"E	415.78'
T71	S88°56'28"E	577.53'
T72	N42°24'29"E	508.09'
T73	N22°38'29"E	667.79'
T74	N09°19'16"W	440.41'
T75	N17°00'16"W	915.88'
T76	N37°47'21"W	793.43'
T77	N26°36'41"W	359.01'
T78	N24°12'14"W	302.81'
T79	N11°55'42"E	301.74'
T80	N44°46'54"E	280.55'
T81	N72°11'36"E	316.77'
T82	S77°55'45"E	203.55'
T83	S73°20'26"E	200.32'
T84	S66°25'34"E	290.07'

NOTE:
Bearings based on NAD83 Grid State Plane
Coordinates, Texas Central Zone. Coordinates
shown herein are Grid Coordinates for
Texas Central Zone in meters.

NOTE: The Lower No. 1 Unit includes
part of the land of the above
tract.

Approximate location of
former levee.

Approximate location of
former levee.

TRACT NO. 3
3481.91 ACRES
BUFFALO RANCH COMPANY, LTD.
255-115

4898.1 ACRES

TRACT NO. 5
1135.251 ACRES
BUFFALO RANCH COMPANY, LTD.
255-115

TRACT TWO
300 ACRES
MARY E. BARNHART
465-324

472.39 ACRES
JOHN K. KASSIG and wife,
GALINDA RAMOS KASSIG
203-447

T85	S58°06'26"E	508.76'
T86	S56°08'23"E	97.71'
T87	S57°53'00"E	126.84'
T88	S48°38'24"E	276.86'
T89	S54°06'55"E	480.47'
T90	S66°36'32"E	661.50'
T91	S79°24'34"E	764.54'
T92	N88°09'15"E	1440.80'
T93	S70°37'48"E	250.63'
T94	S43°20'20"E	106.70'
T95	S23°37'51"E	163.12'
T96	S13°51'09"E	703.37'
T97	S18°55'11"E	506.11'
T98	S38°05'47"W	657.15'
T99	S07°26'35"E	574.80'
T100	S14°16'36"E	438.40'
T101	S21°43'44"E	658.24'
T102	S19°43'06"E	819.22'
T103	S13°06'06"E	740.83'
T104	S06°17'41"E	575.87'
T105	S01°38'58"E	703.94'
T106	S09°41'52"W	531.81'
T107	S17°50'29"W	496.55'
T108	S36°05'25"W	783.19'
T109	S56°24'58"W	355.22'
T110	S65°23'26"W	400.32'
T111	S75°25'46"W	891.64'
T112	S82°39'54"W	670.64'
T113	N87°18'18"W	1090.37'
T114	S70°58'08"W	618.62'
T115	S38°36'39"W	582.48'
T116	S25°59'08"W	475.00'
T117	S08°06'47"W	599.46'
T118	S26°05'38"E	483.64'
T119	S41°52'12"E	658.61'
T120	S58°37'27"E	768.25'
T121	S83°00'51"E	665.15'
T122	N88°50'09"E	813.10'
T123	N48°39'03"E	421.36'
T124	N51°05'31"E	1141.45'
T125	N48°43'07"E	455.82'
T126	N65°37'36"E	306.46'
T127	N83°10'26"E	299.68'
T128	S58°45'58"E	2371.44'
T129	S35°47'17"E	287.68'
T130	S12°13'40"E	437.40'
T131	S07°43'29"W	441.63'
T132	S12°11'02"W	405.58'
T133	S07°35'01"W	1065.51'
T134	S25°56'33"E	1178.42'
T135	S35°30'50"E	603.16'
T136	S47°24'05"E	473.86'
T137	S78°02'39"E	907.16'
T138	S77°57'45"E	592.15'
T139	S77°41'43"E	671.58'
T140	S69°25'37"E	686.80'
T141	S46°44'20"E	191.75'
T142	S24°50'47"E	207.30'
T143	S09°49'34"E	448.93'
T144	S28°10'11"E	375.01'
T145	S25°16'35"E	103.01'

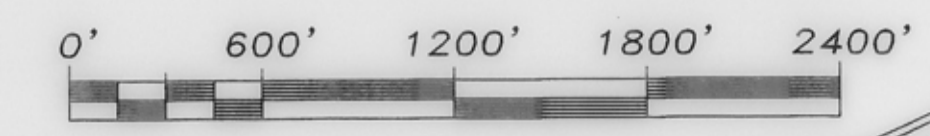
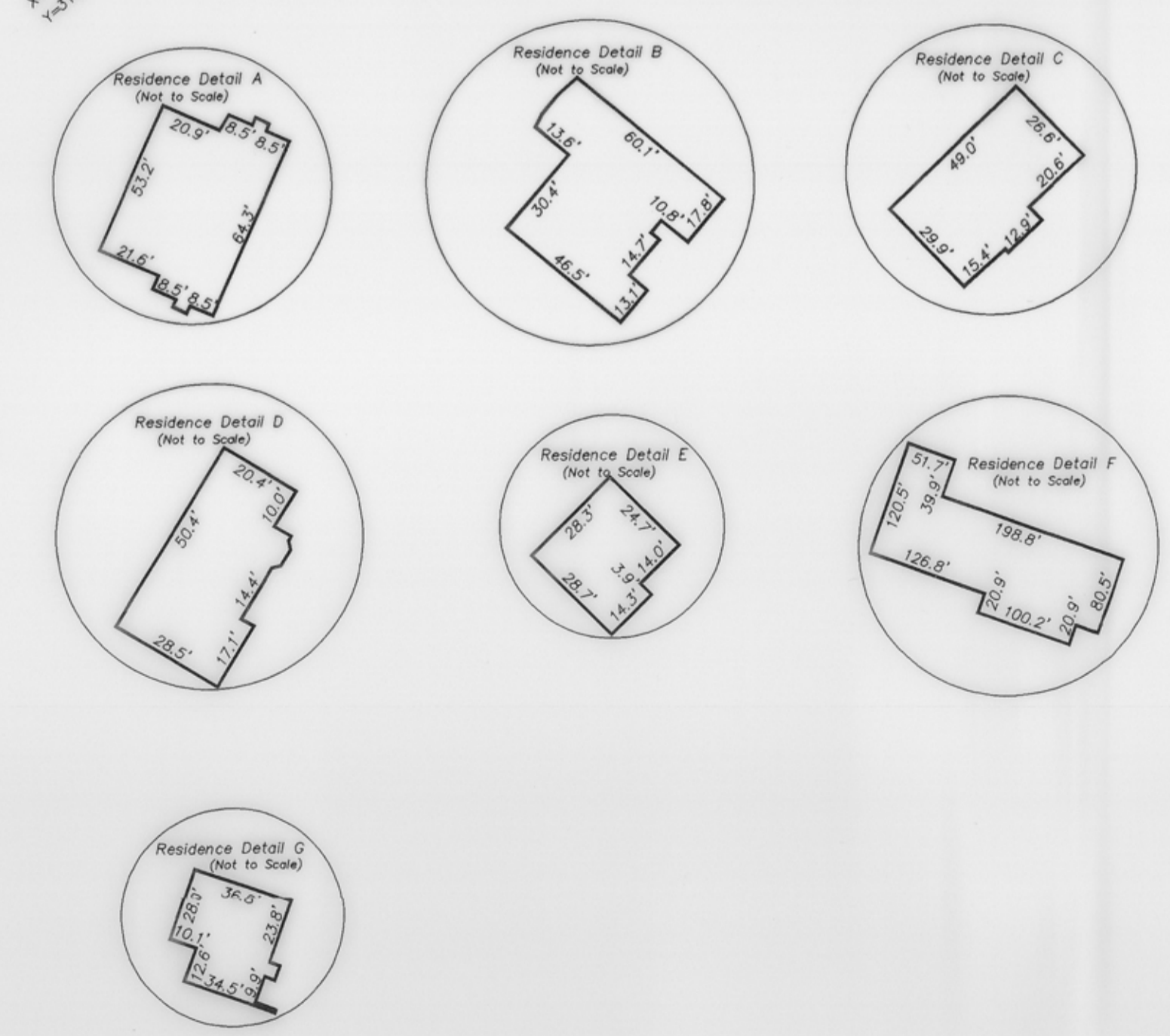

TEXAS GENERAL LAND OFFICE
State Real Property Sketch
Agency PSF
Sketch No. L-36-B

G.P. No. 03-57001
Sheet 2 of 14
Drawn By: SG
Vannoy Job No.: 0307-018

PREPARED FOR:
Brzos Enterprises Corp.
P.O. Box 610
Bedford Hills, NY 10507

Vannoy & Assoc., Inc.
Surveyors/Planners
300 N. Wacker Drive, Suite 713
Dallas, Texas 75201
Tel: 972.342.1844
Fax: 972.342.1844

BOUNDARY SURVEY
11002.1 ACRES
J. P. COLES 7-1/2 LEAGUE, A-12
BURLESON COUNTY, TEXAS

NOTE: Concrete monument found but not held, bearing N42°14'17"E, 4.0' from
Point of Beginning. No other monuments found along highway within subject
property or within 2 miles either direction. Highway alignment was constructed
from 1907 maps and aerial derivative stock over a distance of about 7 miles.

● DENOTES CONCRETE MONUMENT FOUND UNLESS OTHERWISE NOTED.
○ DENOTES 1/2" STEEL ROD SET UNLESS OTHERWISE NOTED.