

VICINITY MAP
(NOT TO SCALE)

BRAZORIA COUNTY

BRAZORIA

Frederick J. Calvit A- 51
Titled December 8, 1830

"NOTICE: This survey was performed in accordance with Section 33.136, Natural Resources Code, for the purpose of evidencing the location of the shoreline in the area depicted in this survey as that shoreline existed before commencement of erosion response activity, as required by Chapter 33, Natural Resources Code. The line depicted on this survey fixes the shoreline for the purpose of locating a shoreline boundary, subject to movement landward as provided by Section 33.136, Natural Resources Code."

"This survey does not nor is intended to be used to identify, delineate or fix the line of vegetation or the landward boundary of the public beach."

Lines Shown were surveyed on the ground September 03, 2004
Field Personnel: Stephen Blaskey

TEXAS GENERAL LAND OFFICE
Art. 33.136, Natural Resources Code
Co. Brazoria, Station No. 7, sheet 1, Large Format
File Date 11-15-2004 by D.J.H.
For Report see Sheet 2, Small Format

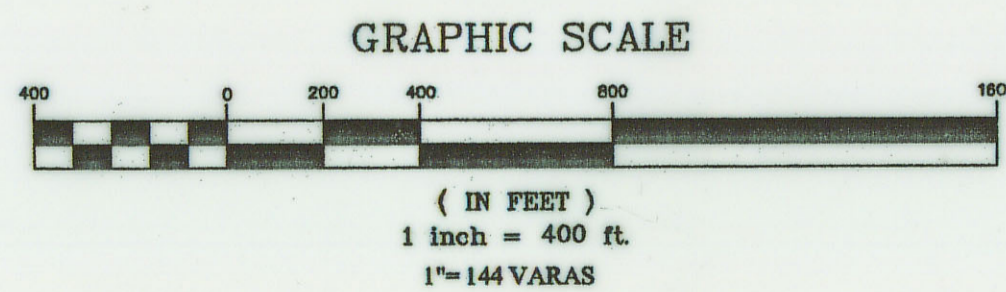

NOVEMBER 12, 2004

I hereby certify that the above described property was surveyed in the field according to law under my direction on the above referenced date, and that the above map together with dimensions and coordinates is true and correct as of the above date.

COASTAL SURVEYING OF TEXAS

Sidney Bouse

Sidney Bouse
Licensed State Land Surveyor
email: sid@surveygalveston.com

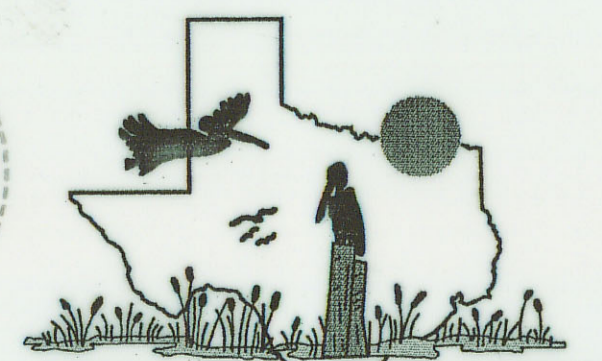
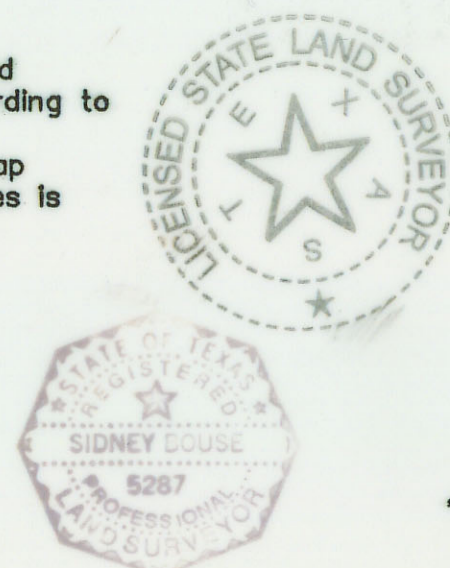

COASTAL SURVEYING OF TEXAS
9117 HARBORSIDE DRIVE, PH (409) 740-1217
GALVESTON, TX 77553 FAX (409) 740-5377
www.surveygalveston.com
"SERVING GALVESTON COUNTY OVER 50 YEARS"
04-1540 03-0525 surfside

"CAPTAIN"
N 4,127,796.937 m
E 960,670.419 m
N 13542613.78 ft
E 3151799.53 ft

POB
N 13543536.06
E 3153325.50

END
N 13547609.77
E 3156115.96

Survey of the MEAN HIGHER HIGH WATER line of part of the Southerly shoreline of the Frederick J. Calvit Survey, Abstract 51, Brazoria County, Texas, and said line being more particularly described as follows;

COMMENCING at NGS Monument "CAPTAIN" with NAD 83 (1993 SPC TXSC Grid Coordinates of 4,127,796.937 N and 960,670.419 E (in Meters) Scale factor 0.99988744 Convergence +1'48'46.0"; Thence N 58°51'06" E, a distance of 1783.05 feet (641.9 Varas) L1 to the said MEAN HIGHER HIGH WATER line of the GULF OF MEXICO and the POINT OF BEGINNING (N=13,543,536.06 feet and E= 3,153,325.50 feet); THENCE along the said Mean Higher High Water line the following courses and distances:
N 24°53'21"E, a distance of 505.20 feet (181.9 Varas) L2;
N 28°03'15"E, a distance of 497.24 feet (179.0 Varas) L3;
N 30°56'34"E, a distance of 496.27 feet (178.6 Varas) L4;
N 32°28'52"E, a distance of 502.65 feet (180.9 Varas) L5;
N 34°49'56"E, a distance of 501.78 feet (180.6 Varas) L6;
N 36°11'59"E, a distance of 498.91 feet (179.6 Varas) L7;
N 37°41'44"E, a distance of 497.52 feet (179.1 Varas) L8;
N 39°52'16"E, a distance of 500.11 feet (180.0 Varas) L9;
N 39°32'18"E, a distance of 500.43 feet (180.1 Varas) L10;
N 40°07'43"E, a distance of 456.51 feet (164.3 Varas) L11 N=13,547,609.77 ft, E= 3,156,115.96 ft;

Tidal Datums at FREEPORT, DOW BARGE CANAL
National Ocean Service Station ID: 8772440 based on:

LENGTH OF SERIES: 5 YEARS
TIME PERIOD: January 1997- December 2001
TIDAL EPOCH: 1983-2001
CONTROL TIDE STATION: N/A

NOTES:

- 1.) ALL COORDINATES REFER TO THE STATE PLANE COORDINATE SYSTEM, SOUTH CENTRAL ZONE, AS DEFINED BY ARTICLE 21.071 OF THE NATURAL RESOURCES CODE OF THE STATE OF TEXAS, 1983 DATUM (1993 ADJUSTMENT).
- 2.) ALL DISTANCES ARE GRID DISTANCES IN FEET AND VARAS.

MEAN HIGHER HIGH WATER
Survey of part of the Southerly shoreline of the
Frederick J. Calvit SURVEY, Abstract 51
Brazoria County, Texas
18.4 Miles South-Southeast of the Brazoria County Courthouse

**SURVEYORS REPORT ON THE
MEAN HIGHER HIGH WATER LINE SURVEY OF PART OF THE
SOUTHERLY SHORELINE OF THE FREDERICK J. CALVIT SURVEY,
ABSTRACT 51 OF BRAZORIA COUNTY, TEXAS**

I surveyed the line of Mean Higher High Water of part of the Southerly shoreline of the Frederick J. Calvit Survey, Abstract 51 Brazoria County, Texas, as authorized by Stephen Blaskey of Frontier Surveying and in my capacity as Licensed State Land Surveyor for the State of Texas.

HISTORY

The Frederick J. Calvit Survey originally encompassed One League of land surveyed by Thomas H. Borden and Titled out of Mexico though the State of Coahuila and Texas on December 8, 1830 as found in the GLO Spanish Collection Box 16, Folder No. 1, with the English Translation of the field notes in English Translation No. 594 with original filed notes in Field Book 7, Page 276 in the Archives and Records Division of the General Land Office, Austin, Texas.

CONSTRUCTION

An Act to adapt the Common Law of England was approved on January 20, 1840. The Littoral State boundary of land granted prior to this date must be surveyed according to the Spanish and Mexican Civil Laws and is determined to be along the Mean Higher High Water Line.

The elevation of the Mean Higher High Water line on this project site was established. The FREEPORT, DOW BARGE CANAL, TEXAS (NOS Station Id: 8772440) Tidal Benchmarks 2440-A, 2440-B, 2440-C and 2440-D were occupied and tied to NGS monument "Captain" (NGS PID AM 0078) utilizing Trimble RTK with 2 Meter fixed height poles. The published Mean Higher High Water elevation from NOS Tide Gauge FREEPORT was then transferred to the shoreline of the Gulf of Mexico by Stephen Blaskey of Frontier Surveying under my direction. The line so established is delineated on the attached survey.



Sidney Bouse
Licensed State Land Surveyor

November 12, 2004
LSLS04-1540 03-0358Freeport



TEXAS GENERAL LAND OFFICE
Art. 33.136, Natural Resources Code
Co. Brazoria, Sketch No. 7, sheet 2, small format
File Date 11-15-2004 by D.J.H.