

J:\SMAcad\Projects\2003\30162\dwg\01\Coastal-Boundary-Survey\30162-01-T01.dwg 3/30/2005 1:52:32 PM CST

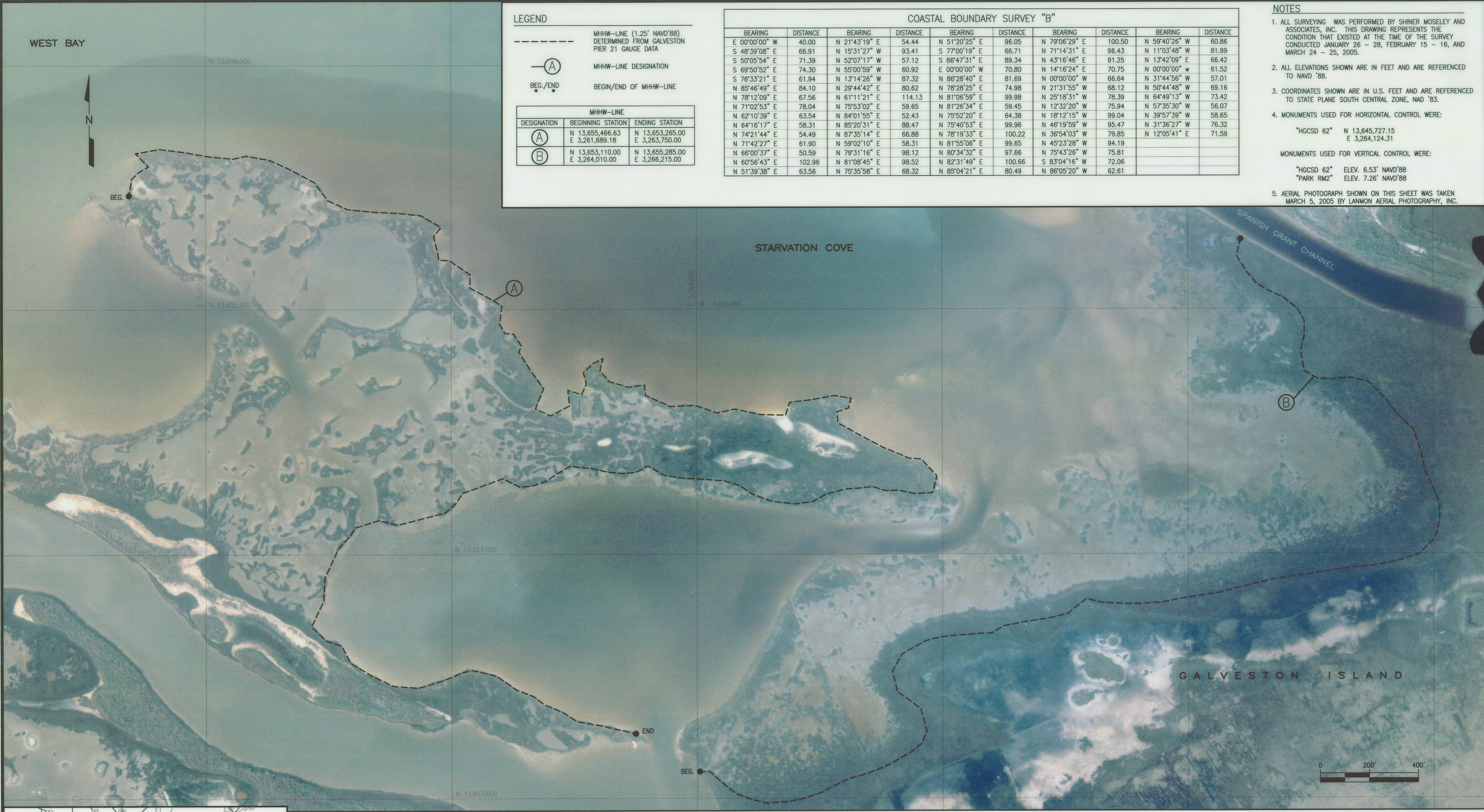

**LEGEND**

----- MHHW-LINE (1.25' NAVD'88) DETERMINED FROM GALVESTON PIER 21 GAUGE DATA

⊙ MHHW-LINE DESIGNATION

BEG./END

BEGIN/END OF MHHW-LINE

MHHW-LINE		
DESIGNATION	BEGINNING STATION	ENDING STATION
⊙	N 13,655,466.63 E 3,261,689.18	N 13,653,265.00 E 3,263,750.00
⊙	N 13,653,110.00 E 3,264,010.00	N 13,655,285.00 E 3,266,215.00

COASTAL BOUNDARY SURVEY "B"											
BEARING	DISTANCE	BEARING	DISTANCE	BEARING	DISTANCE	BEARING	DISTANCE	BEARING	DISTANCE	BEARING	DISTANCE
E 00°00'00" W	40.00	N 21°43'19" E	54.44	N 51°20'25" E	96.05	N 79°06'29" E	100.50	N 59°40'26" W	60.86		
S 46°39'08" E	66.91	N 15°31'27" W	93.41	S 77°00'19" E	66.71	N 71°14'31" E	96.43	N 11°03'48" W	81.99		
S 50°05'54" E	71.39	N 52°07'17" W	57.12	S 86°47'31" E	89.34	N 43°16'46" E	91.25	N 13°42'09" E	66.42		
S 69°50'52" E	74.30	N 55°00'59" W	60.92	E 00°00'00" W	70.80	N 14°16'24" E	70.75	N 00°00'00" W	61.52		
S 76°33'21" E	61.94	N 13°14'26" W	87.32	N 86°28'40" E	81.69	N 00°00'00" W	66.64	N 31°44'56" W	57.01		
N 85°46'49" E	84.10	N 29°44'42" E	80.62	N 78°28'25" E	74.98	N 21°31'55" W	68.12	N 50°44'48" W	69.16		
N 78°12'09" E	67.56	N 61°11'21" E	114.13	N 81°06'59" E	99.98	N 25°18'31" W	78.39	N 64°49'13" W	73.42		
N 71°02'53" E	78.04	N 75°53'02" E	59.65	N 81°26'34" E	59.45	N 12°32'20" W	75.94	N 57°35'30" W	56.07		
N 62°10'39" E	63.54	N 84°01'55" E	52.43	N 75°52'20" E	64.38	N 18°12'15" W	99.04	N 39°57'39" W	58.65		
N 64°16'17" E	58.31	N 85°20'31" E	88.47	N 75°40'53" E	99.96	N 46°19'59" W	95.47	N 31°36'27" W	76.32		
N 74°21'44" E	54.49	N 87°35'14" E	66.88	N 78°19'33" E	100.22	N 36°54'03" W	79.85	N 12°05'41" E	71.59		
N 71°42'27" E	61.90	N 59°02'10" E	58.31	N 81°55'06" E	99.65	N 45°23'28" W	94.19				
N 66°00'37" E	50.59	N 79°31'16" E	98.12	N 80°34'32" E	97.66	N 75°43'26" W	75.81				
N 60°56'43" E	102.96	N 81°08'45" E	98.52	N 82°31'49" E	100.66	S 83°04'16" W	72.06				
N 51°39'38" E	63.56	N 75°35'58" E	68.32	N 85°04'21" E	80.49	N 86°05'20" W	62.61				

**NOTES**

- ALL SURVEYING WAS PERFORMED BY SHINER MOSELEY AND ASSOCIATES, INC. THIS DRAWING REPRESENTS THE CONDITION THAT EXISTED AT THE TIME OF THE SURVEY CONDUCTED JANUARY 26 - 28, FEBRUARY 15 - 16, AND MARCH 24 - 25, 2005.
- ALL ELEVATIONS SHOWN ARE IN FEET AND ARE REFERENCED TO NAVD '88.
- COORDINATES SHOWN ARE IN U.S. FEET AND ARE REFERENCED TO STATE PLANE SOUTH CENTRAL ZONE, NAD '83.
- MONUMENTS USED FOR HORIZONTAL CONTROL WERE:
  - "HGCS D 62" N 13,645,727.15  
E 3,264,124.31
- MONUMENTS USED FOR VERTICAL CONTROL WERE:
  - "HGCS D 62" ELEV. 6.53' NAVD'88
  - "PARK RM2" ELEV. 7.26' NAVD'88
- AERIAL PHOTOGRAPH SHOWN ON THIS SHEET WAS TAKEN MARCH 5, 2005 BY LANMON AERIAL PHOTOGRAPHY, INC.

REV	DATE	DESCRIPTION	APP
0	MAR. '05	ISSUED TO CLIENT	
3/05			
3/05			
3/05			

DRU GR GR GRAPHIC  
30162-01-T01  
200.30162.01

TEXAS GENERAL LAND OFFICE  
At 33.136, Natural Resources Code  
Co. Galveston Sketch No. 31  
File Date 5-24-2005 by [Signature]  
See Report

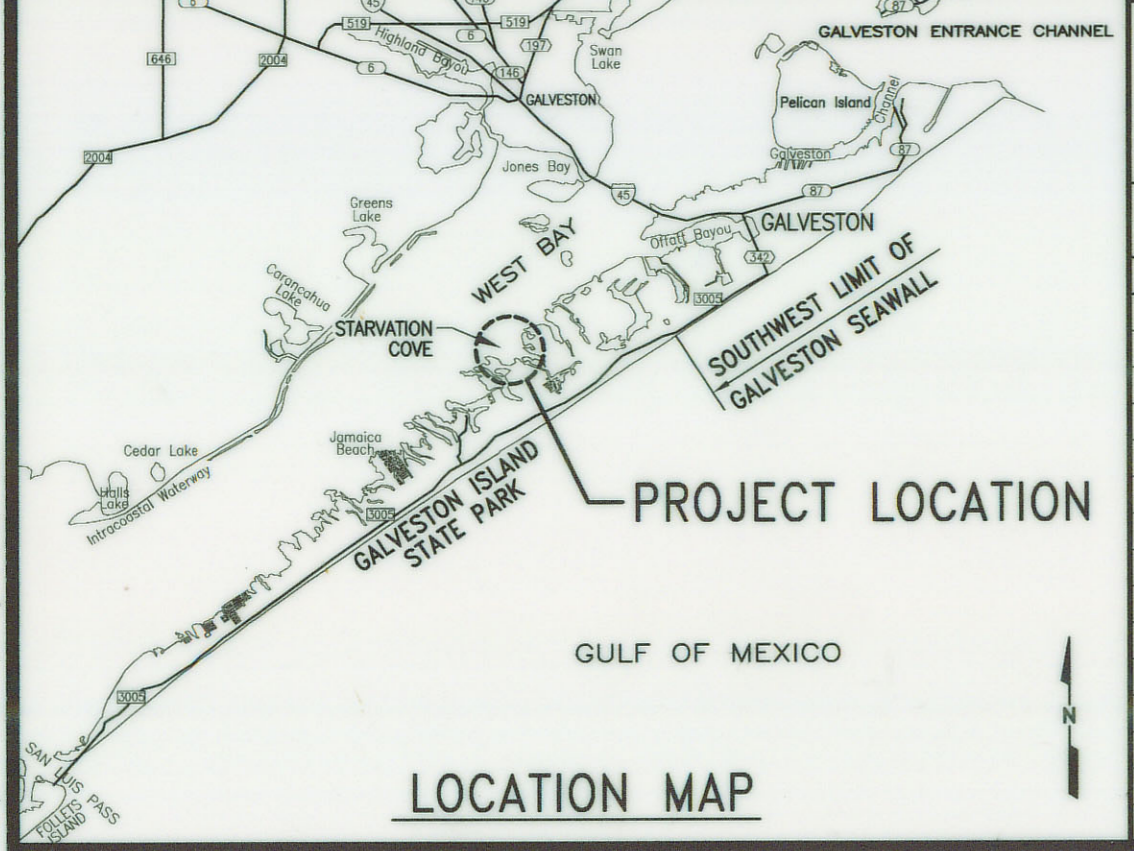

**1 SITE SURVEY**  
SCALE: GRAPHIC

**COASTAL BOUNDARY SURVEY "A"**

BEARING	DISTANCE	BEARING	DISTANCE	BEARING	DISTANCE	BEARING	DISTANCE	BEARING	DISTANCE	BEARING	DISTANCE	BEARING	DISTANCE	BEARING	DISTANCE
N 10°03'32" E	70.53	S 87°13'52" E	104.34	S 31°57'42" E	92.09	S 05°36'07" E	43.05	S 61°46'55" E	114.07	N 70°11'10" W	85.64	S 83°33'05" W	57.13	S 28°12'19" E	80.82
N 45°30'09" E	40.76	S 83°53'14" E	94.67	S 35°13'47" E	87.42	S 65°48'43" E	110.64	S 67°27'58" E	121.42	N 55°32'43" W	60.81	N 63°26'06" W	78.26	S 58°22'25" E	98.77
N 60°49'49" E	43.45	S 59°49'39" E	95.27	S 22°25'08" W	88.15	N 87°36'54" E	101.66	S 86°11'15" E	47.72	N 72°22'57" W	68.05	S 70°01'01" W	175.57	S 64°39'50" E	99.56
N 43°21'03" W	75.13	S 38°30'47" W	47.24	S 65°02'09" E	67.68	S 70°44'55" E	93.02	S 42°43'20" E	93.57	N 86°02'46" W	86.28	S 33°04'18" W	50.73	S 85°41'09" E	100.69
N 80°03'14" E	97.28	S 12°16'12" E	98.87	N 62°42'39" E	87.95	N 77°44'26" E	74.71	S 14°27'44" W	70.49	N 86°51'50" W	74.04	S 48°27'49" W	56.53	N 73°27'51" E	99.79
S 83°03'01" E	104.14	S 85°31'03" E	43.00	N 06°45'24" W	64.29	S 77°43'01" E	109.36	S 86°59'20" W	71.05	N 82°08'51" W	81.23	S 75°37'07" W	201.31	N 67°08'41" E	85.32
S 80°04'41" E	102.39	S 58°29'31" E	101.36	S 71°34'22" E	58.47	S 88°47'40" E	100.53	N 78°45'04" W	70.40	N 60°46'27" W	79.68	N 75°04'07" W	77.62	N 77°17'02" E	47.39
S 84°33'23" E	97.39	S 00°53'44" W	53.77	N 26°07'27" E	47.72	N 17°01'40" E	54.19	S 88°27'53" W	53.16	S 61°50'37" W	54.35	S 72°28'28" W	99.62	S 76°50'13" E	100.70
N 77°16'52" E	53.42	S 61°21'32" E	92.89	N 14°45'00" W	49.52	N 82°57'26" E	94.88	N 72°25'31" W	54.39	S 85°38'22" W	57.25	S 34°06'29" W	46.21	S 55°06'35" E	99.31
S 79°34'02" E	97.42	S 58°54'09" E	56.93	N 48°05'25" E	55.34	N 79°38'18" E	88.20	S 83°40'35" W	54.56	N 84°30'10" W	56.08	S 43°19'41" W	64.25	S 68°20'34" E	74.40
S 65°28'55" E	95.15	S 07°12'33" W	73.67	N 62°57'35" E	44.35	S 81°15'28" E	69.58	S 85°54'27" W	55.91	N 77°09'39" W	65.83	S 24°37'25" W	132.00	S 51°33'53" E	52.77
S 61°51'36" E	108.66	S 28°31'54" E	44.50	S 14°02'32" W	51.96	S 13°19'49" W	41.30	S 75°57'50" W	82.46	N 83°59'28" W	95.52	S 03°00'46" W	95.13	S 67°12'51" E	81.53
S 36°34'19" E	93.10	S 85°54'58" E	35.39	S 41°34'45" E	59.52	S 71°34'22" W	50.18	S 60°22'46" W	60.65	S 58°46'15" W	45.66	S 25°27'48" W	116.30	S 57°17'28" E	71.11
S 65°24'42" E	89.19	S 33°27'55" E	56.39	S 73°39'04" E	80.58	S 05°19'01" E	45.67	S 82°06'14" W	72.97	S 57°00'29" W	66.72	S 46°36'46" E	85.64	S 80°02'28" E	100.82
S 84°08'48" E	98.85	S 18°58'42" W	28.43	N 81°52'25" E	65.37	S 61°05'48" E	90.09	N 83°22'23" W	95.07	S 68°55'43" W	51.69	S 71°29'03" E	62.82	S 76°58'07" E	144.42

WE, SHINER MOSELEY AND ASSOCIATES, INC., HEREBY STATE THAT THIS DRAWING REPRESENTS THE CONDITIONS THAT EXISTED AT THE TIME OF THE STARVATION COVE SURVEY CONDUCTED ON JANUARY 26 - 28, FEBRUARY 15 - 16, AND MARCH 24 - 25, 2005.

NOTICE: THIS SURVEY WAS PERFORMED IN ACCORDANCE WITH SECTION 33.136, NATURAL RESOURCES CODE, FOR THE PURPOSE OF EVIDENCING THE LOCATION OF THE SHORELINE IN THE AREA DEPICTED IN THIS SURVEY AS THAT SHORELINE EXISTED BEFORE COMMENCEMENT OF EROSION RESPONSE ACTIVITY, AS REQUIRED BY CHAPTER 33, NATURAL RESOURCES CODE. THE LINE DEPICTED ON THIS SURVEY FIXES THE SHORELINE FOR THE PURPOSE OF LOCATING A SHORELINE BOUNDARY, SUBJECT TO EROSION LANDWARD AS PROVIDED BY SECTION 33.136, NATURAL RESOURCES CODE.

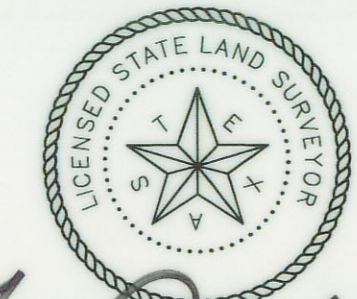

*George Rubalcaba* 5-30-05  
 GEORGE RUBALCABA  
 LICENSED STATE LAND SURVEYOR

TEXAS GENERAL LAND OFFICE  
**STARVATION COVE WETLANDS RESTORATION AND SHORELINE PROTECTION**  
 GALVESTON  
 STATE COASTAL BOUNDARY SURVEY

SHEET **T1**  
 OF 1 REV 0



March 30, 2005

J200.30162.01

Mr. Ben Thomson  
Texas General Land Office  
1700 N. Congress Avenue  
Austin, Texas 78701-1495

**RE: SURVEY AT STARVATION COVE, GALVESTON COUNTY, TEXAS  
(STATE COASTAL BOUNDARY SURVEY)**

Dear Mr. Thomson:

Enclosed is the State Coastal Boundary Survey drawing depicting the survey conducted by us at Starvation Cove on Galveston Island. The Mean Higher High Water Line shown was determined from the tidal information obtained from the Pier 21 gauge and Pier 21 benchmarks. As per our previous submittal on the Coastal Boundary Survey of Delehide Cove, you indicated the datum from Pier 21 would be acceptable for determining the MHHW at this project site.

State plane coordinates were arrived at from the monumentation shown on the drawing. As previously done on the Delehide Cove project, the elevations were looped from monuments for Pier 21 gauge and transferred to the monuments noted on the drawing. Elevations are referenced to NAVD '88 datum.

Thanks again for your time and assistance on this project. If you should have any questions, please call me at (361) 857-2211.

Sincerely,

SHINER MOSELEY AND ASSOCIATES, INC.

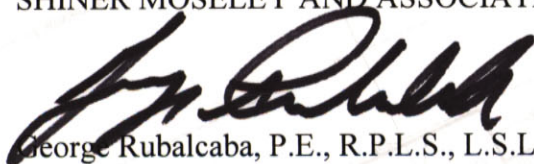
  
George Rubalcaba, P.E., R.P.L.S., L.S.L.S.  
Manager of Surveys

GR/dd

Enclosure

cc: Dennis Rocha  
Cherie O'Brien

TEXAS GENERAL LAND OFFICE  
Art. 33.136, Natural Resources Code  
Co. Galveston, No. 31  
File Date 5-24-2005 by 