

SHAHAN & ERWIN, L.L.P.

Gary H. Shahan

Charles E. Erwin

Attorneys At Law
Post Office Box 6146
Abilene, Texas 79608

2 Village Drive
Century Plaza II, Suite 101
Abilene, Texas 79606

Tel: (325) 692-2292
Fax: (325) 692-6730
E-mail: sha-erw@swbell.net

May 12, 2006

Warnick

Mr. Jerry Patterson, Commissioner
Texas General Land Office
Box 12873
Austin, TX 78711-2873

RECEIVED

MAY 15 2006

EXECUTIVE

cc: JP
Rene
BENT

Dear Mr. Patterson:

I represent Mrs. Herbie West who owns property in the 3400 block of South 6th Street, Abilene, Texas. Elm Creek was adjacent to her property until 1973, when the City of Abilene, as a part of a flood control project, relocated, diverted and re-constructed that portion of Elm Creek and filled in the old creek bed. The City of Abilene conveyed the old creek bed to the West family.

Since 1973, the West family has been paying ad valorem taxes on the abandoned creek bed.

Mrs. West has had several inquiries from prospective purchasers that want to buy this property on which the old creek bed has been filled in, covered and leveled. This property has the potential of being a good building site; however, for her to be able to sell this property, including the abandoned creek bed, she needs to obtain a conveyance from the State of Texas covering any interest the State might have in the old creek bed which no longer exists.

Enclosed is a copy of letter dated May 20, 2005, from William F. Warnick, General Counsel of the Texas General Land Office, to Jeff Grindstaff of the City of Abilene concerning the creek bed.

What is required by the General Land Office for her to be able to obtain a conveyance from the State of Texas of the abandoned creek bed?

File No. Sketch File 23
Taylor County

Disclaimer of Public Interest in Surface
of Elm Creek

Date Filed: August 11, 2006

Taylor Co. SK. File 23
sheet 1

Jerry Patterson, Commissioner

By Douglas Howard

counter 87114

Mr. Jerry Patterson
May 12, 2006
Page Two

Your prompt reply would be appreciated.

Yours very truly,

SHAHAN & ERWIN, L.L.P.

BY:

CHARLES E. ERWIN

CEE:vc
Enclosure

cc: Mrs. Herbie West
3465 South 6th St.
Abilene, TX 79605

Taylor Co. SK. File 23
sheet 2

Counter 87115

Erwin

COMMISSIONER JERRY PATTERSON
CORRESPONDENCE ASSIGNMENT

To: Wharnick

Date: 5/15/06

Letter for the
Commissioner Signature

Please handle on behalf of
Commissioner
(Notify Executive of any action taken)

Response is due within 2 working days of assignment

APPROVAL FOR COMMISSIONER'S SIGNATURE

Note: Please attach a briefing memo to the Commissioner on both incoming and outgoing correspondence. (Only if box is checked)

Date: _____
(of the letter)

Letter to: _____

Topic: _____
(brief description)

Letter for Electronic Distribution

Letter to be copied on letterhead

Author: _____

Contact Person: _____ Phone #: _____

Special Instructions, if any: _____

If box is checked below, must have approval before it goes to the Commissioner:

* Deputy _____

* Mark Loeffler Approval: _____

Erin Guillette: _____

Becki Gregg: _____ (If letter is to Legislators, must have GR approval)

Trace Finley _____ (If letter is to local elected officials, must have approval)

For Executive Use only:

Received: _____ Returned for Revisions: _____ JP signature; call for pick up: _____

Taylor Co. Sk. File 23
sheet 3

Counter 87116

COMMISSIONER JERRY PATTERSON
CORRESPONDENCE ASSIGNMENT

To: Warnick

Date: 5/15/06

Letter for the
Commissioner Signature

Please handle on behalf of
Commissioner
(Notify Executive of any action taken)

Response is due within 2 working days of assignment

APPROVAL FOR COMMISSIONER'S SIGNATURE

Note: Please attach a briefing memo to the Commissioner on both incoming and outgoing correspondence. (Only if box is checked)

Date: _____
(of the letter)

Letter to: Charles E. Erving

Topic: procedure for conveyance of creekbed property
(brief description)

Letter for Electronic Distribution Letter to be copied on letterhead

Author: Moulton x 35091
Contact Person: Coover Phone #: 52225

Special Instructions, if any: CC: Mrs. Heekie West

If box is checked below, must have approval before it goes to the Commissioner:

* Deputy _____

* Mark Loeffler Approval: _____
Erin Guillette: _____

Becki Gregg: _____ (If letter is to Legislators, must have GR approval)

Trace Finley _____ (If letter is to local elected officials, must have approval)

For Executive Use only:

Received: _____ Returned _____ JP signature;
for Revisions: _____ call for pick up: _____

Taylor Co. SK File 23
sheet 4

Counter 87117

COMMISSIONER LETTERS:

All outgoing letters for the Commissioner's signature MUST be submitted through Executive's Approval Process.

All outgoing letters submitted through the Executive Approval Process must be accompanied by both a blue Correspondence Assignment/Approval Sheet (blue sheet) as well as a briefing memo (see #2 below).

NOTE: If the blue sheet is marked "please handle", you must notify Ester Amesquita of the action taken and/or submit a copy of the response for the Commissioner's files.

CORRESPONDENCE PROCEDURES:

1. Type the response letter on plain white paper. Seldom does a letter go out without any revision(s). Generating response letters on plain white paper first will save money on stationery.
2. You only complete a briefing memo to accompany the response letter, briefly describing the letter and response, **only if the box is checked**. Use the memo format for briefing memos. On these briefing memos, the standard cc's included on the template are not necessary.
3. After a response letter is completed, **it should be approved by the appropriate Deputy and Mark Loeffler**. If any of the boxes are checked then it must have the approval of the box that is checked before it goes to Mark Loeffler.
4. Return the entire packet, including the incoming letter, outgoing response and briefing memo to Ester Amesquita. She will log it into the Commissioner's Correspondence Tracking System and submit it to Mark Loeffler for approval.
5. If a revision is necessary, Ester will call to ask you to pick up the letter. After the revision is completed, the letter can then be printed out on letterhead and re-submitted to Ester. **Remember to attach the marked-up draft copy so the revision(s) can be proofed.**
6. After final approval of the revision by Erin Guillette, it is then submitted to the Commissioner for signature.

If the Commissioner revises the letter, repeat steps 5 and 6.

As letters are received in Executive, Ester will notate on the blue sheet the date received, the date returned for revisions, and the date the Commissioner signed.

When a letter is signed by the Commissioner, Ester makes the appropriate copies for the Executive files, and calls to have the letter picked up and mailed out. Letters are filed under Alpha.

Taylor Co. Sk. File 23
sheet 5

Counter 87118

From: Bob Moreland
To: LaNell Aston
Date: 5/16/2006 1:33:48 PM
Subject: creek bed

We have received a letter from Charles Erwin, an attorney for Mrs Herbie West who owns the property in Abilene adjacent to the abandoned bed of Elm Creek. They are requesting our assistance with the removal of a cloud on the title to her property.

You may recall that Elm Creek was summarily re-routed by the city as a part of a flood control project associated with the completion of a city street. in 1973. She has a QCD from the city. Last year about this time, we wrote the city following a site visit Ben and I made and confirmed that the state would make no claim to the old bed of the creek, but would maintain that the minerals underlying the old creek bed were dedicated to the PSF. Mrs West has confirmed that she has no interest in disputing our claim to the minerals.

I have relayed to Mrs West last week (and today to her neighbor and lobbyist now in Austin, Bill Stevens) that the GLO has no authority to sell, convey, or otherwise alienate the bed of a river or creek which is in the public domain but not dedicated to the PSF. I related to Mr Stevens that we had just received the letter from Mrs West's attorney and that the brain-trust was being assembled to conjure up an innovative solution to this problem. He in turn said that he would discuss with Mr Erwin and the title company to see what would be acceptable to them. We discussed some sort of affidavit that could be recorded. I had in mind the corollary of our "Statement of State Interest" document we have used to put the public on notice of filled lands that appear to be incorporated into adjacent littoral properties - something I would suggest that we could call "Disclaimer of State Interest." It probably wouldn't have much more validity than Special Award No. 1, but it might keep the title company from running amok on Mrs West's title.

Anybody got any more ideas??

Robert F. Moreland
Attorney at Law
Team Leader, Public Lands/Coastal Section
Legal Services Division
512.463.5091

This correspondence may be confidential and subject to the attorney-client privilege.

CC: Ben Thomson; Bill Warnick; Billy Mullens; Dwain Rogers

Taylor Co. Sk. File 23
sheet 6

Counter 87119

TEXAS



GENERAL LAND OFFICE

JERRY PATTERSON, COMMISSIONER

May 20, 2005

Jeff Grindstaff
City of Abilene
555 Walnut Street
P.O. Box 60
Abilene, Tx 79604-0060

Re: Realigned streambed (Elm Creek, City of Abilene)

Dear Mr. Grindstaff:

You have asked the General Land Office to review the status of the above referenced matter. After a field visit by Ben Thomson, Chief Surveyor, and Bob Moreland from the Legal Services Division and an examination of the official records of this office, it has been determined that the General Land Office, on behalf of the State of Texas, will make no claim to ownership of any interest in the original bed of Elm Creek where it was realigned by the City during the completion of 7th Street. However, it is the position of this office that the minerals, if any, underlying the realigned streambed in its present configuration are owned by the State and dedicated to the Permanent School Fund.

Should you have any questions, or if we can be of further assistance, please let us know. You may reach Mr. Moreland at phone number (512) 463-5091 or Mr. Thomson at (512) 463-5212.

Sincerely,

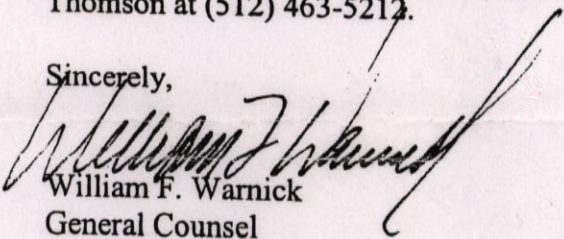
William F. Warnick
General Counsel

cc: Robert F. Moreland, Attorney
Ben Thomson, GLO Chief Surveyor

Stephen F. Austin Building • 1700 North Congress Avenue • Austin, Texas 78701-1495

Post Office Box 12873 • Austin, Texas 78711-2873

512-463-5001 • 800-998-4GLO Taylor Co. Sk. File 23

www.glo.state.tx.us

sheet 7

Counter 87120

Gary H. Shahan

SHAHAN & ERWIN, L.L.P.

Attorneys At Law
Post Office Box 6146
Abilene, Texas 79608

2 Village Drive
Century Plaza II, Suite 101
Abilene, Texas 79606

RECEIVED
JUN 15 2006
EXECUTIVE
Charles E. Erwin
Tel: (325) 692-2292
Fax: (325) 692-6730
E-mail: sha-erw@swbell.net

June 13, 2006

Mr. Jerry Patterson, Commissioner
Texas General Land Office
Box 12873
Austin, TX 78711-2873

Dear Mr. Patterson:

Reference is made to my letter of May 12, 2006. It has been a month and I have not had the courtesy of a reply.

Please let me know the proper person to contact concerning the inquiry.

Thanks.

Yours very truly,

SHAHAN & ERWIN, L.L.P.

BY:

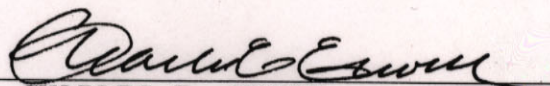
CHARLES E. ERWIN

CEE:vc

cc: Mrs. Herbie West
3465 South 6th St.
Abilene, TX 79605

Taylor Co. Sk. File 23
sheet 8

Counter 87121

TEXAS



GENERAL LAND OFFICE

JERRY PATTERSON, COMMISSIONER

June 29, 2006

Charles E. Erwin, Esq.
Shahan & Erwin, LLP
P.O. Box 6146
Abilene, Tx 79608

Re: Realigned Elm Creek, City of Abilene

Dear Mr. Erwin:

In response to your request assistance with issues related to the realignment of Elm Creek in Abilene, I have prepared a draft document entitled "Disclaimer of State Interest" that could be recorded in the county deed records. A copy is enclosed for your review and comment. Please let me know if you think this will suffice for the purpose stated, i.e. notice to the world that the State maintains no claim to the original streambed and I will proceed to finalize the document. It is my intent to have it executed by the Chief Clerk and notarized if the Commissioner is not available at the appropriate time.

If you have further questions or if the GLO can be of any assistance to you, please feel free to contact me.

Sincerely,

Robert F. Moreland
Attorney at Law
Coastal and Public Lands Section
(512) 463-5091

cc: Ben Thomson, Director of Surveying
LaNell Aston, Special Assistant, Chief Clerk's Office

Stephen F. Austin Building • 1700 North Congress Avenue • Austin, Texas 78701-1495

Post Office Box 12873 • Austin, Texas 78711-2873

512-463-5001 • 800-998-4GLO

www.glo.state.tx.us

Taylor Co. SK. File 23
sheet 9

Counter 87122

DISCLAIMER OF STATE INTEREST

STATE OF TEXAS §
TRAVIS COUNTY §

BEFORE ME, the undersigned authority, on this day personally appeared _____, of Austin, Travis County, Texas, who after being duly sworn upon oath, did depose and state as follows:

DRAFT

My name is _____ I have personal knowledge of the facts and statements contained in this affidavit and each of them is true and correct. I am over the age of twenty-one (21) years, have never been convicted of a felony or a crime of involving moral turpitude, and am of sound mind and capable of making this affidavit.

I am the _____ for the Texas General Land Office (GLO). I am authorized by the GLO to make this affidavit within the scope of my assigned duties and responsibilities.

I have caused the facts related to the relocation, diversion, and re-construction of Elm Creek in the City of Abilene to be investigated and evaluated by the Chief Surveyor and legal staff of the GLO. It is understood that Elm Creek was diverted from its original bed and realigned as a part of an extensive flood control project by the City of Abilene in 1973. The acts of the city are deemed to be in the nature of an avulsive change and must be interpreted as such.

The original bed was filled and abandoned in the area adjacent to the 3400 block of 6th Street. The city conveyed its interest in the abandoned creek bed adjacent to their property at 3465 South 6th Street to Mr. and Mrs. Thomas West by Quit Claim Deed duly recorded in the records of the county. Mr. and Mrs. West have paid ad valorem taxes on the abandoned creek bed since 1973.

I have determined that the General Land Office has no statutory authority to sell, convey, or otherwise transfer the state's interest in the bed of a navigable stream; however, based on the site visit and analysis of the facts by GLO staff, I have further determined that the State of Texas has no ownership interest in the former bed of Elm Creek in the City of Abilene. On behalf of the state, however, the GLO takes the position that any minerals underlying the realigned streambed are dedicated to the Permanent School Fund.

I have directed that this Disclaimer of State Interest be recorded in the deed records of Taylor County and that it may be relied on by owners of property adjacent to the abandoned original bed of Elm Creek in the City of Abilene.

Further, affiant sayeth not.

Name: _____
Title: _____

ACKNOWLEDGEMENT

Before me, the undersigned authority, personally appeared _____, _____ of the General Land Office, and

SHAHAN & ERWIN, L.L.P.

Gary H. Shahan

Charles E. Erwin

Attorneys At Law
Post Office Box 6146
Abilene, Texas 79608

2 Village Drive
Century Plaza II, Suite 101
Abilene, Texas 79606

Tel: (325) 692-2292
Fax: (325) 692-6730
E-mail: sha-erw@swbell.net

July 5, 2006

Mr. Robert F. Moreland
Attorney at Law
Texas General Land Office
1700 North Congress Avenue
P. O. Box 12873
Austin, TX 78711-2873

2006 JUL -7 PM 2:26
GENERAL LAND OFFICE
LEGAL SERVICES

Re: Realigned Elm Creek, City of Abilene

Dear Mr. Moreland:

Thank you for your letter of June 29, 2006, and the proposed "Disclaimer of State Interest". It addresses the issue appropriately.

Please proceed to have the document executed and forward to me for recording.

Best wishes.

Yours very truly,

SHAHAN & ERWIN, L.L.P.

BY: 
CHARLES E. ERWIN

CEE:vc

cc: Mrs. Herbie West
3465 South 6th St.
Abilene, TX 79605

Taylor Co. Sk. File 23
sheet 11



MEMORANDUM

Texas General Land Office • Jerry Patterson • Commissioner

DATE: July 17, 2006

TO: Larry L. Laine, Chief Clerk

FROM: Bob Moreland, Legal Services
LaNell Aston, Chief Clerk's Office

SUBJECT: Request for signature on Affidavits

Background: Staff was asked to respond to two separate requests to clarify the interest of the State in certain tracts of land. The surface of one tract, in Colorado County, has been leased to the same entity for over 20 years in the mistaken belief that it reverted to state ownership upon forfeiture of the award in 1904. The other tract constitutes an original streambed in the City of Abilene that was filled and abandoned in the early 1970's when the creek was realigned as a part of a flood control project.

In the past, on several occasions the agency has filed a "Notice of State Interest" to put the public on notice that certain described parcels of land are filled submerged land even though they may appear to be a part of an adjacent littoral tract. The use of the corollary "Disclaimer of State Interest" was discussed among staff and then proposed to and accepted by the attorneys requesting clarification and documentation upon which their clients could rely when ownership came into question.

Purpose of affidavits: After substantial research and a site visit in one instance, it was the unanimous conclusion of the legal staff and surveying staff that there was no basis upon which to maintain a continuing claim of State interest in the subject lands. These affidavits were prepared to evidence these conclusions in a document that can be recorded in the local deed records to provide "notice to the world" that the State does not claim any interest in the subject lands.

Recommendation: Sign the attached affidavits, have them notarized, and transmit them to the respective attorneys for recording.

Taylor Co. SK. File 23
Sheet 12

Counter 87125

DISCLAIMER OF STATE INTEREST

STATE OF TEXAS §
 §
TRAVIS COUNTY §

BEFORE ME, the undersigned authority, on this day personally LARRY L. LAINE, of Austin, Travis County, Texas, who after being duly sworn upon oath, did depose and state as follows:

“My name is LARRY L. LAINE. I have personal knowledge of the facts and statements contained in this affidavit and each of them is true and correct. I am over the age of twenty-one (21) years, have never been convicted of a felony or a crime of involving moral turpitude, and am of sound mind and capable of making this affidavit.

“I am the Chief Clerk of the Texas General Land Office (GLO). I am authorized by the Commissioner of the GLO to make this affidavit within the scope of my assigned duties and responsibilities.

“I have caused the facts related to the relocation, diversion, and re-construction of Elm Creek in the City of Abilene to be investigated and evaluated by the Chief Surveyor and legal staff of the GLO. It is understood that Elm Creek was diverted from its original bed and realigned as a part of an extensive flood control project by the City of Abilene in 1973. The acts of the city are deemed to be in the nature of an avulsive change and must be interpreted as such.

“The original bed was filled and abandoned in the area adjacent to the 3400 block of 6th Street. The city conveyed its interest in the abandoned creek bed adjacent to their property at 3465 South 6th Street, Abilene, Texas, to Mr. and Mrs. Thomas West by Quit Claim Deed duly recorded in the records of Taylor County. Mr. and Mrs. West have paid ad valorem taxes on the abandoned creek bed since 1973.

“I have determined that the General Land Office has no statutory authority to sell, convey, or otherwise transfer the state’s interest in the bed of a navigable stream; however, based on the site visit and analysis of the facts by GLO staff, I have further determined that the State of Texas has no ownership interest in the former bed of Elm Creek in the City of Abilene. On behalf of the state, however, the GLO takes the position that any minerals underlying the realigned streambed are dedicated to the Permanent School Fund.

“I have directed that this Disclaimer of State Interest be recorded in the deed records of Taylor County and that it may be relied on by owners of property adjacent to the abandoned original bed of Elm Creek in the City of Abilene.”

Further, affiant sayeth not.

Larry L. Laine
Chief Clerk
General Land Office

ACKNOWLEDGEMENT

SUBSCRIBED AND SWORN before me on this 18th day of July, 2006, by Larry L. Laine, in his capacity as Chief Clerk of the Texas General Land Office.

(SEAL)
NOTARY WITHOUT BOND

LaNell Aston
NOTARY PUBLIC
My Commission expires: 1-22-2010

TEXAS



GENERAL LAND OFFICE

JERRY PATTERSON, COMMISSIONER

August 1, 2006

Charles E. Erwin, Esq.
Shahan & Erwin, LLP
P. O. Box 6146
Abilene, TX 79608

Re: Realigned Elm Creek, City of Abilene
Disclaimer of State Interest

Dear Mr. Erwin:

The Disclaimer of State Interest relating to the realignment of Elm Creek located in the city of Abilene, Taylor County, Texas, which you have been discussing with Bob Moreland, GLO staff attorney, has been fully executed by Larry L. Laine, Chief Clerk of the General Land Office (GLO). As Chief Clerk, Mr. Laine is authorized to act of behalf of the Land Commissioner of Texas in executing such documents.

I discussed the enclosed Disclaimer with you on the phone today and, as agreed, you will please have the document recorded in the Taylor County Real Property Records and return a file-stamped copy to me for incorporation into the records of the GLO.

If Bob or I can be of further assistance, please do not hesitate to call us.

Sincerely,

LaNell H. Aston
Program Director
Office of Chief Clerk/Deputy Land Commissioner
512-936-1921

enclosure

Stephen F. Austin Building • 1700 North Congress Avenue • Austin, Texas 78701-1495

Post Office Box 12873 • Austin, Texas 78711-2873

512-463-5001 • 800-998-4GLO Taylor Co. Sk. File 23

www.glo.state.tx.us

sheet 14

counter 87127

SHAHAN & ERWIN, L.L.P.

Gary H. Shahan

Charles E. Erwin

Attorneys At Law
Post Office Box 6146
Abilene, Texas 79608

2 Village Drive
Century Plaza II, Suite 101
Abilene, Texas 79606

Tel: (325) 692-2292
Fax: (325) 692-6730
E-mail: sha-erw@swbell.net

August 8, 2006

Ms. LaNell H. Aston, Program Director
Texas General Land Office
Box 12873
Austin, TX 78711

Re: Realigned Elm Creek, City of Abilene

Dear Ms. Aston:

Thank you for your letter of August 1, 2006, and the Disclaimer enclosed therein. As requested, a certified copy of the recorded Disclaimer is enclosed.

Your assistance is greatly appreciated.

Yours very truly,

SHAHAN & ERWIN, L.L.P.

BY: 
CHARLES E. ERWIN

CEE:vc
Enclosure

cc: Mrs. Herbie West
3465 South 6th St.
Abilene, TX 79605

Taylor Co. SK. File 23
Sheet 15

Counter 87128

DISCLAIMER OF STATE INTEREST

STATE OF TEXAS §
§
TRAVIS COUNTY §

BEFORE ME, the undersigned authority, on this day personally LARRY L. LAINE, of Austin, Travis County, Texas, who after being duly sworn upon oath, did depose and state as follows:

“My name is LARRY L. LAINE. I have personal knowledge of the facts and statements contained in this affidavit and each of them is true and correct. I am over the age of twenty-one (21) years, have never been convicted of a felony or a crime of involving moral turpitude, and am of sound mind and capable of making this affidavit.

“I am the Chief Clerk of the Texas General Land Office (GLO). I am authorized by the Commissioner of the GLO to make this affidavit within the scope of my assigned duties and responsibilities.

“I have caused the facts related to the relocation, diversion, and re-construction of Elm Creek in the City of Abilene to be investigated and evaluated by the Chief Surveyor and legal staff of the GLO. It is understood that Elm Creek was diverted from its original bed and realigned as a part of an extensive flood control project by the City of Abilene in 1973. The acts of the city are deemed to be in the nature of an avulsive change and must be interpreted as such.

“The original bed was filled and abandoned in the area adjacent to the 3400 block of 6th Street. The city conveyed its interest in the abandoned creek bed adjacent to their property at 3465 South 6th Street, Abilene, Texas, to Mr. and Mrs. Thomas West by Quit Claim Deed duly recorded in the records of Taylor County. Mr. and Mrs. West have paid ad valorem taxes on the abandoned creek bed since 1973.

“I have determined that the General Land Office has no statutory authority to sell, convey, or otherwise transfer the state’s interest in the bed of a navigable stream; however, based on the site visit and analysis of the facts by GLO staff, I have further determined that the State of Texas has no ownership interest in the former bed of Elm Creek in the City of Abilene. On behalf of the state, however, the GLO takes the position that any minerals underlying the realigned streambed are dedicated to the Permanent School Fund.

“I have directed that this Disclaimer of State Interest be recorded in the deed records of Taylor County and that it may be relied on by owners of property adjacent to the abandoned original bed of Elm Creek in the City of Abilene.”

Further, affiant sayeth not.

Larry L. Laine
Chief Clerk
General Land Office

ACKNOWLEDGEMENT

SUBSCRIBED AND SWORN before me on this 18th day of July, 2006, by Larry L. Laine, in his capacity as Chief Clerk of the Texas General Land Office.

(SEAL)
NOTARY WITHOUT BOND

NOTARY PUBLIC

My Commission expires: 1-22-2010

Taylor Co. Sk. File 23
sheet 16



True and correct
copy of original
filed in the Taylor
County Clerks Office

Counter B7129

Doc 06015039 OR
Blk 3262
Vol 484
Pg 484

Return to:
Chuck Brown
Box 6146
Meridian TX
79608

Filed for Record in:
Taylor County

On: Aug 07, 2006 at 08:09A

As a
Recording Fee

Document Number: 06015039

Amount 16.00

Receipt Number - 166908

By:
Samantha Rollins

STATE OF TEXAS COUNTY OF TAYLOR
I hereby certify that this instrument was
filed on the date and time stamped hereon by me
and was duly recorded in the volume and page
of the Official Public records of:
Taylor County

Larry G Bevill, County Clerk
Taylor County



True and correct
copy of original
filed in the Taylor
County Clerks Office

STATE OF TEXAS
COUNTY OF TAYLOR
Certified to be a True and Correct copy
of the original in my custody
Vol. 3262 Page 483
Given under my hand and seal of office
Dated August 7 AD 20 06
Larry G. Bevill
County Clerk of Taylor County, Texas,
By Samantha Rollins
Deputy

Samantha Rollins

Taylor Co. SK. File 23
Sheet 17

Counter 87130

3465 S. 6th St., Abilene, Tx.

Thu Aug 10 17:34:34 2006

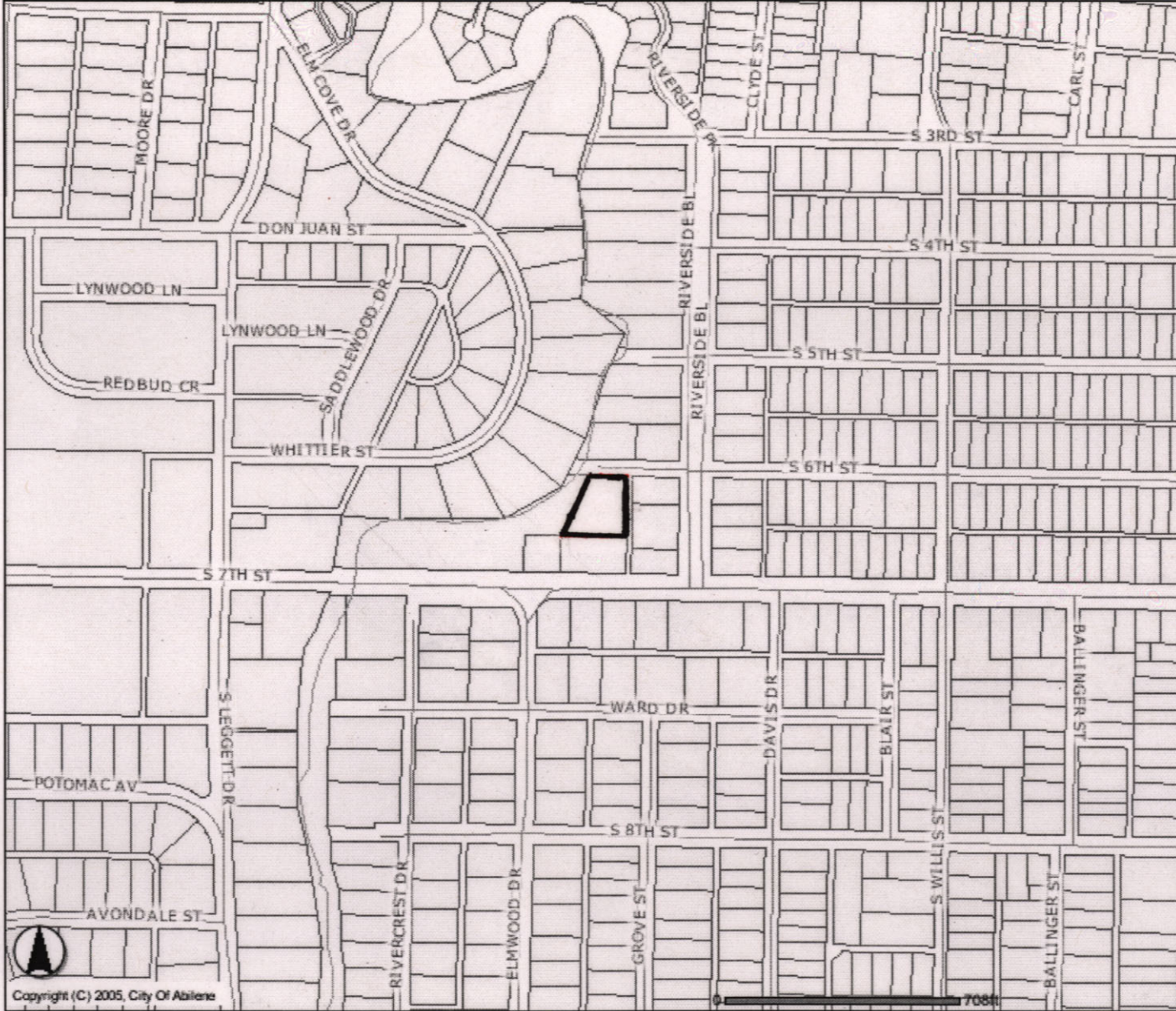

Legend

Counter 87132

Taylor Co. Sk. File 23
Sheet 18

Copyright (C) 2005, City Of Abilene

3465 S. 6th. St., Abilene, Tx.



- Upland Leases Legend**
- Permitted Wells - Tobin**
- Bottom Hole
 - Permit Location
- Completed Wells - Tobin**
- Single or Multiple Oil Well
 - ⊗ Single or Multiple Gas Well
 - ⊙ Oil and Gas Well
 - Service Well
 - Injection Well
 - ⊗ Abandoned Oil Well
 - ⊗ Abandoned Gas Well
 - ⊗ Plugged and Abandoned Well
 - ⊗ Junked and Abandoned Well
 - Bottom Hole
 - Dry Hole
 - Unknown
- USGS Quad Boundary
- Leases and Agreements**
- ▨ Pooling Agreements
 - ▨ Oil - Gas Leases
 - ▨ Hard Mineral Leases
 - ▨ PSF Surface Leases
 - ⊗ Cabins
 - ⊗ Piers, Bulkheads
 - ⊗ Dredged Channels
 - ⊗ Other overwater structures, Misc. Enclosures, Refuges, and Other leased areas.
- Text Labels**
- 520 Pooling Agreements
 - MF101888 Oil & Gas Lease Number
- Permanent School Fund Land**
- 4 - School Land Free
 - 7 - Relinquishment Act Land
 - 8 - Free Royalty Land
 - 12 - Escheat land
 - 14 - Gift
 - 15 - Surface sold - all mineral rights ravid
 - 16 - Surface sold - part minerals
 - 17 - Surface Only
 - 18 - Surface & part minerals
 - 19 - Surface & all minerals
 - 28 - Paid Minerals
 - 99 - Permanent University Fund
- Pipelines**
- ~ Anhydrous Ammonia
 - ~ Carbon Dioxide
 - ~ Crude Oil
 - ~ Empty Line
 - ~ Hydrogen Gas
 - ~ Highly Volatile Liquid
 - ~ Liquid Petroleum Gas
 - ~ Natural Gas
 - ~ Natural Gas Liquids
 - ~ Product

Copyright (C) 2006 Texas General Land Office, ESRI 0 0.19mi

Taylor Co. Sk. File 23
Sheet 19

Counter 87132