

Resurvey of Alligator Bayou

through the Motiva Enterprises, L.L.C. Area
Jefferson County, Texas

§ 33.136
Sketch

File No. Rolled Sketch 668

Jefferson County

Resurvey of Alligator Bayou

Date Filed: June 21, 2007

Jerry Patterson, Commissioner

By Douglas Howard

See Rld. Sk. 67

Joseph Butler League
Titled October 17, 1835
A-9

B.B.B. & C.
Railway Co.
Scrip 228
Section 393
A-86

Burr & Caswell
Section 11
Scrip 474
A-391

B.B.B. & C.
Railway Co.
Scrip 170
Section 397
A-91

Joseph Butler League
Titled October 17, 1835
A-9

Original
Alligator
Bayou

W. P. H.
McFaddin
School File 36871
A-645

B.B.B. & C.
Railway Co.
Scrip 167
Section 388
A-94

B. C. Arthur
1-102
A-61

B.B.B. & C.
Railway Co.
Scrip 169
Section 391
A-92

Heirs of
Isaiah Bray
3-152
A-401

LINE	BEARING	DISTANCE	LINE	BEARING	DISTANCE
L1	N 40°37'07" E	25.00'	L113	N 20°02'32" E	228.35'
L2	N 59°51'15" E	185.08'	L114	S 69°56'08" E	53.86'
L3	N 02°32'13" E	77.78'	L115	S 20°03'52" W	242.34'
L4	N 40°02'56" W	93.73'	L116	S 28°58'01" W	231.86'
L5	N 69°06'50" W	253.05'	L117	S 17°19'40" W	227.98'
L6	N 15°15'34" W	152.35'	L118	S 16°57'16" W	261.37'
L7	N 36°10'00" E	118.18'	L119	S 18°44'25" W	382.67'
L8	N 71°09'29" E	164.98'	L120	S 27°36'43" W	235.11'
L9	N 84°05'50" E	111.11'	L121	S 87°36'28" W	75.20'
L10	N 75°58'16" E	76.19'	L122	N 51°25'09" W	427.34'
L11	N 87°12'30" E	108.74'	L123	N 28°51'51" W	63.77'
L12	N 76°56'45" E	246.10'	L124	S 57°29'24" W	309.04'
L13	N 65°37'38" E	257.91'	L125	S 62°47'44" W	384.91'
L14	N 30°40'00" E	86.25'	L126	S 49°09'27" W	218.70'
L15	N 34°02'26" E	94.24'	L127	N 81°47'42" E	122.46'
L16	N 12°04'38" W	101.16'	L128	N 84°48'49" E	466.65'
L17	N 24°47'23" W	63.47'	L129	S 31°46'30" E	350.89'
L18	N 35°00'23" W	149.32'	L130	S 31°37'28" W	72.29'
L19	N 10°00'38" E	135.98'	L131	N 88°43'40" W	213.25'
L20	N 74°03'46" E	192.61'	L132	S 37°18'00" W	571.16'
L21	S 41°28'18" E	83.47'	L133	S 71°58'32" W	428.47'
L22	N 80°50'35" E	63.20'	L134	N 35°51'14" W	210.31'
L23	N 75°25'49" E	125.34'	L135	N 08°08'06" W	502.21'
L24	N 52°08'31" E	182.66'	L136	N 24°40'02" W	84.41'
L25	N 36°23'25" W	86.47'	L137	S 87°28'16" W	297.74'
L26	N 29°58'07" W	317.41'	L138	S 82°38'10" W	295.83'
L27	N 44°09'43" E	459.01'	L139	S 27°22'14" W	194.18'
L28	N 14°46'41" W	248.84'	L140	WEST	66.33'
L29	N 06°18'11" W	743.88'	L141	N 40°26'21" W	204.00'
L30	N 01°06'43" E	451.20'	L142	S 89°27'07" W	8.58'
L31	N 05°47'00" W	161.14'	L143	N 87°20'21" W	212.56'
L32	N 69°57'18" W	229.33'	L144	N 59°13'27" W	167.87'
L33	S 50°51'40" W	396.11'	L145	S 80°13'28" W	139.42'
L34	S 67°04'51" W	208.18'	L146	S 29°46'59" W	152.49'
L35	N 31°18'44" W	262.98'	L147	S 01°22'34" E	238.54'
L36	N 30°09'24" E	201.53'	L148	S 37°30'34" W	254.58'
L37	N 11°27'21" E	342.31'	L149	N 50°58'39" W	84.89'
L38	N 28°52'12" W	271.38'	L150	S 85°19'30" W	74.01'
L39	N 19°59'36" E	171.15'	L151	N 31°38'43" W	248.75'
L40	N 59°40'20" E	264.95'	L152	N 53°08'48" W	75.48'
L41	N 79°55'30" E	230.82'	L153	N 68°12'36" W	40.65'
L42	N 81°34'42" E	97.95'	L154	S 78°41'47" W	38.49'
L43	N 34°14'31" E	83.50'	L155	S 38°28'11" W	163.82'
L44	N 27°11'11" E	304.74'	L156	S 37°35'05" W	185.66'
L45	N 18°06'52" W	201.73'	L157	S 37°35'32" W	200.08'
L46	N 57°21'17" W	259.60'	L158	S 67°21'41" W	219.85'
L47	N 26°34'43" E	163.39'	L159	S 80°36'28" W	359.28'
L48	N 75°04'37" E	302.03'	L160	S 41°01'32" E	115.01'
L49	N 37°04'23" E	236.58'	L161	S 23°02'14" W	327.95'
L50	N 05°22'19" W	105.78'	L162	S 11°18'59" W	250.07'
L51	N 13°08'25" W	72.95'	L163	S 02°07'16" W	101.92'
L52	N 44°36'17" E	49.70'	L164	S 41°12'06" E	34.82'
L53	N 78°46'07" W	114.35'	L165	N 53°32'16" E	77.50'
L54	S 87°12'35" W	22.88'	L166	N 62°32'43" E	250.52'
L55	S 68°04'47" W	286.81'	L167	N 61°18'05" E	349.87'
L56	S 61°45'37" W	304.18'	L168	N 68°51'56" E	265.00'
L57	S 62°29'38" W	323.18'	L169	N 86°06'41" E	87.18'
L58	S 51°31'04" W	71.42'	L170	S 76°48'07" E	145.50'
L59	S 51°45'46" W	74.50'	L171	S 44°38'17" E	91.89'
L60	N 41°12'06" E	58.07'	L172	S 13°08'28" E	98.82'
L61	N 02°07'16" E	137.26'	L173	S 09°22'19" E	139.48'
L62	N 11°18'59" E	263.61'	L174	S 37°04'23" W	290.79'
L63	N 23°02'14" E	347.25'	L175	S 79°04'37" W	284.19'
L64	N 41°01'32" E	153.34'	L176	S 26°34'43" W	63.53'
L65	N 80°36'28" E	377.31'	L177	S 57°21'17" E	219.43'
L66	N 67°21'41" E	191.60'	L178	S 18°06'52" E	259.05'
L67	N 37°35'32" E	180.41'	L179	S 27°17'11" W	340.18'
L68	N 37°35'05" E	186.22'	L180	S 34°14'31" W	120.43'
L69	N 38°28'11" E	191.48'	L181	S 80°32'35" W	345.81'
L70	N 78°41'47" E	87.56'	L182	S 59°40'20" W	225.04'
L71	S 68°12'36" E	72.41'	L183	S 19°59'38" W	110.85'
L72	S 53°08'48" E	99.30'	L184	S 28°52'12" E	264.94'
L73	S 31°38'43" E	229.67'	L185	S 11°27'21" W	381.66'
L74	S 77°16'59" E	65.14'	L186	S 30°09'24" W	169.76'
L75	N 39°01'21" E	196.64'	L187	S 31°16'44" E	155.12'
L76	N 10°22'37" W	104.94'	L188	N 67°04'51" E	133.74'
L77	N 11°19'05" E	137.74'	L189	N 50°51'40" E	427.58'
L78	N 21°48'42" E	169.72'	L190	S 69°57'18" E	317.72'
L79	N 74°51'02" E	169.68'	L191	S 05°47'00" E	211.98'
L80	S 69°39'36" E	184.88'	L192	S 01°06'43" W	450.86'
L81	S 80°20'48" E	217.99'	L193	S 06°18'11" E	733.60'
L82	S 38°33'57" E	167.88'	L194	S 14°46'41" E	223.96'
L83	S 86°38'04" E	80.68'	L195	S 44°09'43" E	448.82'
L84	N 30°58'30" E	185.52'	L196	S 29°58'07" E	322.47'
L85	N 84°55'36" E	294.22'	L197	S 36°23'25" E	154.43'
L86	N 86°05'57" E	300.65'	L198	S 52°08'31" W	270.03'
L87	S 37°25'53" E	246.91'	L199	S 78°25'49" W	144.08'
L88	S 07°11'53" E	491.55'	L200	S 80°50'35" W	107.47'
L89	S 73°30'18" E	133.41'	L201	N 41°26'18" W	77.57'
L90	N 66°10'26" E	222.70'	L202	S 74°03'49" W	99.66'
L91	N 33°17'26" E	181.26'	L203	S 10°00'38" W	59.05'
L92	N 42°55'37" E	459.12'	L204	S 39°00'23" E	125.28'
L93	S 78°41'46" E	120.79'	L205	S 28°34'35" E	88.84'
L94	N 48°23'04" E	57.03'	L206	S 12°04'38" E	150.65'
L95	N 31°50'37" W	161.84'	L207	S 34°02'26" W	123.55'
L96	N 70°34'12" W	85.40'	L208	S 30°40'00" W	107.37'
L97	S 83°46'12" W	499.10'	L209	S 65°37'38" W	288.54'
L98	S 81°43'38" W	205.90'	L210	S 78°56'45" W	280.07'
L99	N 16°26'15" W	94.51'	L211	S 87°12'30" W	126.33'
L100	N 73°33'46" E	125.75'	L212	N 79°58'16" W	76.13'
L101	N 52°02'48" E	349.11'	L213	S 84°05'50" W	89.72'
L102	N 86°26'12" E	425.15'	L214	S 71°09'29" W	133.33'
L103	N 54°24'25" E	190.63'	L215	S 36°16'00" W	57.22'
L104	N 70°43'23" E	56.41'	L216	S 18°15'34" E	70.14'
L105	S 66°46'39" E	162.98'	L217	S 62°07'05" E	59.19'
L106	S 48°15'23" E	177.79'	L218	S 69°06'50" E	181.17'
L107	S 37°26'28" E	158.75'	L219	S 40°02'56" E	141.74'
L108	N 55°01'33" E	57.82'	L220	S 02°32'13" W	147.05'
L109	N 23°05'37" E	583.36'	L221	S 59°51'15" W	212.95'
L110	N 14°24'29" E	233.15'	L222	S 40°37'07" W	8.74'
L111	N 19°28'20" E	198.18'	L223	N 53°48'41" W	74.20'
L112	N 28°39'45" E	257.57'			

All bearings, distances, and acreages are grid and are referred to the Texas Plane Coordinate System, NAD 83, South Central Zone, U. S. survey feet. Gamma angle for the project is +02°28'03" and the combined scale factor is 0.999910334.
Placement of survey lines shown is approximate.

I, Nedra J. Foster, do hereby certify that this plat reflects an actual survey made by me on the ground and according to law. The limits and boundaries are truly described just as I found them on the ground on the current channel. Points shown on the current channel of Alligator Bayou (which also coincides in places with the original channel) were on the line of mean high water or mean higher high water at the time of my survey, January 3, 2007. Lines connecting these points are meander lines. The original Alligator Bayou shown in blue has been determined from historical documents: USGS topographical maps from 1943 through 2004, 1930's era aerial photography, original field notes of grants in area, construction drawings from Texaco files from 1914, 1927, through to more current plats.
Given under my hand and seal this 19th day of January, 2007.

Nedra J. Foster
Nedra J. Foster
Licensed State Land Surveyor



Coordinate Pairs at Segment Ends:

- Segment A:
 - ① N: 13904474.82 E: 3561930.74
 - ② N: 13904428.73 E: 3561989.28
 - ③ N: 13904944.24 E: 3562829.06
 - ④ N: 13904873.42 E: 3562865.87
- Segment B:
 - ⑤ N: 13905601.11 E: 3563457.90
 - ⑥ N: 13905547.66 E: 3563823.85
 - ⑦ N: 13905798.82 E: 3563618.13
 - ⑧ N: 13905749.60 E: 3563678.86
- Segment C:
 - ⑨ N: 13906174.83 E: 3564026.27
 - ⑩ N: 13906063.16 E: 3564021.08
 - ⑪ N: 13906138.28 E: 3564241.17
 - ⑫ N: 13906053.37 E: 3564241.99
- Segment D:
 - ⑬ N: 13906161.35 E: 3564521.85
 - ⑭ N: 13906070.55 E: 3564529.91
 - ⑮ N: 13906207.82 E: 3565114.87
 - ⑯ N: 13906121.60 E: 3565120.75
- Segment E:
 - ⑰ N: 13906250.62 E: 3565338.96
 - ⑱ N: 13906159.97 E: 3565365.70
 - ⑲ N: 13906800.44 E: 3566332.81
 - ⑳ N: 13906744.67 E: 3566352.31
- Segment F:
 - ㉑ N: 13907061.52 E: 3566987.95
 - ㉒ N: 13907027.53 E: 3567033.77
 - ㉓ N: 13907912.87 E: 3567313.06
 - ㉔ N: 13907894.39 E: 3567363.65

§33.136 SKETCH NO. 668
COUNTY Jefferson

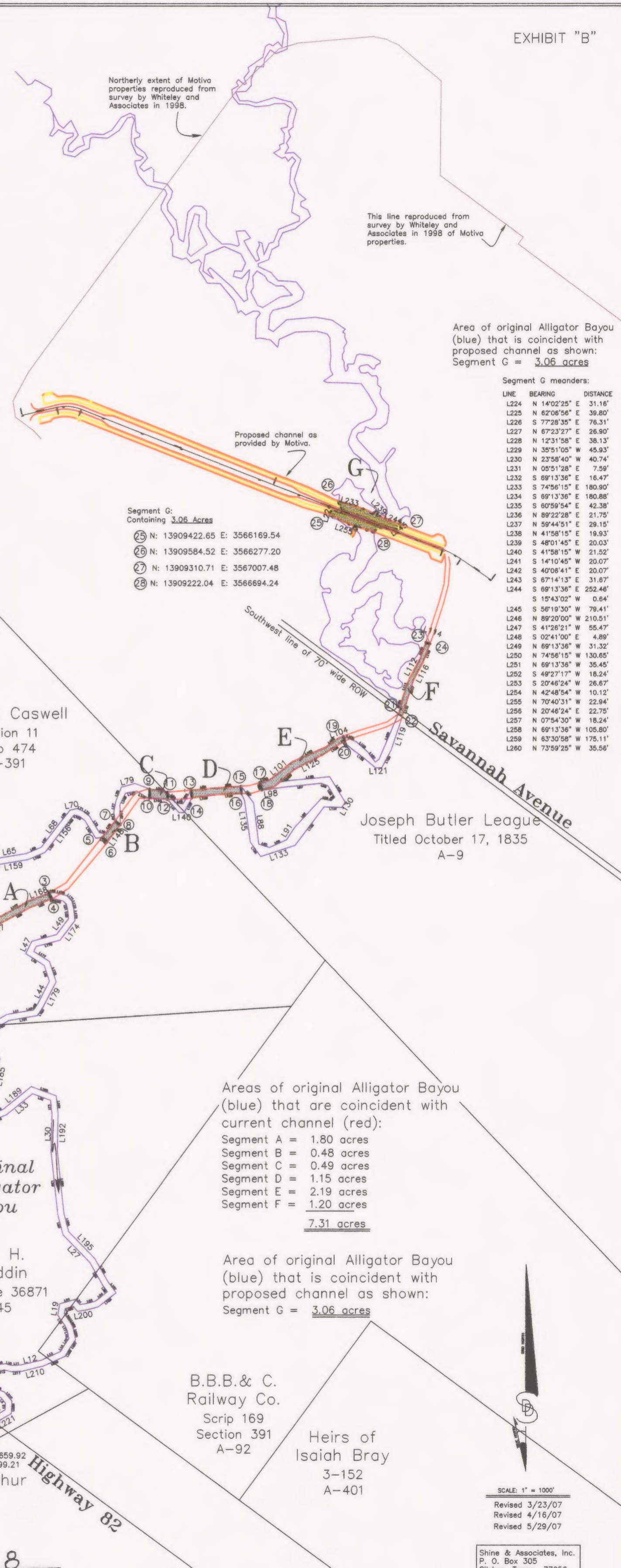

Northerly extent of Motiva properties reproduced from survey by Whiteley and Associates in 1998.

This line reproduced from survey by Whiteley and Associates in 1998 of Motiva properties.

Area of original Alligator Bayou (blue) that is coincident with proposed channel as shown:
Segment G = 3.06 acres

Segment G meanders:

LINE	BEARING	DISTANCE
L224	N 14°02'25" E	31.16'
L225	N 62°06'56" E	39.80'
L226	S 77°28'35" E	76.31'
L227	N 67°23'27" E	26.90'
L228	N 12°31'58" E	38.13'
L229	N 35°51'05" W	45.33'
L230	N 23°58'40" W	40.74'
L231	N 05°51'28" E	7.59'
L232	S 69°13'36" E	16.47'
L233	S 74°56'15" E	180.90'
L234	S 69°13'36" E	180.88'
L235	S 80°59'54" E	42.38'
L236	N 89°22'28" E	21.75'
L237	N 59°44'51" E	29.15'
L238	N 41°58'15" E	18.93'
L239	S 48°01'45" E	20.03'
L240	S 41°58'15" W	21.52'
L241	S 14°10'45" W	20.07'
L242	S 40°08'41" E	20.07'
L243	S 67°14'13" E	31.67'
L244	S 69°13'36" E	252.46'
L245	S 15°43'02" W	0.84'
L246	N 89°20'00" W	79.41'
L247	S 41°26'21" W	55.47'
L248	S 02°41'00" E	4.89'
L249	N 69°13'36" W	31.32'
L		