

J:\SWACAD\Projects\2006\48573\DWG\00\Exhibits\4-10-04-SURVEY-LSLS\48573-00-T1.dwg 7/5/2007 10:47:21 AM CDT

SURFSIDE TOWNSITE

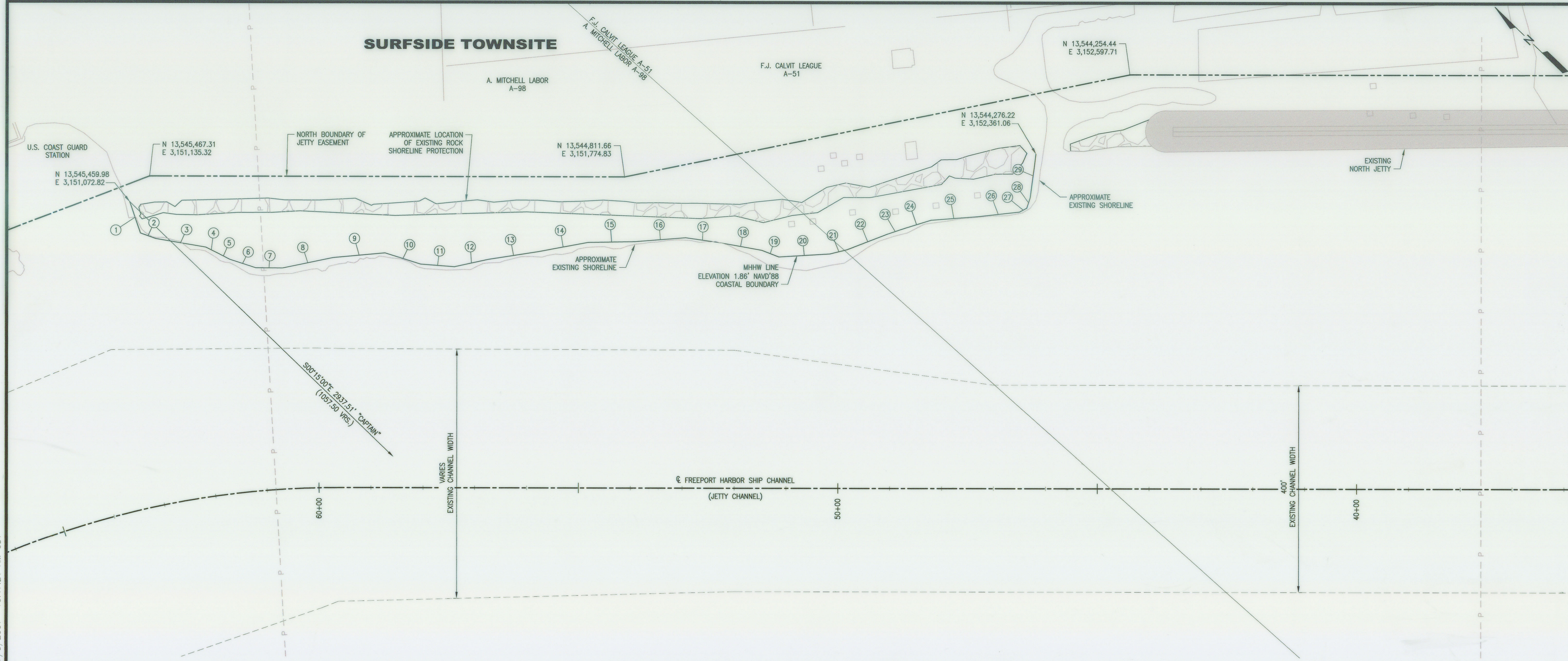

**COASTAL BOUNDARY SURVEY
ENLARGED PARTIAL PLAN - JETTY CHANNEL**

TEXAS GENERAL LAND OFFICE
Art. 33.136, Natural Resources Code
Co. Brazoria, Sketch No. 9, sh. 1
File Date 9-7-2007 by D.J.H.
See Shits. 2 & 3, small format

WE, HDR | SHINER MOSELEY AND ASSOCIATES, INC., HEREBY STATE THAT THIS DRAWING REPRESENTS THE CONDITIONS THAT EXISTED AT THE TIME OF THE COASTAL BOUNDARY SURVEY CONDUCTED ON APRIL 6, 2007.
NOTICE: THIS SURVEY WAS PERFORMED IN ACCORDANCE WITH SECTION 33.136, NATURAL RESOURCES CODE, FOR THE PURPOSE OF EVIDENCING THE LOCATION OF THE SHORELINE IN THE AREA DEPICTED IN THIS SURVEY AS THAT SHORELINE EXISTED BEFORE COMMENCEMENT OF EROSION RESPONSE ACTIVITY, AS REQUIRED BY CHAPTER 33, NATURAL RESOURCES CODE. THE LINE DEPICTED ON THIS SURVEY FIXES THE SHORELINE FOR THE PURPOSE OF LOCATING A SHORELINE BOUNDARY, SUBJECT TO EROSION LANDWARD AS PROVIDED BY SECTION 33.136, NATURAL RESOURCES CODE.



George Rubalcaba 7/5/07
GEORGE RUBALCABA
LICENSED STATE LAND SURVEYOR

DESC.	BEARING	DISTANCE
1	S26°42'14"W	64.39'
2	S24°21'25"E	30.86'
3	S34°35'21"E	97.88'
4	S17°57'58"E	24.66'
5	S16°49'30"E	26.86'
6	S26°19'23"E	53.43'
7	S43°59'28"E	51.89'
8	S56°03'54"E	99.22'
9	S49°34'51"E	100.69'
10	S26°42'39"E	71.61'
11	S39°55'42"E	65.71'
12	S56°41'11"E	67.40'
13	S53°13'31"E	97.64'
14	S54°59'33"E	97.24'
15	S45°16'26"E	90.53'
16	S48°53'00"E	97.72'
17	S36°07'10"E	65.85'
18	S34°05'37"E	83.06'
19	S22°59'05"E	35.46'
20	S47°44'05"E	98.49'
21	S58°23'30"E	35.53'
22	S65°39'49"E	82.97'
23	S63°10'44"E	29.86'
24	S61°40'31"E	57.28'
25	S48°50'24"E	88.65'
26	S50°41'40"E	83.16'
27	S73°02'45"E	15.73'
28	N63°21'43"E	21.72'
29	N52°55'15"E	84.93'

NOTES

- ALL SURVEYING WAS PERFORMED BY HDR | SHINER MOSELEY AND ASSOCIATES, INC. FROM GPS OBSERVATIONS. THIS DRAWING REPRESENTS THE CONDITION THAT EXISTED AT THE TIME OF THE SURVEY CONDUCTED APRIL 6, 2007.
FIELD PERSONNEL: GEORGE RUBALCABA, BRUCE JACKSON, HOMER MARTINEZ
- ALL ELEVATIONS SHOWN ARE IN FEET AND ARE REFERENCED TO NAVD '88.
- COORDINATES SHOWN ARE GRID IN U.S. FEET AND REFERENCED TO STATE PLANE GRID COORDINATE SYSTEM, SOUTH CENTRAL ZONE, AS DEFINED BY ARTICLE 21.071 OF THE NATURAL RESOURCES CODE OF THE STATE OF TEXAS, 1983 DATUM (1993 ADJUSTMENT).
- MONUMENTS USED FOR HORIZONTAL CONTROL WERE:
"CAPTAIN" N 13,542,613.78 E 3,151,799.53
MONUMENTS USED FOR VERTICAL CONTROL WERE:
"CAPTAIN" ELEV. 9.70' NAVD'88
"Z 1255" ELEV. 7.02' NAVD'88
- MEAN HIGHER HIGH WATER DETERMINED FROM TIDAL INFORMATION AT TCOON FREEPORT GAUGE NO. 056
- BASIS OF BEARINGS IS "TEXAS COORDINATE SYSTEM" PER SECTION 21.071 OF THE NATIONAL RESOURCES CODE.
- DISTANCES AND BEARINGS ARE GRID. SCALE FACTOR IS 0.99988744 CONVERGENCE IS +1'48"46.0".
- UPLAND OWNER IS BRAZOS RIVER HARBOR NAVIGATION DISTRICT.

LEGEND

- NORTH BOUNDARY OF JETTY EASEMENT
- EXISTING PIPELINE

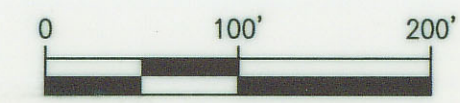
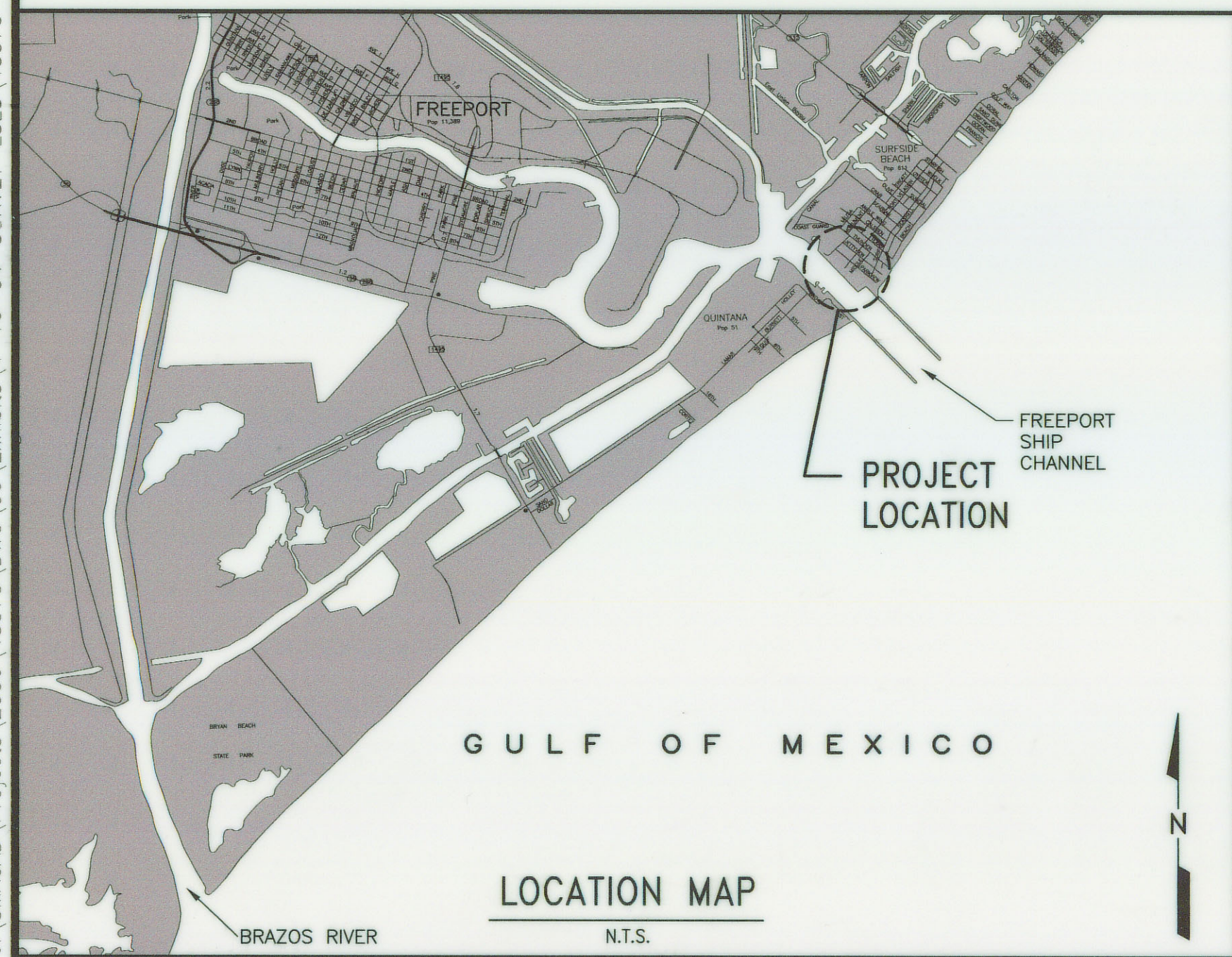

REV	DATE	DESCRIPTION	APP
0	4/13/07	SUBMITTED TO GLO	
1	5/8/07	REVISIONS PER GLO COMMENTS	
2	7/2/07	REVISIONS PER GLO COMMENTS	

BLJ	4/13/07	AS SHOWN	
GR	4/13/07	48573-00-T1	
NO		48573	

HDR SHINER MOSELEY AND ASSOCIATES, INC.	
555 N. Carancahua, Suite 1650 Corpus Christi, Texas 78478	
PORT FREEPORT	TEXAS
FREEPORT CHANNEL WIDENING	BRAZORIA COUNTY
COASTAL BOUNDARY SURVEY	
SHEET	T1
OF 1	REV 2



**SHINER MOSELEY
AND ASSOCIATES, INC.**

July 5, 2007

200.48573

Mr. Bill O'Hara
Texas General Land Office
1700 N. Congress Avenue
Austin, Texas 78701-1495

**RE: SURVEY AT QUINTANA BEACH AND FREEPORT CHANNEL,
BRAZORIA COUNTY, TEXAS (STATE COASTAL BOUNDARY
SURVEY)**

Dear Mr. O'Hara:

Enclosed are the State Coastal Boundary Survey drawings and metes and bounds descriptions of the above referenced sites depicting the revisions as per your comments of May 29, 2007.

Your letter with the comments was apparently lost in the mail and only found its way to my desk last Friday.

Thanks again for your time and assistance on this project. If you should have any questions, please call me at (361) 857-2211.

Sincerely,

HDR ENGINEERING, INC.

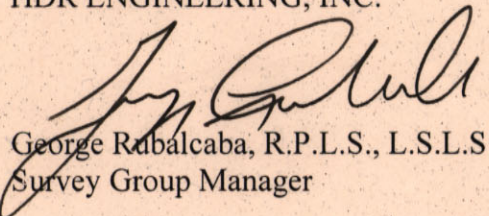
George Rubalcaba, R.P.L.S., L.S.L.S.
Survey Group Manager

GR/vmn

Enclosures: State Coastal Boundary Survey Drawings
State Coastal Boundary Metes and Bounds

TEXAS GENERAL LAND OFFICE
Art. 33.136, Natural Resources Code

Co. Brazoria, Sketch No. 9 sh. 2
Small format

File Date 9-7-2007 by D.J.H.

COASTAL BOUNDARY SURVEY
METES AND BOUNDS DESCRIPTION
AT FREEPORT CHANNEL

Being the coastal boundary along the north shoreline of the Freeport Harbor Ship Channel determined from an on the ground survey conducted by GPS observations on April 6, 2007, said coastal boundary being the Mean Higher High Water line determined from TCOON Freeport Gauge No. 056 at elevation +1.86' NAVD '88 located within portions of the A. Mitchell Labor, A-98, and the F.J. Calvit League, A-51, and this coastal boundary being more particularly described by metes and bounds as follows:

Beginning at the west end of this surveyed coastal boundary, said beginning point having a grid coordinate of N 13,545,459.98, E 3,151,072.82, State Plane Grid, Texas South Central Zone, NAD'83 in U.S. feet and bearing N 0° 15' 00" W, 2937.51 feet (1057.50 varas) from NGS monument "CAPTAIN" having grid coordinates of N 13,542,613.78', E 3,151,799.53', NAD '83 (1993 adjustment) State of Texas Coordinate System, South Central Zone as defined by Article 21.071 of the Natural Resources Code of the State of Texas, Scale Factor 0.99988744, convergence +1°48'46.0";

Thence along said coastal boundary as follows:

S 26-42-14 W, 64.39 feet (23.18 varas);
S 24-21-25 E, 30.86 feet (11.11 varas);
S 34-35-21 E, 97.88 feet (35.24 varas);
S 17-57-58 E, 24.66 feet (8.88 varas);
S 16-49-30 E, 26.86 feet (9.67 varas);
S 26-19-23 E, 53.43 feet (19.34 varas);
S 43-59-28 E, 51.89 feet (18.68 varas);
S 56-03-54 E, 99.22 feet (35.72 varas);
S 49-34-51 E, 100.69 feet (36.25 varas);
S 26-42-39 E, 71.61 feet(25.78 varas);
S 39-55-42 E, 65.71 feet(23.66 varas);
S 56-41-11 E, 67.40 feet(24.26 varas);
S 53-13-31 E, 97.64 feet(35.15 varas);
S 54-59-33 E, 97.24 feet(35.01 varas);
S 45-16-26 E, 90.53 feet(32.59 varas);
S 48-53-00 E, 97.72 feet(35.18 varas);
S 36-07-10 E, 65.65 feet(23.63 varas);
S 34-05-37 E, 83.06 feet(29.90 varas);
S 22-59-05 E, 35.46 feet(12.77 varas);
S 47-44-05 E, 98.49 feet(35.46 varas);
S 58-23-30 E, 35.63 feet(12.83 varas);
S 65-39-49 E, 82.97 feet(29.87 varas);
S 63-10-44 E, 29.86 feet(10.75 varas);
S 61-40-31 E, 57.28 feet(20.62 varas);
S 48-50-24 E, 88.65 feet(31.91 varas);
S 50-41-40 E, 83.16 feet(29.94 varas);
S 73-02-45 E, 15.73 feet(5.66 varas);
S 63-21-43 E, 21.72 feet(7.82 varas);

N 52-55-15 E, 84.93 feet (30.57 varas), to the east end of this surveyed coastal boundary, said point of termination having a coordinate of N 13,544,276.22, E 3,152,361.06;

TEXAS GENERAL LAND OFFICE
Art. 33.136, Natural Resources Code

Co. Brazoria, Sketch No. 9, sht. 3
small format

File Date 9-7-2007 by D.J.H.



[Handwritten Signature]
7/9/07

Note: Bearings based on "Texas Coordinate System" per Section 21.071 of the Natural Resources Code.

5-221-06

Counter 87928