

VICINITY MAP
NORTH GALVESTON COUNTY, TX
(NOT TO SCALE)

DETENTION AREA
DRAINAGE RESERVE "A"
(PLAT REC. 2004A, MAP No. 130-131 GCMR)

H.G.C.S.D. No. 54
N: 13,748,468.00'
E: 3,176,255.29'
CONVERGENCE ANGLE: 1°51'37.66553"
GRID SCALE FACTOR: 0.999867513

POINT OF TERMINATION
N: 13,750,374.58'
E: 3,181,293.14'
CONVERGENCE ANGLE: 1°52'05.92806"
GRID SCALE FACTOR: 0.999867554

LINE	BEARING	DISTANCE
L1	S 21°35'29" W	33.94
L2	S 28°52'35" W	37.81
L3	S 28°21'54" W	12.67
L4	S 19°58'59" W	27.97
L5	S 20°48'54" W	25.13
L6	S 18°52'19" W	11.19
L7	S 00°13'32" E	7.62
L8	S 23°28'39" W	10.79
L9	S 49°35'58" W	13.31
L10	S 57°16'20" W	18.83
L11	S 55°20'44" W	10.71
L12	S 87°26'56" W	8.09
L13	S 72°26'44" W	20.98
L14	S 73°06'55" W	33.43
L15	S 87°11'43" W	29.22
L16	S 78°39'24" W	16.78
L17	S 86°32'53" W	19.26
L18	S 71°40'46" W	9.51
L19	S 58°46'19" W	16.72
L20	S 77°00'37" W	26.82
L21	S 75°08'20" W	17.86
L22	S 78°11'48" W	26.64
L23	S 81°30'51" W	26.43

LOT 1
FINAL PLAT OF HOPE LUTHERAN CHURCH OF FRIENDSWOOD
(PLAT REC. 18, MAP No. 391 GCMR)

RESERVE "A"
(PLAT REC. 18, MAP No. 391 GCMR)
DRAINAGE RESERVE DEDICATED TO GALVESTON COUNTY
CONSOLIDATED DRAINAGE DISTRICT

TIDE GAUGE
N: 13,750,733.53'
E: 3,181,681.81'

POINT OF BEGINNING
N: 13,750,607.07'
E: 3,181,634.93'
CONVERGENCE ANGLE: 1°52'07.86426"
GRID SCALE FACTOR: 0.999867585

SARAH MCKISSICK A-151
FIRST CLASS HEADRIGHT
1 LEAGUE - SURVEYED MARCH 1861

RESERVE "A"
LAKE SITE
(PLAT REC. 18, MAP No. 294 GCMR)

NOTES:

- ALL COORDINATES SHOWN HEREON REFER TO THE TEXAS STATE COORDINATE SYSTEM OF 1983 - SOUTH CENTRAL ZONE, AS DEFINED BY ARTICLE 21.070 OF THE NATURAL RESOURCE CODE OF THE STATE OF TEXAS, AND ARE SHOWN IN U.S. SURVEY FEET.
- ALL DISTANCES ARE GRID DISTANCES AND ARE SHOWN IN U.S. SURVEY FEET AND VARAS.
- ALL BEARINGS SHOWN HEREON ARE GRID BEARINGS AND REFER TO THE TEXAS STATE COORDINATE SYSTEM OF 1983 - SOUTH CENTRAL ZONE, AS DEFINED BY ARTICLE 21.070 OF THE NATURAL RESOURCE CODE OF THE STATE OF TEXAS.
- LOCAL TIDE GAUGE REFERENCED TO:
CLEAR LAKE, TX
NATIONAL OCEAN SERVICE STATION
ID# 8770933
LENGTH OF SERIES: 3 YEARS
TIDAL EPOCH: 1983 - 2001
CONTROL TIDE STATION: 8771450
GALVESTON PIER 21,
GALVESTON CHANNEL
- ON THE DATE OF THIS SURVEY THERE WAS NO APPARENT ARTIFICIAL FILL PLACED UPON OR ADJACENT TO THE LINE OF MEAN HIGH WATER AS SHOWN ON THIS SURVEY.

NOTICE:

This survey was performed in accordance with Section 33.136, Natural Resources Code, for the purpose of evidencing the location of the shoreline in the area depicted in this survey as that shoreline existed before commencement of erosion response activity, as required by Chapter 33, Natural Resources Code. The line depicted on this survey fixes the shoreline for the purpose of locating a shoreline boundary, subject to movement landward as provided by Section 33.136, Natural Resources Code.

This survey does not nor is intended to be used to identify, delineate or fix the line of vegetation or the landward boundary of the public beach.

Lines shown were surveyed on the ground by Stephen C. Blaskey, Marty Barkdull, and Larry Hammaker on April 16, 2009.

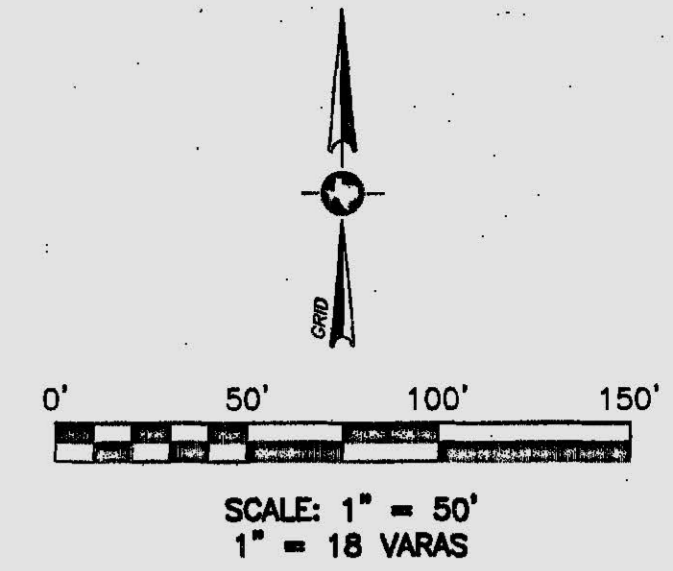

Mean High Water line survey of a part of the Sarah McKissick Survey, Abstract 151, Galveston County, Texas, being 27.6 miles N 61°51'27" W of the Old Galveston County Courthouse and being described more fully described by metes and bounds as follows:

COMMENCING at N.G.S. Monument H.G.C.S.D. 54 (N: 13,758,468.00', E: 3,176,255.29');

THENCE N 68°18'58" E, a distance of 5,789.31 feet (2,084.2 varas) to a point on the Mean High Water line of the South bank of Chigger Creek, also known as Chigoe Bayou, and the POINT OF BEGINNING of the herein described line (N: 13,750,607.07', E: 3,181,634.93')

THENCE meandering the said Mean High Water line along the following courses and distances:

- L1 THENCE S 21°35'29" W, a distance of 33.94 feet (12.2 varas);
- L2 THENCE S 28°52'35" W, a distance of 37.81 feet (13.6 varas);
- L3 THENCE S 28°21'54" W, a distance of 12.67 feet (4.6 varas);
- L4 THENCE S 19°58'59" W, a distance of 27.97 feet (10.1 varas);
- L5 THENCE S 20°48'54" W, a distance of 25.13 feet (9.0 varas);
- L6 THENCE S 18°52'19" W, a distance of 11.19 feet (4.0 varas);
- L7 THENCE S 00°13'32" E, a distance of 7.62 feet (2.7 varas);
- L8 THENCE S 23°28'39" W, a distance of 10.79 feet (3.9 varas);
- L9 THENCE S 49°35'58" W, a distance of 13.31 feet (4.8 varas);
- L10 THENCE S 57°16'20" W, a distance of 18.83 feet (6.8 varas);
- L11 THENCE S 55°20'44" W, a distance of 10.71 feet (3.9 varas);
- L12 THENCE S 87°26'56" W, a distance of 8.09 feet (2.9 varas);
- L13 THENCE S 72°26'44" W, a distance of 20.98 feet (7.6 varas);
- L14 THENCE S 73°06'55" W, a distance of 33.43 feet (12.0 varas);
- L15 THENCE S 87°11'43" W, a distance of 29.22 feet (10.5 varas);
- L16 THENCE S 78°39'24" W, a distance of 16.78 feet (6.0 varas);
- L17 THENCE S 86°32'53" W, a distance of 19.26 feet (6.9 varas);
- L18 THENCE S 71°40'46" W, a distance of 9.51 feet (3.4 varas);
- L19 THENCE S 58°46'19" W, a distance of 16.72 feet (6.0 varas);
- L20 THENCE S 77°00'37" W, a distance of 26.82 feet (9.7 varas);
- L21 THENCE S 75°08'20" W, a distance of 17.86 feet (6.4 varas);
- L22 THENCE S 78°11'48" W, a distance of 26.64 feet (9.6 varas);
- L23 THENCE S 81°30'51" W, a distance of 26.43 feet (9.5 varas) to the POINT OF TERMINATION of the herein described line (N: 13,750,374.58', E: 3,181,293.14').

April 16, 2009

I certify that on the above date, the herein described property, was surveyed in the field according to the law under my direction, and this map together with dimensions and coordinates is true and correct as of the above date.

COASTAL SURVEYING OF TEXAS, INC.

Stephen C. Blaskey

Stephen C. Blaskey
Licensed State Land Surveyor
email: stephen@surveygalveston.com

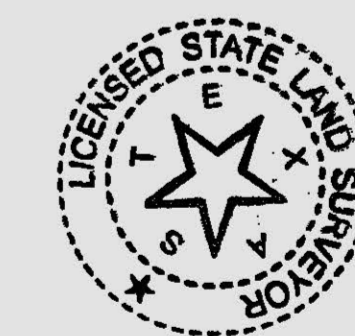

MEAN HIGH WATER SURVEY OF PART OF THE
SOUTH BANK OF CHIGGER CREEK (AKA CHIGOE BAYOU)
LYING WITHIN THE SARAH MCKISSICK SURVEY, ABSTRACT
151, GALVESTON COUNTY, TEXAS
N 61°51'27" W, 27.6 MILES OF THE
OLD GALVESTON COUNTY COURTHOUSE

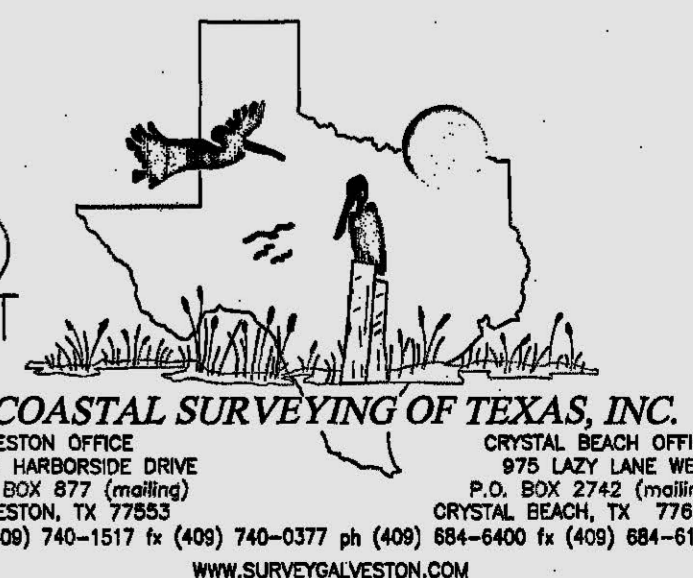



**Surveying Division
Coastal Boundary Survey Approval**

Project: Chigger Creek (aka Chigoe Bayou) Channel Alignment

Project No: CL20090003 (GLO)

Project Manager: Jeffrey Davis, GLO Upper Coast
Surveyor - Stephen Blaskey, LSLS, Coastal Surveying of Texas

Description: Coastal Boundary Survey situated on the right (south or east) bank of Chigger Creek (aka Ghigoe Bayou), same line being a boundary of the Sarah McKissick Survey, Abstract 151, approximately one-tenth of a mile west of the center of Friendswood Drive (FM Road 518), Galveston County.

A Coastal Boundary Survey for the above-referenced project has been reviewed and accepted. Upon completion of public notice requirements, the survey will be filed in the Texas General Land Office, Archives and Records, in accordance with provisions of the *Texas Natural Resources Code*, Chapter 33.136.

Approved:

Signed:

David A. Pyle

Survey Division

July 16, 2009

Date

Approval Filed as:

Tex. Nat. Res. Code Article 33.136 Galveston County Report No. 55

TEXAS GENERAL LAND OFFICE

Art. 33.136, Natural Resources Code

Co. Galveston, Sketch No. 55A

File Date 06/18/2018 by R. Kartye

Stephen F. Austin Building • 1700 North Congress Avenue • Austin, Texas 78701-1495

Post Office Box 12873 • Austin, Texas 78711-2873

512-463-5001 • 800-998-4GLO

www.glo.state.tx.us

TEXAS GENERAL LAND OFFICE

Art. 93.136, Natural Resources Code

Co. Galveston, Sketch No. 55A

File Date 06/18/2018 by R. Kartye

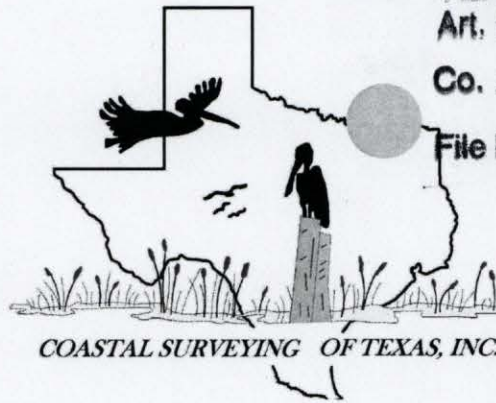

975 Lazy Lane West, Crystal Beach, TX 77650
P.O. Box 2742, Crystal Beach, TX 77650 (mailing)
Sidney Bouse
RPLS No. 5287

8017 Harborside Drive, Galveston, TX 77554
(mailing) P.O. Box 877 Galveston, TX 77553
Stephen C. Blaskey
RPLS No. 5856

SURVEYOR'S REPORT
On the Mean High Water Survey of Part of the South Bank
Of Chigger Creek (AKA Chigoe Bayou) lying within the
Sarah McKissick Survey, Abstract 151
Galveston County, Texas

The line of Mean High Water of part of the South Bank of Chigger Creek (AKA Chigoe Bayou) lying within the Sarah McKissick Survey, Abstract 151, Galveston County, Texas was surveyed under my direction as authorized by Chuck L. Davis on behalf of the Galveston County Consolidated Drainage District, and in my capacity as Licensed State Land Surveyor for the State of Texas.

HISTORY

The Sarah McKissick Survey, Abstract 151, is a First Class Headright survey of one league of land lying in Galveston and Harris Counties. This tract was surveyed in March 1861, and reexamined and corrected September 3, 1863.

CONSTRUCTION

The elevation of the Mean High Water line of this project site was determined by establishing a temporary tide gauge at the location shown on the accompanying drawing. This gauge collected data from March 29, 2009, until April 3, 2009. The collected data was then correlated to the Control Gauge that was utilized for this project, Clear Lake, TX, National Ocean Service Station ID# 8770933. The calculated elevation was then transferred to the shoreline through the use of a surveyor's level, and then located horizontally through the use of conventional surveying methods. This report and the accompanying drawing reflect the result of this work.

Stephen C. Blaskey
Licensed State Land Surveyor
April 16, 2009

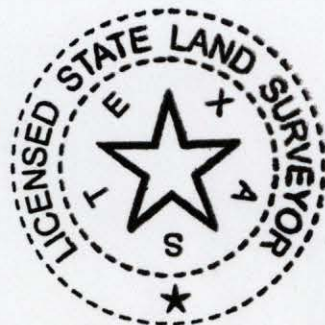

A F F I D A V I T

RECEIVED

SEP 08 2009

GENERAL LAND OFFICE

Attachment

TEXAS GENERAL LAND OFFICE
NOTICE OF APPROVAL OF COASTAL BOUNDARY SURVEY

Pursuant to §33.136 of the Texas Natural Resources Code, notice is hereby given that Jerry Patterson, Commissioner of the Texas General Land Office (GLO), has approved a Coastal Boundary Survey, conducted in April, 2009 by Stephen C. Blakey, a Licensed State Land Surveyor. Written approval is filed, in GLO records, as Galveston County, Art. 33.136, Report No. 55. Said survey locates the following shoreline boundary:

Situated on the right (south or east) bank of Ghigger Creek (aka Ghigoe Bayou), same line being a boundary of the Sarah McKissick Survey, Abstract 151, approximately onetenth of a mile west of the center of Friendswood Drive (FM Road 518), Galveston County.

For a copy of the approval and/or the survey, contact Archives & Records, Texas General Land Office at (512) 463-5277.

Published: August 27 & September 3, 2009
00220049

County of Galveston §
§
State of Texas §

Before me, the undersigned authority, on this day personally came and appeared Lois Colvin, to me well known (or proved to me on the basis of satisfactory evidence), and who after being duly sworn (affirmed) did depose and say that she is an AGENT for THE GALVESTON COUNTY DAILY NEWS, a newspaper of general circulation, which has been continuously and regularly published for a period of not less than one year, in the County of Galveston, and that the NOTICE, a copy of which is hereto attached was published in said newspaper on the following days, to wit:

August 27 & September 3, 2009

Lois Colvin
Agent Signature

Sworn and subscribed before me

On this the 3rd day of Sept, 2009

Lynette Tisdale
Notary for the State of Texas

TEXAS GENERAL LAND OFFICE
Art. 33.136, Natural Resources Code

Co. Galveston, Sketch No. 55A

File Date 06/18/2012 by R. Kartye

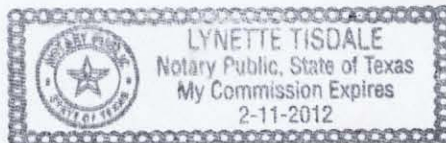

**TEXAS GENERAL LAND OFFICE
NOTICE OF APPROVAL OF COASTAL BOUNDARY SURVEY**

Pursuant to §33.136 of the Texas Natural Resources Code, notice is hereby given that Jerry Patterson, Commissioner of the Texas General Land Office (GLO), has approved a Coastal Boundary Survey, conducted in April, 2009 by Stephen C. Blaskey, a Licensed State Land Surveyor. Written approval is filed, in GLO records, as Galveston County, Art. 33.136, Report No. 55. Said survey locates the following shoreline boundary:

Situated on the right (south or east) bank of Ghigger Creek (aka Ghigoe Bayou), same line being a boundary of the Sarah McKissick Survey, Abstract 151, approximately one-tenth of a mile west of the center of Friendswood Drive (FM Road 518), Galveston County.

For a copy of the approval and/or the survey, contact Archives & Records, Texas General Land Office at (512) 463-5277.

TEXAS GENERAL LAND OFFICE
Art. 33.136, Natural Resources Code

Co. Galveston, Sketch No. SSA

File Date 06/18/2018 by R. Kartye