

C.W. EGERY, A-111
 City of Portland, Texas
 52.48 Acre Tract
 File No. 299446 (O.P.R.S.P.C.T.)
 Area 35.2 Acres, Nov. 2013

TEXAS GENERAL LAND OFFICE
 Art. 33.136, Natural Resources Code
 Co. San Patricio, Sketch No. 7
 File Date 8/19/2014, by J. Naismith

LINE	BEARING	DISTANCE	VARAS
L1	N 72°12'52" E	168.86'	60.79v
L2	N 72°01'51" E	295.13'	106.25v
L3	N 82°53'56" E	104.76'	37.71v
L4	S 79°18'46" E	49.62'	17.86v
L5	S 45°35'39" E	94.43'	34.00v
L6	S 87°26'42" E	64.66'	23.28v
L7	S 79°03'54" E	131.84'	47.46v
L8	S 58°26'19" E	39.32'	14.15v
L9	N 12°58'06" E	24.80'	8.93v
L10	N 81°48'47" E	17.28'	6.22v
L11	S 17°28'10" E	59.15'	21.29v
L12	S 08°16'50" E	74.70'	26.89v
L13	S 55°59'08" E	49.85'	17.96v
L14	S 87°46'38" E	72.59'	26.13v
L15	S 36°13'32" E	84.55'	30.44v
L16	S 12°38'34" E	53.39'	19.22v
L17	S 11°00'10" W	90.44'	32.56v
L18	S 14°11'57" E	90.79'	32.69v
L19	S 24°34'51" E	108.36'	39.01v
L20	S 27°25'28" E	89.37'	32.71v
L21	N 03°39'49" E	78.53'	27.27v
L22	N 80°39'55" E	42.48'	15.29v
L23	N 40°22'50" E	200.97'	72.35v
L24	N 10°34'10" E	49.47'	17.81v
L25	N 38°30'14" W	79.53'	28.63v
L26	N 39°24'44" E	92.51'	33.30v
L27	N 55°43'12" E	118.83'	42.78v
L28	N 27°50'08" E	43.92'	15.81v
L29	N 01°43'33" E	110.45'	39.76v
L30	N 28°30'24" E	71.30'	25.87v
L31	N 50°41'01" E	118.12'	42.52v
L32	N 24°44'37" E	65.49'	23.55v
L33	N 41°14'03" E	138.52'	49.87v
L34	N 38°19'52" E	449.49'	161.82v
L35	N 45°01'52" E	262.21'	94.40v
L36	N 49°07'58" E	308.00'	110.88v

- NOTES:
- ALL COORDINATES REFER TO THE TEXAS STATE PLANE COORDINATE SYSTEM, SOUTH ZONE (#4205), AS DEFINED BY ARTICLE 21.071 OF THE NATURAL RESOURCES CODE OF THE STATE OF TEXAS, 1983 DATUM, US FEET. ALL BEARINGS ARE LAMBERT GRID BEARINGS AND ALL DISTANCES GRID. THE SCALE FACTOR IS 1.00000869 AND MAPPING ANGLE IS 00d 31' 04".
 - COORDINATES AND ELEVATIONS ARE BASED ON MONUMENTS & ON OPUS SOLUTIONS.
 "MARIAH" PID: DH4664
 N = 17,200,025.97
 E = 1,352,830.82
 NAVD 88 = 3.1'
 - MEAN HIGH WATER (MHW) ELEVATION OF 1.2' FOR CORPUS CHRISTI BAY WAS DETERMINED FROM TEXAS STATE AQUARIUM TIDE GAUGE DATA.
 - TO CONVERT FEET TO VARAS MULTIPLY BY 0.36.
 - UPLAND TRACT LINES SHOWN HEREON ARE BASED ON DEED DESCRIPTIONS AND APPRAISAL DISTRICT MAPS, LINES ARE SHOWN FOR REFERENCE ONLY.
 - EROSION RESPONSE WORK WILL CONSIST OF THE FOLLOWING:
 - ENHANCING THE EXISTING BARRIER RIDGE PROTECTING THE ADJACENT WETLANDS BY BENEFICIALLY UTILIZING STOCKPILED MATERIAL LOCATED ONSITE.
 - ERECTING ROCK STRUCTURES CONSISTING OF GROINS AND BREAKWATERS TO PROTECT THE SITE FROM THE FORCES OF EROSION.
 ALL WORK IS TO BE CONDUCTED UNDER CEPPA PROJECT NO. 1527 (SUBMERGED LAND OWNED BY PORT OF CORPUS CHRISTI).
 - REFERENCE ACCOMPANYING REPORT AND FIELD NOTES DATED NOVEMBER, 2013 FOR ADDITIONAL INFORMATION.
 - BACKGROUND IMAGE FROM GOOGLE EARTH AND IS FOR REFERENCE ONLY.

I, JAMES M. NAISMITH, HEREBY STATE THAT THIS DRAWING REPRESENTS A SURVEY THAT IS CORRECT; AND IN ACCORDANCE WITH SECTION 21.042, TEXAS NATURAL RESOURCES CODE; WAS MADE ACCORDING TO LAW; WAS MADE IN THE FIELD UNDER MY DIRECT CONTROL AND SUPERVISION; WAS MADE UTILIZING METHODOLOGY APPROVED BY THE GLO; AND IS RECORDED IN

NOTICE: THIS SURVEY WAS PERFORMED IN ACCORDANCE WITH SECTION 33.136, NATURAL RESOURCES CODE, FOR THE PURPOSE OF EVIDENCING THE LOCATION OF THE SHORELINE IN THE AREA DEPICTED IN THIS SURVEY AS THAT SHORELINE EXISTED BEFORE COMMENCEMENT OF EROSION RESPONSE ACTIVITY, AS REQUIRED BY CHAPTER 33, NATURAL RESOURCES CODE. THE LINE DEPICTED ON THIS SURVEY FIXES THE SHORELINE FOR THE PURPOSE OF LOCATING A SHORELINE BOUNDARY, SUBJECT TO MOVEMENT LANDWARD AS PROVIDED BY SECTION 33.136, NATURAL RESOURCES CODE.

EXCEPT RIP RAP AS NOTED, NO FILL OR BUILDUP IS LOCATED WITHIN THE SURVEYED AREA AND NO RETAINING WALLS OR STRUCTURAL MODIFICATIONS HAVE BEEN PLACED ALONG THE SURVEYED LITTORAL BOUNDARY.

SURVEYED: JANUARY AND NOVEMBER, 2013 SURVEY PERSONNEL: JAMES M. NAISMITH B.S. GAMBILL

JM 8/19/2014
 JAMES M. NAISMITH
 LICENSED STATE LAND SURVEYOR

STATE TRACT 41

STATE TRACT 26

STATE TRACT 40

PORT OF CORPUS CHRISTI
 3929.1 ACRE TRACT NO. 2
 PATENT 106
 REFUGIO SCRIP SF-1930

CORPUS CHRISTI BAY
 NUECES COUNTY

N:17,197,626.55
 E:1,354,840.25

Naismith Marine Sea Floor Surveying 3765 South Alameda, Suite 205 Corpus Christi, Texas 78411 WWW.NAISMITHMARINE.COM (361) 945-0248	NO.	DATE	REVISION	COASTAL BOUNDARY SURVEY OF THE LITTORAL BOUNDARY OF A 37.7 ACRE UPLAND TRACT IN THE C.W. EGERY SURVEY, A-111 ADJACENT TO PATENT 106 CORPUS CHRISTI BAY, NUECES CO. TEXAS
	SCALE: 1" = 200'	DATE: NOV. 2013	SHEET: 1 OF 1	



**Surveying Division
Coastal Boundary Survey Approval**

Project: Indian Point Shoreline Protection

Project No: CEPRA 1527

Project Manager: Amy Nunez (GLO-Upper Coast Regional Manager)
Michael Weeks (GLO-Coastal Project Planner)

Surveyor: James M. Naismith, Licensed State Land Surveyor

Description: Being a Coastal Boundary Survey, dated January and November 2013, by James M. Naismith, Licensed State Land Surveyor, delineating the line of Mean High Water along the northerly shore of Corpus Christi Bay and submerged lands described in Patent No. 106 (Refugio Scrip, SF-1930), from the State of Texas, same line being a portion of the littoral boundary of the C. W. Egery Survey, A-111. The survey is in support of a proposed shoreline protection project, consisting of rock groin and breakwater construction, under Coastal Erosion Planning and Response Act (CEPRA) project No. 1527. The site is situated at the Philip Dimitt Municipal Fishing Pier on Indian Point (coordinates N 27° 51' 02", W 97° 21' 16", WGS84) and extends both westward to the right-of-way of US Highway No. 181 and easterly along the shore approximately 2000 feet.

A Coastal Boundary Survey for the above-referenced project has been reviewed and accepted; upon completion of public notice requirements, the survey will be filed in the Texas General Land Office, Archives and Records, in accordance with provisions of the *Texas Natural Resources Code*, Chapter 33.136.

Approved:

Signed: _____

David A. Ryle
Surveying Division

July 18, 2014
Date

Approval Filed as:

Tex.Nat.Res.Code Article 33.136 San Patricio County, Sketch No. 7

TEXAS GENERAL LAND OFFICE
Art. 33.136, Natural Resources Code
Co. San Patricio, Sketch No. 7

File Date 04/16/18 by K. Schreiber

Stephen F. Austin Building • 1700 North Congress Avenue • Austin, Texas 78701-1495

Post Office Box 12873 • Austin, Texas 78711-2873

512-463-5001 • 800-998-4GLO

www.glo.state.tx.us



July 8, 2014

Mr. David Pyle
Texas General Land Office
1700 N. Congress Ave.
Suite 935
Austin, Texas 78701-1495

RE: Coastal Boundary Survey map and report: Indian Point, San Patricio County, Texas

David Pyle:

Please find enclosed two signed and sealed Coastal Boundary Survey maps and one accompanying report for Indian Point, San Patricio County, Texas. One Coastal Boundary Survey map is printed without aerial photography background on Mylar; the other map includes aerial photography and is printed in color on paper. If you have any questions please do not hesitate to call or email.

Thank you,

Justin ZAC Giessel
Naismith Marine Services, Inc.
zac@naismithmarine.com
361-920-0436

Encl.

- 1 Coastal Boundary Survey map (Mylar)
- 1 Coastal Boundary Survey map (paper with aerial photography)
- 1 Coastal Boundary Survey report

TEXAS GENERAL LAND OFFICE
Art. 33.136, Natural Resources Code
Co. San Patricio, Seals No. 7
File Date 09/16/18 by K. Schreiber

Naismith Marine Services, Inc.
3765 South Alameda, Suite 205
Corpus Christi, Texas 78411
(361) 945-0248 www.naismithmarine.com



November 6, 2013

Report of a Coastal Boundary Survey

THE LITTORAL BOUNDARY OF A 37.7 ACRE UPLAND TRACT
IN THE C.W. EGERY SURVEY, A-111
ADJACENT TO PATENT 106
CORPUS CHRISTI BAY, NUECES CO. TEXAS

to accompany map of survey dated November, 2013
Indian Point, Corpus Christi Bay



Survey Area (Google Earth)

The property is located at the end of the peninsula that separates Nueces Bay from Corpus Christi Bay. Historically this area has been referred to as "Indian Point". The land was first surveyed in 1855 for C.W. Egery. The land surveyed is described as "...all of the vacant land on the said peninsula (South West of Henry Smith's Survey) not subject to overflow by high tide water." The boundary between the upland owner and the State of Texas is set at this time. C.W. Egery is listed as a chain carrier on the original survey by William R. Reid, District Surveyor for San Patricio District.

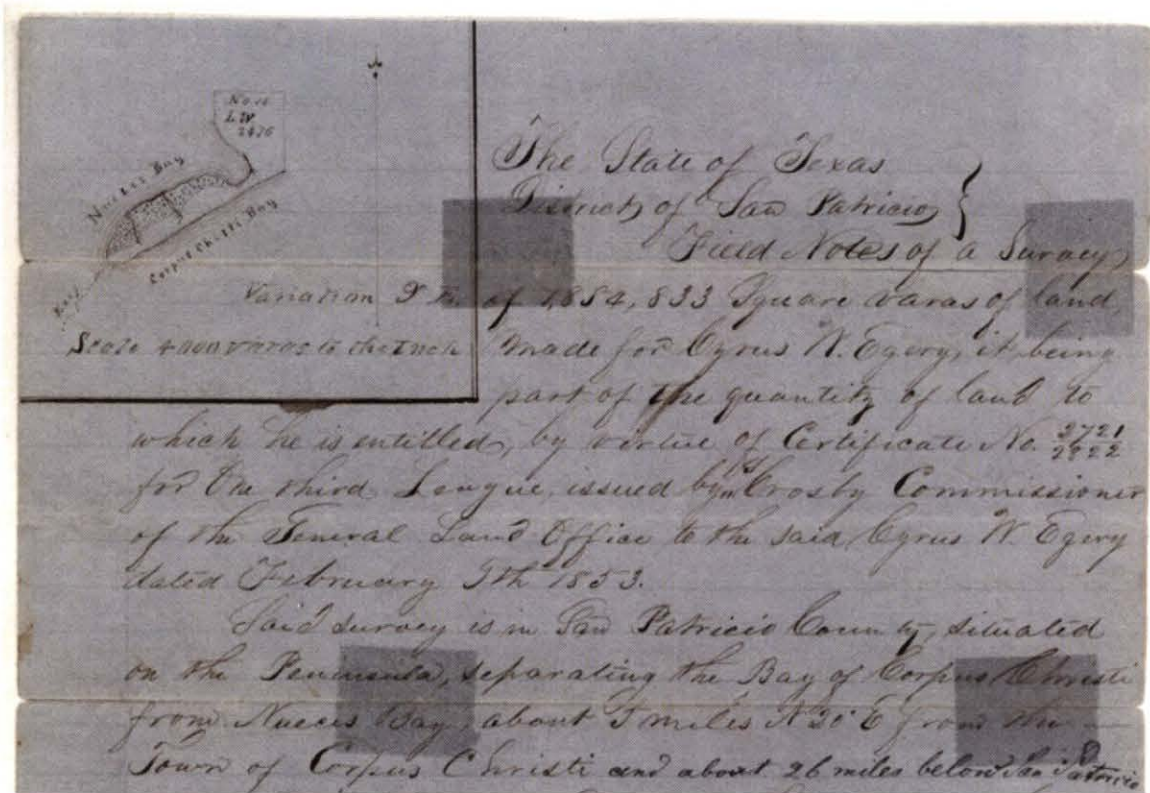

Original 1855 Egery Survey

The Peninsula was re-surveyed in 1950 by H.A. Pierce, Licensed State Land Surveyor. An application was made by the current owner to purchase excess acreage in the survey claiming the land that had accreted to the survey. The owner of the peninsula in 1950 is the Medical-Professional Building Corporation of Corpus Christi.

Court decisions, not related to this survey, in 1958 and 1964 set the delineation between the state and upland private ownership at either Mean Higher High Water or Mean High Water for grants made after 1840. This sets the southeast line of the Egery survey at the Mean High Water line along the shoreline of Corpus Christi Bay.

TEXAS GENERAL LAND OFFICE
Art. 33.136, Natural Resources Code

Co. San Patricio, Sketch No. 7
File Date 04/16/18 by K. Schreiber

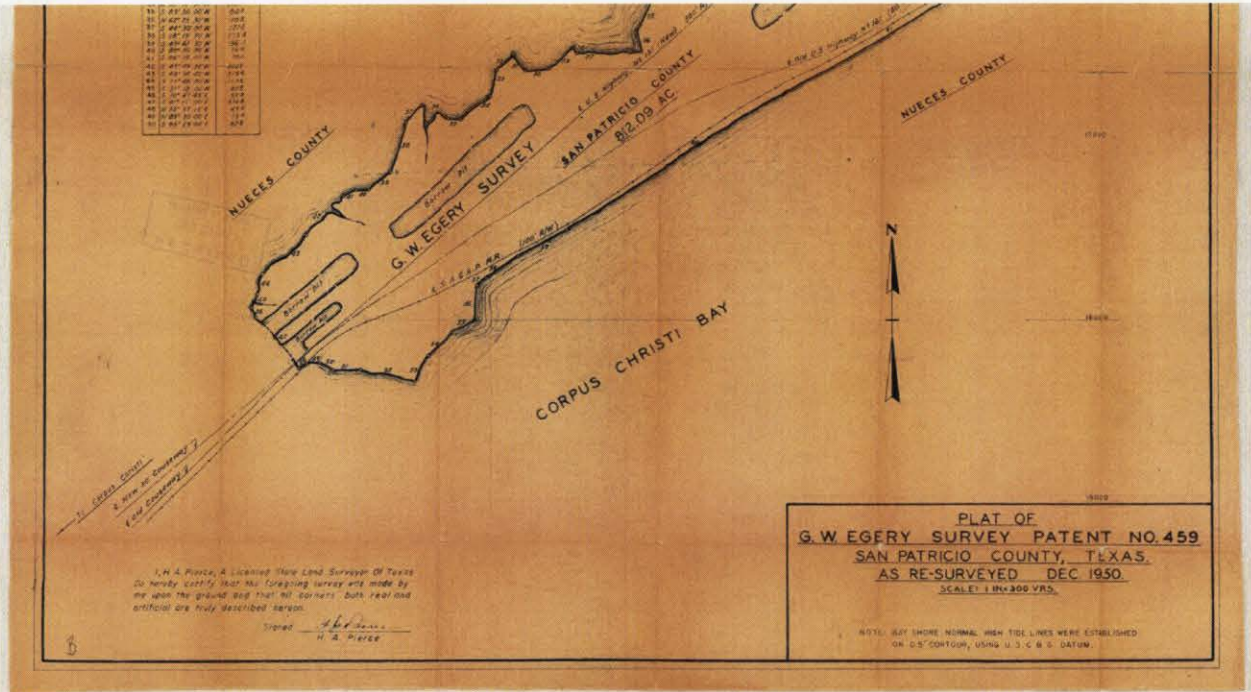

Pierce 1950 Survey

In 1951 the 'Nueces County Navigation District No. 1' purchased the submerged lands along the southeast side of the peninsula. The tract was surveyed by C.E. Haberer, Jr., Licensed State Land Surveyor and filed by Conrad M. Blucher, County Surveyor of Nueces County.

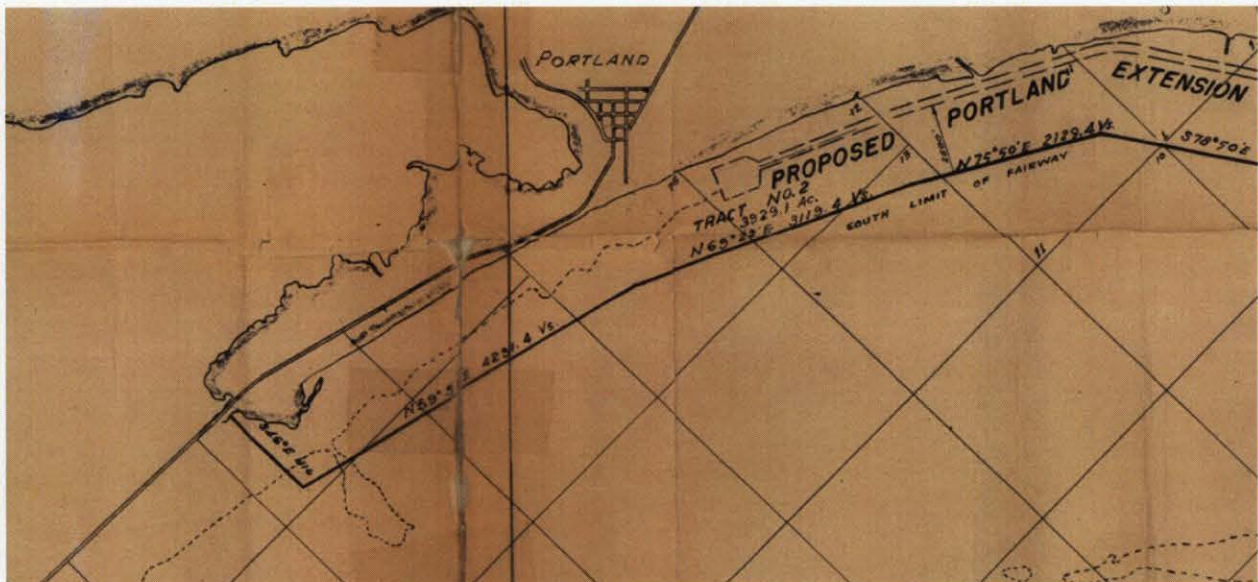

Port of Corpus Christi 1951 "Tract 2" Survey

TEXAS GENERAL LAND OFFICE
 Art. 33.136, Natural Resources Code
 Co. San Patricio, Sketch No. 7
 File Date 04/16/18 by K. Schreiber

The excess acreage issue for the upland owner was apparently settled in court and the northwest line of the Egery survey was placed at an agreed location. It was surveyed and staked by Conrad M. Blucher in 1960. The southeast line of the Egery survey was left as is and continues to follow the Mean High Water (Tide) line.

333 3
333 3
333 3
333 3
333 3
333 3
333 3
333 3
333 3
333 3
333 3
333 3

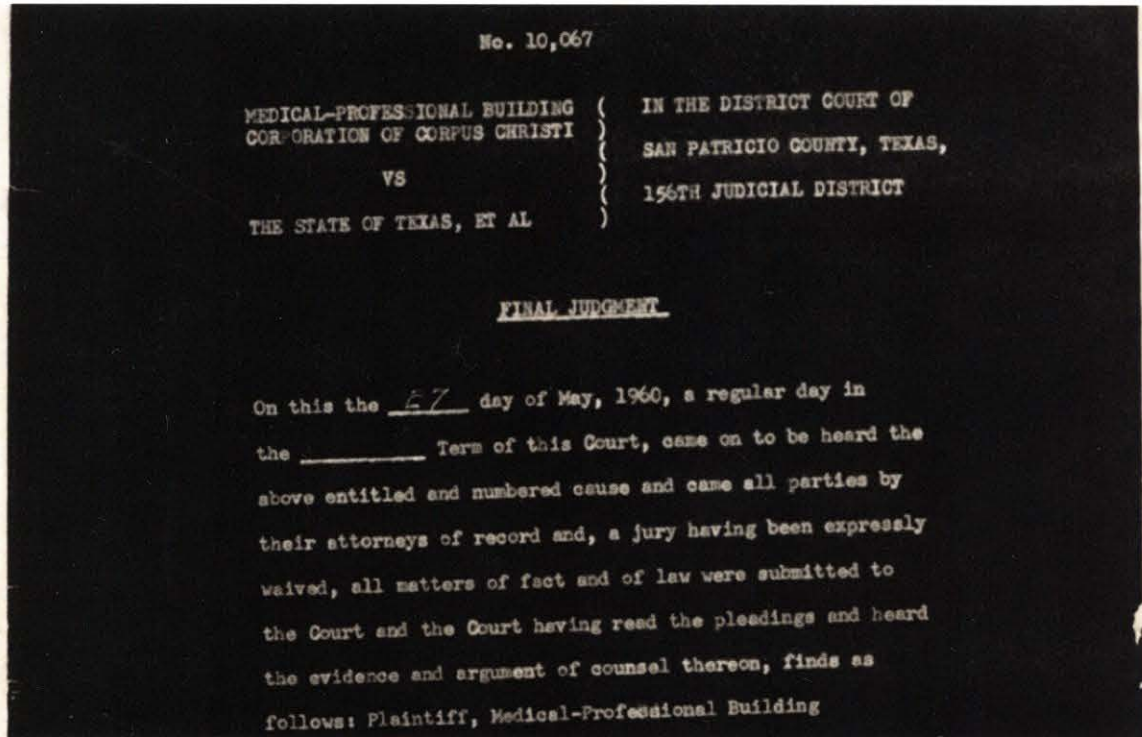

Final Judgment for Egery Survey

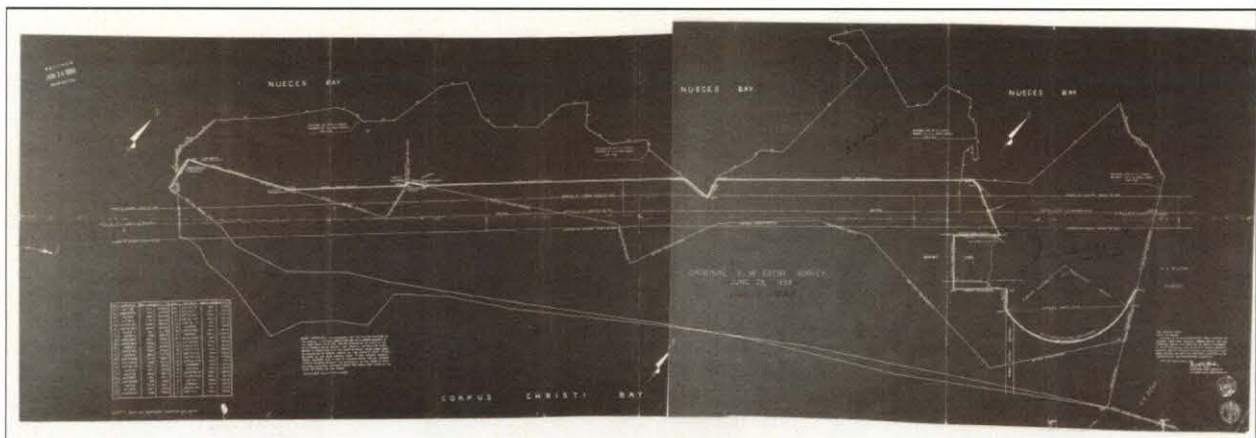

Blucher 1960 Plat of Judgment Line

TEXAS GENERAL LAND OFFICE
Art. 33.136, Natural Resources Code
Co. San Patricio, Sketch No. 7
File Date 04/16/18 by K. Schreiber

In 1981 the 'Medical-Professional Building Corporation of Corpus Christi' sold two tracts, a 4.6 acre and a 52.5 acre, of land to the 'City of Portland'. The surveys follow the southeast line of the Egery survey which is along the Mean High Water (Tide) line. At the time of the sale, it was clear to both parties that the boundary moves with the shoreline. The following statement is included in the deeds: "...that the actual land area covered by this conveyance is uncertain, due to the uncertainty of the shoreline boundary on the eastern boundary..."

289475
 WARRANTY DEED
 MEDICAL PROFESSIONAL BUILDING CORPORATION OF CORPUS CHRISTI
 TO
 THE CITY OF PORTLAND, TEXAS

FILED FOR RECORD
 JUL 28 1981
 DOTTIE MALEY
 CLERK COUNTY CLERK SAN PATRICK CO. TEX.
 [Signature]

PREPARED IN THE LAW OFFICE OF:
 Robert M. Kendrick
 P. O. Drawer 2824
 Corpus Christi, TX 78403
 (512) 888-4271

PLEASE RETURN TO:
 CHARGE AND RETURN TO:
COASTAL TITLE COMPANY
 103 W. BROADWAY
 PORTLAND, TEXAS 78374
 [Signature] BFM 5203-PT

(Corporate Acknowledgment)

THE STATE OF ~~TEXAS~~ Louisiana }
 COUNTY OF ~~WILCOX~~ Jefferson }

Before me, the undersigned authority, on this day personally appeared **MICHAEL J. RAPIER**, President of Medical Professional Building Corporation of Corpus Christi, a corporation, known to me to be the person whose name is subscribed to the foregoing instrument, and acknowledged to me that he executed the same for the purposes and consideration therein expressed, in the capacity therein stated and as the act and deed of said corporation.

Given under my hand and seal of office on this the 22 day of July, A.D. 1981.

[Signature]
 Notary Public in and for the State of Louisiana
 My commission expires out health 19
 [Signature]
 (Printed or typed name of officer)

1981 City of Portland Deed

TEXAS GENERAL LAND OFFICE
 Art. 33.136, Natural Resources Code
 Co. San Patricio, Sketch No. 7
 File Date 04/16/18 by K. Schreiber

Survey Methodology

Upland surveying was completed with GPS-RTK. The base was stationed at NGS control point "Mariah".

Datums

Horizontal Datum is NAD83, Texas South Central Zone, US Feet and varas.

Vertical Datum is NAVD88, Mean High Water (MHW) determined at Tide Station 'Texas State Aquarium'. Note that the published NAVD88 values at the Tide Gauge are approximately 0.2 different than the NGS published values at Indian Point. Mean High Water is 1.2 feet NAVD88 for this survey.

Proposed Erosion Response Activity

The nature of the erosion response activities consist of placing geotextile tubes filled with dredged material from a nearby permitted borrow area to protect existing vegetated marsh and future marsh restoration features from erosion forces.

CEPRA Project Number 1527 (Submerged land owned by the Port of Corpus Christi)

Equipment

GPS-RTK – Hemisphere S320
Conventional Survey equipment as required

Personnel

Project Surveyor: James M. Naismith, RPLS, LSLs

Crew Chief: Benjamin S. Gambill

Field Notes of the littoral boundary of a 37.7 acre tract of land consisting of a 35.2 acre tract of land (called 52.48 acres) described in a deed to the City of Portland, file no. 299446 OPRSPCT, and a 2.5 acre tract (called 4.605 acres) described in a deed to the City of Portland, file no. 299447 OPRSPCT; in the C.W. Egery Survey, A-111, adjacent to "Patent 106", a portion of State Tract 41 patented to the Nueces County Navigation District No. 1 (now the Port of Corpus Christi), described in Refugio Scrip SF-1930 filed at the Texas General Land Office;

Beginning at N = 17,200,152.25, E = 1,353,106.86 a point on the shoreline of Corpus Christi Bay at the west end of a 35.2 acre (called 52.48 acre) tract described in file no. 299446 OPRSPCT, from which NGS control point "MARIAH" bears S 65°25'01" W, a distance of 303.55' 109.28v;

thence N 72°12'52" E, along the mean high water line of the shoreline of Corpus Christi Bay a distance of 168.86' 60.79v;

thence N 72°01'51" E a distance of 295.13' 106.25v;

thence N 82°53'56" E a distance of 104.76' 37.71v;

thence S 79°16'46" E a distance of 49.62' 17.86v;

thence S 45°35'39" E a distance of 94.43' 34.00v;
thence S 82°26'42" E a distance of 64.66' 23.28v;
thence S 79°03'54" E a distance of 131.84' 47.46v;
thence S 58°26'19" E a distance of 39.32' 14.15v;
thence N 12°58'06" E a distance of 24.80' 8.93v;
thence N 81°48'47" E a distance of 17.28' 6.22v;
thence S 17°28'10" E a distance of 59.15' 21.29v;
thence S 08°16'50" E a distance of 74.70' 26.89v;
thence S 55°59'08" E a distance of 49.95' 17.98v;
thence S 87°46'38" E a distance of 72.59' 26.13v;
thence S 36°13'32" E a distance of 84.55' 30.44v;
thence S 12°38'34" E a distance of 53.39' 19.22v;
thence S 11°00'10" W a distance of 90.44' 32.56v;
thence S 14°11'57" E a distance of 90.79' 32.69v;
thence S 24°34'51" E a distance of 108.36' 39.01v;
thence S 27°29'28" E a distance of 89.37' 32.17v;
thence N 03°38'49" W a distance of 78.53' 28.27v;
thence N 80°39'55" E a distance of 42.48' 15.29v;
thence N 40°22'50" E a distance of 200.97' 72.35v;
thence N 10°34'10" E a distance of 49.47' 17.81v;
thence N 38°30'14" W a distance of 79.53' 28.63v;
thence N 39°24'44" E a distance of 92.51' 33.30v;
thence N 55°43'12" E a distance of 118.83' 42.78v;
thence N 27°50'08" E a distance of 43.92' 15.81v;
thence N 01°49'33" E a distance of 110.45' 39.76v;
thence N 26°30'24" E a distance of 71.30' 25.67v;
thence N 50°41'01" E a distance of 118.12' 42.52v;
thence N 24°44'37" E a distance of 65.49' 23.58v;
thence N 41°14'03" E a distance of 138.52' 49.87v;
thence N 38°19'52" E a distance of 449.49' 161.82v;
thence N 45°01'52" E a distance of 262.21' 94.40v;
thence N 49°07'58" E a distance of 308.00' 110.88v;
to N = 17,201,247.62, E = 1,355,560.48, which is the **end point**, from which NGS control point "MARIAH"
bears S 65°53'21" W, a distance of 2,990.56' 1,076.60v.

 7/8/2018
James M. Naismith, RPLS, LSLS

Naismith Marine Services, Inc.

TEXAS GENERAL LAND OFFICE
Art. 33.136, Natural Resources Code
Co. San Patricio, Sketch No. 7
File Date 04/16/18 by K. Schreiber

Texas Register, Volume 39, Number 34, Pages 6295-6760, August 22, 2014 Page: 6,747

Notice of Approval of Coastal Boundary Survey

Pursuant to §33.136 of the Texas Natural Resources Code, notice is hereby given that Jerry Patterson, Commissioner of the General Land Office, approved a coastal boundary survey described as follows:

Being a Coastal Boundary Survey, dated January and November 2013, by James M. Naismith, Licensed State Land Surveyor, delineating the line of Mean High Water along the northerly shore of Corpus Christi Bay and submerged lands described in Patent No. 106 (Refugio Serip, SF-1930), from the State of Texas, same line being a portion of the littoral boundary of the C. W. Egery Survey, A-111. The survey is in support of a proposed shoreline protection project, consisting of rock groin and breakwater construction, under Coastal Erosion Planning and Response Act (CEPRA) project No. 1527. The site is situated at the Philip Dimitt Municipal Fishing Pier on Indian Point (coordinates N 27° 51' 02", W 97° 21' 16", WGS84) and extends both westward to the right-of-way of US Highway No. 181 and easterly along the shore approximately 2000 feet.

This survey is intended to provide pre-project baseline information related to an erosion response activity on coastal public lands. An owner of uplands adjoining the project area is entitled to continue to exercise littoral rights possessed prior to the commencement of the erosion response activity, but may not claim any additional land as a result of accretion, reliction, or avulsion resulting from the erosion response activity.

For a copy of this survey or more information on this matter, contact Bill O'Hara, Director of the Survey Division, Texas General Land Office, by phone at (512) 463-5212, email bill.o'hara@glo.texas.gov or fax (512) 463-5223.

TRD-201403822
Larry L. Laine
Chief Clerk, Deputy Land Commissioner
General Land Office
Filed: August 13, 2014

Notice of Approval of Coastal Boundary Survey

Pursuant to §33.136 of the Texas Natural Resources Code, notice is hereby given that Jerry Patterson, Commissioner of the General Land Office, approved a coastal boundary survey described as follows:

Being a Coastal Boundary Survey, dated January and March 31, 2014, by Stephen C. Blaskey, Licensed State Land Surveyor, delineating the line of Mean Higher High Water along the shore of Galveston Bay and submerged lands of Chambers & Liberty Co Navigation District, Abstract 680. The survey is in support of a proposed marsh creation under Texas Parks and Wildlife Department, Project No. 444784, is located at Houston Point, near the confluence of Trinity Bay, the San Jacinto River and Galveston Bay (coordinates N 29° 39' 41", W 94° 55' 31", WGS84) and extends easterly, to near Center Point Road, then northwesterly approximately 3600 feet.

This survey is intended to provide pre-project baseline information related to an erosion response activity on coastal public lands. An owner of uplands adjoining the project area is entitled to continue to exercise littoral rights possessed prior to the commencement of the erosion response activity, but may not claim any additional land as a result of accretion, reliction, or avulsion resulting from the erosion response activity.

For a copy of this survey or more information on this matter, contact Bill O'Hara, Director of the Survey Division, Texas General Land Office,

by phone at (512) 463-5212, email bill.o'hara@glo.texas.gov, or fax (512) 463-5223.

TRD-201403823
Larry L. Laine
Chief Clerk, Deputy Land Commissioner
General Land Office
Filed: August 13, 2014

Texas Health and Human Services Commission

Notice of Public Hearing on Proposed Community First Choice State Plan Amendment

Hearing. The Texas Health and Human Services Commission (HHSC) will conduct a public hearing on Wednesday, September 3, 2014, at 2:00 p.m. to receive public comment on transmittal number 14-026 to the Texas State Plan for Medical Assistance, under Title XIX of the Social Security Act. The proposed amendment would implement the Community First Choice (CFC) program. The public hearing will be held in the Public Hearing Room of the John H. Winters Building, located at 701 West 51st Street, Austin, Texas. Entry is through Security at the front of the building facing 51st Street.

Proposal. HHSC proposes to implement the Community First Choice (CFC) program under section 1915(k) of the Social Security Act. CFC services would be provided at an enhanced federal match rate to individuals who have a physical or intellectual disability, who meet categorical coverage requirements for Medicaid or meet financial eligibility for home and community-based services, and who meet an institutional level of care. The requested effective date for the proposed amendment is March 1, 2015.

Methodology and Justification. Texas Government Code §534.152(a)(1), adopted in 2013, §1.01, requires HHSC to "implement the most cost-effective option for the delivery of basic attendant and habilitation services for individuals with disabilities under the STAR + PLUS Medicaid managed care program that maximizes federal funding for the delivery of services for that program and other similar programs." See Act of May 26, 2013, 83d Leg., R.S., ch. 1310, §1.01, 2013 Tex. Gen. Laws 3409, 3416. Texas Government Code §534.152(a)(2) requires voluntary training to individuals receiving services under the STAR + PLUS Medicaid managed care program or their legally authorized representatives regarding how to select, manage, and dismiss personal attendants providing basic attendant and habilitation services under the program. CFC is available under federal law and lets states provide home and community-based attendant services to Medicaid enrollees with disabilities under their State Plan. See 42 U.S.C. §1396n(k). This option became available on October 1, 2011, and provides a six percent increase in the Federal Medical Assistance Percentage for expenditures related to this option. The Final Rule was issued May 7, 2012, and regulations are in effect as of July 6, 2012. See 42 C.F.R. pt. 441, subpt. K.

Briefing Package. A briefing package describing the proposed amendment will be available at <http://www.hhsc.state.tx.us/medicaid/about/state-plan/> by August 29, 2014. Interested parties may also obtain a copy of the proposed amendment prior to the hearing by contacting Policy Development Support by telephone at (512) 728-1932; by fax at (512) 730-7472; or by e-mail at beren.dutra@hhsc.state.tx.us. The proposed amendment also will be available at the public hearing.

Written Comments. Written comments regarding the proposed amendment may be submitted in lieu of, or in addition to, oral testimony. Written comments may be sent by U.S. mail to the Texas Health and Human Services Commission, Policy Development Support,

TEXAS GENERAL LAND OFFICE
Art. 33.136, Natural Resources Code
Co. San Patricio, Sketch No. 7
File Date 06/22/2018 by R. Keartye

IN ADDITION August 22, 2014 39 TexReg 6747

Texas. Secretary of State. Texas Register, Volume 39, Number 34, Pages 6295-6760, August 22, 2014, periodical, August 22, 2014; Austin, Texas.

(texashistory.unt.edu/ark:/67531/metaph517283/m1/453/?

q=Naismith%20AND%20%22Coastal%20Boundary%20Survey%22: accessed June 21, 2018),

University of North Texas Libraries, The Portal to Texas History, texashistory.unt.edu; crediting UNT Libraries Government Documents Department.

7/24 and 31, 2014

General Land Office
Indiana Point

Coastal
Boundary
survey

AFFIDAVIT of PUBLICATION

THE STATE OF TEXAS

COUNTY OF BEE

Before me, the undersigned authority, on this day personally appeared George G. Latcham, Publisher of The Portland News, a newspaper having general circulation in San Patricio County, Texas, who being by me duly sworn, deposes and says that the foregoing attached notice was published in said newspaper on the following date(s),

to wit: July 24 and July 31, 2014



George G. Latcham, Publisher

TEXAS GENERAL LAND OFFICE
Art. 33.136, Natural Resources Code
Co. SAN PATRICIO, sect. No. 7
File Date 10/01/2008 by K. Schreiber

Sworn to and subscribed before me by George G. Latcham, this the 31 day of July, 20 14 A.D. to certify which witness my hand and official seal.



Mary Virginia Massey

Notary Public in and for the State of Texas

