

LINE	BEARING	DISTANCE	VARAS
L110	S 89°28'12" W	21.52	7,749 VS
L111	S 60°28'13" W	42.95	15,463 VS
L112	S 75°02'35" W	37.91	13,649 VS
L113	N 70°13'08" W	55.22	19,878 VS
L114	N 39°24'48" W	94.04	33,854 VS
L115	N 82°44'07" W	11.58	4,169 VS
L116	N 39°41'20" W	62.39	22,484 VS
L117	N 07°32'28" W	38.85	13,987 VS
L118	N 32°28'09" W	84.44	30,398 VS
L119	N 49°56'10" W	72.06	25,943 VS
L120	N 08°18'10" W	50.76	18,275 VS
L121	N 59°17'09" W	33.00	11,891 VS
L122	N 31°40'20" W	35.89	12,921 VS
L123	N 08°28'10" W	28.88	9,317 VS
L124	N 64°00'35" W	28.81	10,373 VS
L125	N 46°58'54" W	34.95	12,438 VS
L126	N 06°39'29" W	36.24	13,048 VS
L127	N 39°05'38" W	40.13	14,448 VS
L128	N 09°12'36" E	35.48	12,774 VS
L129	N 27°14'07" W	50.16	18,098 VS
L130	N 14°00'58" W	54.17	19,501 VS
L131	N 62°03'20" W	84.41	30,387 VS
L132	N 37°14'07" W	62.05	22,274 VS
L133	N 56°33'22" W	94.34	33,983 VS
L134	N 07°43'07" E	40.32	14,616 VS
L135	N 23°19'14" W	48.52	17,458 VS
L136	N 78°28'56" W	34.42	12,390 VS
L137	N 57°10'22" W	27.28	9,820 VS
L138	N 22°14'07" W	30.85	11,066 VS
L139	N 03°01'26" W	22.32	8,036 VS
L140	N 20°19'14" E	24.52	8,827 VS
L141	N 08°28'10" W	28.88	9,317 VS
L142	N 10°28'08" E	104.78	37,371 VS
L143	N 53°32'47" W	34.49	12,416 VS
L144	N 15°31'54" W	30.85	11,066 VS
L145	N 09°14'00" W	81.33	29,290 VS
L146	N 34°51'51" W	93.06	33,501 VS
L147	N 08°28'10" W	28.88	9,317 VS
L148	N 12°58'13" W	47.61	17,139 VS
L149	N 04°49'59" E	69.44	24,998 VS
L150	N 02°23'41" E	41.02	14,787 VS
L151	N 09°41'51" W	44.41	15,988 VS
L152	N 08°42'27" W	7.95	2,884 VS
L153	N 08°28'10" W	9.57	3,444 VS
L154	N 79°44'57" W	4.26	1,532 VS
L155	N 18°19'24" W	17.21	6,196 VS
L156	N 08°28'10" W	11.82	4,296 VS
L157	N 23°22'43" W	11.82	4,296 VS
L158	N 14°51'27" W	84.06	30,282 VS
L159	N 44°03'41" W	91.37	32,884 VS
L160	N 13°49'48" W	82.39	29,489 VS
L161	N 10°28'08" W	89.30	32,149 VS
L162	N 08°28'10" W	86.97	31,309 VS
L163	N 37°54'58" W	14.71	5,242 VS
L164	N 12°08'18" W	52.82	18,908 VS
L165	N 01°38'17" W	74.40	26,783 VS
L166	N 04°58'54" W	31.62	11,312 VS
L167	N 04°58'54" W	53.76	19,553 VS
L168	N 08°48'18" E	37.07	13,346 VS
L169	N 04°58'54" W	38.85	13,987 VS
L170	N 22°20'18" W	47.02	16,928 VS
L171	N 08°28'10" W	49.38	17,775 VS
L172	N 08°28'10" W	11.36	4,046 VS
L173	N 01°07'54" E	89.13	32,086 VS
L174	N 07°33'24" W	102.28	36,821 VS
L175	N 08°28'10" W	92.91	33,446 VS
L176	N 18°00'38" E	90.19	32,468 VS
L177	N 08°47'38" E	49.17	17,701 VS
L178	N 18°00'38" E	31.31	11,270 VS
L179	N 03°02'46" E	45.76	16,474 VS
L180	N 04°48'56" W	44.31	15,951 VS
L181	N 08°28'10" W	44.31	15,951 VS
L182	N 32°34'06" W	33.41	12,029 VS
L183	N 08°28'10" W	30.34	10,922 VS
L184	N 03°22'24" W	42.34	15,243 VS
L185	N 04°58'54" W	89.75	32,312 VS
L186	N 08°48'08" W	14.33	5,160 VS
L187	N 21°40'51" W	17.41	6,286 VS
L188	N 02°11'18" E	63.22	22,759 VS
L189	N 11°35'33" E	35.21	12,475 VS
L190	N 12°16'26" W	118.22	42,100 VS
L191	N 07°37'55" E	64.19	23,109 VS
L192	N 20°21'19" E	66.58	23,969 VS
L193	N 34°43'55" E	35.88	12,846 VS
L194	N 17°48'28" W	38.04	13,696 VS
L195	N 08°28'10" W	109.06	37,821 VS
L196	N 03°28'02" E	91.89	33,081 VS
L197	N 10°37'28" E	91.89	33,081 VS
L198	N 11°04'09" E	96.88	34,878 VS
L199	N 31°01'30" E	24.01	8,445 VS
L200	N 08°10'04" E	117.09	41,151 VS
L201	N 37°11'12" E	26.72	9,618 VS
L202	N 12°18'58" E	92.85	33,426 VS
L203	N 71°48'41" E	81.30	29,290 VS
L204	N 17°40'32" E	95.22	34,279 VS
L205	N 36°48'02" E	48.36	17,410 VS
L206	N 42°28'56" E	42.34	15,243 VS
L207	S 85°02'49" E	46.21	16,636 VS
L208	N 14°50'03" W	48.26	17,374 VS
L209	N 07°09'15" E	57.75	20,789 VS
L210	N 42°20'27" E	51.73	18,625 VS
L211	N 81°07'50" E	55.27	19,899 VS
L212	N 31°34'28" E	34.73	12,504 VS
L213	S 85°27'44" E	44.14	15,889 VS
L214	N 83°28'18" E	41.14	14,812 VS
L215	N 81°28'04" E	76.71	27,615 VS
L216	N 28°11'25" E	27.63	9,946 VS
L217	N 56°47'19" E	43.52	15,666 VS
L218	N 15°18'58" E	56.23	20,000 VS
L219	N 48°01'06" E	36.17	13,022 VS
L220	N 83°28'39" E	35.17	12,662 VS
L221	N 81°48'55" E	27.17	9,782 VS
L222	S 70°47'13" E	19.75	7,111 VS
L223	S 27°28'24" E	8.98	3,233 VS
L224	N 81°48'55" E	11.95	4,389 VS
L225	S 87°37'00" E	20.87	7,481 VS
L226	S 63°46'05" E	22.00	7,922 VS
L227	N 41°28'24" E	10.08	3,629 VS
L228	N 47°03'24" E	15.11	5,440 VS
L229	N 37°11'22" E	6.82	2,427 VS
L230	N 41°28'24" E	10.08	3,629 VS
L231	N 84°30'15" W	40.63	14,607 VS
L232	N 59°07'37" W	34.42	12,392 VS
L233	N 56°02'42" E	18.21	6,557 VS
L234	N 31°58'52" W	11.02	4,033 VS
L235	N 36°13'50" W	27.18	9,784 VS
L236	N 77°06'04" E	55.29	19,905 VS
L237	N 86°46'48" E	26.81	9,291 VS

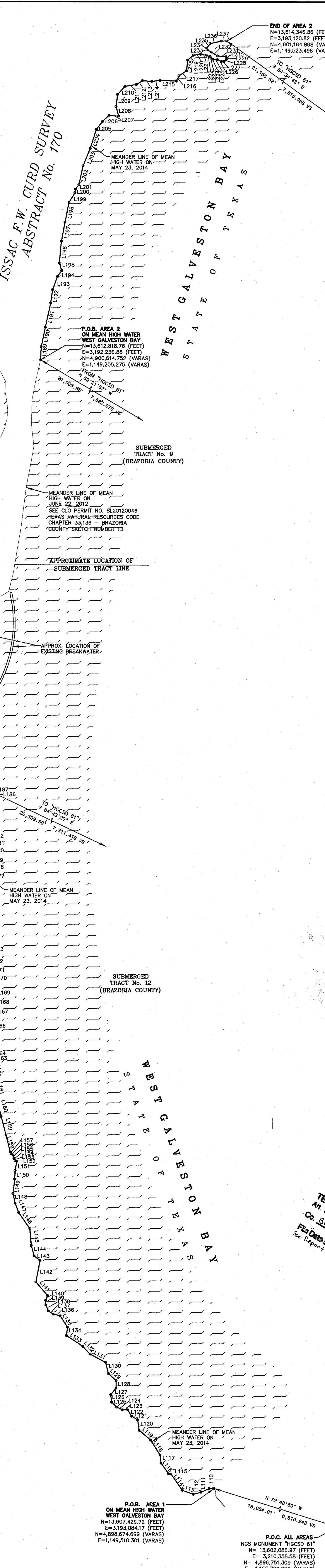
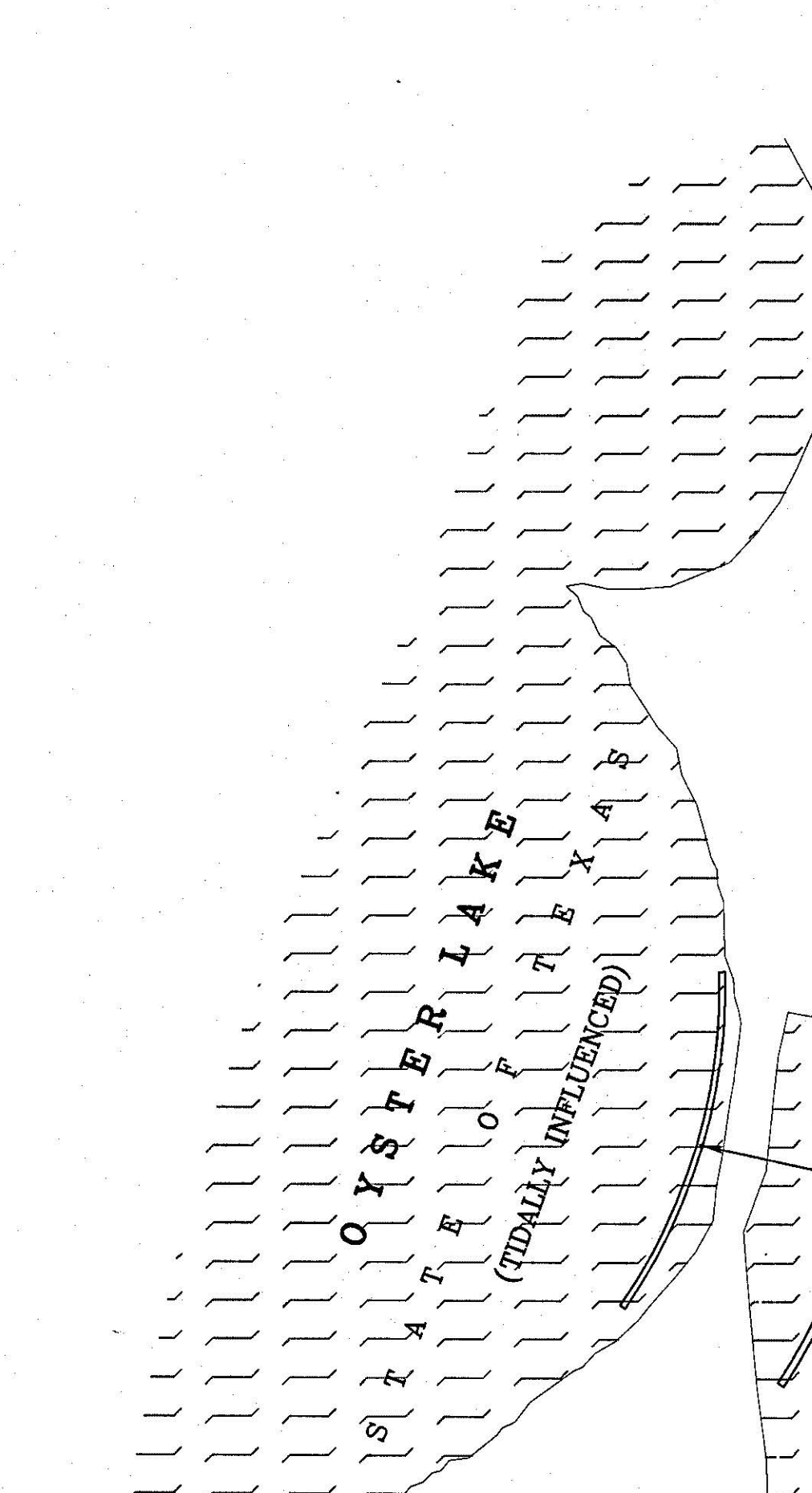

**FIELD NOTE DESCRIPTION - AREA 1:**  
 Being the line of Mean High Water of West Galveston Bay along a portion of the Isaac F. W. Curd Survey, Abstract Number 170, in Brazoria County, Texas. The meander line of said Mean High Water (Area 1) being more particularly described as follows (coordinates and bearings are grid values referred to the Texas Coordinate System of 1983, South Central Zone and NGS Monuments "HGCSD 61" and "HGCSD 62". Distances shown are surface distances and may be converted to grid distances by multiplying by a scale factor of 0.99987597):

**COMMENCING** at NGS Monument "HGCSD 61" having grid coordinates of N=13,602,086.97 feet (4,896,751.309 varas) and E=3,210,358.58 feet (1,155,729.089 varas), from which NGS Monument "HGCSD 62" bears North 50°56'05" East, 69,256.16 feet (24,932.218 varas);

**THENCE**, North 72°48'50" West, a distance of 18,084.01 feet (6,510,243 varas) to a point on the line of Mean High Water of West Galveston Bay, on the easterly line of said Isaac F. W. Curd Survey, for the POINT OF BEGINNING and southerly end of said meander line having grid coordinates of N=13,607,429.72 feet (4,898,674.699 varas) and E=3,193,084.17 feet (1,149,510.301 varas);

**THENCE**, in a generally northerly direction, along said meander line of Mean High Water of West Galveston Bay and the easterly line of said Isaac F. W. Curd Survey the following seventy-eight (78) courses:

- (L110) South 85°29'12" West, a distance of 21.52 feet (7,749 varas) to a point;
- (L111) South 60°28'13" West, a distance of 42.95 feet (15,463 varas) to a point;
- (L112) South 75°02'35" West, a distance of 37.91 feet (13,649 varas) to a point;
- (L113) North 70°13'08" West, a distance of 55.22 feet (19,878 varas) to a point;
- (L114) North 39°24'48" West, a distance of 94.04 feet (33,854 varas) to a point;
- (L115) North 82°44'07" West, a distance of 11.58 feet (4,169 varas) to a point;
- (L116) North 39°41'20" West, a distance of 62.39 feet (22,484 varas) to a point;
- (L117) North 07°32'28" West, a distance of 38.85 feet (13,987 varas) to a point;
- (L118) North 32°28'09" West, a distance of 84.44 feet (30,398 varas) to a point;
- (L119) North 49°56'10" West, a distance of 72.06 feet (25,943 varas) to a point;
- (L120) North 08°18'10" West, a distance of 50.76 feet (18,275 varas) to a point;
- (L121) North 59°17'09" West, a distance of 33.00 feet (11,891 varas) to a point;
- (L122) North 31°40'20" West, a distance of 35.89 feet (12,921 varas) to a point;
- (L123) North 08°28'10" West, a distance of 28.88 feet (9,317 varas) to a point;
- (L124) North 64°00'35" West, a distance of 28.81 feet (10,373 varas) to a point;
- (L125) North 46°58'54" West, a distance of 34.95 feet (12,438 varas) to a point;
- (L126) North 06°39'29" West, a distance of 36.24 feet (13,048 varas) to a point;
- (L127) North 39°05'38" West, a distance of 40.13 feet (14,448 varas) to a point;
- (L128) North 09°12'36" East, a distance of 35.48 feet (12,774 varas) to a point;
- (L129) North 27°14'07" West, a distance of 50.16 feet (18,098 varas) to a point;
- (L130) North 14°00'58" West, a distance of 54.17 feet (19,501 varas) to a point;
- (L131) North 62°03'20" West, a distance of 84.41 feet (30,387 varas) to a point;
- (L132) North 37°14'07" West, a distance of 62.05 feet (22,274 varas) to a point;
- (L133) North 56°33'22" West, a distance of 94.34 feet (33,983 varas) to a point;
- (L134) North 07°43'07" East, a distance of 40.32 feet (14,616 varas) to a point;
- (L135) North 23°19'14" West, a distance of 48.52 feet (17,458 varas) to a point;
- (L136) North 78°28'56" West, a distance of 34.42 feet (12,390 varas) to a point;
- (L137) North 57°10'22" West, a distance of 27.28 feet (9,820 varas) to a point;
- (L138) North 22°14'07" West, a distance of 30.85 feet (11,066 varas) to a point;
- (L139) North 03°01'26" West, a distance of 22.32 feet (8,036 varas) to a point;
- (L140) North 20°19'14" East, a distance of 24.52 feet (8,827 varas) to a point;
- (L141) North 08°28'10" West, a distance of 28.88 feet (9,317 varas) to a point;
- (L142) North 10°28'08" East, a distance of 104.78 feet (37,371 varas) to a point;
- (L143) North 53°32'47" West, a distance of 34.49 feet (12,416 varas) to a point;
- (L144) North 15°31'54" West, a distance of 30.85 feet (11,066 varas) to a point;
- (L145) North 09°14'00" West, a distance of 81.33 feet (29,290 varas) to a point;
- (L146) North 34°51'51" West, a distance of 93.06 feet (33,501 varas) to a point;
- (L147) North 08°28'10" West, a distance of 28.88 feet (9,317 varas) to a point;
- (L148) North 12°58'13" West, a distance of 47.61 feet (17,139 varas) to a point;
- (L149) North 04°49'59" East, a distance of 69.44 feet (24,998 varas) to a point;
- (L150) North 02°23'41" East, a distance of 41.02 feet (14,787 varas) to a point;
- (L151) North 09°41'51" West, a distance of 44.41 feet (15,988 varas) to a point;
- (L152) North 08°42'27" West, a distance of 7.95 feet (2,884 varas) to a point;
- (L153) North 08°28'10" West, a distance of 9.57 feet (3,444 varas) to a point;
- (L154) North 79°44'57" West, a distance of 4.26 feet (1,532 varas) to a point;
- (L155) North 18°19'24" West, a distance of 17.21 feet (6,196 varas) to a point;
- (L156) North 08°28'10" West, a distance of 11.82 feet (4,296 varas) to a point;
- (L157) North 23°22'43" West, a distance of 11.82 feet (4,296 varas) to a point;
- (L158) North 14°51'27" West, a distance of 84.06 feet (30,282 varas) to a point;
- (L159) North 44°03'41" West, a distance of 91.37 feet (32,884 varas) to a point;
- (L160) North 13°49'48" West, a distance of 82.39 feet (29,489 varas) to a point;
- (L161) North 10°28'08" West, a distance of 89.30 feet (32,149 varas) to a point;
- (L162) North 08°28'10" West, a distance of 86.97 feet (31,309 varas) to a point;
- (L163) North 37°54'58" West, a distance of 14.71 feet (5,242 varas) to a point;
- (L164) North 12°08'18" West, a distance of 52.82 feet (18,908 varas) to a point;
- (L165) North 01°38'17" West, a distance of 74.40 feet (26,783 varas) to a point;
- (L166) North 04°58'54" West, a distance of 31.62 feet (11,312 varas) to a point;
- (L167) North 04°58'54" West, a distance of 53.76 feet (19,553 varas) to a point;
- (L168) North 08°48'18" East, a distance of 37.07 feet (13,346 varas) to a point;
- (L169) North 04°58'54" West, a distance of 38.85 feet (13,987 varas) to a point;
- (L170) North 22°20'18" West, a distance of 47.02 feet (16,928 varas) to a point;
- (L171) North 08°28'10" West, a distance of 49.38 feet (17,775 varas) to a point;
- (L172) North 08°28'10" West, a distance of 11.36 feet (4,046 varas) to a point;
- (L173) North 01°07'54" East, a distance of 89.13 feet (32,086 varas) to a point;
- (L174) North 07°33'24" West, a distance of 102.28 feet (36,821 varas) to a point;
- (L175) North 08°28'10" West, a distance of 92.91 feet (33,446 varas) to a point;
- (L176) North 18°00'38" East, a distance of 90.19 feet (32,468 varas) to a point;
- (L177) North 08°47'38" East, a distance of 49.17 feet (17,701 varas) to a point;
- (L178) North 18°00'38" East, a distance of 31.31 feet (11,270 varas) to a point;
- (L179) North 03°02'46" East, a distance of 45.76 feet (16,474 varas) to a point;
- (L180) North 04°48'56" West, a distance of 44.31 feet (15,951 varas) to a point;
- (L181) North 08°28'10" West, a distance of 44.31 feet (15,951 varas) to a point;
- (L182) North 32°34'06" West, a distance of 33.41 feet (12,029 varas) to a point;
- (L183) North 08°28'10" West, a distance of 30.34 feet (10,922 varas) to a point;
- (L184) North 03°22'24" West, a distance of 42.34 feet (15,243 varas) to a point;
- (L185) North 04°58'54" West, a distance of 89.75 feet (32,312 varas) to a point;
- (L186) North 08°48'08" West, a distance of 14.33 feet (5,160 varas) to a point;
- (L187) North 21°40'51" West, a distance of 17.41 feet (6,286 varas) to a point;
- (L188) North 02°11'18" East, a distance of 63.22 feet (22,759 varas) to a point;
- (L189) North 11°35'33" East, a distance of 35.21 feet (12,475 varas) to a point;
- (L190) North 12°16'26" West, a distance of 118.22 feet (42,100 varas) to a point;
- (L191) North 07°37'55" East, a distance of 64.19 feet (23,109 varas) to a point;
- (L192) North 20°21'19" East, a distance of 66.58 feet (23,969 varas) to a point;
- (L193) North 34°43'55" East, a distance of 35.88 feet (12,846 varas) to a point;
- (L194) North 17°48'28" West, a distance of 38.04 feet (13,696 varas) to a point;
- (L195) North 08°28'10" West, a distance of 109.06 feet (37,821 varas) to a point;
- (L196) North 03°28'02" East, a distance of 91.89 feet (33,081 varas) to a point;
- (L197) North 10°37'28" East, a distance of 91.89 feet (33,081 varas) to a point;
- (L198) North 11°04'09" East, a distance of 96.88 feet (34,878 varas) to a point;
- (L199) North 31°01'30" East, a distance of 24.01 feet (8,445 varas) to a point;
- (L200) North 08°10'04" East, a distance of 117.09 feet (41,151 varas) to a point;
- (L201) North 37°11'12" East, a distance of 26.72 feet (9,618 varas) to a point;
- (L202) North 12°18'58" East, a distance of 92.85 feet (33,426 varas) to a point;
- (L203) North 71°48'41" East, a distance of 81.30 feet (29,290 varas) to a point;
- (L204) North 17°40'32" East, a distance of 95.22 feet (34,279 varas) to a point;
- (L205) North 36°48'02" East, a distance of 48.36 feet (17,410 varas) to a point;
- (L206) North 42°28'56" East, a distance of 42.34 feet (15,243 varas) to a point;
- (L207) South 85°02'49" East, a distance of 46.21 feet (16,636 varas) to a point;
- (L208) North 14°50'03" West, a distance of 48.26 feet (17,374 varas) to a point;
- (L209) North 07°09'15" East, a distance of 57.75 feet (20,789 varas) to a point;
- (L210) North 42°20'27" East, a distance of 51.73 feet (18,625 varas) to a point;
- (L211) North 81°07'50" East, a distance of 55.27 feet (19,899 varas) to a point;
- (L212) North 31°34'28" East, a distance of 34.73 feet (12,504 varas) to a point;
- (L213) South 85°27'44" East, a distance of 44.14 feet (15,889 varas) to a point;
- (L214) North 83°28'18" East, a distance of 41.14 feet (14,812 varas) to a point;
- (L215) North 81°28'04" East, a distance of 76.71 feet (27,615 varas) to a





Surveying Division  
Coastal Boundary Survey Approval

TEXAS GENERAL LAND OFFICE  
Art. 33.136, Natural Resources Code  
Co. Brazoria, Sketch No. 15  
File Date 06/21/2016 by R. Kartye

**Project:** Oyster Lake Shoreline Protection and Marsh Restoration-Phase 2

**Project No:** SL20120046, General Land Office  
CEPRA 1588

**Project Manager:** Mollie Powell (GLO-Upper Coast Regional Manager)  
Carla Kartman (GLO-Coastal Project Planner)

**Surveyor:** William E. Merten, Licensed State Land Surveyor

**Description:** A Coastal Boundary Survey, dated May 23, 2014, by William E. Merten, Licensed State Land Surveyor, delineating the line of Mean High Water along the western shore of West Galveston Bay, same line being a portion of the littoral boundary of the Isaac F.W. Curd Survey, A-170 and the western boundary of West Galveston Bay Submerged Land Tracts 9 and 12. The survey supports the expansion of an existing shoreline protection project, consisting of breakwater construction, authorized under Texas General Land Office Lease No SL20120046. The surveyed line is comprised of two lines adjacent to and extending northerly (1500 feet) and southerly (3700 feet) from the ends of a previously surveyed shoreline (Texas Natural Resources Code, Chapter 33.136, Brazoria County Sketch 13), situated east of Oyster Lake (coordinates N 29° 07' 15", W 95° 10' 01", WGS84).

A Coastal Boundary Survey for the above-referenced project has been reviewed and accepted; upon completion of public notice requirements, the survey will be filed in the Texas General Land Office, Archives and Records, in accordance with provisions of the *Texas Natural Resources Code*, Chapter 33.136.

Approved:

Signed: David A. Lyb  
Surveying Division

Aug 25 2014  
Date

Approval Filed as:

*Tex. Nat. Res. Code* Article 33.136 Brazoria County, Sketch No. 15





DECLARATION OF A COASTAL BOUNDARY SURVEY

PURPOSE AND NOTICE:

This survey was performed in accordance with Section 33.136, Natural Resources Code, for the purpose of evidencing the location of the shoreline in the area depicted in this survey as that shoreline existed before commencement of erosion response activity, as required by Chapter 33, Natural Resources Code. The line depicted on this survey fixes the shoreline for the purpose of locating a shoreline boundary, subject to movement landward as provided by Section 33.136, Natural Resources Code.

FIELD NOTE DESCRIPTIONS:

AREA ONE

MEAN HIGH WATER OF WEST GALVESTON BAY ALONG  
THE ISSAC F. W. CURD SURVEY, ABSTRACT NUMBER 170  
BRAZORIA COUNTY, TEXAS

Being the line of Mean High Water of West Galveston Bay along a portion of the Issac F. W. Curd Survey, Abstract Number 170, in Brazoria County, Texas. The meander line of said Mean High Water (Area 1) being more particularly described as follows (coordinates and bearings are grid values referenced to the Texas Coordinate System of 1983, South Central Zone and NGS Monuments "HGCS D 61" and "HGCS D 62". Distances shown are surface distances and may be converted to grid distances by multiplying by a scale factor of 0.99987597):

COMMENCING at NGS Monument "HGCS D 61" having grid coordinates of N=13,602,086.97 feet (4,896,751.309 varas) and E=3,210,358.58 feet (1,155,729.089 varas), from which NGS Monument "HGCS D 62" bears North 50°56'05" East, 69,256.16 feet (24,932.218 varas);

THENCE, North 72°48'50" West, a distance of 18,084.01 feet (6,510.243 varas) to a point on the line of Mean High Water of West Galveston Bay, on the easterly line of said Issac F. W. Curd Survey, for the POINT OF BEGINNING and southerly end of said meander line having grid coordinates of N=13,607,429.72 feet (4,898,674.699 varas) and E=3,193,084.17 feet (1,149,510.301 varas);

TEXAS GENERAL LAND OFFICE  
Art. 33.136, Natural Resources Code

Page 1

Co. Brazoria, Sketch No. 15

File Date 06/21/2018 by R. Kartve

**RECORDER'S MEMORANDUM:**

At the time of recordation, this instrument was found to be inadequate for the best photographic reproduction because of illegibility, carbon, or photo-copy, discolored paper, etc. All blockouts, additions and changes were present at the time the instrument was filed and recorded.



THENCE, in a generally northerly direction, along said meander line of Mean High Water of West Galveston Bay and the easterly line of said Issac F. W. Curd Survey the following seventy-eight (78) courses:

1. (L110) South 85°29'12" West, a distance of 21.52 feet (7.749 varas) to a point;
2. (L111) South 66°02'13" West, a distance of 42.95 feet (15.463 varas) to a point;
3. (L112) South 75°02'35" West, a distance of 37.91 feet (13.649 varas) to a point;
4. (L113) North 70°13'08" West, a distance of 55.22 feet (19.878 varas) to a point;
5. (L114) North 35°29'46" West, a distance of 94.04 feet (33.854 varas) to a point;
6. (L115) North 82°44'07" West, a distance of 11.58 feet (4.169 varas) to a point
7. (L116) North 35°41'20" West, a distance of 62.39 feet (22.464 varas) to a point;
8. (L117) North 07°35'26" West, a distance of 38.85 feet (13.987 varas) to a point
9. (L118) North 32°28'09" West, a distance of 84.44 feet (30.398 varas) to a point;
10. (L119) North 49°56'10" West, a distance of 72.06 feet (25.943 varas) to a point;
11. (L120) North 09°18'15" West, a distance of 50.76 feet (18.275 varas) to a point;
12. (L121) North 59°17'09" West, a distance of 33.00 feet (11.881 varas) to a point;
13. (L122) North 31°40'20" West, a distance of 35.89 feet (12.921 varas) to a point;
14. (L123) North 89°56'19" West, a distance of 25.88 feet (9.317 varas) to a point;
15. (L124) North 64°00'35" West, a distance of 28.81 feet (10.373 varas) to a point;
16. (L125) North 46°58'54" West, a distance of 34.55 feet (12.438 varas) to a point;
17. (L126) North 06°36'22" West, a distance of 36.24 feet (13.048 varas) to a point;
18. (L127) North 38°05'36" East, a distance of 40.13 feet (14.448 varas) to a point;
19. (L128) North 00°12'38" East, a distance of 35.48 feet (12.774 varas) to a point;
20. (L129) North 47°31'45" West, a distance of 50.16 feet (18.058 varas) to a point;
21. (L130) North 14°00'58" West, a distance of 54.17 feet (19.501 varas) to a point;
22. (L131) North 62°03'20" West, a distance of 84.41 feet (30.387 varas) to a point;
23. (L132) North 43°01'17" West, a distance of 50.07 feet (18.024 varas) to a point;
24. (L133) North 56°33'42" West, a distance of 94.34 feet (33.963 varas) to a point;
25. (L134) North 07°43'07" East, a distance of 40.32 feet (14.516 varas) to a point;
26. (L135) North 33°07'58" West, a distance of 64.71 feet (23.294 varas) to a point;
27. (L136) North 76°26'56" West, a distance of 34.42 feet (12.390 varas) to a point;
28. (L137) North 57°10'22" West, a distance of 27.28 feet (9.820 varas) to a point;
29. (L138) North 22°22'17" West, a distance of 30.85 feet (11.106 varas) to a point;
30. (L139) North 03°01'26" West, a distance of 22.32 feet (8.036 varas) to a point;
31. (L140) North 20°19'14" East, a distance of 24.52 feet (8.827 varas) to a point;
32. (L141) North 40°36'27" West, a distance of 85.00 feet (30.601 varas) to a point;
33. (L142) North 10°25'08" East, a distance of 104.78 feet (37.721 varas) to a point;
34. (L143) North 53°32'47" West, a distance of 34.49 feet (12.416 varas) to a point;
35. (L144) North 15°31'34" West, a distance of 52.10 feet (18.757 varas) to a point;
36. (L145) North 05°14'00" West, a distance of 81.33 feet (29.280 varas) to a point;
37. (L146) North 34°45'51" West, a distance of 93.06 feet (33.501 varas) to a point;
38. (L147) North 20°46'43" West, a distance of 48.52 feet (17.468 varas) to a point;
39. (L148) North 12°55'13" West, a distance of 47.61 feet (17.139 varas) to a point;
40. (L149) North 06°49'59" East, a distance of 69.44 feet (24.998 varas) to a point;

TEXAS GENERAL LAND OFFICE  
Art. 33.136, Natural Resources Code

Co. Brazoria, Sketch No. 15

File Date 06/21/2018 by R. Kurtze



41. (L150) North 02°23'41" East, a distance of 41.02 feet (14.767 varas) to a point;
42. (L151) North 09°41'19" East, a distance of 44.41 feet (15.988 varas) to a point;
43. (L152) North 66°47'27" West, a distance of 7.95 feet (2.864 varas) to a point;
44. (L153) North 08°38'57" West, a distance of 9.57 feet (3.444 varas) to a point;
45. (L154) North 79°44'57" West, a distance of 4.26 feet (1.532 varas) to a point;
46. (L155) North 16°19'24" West, a distance of 17.21 feet (6.196 varas) to a point;
47. (L156) North 51°07'33" West, a distance of 11.82 feet (4.256 varas) to a point;
48. (L157) North 23°22'43" West, a distance of 7.81 feet (2.812 varas) to a point;
49. (L158) North 14°51'27" West, a distance of 84.06 feet (30.262 varas) to a point;
50. (L159) North 14°44'13" West, a distance of 91.37 feet (32.984 varas) to a point;
51. (L160) North 13°49'49" West, a distance of 89.30 feet (32.148 varas) to a point;
52. (L161) North 10°29'28" West, a distance of 89.30 feet (32.149 varas) to a point;
53. (L162) North 01°15'22" West, a distance of 86.97 feet (31.309 varas) to a point;
54. (L163) North 37°54'22" West, a distance of 14.12 feet (5.083 varas) to a point;
55. (L164) North 12°06'18" West, a distance of 52.52 feet (18.908 varas) to a point;
56. (L165) North 01°32'17" West, a distance of 74.40 feet (26.783 varas) to a point;
57. (L166) North 11°39'36" East, a distance of 87.81 feet (31.612 varas) to a point;
58. (L167) North 04°55'22" East, a distance of 53.76 feet (19.353 varas) to a point;
59. (L168) North 09°49'18" East, a distance of 37.07 feet (13.346 varas) to a point;
60. (L169) North 02°47'50" East, a distance of 56.85 feet (20.465 varas) to a point;
61. (L170) North 29°20'18" West, a distance of 47.02 feet (16.928 varas) to a point;
62. (L171) North 05°53'06" West, a distance of 49.38 feet (17.775 varas) to a point;
63. (L172) North 13°22'12" West, a distance of 32.05 feet (11.538 varas) to a point;
64. (L173) North 01°07'54" East, a distance of 89.13 feet (32.086 varas) to a point;
65. (L174) North 07°53'24" West, a distance of 102.28 feet (36.821 varas) to a point;
66. (L175) North 06°28'11" West, a distance of 92.91 feet (33.446 varas) to a point;
67. (L176) North 16°00'35" East, a distance of 90.19 feet (32.468 varas) to a point;
68. (L177) North 08°47'39" East, a distance of 49.17 feet (17.701 varas) to a point;
69. (L178) North 16°04'31" West, a distance of 31.31 feet (11.270 varas) to a point;
70. (L179) North 03°02'46" East, a distance of 45.76 feet (16.474 varas) to a point;
71. (L180) North 04°46'56" West, a distance of 44.31 feet (15.951 varas) to a point;
72. (L181) North 08°08'58" East, a distance of 27.79 feet (10.004 varas) to a point;
73. (L182) North 32°34'06" West, a distance of 33.41 feet (12.029 varas) to a point;
74. (L183) North 09°29'45" West, a distance of 30.34 feet (10.922 varas) to a point;
75. (L184) North 03°22'24" East, a distance of 61.00 feet (21.961 varas) to a point;
76. (L185) North 04°56'54" East, a distance of 89.75 feet (32.312 varas) to a point;
77. (L186) North 00°48'08" West, a distance of 14.33 feet (5.160 varas) to a point;
78. (L187) North 21°48'51" East, a distance of 17.41 feet (6.266 varas) to the northerly end of said meander line (Area 1), having grid coordinates of N=13,610,758.19 feet (4,899,872.949 varas) and E=3,191,996.03 feet (1,149,118.570 varas). from which NGS Monument "HGCS D 61" bears South 64°43'20" East, 20,309.50 feet (7,311.419 varas).

TEXAS GENERAL LAND OFFICE  
 Art. 33.136, Natural Resources Code

Co. Brazoria, Sketch No. 15

Page 3

File Date 06/21/2018 by R. Kartye



AREA TWO

MEAN HIGH WATER OF WEST GALVESTON BAY ALONG  
THE ISSAC F. W. CURD SURVEY, ABSTRACT NUMBER 170  
BRAZORIA COUNTY, TEXAS

Being the line of Mean High Water of West Galveston Bay along a portion of the Issac F. W. Curd Survey, Abstract Number 170, in Brazoria County, Texas. The meander line of said Mean High Water (Area 2) being more particularly described as follows (coordinates and bearings are grid values referenced to the Texas Coordinate System of 1983, South Central Zone and NGS Monuments "HGCS D 61" and "HGCS D 62". Distances shown are surface distances and may be converted to grid distances by multiplying by a scale factor of 0.99987597):

COMMENCING at NGS Monument "HGCS D 61" having grid coordinates of N=13,602,086.97 feet (4,896,751.309 varas) and E=3,210,358.58 feet (1,155,729.089 varas), from which NGS Monument "HGCS D 62" bears North 50°56'05" East, 69,256.16 feet (24,932.218 varas);

THENCE, North 59°21'57" West, a distance of 21,063.65 feet (7,582.070 varas) to a point on the line of Mean High Water of West Galveston Bay, on the easterly line of said Issac F. W. Curd Survey, for the POINT OF BEGINNING and southerly end of said meander line having grid coordinates of N=13,612,818.76 feet (4,900,614.752 varas) and E=3,192,236.88 feet (1,149,205.275 varas);

THENCE, in a generally northerly direction, along said meander line of Mean High Water of West Galveston Bay and the easterly line of said Issac F. W. Curd Survey the following forty-nine (49) courses:

1. (L189) North 02°11'18" East a distance of 63.22 feet (22.759 varas) to a point;
2. (L190) North 11°35'33" East a distance of 95.21 feet (34.275 varas) to a point;
3. (L191) North 12°19'26" East a distance of 119.22 feet (42.920 varas) to a point;
4. (L192) North 07°37'55" East a distance of 64.19 feet (23.109 varas) to a point;
5. (L193) North 20°21'19" East a distance of 66.58 feet (23.969 varas) to a point;
6. (L194) North 34°47'55" East a distance of 35.68 feet (12.846 varas) to a point;
7. (L195) North 17°48'28" West a distance of 38.04 feet (13.696 varas) to a point;
8. (L196) North 05°26'02" East a distance of 105.06 feet (37.821 varas) to a point;
9. (L197) North 10°37'28" East a distance of 91.89 feet (33.081 varas) to a point;
10. (L198) North 11°04'09" East a distance of 96.88 feet (34.878 varas) to a point;
11. (L199) North 31°01'30" East a distance of 54.01 feet (19.445 varas) to a point;
12. (L200) North 08°13'04" East a distance of 17.09 feet (6.151 varas) to a point;
13. (L201) North 37°11'15" East a distance of 26.72 feet (9.618 varas) to a point;

TEXAS GENERAL LAND OFFICE  
Art. 33.136, Natural Resources Code

Page 4

Co. Brazoria, Sketch No. 15

File Date 06/11/2018 by R. Kertye



14. (L202) North 12°18'58" East a distance of 92.85 feet (33.426 varas) to a point;
15. (L203) North 21°46'41" East a distance of 91.30 feet (32.866 varas) to a point;
16. (L204) North 17°40'32" East a distance of 95.22 feet (34.279 varas) to a point;
17. (L205) North 36°48'02" East a distance of 48.36 feet (17.410 varas) to a point;
18. (L206) North 46°28'56" East a distance of 42.34 feet (15.243 varas) to a point;
19. (L207) South 85°02'49" East a distance of 46.21 feet (16.636 varas) to a point;
20. (L208) North 14°50'03" West a distance of 48.26 feet (17.374 varas) to a point;
21. (L209) North 07°09'15" East a distance of 57.75 feet (20.789 varas) to a point;
22. (L210) North 42°20'27" East a distance of 51.73 feet (18.625 varas) to a point;
23. (L211) North 81°07'50" East a distance of 55.27 feet (19.899 varas) to a point;
24. (L212) North 57°34'28" East a distance of 34.73 feet (12.504 varas) to a point;
25. (L213) South 85°27'44" East a distance of 44.14 feet (15.889 varas) to a point;
26. (L214) North 83°28'18" East a distance of 41.14 feet (14.812 varas) to a point;
27. (L215) South 87°56'04" East a distance of 76.71 feet (27.615 varas) to a point;
28. (L216) North 28°11'25" East a distance of 27.63 feet (9.946 varas) to a point;
29. (L217) North 55°47'19" East a distance of 43.52 feet (15.666 varas) to a point;
30. (L218) North 06°19'30" East a distance of 50.23 feet (18.084 varas) to a point;
31. (L219) North 48°01'06" East a distance of 36.17 feet (13.022 varas) to a point;
32. (L220) North 83°25'39" East a distance of 35.17 feet (12.662 varas) to a point;
33. (L221) South 81°48'36" East a distance of 27.17 feet (9.782 varas) to a point;
34. (L222) South 70°47'13" East a distance of 19.75 feet (7.111 varas) to a point;
35. (L223) South 27°28'24" East a distance of 8.98 feet (3.233 varas) to a point;
36. (L224) South 62°30'54" East a distance of 11.05 feet (3.980 varas) to a point;
37. (L225) South 87°37'00" East a distance of 20.77 feet (7.477 varas) to a point;
38. (L226) South 63°46'05" East a distance of 22.00 feet (7.922 varas) to a point;
39. (L227) South 88°45'57" East a distance of 12.01 feet (4.322 varas) to a point;
40. (L228) North 47°03'24" East a distance of 15.11 feet (5.440 varas) to a point;
41. (L229) North 37°11'22" East a distance of 6.82 feet (2.457 varas) to a point;
42. (L230) North 41°28'24" West a distance of 10.08 feet (3.629 varas) to a point;
43. (L231) North 84°30'15" West a distance of 40.63 feet (14.627 varas) to a point;
44. (L232) North 59°07'37" West a distance of 34.42 feet (13.392 varas) to a point;
45. (L233) North 58°02'42" West a distance of 18.21 feet (6.557 varas) to a point;
46. (L234) North 31°59'52" West a distance of 11.20 feet (4.033 varas) to a point;
47. (L235) North 36°13'50" East a distance of 27.18 feet (9.784 varas) to a point;
48. (L236) North 77°06'04" East a distance of 55.29 feet (19.905 varas) to a point;
49. (L237) North 88°45'48" East a distance of 25.81 feet (9.291 varas) to the northerly end of said meander line (Area 2), having grid coordinates of N=13,614,346.86 feet (4,901,164.868 varas) and E=3,193,120.82 feet (1,149,523.496 varas) from which NGS Monument "HGCS D 61" bears South 54°34'43" East, 21,155.52 feet (7,615.988 varas).

TEXAS GENERAL LAND OFFICE

Art. 33.136, Natural Resources Code

Page 5

Co. Brazoria, Sketch No. 15

File Date 06/21/2018 by R. Hartye

NOTES:

1) All coordinates and bearings shown hereon are grid values referenced to the Texas Coordinate System of 1983, South Central Zone and NGS Monuments "HGCS D 61" and "HGCS D 62". All distances shown hereon are surface distances unless noted and may be converted to grid distances by multiplying by a scale factor of 0.99987597. Mapping angle for this project is 01°54'20". Elevations are referenced to NAVD '88 datum and NGS Monument "HGCS D 61" having an elevation of 5.84', NAVD '88.

2) Elevation of Mean High Water was determined by use of and on-site tide gauge adjusted to the NOAA gauges "San Luis Pass" and "Galveston Pier 21". Elevation of Mean High Water was determined to be 1.05' NAVD '88.

3) This map is in support of an Erosion Control Project with possible slope protection and/or breakwater construction, authorized under GLO Permit Number SL20120046

4) This project adjoins an existing erosion control project, also authorized under GLO Permit Number SL20120046. Reference, Texas Natural Resources Code - Chapter 33.136 - Brazoria County Sketch Number 13.

TEXAS GENERAL LAND OFFICE  
Art. 33.136, Natural Resources Code  
Co. Brazoria, Sketch No. 15  
File Date 06/21/2018 by R. Kartve



SURVEYORS CERTIFICATE:

I, William E. Merten, Licensed State Land Surveyor in and for the State of Texas, do hereby certify that on May 23, 2014, I have located the natural contour line of Mean High Water in accordance with methodology approved by the General Land Office, on the ground, according to law, in accordance with Natural Resources Code Section 21.042 and with the personnel stated, and that said contour line is true and correct as described above and as shown on the attached "Exhibit A". To the best of my knowledge no artificial fill, any development or placement of retaining walls, other than as shown hereon, that would cause alteration to said contour line has occurred within the area surveyed.

Field Personnel: Kyle C. Sunday, RPLS



William E. Merten  
Licensed State Land Surveyor  
Cobb Fendley & Associates, Inc.  
TBPLS Firm Registration Number 100467  
1506 E. Broadway, Suite 201  
Pearland, Texas 77581  
281-993-4952



Subscribed and sworn to me on the 13th. day of August, 2014.

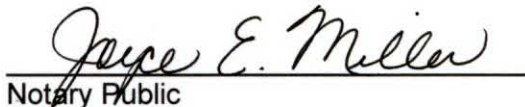

Notary Public

My commission expires 8-18-16

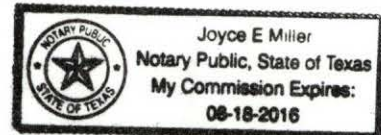

TEXAS GENERAL LAND OFFICE  
Art. 33.136, Natural Resources Code

Co. Brazoria, Sketch No. 15

File Date 06/24/2013 by R. Kartye

Page 7



# EXHIBIT "A"

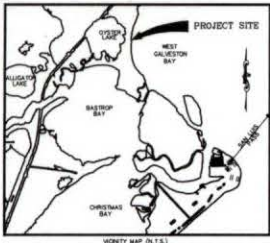

STATION	Bearing	Distance	Remarks
1	S 89° 52' 11" E	21.52	to a point
2	S 89° 52' 11" E	42.95	to a point
3	S 89° 52' 11" E	64.38	to a point
4	S 89° 52' 11" E	85.81	to a point
5	S 89° 52' 11" E	107.24	to a point
6	S 89° 52' 11" E	128.67	to a point
7	S 89° 52' 11" E	150.10	to a point
8	S 89° 52' 11" E	171.53	to a point
9	S 89° 52' 11" E	192.96	to a point
10	S 89° 52' 11" E	214.39	to a point
11	S 89° 52' 11" E	235.82	to a point
12	S 89° 52' 11" E	257.25	to a point
13	S 89° 52' 11" E	278.68	to a point
14	S 89° 52' 11" E	300.11	to a point
15	S 89° 52' 11" E	321.54	to a point
16	S 89° 52' 11" E	342.97	to a point
17	S 89° 52' 11" E	364.40	to a point
18	S 89° 52' 11" E	385.83	to a point
19	S 89° 52' 11" E	407.26	to a point
20	S 89° 52' 11" E	428.69	to a point
21	S 89° 52' 11" E	450.12	to a point
22	S 89° 52' 11" E	471.55	to a point
23	S 89° 52' 11" E	492.98	to a point
24	S 89° 52' 11" E	514.41	to a point
25	S 89° 52' 11" E	535.84	to a point
26	S 89° 52' 11" E	557.27	to a point
27	S 89° 52' 11" E	578.70	to a point
28	S 89° 52' 11" E	600.13	to a point
29	S 89° 52' 11" E	621.56	to a point
30	S 89° 52' 11" E	642.99	to a point
31	S 89° 52' 11" E	664.42	to a point
32	S 89° 52' 11" E	685.85	to a point
33	S 89° 52' 11" E	707.28	to a point
34	S 89° 52' 11" E	728.71	to a point
35	S 89° 52' 11" E	750.14	to a point
36	S 89° 52' 11" E	771.57	to a point
37	S 89° 52' 11" E	793.00	to a point
38	S 89° 52' 11" E	814.43	to a point
39	S 89° 52' 11" E	835.86	to a point
40	S 89° 52' 11" E	857.29	to a point
41	S 89° 52' 11" E	878.72	to a point
42	S 89° 52' 11" E	900.15	to a point
43	S 89° 52' 11" E	921.58	to a point
44	S 89° 52' 11" E	943.01	to a point
45	S 89° 52' 11" E	964.44	to a point
46	S 89° 52' 11" E	985.87	to a point
47	S 89° 52' 11" E	1007.30	to a point
48	S 89° 52' 11" E	1028.73	to a point
49	S 89° 52' 11" E	1050.16	to a point
50	S 89° 52' 11" E	1071.59	to a point
51	S 89° 52' 11" E	1093.02	to a point
52	S 89° 52' 11" E	1114.45	to a point
53	S 89° 52' 11" E	1135.88	to a point
54	S 89° 52' 11" E	1157.31	to a point
55	S 89° 52' 11" E	1178.74	to a point
56	S 89° 52' 11" E	1200.17	to a point
57	S 89° 52' 11" E	1221.60	to a point
58	S 89° 52' 11" E	1243.03	to a point
59	S 89° 52' 11" E	1264.46	to a point
60	S 89° 52' 11" E	1285.89	to a point
61	S 89° 52' 11" E	1307.32	to a point
62	S 89° 52' 11" E	1328.75	to a point
63	S 89° 52' 11" E	1350.18	to a point
64	S 89° 52' 11" E	1371.61	to a point
65	S 89° 52' 11" E	1393.04	to a point
66	S 89° 52' 11" E	1414.47	to a point
67	S 89° 52' 11" E	1435.90	to a point
68	S 89° 52' 11" E	1457.33	to a point
69	S 89° 52' 11" E	1478.76	to a point
70	S 89° 52' 11" E	1500.19	to a point
71	S 89° 52' 11" E	1521.62	to a point
72	S 89° 52' 11" E	1543.05	to a point
73	S 89° 52' 11" E	1564.48	to a point
74	S 89° 52' 11" E	1585.91	to a point
75	S 89° 52' 11" E	1607.34	to a point
76	S 89° 52' 11" E	1628.77	to a point
77	S 89° 52' 11" E	1650.20	to a point
78	S 89° 52' 11" E	1671.63	to a point
79	S 89° 52' 11" E	1693.06	to a point
80	S 89° 52' 11" E	1714.49	to a point
81	S 89° 52' 11" E	1735.92	to a point
82	S 89° 52' 11" E	1757.35	to a point
83	S 89° 52' 11" E	1778.78	to a point
84	S 89° 52' 11" E	1800.21	to a point
85	S 89° 52' 11" E	1821.64	to a point
86	S 89° 52' 11" E	1843.07	to a point
87	S 89° 52' 11" E	1864.50	to a point
88	S 89° 52' 11" E	1885.93	to a point
89	S 89° 52' 11" E	1907.36	to a point
90	S 89° 52' 11" E	1928.79	to a point
91	S 89° 52' 11" E	1950.22	to a point
92	S 89° 52' 11" E	1971.65	to a point
93	S 89° 52' 11" E	1993.08	to a point
94	S 89° 52' 11" E	2014.51	to a point
95	S 89° 52' 11" E	2035.94	to a point
96	S 89° 52' 11" E	2057.37	to a point
97	S 89° 52' 11" E	2078.80	to a point
98	S 89° 52' 11" E	2100.23	to a point
99	S 89° 52' 11" E	2121.66	to a point
100	S 89° 52' 11" E	2143.09	to a point

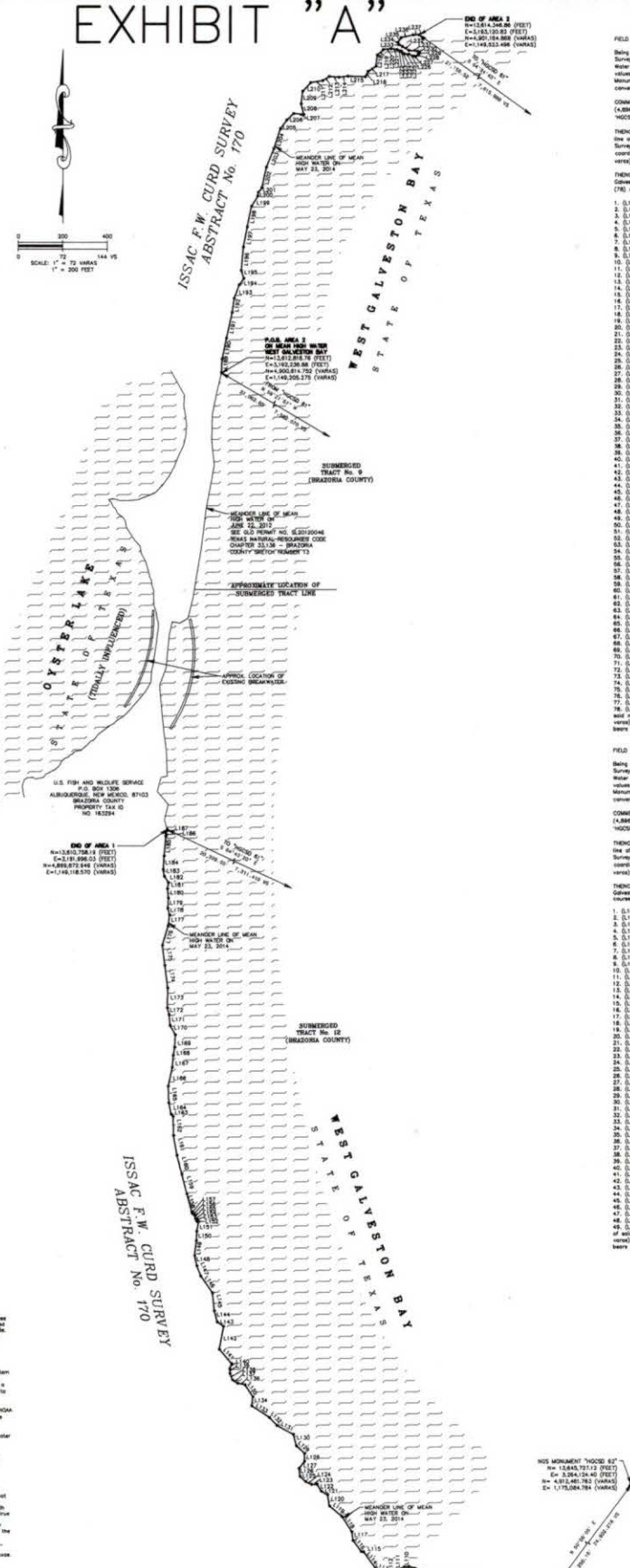

**FIELD NOTE DESCRIPTION - AREA 1:**

Being the line of Mean High Water of West Galveston Bay along a portion of the line of F. W. Curd Survey, Abstract Number 170, in Brazoria County, Texas. The meander line of said Mean High Water (MHW) line is being more particularly described as follows: (Coordinates and bearings are grid values referred to the Texas Coordinate System of 1983, South Central Zone and NGS Monument 7020 81 and 7020 82. Distances shown are surface distances and may be converted to grid distances by multiplying by a scale factor of 0.999979777.)

COMMENCING at NGS Monument 7020 81 having grid coordinates of N=1,802,088.97 feet (4,884,791.308 meters) and E=2,102,358.56 feet (1,159,720.089 meters), from which NGS Monument 7020 82 bears North 50°50'50" East, 68,236.16 feet (24,822.218 meters).

THENCE, North 50°11'57" West, a distance of 21,523.85 feet (7,582.970 meters) to a point on the line of Mean High Water of West Galveston Bay, on the westerly line of said Isaac F. W. Curd Survey, for the POINT OF BEGINNING and southerly end of said meander line having grid coordinates of N=1,812,518.78 feet (4,900,614.751 meters) and E=2,102,358.56 feet (1,159,720.089 meters).

THENCE, in a generally northerly direction, along said meander line of Mean High Water of West Galveston Bay and the westerly line of said Isaac F. W. Curd Survey, the following forty-eight (48) courses:

1. (S 89° 52' 11" E) East, a distance of 21.52 feet (7.582 meters) to a point.
2. (S 89° 52' 11" E) East, a distance of 42.95 feet (13.083 meters) to a point.
3. (S 89° 52' 11" E) East, a distance of 64.38 feet (19.624 meters) to a point.
4. (S 89° 52' 11" E) East, a distance of 85.81 feet (26.165 meters) to a point.
5. (S 89° 52' 11" E) East, a distance of 107.24 feet (32.706 meters) to a point.
6. (S 89° 52' 11" E) East, a distance of 128.67 feet (39.247 meters) to a point.
7. (S 89° 52' 11" E) East, a distance of 150.10 feet (45.788 meters) to a point.
8. (S 89° 52' 11" E) East, a distance of 171.53 feet (52.329 meters) to a point.
9. (S 89° 52' 11" E) East, a distance of 192.96 feet (58.870 meters) to a point.
10. (S 89° 52' 11" E) East, a distance of 214.39 feet (65.411 meters) to a point.
11. (S 89° 52' 11" E) East, a distance of 235.82 feet (71.952 meters) to a point.
12. (S 89° 52' 11" E) East, a distance of 257.25 feet (78.493 meters) to a point.
13. (S 89° 52' 11" E) East, a distance of 278.68 feet (85.034 meters) to a point.
14. (S 89° 52' 11" E) East, a distance of 300.11 feet (91.575 meters) to a point.
15. (S 89° 52' 11" E) East, a distance of 321.54 feet (98.116 meters) to a point.
16. (S 89° 52' 11" E) East, a distance of 342.97 feet (104.657 meters) to a point.
17. (S 89° 52' 11" E) East, a distance of 364.40 feet (111.198 meters) to a point.
18. (S 89° 52' 11" E) East, a distance of 385.83 feet (117.739 meters) to a point.
19. (S 89° 52' 11" E) East, a distance of 407.26 feet (124.280 meters) to a point.
20. (S 89° 52' 11" E) East, a distance of 428.69 feet (130.821 meters) to a point.
21. (S 89° 52' 11" E) East, a distance of 450.12 feet (137.362 meters) to a point.
22. (S 89° 52' 11" E) East, a distance of 471.55 feet (143.903 meters) to a point.
23. (S 89° 52' 11" E) East, a distance of 492.98 feet (150.444 meters) to a point.
24. (S 89° 52' 11" E) East, a distance of 514.41 feet (156.985 meters) to a point.
25. (S 89° 52' 11" E) East, a distance of 535.84 feet (163.526 meters) to a point.
26. (S 89° 52' 11" E) East, a distance of 557.27 feet (170.067 meters) to a point.
27. (S 89° 52' 11" E) East, a distance of 578.70 feet (176.608 meters) to a point.
28. (S 89° 52' 11" E) East, a distance of 600.13 feet (183.149 meters) to a point.
29. (S 89° 52' 11" E) East, a distance of 621.56 feet (189.690 meters) to a point.
30. (S 89° 52' 11" E) East, a distance of 642.99 feet (196.231 meters) to a point.
31. (S 89° 52' 11" E) East, a distance of 664.42 feet (202.772 meters) to a point.
32. (S 89° 52' 11" E) East, a distance of 685.85 feet (209.313 meters) to a point.
33. (S 89° 52' 11" E) East, a distance of 707.28 feet (215.854 meters) to a point.
34. (S 89° 52' 11" E) East, a distance of 728.71 feet (222.395 meters) to a point.
35. (S 89° 52' 11" E) East, a distance of 750.14 feet (228.936 meters) to a point.
36. (S 89° 52' 11" E) East, a distance of 771.57 feet (235.477 meters) to a point.
37. (S 89° 52' 11" E) East, a distance of 793.00 feet (242.018 meters) to a point.
38. (S 89° 52' 11" E) East, a distance of 814.43 feet (248.559 meters) to a point.
39. (S 89° 52' 11" E) East, a distance of 835.86 feet (255.100 meters) to a point.
40. (S 89° 52' 11" E) East, a distance of 857.29 feet (261.641 meters) to a point.
41. (S 89° 52' 11" E) East, a distance of 878.72 feet (268.182 meters) to a point.
42. (S 89° 52' 11" E) East, a distance of 900.15 feet (274.723 meters) to a point.
43. (S 89° 52' 11" E) East, a distance of 921.58 feet (281.264 meters) to a point.
44. (S 89° 52' 11" E) East, a distance of 943.01 feet (287.805 meters) to a point.
45. (S 89° 52' 11" E) East, a distance of 964.44 feet (294.346 meters) to a point.
46. (S 89° 52' 11" E) East, a distance of 985.87 feet (300.887 meters) to a point.
47. (S 89° 52' 11" E) East, a distance of 1007.30 feet (307.428 meters) to a point.
48. (S 89° 52' 11" E) East, a distance of 1028.73 feet (313.969 meters) to a point.
49. (S 89° 52' 11" E) East, a distance of 1050.16 feet (320.510 meters) to a point.
50. (S 89° 52' 11" E) East, a distance of 1071.59 feet (327.051 meters) to a point.
51. (S 89° 52' 11" E) East, a distance of 1093.02 feet (333.592 meters) to a point.
52. (S 89° 52' 11" E) East, a distance of 1114.45 feet (340.133 meters) to a point.
53. (S 89° 52' 11" E) East, a distance of 1135.88 feet (346.674 meters) to a point.
54. (S 89° 52' 11" E) East, a distance of 1157.31 feet (353.215 meters) to a point.
55. (S 89° 52' 11" E) East, a distance of 1178.74 feet (359.756 meters) to a point.
56. (S 89° 52' 11" E) East, a distance of 1200.17 feet (366.297 meters) to a point.
57. (S 89° 52' 11" E) East, a distance of 1221.60 feet (372.838 meters) to a point.
58. (S 89° 52' 11" E) East, a distance of 1243.03 feet (379.379 meters) to a point.
59. (S 89° 52' 11" E) East, a distance of 1264.46 feet (385.920 meters) to a point.
60. (S 89° 52' 11" E) East, a distance of 1285.89 feet (392.461 meters) to a point.
61. (S 89° 52' 11" E) East, a distance of 1307.32 feet (399.002 meters) to a point.
62. (S 89° 52' 11" E) East, a distance of 1328.75 feet (405.543 meters) to a point.
63. (S 89° 52' 11" E) East, a distance of 1350.18 feet (412.084 meters) to a point.
64. (S 89° 52' 11" E) East, a distance of 1371.61 feet (418.625 meters) to a point.
65. (S 89° 52' 11" E) East, a distance of 1393.04 feet (425.166 meters) to a point.
66. (S 89° 52' 11" E) East, a distance of 1414.47 feet (431.707 meters) to a point.
67. (S 89° 52' 11" E) East, a distance of 1435.90 feet (438.248 meters) to a point.
68. (S 89° 52' 11" E) East, a distance of 1457.33 feet (444.789 meters) to a point.
69. (S 89° 52' 11" E) East, a distance of 1478.76 feet (451.330 meters) to a point.
70. (S 89° 52' 11" E) East, a distance of 1500.19 feet (457.871 meters) to a point.
71. (S 89° 52' 11" E) East, a distance of 1521.62 feet (464.412 meters) to a point.
72. (S 89° 52' 11" E) East, a distance of 1543.05 feet (470.953 meters) to a point.
73. (S 89° 52' 11" E) East, a distance of 1564.48 feet (477.494 meters) to a point.
74. (S 89° 52' 11" E) East, a distance of 1585.91 feet (484.035 meters) to a point.
75. (S 89° 52' 11" E) East, a distance of 1607.34 feet (490.576 meters) to a point.
76. (S 89° 52' 11" E) East, a distance of 1628.77 feet (497.117 meters) to a point.
77. (S 89° 52' 11" E) East, a distance of 1650.20 feet (503.658 meters) to a point.
78. (S 89° 52' 11" E) East, a distance of 1671.63 feet (510.199 meters) to a point.
79. (S 89° 52' 11" E) East, a distance of 1693.06 feet (516.740 meters) to a point.
80. (S 89° 52' 11" E) East, a distance of 1714.49 feet (523.281 meters) to a point.
81. (S 89° 52' 11" E) East, a distance of 1735.92 feet (529.822 meters) to a point.
82. (S 89° 52' 11" E) East, a distance of 1757.35 feet (536.363 meters) to a point.
83. (S 89° 52' 11" E) East, a distance of 1778.78 feet (542.904 meters) to a point.
84. (S 89° 52' 11" E) East, a distance of 1800.21 feet (549.445 meters) to a point.
85. (S 89° 52' 11" E) East, a distance of 1821.64 feet (555.986 meters) to a point.
86. (S 89° 52' 11" E) East, a distance of 1843.07 feet (562.527 meters) to a point.
87. (S 89° 52' 11" E) East, a distance of 1864.50 feet (569.068 meters) to a point.
88. (S 89° 52' 11" E) East, a distance of 1885.93 feet (575.609 meters) to a point.
89. (S 89° 52' 11" E) East, a distance of 1907.36 feet (582.150 meters) to a point.
90. (S 89° 52' 11" E) East, a distance of 1928.79 feet (588.691 meters) to a point.
91. (S 89° 52' 11" E) East, a distance of 1950.22 feet (595.232 meters) to a point.
92. (S 89° 52' 11" E) East, a distance of 1971.65 feet (601.773 meters) to a point.
93. (S 89° 52' 11" E) East, a distance of 1993.08 feet (608.314 meters) to a point.
94. (S 89° 52' 11" E) East, a distance of 2014.51 feet (614.855 meters) to a point.
95. (S 89° 52' 11" E) East, a distance of 2035.94 feet (621.396 meters) to a point.
96. (S 89° 52' 11" E) East, a distance of 2057.37 feet (627.937 meters) to a point.
97. (S 89° 52' 11" E) East, a distance of 2078.80 feet (634.478 meters) to a point.
98. (S 89° 52' 11" E) East, a distance of 2100.23 feet (641.019 meters) to a point.
99. (S 89° 52' 11" E) East, a distance of 2121.66 feet (647.560 meters) to a point.
100. (S 89° 52' 11" E) East, a distance of 2143.09 feet (654.101 meters) to a point.

**FIELD NOTE DESCRIPTION - AREA 2:**

Being the line of Mean High Water of West Galveston Bay along a portion of the line of F. W. Curd Survey, Abstract Number 170, in Brazoria County, Texas. The meander line of said Mean High Water (MHW) line is being more particularly described as follows: (Coordinates and bearings are grid values referred to the Texas Coordinate System of 1983, South Central Zone and NGS Monument 7020 81 and 7020 82. Distances shown are surface distances and may be converted to grid distances by multiplying by a scale factor of 0.999979777.)

COMMENCING at NGS Monument 7020 81 having grid coordinates of N=1,802,088.97 feet (4,884,791.308 meters) and E=2,102,358.56 feet (1,159,720.089 meters), from which NGS Monument 7020 82 bears North 50°50'50" East, 68,236.16 feet (24,822.218 meters).

THENCE, North 50°11'57" West, a distance of 21,523.85 feet (7,582.970 meters) to a point on the line of Mean High Water of West Galveston Bay, on the westerly line of said Isaac F. W. Curd Survey, for the POINT OF BEGINNING and southerly end of said meander line having grid coordinates of N=1,812,518.78 feet (4,900,614.751 meters) and E=2,102,358.56 feet (1,159,720.089 meters).

THENCE, in a generally northerly direction, along said meander line of Mean High Water of West Galveston Bay and the westerly line of said Isaac F. W. Curd Survey, the following forty-eight (48) courses:

1. (S 89° 52' 11" E) East, a distance of 21.52 feet (7.582 meters) to a point.
2. (S 89° 52' 11" E) East, a distance of 42.95 feet (13.083 meters) to a point.
3. (S 89° 52' 11" E) East, a distance of 64.38 feet (19.624 meters) to a point.
4. (S 89° 52' 11" E) East, a distance of 85.81 feet (26.165 meters) to a point.
5. (S 89° 52' 11" E) East, a distance of 107.24 feet (32.706 meters) to a point.
6. (S 89° 52' 11" E) East, a distance of 128.67 feet (39.247 meters) to a point.
7. (S 89° 52' 11" E) East, a distance of 150.10 feet (45.788 meters) to a point.
8. (S 89° 52' 11" E) East, a distance of 171.53 feet (52.329 meters) to a point.
9. (S 89° 52' 11" E) East, a distance of 192.96 feet (58.870 meters) to a point.
10. (S 89° 52' 11" E) East, a distance of 214.39 feet (65.411 meters) to a point.
11. (S 89° 52' 11" E) East, a distance of 235.82 feet (71.952 meters) to a point.
12. (S 89° 52' 11" E) East, a distance of 257.25 feet (78.493 meters) to a point.
13. (S 89° 52' 11" E) East, a distance of 278.68 feet (85.034 meters) to a point.
14. (S 89° 52' 11" E) East, a distance of 300.11 feet (91.575 meters) to a point.
15. (S 89° 52' 11" E) East, a distance of 321.54 feet (98.116 meters) to a point.
16. (S 89° 52' 11" E) East, a distance of 342.97 feet (104.657 meters) to a point.



# FILED and RECORDED

Instrument Number: 2014034441

Filing and Recording Date: 08/13/2014 02:59:34 PM Pages: 9 Recording Fee: \$54.00

I hereby certify that this instrument was FILED on the date and time stamped hereon and RECORDED in the OFFICIAL PUBLIC RECORDS of Brazoria County, Texas.



*Joyce Hudman*

Joyce Hudman, County Clerk  
Brazoria County, Texas

ANY PROVISION CONTAINED IN ANY DOCUMENT WHICH RESTRICTS THE SALE, RENTAL, OR USE OF THE REAL PROPERTY DESCRIBED THEREIN BECAUSE OF RACE OR COLOR IS INVALID UNDER FEDERAL LAW AND IS UNENFORCEABLE.

***DO NOT DESTROY - Warning, this document is part of the Official Public Record.***

cclerk-amanda

TEXAS GENERAL LAND OFFICE  
Art. 33.136, Natural Resources Code  
Co. Brazoria, Sketch No. 15  
File Date 06/21/2018 by R. Kartye



# Texas Register, Volume 39, Number 39, Pages 7645-7830, September 26, 2014 Page: 7,818

County; Cox Road Dump Site, Liberty County; Crim-Hammett, Rusk County; Dorchester Refining Company, Titus County; Double R Plating Company, Cass County; Force Road Oil, Brazoria County; Gulf Metals Industries, Harris County; Hagerson Road Drum, Fort Bend County; Harkey Road, Brazoria County; Hart Creosoting, Jasper County; Harvey Industries, Inc., Henderson County; Hicks Field Sewer Corp., Tarrant County; Hi-Yield, Hunt County; Higgins Wood Preserving, Angelina County; Houston Lead, Harris County; Houston Scrap, Harris County; J.C. Pencko Waste Oil Service, Bexar County; Kingsbury Metal Finishing, Guadalupe County; LaPata Oil Company, Harris County; Lyon Property, Kimble County; McNabb Flying Service, Brazoria County; Melton Kelly Property, Navarro County; Munoz Borrow Pits, Hidalgo County; Newton Wood Preserving, Newton County; Niagara Chemical, Cameron County; Old Lufkin Creosoting, Angelina County; Permian Chemical, Ector County; Phipps Plating, Bexar County; PIP Minerals, Liberty County; Poly-Cycle Industries, Ellis County; Poly-Cycle Industries, Jacksonville, Cherokee County; Rio Grande Refinery I, Hardin County; Rio Grande Refinery II, Hardin County; Rogers Delinted Cottonseed-Farmersville, Collin County; Sampson Horrice, Dallas County; SESCO, Tom Green County; Shelby Wood Specialty, Inc., Shelby County; Solvent Recovery Services, Fort Bend County; South Texas Solvents, Nueces County; State Marine, Jefferson County; Stoller Chemical Company, Hale County; Texas American Oil, Ellis County; Thompson Hayward Chemical, Knox County; Waste Oil Tank Services, Harris County; and Wortham Lead Salvage, Henderson County.

The Lindsay Post Company Site, located in Alto, Cherokee County, was removed from inclusion on the registry as a site that was proposed for listing in the January 22, 1988, issue of the *Texas Register* (13 TexReg 427).

Agency records for these sites may be accessible for viewing or copying by contacting the TCEQ Central File Room (CFR) Customer Service Center, Building E, North Entrance, at 12100 Park 35 Circle, Austin, Texas 78753, phone number (512) 239-2900, fax (512) 239-1850 or e-mail [cfrreq@tceq.texas.gov](mailto:cfrreq@tceq.texas.gov). CFR Customer Service Center staff will assist with providing program area contacts for records not maintained in the Central File Room. Also, inquiries concerning the agency Superfund program records may be directed to Superfund staff at the Superfund toll free line (800) 633-9363 or e-mail [superfund@tceq.texas.gov](mailto:superfund@tceq.texas.gov). Parking for mobility impaired persons is available on the east side of Building D, convenient to access ramps that are located between Buildings D and E. There is no charge for viewing the files; however, copying of file information is subject to payment of a fee.

TRD-201404412  
Kathleen C. Decker  
Director, Litigation Division  
Texas Commission on Environmental Quality  
Filed: September 16, 2014

### Texas Ethics Commission

#### List of Late Filers

Listed below are the names of filers from the Texas Ethics Commission who did not file reports or failed to pay penalty fines for late reports in reference to the listed filing deadline. If you have any questions, you may contact Robbie Douglas at (512) 463-5800.

**Deadline: Personal Financial Statement due June 30, 2014**

Laura G. Maczka, 301 Overcreek, Richardson, Texas 75080

### Deadline: Semiannual Report due July 15, 2014 for Candidates and Officeholders

Nathan G. Macias, 31540 Smithson Valley Road, Bulverde, Texas 78163

TRD-201404418  
Natalia Luna Ashley  
Executive Director  
Texas Ethics Commission  
Filed: September 16, 2014

### Texas Facilities Commission

#### Request for Proposals #303-6-20468

The Texas Facilities Commission (TFC), on behalf of the Department of Family and Protective Services (DFPS), announces the issuance of Request for Proposals (RFP) #303-6-20468. TFC seeks a five (5) or ten (10) year lease of approximately 18,570 square feet of office space in Edinburg, Hidalgo County, Texas.

The deadline for questions is October 6, 2014 and the deadline for proposals is October 20, 2014 at 3:00 p.m. The award date is November 19, 2014. TFC reserves the right to accept or reject any or all proposals submitted. TFC is under no legal or other obligation to execute a lease on the basis of this notice or the distribution of an RFP. Neither this notice nor the RFP commits TFC to pay for any costs incurred prior to the award of a grant.

Parties interested in submitting a proposal may obtain information by contacting the Program Specialist, Evelyn Esquivel, at (512) 463-6494. A copy of the RFP may be downloaded from the Electronic State Business Daily at [http://esbd.cpa.state.tx.us/bid\\_show.cfm?bidid=113867](http://esbd.cpa.state.tx.us/bid_show.cfm?bidid=113867).

TRD-201404438  
Kay Molina  
General Counsel  
Texas Facilities Commission  
Filed: September 17, 2014

### General Land Office

#### Notice of Approval of Coastal Boundary Survey

Pursuant to §33.136 of the Texas Natural Resources Code, notice is hereby given that Jerry Patterson, Commissioner of the General Land Office, approved a coastal boundary survey described as follows:

A Coastal Boundary Survey, dated May 23, 2014, by William E. Merten, Licensed State Land Surveyor, delineating the line of Mean High Water along the western shore of West Galveston Bay, same line being a portion of the littoral boundary of the Isaac F.W. Curd Survey, A-170 and the western boundary of West Galveston Bay Submerged Land Tracts 9 and 12. The survey supports the expansion of an existing shoreline protection project, consisting of breakwater construction, authorized under Texas General Land Office Lease No SL20120046. The surveyed line is comprised of two lines adjacent to and extending northerly (1500 feet) and southerly (3700 feet) from the ends of a previously surveyed shoreline (Texas Natural Resources Code, Chapter 33.136, Brazoria County Sketch 13), situated east of Oyster Lake (coordinates N 29° 07' 15", W 95° 10' 01", WGS84).

This survey is intended to provide pre-project baseline information related to an erosion response activity on coastal public lands. An owner of uplands adjoining the project area is entitled to continue to exercise littoral rights possessed prior to the commencement of the erosion re-

39 TexReg 7818 September 26, 2014 Texas Register

Texas. Secretary of State. Texas Register, Volume 39, Number 39, Pages 7645-7830, September 26, 2014, periodical, September 26, 2014; Austin, Texas.

([texashistory.unt.edu/ark:/67531/metaph517285/m1/174/?q=Merten%20AND%20%22Coastal%20Boundary%20Survey%22](http://texashistory.unt.edu/ark:/67531/metaph517285/m1/174/?q=Merten%20AND%20%22Coastal%20Boundary%20Survey%22): accessed June 21, 2018),

University of North Texas Libraries, The Portal to Texas History, [texashistory.unt.edu](http://texashistory.unt.edu); crediting UNT Libraries Government Documents Department.

TEXAS GENERAL LAND OFFICE  
Art. 33.136, Natural Resources Code

Co. Brazoria, Sketch No. 15

File Date 06/21/2018 by R. Kerbye



# Texas Register, Volume 39, Number 39, Pages 7645-7830, September 26, 2014 Page: 7,819

sponse activity, but may not claim any additional land as a result of accretion, reliction, or avulsion resulting from the erosion response activity.

For a copy of this survey or more information on this matter, contact Bill O'Hara, Director of the Survey Division, Texas General Land Office, by phone at (512) 463-5212, email bill.o'hara@glo.texas.gov, or fax (512) 463-5223.

TRD-201404358  
Larry L. Laine  
Chief Clerk, Deputy Land Commissioner  
General Land Office  
Filed: September 11, 2014

### Notice of Approval of Coastal Boundary Survey

Pursuant to §33.136 of the Texas Natural Resources Code, notice is hereby given that Jerry Patterson, Commissioner of the General Land Office, approved a coastal boundary survey described as follows:

A Coastal Boundary Survey, dated March 2013, by Michael W. Chandler, Registered Professional Land Surveyor and duly elected County Surveyor for Chambers County, delineating the line of Mean Higher High Water along the western shore of Trinity Bay Submerged Land Tracts 10-11E and 14-15E, same line, being a portion of the littoral boundary of the Solomon Barrow Survey, Abstract 3. The survey is in support of cordgrass planting and rip-rap placement along the shore, authorized under Texas General Land Office lease No. CL20130002 and situated at McCollum Park (coordinates N 29° 44' 42", W 94° 49' 40", WGS84).

This survey is intended to provide pre-project baseline information related to an erosion response activity on coastal public lands. An owner of uplands adjoining the project area is entitled to continue to exercise littoral rights possessed prior to the commencement of the erosion response activity, but may not claim any additional land as a result of accretion, reliction, or avulsion resulting from the erosion response activity.

For a copy of this survey or more information on this matter, contact Bill O'Hara, Director of the Survey Division, Texas General Land Office, by phone at (512) 463-5212, email bill.o'hara@glo.texas.gov, or fax (512) 463-5223.

TRD-201404359  
Larry L. Laine  
Chief Clerk, Deputy Land Commissioner  
General Land Office  
Filed: September 11, 2014

### Texas Health and Human Services Commission

Notice of Public Hearing on Proposed Medicaid Payment Rates Hearing. The Texas Health and Human Services Commission (HHSC) will conduct a public hearing on October 17, 2014, at 2:00 p.m. to receive public comment on proposed rates for hospice routine home, continuous home, inpatient respite, and general inpatient care. The Medicaid hospice program is operated by the Texas Department of Aging and Disability Services (DADS).

The public hearing will be held in compliance with Texas Human Resources Code §32.0282, Government Code §531.021, and 1 Texas Administrative Code (TAC) §355.105(g), which require public notice and hearings on proposed Medicaid reimbursements. The public hearing

will be held in the Health and Human Services Commission Public Hearing Room, Brown Heatly Building, located at 4900 North Lamar, Austin, Texas. Entry is through Security at the main entrance of the building, which faces Lamar Boulevard.

**Proposal.** The payment rates for hospice routine home, continuous home, inpatient respite, and general inpatient care are proposed to be effective October 1, 2014.

**Methodology and Justification.** The hospice reimbursement methodology is located at the Code of Federal Regulations, Title 42, Part 418, Subpart G.

**Briefing Package.** A briefing package describing the proposed payment rates will be available at <http://www.hhsc.state.tx.us/rad/rate-packets.shtml> on or after October 3, 2014. Interested parties also may obtain a copy of the briefing package before the hearing by contacting Michelle Mikulencak by telephone at (512) 730-7401; by fax at (512) 730-7475; or by e-mail to [RAD-LTSS@hhsc.state.tx.us](mailto:RAD-LTSS@hhsc.state.tx.us). The briefing package will also be available at the public hearing.

**Written Comments.** Written comments regarding the proposed payment rates may be submitted in lieu of, or in addition to, oral testimony until 5:00 p.m. the day of the hearing. Written comments may be sent by U.S. mail to the Texas Health and Human Services Commission, Rate Analysis Department, Mail Code H-400, P.O. Box 149030, Austin, Texas 78714-9030; by fax to Rate Analysis at (512) 730-7475; or by e-mail to [RAD-LTSS@hhsc.state.tx.us](mailto:RAD-LTSS@hhsc.state.tx.us). In addition, written comments may be sent by overnight mail or hand delivered to the Texas Health and Human Services Commission, Rate Analysis Department, Mail Code H-400, 4900 North Lamar, Austin, Texas 78751-2316.

Persons requiring Americans with Disabilities Act (ADA) accommodation or auxiliary aids or services should contact Rate Analysis at (512) 730-7401 at least 72 hours before the hearing so appropriate arrangements can be made.

TRD-201404380  
Jack Stick  
Chief Counsel  
Texas Health and Human Services Commission  
Filed: September 12, 2014

### Public Notice

The Texas Health and Human Services Commission announces its intent to submit transmittal number 14-030 to the Texas State Plan for Medical Assistance, under Title XIX of the Social Security Act.

The purpose of this amendment is to update the state plan's provisions regarding the prohibition against reassignment of provider claims by adding an exception for substitute physician arrangements. The amendment would clarify that no payment under the plan for any care or service provided to an individual shall be made to anyone other than the person providing such care or service, except in cases where a substitute physician sees a billing physician's patients for 14 continuous days or less under an informal reciprocal arrangement or for up to 90 continuous days under a formal locum tenens arrangement. The proposed amendment is effective July 14, 2014.

The proposed amendment is estimated to have no fiscal impact. The clarification of the State's substitute physician arrangements would align the state plan with the State's program rules without changing Medicaid fees, costs, or utilization.

To obtain copies of the proposed amendment, interested parties may contact Marcus Denton, State Plan Coordinator, by mail at the Health and Human Services Commission, P.O. Box 13247, Mail Code H-100,

IN ADDITION September 26, 2014 39 TexReg 7819

TEXAS GENERAL LAND OFFICE  
Art. 33.136, Natural Resources Code  
Co. Brazoria, Sketch No. 15  
File Date 09/21/2014 by R. Kartye

Texas. Secretary of State. Texas Register, Volume 39, Number 39, Pages 7645-7830, September 26, 2014, periodical, September 26, 2014; Austin, Texas.

([texashistory.unt.edu/ark:/67531/metaph517285/m1/175/](http://texashistory.unt.edu/ark:/67531/metaph517285/m1/175/)?

q=Merten%20AND%20%22Coastal%20Boundary%20Survey%22: accessed June 21, 2018),

University of North Texas Libraries, The Portal to Texas History, [texashistory.unt.edu](http://texashistory.unt.edu); crediting UNT Libraries Government Documents Department.