

VOL 67 Pg 641

BEING THE SOUTH PORTION OF SHAMROCK ISLAND LYING WITHIN THE WILLIAM LITTLE SURVEY, ABSTRACT NO. 215, SAID SOUTH PORTION BORDERED BY STATE OF TEXAS SUBMERGED TRACTS 428, 429, 438, AND 439 OF CORPUS CHRISTI BAY AND SAID NORTH PORTION BEING MORE PARTICULARLY DESCRIBED BY METES AND BOUNDS AS FOLLOWS:

BEGINNING AT A CORNER HAVING A STATE PLANE GRID COORDINATE OF N 17,168,337.28, E 1,414,785.42, NAD'83, TEXAS SOUTH ZONE IN U.S. FEET, SAID CORNER LYING ON THE MEAN HIGH WATER BOUNDARY BETWEEN SAID WILLIAM LITTLE SURVEY AND SUBMERGED TRACT 428 AND FORM WHICH NG'S MONUMENT "SHAM" BEARS S 29°52'25" W, 3637.90' (1309.64 VARAS); THENCE WITH SAID MEAN HIGH WATER BOUNDARY AND WITH THE FOLLOWING LINES AS FOLLOWS:

Table with columns: LINE, BEARING, LENGTH (FT.), LENGTH (VARA), LINE, BEARING, LENGTH (FT.), LENGTH (VARA). Contains survey data for submerged tracts 438, 429, 438, 439.

TO THE POINT OF BEGINNING AND CONTAINING 107.98 ACRES OF LAND, MORE OR LESS, WITHIN THIS DESCRIPTION.

BEING THE NORTH PORTION OF SHAMROCK ISLAND LYING WITHIN THE WILLIAM LITTLE SURVEY, ABSTRACT NO. 215, AND BORDERED BY STATE OF TEXAS SUBMERGED TRACTS 428, AND 429, OF CORPUS CHRISTI BAY AND SAID NORTH PORTION BEING MORE PARTICULARLY DESCRIBED BY METES AND BOUNDS AS FOLLOWS:

BEGINNING AT A CORNER HAVING A STATE PLANE GRID COORDINATE OF N 17,168,225.69, E 1,414,892.46, NAD'83, TEXAS SOUTH ZONE IN U.S. FEET, SAID CORNER LYING ON THE MEAN HIGH WATER BOUNDARY BETWEEN SAID WILLIAM LITTLE SURVEY AND SUBMERGED TRACT 428 AND FORM WHICH NG'S MONUMENT "SHAM" BEARS S 32°14'18" W, 3597.51' (1295.10 VARAS); THENCE WITH SAID MEAN HIGH WATER BOUNDARY AND WITH THE FOLLOWING LINES AS FOLLOWS:

Table with columns: LINE, BEARING, LENGTH (FT.), LENGTH (VARA), LINE, BEARING, LENGTH (FT.), LENGTH (VARA). Contains survey data for submerged tracts 428, 429.

TO THE POINT OF BEGINNING AND CONTAINING 14.26 ACRES OF LAND, MORE OR LESS, WITHIN THIS DESCRIPTION.

TEXAS GENERAL LAND OFFICE Art 33.136 Natural Resources Code Co. Nueces, Sketch No. 16 File Date 06/12/2019 by R. Harbo

I, DIANA T. BARRERA, CLERK OF THE COUNTY COURT, IN AND FOR NUECES COUNTY, TEXAS, HEREBY CERTIFY THAT THE FOREGOING INSTRUMENT DATED THE 14th DAY OF June, 2012, WITH ITS CERTIFICATE OF AUTHENTICATION, WAS FILED FOR RECORD IN MY OFFICE THIS 14th DAY OF June, 2012, AT 4:02 O'CLOCK P. M. AND DULY RECORDED THE 14th DAY OF June, 2012, AT 4:02 O'CLOCK P. M. IN SAID COUNTY IN VOLUME 67, PAGE 641, MAP RECORDS OF NUECES COUNTY, TEXAS.

Dianna T. Barrera DIANA T. BARRERA, COUNTY CLERK Emma Cruz EMMA CRUZ, DEPUTY OF THE COUNTY CLERK

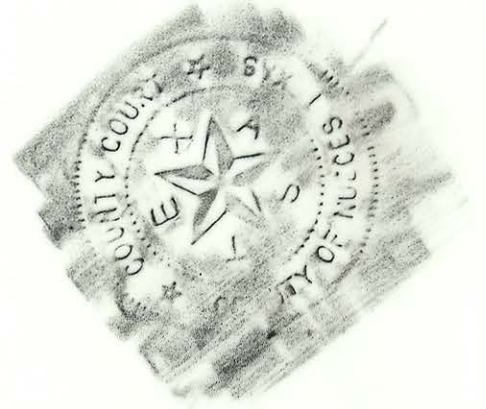

Table with columns: PROJECT MANAGER, SURVEY, CADD, PROJECT NUMBER. Values: G. RUBALCABA, G. RUBALCABA, G. GATICA, 180349.



THE NATURE CONSERVANCY COASTAL BOUNDARY OF SHAMROCK ISLAND NUECES COUNTY TEXAS. Includes a scale bar and sheet number 002.

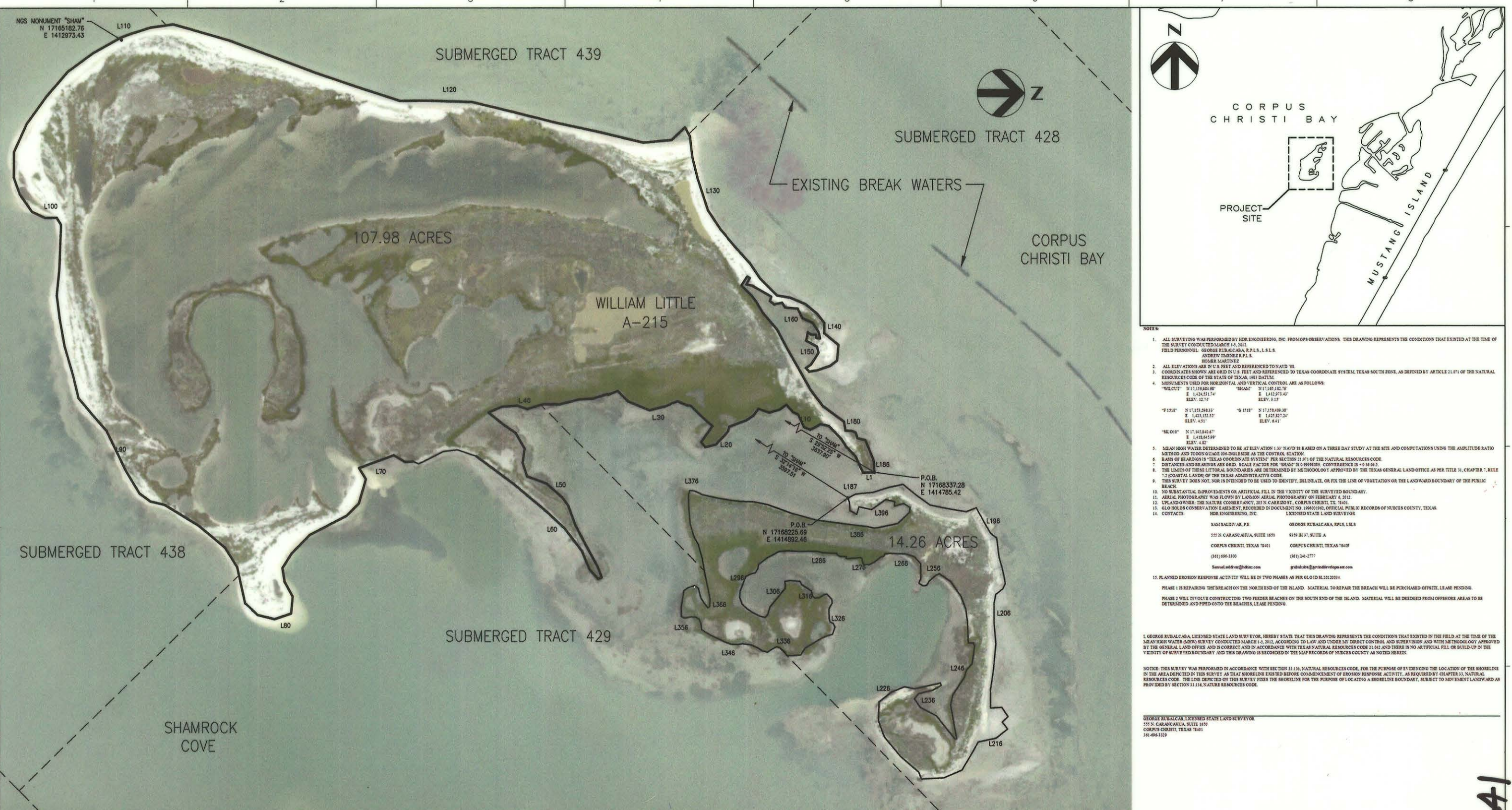
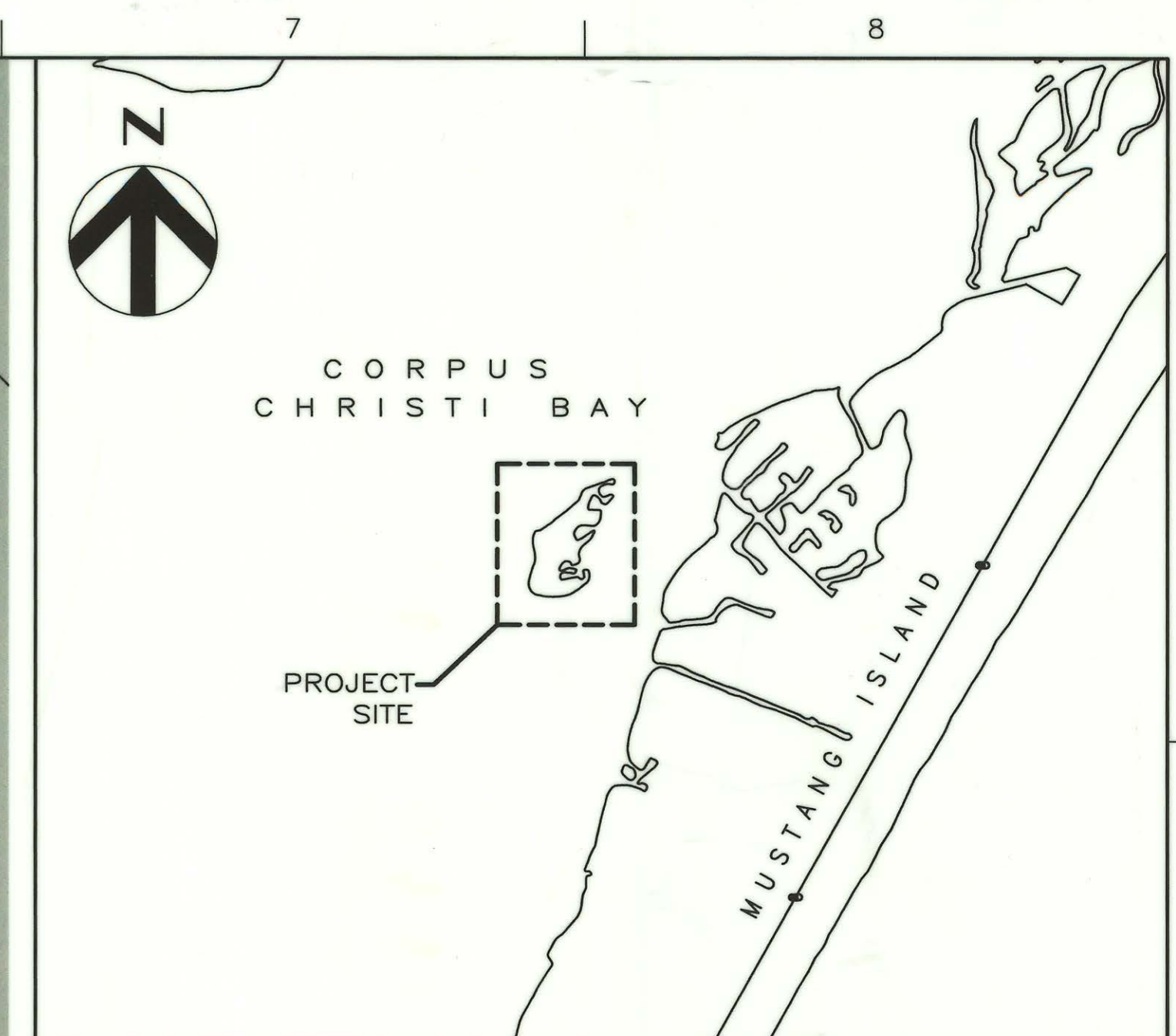

Table with columns: PROJECT MANAGER, SURVEY, CADD, PROJECT NUMBER. Values: G. RUBALCABA, G. RUBALCABA, G. GATICA, 180349.



THE NATURE CONSERVANCY COASTAL BOUNDARY OF SHAMROCK ISLAND NUECES COUNTY TEXAS. Includes a scale bar and sheet number 001.

VOL 67 Pg 641 94804



- NOTES:**
1. ALL SURVEYING WAS PERFORMED BY HDR ENGINEERING, INC. FROM GPS OBSERVATIONS. THIS DRAWING REPRESENTS THE CONDITIONS THAT EXISTED AT THE TIME OF THE SURVEY CONDUCTED MARCH 1-5, 2012. FIELD PERSONNEL: GEORGE RUBALCABA, R.P.L.S., L.S.L.S. ANDREW JIMENEZ R.P.L.S. HOMER MARTINEZ
 2. ALL ELEVATIONS ARE IN U.S. FEET AND REFERENCED TO NAVD 83
 3. COORDINATES SHOWN ARE GRID IN U.S. FEET AND REFERENCED TO TEXAS COORDINATE SYSTEM, TEXAS SOUTH ZONE, AS DEFINED BY ARTICLE 21.071 OF THE NATURAL RESOURCES CODE OF THE STATE OF TEXAS, 1981 DATUM.
 4. MONUMENTS USED FOR HORIZONTAL AND VERTICAL CONTROL ARE AS FOLLOWS:
 "WILCUT" N 17,159,684.98' E 1,424,531.74' ELEV. 12.74'
 "SHAM" N 17,165,182.70' E 1,412,973.43' ELEV. 13.15'
 "F 1518" N 17,153,598.33' E 1,423,152.52' ELEV. 4.51'
 "G 1518" N 17,158,400.38' E 1,425,827.24' ELEV. 6.41'
 "SK 010" N 17,145,840.67' E 1,418,645.99' ELEV. 4.82'
 5. MEAN HIGH WATER DETERMINED TO BE AT ELEVATION 1.3' NAVD 83 BASED ON A THREE DAY STUDY AT THE SITE AND COMPUTATIONS USING THE AMPLITUDE RATIO METHOD AND TIDE GAUGE 066-066-066 AS THE CONTROL STATION.
 6. BASIS OF BEARINGS IS "TEXAS COORDINATE SYSTEM" PER SECTION 21.071 OF THE NATURAL RESOURCES CODE.
 7. DISTANCES AND BEARINGS ARE GRID. SCALE FACTOR FOR "SHAM" IS 0.9999888. CONVERGENCE IS +0.36 06.5
 8. THE LIMITS OF THESE LITORAL BOUNDARIES ARE DETERMINED BY METHODOLOGY APPROVED BY THE TEXAS GENERAL LAND OFFICE AS PER TITLE 31, CHAPTER 7, RULE 7.2 (COASTAL LANDS) OF THE TEXAS ADMINISTRATIVE CODE.
 9. THIS SURVEY DOES NOT, NOR IS IT INTENDED TO BE USED TO IDENTIFY, DELINEATE, OR FIX THE LINE OF VEGETATION OR THE LANDWARD BOUNDARY OF THE PUBLIC BEACH.
 10. NO SUBSTANTIAL IMPROVEMENTS OR ARTIFICIAL FILL IN THE VICINITY OF THE SURVEYED BOUNDARY.
 11. AERIAL PHOTOGRAPHY WAS FLOWN BY LANDSON AERIAL PHOTOGRAPHY ON FEBRUARY 4, 2012.
 12. UPLAND OWNER: THE NATURE CONSERVANCY, 255 N. CARREZO ST., CORPUS CHRISTI, TX 78401
 13. GLO HOLDS CONSERVATION EASEMENT, RECORDED IN DOCUMENT NO. 198601962, OFFICIAL PUBLIC RECORDS OF NUECES COUNTY, TEXAS.
 14. CONTACTS:
 HDR ENGINEERING, INC. LICENSED STATE LAND SURVEYOR
 SAM SALDIVAR, P.E. GEORGE RUBALCABA, R.P.L.S., L.S.L.S.
 555 N. CARANCAHUA, SUITE 1650 9359 H 37, SUITE A
 CORPUS CHRISTI, TEXAS 78401 CORPUS CHRISTI, TEXAS 78409
 (361) 696-3300 (361) 241-2777
 Sam.saldivar@hdrinc.com georgerubal@gnrdevelopment.com
 15. PLANNED EROSION RESPONSE ACTIVITY WILL BE IN TWO PHASES AS PER GLO ID SL20120034.
 PHASE 1 IS REPAIRING THE BREACH ON THE NORTH END OF THE ISLAND. MATERIAL TO REPAIR THE BREACH WILL BE PURCHASED OFFSITE, LEASE PENDING.
 PHASE 2 WILL INVOLVE CONSTRUCTING TWO FEEDER BEACHES ON THE SOUTH END OF THE ISLAND. MATERIAL WILL BE DREDGED FROM OFFSHORE AREAS TO BE DETERMINED AND PIPED ONTO THE BEACHES, LEASE PENDING.

I, GEORGE RUBALCABA, LICENSED STATE LAND SURVEYOR, HEREBY STATE THAT THIS DRAWING REPRESENTS THE CONDITIONS THAT EXISTED IN THE FIELD AT THE TIME OF THE MEAN HIGH WATER (MHW) SURVEY CONDUCTED MARCH 1-5, 2012, ACCORDING TO LAW AND UNDER MY DIRECT CONTROL AND SUPERVISION AND WITH METHODOLOGY APPROVED BY THE GENERAL LAND OFFICE AND IS CORRECT AND IN ACCORDANCE WITH TEXAS NATURAL RESOURCES CODE 21.042 AND THERE IS NO ARTIFICIAL FILL OR BUILDUP IN THE VICINITY OF SURVEYED BOUNDARY AND THIS DRAWING IS RECORDED IN THE MAP RECORDS OF NUECES COUNTY AS NOTED HEREIN.

NOTICE: THIS SURVEY WAS PERFORMED IN ACCORDANCE WITH SECTION 31.136, NATURAL RESOURCES CODE, FOR THE PURPOSE OF EVIDENCING THE LOCATION OF THE SHORELINE IN THE AREA DEPICTED IN THIS SURVEY AS THAT SHORELINE EXISTED BEFORE COMMENCEMENT OF EROSION RESPONSE ACTIVITY, AS REQUIRED BY CHAPTER 31, NATURAL RESOURCES CODE. THE LINE DEPICTED ON THIS SURVEY FIXES THE SHORELINE FOR THE PURPOSE OF LOCATING A SHORELINE BOUNDARY, SUBJECT TO MOVEMENT LANDWARD AS PROVIDED BY SECTION 31.136, NATURAL RESOURCES CODE.

GEORGE RUBALCABA, LICENSED STATE LAND SURVEYOR
 555 N. CARANCAHUA, SUITE 1650
 CORPUS CHRISTI, TEXAS 78401
 361-696-3329

TEXAS GENERAL LAND OFFICE
 Art. 33.136, Natural Resources Code
 Co. Nueces, Nueces County
 File Date 04/12/12 by R. Martinez

Vol. 67, Pg. 647

ISSUE	DATE	DESCRIPTION

PROJECT MANAGER: G. RUBALCABA
 SURVEY: G. RUBALCABA
 CADD: G. GATICA

PROJECT NUMBER 180349



COASTAL BOUNDARY OF SHAMROCK ISLAND
 NUECES COUNTY, TEXAS

THE NATURE CONSERVANCY
 COASTAL BOUNDARY OF SHAMROCK ISLAND
 SITE MAP
 NUECES COUNTY TEXAS

FILENAME: _____ SHEET: 001
 SCALE: 1" = 200'

BEING THE SOUTH PORTION OF SHAMROCK ISLAND LYING WITHIN THE WILLIAM LITTLE SURVEY, ABSTRACT NO. 215, SAID SOUTH PORTION BORDERED BY STATE OF TEXAS SUBMERGED TRACTS 428, 429, 438, AND 439 OF CORPUS CHRISTI BAY AND SAID PORTION BEING MORE PARTICULARLY DESCRIBED BY METES AND BOUNDS AS FOLLOWS:

BEGINNING AT A CORNER HAVING A STATE PLANE GRID COORDINATE OF N 17,168,337.28, E 1,414,785.42, NAD'83, TEXAS SOUTH ZONE IN U.S. FEET, SAID CORNER LYING ON THE MEAN HIGH WATER BOUNDARY BETWEEN SAID WILLIAM LITTLE SURVEY AND SUBMERGED TRACT 428 AND FORM WHICH NGS MONUMENT "SHAM" BEARS S 29°52'25" W, 3637.90' (1309.64 VARAS); THENCE WITH SAID MEAN HIGH WATER BOUNDARY AND WITH THE FOLLOWING LINES AS FOLLOWS;

Table with columns: LINE, BEARING, LENGTH (FT.), LENGTH (VARA), LINE, BEARING, LENGTH (FT.), LENGTH (VARA), LINE, BEARING, LENGTH (FT.), LENGTH (VARA). Contains 186 rows of survey data.

TO THE POINT OF BEGINNING AND CONTAINING 107.98 ACRES OF LAND, MORE OR LESS, WITHIN THIS DESCRIPTION.

BEING THE NORTH PORTION OF SHAMROCK ISLAND LYING WITHIN THE WILLIAM LITTLE SURVEY, ABSTRACT NO. 215, AND BORDERED BY STATE OF TEXAS SUBMERGED TRACTS 428, AND 429, OF CORPUS CHRISTI BAY AND SAID NORTH PORTION BEING MORE PARTICULARLY DESCRIBED BY METES AND BOUNDS AS FOLLOWS:

BEGINNING AT A CORNER HAVING A STATE PLANE GRID COORDINATE OF N 17,168,225.69, E 1,414,892.46, NAD'83, TEXAS SOUTH ZONE IN U.S. FEET, SAID CORNER LYING ON THE MEAN HIGH WATER BOUNDARY BETWEEN SAID WILLIAM LITTLE SURVEY AND SUBMERGED TRACT 428 AND FORM WHICH NGS MONUMENT "SHAM" BEARS S 32°14'16" W, 3597.51' (1295.10 VARAS); THENCE WITH SAID MEAN HIGH WATER BOUNDARY AND WITH THE FOLLOWING LINES AS FOLLOWS;

Table with columns: LINE, BEARING, LENGTH (FT.), LENGTH (VARA), LINE, BEARING, LENGTH (FT.), LENGTH (VARA), LINE, BEARING, LENGTH (FT.), LENGTH (VARA). Contains 186 rows of survey data.

TO THE POINT OF BEGINNING AND CONTAINING 14.26 ACRES OF LAND, MORE OR LESS, WITHIN THIS DESCRIPTION.

STATE OF TEXAS COUNTY OF NUECES

I, DIANA T. BARRERA, CLERK OF THE COUNTY COURT, IN AND FOR NUECES COUNTY, TEXAS, HEREBY CERTIFY THAT THE FOREGOING INSTRUMENT DATED THE 14TH DAY OF JUNE, 2012, WITH ITS CERTIFICATE OF AUTHENTICATION, WAS FILED FOR RECORD IN MY OFFICE THIS 14TH DAY OF JUNE, 2012, AT 4:02 O'CLOCK P. M. AND DULY RECORDED THE 14TH DAY OF JUNE, 2012, AT 4:02 O'CLOCK P. M. IN SAID COUNTY IN VOLUME 67, PAGE 641, MAP RECORDS OF NUECES COUNTY, TEXAS.

DIANA T. BARRERA COUNTY CLERK

EMMA CRUZ DEPUTY OF THE COUNTY CLERK

TEXAS GENERAL LAND OFFICE File Date 06/14/2012 by R. Harkins



Table with columns: ISSUE, DATE, DESCRIPTION

Table with columns: PROJECT MANAGER, SURVEY, CADD, PROJECT NUMBER



COSTAL BOUNDARY OF SHAMROCK ISLAND NUECES COUNTY, TEXAS

THE NATURE CONSERVANCY COASTAL BOUNDARY OF SHAMROCK ISLAND FIELD NOTE DESCRIPTION NUECES COUNTY TEXAS

Table with columns: FILENAME, SCALE, SHEET



Surveying Division
Coastal Boundary Survey Approval

TEXAS GENERAL LAND OFFICE
Art. 33.136, Natural Resources Code
Co. Nueces, Sketch No. 16
File Date 06/27/2012 by R. Kurtze

Project: Shamrock Island Breach Repair and Beach Nourishment

Project No: SL20120034 (GLO)

Project Manager: Amy Nunez (GLO - Lower Coast)

Surveyor: George Rubalcaba, Licensed State Land Surveyor

Description: A Coastal Boundary Survey, dated March 1-5, 2012, by George Rubalcaba, Licensed State Land Surveyor, delineating the littoral boundary of a portion of the Wm Little Survey, Abstract 215, Nueces County, same line being the boundary of remnants of said survey, situated in Corpus Christi Bay and known as Shamrock Island, bounded on the north by Tract 428, on the east by Tract 429, on the south by Tract 438 and on the west by Tract 439, said tracts being state owned submerged land tracts as shown on Texas General Land Office, Submerged Area Map No. 2797-442.

A Coastal Boundary Survey for the above-referenced project has been reviewed and accepted; upon completion of public notice requirements, the survey will be filed in the Texas General Land Office, Archives and Records, in accordance with provisions of the *Texas Natural Resources Code*, Chapter 33.136.

Approved:

Signed: David A. Pyle
Surveying Division

July 12, 2012
Date

Approval Filed as:

Texas Natural Resources Code Article 33.136, Nueces County, ^{Sketch} ~~Small Format~~ Sketch No. 16
RR

June 28, 2012

180349

Mr. David Pyle, RPLS, LSLS
Texas General Land Office
Surveying Division
1700 N. Congress Avenue
Austin, Texas 78701-1495

RE: COASTAL BOUNDARY OF SHAMROCK ISLAND, NUECES COUNTY, TEXAS

Dear David:

Please find enclosed the recorded survey of the Coastal Boundary of Shamrock Island. Since the county clerk specifies an 18x24 size for the recording, we merged the half size drawings into one for the recording.

I have enclosed the recorded version as well as the normal full size drawings we normally submit with the recorded information.

If you have any questions, let me know.

Sincerely,



George Rubalcaba, RPLS, LSLS
Survey Group Manager

TEXAS GENERAL LAND OFFICE
Art. 33.136, Natural Resources Code
Co. Nueces, Sketch No. 16
File Date 06/27/2012 by R. Rortye

Enclosures:

Recorded coastal boundary of Shamrock Island
Full size drawings of coastal boundary of Shamrock Island

Texas Register, Volume 37, Number 32, Pages 5857-6178, August 10, 2012 Page: 6,151

If you need more information about these permit applications or the permitting process, please call the TCEQ Public Education Program, toll free, at 1-800-687-4040. General information about the TCEQ can be found at our web site at www.tceq.texas.gov. Si desea información en español, puede llamar al 1-800-687-4040.

TRD-201204042
Bridget C. Bohac
Chief Clerk
Texas Commission on Environmental Quality
Filed: August 1, 2012

Texas Ethics Commission

List of Late Filers

Listed below are the names of filers from the Texas Ethics Commission who did not file reports, or failed to pay penalty fines for late reports in reference to the listed filing deadline. If you have any questions, you may contact Robbie Douglas at (512) 463-5800.

Deadline: Semiannual Report due January 17, 2012, for Candidates and Officeholders

Teresa J. Hawthorne, P.O. Box 670844, Dallas, Texas 75367-0844

Deadline: 8-Day Pre-Election Report due May 21, 2012, for Candidates and Officeholders

Rebecca Berger, 349 Private Road 2006, Schulenburg, Texas 78956-5885

Joseph F. Hoelscher II, 115 E. Travis, Ste. 1500, San Antonio, Texas 78205

Philip E. Mullin, 1790 Lee Trevino, Ste. 214, El Paso, Texas 79936

David L. Nigh, 494 S. Seguin Ave., Ste. 201, New Braunfels, Texas 78130

Deadline: 30-Day Pre-Election Report due April 30, 2012, for Committees

Janis Lowe, Friendswood Republican Women PAC, 1506 Winding Way, Friendswood, Texas 77546

Billie W. James, Arlington Republican Club PWR PAC, P.O. Box 14095, Arlington, Texas 76094-1095

Deadline: 8-Day Pre-Election Report due May 21, 2012, for Committees

Janis Lowe, Friendswood Republican Women PAC, 1506 Winding Way, Friendswood, Texas 77546

Billie W. James, Arlington Republican Club PWR PAC, P.O. Box 14095, Arlington, Texas 76094-1095

Deadline: Monthly Report due June 5, 2012, for Committees

Gina M. Gabriano, Alliance of Conservative Texans, 5040 Lorraine Dr., Frisco, Texas 75034

Richard Christopher Nevils, Bayou City P.A.C., 414 Marshall St. #1, Houston, Texas 77006

Deadline: Lobby Activities Report due April 10, 2012

Stephen W. Greenberg, 1510 W. Loop South, Houston, Texas 77027

Jennifer E. Sellers, P.O. Box 684501, Austin, Texas 78768

Bryan P. Sperry, 823 Congress Ave., Ste. 1500, Austin, Texas 78701

Deadline: Personal Financial Statement due April 18, 2012

Vacochia I. Barnett, 7205 Port Phillip Dr., Arlington, Texas 76002

Michael Berlanga, 4110 Greenboro, San Antonio, Texas 78229

Deadline: Personal Financial Statement due April 30, 2012

Lionel Sosa, 215 Rohde Ct., Floresville, Texas 78114

TRD-201203905
David Reisman
Executive Director
Texas Ethics Commission
Filed: July 27, 2012

Texas Facilities Commission

Request for Proposals #303-4-20339

The Texas Facilities Commission ("TFC"), on behalf of the Office of the Attorney General ("OAG"), announces the issuance of Request for Proposals ("RFP") #303-4-20339. TFC seeks a five (5) or ten (10) year lease of approximately 8,837 square feet of office space in El Paso, El Paso County, Texas.

The deadline for questions is August 23, 2012, and the deadline for proposals is September 6, 2012, at 3:00 p.m. The award date is October 17, 2012. TFC reserves the right to accept or reject any or all proposals submitted. TFC is under no legal or other obligation to execute a lease on the basis of this notice or the distribution of an RFP. Neither this notice nor the RFP commits TFC to pay for any costs incurred prior to the award of a grant.

Parties interested in submitting a proposal may obtain information by contacting the Regional Leasing Assistant, Evelyn Esquivel, at (512) 463-6494. A copy of the RFP may be downloaded from the Electronic State Business Daily at http://esbd.cpa.state.tx.us/bid_show.cfm?bidid=101808.

TRD-201204052
Kay Molina
General Counsel
Texas Facilities Commission
Filed: August 1, 2012

General Land Office

Notice of Approval of Coastal Boundary Survey

Pursuant to §33.136 of the Texas Natural Resources Code, notice is hereby given that Jerry Patterson, Commissioner of the General Land Office, approved a coastal boundary survey described as follows:

A Coastal Boundary Survey, dated March 1 - 5, 2012, by George Rubalcaba, Licensed State Land Surveyor, delineating the littoral boundary of a portion of the Wm Little Survey, Abstract 215, Nueces County, same line being the boundary of remnants of said survey, situated in Corpus Christi Bay and known as Shamrock Island, bounded on the north by Tract 428, on the east by Tract 429, on the south by Tract 438 and on the west by Tract 439, said tracts being state owned submerged land tracts as shown on Texas General Land Office, Submerged Area Map No. 2797-442.

This survey is intended to provide pre-project baseline information related to an erosion response activity on coastal public lands. An owner of uplands adjoining the project area is entitled to continue to exercise littoral rights possessed prior to the commencement of the erosion response activity, but may not claim any additional land as a result of

TEXAS GENERAL LAND OFFICE
Art. 33.136, Natural Resources Code

Co. Nueces, Sketch No. 16

File Date 06/22/2018 by R. Kartye

IN ADDITION August 10, 2012 37 TexReg 6151

Texas. Secretary of State. Texas Register, Volume 37, Number 32, Pages 5857-6178, August 10, 2012, periodical, August 10, 2012; Austin, Texas. (texashistory.unt.edu/ark:/67531/metaph244544/m1/292/?q=Rubalcaba%20AND%20%22Coastal%20Boundary%20Survey%22: accessed June 21, 2018), University of North Texas Libraries, The Portal to Texas History, texashistory.unt.edu; crediting UNT Libraries Government Documents Department.

Texas Register, Volume 37, Number 32, Pages 5857-6178, August 10, 2012 Page: 6,152

accretion, reliction, or avulsion resulting from the erosion response activity.

For a copy of this survey or more information on this matter, contact Bill O'Hara, Director of the Survey Division, Texas General Land Office by phone at (512) 463-5223, email bill.o'hara@glo.texas.gov, or fax (512) 475-4619.

TRD-201203971
Larry L. Laine
Chief Clerk, Deputy Land Commissioner
General Land Office
Filed: July 31, 2012

Texas Health and Human Services Commission

Notice of Intent to Enter into a Consultant Contract for a Subject Matter Expert for the Sunset Review Process

In accordance with Texas Government Code, Chapter 2254, the Health and Human Services Commission (HHSC) announces its intention to enter into a Consultant Contract for the guidance and accurate understanding of the scope of information Sunset requires for their review process scheduled for the 84th Legislature beginning in 2015.

PURPOSE

The purpose of this contract is to obtain services of a single, qualified consultant to provide information, advice, and assistance to HHSC concerning preparation for, undergoing, and responding to a Sunset review which is a complex and lengthy process. This qualified consultant will help HHSC by providing expert services for the agencies to assess their missions and statutory requirements and how their organizations meet those goals and regulations. The ability to have an expert in the Sunset process external to HHS provide guidance on the structure and approach to the Sunset review, analyze materials, help identify agency strengths and vulnerabilities, prepare staff for testimony, and interpret Sunset actions could be a significant asset to HHS agencies. HHSC intends to contract with Civic Initiatives, L.L.C., for a 12-month time period with options to extend, unless a better offer is received subsequent to publication of these service requirements. HHSC publishes this notice to determine the existence of any other vendors with this skill set and knowledge base. If competing proposals are received, HHSC will base its selection on: (1) demonstrated competence, knowledge and qualifications and experience, including the depth, breadth, and quality of information and expertise the proposer can provide; and (2) the reasonableness of the proposed price. All other factors being equal, HHSC will give preference to a vendor whose offices, or whose operations for this engagement, are located in Texas.

HHSC is procuring consultant services to assist HHSC in its role in the HHSC's 2015 84th Legislative Sunset review process. The services being procured are more fully described below.

The vendor compensation will be based on an agreed upon amount for performance of deliverables. Deliverables tie to the reports, stakeholder input, and deadlines required or deemed necessary to complete the review.

Vendors may currently have staff on contract; however, no new subcontracting to perform this scope of work will be allowed. HHSC reserves the right to cancel this contract in the event the Legislature acts to postpone the HHS Sunset Review past FY 2015.

DESCRIPTION OF WORK

The qualified consultant will help HHSC by providing expert services for the agencies to assess their missions and statutory requirements and

how their organizations meet those goals and regulations. The time period to prepare, undergo, and respond to a Sunset review is extended but varies by intensity throughout the cycle. The HHS agencies plan to complete their drafts of the Sunset required self-evaluation reports prior to the legislative session, even though they are not due to the Sunset Advisory Commission until late August 2013. The intent is to allow HHS staff to focus on the legislative session rather than have to respond to internal HHS staff requests to provide Sunset required information and documentation. Guidance from an external subject matter expert at the outset of this process would help ensure an accurate understanding of the scope of information Sunset requires and limit multiple information requests to program staff. Following the legislative session is another intense period of activity to complete the reports. The proposed subject matter expert shall read and comment on the reports in time for staff to revise the reports prior to submission to the Sunset Advisory Commission. As specified by HHSC, the awarded consultant will provide services as an independent expert providing complex policy analysis to help guide HHSC and the independent entity under contract with HHSC, to ensure successful completion of the review. The information, advice, and assistance provided by the consultant must demonstrate deep and comprehensive knowledge of the review, analysis process, as well as in depth knowledge and demonstrated foresight into potential legislative, management or policy implications of such reviews and resulting recommendations. The consultant will provide advice regarding the review and assistance in producing the reports and analysis required. This will include assistance with the critical component of coordinating and gathering input in conjunction with the review.

DESCRIPTION OF COMPENSATION

A. Total Compensation. For the information, advice, and assistance described above, and subject to the terms of the agreement finally executed between HHSC and the awarded vendor, HHSC will pay the awarded vendor an agreed upon amount based on the performance of the listed deliverables. The total amount for the work to be performed under the initial 12-month contract cannot exceed \$200,000. Proposals must include a proposed total amount for the performance of the deliverables and a description of the methodology used to determine that amount. Any proposal received that does not include a projected rate for performance of the deliverables and the methodology for determining the rate or that exceeds \$200,000 for the total of all deliverables will be automatically rejected as non-conforming to advertised requirements.

B. List of Deliverables

Internal Strategy and Pre-Assessment

- * Advise executive management on approach to Sunset process
- * Help with pre-planning, how to organize and prepare, and structure reports required by Sunset
- * Work with the HHS agencies to identify areas of focus and recommend preemptive actions

HHS Self Evaluation Reports

- * Read reports and assess strengths and weaknesses
- * Advise on policy issues

Active Sunset Review

- * Advise on all aspects on the Sunset review - prepare agency staff for interviews, review Sunset staff reports, inform agency staff on what to expect during the exit conference, provide strategy on how to respond to the Sunset HHS report
- * Serve as a resource to the HHS agencies Sunset liaisons

TEXAS GENERAL LAND OFFICE
Art. 33.136, Natural Resources Code
Co. Nueces, Sketch No. 16
File Date 06/22/12 by R. Korte

37 TexReg 6152 August 10, 2012 Texas Register

Texas. Secretary of State. Texas Register, Volume 37, Number 32, Pages 5857-6178, August 10, 2012, periodical, August 10, 2012; Austin, Texas. (texashistory.unt.edu/ark:/67531/metaph244544/m1/293/?q=Rubalcaba%20AND%20%22Coastal%20Boundary%20Survey%22: accessed June 21, 2018), University of North Texas Libraries, The Portal to Texas History, texashistory.unt.edu; crediting UNT Libraries Government Documents Department.