



NOTE:
SEE SHEET 2 FOR FILL AND BUILDUP TRACTS 1-3

MHHW LINE

LINE	BEARING	DISTANCE	DISTANCE2
L1	N 88°46'00" E	55.73'	20.06v
L2	N 78°10'03" E	44.38'	15.98v
L3	S 83°30'02" E	48.73'	17.54v
L4	N 88°56'39" E	123.19'	44.35v
L5	N 83°22'58" E	51.56'	18.56v
L6	N 83°22'58" E	44.48'	16.01v
L7	N 68°24'40" E	14.38'	5.18v
L8	S 74°17'18" E	22.53'	8.11v
L9	N 80°21'14" E	69.47'	25.01v
L10	N 75°52'39" E	59.18'	21.30v

- NOTES:
- FIELD SURVEY CONDUCTED ON JUNE 27, 2013 BY JAMES M. NAISMITH AND BENJAMIN S. GAMBILL OF NAISMITH MARINE SERVICES.
 - EROSION RESPONSE WORK WILL CONSIST OF THE FOLLOWING:
 - PROTECTING THE EXISTING CHANNEL AND ADJACENT WETLANDS BY EXTENDING THE EXISTING BREAKWATERS.
 - PLACEMENT OF THE DREDGED MATERIAL INTO A DESIGNATED BENEFICIAL USE PLACEMENT AREA WITHIN THE WATERS OF THE STATE.
 - CONSTRUCTING A ROCK DIKE SEAWARD OF THE BENEFICIAL USE PLACEMENT AREA TO PROTECT IT AGAINST WAVE EROSION.
 - COORDINATES AND ELEVATIONS ARE BASED ON MONUMENTS & ON OPUS SOLUTIONS.

"CAMPO"	3/4 IN. PIPE W/ CAP
N = 13,433,597.26	N = 13,461,534.79
E = 2,815,271.85	E = 2,801,151.83
	NAVD 88 = 5.7'
 - MEAN HIGHER HIGH WATER (MHHW) ELEVATION OF 1.2' FOR CARANCAHUA BAY WAS DETERMINED FROM PORT LAVACA TIDE GAUGE DATA.
 - TO CONVERT FEET TO VARAS MULTIPLY BY 0.36.
 - BOUNDARY LINES SHOWN HEREON ARE BASED ON CURRENT DEEDS AND RESEARCH AT THE APPRAISAL DISTRICT AND ARE FOR REFERENCE ONLY. THEY DO NOT REPRESENT A BOUNDARY SURVEY.
 - REFERENCE ACCOMPANYING REPORT DATED JUNE, 2013 FOR ADDITIONAL INFORMATION.
 - BACKGROUND IMAGE FROM GOOGLE EARTH AND IS FOR REFERENCE ONLY.

TEXAS GENERAL LAND OFFICE
 Art. 33.136, Natural Resources Code
 Co. Jackson, Subst. No. 1
 File Date 8/2/2013 by B. Kestive
 See Report

I, JAMES M. NAISMITH, HEREBY STATE THAT THIS DRAWING REPRESENTS A SURVEY THAT IS CORRECT AND IN ACCORDANCE WITH SECTION 21.042 TEXAS NATURAL RESOURCES CODE; WAS MADE ACCORDING TO LAW; WAS MADE IN THE FIELD UNDER MY DIRECT CONTROL AND SUPERVISION; WAS MADE UTILIZING METHODOLOGY APPROVED BY THE GLO; AND IS RECORDED IN

NOTICE: THIS SURVEY WAS PERFORMED IN ACCORDANCE WITH SECTION 33.136, NATURAL RESOURCES CODE, FOR THE PURPOSE OF EVIDENCING THE LOCATION OF THE SHORELINE IN THE AREA DEPICTED IN THIS SURVEY AS THAT SHORELINE EXISTED BEFORE COMMENCEMENT OF EROSION RESPONSE ACTIVITY, AS REQUIRED BY CHAPTER 33, NATURAL RESOURCES CODE. THE LINE DEPICTED ON THIS SURVEY FIXES THE SHORELINE FOR THE PURPOSE OF LOCATING A SHORELINE BOUNDARY, SUBJECT TO MOVEMENT LANDWARD AS PROVIDED BY SECTION 33.136, NATURAL RESOURCES CODE.

FILL, BUILDUP, AND RETAINING WALLS LOCATED WITHIN THE SURVEYED AREA AND ALONG THE SURVEYED LITTORAL BOUNDARY ARE SHOWN.

JMN 8/2/2013

JAMES M. NAISMITH
 LICENSED STATE LAND SURVEYOR

<p>Naismith Marine Sea Floor Surveying 3785 South Alameda, Suite 205 Corpus Christi, Texas 78411 WWW.NAISMITHMARINE.COM (361) 945-0248</p>	NO.	DATE	REVISION	COASTAL BOUNDARY SURVEY OF THE LITTORAL BOUNDARY OF A 1.8 AC UPLAND TRACT IN THE N.A. MCFARLAND SURVEY, A-42 ADJACENT TO ST 233, CARANCAHUA BAY JACKSON COUNTY, TEXAS
	SCALE: 1" = 50'	DATE: JUNE 2013	SHEET: 1 OF 2	



NOTE:
 FILL AND RIPRAP WERE PLACED ALONG THE ENTRANCE CHANNEL ACCORDING TO PLANS FOR A TEXAS PARKS AND WILDLIFE BOATRAMP PROJECT DATED JANUARY 28, 1971

- NOTES:
- FIELD SURVEY CONDUCTED ON JUNE 27, 2013 BY JAMES M. NAISMITH AND BENJAMIN S. GAMBILL OF NAISMITH MARINE SERVICES.
 - EROSION RESPONSE WORK WILL CONSIST OF THE FOLLOWING:
 - PROTECTING THE EXISTING CHANNEL AND ADJACENT WETLANDS BY EXTENDING THE EXISTING BREAKWATERS.
 - PLACEMENT OF THE DREDGED MATERIAL INTO A DESIGNATED BENEFICIAL USE PLACEMENT AREA WITHIN THE WATERS OF THE STATE.
 - CONSTRUCTING A ROCK DIKE SEAWARD OF THE BENEFICIAL USE PLACEMENT AREA TO PROTECT IT AGAINST WAVE EROSION.
- ALL WORK IS TO BE CONDUCTED UNDER GLO LEASE #: CL 2001003
- ALL BEARINGS ARE LAMBERT GRID BEARINGS AND ALL COORDINATES REFER TO THE TEXAS STATE PLANE COORDINATE SYSTEM, SOUTH CENTRAL ZONE (#4204), AS DEFINED BY ARTICLE 21.071 OF THE NATURAL RESOURCES CODE OF THE STATE OF TEXAS, 1983 DATUM, US FEET. ALL DISTANCES AND COORDINATES ARE GRID. THE SCALE FACTOR IS 0.999921051 AND MAPPING ANGLE IS 01d 16' 23".
 - COORDINATES AND ELEVATIONS ARE BASED ON MONUMENTS & ON OPUS SOLUTIONS.

"CAMPO"	3/4 IN. PIPE W/ CAP
N = 13,433,597.26	N = 13,461,534.79
E = 2,815,271.85	E = 2,801,151.83
	NAVD 88 = 5.7'
 - MEAN HIGHER HIGH WATER (MHHW) ELEVATION OF 1.2' FOR CARANCAHUA BAY WAS DETERMINED FROM PORT LAVACA TIDE GAUGE DATA.
 - TO CONVERT FEET TO VARAS MULTIPLY BY 0.36.
 - BOUNDARY LINES SHOWN HEREON ARE BASED ON CURRENT DEEDS AND RESEARCH AT THE APPRAISAL DISTRICT AND ARE FOR REFERENCE ONLY. THEY DO NOT REPRESENT A BOUNDARY SURVEY.
 - REFERENCE ACCOMPANYING REPORT DATED JUNE, 2013 FOR ADDITIONAL INFORMATION.
 - BACKGROUND IMAGE FROM GOOGLE EARTH AND IS FOR REFERENCE ONLY.

TRACT 1 (BUILDUP)

LINE	BEARING	DISTANCE	DISTANCE2
L11	N 88°56'39" E	108.51'	39.06v
L12	S 14°26'04" W	90.79'	32.68v
L13	N 24°25'58" W	44.41'	15.99v
L14	N 42°43'02" W	37.91'	13.65v
L15	N 67°06'38" W	45.34'	16.32v

TRACT 2 (FILL)

LINE	BEARING	DISTANCE	DISTANCE2
L16	N 88°56'39" E	14.68'	5.28v
L17	S 16°10'37" W	36.70'	13.21v
L18	S 13°12'14" W	43.08'	15.51v
L19	S 07°51'53" E	33.83'	12.18v
L20	S 29°33'22" W	44.84'	16.14v
L21	S 07°28'01" W	49.35'	17.77v
L22	S 17°50'39" W	25.68'	9.21v
L23	S 82°22'52" W	10.05'	3.62v
L24	N 63°28'06" W	8.50'	3.06v
L25	N 19°47'49" E	26.52'	9.55v
L26	N 12°07'37" E	109.83'	39.54v
L27	N 14°26'04" E	90.79'	32.68v

TRACT 3 (FILL)

LINE	BEARING	DISTANCE	DISTANCE2
L28	S 38°15'01" W	38.56'	13.88v
L29	S 16°14'03" W	69.08'	24.87v
L30	S 14°17'39" W	139.50'	50.22v
L31	S 14°05'35" W	41.09'	14.79v
L32	S 28°47'49" W	25.40'	9.14v
L33	N 85°38'37" W	7.62'	2.74v
L34	N 55°50'39" W	7.60'	2.74v
L35	N 10°25'02" E	19.41'	6.99v
L36	N 14°41'34" E	39.12'	14.08v
L37	N 16°41'24" E	51.09'	18.39v
L38	N 12°22'05" E	97.84'	35.22v
L39	N 14°35'17" E	48.93'	17.62v
L40	N 13°07'07" E	36.07'	12.98v
L41	N 83°22'58" E	44.48'	16.01v

TEXAS GENERAL LAND OFFICE
 Art. 33.136, Natural Resources Code
 Co. [Signature], Subst. No. 1
 File Date 8/21/2013 by [Signature]
 See Report

I, JAMES M. NAISMITH, HEREBY STATE THAT THIS DRAWING REPRESENTS A SURVEY THAT IS CORRECT AND IN ACCORDANCE WITH SECTION 21.042 OF THE TEXAS NATURAL RESOURCES CODE; WAS MADE ACCORDING TO LAW; WAS MADE IN THE FIELD UNDER MY DIRECT CONTROL AND SUPERVISION; WAS MADE UTILIZING METHODOLOGY APPROVED BY THE GLO; AND IS RECORDED IN

NOTICE: THIS SURVEY WAS PERFORMED IN ACCORDANCE WITH SECTION 33.136, NATURAL RESOURCES CODE, FOR THE PURPOSE OF EVIDENCING THE LOCATION OF THE SHORELINE IN THE AREA DEPICTED IN THIS SURVEY AS THAT SHORELINE EXISTED BEFORE COMMENCEMENT OF EROSION RESPONSE ACTIVITY, AS REQUIRED BY CHAPTER 33, NATURAL RESOURCES CODE. THE LINE DEPICTED ON THIS SURVEY FIXES THE SHORELINE FOR THE PURPOSE OF LOCATING A SHORELINE BOUNDARY, SUBJECT TO MOVEMENT LANDWARD AS PROVIDED BY SECTION 33.136, NATURAL RESOURCES CODE.

FILL, BUILDUP, AND RETAINING WALLS LOCATED WITHIN THE SURVEYED AREA AND ALONG THE SURVEYED LITTORAL BOUNDARY ARE SHOWN.

[Signature] 8/21/2013

JAMES M. NAISMITH
 LICENSED STATE LAND SURVEYOR

<p>Naismith Marine Sea Floor Surveying 3765 South Alameda, Suite 205 Corpus Christi, Texas 78411 WWW.NAISMITHMARINE.COM (361) 945-0248</p>	NO.	DATE	REVISION	COASTAL BOUNDARY SURVEY OF THREE TRACTS CONSISTING OF FILL AND BUILDUP IN STATE TRACT 233, CARANCAHUA BAY ADJACENT TO THE N.A. MCFARLAND SURVEY, A-42 JACKSON COUNTY, TEXAS
	SCALE: 1" = 50'	DATE: JUNE 2013	SHEET: 2 OF 2	



Surveying Division
Coastal Boundary Survey Approval

Project Name: Carancahua Bay Boat Ramp
Project No: CL20010003, General Land Office
Project Manager: Amy Nunez, Lower Coast Regional Manager
Surveyor: James M. Naismith, Licensed State Land Surveyor

Description: A Coastal Boundary Survey, dated June 27, 2013, by James M. Naismith, Licensed State Land Surveyor, associated with Texas General Land Office, lease No. CL20010003, delineating a portion of the littoral boundary of the N. A. McFarland Survey, Abstract 42, along the line of Mean Higher High Water on the north shore of Carancahua Bay. Same line being a portion of the north boundary line of State of Texas Submerged Land Tract, Carancahua Bay, Tract 233. The survey is situated at the public boat ramp, on the south side of State Highway No. 35, approximately 10.2 miles easterly from Point Comfort. Said survey is filed as 209-B of the Plat Records of Jackson County.

A Coastal Boundary Survey for the above-referenced project has been reviewed and accepted; upon completion of public notice requirements, the survey will be filed in the Texas General Land Office, Archives and Records, in accordance with provisions of the Texas Natural Resources Code, Chapter 33.136.

Approved:

Signed: [Signature]
Surveying Division

[Signature] August 28, 2013
Date

Approval Filed as:

Tex.Nat.Res.Code Article 33.136, Jackson County, Sketch No. 1

TEXAS GENERAL LAND OFFICE
Art. 33.136, Natural Resources Code
Co. Jackson, Sketch No. 1
File Date 08/21/2013 by R. Kartye

Naismith Marine Services, Inc.
 3765 South Alameda, Suite 205
 Corpus Christi, Texas 78411
 (361) 945-0248 www.naismithmarine.com

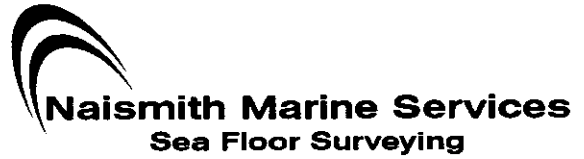

June, 2013

Report of a Coastal Boundary Survey for

A 1.8 Acre Tract on Carancahua Bay in the
 Nancy Artemecia McFarland Survey, Abstract No. 42
 Jackson County, Texas

This report accompanies a map of survey dated June, 2013.

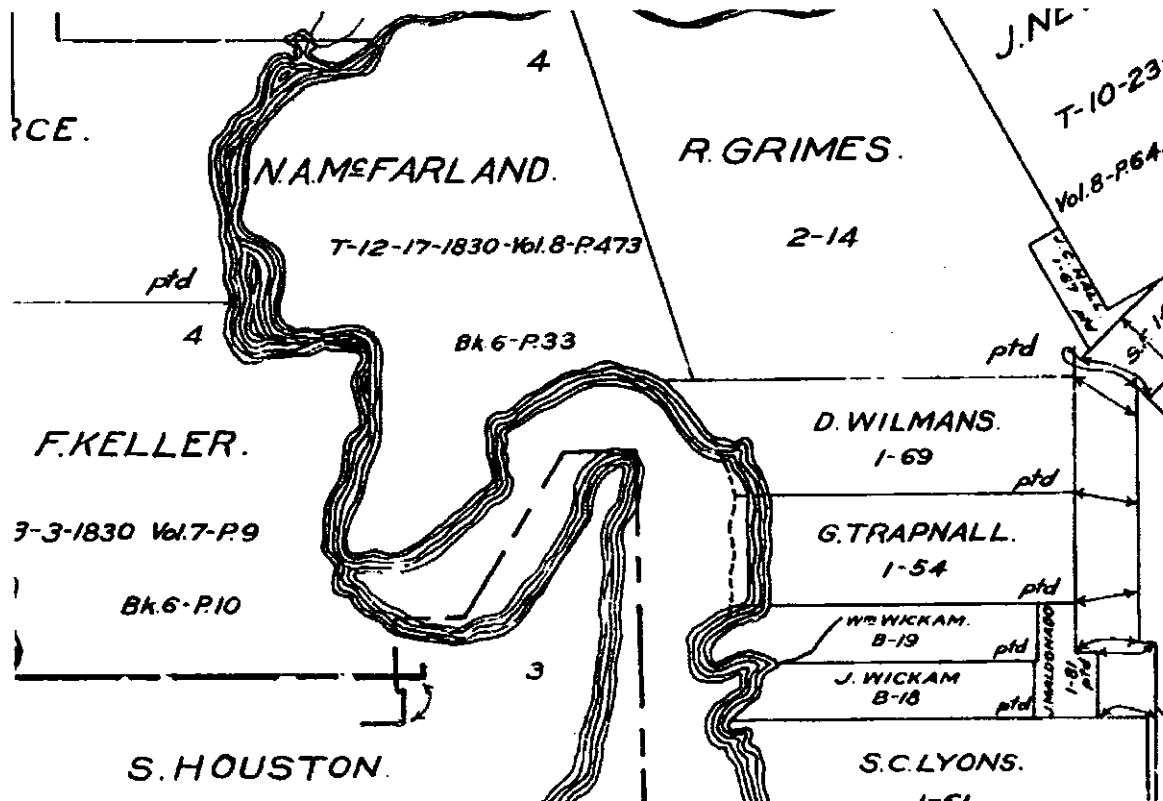

Survey area is in the Nancy A. McFarland Survey, Abstract No. 42

TEXAS GENERAL LAND OFFICE
 Art. 33.136, Natural Resources Code
 Co. Jackson, Sketch No. 1
 File Date 06/21/2018 by R. Kertye



Survey Control

Horizontal control for this project is based on the NGS control point "CAMPO", a benchmark near the survey area, and a 3/4" iron pipe with cap set by Naismith Marine Services at the project site. Multiple OPUS solutions at the 3/4" iron pipe were used to compute coordinates in the South Central Zone of the Texas State Plane Coordinate system. Datum is NAD83, US Feet.

"CAMPO"	3/4 IN. PIPE W/ CAP
N = 13,433,597.26	N = 13,461,534.79
E = 2,815,271.85	E = 2,801,151.83
	NAVD 88 = 5.7'

Tidal Datums

The tide gauge at "Port Lavaca" and five consecutive days of tidal observations at the project site were used to establish MHHW (Mean Higher High Water) for this survey.

As referenced to this survey, the elevation of MHHW on the Carancahua Bay shoreline is 1.2 feet (datum is NAVD 88).

MHHW Survey

The MHHW line was measured along the shoreline of Carancahua Bay at the 1.8 acre tract. The shoreline of the 1.8 acre tract is composed mud, grass and two jetties along the channel to the boat ramp. Tracts 1 and 2 are fill and buildup placed in State tract 233. Part of the west jetty is submerged. The MHHW line was extended across the tract along a line that represents where the shoreline would be, if the jetties and channel were not constructed. Historical maps of the area indicate that the MHHW line has followed a similar location in the grassy shoreline since before the boat ramp was constructed.



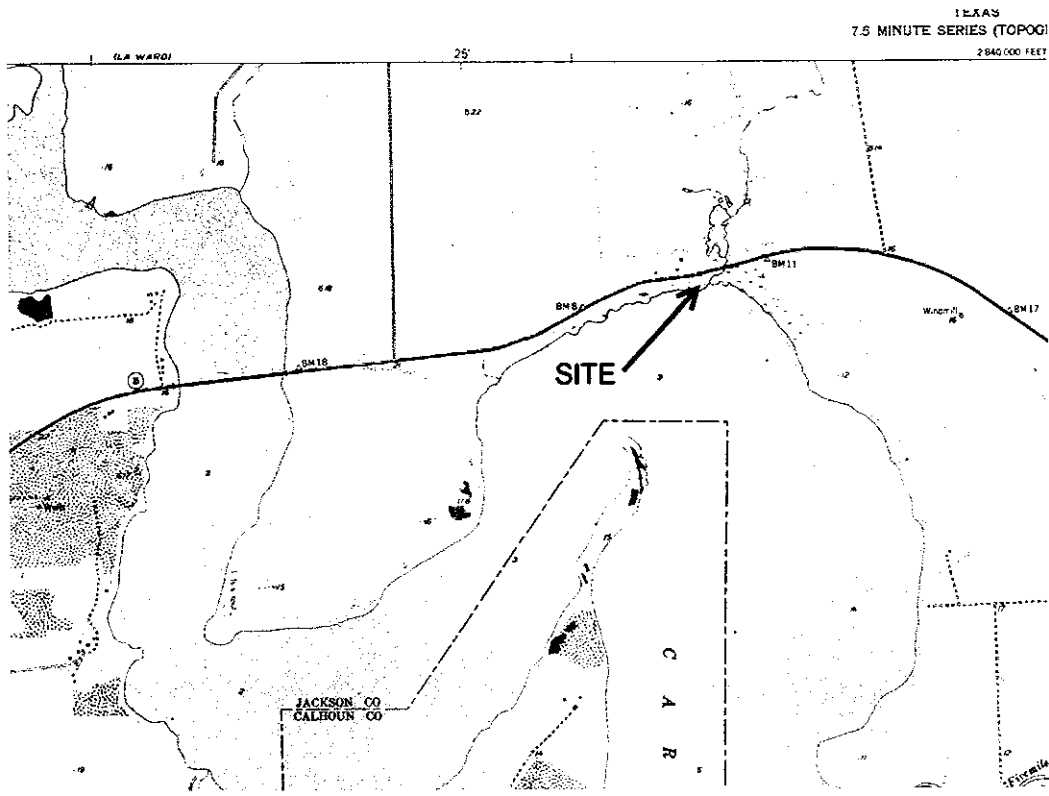

1952 Topographic Map



Typical Shoreline at MHHW line

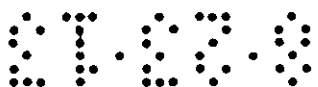



Submerged Jetty, Picture taken from East Jetty

Proposed Erosion Response Activity

The nature of the erosion response activities consist of:

- 1) Protecting the existing channel and adjacent wetlands by extending the existing breakwaters.
- 2) Placement of the dredged material into a designated beneficial use placement area within the waters of the state.
- 3) Constructing a rock dike seaward of the beneficial use placement area to protect it against wave erosion.

GLO lease #: CL 20010003



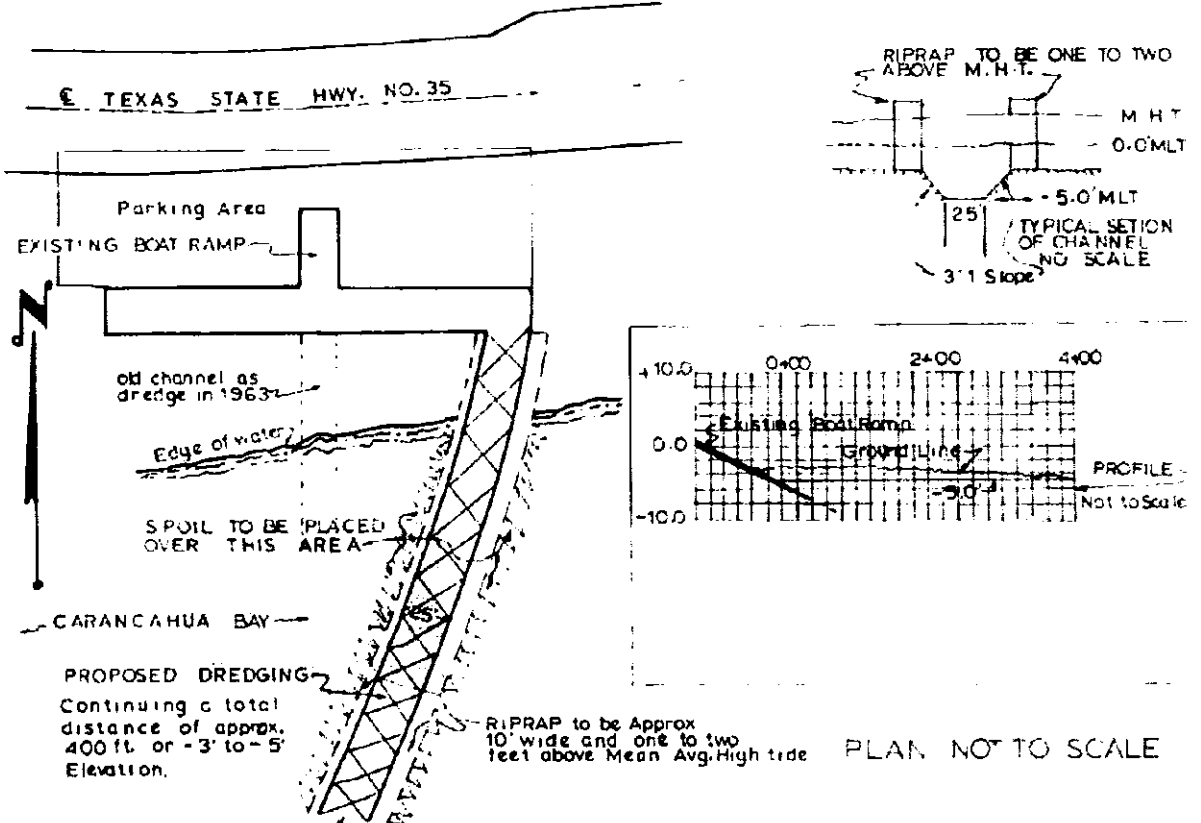
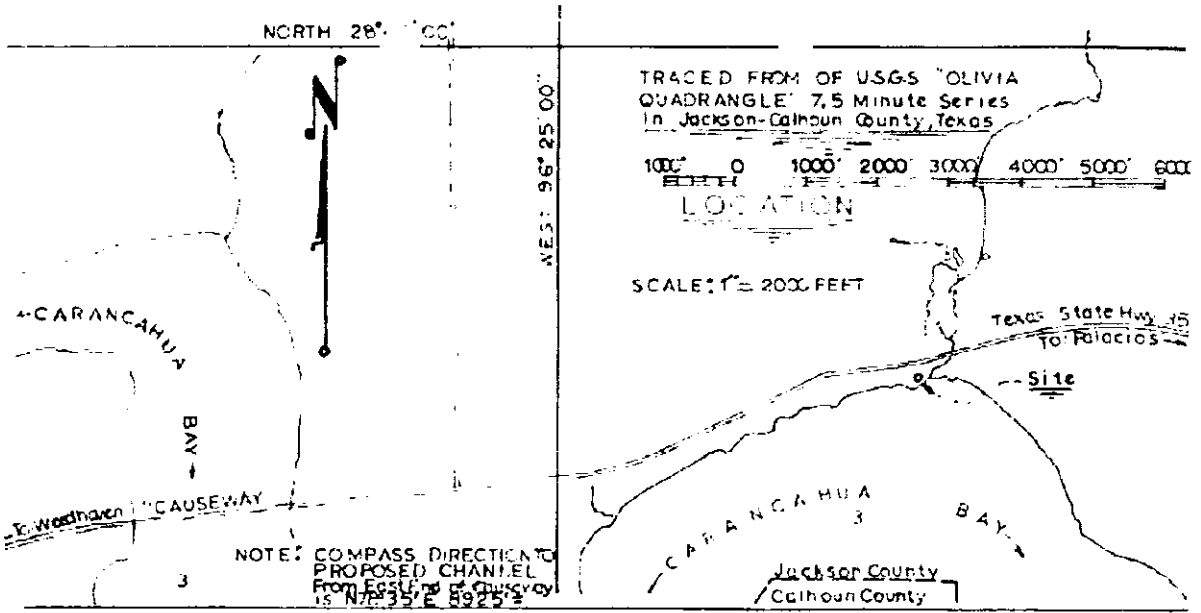

PROPOSED BOAT CHANNEL MAINTENANCE DREDGING
 FOR PARKS & WILDLIFE DEPARTMENT, AUSTIN, TEXAS
 JANUARY 28, 1971
 SHEET 1 OF 1

Copy of 1971 Boat Channel and Ramp Plans



LITTORAL BOUNDARY

Field Notes for the littoral boundary of a 1.80 acre tract of land described in a deed from John S. Bennett, et al to Jackson County, Instrument No. 102,343, filed March 29, 1976 in Volume 533, Page 76, Jackson County; in the Nancy A. McFarland Survey, A-42, surveyed in 1830, adjacent to State Tract 233 in Carancahua Bay, Jackson County, Texas. Distances, Bearings, and Coordinates are grid, North American Datum of 1983, Texas South Central Zone.

Beginning at a point , N= 13,461,278.58, E= 2,800,840.77, on the MHHW (Mean Higher High Water) line on the north shoreline of Carancahua Bay; from which "CAMPO" bears S 27°32'04" E a distance of 31,217.16' (11,238.18v);

thence N 88°46'00" E a distance of 55.73', (20.06v);
thence N 76°10'03" E a distance of 44.38', (15.98v);
thence S 83°30'02" E a distance of 48.73', (17.54v);
thence N 88°56'39" E a distance of 123.19', (44.35v);
thence N 83°22'58" E a distance of 51.56', (18.56v);
thence N 83°22'58" E a distance of 44.48', (16.01v);
thence N 68°24'40" E a distance of 14.38', (5.18v);
thence S 74°17'18" E a distance of 22.53', (8.11v);
thence N 80°21'14" E a distance of 69.47', (25.01v);
thence N 75°52'39" E a distance of 59.18', (21.30v);
to the **end** point, N= 13,461,323.48, E= 2,801,367.51, from which "CAMPO" bears S 26°37'59" E a distance of 31,017.32' (11,166.23v).

TRACT 1 – Buildup

Field Notes for the littoral boundary of a 0.12 acre tract of land lying above the MHHW (Mean Higher High Water) line, and being a part of State Tract 233 in Carancahua Bay, Jackson County, Texas. Distances, Bearings, and Coordinates are grid, North American Datum of 1983, Texas South Central Zone.

Beginning at a point, N= 13,461,284.87, E= 2,800,988.01, on the LITTORAL BOUNDARY, as described in this survey, on the MHHW (Mean Higher High Water) line on the north shoreline of Carancahua Bay; from which "CAMPO" bears S 27°17'20" E a distance of 31,154.97' (11,215.79v);

thence N 88°56'39" E along Line 4 of the LITTORAL BOUNDARY described in this survey, a distance of 108.51' (39.06v);
thence S 14°26'04" W generally along the west edge of a rock jetty, a distance of 90.79' (32.68v);
thence N 24°25'58" W a distance of 44.41' (15.99v);



thence N 42°43'02" W a distance of 37.91' (13.65v);
thence N 67°06'38" W a distance of 45.34' (16.32v);
to the **point of beginning**, having an area of 3,445 square feet, 0.08 acres

TRACT 2 – Artificial Fill

Field Notes for the boundary of a 0.09 acre tract of land and rock fill lying partially above the MHHW (Mean Higher High Water) line, and being a part of State Tract 233 in Carancahua Bay, Jackson County, Texas. Distances, Bearings, and Coordinates are grid, North American Datum of 1983, Texas South Central Zone.

Beginning at a point, N= 13,461,286.87, E= 2,801,096.49, on the LITTORAL BOUNDARY, as described in this survey, on the MHHW (Mean Higher High Water) line on the north shoreline of Carancahua Bay; from which "CAMPO" bears S 27°06'35" E a distance of 31,107.16' (11,198.58v);

thence N 88°56'39" E along Line 4 of the LITTORAL BOUNDARY described in this survey, a distance of 14.68' (5.28v);
thence S 16°10'37" W a distance of 36.70' (13.21v)v;
thence S 13°12'14" W a distance of 43.08' (15.51v);
thence S 07°51'53" E a distance of 33.83' (12.18v);
thence S 29°33'22" W a distance of 44.84' (16.14v);
thence S 07°28'01" W a distance of 49.35' (17.77v);
thence S 17°50'39" W a distance of 25.58' (9.21v);
thence S 82°22'52" W a distance of 10.05' (3.62v);
thence N 63°28'06" W a distance of 8.50' (3.06v);
thence N 19°47'49" E a distance of 26.52' (9.55v);
thence N 12°07'37" E a distance of 109.83' (39.54v);
thence N 14°26'04" E a distance of 90.79' (32.68v);
to the **point of beginning**, having an area of 3,720 square feet, 0.09 acres

TRACT 3 – Artificial Fill

Field Notes for the littoral boundary of a 0.16 acre tract of land lying above the MHHW (Mean Higher High Water) line, and being a part of State Tract 233 in Carancahua Bay, Jackson County, Texas. Distances, Bearings, and Coordinates are grid, North American Datum of 1983, Texas South Central Zone.

Beginning at a point, N= 13,461,298.21, E= 2,801,206.57, on the line of the LITTORAL BOUNDARY, as described in this survey, on the MHHW (Mean Higher High Water) line on the north shoreline of Carancahua Bay; from which "CAMPO" bears S 26°55'10" E a distance of 31,067.26' (11,184.21v);

thence S 38°15'01" W a distance of 38.56' (13.88v);

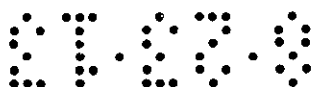

thence S 16°14'03" W a distance of 69.08' (24.87v);
thence S 14°17'39" W a distance of 139.50' (50.22v);
thence S 14°05'35" W a distance of 41.09' (14.79v);
thence S 28°47'49" W a distance of 25.40' (9.14v);
thence N 85°38'37" W a distance of 7.62' (2.74v);
thence N 55°50'39" W a distance of 7.60' (2.74v);
thence N 10°25'02" E a distance of 19.41' (6.99v);
thence N 14°41'34" E a distance of 39.12' (14.08v);
thence N 16°41'24" E a distance of 51.09' (18.39v);
thence N 12°22'05" E a distance of 97.84' (35.22v);
thence N 14°35'17" E a distance of 48.93' (17.62v);
thence N 13°07'07" E a distance of 36.07' (12.98v);
thence N 83°22'58" E, along Line 6 of the LITTORAL BOUNDARY, as described in this
survey, a distance of 44.48' (16.01v);
which is the **point of beginning**, having an area of 6,840 square feet, 0.16 acres

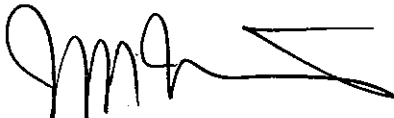
 8/21/2013

James M. Naismith, RPLS, LSLS

Naismith Marine Services, Inc.

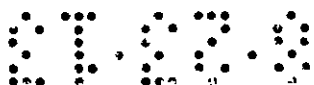

[<<Prev Document](#)

Texas Register

[Next Document>>](#)

AGENCY General Land Office
ISSUE 09/27/2013
ACTION Miscellaneous

Notice of Approval of Coastal Boundary Survey

Pursuant to §33.136 of the Texas Natural Resources Code, notice is hereby given that Jerry Patterson, Commissioner of the General Land Office, approved a **coastal boundary** survey described as follows:

A **Coastal Boundary** Survey, dated June 27, 2012, by James M. Naismith, Licensed State Land Surveyor, associated with Texas General Land Office, lease No. CL20010003, delineating a portion of the littoral boundary of the N. A. McFarland Survey, Abstract 42, along the line of Mean Higher High Water on the north shore of Carancahua Bay. Same line being a portion of the north boundary line of State of Texas Submerged Land Tract, Carancahua Bay, Tract 233. The survey is situated at the public boat ramp, on the south side of State Highway No. 35, approximately 10.2 miles easterly from Point Comfort. Said survey is filed as 209-B of the Plat Records of Jackson County.

This survey is intended to provide pre-project baseline information related to an erosion response activity on coastal public lands. An owner of uplands adjoining the project area is entitled to continue to exercise littoral rights possessed prior to the commencement of the erosion response activity, but may not claim any additional land as a result of accretion, reliction, or avulsion resulting from the erosion response activity.

For a copy of this survey or more information on this matter, contact Bill O'Hara, Director of the Survey Division, Texas General Land Office, by phone at (512) 463-5212, email bill.o'hara@glo.texas.gov, or fax (512) 463-5223.

TRD-201304029

Larry L. Laine

Chief Clerk, Deputy Land Commissioner

General Land Office

Filed: September 17, 2013

TEXAS GENERAL LAND OFFICE
Art. 33.136, Natural Resources Code
Co. Jackson, Sketch No. 1
File Date 08/21/2013 by L. Rantye

[Next Page](#)

[Previous Page](#)

[Re-Query Register Database](#)

[Back to List](#)

DEADLINE - MONDAY 10 AM • CHARGE TO: VISA • MASTERCARD • DISCOVER

ANNOUNCEMENTS	Legals	Legals	Commercial Prop	General Merchandise	EMPLOYMENT
Legals No. 4849 ESTATE MILDREDO IN THE OF JAC...	also being a part of the...			FOR SALE	Help Wanted District Office Services, TED-Experienced Teacher Ins. & 4 48-2416 Navidad Fr accepting ap a Land Mana Operator position. responsibilities include op tion, maintenance, and p fection of the land resourc of the Lavaca Basin. Em ence in Finance Managem

The Classifieds

(361) 782-3547 • (361) 782-6002 Fax • www.jacksonconews.com

ANNOUNCEMENTS

Legals

GENERAL LAND OFFICE
NOTICE OF APPROVAL OF COASTAL BOUNDARY SURVEY

Pursuant to §§3.136 of the Texas Natural Resources Code, notice is hereby given that Jerry Patterson, Commissioner of the General Land Office, approved a coastal boundary survey described as follows:

A Coastal Boundary Survey, dated June 27, 2013, by James M. Naciri, Licensed State Land Surveyor, associated with Texas General Land Office, lease No. CL20010003, delineating a portion of the littoral boundary of the N. A. McFarland Survey, Abstract 42, along the line of Mean Higher High Water on the north shore of Carancahua Bay. Same line being a portion of the north boundary line of State of Texas Submerged Land Tract, Carancahua Bay, Tract 235. The survey is situated at the public boat ramp, on the south side of State Highway No. 35, approximately 10.2 miles east-southeast from Point Comfort. Said survey is filed as 209-B of the Plat Records of Jackson County.

This survey is intended to provide pre-project baseline information related to an erosion response activity on coastal public lands. An owner of uplands adjoining the project area is entitled to continue to exercise littoral rights possessed prior to the commencement of the erosion response activity, but may not claim any additional land as a result of accretion, reliction, or avulsion resulting from the erosion response activity.

For a copy of this survey or more information on this matter, contact Bill O'Hara, Director of the Survey Division, Texas General Land Office by phone at 512-463-5212, email bill.o'hara@texas.gov, or fax 512-463-5222.

CITATION BY PUBLICATION

THE STATE OF TEXAS TO ALL PERSONS INTERESTED IN THE MATTER OF BARBARA D. STROUD, Docket No. 4979 County Court, Jackson County, Texas, William Stroud, applicant in the above numbered and entitled estate, filed on the 13th day of September, 2013 an Application For Independent Administration And Letters Of Administration Pursuant To Section 145(a) of the Texas Probate Code.

Said application will be heard and acted on by said Court at 10 o'clock A.M. on the first Monday next after the expiration of ten days from date of publication of this citation, the same being the 30th day of September, 2013, at the County Courthouse in Edna, Texas.

All persons interested in said estate are hereby cited to appear before said Honorable Court at said above mentioned time and place by filing a written answer contesting such application should they desire to do so.

The officer executing this citation shall promptly serve the same according to requirements of law, and the mandates hereof, and make due return as the law directs.

GIVEN UNDER MY HAND AND SEAL OF SAID COURT at office in Edna, Texas, this 13th day of September, 2013.

Barbara Williams, Clerk of the County Court, Jackson County, Texas
By Janet Whitely, Deputy

Clerk's address:
115 W. Main, Room 101
Edna, Texas 77857

All the latest news at www.jacksonconews.com

Legals

Application has been made with the Texas Alcoholic Beverage Commission for a Wine and Beer Retailer's Off-Premise Permit by DolgenCorp of Texas Inc. d/b/a Dollar General Store #14371 located at 308 N. 3rd Street, Ganado, Jackson County, Texas 77962. Officers of said Corporation are William C. Bass, CEO, John W. Faray, Senior Vice President and CFO, Maurice A. LaBerte, Vice President of Lease Administration, Christine L. Connolly, Secretary, and Robert R. Stephenson, Assistant Secretary.

Public Notices

NOTICE

The City of Edna is requesting proposals for the services of a Certified Public Accounting firm to conduct the Financial and Compliance Audit of the City for the fiscal year ending September 30, 2013 with an option to renew for two (2) additional years.

Sealed proposals will be accepted until 6:00 p.m. Tuesday, October 29, 2013 at City Hall, City of Edna, 126 W. Main, Edna, Texas 77957.

Becky Miska
City Secretary
City of Edna

NOTICE

The City of Edna is requesting proposals for the services of a Certified Public Accounting firm to conduct the Financial and Compliance Audit of the City for the fiscal year ending September 30, 2013 with an option to renew for two (2) additional years.

Sealed proposals will be accepted until 6:00 p.m. Tuesday, October 29, 2013 at City Hall, City of Edna, 126 W. Main Street, Edna, Texas 77957.

Becky Miska
City Secretary
City of Edna

NOTICE OF PUBLIC MEETING TO DISCUSS GANADO ISD'S STATE FINANCIAL ACCOUNTABILITY RATING

Ganado ISD will hold a public meeting at 6:30 p.m., September 19, 2013 in the Administration Office, 210 South Sixth Street, Ganado, Texas 77962.

The purpose of this meeting is to discuss Ganado ISD's rating on the state's financial accountability system.

Services

AWESOME MOONWALK RENTALS & MORE

Water slides, boy/girl combos, cars, Princess, Hello Kitty & many more themes available!

Call 935-7006 and leave message

7500 Power Washing Service

Protect the investment in your home while increasing curb appeal. We can remove unsightly grime and stains from driveways, sidewalks, decks, patios and more.

Free Quote 935-1798

J&J Lawn Services
Trimming-Flowerbeds-Mowing-Land & Limb Removal-House Painting-Minor Repairs
782-3178, 532-8252

Services

COASTAL BEND FOUNDATION REPAIR

Experienced Crew
Life-time Transferable Warranty
FREE Estimates

Ask for Danny McBride or Troy Gann

1-800-460-8594
(360) 572-5827
(360) 782-6231

Locally owned & operated

REAL ESTATE

Homes For Sale

REDUCED
528 Ed Linn
5/2, kitchen on corner lot, Lg. kitchen, formal dining, C AH
Jacobs Real Estate-Linda Sternadel 361-293-4773

613 E. Division
3/2 home on 1.13ac. Recently remodeled, close to park.
Jacobs Real Estate-Linda Sternadel 361-293-4773

402 Dugger, Edna
For sale by owner
2 bedroom, 2 bath, 1200 + sq. ft., fenced yard, corner lot, storage bldg.
361-782-6349

Homes For Rent

RENT TO OWN
Nicely renovated 2BD, 2BA home; Call 648-9263

GANADO
2 bedroom, 1 bath home; Call 832-444-0104

Apartment For Rent

September Special

COTTONWOOD APARTMENTS

\$125 Holding Fee Reduced Rates

1400 N. Wells • Edna, TX • 361-782-3830

Mon-Fri 9 am-6 pm • Sat. 10 am-5 pm

• 1-6 Bedrooms Available
• Playground • Pet Friendly
• Sports Court • Swimming Pool

JK Estates Apartments

306 S. Colorado, Edna

• Newly Updated • Close to Schools
• Remodeled • Quiet Neighborhood
• 1, 2 & 3 Bedroom Units Available
starting at \$425.00

Miracle Manor Apartments
A Retirement Housing Foundation Community

TAKING APPLICATIONS
No Vacancies

An Affordable Senior Apartment Community For 62 or older. Income limits are \$20,700 Annual for 1 person and \$23,650 Annual for 2 people. Rent based on 30% of monthly adjusted income. For more information please call, write or visit us at:

MIRACLE MANOR
1207 Miracle Drive • Edna, TX 77957
Call immediately (361) 782-2019

Homes For Rent

3 BD, 2BA, nice backyard, quiet neighborhood, close to schools; Call 649-9439 after 4pm

Apartment For Rent

COLONIAL VILLAGE APARTMENTS
602 Brodia, Edna
361-782-5766

Nice Neighborhood
Very Quiet
1 & 2 Bedrooms

Commercial Prop For Rent

DISCOUNT STORAGE
Edna's Largest; 4 Locations; Best Rates. All Sizes. 782-2838 or 782-1673.

EDNA MINI STORAGE
802 W. Elm, Edna
All sizes, all sizes
5x10 to 10x40
Rent for 12 months, get 1 free month. Call 782-2272, 782-6564.

Lots

FOR SALE
Like new Vera Bradley Jazzy Blooms Purse, Billfold, Make-up bag and Phone Holder, Lunch Box, all for \$100.
Call 361-648-0097

Apartment For Rent

TRANSPORTATION

Automobiles

FOR SALE
1995 Jeep Wrangler
New rebuilt engine w/less than 1,000 miles, T-top, great tires w/mags; \$5485.00 Call 782-6655 or 649-5006

ITEMS FOR SALE

General Merchandise

FOR SALE
Fertilized coastal hay Square bales-\$5.50/ea (over 100 bales); \$5.00/ea (less than 100 bales) Call Sherman @ 650-9406, Little @ 832-577-6959 or Welfe Sherman @ 552-9074

ORDER HOME-ECOMING MILMS now for Edna, Ganado, Industrial, Louise "Ganado Flowers & Gifts" 106 S 3rd St, Ganado 771-6779, 771-2805

CAMPER FOR RENT
Very nice camper with 2 slides, 1-2 people that work around the area, all bills paid including direct & internet, 700/month
361-781-2488

WANTED USED GUNS

Check with us before you sell. Best selection in town.

Don's Firearms
2302 N. Main, Victoria 572-9866

Livestock

Good selection of 2 & 3 year old black & red Tangus bulls; no papers Call 830-437-5772

Garage Sales

Sat. 7:30-7
New Harvest Christian Church
1016 S. East, Edna
Breakfast, menu, menudo, gorditas, lots of misc.

Sat. 8-2
10108 Hwy 111 North across from Morales Store
Too much to list

EMPLOYMENT

Help Wanted

Ganado
Seeking in-home care attendant Mon-Fri, flexible hours, occasional weekend (very few); Call 771-5432

The City of Edna is accepting applications in the street department a street maintenance worker. Requirements: High school diploma or GED equivalent, good driving record, valid Texas drivers license/CDL preferred, able to work flexible hours, able to operate light equipment and be physically able to do various manual labor duties. Salary: Depending on qualifications. The City of Edna is an Equal Opportunity Employer. Applications may be obtained from City Hall, 126 W. Main, Edna, Texas. Position open until filled.

Citizens State Bank has an immediate opening for a TELLER position. Banking experience preferred. Please mail resume to PO Box 1180, Ganado 77962

INDUSTRIAL ISD is seeking to hire an ASSISTANT MAINTENANCE DIRECTOR. Requiring heavy mechanical and/or HVAC experience. Interested individuals may apply online at www.industrialisd.org under employment heading. For more information regarding the position call Jeff Woodring 361-284-3226 Ext. 1800. Deadline until position filled. Industrial ISD is an Equal Opportunity Employer.

LVNs
New Increased Wages
CNAS- Part Time
Various shifts available. Very competitive rates & benefits available for full time employees! Requires State license or certification. Experience preferred, not necessary. EOE. Call our Administrator, 361-672-2542 or apply in person at

PALACIOS HEALTHCARE CENTER
1414 Fourth Street
Palacios

Help Wanted

Pump 'N Munch is hiring for CLEANING, COOKING & CASHIER. Located next to Dairy Queen in Ganado. Call 713-962-7710 or pick up an application.

The City of Ganado is accepting applications for employment in the Water Wastewater Department for an operator/collector system technician. Requirements: High school diploma or GED equivalent, good driving record, valid Texas license, able to work flexible hours, able to operate light equipment and be physically able to do various manual labor duties. Applicant must have the ability to obtain state water/wastewater licenses. Salary: Depending on qualifications. The City of Ganado is an Equal Opportunity Employer. Applications may be obtained from City Hall, 112 E. Putnam, Ganado, Texas 77962. Position open until filled.

Jackson County Tax Assessor-Collector's office is accepting applications for full-time employment as Deputy Tax Assessor-Collector. Position requires applicant's computer experience to include Word and Excel as well as being proficient in typing and 10 key. Position also requires that applicant be able to perform financial calculations. Applicant must be detail oriented and have excellent organizational, written and oral communication skills. Spelling considered a plus. The position also requires that applicant be friendly, courteous, and able to work well with others and have a good personal appearance. Applicant must have a high school diploma or its equivalent and be bondable. Previous office experience a must. Salary: \$16.50 to \$14.77 per hour depending on experience. Applications may be picked up at Jackson County Tax Assessor-Collector's Office at 115 W. Main, Room 102, Edna.

To be considered, you must submit an application to Jackson County Tax Assessor-Collector's Office by 6:00 p.m. on Tuesday, September 24, 2013.

County of Jackson, Texas is an Equal Employment Opportunity Employer. The County does not discriminate on the basis of race, color, national origin, sex, religion, age and handicapped status in employment or provision of services.

EDNA ISD
BUS DRIVER NEEDED
Edna ISD is seeking a bus driver. CDL required. Competitive wages. Contact Sonny Strode at (361) 782-3243.

Receptionist needed to join experienced dental team. Must have excellent computer, phone skills and work ethics. Please mail resume to Joe Lynn Bonhot, D.O.S. @ PO Box 302, Ganado, TX 77962.

TEXAS GENERAL LAND OFFICE
Art. 33.136, Natural Resources Code
Co. Jackson, Sketch No. 1

File Date 06/1/2013 by R. Kertive

PUBLISHER'S AFFIDAVIT

STATE OF TEXAS
COUNTY OF JACKSON

Personally appeared before the undersigned, a notary public within and for said County and State, Chris Lundstrom, Publisher of THE JACKSON COUNTY HERALD-TRIBUNE a newspaper having general circulation in Jackson County, Texas, who, being duly sworn, states on oath that the foregoing attached notice was published in said newspaper on the following date(s), to wit:

9/18/13

9/25/13

Chris Lundstrom

Chris Lundstrom, Publisher

Subscribed and sworn to me before this 26 day of Sept 2013
to certify which witness my hand and seal of office.

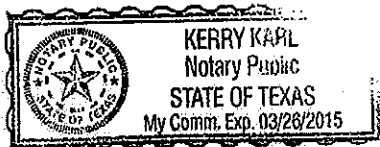

Kerry Kapl

TEXAS GENERAL LAND OFFICE
Art. 33.136, Natural Resources Code

Co. Jackson, Sketch No. 1

File Date 06/21/2013 by R. Kartye