

LINE BEARING	DISTANCE
L1 S 84°54'10" E	65.86'
L2 N 59°15'39" E	124.88'
L3 N 53°41'05" E	249.13'
L4 N 56°45'27" E	304.72'
L5 N 52°24'47" E	340.64'
L6 N 53°33'59" E	1,049.11'
L7 N 53°52'35" E	999.51'
L8 N 53°45'20" E	999.45'
L9 N 53°59'24" E	1,002.86'
L10 N 53°40'00" E	998.55'
L11 N 54°06'56" E	999.58'
L12 N 53°55'11" E	999.83'
L13 N 53°48'32" E	1,000.66'
L14 N 53°57'03" E	1,000.10'
L15 N 53°57'16" E	998.18'
L16 N 55°37'18" E	996.69'
L17 N 56°15'42" E	1,003.82'
L18 N 56°20'13" E	1,001.05'
L19 N 56°17'22" E	1,001.16'
L20 N 56°10'03" E	1,138.78'

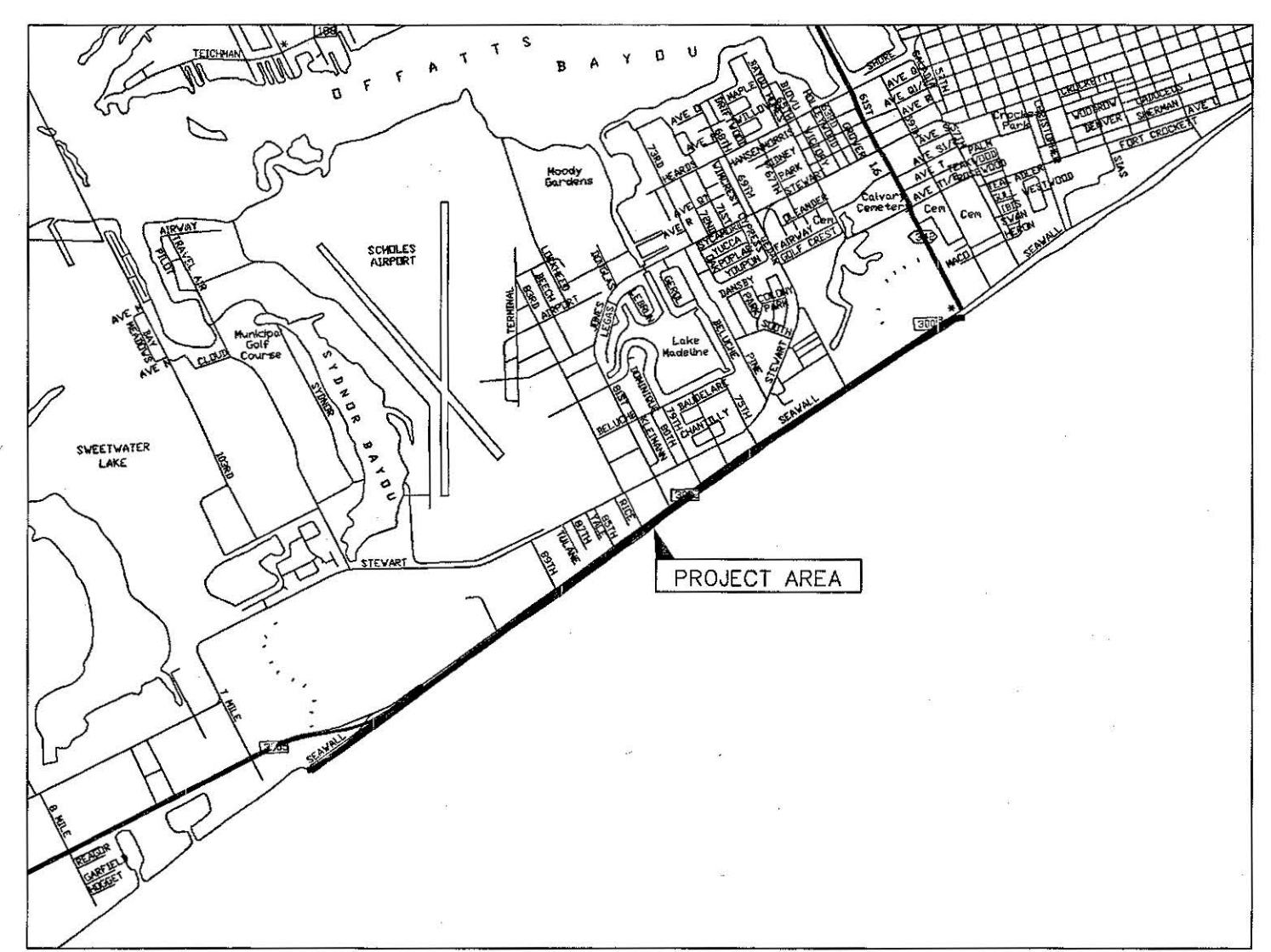

VICINITY MAP - NOT TO SCALE

Address of Upland Owner:
Galveston County
722 Moody
Galveston, TX 77550

75+28
N: 13,663,931.46'
E: 3,292,783.54'
CONVERGENCE ANGLE: 2°02'06.71263"
GRID SCALE FACTOR: 0.999864199

Submerged Land
Tract 231
North 310

GULF OF MEXICO

Submerged Land
Tract 231
South 320

Submerged Land
Tract 241

POINT OF BEGINNING
N: 13,658,713.59'
E: 3,285,602.73'
CONVERGENCE ANGLE: 2°01'25.99801"
GRID SCALE FACTOR: 0.999864555

Submerged Land
Tract 243

Filed May 5, 2015 in Book I, Page 237
of the Galveston County Surveyor's Records

SURVEY DATE:	JANUARY 31, 2015
FILE NO.:	7205-0000-0381-003
DRAWING:	308
UGB No.:	15-0067



8017 HARBORSIDE DRIVE
P.O. BOX 16142 (mailing)
GALVESTON, TX 77552
ph (409) 740-1817
Registration Number: 10193855
www.hightidelandsurveying.com

January 31, 2015

I certify that on the above dates, that the littoral boundary of the herein described property, was surveyed on the ground, according to the law under my direction, and this map together with dimensions and coordinates is true and correct as of the above date.

HIGH TIDE LAND SURVEYING, LLC

Stephen C. Blaskey
Licensed State Land Surveyor
email: stephen@hightidesurveying.com

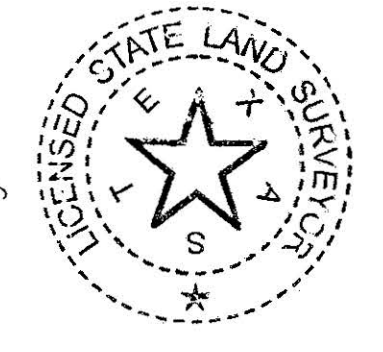

POINT OF TERMINATION
N: 13,668,084.73'
E: 3,298,884.78'
CONVERGENCE ANGLE: 2°02'41.25939"
GRID SCALE FACTOR: 0.999863956

FOR GENERAL LAND OFFICE USE ONLY

AREA OF ARTIFICIAL FILL / BUILDUP
SEE MAP TO ACCOMPANY THIS SURVEY
OF SAME DATE
20,350 SQUARE FEET

Submerged Land
Tract 230

TEXAS GENERAL LAND OFFICE
Art. 33.136 Natural Resources Code
Co. Galveston - Sketch No. 77
File Date Determined by Registrar

Commencing at N.G.S. Monument "75+28," said point having the following coordinates: Northing: 13,663,931.46, Easting: 3,292,783.54, a convergence angle of: 2°02'06.71263", and a grid scale factor of 0.999864199;

Thence S 53°59'47" W, a distance of 8,876.38' (3195.5 Varas) to the Point of Beginning, said point lies on the Littoral Boundary of the Gulf of Mexico, and has the following coordinates: Northing: 13,658,713.59, Easting: 3,285,602.73, a convergence angle of 2°01'25.99801", and a grid scale factor of 0.999864555;

Thence meandering along the Littoral Boundary Line of the Gulf of Mexico the following courses and distances:

- (L1) Thence S 84°54'10" E a distance of 65.86' (23.7 Varas);
 - (L2) Thence N 59°15'39" E a distance of 124.88' (45.0 Varas);
 - (L3) Thence N 53°41'05" E a distance of 249.13' (89.7 Varas);
 - (L4) Thence N 56°45'27" E a distance of 304.72' (109.7 Varas);
 - (L5) Thence N 52°24'47" E a distance of 340.64' (122.6 Varas);
 - (L6) Thence N 53°33'59" E a distance of 1,049.11' (377.7 Varas);
 - (L7) Thence N 53°52'35" E a distance of 999.51' (359.8 Varas);
 - (L8) Thence N 53°45'20" E a distance of 999.45' (359.8 Varas);
 - (L9) Thence N 53°59'24" E a distance of 1,002.86' (361.0 Varas);
 - (L10) Thence N 53°40'00" E a distance of 998.55' (359.5 Varas);
 - (L11) Thence N 54°06'56" E a distance of 999.58' (359.8 Varas);
 - (L12) Thence N 53°55'11" E a distance of 999.83' (359.9 Varas);
 - (L13) Thence N 53°48'32" E a distance of 1,000.66' (360.2 Varas);
 - (L14) Thence N 53°57'03" E a distance of 1,000.10' (360.0 Varas);
 - (L15) Thence N 53°57'16" E a distance of 998.18' (359.3 Varas);
 - (L16) Thence N 55°37'18" E a distance of 996.69' (358.8 Varas);
 - (L17) Thence N 56°15'42" E a distance of 1,003.82' (361.4 Varas);
 - (L18) Thence N 56°20'13" E a distance of 1,001.05' (360.4 Varas);
 - (L19) Thence N 56°17'22" E a distance of 1,001.16' (360.4 Varas);
 - (L20) Thence N 56°10'03" E a distance of 1,138.78' (410.0 Varas)
- to the Point of Termination, said point having the following coordinates: Northing: 13,668,084.73, Easting: 3,298,884.78, a convergence angle of 2°02'41.25939", and a grid scale factor of 0.999863956, said point also lies N 55°45'21" E, at a distance of 7,380.70' (2,657.1 Varas) from said N.G.S. Monument "75+28."

NOTICE:

This survey was performed in accordance with Section 33.136, Natural Resources Code, for the purpose of evidencing the location of the shoreline in the area depicted in this survey as that shoreline existed before commencement of erosion response activity, as required by Chapter 33, Natural Resources Code. The line depicted on this survey fixes the shoreline for the purpose of locating a shoreline boundary, subject to movement landward as provided by Section 33.136, Natural Resources Code. This survey does not nor is intended to be used to identify, delineate or fix the line of vegetation or the landward boundary of the public beach. Lines shown were surveyed on the ground were surveyed by Kyle Rodriguez and Markus Jackson on January 31, 2015.

NOTES:

- 1) ALL DISTANCES ARE GRID DISTANCES AND ARE SHOWN IN U.S. SURVEY FEET AND VARAS.
- 2) ALL BEARINGS SHOWN HEREON ARE GRID BEARINGS AND REFER TO THE TEXAS COORDINATE SYSTEM OF 1983 - SOUTH CENTRAL ZONE, AS DEFINED BY ARTICLE 21.070 OF THE NATURAL RESOURCE CODE OF THE STATE OF TEXAS.
- 3) ALL COORDINATES SHOWN HEREON ARE GRID COORDINATES AND REFER TO THE TEXAS COORDINATE SYSTEM OF 1983 - SOUTH CENTRAL ZONE, AS DEFINED BY ARTICLE 21.070 OF THE NATURAL RESOURCE CODE OF THE STATE OF TEXAS.
- 4) LOCAL TIDE GAUGE REFERENCED TO: GALVESTON PLEASURE PIER - GULF OF MEXICO NATIONAL OCEAN SERVICE STATION ID# 8771510 LENGTH OF SERIES: 5 YEARS TIDAL EPOCH: 1983-2001 CONTROL TIDE STATION: N/A
- 5) ON THE DATE OF THIS SURVEY THERE WAS NO APPARENT FILL OR BUILDUP UPON OR ADJACENT TO THE LINE OF MEAN HIGHER HIGH WATER EXCEPT AS SHOWN HEREON, AND FURTHER DESCRIBED ON ARTIFICIAL FILL / BUILDUP MAP OF SAME DATE TO ACCOMPANY THIS SURVEY.
- 6) ON THE DATE OF THIS SURVEY THERE WAS NO APPARENT RETAINING WALL OR OTHER STRUCTURE UPON OR ADJACENT TO THE LINE OF MEAN HIGHER HIGH WATER EXCEPT AS NOTED ON THIS SURVEY.
- 7) THE LITTORAL BOUNDARY AS SHOWN ON THIS SURVEY WAS LOCATED IN ACCORDANCE WITH METHODOLOGY APPROVED BY THE GENERAL LAND OFFICE.
- 8) THE LINE OF MEAN HIGH WATER AS SHOWN HEREON IS GENERALLY CONTIGUOUS WITH THE EXISTING FACE OF THE ROCK RIP-RAP.
- 9) THIS SURVEY COMPLIES WITH REQUIREMENTS IN CHAPTER 21 OF THE NATURAL RESOURCE CODE OF THE STATE OF TEXAS.

COASTAL BOUNDARY SURVEY
OF PART OF THE LITTORAL BOUNDARY
OF THE EDWARD HALL AND LEVI
JONES SURVEY, ABSTRACT 121
GALVESTON COUNTY, TEXAS
SOUTH 46°26'27" WEST, 6.4 MILES OF THE
GALVESTON COUNTY COURTHOUSE

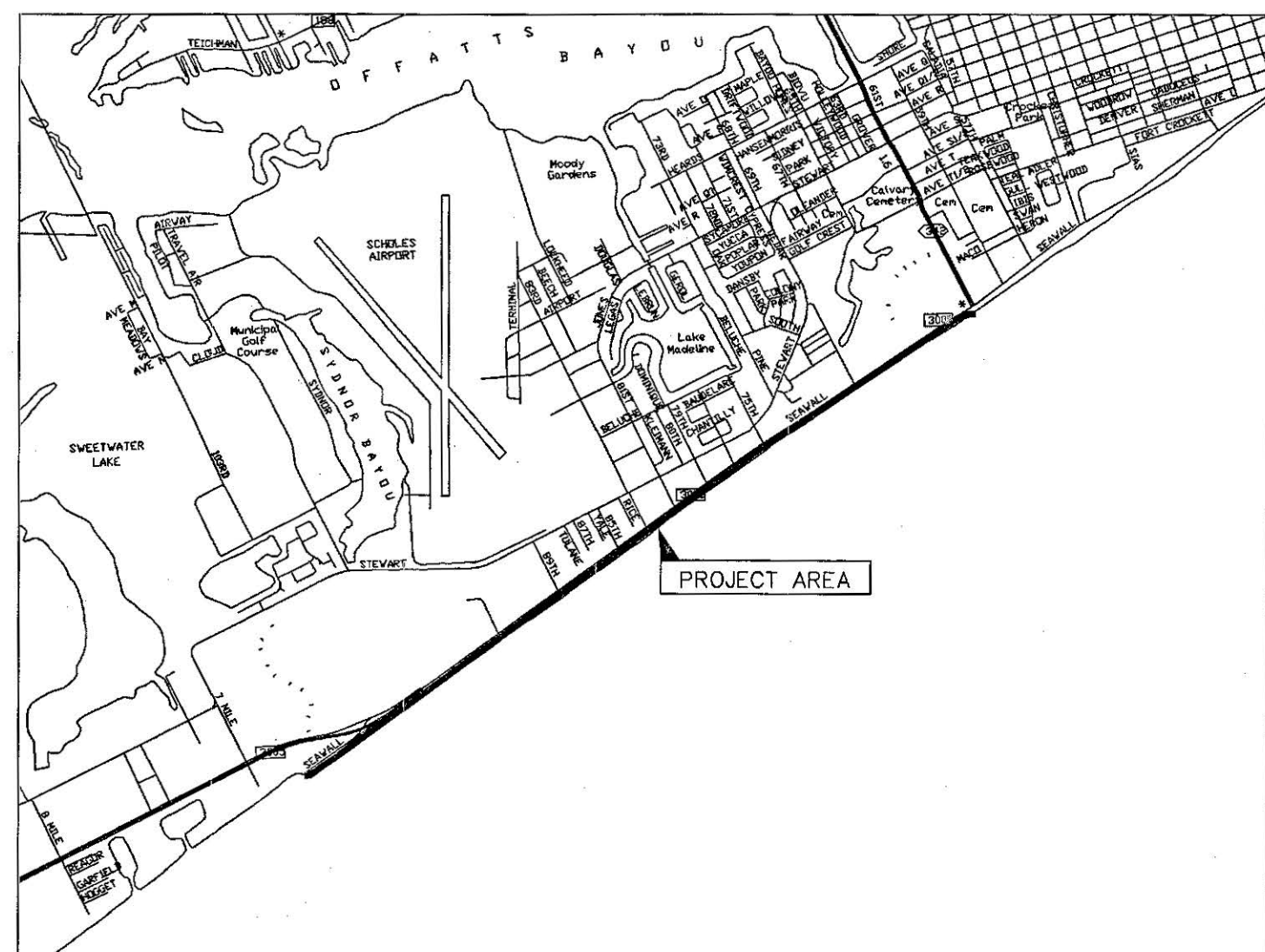
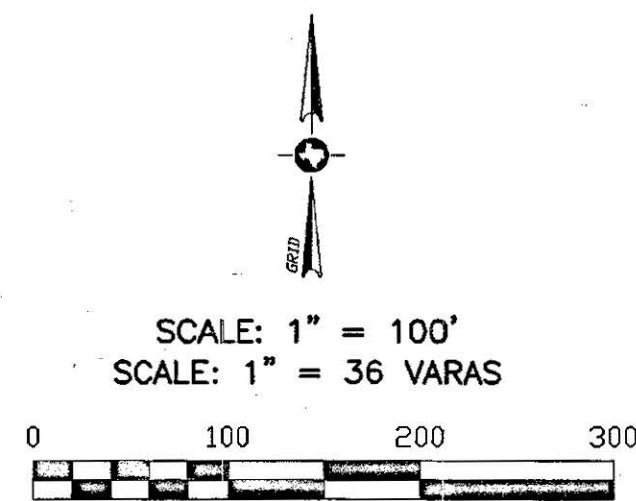

VICINITY MAP - NOT TO SCALE

Address of Upland Owner:
Galveston County
722 Moody
Galveston, TX 77550

LINE	BEARING	DISTANCE
L1	S 27°06'18" E	128.89'
L2	S 86°01'16" W	111.57'
L3	S 72°56'00" W	85.38'
L4	S 69°39'37" W	205.01'
L5	N 56°10'03" E	392.96'

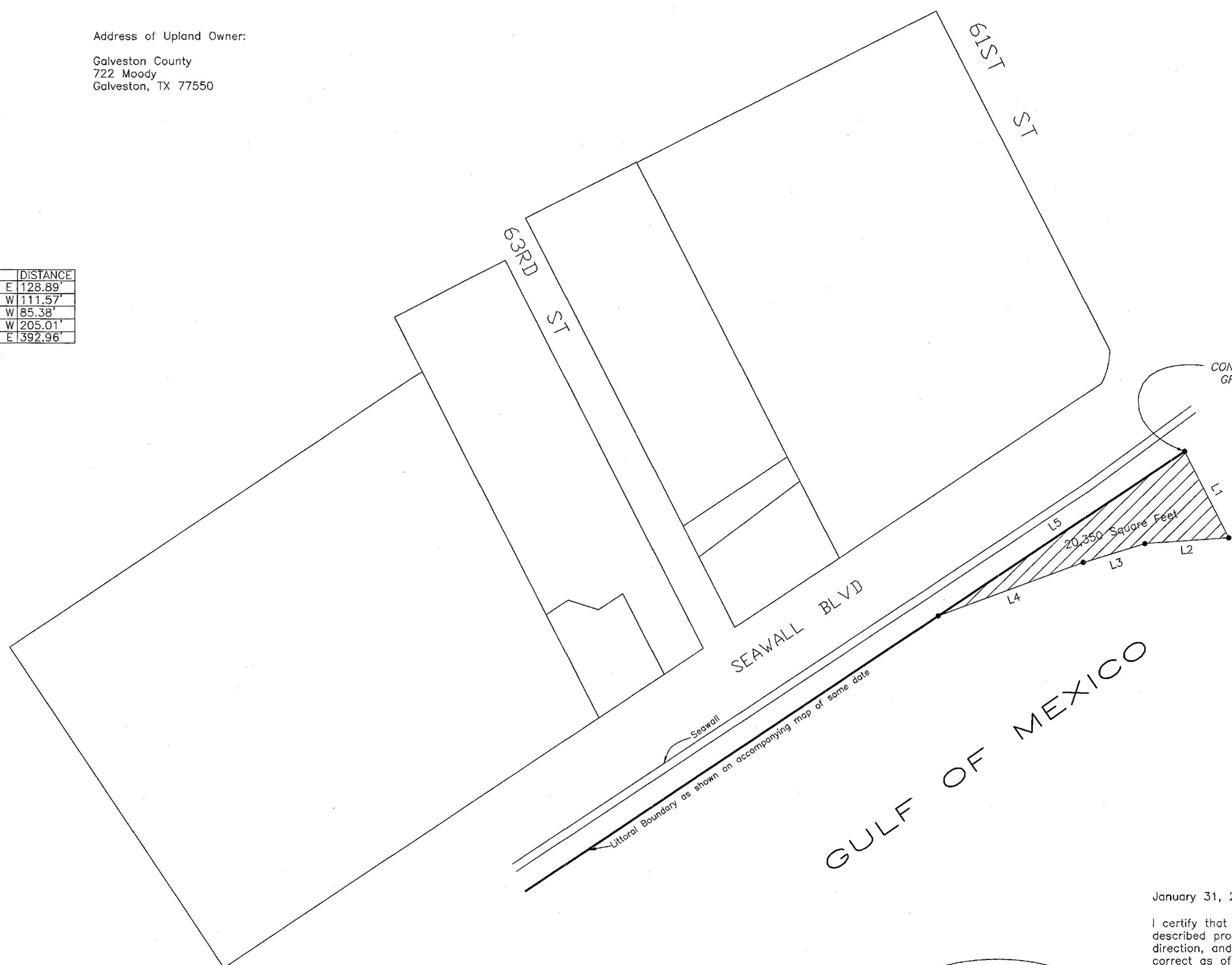

POINT OF BEGINNING
N: 13,668,084.73'
E: 3,298,884.78'
CONVERGENCE ANGLE: 2°02'41.25939"
GRID SCALE FACTOR: 0.999863956

NOTICE:

This survey was performed in accordance with Section 33.136, Natural Resources Code, for the purpose of evidencing the location of the shoreline in the area depicted in this survey as that shoreline existed before commencement of erosion response activity, as required by Chapter 33, Natural Resources Code. The line depicted on this survey fixes the shoreline for the purpose of locating a shoreline boundary, subject to movement landward as provided by Section 33.136, Natural Resources Code.

This survey does not nor is intended to be used to identify, delineate or fix the line of vegetation or the landward boundary of the public beach.

Lines shown were surveyed on the ground were surveyed by Kyle Rodriguez and, Markus Jackson on January 31, 2015.

Commencing at N.G.S. Monument "75+28," said point having the following coordinates: Northing: 13,663,931.46, Easting: 3,292,783.54, a convergence angle of: 2°02'06.71263", and a grid scale factor of 0.999864199;

Thence N 55°45'21" E, a distance of 7,380.70' (2,657.1 Varas) to the Point of Beginning, said point lies on the Littoral Boundary of the Edward Hall and Levi Jones Survey, Abstract 121, same line being the Northern Boundary of Gulf of Mexico Submerged Land Tract 230, and has the following coordinates: Northing: 13,668,084.73, Easting: 3,298,884.78, a convergence angle of 2°02'41.25939", and a grid scale factor of 0.999863956;

Thence meandering along the Artificial Fill / Buildup the following courses and distances:

(L1) S 27°06'18" E, a distance of 128.89' (46.4 Varas);
(L2) S 86°01'13" W, a distance of 111.57' (40.2 Varas);
(L3) S 72°56'00" W, a distance of 85.38' (30.7 Varas);
(L4) S 69°39'37" W, a distance of 205.01' (73.8 Varas) to a point lying on the Littoral Boundary of the Gulf of Mexico;

(L5) N 56°10'03" E, along the said Littoral Boundary of the Gulf of Mexico, a distance of 392.96' (141.5 Varas) to the POINT OF BEGINNING, and containing 20,350 square feet.

FOR GENERAL LAND OFFICE USE ONLY

This survey was completed in support of Beach Nourishment Project under GLO Lease SL20150012 and Coastal Erosion Planning Response Act (CEPRA) Project 1609.

TEXAS GENERAL LAND OFFICE
Art. 33.136, Natural Resources Code
Galveston County, Sketch No. 77
File Date 05/05/2015 by JL/KH

NOTES:

- 1) ALL DISTANCES ARE GRID DISTANCES AND ARE SHOWN IN U.S. SURVEY FEET AND VARAS.
- 2) ALL BEARINGS SHOWN HEREON ARE GRID BEARINGS AND REFER TO THE TEXAS COORDINATE SYSTEM OF 1983 - SOUTH CENTRAL ZONE, AS DEFINED BY ARTICLE 21.070 OF THE NATURAL RESOURCE CODE OF THE STATE OF TEXAS.
- 3) ALL COORDINATES SHOWN HEREON ARE GRID COORDINATES AND REFER TO THE TEXAS COORDINATE SYSTEM OF 1983 - SOUTH CENTRAL ZONE, AS DEFINED BY ARTICLE 21.070 OF THE NATURAL RESOURCE CODE OF THE STATE OF TEXAS.
- 4) LOCAL TIDE GAUGE REFERENCED TO:
GALVESTON PLEASURE PIER - GULF OF MEXICO
NATIONAL OCEAN SERVICE STATION ID# 8771510
LENGTH OF SERIES: 5 YEARS
TIDAL EPOCH: 1983-2001
CONTROL TIDE STATION: N/A
- 5) ON THE DATE OF THIS SURVEY THERE WAS NO APPARENT FILL OR BUILDUP UPON OR ADJACENT TO THE LINE OF MEAN HIGHER HIGH WATER EXCEPT AS SHOWN HEREON.
- 6) ON THE DATE OF THIS SURVEY THERE WAS NO APPARENT RETAINING WALL OR OTHER STRUCTURE UPON OR ADJACENT TO THE LINE OF MEAN HIGHER HIGH WATER EXCEPT AS NOTED ON THIS SURVEY.
- 7) THE LITTORAL BOUNDARY AS SHOWN ON THIS SURVEY WAS LOCATED IN ACCORDANCE WITH METHODOLOGY APPROVED BY THE GENERAL LAND OFFICE.
- 8) THE LINE OF MEAN HIGHER HIGH WATER AS SHOWN HEREON IS GENERALLY CONTIGUOUS WITH THE EXISTING FACE OF THE ROCK RIP-RAP.
- 9) THIS SURVEY COMPLIES WITH REQUIREMENTS IN CHAPTER 21 OF THE NATURAL RESOURCE CODE OF THE STATE OF TEXAS.

January 31, 2015

I certify that on the above dates, that the artificial fill / buildup of the herein described property, was surveyed on the ground, according to the law under my direction, and this map together with dimensions and coordinates is true and correct as of the above date.

HIGH TIDE SURVEYING, LLC

Stephen C. Blaskey
Licensed State Land Surveyor
email: stephen@hightidesurveying.com



8017 HARBORSIDE DRIVE
P.O. BOX 16142 (mailing)
GALVESTON, TX 77552
ph (409) 740-1517
Registration Number: 10193855
www.hightidelandsurveying.com

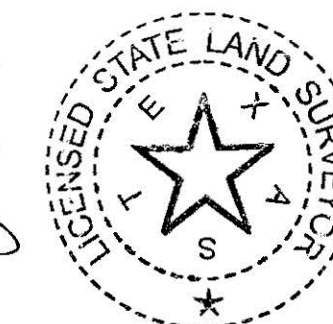

ARTIFICIAL FILL / BUILDUP MAP
OF A PART OF GULF OF MEXICO SUBMERGED
LAND TRACT 230, AS DESIGNATED BY THE
TEXAS GENERAL LAND OFFICE
GALVESTON COUNTY, TEXAS
SOUTH 46°26'27" WEST, 6.4 MILES OF THE
GALVESTON COUNTY COURTHOUSE

Filed May 5, 2015 in Book I, Page 238
of the Galveston County Surveyor's Records

SURVEY DATE: JANUARY 31, 2015
FILE No.: 7205-0000-0381-003
DRAFTING: SCB
JOB No.: 15-0067



TEXAS GENERAL LAND OFFICE
GEORGE P. BUSH, COMMISSIONER

Surveying Division
Coastal Boundary Survey Approval

Project: Galveston Seawall BUDM West of 61st to 103rd Street

Project No: SL20150012 (GLO); CEPRA 1609

Project Manager: Kevin Frenzel (GLO), CEPRA Manager

Surveyor: Stephen C. Blaskey, Licensed State Land Surveyor

Description: A Coastal Boundary Survey, dated January 31, 2015, by Stephen C. Blaskey, Licensed State Land Surveyor, delineating the littoral boundary line of the Gulf of Mexico and the Edward Hall and Levi Jones Survey, A-121, same line being the western boundary of Submerged Land Tracts 230, 231/North310 and 241. The survey is required under Section 33.136 Texas Natural Resources Code for a proposed beach nourishment project to be completed under authority of Texas General Land Office Lease No SL20150012 and Coastal Erosion Planning and Response Act (CEPRA) Project No. 1609. The surveyed line is situated along the seaward edge of the granite rip-rap in front of the Galveston Seawall [N29.254251°, W94.847593° (29°15'15.31" 94°50'51.34"), WGS84], extending from 61st Street westward to the end of said seawall.

A Coastal Boundary Survey for the above-referenced project has been reviewed and accepted; upon completion of public notice requirements, the survey will be filed in the Texas General Land Office, Archives and Records, in accordance with provisions of the *Texas Natural Resources Code*, Chapter 33.136.

Approved:

Signed: David A. Lyle
Surveying Division

May 12, 2015
Date

Approval Filed as:

Tex. Nat. Res. Code Article 33.136 Galveston County, Sketch No. 77 Co. Galveston, Sketch No. 77
File Date 06/20/2018 by R. Kertye

Texas Register, Volume 40, Number 26, Pages 4071-4262, June 26, 2015 Page: 4,244

Note: The consistency review for this project may be conducted by the Texas Commission on Environmental Quality under §401 of the Clean Water Act (33 U.S.C.A. §1344).

Pursuant to §306(d)(14) of the Coastal Zone Management Act of 1972 (16 U.S.C.A. §§1451 - 1464), as amended, interested parties are invited to submit comments on whether a proposed action or activity is or is not consistent with the Texas Coastal Management Program goals and policies and whether the action should be referred to the Land Commissioner for review.

Further information on the applications listed above, including a copy of the consistency certifications or consistency determinations for inspection, may be obtained from Mr. Ray Newby, P.O. Box 12873, Austin, Texas 78711-2873 or via email at federal.consistency@glo.texas.gov. Comments should be sent to Mr. Newby at the above address or by email.

TRD-201502307
Anne L. Idsal
Chief Clerk
General Land Office
Filed: June 17, 2015

Notice of Approval of Coastal Boundary Survey

Pursuant to §33.136 of the Texas Natural Resources Code, notice is hereby given that George P. Bush, Commissioner of the General Land Office, approved a coastal boundary survey described as follows:

A Coastal Boundary Survey, dated January 31, 2015, by Stephen C. Blaskey, Licensed State Land Surveyor, delineating the littoral boundary line of the Gulf of Mexico and the Edward Hall and Levi Jones Survey, A-121, same line being the western boundary of Submerged Land Tracts 230, 231/North 310 and 241. The survey is required under §33.136 Texas Natural Resources Code for a proposed beach nourishment project to be completed under authority of Texas General Land Office Lease No SL20150012 and Coastal Erosion Planning and Response Act (CEPRA) Project No. 1609. The surveyed line is situated along the seaward edge of the granite riprap in front of the Galveston Seawall [N29.254251°, W94.847593° (29°15'15.31" 94°50'51.34"), WGS84], extending from 61st Street westward to the end of said seawall.

This survey is intended to provide pre-project baseline information related to an erosion response activity on coastal public lands. An owner of uplands adjoining the project area is entitled to continue to exercise littoral rights possessed prior to the commencement of the erosion response activity, but may not claim any additional land as a result of accretion, reliction, or avulsion resulting from the erosion response activity.

For a copy of this survey or more information on this matter, contact Bill O'Hara, Director of the Survey Division, Texas General Land Office by phone at (512) 463-5212, email bill.o'hara@glo.texas.gov, or fax (512) 463-5223.

TRD-201502294
Anne L. Idsal
Chief Clerk
General Land Office
Filed: June 16, 2015

Texas Health and Human Services Commission Public Notice

SPA 15-005 VDP Reimbursement

The Texas Health and Human Services Commission announces its intent to submit transmittal number 15-005 to the Texas State Plan for Medical Assistance, under Title XIX of the Social Security Act.

The purpose of this amendment is to modify the reimbursement methodology for the pharmacy dispensing fee. The methodology is being revised to comply with federal guidance; the new methodology will be based on the National Average Drug Acquisition Cost (NADAC) pricing benchmark and will include a new dispensing fee that is based on a study completed by the State's contractor that analyzed pharmacies' cost of dispensing. The proposed amendment is effective February 1, 2016.

The proposed amendment is estimated to result in a cost savings of \$11,519,470 for the remainder of federal fiscal year (FFY) 2016, consisting of \$6,577,488 in federal funds and \$4,941,982 in state general revenue. For FFY 2017, the estimated savings is \$10,302,139, consisting of \$5,841,978 in federal funds and \$4,460,161 in state general revenue. For FFY 2018 the estimated savings is \$11,019,179, consisting of \$6,244,569 in federal funds and \$4,774,610 in state general revenue.

To obtain copies of the proposed amendment, interested parties may contact J.R. Top, State Plan Coordinator, by mail at the Health and Human Services Commission, P.O. Box 13247, Mail Code H-600, Austin, Texas 78711; by telephone at (512) 462-6397; by facsimile at (512) 730-7472; or by e-mail at jr.top@hhsc.state.tx.us. Copies of the proposal will also be made available for public review at the local offices of the Texas Department of Aging and Disability Services.

TRD-201502313
Karen Ray
Chief Counsel
Texas Health and Human Services Commission
Filed: June 17, 2015

Public Notice - Amendment to the Texas State Plan for Medical Assistance Effective July 1, 2015

The Texas Health and Human Services Commission (HHSC) announces its intent to submit an amendment to the Texas State Plan for Medical Assistance under Title XIX of the Social Security Act. The proposed amendment is effective July 1, 2015.

The purpose of this amendment is to update the fee schedules in the current state plan by adjusting or implementing fees for:

- Early and Periodic Screening, Diagnosis, and Treatment Services (EPSDT);
- Licensed Clinical Social Worker Services;
- Licensed Professional Counselor Services;
- Licensed Marriage and Family Therapist Services;
- Physicians and Other Practitioners;
- Vision Care Services; and
- Clinical Laboratory Services

The purpose of these rate actions is to comply with federal common procedural mandates and to adjust reimbursements to comply with the State's methodology. These rate actions comply with applicable adjustments in response to direction from the Texas Legislature as set out in the 2012-2013 General Appropriations Act, effective September 1, 2011, and the 2014-2015 General Appropriations Act, effective

TEXAS GENERAL LAND OFFICE
Art. 33.136, Natural Resources Code
Co. Galveston, Sketch No. 77
File Date 06/10/2018 by R. Kerbye

Texas. Secretary of State. Texas Register, Volume 40, Number 26, Pages 4071-4262, June 26, 2015, periodical, June 26, 2015; Austin, Texas. (texashistory.unt.edu/ark:/67531/metaph623018/m1/174/?q=Blaskey%20AND%20%22Coastal%20Boundary%20Survey%22: accessed June 18, 2018), University of North Texas Libraries, The Portal to Texas History, texashistory.unt.edu; crediting UNT Libraries Government Documents Department.