

Coastal Boundary Survey of a Portion of  
Neches River  
in  
Jefferson County, Texas

W. G. Jackson  
41234  
A-680  
(Burr & Caswell #2)  
S-469

NOTICE: This survey was performed in accordance with Section 33.136, Natural Resources Code, for the purpose of evidencing the location of the shoreline in the area depicted in this survey as that shoreline existed before commencement of erosion response activity, as required by Chapter 33, Natural Resources Code. The line depicted on this survey fixes the shoreline for the purpose of locating a shoreline boundary, subject to movement landward as provided by Section 33.136, Natural Resources Code.

The littoral boundary was established at Mean High Water, elevation 1.37 feet NAVD88 per tide datum established at gauge Rainbow Bridge (504) operated by NOAA.

Hatched area on plot is rebuilt bulkhead and fill that has been completed in 2012 under GLO Project No. SL20120024 and contains 4399.74 square feet. Other than this, in this subject project area, there is no evidence of fill; in fact, erosion is occurring at a rapid pace.

FIELD NOTES FOR GLO PROJECT SL20120008

State of Texas §  
County of Jefferson §

Field notes describing a portion of the right bank of the Neches River adjacent to the W. G. Jackson Survey, Abstract 680, Jefferson County, Texas and a portion of a dug canal.

All bearings, distances and coordinates are grid and are referenced to the Texas State Plane Coordinate System, South Central Zone, NAD 83, U. S. survey feet. Mapping angle is +02°29'55" and the combined scale factor is 0.999926848.

BEGINNING at a point on mean high water on the right bank of the Neches River having a coordinate value of N: 13940233.20 and E: 3582602.00.

Thence with the right bank of the Neches River the following courses and distance:

LINE	BEARING	DISTANCE
L1	S 80°16'38" E	8.33' 3.00 varas
L2	N 87°34'23" E	33.94' 12.22 varas
L3	N 32°40'11" E	34.68' 12.48 varas
L4	S 62°52'43" E	1.98' 0.71 varas
L5	S 12°11'05" E	11.66' 4.20 varas
L6	S 34°30'01" W	36.45' 13.12 varas
L7	S 11°13'26" W	53.38' 19.22 varas
L8	S 07°27'15" E	42.06' 15.14 varas
L9	S 11°33'55" E	67.52' 24.30 varas
L10	S 01°15'57" W	50.33' 18.12 varas
L11	S 10°54'59" E	106.76' 38.43 varas
L12	S 20°21'34" E	81.21' 29.24 varas

to the current entrance of the dug canal. THENCE with the the line of mean high water on the bank of the dug canal.

L13 S 44°26'44" W 95.36' 34.33 varas

To the end of the project area.

Field Personnel:  
Alvin Lassiter  
Jonathan Freeman

This map and the accompanying "Filled Area Map" are filed for record under County Clerk File No. 2012035405 Official Public Records, Jefferson County, Texas.

Huntsman Performance Products  
2701 Spur 136  
P.O. Box 847  
Port Neches, TX 77651  
V 2061/Pg 31

End of Project Area:  
Monument LUB 0520 D brs.  
S82°37'20"E 1967.05 v.  
N: 13939760.52  
E: 3582635.60

N: 13940233.20  
E: 3582602.00  
Monument LUB  
0520 D brs.  
S77°50'44"E  
2007.87 v.

N: 13939609.86  
E: 3586441.28  
3/4" Iron pipe found  
by D. D. Shine in 1959 from  
which the Northeast corner W.  
G. Jackson Survey bears  
N04°52'05"E 41.33 varas.

TEXAS GENERAL LAND OFFICE  
Art. 33.136, Natural Resources Code  
Co. J. Jackson - State No. 11  
File Date 02/22/2012 by R. Kerker

Project Description: Reburial of exposed Praxair pipeline and placement of revetment on eroding shoreline in vicinity of Praxair pipeline.

This survey performed in connection with Central States Underwater Contracting General Land Office Project No. SL20130008

Central States Underwater Contracting  
22103 FM 2100 Road  
Crosby, TX 77532

Hatched area is bulkhead and fill completed 2012 under GLO Project No. #SL20120024 and contains 4399.74 square feet.

I, Nedra J. Foster, Licensed State Land Surveyor, do hereby certify that the line of mean high water shown hereon was correctly surveyed under my direction on the ground and according to law on October 3, 2012. (In accordance with Texas Natural Resources Code Sec. 21.042 and in accordance with methodology for the project approved by the surveying Division of the GLO). Points on Neches River and on the dug canal are on the line of mean high water and lines connecting are meander lines. Given under my hand and seal this 8th day of October 2012.

Nedra J. Foster  
Nedra J. Foster  
L. S. L. S.



Shine & Associates, Inc.  
P. O. Box 305  
Silsbee, Texas 77656  
409-385-9383





Shine & Associates, Inc.  
P. O. Box 305  
Silsbee, Texas 77656  
409-385-9383

# Filled Area Map to Accompany Coastal Boundary Survey of a Portion of Neches River in Jefferson County, Texas



SCALE: 1" = 40'  
1" = 14.40 varas

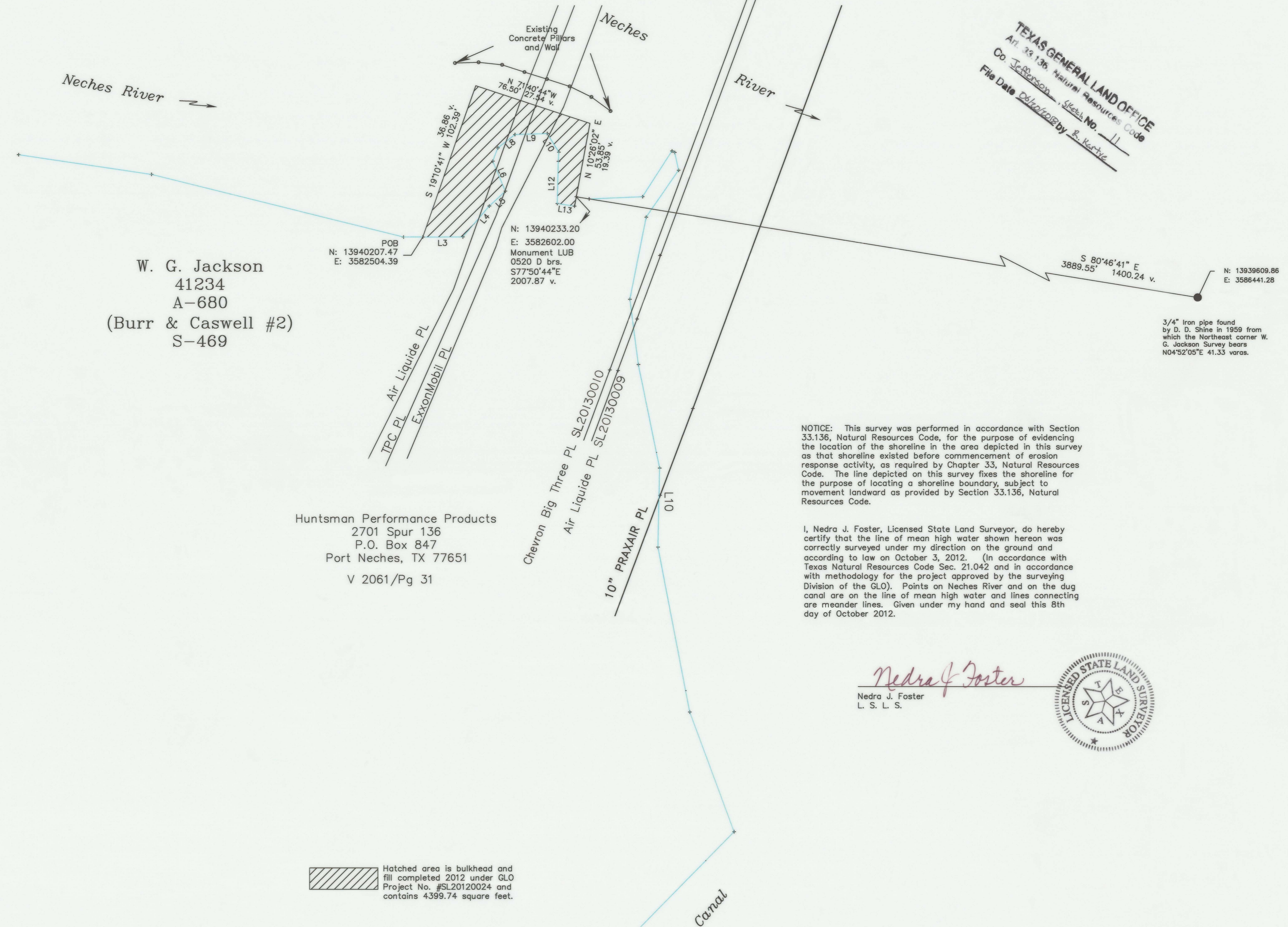

TEXAS GENERAL LAND OFFICE  
Art. 33.136, Natural Resources Code  
Co. Jefferson, Sketch No. 11  
File Date 09/26/2012 by R. Kerker

W. G. Jackson  
41234  
A-680  
(Burr & Caswell #2)  
S-469

Huntsman Performance Products  
2701 Spur 136  
P.O. Box 847  
Port Neches, TX 77651  
V 2061/Pg 31

NOTICE: This survey was performed in accordance with Section 33.136, Natural Resources Code, for the purpose of evidencing the location of the shoreline in the area depicted in this survey as that shoreline existed before commencement of erosion response activity, as required by Chapter 33, Natural Resources Code. The line depicted on this survey fixes the shoreline for the purpose of locating a shoreline boundary, subject to movement landward as provided by Section 33.136, Natural Resources Code.

I, Nedra J. Foster, Licensed State Land Surveyor, do hereby certify that the line of mean high water shown hereon was correctly surveyed under my direction on the ground and according to law on October 3, 2012. (In accordance with Texas Natural Resources Code Sec. 21.042 and in accordance with methodology for the project approved by the surveying Division of the GLO). Points on Neches River and on the dug canal are on the line of mean high water and lines connecting are meander lines. Given under my hand and seal this 8th day of October 2012.

*Nedra J. Foster*  
Nedra J. Foster  
L. S. L. S.



FIELD NOTES FOR AS-BUILT BULKHEADED/FILL AREA  
ASSOCIATED WITH GLO PROJECT SL20120024

Field notes of a portion of the right bank of the Neches River adjacent to the W. G. Jackson Survey, Abstract 680, Jefferson County, Texas, as surveyed on April 4, 2012 under GLO Project No. SL20120024 and in accordance with Section 33.136 of Texas Natural Resources Code, and the subsequent as-built bulkheading and fill area associated with this project.

All bearings, distances and coordinates are grid and are referenced to the Texas State Plane Coordinate System, South Central Zone, NAD 83, U. S. survey feet. Mapping angle is +02°29'54" and the combined scale factor is 0.999927058.

BEGINNING at a point on mean high water on the right bank of the Neches River having a coordinate value of N: 13940207.47 and E: 3582502.39 as surveyed April 12, 2012 in accordance with Section 33.136 of Texas Natural Resources Code.

Thence with the right bank of the Neches River as surveyed April 4, 2012 the following courses and distances:

Line	Bearing	Distance	Varas
L3	N 89°54'10" E	25.46'	9.17 v.
L4	N 40°30'54" E	25.93'	9.33 v.
L5	N 46°59'41" E	13.98'	5.03 v.
L6	N 22°44'26" W	20.73'	7.46 v.
L7	N 20°48'23" E	9.11'	3.28 v.
L8	N 51°46'25" E	13.80'	4.97 v.
L9	N 88°09'23" E	20.61'	7.42 v.
L10	S 31°51'12" E	14.05'	5.06 v.
L11	S 03°13'18" W	5.93'	2.13 v.
L12	S 01°22'05" W	26.89'	9.68 v.
L13	S 81°09'51" E	11.01'	3.96 v.

to a corner of the as-built bulkhead. Thence with the as-built bulkhead N10°26'02"E at 6.13 feet pass the line of mean high water as surveyed on October 8, 2012 and continue for a total distance of 53.85 feet (19.39 v.) to a corner of the as-built bulkhead area. Thence N71°40'44"W 76.50 feet (27.54 v.) to a corner of the as-built bulkhead area. Thence S19°10'41"W 102.39 feet (36.86 v.) to the PLACE OF BEGINNING, containing 4399.74 square feet of fill between the coastal boundary established April 4, 2012 and the as-built bulkhead area.

Field Personnel:  
Alvin Lassiter  
Jonathon Freeman

This map and the accompanying 'Coastal Boundary Survey' are filed for record under County Clerk File No. 2012035403 Official Public Records, Jefferson County, Texas.

Hatched area is bulkhead and fill completed 2012 under GLO Project No. #SL20120024 and contains 4399.74 square feet.

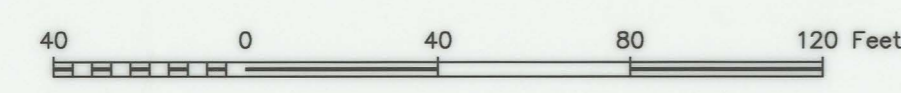





**Surveying Division  
Coastal Boundary Survey Approval**

**Project:** Central State Underwater Contracting-Praxair Pipeline Reburial  
Central State Underwater Contracting-Air Liquide Pipeline Reburial  
Central State Underwater Contracting-Chevron Pipeline Reburial

**Project No:** SL20130008 (General Land Office) (Praxair)  
SL20130009 (General Land Office) (Air Liquide)  
SL20130010 (General Land Office) (Chevron)

**Project Manager:** Jeffrey Davis, Regional Manager, Upper Coast, GLO

**Surveyor:** Nedra Foster, Licensed State Land Surveyor

**Description:** A Coastal Boundary Survey together with associated Fill Map, dated October 3, 2012, by Nedra Foster, Licensed State Land Surveyor, delineating the littoral boundary of a portion of the W. G. Jackson Survey, Abstract 680, same line being the right or south bank of the Neches River, situated approximately 1.7 miles westerly (upstream) from State Highway 87, Jefferson County, Texas. Fill Map delineates the limits of fill material placed in the bed of the Neches River under GLO Permit SL20120024, adjacent to and immediately upstream from current survey.

A Coastal Boundary Survey for the above-referenced project has been reviewed and accepted; upon completion of public notice requirements, the survey will be filed in the Texas General Land Office, Archives and Records, in accordance with provisions of the *Texas Natural Resources Code*, Chapter 33.136.

Approved:

Signed: David A. Bell  
Surveying Division

Nov. 6, 2012  
Date

Approval Filed as:

*Texas Natural Resources Code* Article 33.136, Jefferson County, Sketch No. 11

TEXAS GENERAL LAND OFFICE  
Art. 33.136, Natural Resources Code  
Co. Jefferson, Sketch No. 11  
File Date 06/10/2018 by R. Kertye

# Shine & Associates, Inc.

LAND BOUNDARY SURVEYORS  
D. D. SHINE, RPLS, LSLs  
NEDRA J. FOSTER, RPLS, LSLs

November 6, 2012

Mr. David Pyle  
Texas General Land Office  
Stephen F. Austin Building, 1<sup>st</sup> Floor  
1700 N. Congress Avenue  
Austin, Texas 78701-1495

Dear David:

On October 25, 2012, I sent to you two survey plats associated with GLO Project Number SL20120008. These two plats are filed in the Official Public Records of Jefferson County, Texas at file number 2012035405.

Two additional projects will be completed in this immediate vicinity and have been assigned GLO project numbers. I am requesting that you add the following notations to this filing. Additionally, the initial project number needs to be corrected as shown in 3).

- 1) Chevron pipeline – shown on the plat as a Big Three pipeline. Please add the word 'Chevron' beside Big Three and the GLO Project #SL20130010.
- 2) Air Liquide pipeline – please add the GLO Project #SL20130009.
- 3) Change GLO Project #SL20120008 to #SL20130008.

Thank you for your help with this matter.

Yours truly,

*Nedra J. Foster*

Nedra J. Foster  
Licensed State Land Surveyor

TEXAS GENERAL LAND OFFICE  
Art. 33.136, Natural Resources Code

Co. Jefferson, Sketch No. 11

File Date 06/20/2013 by R. Kartye



