

STATE OF TEXAS
COUNTY OF BRAZORIA

Field notes describing a coastal boundary survey performed on the line of mean high water adjacent to a portion of the John G. McNeel Survey, Abstract 335, Brazoria County, Texas.

All bearings and distances are grid and are referenced to the Texas Plane Coordinate System, NAD83, South Central Zone, U. S. survey feet and varas. The combined scale factor for this project is 0.999894704 and the mapping angle is +1°47'37". NGS monument DP0699, designated 877 2447 E, was utilized having a published coordinate of N: 13,546,153.59 (U. S. survey feet) and E: 3,150,613.76 (U. S. survey feet) and H: 5.2 feet related to NAVD83. Tide gauge Freeport, Station ID 8772447, was utilized in determining mean high water.

BEGINNING at a point on the line of mean high water on the Gulf of Mexico, also being the northerly line of Submerged Land Tract 278, and the south line of said McNeel Survey which has a state plane coordinate value of N: 13532870.12 U. S. survey feet and E: 3139641.74 U. S. survey feet. From said beginning point NGS monument DP0699 bears N39°33'23"E 6202.41 varas (17,228.92 U. S. survey feet).

THENCE with the line of mean high water the following courses and distances:

| LINE | BEARING | DIST VARAS | DIST FEET |
|------|---------------|--|-----------|
| L1 | N 48°29'46" E | 69.56 | 193.23' |
| L2 | N 50°16'30" E | 64.59 | 179.42' |
| L3 | N 47°34'57" E | 83.31 | 231.41' |
| L4 | N 49°10'29" E | 72.69 | 201.91' |
| L5 | N 50°06'42" E | 71.18 | 197.73' |
| L6 | N 48°13'15" E | 72.44 | 201.21' |
| L7 | N 49°14'53" E | 75.40 | 209.44' |
| L8 | N 50°05'16" E | 70.50 | 195.82' |
| L9 | N 48°52'18" E | 72.18 | 200.49' |
| L10 | N 50°53'50" E | 72.24 | 200.66' |
| L11 | N 48°45'15" E | 73.29 | 203.57' |
| L12 | N 49°15'50" E | 73.11 | 203.07' |
| L13 | N 50°03'38" E | 87.25 | 242.35' |
| L14 | N 49°02'24" E | 72.72 | 202.00' |
| L15 | N 49°41'49" E | 98.57 | 273.81' |
| L16 | N 49°49'54" E | 72.34 | 200.95' |
| L17 | N 50°11'42" E | 68.06 | 189.06' |
| L18 | N 48°26'48" E | 71.95 | 199.86' |
| L19 | N 50°43'32" E | 69.55 | 193.20' |
| L20 | N 49°28'56" E | 74.77 | 207.70' |
| L21 | N 51°06'54" E | 75.76 | 210.45' |
| L22 | N 47°46'50" E | 71.46 | 198.49' |
| L23 | N 52°21'04" E | 68.61 | 190.58' |
| L24 | N 50°05'50" E | at 1.73 varas pass the northeast corner of State Submerged Tract 378/northwest corner Tract 377 and continue for a total distance of 74.52 varas (207.00') | |

to the end of the project area at a point on the common Gulf of Mexico and said McNeel line which has a state plane coordinate value of N: 13536069.57 and E: 3143395.86. From said end point NGS monument DP0699 bears N35°35'39"E 4464.37 varas (12,401.03 U. S. survey feet).

Field personnel:
Nedra J. Foster
Alvin Lassiter
J. T. Lokey

NOTICE: This survey was performed in accordance with Section 33.136 Natural Resources Code, for the purpose of evidencing the location of the shoreline in the area depicted in this survey as that shoreline existed before commencement of erosion response activity, as required by Chapter 33, Natural Resources Code. The line depicted on this survey fixes the shoreline for the purpose of locating a shoreline boundary, subject to movement landward as provided by Section 33.136, Natural Resources Code.

I, Nedra J. Foster, do hereby certify that the line of mean high water shown hereon was correctly surveyed by me on the ground and according to law during June 2015, in accordance with Texas Natural Resources Code Section 21.042 and in accordance with methodology for the project approved by the Surveying Division of the General Land Office. There is no evidence of buildup, fill, improvements, or retaining walls.



Nedra J. Foster
Nedra J. Foster
Licensed State Land Surveyor
June 29, 2015

J. G. McNeel Survey
A-335
1-12

TEXAS GENERAL LAND OFFICE
Art. 33.136, Natural Resources Code
Co. Brazoria, Sketch No. 18
File Date dictated by E. Kerche

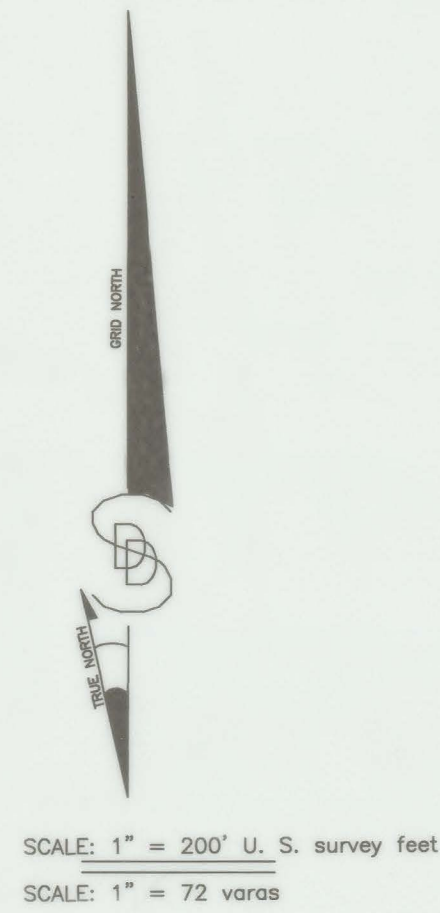

Shine & Associates, Inc.
330 N. 4th Street
P. O. Box 305
Silsbee, Texas 77656
409-385-9383
TBPLS Firm #10040800

POB
N: 13532870.12
E: 3139641.74
378

GLO Project Number: CEPRA 1571
This beach nourishment project is an erosion response activity.

Applicant: ARCADIS U.S., Inc.
630 Plaza Drive, Suite 600
Highlands Ranch, CO 80129

Filed for record at #2015031829
July 14, 2015
Official Public Records
Brazoria County, Texas

Coastal Boundary Survey
Bryan Beach Area
J. G. McNeel Survey, A-335
and the
Gulf of Mexico
Brazoria County, Texas



TEXAS GENERAL LAND OFFICE
GEORGE P. BUSH, COMMISSIONER

Surveying Division
Coastal Boundary Survey Approval

Project: Bryan Beach BMMP Beach Nourishment

Project No: CEPRA 1571 (GLO)
SD20040004 (GLO)

Project Manager: Carla Kartman, CEPRA Project Manager
Texas General Land Office

Surveyor: Nedra Foster, Licensed State Land Surveyor

Description: Coastal Boundary Survey, dated the month of June, 2015, by Nedra Foster, Licensed State Land Surveyor, on the shore of the Gulf of Mexico, delineating a portion of the littoral boundary of the J. G. McNeel Survey, Abstract 335, along the line of Mean High Water, same line being the boundary of Gulf of Mexico Submerged Land Tracts 377 and 378. The survey is in support of Coastal Erosion Planning and Response Act (CEPRA), Project No. 1571 and is situated at the eastern end of Bryan Beach Road, the Town of Quintana, at coordinates N 28°54'48", W95°19'58" (N28.913416°, W95.332823°) WGS84, in Brazoria County.

A Coastal Boundary Survey for the above-referenced project has been reviewed and accepted; upon completion of public notice requirements, the survey will be filed in the Texas General Land Office, Archives and Records, in accordance with provisions of the *Texas Natural Resources Code*, Chapter 33.136.

Approved:

Signed: _____

David A. Ryle
Surveying Division

July 20, 2015
Date

Approval Filed as:

Tex. Nat. Res. Code Article 33.136 Brazoria County, Sketch No. 18

TEXAS GENERAL LAND OFFICE
Art. 33.136, Natural Resources Code
Co. Brazoria, Sketch No. 18
File Date 06/20/2018 by R. Kertve

A copy of the RFP may be downloaded from the Electronic State Business Daily at http://esbd.cpa.state.tx.us/bid_show.cfm?bidid=119711.

TRD-201503279

Kay Molina

General Counsel

Texas Facilities Commission

Filed: August 21, 2015

General Land Office

Notice of Approval of Coastal Boundary Survey

Pursuant to §33.136 of the Texas Natural Resources Code, notice is hereby given that George P. Bush, Commissioner of the General Land Office, approved a coastal boundary survey described as follows:

A Coastal Boundary Survey, dated the month of June, 2015, by Nedra Foster, Licensed State Land Surveyor, on the shore of the Gulf of Mexico, delineating a portion of the littoral boundary of the J. G. McNeel Survey, Abstract 335, along the line of Mean High Water, same line being the boundary of Gulf of Mexico Submerged Land Tracts 377 and 378. The survey is in support of Coastal Erosion Planning and Response Act (CEPRA), Project No. 1571 and is situated at the eastern end of Bryan Beach Road, the Town of Quintana, at coordinates N 28°54'48", W95°19'58" (N28.913416°, W95.332823°) WGS84, in Brazoria County.

This survey is intended to provide pre-project baseline information related to an erosion response activity on coastal public lands. An owner of uplands adjoining the project area is entitled to continue to exercise littoral rights possessed prior to the commencement of the erosion response activity, but may not claim any additional land as a result of accretion, reliction, or avulsion resulting from the erosion response activity.

For a copy of this survey or more information on this matter, contact David Pyle, Director of the Survey Division, Texas General Land Office by phone at (512) 463-5229, email david.pyle@glo.texas.gov, or fax (512) 463-5223.

TRD-201503390

Anne L. Idsal

Chief Clerk, Deputy Land Commissioner

General Land Office

Filed: August 24, 2015

Notice of Approval of Coastal Boundary Survey

Pursuant to §33.136 of the Texas Natural Resources Code, notice is hereby given that George P. Bush, Commissioner of the General Land Office, approved a coastal boundary survey described as follows:

A Coastal Boundary Survey, dated April 21, 2015, by David L. Nesbitt, Licensed State Land Surveyor, delineating the littoral boundary line of portions of the T. J. Dasher Survey, A-146 and the L. Goodwin Survey, A-162, along the line of Mean High Water, same line being the boundary of Tres Palacios Bay Submerged Land Tracts 31 and 39. The survey is in support of a proposed beach nourishment project authorized under Texas General Land Office lease, CL19990014, and is situated along the southern limits of the City of Palacios, at coordinates N28°41'53", W96°12'50" (N28.698218°, W96.213998°) WGS84.

This survey is intended to provide pre-project baseline information related to an erosion response activity on coastal public lands. An owner of uplands adjoining the project area is entitled to continue to exercise

littoral rights possessed prior to the commencement of the erosion response activity, but may not claim any additional land as a result of accretion, reliction, or avulsion resulting from the erosion response activity.

For a copy of this survey or more information on this matter, contact David Pyle, Director of the Survey Division, Texas General Land Office by phone at (512) 463-5229, email david.pyle@glo.texas.gov, or fax (512) 463-5223.

TRD-201503391

Anne L. Idsal

Chief Clerk, Deputy Land Commissioner

General Land Office

Filed: August 24, 2015

Texas Health and Human Services Commission

Public Notice of Withdrawal of Proposed Medicaid Payment Rates for Physical, Occupational and Speech Therapy

The Texas Health and Human Services commission (HHSC) has withdrawn the proposed Medicaid Payment Rates for Physical, Occupational, and Speech Therapy provided by Comprehensive Outpatient Rehabilitation Facilities/Outpatient Rehabilitation Facilities (CORFs/ORFs), Home Health Agencies (HHAs), and Independent Therapists that were the subject of a public hearing held on July 20, 2015, that was noticed in the July 10, 2015 issue of the *Texas Register* (40 TexReg 4475). Additional information may be obtained by contacting HHSC Rate Analysis by telephone at (512) 730-7401 or by e-mail to RADAcuteCare@hhsc.state.tx.us.

TRD-201503441

Karen Ray

Chief Counsel

Texas Health and Human Services Commission

Filed: August 26, 2015

Public Notice - Proposed Medicaid Payment Rates for Physical, Occupational, and Speech Therapy Provided by Comprehensive Outpatient Rehabilitation Facilities/Outpatient Rehabilitation Facilities, Home Health Agencies, and Independent Therapists

Hearing. The Texas Health and Human Services Commission (HHSC) will conduct a public hearing on September 18, 2015, at 9:00 a.m., to receive comment on proposed Medicaid payment rates for Physical, Occupational, and Speech Therapy provided by Comprehensive Outpatient Rehabilitation Facilities/Outpatient Rehabilitation Facilities (CORF/ORF), Home Health Agencies (HHA), and Independent Therapists. The proposed rate actions are based on direction provided by the 2016-2017 General Appropriations Act, 84th Legislature, Regular Session, Article II, Rider 50, at pages II-96 through II-98 (Health and Human Services Section, Health and Human Services Commission).

The public hearing will be held in the Public Hearing Room of the John H. Winters Building at 701 West 51st Street, Austin, Texas. The hearing will be held in compliance with Human Resources Code §32.0282 and Title 1 Texas Administrative Code (1 TAC) §355.201, which require public notice of and hearings on proposed Medicaid reimbursements.

Proposal. The payment rates for Physical, Occupational, and Speech Therapy provided by Comprehensive Outpatient Rehabilitation Facilities/Outpatient Rehabilitation Facilities (CORF/ORF), Home Health

40 TexReg 5956 September 4, 2015 Texas Register

TEXAS GENERAL LAND OFFICE
 Art. 33.136, Natural Resources Code
 Co. Brazoria, Sketch No. 18
 File Date 06/20/2015 by R. Rortye