

ENGLISH FIELD NOTES

BOOK 5

SPANISH ARCHIVES

G. L. O.



1056098  
EFN 000005

English Field Notes 5

153

J. P. Borden

T. Borden Jr.

W. R. Hensley

Seth Ingram

William Selkirk

Galveston

Waller

Fort Bend

Fayette

Washington

Austin

Montgomery

Madison

4Burleson

Grimes

Lee

Matagordia

Lavaca

Colorado

Wharton

Austin

Brazoria

Waller

Matagorda

Austin

Waller

Wharton

Seth Ingram's Book  
of field notes. 1824.

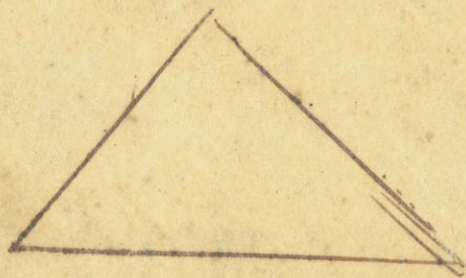

Surveys situated on both sides of the  
river Colorado and beyond.

No 5. Austin's Colony



MS  
Vol. 1. p. 225  
Stoughton Co  
July 7/44  
Type used

(1) Sylvanus Castleman  
Field notes, of Sylvanus Castleman's  
half League of land lying on the River Colorado  
above the Laborde road, taken by an actual  
Survey August 15<sup>th</sup> & 19<sup>th</sup> 1823.

Beginning at a Stone corner on the west bank of the  
river about one mile below said Castleman's dwelling house  
near a large Cotton wood, from thence due west 2260  
bars to a Stone corner, from thence due North 5190 bars  
to corner on the bank of the river to a Stone corner,  
where a Cotton wood 2 feet in diameter bears North 70°  
West 10 bars, from thence down the river with the  
meanders thereof to the beginning.

For Protraction.

Beginning at sd. corner first mentioned, from thence  
360 bars to a stake on the bank of the Spring branch,  
from thence due North 900 bars to an offsett to right  
to river <sup>30 bars</sup>, thence 700 bars, to an offsett 15 bars, thence  
500 bars to an offsett 150 bars, thence 2200 bars to an  
offsett 1750 bars, thence 700 bars to an offsett 670  
bars. 2<sup>ndly</sup> from sd. stake on the bank of sd. Spring  
branch due West 1900 bars to corner. thence due North 5190  
bars to bank of river. This tract of land contains  
12,500,000 square bars,

Survey of the 19th of 1848

William Smetham (S.)

League

Field Notes of William Smetham, ~~Foot~~ of

land. Beginning on the bank of the river below Smetham's house at a large Cotton wood marked WS EC from which an ash 12 inches diameter bears N 76° W. 4 links, and a cotton wood 2 feet in diam<sup>r</sup> bears S 2° W. 2 chains and 17 links, <sup>(23)</sup> 2<sup>d</sup> corner about 50 bars below a ripple. From thence N W. 3791 bars to corner a stake in the Prairie a little north of the Cochatta road from which a Post oak 14 in<sup>s</sup> diam<sup>r</sup> bears S 53° E. 4 chains. <sup>marked WS SC</sup> near it stands 3 other P. oaks. From thence N W. 6666 bars to corner a stake in Prairie, from which a Post oak 18 in<sup>s</sup> diam<sup>r</sup> bears N 30° W. 3 chains and 28 links. Marked WS WC. From thence N E 3251 bars to the corner a stake on the bank of the river from which a Spanish oak 18 in<sup>s</sup> diam<sup>r</sup> bears N 71 1/2° W. 32 links. Marked WS NC. From thence down the river with the meanders thereof to the beginning. Containing 25,000,000 Square Bars. In the title the 1<sup>st</sup> line is 3721 bars. MDJ

commencing at the above said beginning. thence N 76° W. 4 links, thence S 2° W. 2 chains and 17 links, thence N W. 3791 bars, thence S 53° E. 4 chains, thence N W. 6666 bars, thence N E 3251 bars, thence down the river with the meanders thereof to the beginning. Containing 25,000,000 Square Bars.

to corner, from river S 71 3251 N. to corner, from  
thence S 6 6 1/2 to corner, from thence N 6  
291 N. to corner on river. Upper end of this  
League bottom 260 N. wide, the remainder 2800  
feet. Lower end, bottom 2440 N. wide, 1246 N. wide  
the river a lake 100 N. wide.

Field notes of William Smeatham tract of land,  
beginning at the lower corner on the river, of the  
before mentioned League from thence S.W. with said  
line 3791 N. to S.E. corner of S. League, from thence  
N.W. 1250 N. to a Stake, in Prairie from thence 2914 N.  
N.E. to corner on river bank, an Elm 6 in. diam.  
from which a cotton wood 2 feet in diam. bears N 86 1/2  
1 Chain 24 links, and a Sycamore 15 in. diam. bears  
S 48 1/2 E. 1 Chain 11 links, from thence down the river  
with the meanders thereof to the beginning. contain-  
ing 727 acres.

A band of the river more from the lower end  
of Smeatham's League, to the upper line of the  
straight labor, beginning on S.E. line 400 N. of  
the river, from thence <sup>SE</sup> 4 1/2 1000 N. of first to  
500 N. thence 1000 to river, thence S 77 500 N. thence  
S 8 450 N. to river, thence S 77 500 N. to river, thence  
N 8 550 N. thence S 77 1200 N. to river, thence S  
70 N. thence S 77 500 N. thence S 77 500 N.  
to river, thence S 77 500 N. to river, thence S 77 500 N.





2010  
530  
1080

(5)

cleanliness of the eyes, from the lower corner  
I traced bright labor, down until I met midline  
with, by moving opposite to the right, I swept  
from them.  $\sqrt{N 81^{\circ} E, 220. S. \text{ line } N 7^{\circ} E, 390. S.}$

Thence $\sqrt{N 81^{\circ} E, 220.}$	Thence $\sqrt{S 86^{\circ} E, 210.}$	Thence $\sqrt{S 21^{\circ} E, 290.}$
" $\sqrt{S 82^{\circ} E, 160.}$	" $\sqrt{S 49^{\circ} E, 320.}$	" $\sqrt{S 27^{\circ} E, 350.}$
" $\sqrt{S 42^{\circ} E, 140.}$	" $\sqrt{S 15^{\circ} E, 320.}$	" $\sqrt{S 36^{\circ} E, 290.}$
" $\sqrt{S 29^{\circ} E, 220.}$	" $\sqrt{S 20^{\circ} E, 170.}$	" $\sqrt{S 50^{\circ} E, 220.}$
" $\sqrt{N 86^{\circ} E, 480.}$	" $\sqrt{S 40^{\circ} E, 180.}$	" $\sqrt{S 63^{\circ} E, 180.}$
" $\sqrt{S 19^{\circ} E, 160.}$	" $\sqrt{S 27^{\circ} E, 170.}$	" $\sqrt{S 65^{\circ} E, 210.}$
" $\sqrt{S 36^{\circ} E, 140.}$	" $\sqrt{S 33^{\circ} E, 290.}$	" $\sqrt{S 69^{\circ} E, 220.}$
" $\sqrt{S 75^{\circ} E, 330.}$	" $\sqrt{S 59^{\circ} E, 340.}$	" $\sqrt{S 24^{\circ} E, 320.}$
" $\sqrt{S 22^{\circ} E, 230.}$	" $\sqrt{S 65^{\circ} E, 220.}$	" $\sqrt{S 72^{\circ} E, 250.}$
" $\sqrt{S 12^{\circ} E, 190.}$	" $\sqrt{S 55^{\circ} E, 160.}$	" $\sqrt{S 47^{\circ} E, 180.}$
" $\sqrt{S 34^{\circ} E, 510.}$	" $\sqrt{S 12^{\circ} E, 370.}$	" $\sqrt{S 27^{\circ} E, 160.}$
" $\sqrt{S 35^{\circ} E, 330.}$	" $\sqrt{S 12^{\circ} E, 130.}$	" $\sqrt{S 60^{\circ} E, 130.}$
" $\sqrt{S 40^{\circ} E, 410.}$	" $\sqrt{S 23^{\circ} E, 330.}$	" $\sqrt{S 45^{\circ} E, 270.}$
" $\sqrt{S 26^{\circ} E, 280.}$	" $\sqrt{S 38^{\circ} E, 36.}$	" $\sqrt{S 57^{\circ} E, 30.}$
" $\sqrt{S 27^{\circ} E, 170.}$	" $\sqrt{S 40^{\circ} E, 270.}$	" $\sqrt{S 61^{\circ} E, 330.}$
" $\sqrt{S 28^{\circ} E, 650.}$	" $\sqrt{S 17^{\circ} E, 190.}$	" $\sqrt{S 70^{\circ} E, 160.}$
" $\sqrt{S 46^{\circ} E, 150.}$	" $\sqrt{S 18^{\circ} E, 290.}$	" $\sqrt{S 54^{\circ} E, 160.}$
" $\sqrt{S 17^{\circ} E, 310.}$	" $\sqrt{S 15^{\circ} E, 140.}$	" $\sqrt{S 23^{\circ} E, 270.}$
" $\sqrt{S 44^{\circ} E, 170.}$	" $\sqrt{S 34^{\circ} E, 300.}$	" $\sqrt{S 24^{\circ} E, 290.}$
" $\sqrt{S 40^{\circ} E, 100.}$	" $\sqrt{S 15^{\circ} E, 220.}$	" $\sqrt{S 24^{\circ} E, 400.}$
" $\sqrt{S 30^{\circ} E, 250.}$	" $\sqrt{S 45^{\circ} E, 160.}$	" $\sqrt{S 61^{\circ} E, 240.}$
" $\sqrt{S 60^{\circ} E, 260.}$	" $\sqrt{S 25^{\circ} E, 180.}$	" $\sqrt{S 70^{\circ} E, 600.}$
" $\sqrt{S 56^{\circ} E, 400.}$	" $\sqrt{S 7^{\circ} E, 520.}$	" $\sqrt{S 56^{\circ} E, 370.}$

(6)

√ 1016 E 250.     √ 125° E 150.     √ 115° E 150.

.. √ 1146 230.     √ 142° N 130.     √ 113° N 130.

√ 124° N 120.     √ 134° N 180.     ~~110~~

Not Selkirk's meandering on the opposite  
side of the river. See Selkirk's field notes

I (7)

Field Notes of John Bott's half League of land. Beginning at a stake on the bank of the river from which a cotton wood 18 ins diam<sup>r</sup>. bears N 11° E 31 links, marked  $\frac{SFA}{NEC}$ , and another cotton wood 12 ins diameter bears N 61° W 1 Chain 26 links marked as before. From thence NW ~~3839~~ 13. to corner a stake in Prairie. Thence NE 1050 13. to Smetham, SE corner. Thence NE 3791 13. along P. Smetham's east line to P. Smetham's NE corner on the river, thence down the river with the meanders thereof to the beginning containing 12,500,000 Square Bars.

William Hearvey Titled to William Hearvey

Field Notes of Col. S. F. Austin's League of land lying above town on the west side of the Brazos. Beginning at the NE corner of David Bright's Labor on the river and running N 65° W 1071 13. to P. Bright's NW corner, thence S 25° W 1000 13. to Bright's SW corner where it intersects Hilburn's north line. Thence N 65° W 260 13. to Hilburn's NW corner, thence S 25° W 330 13. to Hilburn's SW corner. Thence N 65° W ~~475~~ 13. to corner of P. League a stake in Prairie. Small boy old in the bottom, from which a Pecan 8 ins. diam<sup>r</sup>. bears S 77° E 36 links, marked  $\frac{SFA}{SWC}$ , and a Spanish oak 16 ins. diam<sup>r</sup>. bears S 61° W 27 links, marked as above, from thence N 25° E 8332 13. to NW corner a stake in Prairie. Thence SE 3780 13. to corner a stake on the bank of the river, from which a cotton wood 18 ins diam<sup>r</sup>. bears N 11° E 31 links, marked  $\frac{SFA}{NEC}$ , and another cotton

William Hearvey  
SFA in and SFA 3000 13.

(8)

wood 12 ins diam<sup>s</sup> bears N 61° W. 1 chain 26 links,  
marked as before, from thence down the river  
with the meanders thence to the beginning.  
Containing 25,000,000 Square Bars.

1000 B. from SW corner of the above League  
came to a Marsh or Lake 900 B. wide. 5000 B.  
from S<sup>o</sup> corner came to open bottom and good  
timber. 6400 B. from S<sup>o</sup> corner came to Prairie.  
from NW corner of S<sup>o</sup> League at 1600 B. came to  
river  
bottom.

(9)

Field notes of Hilburn's Labor, beginning  
at the upper corner of Thom's Boatright, Labor on the  
river, from thence  $N 65^{\circ} W 2871$  ft. to corner a stake  
from which a Pecan 15 in. diam. bears  $N 46^{\circ} E 46$  links  
marked  $\begin{matrix} WL \\ NT \end{matrix}$ , and an ash 6 in. diam. bears  $S 58^{\circ} W 32$  links  
marked as before, from thence  $N 25^{\circ} E 330$  ft. to corner  
a stake from which an elm 8 in. diam. bears  $S 15^{\circ} E$   
40 links, marked as above, and an ash 8 in. diam.  
bearing  $S 82^{\circ} W 7$  links, marked as above, thence  
 $S 65^{\circ} E 1551$  ft. to corner on the river, a stake from  
which a Hackberry 10 in. diam. bears  $S 9^{\circ} W 25$  links  
marked as above. Thence down the river with the me-  
anders thereof to the beginning, containing  
1,000,000 Square Bars.

David Bright

(70) O.K. Title issued July 15 1924 - Vol 1 p. 114  
K. 123  
Drazona co.

Field Notes of David Bright's Labor, beginning at  
 the upper corner of Hilburn's Labor, from thence along  
 Hilburn's north line 1291 7/8 to corner Stake, from  
 which an elm 8 in. diam. bears N 88° W 24 links  
 marked <sup>WL</sup>/<sub>NT</sub>, and another elm 7 in. diameter bears  
 N 89° E 40 links, marked as before, thence N 25° E 1000  
 7/8 to corner, a Stake from which an elm 8 in.  
 diam. bears N 88° E 40 links, marked as above, and  
 another elm 12 in. diam. bears S 35° E 1 chain  
 4 links, marked as above, thence S 65° E 10 7/8  
 to the river, upper corner a Stake on the river bank  
 from which a box elder 6 in. diam. bears N 27° E  
 32 links marked as before, thence down the river with  
 the Meanders thereof to the beginning, containing  
 1,000,000 Square Bars.

Meanders of the above Labor.

beginning at the lower corner of  
 the north line, from thence S 25° E 1000 7/8  
 to corner, thence 600 7/8 to the river,  
 thence S 65° E 10 7/8 to the river.

Field notes July 27/24 vol 1 p 258 Walker cr

Jared E. (11) Grace

Field Notes of Jared E. Grace's tract of land situated on the east side of River Brazos at the <sup>estate</sup> Coehatta crossing, beginning at a Pecon near the bank of the river, 2 feet in diam<sup>r</sup>. mark<sup>d</sup>  $\frac{IEG}{SWC}$ , from which a wild China tree 12 in<sup>s</sup> in diameter bears S 55° E 47 links, <sup>(9)</sup> marked as above, and a Pecon 2 1/2 feet in diam<sup>r</sup>, bears N 61° E 1 chain 44 links, <sup>(19)</sup> marked as above, from thence N 80° E 5000 W<sup>s</sup>. to corner a stake in prairie, from which a black jack oak 12 in<sup>s</sup> diam<sup>r</sup>. bears N 46° W 80 W<sup>s</sup>. 36 links, mark<sup>d</sup>  $\frac{IEG}{SWC}$ . thence N 10° W 10,000 W<sup>s</sup>. to corner a stake from which a Post oak 10 in<sup>s</sup> diam<sup>r</sup>. bears N 54 1/2° E 47 links mark<sup>d</sup>  $\frac{IEG}{NEC}$ , and another P. oak 12 in<sup>s</sup> diam<sup>r</sup>. bears S 43 1/2° E 1 chain 3 1/2 links, mark<sup>d</sup> as before, thence west to ~~the river~~ 4700 W<sup>s</sup>. to corner on the river bank, a Pecon 16 in<sup>s</sup> diam<sup>r</sup>. mark<sup>d</sup>  $\frac{IEG}{NWC}$ , from which a P. oak 7 in<sup>s</sup> diam<sup>r</sup>. bears N 37° E 22 links, thence down the river with the meanders thereof to the beginning, containing

... the lower end of the tract ...  
 ... from the corner stake ...  
 ... it is ...  
 ... the ...  
 ... through the ...  
 ... the remainder of the ...  
 ...

Grace's lower corner on the river, is 2350 W<sup>s</sup>. below the upper corner of Col. Austin in the meanders of the river.



Field notes of John Irons League of Wallace 1802

land, beginning at a dead elm from which a  
 Sycamore 14 ins. diam. bears N 82 E Marked <sup>II</sup> SWC.  
 and a Cotton wood 30 ins. diam. bears N 80 E 41 links  
 marked as before. from thence due east 4444 B.  
 to corner a Stake in Prairie from which 7 small  
 P. oaks in a clump bear S 63 W 7 chains 31 links <sup>(14)</sup>  
 thence due north 4400 B. where it intersects Groves  
 south line 400 B. from the SE corner, from thence  
 S 60 W 4600 B. to the river at Groves SW corner.  
~~containing 25,000,000 square Bars.~~

thence down the river with the meanders  
 thereof to the beginning, containing 25,000,000  
 Square Bars.

For the meandering of the above League,  
 see Page B. 110.

Notes of the succession of the river from the point  
 where the upper line of the sea-trail intersects the  
 river, to the point where the lower line intersects the  
 same, commencing at the corner State Lane the  
 S 77° 0' 150 p. 160. S 67° 0' 140. N 45° 0' 200.  
 N 44° 0' 200. N 60° 0' 170. S 69° 0' 120. N 44° 0' 120.  
 N 40° 0' 120. S 22° 0' 100 V. S 37° 0' 90 V. N 34° 0' 200 V.  
 N 22° 0' 200 V. S 25° 0' 200 V. S 31° 0' 130 V. S 26° 0' 80 V.  
 S 26° 0' 100 V. South 100 V. S 11° 0' 200 V. S 47° 0' 140 V.  
 S 21° 0' 150 V. S 40° 0' 60 V. S 46° 0' 100 V. S 33° 0' 100 V.  
 S 20° 0' 160 V. S 36° 0' 130 V. S 44° 0' 70 V. S 39° 0' 240 V.

Notes of the succession of the river from the point  
 where the lower line intersects the river, to the corner of  
 the river, commencing at the corner of the river  
 N 45° 0' 120 V. S 36° 0' 110 V. S 46° 0' 200 V.  
 S 45° 0' 120 V. S 46° 0' 110 V. S 46° 0' 110 V. S 46° 0' 110 V.  
 S 71° 0' 110. S 71° 0' 160. S 71° 0' 200. S 71° 0' 110.  
 S 41° 0' 110. S 71° 0' 190. S 77° 0' 110. S 71° 0' 110.  
 S 25° 0' 210. S 13° 0' 210. S 6° 0' 100. S 41° 0' 200.  
 S 40° 0' 200. S 47° 0' 110. S 41° 0' 110. S 40° 0' 70.  
 S 25° 0' 150. S 36° 0' 60. to the corner of the river  
 on the river below town.

Field Notes of the Labors above town as surveyed by William Selkirk, beginning at the upper corner of the town tract on the River, a stake from which a China tree 6 in. diam., bears  $N 31^{\circ} W$  36 links marked and an ash 12 in. diam., bears  $S 32^{\circ} W$  32 links as before, thence  $S W$  437  $rs.$  to corner in the edge of Prairie a stake from which a white oak 7 in. diam., bears  $N 23^{\circ} W$  56 links, marked  $\frac{NT}{WR}$ , and a Pecan 14 in. diam., bears  $S 88^{\circ} E$  30 links, marked as before, thence  $NW$  1000  $rs.$  to corner a stake in Prairie, thence  $N E$  1284  $rs.$  to corner a stake on River bank from which an elm 6 in. diam., bears  $S 5^{\circ} W$  29 links, marked as before, ~~thence~~ and a Cotton wood 26 in. diam., bears ~~xxx~~  $N 55^{\circ} W$  23 links, marked as before, thence down the River with the meanders thereof to the beginning, containing 1,000,000 Square Bars.

The remainder of the above Labors, beginning 50  $rs.$  from the lower corner on the line, thence  $N 45^{\circ} W$  500  $rs.$  off to the right to line 100  $rs.$  thence  $S 45^{\circ} W$  to the line 500  $rs.$  from the river.

The lower corner of the Labors just mentioned, containing 1000  $rs.$  of the line, bottom for 10 rods.



(16.)

2<sup>nd</sup> Labor above the town tract, beginning at the upper corner of first Labor, thence S<sup>W</sup> 99<sup>o</sup> 13. to corner a stake in Prairie, thence N<sup>W</sup> 78<sup>o</sup> 13. to corner a stake in Prairie, thence N<sup>25</sup><sup>o</sup> E 1560<sup>o</sup> to corner a stake from which a hackberry 10 in. diam. bears N<sup>48</sup><sup>o</sup> E 36 links mark<sup>d</sup>.  $\frac{NT}{WR}$  and another hackberry 8 in. diam. bears S<sup>54</sup><sup>o</sup> E 14 links, thence S<sup>65</sup><sup>o</sup> E 665<sup>o</sup> to corner stake on the bank of river from which a Hackberry 10 in. diam. bears N<sup>70</sup><sup>o</sup> W 26 links, mark<sup>d</sup>.  $\frac{NT}{WR}$ , and another Hackberry 8 in. diam. bears N<sup>6</sup><sup>o</sup> E 28 links mark<sup>d</sup> as before, thence down the river with the meanders thereof to the beginning, containing 1,792,000 Square bars.

For meanders of the above Labor, see Page 15. —

2<sup>nd</sup> Labor, or Prairie line, of the Labor 99<sup>o</sup> 13.  
from corner to Prairie,

3<sup>rd</sup> Labor above town tract, beginning at the upper corner of Labor 2<sup>nd</sup> on the river, from thence N 65° W, with the north line of 2<sup>d</sup> Labor 665 Rs. to N.W. corner of 2<sup>d</sup> Labor, thence N 25° E with Saml. Dixon's line 1000 Rs. to corner a stake from which a Hackberry 9 ins. diam<sup>r</sup>. bears N 39° E 34 links, marked  $\frac{NT}{WR}$ , and a China tree 6 ins. diam<sup>r</sup>. bears S 50° E 28 links mark<sup>d</sup>. as before, thence S 65° E 995 Rs. to river, corner a stake from which a China tree 12 ins. diam<sup>r</sup>. bears N 13° E 27 links, mark<sup>d</sup>. as before, and an ash 6 ins. diam<sup>r</sup>. bears N 85° W 15 links, mark<sup>d</sup>. as above, thence down the river with the meanders thence to the beginning, containing <sup>1,050.000</sup> ~~1,200.000~~ square feet.

For Meanders of the above Labor see Page 15.

On each line of the Labor 445 from the upper corner of the tract will cross at right angles a creek or rill.

On each line of the Labor 445 from the upper corner of the tract will cross at right angles a creek or rill.

4<sup>th</sup> Labor above Town tract, beginning at the last corner but one, mentioned in the 3<sup>rd</sup> Labor, thence  $N25^{\circ}E$  along Dixon's line 1000 B. to corner a stake from which an ash 10 in. diam<sup>r</sup>. bears  $N88^{\circ}E$  8 links, mark<sup>d</sup>.  $\frac{AT}{WR}$ , and another ash 9 in. diam<sup>r</sup>. bears  $S14^{\circ}E$  42 links, marked as before, thence  $S65^{\circ}E$  1300 B. to corner a stake from which a Hackberry 16 in. diam<sup>r</sup>. bears  $S15^{\circ}E$  10 links, mark<sup>d</sup>. as above, and another Hackberry 12 in. diam<sup>r</sup>. bears  $N58^{\circ}E$  24 links, mark<sup>d</sup>. as above, thence  $S25^{\circ}W$  100 B. to corner stake on the 2<sup>nd</sup> bank of river, from which an elm 14 in. diam<sup>r</sup>. bears  $N20^{\circ}E$  17 links mark<sup>d</sup>. as above, and another elm 6 in. diam<sup>r</sup>. bears  $S64^{\circ}W$  24 links, and mark<sup>d</sup>. as above, thence down the River with the Meanders thence to the beginning containing - to upper corner of Labor 3<sup>rd</sup>, thence to the place of beginning. Containing. - 1,180,000. Square bars

For Meanders of the above Labor see Page 15. -

Page 50 Notebook.





(20.)

†  
The river July 19/29 Vol 1 p 178  
Section Co. 22

6<sup>th</sup> Labor above town tract, beginning at the  
 NW corner of 5<sup>th</sup> Labor on Dixon's line, thence  
 N 25° E 1700 B. along Dixon's line, to corner a stake  
 from which a Hackberry 7 in. diam. bears  
 N 71° E 27 links, mark.  $\frac{N}{W} \frac{T}{R}$ , and a box elder 6 in.  
 diam. bears S 50° E 44 links, marked as before.  
 thence S 65° E 550 B. to corner a stake on the 2<sup>nd</sup> bank  
 of the river from which a white oak 8 in. diam.  
 bears S 7° W 6 links, mark. as above, and a tooth-  
 ache tree 5 in. diam. bears N 12° W 36 links,  
 marked as before, thence down the river with  
 the meanders thence up to upper corner of 5<sup>th</sup>  
 League Labor on the river, from thence N 65° W  
 to the place of beginning, containing 1,012,000  
 square bars. In the total, the closing line (20.65 W) is 1615 B.

ASD

This is also the note of Wm. P. O'ator  
 See Spanish Vol 1 p-180.

For meanders of the above Labor see Page 5.

Pamela Dickcote  
The record of 24. vol 1. p 202  
Admission Co  
2889

7<sup>th</sup> Labor (A) &  
Labor above town tract, beginning at  
the NW corner of 6<sup>th</sup> Labor on Dixon's line, thence  
along Dixon's line 1700 B, to lower corner on the  
River of Labor No. 1 run off by Dixon, thence  
down the river with the meanders thereof to the  
upper corner on the river of the 6<sup>th</sup> Labor, thence  
N 65° W to the place of beginning, containing 1,000,000  
square bars.

For meanders of the above Labor see Page 5.



line of the 4<sup>th</sup> to place of beginning, containing 1,000,000 square  
bars. In the title, this line is 1760 vs. ~~1760~~

5<sup>th</sup> Labor, beginning at the NW corner of 5<sup>th</sup> Labor, then  
N56°W 500 rs. to corner a stake from which a hackberry 10 in.  
diam., bears S70°E 21 links, Mark<sup>d</sup> <sup>EL</sup>/<sub>N<sup>o</sup>R</sub>, and an Elm 34 in. diam.  
bears N86°W 4 links, Mark<sup>d</sup> <sup>EL</sup>/<sub>N<sup>o</sup>R</sub>, then S34°W 2400 rs. to corner  
the first bank of river, a stake from which a cotton wood  
12 in. diam. bears S46°E 11 links, Mark<sup>d</sup> <sup>EL</sup>/<sub>N<sup>o</sup>R</sub>, and another  
cotton wood 13 in. diam. bears N50°W 25 links, Mark<sup>d</sup> <sup>EL</sup>/<sub>N<sup>o</sup>R</sub>,  
thence down the river with the meanders to to upper corner  
of 5<sup>th</sup> Labor on the river, thence <sup>N34°E</sup> with the west line of  
6<sup>th</sup> Labor to the place of beginning, containing <sup>1,057,500</sup>/<sub>1,057,000</sub>  
square bars. - In the title, this line is 1830 vs. ~~1830~~

6<sup>th</sup> Labor, beginning at the NW corner of Labor  
from thence N56°W 500 rs. to corner a stake from  
which an ash 12 in. diam., bears S25°E 34 links, Mark<sup>d</sup>,  
and another ash 13 in. diam., bears N80°W 20 links,  
Mark<sup>d</sup> <sup>EL</sup>/<sub>N<sup>o</sup>R</sub>, then S34°W 2370 rs. to corner on first bank of  
river, a stake from which a cotton wood 20 in. diam.  
bears S17°W 15 links, Mark<sup>d</sup> <sup>EL</sup>/<sub>N<sup>o</sup>R</sub>, and another cotton wood  
18 in. diam., bears N58°W 27 links, Mark<sup>d</sup> <sup>EL</sup>/<sub>N<sup>o</sup>R</sub>, then  
down the river to upper corner of Labor 6<sup>th</sup> on the  
river, thence <sup>N34°E</sup> <sup>140000</sup> to place of beginning, containing  
1,92,500 square bars. Lab. h = 8. is also granted to Wm. Stafford Aug 16/24  
vol 2. p. 428.

8<sup>th</sup> Labor, beginning at the NW corner of 7<sup>th</sup> Labor  
from thence N56°W 500 rs. to corner a stake from which  
an Elm 4 in. diam., bears S33°E 16, Mark<sup>d</sup> <sup>EL</sup>/<sub>N<sup>o</sup>R</sub>, and another  
title issued Aug 24/24 vol 2, p 530 - Waller Co assign

James Martin  
John Miller  
Stafford vs  
1022  
1023  
1024  
1025  
1026  
1027  
1028  
1029  
1030  
1031  
1032  
1033  
1034  
1035  
1036  
1037  
1038  
1039  
1040  
1041  
1042  
1043  
1044  
1045  
1046  
1047  
1048  
1049  
1050  
1051  
1052  
1053  
1054  
1055  
1056  
1057  
1058  
1059  
1060  
1061  
1062  
1063  
1064  
1065  
1066  
1067  
1068  
1069  
1070  
1071  
1072  
1073  
1074  
1075  
1076  
1077  
1078  
1079  
1080  
1081  
1082  
1083  
1084  
1085  
1086  
1087  
1088  
1089  
1090  
1091  
1092  
1093  
1094  
1095  
1096  
1097  
1098  
1099  
1100

pt 137

(Plot)

Line 7 in diam. bears  $S48^{\circ}W$  18 links,  $M^{\circ}$  as before,  
thence  $S34^{\circ}W$  253 to the river, thence down the river  
with the meanders thereof to the upper corner of 7<sup>th</sup>  
Labor on the river, thence  $N34^{\circ}E$  to place of beginning,  
Containing 1,224,850 Square Bars.

Meander of the river from the place north of the  
place of the 7<sup>th</sup> Labor to the river, and thence  
down the river with the meanders thereof to the  
upper corner of 7<sup>th</sup> Labor, and thence  $N34^{\circ}E$  to  
place of beginning, containing 1,224,850 Square Bars.  
The river is a mile or more wide at this place,  
and is along the bank of the river, thence  $N56^{\circ}E$   
285 to the river, and thence down the river  
with the meanders thereof to the place of the  
7<sup>th</sup> Labor.

9<sup>th</sup> Labor.

Vertical text on the right margin, possibly a page number or reference, including '137'.

Aprilles McIsland (25)

1<sup>st</sup> Labor above the road, beginning at a post opposite to town, thence  $N 34^{\circ} E$  3058 Bars, to corner a stake from which a Hackberry 10 in. diam. bears  $N 27^{\circ} E$  42 links, Mark <sup>EL</sup> <sub>NSR</sub>, and another Hackberry 12 in. diam. bears  $S 56^{\circ} E$  1 Chain, nine links, Mark as before. Thence  $N 56^{\circ} W$  500 B., to corner a stake from which a hackberry 10 in. diam. bears  $S 50^{\circ} W$  6 links, Mark <sup>EL</sup> <sub>NSR</sub>, and another Hackberry 12 in. diam. bears  $S 23^{\circ} E$  38 links, Mark <sup>EL</sup> <sub>NSR</sub>. Thence  $S 34^{\circ} W$  2868 B. to corner on river a post from which an ash 7 in. diam. bears  $S 77^{\circ} E$  47 links, Mark <sup>EL</sup> <sub>NSR</sub>, and another ash 10 in. diam. bears  $S 1^{\circ} E$  50 links, Mark <sup>EL</sup> <sub>NSR</sub>. Thence down the river with the meanders thereof to the beginning, containing 1,510,000 square Bars.

2<sup>nd</sup> Labor above the road, beginning at the SW corner of No. 1, thence along the west line of the same to the NW corner, thence  $N 56^{\circ} W$  500 B. to corner a stake from which a hackberry 18 in. diam. bears  $N 56^{\circ} W$  15 links, Mark <sup>EL</sup> <sub>NSR</sub>, and another hack 7 in. diam. bears  $S 1^{\circ} W$  34 links, Mark <sup>EL</sup> <sub>NSR</sub>. Thence  $S 34^{\circ} W$  2712 B. to river thence down the river to the beginning, containing 1,396,500 square Bars.

3<sup>rd</sup> Labor above the road, beginning at the SW corner of No. 2, thence along the west line

Tale arrived July 10/24. Vol 1 p 76. Survey of Waller

L. C. A. Survey of Waller  
1868  
A. 206 1<sup>st</sup> line 2868 B.

11<sup>th</sup> Patent  
M. Patton

copy (20)

of the same to NW corner. thence N56°W 500 to  
to corner a stake, from which a hackberry 18 in. diam<sup>r</sup>  
bears N40°W 3 links, marked <sup>of</sup><sub>N7R</sub>, and another hack<sup>r</sup>  
6 in. diam<sup>r</sup> bears S20°E 26 link, Mar<sup>r</sup> <sup>of</sup><sub>N7R</sub>, thence  
S34°W 2030 to river, thence down the river  
to the beginning, containing 1,100,000 Square  
Bars. In the total the 1st line (N. 34 E) is 27 1/2 in. and

9<sup>th</sup> Labor above the road, beginning at a post  
on the north side of the first road running para-  
allel with the river, from which a red oak  
24 in. diam<sup>r</sup> bears N21°W 23 links, Mar<sup>r</sup> <sup>of</sup><sub>N9R</sub>  
and a hackberry 9 in. diam<sup>r</sup> bears N21°E 45  
links, Mar<sup>r</sup> as before, thence S4°E 1000 to corner  
a stake from which a box elder 10 in. diam<sup>r</sup>  
bears S20°E 20 links, Mar<sup>r</sup> as before, and a  
36 in. 5 in. diam<sup>r</sup> bears N68°E 33 link Mar<sup>r</sup> <sup>of</sup><sub>N9R</sub>  
thence S56°E 1000 to corner, a stake from which  
a china tree 4 in. diam<sup>r</sup> bears N76°W 15 links, Mar<sup>r</sup>  
<sup>of</sup><sub>N9R</sub> and an elm 26 in. diam<sup>r</sup> bears S15°W 36 links Mar<sup>r</sup>  
<sup>of</sup><sub>N10R</sub> and a hack<sup>r</sup> 6 in. diam<sup>r</sup> bears S63°E 21 link Mar<sup>r</sup>  
<sup>of</sup><sub>N11R</sub> and an elm 10 in. diam<sup>r</sup> bears N5°W 39 link Mar<sup>r</sup> <sup>of</sup><sub>N12R</sub>  
thence S34°W 1000 to corner a stake on the  
afore said road, from which an elm 8 in. diam<sup>r</sup>  
bears N67°E 4 link, Mar<sup>r</sup> <sup>of</sup><sub>N10R</sub>, and a box elder 12 in.  
diam<sup>r</sup> bears N44°W 36 link, Mar<sup>r</sup> <sup>of</sup><sub>N11R</sub> thence  
along the road 1000 to the beginning containing  
1,000,000 Square Bars. OK - Title issued July 7/24  
Walton County, ARK Vol 9 P 36





20327

(28)

thence S 34° W 1000 ft. to N W corner of A<sup>o</sup>: 9, thence  
S 56° E 1000 ft. to place of beginning containing  
1,000,000 square ft.

*[Faint, illegible handwriting covering the remainder of the page, likely bleed-through from the reverse side.]*

Field Notes of the Labors below the road on the east side of the river. Beginning at a post opposite town on the road, thence  $N34^{\circ}E$  along the road 3058  $\bar{N}$ . to corner a stake on the road running parallel to the river, from which a hackberry 10 in. diam<sup>r</sup> bears  $N27^{\circ}E$  42 links mark<sup>r</sup>  $\frac{EL}{NR}$  and another do. 12 in. diam<sup>r</sup> bears  $S56^{\circ}E$  1 chain 9 links. mark<sup>r</sup>  $\frac{EL}{SR}$ . thence  $S56^{\circ}E$  500  $\bar{N}$  to corner a stake from which a hack<sup>r</sup> 12 in. diam<sup>r</sup> bears  $N67^{\circ}W$  34 links. mark<sup>r</sup>  $\frac{EL}{SR}$  and another hack<sup>r</sup> 12 in. diam<sup>r</sup> bears  $S55^{\circ}E$  42 links more  $\frac{EL}{SR}$ . thence  $S34^{\circ}W$  2843  $\bar{N}$ . to river, thence up the river to place of beginning, containing 1.507.500 Square Bars.

2<sup>nd</sup> Labor below the road. beginning at the SE corner of No. 1. on the river. thence  $N34^{\circ}E$  to NW corner of same. thence  $S56^{\circ}E$  500.  $\bar{N}$ . to corner a stake. from which a hack<sup>r</sup> 10 in. diam<sup>r</sup> bears  $E20^{\circ}E$  5 links. marked  $\frac{EL}{SR}$  and another hack<sup>r</sup> 7 in. diam<sup>r</sup> bears  $S7^{\circ}E$  24 links. mark<sup>r</sup>  $\frac{EL}{SR}$ . thence  $S34^{\circ}W$  2665  $\bar{N}$ . to corner on the river. thence up the river to the beginning. containing 1.368.500 Square Bars.

3<sup>rd</sup> Labor below the road. beginning at the SE corner of Labor No. 2. thence  $N34^{\circ}E$  2665  $\bar{N}$ .

The Sur Land  
 Vol 2. p. 406  
 Title comes Aug 24  
 Francis Big hand  
 5<sup>th</sup> July 1884  
 Waller Co.  
 William Parker  
 Title comes July 24 vol 1. p. 56  
 Waller Co.



Rebecca Sumner's  
Title issued July 24/34. Vol. 1. P. 144  
Wells

6<sup>th</sup> Labor below the road. Beginning at the  
SE corner of Labor N<sup>o</sup> 5, thence N34<sup>o</sup>E 2005 B. to  
NE corner of the same, thence S56<sup>o</sup>E 500 B. to  
corner a stake from which an ash 9 in. diam.  
bears S58<sup>o</sup>W 69 links, Marked <sup>6E</sup>S/R, and a china  
tree 4 in. diam. bears SW 76 links, Marked <sup>6E</sup>S/R.  
thence S34<sup>o</sup>W 2800 B. to corner on the river, thence  
up the river to the beginning, containing  
1,201,250 Square Bars. on page 23

Samuel H. H. H. H. H.  
Title issued Jan 1/30 Vol. 6. P. 209  
Wells

7<sup>th</sup> Labor below the road, beginning at the  
SE corner of Labor N<sup>o</sup> 6, thence N34<sup>o</sup>E 2800 B. to  
NE corner of the same, thence S56<sup>o</sup>E 500 B. to  
corner a stake from which a hackberry 8 in.  
diam. bears S77<sup>o</sup>W 40 links, Marked <sup>6E</sup>S/R  
and another hackby. 13 in. diam. bears South  
44 links, Marked <sup>6E</sup>S/R, thence S34<sup>o</sup>W 2600 B. to  
corner on river bank, a stake from which a  
Prickly ash 6 in. diam. bears N14<sup>o</sup>E 18 links,  
marked <sup>EL</sup>S/R, thence up the river to the beginning,  
containing 1,350,000 Square Bars.

Title issued Aug 2/34  
Vol. 2. P. 535-6  
Mr. Mayor Wells

8<sup>th</sup> Labor below the road, beginning at  
the SE corner of Labor N<sup>o</sup> 7, thence N34<sup>o</sup>E  
2600 B. to NE corner of the same, thence S56<sup>o</sup>E  
500 B. to corner, a stake from which a red oak  
14 in. diam. bears S46<sup>o</sup>E 10 links, Marked <sup>6E</sup>S/R

and another red oak 7 in. diam<sup>r</sup> bears S13<sup>o</sup>E  
38 links, mark<sup>d</sup> as before, then S34<sup>o</sup>W  
2400 Bars, to River, then up the river to  
place of beginning, containing 1,250,000  
Square Bars.

9<sup>th</sup> Labor below the road, beginning at a stake  
on the road parallel and nearest the river, from  
which a Pecan tree 12 in. diam<sup>r</sup>, N44<sup>o</sup>W, 31 links  
mark<sup>d</sup> E.L., and an ash 7 in. diam<sup>r</sup>, bears N26<sup>o</sup>E  
35 links <sup>3<sup>o</sup>R</sup>. Marked as before, then N34<sup>o</sup>E 1000 Bars  
to corner a stake from a hackberry 10 in. diam<sup>r</sup>  
bears S88<sup>o</sup>W 45 links mark<sup>d</sup> as before, and a  
China tree 10 in. diam<sup>r</sup>, bears N32<sup>o</sup>W 41 links  
mark<sup>d</sup> <sup>E.L.</sup> <sub>16</sub>, then N56<sup>o</sup>W 1000 Bars to corner  
stake from which another ~~elm~~ elm 14 in.  
diam<sup>r</sup> bears S30<sup>o</sup>E 11 links mark<sup>d</sup> <sup>E.L.</sup> <sub>16</sub>, and an  
ash 12 in. diam<sup>r</sup>, bears S83<sup>o</sup>E 16 links <sup>3<sup>o</sup>R</sup> mark<sup>d</sup> <sup>E.L.</sup> <sub>16</sub>  
and an elm 10 in. diam<sup>r</sup>, bears N58<sup>o</sup>W 43 links  
mark<sup>d</sup> E.L., and an elm 11 in. diam<sup>r</sup>, bears  
N38<sup>o</sup>W <sup>5<sup>o</sup>R</sup> 26 links mark<sup>d</sup> <sup>E.L.</sup> <sub>15</sub>, then S34<sup>o</sup>W  
1000 Bars to corner a stake <sup>5<sup>o</sup>R</sup> on the road from  
which a hackberry 8 in. diam<sup>r</sup> bears S81<sup>o</sup>E  
15 links mark<sup>d</sup> <sup>E.L.</sup>, and another hackberry  
10 in. diam<sup>r</sup>, bears <sup>5<sup>o</sup>R</sup> N30<sup>o</sup>W 45 links mark<sup>d</sup>  
<sup>E.L.</sup>, then S56<sup>o</sup>E 1000 Bars to place of beginning  
<sup>5<sup>o</sup>R</sup> containing 1,000,000 Square Bars.

Solomon Williams  
The land by  
Vol 2 of  
the  
of  
the  
of

The bearing trees of these Labors are all marked with the same letters below the road, and I shall only put down the numbers hereafter.

11<sup>th</sup> Labor below the road, beginning at the SW corner of the 9<sup>th</sup> from thence N 34° E 1000 Rods to NW corner of the 9<sup>th</sup>, thence N 56° W 1000 Rods to corner a Stake from which an ash 8 in. diam<sup>r</sup> bears S 9° W 22 links Number 10, and an ash 7 in. diam<sup>r</sup> bearing east 15 links Number 15, and an ash 9 in. diam<sup>r</sup> bears N 78° W 24 ~~5~~ links Number 11, and an ash 14 in. diam<sup>r</sup> bears N 11° W 26 links Number 14, thence S 34° W 1000 Rods to corner on the road a Stake from which a hackberry 6 in. diam<sup>r</sup> bears N 82° E. 33 links Number 10, and a hackberry 10 in. diam<sup>r</sup> bears N 12° W 13 links Number 11, thence S 56° E along the road 1000 Rods to place of beginning, containing 1,000,000 Square Rods

12<sup>th</sup> Labor, Beginning at the SW corner of the 10<sup>th</sup> Labor from thence N 34° E 1000 Rods to NW corner of the same, thence N 56° W 1000 Rods to corner a Stake from which a red oak 26 in. diam<sup>r</sup> bears N 51° W 63 links Number 13, and a china tree 7 in. diam<sup>r</sup> bears S 88° W 50 links Number 12, and a red oak 18 in. diam<sup>r</sup> bears S 24° E 52 links Number 11, and a hackberry 7 in. diam<sup>r</sup> bears N 6° 41 links Number 14, thence S 34° W 1000 Rods to corner a Stake on the road from which a

John Williams - Brother of Solomon  
The record of 1844, Vol 2, p. 532  
Walker Co. 1849

S. M. Williams  
The record of 1844, Vol 2, p. 386  
Walker Co. 1849

hackberry 10 in. diam<sup>r</sup>. bears N16°W. 6 links  
numb<sup>r</sup>. 12, and another hackberry 11 in. diam<sup>r</sup>.  
bears S41°E 21 links numb<sup>r</sup>. 11. thence ~~S56°E~~  
S56°E 1000 W. along the road to the place of  
beginning. containing 1,000,000 square W.

12<sup>th</sup> Labor <sup>Jan<sup>y</sup> 4<sup>th</sup> Long</sup> below the road, beginning  
at the SW corner of 11 Labor, thence  
N34°E 1000 W. to NW corner of the same,  
thence N56°W 1000 W. to corner a stake  
from which a hackberry 5 in. diam<sup>r</sup>.  
bears S23°E. 27 links. numb<sup>r</sup>. 12, and a hack<sup>r</sup>.  
6 in. diam<sup>r</sup>. bears N17°W 23 links. numb<sup>r</sup>. 11.  
thence S34°W 1000 W. to corner a stake from a  
which a hackberry 9 in. diam<sup>r</sup>. bears N56°E  
47 links numb<sup>r</sup>. 12, and another hackberry 7 in.  
diam<sup>r</sup>. bears N57°W 45 links numbered 10.  
thence S56°E 1000 W. to place of beginning.  
containing 1,000,000 square W.

Title as used Apr 30/27  
Vol 2. p 540  
Waller Co

See Ingram. Title issued Aug 24/24, vol 2. p 535  
Waller Co

13<sup>th</sup> Labor below the road, beginning at  
the NW corner of the 12<sup>th</sup> on the road, from  
thence N34°E 1000 W. to corner a stake from  
which a red oak 18 in. diam<sup>r</sup>. bears S44°W  
36 links numb<sup>r</sup>. 11, and an ash 6 in. diam<sup>r</sup>.  
bears S39°E 37 links numb<sup>r</sup>. 12. thence S56°E  
1000 W. to corner on the 2<sup>nd</sup> road from the

Ingram

river, a stake from which a red oak 7 in diam<sup>r</sup> bears S76°W 52 links Numb<sup>r</sup>. 13. and an ash 5 in diam<sup>r</sup> bears S17°E 20 links Numb<sup>r</sup>. 14. thence S34°W 1000 to NE<sup>r</sup> <sup>corner of</sup> 12<sup>th</sup> and NW corner 11<sup>th</sup>, thence N56°W 1000 to place of beginning, containing 1,000,000 square rs.

14<sup>th</sup> Labor below the road beginning at the SE corner of the 13<sup>th</sup> Labor thence at N34°E 1000 rs. to <sup>NE</sup> corner of the same, from thence S56°E, 1000 rs. to corner a stake from which an elm 5 in. diam<sup>r</sup> bears S63°W 12 links Numb<sup>r</sup>. 14. and an ash 6 in. diam<sup>r</sup> bears S34°E 30 links Numb<sup>r</sup>. 15. thence S34°W 1000 rs. to NW corner of 10. and NE corner of 11. thence N56°W 1000 rs. to place of beginning, containing 1,000,000 square rs.

15<sup>th</sup> Labor below the road, beginning at the SE corner of 14. thence N34°E 1000 rs. to NE corner of same, thence S56°E 1000 rs. to corner a stake from which a hackberry 8 in. diam<sup>r</sup> bears S81°W 38 links Numb<sup>r</sup>. 15. and a hackberry 5 in. diam<sup>r</sup> bears S17°E 25 links Numb<sup>r</sup>. 16. thence S34°W 1000 rs. to corner at same with NW of 9. and NE corner of 10. thence N56°W 1000 rs. to place of beginning, containing 1,000,000 square rs.

John Hall  
1838  
1839  
1840  
1841  
1842  
1843  
1844  
1845  
1846  
1847  
1848  
1849  
1850  
1851  
1852  
1853  
1854  
1855  
1856  
1857  
1858  
1859  
1860  
1861  
1862  
1863  
1864  
1865  
1866  
1867  
1868  
1869  
1870  
1871  
1872  
1873  
1874  
1875  
1876  
1877  
1878  
1879  
1880  
1881  
1882  
1883  
1884  
1885  
1886  
1887  
1888  
1889  
1890  
1891  
1892  
1893  
1894  
1895  
1896  
1897  
1898  
1899  
1900

1838 in west July 10/24  
1839  
1840  
1841  
1842  
1843  
1844  
1845  
1846  
1847  
1848  
1849  
1850  
1851  
1852  
1853  
1854  
1855  
1856  
1857  
1858  
1859  
1860  
1861  
1862  
1863  
1864  
1865  
1866  
1867  
1868  
1869  
1870  
1871  
1872  
1873  
1874  
1875  
1876  
1877  
1878  
1879  
1880  
1881  
1882  
1883  
1884  
1885  
1886  
1887  
1888  
1889  
1890  
1891  
1892  
1893  
1894  
1895  
1896  
1897  
1898  
1899  
1900



Title issued July 10/24. Vol. 1. p. 70

16<sup>th</sup> Labor <sup>137</sup> (36) below the road, beginning at <sup>Waller Co.</sup> the SE corner of Number 15, thence N 34° E <sup>and</sup> 1000 ft. to NE corner of same, thence S 56° E 150 ft. to creek, thence E 50 ft. to corner a stake from which a hackberry 15 in. diam. bears S 62° W 13 Links, Num. 16, and another hackberry 9 in. diam. bears S 35° W 50 links, Num. 16, thence S 34° W ~~1000~~<sup>570</sup> ft. to creek, 30 ft. wide, thence E 30 ft. to ~~corner~~ NE corner of 9<sup>th</sup>, thence N 56° W 1000 ft. to place of beginning, containing 1000.000 square ft.

Robert Elder

Title issued Aug 24/24. Vol. 2. p. 531 Waller Co

17<sup>th</sup> Labor <sup>138</sup> the road, beginning at the SE corner of 17<sup>th</sup> a stake from which a Pecan 16 in. diam. bears S 84° W 5 links, Num. 17, and a box elder 16 in. diam. bears N 82° E <sup>link</sup> 16, Num. 17, thence N 56° W 890 ft. to creek, thence 110 ft. to corner a stake from which an ash 6 in. diam. bears ~~N 75° E~~ N 11° W 12 links, Num. 18, and another ash 9 in. diam. bears S 57° E 17 links, Num. 17, thence ~~S 34° W~~ N 34° E ~~1000~~ 120 ft. to creek, thence E 80 ft. to corner a stake from which in Prairie, thence S 56° E 1000 ft. to corner a stake from which Pecan 20 in. diam. bears N 75° E 14 links, Num. 17, and an ash 8 in. diam. bears S 44° W 9 links, Num. 17, thence S 34° W 1000 ft. to place of

Robert Elder

(37)

beginning, containing 1,000,000 square rods.

18<sup>th</sup> Labor below the road, beginning at the SW corner of the 17 Labor from thence N56° along the road 1000 R. to corner a stake from which a hackberry 6 in. diam<sup>r</sup> bears N41°W 60 links Numb<sup>r</sup>. 19, and an elm 8 in. diam<sup>r</sup> bears S88°E 7 links. Numb<sup>r</sup>. 18, thence N34°E 1500\* R. to corner a stake from which an ash 7 in. diam<sup>r</sup> bears S42°E 10 links Numb<sup>r</sup>. 18, and an ash 5 in. diam<sup>r</sup> bears S28°E 8 links Numb<sup>r</sup>. 19, thence S56°E 1000 R. to corner same with NW corner of N<sup>o</sup>. 17, thence S34°W 1500 to place of beginning, containing 1,500,000 square R.

\* This labor has been altered and is a labor & a half. S.P.V.  
O. K. 1 1/2 hrs. Title issued July 8/24 - Vol. 1 - p. 42

19<sup>th</sup> Labor below the road, beginning at the SW corner of N<sup>o</sup>. 18, thence N56°W 1000 R. along the road to corner a stake from which an elm 10 in. diam<sup>r</sup> bears N34°W 21 links Numb<sup>r</sup>. 19, and another elm 16 in. diam<sup>r</sup> bears N76°E 39 links Numb<sup>r</sup>. 19, thence N34°E ~~1000~~ <sup>1100</sup> R. to corner a stake from which a Pecan 14 in. diam<sup>r</sup> bears N50°W 5 links Numb<sup>r</sup>. 19, and another Pecan 5 in. diam<sup>r</sup> bears N38°W 6 links Numb<sup>r</sup>. 19, thence S56°E ~~1000 to corner~~ 20 R. to creek, thence 980 R. to corner a stake in Prairie, thence

# On the 126 The two lines N. 34 E. are 1200. 0°

Title issued July 18/24 Vol. 1 p. 42

S34°W 1100 No. to place of beginning.  
containing 1,100,000 Square Bars.

19. 1/2

19. 1/2

19. 1/2

Meanders of River Colorado by William  
Sedgwick, from the place where his base  
line touches the river, ~~then~~ S. base line  
from Prairie to River 1710 ft. running SW.

- thence N31°W. 300 .. N4°W. 170 .. N26°E. 140
- N35°E. 170. N12°E 180.. N7°E 240.. N3°E 180
- N22°E 500. N3°E 220.. N16°W 280 .. N57°W. 100
- N68°W 300.. N30°W 240. N7°E 440.. N17°W. 230
- N34°W 140. N77°W 160.. N88°W 280.. N73°W. 50
- W 230. S72°W 260.. S84°W 200. S68°W. 100
- N84°W 260. N67°W 140. N50°W 160.. N7°W 200
- N25°E 130 .. N62°E 330 .. N35°E 270 N24°E 250
- North 180 .. N10°W 160.. N40°W. 220 N68°W. 540
- N40°W 240 .. N24°W 170 .. N20°W 490. N35°W 100
- N62°W 120.. West 100 .. S69°W 200 .. West 170.
- N57°W 190.. N50°W 240 .. N40°W 180 .. N31°W. 290
- NW 200 .. N60°W 340. N68°W 110 .. N52°W 190
- N20°W 310.. N50°W 320.. N24°W 250.. N46. 290
- N17°W 200. N26°E 220 .. N5°E 200.. N30°W. 300
- N20°W 620.. N13°W 200 .. N30°W 700.. N13°W 410
- N7°W 830.. N24°W 220.. N32°W 210 .. N53°W 240
- N80°W + 150. West 250.. N71°W 150.. N44. W 170
- N20°W 150.. N6°W 330.. N46.. 180.. N24°E 210
- N37°E 280.. N58.. 120 .. N29°W. 250.. N8°W. 190
- N25°E 150.. N49°E 430.. N41°E 550.. N58. 380
- N21°W 170.. N59°W 150 .. N85°W 130 .. N60°W 220
- N38 200.. N27°E. 490 .. N3°W 370.. N30°W. 150

(11)

N59W 130.. N80W 230.. N17W 240.. N63E 350  
 S71E 260.. S61E 520.. S87E 300.. N61E 300..  
 N27E 290.. N5E 310.. N13W 440 N6E 150  
 North 230.. N15W 150.. N21W 445 to SE  
 corner of Wm Kinchelais League, thence  
 N20E 9850 W. to Peack creek, thence S10E  
 1000 W. thence N80E 200 W. to creek, thence  
 S35E 180 W. thence N55E 20 W. to creek, thence  
 S68E 440 W. thence S56E 240.. 243E 110  
 S23E 160.. S43E 130.. S55E 170.. S71E 330  
 S11E 110.. S5W 250.. S39E 120.. S28E 180  
 East 60.. N24E 80.. N75E 40.. S79E 100E  
 N62E 50.. S65E 50.. S49E 230.. S84E 280  
 N81E 140.. N59E 210.. N75E 160.. N57E 140  
 N78E 120.. N54E 110.. N13W 110.. N8E 110  
 N82E 130.. S72E 90.. S53E 90.. N72E 230  
 N21E 260.. S83E 50.. S72E 170.. S51E 170  
 S37E 210.. S5E 180.. S10W 80.. S20E 100  
 S70E 80.. S22E 120.. S27E 80.. S22E 150  
 S10W 60.. S42E 600.. off set to creek 140  
 thence 60 W. to creek.. thence S85E 230  
 S50E 140 and met S. Ingram Mean  
 dering up the creek

Francis Diggam  
July 10/34 - Gra 1 p. 34  
Boston Co

(11)  
Field Notes of the League lying below Mill  
Pine below on the Colorado. Surveyed by William  
Seltirk, in Feb. 1824.

1<sup>st</sup> League beginning at a stake on the river  
from which a live oak 9 in. diam<sup>c</sup>. bears N23°  
33 links, Mark<sup>d</sup>.  $\frac{E.R.}{1.S.}$ , and a Pecan 10 in. diam<sup>c</sup>. bears S6°W  
11 links, Mark<sup>d</sup>.  $\frac{E.R.}{2.S.}$ , thence N62° 7,330 B. to corner a stake  
from which an ash 8 in. diam<sup>c</sup>. bears S50°W 50 links  
Mark<sup>d</sup>.  $\frac{E.R.}{2.S.}$ , and another ash 10 in. diam<sup>c</sup>. bears N49°  
64 links, Mark<sup>d</sup>.  $\frac{E.R.}{1.S.}$ , thence NW 6180 B. to corner on Pin  
e below lower line, thence S20°W 4,000 B with said  
Pine below line to S. C. lower corner on the river  
thence down the river with the meanders thereof to the  
beginning, containing 25,000,000 Square Bars.

2<sup>nd</sup> League, beginning at a stake from which a  
live oak 7 in. diam<sup>c</sup>. bears N32° 65 links  
Mark<sup>d</sup>.  $\frac{E.R.}{2.S.}$ , and another live oak 9 in. diam<sup>c</sup>. bears  
S49° 37 links, Mark<sup>d</sup>.  $\frac{E.R.}{3.S.}$ , thence N62° 9,500 B.  
to corner a stake from which an ash 9 in. diam<sup>c</sup>.  
bears N37°W 23 links, Mark<sup>d</sup>.  $\frac{E.R.}{2.S.}$ , and another ash  
7 in. diam<sup>c</sup>. bears S6° 11 links, Mark<sup>d</sup>.  $\frac{E.R.}{3.S.}$ , thence  
NW 2,960 B to NE corner of first League, thence  
S6°W 7,330 B to river thence down the river to the  
beginning, containing 25,000,000 Square Bars.

708 and Aug 19/34  
Boston Co

Charles S. Hudson

File issued July 29/24 Vol 1. f 2

Wharton Co  
No 2

2<sup>nd</sup> League, beginning at a stake on the bank  
 the river from which a live oak 5 in. diam.  
 bears N7°W 25 links Mark<sup>o</sup>  $\frac{E.R.}{3.S.}$  and another live  
 oak 6 in. diam. bears S12°W 16 links Mark<sup>o</sup>  $\frac{E.R.}{4.S.}$   
 thence N62°E 11,050 ft. to corner a stake. thence NW  
 2540 ft. to NE corner of 2<sup>nd</sup> League. thence S62°W  
 9,500 ft. to river. thence down the river to the be-  
 ginning, containing 25,000,000 Square Feet.

Leagues 4 & 5. Sylvanus Eastman Vol 1. f 22  
 File issued July 1/24. Wharton Gayette  
 No 2

4<sup>th</sup> League, beginning at a stake on the bank of  
 the river from which an ash 10 in. diam. bears  
 N42°E 26 links Mark<sup>o</sup>  $\frac{E.R.}{4.S.}$  and another ash 12 in.  
 diam. bears N66°E 12 links Mark<sup>o</sup>  $\frac{E.R.}{5.S.}$  thence  
 N62°E 5,070 ft. to corner a stake in Prairie, thence  
 N28°W 4,970 ft. to corner a stake from which a  
 mulberry 10 in. diam. bears S42°E 19 links  
 Mark<sup>o</sup>  $\frac{E.R.}{4.S.}$  thence S62°W 5,700 ft. to river  
 thence down the river to place of beginning  
 containing 25,000,000. Square Feet.

3<sup>rd</sup> League, beginning at a stake on the bank  
 of the river from which an elm 6 in. diam.  
 bears N29°W 28 links Mark<sup>o</sup>  $\frac{E.R.}{5.S.}$  and a live oak  
 14 in. diam. bears S23°W 33 links Mark<sup>o</sup>  $\frac{E.S.}{6.S.}$   
 thence N62°E 4416 ft. to corner a stake in Prairie,  
 thence N28°W 7,500 ft. to corner where it inter-  
 sects the south line of League 4. thence

In the table, there is one from one Survey

Sylvanus Eastman

(11)  
S62°W 3870 Rs. to river, thence down the river to the  
beginning, containing 25,000,000 Square Bars.

6<sup>th</sup> League, beginning <sup>on the bank of the Bernard creek</sup> at a Pleon, 6 in. diam.,  
Mark<sup>d</sup>. on one side L<sup>6</sup> WC, and on the other L<sup>7</sup> WC, thence  
S20°W 12,310 Rs. to corner a stake in Prairie, thence  
N70°W 2,080 Rs. to corner in an Island of timber,  
a stake from which a hackberry 8 in. diam.,  
bears S67°E 50 links, Mark<sup>d</sup>. L<sup>6</sup> WC, and an ash 12 in.  
diam., bears S12°W 13 links, Mark<sup>d</sup>. L<sup>6</sup> WC, thence  
N20°E 12,170 Rs. to creek at SE corner of League 5.  
thence down the Bernard to the beginning,  
containing 25,000,000 Square Bars.

7<sup>th</sup> League, beginning at a Sycamore, <sup>18 in. diam.</sup> on the bank  
of the Bernard creek, Mark<sup>d</sup>. on one side L<sup>7</sup> WC, and  
on the other L<sup>8</sup> WC, thence S20°W 11,400 Rs. to corner  
a stake from which a Spanish oak 7 in. diam.,  
bears N17°W 43 links, Mark<sup>d</sup>. L<sup>7</sup> WC, and another Spanish  
oak 16 in. diam., N46°E 1 chain 28 links, Mark<sup>d</sup>. L<sup>7</sup> WC,  
thence N70°W 2,175 Rs. to corner a stake in Prairie,  
thence N20°E 12,210 Rs. to creek at SE corner of  
League 6<sup>th</sup>, thence down the Creek to the  
beginning, containing 25,000,000 Square Bars.



Field Notes of the Leagues lying on Peach creek and the St Bernard below William Kincheloe's League.

+ No 1. Beginning at a cotton wood on the bank of Peach Creek marked on one side  $\frac{L1}{WC}$  and on the other  $\frac{L2}{WC}$  from thence  $S20^{\circ}W$  6,630 <sup>to corner</sup>  $\frac{13}{13}$  where it intersects the north line of League No 1 on the Colorado. thence  $NW$  4,450  $\frac{13}{13}$  with  $S^{\circ}$  line to corner where it intersects Kincheloe's lower line thence  $N20^{\circ}E$  with  $S^{\circ}$  Kincheloe's 5,850 to Peach Creek. thence down the creek with the meanders thereof to the beginning. containing 25,000,000 Square Bars.

This league was settled to Sims, to Cooper and to DeWitt more  
Bartlett Sims - Title issued Aug 7/24. vol. 2. p. 348. - Wharton Co. Tex 1872

+ 2<sup>nd</sup> League. Beginning at a stake on the bank of the creek from which a Pecan 8 in. diam. bears  $N65^{\circ}E$  11 links Mark  $\frac{L3}{WC}$  and a Sycamore 18 in. diam. bears  $S60^{\circ}W$  26 links Mark  $\frac{L2}{WC}$  thence  $S20^{\circ}W$  8,340 <sup>to corner</sup>  $\frac{13}{13}$  where it intersects the north line of No 2 on the Colorado. thence  $NW$  3,640  $\frac{13}{13}$  to  $SE$  corner of League No 1 on Peach Creek. thence  $N20^{\circ}E$  6,630  $\frac{13}{13}$  to  $NE$  corner of No 1 on Peach Creek thence down the creek with the meanders thereof to the beginning. Containing 25,000,000 Square Bars.

Ed. H. Carter  
Title issued July 24/24 vol 1 p 236  
Wharton Co

(45)  
3<sup>rd</sup> League. Beginning at a red oak <sup>14 in diam</sup> on the bank of the creek marked on one side L4 WC and on the other L3 WC. thence S20°W 10,130 B. to corner where it intersects the North line of N° 3 on the Colorado, thence NW 3,200 B. to SE corner of N° 2. thence <sup>N. 20 E</sup> with the east line of N° 2, 8,340 B. to Peach creek, and corner. thence down the creek to the beginning, containing 25,000,000 Square Bars.

John Huff  
Title issued July 24/24 vol 1 p 220  
Wharton Co

4<sup>th</sup> League. Beginning at an elm <sup>15 in diam</sup> on the bank of Peach Creek. Mark. on one side L5 WC and on the other L4 WC. thence S20°W 10,700 B. to corner a stake in Prairie, thence N70°W 1,800 B. <sup>to corner</sup> or till it intersects the North line of the 3<sup>rd</sup> League (on the Colorado) produced. thence NW 750 B. to SE corner of 3<sup>rd</sup> League. thence N20°E 10,130 B. to creek, thence down the creek with the meanders to the beginning, containing 25,000,000 Square Bars.

John Huff  
Title issued July 10/24 vol 1 p 22  
Wharton Co

John Huff  
5<sup>th</sup> League. Beginning at a white oak <sup>18 in diam</sup> about 1000 B. below the junction of Peach creek and St. Bernard. The oak is marked on one side L6 WC and on the other L5 WC. thence S20°W 11,420 B. to corner a stake in Prairie, thence N70°W 2,310 B. to SW corner of League 4<sup>th</sup>. thence N20°E 10,900 B. to creek, thence down the creek to the beginning, containing 25,000,000 Square Bars.

(46)

of the League, beginning at an ash 16 in. diam.  
marked on one side  $\frac{L8}{WC}$ , and on the other  $\frac{L9}{WC}$ , thence  
SW 9,500 yds to corner a Pecan 7 in. diam. standing  
in the edge of the Prairie marked  $\frac{L8}{WC}$ , thence  
NW 440 yds. to corner a stake in Prairie, thence  
NE 800 yds. to SW corner of League 7<sup>th</sup> thence N 20° E  
11,400 yds. to lower corner of League 7<sup>th</sup> on the creek  
thence down the creek with the meanders  
thereof to the beginning, containing  
25,000,000 Square Yards.

Copied by P. D. Johnson June 8. 1837

(47)

Meander of the St Bernard creek from the bar  
line up, run a bar line from the bay Prairie  
to the St Bernard 8500 Bars. from the bank of  
the Creek run back on S. line 1000 B. thence  
N15°W 500 B. offset to creek 90. thence 300. offset  
to creek 110. thence NW 500. offset to creek 200. then  
1000. thence NE 880 B. to creek, at 500. thence  
North 1000. offset to creek 610. thence N20°E 610 B. to  
creek, at 300 thence NW 230. to creek. thence SW.  
150. thence NW 570. offset to creek 40. thence  
West 700. thence North 220 to creek, at 170. thence  
West 500. thence North 230 to creek, at 201 thence  
thence West 500. thence NW 1000. thence North 620  
to C. at 500 B. thence NW 150. offset to C. 30. thence  
S80°W 500. thence N 55°W 200. offset to C. 30. thence  
N75°W 1000. offset to C. 110. thence 1000. thence North  
1000. at 200 crossed Peach creek just above its  
mouth. offset to C. 200. thence 100. thence NW 1000.  
thence 1000. thence NE 2030 to C. thence North 130 to C.  
thence NW 1000. thence North 520, to C. at 500. then  
west 1000. thence North 560 to C. at 500 thence west  
500 and crossed an elbow in the Creek, thence  
west 940. to creek about 500 B. above the  
confluence of the 2 St Bernards. and  
opposite to a small Prairie.

(149)  
Meanders of Peach creek from its junction  
with the St. Bernard up till I met W. Selkirk  
meandering down the same. Beginning at  
the Mouth the Bernard bearing S. 6. from  
thence S 58° W 255 N. crossed the line which  
crossed Peach creek in Meandering the Bernard  
30 N from Peach creek, on the South side.  
thence together with the same line and course  
500 N. thence west 1000, thence NW 200 N.  
offset North to creek 60. thence N 270 to C. thence  
SW 470 to C. thence S 500 N. 300 along the bank  
of C. thence NW 500. offset to C. 270. thence 1000.  
thence N 1360 N. to C. at 1000 N thence N 500.  
offset to C. 60. thence 1000 N. thence NW 1000.  
offset to C. 200. thence 260 to C. at 180. thence SW  
500 N. thence N 200. thence NW 100. offset to C 30.  
thence N 300. thence NW 100. thence N 13° W 118.  
and met W. Selkirk meandering down.

(11)  
 Meanders of the St. Bernard Creek for the 9<sup>th</sup> League  
 Run SW from the corner 300 bars. Thence SE 340 bars to creek. Thence  
 SW 600 bars. Thence SE 1000 bars offset to creek 400 bars. Thence  
 SE 1000 bars. Thence N 500 bars to bank of creek. Thence 400 bars  
 along the bank of creek. Thence SE 600 bars. Thence NE  
 230 bars to creek. Thence SE 760 bars. Thence NE 600 bars  
 to creek.

+ 9<sup>th</sup> League

{ This, with N: 12, constitutes  
 a 2 Lea. tract granted to  
 Seth Ingram.

Seth Ingram.  
 Beginning on the west bank of San Bernard  
 river at a plum tree 3 in. dia. from which  
 a red oak 32 in. dia. bears S 64 W. 10 bars. Marked  
 We. and a red oak 2 feet in dia. bet. S 25 E 10 bars  
 Marked We. Thence SW 919 bars to corner a post in  
 Prairie cane brake from which a Hackberry 9 in  
 dia. bears N 75 W 12 bars Marked We. and a Mulberry 8 in  
 dia. bears N 23 W 4 bars Marked We. Thence NW 3016  
 bars to a post from which an elm 14 in. dia. bears  
 S 31 E 3 bars Marked We. and a red oak 15 in. dia. bears  
 N 52 E 14 bars Marked We. Thence NE 8632 bars to  
 the San Bernard. Thence down the Bernard with  
 the meanders thereof to the place of beginning  
 containing in these limits one sitio of land  
 surveyed by me Seth Ingram

9 bars in case July 29/24  
 of the Ingrams & 276  
 Wharton Co.  
 R. A. Johnson

+ 10<sup>th</sup> League R. Scoby  
 Beginning at the SE corner of the 9<sup>th</sup> Thence  
 NW 8289 bars to a post and mound in the Prairie  
 Thence NW 3016 bars to a post and mound in  
 Prairie

Copied by  
 Mrs. A. A. Scoby 3/24  
 6-2-2-312  
 Wharton Co.

Thence N<sup>o</sup> 8289 N to NW corner of N<sup>o</sup> 9

Thence S<sup>o</sup> 3016 N. to Place of Beginning containing in these limits one Sitio of land surveyed by me Seth Ingram

Gustavus E. Edwards.

+ 11<sup>th</sup> League, G. Edwards

Beginning at a post in the east line of N<sup>o</sup> 10

Thence S<sup>o</sup> 2500 N. to a post in from which a Hickory 6 in. dia. br. c 123 N 5 N. Marked We Elm 4 in. dia. br. S 62 N 4 bars Marked We

Thence S<sup>o</sup> 2500 N. to a post in Prairie Cane Brake. Thence S<sup>o</sup> N. 10,000 N. to a post and mound in Prairie Cane Brake. Thence NW 2500 N. to a post and mound in Prairie

Thence N<sup>o</sup> 10,000 N. to Place of beginning containing in these limits one Sitio of land surveyed by me Seth Ingram

+ 12<sup>th</sup> League

Seth Ingram.

(This with Sec. No. 9, constitute a 2 Sec tract granted to Seth Ingram)

Beginning at the lower corner of the 9<sup>th</sup> on the San Bernard river. Thence S<sup>o</sup> N. 9290 N. NW corner of the 11<sup>th</sup> Thence S<sup>o</sup> 2500 N.

to NE corner of 11<sup>th</sup> Thence N<sup>o</sup> 10,250 bars to a post red cedar 6 in. dia. Marked We and We from which a Sycamore 15 in. dia. br. N 88 N 10. and an ash 10 in. dia. br. S 72 E 3 N. Thence

up the Bernard with the meandering line to the place of beginning containing in these limits one Sitio of land surveyed by me Seth Ingram

Original of P. M. A. B. Ingram

746  
1846  
1847  
1848  
1849  
1850  
1851  
1852  
1853  
1854  
1855  
1856  
1857  
1858  
1859  
1860  
1861  
1862  
1863  
1864  
1865  
1866  
1867  
1868  
1869  
1870  
1871  
1872  
1873  
1874  
1875  
1876  
1877  
1878  
1879  
1880  
1881  
1882  
1883  
1884  
1885  
1886  
1887  
1888  
1889  
1890  
1891  
1892  
1893  
1894  
1895  
1896  
1897  
1898  
1899  
1900  
1901  
1902  
1903  
1904  
1905  
1906  
1907  
1908  
1909  
1910  
1911  
1912  
1913  
1914  
1915  
1916  
1917  
1918  
1919  
1920  
1921  
1922  
1923  
1924  
1925  
1926  
1927  
1928  
1929  
1930  
1931  
1932  
1933  
1934  
1935  
1936  
1937  
1938  
1939  
1940  
1941  
1942  
1943  
1944  
1945  
1946  
1947  
1948  
1949  
1950  
1951  
1952  
1953  
1954  
1955  
1956  
1957  
1958  
1959  
1960  
1961  
1962  
1963  
1964  
1965  
1966  
1967  
1968  
1969  
1970  
1971  
1972  
1973  
1974  
1975  
1976  
1977  
1978  
1979  
1980  
1981  
1982  
1983  
1984  
1985  
1986  
1987  
1988  
1989  
1990  
1991  
1992  
1993  
1994  
1995  
1996  
1997  
1998  
1999  
2000

Charles Garrett + 13<sup>th</sup> Sitio (51) Garrit J  
 Beginning at a post on the west bank of the San  
 Bernard from which a Live oak 18 in. dia, br.  
 N 64 1/2 W 14 N. and an ash 15 in. dia, br. S 28 1/2 W.  
 An ash tree at this corner is marked W<sup>3</sup> and W<sup>6</sup>.  
 Thence SW 6733 N. to a post from which an ash  
 12 in. dia, br. N 22 1/2 E 10 N. and an Elm 15 in. dia  
 br. S 58 1/2 W 6 N. an ash at this corner is marked  
 W<sup>3</sup> and W<sup>4</sup>. Thence NW 4545 N. to intersected east <sup>line</sup>  
 of N<sup>o</sup> 12 where set a post from which an ash 12 in.  
 dia, br. N 84 1/2 E 11 N. Marked W<sup>3</sup> and Elm 14 in. dia  
 br. S 22 E 15 N. Marked W<sup>6</sup>. Thence NE 5163 N. to  
 the Bernard. Thence down the Bernard with the  
 Meanders thereof to the place of Beginning contain  
 ing in these limits one Sitio of land.

Lawrence Ramsey + 14<sup>th</sup> Sitio J. Alderson Ramsey  
 Beginning at the SE corner of the 13<sup>th</sup> Thence  
 NW 5500 N. to a post from which a red Cedar 12 in. dia,  
 br. S 76 W. 11 N. and a red Cedar 14 in. dia, br. N 6 1/2 W. 15 N.  
 an ash at this corner is marked W<sup>6</sup> and W<sup>5</sup>. Thence  
 NW 4545 N. to a post in Prairie cane brake, and inter  
 section of the east line of N<sup>o</sup> 11. Thence NE 5500 to  
 SE corner of N<sup>o</sup> 13. Thence SE 4545 N. to place of begin  
 ning comprehending in these limits one Sitio

+ 15<sup>th</sup> Sitio. Pedungir & Holloway  
 Beginning at the SE corner of the 14<sup>th</sup> Thence  
 NW 5500 N. to corner <sup>a post</sup> in Prairie cane brake  
 Thence NW 4545 N. and intersected the east

Charles Garrett + 13<sup>th</sup> Sitio (51) Garrit J  
 Total issued May 23/37 - vol 2, p 572  
 R. D. Johnson  
 Lawrence Ramsey  
 J. Alderson Ramsey  
 Pedungir & Holloway  
 Total issued May 15/37, vol 2, p 562.



line of N<sup>o</sup> 11 where set a post from which a  
~~line~~ set white oak 2 feet in dia. brs.  
 N 83 1/2 E 6 B. Marked Wc and a Live oak 12 in. dia.  
 brs. S 25 E 8 B. Marked Wc. Thence N 6 along the  
 east line of N<sup>o</sup> 11. 45 45 B. to SW. corner of  
 N<sup>o</sup> 14. Thence N 5 E 45 45 B. to place of beginning  
 containing one sitio of land. In the title, the 3<sup>rd</sup> line is 5500 and

Aug 31st Vol 1 - 1834  
 Matagorda Co

Charles Demos + 16 Sitio Chas. Demos  
 Beginning at the SE corner of 15<sup>th</sup> Thence  
 N 55 00 W to post and Mound in Prairie  
 Thence N 45 45 W to a post and Mound. Thence  
 N 6 55 00 W to SW corner of 15<sup>th</sup>. Thence S 6  
 45 45 W to place of beginning, containing  
 in these limits one sitio of land

9th Dec 1834 Vol 1 - 1834  
 Matagorda Co

Benjamin Bawderson + 17<sup>th</sup> Sitio B. Bawderson  
 Beginning at the SE corner of the 18. Thence  
 N 80 00 W to post and Mound in Prairie  
 Thence N 31 25 W to post and Mound in  
 Prairie. Thence N 6 80 00 W to a post in  
 Prairie cane brake. Thence S 6 31 25 W  
 to place of beginning containing in these  
 limits one sitio of land

Benjamin Bawderson

Peter Demos  
 Title issued July 24/34 Vol 1 p 244 + 18<sup>th</sup> Sitio Peter Demos  
 Matagorda Co  
 Beginning at the SE corner of 17<sup>th</sup> a post  
 from which an ash 3 in. dia. brs. N 45 W 7 B.  
 Marked Wc and an ash 10 in. dia. brs. N 85 W  
 7 B. Marked Wc. Thence N 6 80 00 W to a post from

Copy of 12th Johnson

which a red oak 14 in. dia. brs. N 27 W. 1 N. Marked  
19 We and an ash 17 in. dia. brs. N 73 W. 11 N. Thence  
NW 3125 N to corner in the east line of 14<sup>th</sup> League  
a post from which an Elm 12 in. dia. brs. S 81 E 18 N  
Marked 19 We and an Elm 10 in. dia. brs. S 18 E 9 N  
Marked 18 We. Thence SW 8000 N to NW corner of 19<sup>th</sup>  
Sotio. Thence SB 3125 N. to Place of beginning containing  
in these limits one Sitio of land " " "

Daniel Shipman of Isaac N. Charley

19<sup>th</sup> Sitio

Beginning <sup>a State</sup> of the lower corner of the 15<sup>th</sup> on the  
San Bernard from which a Sycamore 12 in. dia.  
brs. N 24 W. 4 N. Marked 19 We and a Sycamore 14 in.  
dia. S 58 E 4 N. Marked 20 We. Thence SW 4800 N. to NE  
corner of the 19<sup>th</sup> Thence NW 3125 N. to NW  
corner of 18<sup>th</sup> Thence SB 5212 N. to San Bernard.  
Thence down the San Bernard with the meander  
thereof to the place of beginning containing  
in these limits one Sitio of land " " "

File issued May 21/27. vol 2 p 53  
Shipman & Charley  
Brazoria

Thomas Gray of John H. Moore  
Test administered Aug 16/29. Vol 2. p 430

20<sup>th</sup> Sitio Gray & Moore

Beginning on the west bank of the San Bernard at  
an Elm 6 in. dia. from which a Cypress 20 in.  
dia. brs. N 68 W 5 bars. Marked 20 We and a Sycamore  
15 in. dia. brs. S 68 E 2 N. Marked 26 We. Thence NW  
3400 N. to corner a stake from which a Cedar 6 in.  
dia. brs. N 56 W 7 N M<sup>10</sup> We and a Cedar 10 in. dia.  
brs. N 26 W 6 N. Marked 20 We. Thence NW 4166 N. to <sup>a post</sup> in the  
east line of the 19<sup>th</sup> a post from which an ash

(57)

65  
along  
3/4  
In distance  
Carson

8 in. dia. brs. S1°E 170. Marked <sup>21</sup>We and a Cedar  
10 in. dia. brs. N72°E 6 N. Marked <sup>20</sup>We. Thence N 6,000

6,565 N. to San Bernard the lower corner of the 13<sup>th</sup>  
Thence down the Bernard with the Meanders thereof  
the place of beginning comprehending in these  
limits one Sitio of land " " " " " "

William C. Carson 21<sup>st</sup> Sitio. Copied R.D. Johnson  
Title issued May 15/27. Vol 2. p. 564

Beginning at the SE corner of the 20<sup>th</sup> Thence SW  
6,000 N. to corner a post from which an Elm 5 in.  
dia. brs. N70°W 11 N. Marked <sup>22</sup>We and a red oak 12 in.

dia. brs. N25°W 9 N. Thence NW 4166 Varas and intersects  
the eastern boundary of the 18<sup>th</sup> at a post from  
which a red oak 16 in. dia. brs. S1°E 20 N. Marked <sup>21</sup>We  
and a red oak 30 in. dia. brs. N80°E 8 N. Marked <sup>22</sup>We.

Thence N 6,000 N. to SW corner of the 20<sup>th</sup>  
Thence SE 4166 N to place of beginning contain-  
ing in these limits one Sitio of land " " " "

Isaac Foster 22<sup>nd</sup> Sitio Foster Copied R.D. Johnson  
Title issued Aug 16/24. Vol 2. p. 366

Beginning at the SE corner of the 21<sup>st</sup> Thence  
SW 6,000 N. to corner a post from which an  
Elm 11 in. dia. brs. S73°W 63 N. Marked <sup>23</sup>We. Thence

NW 4166 N. and intersects the east line of the 17<sup>th</sup>  
corner a stake from which an Elm 6 in. dia.  
brs. S1°E 2 N. Marked <sup>23</sup>We and an Elm 8 in. dia.  
brs. N81°E 6 N. Marked <sup>22</sup>We. Thence NE 6,000 N. to SW  
corner of the 21<sup>st</sup> Thence SE 4166 N. to place of  
beginning containing one Sitio of land " " " "

William C. Carson  
Isaac Foster

In the 7th, the line runs S.W. 7500 ft.  
N.W. 4166 ft. - N.E. 7500 ft. to the W. corner  
of 22<sup>nd</sup> Thence S.E. 4166 ft. to  
beginning place

(55)  
Title issued July 24/24 vol 1 p 224. + 23<sup>rd</sup> Sitio Daniel Rawls  
beginning at the S.E. corner of the 22<sup>nd</sup> Thence  
S.W. 6,000 ft. to post and mound in Prairie. Thence  
N.W. 4,166 ft. to post and mound in Prairie. Thence  
N.E. 6,000 ft. to S.W. corner of 22<sup>nd</sup> Thence S.E.  
4,166 ft. to place of beginning containing in these  
limits one Sitio of land

Cap. O. Johnson  
+ 24<sup>th</sup> Sitio Amor Rawls  
beginning at the S.E. corner of the 23<sup>rd</sup> Thence  
S.W. 7,500 ft. to a post from which an ash 12 in. dia. br.  
N 37° W 7 ft. Mark<sup>24</sup> We. and an ash 6 in. dia. br.  
N 11° W 13 ft. Mark<sup>25</sup> We. Thence S.W. 7,500 ft. to a post  
and mound in Prairie. Thence N.W. 3,333 ft. to  
a post and mound in Prairie. Thence N.E. 7,500  
to corner a post from which a Hackberry 9 in.  
dia. br. S 26° W 10 ft. Mark<sup>24</sup> We. and a Hackberry  
dia. br. S 7° W. Thence S.E. 3,333 ft. to place of  
beginning containing in these limits one  
Sitio of land

+ 25<sup>th</sup> Sitio B. Lindsey at 29/31 vol 3 p 67  
Benjamin Lindsey, cancelled and titled to Benj. Ferry & wife  
beginning at the N.E. corner of the 24<sup>th</sup> Thence  
N.E. 7,500 ft. corner a post from which a Spanish  
Oak 14 in. dia. br. N 65° W 13 ft. Mark<sup>25</sup> We. and an  
Elm 10 in. dia. br. N 17° W 17 ft. Mark<sup>26</sup> We. Thence  
N.W. 3,333 ft. to intersection of east line of 21<sup>st</sup> where  
set a post from which an Elm 6 in. dia. br.  
S 20° W 1 ft. Mark<sup>25</sup> We. and a Hackberry 5 in. dia.

Title issued July 24/24  
vol. 1 p 222.

J. G. Lindsey  
Title issued Aug 19/24  
vol. 2 p 58.  
beginning at 29/31

brs. S 80 E 3 N. Mark<sup>o</sup> <sup>26</sup>We. Thence S N. 7,500 N to  
NW corner of 24<sup>th</sup>. Thence S 80 3,333 N. to place  
beginning comprehending in these limits  
one sitio of land

James McKeel + 26<sup>th</sup> Sitio D McNeil

Beginning on the west bank of the San Bernard  
at a post corner a Cotton Wood 2 feet Dia.  
Mark<sup>o</sup> <sup>26</sup>We. Thence S N. 5,855 N. to NW corner  
of 25<sup>th</sup>. Thence N W 3,333 N. to intersection  
east line of 21<sup>st</sup> and at the NW corner  
of 25<sup>th</sup>. Thence N 8 6,790 N. to San Bernard.  
at the lower corner of N<sup>o</sup> 20. Thence down  
the river with the meanders thereof to the  
place of beginning containing in these  
limits one sitio of land

*In the title, the line N.E. is 7270 N*

Joseph White + 27<sup>th</sup> Sitio R. Leal

Beginning on the West Bank of the San  
Bernard at a post and an oak Mark<sup>o</sup> <sup>27</sup>We. Thence  
S N. 8,140 N. to corner a post from which  
a live oak 8 in. dia. brs. S 2 W 12 N. Mark<sup>o</sup> <sup>27</sup>We.  
and a Pecan 12 in. dia. brs. S 81 W. 11 N. Mark<sup>o</sup> <sup>28</sup>We.  
Thence N W 3,333 N. to intersection of east line of  
25<sup>th</sup> at a post from which an Elm 15 in. dia.  
brs. N 87 E 16 N. Mark<sup>o</sup> <sup>27</sup>We. and a Hackberry  
8 in. dia. brs. S 27 E 9 N. Mark<sup>o</sup> <sup>28</sup>We. Thence  
N 6 7,500 N. to San Bernard at the lower corner  
of 26<sup>th</sup>. Thence down the Bernard with the

James McKeel  
James McKeel  
James McKeel

Joseph White  
Joseph White  
Joseph White

Copy by ...

Meanders thence to the place of beginning  
containing one Sitio of land  
Greenman Pettus + 28<sup>th</sup> Sitio Freeman & Peter

Beginning at the SE corner of the 27<sup>th</sup> Thence  
SW 7,500 Rs. to corner a post from which an  
elm 12 in. dia. b. N 22 W. 17 Rs. Mark<sup>28</sup> We and a live  
oak 7 in. dia. b. N 77 1/2 W 11 Rs. Mark<sup>29</sup> We. Thence  
NW 3,333 Rs. to corner in Prairie cane brake  
and intersection of east line of 24<sup>th</sup> Sitio.  
Thence NE 7,500 Rs. to SW corner of 27<sup>th</sup> Thence  
SE 3,333 Rs. to place of beginning containing  
one Sitio of land

Simphey Burnett and + 29<sup>th</sup> Sitio, Burnett & Sojourner  
Albert Lloyd Sojourner

Beginning at the SE corner of 28<sup>th</sup> a post from  
which an elm 12 in. dia. b. N 22 W. 17 Rs. Mark<sup>28</sup> We  
and a live oak 7 in. dia. b. N 77 1/2 W 11 Rs. Mark<sup>29</sup> We  
Thence SW 7,500 Rs. to post and mound in  
Llano (Prairie). Thence NW 3,333 Rs. to a post and  
mound in Prairie. Thence NE 7,500 Rs. to SW  
corner of 28<sup>th</sup> Thence SE 3,333 Rs. to place of  
beginning containing in their limits one Sitio  
of land

Thomas M. Duke. + 30<sup>th</sup> Sitio Duke

Beginning at the SE corner of the 31<sup>st</sup> a stake from  
which an Elm 10 in. dia. b. N 58 12 Rs. Marked<sup>31</sup> We. and  
a Mulberry 14 in. dia. b. N 58 W. 7 Rs. M<sup>31</sup> We. Thence  
SW 6,500 Rs. to a post and mound in Prairie. Thence

Total issued Aug 31 24 vol 2 p 318  
Matagorda Co

Total issued Aug 23/24  
vol 1 p 240  
Matagorda Co

Total issued July 24/24  
vol 1 p 228  
Matagorda Co

T.M.D.

NW 3846 N. to a post and Maun, Thence  
 N 6,500 N. to NW corner of 31<sup>th</sup>. Then a post  
 from which a red oak 26 in. D. b. 28 53 N.  
 Marked <sup>31</sup> We & <sup>30</sup> We T.M.D. Thence S 3846 N. to place  
 of beginning containing one Sitio of land.  
 Copied R.D. Johnson + 31<sup>th</sup> Sitio 7. Green George  
 beginning at the NE corner of the 30<sup>th</sup>. Thence N  
 6,500 N. to corner a post from which an Elm 7 in.  
 b. N 31 W 2 N. Marked <sup>32</sup> We and an ash 5 in. D. b.  
 N 75 W 4 N. Marked <sup>31</sup> We. Thence NW 3846 N. to corner  
 and intersection of east line of the 28<sup>th</sup> a post  
 from which an Elm 12 in. D. b. S 54 E 10 N.  
 Marked <sup>32</sup> We and a red oak 6 in. D. b. S 11 E 10 N.  
 Marked <sup>31</sup> We. Thence NW 6,500 N. to NW corner of  
 the 30<sup>th</sup>. Thence S 3846 N. to place of be-  
 ginning comprehending one Sitio  
 of land

106 used July 24 1874  
 34  
 34  
 34

Copied R.D. Johnson + 32<sup>nd</sup> Sitio Johnson, Borden Walker  
 beginning at the NE corner of the 31<sup>st</sup> a post  
 from which an Elm 7 in. D. b. N 31 W 2 N. Marked  
 We and an ash 5 in. D. b. N 75 W 4 N. Marked <sup>31</sup> We  
 Thence N 6,500 N. to corner a post from which an  
 Elm 24 in. D. b. N 33 W 5 N. Marked <sup>33</sup> We and an Elm  
 in D. b. N 55 W 7 N. Marked <sup>32</sup> We. Thence NW  
 3846 N. to corner and intersection of east  
 line of the 27<sup>th</sup> a post from which a  
 red oak 12 in. D. b. S 78 E 8 N. Marked <sup>33</sup> We and

Henry W. Johnson  
 Borden Walker  
 106 used July 24 1874

Copied R.D. Johnson





Taxes assessed July 27/24 Doc. 1 for 256

Borough of Matagorda Co

Joseph H. Polley & <sup>James H. Chagnacoff</sup> (60) + 35<sup>th</sup> Sitio Polley. Commenced organ  
 beginning at the SE corner of the 34<sup>th</sup> corner  
 post from which a live oak 10 in. D. b. N 91 W 14 N  
 Ma<sup>D</sup> 35<sup>th</sup> We. and a live oak 5 in. D. b. N 13 W 9 N. Ma<sup>D</sup> 35<sup>th</sup>  
 We. Thence SW. 6,500 N. to corner a red oak 11 in.  
 D. b. S 72 W. 12 N. Ma<sup>D</sup> 36<sup>th</sup> We. ~~Thence~~ and a red oak  
 7 in. D. b. N 3 W 17 N. Ma<sup>D</sup> 35<sup>th</sup> We. Thence NW. 3,846  
 and intersects the east line of 31<sup>st</sup>. Thence  
 NB 6,500 N. to SW. corner of 34<sup>th</sup>. Thence  
 SB 3,846 N. to place of beginning containing  
 one Sitio of land

Mills M. Battle Mandus Berry + 36<sup>th</sup> Sitio Battle & Co. <sup>Tax assessed Aug 10/24</sup> Me S. 10 60  
 and John Williams S<sup>on</sup> <sup>Matagorda Co</sup> W. S.

beginning at the SE corner of 35<sup>th</sup> a post  
 from which red oak 11 in. D. b. S 72 W. 12 N.  
 Ma<sup>D</sup> 36<sup>th</sup> We and a red oak 7 in. D. b. N 3 W 17 N. Ma<sup>D</sup> 36<sup>th</sup>  
 We. Thence SW. 6,500 N. to corner a post from  
 which an Elm 7 in. D. b. S 79 W 8 N. Ma<sup>D</sup> 36<sup>th</sup>  
 We. and an Elm 6 in. D. b. N 44 W 9 N. Ma<sup>D</sup> 36<sup>th</sup>  
 We. Thence NW. 3,846 N. to corner and inter-  
 section of of the east line of the 30<sup>th</sup> a post  
 from which a red oak 14 in. D. b. S 11 W 16 N.  
 Ma<sup>D</sup> 37<sup>th</sup> We and an ash 13 in. D. b. S 87 E 5 N.  
 Ma<sup>D</sup> 36<sup>th</sup> We. Thence NB 6,500 N. to SW. corner  
 of the 35<sup>th</sup> Thence SB 3,846 N. to place of begin-  
 ning containing in their bounds one Sitio  
 of land

Pleasant Point  
 Tax assessed July 27/24 Doc. 1 for 238 + 37<sup>th</sup> Sitio P. M. Point  
 Matagorda Co. Ass<sup>ts</sup>  
 beginning at the SE corner of the 26<sup>th</sup> at a post

R. P. Johnson

Capt. R. P. Johnson

from which an Elm 7 in. D. b.  $S 7^{\circ} N 8^{\circ} W$ , Marked  $36^{\circ}$  We.  
 and an Elm 6 in. D. b.  $N 4^{\circ} W 9^{\circ} N$ , Marked  $36^{\circ}$  We. Thence  
 SW 6,500 N. to corner a post and Mound in Prairie  
 Thence NW 3,846 N. to a post and Mound in Prairie  
 Thence NE ~~6,546~~ 6,500 N. to SW corner of the  $36^{\text{th}}$   
 Thence SE 3,846 N. to place of beginning containing  
 one Sitio of Land

Caleb Postick Robert Protherton  
 Total issued July 21/24 Vol 1 p 332.  
 Montague Co. N.H.

+  $38^{\text{th}}$  Sitio Postick & Protherton

Beginning at the SE corner of the  $39^{\text{th}}$  a post  
 corner an Elm 6 in. D. Marked  $38^{\circ}$  We. &  $39^{\circ}$  We.  
 Thence SW 7,100 N. to a post and Mound in Prairie  
 Thence NW 3,521 3,521 N. to post and Mound  
 Thence NE 7,100 N. to corner a Hackberry 4 in. D.  
 from an Elm 15 in. D. b.  $S 43^{\circ} 9^{\circ} N$  Marked  $38^{\circ}$  We. &  $39^{\circ}$  We.  
 Thence SE 3,521 N. to place of beginning containing in  
 these limits one Sitio of Land

No. D. Buckolls 39<sup>th</sup> Sitio N.D. Nuckolls

Beginning at the NE corner of the  $38^{\text{th}}$  an Elm  
 8 in. D. Marked  $38^{\circ}$  We. &  $39^{\circ}$  We. Thence NE 7,100 N. to corner  
 a post in a Lake grained up with flags and flagg  
 grass. Thence NW 3,521 N. to corner and intersection  
 of the east line of the  $36^{\text{th}}$  at a post from which  
 an oak 14 in. D. b.  $S 28^{\circ} W 7^{\circ} N$ , Marked  $39^{\circ}$  We. and an  
 ash 12 in. D. b.  $S 81^{\circ} 8^{\circ} 1^{\circ} N$ , Marked  $39^{\circ}$  We. Thence SW 7,100  
 to NW corner of  $38^{\text{th}}$ . Thence SE 3,521 N. to place  
 of beginning containing in these bounds one Sitio  
 of Land

Cop. 120 Johnson

Total issued July 31st. Vol 2. p 308  
 Cop. D. D.D. Montague Co. N.H.

Charles Breen (C) + 40<sup>th</sup> Titio Breen

Beginning at the NE corner of the 39<sup>th</sup>  
at a post in a Lake, Thence N 67.100 B.  
to corner a post from which a Live oak 6 in.  
D. b. S 60 W 8 B. Marked We. and a Box Elder  
D. b. N 20 E 1 B. Marked We. Thence NW  
3,521 B. to corner and intersection of east  
line of the 34<sup>th</sup>, a post from which  
an ash 24 in. D. b. S 12 W 7 B. Marked  
We. and an \* 26 in. D. b. N 7 1/2 W. 5 B. Marked We.  
Thence SW 7,100 B. to NW corner of 39<sup>th</sup>  
Thence SE 3,521 B. to place of beginning  
containing in these bounds one Titio of  
land

O. b. To be viewed May 24/27 - Vol 2. p. 514

Capt. J. M. Johnson

\* what? + 41<sup>st</sup> Titio D. M. McCormick

David McCormick

Beginning at the Bernard on the west  
bank a post from which a live oak  
D. b. N 68 W 8 B. Marked We. and a Live  
oak 9 in. D. b. S 3 W 2 B. Marked We. Thence SW  
3,910 B. to NE corner of the 40<sup>th</sup> Thence NW  
3,521 B. to intersection of the east line  
of 34<sup>th</sup> and same with the NW corner  
of the 40<sup>th</sup>. Thence N 6.248 B. to San Bernard  
and lower corner of 34<sup>th</sup>. Thence down  
the river with the meanders thereof to  
the place of Beginning containing  
in these bounds one Titio of land

To be viewed July 24/24 Vol 1 p. 210

Capt. J. M. Johnson

In the title, the 3<sup>d</sup> line (N.E.) is 6848 B.  
1857

506 issued July 24/24. Vol 1 p 242.

Inula Keep. (63) 7 12<sup>th</sup> Site Inula Keep  
 Beginning at the SE corner of the 41<sup>st</sup> on the  
 Bernard, west bank, at a post from which a  
 white oak 8 in. D. b. N71 W 3 N. Marked <sup>42</sup>We.  
 and a Black oak 8 in. D. b. S16 W. 2 N. Marked <sup>42</sup>We.  
 Thence S W. 5.525 N. to corner a post from which  
 an Elm 24 in. D. b. N32 W 3 N. Marked <sup>42</sup>We. and  
 an Elm 13 in. D. b. N78 W 15 N. Marked <sup>43</sup>We. Thence  
 N W. 3.846 N. to corner and intersection of east  
 line of the 40<sup>th</sup> a post from which an  
 Elm 14 in. D. b. S68 E 2 N. Marked <sup>43</sup>We. and an  
 Elm 9 in. D. b. S88 11 N. Marked <sup>43</sup>We. Thence  
 N E 7.475 N. to San Bernard. Thence down  
 the river with the meanders thereof to the  
 place of beginning containing one Site  
 of land

Oliver Jones. 43<sup>rd</sup> Site Jones

Beginning at the SE corner of the 42<sup>nd</sup>.  
 a post from which an Elm 24 in. D. b.  
 N32 W 3 N. Marked <sup>42</sup>We and an Elm 18 in.  
 D. b. N78 W 15 N. Marked <sup>43</sup>We Thence S W 6.500 N  
 to corner a post from which a red oak 12 in.  
 D. b. N26 W 16 N. Marked <sup>43</sup>We and a Pecan  
 7 in. D. b. N79 W 14 N. Marked <sup>44</sup>We. Thence S W  
 3.846 N. to corner and intersection of east  
 line of the 39<sup>th</sup> corner a post from which  
 a red oak 14 in. D. b. S66 7 E 9 N. Marked <sup>43</sup>We.  
 and an Elm 5 in. D. b. S9 W 6 N. Marked <sup>44</sup>We.

506 issued Aug 10/24. Vol 2 p 410.

Begining of Meander Co

Thence N 6,500 P. to SW corner of the 42<sup>nd</sup>  
Thence S 3,846 P. to place of Beginning  
containing in these limits one Sitio

R. Williams + 44<sup>th</sup> Sitio ~~to~~

Beginning at the SE corner of the 43<sup>rd</sup>  
corner a post from which a red oak 12 in.  
D. b. N 26 W 16 P. Marked 43<sup>e</sup>, and a Pecor  
7 in. D. b. N 79 W 14 P. Marked 44<sup>e</sup>. Thence SW  
6,500 P. to corner a post from which a  
hackberry 7 in. D. b. N 32 E 4 P. Marked 45<sup>e</sup>  
and a Hackberry 6 in. D. b. N 63 1/2 W  
5 P. Marked 45<sup>e</sup>. Thence NW 3,846 P. till  
it intersects the east line of the 38<sup>th</sup>

Thence N 6,500 P. to SW corner of the  
43<sup>rd</sup>. Thence S 3,846 P. to place of  
beginning containing in these limits  
one Sitio of first grade land

Copied R. D. Johnson + 45<sup>th</sup> Sitio to Rable  
William Rable.

Beginning at the SE corner of the  
44<sup>th</sup> a post from which a Hackberry  
7 in. D. b. N 32 E 4 P. Marked 45<sup>e</sup> and a  
Hackberry 6 in. D. b. N 63 1/2 W 5 P. Marked  
45<sup>e</sup>. Thence SW 6,500 P. to a post and  
mound in Prairie. Thence NW 3,846 P.  
to a post and mound in Prairie.  
Thence N 6,500 P. to SW corner of 44<sup>th</sup>,

Robert Williams  
124 1/2 E of 42<sup>e</sup>  
Del Norte Co  
Mar 29  
716 miles Aug 124 1/2 E of 42<sup>e</sup>  
Del Norte Co  
Mar 29

Thence S 6 3,846 N. to place of beginning containing in these limits one Sitio of land

+ 46<sup>th</sup> Sitio ~~William Rabb.~~ William Rabb.  
Beginning at the S 6 corner of the 45<sup>th</sup> a post and mound in Prairie, Thence S 6 3,846 N. to a post and mound in Prairie, Thence N 6 6,500 W. to corner a post from which an Elm 7 in. D. b. 157 W 27 N. Mark<sup>d</sup> We and an Elm 12 in. D. b. 138 13 N. Mark<sup>d</sup> We, Thence NW 3,846 N. to corners of 44<sup>th</sup> & 45<sup>th</sup>, Thence SW 6,500 N. to place of beginning containing in these limits one Sitio of land.

47<sup>th</sup> Sitio The & Jamison  
Beginning at the N 6 corner of the 46<sup>th</sup> a post from which an Elm 7 in. D. b. 157 W 27 N. Mark<sup>d</sup> We and an Elm 12 in. D. b. 138 13 N. Mark<sup>d</sup> We, Thence N 6 6,500 W. to corner Thence NW 3,846 N. to the corners of 43 & 44. Thence SW 6,500 N. to NW corner of 47<sup>th</sup>. Thence S 6 3,846 N. to place of beginning containing in these bounds one Sitio of land surveyed by William Solkins 20<sup>th</sup> Dec 1827

Feb. 27<sup>th</sup> 1827

same as bk 1. p. 229

Thomas J. Tone & Thomas Jamison  
File in vol. July 24/24. vol. 1. p. 226.  
Matagorda Co

Neathan Brookshire 66 o.k. Title issued Oct 5/35. vol 70 p. 53  
Waller & ~~Waller~~ Bend Co  
MSB

Field Notes of a League of Land Surveyed for  
~~Brookshire~~ <sup>Silvatica</sup> Jack of Coopers Foster and  
other surveys on the East Side of the Brass R  
Beginning at the south East corner of Mr. Cooper's  
land at a post. Thence

North 3860 vs. to the North West corner of the said  
League of Brookshire's. on Cooper's  
East boundary line. Thence

East <sup>33</sup>3315 vs. At 1370 vs a double Black Jack at  
3315 vs to the N E corner of said League,  
Thence

South 6990 vs to the S E corner said to be the N E corner  
of a small tract surveyed for Col. Johnston  
Thence

West 2896 vs. At 1370 vs to the S E corner of said  
tract at 1396 vs timber  
Point at E corner. At 2146 vs Creek  
At 2896 vs to the corner being the N W

corner of San Jans Labor on Roberts  
East boundary line on Oak 2 ft diameter  
6 vs from an inch 6 in. diameter N S W  
Thence

North 2000 vs <sup>with Roberts east boundary</sup> to ~~Roberts~~ <sup>the</sup> N E corner at the edge  
of prairie which is a piece Thence  
<sup>with Roberts north boundary to his N W corner</sup>  
West 2772 vs. At 460 vs to a road timber passing through

a fenced field to the corner of said  
tract on the Eastern boundary of R.

67  
 AT Title made to Brookshire

Cooper

R. Foster



R. Foster's land

North 1130.00 to another corner on Mr. Cooper's  
 South boundary line, Thence  
 East <sup>with Cooper's south boundary</sup> 2052.00 To the place of beginning -  
 Comprehending one league of land  
 Surveyed 25<sup>th</sup> March 1835  
 by Mr. Case for  
 G. Borden Jr.  
 Nathan Brookshire  
 John Scott } to have and



W. J. Miller & Co. 86

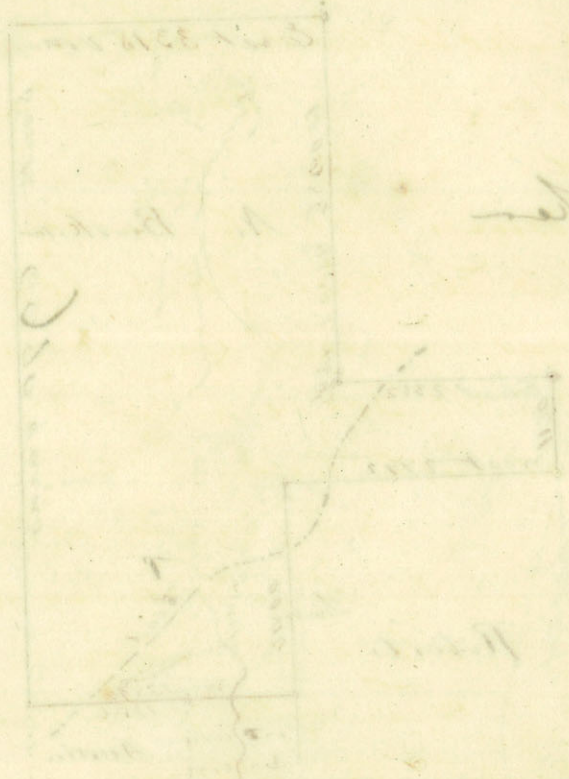

Water

The following is a description of the land shown in the above diagram. It is a tract of land situated in the town of ...  
 The tract is bounded on the north by ... on the south by ... on the east by ... and on the west by ...  
 The area is divided into several sections, and a water course is shown running through it. The total area is ...  
 This land is owned by ... and is being offered for sale. The price is ...  
 For further information, please contact ...

Field notes and plot of a League of land  
 surveyed for on the East end of Galveston  
 Island

- Beginning at the Eastern extremity of said  
 Island at a Cypress block 30 ft. dia. Thence  
 S. 10 W. 500 varas. mostly low ground. Thence  
 S. 35 E. 350 " At 300 is a Camp - 350 is the Gulf Shore  
 at high tide. Thence  
 S. 55 W. 420 " low ground as before. Thence  
 S. 35 E. 410 " to the Shore Thence  
 S. 10 W. 580 " along the Shore Thence  
 S. 55 W. 590 " over hills of white sand. Thence  
 S. 35 E. 410 " to the Shore. Thence  
 S. 55 W. 1000 " the first 500 is over sand hills, and  
 the last 500 is on low ground. Thence  
 S. 35 E. 410 " to the Shore Thence  
 S. 55 W. 800 " grass hills, and then low ground. Thence  
 S. 35 E. 250 " to the Shore Thence  
 S. 55 W. 1010 " At 675 is crossed a road running  
 across the Island. Thence  
 S. 35 E. 190 " to the Shore Thence  
 S. 55 W. 6140 " to a Cypress tree Mt. S. M.

This line is 10000 } At 180 is on this line crossed a small lagoon  
 from the shore. at 2380 is crossed a bay or 30 or 40 ft.  
 the widest place } This line is at first on low ground - sand hills  
 to the right and left. Plenty of fresh water.

- Beginning again at the Cypress block. Thence
- N. 35 W. 390 bars along a sand bar. Thence
- S. 55 W. 250 " across do do. Thence
- S. 35 E. 260 " along the same. Thence
- S. 55 W. 440 " through marsh. Thence
- N. 80 W. 360 " on dry land to bay shore. Thence
- S. 55 W. 180 " into a point - 200 w from the shore
- S. 80 E. " to the right hand. Thence
- S. 80 E. 310 " through wet ground. - 40 w
- from the shore to the right. Thence
- S. 35 E. 310 " on low ground. Thence
- S. 55 W. 700 " through water & marsh. Thence
- N. 35 W. 460 " 300 w along the marsh. Thence
- S. 55 W. 370 " across a point of dry land. Thence
- S. 35 E. 970 " at 600 w entered an arm of the bay
- just 400 w on dry land - at 970 w
- the eastern point of water 100 w. to the left
- Thence
- S. 55 W. 440 " through marsh. Thence
- S. 35 E. 340 " at 280 w crossed at small point of
- water - line on low ground. Thence
- S. 55 W. 430 " at 100 w entered an arm of the bay
- 200 w of the line in the water. Thence
- N. 35 W. 410 " along the marsh. Thence
- S. 55 W. 1030 " at 300 w entered water at 500 left the water
- and over dry land. Thence
- S. 35 E. 210 " crossed an arm of an oyster bay.

- Thence
- S. 55<sup>th</sup>. 320<sup>rs</sup> areas on high rich prairie. Thence
- N. 35<sup>th</sup>. 140<sup>rs</sup> " at 100<sup>rs</sup> opposite custom House 15<sup>rs</sup> to the right  
and 20<sup>rs</sup> from Churchhills on the left.
- S. 55<sup>th</sup>. 570<sup>rs</sup> " Thence
- S. 55<sup>th</sup>. 590<sup>rs</sup> " on good prairie Thence
- N. 35<sup>th</sup>. 230<sup>rs</sup> " to bay shore, on high land. Thence
- S. 55<sup>th</sup>. 1090<sup>rs</sup> " on low ground. Thence
- N. 35<sup>th</sup>. 330<sup>rs</sup> " to bay shore. Thence
- S. 55<sup>th</sup>. 950<sup>rs</sup> " on dry land. Thence
- N. 35<sup>th</sup>. 350<sup>rs</sup> " at 180<sup>rs</sup> a reed brake. Thence
- S. 55<sup>th</sup>. 600<sup>rs</sup> " pond, then good prairie. Thence
- N. 35<sup>th</sup>. 200<sup>rs</sup> " to bay shore Thence
- S. 55<sup>th</sup>. 700<sup>rs</sup> " on dry land Thence
- N. 35<sup>th</sup>. 300<sup>rs</sup> " to bay shore. Thence
- S. 55<sup>th</sup>. 710<sup>rs</sup> " low and wet. Thence
- N. 35<sup>th</sup>. 450<sup>rs</sup> " to shore. Thence
- at 360<sup>rs</sup> small bayous. Thence
- S. 55<sup>th</sup>. 840<sup>rs</sup> " mostly dry land. Thence
- N. 35<sup>th</sup>. 480<sup>rs</sup> " to bay shore. Thence
- S. 55<sup>th</sup>. 500<sup>rs</sup> " low ground. Thence
- N. 35<sup>th</sup>. 350<sup>rs</sup> " to bay shore. Thence
- S. 55<sup>th</sup>. 520<sup>rs</sup> " at the point of intersection on the line  
running across the S. 8<sup>th</sup>. end of the League
- ~~N. 35<sup>th</sup>. 260<sup>rs</sup>~~ Thence
- N. 35<sup>th</sup>. 260<sup>rs</sup> " to a stake for the E. corner of the League. Thence

S 35 E. 4820 varas to the South Corner on the Gulf  
Shore a cypress knee Mk S. M.

At 2000 varas on this line struck low  
marshy ground at 2550 varas small  
salt water lakes at 3000 varas struck  
dry land when there were a few bushes

The foregoing limits together with the  
meanders of the bay & Gulf comprise  
nearly one League of land or an area  
of 95,000,000 square varas. Surveyed  
by me John B. Order on the 29<sup>th</sup> July  
1835.





Scale. 1000 yards to an Inch

74

Black



J. F. Austin

776 unad Dec 29/31

Nov 6 p. 2107

Walker Co

MS

Field Notes of 1/2 Labor of Land  
Situates in a Cor. formed by the  
lands granted to John McFarland &  
William Cooper East of the Brazos  
2 Leagues below San Felipe de Austin  
Beginning at the Extreme point where the  
Upper Line of Cooper's League leaves the S.E.  
line of McFarland

N 34 E. following the said boundary of McFarland  
to a Corner. Thence  
S. 28 E. 12500 to another Cor. upon the st. boundary line of  
Cooper's Survey Thence  
West with the said boundary 13500 to the place of  
Beginning. Comprehending within these limits  
812.500 sq. ft.



J

J. S. Hunter

1097

Field Notes of a Labor of Land granted to Johnson Hunter. Situated East of the Brazos about a league and a half from San Felipe de Austin on Irons Creek.

Beginning at the East Cor of N<sup>o</sup> 9 which is also the South Cor of N<sup>o</sup> 16. Thence S. 56. E. 4600 to the S. Cor on said Creek Thence Up the said Creek with the meanders thereof to a point where the S. E. line of N<sup>o</sup> 16 intersects said Creek at 36 or N. 34. E. of the S. cor. of said Labor Thence S. 34. W following the S. E. Boundary of Labor N<sup>o</sup> 16. to the place of beginning.

In the title, the last line is 43600.

Title issued Nov. 28/32.

Vol 6. p. 1922.

Walker Co.

and

Field Notes of our Labor of Land N<sup>o</sup> 10.  
Situated E. of the River Brazos and adjacent  
to the Town of San Felipe de Austin  
Beginning at the West Corner of Labor N<sup>o</sup> 19  
Thence

to West 1000 or to the West Cor. and North Corner  
of N<sup>o</sup> 13 a

East out from which a

Red Oak numbered 11-18 in dia N<sup>o</sup> 1 S. 74. W. 7 or and an

Ash numbered 13. = 6 in " " N. 39. E. 7 or Thence

N. 34. E. 1500 to the North Corner. Thence

S. 56. E. 1000 or to the East Corner. Thence

S. 34 West 1500 or to the place of Beginning.

Element G. Dyer

Told used Aug 24/24.

Vol 2 p. 536 B.

Waller Co

*[Faint, illegible handwriting, likely bleed-through from the reverse side of the page]*

See Page 52 of this Book

John Morris Deague n<sup>o</sup> on Navidad

Beginning on the West margin of Navidad  
at the S.E. Corner of Mrs Livings  
Survey thence  
S. 70° W. 7000 Varas with South line of  
Said Survey to the S.W. Cor-  
ner of the same thence due  
East 650 Varas to John Adams  
S.E. Corner thence  
S. 2500 Varas with East line of said  
Survey to his S.E. Corner  
thence E. 2676 Varas thence  
S. 250 Varas and established a corner  
from which a Live Oak 4  
Varas distant 8 inches dia.  
brans N. 41° W. and a Live  
Oak 14 inches dia 18 1/2 Varas  
dist brs. S. 25° E. thence  
N. 70° E. 4360 Varas to the Navidad W

W established a  
corner on a Hackberry  
marked W from  
which a Box elder  
8 inches in dia. 4  
Varas dist brs. S. 51° W  
and an elm 18 inches  
in diameter 9 1/2 Varas  
distant br. N. 80° W.

thence up said Stream  
with the meanders thereof  
to the place of Beginning  
containing Une Lito de  
Siere June 20<sup>th</sup> 1835

W. R. Hensley  
S. J. Tur.

60  
J  
Joel Ponton & Seague

Beginning at the S. E. Corner of the  
Survey of John Morris on the  
West margin of Navidad. thence  
S. 70° W. 4360 Varas to John Morris S. W.  
Corner on Back line of Mrs. Hatten  
thence

South 2250 Varas to Mrs. Hatten. S. E.  
Corner thence

West 1188 Varas. thence  $\frac{1}{2}$

South 3380 Varas and established a corner  
thence

N. 70. E. 6000 Varas to the Navidad and  
Established a corner on a  
hackberry Marked T from  
which an ash 30 inches in  
dia  $\frac{1}{2}$  Varas distant bears N. 51  
West and an Elm 15 inches  
in dia 6 Varas distant bears  
N. 39 E thence up said Stream  
with the meanders thereof to  
the place of Beginning Cont-  
aining one Sitio de Tierra

June 21<sup>st</sup> 1835

W. H. Menzley  
Surveyor

9

Thomas Mitchell 1 League.

87

Beginning on the West margin of the Navidad at the S.E. Corner of the Survey Made for Fort Gordon on a Hackberry Marked T from which an ash 30 inches in dia 4 $\frac{1}{2}$  Varas distant bears N. 51° W. and an Elm 15 inches in dia 6 Varas disty brs. N. 39° E thence ~~xx~~ ~~Said Stream~~ ~~xxxx~~ ~~xx~~

S. 70° W. 7500 ~~miander~~ Varas to the West line of a Survey made on the Sabaca North of Sect H. 3/4 and established a corner on a Black Oak Sapling MKD H from which a post <sup>Oak</sup> 11 inch in dia 3 Varas dist brs N. 70° W and post Oak 9 inches in dia <sup>5 $\frac{1}{2}$  Varas</sup> S. 14° W thence

*Black Oak*

South 4000 Varas to the S.E. Corner of the the aforesaid Survey (North of Sect H) thence

North 70° East 7100 Varas to the Navidad thence up said Stream to place of Beginning

Containing one title de Tierra

Jun 22. 1835

W. R. Murphy  
Sur.

Survey of League of Land  
on the Sabaco north & adjoining Sects 3 & 4

Beginning at the N. West Corner of said  
 Survey on the East margin  
 of the Sabaco thence

East 4909 Varas and established a  
 Corner - thence

North 7400 Varas and established a  
 Corner on Mrs. Halletts  
 South Line thence

West 1210 Varas to the N. E. Corner of  
 Dr. N. 1 on Mrs. Halletts South  
 line thence

South with East Line of Drs. N. 1-2 & 3  
 3680 Varas to the S. E.

Corner of Dr. N. 3. thence

West 3963 Varas to the Sabaco. thence  
 down said Stream to

the place of Beginning  
 On the following meanders

1. S. 10° W 1250 Var. S. 36° E 830.15  
 2. S. 112° W 530 Var. S. 48° W 700 Varas  
 3. S. 122° E 540 Varas S. 65° E 400 Varas  
 4. S. 17° E 200 Varas containing one

Cerro de Sierra. May 25<sup>th</sup> 1835

M. R. Newby

Survey of Tr. No. 1.

Beginning at Mrs. Malletts South Line on  
the East margin of the  
Sabaco. thence

East with South Line of said Survey  
7086 Varas and established  
a Corner on a post Oak  
18 inches in diameter  
Marked A from which  
a post Oak 20 inches  
in dia 5 Varas distant  
bears  $S 70^{\circ}$  East, and a  
post Oak 12 inches in  
dia 7 Varas distant bears  
 $N 55^{\circ}$  E thence

1915 Varas to a Black Jack at ~~the~~ ~~the~~ ~~the~~  
~~the~~ ~~the~~ ~~the~~ ~~the~~ ~~the~~ ~~the~~ ~~the~~ ~~the~~ ~~the~~ ~~the~~  
Marked H  
for the South East Corner  
of this Survey from which  
a post Oak 24 in. dia  
13 Varas distant bears  $S 35^{\circ}$  W  
and a post Oak 13 inches dia  
15 Varas distant bears  $N. 60^{\circ}$  W

Thence West 6627 Varas to the Sabaco, thence up  
said stream with the following meanders viz N. 55 W 5300  
N. 25° East 438 Varas. N. 51° W 290 } May 25: 1835  
to the place of Beginning containing  $\frac{1}{4}$  (Acre) } W. R. Hensley Sur





Survey of P. N<sup>o</sup> 2 on Sabaca 85

Beginning on the East margin of the Sabaca  
at the S. West corner of <sup>Gr. N<sup>o</sup> 1</sup> ~~the same~~ thence  
East 6627 Varas with South boundary of said  
quarter N<sup>o</sup> 1 to the S. E. corner of  
the same being on a black Jack  
marked H from which a post oak  
24 inches in dia 15 Varas distant  
bears S. 35<sup>o</sup> W. and a post oak  
13 inches in dia 15 Varas distant  
bears N. 60<sup>o</sup> W. thence due

South 1160 Varas and established a corner  
on a stake from which a live  
Oak 12 inches in dia 41 Varas  
dist N. 39<sup>o</sup> West and a post oak  
18 inches in dia 38 Varas dist  
bears N. 53<sup>o</sup> E thence due West

West 4215 Varas to the margin of the  
Sabaca thence up said  
Stream with the meanders  
thereof viz. N 9<sup>o</sup> West 480 Varas  
N. 62<sup>o</sup> W. 900 Varas N 85<sup>o</sup> West 1430  
Varas N. 55 W 200. Containing  
una biteo de tierra in superficie

3 May. 25<sup>th</sup> 1835

M. B. Newby  
3 Sur

28

Journal of Dr. J. S. on a visit to

the ... of the ... with ... of the ... the ... of the ... the ... of the ... the ... of the ...

Journal 1100

the ... of the ... the ... of the ... the ... of the ... the ... of the ... the ... of the ... the ... of the ...

the ... of the ... the ... of the ... the ... of the ... the ... of the ... the ... of the ... the ... of the ...

J Survey of Dr. No 3. on Sabaca 87

Beginning at the South West Corner  
of Dr. No 2 on the East margin  
of the Sabacca thence ~~E~~

East 4215 Varas with South line of said  
Survey to the S. E. Corner of the same  
from which a Live Oak 12 inches  
in dia. 41 Varas distant bears N. 37° W  
and a post Oak 18 inches in dia  
38 Varas distant bears N 53° E thence

1575 Varas and established a corner on a post  
Oak 14 inches in dia marked X from  
which a post oak 16 inch in  
dia 5 Varas dist bears South 18° E  
and a post Oak 16 inch in  
dia 5 Varas distant bears S. 18° E  
and a p. Oak 20 inches in dia  
8 Varas dist bears S. 36° W thence

West 3963 Varas to the Sabacca and es-  
tablished a corner - thence

up said Stream with the following  
meanders. S. by N 10° E 750 Varas

N. 20° W. 360 N. 22° E 300 Varas N. 70° W

380. N 9 West 90 Varas to the place of

Beginning containing una

litro de tierra } May 25<sup>th</sup> 1835 } W. R. Hensley  
Survey

# Rich Dowdy's Survey

Beginning 1877 Varas from the S. E. corner  
 of Joseph Thompson's Survey on  
 his East line on the Waters of  
 the Navidad at a black oak  
 marked X from which post oak  
 12 inches in dia, 5 Varas dist,  
 bears S. 18° E and a Black oak  
 14 inch in dia, 5 1/2 Varas dist  
 bears S 83 West. thence

East 6020 Varas and established a corner  
 on a stake from which a  
 post Oak 14 inches in diam,  
 11 1/2 Varas dist bears S. 79° E  
 and a post Oak 18 inches  
 in dia, 11 Varas dist bears S. 35° E  
 thence

N 1500 Varas to Robert Cunningsham's S. W.  
 Corner thence with the West  
 line of said Survey 2653  
 Varas and established a  
 corner on a stake from  
 which a black Oak 16 in,  
 in dia 5 Varas dist bears  
 N. 69° E and a post Oak  
 18 inches in dia 17 Varas dist  
 bears S. 60 West thence  
 (see next page)

West 6020 Varas and established a corner on a post oak N.W. D from which a post oak 8 inches in dia. 2 1/2 Varas dist bears S. 59 E and a post oak 18 inches in dia. 6 1/2 Varas dist bears N. 58 W. thence

South 1030 Varas to Joseph Thompson's N.E. corner thence

South 3123 Varas with E. line of said league to place of Beginning containing one Lito de Terra Superficie

June 25 1835

W.R. Hensley

" 3 " Sur "

of  
That 2000 was an ...  
was on a ...  
from which a ...  
in ...  
was ...  
in ...

1847  
to ...  
to ...  
to ...  
to ...  
to ...

1848  
to ...  
to ...  
to ...  
to ...  
to ...

J

A Kelson I League between  
Naridad and Seel Creek.

Beginning at Joseph Thompsons N E Cor-  
ner thence

West 610 Varas to the South East Corner  
of a League Survey North of  
Joseph Thompsons Survey thence  
N 4600 Varas with east line of said Sur-  
vey and established a Corner from  
which a black Jack 8 inches in  
dia 64 Varas dist bears N 70 E- and  
a black Jack 10 inches in dia  
110 Varas dist bears due South thence

East 6800 Varas to the West Line of  
Gillerlands League on Colorado  
thence South ~~to~~ 1800 Varas to Cuminghams  
North Line thence

West 750 Varas with said Survey to the  
the N. W. Corner of Cuminghams  
Survey - thence

South 2570 Varas with Cuminghams West line  
to the N. E. Corner of Doudays Survey

thence West 6020 Varas to N. W. Corner of R Douday  
Survey thence

S. 1030 Varas to Thompsons N. E. Corner & place of  
Beginning - June 26. 1835

} W. R. Hensley  
W



92  
Survey of a Tract of Land  
of South and adjoining Daniels League

Beginning at a post, Oak Tree 18 inches  
in diameter marked A on  
the margin of Rio Tabaca  
thence

North  $15^{\circ} 27' 10''$  Varas and established  
a Corner from which a Black  
Jack Oak marked X 12 inches  
in dia 178 Varas distant bears  
West and a Black Jack  
14 inches in diameter 177 Varas  
west marked A bears  $A 87^{\circ} W$   
thence

West 776 1/2 Varas to the West line of Daniels  
League and set a Stake in  
a mound thence

South 3700 Varas to the S. E. Corner of  
Daniels League on Tabaca  
thence

down said Stream with the meanders  
thereof to the place of Begin-  
ning containing Una Cito  
de Sierra Mar. 15. 1833

W. H. Woodley  
Surveyor

9 Survey of 1 League of Land North and  
adjoining Lands granted. William  
Penton on the Sabaca.

---

Beginning at a post Oak Tree 18 inches  
in diameter marked A on the  
East margin of the Sabacca  
thence

---

N. 45 E. 4700 varas Set Stake in mound thence  
S. 45 E 7900 Varas to North line of William  
Penton's Survey and Set a Stake  
in mound on said line thence  
West 6000 Varas to the N. W. Corner of same  
on E. margin of Sabacca. thence  
Up said Stream with the meanders  
thereof to place of Beginning  
Comprehending un Cited  
de Lira March 15-1833

W. C. Hensley  
Sor

History of the Province of North Carolina  
and the Kingdom of Great Britain  
in the Year 1733

beginning of a great City here  
in the winter months A on the  
west margin of the Lake  
there

first three days in winter there  
last year to the end of winter  
winter days were all alike  
in winter the days are the same  
the first year to the end of winter  
on the margin of the Lake  
the days there will be the same  
that the place of beginning  
the first year to the end of winter  
the days there will be the same

History of the Province of North Carolina  
and the Kingdom of Great Britain  
in the Year 1733

# Memorandum of unfinished business

E side Brazos	S.P. Austin	1 <sup>st</sup> Line of 5 League tract. distance
E. Leo.	J.P. Coles	Corner at the end of 3 <sup>rd</sup> line [In pencil]
West side Brazos	Polly & Milburn	Beginning cor of his half League, 3 <sup>rd</sup> Line of 7 League distance in plot & notes [Spent 3 hours on this, would rather survey it.]
What shall we do - when a surveyor can set at his fire side and calculate & lay off Leagues & Quarter leagues on old surveys that never was surveyed [Big Creek		Calculated length of of the
Leagues Below Fort Bend	- Sony	upper line $3,178 - 3,502.12 -$ course $14\frac{1}{2}^{\circ} W.$
Tract South of 4 Leagues	Jeffery	1 <sup>st</sup> & 6 <sup>th</sup> lines distance not found in notes 213-
No. 7. League above 1 Bell	Polly & Milburn	3 <sup>rd</sup> line not marked in dis Again plagued with that thing
Big C. League Leo Leo Leo no 2 " 3 " 4 " 5 " 6	Philo Fairchild Leo	Beginning corner I course & line marked but not found in the notes, nor distance omitted in all the lines but the first & last.

95 West side Brazos John Jones's tract notes  
Below Fort Bend } not found -

~~Finch~~ do ~ } John Jones 1/4 League notes not found

Big Creek - E. Lippincott SW boundary on plot.

Fort Bend Churchill, 11 & 12<sup>th</sup> Corners not established in notes

Same above his upper corner not made in notes.

Big Creek ~~Mixer~~ 1/4 League No 4 - 4<sup>th</sup> Cor. not found.

Stewart do " 5 4 - not found.

This 20<sup>th</sup> day of December, Completed the plot &  
notes of a gr. League granted to J.

Jones back of Henry Jones - Found

several other tracts depending on this

survey, and even this depending on

two others, although very well surveyed

But it is a great trouble in making

out notes - to be obliged to refer to one

man's survey for one corner & to an

others for a second, and so on which

is continually occurring -

Every survey should be full & comp

-ete; and not say - "Jones lower

Corner is Dick's upper Corner & Pills

Beginning Cor. is Harry's NE Cor, which

is but an imaginary one at best (Post

and mound) five thousand yds from a Post

Ex. What is "Diaphragm"? Ans "Midriff"

What is "Midriff"? Ans "Diaphragm"

Next Bend  
Above Sea No 1 2nd Line no Corridor for

90  
96

" " 3 2nd Cor, not found

" " 5 Outer corners not established

6 Upper Line not run

" 1/3 off of same Inner work not done

" 1/4 " 8 mile point 4<sup>th</sup> & 3<sup>rd</sup> Cor not Est.

(1/3 off 6 - Why say not run on upper line.)

Labors N 7 Corner at the end of 3<sup>rd</sup> Course

Town Tract not finished in plot.

Meandering of the Labors from Ingram to Texas

Base line above San Felipe - See Ingram's book

page 18 & 19 - Record not finished page 50

10/11/07

*[Faint, illegible cursive handwriting, likely bleed-through from the reverse side of the page.]*

*[Faint, illegible handwriting, possibly a signature or initials.]*

X?



99 Benjamin Babbitt Benj Babbet *Seed made out*  
 Three fourths of a league situated on the  
 Left bank of Mill Creek above and adjoining  
 the Hacienda of land granted to Cummings  
 Beginning on the western boundary of said Hacienda  
 on the bank of said creek; Thence  
 N 21 1/2° E with ~~the~~ said western boundary 2790 vs to the  
 North west corner of the aforesaid Hacienda.  
 Thence

N 43° E with the lands granted to Nichols 2604  
 vs to another corner a

Post { Black Jack <sup>15.40 E.</sup> 79 vs  
 Do " <sup>583 E.</sup> 86 " Thence

N 47° W ~~with the back line~~ to a point from  
 which a line running South 43° West  
 to the bank of said Mill Creek, and

OKe. <sup>to be inserted in</sup> thence down ~~with~~ the same with the mean  
 vol 10 p 25 <sup>Austin County</sup> class thereof, to the place of beginning  
 will comprehend an area of ~~two~~  
 eighteen millions seven hundred  
 and fifty thousands square varas  
 of land or three quarters of a  
 League

See Book T 40



Copied by  
 C. D. Johnson

1798 received Oct 3/35. Vol 10. p 17  
 1835  
 1840

Deeds - 100<sup>00</sup>

Alexander Ewing 1/4 League

Situated west of Cummings Creek adjoining  
 the land granted to Hensley & Peebles.

Beginning at the South Corner of a league no 8  
 granted to said Hensley which corner is a  
 post and mound. Thence

1<sup>st</sup> N 43° E with the North west boundary of league  
 no 10 <sup>2917</sup> to the East Corner of said one fourth league  
 a Post { Post Oak N 4.00  
 do N. 39 W. 4.00  
 do S. 45 E. 14.00 Thence

2<sup>nd</sup> N 47° W 2142<sup>00</sup> to the South East boundary of R.  
 Peebles league a

Post { Post Oak N. 72 W. 7.00  
 do S. 60 E. 7.00 Thence

3<sup>rd</sup> S 42° W with the south east boundary of said league  
 granted to R. Peebles 2917 vs to the South  
 Corner thereof a

Post { Post Oak S. 20 W. 9.00  
 do N 72 E. 1.00 Thence

4 S 47° E with the North East boundary of league no 8  
 2142 vs to the place of beginning



Copied by

R. D. Johnson

To be issued Oct 3/35 Vol 10 p 95

N<sup>o</sup> Henry Winburn

Winburn Seed made out  
4 1/4 League granted to the Henry Winburn  
Situatd on the waters of the yearua adjoin  
ing the lands of ~~the~~ Friess, Miller & Holdermans  
Beginning at the S W corner of said Friess league  
Post { Post Oak  $\frac{N. 86^{\circ} W. 16^{\circ} 00'$   
Do  $\frac{S 17^{\circ} W. 27^{\circ} 00'$  Thence

N 35 W with Friess western boundary 1200 vs. to  
a corner on said boundary line

Post { Post Oak  $\frac{S 55^{\circ} 6' W 9'$   
Blick Jack  $\frac{N. 1^{\circ} E. 12^{\circ} 00'$  Thence

S 55 W 518 vs to another corner of said 1/4 league

Post { Post Oak  $\frac{N. 3^{\circ} W. 9'$   
Do  $\frac{S. 32^{\circ} E. 12'$  Thence

S 35 E 265 vs to the ~~west~~ Northern corner of Miller's  
league Post { Post Oak  $\frac{N. 1^{\circ} W. 4^{\circ} 00'$   
Do  $\frac{N. 65^{\circ} W. 11^{\circ} 00'$  Thence

S 45 E with Millers line 2966 to the western corner  
of a league granted to the same Thence

N 45 E with the north western boundary of said league  
3500 vs to the Northern corner thereof  
on the south western boundary of Holdermans  
one fourth league.

Post { Post Oak  $\frac{N. 80^{\circ} W. 3^{\circ} 00'$   
Do  $\frac{N. 28^{\circ} E. 13^{\circ} 00'$  Thence

N 45 W with Holdermans line to the west corner  
of his land. a Post { Cedar  $\frac{S. 70^{\circ} 11^{\circ} 2'$  vs  
Do  $\frac{N. 59^{\circ} 48'$  Thence

N 45 E with Holdermans N W boundary 137 vs to a corner  
on said boundary, ~~and~~ Post { Post Oak  $\frac{N. 75^{\circ} 11^{\circ} 2'$  vs  
Do  $\frac{N. 75^{\circ} 11^{\circ} 2'$  Thence

S 55 W with Friess southern boundary to the place of beginning  
Class 1. temporal 5. agostadum

Copied by  
R. D. Johnson

June 1837

Wednesday 7 Oct 1702

102

Pro. *Quinta* for one  $\frac{1}{4}$  League

*Book*

*[Faint, mostly illegible handwritten text, likely bleed-through from the reverse side of the page]*

103

AN. — Title made

Field Note of a quarter of a league

Enoch Patham } Title made AN

Situated East of the Brazos  
 river north of the league granted to  
 Randon & Pennington and East of a  
 league granted to Churchill Fulcher  
 Beginning at the North West  
 Corner of the league granted to Ran-  
 don & Pennington on the East boundary  
 of said Fulcher's league six vars from  
 a Black Jack bearing S 25° E and 12  
 vars from a Black Oak bearing S 46° W  
 Thence

North with said East boundary of  
 Fulcher's 2612 vs to the Corner  
 on said boundary. Thence  
 East 2393 vs to the N.E. Corner of the  
 said quarter of a league  
 Thence

South 2194 vs to the N.W. Corner of a  
 tract granted to John Foster containing  
 same course 415 vs making the whole line  
 2612 vs to the N.E. corner of ~~the~~ league granted  
 to Randon & Pennington. Thence

West with the North boundary of said league 2393 vs  
 to the place of Beginning —

Copied by R. A. Johnson  
 44-2 bp  
 1904 (ms) Dec 6 for vol 10 p. 61  
 Dec 10 1860

Little inwood Oct 7/35 Vol 10 p 65  
Fort Bend Co. Texas

Edward P. Whitehead. 1/4 League

Situated East of the Brazos back and adjoining the land granted to Isaacs & Knight & White.

Beginning at the North West Corner of Said Isaacs League

Thence North 820 vs to the North East Corner of a league granted to Andrews, continuing the same course 941 vs more, making the whole line 1761 vs to the NW Corner of Said Quarter

Thence East 3549 vs to the North East Corner, Thence South 1761 vs to the South East Corner on the North boundary line of the league granted to the Said Knight & White Thence West with Said North boundary 1450 vs to the North West corner of said league of Knight and White, continuing same course with the North boundary of the league granted to Isaacs 2099 vs to the place of beginning

2099  
1450  
1549  
1799

2099  
1450  
649  
2099

AN Title made

Copied by  
Robt. D. Johnson

Thomas O Berry  
1000 Title issued Oct 24/35  
Vol 10 - p 309 - Fayette Co

Thomas O Berry

League No. 2 situated  
on the head waters of Navidad above the  
Labakia road in Tho. H. Bordin's survey  
made this year 1835.

Beginning at the S E corner of League No.  
2 on Buckness Creek at a mound - Thence  
South 3900 vs intersected the North boundary  
of League No 21 on the Navidad

~~Post~~  
Post { Live oak  $\frac{1}{N. 68 E.}$  477 vs  
Thence.

West 1640 vs to the N.W. corner of said league  
No. 21 - a Post { a bunch of Oaks  $\frac{1}{N. 80 W.}$  800 vs  
Thence

South with the west boundary of said league 2000  
vs a Post and mound; Thence

West 2800 vs to another corner  
Post { ~~Live oak~~  
Live Oak marked 'B'  $\frac{1}{N. 6 W.}$  60 vs  
Thence

North 7856 vs to the NW corner of the league  
herin mentioned on the south boundary  
of League No 3 on Buckness Creek

Post { Post Oak mk B  $\frac{1}{N. 52 W.}$  3  
" " " "  $\frac{1}{N. 52 W.}$  4  
Thence

East with said south boundary 1580 vs.

to another corner on the west <sup>105</sup> ~~108~~  
 boundary of league No 2 on said  
 Buckners Creek - Thence  
 South with said west boundary 1956 vs to  
 the south west corner of said league  
 No 2 -   
 Port of  $\left\{ \begin{array}{l} \text{Port Oak mk. N } \frac{7}{8} \\ \text{do } \dots \text{ } \frac{4}{10} \end{array} \right.$   $\frac{535}{1610}$  vs.  
 Thence  
 East with the South boundary of said  
 league No 2 - 2860 vs to the place  
 of beginning  
 Ex

AN *W. Borden*



Copied by  
*Robt. D. Johnson*  
 June 15. 1837  



# 107

# Jesse Richards League No 8

Situated between the Navidad and La Vaca Creeks west of the Sabatin road and north of the road leading to Gonzales

Beginning at the south west corner of League No. 12 on Mulberry Fork  
Post { Live Oak mk  $\frac{334}{7}$  W 5607  
Do "  $\frac{1}{1}$  N 73 W 37

Thence

West with the south boundary of League No. 7 of the new surveys 5142 vs to the S.W. corner of said League No. 7 a  
Post { Live Oak mk  $\frac{528}{1}$  3907  
Do -  $\frac{1}{1}$  N 78 E

Thence

North with the west boundary of said League 1750 vs. to ~~post~~ a corner on said boundary Post { Post Oak <sup>mk</sup>  $\frac{545}{7}$  3  
Do  $\frac{1}{1}$  N 45 E 3

Thence

West 1858 vs to the NW corner of said League No 8  
Post { Post Oak mk  $\frac{1438}{7}$  301  
Do  $\frac{1}{1}$  S 82 W 507

Thence

File in med. Oct 10/85. Vol 10, p. 105. Gayette Co

South 5375 vs to the SW corner a

Post. { Post Oak +  $\frac{1}{4}$  N 26 W 100 rods  
Live Oak - A East 9 rods

Thence

East 7000 vs to the South East corner  
of said league No 8.

Thence

North 3625 vs to the place of  
beginning

AN. Title made



Copied By

Robt. D. Johnson

June 10. 1837

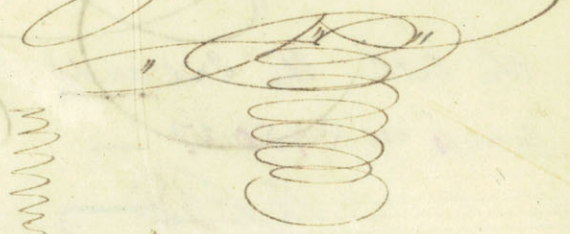

109

Tit Oct 5/35 July 10. p 57 Montgomery Co.

8

Archibald M. Alexander 1/4 League

Situate on Lake Creek South & adjo-  
 ining the 1/4 of league granted to William  
 W Ford Beginning at the S. E. corner of a  
 league granted to Noah Griffith which also  
 the S. W. corner of S. 1/4 of Ford 15 ors from  
 a Spanish oak noted & being N. 25° E. Thence  
 East with the S. boundary of S. Ford's  
 quarter 2557 varas - to the S. E. corner there-  
 of 73 ors from a Post oak being N 26° W. & 97 ors  
 from do by N 19° E. Thence

South <sup>2450</sup> 2444 ors to the S. E. corner. Thence  
 West 2557 ors to S. W. corner. Thence  
 North <sup>2450</sup> 2444 ors to place of beginning  
 AN Title made



Montgomery County

In the title the 2nd and  
 4th Courses are 2450 ors

WBD

Copied by

Robt Johnson

League C situated on the Sabahia Coast East of the Navarota

Beginning at the South Corner of a League known as League B a

Post { Post O. N. 138 501  
Do N. 62 E. 941 Thence  
S 52 E 500 vs. to a Corner of said League C a

Post { Post O. N. 62 W. 1311 Thence  
Do N. 21 W. 411  
S 10 W 626 vs to another corner on the

Northern boundary of a League surveyed for Sines 97 vs. westerly of Sines at a corner

Post { Post O. N. 45 W. 801 Thence  
Black S. N. 87 E. 1401

N 80 W with Sines Northern boundary 4903 vs to the NW corner, con-

tinuing same course 2661 vs making the whole line 7564 vs to the South Western Corner of said League C a

Post { Post O. N. 41 W. 401 Thence  
Do N. 72 E. 2801

N 10 E 4500 vs to the North Western corner a Post { Post O. N. 63 W. 401  
Do N. 19 E. 941 Thence

S 80 E 5211 vs to another corner on the western boundary of League B a Post { Post O. N. 58 W. 2201  
Do N. 38 E. 401

Thence S 38 W with the western boundary of said League B 2300 to the western corner thereof Thence

S 52 E with the Southern boundary 3400 vs to the place of begin-

Copy of the Map of the

Henry Parker One League

Situated on Trespaacios west of the Colorado at or near the crossing of the La Vaca & Brazoria road.

Beginning on the North boundary line of a quarter of a league of land known as No 35 on a small creek called Juavito seven hundred and seventy two varas East of the North west corner of said quarter

Thence

East with said North boundary 2278 vs to the North ~~west~~<sup>east</sup> corner of said quarter No 35

Continuing same course with the upper or north boundary of league No 30 - 6638 varas <sup>in all 8912 vs</sup> to the South East corner of the league herein added on the North boundary of league No 30 Thence

North 2805 vs to the North ~~west~~<sup>east</sup> corner Thence

West 8912 varas to the North west corner Thence

South 2805 vs to the place of beginning - Copied By

E. R. Wightman  
Surveyor

R. D. Johnson

Handwritten notes in red ink: #111, 5000 vs used July 5/33. 96.8 p. 21

Neah Barnes League No 3 Situated  
on the waters of Navidad and Buckner  
Creek west of the Labadie road.  
Beginning at the Street Corner of League No  
2 surveyed for Berry a

Post { Live Oak mk B  $\frac{1}{2}$  NW 6000  
Thence

South 2250 vs. to the South East Corner a

Post { Willow in the head of a hollow mk  $\frac{1}{2}$  NE 677  
Thence

West 4000 at 1900 vs crossed Cedar Creek, at 3750 crossed  
a fine Spring Branch at 4000 vs to the  
Street Corner a

Post { Black Oak mk  $\frac{1}{2}$   $\frac{1}{2}$  SW 5000  
Thence

North 6250 vs to the North West corner a

Post { Post Oak mk H 202 5000 a  
Do "  $\frac{1}{2}$  SW 7  
Thence

East 4000 vs - at 300 vs crossed small creek running  
to the left 2000 vs crossed Cedar Creek  
running to the left 4000 vs to  
the NE Corner on the West boundary  
of said league No. 2 a

Post { Post Oak mk B  $\frac{1}{2}$   $\frac{1}{2}$  NE 200  
Do "  $\frac{1}{2}$  SE 100  
Thence

South 4000 vs to the place of beginning

W  Or 

Rd. Johnson  
Esq.

183

Salathiel Knight  
Title issued Oct 35  
Sayetta Co

L. J. Knight League No. 4 situated  
on the Sabahia road on the head waters of  
the Navidad

Beginning at the south west corner of  
a league granted to Richard Smith known as  
league no 21 in the old surveys a

Post { Black Jack X  $\frac{1}{2}$  15 10 1/4 vs.

Thence

South 3000 vs with the west boundary of league  
no. 19 to the South East corner of the  
league herein described a

Post { Black Jack  $\frac{1}{2}$  18 9 1/2 70 vs  
Do  $\frac{1}{2}$  17 10 1/4 24

Thence

West 6500 vs with the north boundary of league  
nos 13 & 16 to the South West corner on  
the north boundary of league no 13 a

Post { Post Oak mk A  $\frac{1}{2}$  14 1/2 2 27 vs

Thence

North 2750 vs with the west boundary of League  
no 8 in the new surveys to the South West  
corner of League no 3 a

Post { Black Jack mk  $\frac{1}{2}$  15 10 5 vs and a  
Do mk  $\frac{1}{2}$  15 9 1/2 5

Thence

East 4000 vs with the South boundary of league  
no 3 to the South East corner thereof a

Post { Willow standing in the head of a hollow  
marked  $\frac{1}{2}$  15 3

Thence

North 2280 <sup>114</sup> vs with the East boundary of said league  
va 3 to another corner on said East boundary

Thence 114

Post { Live 0 mi B. <sub>N 6 W.</sub> 6000 Thence

East 2800 vs with a south boundary of league va  
2 to the North East corner of the league  
herin described on the West boundary  
of the said league va 21 a mound.

Thence

South with the west boundary of said league  
2000 vs to the place of Beginning

Ex J. W. Gordon

AT Teste Made

Copied By

R. D. Johnson



115  
1  
Part of wood Oct 16/35  
Vol 10, p. 177  
Baker of Wash  
11/19

Eliza Peak League A situated

on the Yigua adjoining a league granted  
to James Cox. Beginning at the NW  
corner of said Cox's league a

Post { Pin Oak  $\frac{4703}{N11E}$  34 vs  
Do  $\frac{N11E}{34}$  vs

S 85° E  $\frac{3654}{2645}$  vs with the northern boundary of said  
league to the North East corner thereof

Post { Elm  $\frac{220}{N22W}$  2 vs.  
Cedar  $\frac{492}{N49E}$  5 vs. Hence

S 5° E 470 vs with his the said Cox's Eastern  
boundary to another corner on said boundary  
Hence

N 45° E 4452 vs with the N West boundary of  
Hanks league to the East corner  
of the league herein described. Hence

N 45° W 4750 vs to the North corner  
on the SW boundary of a league known as league B granted  
to James Lastly a

Post { Post oak  $\frac{5300}{N51W}$  10 vs  
Do  $\frac{N51W}{3}$  vs. Hence

South 45° W 5070 vs with the South East  
boundary of league known as league B  
to the South corner thereof a

Post { ~~Pin Oak~~  $\frac{1790}{N79W}$  9 vs Hence

S 35° E 1900 vs to another corner a

Post On k  $\times 15 \frac{1}{2}$  6 and a 116 ~~7~~  
Post { Gum-Elastic  $\times 15 \frac{1}{2}$  3 vs. Three

S 55° W 1070 vs to the place of begin-  
ning

Co  
W. Borden

AT J. H. made

Copied By  
R. D. Johnson

Edwards Arriola Same as Book  
Dolores Arriola League B situated  
on Pidas Creek South of the San  
Antonio road

Beginning at the  
Western Corner of said league which  
is also a corner known as league C  
Post { Post 0  $\frac{5000}{7}$   
Do  $\frac{132}{40}$  Thence

Copied by J. P. Johnson

N 88 E 7352 At 5300 v crossed creek  
to the northern corner of the  
league herein described a  
Post { Post 0  $\frac{492}{13}$   
Do  $\frac{1627}{13}$  Thence

S 52 E 3400 v at 2520 v cross road  
to the Eastern corner a  
Post { Post 0  $\frac{402}{13}$   
Do  $\frac{13710}{13}$  Thence

S 38 W 7352 v at 1100 v entered creek bottom  
at 1580 crossed creek  
to the Southern corner a  
Post { Post 0  $\frac{1}{8}$   
Do  $\frac{132}{9}$  Thence

N 52 W 3400 v at 1700 v crossed road  
to the place of beginning.

Or 

Dolores ~~Arriola~~ of the Title issued Oct 16 35. 118 ~~118~~  
Vol. 10. p. 15.  
D. N. Madison League by Settlement  
on the waters of Bidais Creek

Beginning at the North West corner  
of a league known on the plot as league E a

Post { Post Oak 4 1101  
do 4 3328 Thence

N 10° E 4326 v. at 074 v. to the N E corner  
of league F granted A. Brown  
Continuing same course 3652 v.  
more making the whole line 4326  
v. to the N W corner of the league  
herein described a

Post { Post Oak 4 7327  
do 4 2229 Thence

S 80° E 5778 v. to the North East corner a.

Post { Post Oak 4 6225  
do 4 4143 Thence

S 10° W 4326 at 1700 crossed a Creek

to the South East corner and the  
North East corner of league E a

Post { Post Oak 4 7214  
do 4 5211 Thence

N 80° W 5778 v. with the northern boundary  
of league E a to the place of

Beginning at the made to Dolores  
Arriola

See #

Copied by: R. J. Johnson

~~119~~ Mill No. 119

League S situated on

the head waters of Bidair Creek East of  
the Pragos beginning at the South West corner  
of a league known as A a

Post { Black Jack  $\overline{N 42^{\circ} 21' W 21}$   
Do  $\overline{N 76^{\circ} W 6}$  Thence

S 10 W 4577 vs to the South West corner a

Post { Black Jack  $\overline{N 8^{\circ} W 7}$   
Post Oak  $\overline{N 43^{\circ} 23'}$  Thence

S 80 E 2760 vs to another corner on the western  
boundary of league May. a

Post { Post Oak  $\overline{N 75^{\circ} W 8}$   
Do  $\overline{N 63^{\circ} E 14}$  Thence

N 20 <sup>0</sup> 1270 vs with the western boundary of  
said league vs to the North West corner  
thereof a

Post { Post Oak  $\overline{S 68^{\circ} E 2}$   
Do  $\overline{N 4^{\circ} E 12}$  Thence

S 70 E <sup>4180</sup> ~~4920~~ vs with the northern boundary of said  
league vs to the South Eastern corner  
of the said league S Thence

N 10 E 4970 vs with the western boundary of a  
league known as R to the North  
Western corner thereof a

Post { Black Jack  $\overline{N 47^{\circ} E 8}$   
Do  $\overline{S 62^{\circ} E 7}$  Thence

Thence 120 ~~##~~

N 80° W 520 vs with the southern boundary of league  
P to the south western corner thereof a

Post { Post oak N 42 E 7  
Do N 55 W 8

Thence

S 10° W 1085 vs with the eastern boundary of <sup>said</sup> league  
known as Q to the South East corner  
thereof a

Post { Post oak N 20 W 2  
Do S 61 W 4

Thence

N 80° W 5500 vs with the southern boundary of  
said league Q to the place of  
Beginning

Es.

AN Title made



Copied By

R. D. Johnson



June 11. 1837.

File issued Oct 16 55. Vol 199 135  
Madison Co. No 8

Leaster Robinson  
League N situated  
on the Bidais Creek adjoining a survey  
made for Sims on the Sabahia road  
beginning at the South west corner  
of a league known on the plot as league M.

Post { Post Oak  $\frac{1}{44}$   $\frac{1}{16}$  vs  
Do  $\frac{1}{5707}$  vs  
Thence

S 10° W 3100 vs to the South west corner of the  
league herein described. a

Post { Post Oak  $\frac{1}{1400}$   
Black Jack  $\frac{1}{85813}$  vs  
Thence

S 80° E 7219 vs at 2980 vs crossed creek  
at 5876 vs crossed another creek  
to the South East corner on the  
Western boundary of said league  
surveyed for Sims. a

Post { Post Oak  $\frac{1}{56015}$   
Do  $\frac{1}{64010}$   
Thence

N 10° E 4084 vs with the western boundary of said  
league of Sims to the North west  
corner thereof Thence

N 80° W 2661 vs to the South west corner of  
a league known as C a

Post { Post Oak N. 14 E 4  
do N. 12 E 8  
12  
Thence

S 10° W 9840 to the South East Corner of said  
league M a

Post { Post Oak S. 12 E 14  
do N 70 E 4  
Thence

N 80° W 4558 or with the Southern boundary  
of said league M to the place  
of Beginning

Ed

Tithe made



Witness By Robt. D. Johnson

11<sup>th</sup> June 1837



"D. D."  
A vertical decorative flourish consisting of a series of small, repeating loops, resembling a stylized 'm' or a calligraphic flourish.



Land of the Mahan League T situated between the waters of the Navasota and Bidais Creeks adjoining leagues Nos. 6 & 7 near Mrs. Andersons.

Beginning at the North West Corner of League No. 6 a

Post { Black Jack N 28 E 7  
Post Oak N 34 W 11  
Thence

N 80 W 135.6 to the South West Corner of the League herein described a

Post { Post Oak N 18 E 2  
Do N 72 W 15  
Thence

N 10 E 5131 to the North West Corner of

Post { Post Oak N 55 E 9  
Do N 38 W 17  
Thence

S 80 E 3816.0 to another corner on the western boundary of league S a

Post { Post Oak S 72 W 10.01  
Do N 40 W 6  
Thence

S 10 W With the western boundary of said League known as S to the South West Corner thereof a

Post { Black Jack N 8 W 7  
Post Oak N 43 W 23  
Thence

124 ~~124~~  
Thence

South 80° East 2760.00 with a Southern boundary of said  
League D to another corner on the  
western boundary of said League No 7 a

Post { Post Oak \$ 75.00 w.  
do N. 63 E 10 w.

Thence

S 20° W. 2090.00 with the western boundary of  
League No 7 to the North East corner  
of League No 6 a

Post Oak \$ 68.80  
Post { do \$ 4.00 1/2

Thence

N 80° W 5000.00 with the northern boundary  
line of said League No 6 to  
the place of Beginning.

Or

AN Title mass



Copied By

Robt D. Johnson  

125

9

A. Sec

League U situated on

the waters of Bidais Creek.

Beginning at the South West Corner of said League which is also the North West Corner of a league known as league O a

Post { Post oak N 62 E 13 vs  
Do. N 17 E 4

Thence

S 80 E 5000 vs. at 2174 vs crossed a creek

with the northern boundary of said league O to the North East corner thereof a

Post { Post oak N 73 E 13  
Spanish oak N 17 E 5

Thence

N 10 E 4545 vs. at 1550 crossed a creek

with the western boundary of a league known as league M to the North West Corner thereof a

Post { Post oak N 79 W 32 vs  
Do N 23 E 23 vs.

Thence

N 80 W 5500 vs with the Southern boundaries of leagues E and F to the South West Corner of said league F a

Post { Post oak N 66 W 18  
Do N 53 E 13

Thence

M. J. G. C.

Thence 120  
S 10° W 4545 or with the Eastern boundary  
of leagues K and W to  
the place of Beginning

Ex. W. Borden

Copied by

R. S. Johnson

June 14 1837

William Townsend  
Reviewed Oct 26/53  
Vol. 10, p. 253.  
Grimes of Madis on Co.  
1853

127 / 3

Journal

League Q situated on

Pidais Creek

Beginning at the South East corner of said league a

Post { Post Oak N 20 W 2  
Do S 61 W 4  
Thence

N 80° W 5500 vs with the Northern boundary of league S to the North West corner thereof a

Post { Black Jack N 42 21  
Do N 67 W 6  
Thence

N 10° E 4545 vs with the Eastern boundaries of leagues U and V to the North West corner of said league Q a

Post { Post Oak N 87 E 11  
Do S 77 W 5  
Thence

S 80° E 5500 vs with the Southern boundary of league Q to the South East corner thereof a

Post { Post Oak N 58 W 20  
Do S 42 W 12  
Thence

Thence

128

S 10° W 4545 vs with the western boundary  
of leagues P and R to the place  
of Beginnings

Ex.

J. Borden for

W

Copied By

R. D. Johnson

June 11<sup>th</sup> 1837

128

129  
Same as B. G. p. 203

W. M. Flukeys League A situated  
on the La Bahia road on the waters of  
Bidair Creek East of the Brazos river  
Beginning at the South West corner of  
a league on sayre road south of Sims  
granted to Land Bowman

Thence

North 80 West 2200 v at 9600 cross a branch of  
to the North West corner  
of the said league A

Post { Post Oak \$ 29<sup>2</sup>/<sub>11</sub> v  
Do \$ 1<sup>3</sup>/<sub>32</sub> v

Thence

S 10° W 4859 v at 2500 entered prairie  
at 3800 v left prairie  
at 3900 road

to the South West corner on  
the northern boundary of league  
No 2 north of Mrs Andersons  
league a

Post { Post Oak \$ 23<sup>4</sup>/<sub>5</sub>  
Do \$ 85<sup>2</sup>/<sub>25</sub>

Thence

S 70° E with the northern boundary of said  
league No 2 2184 v to the  
North east corner thereof

Thence

2070  
S 80° E 2696 W to the South eastern <sup>130</sup> corner  
of the league herein described a

Post { Post Oak  $\frac{N 49^{\circ} E 10}{Black Jack \frac{1}{5} 810 W 9}$

Thence  
N 10° E 5230 W to the North East corner  
of said league on the Southern  
boundary of the league granted  
to the said Saul Bowman a

Post { Post Oak  $\frac{163 W 9}{Oak}$

Thence  
N 80° W 2650 with the <sup>Said</sup> Southern boundary  
to the place of beginning

Ex <sup>Part Key</sup>

Witness made AN

Copied By  
R. D. Johnson



131  
FILED in and Oct 20 1854 Vol 10 p 43  
Layton

Joseph Mc Callister

Joseph McAlister 1/4 League  
situated on the waters of Buckners  
Creek

Beginning at the south East corner of  
said quarter on the North boundary of league  
No 9 granted to J. G. W. Pearson a

Post { Post oak mk L 21/104 vs  
Do " + 2081 vs  
Thence

West 1250 vs with the north boundary of the  
said Pearson to the south East  
corner of three quarters of a league  
granted to Tho. Thompson

Thence  
North 5000 vs with the East boundary  
of said Thompson to his north  
East corner. Thence

East 1250 vs to the north East corner  
of the one fourth league herein describe

Post { Post oak mk. M 163/103  
Do " + 18767  
Thence

South 5000 vs to the place of Beginning

Ex. J. Jordan Little made  
Copied by  
Chas. Johnson

~~Along~~ ~~Pratnight~~ League M situated on <sup>132</sup> ~~34~~  
the waters of Bidais Creek south of the  
San Antonio road.

Beginning at the South West Corner of said  
League on the eastern boundary of League O a

Post { Post Oak N 68<sup>o</sup> 16 vs  
Do S 57<sup>o</sup> 45 Thence

S 80<sup>o</sup> E 4558 vs with a northern boundary of a  
league granted to Doraster Robinson  
to the South East corner of the league  
herin described a

Post { Post Oak S 12<sup>o</sup> 6 1/4  
Do N 70<sup>o</sup> 24 Thence

N 10<sup>o</sup> E 5484 vs with the western boundary of said  
Robinsons league 984 vs and 4500 vs  
with the western boundary of a league  
granted to S. Stees to the North  
West corner thereof which is also the  
NE corner of the league herin described

Copied by  
Dor Robinson

Post { Post Oak N 63<sup>o</sup> 34  
Do S 12<sup>o</sup> 9 Thence

N 80<sup>o</sup> W 4558 vs with the southern boundary of league  
E to the NW corner of the said league

M a Post { Post Oak S 72<sup>o</sup> 32  
Do S 23<sup>o</sup> 23 Thence

S 10 W 5484 vs with the Eastern boundary of league  
L & O to the place of beginning.



James W. Moore

Pat. issued Oct 20/35. Vol. 11, p. 237  
Grimes Co. 228

W. Moore

League R. situated

on the East side of the Brazos on the waters of Bidais Creek

Beginning at the South West Corner of a league granted to Pankay on the northern boundary of a league known as league No 2 North of Mrs Andersons

a Post { Post Oak 173 W 5 v  
Do. N 85 E 25 W  
Thence

North 10° East 4859 v with the western boundary of said league granted to Pankay to the North West Corner thereof a

Post { Post Oak 129 E 11  
Do. N 43 E 3  
Thence

S 80° W 2200 v with the northern boundary of said league to the South West Corner of a league granted to Bowman Thence

N 10° E 1950 with the western boundary of said Bowmans league to the North East Corner of the league herein described

Post { Post Oak 162 W 5  
Do. N 36 W 6  
Thence

73 73  
73

Thence

134

N 80° W 5449 vs with the Southern boundary of a league known as league P to the North West Corner of the said league R on the Southern boundary of S<sup>d</sup> league P

Post } 1 Black jack  $\frac{N 47^{\circ} E}{62}$   
Do } 1 Do  $\frac{S 62^{\circ} E}{62}$

Thence

S 10° W 4970 vs with the Eastern boundary of the league granted to M. Mc Dowell to another corner on the Northern boundary of league No 7 near Mrs. Anderson's a Post.

Thence

S 70° E 740 vs with the northern boundary of said league No 7 to the North East corner thereof a

Post } Post oak  $\frac{N 81^{\circ} E}{61}$  61 yards

Thence

S 20° W 1250 vs with the Eastern boundary of said league No 7 to the North West corner of league No 2

Thence

S 70° E 2816 vs with the northern boundary of said league No 2 to the place of Benjamin D

Copied by [Signature]

Simon Jones

135

League F. Situated ~~at~~

on the Bidais Creek East of the Brazos  
beginning at the South East corner  
of said league which is also the South  
West corner of a league known as league

D a Post { Post oak  $\frac{1}{2}$  1/2  
Do. N 43 W 4  
Thence

N 80° W 5578 vs with the northern boundary  
of league C - M & I. to the  
South East corner of league F  
granted to Crownover a.

Post { Post N 52 2' 17 Paces  
Do. N 45 W 7000 paces  
Thence

N 70° E 4326 vs with the eastern boundary  
of said Crownover to the South  
West corner of the league herein  
described a

Post { Post oak  $\frac{1}{2}$  11 paces  
Do. N 81 2  
N 33 E  
Thence

S 80° E 5778 vs with the southern boundary  
of league C granted to  
Arriola do the South East  
corner thereof a

Post { Post oak  $\frac{1}{2}$  7 E 14  
Do. N 52 W 11

35  
130

Thence

S 10° W 4326 with the western boundary of  
League D to the place of beginning.

Es  
Bordeny



Copied By

Robt. L. Johnson



June 14<sup>th</sup> 1837



37  
137

Title issued Oct 24/35 Vol 10, p 321  
Grimes Co.

# Timothy Jones League No 6 Situated

between the head waters of Navasota and Bidair Creek near Mrs Anderssons  
Beginning at the North East corner of said league on the Western boundary of league No 7 a

Post { Post oak  $\frac{N 20^{\circ} W}{7} 321$

Thence

N 70° W 5000 vs with the Southern boundary of a league granted to Mc Chapin

Post { Black Jack  $\frac{S 28^{\circ} E}{7}$   
Post oak  $\frac{N 84^{\circ} W}{7}$   
Thence

S 20° W 5000 vs to the North West corner of league No 4 granted to Mc Donald a

Post { Post oak  $\frac{N 2^{\circ} E}{10}$   
Do  $\frac{N 69^{\circ} E}{15}$

Thence

S 70° E 5000 vs with the northern boundary of said league No 4 to the North East corner thereof

Post { Post oak  $\frac{S 67^{\circ} W}{20}$   
Do  $\frac{N 85^{\circ} E}{14}$

Thence

N 26° 05' 00" W with the western boundary  
of leagues Nos. 34 & 7 to the place  
of beginning

Ex 

Copied By

Robt D. Johnson 

*[Faint, mostly illegible mirrored handwriting, likely bleed-through from the reverse side of the page]*



File record Oct 12/55 Pol 10 p 121  
Haystack Co. MS

William H. Fry  
League No. 1 New Survey

Situated west of the Colorado river  
on the Sabahua road between the Nav  
idad and Buckners Creeks.

Beginning at <sup>the south west corner of said league which is</sup> a corner of league No. 2  
of the new Survey on the north boundary  
of league No. 21 on the head waters of  
Navidad Creek granted to Smith  
which corner is a

Post Live oak marked T No. 4770  
Thence

North with the east boundary of league  
No. 2 3900 vs to the North East corner  
of said league continuing same  
course with the east boundary  
of league No. 2 on the South of  
Buckners Creek 1969 vs further  
making the whole line 5869 vs to  
the South west corner of league  
No. 1 on said Buckners Creek

Thence  
East ~~3410 vs~~ with the south boundary of league No. 1  
crossing the Sabahua  
road on said line 3410 vs to the  
South East corner thereof, a mound  
in the prairie - Thence

Wm. H. Fry  
John W. Johnson

North with ~~the~~ the East boundary of said  
league <sup>no 1</sup> 2756 vs to the South west  
corner of a quarter of a league  
on Buckners Creek granted to  
Lewis a

Post { Post o. mk M  $\frac{65^{\circ} E}{7} 1901$   
Do " T. A  $\frac{69^{\circ} W}{18} 1800$   
Thence

East 340 vs with the South boundary of  
said quarter to the western corner  
of a league on the Colorado river  
granted to Paul Berry a

Post { Live oak mk S  $\frac{7^{\circ} W}{7} 340$   
Do " E  $\frac{62^{\circ} W}{7} 33$   
Thence

S 45° E with the back line of said Berry's  
league 1300 vs to another corner  
of the league herein described on said  
back line of Berry's. Thence

S 10 1/2° W 7800 vs to the South East corner  
of said league <sup>herein described</sup> on the north  
boundary of the aforesaid league  
vs 25. Thence

West with said ~~line~~ north boundary  
to the place of beginning.

Copied By R. D. Johnson

Geo. J. Bordrup

~~13~~ 141  
~~131~~

J. Boatwright  
Friend Boatwright

Title in 0225/35  
Vol 10. p. 285

League V on the See Co  
add

head waters of the ~~up~~ ~~of~~ ~~the~~

Beginning at the South Corner of  
said league on the N.W. boundary of league V a

Post oak  $\frac{1}{34}$   $\frac{11}{13}$  or.  
Do. N.  $\frac{3}{5}$   $\frac{16}{16}$   
Thence

N 45° W 7033 vs to the west corner a

Post oak  $\frac{1}{192}$   $\frac{14}{14}$   
Do.  $\frac{1}{892}$   $\frac{22}{22}$   
Thence

N 45° E. 4300 vs to the North Corner  
of said league on the South  
west boundary of league known  
on the plot as league R a

Post oak  $\frac{1}{44}$   $\frac{11}{33}$  or  
Do. West  $\frac{3}{12}$   
Thence

S 45° E with the said South west  
boundary of said league  
3283 vs to another corner

on the northern boundary of a  
league surveyed for ~~Frank~~  
Thence

S 55° W with said northern bound.

July 10 30 vs to the north west  
corner of said league surveyed for  
Franks Thence

S 35° E 4000 vs with the western bound-  
ary to his south west corner  
Thence

S 45° W 2696 vs with the north west  
boundary of league TW to the  
place of Beginning

Es.

W. Borden

Copied By Rob. D. Johnson

June 11<sup>th</sup> 1837

45 Jas. Buchanan *with me: Oct 19/35*  
143 *Vol 10. p 213.*

League F situated Burbank Co

North of the Yegua  
Beginning at the Southern corner of  
said league on the North west boundary of  
league known as K a

Post { *Post oak N 37 E 11*  
*do N 37 W 19*  
Thence

N 45° W 4705 vs with the North east boundary  
of league I to the west corner of said  
league F a

Post { *Post oak N 61 E 11*  
*do N 45 W 11*  
Thence

N 45° E 5313 vs to the Northern corner  
which is also the Western corner  
of league No 11

Thence

S 45° E 4705 vs with the South west boundary  
of league No 11 to the eastern  
corner of said league F on said boundary

Post oak { *Post oak N 63 W 9*  
*do N 42 E 22*  
Thence

S. 45° W 5313 vs with the North west boundaries  
of leagues F & K to the place of begin-  
ning

Copied By  
R. D. Johnson  
June 10<sup>th</sup> 1857



R. J. W. Reel  
 League I situated on the <sup>144</sup>  
 Yegua Beginning at the North Corner of  
 said league which is also the west corner  
 of league F a Post } Post oak  $\frac{1}{2}$  11  
 } " " N 61 2 11  
 } " " N 35 2 11  
 Thence

S 45 W 5313 vs with the South East boundaries  
 of H & O to the West Corner of said  
 league herein described a  
 Post } Pin oak  $\frac{1}{2}$  24  
 } Elm  $\frac{1}{2}$  40 x 8  
 Thence

S 45 E at 300 vs crossed 4<sup>th</sup> Creek  
 4905 to the Southern corner of  
 said league I on the north west  
 boundary of league I a  
 Post } Pin oak 36 2 y  
 } Peach 28 2  
 Thence

N 45 E at 4268 vs with the north west  
 boundary of league I to the north  
 corner thereof, continuing same course  
 with the north west boundary of R 1045  
 further to the east corner of said league  
 I Thence

N 45 W 4905 vs with the south west boundary of league F  
 to the place of beginning.

DATE issued Oct 21/35 -  
 Vol 10 fo 269.

Burton of Lee Co  
 1829

Copied by R.A. Johnson

Little Made

~~44~~ Humphrey Best 1851  
 45 3 League I situated on  
 the Negaunee Beginning at the North  
 Corner of said league which is also the  
 Western Corner of league K a

Post { Pin oak  $\frac{1}{8}$  Varad  
 Do  $\frac{1}{2}$  269 Varad Thence

~~45~~ S 45 W 4777 vs with the south east boundaries  
 of leagues I & N to the west corner of  
 said league I

Post { Post oak  $\frac{1}{2}$  6893  
 Do  $\frac{1}{2}$  3727  
 Thence

S 45 E 4810 vs with the north east boundary  
 of league M to the Southern Corner  
 of said league I on the northern  
 boundary of a league granted to Neal a

Little Mackinac

Post { Post oak  $\frac{1}{2}$  14  
 Do  $\frac{1}{2}$  20 13  
 Do  $\frac{1}{2}$  6107 Thence

N 55 E 4835 vs with the northern boundary of  
 Neals & Stevens land to the  
 Eastern Corner of said league I a

Post { Post oak  $\frac{1}{2}$  18  
 Do  $\frac{1}{2}$  910 18  
 Do  $\frac{1}{2}$  67 16 Thence

N 45 W 5665 vs with the south west boundary  
 of league K to the place of beginning

Copied by  
 H. D. Johnson  
 June 10<sup>th</sup> 1857

278

One or Duty One fourth League 146  
 Situated East of the Colorado above  
 Pastrop adjoining lands granted to M.  
 Duty, Webber, Waters and the heirs of  
 Osborne. Beginning at the Northern corner  
 of a half League granted to M. Duty a

Copied By Post { Post oak + ~~182 1/8~~  
 Do. + ~~190 1/2~~ } 1747

J. P. Johnson Thence  
 N 43° E 1570 vs with the South East boundary of the  
 sd Webbers half League to the Eastern corner  
 thereof a Post { Post oak 1562 2 vs  
 Do. } Thence

N 30° E 2249 vs with the Eastern boundary of the  
 said Waters to the Northern corner  
 of the one fourth league herein described  
 Thence

S 60° E 1240 vs to the eastern corner of said  
 quarter on the North west boundary  
 of a League granted to the heirs of Osborne  
 Thence

S 30° W 2789 vs with said north west boundary to  
 another corner on the Northern boundary of sd Duty  
 Thence

N 47° W 1660 vs with said northern bound-  
 ary to the place of beginning

Copied By P. Johnson





Gulf Shore. Thence

58  
148

South westerly with the Gulf Shore  
to the mouth of Old Camp  
Thence up said Camp Creek with  
the meanders thereof to the place of  
Beginning

Copied By

L. D. Johnson

June 17<sup>th</sup> 1837



# 149

*[Faint, illegible handwriting]*

*[Faint, illegible handwriting]*

John Morris one League~~148~~

on the West margin of the Arvidad south of Mrs Living  
 Beginning at the South East Corner of Mrs Living  
 thence S. 70° West 7600 Varas with the South line of  
 the same to the S. W. Corner of Said Survey the  
 due East Six hundred and fifty Var. to the N. E.  
 Corner of Survey of John Hibbins thence South  
 with East Line of Said Hibbins League  
 2570 Varas to the S. E. Corner of the same  
 thence East with the North line of a Survey  
 made for M<sup>rs</sup> Hallett 2676 Varas to N. W. Station  
 N. E. Corner thence North 76° E 7000 Varas to the  
 Arvidad thence and established a Corner  
 on a Gaekerry marked W from which  
 a box elder 8 inches dia 4 Varas bears  
 S. 51° West and an Elm 18 inches in dia 9½  
 Varas br. N. 80° W. thence up Said Stream  
 with the meanders thereof to the place of  
 Beginning containing one Liticio de Yere  
 June 20th 1825  
 M. P. Hensley  
 Surveyor

See Page 79 of this Book

151

Joel Ponton

One League of Land on the Navidad  
-dard South of John Morris

Beginning at the S. E. Corner of  
John Morris' Survey.

a Hackberry marked ~~W~~  
from which - a box Elder mkd + 8 inches  
diam. 4 Varas dist brs S. 51° W.  
An Elm 14 inches dia - 9 1/2 Vrs  
dist brs N. 80° W.  
thence S. 70° W. 7000 Varas. to S. W. Corner  
of Morris' League.

thence S. 22 1/2 Vars. to Mrs. Halletts S. E. corner  
thence W. 1188 Varas. thence S. 3380 Varas  
thence N. 70° East 6000 Varas. to the  
Navidad and established a corner  
Hackberry marked 'I' from which an ash  
30 inch dia - 1 1/2 Varas. bears N. 51° W.  
An Elm 15 inches in dia 6 Varas. N. 39° E  
Thence up said Stream with meanders  
to place of Beginning containing on  
title de Terro

June 21<sup>st</sup> 1835

W. R. Hensley  
Sur

T S Mitchell League 152

T. S. Mitchell one League West Side Navidad  
Beginning at the S. E. Corner  
of Pontons League at a  
Hackberry MKd. T. from  
which an Ash 30 inches  
dia. 4 1/2 Varas. bears N. 51° W.  
An Elm 15 inches dia.  
6 Varas. dist. bears N. 39° E  
thence

S. 70° W. with South line of Pontons Survey  
1500 Varas to East line of  
a Survey made on Sabaca  
Marked N° 5 on the plat and  
established a corner on a  
Blk Yack. MKd. T. from  
which a P. O. 14 inches  
dia. 3 Varas. brs. S. 70° W.  
a P. O. 9 inches dia. 5 1/2 Varas  
brs. S. 14° W. thence

S. 70° E. 7100 Varas to the Navidad thence  
up said Stream with the  
meanders thereof to the place  
of Beginning - Containing one  
Lito de Terro. June 22 1835

Mr. R. Henry  
Sur

153

1 League Land N. of Scott's  $\frac{3}{4}$

Situate on ~~West~~ East Margin of Sab-  
 aca North of Scott's  $\frac{3}{4}$   
 League beginning at his  
 N. W. Corner on the East  
 Margin of Sabaca thence  
 East with North Line of Scott's Survey  
 4860 Varas passing Scott's  
 N. E. Corner. Continued on  
 same Course & at 4909  
 Established a corner thence  
 North 7400 Varas and Established  
 a corner on Mrs Hallett's  
 S. Line thence  
 West with said Line 1210 Varas  
 to the N. E. Corner of Dr. A's  
 thence  
 South with E Line of Drs. A. & B. 3650 Varas  
 thence

West with S. Line of N. 3-3963 Varas to the  
 Sabaca thence down said  
 Stream with meanders #

#the meanders are  
 S. 10° W. 1250. S. 36° E 830  
 S. 17° W. 530 - S. 8° W. 700  
 S. 22° E 540. S. 65° E 400  
 S. 17° E 200 Varas

to place of Beginning  
 containing one bitio de  
 land. May 25<sup>th</sup> 1835

W. R. Hensley

File  
154  
Survey of Dr. N. A. Sabacia

---

Beginning at



133

*[Faint, mirrored handwriting, likely bleed-through from the reverse side of the page]*

*[Faint, mirrored handwriting, likely bleed-through from the reverse side of the page]*

# Index.

	Page
Williams Smathers tract	3
John Botts' half League	7
meanders of river from Smathers lower corner. to David Brights Labor	3
Meanders of the east side of the river Brozes from the lower corner of Brights Labor down until I met William Selkirk	5
Stephen J. Austins League above the Labors on the west side of the river	7
David Brights Labor	10
Hilburns Labor	9
Sarah C. Groce's tract at Coehatta crossing	11
John Irons' League	12
Meanders of the river fronting town tract	13
1 <sup>st</sup> Labor above town	14
Meanders of the river by Selkirk	15
2 <sup>nd</sup> Labor	16
3 <sup>rd</sup> Labor	17
4 <sup>th</sup> Labor	18

# Index.

	Page
5 <sup>th</sup> Labor .....	19
6 <sup>th</sup> Labor .....	20
7 <sup>th</sup> Labor .....	21
4 & 5 above the road and east of river .....	22
6, 7 & 8 .....	23
1, 2 & 3 .....	25
9 <sup>th</sup> .....	26
10, 11 & 12 .....	27
1 <sup>st</sup> 2 & 3 labors below the road .....	29
*4 & 5 .....	30
6, 7 & 8 .....	31
9 <sup>th</sup> .....	32
10 & 11 .....	33
12 & 13 .....	34
14 & 15 .....	35
16 & 17 .....	36
*18 & 19 .....	37
Meanders of Colorado River below Pinchitos line by William Silkhirk .....	39-40
Field notes of the League below Pinchitos line surveyed by William Silkhirk, 1 <sup>st</sup> & 2 <sup>nd</sup> .....	41
3 <sup>rd</sup> 4 & 5 .....	42
6, 7 on Peach & St. Bernarde Creeks .....	43
1 & 2 .....	44
3, 4 & 5 .....	45