



ENGLISH
FIELD
NOTES



BOOK 9



SPANISH
ARCHIVES



G. L. O.





1056102
EFN 000009

160

Rawson Alley

A. Blair

Horace Chreisman

Fayette
Grimes
Madison

Burleson
Washington
Lee
Waller
Fayette

Fort Bend
Wharton
Brazoria
Matagordia

Field Notes of
Survey's Made
East of Davidsons
Creek a Branch
of the ^{St. Ignace} ~~St. Ignace~~.

H

Index

Book 9.

William S. Huff

7962 issued Oct 19/35 vol 10 p. 101.

W. E. Huff NW 1/4th mad
 League of 36 c 1/2th of Yll
 ma East of Davidsons creek
 in new surveys
 Beginning at the ~~SE~~ corner
 of a League of land granted
 to J. B. Bell, N^o 4. on David-
 sons creek, Thence N^o 45 W.
 with the S. W. boundary
 line of League N^o 5 East
 of Davidsons creek 1120 vs to
 the ~~SE~~ W. corner. Thence N^o 45
 E with the N. W. boundary
 line of sd. League. 1308 vs. to
 the ~~SE~~ corner of a League
 of land granted to A. A. the
 Mc^{rs} Sadden, where set a
 Post from which a Post Oak
 10 in dia. vs. N^o 45 E. 12 vs.
 and a Post 11 in dia. vs. N^o 3
 W. 13 vs, Thence N^o 45 W. with
 the S. W. boundary line of

Davidson Co.
Huff

2nd League, at 2746 rs set a Post
pole for the N^W corner from
which a Post Oak 14 in dia,
rs. at 5983 rs. and a Post Oak
in dia. rs. 935 W. 7000. Thence
945 W. at 4460 rs a creek run
S.E. at 6974 rs intersected
the N.E. boundary line of
League 1st on Davidsons
creek, thence 945 E. with S^W
line 273 rs to the N^W corner
of 1st League 1st. thence
945 E. with the N.W. bounda-
ry line of League 1st 6 West
of Davidsons creek, 196 rs
to the N^W corner, thence 945
E. with the N.E. boundary line
of 1st League 3623 rs. to the
N^W corner, ^{thence} thence 945 E. with
the N.W. boundary line of
League 1st 4. 5470 rs. To the
place of beginning E-d

League n^o 7 East of Davidsons
 Creek, Beginning at the n^e corner
 of League n^o 6 East of
 Davidsons creek, at a Post from
 which a Post Oak 10 in dia, bs,
 n^o 548, 30rs and a P. 12 in dia
 bs, 935 to 7rs, Thence n^o 45 W
 with the I. W. boundary line
 of a League of land granted
 to Nathan & Wm Gadden, at
 1804 vs, set a Post for the n^e
 corner of 1st League, from
 which a Post Oak 14 in dia, bs,
 n^o 348, 15 vs, and a P. 13 in
 dia, bs, n^o 996, 33 vs Thence
 I 46 W with the I. C. bounda-
 ry line of quarter League n^o 7
 East of Davidsons creek,
 420 vs, to the I. W. corner of
 1st quarter, Thence n^o 45
 W with the I. W. boundary

H. line of 1st quarter, 1260 vs
to the N.W. corner, Thence same
course with the I.W. bounda-
ry line quarter League 1st 2,
East of Davidsons creek, at
845 vs. set a Post for the N.E.
corner, from which a Post Oak
22 in dia, by I 83 E. 55 vs, and
a I. 12 in dia, by I 23 E. 52 vs,
Thence I 45 W. at 6554 vs, ~~at~~
intersected the N.E. bounda-
ry line of League 1st 4, when
set a Post for the N.W. corner
from which a Post Oak 14
in dia, by, N 60 W 13 vs, and
a I. 15 in dia, by, N 49 E
15 vs, Thence I 45 E with
the N.E. boundary line

5
of St. Seague No. 3699 res
to the SW corner of League
no. 6 East of Davidsons creek
Thence N 45 E with the NW
boundary line of St. Seague
6974 m. to the place of begin
ing

6
Quarter League N^o. 1 East of
Davidson's Crak Beginning at
the S. W. corner of a League of
land granted to Nathan &
M^r. Fadden, at a Post, from
which a Post Oak 14 in dia,
br. N 54 E. 15 vrs. and a P^o 13
in dia, br. N 29 W 33 vrs.

Thence 45 W. at 420 vrs. set
a Post for the S W corner, from
which a Black Jack 13 in
dia, br. N 91 E. 10 vrs. and a
Post Oak 16 in dia, br. S 55
E 11 vrs. Thence N 45 W. at
1250 vrs. set a Post for the
N W corner, from which a
Post Oak 18 in dia, br. N 85
E. 25 vrs. and a P^o 14 in dia,
br. S 88 W. 4 vrs. Thence N
45 E. at 5000 vrs. ~~set a Post~~
intersected

for the N.E. corner, from which

the N.W. boundary line of a
League of land granted to
Blueford Brooks, where set
a Post for the S.E. corner, from
which a Post Date, 13 in dia
bs. 989 to 12 vs. and a 9.20
in dia bs. at 296. 18 vs. Hence
945 E. with the N.W. boundary
line of S. League 1250 vs. to the
N.W. corner, Hence, 945 N.
with the N.W. boundary line
of Mr. Fadden's League, 4580
vs. to the Place of beginning

Quarter League of 1^{st} East of
Davidsons Creek, Beginning at
the 1^{st} corner of Quarter League
of 1^{st} , at a Post from which
a Post Oak 13 in dia, bs. 1^{st}
89 W. 12 ns, and a 2^{d} 20 in dia,
bs. 1^{st} 29 E. 18 ns. Thence 1^{st} 45
W. with the 1^{st} boundary line
a league granted to ~~the~~ ^{the} ~~the~~ ^{the} ~~the~~ ^{the}
of Brooks ~~the~~ ^{the} ~~the~~ ^{the} ~~the~~ ^{the}
set a Post for the 1^{st} corner
from which a Post Oak 26
in dia, bs. 1^{st} 36 E. 8 ns and
a 2^{d} 11 in dia, bs. 1^{st} 12 W. 12 ns.
Thence 1^{st} 45 ~~W.~~ ^{at 5000 ns.}
set a Post for the ~~1^{\text{st}} ^{1st corner} ~~1st corner~~
from which a Post Oak
26 in dia, bs. 1^{st} 46 W. 49 ns, and
a 2^{d} 18 in dia, bs. 1^{st} 46 E. 38 ns,
Thence 1^{st} 45 E. 1250 ns to the
 1^{st} W corner of Quarter League
of 1^{st} , Thence 1^{st} 45 E. with~~

the N.W. boundary line of
pt. 2^d ⁵⁰⁰⁰ 5000 rs to the place
of beginning. *EX*

Quarter League N^o 3 East of
Davidson's Creek. Beginning
at the N.E. corner Quarter Lea-
gue N^o 2, at a Post from which
a Post Oak 16 in dia, br. N 45 E
8 rs. and a *9* 11 in dia, br. N 12
W. 12 rs. Thence S 45 W. with
the N.W. boundary line of Quar-
ter League N^o 2, at 2500 rs, set
a Post for the S.W. corner from
which a Post Oak 12 in dia,
br. N 45 E. 4 rs. N 64 W. 4 rs.
and a *9* 12 in dia, br. S 13 E.
4 rs. Thence N 45 W. at 2500
rs. set a Post ^{on the S.E. boundary of pt. 1^o 8} for the N.W. corner
from which a Post Oak 25 in
dia, br. N 45 E. 25 rs. and

10
and a D° 26 in dia, $\text{hs. N}^{\circ} 12$
E. 20 vs. Thence $\text{N}^{\circ} 45$ E with
the I° boundary line of
League $\text{N}^{\circ} 8$ on the Sanan-
tonia road, 1570 vs. to the
 I° corner. Thence same course
with the I° boundary line
of League $\text{N}^{\circ} 4$ on the San-
antonio road, 930 vs. to
the N° corner of Brooks
League. Thence $\text{N}^{\circ} 45$ E with
the I° boundary line of
 I° League. 2500 vs. to the
place of beginning

Quarter League et^{no} 4 East
of Davidson's creek. Beginning at
the N^E corner of Quarter League
et^{no} 3. at a Post from which a
a Post Oak 25 in dia, br. N⁴⁵ E,
25 vs. and a P^o 26 in dia, br,
N¹² E. 20 vs. Thence S⁴⁵ W
with the S^E boundary line
of League et^{no} 8 on the Pan an
tonia road, 2291 vs to the S.
W corner of 1st League. Thence
same course with the S^E bound
ary line of League et^{no} 9, at
209 vs. set a Post from which
a Post Oak 11 in dia, br, S⁵⁶ W
7 vs. and a P^o 16 in dia, br,
N⁴² E, 4 vs. Thence S⁴⁵ E
2500 vs to the N^W corner of
Quarter League et^{no} 2. Thence
N⁴⁵ E. with the N^W bound

19
davy line of 1st quarter 2500
var. to the S.W. corner of Quar-
ter League No. 3. Thence
p. 45 W. with the S.W. bound-
ary line of 1st quarter
2500 var. to the place of
beginning

v. 16, p. 40, when ca 1935 - vol 10 p. 97. Burlington Co. N.J.

^{Alexander} A B Lajoie - NW Tolle man
Quarter League et^{no}. 5 East of
Davidson's creek. Beginning ¹³
at the ~~SW~~ W. corner of Quarter
et^{no}. 4 at a Post from which
a Post Oak 11 in dia, by 956
W. 4 vs. and a 9^o. 16 in dia, by,
et^{no}. 42 E. 7 vs. Thence 945 W.
with the P.C. boundary line
of League et^{no}. 9. on the San
Antonio road, at 2016 vs.,
set a Post for the ~~SW~~ W corner
from which a Post Oak 11 in
dia. by 969 W. 6 vs. and a
Black Jack 14 in dia. by 9
94 E. 10 vs. Thence 946 E
at 3105 vs. vs intersected
the ~~SW~~ W. boundary line
of League et^{no}. 9. East of
Davidson's Creek, where set
where set a Post for the

TH
A B L A
The corner from which a 1st
Oak 14 in dia. b. 188 W. 900
and a 2d 15 in dia. b. 180
E. Thence at 75 E. with the
NW boundary line of 1/4
league at 1/4 20.16 W. to the
E. corner, Thence at 45 W.
with the SW boundary
line of Quarter League at 2,
605 W. to the ~~SW~~ corner
of 1/4 quarter, Thence same
course with the SW bounda-
ry line of Quarter League at 1/4
4 25 W. to the place of
beginning, -

Ex -

A. Blawie

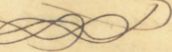

Quarter League N^o of East of
 Davidsons Creek ^{in the new survey} Beginning at
 the N.W. corner of League N^o
 of East of Davidsons Creek,
 at a Post from which a Post
 Oak 14 in dia, bs. N^o 60 W. 13 rrs.
 and a 15 in dia, bs. N^o 49 E.
 15 rrs, Thence N^o 45 W. with the
 N.E boundary line of League
~~League~~ N^o 4 on Davidsons
 creek, ^{at} 1374 rrs set a Post for
 the N.W. corner, from which
 a Post Oak 20 in dia, bs. S.
 31. W. 2 rrs. and a S^o 18 in dia
 bs. N^o 65 W. 14 rrs, Thence S^o
 45 E. at 4538 rrs. set a Post
 from which a Post Oak 18
 in dia, bs. S^o 10. E. 23 rrs. and
 a S^o 22 in dia, bs. S^o 43. E 12

rrs

16

I 45 &

Hence ~~of 45th~~ with the S.W.
 boundary line of Quarter 27th
 S. 1377 rods. to the S.W. corner of
 2^d quarter. Hence. S 45th
 with the S.W. boundary line
 of League 27th East of La
 Bidson's Tract 4538 rods. to
 the S.W. corner of 1st League
 the place of beginning

Quarter League et^{no} 7 East
of Davidsons Creek, Begin-
ing at the N.E. corner of Quar-
ter et^{no} 6. at a Post from which a
Post Oak 18 in dia. by 9 10 E. 23 vs.
and a S. 22 in dia. by 43 E. 12 vs.
Thence et^{no} 45 W. with the S.
W. boundary line of Quarter
League et^{no} 5. at 1374 vs. set a
Post for the S.E. corner. from
which a Post Oak 18 in dia. by
9 8. W. 11 vs. and a S. 11 in dia.
by 22 E. 12 vs. Thence 9 45
W. at 4538 vs. intersected.
the et^{no} 8. boundary line of
League et^{no} 7 on Davidsons
Creek where set a Post for the
S.W. corner. from which a Post
Oak 11 in dia. by 26 W. 5 vs. and
a S. 15 in dia. by 30 E. 9 vs.

18. Thence S 45 E with the S^o E
boundary line of M^o League
S. 74. 1844 to the N^o W. corner
of Quarter League S^o E. Thence
S 45 E with the N^o W bounda-
ry line of S^o Quarter 4538
to the place of beginning

17-20 11-21-

23

William of the ...

... H ...

... Louis ...



... of ... East of ...

25

12

24

Yegua
 Mare Creek
 Survey

T.L.

Index

Index to this Book

J. Thompson 29

League Q on the main ya-
gua. Beginning at the N.W.
corner of League P. at a Post
from which a Hickory 18 in
Dia. by S 22 W 13 vs. and a Post
at 18 in Dia. by N 46 E 15 vs.
Thence S 45 W. with the S.E.
boundary line of et^{no} 20
at 300 vs. entered Yagua bot-
tom at 1830 vs. crossed Yagua
at 2375 vs. set a Post for the
S.W. corner of et^{no} 20 from
which a Red Oak 22 in
Dia. by N 27 W. 10 vs. and a
P. 30 in Dia. by N 83 W. 11 vs.
Thence N 45 W. with the
S.W. boundary line of et^{no}
20. at 400 vs. entered Prai-
rie. at 1000 vs. left Prairie
at 2222 vs. set a Post for

Table issued Feb'y 23/36. Vol 11. p. 649. Washington Co. Joseph Thompson

30
177

the S.E. corner of P^o 21 from
 which an Elm 12 in Dia by
 S 11 W 2 vs. and an Ash 15
 in Dia by S 1 E 10 vs. Thence
 S 45 W with the S.E. bounda-
 ry line of P^o 21 at 1246 vs.
 set a Post for the S.W. corner
 from which a Post Oak 22
 in Dia by S 45 E 24 vs. and
 a S^o 13 in Dia by S 23 W 18 vs.
 Thence S 45 E at 1970 vs.
 crossed a creek at 8360 vs.
 a Post Oak for the S.W. corner
 from which a Post Oak
 14 in Dia by S 87 E 16 vs.
 and a S^o 13 in Dia by S
 14 W 16 vs. Thence at 245
 E. ³⁶²¹ ~~525~~ vs. to the S.W. corner
 of P. Thence N 45 W with
 the S.W. boundary of P
 6138 vs. to the place of begin-
 ing.

31 #

League R. South of Yagha
Beginning at the SW corner
of P at a Post from which
from which a Post Oak 13
in Dia. ^{bs.} N. 11. W. 11 vrs and
a Do 14 in Dia. ^{bs.} S 42 W. 10 vrs
Thence S 45 W. with the P.C.
boundary line of ~~Q~~ ^R at
3118 vrs. set a Post for the
NW corner from which a
Post Oak 13 in Dia. ^{bs.} S 12 E
17 vrs and a Do 11 in Dia
^{bs.} S 68 E. 14 vrs. Thence S.
45 E. at 6200 vrs crossed a
large creek running E at
7950 vrs. intersected the
NW boundary line of a ha-
gue of land granted to
Frank's. where set a Post
for the S.W. corner

11

[Faint, illegible handwriting, likely bleed-through from the reverse side of the page.]

[Faint, illegible handwriting, likely bleed-through from the reverse side of the page.]

34
~~1115~~

from which a Hickory 12
in Dia to N 36 E. 14 rods, and
a Black Jack 13 in Dia to S
71 E. 8 rods. Thence N 55 E. with
the N.W. boundary line of
S^d League 2400 rods to the S
W corner of M. Thence N 45 W
with the S.W. boundary line
of M 3660 rods to N.W. corner
of M. Thence N 45 E. with
the N.W. boundary line of
M 1146 rods to the S.W. corner
of N. Thence S 45 W with
the S.W. boundary of N
4705 rods to the N.W. corner of
N. Thence S 45 W. with the
S.E. boundary of P 430 rods.
to the place of beginning

N. E. corner
 League. South of Yagun
 Beginning at a Post on the
 S. E. boundary of Frank's
 League. ^{Summary} 1630 ^{rs.} N. E. of the S. W.
 corner. Thence S 45 E. a 95784
^{rs.} intersected the N. W.
 boundary line of ^{at} 10.
 where set a Post from which
 a Post Oak 15 in Dia S 44 W. 11
^{rs.} and a ^{Post} 13 in Dia by N.
 63 E. 4 ^{rs.} Thence at 45 E. with
 the N. W. boundary line of ^{at}
 10 2836 ^{rs.} to the S. E. corner.
 Thence same course 1412 ^{rs.}
 to the S. W. corner of a League
 of land granted to J. Ayres.
 Thence N. 35 W. with the S.
 W. boundary line of of S. E.
 League 4900 ^{rs.} to the N. W.
 corner

#30

Thence S 55 W with the
S.E. boundary line of a league
of land granted to Camp-
bell. 597 vs. to the S.E. corner
of a league of land granted
to Franke. Thence same course
with the S.E. boundary line
of S^d league 4620 vs. to the
place of beginning

Little made to
A. C. Moffet
28 July 1834

League. I. South of Yagua

Beginning at the S.W. corner
of Franks. League, Thence
S. 45 W. at 2572 vrs. set a Post
for the e. W corner, from which
a Post Oak 18 in Dia. by S 29 W
4 vrs. and a S. 11 in Dia. by S
57. E 7 vrs. Thence S 45 E. at
at 440 vrs crossed a branch
of Mills creek saving N. E.
at 5305 vrs. crossed a branch
of the same creek. ^{intersected the N.W. (line) of 12}
at 6000 vrs. ^{for S.W. corner}
set a Post, from which a
Post Oak 11 in Dia. by S 57 W.
4 vrs. and a S. 10 in Dia. by
S 11 W 12 vrs. Thence N 45 E
with the N.W boundary line
of N. 12 917 vrs to the N.E.
corner. Thence N 45 E with the
N.W boundary line of N. 12

#38

3032.00 to the N.E. corner Thence
same course with the N.W.
boundary of N^o: 10 196.00 to
the S.W. corner of League S.
Thence N. 45 W with the S.W.
boundary line of S^d League
5434.00 to the N.W. corner,
Thence S 55 W with the S.E.
boundary of Franks League
1630.00 to the place of be-
ginning

39 #

League U. North of Cummings
crack. Beginning at the N.W.
corner of $\text{C}^{\text{no}} 12$. Thence $\text{S} 45$
 W . at 2051 vrs. set a Post for
the S.W. corner from which
a Post Oak 12 in Dia. bs . $\text{C}^{\text{no}} 24$ C .
4 vrs. and a $\text{S}^{\text{no}} 13$ in Dia. bs . S
 61 W . 5 vrs. Thence $\text{C}^{\text{no}} 45$ W . at
at 6000 vrs. set a Post for the
N.W. corner from which a
Post Oak 12 in Dia. bs . $\text{C}^{\text{no}} 85$
 C . 15 vrs. and a $\text{S}^{\text{no}} 11$ in Dia.
 bs . $\text{C}^{\text{no}} 21$ C 7 vrs. Thence $\text{C}^{\text{no}} 45$
 C . 4166 vrs to the N.W. corner of
League I, Thence $\text{S} 45$ C . with
the S.W. boundary line of $\text{S}^{\text{no}} 11$
League, 6000 vrs to the S.W. cor-
ner. Thence $\text{S} 45$ W . with the
N.W. boundary line of $\text{C}^{\text{no}} 12$
2115 vrs to the place of beginning.

#40

△ 43

League V South of Yagua
 Beginning at the N.W. corner
 of ~~Post~~ a Post from which
 a Post Oak 18 in Dia. bs, 9 29
 W. 7 vs. and a ~~Co.~~ 11 in Dia
 bs, N 5 4 E. 14 vs. Thence S
 45 W. with the N.W. bounda
 ry line of League VI at 62
 vs. set a Post for the S.W.
 corner from which a Post
 Oak 15 in Dia, bs, 9 34 W. 18 vs.
 and a ~~Co.~~ 11 in Dia, bs, N 35
 W. 16 vs. Thence N 45 W.
 at 70 33 vs. set a Post for the
 N.W. corner from which a
 Post Oak 15 in Dia, bs, N
 29 E. 14 vs. and a ~~Co.~~ 11 in Dia,
 bs, N 89 E. 22 vs. Thence
 N 45 E. at 4300 vs. ~~set~~ in
 intersected the S.W. boundary

same as in book 5 p. 141

41

line of League R. where set
a Post from which a Post
Oak 14 in Dia, br. 9.44 W. 93 vrs
and a 9. 11 in Dia, br. W 31 vrs.
Thence 9.45 C with the N.W. bound-
ary line of 1st League 3283 vrs
to the N.W. corner. Thence 9.5
W with the N.W. boundary
line of 2nd League 1030
vrs. to the N.W. corner. Thence
9.35 C with the N.W. boundary
line of 3rd League 4000 vrs to
the N.W. corner. Thence 9.45 W.
with the N.W. boundary line
of League I. 2634 vrs to the
place of beginning,

△ 43

#12

League W South of Yagna
Beginning at the NW corner
of league V at a Post from
which a Post Oak 15 in Dia,
bs, N 29 E, 14 vs. and a I° 10
11 in Dia, bs, N 89 E, 22 vs.
Thence N 45 W at 1300 vs
crossed a creek running E
at 2160 vs. crossed a creek
running E at 5971 vs. set a
Post for the NW corner, from
which a Post Oak 12 in Dia,
bs, S 55 E, 13 vs. and a I° 10
in Dia, bs, N 14 W, 8 vs. Thence
N 45 E at 3480 vs. intersect
ed the S.W. boundary line
of league Q where set a
Post from which a Post
Oak 16 in Dia, bs, N 53 E

12 vrs, and a $\frac{1}{11}$ 18 in dia. $\frac{1}{11}$,
 868 18 vrs. Thence I 45 E with
 the I W boundary line of
 1st League 1304 vrs. to the S
 W corner. Thence I 45 E with
 the S E boundary of Q 520
 vrs. to the N W corner of League
 R. Thence I 45 E. with the
 S W boundary of 1st League
 4664 vrs. to the N E corner of
 League V. Thence I 45 W. with
 the N W boundary line of
 1st League. 2634 vrs to the
 place of beginning.

Set on road July 19/56. Vol 11. p. 625
Working on Leo

44 Amanda Mc Crackin
League X South of Ogawa
beginning at the N.W. corner of
League W at a Post from which
Post Oak 12 in Dia. by 955 C.
3. vs. and a 9^o 14 in Dia. by
14 W. 8 vs. Thence 945 W.
at 3844 vs. set a Post ^{for N.W. corner} from
which a Post Oak 15 in Dia,
by 946. 6 vs. and a 9^o 12 in
Dia. by 896. 3 vs. Thence
945. C. at 1220 vs. crossed a
creek running S.E. at 6502 vs.
set a Post for the S.W. corner
from which a Post Oak 12
in Dia. by 814 C. 10 vs. and
a 9^o 13 in Dia. by 980 C. 4 vs.
Thence 845 C. at 3844 vs. in
tersected the S.W. boundary
line of League V. where set

45 

a Post from which a Post
Oak. 14 in Dia; br. 92 lb. 6 vss.
and a 9. 20 in Dia, br. 98 lb
12 vss. Thence N 45 W. with the
S.W. boundary line of 1st League
531 vss. to the N.W. corner. Thence
same course with the S.W. bound-
ary line of League W. 5971 vss.
to the place of beginning,

tith made to Mrs
Mc Crackin

#40

League Y South of League
beginning at the S.W. corner of
League X at a Post from
which a Post Oak 12 in dia,
br, N^o 44 E. 10 vs. and a S^o 13 in
dia, br, S 80 E. 4 vs. Thence
S 45 E. at 6502 vs. intersect
ed the N.W. boundary line
of League U 260 vs. N.E. of the
N.W. corner, where set a Post
from which a Post Oak 13
in dia, br, N 15 W. 6 vs. and a
S^o 12 in dia, br, N 35 E. ---
Thence N 45 E. with the N.
W. boundary line of S^o.
League 3844 vs. to the S.W. cor-
ner of League V. Thence N 45
W. with the S.W. boundary

line of S. League 6562 rods
to the S.E. corner of League
X. Thence S 45 W with the
S.E. boundary line of S. League
3844 rods to the place
of beginning,

Amaziah Baker

League 2 on Cummings
 creek. Beginning at the S.W.
 corner of 13, Thence N.
 45 W. with the S.W. boundary
 line of 1st League ^{at 4681 vs set}
 a Post for the N.E. corner from
 which a Live Oak 24 in Dia, bs,
 at 28 E. 13 vs. and a Post Oak
 13 in dia, bs, S 89 W. 13 vs.
 Thence S 43 W. at 4200 vs cross-
 ed a creek running S.E. at
 5500 vs set a Post for the N.
 W. corner from which a Post
 Oak 11 in Dia, bs, S 48 W. 6 vs
 and a 11 in dia, bs, at 30 E
 3 vs. Thence S 41 E. at 1201 vs
 past the N.E. corner of 11,
 Williams's League, Thence with
 the N.E. boundary line of 1st

League ~~49~~ ⁴⁹ is to the location
of the League. Hence at 143-C.

5365 is to the place of begin-
ing. In the title, the 3^d line
is 5365 v. (4601)

Title made to A. Baker

13. October 1835

Title issued Oct 13/35

Vol 10 - p. 137

Waller Co.

A. B. O. D.

League $\frac{A}{2}$ on Cummings

± 14

creek, Beginning at the S.W. corner of League 7. at a Post from which a Post Oak 11 in dia, bs. ~~S 83 W 15~~ and a ~~S 11 in dia, S 30 E 8~~

Thence 47 W at 1079 vrs. crossed a creek running E. at 2199 vrs. set a Post for the S.E. corner, from which a

Post Oak 12 in dia, bs. S 8 W. 12 vrs. and a ~~S 15 in dia, bs, S 83 W. 10 vrs.~~ Thence S 43

W. at 30 vrs crossed a creek running E. at 5000 vrs crossed a branch running N.E.

at 7852 vrs. set a Post for the N.W. corner, from which a Post Oak 15 in dia, bs, S 57 W

John Pondwenty
Same as bk 4 p. 94.

10 1/2, and a I^o 10 in dia,
 I 89 & 14 1/2, Thence I 47 &
 3400 1/2, to the to the N.W. cor-
 ner of Mrs Williamson's begin-
 thence N 43 E with the N-
 W boundary line of S^d League
 7352 1/2, to the N.E. corner
 thence N 47 W. with the S-
 W. boundary of league 1,
 thence N 1201 1/2 to the
 place of beginning.

League C South of Yagua
beginning at the S.W. corner
of League J. set a Post from
which a Post Oak 13 in dia,
bs, at 15 W 6 vs. and a P° 12
in dia, bs, N. 35 E. — Thence
S 45 W with the N.W. bound-
ary line of League U 260
vs. to the N.W. corner. Thence
same course, with the N.W.
boundary line of League B
at 3844 vs. set a Post for the
S.W. corner from which a
Post Oak 14 in dia, bs, S 70 W
2 vs. and a P° 12 in dia, bs,
N. 5 W, 14 vs. Thence S 45 W,
at 5110 vs. entered Prairie. at
at 6512 vs. set a Post for the
N.W. corner from which.

1845
55
A Post Oak 16 in dia, by N 15 W
29 vs, and a 2^d 14 in dia, by N
63 W, 21 vs, Thence N 45 E, 38 1/4
vs. to the N W corner of League
T. Thence S 45 E. with the S W
boundary of S^d League 6500
vs. to the place of beginning

Matthew Sparks
Lee & Ames
576 issued Oct 3/35. vol 10. p. 5.

Dec'd to M Sparks
League 2 South of Yagua
Beginning at the ~~SW~~ W. corner
of League 2 at a Post from
which a Post Oak 16 in dia, br,
sp 16. W. 29 vs. and a ~~Do.~~ 18 in
dia, br, sp 63 W, 21 vs. Thence
sp 45 W. at 3200 vs. a branch
running N.E. at 6502 vs. set a
Post for the N.W. corner. from
which a Post Oak 18 in dia,
br, sp 41 E. 5 vs. and a ~~Do.~~ 22
in dia, br, sp 31 W. 10 vs. Thence
sp 45 E. 3844 vs. to the ~~SW~~ W
corner of League X. Thence
sp 45 E. with the N.W. bounda-
ry line of ~~League~~ ⁶⁵⁰² League ~~2~~ ⁶⁵⁰² vs
to the ~~SW~~ ^{East corner of the League} corner of the League ~~2~~ ⁶⁵⁰² vs
~~course with the~~ Thence ~~with~~
sp 45 W. with
the N.W. boundary line of
League ^C 2 3844 vs to the place
of beginning—

Oct 24/35. Vol 10. p 258.
See Co
Mrs
Koridman

£ 10 E

57 ~~57~~

League ^D South of Yague

Beginning at the ^D N.W. corner
of League ^D at a Post from
which a Post Oak 18 in dia, bs,
S 41 E. 5 vs, and a ^D 22 in dia,
bs. S 31 W. 10 vs, Thence S 45
W. at 3844 vs. Set a Post for
the ^D N.W. corner, from which
a Post Oak 10 in dia, bs, S 44
E. 10 vs, and a ^D 12 in dia, bs,
S 40 E. 11 vs, Thence S 45 E. at
6502 vs. Set a Post for the ^D N.W.
corner, from which, a Post Oak
16 in dia, bs, S 89 E. 10 vs, and
a ^D 12 in dia, bs, S 69 E. 18 vs,
Thence S 45 E 3844 vs. to the ^D S
W. corner of League ^D. Thence
S 45 W. with the ^D S.W. boundary
line of S^d League 6502 vs to
the place of beginning

~~58~~ League $\frac{F}{2}$ South of $\frac{A}{2}$ & $\frac{C}{2}$
 Beginning at the S.W. corner
 of League $\frac{F}{2}$. at a Post from which
 a Post Oak 15 in dia. $\frac{C}{2}$, N 89 E.
 10 vs. and a $\frac{D}{2}$ 12 in dia. $\frac{C}{2}$, N.
 89 E. 18 vs. Thence S 45 E. at
 5502 vs. set a Post for the S.W.
 corner from which a Post Oak
 13 in dia. $\frac{C}{2}$, N 85 E. 3 vs. and a
 $\frac{D}{2}$ 9 in dia. $\frac{C}{2}$, N 9 E. 2 vs.
 Thence N 45 E. at 350 vs. en-
 tered Prairie at 3040 vs. &
 left Prairie, 3262 vs. to the S.W.
 corner of League $\frac{B}{2}$. Thence
 same course, with the N.W.
 boundary line of S.A. League
 582 vs. to the S.W. corner of
 $\frac{C}{2}$. Thence N 45 W. with the S
 W boundary line of S.A. League
 6502 vs. to the S.W. corner

59

Thence S 45 W with the S. E.
boundary line of League
E₂ 3844 vs to the place
of beginning.

League G North of Cum-
mings Creek. Beginning at
the S. W. corner of League D₂
at a Post from which a Post
Oak 13 in dia, by, N 85 E 3 vs
and a do 9 in dia, by, N 3 E, 2 vs
Thence S 45 W, 904 vs set a Post
for the N. W. corner, from which
a Post Oak 11 in dia, by, N 12 W,
9 vs, and a Black Jack, 10 in
dia, by, S 55 W, 10 vs, Thence S.
45 E, at 6000 vs set a Post for
the S. W. corner, from which
a Post Oak 16 in dia, by, N 61
E, 6 vs, and a Dⁿ 12 in dia, by,
S 59 E, 4 vs, Thence N 45 E



50

4166 vs to the S.W. corner of
 League $\frac{B}{2}$. Thence N 45 W with
 the S.W. boundary line of S^d
 League, ~~Thence S 45 W with~~
~~the S.E. boundary line of~~
 League $\frac{F}{2}$ 6000 vs. to the
 N.W. corner. Thence S 45 W. with
 the S.E. boundary line of
 League $\frac{F}{2}$ 3262 vs to the
 place of beginning

James G. Wilkinson
Gardner Co.
P.T.B. issued Oct 14 35 Vol 10 p. 145.

League $\frac{1}{2}$ South of Cummings
 creek Beginning at the ^{ext^l} West
 corner of League $\frac{1}{2}$. at a Post
 from which a Post Oak 15 in
 dia, br. $\text{S } 54^{\circ}$ $\text{W } 10$ vs. and a D°
 $\text{N } 10$ in dia, br. $\text{S } 89^{\circ}$ $\text{E } 14$ vs. Thence
 $\text{S } 47^{\circ}$ $\text{W } 17$ vs set a Post
 for the ^{ext^l} corner from which
 Post Oak 14 in dia, br. $\text{S } 16^{\circ}$ $\text{E } 15$
 vs. and a D° 12 in dia, br.
 $\text{S } 68^{\circ}$ $\text{W } 7$ vs. Thence $\text{S } 43^{\circ}$ $\text{W } 5$
 vs. set a Post for the
^{ext^l} corner from which a Post
 oak 15 in dia, br. $\text{S } 10^{\circ}$ $\text{W } 15$ vs
 and a D° 12 in dia, br. $\text{S } 5^{\circ}$ $\text{E } 13$
 vs. Thence $\text{S } 44^{\circ}$ $\text{E } 44$ vs
 to the ^{ext^l} corner of a league
 granted to Ross Philips. Thence
 same course with the ^{ext^l} N.E.
 boundary line of sd. league

[Large handwritten signature or scribble across the page]

82
~~400000~~

to the ~~NW~~ NW corner of
a League of land granted to
Mr Russell. Thence N 43 E with
the NW boundary line of S^d
League 5154 m to the ~~NW~~ NW cor-
ner of Mr^s Williamsons League
thence N 44 W with the S^d NW
boundary line of S^d League
3400 m to the place of begin-
ing.

Er

and find Er in this or
in his former work.

AN Title map

Robert G. Bangs, NE Situated on the head
Quarter League of No. 1 ~~the~~ was 85

0/6 - Tax & issued Oct 5/35 - Vol 10 - p. 45. Gray 200 County

top of Runnings Creek, Be
gining at the ~~the~~ N.W. corner
League $\frac{A}{2}$ set a Post from
which a Post Oak 15 in dia, br,
I 67 W. 10 ns, and a P. 10 in
dia, br, I 89 E. 14 ns, Thence
S 47 W with the N.E. bounda
ry line of League $\frac{H}{2}$ at 1447
ns past the ~~the~~ corner at
2400 ns, set a Post from which
a Post Oak 12 in dia, br, I 66
E. 2 ns, and a P. 13 in dia, br,
I 24 W. 14 ns, Thence S 43 E,
at 2314 ns, a Black Oak for
the ~~the~~ corner, from which a
Post Oak 11 in dia, br, I 30 W,
8 ns, and a P. 13 in dia, br,
I 45 E. 9 ns, Thence S 47 E, at
2400 ns, intersected the N.W.

Robt. G. Bangs

SP 54

boundary line of League
A₂ - where set a Post for the ~~S~~
~~S~~ ^{East} corner. from which a Post
Oak 13 in dia. bs, 9 3/4 w, 9 vs.
and a 20 1/2 in dia bs, 10
9 w, 16 vs. Thence 9 3/4 w.
with the N. W. boundary line
of S. League, 23 1/4 vs. to the
place of beginning -

87

85

59

33

70

71

34

72

5623

2000

4847

11246000

9694

15520

1434

9790

9694

960

2320

7L

73

35



77
Beginning at a Live
Oak thence West 1200
Bars thence N 60th E
Small Indian Baring E
thence N 400 thence E 200

N 1000

E 900

N 1000

E 1000

N 1000

E 600 to the River

W 1600 800 to the river

~~W 1200~~

~~N 1000~~
550

Field Book of Thos.
 Williamses Leigue of

Beginning Land
 Beginning at the Nor-
 th East Corner on the
 South Side of the Colorado
 on a Line Cook attached

T^o W thence South East
 1000 Paces thence North
 900 P 250 Paces to the River
 thence West 400 P thence
 North 580 P thence West
 80 P thence North 90 P
 thence West 240 P thence
 North 1440 P
 thence East 200 P thence
 North ~~to the Colorado~~ Call of 90

~~the~~ ~~to~~ ~~the~~ ~~line~~ ~~East~~ ~~of~~ ~~79~~
~~to~~ ~~the~~ ~~line~~ ~~thence~~ ~~1400~~
1400 B thence East to the
River - ~~2800~~ ²⁸⁰⁰ on offset
thence North - ~~1350~~ ¹³⁵⁰
to the Corner on a
Hackberry ^{14 in diameter} marked TW
a live oak bearing North
West 11 Links 20 inches
diameter thence West 290 ft
bars to the corner on a
Post oak marked TW 14
inches diameter bearing
1 chain 4 Links ~~a Post oak~~
North 37 East a Post oak
bearing South East 1 ch
24 Links a Post oak

Bearing North 70 -
 West 1 ch 37 Links
 thence South 5400 B
 to a Creek Bearing East
 thence to the Corner 498
 in the praxe thence
 North East to the

beginning

	1150	150	150	150	150
	5400	2100	1000	400	
125	5500				
	<u>100000</u>				
	270000	3900			
	280000	320	24		
	0098	4221			
	0835	1086			
		<u>530000</u>			
	0076				
		1350000			
	0061				
	0098				

81 10th

Jesse Burnum
Jesse Burnum
League of Land -

Beginning at the
North West Corner on
the South Bank of the
Colorado - on an Elm
14 inches Diameter 1 mile

have a Shoat and very
good Ford a Hackberry
Baring North 20 Links
from Elm Baring South
3 links thence South
61 West with the
conditional line 2100
thence South - 1000

thence East - 400 B
 thence South - 320 B -
 thence East - 1060 Bars -
 to the Mouth of a Stream
 Bearing East thence
 South - 750 thence
 East - 2300 B ^{to the River} thence
 South - 570 Bars to a
 Stream Bearing South East
 430 B thence East 470 B
 thence South 400 B -
 thence - East 330 B -
 thence South 400 B -
 thence East - 1530 B
 thence South - 160 thence
 West - 240 B thence
 South - 150 B -

thence West 740 P⁸³

thence South 200 P

thence West 200 P

thence South 650 P

~~thence East 100 P~~

~~South 710 P~~

~~West 100 P~~ thence South

~~740 P~~ with a Creek Bar

ing, East - one chain wide

Continue on - 690 P thence

East 1635 P - thence

South ~~100 P~~ ^{then} 2 P to the

Corner on a ~~100 P~~ ^{then} 2 P to the

Red I B on Boulder Baring

South 29 Links a ~~100 P~~ ^{then} 2 P to the
Baring South 30 East 74 Links

82
thence South - 7 10 B
to the Corner on a Cotton
Wood Marked I B 2 feet
Diameter a Cotton Wood
Bearing South 1 chain 10 L
a Cotton Tree Bearing South
54 Links 49.50 B Avg over
thence West
5400 Bars to the same
on a Live oak Marked
IB a Jack Oak Bearing
North 20 West 1 Chain
15 Links a Live oak Bearing
South 70 West thence S
outh - 58 70 Bars to the Corner
- 3750 Bars to a Live oak
Bearing East - - -

Baring Worth
49 50 2 -

Bearing

5440
3750

2090



88

Field Notes of Thomas

8 1/2 feet High

3,6
8,5

6 1/2

Wide

140
240

5 1/2

Wide

3060 6,9
71 5,5

6,5
10,5

3060 345
1430 345

325
650

17360 3795
103 18,5

6825
58 54

14975

54800 (2)

30360

274

322575 (2)

10,5
6,5

161,28 7 1/2

525
630

191)

68,25
56

40950

34125

342100

371

1000
 320 1775
 850 1775
 1000 1950
 400 4600
 400
 160 6200
 150 5250
 200 5500
 650
 710 27045

340 3863 1/2 60
 56
 444
 42

27041000 2 25
25000000 2 21
2041000 2 4

27041000
 5500) 2041000 (371
 1851
 391

2041000
 345
 60
55

92

beginning at

Pearson's lower

corner then you

go west to the

corner on a state

road which is

12 bars

102 feet

a live oak corner

13 bars then

go south 400 bars to the

corner on a state

road which is live oak

bars D 20 & 20 bars
Marked 1 D 12 In Dia
a Live oak bars 40
W 4 bars three East

Arthur H. Carver

on a Sukamore
Marked FP Six In Dia
from which a Sukam
ore bars 3 10 W 10 bars
12 In Dia on Live oak
bars West 15 bars
18 In Dia three South
3500 bars to the corner
on a Live oak

Marked F P 6 In dia
 from which a P Oak
 faves Dr W 10 faves
 12 In Dia a P Oak
 oak faves Dr W 9 faves
 15 In Dia same
 Case 5600 faves to
 the SE corner on
 an Ash marked
 F P 2 feet Dia
 from which an Oak
 faves Dr W 10 faves
 2 feet Dia on a Oak
 faves Dr W 8 faves to 15
 In Dia

96

(No 3)

from a Stake from
 which a Post line
 bears S 30° W 25 bars
 15 In Dia a Post
 at end bears N 45° W
 20 fars S 60° Dia
 thence West 7 1/2 bars
 to the corner of a
 Stake from which
 Post line bears S 45° W
 17 fars Marked
 at end bears S 55° W 16
 fars thence W
 7 1/2 fars to the corner of

State from a how
 a post oak bar
 18th 19th 10 far marked
 of a post oak
 bar of 8th 5th
 marked of 12 2nd
 then of 7 34
 bar to the 8th
 of 8 or a state

111.00
 000.00
 000.00
 000.00
 000.00
 000.00
 000.00
 000.00

17400400 471
 676108665

Beginning at
 877 corner of 5th

Stone 8th 300

South West 800

North 500

West 300

North 450

West 320

North 400

West 400

North 400

West 400

North 400

1350
 575
 1925

600
 540
 600

1113
 1113
 1113

November

Corner of 28th on a stake upon
which a Post oak grows S 64 E 59th bars
12 In dia thence South

—
—
—

1000
0001

115

50

716

48,752 over of 3 ^{bars} 96

In the corner of ...
 Beginning at the SW
 Corner of Capt. Jamlinson
 League of Land on the
 N Bank of the Colorado
 thence North with S
 Jamlinson's Line 1300 fars
 to the NE Corner on a Stake
 from which a Post Oak
 bears S 30 W 25 Marked N^o 1
 a Jack Oak bearing N 89 W
 20 fars & In Dia thence
 West 770 fars to the SW
 Corner on a Stake from
 which a Post Oak bears
 S 47 E 17 fars Marked N^o 1
 12 In Dia a Post Oak

Bars S 58 W 16 Marked
 No 2 12 In Dia three South
 1250 bars to the SW Corner on
 a Post from which a rod
 bars S 49 E 10 Bars to In Dia
 on Willow Bars S 55 W 7
 bars 14 In Dia Marked No 2

No 2 Beginning at the
 SW Corner of No 1 three
 West 775 bars to the SW
 Corner on a Stake from
 which a Post oak bars S 17 W
 10 bars Marked No 2 12 In Dia
~~the rod a Post Oak~~
 bars S 83 W 3 bars Marked
 No 3 12 In Dia three South
 1250 bars to the SW Corner on
~~the rod a Post Oak~~

a Hackberry marked No¹¹⁹
 from which a box Elder
 bears S 70° W 9 marks 13
 9 In Dia an Elm bears S 80° E
 9 bears 13 In Dia

No³ Beginning at the
 North West Corner of No²
 thence West 43 1/2 bars to the
 S W Corner on a Stake from
~~which a Hackberry marked~~
~~No² from which a box Elder~~
~~bears S 70° W 9 bars Stake~~
 from which a Post Oak
 bears S 55° E 4 bars 15 In Dia
 a Post Oak bears S 79° W

9 bars 15 In Dia thence
 South 1100 Bars to the
 S.W. Corner on a Post
 from which a Collonwood
 bars 860⁰ 5 bars Marked
 D⁰ 2 feet Dia an Elm
 870 W. 3 bars Marked D⁰ 4
 12 In Dia thence S from the line
 with the meanders thereof to the
 S.W. Corner of D⁰ 3 thence E to the
 beginning including

~~D⁰ 5 Beginning at the
 S.W. Corner of D⁰ 3 thence
 West ~~to the corner
 on a stake from which~~~~

~~bars~~
 D⁰ 4 Beginning on the
 opposite board a line of D⁰ 3
 415 bars from the S.W.
 corner ^{on a stake that marked D⁰ 4} thence West 900 bars
 to the S.W. Corner on a Post
 from which a Post oak bars

121

S 60 E 19 bars marked N^o 4
12 In Dia a Post oak bar
S 60 W 10 bars 12 In Dia three
South 1200 Bars to the S.W.
Corner on a Post from which
a Hickory Ash bares East
4 bars marked N^o 3 In Dia
a Hackberry S 54 W 4 bars
marked N^o 2 In Dia

N^o 5 Beginning
337 Bars from the N.W. Corner
of N^o 4 ~~on~~ on the W boundary
line of N^o 4 on a Post
from which a Pecan bares
S 40 W 10 bars marked N^o 5
three West ~~10~~ bars to the
N.W. Corner in Prairie Set.
Post from which a Live oak
bares South 95 bars marked

N^o 5 thence 1300 bars to
 the SW corner on a post
 from which a Hackberry Barre
 N 40 E & marked N 5 9 In Dia
 a Hackberry Barre N 35 W 7 bars
 marked N 6 7 In Dia

N^o 6 Beginning at the
 SW corner of N^o 5 thence
 North 300 bars thence
 400 bars to the corner on a
 post from which another
 barre East 44 bars marked
 N 6 14 In Dia an-oth^r
 N 45 W 7 bars marked N 7
 15 In Dia thence North

1100 bars to the S.W. corner
 on a ~~Stake~~ Stake from
 which a Live Oak bares S.E. 50 paces
 Marked N^o 6 thence East 80 paces
 to the N.E. corner on a Stake
 from which a Live Oak bares
 S 76 E 3 bars Marked N^o 6
 15 In Lin a Live Oak bares S 67 E
 3 bars thence South to the begin-
 -ning

Day Beginning at the
 S.W. corner of N^o 6 thence S 40
 500 W 300 E N 45 50 West 300
 N 40 00 West 200 to the corner
 on Post from which a
 overcap Oak bares S 73 E 3 bars
 Marked N^o 9 In Lin an Elm
 bares S 60 W 3 bars 4 In Lin
 thence North 5 80 bars

to the S^W corner on a
 Post from which a willow
 oak bar 8 E 3 bars marked
 N^o 14 In Dia a willow oak
 bar. North 3 bars 14 In Dia
 then East 400 bars to the
 N^E corner on a Stake in
 prairie then South ~~400~~
 1927 bars to the commencement

N^o 4 Beginning at the
 S^W corner of N^o 4 then
 North 400 bars then West
 400 bars to the S^W corner
 on a Post from which a
 Bar Elder N^E 2 marked N^o 5
 15 In Dia an ash N^o 3
 7 bars marked N^o 9 3 In Dia

thence North 450 bars
 to the N W corner on a
 Stake from which a Post
 oak bares S 64 E 59 bars
 12 In Dia thence East 800
 bars to the S E corner on a
 Stake in Prairie thence South
 1927 bars to the beginning
 including one La bar

S 9 Beginning at the
 S W corner of S 9 thence
 North 450 bars thence
 West 1200 thence North
 775 bars thence West 250
 to the N W corner on a
 Stake from which a
 Hackberry bares S 20 E 4 bars
 on the S 9 & India a Hackberry

126
143
7
Pines at 7 off 12 bar marked 10
thence East 1430 bars -
to the S.W. corner on a stake
in Prairie thence South
1223 bars to the beginning
Including one labor -

N^o 10 Beginning at the S.W.
corner of S^o 9 thence South
640 bars thence West 50 bars
to the S.W. corner on a
stake from which a cotton
wood Pines South 1 Bar marked
S^o 10 a cottonwood bars S.W.
then Marked S^o 11 2 feet dia.

127

thence East 1510 bars to the
S.E. corner on a stake in
prairie from which a
oak bar West 163 bars
Marker N^o 10. 18 In Dia
a cluster of Live oak bar
S 51 East 43 bars thence
South 680 bars to the S.E.
corner of N^o 9. thence West
1430 bars to the Beginning
Including one Labor.

N^o 11 Beginning at the
S.W. corner of N^o 90 thence
East 500 bars thence North
500 bars thence East 260 thence
North 200 to the S.W. corner
on a stake
from which an oak

Bears East 5 Bars M^o
 No 11 ^{1/2} In Dia an Ash Bars 5⁹ W
 14 Bars ~~thence East~~ 14 In
 Lion thence East 10²⁷
 Bars to the N E corner
 on a Stake in Prairie
 Marked No 11 - 4 In Dia
 from which a Pickery
 takes N 11 W 1^{1/2} Bars 8 In
 Dia a Pickery Bars No 36²⁷
 29 Bars 6 In Dia thence
 South 700 Bars to Mound
 thence West 277 Bars to the
 N E corner of No 10

No 12 Beginning at
 the S^W corner of No 11
 thence E 497 bars thence
 North 900 to the S^W
 corner on a Stake from
 which an overcup oak
 bars S³E 6 bars marked
 No 12 2 feet 6 In dia a Hack
 berry bars S 13 W 6 bars
 thence East 940 bars to the
 S^E corner on a Stake
 from which a Post
 oak Posters S 49 W 4
 bars marked No 12 10 In
 dia a Post oak bars
 S 4 W 10 bars 15 In dia
 thence South 700 bars

130
to the SE corner on a
Stake from which a
Port Oak bears S 85° W
30 fars marked 2012, 10
India a Port Oak bears
S 52° W 43 fars to India
thence West 1477 fars to
the Place of Beginning
including one Lebar

4

918

918

918

918

144

145

986

3852.5 (1488)

1488

273.645600

1486.41400

9600

1760

960

1600

41600

3900

9600

960

1800

17⁰ 14⁰ 1/2

at the
of 10 10

East 40

North 10

East 10

West 10

at the

no. 10

at the

134

980
4
1,074

91
1



113
150
4841
094
1024

Handwritten scribbles and symbols, including a large plus sign and some illegible characters.

21627900
313950
204

894

506
095
560

680
250987
100000
313950

86

8.50
100.00

12) 49.50
49.50
100.00

1300
1100
1000
900
800
700
600
500
400
300
200
100

14) 2.50
2.50

1937
27
90
77
6

130

1790

1790

1790

18190

1790

11400

89

99

55

45

55

89

375

860

1223

1822

137

61

138

12 1825

(No 4)

North Corner of Betty's
Situ: on a Stake from
which a Pecan falls
N 10 W 2 3 bars 10 In Dia

South Corner on an Elm
Marked JT 8 In Dia from
which an Elm falls
S 3 E 4 feet 6 In 15 In
Dia. an Elm falls
7 bars Marked JT 12

S.E. Corner on a Stake
from which a post oak
falls N 55 W 100 bars
1 1/2 In Dia a post oak
falls S 89 E 3 bars 6 In Dia

S W Corner on a Poak
 Market J D 4 In Dia. from
 which a Poak bares S 50
 5 fars a Poak bares S 60
 2 bars 4 In Dia. same
 S 50 E 5000 bars to the S E
 Corner on a Poak Market
 T E 4 In Dia. from which
 a Jack oak bares East
 10 fars a Poak bares S 4
 20 fars 2 In Dia. same
 S 37 W to the S E corner
 on a Cotton wood Market
 T E 1 2 In Dia. from which
 a Hackberry bares S 27 E
 27 bars 4 In Dia. 100 Cotton
 wood bares S 6 W 3 fars 4 In
 Dia.

Same as in Book 1 page 224 1/2
Andersons Sello 11/2

beginns on an Ash
Marked A 13 In Dia from
which an Ash bares SW
4 bars marked IP an Ash
bares SE 14 feet 12 In Dia
thence SE 565 bars to the
SE corner on a Stake from
which a Pecan bares SW
25 bars 10 In Dia thence
NW 6000 bars to the SW
corner on a stake from
which a Post oak bares
N 25 W 15 bars 9 In Dia a
Post oak bares S 5 E 4
bars Marked A 6 10 In Dia
thence SW 2000 bars to the
SW corner with 9 cuts

144

145

65

140

4 98

197.75

004.1
56.801

096.75

097.7
008.5
009.7
006.4

9340
4690

6.00
1.500
1.600
1.500
5.00
3.00
6.50

276350

3170

1270

41150

2100

5000

3250

15565

3

440

1065
1069
1625

beginning at the
corner of the 12

- thence N 85° W 800 - Do
- S 12° W 400 - Do
- N 7° W 1200 - Do
- S 45° W 1400 - Do
- 140 bars S 45° W 600 - Do
- S 62° W 1500 - Do
- West - 500 - Do
- N 74° W - 300 - Do
- N 50° W - 450 - Do

beginning at S. B. corner
upper corner

- thence N 25° E - 1000 bars
- N 7° W - 500
- N 40° W - 600
- N 75° W - 500
- S 23° W - 600
- S 17° W - 500

S 90 W	600	bars
S 90 W	500	
S 90 W	900	
S 70 W	5800	

George Dutz Site
 of Land beginning
 at the South Corner
 on a Cottonwood. Marked
 G.D. 5 feet Dia from
 which a black line
 faced S 90 W 1 foot thick
 of 300 ft

S 63 W	900	700
S 65 W	1300	
S 68 W	1000	500
S 68 W	1400	

George Dwyer
Same as Ch 4 p. 2

George Dwyer's Sites
 begins at a Live Oak
 marked C D 7 In Dia
 from which a Post
 oak bears S 35 E 12 bars
 In Dia situated on
 the N E bank of the
 Colorado 300 bars below
 the Mouth of a Creek
 thence N E 4.500 bars
 to the East Corner
 on a Stake from
 which a Post Oak
 bears S 77 W 3 bars
 marked C D a Post
 oak bears S 84 W
 1 bar In Dia a Post
 oak bears S 23 W 7 bars

~~thence~~ ^{N 15°} N W 5,000 bars
 to the North Corner on a
 point 15 India Marked
 from which a Poak bar
 SW 10 bars 12 India or Poak
 bars S 12 W 12 bars 15 India

thence ^{00 4} 000 7 545
 West 51 7 5 1/2 bars
 to the ^{05 1/2} ~~North~~ Corner on
 a Cotton ^{00 00} Marked
 6 D 4 feet Dia from
 which a Cotton bar
 S 29 W 10 bars 3 feet Dia

159
~~100~~ 16 18 1/2

157

68

152

1510
 1520
 1530
 1540
 1550
 1560
 1570
 1580
 1590
 1600

No 5

153

69

154

155
Beginning at R. Bluff
Corner

S 49° E	1900
S 55° 30' E	900
S 50° 30' W	900
S 27° 30' W	2200
S 16° 30' E	1400
South	700
S 26° 50' W	1400
S 42° 0' W	1200 - Bluff
S 26° 0'	300
S 15° W	400
S 38° E	3900
East	3300
S 74° 30' E	1700
S 37° E	000

150

thence by 360	11500
by 470	1200
3210	2400
3600	1200
3260	2200
3150	1600
3230	400
3310	5200
1730	

3300	2000
3680	2000
3600	6000
3100	9000
3200	6000
3350	2500

to 01 corner
 11400

11400
 4200
 11500

157
Began at Elizabeth

Tomlinson's N W Corner

on a box Elder Marked

ET thence S 6³⁰ E 12.00

bars to the SE corner on

Stake on a Post Oak

Marked N^o 1 of the ~~the~~

a Post Oak Baring

N W 10 bars 12 In Dia

a Post Oak Baring N 6³⁰ W

12 bars 14 In Dia thence

West 90^o bars to the N W

Corner on a Stake from

which a Post Oak

East 4 feet 10 In Dia

a Post Oak Baring

N 75^o W 2 bars thence

South 13⁰⁰ bars to
 the S^W Corner on
 a Hackberry Marked
 S⁰¹ from which a Mulberry
 by bars N 65⁰⁰ E 8 bars 9⁰⁰
 Dia an Elm S 67⁰⁰ W 11 bars
 9⁰⁰ In Dia thence Down the
 river to the beginning

S⁰² Beginning
 at the S^W Corner of S⁰¹
 thence West 72⁰⁰ bars to the
 S^W Corner on a Stake
 in prairie from which
 a Post Oak Barre N 10⁰⁰ E
 Marked S⁰² a Post Oak
 bearing S 53⁰⁰ W 15 bars
 Marked S⁰³ thence

1445

159

North ~~to~~ bars to
 the SW corner on
 a Box Elder Marked No 2
 of In Dia from which a
 Hackberry Barre No 2
 3 bars Marked No 2 a
 Cherry 8 1/4 W 4 bars Mark
 No 3 of In Dia

No 3 of Beginning at
 the SW corner of No 2
 thence West 700 Bars to
 the SW corner on a
 stake from which a
 of oak bars No 3 4
 19 bar Marked No 3 12
 Dia a of oak Barre
 SW Marked No 3

thence North 1500
 bars to the N^W Corner
 on a Post from which
 on Cotton Wood bars 3 70⁰⁰
 10 bars Marked N⁴ 4 feet
 Dia a Cottonwood boring
 N⁶ E 13 bars Marked N³
 4 feet 6 In Dia thence Down
 the river to the S^W Corner
 Corner of N³ thence to
 the S^W Corner of N³
 N⁴ Beginning at
 the S^W Corner of N³
 thence West 655 bars to
 the Corner on a Stake
 from which a P oak

Bars $N 86^{\circ} 50$ bars ¹⁰¹
Marked $N 86$ 15 In Lin
a Poak. Bars $N 35^{\circ} W$
12 bars Marked $N 5$ 15 In Lin
thence North 1570 bars to
the NW corner on a Cotton
Wood. Marked $N 48^{\circ} 5$
off Hackberry $S 5^{\circ} W$ 6 bars
thence down the wood
specimen East of bar
to the SW corner of
 $S 8$ thence to the SE
corner

$N 5$ Begon may at
the SW corner of $S 8$
thence West 632 bars to
the SW corner on a
stake from which a Sack

152
at Barb N 58 E Marked
N^o 5 10 In Dia 93 bars
thence North 1640 bars
to the corner on a Post
from which an Elm bar
of 99 E 4 bars Marked N^o 5
6 In Dia a loc Elder bar
of W 6 bars Marked N^o 6
6 In Dia thence Down
the river with the Miami
there of to the S W corner
of N^o 4 thence South to
the beginning —
N^o 6 Beginning at
the S W corner of N^o 5
thence West 610 to the
corner on a Post Oak
marked N^o 6 thence

North 1780 Bars to the

Corner on a front which

a Post oak bares N46E

4 Bars 6 India a post oak

baring N72W 4 bars

thence North 1780 bars

to the S W Corner on a

Cotton wood Marked S68E

3 feet 6 India from which

a Hackberry bares S50E 4 bars

6 India a Post Oak N40W

2 bars 7 India

Beginning at the S W

Corner of S6E thence

West 590 to the corner

on a ~~Post oak~~ Jack oak

2 India from which a

post oak bares S60E 11 bars

marked S70E 12 India
a Post oak baring N10E

154

thence North 14.00 bars
to the corner on a Beech
Elder marked 1788 from
which a Hackberry bears
N 40 E 4 bars 3 In Dia
an Elm bears S 75 W
to bar 9 In Dia thence
down to the S W -
corner of N 6 -
N 4 beginning at the
S W corner of N 4 of the
West 555 bars to the S W
corner on a Hackberry Mar
N 4 6 In Dia from which a
beech Elder bears N 50 E 5 bars
S In Dia an Elm bears N 6 E
to bar 10 mark N 9 6 In Dia

thence South to the SW
 corner on a Post oak ^{12 India}
 Marked 20 1/2 from which
 a Post oak ^{Barred 1/4}
 W Marked 20 1/2 ^{India}
 thence East to the SW
 corner of 20 1/2 bars

20 1/2 Beginning at the
 SW corner of 20 1/2 thence
 West 555 bars to the SW
 corner on a Stake from
 which a Post oak ^{Barred 1/4}
 20 1/2 bars Marked 20 1/2
 a Post oak bearing N 70 W
 10 bars - 10 India thence

188

North 1400 bars to the
 SW corner on a stake
 from which a Pigeon bar
 N 55 E 9 bars Marked No 9
 to India a Pigeon bar
 N 55 W 14 bars Marked
 No 10 thence down the line
 to the SW corner of No 9

No 10 Begins at the SW
 corner of No 9 thence West
 55 3 bars to the corner on a
 stake from which a cotton Wood
 bar N 40 E 25 bars to India
 Marked No 10
 a Cotton Wood bar
 Marked No 11
 N 52 W 14 bars

thence South 1200 bars to
 the S.W. corner on the State
 from which a Jack Oak
~~marked~~ bars N 45 E 170 bars
 marked N 10 4 In Dia
 thence East to the S.W. cor-
 ner of N 9 thence North
 1450 bars to the beginning

N 11 Begins at the
 S.W. corner of N 10 thence
 West 400 bars thence
 North 200 to the S.W.
 corner on a Hackberry
 marked N 11 12 In Dia
 from which a Hackberry bar
 S 45 W 6 bars Mark
 N 12 ^{12 bars} Hackberry bar
 the 4 bars 8 In Dia

108

then South 150 bars
 to the S^W corner
 a Stake in Prairie
 then East 400 bars to the
 S^E corner on a Stake
 on the West Boundary Line
 of S^o 10 from which a Post
 oak bar North 3 bars Mark
 S^o 11 15 India or Post oak
 bar South 6 Bars 15 India
 then S to the beginning
 1,150 bars

S^o 12 being at the S^W
 corner of S^o 9, then South
~~1400 bars then West~~
 100 bars to the corner.

on a state from ¹⁰⁹ where
a person bears South 10 to
marked S^o 12 thence
South 360 bars to the
corner on a Post in Prai
in thence East 1100 bars
to the SE corner at a
Post in the Prairie
thence 110 bars to the SW
corner of S^o 11.

170

171

78

172

10500

12100

22600

1,1300

4700

00000000

79100

45200

53,110,000

26,555,000

1774

437.00
564.00
1 1000
2 1000
0 1000

4600
9400
292

18800
56200

50000000

50000000

50000000

50000000

9400 6900

9400

four feet in

at Mulberry Branch 15

10 feet 12 in in cut

2 feet 2 in - Branch 590

the other with marks

to West-Corn

175

20

170

North corner of Aug 177
on a Post oak Market
14 In Dia a Post oak
bearing 52 West 3 bars 6 in
a Post oak bearing 50
3 bars off Boundary Line 11400
then 5 ft East 5000

178

to the corner on a point
in Prairie thence S 20° W 40

Corner of ~~Tray~~ 2500 Bars

from Post ~~to~~ a Post
at bearing ~~of~~ S 56° E 7

bars 12 In dia a Post and

Bearing East 10 bars 15 In dia

Beginning at the
 Corner of N^o 5, Run
 N 20 E ~~thence~~ 720 to the
 N 70 W 3,800 to the Corn
 of N^o 6 thence N 20 E
 1,020 to thence N 70 W
 3,000 thence N 20 E
 1,150 thence N 70 W
 3,000

5100
 3333
 3000
 41650
 5000
 3650
 11333

North line of
 6902 Paces
 6902 Paces
 2400

Beginning at the

S W Corner of D. 4

thence	N 70 W	2400
	North	200
	N 44 E	750
	S 42 E	300
	N 59 E	350
	N 45 W	340
	N 77 W	600
	North	240
	N 16 E	1070
	N 62 W	360
	S 55 W	340
	S 17 W	440
	N 43 W	450
	N 83 W	990

8630

3266.20
 90.4680
 55.15320
 33.152
 17.

	Home North	500
	S 27 E	240
	North	430
	N 40 ⁰⁰ W	600
90	S 26 E	750
54	N 42 ⁰⁰ W	620
36	S 46 ⁰⁰ W	930
45	S 52 ⁰⁰ W	340
	North	750
51	N 41 ⁰⁰ W	250
	West	200
40	S 61 ⁰⁰ W	660
		6690

	Home S 38 ³⁰ W	650
	S 3 E	540
	N 10 E	5400
	S 41⁰⁰ W	3900
150	S 23 E	580
	S 37 ⁰⁰ W	200
		5640

182

them	N 64 W	330
	N 49 W	430
	West	500
	N 24 W	900
		1720

them	N 24 W	460
	N 24 W	960
	North	150
	N 35 E	100
	N 42 E	260
	N 30 E	370
	N 53 W	480
	West	640
	N 10 W	200
	N 10 E	680
	N 54 W	740
		5960

them	N 10 0	
	N 20 0	- 500
	N 80 0	420
	S 23 E	600
	N 40 W	140
	N 40 E	160
	N 60 E	850
	N 23 W	500
	N 55 W	260

3460

them	N 65 W	200
	N 26 E	580
	N 45 W	1000
	N 60 W	900
	N 31 W	450
	N 77 W	300
	N 46 W	800

~~2300~~ 5450

June 27 1,000

6530 Dr 800 - 1,000

6400 Dr 2 1,000

5450 Dr 1930 X

14380 Dr 360 - 1200

11900 Dr 550 - 400

6 1890 6500

June 28 800

2500 Dr 450 400

Dr 2200 200

Dr 600 700

Dr 1000 1100

Dr 700

6,500

6400
6600
10900
10900

185

85

180

187
The west corner of the
stone on Cotton street
marked 807

1250
1250
= 1350
7950

800
800
2000
1600
4000
4000

00

800 1000 112

881

189

87

190

on Site No 1 on
 Hackberry 18 In Diameter
 Hackberry Bears N 85
 8 bars 12 In in Diameter
 Hack Bears S 72 W
 9 bars marked S 2 1/8 In
 Diameter

24 Corner of Site No 1 on
 a Hackberry marked No 1
 18 In in Diameter
 an Elm bears S 63 W
 13 bars 14 In Diameter
 marked No 1 - - -

1 Corner of Site No 1
 on a Post oak 8 In Diam
 marked N 1 from which
 a Post oak bears N 85 W
 marked N 2 10 In

92

SE Corner of Lot on

N^o 7 on Mulberry Mark^o

N^o 7 10 In in Lot from
which an ashbar is 40 Ed

4 bars 3 In in Leamtea made

no 8

194

195

90

98

S E Corner of Site N^o 4
on an Elm marked N^o 4
24 In In Diameter from
which an Elm bears S 60
E 12 bars 10 In in Diam^r
Marked N^o 5 - - -

S E Corner of Site N^o 5
on an Elm marked
N^o 5 9 In In Diameter

S E Corner of Site N^o 6
on an Elm marked N^o 6
9 Inches In Diameter
from which an Elm bears
N 66 E 10 bars 18 In In Diam^r
Marked N^o 5

197

91

75
S E corner of the tract
on State Boxelder

bars 26 E 2 bars 4

^{marked in 3}
in diameter from which
Boxelder bars 79 w
in diameter

S E corner of Site N^o
on State from which a
live oak bars 54 w 9 bars

12 in in diameter marked
N^o 4 a live oak bars
w 64 w 14 bars 18 in
in diameter mark
N^o 3

Field Notes of Land

Surveyed on west side
of Colorado

199

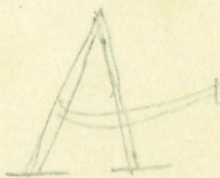

92

50 :

Notes of Land ~~the~~ line of
 a league laying to the South
 of Sims league beginning
 at the N.W. corner made
 by Cummings. Thence
 S. 80 E. at 1400 vs crossed
 a road at 2080 vs a dry
 branch of Bowmans creek
 running N.E. at 5000 vs
 set a Post from which
 a Post Oak 13 in dia N.
 54 E. 65 vs and a Post 11 in
 dia S 38 W. 4 vs. Thence N.
 10 E. at 4790 vs a creek run-
 ing E. at 5000 vs intersected
 the South boundary line
 of Sims League where
 set a Post from which a Post
 18 in dia N 15 W. 14. vs and
 a Hickory 13 in dia N. 1 W. 10 vs

202

217
Tul. in rec. Oct 19/35. Vol 10. p. 217.
James W. Pankey.
Grimes Co

League A, 231 203
Surveyed for Pankey
a League of land laying
on the Labakia Road
East of the Pinos.
Beginning at the S.
corner of a League
joining Sims on the
South. Thence c. 1.800
at 960 vs crossed a Branch
running c. 1. E. at 2200 vs
set a Post from which
a Post back 12 in Dia
S. 29 E. 11 vs. and a Post
13 in Dia S. 43 E 3 vs
Thence S 10 W. at 250
vs entered Prairie at 3800
left Prairie

20/1 at 3900 vs Road. at
4859 vs intersected the
North boundary line of
League No. 2 laying
off of Mrs Andersons
League. Where set a Post
from which a Post Oaks
12 in Dia S 73 W 5 vs
and a ~~Post~~ 18 in Dia N 85
E. 26 vs. Thence S 70 E
with said line 2184 vs
to the NE corner of said
League. Thence S 80 E at
2696 vs set a Post from
which a P. Oak 14 in Dia
N 49 E 10 vs and a Black
Jack 8 in Dia S 68 W
9 vs

Thence N 10 E at 205
5230 intersected the ~~A~~
South boundary line of
a league joining Gins
on the south of which
place a Post Oak. from
which a Post Oak 12 in di
S 63 W 9 vs. Thence N
80 W with 8¹/₂ line ²⁶⁵⁶ to
the place of beginning.

The above League is mar-
ked A.

Q. Quarter League.
N. 1 Beginning at the S.
E. corner of Gins Lea-
gue. Thence S 10 W
at 940 is a creek running

206

at 5000 rs set a Post
 from which a Post Oak
 16 in Dia N 84 E. 4 rs
 and a 90 18 in Dia
 N 6 W 5 rs. Thence N.
 80 W 1250 rs to the
 S. E. corner of a League
 selected by H. Christman
 for ¹⁶ rowman
 Thence N. 10 E. 5000 rs
 to the E boundary
 line of the League to the
~~corner~~ S E corner. Then
 S 80 W 1250 rs to the
 place of beginning

Quarter League #1

2. Beginning at Post, (on the
 South boundary line
 of Quarter League #1,
 1600 rs from the S.W. cor-
 ner of Christmans League,
 from which a Post oak
 16 in dia N 65 W 7 rs.
 and a Black Jack 8 in
 N 22 W 11 rs. Thence S
 10 W at 2500 rs set a Post
 from which a Post oak
 11 in dia S 40 W. 20 rs
 Thence N 80 W at
 2500 rs set a Post from
 which a P. Oak 16 in dia
 N 74 E 3 rs. and a Do
 18 in dia S 31 W 7 rs

208

[Faint, illegible cursive handwriting covering the majority of the page.]

Title issued July 22/36. Vol. 11 p. 645.

Grimes Co

Case

209
Quarter League No. 3

laying East of Sims
League. Beginning at
a Post, on the East
boundary line of S^d.
1200 is from the N.E. corner of said
League) from which a
Post Oak 13 in Dia ^{dia} N 47
E. 10 is and a ^{dia} 10 in
dia S 84 W. 9 is. Thence S
80 ~~W~~ at 1480 is set a Post
from which a Post Oak
16 in Dia S 85 W 15 is. and
a ^{dia} 12 in Dia S 47 E 4 is.
Thence S 10 W. at 1940 is
entered Prairie. at 2800
left Prairie at 3511 is
set a Post from which
a Post Oak 12 in Dia
N 4 W 15 is

210

and a I° 10 in Dia
 N 51 E 34. Thence N.
 60 ~~E~~^W at 1780 vs set a Post
 from which a Post
 Oak 16 in Dia N 49 E
 6 vs and a I° 11 in Dia
 N 49 W. 3 vs. Thence N.
 10 E. with the E bound-
 ary line of Quarter
 N 51, 2311 to the S. ~~E~~^E
 corner of Six League
 Thence same course
 with the E bounda-
 ry line of 1st League
 1200 vs to the place of
 beginning.



211 ~~Bad pass~~
Eduardo Arroyo
League Bon the head water of river

at the western corner of said League
Beginning at a Post
from which a Post bears
10 in Dia S 50 W 9 vs
and a D^o 18 in Dia S 3 E
40 vs. Thence N 38 E

at 5300 is a creek running
S E. at 4352 vs. set a Post
from which a Post bears
18 in Dia S 49 E, 13 vs.

and a D^o 12 in Dia N
66 E 7 vs. Thence S 52 E

at 2520 is crossed Road

at 3400 vs set a Post ^{for the eastern Cor} from
which a Post bears 16 in
Dia S 40 E 13 vs. and a D^o
13 in Dia N 34 W. 13 vs.
Thence S 38 W

at 1100 is entered creek
bottom at 1580 is crossed
creek running S E

O.K. To be wind Oct 17/35. Vol. 10 p. 193. Madison Co

212 at 2350 is left bot-
tom, at 4352 is Set a
Post from which a
Post Oak 11 in Dia N 13 E
8 is and a Do 12 in Dia
9 62 C. 9 is. Thence N
52 W. at 1700 is Road
Thence Same course 3400
is to the place of begin-
ing-

situated on the headwaters of
Saugucette League C. 213

Beginning at the I.C.
corner of League B.

Thence S 32 E. at 5000 vs
set a Post from which
a Post Oak 14 in Dia S
62 W. ^{13 vs} and a ~~S~~ 16 in Dia
N. 21 W. 4 vs. Thence

S 10 W. at 626 vs inter-
sected the North bound-
ary line of Giv's league
97 vs west of Giv's
E.W. corner. where set
a Post from which a
Post Oak 14 in Dia S 5 W
8 vs. and a Black Jack
18 in Dia N. 59 E. 14 vs.
Thence N. 80 W. with

For these notes see B Δ 12 Same as A. 4 p. 113

21/11

the ^{pp} northern boundary line
 of St. Lague. at 4903
~~to the~~ the N.W. corner
 of Sims Lague at ~~4404~~
 6063 is crossed creek run-
ing S.E. at 7564 vs.
 set a Post from which
 a Post Oak 18 in Dia
 N. 14 W. 4 vs and a Do
 11 in Dia N. 42 E. 8 vs
 Thence N. W. E. at 580
vs entered creek bottom
at 720. is crossed creek
at 1270 left bottom
 at 4600 vs set a Post
 for the north West corner
 from which a P. Oak
 20 in Dia N. 63 W. 4 vs,
 and a Do 12 in Dia

215

I 19 E. 9 vs Thence S.
 80 E. 210 vs entered creek
 bottom at 2400 crossed
 creek running S. E. 2450 vs.
 left bottom, at 5211 vs.
 intersected the West
 boundary line ^{of League} B. where
 set a Post from which
 a Post back 15 in Dia
 N. 58 W. 22 vs. and a
 2^d 12 in Dia N. 31 E.
~~4 vs. Thence S. 8 E. with~~
 The West boundary
 line of B. 5052 vs to the ^{SE}
 corner of sd. League.
 Thence N. 80 W. at 2720 vs
 crossed a creek running
 South East ^{SE}

Notes of League B
 same as book 5 p. 88

246. † §.
at 6748 w set a Post
from which a Post back
18 in Dia S. 4 E. 14 w
and a S. 16 in Dia
at 520¹¹⁵⁰ Thence S 10
W. at 3380 crossed
creek running S. E. at
4326 is intersected
the North boundary
line of C. where set a
Post from which a
Post back 13 in Dia S.
62 W. 2 W. and a S.
18 in Dia at 4300. 14
w Thence S 8 E with the
North boundary line of sd
Learm 4491 to the
Place of Beginning

Simon Jones $\Delta 37$ 217
League E

James 20
6th 5 p. 13
A. B. C.

Beginning at the S.W.
corner of D. Thence N.
80 W. with the N. bound-
ary line of C. at 420
rs past the N.W. corner
of C. at $57 \frac{1}{8}$ rs set
a Post from which
a Post Oak 16 in Dia
N. ~~42~~⁵² E. 17 rs. and a D. ~~12~~
12 in Dia N. 45 W. 7 rs.
Thence N. 10 E. at 3010
rs crossed a creek run-
ning S. E. at 4326. rs set
a Post from which a
Post Oak 16 in Dia N.
81 E 11 rs and a D. 78
in Dia N. 83 E. 8 rs

218 Thence Geo ~~III~~ at
1050 vs. entered Prairie
at 3120 vs. left Prairie
at 5778. vs. ~~to~~ the N.
W. corner of D.

Situated on the waters of Beed eye
Creek East of the $\frac{1}{2}$ League $\frac{1}{2}$ 19

After Crownover
beginning at the $\frac{1}{2}$
W. corner of $\frac{1}{2}$ E. Thence
N. 10 E. at 674 v. set a
Post from which a Post
Oak 16 in Dia 9 20 E. 11 v.
and a Black Tack 11 in
Dia 9 39 W. 9 v. Thence
N. 80 W. at 2170 v. crossed
a branch ⁰⁶ at 4820 v. a
branch running S. E. at
5000 v. set a Post from
which a Post Oak 16 in
Dia 9 18 W 13 v. and a Post
15 in Dia 9 8 E. 18 v.
Thence S 10 W. at 2600
v. entered Prairie -

220

at 4200. vs left Prairie
at 5000. vs set a Post
from which ^a Post back
16 in Dia. N. 66 W. 8 vs
and a ^{Post} 13 in Dia
N 53 E. 13 vs.

Thence S 80 E, 5000
vs to the S. W corner of
E₁. Thence N 10 E with
the west boundary line
of E₁ to the place of
beginning —

Arthur. Crownover
A.V. Till made

T7C issued Oct 16/35. Vol 10 p. 157

Δ 20 Dolores Arriola 221
League

Beginning at the N.
E. corner of T. Thence N.
10° E at 3658 vs set a
Post from which a Post
bear 12 in dia 943 E. 7 vs
and a Post 12 in dia 922
E. 7 vs. Thence 988
at 5478 vs set a Post
from which a Post bear
12 in dia 962 E. 5 vs
and a Post 14 in dia
941 W. 3 vs. Thence 9.10
W. at 1900 vs crossed a
creek running N.E. Thence
S at 4326. The N. Corner
of T.

These field notes do not
agree with the title. 1832

22 John Crownmolden
known as
League, H situated
in a creek known by the name of

Beginning at
the N.E. corner of G.

thence N. 10 E. at 200
dropped a creek running

S.E. at 674 is set a

Post from which a

Post Oak 8 in Dia. I

at 16. 8 is and a Hick

ory 11 in Dia. N. 42 W

8 is. Thence S 80 E.

at 400 is a branch at

390 is a branch run-

ing. I. at 500 is set

~~at 500 is set~~
a Post from which

a Post Oak 24 in Dia

The wood Oct 2/35
be 10 p. 6
No addition to

then N 37 W 6 rs and a D

30 in Dia I 61 W 10 rs

~~int. of the D~~
Thence S 10 W at 5000 rs
on the w. boundary of league D.
shall a Post ~~from~~ which a

Black Jack 11 in Dia N.

20 E. 7 rs. and a 9th 10 in

Dia I 89 W. 4 rs. Thence

N 80 W with the N. bound

dary line of D 5000 rs to

the N.W. corner of 8th

league. Thence N 10 E

4326 rs to the place of be

giving

* of Bear Creek waters of
the ~~Trinity~~ San Jacinto

John Brownover senr

of Little made AT

224 Malign C. Hill
League I

Same as bk 4 p 15
Beginning at the N.
W. corner of J. Thence N.
10 E. at 9480 at 5100
a Spring Branch East
at 9480 set a Post
from which a Post Oak
12 in Dia N 45 E. 3 rs.
and a 9th 11 in Dia N
85 W 11 rs. Thence N
80 W. at 1800 a branch
N.E. at 2720 rs a branch
siving East at 4028 rs
set a Post from which a
Black Jack 18 in Dia S
61 E 11 rs. and a Post Oak
13 in Dia S 7 E 10 rs. Thence
N. 10 E. 189 rs to the ~~Top~~

corner of L No. 5 on ²⁴⁵ ~~League~~
Sun auto the road

Thence W. with the South
boundary of 1st League
at 1413. W. set a Post from
which a Post oak 27 in
Dia N 72 E 6 vs. and a
P. Oak. 14 in Dia N 34
W. 4 vs. Thence S 10 W.
at 4540 vs. set a Post
from which a Post
26 in Dia S 53 E. 13 vs
and a 20 16 in Dia N
62 E. 9 vs. Thence S 80
E. 420 vs to the N. W. cor-
ner of F.

Title made to W. C. Hill
25 July 1836

296 Sangras book 4 p. 116
League J

Beginning at the NW
corner of II thence west
with the South bound-
ary of N^o 5 1742 vs.
to the SW corner of S^d
League. Thence South with
the East boundary of N^o
4. 990 is to the SE corner
of S^d League. thence west
with the South boundary
of S^d League ³⁹⁷⁵ ~~4044~~ is to
the SW corner of N^o 4.
thence South with the East
boundary of N^o 9. 2221 is
to the SE corner of S^d
League

227

Thence $S 10 W 1889$ is
set a Post from which
a Post Oak 13 in Dia
N 60 E. 14 m. and a $S^o 14$
in Dia $S 89 W 4$ m. Thence
 $S 80 E.$ at 5500 m inter-
sected the west bounde-
ry of F --- then set a post
from which which a Post Oak
16 in dia in $N 28 E 32$ Lams
a do 14 in dia in $N 12 W$
36 Lams

Title made to Wm Beasley
25 July 1836

228

± 10
League K

Beginning at the S^W
corner of J. thence S 10 W
at 4545 is a Post Oak from
which a S. 13 in Dia N^o
45 W 3 is and a S. 16 in
Dia S 89 E. 18 is Thence
~~S 80 E. at 6500 is a Post~~
~~Post from which a Pin-~~
~~oak 18 in Dia N 28 E~~
~~7 is and a Hack berry~~
~~10 in Dia N 24 W. 3 is~~
~~Thence N 10 E.~~

S 80 E. at 6500 is a
Post from which a
Hickory 14 in Dia N 49
W. 5 is and an Elm
9 in Dia N 49 E. 6 is

Thence N. 10 E. ²²⁹ 85 1/2
to the S.W. corner of

by
A

230 Δ 27

League I

Beginning at the S.E.
corner of K. Thence

S. 10 W. at 3694 vs set
a Post from which a

Post Oak 10 in Dia N.
62 E. 13 vs. and a Do
12 in Dia S. 14 E. 4 vs.

Thence S 80 E. at 2170 vs
crossed a creek running
East at 550 vs set a

Post from which a Post
15 in Dia S 73 E. 13 vs.

and a Spanish Oak
10 in Dia N 17 E 5 vs.

Thence N 10 E. at 1550
vs crossed a creek run-

ing East. at 4545²³¹
intersected the I bou
nary of E 500 vs West
of I W corner of S^d
League, where set a
Post. from which a Post
runs N in Dia. S 49 W
32 vs. and a S 18 in dia
S 23 E. 23 vs.

232

League M

△34

Beginning at the S
E corner of Ia. Thence

S 10 E at 989 rs set a
Post from which a

Post Oak 13 in Dia N

68 E. 16 rs. and a Do

16 in Dia S 57 W. 100

Thence S 80 E. at 4558^{rs}

set a Post from which

a Post Oak 11 in Dia

S 12 E. 14 rs. and a Do

10 in Dia N 70 E. 4 rs.

Thence N 10 E. 984 rs

to the SW corner of

C

p. 132

Book 5

same as in

Boat survey

1110

[Faint, illegible handwriting, likely bleed-through from the reverse side of the page.]

234

League ^W Δ 23

Beginning at the SW
corner of M thence S 10

W. at 3100 is set a Post
from which a Post Oak
is in Dia S 14 W. 11 is

and a Black Sack
12 in Dia S 85 E 13 is.

Thence S 80 E. at 2580 is
a creek running N.E.

6870 a creek running N.
at 7219 is intersected

the West boundary of
Lins League. When set

a post from which is
Post Oak 14 in dia is
at 5677. 15 bars a do 10 2nd

Ma is 164 W. 10 bars

Same as bk 5. p. 121.

[Faint, illegible handwriting, likely bleed-through from the reverse side of the page]

236

League O

Beginning at the S
W corner of N. News

S. 10 W. at 506 vs set a

Post from which a

Post Oak 14 in Dia N

58 W. 20 vs and a P

13 in Dia S 42 W. 12 vs

Thence N 8^{1/2} E. at 2105 vs

a creek running S E. at

5500 vs set a Post from

which a Post Oak 20 in

dia N. 87 E. 11 vs and a P

8 in Dia S 77 W. 3 vs.

Thence N. 10 E. at 6600 vs

entered Prairie at

2600 vs left prairie

Same as Book 4 p 114

237

at 4545 us set a Post
~~from which~~ the S.W.
corner of T

till made to
Matthew Borer

238 League P

Beginning at the P.C.
corner of O. Thence
S 10 W. at 780 is crossed
a creek running S. E.
at 2100 is a creek running
S. E. 34 60 is set a Post
from which a Post
ack 10 in dia N 42 E 7 W
and a Post 14 in dia N 55
W 8 is. Thence 4800 at
1150 is a creek running
N. E. at ⁵⁹⁶⁹ ~~6040~~ is intersect
ed the west boundary
of Bowman's League

where set a Post ²³⁹
which a Post takes 20 in
Dia 962 W 5 rs; and a ²⁰
14 in Dia 836 W 6 rs

William Townsend

Same as bk 5. p. 127

240
LAD Δ 29

League Q

beginning at the S.
 W. corner of of P. Thence
 S. 10 W. at 1085 vs set
 a Post from which
 a Post oak 13 in Dia
 N 20 W. ^{2nd} and a P^o 11 in
 Dia 961 W. 4th. Thence
 S. 80 W. at 5500 vs set
 a Post from which a
 Black Jack 14 in Dia
 N 42 E. 21st and a P^o
 11 in Dia N 67 W. 6th
 Thence N 10 E. at 4545
 vs to the S. W. corner of
 O

244

[Faint, illegible handwriting in cursive script, possibly bleed-through from the reverse side of the page.]

242 James W. Moore 35
League R. 

Same as bk 5. p. 133.

Beginning at the a
Post on the S. bounde-
ry of P 520 vs East
of the S.W. corner: from
which a Black Tack
14 in Dia N 47 E. 8 vs
and a 909 in Dia
S 62 E. 7 vs. Thence S 10
W. at 3600 vs a creek
running E at 4970 vs
intersected the North bound-
-ary line of League No 7
740 bars West of the NE
Cor
"

243

[Faint, illegible handwriting covering the majority of the page]

L 44 Δ 21

League I

Beginning at the SW
corner of ^{square} A. thence S 10 W
at 577 set a Post from
which a Black Jack 12
in line N 80 4 W and
a Post 11 in line N.
43 E. 23 W. Thence S 80

E. at 2760 is set a Post
The west boundary line of L 44 7
from which a Post 10

in line N 1 W 8 W and
20 12 in line S 68 E. 8 23
Thence N 70 E with the west
boundary of N 5

from which a Post
10 in line S 45 W 8 W
and a Post 13 in line N 63
E. 10 W

In title, Thence

No. 22 Mc Dougal
There is an Oct 1735 vol. 10 p. 189.
Primer

245

N. 20 W. 1270 v^a

Thence, S. 70 E. 4180 v^a

Thence N. 10 E. 4470 v^a

Thence N. 80 W. 520 v^a

Thence S. 10. W. 1085 v^a

Thence N. 80 W. 50⁵⁰⁰+5 v^a to beginning

Daniel M. Johnson
46
James Co
Cabin
5135
Vol 10, p. 113
The record Dec 16/35

Δ 25

Liaquist
Michigan

Beginning at the N.W. cor-
ner of sp 6 thence N
80 W. at 1356 v. set a Post
from which a Post Oak
18 in dia N 18 E 20 v. and
12 in dia N 12 W
15 v. Thence N 10 E. at
~~5000 v~~ set a Post from
which a Post Oak 15 in
dia N 44 E. 20 v. and a
Post 12 in dia N 36 E 10 v.
~~Thence S 80 E~~ a Post
Oak 13 in dia N 55 E 9 v.
and a Post 11 in dia N.
38 W. 14 v. Thence S. 80 E
at 3806 v. intersected
the west boundary of

~~Thence S 10 W 247~~
League S. Where at a Post
from which a Post 14
in Dia S 72 W. 10 vs and
a Post 15 in Dia N 40 W 6 vs
Thence S 10 W. with said
boundary.

In the litch, - to its S.W. Corner
Thence S. 80 E. with the S. line of the same
to the western boundary of Ea: N = 7.
Thence, S. 20 W. with said boundary
2090 vs to the N.E. Corner N = 6.
Thence, N 80 W. 5000 vs. to the place
of beginning

248

#4. League U 249

Beginning at the S.W.
corner of T. Thence N
80 W at 1684 vs set a
Post from which a Post
Cable 22 in Dia N 41 E
19 vs. and a ~~S~~ 12 in Dia
S 47 E. 16 vs. Thence N. W
E. at 2800 a creek running
South at 4545 vs set a Post
from which a Post Cable
11 in Dia S 4 E. 15 vs and
a ~~S~~ 8 in Dia S 42 E 14 vs
Thence S 80 E. at 1150 vs
a creek running S. W. at
5500 vs intersected the
west boundary of

250

where set a Post from
which a Post Oak 20 in
Dia 518 6 vs and a
50 13 in Dia 50 W 13
vs.

John Payne

League V. 257.

Same as bk 4. p. 84.

Beginning at the NW
corner of U. Thence N
10 E. at 4545 vs. set a Post
from which a Post Oak
12 in Dia. 17 1/2 vs. 6 vs. and
an Ash 12 in Dia 149 E
12 vs. Thence S 80 E at
5500 vs. intersected the
west boundary of O

where set a Post from
which a Plum 10 in Dia
172 E. 3 vs. and a Red
Oak 14 in Dia 149 W
15 vs.

252

253

119

2574

255

120

250

257

258

△ 39

259

League No 6

Beginning at a Post on
the west boundary of No 4
321 is North of a Post oak 8
in dia blazed on ^{1^d} line
Thence N 40 W. at 5000 is
set a Post from which a Blaz
Jack 8 in dia S 28 E 4 is
and a Post oak 24 in dia
N 84 W 11 is. Thence S 20 W.
5000 is to the N.W. corner
of No 4.

† 13

No 7 Beginning
at the N.W. of No 3
Thence N 20 E. at 6250 is
set a Post from which a
Post oak 12 in dia S 68 E
and a Jack 15 in dia S 4 E.

250
Thence S 40 E. at 3920
is set a Post from which
a Post Oak 24 in Dia at
81 E 61 N. Thence S 20 W
1250 is to the N^W cor-
ner of Sec 2.

201

123

202 | 220
2860
3390

38 535

A ³ C. C. Givens
Method of writing
of
the Facinto
and Bedding etc

255
1564
4963
2661

C. C. Givens



C. C. Givens

116
4604
2285

4825
726
2068

Good **CR** 203
Account Book

held Book of Private
ways - it also contains
of this Jones tract back
of Henry Jones

CR
10. Christmas
Julia's Book (No)
1897 124

204 from Wrights NB con to
 Dyer & Co on Staffords
 sum is 35.96 bars

15.00
 10.38
 1.38

\$ 26.38

1866.5.469

8.76

1666 / 232.0 / 10387 7.62

6540
 490
 154 1724
 2448
 3625

8.797
 5000
 3797
 3333
 1646

field notes of 400 acres of Land
for Philo Fairchild of St. A.
Christians League

beginning at the upper corner of
St. Christians League at a post
from which a Spanish Oak
14 1/2 dia. W. N 77 E 3 bars a do
20 1/2 dia. W. S 84 W 9 bars
thence down the River with
the meanders. Thence of
East. 400 bars North 306 bars River
East 300 bars North 30 bars River
whence bet a post for the lower corner
from which a Cotton Wood 30 1/2
dia. W. N 37 W 2 bars a do 40 1/2
dia. W. S 47 E 30 bars thence South at
33 25 bars bet a post for the SE corner
from which a Ash 13 1/2 dia. W. S 7 E
8 bars a Pecan 2 1/2 dia. W. N 10 W
2 bars thence W. N 1/2 at 700 bars

268

intended the West boundary line
 of A. Chismans Survey which at
 a post for the S^W cor from which
 a Stakeberry 3rd dia W. is 80E
 5 bars and do 9th dia W. is 148E
 6 bars then a North S line of
 A. Chismans 2989 bars to
 the place of beginning

Dec. 9th 1826

130
360
70
40
<hr/>
1200
2105
400
<hr/>
3405

Field Notes of a Section of Land
surveyed for John Little beginning
at the upper cor. of Jas P. Cooks Survey
on the River then down the River
with the meanders there of East
at 730 bars off set South 360 bars
to the River East 70 bars South 40
bars River where set a post for
the Lower Cor from which a
Box Elder 8th in dia. W. S. 48th W. 2nd bar
thence East at 2108 bars set a
post for the SE Cor. from which an
Elm 13th in dia. W. S. 69th W. 4th bars thence
North at 400 bars intersected the
North boundary line of Jas P. Cooks
Survey where set a post for the NE Cor.
from which an Elm 14th in dia. W. S.
at 15th E 4 bars thence west with old
line 2905 bars to the place of beginning
Dec. 19. 1826

290
(3)
State notes of the Division of Geology
No 11 between Williams and Philips
beginning at the upper corner of
Stephen's & Justice's Reserve on the
East bank of the San Bernardino
up the River with the meandering
there of East at 100 bars off of the
200 bars to the Bernardino thence
East 140 bars thence North
to 210 bars off West 20 bars to
the River at 300 bars off West
110 bars River North 400 bars West
170 bars River North 370 bars West
70 bars River North 224 bars West
80 bars River when crossed
on a Cottonwood 36 In dia noted
with three notches, which
Cotton wood is 200 bars below
the mouth of a Creek where
Pentacost now lives thence
N 55 East at 500 bars intended

Prairie at 2970 bars (Wentley's line)
 Island at 4383 bars (with P. line)
 Maffey's South boundary line
 Thence East 440 bars To T. H. B.
 -ells N. W. cor Thence South
 with his line 4224 bars to
 his South West cor which is
 on Maffey & Austin's North bound-
 ary line Thence with P. line of
 J. Austin 3862 bars to the

Place of Beginning



June 25. 1826

open line 6940 bars NE
 South 3330 bars East 1546 bars
 South 4222 bars West 3862 bars
 to the Creek

27th Field lots of 300⁽⁸⁵⁾ Acres of
Land Surveyed for Charles
Benton, of off Stephen T. Benton
Benton Beginning at the upper
Corner of J. C. Cummins Survey
which is also the lower Corner of
the Reserve Land that extends
from the Brazos to the Sand
Hazard and commencing on
the East side of S. River at
the above mentioned Co. then
up the River with the meanders
there of North at 600 Yards off
490370 Land River at 1153 Yards
off West 170 Yards to the
River where ~~commenced~~
set a post from which is
Spanish Oak 24th Indian
P 22nd 10th bars then East

at 2313 bars set a post for the
NE cor from which a line
Oak 24th dia 6th of 68th
bars Thence South at 1182 bars
intersected the South Boundary
line of J^o Cummins Survey
Whar set a post for the S.E.
cor from which a Pecan
14th dia 6th of 102³ bars
Thence West with 1st
bar marked line 24th
bars to the Place of Beginning

Dec. 27th 1826

254
4000 Acres of 4000 Acres of Land
Surveyed for Jas Kingfellow
of Pellicans & Cummins League
Beginning at the Lower Co
of J. Cummins League on the
East Side of the San Bernardino
thence up the River with the
meanders therein East 140
thence North at 690 bars
crossed a point of the River
at 1290 bars off West 340
bars to the River Whar
Cornered on a Live Oaks
& the draw Blazed and a cross
cut on it thence East
1963 bars cornered on a Mull
roy 42 dia thence South

at 1790 ¹⁷⁷⁵ was intersected the
South Boundary line of the
Cummings Survey when set
a post from which a Stake
berry 12 in dia to 133 1/2
was thence West with
Cummings Survey 1763 to
to the Place of Beginning

Dec 29th 1826

(8)
The 30th lot of 2 Acres of Land in
County for James Hope out of Stone
& Austins Survey on Dick cut
adjoining Alexander Jacksons Survey
above Beginning at the NE Cor
of P. Austins Survey at a post and
mound in the Deercor thence N 70 W
at 1000 bars set a post and raised a
mound for the for the N. W. Cor thence
S 20 W at 570 bars left mark at
1000 bars Decks break runs N E at
2000 bars set a post for the S. W. Cor
from which a Mulberry 12ⁱⁿ dia
at S 42 W 6 bars blazed and notched
and an Elm 10ⁱⁿ dia at S 70 E 3 bars
blazed and notched thence S 70 E at
1000 bars intersected the lower line
of P. Austins Survey when set a
post from which an ash 6ⁱⁿ dia

at 15 E 1 bar a do 10 in dia to 17 7/8
to base thence N 24 E with a distance
2000 to the place of beginning

217

March 19th 1827

[Faint, mostly illegible handwritten text, possibly a survey description or journal entry.]

Field notes of a 1/2 League of
 Land Surveyed for John Jones
 Beginning at the S.E. Cor of
 League N^o 13 West of the Brazos
 River which League was given
 to Abner Ray Kendall
 thence N 65 W with P. Raykend
 all line 400 bars then set a post
 and raised a mound in the prairie
 for the N W Cor. Thence S 55 W
 at 2800 bars deep cut, at 3400
 bars set a post and raised a
 mound for the S W Cor. Thence
 S 65 E at 2110 bars set a post
 and raised a mound for
 the S E Cor. Thence N 55 E at
~~2000~~
~~2000~~ bars intersected the back
 line of Henry Jones Survey

John Jones
 James as of 7. p. 18
 1850

When set a post for the N E cor.
from which an Elm & Indian
is S 33 W 9 bars and a Hackberry
3/4 in dia is N 63 E 5 bars
thence N 65 W with the back
line of Jones is to a c 1710 bars
to his S W. Cor. thence S 25 W
12 bars to the place of beginning

Recorded A 27

Oct 22nd 1827

280

10

[Faint, illegible handwriting, likely bleed-through from the reverse side of the page.]

I have been thinking of you
 very much lately and
 wondering how you are
 getting on. I hope you
 are well and happy. I
 have not heard from you
 for some time. I am
 well at present. I hope
 you are the same. I
 have been thinking of
 you very much lately. I
 hope you are well and
 happy. I have not heard
 from you for some time.
 I am well at present. I
 hope you are the same. I
 have been thinking of you
 very much lately. I hope
 you are well and happy.

82
11
Field Notes of 600 Acres of Land
Surveyed for Moses Shipman out
of Heaters Christmans Survey -
Beginning at a point on the
West side of the Brazos River
at a Chaney tree 10¹/₂ in dia. ^M/_S
from which an Elm 7¹/₂ dia in
S 85 E 11 bars Thence South at 1366
bars bet a post for the S¹/₄ Cor from
which a Spanish Oak 10 in dia
to S 73¹/₄ W 3 bars a do 12 in dia
to S 8¹/₄ W 3 bars Thence East at
1837 bars bet a post for the S E Cor
from which an Elm 12 in dia to
S 9¹/₄ W 3 bars and a Mulberry
14 in dia to N 53 E 8 bars
Thence North at 1480 bars

283
I started on the Oregon River when
I arrived on a Spanish Oak & I
did for the lower corner on the
River from which an Ash 14 In
dia has 68 E & bars. I then
up the River with the mander
there of to the place of beginning

Oct. 31. 1827

1366
1837
1480

284

285

135

280

287

Handwritten notes in a vertical column on the left side of the page, including numbers and symbols such as 1, 2, 3, 4, 5, 6, 7, 8, 9, 10, 11, 12, 13, 14, 15, 16, 17, 18, 19, 20, 21, 22, 23, 24, 25, 26, 27, 28, 29, 30, 31, 32, 33, 34, 35, 36, 37, 38, 39, 40, 41, 42, 43, 44, 45, 46, 47, 48, 49, 50, 51, 52, 53, 54, 55, 56, 57, 58, 59, 60, 61, 62, 63, 64, 65, 66, 67, 68, 69, 70, 71, 72, 73, 74, 75, 76, 77, 78, 79, 80, 81, 82, 83, 84, 85, 86, 87, 88, 89, 90, 91, 92, 93, 94, 95, 96, 97, 98, 99, 100.



136

288



a fine coat 14 sh
a de 8 sh
a de 12 sh
a de 12 sh
a de 12 sh

W. H. H. & Co.

W. H. H. & Co. Merchants, Boston, New York

Oct. 28. 1897

My dear Sir, in answer to your letter of the 24th inst. regarding the purchase of the 100 shares of the New York & New Jersey Gas & Electric Light Co. I have the pleasure to inform you that the same have been purchased for you at the price of \$100.00 per share, or \$10,000.00 in all.

The accompanying find will be \$464.64

at \$5.00 per share. . . . \$ 26.38

Yours truly,
W. H. H. & Co.

17.82

29.0

2110
400
1710

880
546
3760
94
40

555

44

86480

86510
837
2810
030
930

10340
8668
1880
920
911

84800
900
100.94

935

880
1760

9100 - 93 1/2 - 900
006

14
Horatio Trisona

2970
855-

14850
14850

2958
400

23760
2539350

2970
12

29587
855-

14790
14790
23664

2529090
1183200

3712290
2539350
6251670

6255000
3712290

2537710
23760

16171
14850
13260

1710

855-

458

(No. 2)

Field Notes
of Bank

B. Sims

June 1826

294

Leage N^o 10²⁹⁵

Surveyed for Samuel Miller
and Leage of Land Laying
on the West Side of the
Brassos Beginning on the
Antient Road

from which a Column India
Bars E 28 E 10 Bars a Ash
12 India Bars N 70 W 7 Bars
thence Down the River

✓ E 45 E 1050 Bars

✓ N 45 E 200 Bars

✓ E 45 E 100 Bars

✓ N 45 E 480 Bars

✓ E 45 E 300 Bars

✓ N 45 E 150 Bars

✓ E 45 E 340 Bars

295

✓ N 215 E 180 Bars

✓ S 45 E 710 Bars

✓ N 45 E 200 Bars

✓ S 45 E 120 Bars

✓ N 45 E 270 Bars

✓ S 45 E 230 Bars

✓ N 45 E 100 Bars

✓ S 45 E 80 Bars

✓ N 45 E 100 Bars

✓ S 45 E 170 Bars

✓ N 45 E 310 Bars

✓ S 45 E 140 Bars

✓ N 45 E 250 Bars

✓ S 45 E 240 Bars

✓ N 45 E 120 Bars

✓ S 45 E 60 Bars

What set apart carver
 of Sand Lumber from which
 a Latin wood is known
 Bears N 30 W 3 03 on
 a willow & India Bears
 S 30 E 3 03 on

298

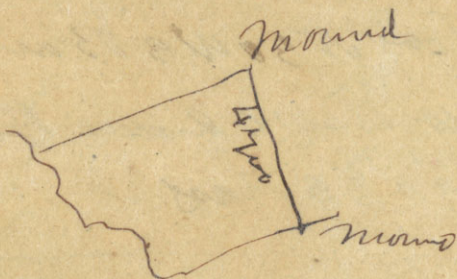

299
Leag N^o 1 East ~~13~~

Survey for William
Matthews one Leag of
Land Laying on the E
Side of the Bras Sar

Beginning at a Stake on
the Sth Antone Road
from which a Hickory

12 inch a Bars **700.5** Bars
a Do Cincha Bars

N 14 W 4 Bars

thence down the River

N 45 E 1050 Bars

N 45 E 200 Bars

290 300

S 45 E 160 Bars

N 45 E 430 Bars

S 45 E 900 Bars

N 45 E 150 Bars

S 45 E 340 Bars

N 45 E 180 Bars

S 45 E 710 Bars

N 45 E 200 Bars

S 45 E 120 Bars

N 45 E 270 Bars

~~S 45 E 230 Bars~~

N 45 E 100 Bars

S 45 E 80 Bars

N 45 E 100 Bars

S 45 E 170 Bars

N 45 E 340 Bars

N 45 E 140 Bars 291

N 45 E 250 Bars

S 115 E 290 Bars

N 45 E 120 Bars

S 45 E 960 Bars

Whose Stakepoint

Corner of Land Survey
from which a
Cedar wood 12 1/2

Bow N 30 W 3 Bars

a Willow 1/2 1/2 Bars

S 30 E 3 Bars

302
~~7~~

James Curtis 1^{on} 303



207

Lag of West

see book 1

See page for James
 Curtis and Lag of
 Luna Laying on the
 west side of the Brass
 Beginning on the S E
 Char. of Samuel
 Miller's Survey thence
 Down the Run

S 720 Brass R.

N 160 Brass

E 220 Brass R.

N 370 Brass

S 700⁷⁰⁰ Brass

S 450 Brass R.

E 320 Brass

204

Nov 27

\$ 300 Beans Pi

£ 240 Beans

\$ 100 Beans Pi

£ 660 Beans

\$ 80 Beans Pi

£ 440 Beans

\$ 100 Beans Pi

£ 530 Beans

\$ 340 Beans Pi

£ 210 Beans

\$ 340 Beans Pi

£ 250 Beans

\$ 120 Beans Pi

East 100 Beans

Joseph St ap east corner
of Paid Survey
a catter wape 12 in d
Bars 215 & 21 Bars
a Do 14 Lincata Bars
N 45 W 4 Bars

Lag No 3 W
Survey for Samuel
Duffel Jan an Leg of
Land Laying out the
West Side of the Bars
as Beginning on the
S E Corner of
James Curless Spring
thence down the River
N 45 W Bars River

~~295~~
306

2137

✓ E 1150 Bars

✓ S 160 Bars Riv

✓ E 120 Bars

✓ S 150 Bars Riv

✓ E 210 Bars

✓ S 520 Bars the
the head of the falls

✓ E 470 Bars

✓ S 460 Bars Riv

✓ E 150 Bars

✓ S 140 Bars Riv

✓ E 130 Bars

✓ S 510 Bars Riv

✓ E 20 Bars Riv

✓ S 40 Bars

✓ E 250 Bars

✓ S 290 Bars Riv

~~W.P.~~ ~~8290~~ Bars ~~299~~
301

~~8510 Bars Riv~~

~~890 Bars Riv~~

~~840 Bars~~

~~8250 Bars~~

~~8290 Bars Riv~~

~~8290 Bars~~

~~8580 Bars Riv~~

~~850 Bars~~

~~870 Bars Riv~~

~~8350 Bars~~

~~880 Bars Riv~~

~~8900 Bars~~

~~8110 Bars Riv~~

~~8150 Bars~~

~~8120 Bars~~

298 308

2098

~~130 Bars~~

~~130 Bars River~~

~~150 Bars~~

~~250 Bars River~~

~~200 Bars~~

~~280 Bars River~~

~~300 Bars~~

Wharve at present corner
 of Pine Survey from
 which a Cotton Wood
 30 Lucia Bars S 20 W
 10 Bars a Do 24 India
 Bars N 20 W 3 Bars

1877 Leg N^o 4 West
 Survey for George Clem
 and Leg of Land Lay
 ing on the West Side of
 the Brazos Beginning
 on the S. E. Corner
 of Saml & David Sam
 Survey thence down
 the River

E 370 Bars ~~River~~
 S 100 Bars River
 E 900 Bars River
 N 100 Bars
 E 850 Bars River
 S 2800 Bars

3150
1189

6330 Bars

81580 Bars River

11190 Bars River

8030 Bars

11190 Bars

11190 Bars
from which was 12000

Bars 5300 Bars

a 11190 Bars

Bars 11190 Bars

James Curtis, Leag No 2 East (15)

See book 1/3.99

Surveyed for James Curtis
and Leag of Land
Laying on the E Side of
the Brasas River
on the S W Corner
of William Matthews
Survey three Down
the River

E 720 Bars

N 100 Bars

E 220 Bars

N 370 Bars

E 470 Bars

N 230 Bars

E 140 Bars

N 230 Bars

E 140 Bars

W 230 Bars

E 230 Bars

the mouth of the Little

Bear Pass Bars N 4 S

thence E 470 Bars

S 450 Bars

a shaft 150 Bars

in length

E 320 Bars

W 300 Bars

E 240 Bars

S 100 Bars

E 660 Bars

S 80 Bars

E 440 Bars

\$ 100 Bars

E 530 Bars

\$ 340 Bars

E 210 Bars

\$ 340 Bars

E 250 Bars

\$ 120 Bars

E 100 Bars

What is a post corner
of said survey from which
a post of 12 lb den Bars

\$ 6800 Bars

a 20 lb den Bars

\$ 8300 Bars

304

00092	400		
00025	7109.58	400	
00260	200	400	
00544	500	200	380
200422	400	500	800
06	380	700	200
028	800	2200	800
2338	200		300
	<u>3580</u>		400
	800	0825	200
000	4380	0941	3280
028	500		2200
	<u>4880</u>		<u>5480</u>

1661

008951	100
0222	500
	600
	400
	600
	150
	600
	400
	400
	<u>3950</u>
	8951
	<u>2240</u>
	320
	320
	<u>1420</u>
	3
	6469

555
<u>277</u>
836
<u>1861</u>

2.8

6672

9

315

150

80

(No 3)

Field Notes

of

the Lakes,

on

the Colorado

Labors on the North
 Side of the Colorado
 do

of the SE corner
 of 189 Beginning at
 the SW corner of 1st
 Tomlinson's League
 of Land on the S. E.
 Bank of the Colorado
 thence N. with 8"
 line 1300 Paces to the
 NE corner on a stake
 from which the Piston

bars S 30° W 25
 12 India a Jack
 oak bars E 49° W 20
 4 India then West
 740 bars to the S W corner
 on a stake from which
 a post oak bars
 S 87° E 17 bars marked S
 12 India a post oak
 bars S 54° W 16 bars marked
 S 2 12 India then S
 1300 bars to the S W corner
 on a stake from which
 a post oak bars S 49° E
 10 bars 4 India

on Willow bars S 55 W
 7 bars 1/4 In Dia marked
 N^o 2 thence down to
 river to the beginning

N^o 2 Beginning at
 the S W corner of
 N^o 1 thence West 77 1/2
 bars to the S W corner
 on a Stake from where
 a Post Oak bar S 19 W
 10 bars marked N^o 2 12 In
 Dia a Post Oak bar
 S 83 W 3 bars marked
 N^o 3 12 In Dia thence

South 1250 bars
 to the S^W corner
 on Hackberry marked
 N^o 2 from which a
 Elder barer N^o 70 W 9 bars
 marked N^o 3 9 India
 an Elm barer S 80 E
 9 bars 13 India. thence
 Down the river with the
 meander thereof to the S^W
 corner of N^o 1.

N^o 3 Beginning at the
 S^W corner of N^o 2 thence
 West 435 bars to the S^W
 corner on a stake

from which a Post
 oak bares S 35 E 7 bars
 15 In Dia a post oak
 bares S 79 W 9 bars 15
In Dia thence South
 1100 bars to the S W cor-
 ner on a Stake from
 which a cottonwood bares
 S 60 E 5 bars Marked S 63
 E 4 In Dia an Elm S 70 W
 9 bars marked S 64 thence
 Down the river with
 the meanders thereof to the
 S W corner of S 62

N^o 4 Beginning
 on the west boundary
 line of N^o 3 41¹/₂ bars
 from the S^W corner
 on a Sack oak Marked
 N^o 4 thence West 440 bars
 to the S^W corner on a
 Stake from which a
 Post oak bares 860
 19 bars Marked N^o 4 12 In
 dia a Post oak bares
 860 W 10 bars 12 In dia
 thence South 1200 bars
 to the S^W corner on a

Stake from which a
 prickly ash bar
 East 9 bars marked N^o
 4 9 In Dia. a Hackberry
 bar. N 5 4 W 4 bars
 marked N^o 5 8 In Dia
 thence down the river
 to the S W corner of N 3

N 5 - Beginning 357
 bars from the N West
 corner of N 4 on the
 west boundary line of N
 one stake from which
 a Pecan bar S 4 0 W

10 bars marked N^o 4 9th
 thence west 740 bars
 to the N^W corner in
 Prairie Sec Post from
 which a Live oak bar
 South 95 bars marked
 N^o 5 thence South 1300
 bars to the S^W corner
 on a stake from which
 a Hackberry bar is 400
 8 bars marked N^o 5 9th
 a Hackberry bar is 350
 7 bars marked N^o 6 7th
 thence down the river
 the meanders thereof to the
 S^W corner of N^o 2

N^o 6 Beginning at
 the SW corner of N^o 5
 thence N 300 bars thence
 West 300 bars to the
 SW corner on a stake
 from which an Ash
 bar East 4 bars marked
 N^o 14 In Dia. an Ash
 bar N 45^o W 7 bars ma
 rked N^o 15 In Dia thence
 North 1100 bars to the
 NW corner on a stake
 from which a Jack oak

bars SE 3 bars Marked
 N^o 6. 6 in Dia. thence East
 800 bars to the SE corner
 on State from which a
 live oak bears N 75 E 37
 marked N^o 15. In Dia a
 live oak bears S 67 E 37
 thence South 1400 bars to the
 place of beginning

N^o 7 beginning at the
 SW corner of N^o 6 thence
 North 300 bars thence West
 200 bars North 45 West
 300 N 400 West 200 bars
 to the Corner on a State

from which are overcup
 oak bears N 3 E 3 bars marked
 N^o 7 9 In. In an Elm bears S 60
 W 3 bars 4 In. In ^{the} Stone
 N 5 80 bars to the N W Cor
 ner on Stake from which a
 willow oak bears ~~S 4 E~~ 3 bars
 18 In. In ^{the} marked N^o 7 a willow
 oak bears North 3 bars 18 In
 In ^{the} thence East 700 bars to
 the N E Corner on Stake
 In ^{the} Place thence South
 1927 bars to the Commencement
 at

N^o 8 Beginning at the SW
 Corner of No 7 thence ^{West} ~~North~~
 800 bars to the SW Corner
 on a Stake from which
 a Boxelder bears N E 3 bars

marked n. 8 15 In Run on
 Ash N 30 W 1 bass marked
 n. 9 8 In Run thence South
 North 850 bass to the NW
 Corner on a State from
 which a post oak bases
 64 & 9 bass 12 In Run
 thence East 800 bass to the
 NE Corner on State In Run
 then South 1929 bass
 to the beginning

James Turner
 Took in land July 19/32. Vol 2 p 52
 Colorado

Beginning at the SW
 corner of n. 8 thence North
 850 bass thence West 1200
 thence North 373 bass thence
 West 230 to the NW Corner
 on State from which a
 post oak bases 80 & 4 bass

330

marked N^o 98 In D^{ist}
 a backery bars N^o 1012
 bars marked N^o 1018 In D^{ist}
 thence 81430 bars to the
 N^e corner on a stake
 In Prairie thence South
 1223 bars to the beginning
 Including one Labor

N^o 10 Beginning at the N^w
 corner of N^o 9 thence South
 450 bars thence West 450 bars to
 the N^w corner on a stake
 from which a cotton wood bar
 South 1 bar marked N^o 10
 cotton wood bars N^w
 bar marked N^o 112 feet dis

Free man
 Cole asst. Aug 24
 1838
 Colorado Co
 Ariz

thence East 1510 bars to the
 N^W corner on a stake in
 prairie from which a Post
 oak bears West 163 bars thence
 N¹⁰ 15 In Dia a cluster of
 live oaks bears S 51 E 43 bars
 thence South 690 bars to the
 N^E corner of N⁹ thence
 West 1430 bars to the place
 beginning including one labor

N¹¹ Beginning at the
 N^W corner of N¹⁰ thence
 East 500 bars thence North
 500 bars thence East 200 thence
 North 200 bars to the N^W
 corner on a stake from
 which an oak bears East

3225 bars Marked S 71 18 In
an Ash Bares S 4 W 4 bars
14 In Dia thence East 102
bars to the S E corner on
a stake from which a Hick-
ory bares S 11 W 18 bars & 1/2 In
a Hickory bares S 36 W 29
6 In Dia thence South 700
bars to the S E corner raised
ground thence West 277 bars
to the S E corner of S 10

S 12 Beginning at the S W
corner of S 11 thence East
497 bars thence North 700
bars to the S W corner on a
stake from which an Oak
Cup Oak bares S 3 E

6 bars Marked N 12 E feet
 6 In Dia a Hackberry bar
 S 13 W 6 bars 12 In Dia them
 East 940 bars to the N East
 Corner on a Stake from
 which a Post Oak bar
 N 49 W 4 bars Marked N 9 E
 10 In Dia a Post oak bar
 S 9 W 10 bars 15 In Dia them
 South 110 bars to the S E
 Corner on a Stake from
 which a Post oak bar
 N 83 W 30 bars marked N 12 E
 10 In Dia a Post oak bar
 S 32 W 43 bars 9 In Dia
 them West 1477 Bars
 to the Place of begining

3

334

N^o 1 On the South Side
of the Colorado Beginning
at Elizabeth Hutchinson's

SW Corner on the South
Bank of the Colorado then
S 60° 31' E 1200 bars to the SE
Corner on 3rd Line once Post
Oak Marked N^o 12 In 2nd
Post Oak bars SW
12 bars 12 In 2nd a Post
Oak bars SW 12 bars
In 2nd Line West 900
bars to the SW corner on
a stake from which a Post
Oak bars East 4 feet
In 2nd a Post Oak bars
SW 1/4° W 2 bars Marked N^o 2

Bureau
from
re
To be issued Aug 16/24
Vol Colorado
A 1852

thence North 1300 bars ³²⁵
to the S.W. corner on a Flac
berry Marked S 1/2 from ~~the~~
a Mulberry bares N 65° E 8
bars 9 Pr Dia an Elm bares
367° W 11 bars 9 Pr Dia thence
Down the river with the mea-
sures thereof to the Place of
beginning containing one
Acre

Elizabeth Tomlinson

2 Beginning at the S.W.
corner of S 1/2 thence West
129 bars to the S.W. corner on
a Stake from which a Post
oak bares N 10° E Marked -
S 1/2 a Post oak bares N 15° S W
15 bars Marked S 1/2 thence
The line course South 1300 to ¹⁶⁰⁰

made by Sir & his wife Aug 1674
Vol 2 p 462
Colorado Co

20th then North 1445 bars to
the SW corner on a Post stake
Marked N^o 6 In Dia from
which a Hackberry bares N^o 2
3 bars Marked N^o 9 a Hackberry
bares 315 W 4 bars Marked
N^o 3 7 In Dia

N^o 3 Beginning at the SW
Corner of N^o 2 then West
900 bars to the SW corner on
a Stake from which a Post
oak bares N^o 4 C 19 bars
Marked N^o 3, 12 In Dia a
Post oak bares S. W. Marked
N^o 4 then North 1550 bars
to the SW corner on a ~~Post~~
~~stake~~ Marked N^o 5 10
from which a Hackberry bares

~~S 4 1/2 W 6 bars 10 In Dia
 thence down the river with
 the Meanders thereof to the
 N E corner of S 4 1/2 Including
 in these lines one labor~~

~~S 7 1/2 W~~

Slake from which a cotton
 wood barres S 90 W 10 bars Mark
 N 4 1/2 4 feet Dia a cotton wood
 barres S 64 E 13 bars Mark
 N 3 1/2 4 feet 6 In Dia thence
 I own the River with the
 Meanders thereof to the
 N W corner of S 4 1/2 Including
 one labor

~~S 4 1/2 W~~ Beginning at the SW
 corner of S 4 1/2 thence West

655 bars to the SW corner on
 a stake from which a Post
 Oak bar is N 88° 50 bars —
 marked N 44 15 In dia. a
 Post Oak bar is N 35° W 12
 bars marked N 5 13 In dia.
 thence North 1700 bars to
 the NW corner on a cotton
 wood marked N 44 8 N 5
 from which a Hackberry bar
 S 5° W 6 bars thence down the
 River to the SE corner of
 N 5 including in these
 Lines one Labor

N 5 Beginning at the
 SE corner of N 4 thence
 West 632 bars to the SW
 corner on a stake from which

329 a 93³ pure
a Jack Oak bares N 54 E
marked N 5 10 In Dia thud
North 1400 bars to the S W
corner on a stake from which
an Elm bares N 49 E 4 fars
marked N 5 6 In Dia a Post
Elder bares N W 6 fars mark
ed N 6 6 In Dia thence from
the River with the Meanders
thru to the S W corner of
N 4 Including in these lines
one Labor

of Beginning at the
S W corner of N 5 thence
west 100 bars to the to the
corner on a Post oak mark
ed N 6 from which a Post
oak bares N 46 E 4 fars

6 In Dia a post oak
bars N 72 W, & bars them
North 1900 bars to the SW

Corner on a Cottonwood
Marked N E S N 7 3/4 S 1/2 at

6 In Dia from which a
Hackberry bars S 50 E 4 bars

6 In Dia a Box Elder
bars N 20 W 2 bars of India

them down the River
with the Meanders thereof
to the SW corner of N 5

Including in these lines
one Labor

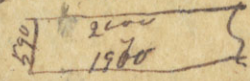

N 7 Beginning at the SW
corner of N 8 there West
1590 bars to the SW corner on a

Jack oak 2 In Dia from which
a post oak bars N 60 E 11

bars marked N 7 1/2 India
 a Post Oak bars N 10 1/2
 then North 2000 bars
 to the SW corner on a
 Post Oak marked N 9 1/2
 from which a Hackberry
 bars N 40 E 7 bars 3 India
 an Elm bars S 75 W 4 bars
 9 India then Down the
 River to the SW corner
 of N 6 Including in this
 Less one Labor

N 7 Beginning at the SW
 corner of N 7 then West
 655 bars to the SW corner
 on Post Oak marked N 7
 12 India from a labor

Post oak bars N 14 W
 10 bars Marked N 3 4 20
 Dia thence North 2000
 bars to the N W Corner
 a Hackberry Marked N 8
 6 In Dia from which a
 Box Elder bars N 50 E
 5 bars to In Dia. an Elm
 bars N 65 E 10 bars Marked
 N 9, 6 In Dia. thence down
 the River with the
 Meanders there of to
 the N W Corner of N 9
 including in these lines
 one Labor.

N 9 Beginning at the S W
 Corner of N 9 thence West

343

525 bars to the S W corner
on a stake from which
a Post oak bares $N 32^{\circ}$
E 24 bars Marked $N 9^{\circ}$ a
Post oak bares $N 70^{\circ} W 10$ bars
10 In Dia thence North
200 bars to the N W corner
on a stake from which
a Pecan bares $N 55^{\circ} E 8$ bars
Marked $N 9^{\circ}$ 8 In Dia a Pecan
bares $N 55^{\circ} W 18$ bars Marked
 $N 10$ thence I own the River
with the meanders thereof
to the N W corner of $N 8$

$N 10$ Beginning at S E corner
of $N 7$ thence west $N 53^{\circ} W$
53

Bars to the S W corner
 on a stake from which a
 Jack Oak bar N 44 E 170
 bars Marked N^o 10 & India
 thence North 2020 bars
 to the S W corner on a stake
 from which a Cotton wood
 bar N 42 E 25 bars & India
 Marked N^o 10 or Cotton wood
 bar N 52 W 14 bars Mark
 N^o 11 thence down the River
 to the S W corner of N^o 11
 Including one Labor

N^o 11 Beginning at the S W
 corner of N^o 10 thence West
 400 bars thence North 200
 bars to the S W corner in a

345

Hackberry Marked $\text{N}^{\circ} 11$
12 In India from where
Hackberry bares $\text{S} \frac{1}{2} \text{E} \frac{1}{2} \text{W}$
6 bars Marked $\text{N}^{\circ} 12, 12$ In India
a Hackberry bares South
4 bars $\frac{1}{2}$ In India. then down
the river with the Miami
there of Including in these
lines one Labor.

$\text{N}^{\circ} 12$ Beginning at
at the $\text{S} \frac{1}{2} \text{W}$ Corner of $\text{N}^{\circ} 11$
then South 1100 fars then
West 1100 bars to the $\text{S} \frac{1}{2} \text{W}$
Corner on a Stake from
a Pecan Bares South 10
bars Marked $\text{N}^{\circ} 12$ then

340

South 360 bars to the SW
corner one stake in
Prairie thence East
100 bars to the SE corner
a post in Prairie
thence S 100 bars to SW
corner of ~~11~~ ¹⁰ ~~11~~ ¹⁰ ~~11~~
Including one labor

347

166

348

RAWSON ALLEY

2500	8334
2042	3
<hr/>	<hr/>
4542	
<hr/>	
29544	

7575
<hr/>
30300
<hr/>
27544
<hr/>
756

(E. O. N.)

870 1000000
600
070
4940
120 325
1000 390
65-249
62

570
300
350
400
87500
84225
91725
4225
908275

Fort Sabers

on

Brazos

Survey

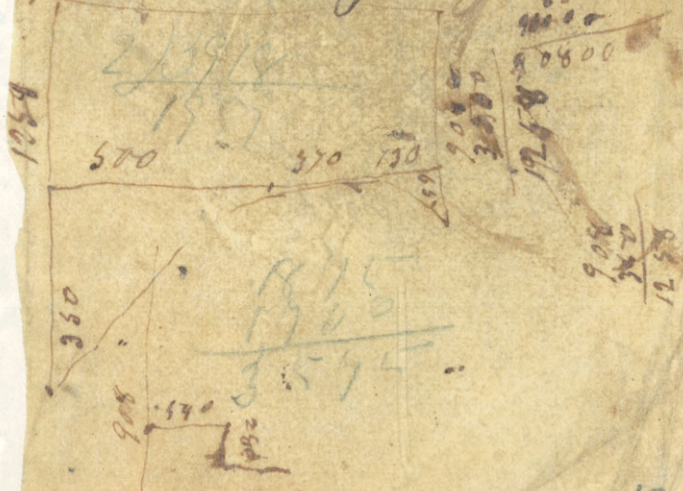

300

1707

John [unclear]

1707

[unclear]

[unclear]

[unclear]

[unclear]

[unclear]

357 ~~347~~

#2 352

Same as bk J. P. 46th

William Houston 353
 Labour No 1. ~~to~~ beginning
 at the upper corner of a
 Survey made for G. P. Hunt
 as is known by the fort
 tract. Thence West at 350 la
 thence North at 500 la
 touched a point of the River
 at 870 la left the River at
 at 1000 la off at East 65 la
 to the River where set a post
 for the upper corner of
 Labour No 1 on the West
 bank of the Big or River
 from which a Dacow 18th
 Dec 18th A 14 N. 130 la thence
 West at 96th la la raised
 a mound in the prairie for
 the N. W. Corner prairie on this
 line 2nd rate prairie thence South at
 1000 la raised a mound in
 the prairie for the S. W. Corner
 prairie on this line 1st rate
 thence East at 1258 la
 intersected the beginning

65
 908

 973

Labors No 2 1813 Beginning
 at the upper corner of Labor No 1
 established on the West Bank of
 the Brazos River thence North
 at 540 Lacs off set East 280 Lacs
 to the River thence North
 at 460 Lacs off set East 160 Lacs
 Southward a part for the upper
 corner of Labor No 2 from
 which a S. 14 E. line to it
 2 1/2 Lacs and a Cotton Wood 30
 ft. dia. to S. 12 W. thence
 West between Labors No 2 & 3
 at 300 Lacs entered prairie at
 540 Lacs left the prairie entered a
 grove of Timber at 760 left the
 grove at 1298 Lacs raised
 a Mound in the prairie for
 the N.W. Corner Land on this line
 Timbered Land 1st rate Timber
 Oak Cottonwood Elm & 26 ft. trees
 10 acres & prairie 2nd rate thence South
 at 1000 Lacs intersected the North
 boundary line of Labor No 1 where
 raised a Mound for the S.W. Corner
 of Labor No 2. prairie on this
 line 2nd rate

Remains of line

110
180
180

Table in west July 15/24
Foot Remains

Labour No 3 N.E. beginning at the
 upper corner of Labour No 2 established
 on the West bank of the Brasos
 River. Thence West 115 Lacs Thence
 North at 1000 Lacs set a post on
 the West bank of the Brasos River
 for the upper corner of Labour No 3
 from which a Box Elder 10th dia
 No. A 41 E 2 Lacs a ds 8th dia No. 1
 34th E 5 Lacs Thence West between
 Labour No 3 & 4 at 942 Lacs set a post
 for the N.W. corner of Labour No 3 from
 which a Pin Oak 16th dia No. 1
 72 E 5 Lacs and an Elm 10th
 dia No. A 46 N. 1 Lac Land on this
 line 1st rate Timber Oak Ash Elm
 4th No. G. Case Vines & Thence South
 at 400 Lacs set a flat at 640 Lacs
 entered prairie at 1000 Lacs Intersected
 the North boundary line of Labour No
 241 Lacs East of the N.W. corner
 there set raised a mound for
 the S.W. corner of Labour No 3
 Land on this line Timber
 Land 1st rate Timber Oak Ash
 Elm & Vines V. No. G. Vines Vines
 4th prairie 2nd rate

776 in road Aug 19/49 Vol 2 of 12 James Jones

League No. 4 M.R. beginning at
the upper corner of Labor No. 3
established on the west bank
of the Brazos River thence North
at 480 Lams - Touches a point of
the River thence West at 500 Lams
offset North 90 Lams to the River
at 990 Lams intersected the River
thence South 40 Lams thence West
at 200 Lams offset North 30 Lams
to the River at 452 Lams offset
North 125 Lams to the River where
upper corner of Labor No. 4 from
which a Cottonwood 40 in dia to
South 59 E 17 Lams and a Lyeamore
4 1/2 in dia to S 80 E 5 Lams thence
South at 895 Lams a Pin Oak 16 in
dia at 1016 Lams intersects the main
where set apart for the S.W. corner
of Labor No. 4 from which a Pin Oak
15 1/2 in dia to N 33 E 7 Lams a do. 20 in
dia to N 18 W 7 Lams ends on the line
1 1/2 in dia Timber Oak 4 1/2 in dia
Black Birch trees 80 thence East at
500 Lams intersects the ^{Survey} North boundary
line of Labor No. 3 345 Lams North of
the S.W. corner where set apart for the S.E.
corner of Labor No. 4 from which an Ash 10 1/2
in dia to N 36 W 3 Lams and an Elm 8 in dia to N
S 83 Lams ends low and set on this line Timber 4 1/2 in dia

William Little

1. 1831 1/2
Same as 66

Labour No 4 WR beginning at 374 Upper
 corner of Labour No 4 Established on the West
 side of the Cooper River. Thence West at
 200 Lams offset North 100 Lams to the
 River at 470 Lams intersected the River
 Thence South 200 Lams Thence West
 at 153 Lams intersected the River Thence
 South 150 Lams Thence West at 375
 Lams intersected the River When set
 a post for the Upper Corner of
 Labour No 5 from which a Cotton
 Wood 8 1/2 dia to S 64 W 4 Lams
 and a Hollow 8 1/2 dia to S 88 E
 7 Lams Thence South between Labour
 No 5 & 6 at 660 Lams entered prairie
 at 745 Lams raised a mound
 Prairie for the SW corner of Labour
 No 5. Land on this line 1st rate
 Timber Oak Ash &c 40 W 40 G. 1
 for oak & Birch Green &c
 Thence East along the South line
 day of Labour 5 at 1000 Lams set
 a post for the SE corner from which
 an Elm 14 1/2 dia to S 44 W 13 Lams
 Prairie on this line 2nd rate
 Thence North at 79 Lams intersected
 the SW Cor of Labour No 4

James as Clerk 1847

Labor No 6 NW beginning at the
 upper corner of Labor No 5 establish
 ed on the West bank of the Brasos River
 Thence South 200 Lacs Thence West
 at 530 Lacs West North 150 Lacs to
 the River at 720 Lacs intersected
 the River Thence South 700 Lacs
 Thence West 280 Lacs intersected
 the Brasos River Opposite to
 the falls whar sets a post for
 the Upper Corner of Labor No 6
 from which a Cotton Wood Wh
 dia be at 4 W. 30 Lacs Thence South
 at 230 Lacs a Gully bears N E & S W
 at 289 Lacs set a post in said
 Gully for the S W. Cor of Labor 6 at
 the edge of the prairie from which
 a pine Oak 12 in dia be at 25 E 10
 Lacs Thence East along the South
 boundary of Labor No 6 at 1000
 Lacs raised a mound for the S E
 corner of Labor No 6 prairie on this
 line 2 1/2 Lacs Thence North at 444
 Lacs intersected the S W. Corner of
 Labor No 5

March 4. 1824

Also notes of a half Labor³⁰⁹
of Land surveyed for Jno Little
beginning at the SW cor of
Little Labor in the first line
thence South at 318 bars to a
post for the SW cor thence East
at 1259 bars Intersected the
West boundary line of Labor
No. 2 ~~345 bars north of the SW~~
~~cor~~ 72 bars South of the SW
cor thence East along the
north boundary line of Lab
or No. 2 $241 \frac{2}{3}$ bars to the SW
cor of Labor No. 3 thence
North with the West boundary
line of Labor No. 3 $345 \frac{2}{3}$ bars
thence West 500 bars thence
South 79 bars thence West
1000 bars to the place
of beginning

100 Field Notes of a gr League of
Land Surveyed for Philo
Fairchild Situated in the
fort land Beginning at the
S.W. cor. of a Labor of Land
granted to Mr. Morton which
Labor is numbered No 1. Thence
North a long the west boundary
of P. Labor 1000 bars Thence
East 973 bars to the Beason River
Thence up the River with
the meanders there of to
the upper Co. of Labor No 2
Thence west between Labors No 2
1298 bars to the N.W. cor. of P
Labor Thence South 72 bars to
the S.E. cor. of 2 Labors of Land
Granted to Little Thence West
with his South boundary bar
1269 bars to his S.W. cor. Thence
South with the East boundary

line of Wright & Whites Labor
196 bars to their SE Cor Thence ³⁸⁹
West with their South bounda-
ry line 1000 bars to their SW
Cor Thence North 290 bars to their
upper Cor on the River Thence
up the River with the meander
then of South that 600 bars off set
West 250 bars to the River at 890
bars intersected the North boundary
line of William Andrews Survey
Thence S 50° W with his line 500 bars
to the River Thence N 50° E with
S¹ ^{boundary line of} William Andrews Survey -
852 bars to his NE Cor Thence
S 40° E with his East boundary
line 1000 bars to his SE Cor
Thence S 50° W with his South
boundary line 1062 bars to his
upper Cor on the River Thence
up the River with the meander
then of East of 300 bars Thence

352 South at 340 bars offpt West
60 bars to the River at 660 bars
offpt West 40 bars River thence
South at 620 bars offpt West
420 bars to the River Whar
Cornered on a Pin Oak 12th
dia for the upper Co on the
River from which a Pin
Oak 16th dia is 830^W 7 bars
thence South ~~1894~~⁷⁰⁴ bars to a post
and mound ~~1894~~ thence
East at ~~1894~~¹⁸⁹⁴ bars to a post
and raised a mound for the
SE Cor thence North at 1432
bars intersected the place of
beginning) South 704 to a
mound thence East 1894 to
S. Long's west boundary line
thence 4500 with 30 line to the
Place of beginning No. 2. 1827

The above notes has
been altered by orders of S^r
Justice by Tho^s G. Gordon

363

174

364



380

7

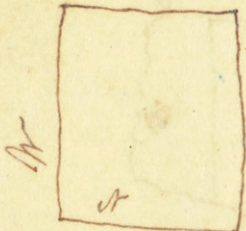

367

Deers of - of water - Chocoma in - Indian and
for - of - of - in - for - one - and - from
of - all - and - a - in -

March 4 1843

James Wilson

369

1400
8000

120000
230000

19875

1009835
620000

1514612

10161

18412

12520
1892

20

3

1.50

1.00

1.31

24005.814
2482.54

38.314

1400
18000

120000
1200

240000

265
150

13250
285

239900

19840

Handwritten numbers and calculations at the top of the page, including a vertical list of numbers on the left and a small table or calculation on the right.

Handwritten numbers and calculations in the middle-left section, possibly a list of values or a small table.



Handwritten numbers and calculations in the middle-left section, similar to the ones above, possibly a continuation of a list or table.

Handwritten numbers and calculations in the middle-right section, possibly a small table or calculation.

Handwritten numbers and calculations in the bottom-left section, possibly a list of values or a small table.



370

$$\begin{array}{r} 200 \\ 150 \\ \hline 350 \\ 175 \\ \hline 525 \\ 8750 \\ 875 \\ \hline 96250 \end{array}$$

720

$$\begin{array}{r} 700 \\ \hline 504000 \end{array}$$

170

$$\begin{array}{r} 75 \\ \hline 850 \\ 1190 \\ \hline 12750 \end{array}$$

700

$$\begin{array}{r} 140 \\ \hline 28000 \\ 700 \\ \hline 98000 \end{array}$$

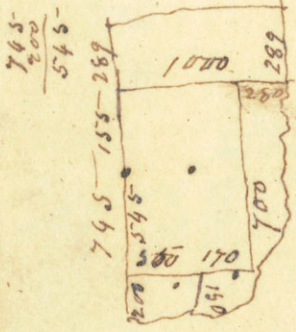

745

$$\begin{array}{r} 510 \\ 200 \\ \hline 1095 \end{array}$$

700

$$\begin{array}{r} 545 \\ \hline 181 \end{array}$$

1000000

$$\begin{array}{r} 711000 \\ \hline 289000 \end{array}$$

289

$$\begin{array}{r} 155 \\ \hline 444 \end{array}$$

96250

$$\begin{array}{r} 12750 \\ 504000 \\ 98000 \\ \hline 711000 \end{array}$$

1095

$$\begin{array}{r} 1016 \\ \hline 79 \end{array}$$

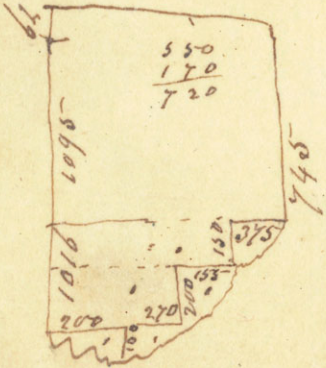

3.00

$$\begin{array}{r} 5.00 \\ 3.00 \\ 1.80 \\ \hline 37.37\frac{1}{2} \\ 37.37\frac{1}{2} \end{array}$$

$$\begin{array}{r} 470 \\ 200 \\ \hline 94000 \end{array} \quad \begin{array}{r} 200 \\ 60 \\ \hline 10000 \end{array}$$

$$\begin{array}{r} 270 \\ 50 \\ \hline 15600 \end{array} \quad \begin{array}{r} 480 \\ 155 \\ 155 \\ \hline 625 \end{array} \quad \text{371}$$

$$\begin{array}{r} 625 \\ 180 \\ \hline 31250 \\ 625 \\ \hline 93750 \end{array}$$

$$\begin{array}{r} 375 \\ 75 \\ \hline 1875 \\ 2625 \\ \hline 28125 \end{array}$$

$$\begin{array}{r} 1000 \\ 745 \\ \hline 1000 \\ 745 \\ \hline 5000 \\ 4000 \\ \hline 4000 \end{array}$$

$$\begin{array}{r} 1000000 \\ 254875 \\ \hline 745125 \\ 152372 \\ \hline 1146372 \end{array}$$

$$\begin{array}{r} 31 \\ 29 \\ \hline 230 \\ 31 \\ \hline 31 \\ 284 \end{array}$$

$$\begin{array}{r} 10000 \\ 13500 \\ 94000 \\ 15500 \\ 93750 \\ 28125 \\ \hline 254875 \end{array}$$

$$\begin{array}{r} 200 \\ 180 \\ \hline 380 \end{array}$$

$$\begin{array}{r} 745 \\ 350 \\ \hline 1095 \\ 79 \end{array}$$

372



$$\begin{array}{r} 659 \\ - 248 \\ \hline 411 \\ 1000 \\ \hline 1411 \end{array}$$

$$\begin{array}{r} 452 \\ 980 \\ \hline 1432 \\ 36160 \\ \hline 40680 \\ 40680 \\ \hline 81360 \\ 40680 \\ \hline 122040 \\ 452 \\ \hline 122492 \end{array}$$

$$\begin{array}{r} 4000 \\ 458 \\ \hline 4442 \\ 45000 \\ \hline 49442 \\ 444 \\ \hline 49886 \end{array}$$

$$\begin{array}{r} 0001 \\ 280 \\ 011 \\ 050 \\ \hline 0001 \end{array}$$

$$\begin{array}{r} 895 \\ 4475 \\ \hline 5370 \end{array}$$

$$\begin{array}{r} 893 \\ 893 \\ \hline 1786 \\ 1000 \\ \hline 2786 \\ 1000 \\ \hline 3786 \\ 1000 \\ \hline 4786 \\ 1000 \\ \hline 5786 \\ 1000 \\ \hline 6786 \\ 1000 \\ \hline 7786 \\ 1000 \\ \hline 8786 \\ 1000 \\ \hline 9786 \\ 1000 \\ \hline 10786 \end{array}$$

$$\begin{array}{r} 475 \\ 529 \\ \hline 1004 \end{array}$$

$$\begin{array}{r} 475 \\ 529 \\ \hline 1004 \end{array}$$

$$\begin{array}{r}
 942 \\
 \underline{400} \\
 376800 \\
 22500 \\
 \underline{22100} \\
 421400
 \end{array}$$

$$\begin{array}{r}
 500 \\
 \underline{45} \\
 2500 \\
 2000 \\
 \underline{22500}
 \end{array}$$

$$\begin{array}{r}
 442 \\
 \underline{4500} \\
 22100
 \end{array}$$

$$\begin{array}{r}
 1000000 \\
 \underline{421400} \\
 578600
 \end{array}$$

$$\begin{array}{r}
 1100 \\
 \underline{570} \\
 77000 \\
 \underline{5500}
 \end{array}$$

$$\begin{array}{r}
 481 \\
 \underline{40} \\
 1920
 \end{array}$$

$$\begin{array}{r}
 1110 \\
 \underline{550} \\
 4400 \\
 \underline{48} \\
 240
 \end{array}$$

$$\begin{array}{r}
 1100 \\
 \underline{540} \\
 44000 \\
 \underline{5500}
 \end{array}$$

$$\begin{array}{r}
 580 \\
 \underline{990} \\
 720
 \end{array}$$

$$\begin{array}{r}
 35 \\
 \underline{300} \\
 10500
 \end{array}$$

$$\begin{array}{r}
 535 \\
 \underline{1100} \\
 53500
 \end{array}$$

$$\begin{array}{r}
 1100 \\
 \underline{53} \\
 5300 \\
 \underline{5500}
 \end{array}$$

$$\begin{array}{r}
 1000000 \\
 \underline{445890} \\
 554160
 \end{array}$$

$$\begin{array}{r}
 1100 \\
 \underline{528} \\
 5500 \\
 2200 \\
 \underline{5500} \\
 577400
 \end{array}$$

$$\begin{array}{r}
 400 \\
 \underline{40} \\
 360
 \end{array}$$

$$\begin{array}{r}
 421400 \\
 1920 \\
 10240 \\
 10500 \\
 \underline{11780} \\
 445840
 \end{array}$$

$$\begin{array}{r}
 125 \\
 \underline{20} \\
 155 \\
 \underline{76} \\
 930 \\
 \underline{1085} \\
 11780
 \end{array}$$

$$\begin{array}{r}
 1100 \\
 \underline{526} \\
 6600 \\
 2200 \\
 \underline{5500} \\
 578600
 \end{array}$$

280
 160
 120
 115
 57500
 100000
 57500
 942500

1000000
 241200
 758800
 1000
 758
 8000
 5000
 000
 958000

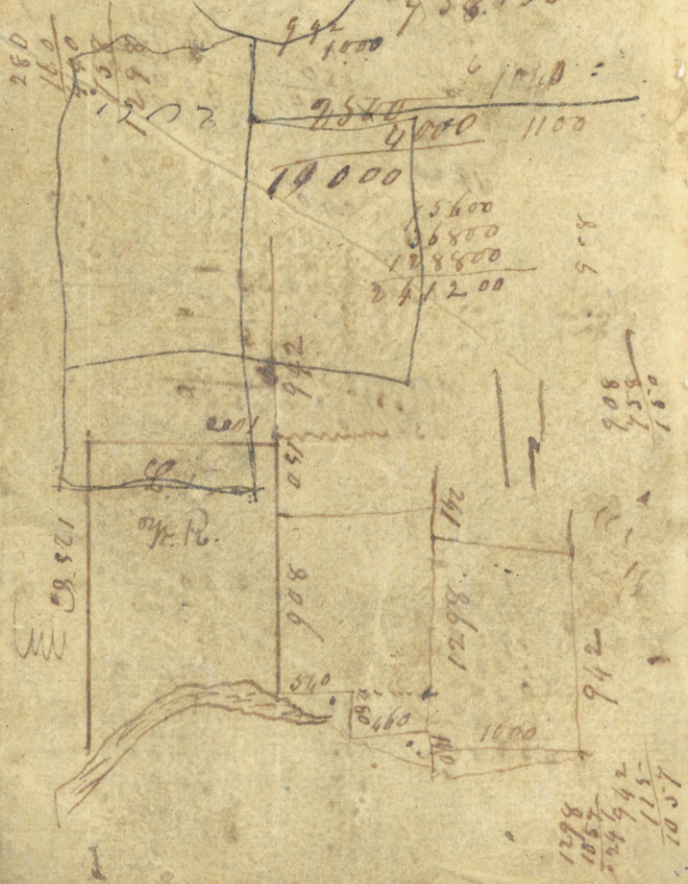

320
670
273 00
1560
1833 00

315

Gold (part)
City of New York
of the
of the
of the

110 80
29 00
3500 00
1626 00
17700 10
615
300
17700 10
3600
78100

Laborer E. R.

W. R. at Mouth of

Bravo River

112	1282	13250	13250	14250	15250	16250	17250	18250	19250	20250	21250	22250	23250	24250	25250	26250	27250	28250	29250	30250	31250	32250	33250	34250	35250	36250	37250	38250	39250	40250	41250	42250	43250	44250	45250	46250	47250	48250	49250	50250																																															
1282	13250	14250	15250	16250	17250	18250	19250	20250	21250	22250	23250	24250	25250	26250	27250	28250	29250	30250	31250	32250	33250	34250	35250	36250	37250	38250	39250	40250	41250	42250	43250	44250	45250	46250	47250	48250	49250	50250	51250	52250	53250	54250	55250	56250	57250	58250	59250	60250																																							
13250	14250	15250	16250	17250	18250	19250	20250	21250	22250	23250	24250	25250	26250	27250	28250	29250	30250	31250	32250	33250	34250	35250	36250	37250	38250	39250	40250	41250	42250	43250	44250	45250	46250	47250	48250	49250	50250	51250	52250	53250	54250	55250	56250	57250	58250	59250	60250	61250	62250	63250	64250	65250	66250	67250	68250	69250	70250	71250	72250	73250	74250	75250	76250	77250	78250	79250	80250	81250	82250	83250	84250	85250	86250	87250	88250	89250	90250	91250	92250	93250	94250	95250	96250	97250	98250	99250	100250

(181)

370

1170 / 723250 (618)
7020
- 2125
1170
- 1550
7360

[Faint, illegible handwriting covering the majority of the page]

397

182

378

31

Field notes of a day. Run out the
 East side of the Brazos River which
 is the lower line; Stephen F Austin
 survey beginning on the East bank
 of the Brazos River opposite to
 the town corner on the West side
 of the River then a North at
 100 yds North bearing trees
 a cottonwood 16 in dia br
 21 W 6 Can and a Mulberry 6 in
 dia. W N E 6 $\frac{5}{10}$ Can at 230 Can
 entered prairie thence East 280 Can South
 145 Can River East 140 Can South 270 River
 East 280 Can thence South at 570 Can
 that went 200 Can to the River at
 770 Can intersected the River when
 set a post for the town corner of La
 b on N^o 1 and upper Co. of Galveson
 from which are Elm 5 in dia br.
 N 15 W 8 Can marked $\frac{1}{ER}$ a do 14 in dia

I. S. Austin Lab M. J. E. R.

80th 150 E 15 line marked ~~EB~~ there
North at 900 line entered parcel
at 2098 line set a post and raised
a mound for the 2nd Co. There
went at 700 line set a post and
raised a mound for the 1st
Co. Thence south at 937 line enter
timber at 1161 line the beginning
course.

Labor NE Cor beginning at the
 lower cor. of Labor No 1 Thence ³⁸¹
 East 400 Lns Thence South 400 Lns
 Thence East 300 Lns South 40 Lns
 Run when set apart for the lower
 cor. of Labor No 2 and upper cor. of
 Labor No 3 from which a cottonwood
 12 1/2 dia lvs West 1/2 Lns marked EB
 a do 10 1/2 dia lvs N 80 E 1 Lns
 marked ³EB Thence North at 650
 Lns intersected prairie at 1570 Lns set
 a post and raised a mound for
 the NE cor. of Labor No 3 Thence
 West at 700 Lns intersected the
 East boundary line of Labor No 1
 964 Lns South of the NE cor. when
 set a post and raised a mound
 for the NW cor. of Labor No 3
 according to the title, the 3d line is 1134 lvs

Anthony T. Clark

Title issued Aug 24/24 Vol 1 p. 533 B.
 E 44 184
 J. W. Briggs - Brazoria Co

49
 Labor ~~no 3~~ ⁴⁹ ~~off~~ Beginning at the
 corner of Labor No 3, then on
 north 500 bars East 260 bars North
 200 bars East at 440 bars touched a
 point of the River at 1140 off
 South 290 bars to the River when
 set a post for the lower Co. of
 Labor No 4 and upper Co. of Labor
~~no 3~~ from which a Live Oak stand
 East 7 bars marked $\frac{5}{ER}$ a do
 to do in No 7 $\frac{11}{ER}$ 12 bars marked
 $\frac{4}{ER}$. Thence North at 230 bars entered
 prairie at 15 $\frac{7}{ER}$ bars set a post and
 raised a mound for the NE cor. of
 Labor No 4 Thence West at 1400 bars
 set a post and raised a mound for
 the N.W. cor. Thence South 378 bars
 to the NE cor. of Labor No 2
 In the table 3^d line (South) 1948 vs to the river
 E 260 Lat
 1852

James C. T. Miller
 1852 March Aug 16 24

Peter Bertrand

Labors No 5 ER Beginning at the ³⁸³
town corner of Labor No 4 Thence East
700 low Thence South at 410 low inter-
sected the Beaver River when set a post
for the town cor. of Labor No 5 and upper
corner of Labor No 6 from which is
W. 100 to 2. ⁵⁶⁸ ⁵⁶⁸ N 72 W 90 low
and an Elm 4 in dia by N 61 E 2 low
marked GEB Thence North at 2162 low
set a post and raised a mound for the
NE cor. of Labor No 5 Thence West at
700 low set a post and raised a mound
for the NW cor. Thence South 178 low
to the NE cor. of Labor No 4

In the title the 3d line is 1752 vs

Title issued Nov. 24/30

Vol 7 - p 406

Meatagorda Co

Nov 24

John P. Field

Labors No 6 E.B. beginning at the
 lower corner of Labors No 5 Thence
 East 400 rods Thence South 200 rods
 Thence East 300 rods Thence South
 310 rods offset west 100 rods Thence at
 at 650 rods offset west 15 rods Thence at
 900 rods offset west 80 rods Thence at
 60 rods intersected the River when
 set a post for the lower corner of
 Labors No 6 from which a Line Bore
 18 In dia bore S 55 E 5 rods marked $\frac{1}{2}$
 and an Elm 4 In dia set at S 1 W
 4 rods marked 6 E.B. Thence North at
 930 rods entered prairie at 2203 rods set
 a post and raised a mound for the
 N.E. cor. Thence West at 700 rods inter-
 sected the East boundary line of Labors
 No 5 $\frac{1}{2}$ 1017 rods South of the N.E. cor
 when set a post and raised a
 mound for the N.W. cor

1854
 1855
 1856
 1857
 1858
 1859
 1860
 1861
 1862
 1863
 1864
 1865
 1866
 1867
 1868
 1869
 1870
 1871
 1872
 1873
 1874
 1875
 1876
 1877
 1878
 1879
 1880
 1881
 1882
 1883
 1884
 1885
 1886
 1887
 1888
 1889
 1890
 1891
 1892
 1893
 1894
 1895
 1896
 1897
 1898
 1899
 1900

John P. Field on the title the
 last course is 1145 rods

Labor No 7 E.R. Beginning at the
 lower cor. of Labor No 6 thence East
 700 feet South at 570 feet intersect
 the Brazos River when I cornered
 on a low bank 2 1/2 in dia. for
 the lower corner of Labor No 7 and
 upper cor. of Labor No 8 marked on
 the East side E.R. on the West side
 E.R. thence North at 270 feet entered
 prairie at 1715 feet set a post and
 raised a mound for the NE cor.
 thence West at 700 feet intersect
 the East boundary line of Labor No
 1060 feet South of the NE cor. when
 set a post and raised a mound
 for the NW cor. of Labor No 7

5. Angier

In the title, the last course is 1143 1/2

Brazoria County, Tex. Witnessed Aug. 24/24
 Vol. 2 - p. 534
 [Signature]

566 Labor No 8th Est beginning at the
Lower cor. Labor No 7th thence East
700 Lams thence South at 400 Lams
thence West 80 Lams to the River at
520 Lams intersected the River when
crossed on a line across the river for
the lower cor. of Labor No 9 marked
on the East side $\frac{9}{ER}$ on the West
side $\frac{8}{ER}$ thence North at 200 Lams
entered prairie at 1761 set a post and
raised a mound for the NE cor
thence West at 700 Lams intersected
the East boundary line of Labor
No 7 $\frac{7}{ER}$ 500 Lams South of the NE
cor. where set a post and raised
a mound for the NW cor. of
Labor No 8

Labour No 9 ER Beginning at the NW
co. of Labour No 8 Thence East 700
then South at 190⁰ less intersected the
Prairie River when crossed on a Ha
shbury & Co. line for the lower cor. of
Labour No 8 located on the East side
ER on the West side of Thence North
at 180⁰ less intersected Prairie at 15 2/3 less
set a post and raised a mound for
the NE co. Thence West at 700 less
intersected the East Boundary line
of Labour No 8 1/2 530 less South of
the NE co. when set a post and
raised a mound for the NW
co. of Labour No 9

388
Below No 9 E. Beginning at the lower
Corner of Labor No 9 Thence North
100 Var Thence East at 380 Var. Offset
South 60 Var to the River at 700 Var
Offset South 250 Var to the Brazos
River When set a post and raised
a mound on the bank of the River
for the lower corner of Labor No 10
Thence North at 1561 Var set a post
and raised a mound for the N.E. C.
Thence West at 700 Var intersected
the East boundary line of Labor
No 9 1/2 112 Var South of the N.E. C.
When set a post and raised a
mound for the N.W. C. of
Labor No 10

Labor No 10 E.R. Beginning at
 the ~~upper~~ ³⁸⁹ cor. of Labor No 10 Thence
^{lower}
 East 700 Cas Thence South at 500
 Cas intersected the Brazos River 10 Cas
 set a post for the lower corner of
 Labor No 11 from which a Line 10 Cas
 10 In dia br S 45 E 3 Cas marked
 $\frac{12}{ER}$ and an Elm 6 In dia br 18 In
 11 Cas marked $\frac{11}{ER}$ Thence North
 at 220 Cas interced prairie at
 1678 Cas set a post and raised
 a mound for the NE cor. Thence
 West at 700 Cas intersected the
 East boundary line of Labor No 10
 345 Cas South of the NE cor
 Whar set a post and raised a
 mound for the N.W. cor. of Labor
 No 11

39
Labors No 12 ER Beginning at the
Lower corner of Labor No 12 Thence
East on the bank of the River 700 Lacs
When set a post for the lower cor
of Labor No 12 from which a
line of 10 1/2 in dia to S 59 W 1 Len
marked 12 ER
do 13 1/2 in dia to S 83 E 5 Lacs
marked 13 ER Thence North at 1428
Lacs set a post and raised a
mound for the NE Co. Thence West
at 700 Lacs intersected the East bound
ary line of Labor No 11 1/2 250 Lacs
South of the NE co. When set
a post and raised a mound
for the N.W. co. of League No
12

Alexander Galvin

Title issued Aug 3/24. Vol 2, p. 316

Brayoria Co

ASB

Labour No 13 & R. 1994 being at the
E. corner corner of Labour No 12 Thence
East 100 Lanes Thence North 30 Lanes East 220
Poles North 6 Lanes East 180 Lanes South 120
Lanes Pole East 200 Lanes South 120 Lanes
Pole when hit a post and raised a
mound for the lower Cor. of Labour
No 13 Thence North at 169 1/2 Lanes hit
a post and raised a mound for
the N.E. Cor. Thence West 700 Lanes
intersected the East boundary line
of Labour No 12 when hit a post and
raised a mound for the S.W. Cor.
of Labour No 13

To Show &c

1. Labors in 4 1/2 days beginning at the
lower Co. of Labor No 13 then we
East 200 yds thence South at 600 yds
I marked a point of the river at 1300
Yds off set west 160 yds to the River
at 1450 yds off set west 200 yds to
the River at 1900 yds intersected
the River thence East along the bank
170 yds thence North 100 yds East 170 yds
River North 150 yds East at 105 yds
intersected the River when set a post
for the lower Co. of Labor No 14
thence North at 1550 yds set a post
and raised a mound for the N.E. Co.
thence West at 725 yds intersected
the lower Co. of Labor No 13 on the
River

Labors No 15 E R by running at the ³⁰⁰ south
corner of Labor No 14 thence North
300 Lins East 240 thence North 200 Lins
East 460 Lins the Quin When set a
post for the corner cor of Labor No 15
thence North at 1122 Lins set a post
and raised a mound for the NE corner
thence West at 800 Lins set a post
and raised a mound for the
N-W cor. thence South 72 Lins to the
NE cor. of Labor No 14

94 Labor No 16 E N Beginning at the
lower cor. of Labor No 15 Thence North
50 bars Thence East 700 bars Thence North
80 bars East 90 bars Thence when
set a post for the lower cor. of Labor
No 16 Thence North at 1152 bars set
a post and raised a mound for the
NE cor. Thence West at 800 bars set
a post and raised a mound for the
N.W. cor. Thence South 160 bars to the
NE cor. of Labor No 15

1152
434

718

File in end of page 24
vol 3 of De. 1824

Ass. Mitehell

Labors No 17 E to beginning at the
town cor. of Labors No 16 Thence North
100 bars Thence East at 265 bars intersected
the River at the mouth of the Bay at 550
bars off set south 100 bars to the River thence
East at 250 bars intersected off set south 290 bars
to the River thence East at 1006 bars off set south
170 bars intersected the Bay or River at the
mouth at 200 bars off set south 170 bars
to the Ocean at 470 bars intersected the
Ocean where set a post for the lower
corner of Labors No 17 Thence North at
1008 bars set a post and raised a mound
for the N.E. cor. Thence West at 1170
bars set a post on the East boundary
line of Labors No 16 1/2 436 bars south
of the N.E. cor. for the N.W. cor.
of Labors No 17

Bay or River
No 17

Dec. 8. 1825

The boat bears S 30 E from Dutch
old cor to the mouth of Oyster Creek,
it then makes more East to the west side

180
10 also No 2 W.D. Beginning at
the upper cor. of Lot No 1
thence West at 200 paces then
40 paces to the River at 490 paces
intersected the River thence
South 180 paces thence West to
310 paces intersected the River
then set a post for the
upper cor. of Lot No 2 thence
South at 1087 paces set a post
and raised a mound for the
S. W. cor. thence East at
800 paces set a post and
raised a mound for the
S. E. cor.

Labrad No 3rd beginning at
the upper pt. of Labrad No
2 thence South 400 cans thence
West 370 cans River South 200 cans
thence East 430 cans thence North 60
cans to the River when set a post
for the upper pt. of Labrad No 3
thence South at 1055 cans set a
post and raised a mound from
the S.W. cor. thence East at 800
set a post and raised a mound
for the S.E. cor. thence North
508 cans to the S.W. cor. of
Labrad No 2

No 3 West of River

Latons No 4 1792 beginning at the
upper cor. of Latons No 3 thence
west 300 Lns to the River
offset 40 Lns North at 400 Lns
offset East 60 Lns to the River
at 660 Lns offset East 60 Lns to
the River where set a post
for the upper cor. of Latons
No 4 thence west at 824 Lns
set a post and raised a mound
for the N^W cor. thence south
at 1100 Lns set a post and
raised a mound for the S^W
cor. thence East at 1144 Lns
intersected the N^W boundary line
of Latons No 3 $\frac{1}{2}$ 200 Lns
south of the upper cor. and
the River where set a post
and raised a mound

Labor No 5. ^W Beginning 1/20 The upper
70. of Labor No 4 Thence West 100 Cas
Thence North at 680 Cas off set East 200 Cas
to the River at 980 Cas intersected
the River Thence West at 450 Cas
off set North 95 Cas to the River at
827 Cas off set North 70 Cas to the
River where set a post for the
upper Co. of Labor No 5 from
which a Live Oak 5th dia
by S 23 E 3 Cas marked ⁶R a 4th
8th dia by S 68 W 5 Cas marked
6th R Thence South at 70 Cas
aft the timber at 1050 Cas
set a post and raised a mound
for the 1st Co. Thence East
103 Cas to the 1st Co. of Labor
No 4.

Rayona Co. returned Nov. 26/32 Vol. 8.

1402

Thomas H. McKeeney

Labor No 6 W. R. beginning at the
 upper co. of Labor No 5 thence
 South 90 tan thence West 300 tan
 thence North 120 tan to the River
 thence West 330 tan thence North
 180 tan to the River West 70 tan
 North 50 tan. Run when hit a post
 for the upper co. of Labor No 6
 from which an Elm 8 in. dia
 is 37 E 7 tan marked with a 20
 10 in dia is 52 W 6 tan marked
 7 W R. thence South at 50 tan
 entered main at 1559 tan hit
 a post and raised a mound for
 the S. W. Co. thence East at 803 tan
 entered the West boundary line
 of Labor No 4 249 tan South
 of the N. W. Co. when hit
 a post and raised a mound
 for the S. E. Co. of Labor No 6

In the table the last line

* E. (North) is 1299 tan

S. S. Austin
The dinner May 1868 vol 2. p. 608
Bragg's Co.

Labore No 7 W. B. beginning at the
upper cor. of Labore No 6. Thence
West 700. yds thence North 466 yds
to the River when set a post for
the upper cor. of Labore No 7 which
is 10 1/2 in dia. by 1 1/2 in dia. by 1 1/2 in dia.
marked 7 W. B. a do 12 1/2 in dia. by
1 1/2 in dia. by 1 1/2 in dia. marked 8 W. B.
thence South at 60 yds intersect
passage at 1508 yds set a post and
raised a mound for the S. W. cor.
thence East at 700 yds intersected
the West boundary line of Labore
No 6 by 511 yds North of the S. E.
cor. when set a post and raised
a mound for the S. E. cor. of
Labore No 7

Labors No 8 440 beginning at
the upper cor. of Labor No 7
thence South 61 can thence West
at 500 can I reached a point of
the River at 700 can off set North
40 can to the River. When set
a post for the upper cor. of
Labor No 8 thence South at
590 can set a post and raise
a mound for the S W cor. thence
East at 700 can intersected the
West boundary line of Labor
No 7 98 can North of the S W
cor. When set a post and raised
a mound for the S E cor
of Labor No 8

The mound No 3 1/2 p 2 1868

Lab. No 8
No 8

J. A. Austin
Brazoria Co.
Total is used May 31/88 Vol 2 of 68

4.15 1890

Latrod No 9 NW by crossing out
the upper cor. of Latrod No 8 then
West at 200 bars offset North 120 bars
to the River at 700 bars offset
North 595 bars to the River when
set a post for the upper cor. of
Latrod No 9 from which a Pin
Oak 5 1/2 dia W S 1/4 NW 1/4 can mark
10 NW and a Live Oak 10 1/2 dia
W. S 30 E 10 bars marked 9 NW
Thence South at 105 bars entered
precure at 1738 bars set a post
and raised a mound for the SW
cor. Thence East at 700 bars entered
the West boundary line of
Latrod No 8 2 1/2 247 bars North of
the S.W. cor. when set a post
and raised a mound for the SE
cor. of Latrod No 9

406.

Labor No 10 WPA beginning
 the upper co. of Labor No 9
 thence W at 700 low thence North
 at 470 low intersected the River
 when set a post for the upper
 corner of Labor No 10 from which
 an Elind 10 in dia cr. S 3 E 60
 marked 10 W thence South at
 130 low intersected prairie at 166 3/4
 set a post and raised a mound
 for the SW cor. of Labor No 10
 thence East at 700 low intersected
 the West boundary line of Labor
 No 9 5 45 low North of the SW
 cor when set a post and raised
 a mound for the SE cor. of
 Labor No 10.

M. B. Nichols.

T. B. & vicinity 3/24

Vol. 2. p. 308

Oregon Co

R. B.

James C. B. Austin

Latow No 11 W.R. beginning ^{at} the
upper cor of Latow No 10 then
off 300 lams North 235 lams then
thence west 400 lams thence
North 1200 lams to the River where
set a post for the upper cor of
Latow No 11 from which a
D. in Oak 10 1/2 dia W. at 44 W-4 lams
marked 12 W.R. a do 9 1/2 dia W 173 E
3 lams marked 11 W.R. thence South
at 400 lams entered prairie at 2342
lams set a post and raised a mound
for the S.W. Cor. thence East at 700
lams intersected the West boundary
line of Latow No 10 2/3 756 lams
North of the S.W. cor. where set
a post and raised a mound
for the S.E. cor. of Latow No 11

In the title the last line is 9070

Title issued ~~by~~ July 24/24 Vol 2 p 537

Mazoria County

34

409

Latrod No 12, 1/4 Sec beginning at
 the upper cor of Latrod No 11 then
 off at 700 can thence north at 2700 can
 intersected the River when set a
 post for the upper cor. of Latrod
 No 12 from which a Levi oak
 15 1/2 dia to S 35 1/4 W 5 can
 marked 13WR thence South
 at 1663 can set a post for
 the S 1/4 cor thence East at 700
 can intersected the West bounda-
 ry of Latrod No 11 1149 can
 north of the S 1/4 cor when
 set a post for the S 1/2 cor
 of Latrod No 12

John Austin

In the title the last course is
 1193 v. - Total issued Aug 24/24
 vol 2 - f 537 -

Brozonia Co
 H. S. S. 1193
 1149
 2342

S. M. Williams
I have used May 10th 24 Vol 2 to 386
Brevoria

Labour No 13th W R by eminent state
The upper cor. of Labour No 12
thence West 700⁰⁰ then North
at 370⁰⁰ then intersected the River
then set a post ^{202⁰⁰ distance} from upper
cor. of Labour No 13 thence ^{342⁰⁰ W 10⁰⁰ E} North
at 300⁰⁰ then intersected ¹⁶¹³ ¹⁶¹³
then set a post and raised a mound
for the Sth cor. Thence East
at 700⁰⁰ then intersected the west
boundary line of Labour No 12 ³²⁰
then North of the Sth cor. then
set a post and raised a mound
for the SE cor. of Labour No
13

S. M. Williams,
In the title, the line course South
is 1243⁰⁰.

2007

1613
300
1313

410
Francis J. Wells.
1874 issued July 21/24 Vol. 1 p. 198

Section 14 W⁴R⁴ beginning at the
upper Co. of Labor at 13th Thence
West at 400 tan offset North 100 tan
to the River at 600 tan intersect
the River Thence South 130 tan
Thence West at 100 tan intersect
the River When set a post
for the upper Co. of Labor at 14th
from which an Elm 8 1/2 dia
S 33 E 3 (Case marked 14 W⁴R⁴)
Thence South at 340 tan intersect prairie
at 1265 tan set a post and
raised a mound for the S W⁴R⁴
Co. Thence East at 700 tan
intersected the west boundary
line of Labor at 18 1/2 218 tan
North of the S W⁴R⁴ Co. When
set a post and raised a mound
and for the SE Co. of Labor
at 14

D. F. F. Wells.
In the title, same course; 1765 to the river

John Mc Neal. Oregon Co
7/31

Labore No 15 WR beginning at ⁴⁰
the upper cor of Labore No 14
Thence South 310 cans Thence West
170 Paces Thence South 226 cans Thence
East at 400 cans off set North 100 cans
to the River at 570 cans off set
North 230 cans to the River then
set a post for the upper cor of
Labore No 15 from which one
can 4 P. due W S 25 E 6 cans.
Marked 15 WR and a Willow
14 P. due W S 46 W 6 cans marked
16 WR Thence South at 590 cans
interd Pointe at 1457 cans set
a post and raised a mound for
the S W cor Thence East at 700 cans
set a post and raised a mound
for the S E cor Thence North 492
cans to the S W cor of Labore
No 14

40
Salad No 16 W.P. beginning at the
upper cor. of Labor No 15 thence
west 300 cans thence north 270 cans
thence west 400 cans
thence north 350 cans west 300 cans
north 40 cans the River thence
west at 100 cans of feet North
800 cans to the River at 380
cans intersected the Brazos River
at the lower cor. of Stephen
& Austin Survey on the west
side of the Brazos thence
south at 660 cans set a
post and raised a mound for
the S.W. cor. thence East at
1010 cans intersected the upper
cor. of Labor No 15 at the River

[Faint, illegible handwriting, possibly bleed-through from the reverse side of the page]

Du Station Gipsman or train
Three Ballads *per* five cents

Vol. I

(106)

N 34 E off the point 413 240

400 Bars

N 56 W 500 Bars

S 34 W 210 Bars to the River

and the port from which

are 7 In to S 77 E 47 L

at the 10 In to S 1° E 50 L

Thence N 34 E at 1848 Bars

to the port from which are

6 In to S 68 W 21 L

at the 10 In to S 77 E 47 L

S 55 E at 1000 Bars

to the port from which are

8 In to S 15 W 21 L

at the 10 In to S 89 E 58 L

Land 2nd Quality Timber in

the above Run 15

318 Bars offset from
the River Thence N 50 W

500 Bars

offset to the North 17 Bars and
set post from which an Elm

3 in 6 N 85 E 14 L

a Hackberry 8 in 6 N 35 W 21 L

Thence N 34 E 1919 Bars between

labor N 2 1/2 S set post from

which a Hackberry 12 in 6

N 73 E 38 L

an Oak 14 in 6 S 14 E 44 L

Thence S 56 E 1800 Bars

between Range line and

set post from which an Oak

18 in 6 S 59 W 26 L

a do 15 in 6 N 5 W 22 L

land west 1/4 first rate East Part
Date since Oak Hackberry

N 34 E 300 Bars off to from the
River Thence N 56 W 270 Bars
to the River S N 34 E 400 Bars
Thence N 56 W 230 Bars
Thence S 34 W 20 Bars to Node

and to port from which an
Orem 10 m 6 N 40 E 22 L
a Hartsburg 12 m 6 N 2 E 45 L

Thence N 32 E between above
3 1/2 1820 Bars and to port from
which no bearing trees in sight
Thence S 56 E 500 Bars in level
Nancy line and to port from
which an Oak 7 m 6 S 30 W 10 L
a m 5 m 6 S 61 W 21 L

Land West 2nd Gate East the first
gate Cane land Timber Oak Ash
Hartsburg Coffeywood & undergrowth
Cane Timber Pines &c

N 34 E 250 Bars off W from
the No. 1 — — —

Traverse N 56 W 500 Bars to the
River No. 1 and set post from
whence an Elm 6 in 6 N 62 E 282

a Coffey tree 10 in 6 N 15 W 48 L

Traverse N 34 E between Labor

N 48 E 1938 Bars and set
post from whence a Hackberry
tree 6 1/2 in 6 N 48 E 20 L

a cu 13 in 6 N 78 E 20 L

Traverse S 56 E 500 Bars detached

Range line and set post from

whence a Hackberry 6 in 6 N 30 W 36 L

a cu 12 in 6 N 55 W 30 L Land

West 1/2 2nd rate Remainder to 1st

rate Timber Oak Hackberry Elm

Peanut undergrowth Sage green
beans Muds vines etc

100 N. 100

Siemens 1/26 1/5 1/5 1/5

Siemens 1/34 1/80 1/80

Siemens 1/34 1/80 1/80

Siemens 1/34 1/80 1/80

Siemens 1/34 1/80 1/80

Siemens 1/34 1/80 1/80
Peter Labor 1/5 1/5

Siemens 1/34 1/80 1/80

Siemens 1/34 1/80 1/80

Siemens 1/34 1/80 1/80

Siemens 1/34 1/80 1/80

456 500 Bars
since 1347 ~~...~~ 30 Bars
not from which a ~~...~~
10 in 6 N 51 E. 17 L
an Elm 12 in 6 N 5 M 10 L
1346 ~~...~~ labor 13 6 R

~~7 at Thence 1346~~ 1993 10

and set post from which
in Elm 14 in 6 S 69 N 25 L
in 20 in 6 S 15 E 43 L
Thence 55 E 20 Bars to a hole
Inaccessible

700

409

N 56 W 500 Bars N 34 E 40

Bars to the first bank public

Node 20. Set post from which

can see 8 Bars N 19 W 29 Bars

in Ark 10 Bars N 52 E 30 Bars

Thence N 34 E 1909 set post

from which are ⁵⁰⁰ coffee bars

220 E 15 - - Links

are 1300 elder 4 Buckles Baring

N 2 E 19 Links

Thence south 50 E

430 Bars and came to

bank inaccessible offset thence

230 E 70 Bars offset 50 E

30 Bars

220
opposite from the first bank
100 bars thence N 56 W 500
bars set post and run back to
the first bank 250 bars
publick road no bars set
post from which an oak 10 sack
having N 44 E 57 Links
a Box elder & In 27 Links
Having N 76 W 37 Links
thence N 34 E 695 Bars and
Came to the river ~~thence~~
opposite from the river S 56 E
300 bars thence N 34 E 500
bars thence N 56 W 300
thence N 34 E 918 bars set post
from which a hackberry & 30
having S 39 E 21 Links

thence 56 £ 5 00 Bar set post
from which a buckberry ^{to the} basin & 50
links

fraction of Land now into
 Labors N 8 N of Rock on the East
 Side of the River off at from
 the River N 34 E 100 Bars

Thence N 56 W 280
 15 m 418
 33 E 403
 82 m 164
 In 72 m 52 1/2
 44 m 99
 61 m 50
 31 m 50
 70 m 218
 N 74 m 29 1/2

Yiqua
Lunacy.

C
Index

situated on the See $\Delta 17$ 134
 League Δ ~~4~~ Δ of League Beginning at
 Point W. corner of a League of Land
 situated on the ~~SE~~ Δ of a League of
 Land granted to James Stewart and
 N. W. of two quarter Leagues of Land
 granted to Whitehead and Hawkins
 thence $\Delta 45$ W at 1860 bars a Creek
 runs S W. at 2722 bars set a post for
 the A & E Co. from which a Post Oak
 15 India, br. S 30 W. 10 bars, a do 12
 do, br. N 51 W. 3 bars. thence S 45 W. at
 880 bars a Creek runs S E. at 5070 bars
 intersected the A & E boundary line
 of a League of Land surveyed for
 J. J. Luster. thence set a post for the A & E
 Co. from which a Post Oak 20 bars, a
 do 4 bars and an oak 8 bars

See Blk 5. p. 115. Eliza Peak No. 13

725

dia to N 79 W. 9 bars. Thence S 35 E
 with the line of Lusters ^{1450 bars with the East} 1900 bars to
 his corner a post from which a
 Post Oak 14 In dia to N 15 E 6 bars
 and a gum Lastic 10 In dia to S 30 W
 3 bars. Thence S 55 W. with Lusters
 line 1070 bars to corner at W. Co.
 Thence S 85 E with his North bound-
 ary line 3654 bars to his NE cor-
 Thence S 5 E with his East boundary
 line 470 bars to B. Banks & W.
 Co. Thence N 45 E with his NW
 boundary line 4452 bars to his
 NE cor. Thence N 45 W. with the SW
 boundary line of Sd League adjoining
 Hewitt Whitehead and A. A. Peck's
 2028 bars to the place of
 beginning Mrs. Peck's W

James Lastley
Burling
129
p. 129
Vol 10
Dec 12

1220
situated ¹²²⁰ ~~near~~ ^{near} B. north of Yguazou Paraguay
at the ^{1st} corner from which a Post-Cape 15 India
from which a Post-Cape 15 India
at 341st 10 bars a do. 12 India dia
151st 3 bars Thence at 45th at
838 bars set a post for the ^{1st} ~~1st~~ ^{1st} ~~1st~~
which a Post-Cape 15 India
at 137th 4 bars a do 10 India dia
113th 4 bars Thence at 45th at
6663 bars intersected the Sth bound
any line of Laguna ^{1st} ~~1st~~ ^{1st} ~~1st~~
bars Creek 418 bars SE of the ^{1st} ~~1st~~ ^{1st} ~~1st~~
near where set a post for the
1st corner from which a Post-
Cape 15 India W. at 128th 9 bars
a do 12 India dia W. 105th 11 bars
Thence at 45th with the Sth

H27

boundary line of No 2 - 3,580 1/2
 bars to the ~~East~~ ^{West} of League No 15 or 16
 of Land adjoining Quinto White
head & Sautkins Thence 140 W
 with the ~~SE~~ ^W boundary line
 of said League 6663 bars to
 the ^{South} ~~SE~~ ^W ~~Co.~~ Thence at 45 W with
 the ~~SE~~ ^W boundary line of League
 A 2722 bars to the place of
 beginning -

Vide. office -

Note I find in running the
~~SE~~ ^W boundary line of
 this League that my measure
 is 283 bars shorter than
 Brown's Calculations I therefore
 the Error is in his

vide issue 478

Title in vol 021 12/35. vol 10 p 125
Durlson Co

League No. North of Yigun Begun
 on the N.W. boundary line of
 League No. 328 bars from the N.W.
 at a post from which a Post
 Oak 2 In dia. to 112 E.S. bars
 do 12 In dia. to 132 W.S. bars
 then at 45 W. at 310 1/2 bars Intersect
 the N.E. boundary line of
 League No. 12 West of Davidson's
 Creek then at a post from which
 a Post Oak 10 In dia. to 82 1/2 W. 30
 do 8 In dia. to 47 W. 5 W. Thence
 N 45 E with S^d line 1814 bars to
 the N.E. cor^r ^{of said league No 12} Thence N 45 W. with
 the N.E. boundary line of S^d League
 888 W. to the S^d boundary line
 Corner of League No 5 Thence

429

MS

145 E with the SE boundary
 line of ¹⁰⁵ League 45282
 to the ~~SE~~ ^{of the same on SW bound of 103} cor. thence S 45 E
 with the SW boundary line
 of ¹⁰⁷ League No 3 ~~of~~ ^{on} ~~of~~ ^{of} Harri-
 son Creek and No 2 - 39952
 to the N ¹⁰⁸ cor. of League B -
 thence S 45 W with ^{the SW boundary line} ~~of~~
 6342 bars to the place
 of beginning

Vide ~~op~~ 

I differ with Brown 68 bars
 in the SW boundary line of C.
 and the same in the SE
 boundary line line as in
 B -

Laguna D. North of Yaguas Begin
 ing at the ^W cor of A. at a post
 from which a Post Oak 20 India
 ls. 4 in and an oak 8 India
 ls. N 79 W 9 ls. Thence at 35 W with
J. J. Luster's NE boundary line 2000
bars to his SE corner which is
 a Post from which a Post Oak
 15 India ls. at 27 E 10 in a do
 12 India ls. S 89 W 7 bars. Thence
 S 55 W with Luster's NE bound
 ary line at 410 bars set a post
 from which

Thence at 45 W at 4830 bars set
 a post intersected the SE bounda
 ry line of Laguna N^o 11 West

421

of Davidsons Creek. Where set
a post for the S^W Corner from
Which a Post Oak

Thence S 45 E with Sa line
1409 bars to the ^{only S.W. cor of 12} S^E Cor. Thence
S 45 E with the S^W. boundary
line of League No 12, 2896 bars
to the S^W cor. Thence S 45 E
with the S^E boundary line
of Saide League 5058 bars
to the corner of ^W B. on Sa line
Thence S 45 E with the S^W
boundary line of Co. 3107 bars
to the S^W cor. Thence S 45 W
with the S^W. boundary line
of B. 321 bars to the ^{then} S^W cor.

1432 ~~477~~
Thence S 45 E with the S W corner
in day line of said League
858 bars to the N S corner
of A. Thence S 45 W with
the N W boundary line of said
League 5770 bars to the place
of Beginning

Vide opposite

Title made to Blythe
12 Oct 1835

Am Woodbridge # 433
Burlington Co
July 29/36. Vol 11 p 67
D. & W. Wood

League C. North of Yagua
beginning at the NW Co. of No 11
thence N 45 W with the SW. to
boundary line of Sa League at
2438 bars set a post on Sa line
for the SE corner from which
a Post Oak 16 In dia br. N 5 W
do a do 18 In dia br. S 15 E
6 bars Thence S 45 W. at 1182
bars a Cuck runs SE at 2284
bars set a post for the NW
Cor. from which a Black Jack
10 In dia br. S 10 E 7 bars a do
2 In dia br. S 75 E 10 bars Thence
S 45 E at 6500 bars Intersected
~~the line of the Sa League~~

NW boundary
A. R. Sturges League
line whar. set a post for

434
The ~~NW~~ ^{SW} Corner from which
is post Oak 18 2/3 dia to N 63 1/2
9/16 a do 20 1/2 dia to N 24 E
22 1/2 Thence N 55 E with
sa line of staves & Suster
4450 bars to the corner of sa
on sa line Thence N 45 W with
the N W boundary line of sa
line 4830 bars to the N W cor
On the SE boundary line of
a 1/2 1/2. Thence S 45 W with
sa line 2091 bars to the place
of Beginning

Rec'd to Am J Woodbridge

~~435~~

△ 45

League N. North of Lyaguan Be
 ginning at the N.W. corner of E.
 at a post from which a Post Oak
 10 In dia. W. S 87 bar a do 12
 In dia. ~~W~~ S 71 E 10 bar Thence
 S 45 W at 3029 bars det a post for
 the S.W. Co. from which a Live
 Oak 12 In dia. W. S 37 E 11 bar
 and a Post Oak 24 In dia.
 W. S 37 W. 19 bar Thence at 45 bar
 at 4705 bars det a post for the
 S.W. Co. from which a P. Oak
 15 In dia. W. S 11 E 11 bar a do
 10 In dia. W. S 35 E 11 bar Thence
 at 45 E at 5313 bars Intersected
 the S.W. Co. of League
 No. 11 - Thence S 45 E with

430 ~~2~~

The S^W. boundary line of
St. Louis 4705 bars to the
N^E Co. of C. on S^W line thence
S 45^W with the N^W. boundary
line of said Louis 2284 to
to the place of Beginning

~~#27~~ 437

Lagun G. North of Laguna
Beginning on the N.W. boundary
line of F. 9th bars from the
N.E. cor at a post from which
a Black Jack 16 In dia br.
at 10 E 3 br and a do 12 In dia
br S 28 E 8 br thence at 45 W
at 6289 bars Intersected the S.E.
boundary line of Laguna No 15
on the San Antonio Road
where set a post from which
a Black Jack 8 In dia br.
S 28 E 3 bars and a Post Oak
10 In dia br. at 71 W 9 bars
thence at 45 E with S.E. line 1064
bars to the S.E. Corner thence
at 45 W with the N.E. boundary

line of S. League 847 bars to the
 S.W. corner of League No 14. Thence
 N45 E with the S.E. boundary
 line of S. League 2566 bars
 to the N.W. cor. of League No 10
 West of Davidsons Creek. Thence
 S45 E with the S.W. boundary
 line of said League 7136 bars
 to the S.W. cor. on the N.W. bound
 ary line of No 11. Thence S45 W
 with the N.W. boundary line of
 said League 2726 bars to the
 N.W. cor. Thence with the N.W. boundary
 line of No 9 910 bars to the place of
 beginning

I find that Brown has noted the S.W.
 boundary line of League No 10; 6681 bars
 and it should be 7136 bars

429

Traverse No. North of Yiguas -

Beginning at the N.W. cor. of S.
at a post from which a Post Oak

15 In dia ^{from north of} N 61 E 11 bars a do 10 In
dia br. of 35 E 11 bars. Thence

S 45 W at 276 bars set a post
for the S.W. corner from which

a Post Oak 11 In dia br. N 13 W
10 bars a do 11 In dia br.

S 58 E 4 bars. Thence N 45 W
at 446.3 bars intersected the

SE boundary line of S. Fisher
and 4 League Survey. Where

set a post Oak 15 In dia br
N 70 W 85 bars a do 18 In dia

br S 14 W 102 bars. Thence N 45 E

with the line of Austin's

24 25 to his SE Cor. Which
 is a part from which a Post
 Oak 14 In dia to S 29 E bars
 a do 8 In dia to S 33 E 7 to
 thence S 45 W with the SE bound
 ary line of Sr Survey of Jus
 tin 1826 bars to the SW cor
 of League No 15 Thence S 45 E
 with the SE boundary line
 of Sr League 2254 bars to the
 Corner of G. Thence S 45 E
 with the SW boundary line of
 Sr League G. 6289 bars to the
 SW cor. Thence S 65 W with the
 NW boundary line of F 4403
 bars to the place of Beginning
 For Daniel Perry by H. Austin

~~177~~ 441. ± 17 League K on the Yagou
beginning at the S. ~~111~~ cor-
ner of Ist at a Post from
which a Live Oak 12 in Dia
by S 37 E 11 vs. and a Post
Oak 24 in Dia by S 37 W
19 vs. Thence S 45 W at 1045
we set a Post ^{for the NW corner} from which
a Pin Oak 12 in Dia at S 48
8 vs. and a Sth 13 in Dia. by
S 26 E 9 vs. Thence S 45 E
at 5665 vs. intersected the
North ^{cut} boundary line, of a
League of land granted to
Ashley Stevens laying on
Mills creek, where set a
Post from which a Post.

Oak 12 in Dia. by a $\text{N}^{\circ} 9^{\circ} \text{W}$ 18 1/2
 and a $\text{I}^{\circ} 11$ in Dia by a $\text{N}^{\circ} 6^{\circ} \text{W}$
 16 1/2. Thence $\text{N} 55^{\circ} \text{E}$ with the N°
 W . boundary line of $\text{S}^{\circ} 4^{\circ}$ league
~~4133 vs. where set a post for~~
~~the $\text{S}^{\circ} \text{E}$. corner 4133 vs. to the~~
 $\text{S}^{\circ} \text{W}$ corner of league E°
 Thence $\text{N} 45^{\circ} \text{W}$. with $\text{S}^{\circ} \text{W}$.
 boundary of $\text{S}^{\circ} 4^{\circ}$ league
 6500 vs to the N° corner
 Thence $\text{S} 45^{\circ} \text{W}$. with the $\text{S}^{\circ} \text{E}$.
 boundary of league E°
 9029 vs to the place of begin-
 ing-

3029
 1044
 4074

† 17

483

~~XX~~

△ 46

League I ~~to~~ the Yagua
 Beginning ~~at~~ the S.W. cor-
 ner of ~~League~~ II at a Post
 from ~~which~~ a Post Oak 11 in
 at 13 W. 10 vrs. and a Pin 11 in
 Dia bs. 935 E. 4 vrs. Thence
 945 W. at 3250 vrs entered
 bottom at 3700 vrs. crossed
 3rd Creek at 5037 vrs. set a
 Post for the S.W. corner. from
 which a Pin Oak 12 in Dia
 bs. at 10 E 4 vrs. and an Elm
 13 in Dia bs. 940 W 8 vrs.
 Thence 945 E. at 300 vrs
 crossed 4th creek. at 1401 vrs
 entered bottom Prairie. at
 2441 vrs left Prairie. at

4705 vrs. intersected the S°W . bound-
 ary line of League I. where
 set a Post for the S°W . corner
 from which a Pin Oak 11 in Dia
 $\text{S}^{\circ}36\text{E}$ 7 vrs. and a Peach 8 in
 Dia $\text{S}^{\circ}88\text{E}$ 2 vrs. Thence S°
 45E . with the S°W . boundary
 line of League I 4268 vrs. to
 the S°E . corner of I. Thence
 the same course 1045 vrs. to
 the S°W . corner of I.² Thence
 $\text{S}^{\circ}45\text{W}$. with the S°W . bounda-
 ry of S°E . League 4705 vrs. to
 the S°W . corner. Thence $\text{S}^{\circ}45$
 W . with S°E . boundary of H.
 276 vrs. to the place of be-
 ginning

445
~~442~~

△ 47

League L South of Yagua
Beginning at the S.W. corner of
League K at a Post from which
a Pin Oak 11 in Dia to S 70
8 vrs. and a ~~Pin Oak~~ 13 in Dia to
S 26 to 9 vrs. Thence S 45 W. at
4774 vrs. set a Post for the S.
W. corner from which a Post
Oak 11 in Dia S 68 E. 13 vrs.
and a ~~Pin Oak~~ 13 in Dia to S 34 E
7 vrs. Thence S 45 E. at 2850 vrs
entered creek bottom at 3510
vrs. left bottom, at ~~4774~~⁴⁵¹⁰ vrs.
intersected the S.W. bound-
ary of a League granted to
~~Neal~~
~~_____~~ whose set a Post
for the S.W. corner from

1446 ~~*29~~ ~~29~~

which a Post Oak 11 in dia 65
S 20 W. 14 vrs. and a D. 13 in dia
65. S 61 W 7 vrs. Thence S 35°
E. with the S W boundary
of S^d League. 3007 vrs. to the
S.E. thence same course 1828 m
to the S W corner of K. Thence
S 45 W with the S W bound-
ary of K. 5565 vrs. to the place
of beginning

~~1447~~

League M. of Yagua
 Beginning at the N.W. corner
 of Ia. at a Post from which
 a Post Oak 11 in dia. bs. 968 &
 13 vs. and a 9. 13 in Dia. bs.
 937 & 7 vs. Thence S 45 W
 at 5950 vs. set a Post for the
 N.W. corner from which a
 Post Oak 16 in Dia. bs. 955
 C. 5 vs. and a 9. 24 in Dia. bs.
 C. 64 W 10 vs. Thence S 45
 C. at 1700 vs. entered creek
 bottom at 2700 vs. left bot-
 tom. at 3660 vs. set a Post
 intersected the N.W. bound-
 ary line of a League
 granted to Franks.

Post oak

Same as in book 5. p. 132.

488 ~~488~~

where set a Post for the
SW corner from which a
Post Oak 12 in Dia ts. at
24 E. 12 vrs. and a Do. 12 in
Dia at 62 W. 14 vrs. Thence at
55 E. with the NW boundary
line of ^{of} Franks and Campbell's
League's 6060 vrs. to the SW corner
of Is. Thence at 45 W with the
SW boundary line of Is. 4810
vrs to the place of begin-
ing.

For Anderson Estis
Surveying fees to be paid by
Capt H Austin

~~24~~ 449

same as sk 5 p. 121

League N South of Yague
 Beginning at the SW corner
 of League ^{mine} at a Post
 from which a Pine Oak 12
 in Dia br. N 15 E 4 vrs. and
 an Elm 13 in Dia br. S 40 W
 8 vrs. Thence S 45 W. at 400
 vrs. crossed 4th creek joining
 S E. at 420 vrs. entered bot
 tom Prairie at 1200 vrs. ^{left} Prai
 rie. at 5313 vrs. set a Post
 for the SW corner from
 which a Post Oak 12 in dia
 br 56 E 19 vrs. and a P.
 18 in Dia br. N 12 E 13 vrs
 Thence S 45 E at 4705 vrs
 intersected the SW bound

dary line of League M. where
 set a Post for the S.W. corner
 from which a Post take
 12 in. Dia. by S 81 W 10 vrs. and
 a S. 14 in. Dia. by S 3 W 11 vrs.
 Thence at ⁴⁵~~55~~ E with the e. P.
 W. boundary line of M
 4804 vrs. to the N.E. corner of
 M. Thence same course
 with the e. P. W. boundary of L
 509 vrs to the S.W. corner of
 I. Thence at ⁴⁵ W with the
 S.W. boundary of I 4406 vrs
 to the place of beginning

~~451~~ 451

League O North of Main Ya
gu beginning at the NW
corner of League H at a Post
from which a Post Oak 15 in
bs of ~~11~~ 85 vs and a ~~9~~ 18
in Dia & ~~9~~ 11 W 102 vs, Thence
945 W with the I.C. bounde
ry line of J. J. Hustins 4 Lea
gue Survey at 1600 vs. enter
ed bottom at 2375 vs crossed
3^d creek running I.C. at 3220
vs. left bottom at 5601 vs.
set a Post for the NW cor
ner from which a Black
Jack 6 in Dia bs & 85 E,
9 vs. and a Post Oak 18 in
Dia bs 945 W 40 vs.

Same as book 4 - p 114

Thence S 45 E at 4463 vrs in
 intersected the N^oW boundary
 line of League N where set
 a Post for the S^oW corner,
 from which a Hackberry 10
 in Dia to S 62 E 4 vrs and an Elm
 10 in Dia to S 22 W 3 vrs. Thence
 N 45 E with the N^oW boundary
 line of N 564 vrs to the N^oW
 corner of I Thence same
 course with the N^oW bound-
 ary line of I 5047 vrs to the
 S^oE corner of H Thence S^o
 45 W with the S^oW bounda-
 ry line of H 4463 vrs to the
 place of beginning

483 AN Little made

League P on the main ga-
qua Bying at the ~~the~~ W.
corner of League O at a Post
from which a Black Table
6 in dia by 18 in dia 9 vs.
and a Post Oak 18 in dia
by 47 1/2 40 vs. Thence
S 45 W at with the SE
boundary line of S. J.
Austin's 4 League Survey
at 4054 vs set a Post for
the W corner of S. J. Sur-
vey. from which a Post
Oak 12 in dia by 11 in
4 vs. and a Pⁿ 12 in dia
by 43 1/2 12 vs. Thence
S 45 W with the S. W.

John G. Wallace

See to

File would Oag. B. vol 10 p 17

John G. Wallace

boundary of sd. Survey, at
 1675 vrs set a Post from
 which a Post Oak 15 in
 dia by $\text{N} 47^{\circ} \text{E}$. 13 vrs. and
 a P° . 16 in dia by $\text{S} 62^{\circ} \text{W}$
 27 vrs. Thence $\text{S} 45^{\circ} \text{W}$ with
 the $\text{S} \& \text{E}$. boundary line
 of S° 20. at 1125 vrs. set a
 Post for the $\text{S} \& \text{W}$. corner
 from which a Hickory 13
 in dia by $\text{S} 22^{\circ} \text{W}$. 13 vrs. and a
 Post Oak 18 in dia by $\text{N} 76^{\circ} \text{E}$.
 15 vrs. Thence $\text{S} 45^{\circ} \text{E}$
 at 1840 vrs entered bottom
 at 2660 vrs. crossed Yagua
 running E . at 3240 vrs left
 bottom at 4340 vrs

~~45~~ 45

Entered Prairie at 4940rs
left Prairie at 6138rs
set a Post for the Sth corner
from which a Post 60 13
in Dia by S 11 W 11 rs.
and a 3^o 14 in Dia by
S 72 W 10 rs. Thence S 45
E to the N.W. corner of N
430 rs. Thence same course
with the N.W. boundary
line of N ⁴⁴⁴⁹ ~~54504~~ rs to the
Sth corner of O. Thence
S 45 W with the S.W. bou-
ndary line of O 4463 rs
to the place of beginning

456

2054
11219
5179

430
4740
517

225

