

FIELD NOTES

BOOK S.A.W.

SPANISH ARCHIVES

G.L.O.

SAW

James Bray

Refugio

Victor Loupy

Refugio

~~Samuel~~ Samuel A. White

Refugio

S. A. W.

Sundry Field Notes

Powers Colony

S. A. W.

- 3. Field notes of surveys south of Chittico in the
for McCulley (2) Pollan & Fittsman
- " " of 4 Leagues for Power and
Huntson, Situal of Peninsula of
Line - Oak Point.
- 5. Sketch of surveys on Saus and Chocolate creeks
for Adetto and others.
- 7. Field notes of surveys on the Tappa
lot Ch. for B. Dale - R. Carlisle &
Quin (2).
- 9. " " of surveys on West bank of Santa
River for Jas. Ino & Wick Fugan
- 11. " " " " " " " " " " " " " " " "
- 13. " " of a League for J. Hayes on South
bank of San. Ant. R.
- 14. " " " " for Collier do. do.
- 15. Sketch of surveys on the South bk of
San. Ant. R.
- 17. " " " " " " " " " " " " " " "
- 17. " " " " " " " " " " " " " " "
- 21. Field notes of a League for Peter Hayes on
South bk. San. Ant. R.
- 23. " " " " " " E. Perry do do
- 25. Field " of Leagues No 1-2 for Davis
on S. bank of S. Ant. R.
- 26. " " " " " No. 2-3-4-5-1/2
for Davis on S. bank S. Ant. R.

Descripcion del plano

el punto C. esta demarcado con un estaca Mosquite Gordo q^o esta en el medio de la laguna de la Cruz de^o merquite tiene 4^o canas principales cada cana puntuado por cada sitio.
 el punto D demarcado con un porcion de canas socias puestas en forma de casa de indio y un merquite poco sobre la misma linea por el Oeste a 330^o el punto E esta demarcado con unas canas puestas en forma de casa de indios y esta al Este de una laguna ^{que como de N. a Sur} a 20^o de distancia al N^o 55^o V un merquite al Sur 30^o al Este otro merquite a 200^o el punto F. esta demarcado con dos estacas puestas sobre cada uno de los tres linderos a 40^o de distancia Sur 10^o Este a 25^o V un merquite N^o 18^o Este a 35^o V otro al N^o 40^o Este a 20^o otro y al N^o 76^o Este a 30^o otro el punto G. no tiene otra demarcacion q^o una estaca en medio de una mata de chaparral. el punto H unas canas puestas como las sus dichas puntos al Sur a 14^o V un merquite al O^o 14^o una mata de chaparral al N^o 4^o Este a 30^o V un merquite el punto A con unas canas como D^o al O^o 12^o N^o a 40^o V un merquite O^o 8^o N^o a 25^o V otro al Sur 35^o al Este 40^o V otro el punto B esta en un llano no se puede hacer otra demarcacion q^o una estaca.

Geo Lopez

Moalcolm Mc Nully Vol 17 p 117
 John F. Daniels " " p 118
 Patrick Fitzsimmons " p 41



por la misma obra la q^o al plano es el mismo

2

Thence N 13° E 3240 varas - Thence N 108° 3030 varas Thence
 N 5° W 320 varas Thence N 32° W 350 varas Thence N 58° W
 to the Beginning 440 varas the whole containing
 27,390,750 square varas from which is deducted
 2,590,750 varas on the account of an arm of the Bay
 as represented at 7th Station on the map

League 2nd Began on the South west corner
 of the above League and ran S 52° W - 1800 varas -
 thence 26° W - 1600 varas - Thence S 39° 45' W 2400 varas on the cor-
 ner a stake on a mound - on the margin of the Bay
 Thence N 13° E - 5435 varas the corner a stake - Thence
 N 33° E - 5350 varas the corner on the North East
 line of the first line a stake - Thence S 67° W
 4130 varas to the Beginning containing 25,000,000
 square varas -

League 3rd began on the North East
 corner of the first League thence ran S 67° W
 4130 varas to the corner North east of the 2nd
 thence with the East line of that League S 33° W
 5350 varas to the South East corner of the above

2nd League thence S 13° E - 5435 varas to
 the corner on the Bay a stake on a mound Thence
 with the meanders of the Bay to the Beginning
 containing 25,000,000 square varas

League 4th Began on the Southwest
 corner of League 2nd Thence S 80° West
 2320 varas - a Stake Thence S 76° E - 10870 varas
 to the corner on the East side of the peninsula
 a Stake standing North of a pit Thence
 with the meanders of the Bay 2360 varas on
 an average bearing of N 20° W - containing
 25,000,000 square varas -

Done Sept 12th 1834

Joseph Bartlett chain }
 James Munroe } corners } Saml. G. White

442
 444
 1772
 1777
 1777

4

Survey for Powers and Heavens
of four leagues of Land

Survey of Heavens
the 17th of 1822

Five Oaks
Five Springs



Began on Five oak point on a line out of 36 inch diameter standing on the point of the peninsula immediately over the spring - Thence bearing S 91° W 910 m - Thence S 53° W 1110 m - Thence S 55° W 850 m - Thence S 118° 1500 m - Thence S 63° W 500 m - Thence S 67° W 2450 m - Thence S 63° W 4000 m - the corner a stake on a mound - on the bank of the bay - Thence N 15° E 8260 m distance the corner of the bay a stake on a mound. Bearing from oak & diameter S 22° 30' E from oak 6 inch beam & 12

No. 2

No. 3

2307
2320

5766. 5435
XV 1178

10890

75

5435

Mayor No 4

Map and Survey of Mrs. Govians Lands
 on the Chocolato & Soles containing two Leagues
 Nov. 28th 1834.

James Bray



Laid down by a Scale
 of 1900 Varas to an Inch

M. Lopez

See vol 7 p 90

10817 p. 110

Benjamin Doel. Vol. 17 p 108
 Roberto Carlisle Vol 17 p 116
 Bridget Quin " 17 p 75
 Mrs. J. Doel " 17 p 35

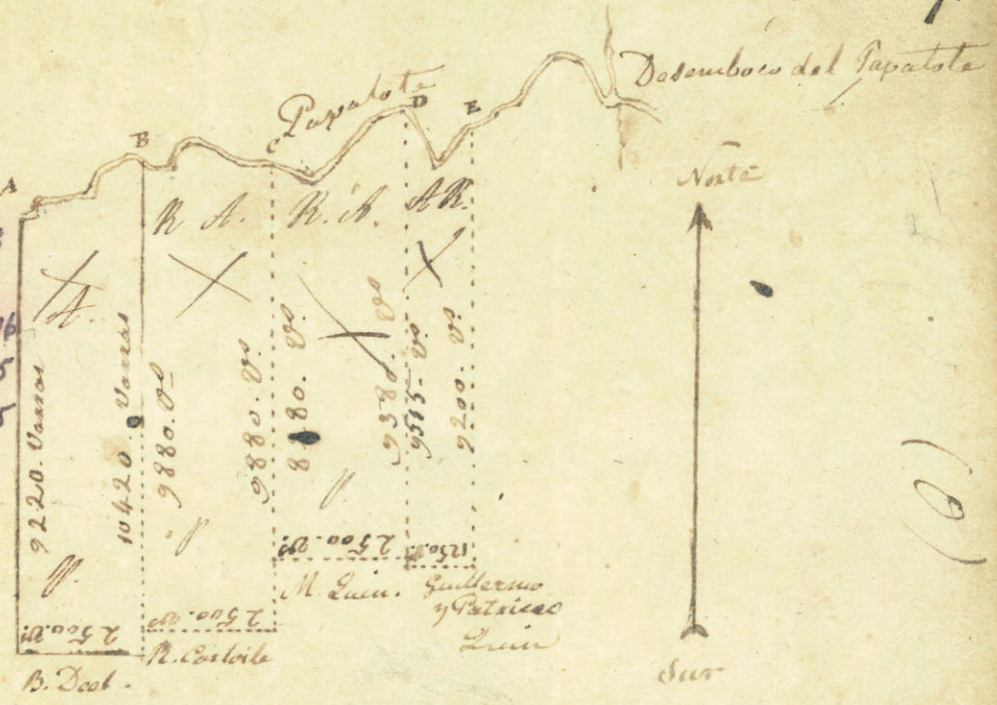

Explicacion del Plano

El punto A esta marcado con un ensino gordo de 3 pies de diametro otro al Sur a 140.º de 8 y pulgadas de diam.º y otro al Nte 75.º al Este de 14 y pulgadas de diam.º casinos son ensinos prietos y tienen p.º señal 3 picquetos de hacha

El punto B es punto de division entre Benjamin Doel y Roberto Carlisle este en el fondo de un Barranco a lonlla del arroyo tiene por marca un palo blanco de un pie de diametro y al Este a 25.º un mesquite de 2.º de diam.º y un anaque de un pie de diametro q.º queda al Sur 36.º a Oeste a 12.º de distancia de los palos marcados con 3 picquetos de hacha

El punto C es punto de division entre D.ª B.ª Quin y Roberto Carlisle este marcado con un ensino prieto de un pie de diametro y a 50.º del arroyo otro ensino de 20 y pulgadas de diam.º al Sur 25.º distante de 60.º y otro del mismo diametro al Sur 17.º Oeste a 65.º de distancia de los tres picquetos

El punto D. esta marcado con ensino prieto de 6.º de diametro y este al orilla de arroyo y otro ensino de 3.º de diametro al Norte 80.º al Este a 25.º de distancia y otro de 3.º de diametro al Sur 25.º corras todos estos ensinos estan demarcados con 3 picquetos de hacha. Este punto es punto de division entre D.ª B.ª Quin y sus dos hijos

8 El punto E está marcado con un palo blanco situado a lo largo
del arroyo y al Sur 67º 9ta un círculo prieto de un pie de
diámetro a 30 V. otro círculo del mismo diámetro al Sur 44º
al Oeste distante de 24 V. todos marcados como el
y es punto de división entre los dos hermanos Juan
y tierra Terma -

en el Papalote a 1º de Noviembre 1834

J. P. Lopez

Nota todos los puntos del fondo de estas tierras están marcados
con dos estacas en cada lindero por estar en llano y no podrían
demarkarse de otro modo. Valez

See p. 17. p. 45

15180

14820

14955

15045

14930

15070



Survey for James Fagan began on the South side of the St. Antonio River on a stake bearing from a Boxelder 4 inches in diameter $N 72^{\circ} 45' W$ 2 varas distance from a cottonwood 4 feet diameter $N 64^{\circ} 40' W$ dis 4 varas thence South $3^{\circ} W$ 14930 varas dis - a stake thence $N 85^{\circ} W$ 416 1/2 varas dis a stake - thence $N 50^{\circ} E$ 15070 - the corner on the river a stake bearing from a sycamore 2 1/2 inch diameter $N 55^{\circ} W$ dis 13 varas - thence with the river to the beginning

Quarter of a League for John Fagan

Began on the Northwest corner of James Fagan thence $S 5^{\circ} W$ 14955 varas a stake thence $N 85^{\circ} W$ 416 1/2 a stake thence $N 5^{\circ} E$ 15045 varas the corner on the river a stake bearing from a Gomo 4 inch diameter $N 78^{\circ} E$ dis 2 varas - an Elm tree $S 18^{\circ} 30' E$ - dis 2 varas - thence with the meanders of the River to the beginning - containing 6,250,000 square varas

One League for Nicholas Fagan

Began on the Northwest corner - as described above - thence $S 5^{\circ} W$ 14820 varas to a stake - thence $N 85^{\circ} W$ 1666 2/3 varas to a stake - thence $N 5^{\circ} E$ 15180 varas to the corner on the river a stake bearing from an Elm 6 inch diameter $S 63^{\circ} 30' E$ - dis 4 varas - from an Elm 6 inch diameter $N 8^{\circ} W$ - dis 6 varas - thence East with the meanders of the River to the beginning containing 5,000,000 square varas

Done Sept 19th 1834

Joseph Bartlett } chain
James Runnels } carriers

Saml A White

Mr. Bowen dr 50

I am a citizen of Guat.
 And wish to obtain Land in your colony I have a
 family A Mexican wife and three children
 I have made arrangements with Mr White to select
 and pay the expences on my Land and to have my
 title made if he can do it without my presents
 Be so good as to Let me know by telling him
 Yours Respectfully

John W Hunter

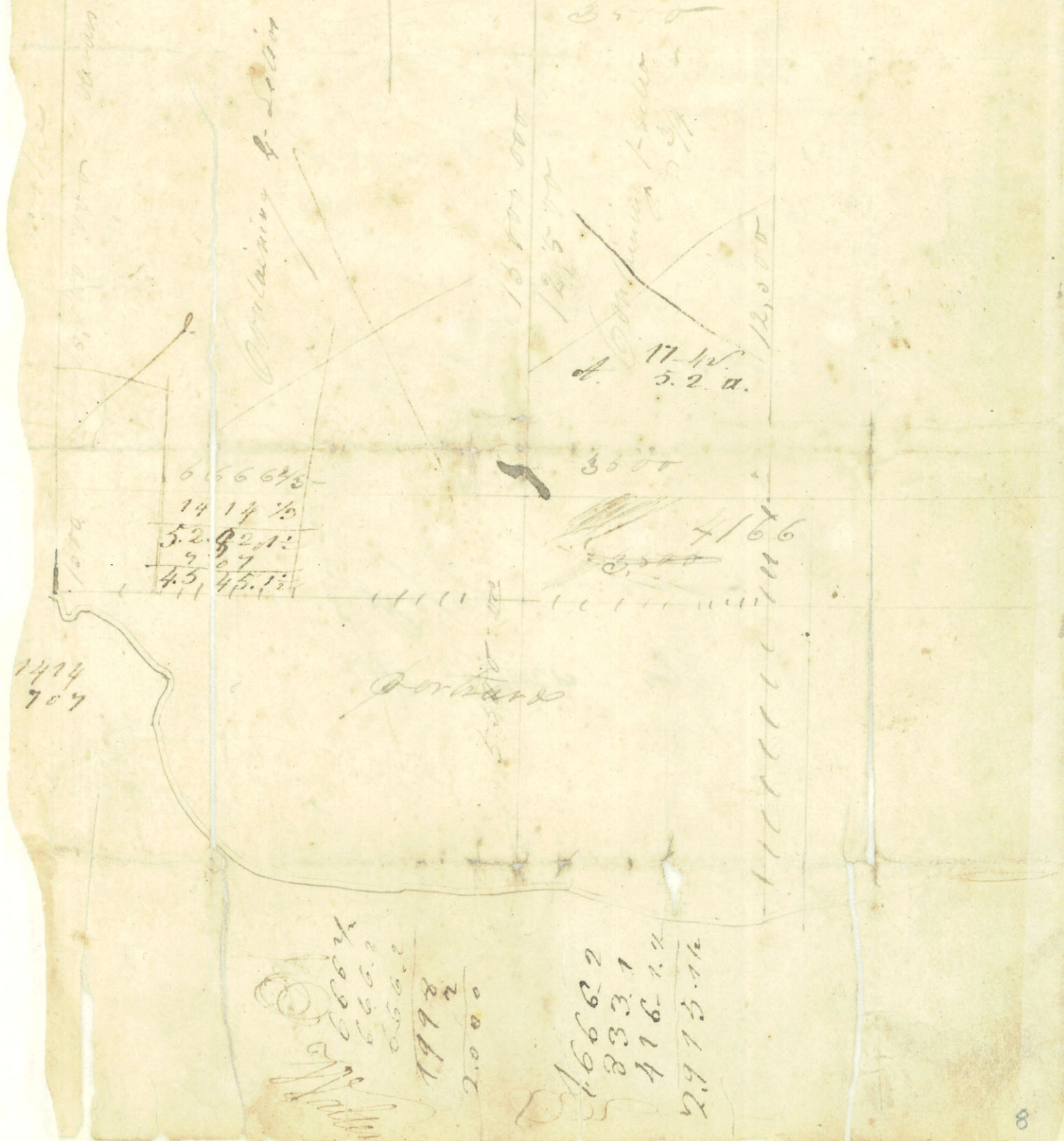

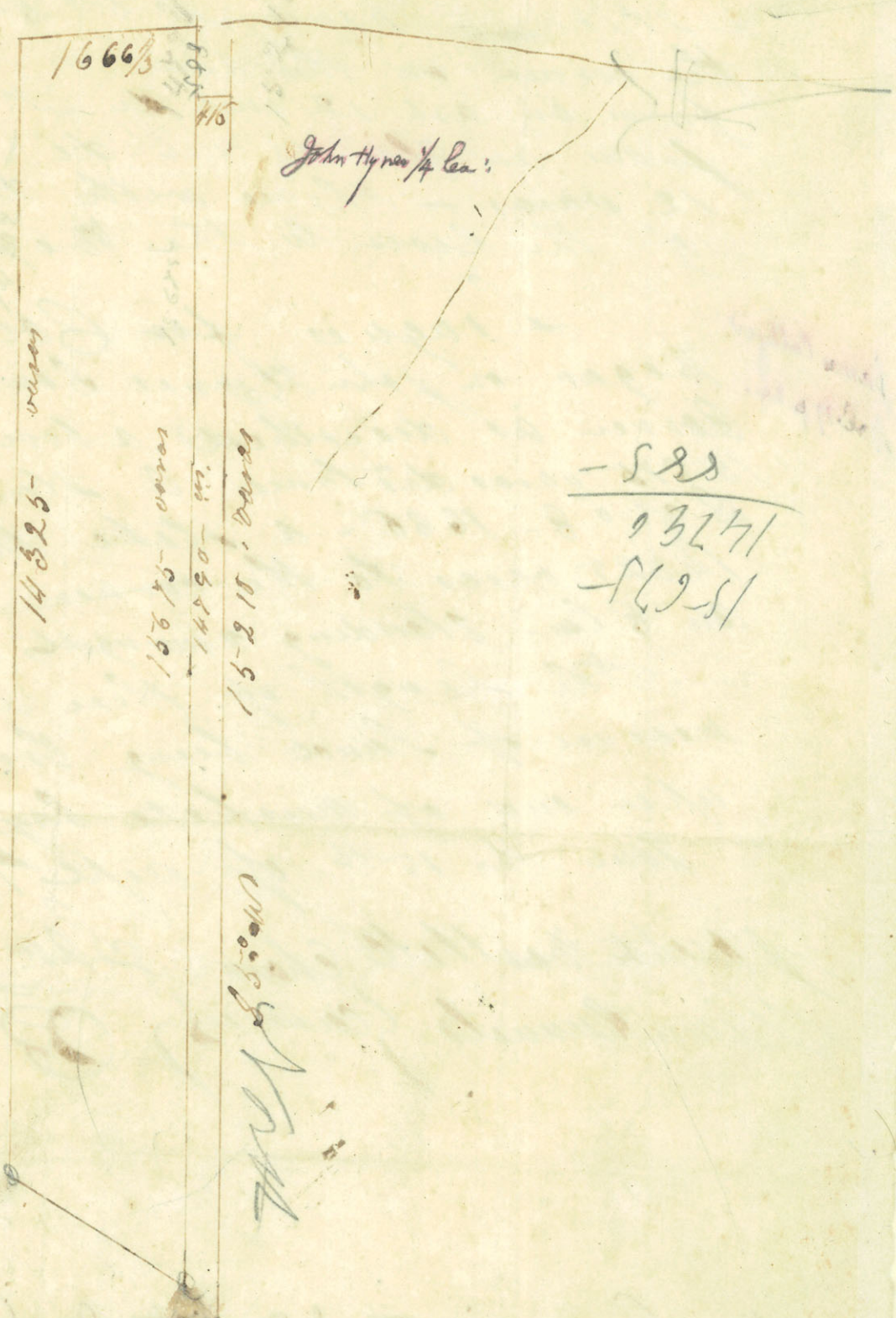

vol 17 p 15

A quarter of a League of Land
 Surveyed for John Hynes on the South
 Side of the St. Antonio River Beginning
 on the South East corner of Peter
 Hynes League - being a stake bearing
 from a wild cherry 8 inch diameter S 44° E
 from a hickberry 6 inch diameter N 36° W

14. Thence South 50 W - 15210 varas distance
 the corner a stake - Thence S 85° E 4164
 a stake - Thence N 5° E - 14790
 the corner on the river a pear tree
 from an ash 12 varas di' N 4° E - di' 1
 from an Elm 15 varas di' S 77 E -
 12 varas - Thence with the meander
 of the river to the beginning

James Callow
 Vol 17 p 24.

Leagues for Collier
 Began on John Heynes South East
 Corner as described above thence S 5°
 15675 varas distance a stake - Thence
 S 85° E - 16350 - a stake thence N 5° E
 14325 varas to the corner on the
 an Elm standing amongst some brush
 The length of these lines as the
 measure of land being broken by the
 upper end of muskete Bay -
 Done the 14th of Sept 1634

Walter Battell Chain } Samuel White
 James Russell } Carvers } 

At - Scor y oriente, de sitio de C. Pedro Negro
 (mi padre) 15875 v - 16642 v -

James Mc Lane Vol 17 p. 167
 Samuel Mc Camby " " " 166
 Dolores Cox by Jace " " " 172
 Ines Beene " " " 134 - in title, upper line 18310.
 Spanish Castron " " " 125

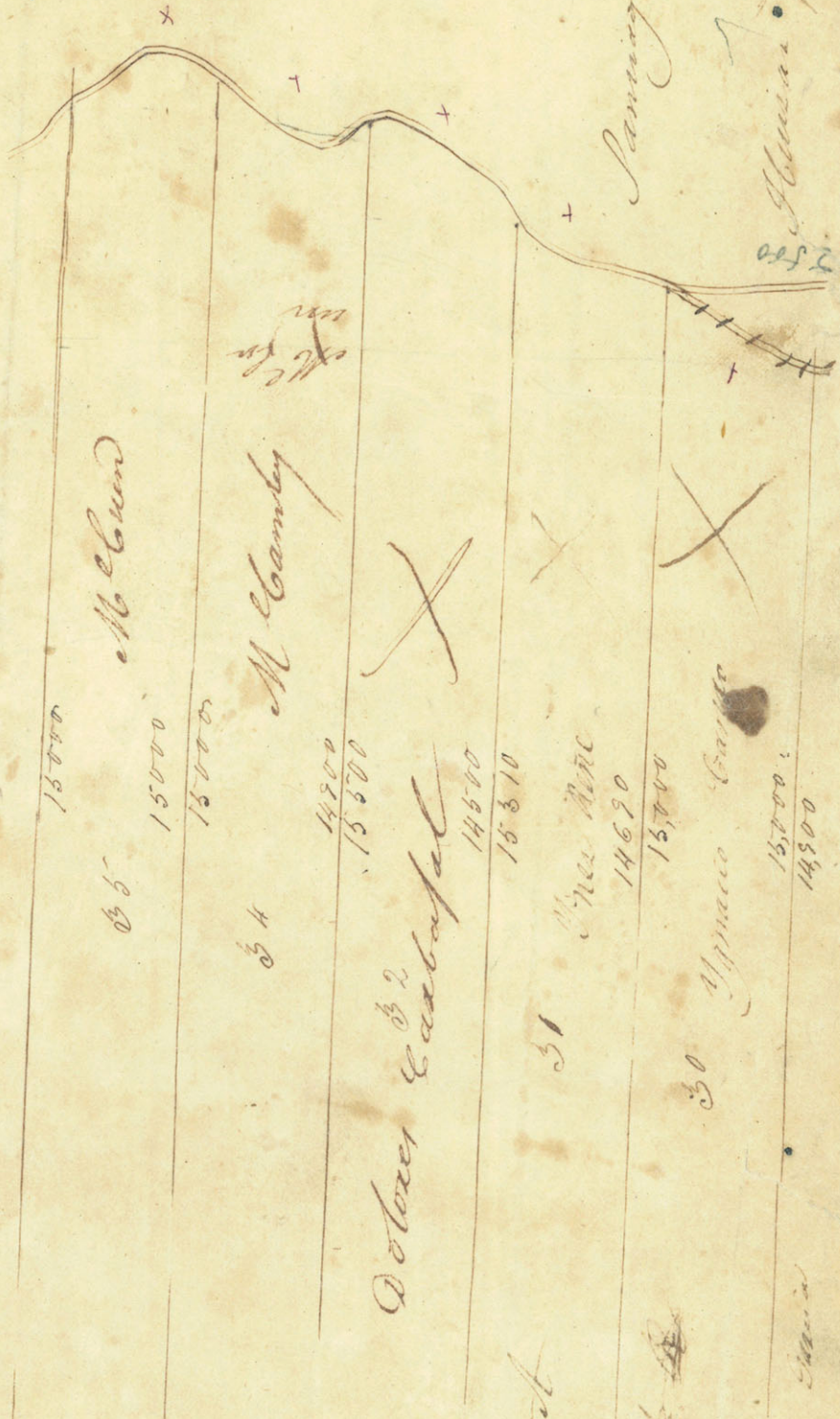

Mc Lane of tres A. J. of Luciano W. Gates
 of Mc Camby.

No 20

15810

Sean Flood

14190

No 20

Power of Attorney
vol 17 p 68

14895

Aratia Serna

15105

No 19

14945

Manuela Salinas

16055

No 15

Little Milpit

John Keating
vol 17 p. 67

15630

J. Niza

John Keating
p. 67

14470

in title 14444

No 17

Sanaro

Glorientina Pains
vol 17. p. 59

14440

L. A.

Glorientina Pains
p. 59

15560

16100

No 16

Perry

Edward Perry
vol 17. p. 48

13900

Edward Perry
p. 48

15325

No 15

Sann

John Sann
vol 17 p 63

14675

No 14

Jagan

2 quarters

14490

Miguel Bayle

15510

12th

15110 14890

Mary Byrnes

14890 15110

11th

15100

Cornelius F. Hermann

14900

15345 15100

10th

William Robertson

14655 14900

15605 15345

9th

Ira Westover

14895 14655

15855

in title 14856

La H. El Rancho de Hernandez.

Abshua Davia

16145

13
Clemente Serna 37

17

2nd

3rd

Prests #4 4th
Cura Valde

- Edward Perry vol 17 p 48
- Michael Reyley " " 57
- Mary Byrnes " " 61
- Cornelius Philip Hermann " " 54
- William Robertson " " 60
- Ira Westover " " 53

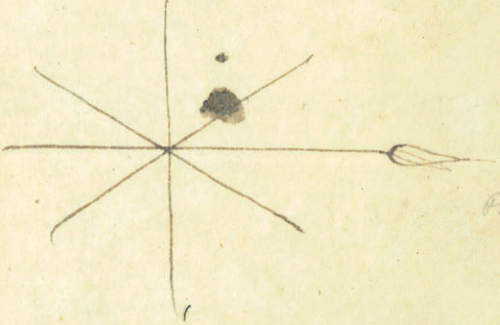

2060

1
208.
1.4
1.2
1.0
3.4
3.0
9
2.5
3.5
1.0

5515

61

John Hancock
and family

George W. Brown
Ansonia, S. D.
Peru, Ill.

Sammuel A. White

11190

2000
Shan Rowland - S. D.

13810

12575

2000

John Hancock

12425

13245

2000

Grant Flory

11725

12565

12205

land

Walter J. Ford

2550

18

Public Sale of the Cove of the State of New York

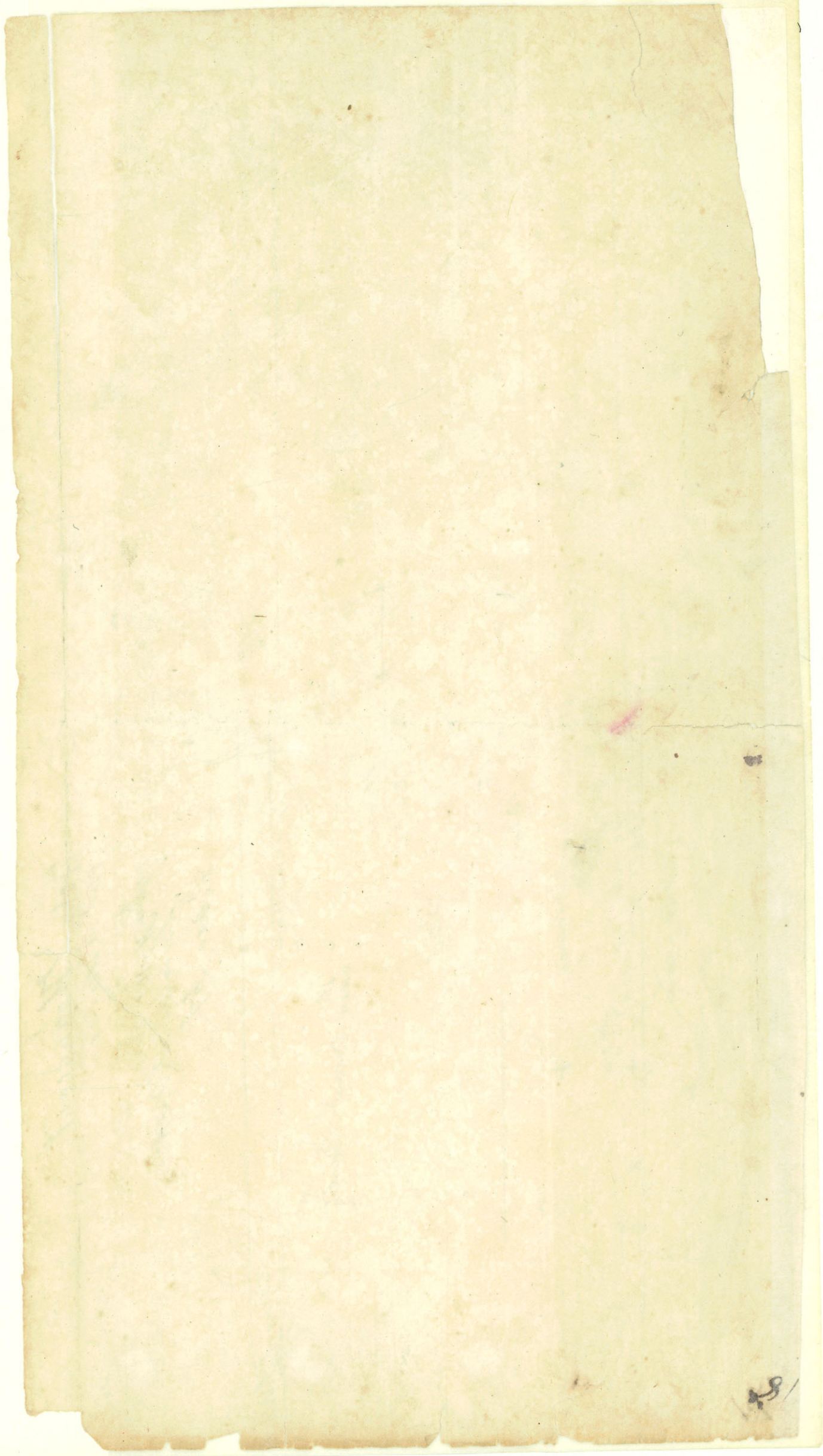

81

19

1777



13

20th of all whom it may concern know ye

Survey for Peter Hays -
Began on the South of the St. Antonio
River on Davis's Lower Corner - a Stake bearing
from a pecan - 20 inch diam S 12° 30' m w

S 5 W 15750 var.

S 5° E 14250 var.

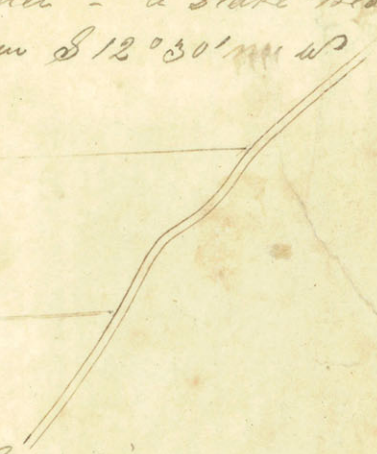

from a pecan 12 inch di N 44° 08' - dis 7 varas
Thence S 5 W - 15750 varas thence the corner on a stake
Thence S 85 W - 1666 1/2 varas a Stake thence N 58° -
14250 varas - To the corner on the River a stake
and mound - Thence with the meanders of the
river to the Beginning Corner as described a bore
containing 25,000,000 - Squar varas -

done Sept 6th 1834

John Hancock } chain
Joseph Bartlett } carriers

Saml. A. White
B

22

Vincent Addison White

Vincent Addison White

9000
8500
13250
13000
13750

13000
13500
13445

6500
5240
1260
15630
14370

South Side of the River
from the former flat up

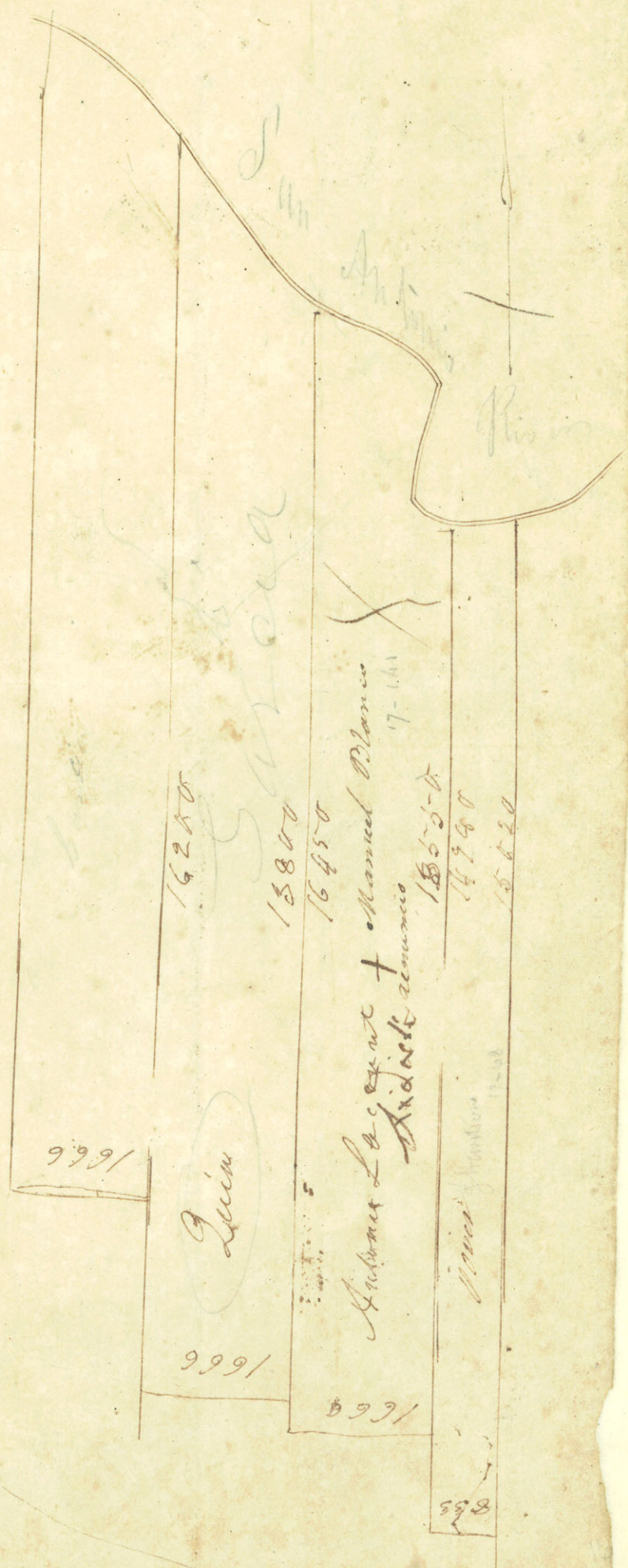

Survey for Edward Perry on the South side of the
 St Antonio River on the River at a stake bearing from a
 Pecan 14 inches diameter $N 40^{\circ} E$ dis 3 varas - From an Elm
 16 inches diameter $S 40^{\circ} W$ dis 3 varas -
 $S 5^{\circ} W$ - 16100 varas

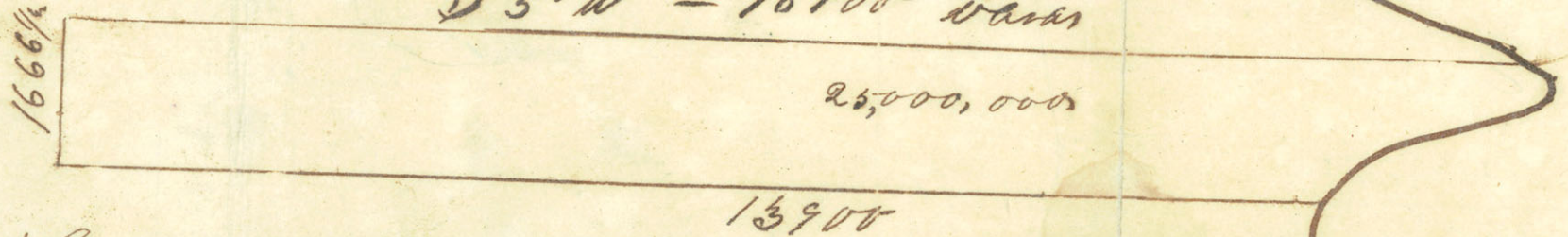

Thence South 5 west 13900 varas - a stake thence $S 85^{\circ} W$
 1666 1/2 varas a stake thence $S 5^{\circ} E$ - 16100 varas distance
 the corner on the River bearing from a pecan 15 inches diameter
 $N 75^{\circ} 30' W$ dis 12 varas - From a mulberry 5 inches diameter
 $N 40^{\circ} E$ dis 3 varas - thence with the meanders of the River
 to the beginning - Containing 25,000,000 square varas
 done Sept 20th 1834 -

Joseph Bartlett chain }
 J. H. Runnels carriers }

Samuel A White
 JS

24

[Faint, mirrored handwriting, likely bleed-through from the reverse side of the page]



2207 - 1811 - 1811

1811

[Faint, mirrored handwriting, likely bleed-through from the reverse side of the page]

[Faint handwriting at the bottom left of the page]

[Faint handwriting at the bottom center of the page]

[Faint handwriting at the bottom right of the page]

Wagon for

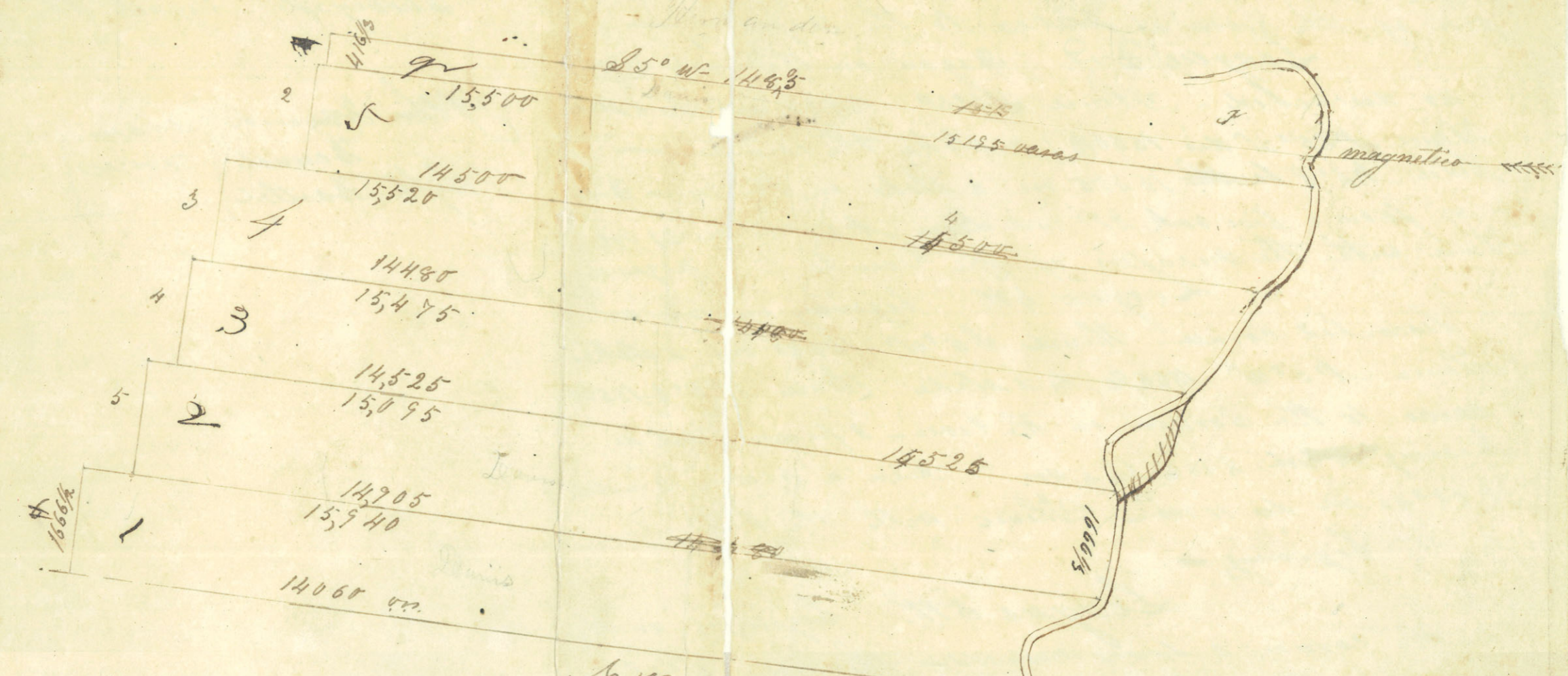

Joshua Davis F. 17 - P. 3.

N 50° E -

Began on the St Antonio River on the south side
 two miles below the musketeer Landing on a stake
 bearing from a pecan 30 inch diam S 12° 30' W dis 600
 From a pecan 12 inch diam N 77° 08' - dis 8 varas
 Thence S 5° W - 14060 varas a stake and mound -
 Thence N 35° W - 1666 1/2 a stake - Thence N 50° E 15940
 the corner on the river a stake bearing from a pecan
 16 inch diam S 53° E - dis 4 varas. From a mulberry
 5 inch diam N 41° E dis 2 varas. - Thence with
 the meanders of the river as plotted to the begin-
 - ing corner -

League 2nd - began on the corner
 last as described above thence S 5° W - 14905 varas

2. Stake - Hence N 85° W 166 1/3 on a stake
N 5° E. 15095 on the corner a stake bearing from
a pecan 14 inch di N 78° W dis 10 ors. - from an Elm
5 inch di N 27° E - dis 3 ors. - Hence with the mean-
der of the river as placed to the beginning -

League 3rd. Began on the last corner
as described - Hence S 5° W 14525 ors. to a stake
Hence N 85° W dis 166 1/3 a stake the corner -
Hence N 5° E to the 15475 on a stake on the river bear-
ing from a live oak 27 inch diam N 51° E - dis 29 ors.
Hence with the meanders of the river to the beginning

League 4th. beginning on the last
described corner - Hence S 5° W 14480 ors. a stake
Hence N 5° W 166 1/3 to a stake Hence N 5° E - 15520
varas - to the corner on the river - a pecan 12 inch di
bearing from a live oak 8 3/4 inch di 5 ors. from a pecan 12 inch di
N 88° 45 W - dis 11 ors. - Hence with the river - to
to the beginning -

League 5th. beginning on the
corner a bore named - Hence S 5° W
14500 ors. to a stake - Hence N 85° W 166 1/3
a stake - Hence N 5° E - 15500 ors. to the beginning
corner on the river a stake bearing from an Elm
10 inch di N 69° E - dis 5 ors. - of an Elm 8 inch di
S 78° W dis 3 ors. - of a live oak 12 inch di - S 33° E
dis 6 ors. - Hence with the meanders of the river
as placed to the beginning -

A quarter of a League
beginning on the corner a bore described
Hence S 5° W - 15195 ors. to a stake and mound
Hence N 85° W - 416 2/3 to the corner a stake
and mound - Hence N 5° E - 14805 ors. to the
corner on the river a stake bearing from
oak 12 inch di N 10° E - dis 4 ors. varas from
an ash 14 inch diameter S 68° 30' E - dis 4 ors.

Thence with the meanders of the
plate to the beginning of the
containing 5 Leagues and a quarter
Surveyed August the 28th 1654

Sam^l A^l White

John Hayward Chain
Bennet Carner
Joseph Bartlett

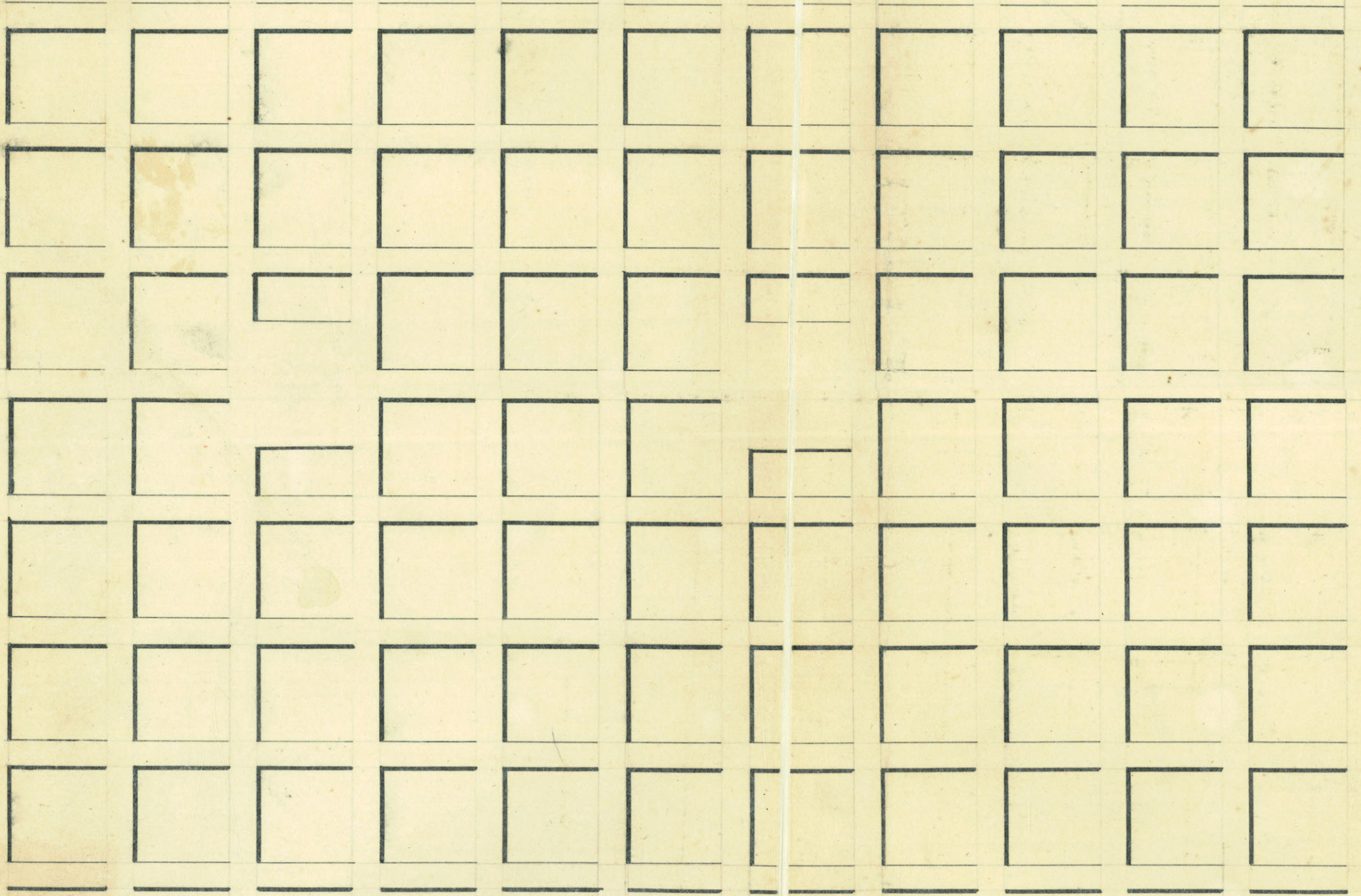

Plan of a Town at Live Oak point Drawn by Geese Fulton



Lower

Blayney 4th
2800
5800
mets

Blayney
2000
mets

2082

Blayney

E 1/2 South

12.008.0

West 1/2 North

5 met. gov.
Blayney
Blayney

Blayney
Blayney
Blayney

Blayney