

ENGLISH
FIELD
NOTES

J. STRODE

SPANISH
ARCHIVES

G.L.O.



1056116
EFN 000023

J. Strobe

Jerimiah Strobe

Polk
Houston
Rusk
Anderson
Cherokee
Smith
Walker
Nacogdoches
Trinity

S. Strode

Captain Surveyor

by

Journals Made

Monthly

Burnell's

Colony



27 2311

Notes of a league of land survey for S. C. Thomas on
the East bank of Trinity adjoining and directly above a league
survey for S. S. Thomas Beginning at the NW corner of S. S. C.
Thomas. Thence North 80 varas N 15 W 190 varas N 5 W 555 varas
N 5 3/4 W 180 varas N 7 3/4 W 420 varas N 5 6 W 660 varas West 152 1/2
N 6 5 W 500 varas N 6 7 W 500 West 2120 N 11 W 515 N 22 E
650 varas To Puntiss NW corner of his Seven league
survey. Thence East

1820
2151
275 1/2

To a small branch covead S 60 W
Mound and Stake 3rd corner from which a pine
18 in di bears S 80 E 8.5 varas dist. Also another pine
20 in di bears S 4 W 19.3 varas dist. Timber pine
and Oak open woods sandy land

2500
2509

Thence South
Small dogwood 4 in di 4th corner from which
a pine 15 in di bears S 18 E 14 varas dist. Also
another pine 18 in di bears N 6 1/2 E 8 varas dist.
Pine timber and poor sandy land

Thence West on Random line

7126 5

To 4 varas south of the Beginning corner

Thence on true line S 89 59 E on true line

7126 5

To the 4th corner, containing one league of about

Five labors of farming land Beyond Gracey Land

Quinn's & Hole

Prepared & Sent
Surveyor

S. C. Thross

Field Notes

Trinity

Notes Book

Stanton & Smith

Francis Johnson
File No. 145
Dec 18. p. 171

Houston Co
Ang

January 12th 1835 Then Surveyed for Francis Johnson One League of Land Situate on the St. Antone Road adjoining W. John Haggans Survey Beginning at his N. E. Corner from which a B. Oak 12 Inches in diameter bears N 56^o 7² W 6⁴/₁₀ Var. distant another B. Oak 15 Inches in diameter bears N 59^o 7² W 11^o/₁₀ Var. distant this being 1st Corner Thence N 54^o 7² East

a branch 1 Bone wide C. R.

Planted a post made a Mound 2nd Corner from which a B Oak 15 Inches in diameter bears N 28^o 7² W 9^o Var. distant a B Oak 10 Inches in diameter bears S 64^o 7² E 4⁴/₁₀ Var. distant Thence S 35^o 7² East

St. Antone Road

Planted a post made a Mound 3rd Corner from which a post Oak 15 Inches in diameter bears S 11^o E 10 Var. distant another post Oak 18 Inches in diameter bears N 10^o W 11^o/₁₀ Var. distant Thence S 54^o 7² W

Set a post and made a Mound 4th Corner from which a B Oak 10 Inches in diameter bears S 44^o 7² W 1^o Var. distant a post Oak 15 Inches in diameter bears S 29^o 7² E 20 Var. distant

Thence N 35^o 7² W with Haggans line To the place of Beginning Timber Oak Hickory Pine &c 2 Laborers Crable teller grazing Land

Jeremiah Strode
Surveyor

2193

3800

2/10

4110

6500

3700

2/10

6500

Varras gentles

Joseph Perry Falcon
9th May 1835
No. 181 p. 283

Stewart Co
1835

April 27th 1835 This Survey for Mrs. Josphat P. Falcon

an section of Land adjoining Joseph Darts Survey on the
Waters of The Angilena Beginning at Josephs Darts
N^W Corner a post around which Made a mound
1st corner from which a B. Oak 15 Inches in diameter
bears S 26^o W 7 Varras distant a post Oak 14 Inches
in diameter bears N 36^o W 13 Varras distant

Thence N 65^o 1/2 W

a Branch 1 Varras wide C. S

a Branch 1 Varras wide C. S

Set a post and made a mound of Stone 2nd corner
from which a B. Oak 8 Inches in diameter bears S 71^o W
7^o 10 Varras distant a B. Oak 17 Inches in diameter bears
N 35^o W 10 Varras distant

Thence N 24^o 1/2 E

Set a post and made a mound 3rd corner from
which a ^{post} Oak ²⁰ 20 Inches in diameter bears N 35^o W
25^o 10 Varras distant other post Oak 17 In. in dia. bears S 8^o E 60
Varras distant Thence S 65^o 1/2 E

Set a post and made a mound 4th corner from
which a B. Oak 12 Inches in diameter bears N 20^o E 80^o
distant a B. Oak 24 In. in diam bears S 30^o W 4^o distant

Thence S 24^o 1/2 W with Darts line

To the place of Beginning Timber Hickory Oak
ash Elm Linn Pine &c & Laborer Arable
Residue Grazing Land

Jumian Strode
Surveyor

1340

3300

5000

5000

5000

5000

Mr. Arthur Hamie

Haragochy

1845

4

4
5
Vernon June 22/35
Vol 18 p 509
Shenando Co
1842

B: 175

June 1st 1835 Then Surveyed for Isaac Reed one
Section or League of Land in D. G. Burnetts Grant adjoining
the Surveys of William Gatie and Isaac Kindricks Survey
Beginning at the S. W. Corner of said Kindricks Survey a post
in a Mound 1st Corner from which a B. Tree 10 Inches in
diameter bears S 5 1/2° W 25 Varas distant an Other B. Tree
19 Inches in diameter bears N 88° W 40 Varas distant

Thence West

6500 Set a Post and made a Mound 2nd Corner from which
a W. Oak 7 Inches in diameter bears N 2° W North 2
Varas distant a Willow Oak 16 Inches in diameter bears S 30° W
6 Varas distant

Thence North

6400 a Creek 2 Varas wide C. S. W

3846 1/2 Set a post and made a Mound 3rd Corner from which
a Hickory 14 Inches in diameter bears N 31° E 10 Varas distant
a Post Oak 10 Inches in diameter bears N 19° W 8 Varas distant

Thence East

6500 line Set a Post and made Mound
4th Corner from which a B. Tree 8 Inches in diameter
bears N 15° W 3 Varas distant an Other B. Tree 10 Inches in
diameter bears N 45° E 4 Varas distant

Thence South

3846 1/2 To the place of Beginning Timber Hickory Oak
Ash Lynn Walnut &c 20 Labors Arable
Residue Grazing Land

Jeremiah Stodd
Surveyor

Mr Arthur Harris

Doerlyshy

Varas, Santa Maria Gertrudis Henrique
Maringa, Santa Maria Henrique
1776 May 13/25.
Vol. 183 p. 251.

June 9th 1775 This Survey for W^m Maria Gertrudis Henrique
one Sitio or League of Land Situate of the waters of the Angitana
on the Trace leading from the big Shawand Village to the
Saline on the Trache beginning on the South Side of said
Trace ~~set~~ a Post and ~~made~~ a Mound 1st Corner from
which a Hickory 9 Inches in diameter bears N 69° W 2 Varas
distant a Red Oak 14 Inches in diameter bears S 34° E 10 Var.
distant Thence West

5000 Set a Post and Made a Mound 2nd Corner from which a
Hickory 10 Inches in diameter bears S 89° W 7 Varas distant
an other Hickory 12 Inches in diameter bears N 70° W 12 Var.
distant Thence North

1870 a Creek 3 Varas wide course W
5000 Set a Post and Made a Mound 3rd Corner from which
a Hickory 9 Inches in diameter bears N 24° E 5 Varas distant
a Red Oak 16 Inches in diameter bears S 39° E 7 Varas distant
Thence East

5000 Juan Vargas N W Corner a Post in Mound 4th Corner
from which a post Oak 10 Inches in diameter bears
S 27° W 7 Varas distant a Red Oak 13 Inches in diam-
eter bears N 43° W 7 Varas distant
Thence South

5000 To the place of Beginning Timber Hickory Oak
Ash Pine &c 10 Labores Arable & residue
grazing land
Jeremiah Strode
Surveyor

Rogers & Co

Mr. Arthur Dennis

Sacramento

1851

St. Martin

Mr Arthur Fenwick

St. George's

—

~~St. George's~~

May 2nd 1835 This Survey for Jefe Agaton Caro 4th of a 3rd
 Section or League of Land Situate on the Waters of the Cuyilena
 adjoining Mrs Maria Genradez Henoque Survey Beginning at
 her N. W. Corner a post in a Mound 1st Corner from
 a Red Oak 16 Inches in diameter bears S 39° E 1/2 Varnas
 distant a Hickory 9 Inches in diameter bears N 24° E
 Varnas distant

Thence West

2500

Set a post and made a Mound 2nd Corner from which
 a Hickory 12 Inches in diameter bears S 70° E 3/4 Varnas distant
 a B. Oak 16 Inches in diameter bears S 70° W 3/4 Varnas
 distant

Thence North

2300

a Creek 2 Varnas wide 6 W

2500

Set a post and made a Mound 3rd Corner from
 which a Red Oak 24 Inches in diameter bears S 35° W
 1 Varnas distant a Sweet Gum 8 Inches in diameter
 bears N 26° W 3/4 Varnas distant

Thence East

2500

Set a post in a Mound 4th Corner from which a
 B. Oak 8 Inches in diameter bears N 34° W 3/4 Varnas
 distant on the B. Oak 12 Inches in diameter bears S 57° W
 7 Varnas distant

Thence South

2500

To the place of Beginning Timber Hickory Elm
 Gum Oak Cane Bottom 6 Labour Arable
 Residue Grazing Land

J. M. Stodd
 Surveyor

Jefe Agaton Caro
 176 May 2/35
 Vol 18 p 291

Mrs Smith Co.

Blair

W. Arthur Harris

Sacagawhoy

"

"

Varras
9
Vol 18 p 255. Page 50

April 28th 1835 Then Survey for Robert H. Smith one

fourth of a Section or League of Land in Burnetts Grant
about 5 Miles of Joseph Durts Survey Beginning at ^{5th} ~~the~~
H. Chambers S.E. Corner to post in a mound
Corner from which a White Oak 10 Inches in diameter
bears S 24th E 3 Varras distant a Black Oak 8 Inches
in diameter bears South 3 Varras distant

Thence S 24th E

2500

Set a post and made a mound 2nd Corner from which
a post Oak 24 Inches in diameter bears S 15th W 14th distant
a Red Oak 24 Inches in diameter bears S 10th E 9 Varras
distant Thence S 65th W West

2500

Set a post and made a mound 3. Corner from which
a Sweet Gum Gum 14 Inches in diameter bears N 31th E
5 Varras distant a Red Oak 14 Inches in diameter
bears S 30th W 6 Varras distant

Thence S 24th W

1740

2500

a branch of the gulch 4 V. wide & S
by the Chambers Corner
Set a post and ~~made~~ mound 4th Corner from
which a Post Oak 24 Inches in diameter bears
N 30th E 5 Varras distant an other post Oak 24 Inches
in diameter bears N 75th E 4 Varras distant

Thence S 65th E with Chambers line

2500

To the place of Beginning Timber Oak Hickory
B. Walnut Ash Elm Gum &c 6 Labors, Able
Residue Grazing Land

Jennian Shode
Surveyor

James Jordan
7916
May 1735
vol. 18 p. 239

James Jordan
7916
May 1735
vol. 18 p. 239

Then Surveyed for M^r James Jordan one
Scite or League of Land adjoining the Surveys of
M^{rs} Maria Gutierrez Henrique and Juan Vargas
adjoining and Binding on their North boundaries
Beginning at a post in a Mound 1st Corner from which
a Red Oak 30 Inches in diameter bears S 48° E 2 Varas
distant an Other Red Oak 19 Inches in diameter bears
S 10° E 16 Varas distant Thence West
a Creek 3 Varas wide C. S
A post in a Mound 2nd Corner from which a Hickory
9 Inches in diameter bears N 24° E 5 Varas distant a
Red Oak 16 Inches in diameter bears S 39° E 7 Varas
distant Thence North
Set a Post and made a Mound 3rd Corner from
which a B. Oak 4 Inches in diameter bears N 57° W
3 Varas distant an Other B. Oak 12 Inches in diam-
eter bears S 57° W 3 Varas distant
Thence East
a Creek 2 Varas wide C. S
Set a post and made a Mound 4th Corner from which
a white Oak 20 Inches in diameter bears S 48° E
12 Varas distant a Sweet Gum 10 Inches in diameter
bears N 34° E 13 Varas distant
Thence South
To the place of Beginning Timber Walnut
Sugar tree Cherry Beech Hickory Oak &c. 12 Leagues
arable Repidue Grazing Land
James Jordan
Surveyor

19500
10000
10000
2500
2500
10000
19000
2500
2500

James Jordan
Surveyor

Mr. Arthur Pennie

Sacramento

London

1835
Anderson Co
1837

Robert W. Box
17th May 17/35
18th p 303

Death March 1835. Then Survey for Mr. Nelson
Box one league of land situated on Prairie
River below the lower Comanche Trace at the
Large Prairie on the East bank of said River
Planted a Post and made a Mound 3rd Corner
from which a Swamp Oak 30 inches in diameter
bears S 80 E 6 1/2 Paces distant an other Swamp
Oak 26 inches in diameter bears S 42 W
42 1/2 Paces distant

Thence S 75 E

9587

Set a post and made a Mound 2nd Corner from
which a Red Oak 19 inches in diameter bears S 39 W
4 1/2 Paces distant an other Red Oak 20 inches in
diameter bears S 33 W 4 Paces distant

Thence S 45 W

40

a Creek 2 Var. wide C. S. W

2500

Set a post and made a Mound 3rd Corner from
which a Hickory 8 inches in diameter bears S 54 E
1 1/2 Paces distant a post Oak 10 inches in diam.
bears S 10 E 11 1/2 Paces distant

Thence S 75 W

214

Set a post and made a Mound 4th Corner from which
a B. Oak 20 inches in diameter bears S 5 E 12 Paces dis-
tant an other B. Oak 9 inches in diameter bears
S 28 W 3 1/2 Paces distant

Thence South

996

with former Box is line to the Corner a post in a
Mound 5th Corner from which a B. Oak 19 inches
in diameter bears S 78 W 15 1/2 Paces distant and the
B. Oak 12 inches in diameter bears S 13 W 19 1/2 Paces distant

Thence West with another of former Box is

1600

line Set a post and made a Mound 6th Corner
from which a B. Oak 8 inches in diameter bears
S 7 W 4 Paces distant and the B. Oak 6 inches in
diameter bears S 7 E 3 1/2 Paces distant

Thomas Dutton

Thence S 75° W

1723

To the Margin of Trinity River set a post and
made a round 7th Corner from which an Elm 20
Inches in diameter bears S 57° W 50 Varas distant
an other Elm 19 Inches in diameter bears S 41° E 47⁸
Varas distant

Thence down said River with its course
- dir S 3° E 400 Varas thence S 42° W 290 Varas thence
S 21° W 370 Varas thence S 50° E 200 Varas thence
S 60° E 500 Varas thence South 550 Varas thence
S 82° E 550 Varas to the place of Beginning
Timber Hickory Oak Elm ash &c 60 Acres Area
Residue grazing Land

James H. Stodd
Surveyor

Mr. Arthur T. Davis
Savannah Georgia
Savannah

Yarras Timber April 25th 1835 Then Surveyd for William D Hillson
 one Section or League of Land Situate on the Camanche
 Trace 4 Miles from the Big Ayone Village

William D Hillson
 State July 9/35
 he 19. p 349
 Anderson Co
 Bond

Set a post and Made a Mound 1st Corner from
 which a B. Tack 15 Inches in diameter bears S 59° E
 7¹⁰/₁₀ Yarras distant and Other B. Tack 10 Inches in
 diameter bears S 39° W 10 Yarras distant

Thence West

4300 a Spring Branch C. N. W
 4540 a Creek 1 1/2 Yarras wide C. N. W
 5000 Set a post and Made a Mound 2nd Corner from
 5000 which a pine 22 Inches in diameter bears S 32° W 6¹⁰/₁₀
 Yarras distant and Other Pine 17 Inches in diameter
 bears S 61° E 7²/₁₀ Yarras distant

Thence South

2330 Camanche Trace C. N. W
 5000 Set a post and Made a Mound 3rd Corner from
 5000 which a B. Tack 16 Inches in diameter bears N 39° E
 9 Yarras distant and Other B. Tack 14 Inches in di-
 ameter bears S 50° E 8¹⁰/₁₀ Yarras distant

Thence East

3760 a Creek 1 1/2 Yarra wide C. N. W
 5000 Set a post and Made a Mound 4th Corner from
 5000 which a B. Tack 14 Inches in diameter bears S 78° E
 11²/₁₀ Yarras distant and Other B. Tack 3 Inches in
 diameter bears N 77° W 5 Yarras distant

Thence North

4500 a Creek 1 Yarra wide C. N. E
 5000 Go the place of Beginning Timber The heavy
 Oak Ash Elm Pine &c & Labourer Arable
 3000 Reproduce Grazing Land

J. M. Stodd
 Surveyor
 " " "

Thomas Smith

January 21st 1835 Then Surveyed for William Whitely one league of Land in Vekline Colloony situate on the South Side of Mossy Creek set a post and made a mound 1st Corner from which a pin Oak 20 Inches in diameter bears S 52° W 3/4 Vars distant a Sweet Gum 36 Inches in diameter bears East 2 1/10 Vars distant Thence S 10° W

V-245

3906

2/10

Set a post and made a mound 2nd Corner from which a B. Oak 17 1/2 Inches in diameter bears South 3 2/10 Vars distant a Pine 10 Inches in diameter bears N 74 1/2° W 7 1/10 Vars distant Thence S 40° E

550

1600

a branch C. & Set a post and made a Mound 3rd Corner from which a pine 20 Inches in diameter bears S 60° W 3 Vars distant an other pine 25 Inches in diameter bears S 63° E 7 2/10 Vars distant Thence N 10° E

3906

2/10

Set a post and made a Mound 4th from which a post Oak 10 Inches in diameter bears N 56° W 4 6/10 Vars distant an other post Oak 12 Inches in diameter bears S 50° W 4 Vars distant Thence N 40° W

1600

To the place of Beginning Timber Humbery Oak Pine ash Lyhn &c 2 Laborer Arable Ballan Grazing Land

Jeremiah Stode
Surveyor

Report

3906
1600

23436.00
3906

22496.00

16

William Miller
St. Louis

By
the
order
of
the
Board

By
the
order

William Whiteley by
Strode Surveyor

Mr Whiteley 1/4
R. Brothers

Richard

From May 6th 1735 Then Surveyed for Mr. James Reel one Quarter
 of a League of Land adjoining his Father Survey ^{near} this
 S. E. Corner set a post and Made a Mound 5th Corner from
 which a Pine 16 Inches in diameter bears S 43° E 11 Varas distant
 a post Oak 13 Inches in diameter bears S 30° W 12 Varas distant.

Thence East

2500

Set a post and Made a Mound 2nd Corner from which a
 a B. Oak 12 Inches in diameter bears S 27° E 5 Varas distant a Red
 Oak 15 Inches in diameter bears N 63° E 12 Varas distant.

Thence North

2500

Set a post and made a Mound 3rd Corner from which a
 Hickory 14 Inches in diameter bears N 60° E 6 Varas distant
 a Chinquemine 10 Inches in diameter bears N 77° E 8 Varas
 distant Thence West

1800

Daniel Reels S. E. Corner line

2500

Set a post and Made a Mound 4 Corner from which a
 B. Oak 10 Inches in diameter bears South 5 Varas distant
 a B. Oak 8 Inches in diameter bears North 7 Varas distant

Thence South

500

To the place of Beginning Timber Pine Hickory Oak &c
 4 Labors Arable & 1/2 Acre Grazing Land

Jeremiah Stone
 Surveyor

Done May 19/35
 the 18 p 34
 B. Oak 12
 2500

James Reed

15
Mr. Arthur Fenwick
Lacayocho

17
Waras

Alloy
March 5th 1835
one Quarter of a League of Land Adjoining this Father
Daniel Reels Survey and also his Brother James Reels
Survey Beginning at James Reels N.E. Corner a post
in Maund 3rd Corner from which a Hickory 4 Inches
in diameter bears S 60° E 6 Varas distant a Chinquapin 10
Inches in diameter bears N 75° E 8 Varas distant

Thence North

a Branch 2 V. wide S. South

Planted a post and made a maund 2nd Corner from
which a Red Oak 15 Inches in diameter bears S 64° W
of Varas distant a white Oak 20 Inches in diameter
bears S 61° E of Varas distant

Thence West

Daniel Reels N.E. Corner a post in Maund 3rd
Corner from which a B Oak 9 Inches in diameter bears
N 45° W 5 Varas distant a post Oak 20 Inches in
diameter bears S 16° E 8 Varas distant

Thence South with 2. rule line

Set a post and made a Maund 4th Corner from which
a B Oak 10 Inches in diameter bears South 5 Varas distant
a B Oak 18 Inches in diameter bears North 7 Varas distant

Thence East

To the place of Beginning Timber pine Hickory Oak
Ash Elm Walnut &c 4 Labors arable Riparian
Grazing Land

Jenniah Stode
Surveyor

972 May 15/35
vol 18 p 349.

Book Co
1835

180

2500

2500

2500

2500

Henry Reed

16

W. Arthur Henne

Harogateschen
11 - 11
Lithuanian State

18. Distant South January 5th 1835 - Then Surveyed for Mr. John
Moore One League of Land on the waters
of the Trinity River Beginning at Thomas
R. Townsends S W Corner a Stake in
13th Corner
a mound from which a B Jack 14 Inches
in diameter bears; N 66 E 2 Varras distant a
Red Oak 14 Inches in diameter bears; S 47 W
13 Varras distant
Thence S 35 1/2 E with Aldredges line
his corner

John Moore
1835 Oct 22/35
Vol 19 p 175
Houston Or
App 29

1345
3800

2
10

Set a post and made a mound 2nd corner
from which a B Jack 10 Inches in diameter
bears; S 66 E 11 1/8 V's distant another B Jack
6 Inches in diameter bears; S 13 W 8 1/2 V's distant
Thence N 34 1/2 E

1700
6500

a branch 1 1/2 V's wide E. S
planted a post and made a mound 3rd corner
from which a B Jack Post Oak 12 Inches in dia
bears; S 10 E 3 6/10 V's distant another post oak 6
Inches in diameter bears South 5 V's distant
Thence N 35 1/2 W

3800

2
10

Planted a post and made a mound 4th corner
from which a B Oak 20 Inches in diameter bears;
S 50 E 10 V's distant a B Jack 6 Inches in diameter
bears; S 67 1/2 W 7 V's distant Thence S 34 1/2 W
Thos R. Townsends S E corner

1500
6500

To the place of beginning Tumbler Oak
Hickory pine Post Oak B Jack & C.
One Laborer available to allow Grazing
Land

Jameson Stock
Surveyor
11

Mr Arthur Harris

Surveyor General

Washington

1852

Washington D.C.

and order of survey
in honor

Mr. Arthur Harris
Jacob Davis

211 Juan José Sanchez - Title June 18/35 - Vol 20 p 611. 22. 1/11 1835

April 13th 1835 Then Surveyd for ^{Walker con} ~~for~~ Juan José Sanchez
one League or Sitio of Land beginning at Madam Jaquith's ^{Jaquith}
South West corner on the waters of San Jacinca a post in
a mound 5th corner from which a post oak 18 Inches in
diameter bears North 17^o 5' Varas distant another post Oak
bears West 5 Varas distant

Thence West

800 a branch 1 Varra wide S South
1600 a branch 1 Varra wide S South
4750 a branch 1 1/2 Varra wide S S.E
5000 Set a post and made a Mound 2rd corner from which
a Post Oak 18 Inches in diameter bears S 41^o 1/2 W 17^o 5' Varas
another post Oak 18 Inches in diameter bears South 14
Varas distant Thence North

1600 a branch 1 Varra wide S.S.E
5000 Set a post and place a Mound 3rd corner from which
a Post Oak 9 Inches in diameter bears N 45^o E 6 Varas distant
another Post Oak 10 Inches in diameter bears S 43^o E 11 Varas
distant

Thence East

5000 To Madam Jaquith's line set a post and made a
Mound 4th corner from which a double Pine 24 Inches
in diameter bears N 31^o W 20 Varas distant

Thence South with said line

5000 To the place of beginning Timber Hickory Oak
Elm ash &c 12 Labores Arable Ripidue Grass
Land

Jeremiah Shode
Surveyor
|| ← ||

276
Title Apr 435 - Vol 20. p 315 Houston Co
Varras Survey March 30. 1835 Surveyed for W. Stephen Box one Section

or League of Land on the South Side of Coney Bayou adjoining
the surveys of Summers Aldridge and J Moore beginning
at Collan Aldridges South West Corner ~~of~~ st ~~corner~~
a Stake in Maund 1st Corner from which a Post Oak 18
Inches in diameter bears S 81 1/2 W 2 1/10 Varras distant a Post Oak
24 Inches in diameter bears N 47 E 5 Varras distant

Thence N 35 1/2 W

Coney Bayou set Post made a Maund 2nd Corner on the
South Margin of the Bayou

Thence down the Bayou with its several Meanders
as follows (to wit) S 36 1/2 W 500 Var^{ies} thence S 27 1/2 W 300 Var^{ies}
thence S 54 W 700 Varras thence South 400 Varras thence
S 50 W 1000 Varras thence S 15 W 250 Var^{ies} thence S 20 E 300
thence S 46 1/2 W 1100 Varras thence South 700 Varras thence
S 27 1/2 W 500 Var^{ies} N 58 1/2 W 150 Var^{ies} thence N 42 W 150

Set a post and made a Maund 3rd Corner from which
a Lynn 14 Inches in diameter bears S 42 W 2 Varras distant
another Lynn 12 Inches in diameter bears S 44 E 4 1/10 Varras distant

Thence S 35 1/2 E

Set a post and made a Maund 3rd Corner from which
a Post Oak 10 Inches in diameter bears N 24 W 3 Varras distant
a post oak 14 Inches in diameter bears S 52 W 2 1/10 Varras distant

Thence N 54 1/2 E

a Creek 1 Var wide C. N. W

a Creek 1 Var wide C. N. W

Set a post made a Maund 4th Corner in Moore
line from which a Post Oak 14 Inches in diameter
bears S 57 W 2 Varras distant another Post Oak 14 Inches
in diameter bears South 5 1/10 Varras distant

Thence N 35 1/2 W with Jellons line

Aldridges corner a post in Maund 5th Corner
from which a post Oak 18 Inches in diameter bears ~~S 50 W 2~~
an other Post Oak 24 ~~S 80 E~~
Varras distant and a Post Oak 14 Inches in diameter bears ~~S 57 W~~
Varras distant

Thence S 54 1/2 W with Aldridges line

To the place of beginning Timber Oak Hickory pine &c
3 Labors available agricultural grazing Land
Jemiah Stode
Surveyor

1500
1500

1950

2300

2500

10000
10,000

2150

2150

5000

Notes Lent

23
 Varras
 Stowell Box
 1776 Aug 15/35
 1782 21/17
 Houston Co 1833

191.
 in the April 2nd 1835 Then Surveyed for Mr. Stowell Box one
 Section or League of Land on Haw Bayou Beginning at
 J. Hodge N W Corner in Henry Masters line a Post
 in Mound 1st Corner from which a B Oak 20 Inches in
 diameter bears S 75° E 3 Varras distant another B Oak
 22 Inches in diameter bears S 90° E 8 Varras distant
 Thence S 54 1/2 W with Masters line

1080
 2500
 3850
 950
 6200
 4000
 6200
 2200
 2500
 210
 3910
 5920

page Masters Corner
 Set a post made a Mound 2nd Corner from which
 a B Oak 21 Inches in diameter bears S 49° W 2 1/2 Varras distant
 another B Oak 18 Inches in diameter bears S 41° W 2 2/10 Varras
 distant Thence S 35 1/2 E
 Set a post and made a Mound 3rd Corner from which
 a White Oak 10 Inches in diameter bears N 14° E 3 Varras
 distant a Post Oak 15 Inches in diameter bears N 20° W
 4 1/10 Varras distant Thence N 54 1/2 E
 Set a post and made a Mound 4th Corner from
 which a B Oak 14 Inches in diameter bears N 35° W 7
 Varras distant another B Oak 13 Inches in diameter
 bears S 74° W 5 Varras distant
 Thence S 35 1/2 E
 a Bayou 3 Varras wide C. South
 Set a post and made a mound 5th Corner from
 which a post Oak 10 Inches in diameter bears S 75° E
 2 Varras distant another post Oak 12 Inches in diam-
 eter bears N 12° E 7 1/10 Varras distant
 Thence N 54 1/2 E
 a Bayou 2 Varras wide C. S. W.
 Set a post and made a Mound 6th Corner from which
 a post Oak 18 Inches in diameter bears S 63° W 5 Varras distant
 a Red Oak 20 Inches in diameter bears S 4° W 11 Varras distant
 Thence N 35 1/2 W
 a Creek 2 Varras wide C. S.
 a Branch 1 Varras wide C. S. W.
 a Spring Branch C. S. W.

Varras Sents

6300

Set a post and made a mound 7th Corner in Hodges
line from which a pine 36 Inches in diameter bears N 11 W
3 Varras distant a B. Oak 30 Inches in diameter bears S 2 E
6 Varras distant

950

Thence S 54 1/2 W with Hodges line
Hodges Corner a post in Mound 8th Corner from which
a B. Oak 28 Inches in diameter bears N 35 1/2 W 8 Varras dis-
tant a Sweet Gum 10 Inches in diameter bears S 59 E
9th Varras distant

3700

Thence N 35 1/2 W with an other of Hodges
To the place of Beginning Timber Hickory Oak
ash Elm pine & cane Bottoms on the Bayous
6 Labors arable Pryide Grazing Land

Notes Sents

Jamiah Shoo
Surveyor
" — "

Mr. C. H. ...

Inspector

...

25.

April 14 1835 Then Surveyed for M^r Manuel Herrera
one Sitio of League of Land on the waters of the
San Juan^o, ^{adjoining Juan Jose Sanchez's Survey} beginning at a post in a Maund 3rd
Corner from which a B Oak 8 Inches in diameter
beary N 75° E 6 Varas distant another B Oak 10 Inches in
diameter beary S 43° E 11 Varas distant Sanchez's ^{3rd Corner}
Thence West

1170
2100
3900
3846

a Spring Branch 6 North
a Spring Branch 6 North
a Black Bayou 1 1/2 Var wide 6 North
Set a post and made a Maund 2nd Corner from
which a B Oak 24 Inches in diameter beary N 40° W
18 Varas a post Oak 12 Inches in diameter beary S 43° W
5 Varas distant Thence South

19
6500

Black Bayou 1 1/2 Var wide
Set a post and made a Maund 3rd Corner from
which a pine 14 Inches in diameter beary S 10° W 7 Varas
distant a post Oak 18 Inches in diameter beary N 6° W
9 Varas distant Thence East

3846

Set a post and made a Maund ^{on the East bank of San Juan} 4th Corner from which
a Hickory 15 Inches in diameter beary N 35° E 15 Varas
distant a Willow Oak 8 Inches in diameter beary N 25° E
6 Varas distant Thence North

6500

To the place of Beginning Timber Hickory Oak
pine Elm Ash &c 16 Labours arable Arpedue
grazing Land
Jerman Stodd
Surveyor

26
Varnas Branch

February 12th 1835 Then Surveyed for Mr. George Pollett

one half League of Land Situate on alla San Creek
Beginning on the East Bank of said Creek on a Compu-
-min with Antonio Sepulvidore planted a post and
made a Mound 1st Corner from which a Red Oak
22 Inches in diameter bears N 54° E 4^{to} Varnas distant
another Red Oak 26 Inches in diameter bears N 69° W
6 Varnas distant Thence N 87° E
a Branch 1/2nd wide C. S

1000

3289

4/10 Planted a post and made a Mound 2nd Corner
from which a Post Oak 10 Inches in diameter
bears N 37° W 2 Varnas distant a Red Oak 30 Inches
diameter bears S 43° E 10 Varnas distance
Thence N 9° W

2700

3800

a Spring branch C. S
planted a post and made a Mound 3rd Corner
from which a Hickory 10 Inches in diameter bears
N 19° E 1^{to} Varnas distant another Hickory 15 Inches
in diameter bears S 19° W 10 Varnas distant
Thence S 51° W

2240

3289

7/10 alla San Creek 1/2nd wide C. S
Planted a post and made a Mound 4th Corner
from which a Red Oak 30 Inches in diameter bears
N 40° W 2^{to} Varnas distant another Red Oak 24 Inches in
diameter bears N 57° E 10 Varnas distant

3800

Thence S 9° E Crops the Creek many times
To the place of beginning Timber Hickory Oak
Pine &c 3 Laborers liable to repaid Grazing
Land. Quenish Shovel

Surveyor

As this is all the Land that is found to belong
here
J. B

3289
3/800

2631200
9267

12498200
12498200

24996400

Distance South December the 1st 1834

Then surveyed for Leonard Williams One League of Land
 Bounded as follows Wth. Planted a Post and made a mound
 1st Corner on the South Bank of the Neches from which a
 Water Oak 5 Inches in diameter bears S. 65 W. 4 5/10 V. distant a
 maple 12 Inches in diameter bears S. 22 1/2 E. 3 7/10 V. distant
 Thence S. 65 4 W. 90 V. thence N. 30 E. 170 V. thence N. 55 W. 160 V.
 thence S. 67 1/2 W. 230 V. thence N. 50 W. 100 V. thence N. 2 W. 50 V.
 thence S. 43 1/2 E. 100 V. thence S. 62 1/2 W. 90 V. thence N. 79 W.
 170 V. thence North 150 V. thence S. 68 W. 125 V. thence N. 74 W.
 200 V. thence N. 15 1/2 W. 125 V. thence N. 37 E. 200 V. thence
 West 190 V. thence North 160 V. thence S. 75 W. 210 V.
 thence N. 45 W. 135 V. thence S. 66 W. 430 V. thence
 S. 13 W. 210 V. thence S. 30 W. 300 V. thence S. 86 W.
 470 V. thence S. 64 W. 100 V. thence S. 55 1/2 W. 455 V. Set a
 Post and made a mound 2^d Corner on the West
 Bank of the Neches from which a sweet Gum 2
 3/4 Inches in diameter bears N. 30 E. 10 V. distant
 a Hickory 18 Inches in diameter bears S. 3 7/10 V. distant
 Thence S. 23 W.

1450

a Road

6200

a Branch C. S. E.

8600

a Road leading to a lick C. East 100 V. distant
 set a Post and made a mound 3^d Corner a B
 Jack 24 Inches in diameter bears N. 85 E. 8 1/10 V. distant
 an Other B. Jack 15 Inches in diameter bears N. 68
 West 9 V. distant Thence S. 67 E

2200

a Spring Branch

2500

set a Post and made a mound 4th Corner from
 which a Post Oak 18 Inches in diameter bears N. 41 W
 5 V. distant an Other Post Oak 10 Inches in diameter bears
 S. 20 E. 5 1/10 V. distant thence N. 23 E

900

a Branch

4200

a Creek C. N. E

9955

to the Place of Beginning Timber Pine Hickory Oak &
 2 Labors Arable Ballance overflow and Grazing
 Land
 Jeremiah Shoar Surveyor

April 22 1735 Then Surveyed for William Heath
one Quarter of a League of Land in the Line Colony
beginning at Jacob Masten's S. E. Corner a post in
Mound 5th Corner from which a Hickory 18 Inches
in diameter bears S 62° E 15 Varas distant a B. Oak
30 Inches in diameter bears S 52° W 13 Varas distant

Thence S 40° W with Master's line

460

a branch 1 Varas wide C. S.

540

League's Corner a post in Mound 2nd
Corner from which a Willow Oak 15 Inches in diam
bears S 82° West 5 Varas distant

a black Oak 20 Inches in diameter bears S 49° E

5 Varas distant Thence East with League's line

2460

League's Corner in Deulen Dupelle's line

a post in Mound 3rd Corner from which a post
Oak 18 Inches in diameter bears S 80° E 5 10 Varas distant

another post Oak 15 Inches in diameter bears S 74° E

12 10 Varas distant Thence North Dupelle's line

600

a Creek fork of the Royal 2 V's wide C. S.

1090

Dupelle's Corner a Stake in Mound 4th Corner

from which a post Oak 18 Inches in diameter
bears N 76° W 5 Varas distant a B. Oak 14 Inches
in diameter bears S 74° E 19 Varas distant

1080

Thence East another of Dupelle's line

140

a Spring Branch 1 V's wide C. S.

2700

Set a post and made a Mound 5th Corner from

which a post Oak 12 Inches in diameter bears S 41° E 5

Varas distant a B. Oak 20 Inches in diameter bears S 25° E

10 Varas distant Thence North

1350

Set a post and made a Mound 6th Corner from

which a B. Oak 4 Inches in diameter bears N 85° E

4 10 Varas distant a B. Oak 4 Inches in diameter

bears N 66° E 3 10 Varas distant Thence West

2700

Set a post and made a Mound 7th Corner from

which a Sweet Gum 24 Inches in diameter bears S 87° E

8 Varas distant a white Oak 24 Inches in diameter

bears S 75° E 8 Varas distant

Thence S 45° W

2915

To the place of beginning 4 Labours Arable
Residue Grazing Land. Thence Hukorry Oak
and Elm &c.

Jamison Stodd
Surveyor

29



12

Faint, illegible handwritten text or markings in the center-right area of the page.

William Heath
by Trade Survey

Mr Arthur Thomas

Longwood

~~Do not close by~~
Longwood

January 22nd 1835 Then Survey for George W. Vanars

one Section or League of Land Situate on the San Pedro Beginning at Mr. John Sheridan's Corner in Martin Murchison's East boundary line a Post in Maund 4th Corner from which a B. Jack 15 Inches in diameter bears N 47 7/8 W 3 8/10 Vanars distant a B. Oak 24 Inches in diameter bears S 40 E 15 Vanars distant

George W. Vanars
9th Oct 1835
No. 19 p. 529
Houston Co.

2025
1680
1900
2000

Thence South with Murchison's line a Stake and Stone in John Edens line ~~2nd Corner~~ Thence East with Edens line Edens Corner a Stone mark to E 3rd Corner Thence S 37 1/2 E with another of Edens line San Pedro Creek 1/2 Vanars wide C.W.E. Made a Maund 4th Corner around a post Mr. Davis Corner from which a white Hickory 10 Inches in diameter bears N 36 E 6 Vanars distant another white Hickory 80 Inches in diameter bears N 68 E 12 Vanars distant

Thence down the San Pedro with its several windings as follows (to wit) East 160 Vanars thence N 63 E 500 Vanars Thence N 22 E 300 Vanars thence N 74 E 100 Vanars thence S 82 E 260 Vanars thence N 51 E 460 Vanars thence S 67 1/2 E 170 Vanars N 69 E 340 Vanars thence N 39 E 370 Vanars thence N 53 E 170 Vanars thence S 80 E 200 Vanars thence S 54 E 100 Vanars thence S 33 E 80 Vanars thence S 69 E 230 Vanars thence N 78 E 450 Vanars thence N 53 E 250 Vanars thence N 46 E 350 Vanars thence S 80 E 90 Vanars thence N 54 1/2 E 100 Vanars thence N 67 1/2 E 50 Vanars thence N 26 E 560 Vanars a Post

1237
4060
4800

Thence ~~S~~ East Davis's Corner in McBlane's line a post and Maund 5th Corner Thence N 10 E with McBlane's line McBlane's Corner Set a post and made a Maund 6th Corner

varas from which a B. Oak 16 Inches in diameter bears
S 82° W 2 ²/₁₀ Varas distant another B. Oak 8 Inches in
diameter bears N 39° W 6 Varas distant
Thence N 68° W

1600 Set a Post and made a mound 7th Corner
from which a Post Oak 20 Inches in diameter
bears S 73° W 12 ⁴/₁₀ Var. distant another post Oak
7 Inches in diameter bears S 2° E 7 ⁶/₁₀ Var. distant
Thence S 40° W

1545 Set a Post and made a Mound 8th Corner ^{the Sheridan line}
from which a Post Oak 24 Inches in diameter bears
S 47° W 10 ⁴/₁₀ Var. distant a B. Oak 18 Inches
in diameter bears N 34° W 9 ³/₁₀ Var. distant

1600 Thence S 50° E with Sheridan line
to his Sheridan's Corner a Post in Mound
9th Corner from which a B. Oak 14 Inches in
diameter bears N 60° W 11 ⁴/₁₀ Var. distant another
B. Oak 16 Inches in diameter bears N 32° W
12 ²/₁₀ Var. distant

1700 Thence S 40° W with another of Sheridan line
a branch 1 Var. wide E. South

1150 a post in Mound 10th Corner from which a B.
Oak 18 Inches in diameter bears N 47° E 8 ²/₁₀ Var.
distant another B. Oak 8 Inches in diameter bears
S 34° E 9 ⁶/₁₀ Varas distant

000 Thence N 50° W Sheridan line
a Post in Mound 11th Corner from which a B. Oak
9 Inches in diameter bears N 44° W 2 ⁶/₁₀ Varas
distant another B. Oak 8 Inches in diameter bears
N 84° W 2 ²/₁₀ Varas distant

1600 Thence S 57° W Sheridan's line
a post in Mound 12th Corner from which a
B. Oak 9 Inches in diameter bears N 73° E 5
3 ²/₁₀ Var. distant another B. Oak 5 Inches in diam
eter bears N 66° W 3 ⁷/₁₀ Varas distant

160 Thence N 50° W
a Post in Mound 13th Corner from which

28.

31
 Veritas South a B. Pack 15 Inches in diameter bears N 18° W
 & is distant another B. Pack 20 Inches in diameter
 bears S 52° E 7⁴ 10⁴ Var. distant
 Thence S 67° W Sheridan's line
 730 a Creek Fork San Pedro a State 14 Station
 Thence S 21° E Sheridan's line
 119 a State Corner Sheridan's corner 15^{on} Station
 Thence S 69° W
 490 a Large Spring and a post Sheridan's corner
 Thence S 77° W with Sheridan's line
 3290 a post in Mound 17th Corner from which
 a B. Pack 20 Inches in diameter bears S 37° W
 4⁴ Var. distant and the B. Pack 13 Inches in diameter
 bears N 39° E Var. distant
 Thence North
 450 a Post in Mound 18th Corner from which a
 B. Pack 5 Inches in diameter bears S 70° W 5⁴ Var.
 distant and the B. Pack 5 Inches in diameter
 bears N 48° W Var. distant
 Thence West with Sheridan's line
 1240 Sheridan's Corner in Martin March's and
 line the place of Beginning Timber Co's
 Hickory Ash Elm Pine & C. Laborer's and
 Residue Grazing Land
 Grenada Stode
 Survey

19600
 1140

1240
 1140
 1250
 3590

George W. Wilson

Notes Sent
& Received

Mr. John H. Lewis

Surveyor Inspector

Surveyor docket

Then Surveyd for Mr Henry Masters, ^{Houston Co} one League
 of Land Situate on the waters of Trinity River
 on the St. Antone Road and adjoining of
~~Johnson~~ Johnsons Survey. Set a post and made
 a mound 1st Corner from which a B. Oak
 10 Inches in diameter bears S 49° E 1 ⁸/₁₀ Norrs distant
 an other B. Oak 8 Inches in diameter bears N 66° W
 6 ²/₁₀ Var^s distant
 Thence S 35° E with Johnsons line
 The St. Antone Road

700
 3100
 3800

Johnsons Corner
²/₁₀ Set a post and made a mound 2nd Corner from
 which a Post Oak 20 Inches in diameter bears
 N 72° E 13 ⁸/₁₀ Var^s distant on other Post Oak 22 Inches
 in diameter bears S 79° W 8 ⁴/₁₀ Nor^s distant
 Thence N 54° E

220
 1300
 2440
 6500

a Creek 2 V^s wide C. S. E
 a Branch 1 V^s wide C. S. E
 a Branch 1 Var wide C. S. E
 Set a post and made a mound 3rd Corner from
 which a B. Oak 12 Inches in diameter bears
 N 30° W 8 ⁶/₁₀ Var^s distant on other B. Oak 14 Inches
 in diameter bears S 36° E 14 ²/₁₀ Var^s distant
 Thence N 35° W

3800 ²/₁₀

Set a post and made a mound 4th Corner from
 which a Post Oak 16 Inches in diameter bears
 S 49° E 10 Var^s distant on other Post Oak
 18 Inches in diameter bears N 26° E 8 ⁶/₁₀ Var^s
 distant Thence S 54° W
 St. Antone Road

1080
 6500

To the place of Beginning Timber Hickory
 mostly Post Oak other Oak some Pine &c
 4 laborers Arable Ballane Grazing Land

Jeremiah Strode
 Surveyor

The following is a list of
 names of persons who
 were present at the
 meeting of the
 Board of Directors
 held on the 15th day
 of January 1882
 at the City of New York
 at the office of the
 Secretary of the
 Board of Directors
 of the
 City of New York
 at the office of the
 Secretary of the
 Board of Directors
 of the
 City of New York

Wth Arthur Henric

Surveyor Inspector
Hacgdoches

Wth Henry Mastby Jr. & Son
and Order of Survey —

— " — " —

34
 December 30, 1834
 700 a. Dec 27/34
 100 20. p 55
 Houston Co
 N.M.G.

Distance from December 14th 1834 Then I surveyed for Cheever 30.
 314
 30.
 Buysle one League of Land on Major Creek
 and Pettreys Bayou Branches of the Rocky
 beginning on the North Side of said Major
 Creek planted a post and made a mound
 1st Corner from which a B Jack 11 Inches in
 in diameter bears S 74 1/2 W 4 5/10 Variat distant
 a Hickory 17 Inches in diameter bears East
 14 2/10 V^s distant Thence South
 Major Creek C. & 2 V^s wide

220
 1400
 3250

a Branch C. & 2 V^s wide
 Set a post and made a Mound Division
 Corner from which a B Jack 8 Inches in dia
 bears S 54 W 14 1/10 V^s distant an other B Jack
 14 Inches in diameter bears N 51 E 28 2/10 V^s
 distant

5250
 6500

Pettreys Bayou 4 V^s wide C. East
 Set a post and made a Mound 2nd Corner
 from which a B Oak 18 Inches in diameter
 bears N 61 1/2 E 4 4/10 V^s distant a pine 8 Inch
 in diameter bears N 20 1/2 E 4 5/11 V^s distant
 Thence East

800
 2200
 3846 2

a creek 2 V^s in width C. North
 a creek same Bottom C. North 2 V^s in width
 set a Post and made a Mound 3rd Corner from which a
 B. Oak 30 Inches in diameter bears S. 49 W. 6 V^s distant
 a B. Jack 12 Inches in diameter bears S. 38 E 11 1/10 V^s distant
 Thence North

3250
 4300
 4700
 6500

set a Post and made a Mound Division Corner from
 which a Pine 12 Inches in diameter bears S. 66 W 4 1/10 V^s distant
 a Hickory 12 Inches in diameter bears S. 87 E 7 1/10 V^s distant
 a Branch C. N. W.
 a large creek 4 V^s in width C. N. E.

4700
 3846 2

Planted a Post and made a Mound 4th Corner from wh
 a Post Oak 24 Inches in diameter bears N. 68 W. 3 3/10 V^s dista
 another Post Oak 16 Inches in diameter bears S. 78 W. 10 1/10 V^s
 distant. Thence West
 a Branch N. in width C. South
 To the place of Beginning of Labor & to divide the
 balance Grazing Land

Trimeter pin Hickory Oak and ash Elm &
20th Commenced at the 5th corner Division
Measured on a true magnetic line East

3446 To the other Division corner

Jeremiah Strode
Surveyor

[Faint, mostly illegible handwritten text follows, likely a survey report or deed description.]

Handwritten text in vertical columns, likely bleed-through from the reverse side of the page. The characters are faint and difficult to decipher.

Ms
Arthur Stinnie
Inspector

Stinnie
Inspector

Distance

Inters

Collins Aldrich
9th July 1835
Vol. 20. p. 127

Houston Co.
May

J. Vekler 31

December 23rd 1834 Then Surveyed for Mr. Collin Aldridge one League of Land Situate on the waters of Trinity and including the place where he now lives set a post and made a Mound 1st Corner on the line of a Survey made for or claimed a Mr. Cummons in the Mustang Prairie from which a post Oak 14 Inches in diameter bears N 40° E 205⁰ distant another post Oak 15 Inches in diameter bears N 73° E 155⁰ Var.^s distant,

Thence N 54 1/2 East

cross a Creek C. C. 17 1/2 V. wide
planted a post and made a Mound 2nd Corner from which a post Oak 20 Inches in diam bears N 83° E 4 1/10 Var.^s distant a B. Oak 18 Inches in diameter bears S 19° W 5 1/10 V. distant

Thence S 35 1/2 E

a Creek C. S. E. 2 V. wide

The S. Antonio Road

Planted a post and made a mound 3rd Corner from which a post Oak 18 Inches in diameter bears N 80° W 1 5/10 V. distant on a tree post Oak 24 Inches in diameter bears N 20° W 3 V. distant

Thence S 54 1/2 W

a Creek C. N. W. 3 V. wide

Set a post and made a Mound 4th Corner from which a post Oak 18 Inches in diam bears S 41° W 2 5/10 V. distant a B. Oak ~~18~~ 24 Inches in diameter bears N 47° E 5 V. distant

Thence N 35 1/2 West

a Creek C. S. 4 V. wide

To the place of Beginning Timber Hickory Oak &c 2 Labors Arable Canyon Bottom
1 Labor arable up land Balance Grazing Land

Jenniah Shode
Surveyor

2215

5000

1150

1520

5000

4980

5000

1500

5000

\$20-00 is due the Survey which
is requested to be lodged with Mr
Arthur Thomas, Surveyor

Mr Arthur Thomas

Inspector Surveyor

James Thomas

Decy 24th

34
 Distant To the
 Francis B. Conner
 7th Dec 14/35
 vol 20 p 171
 Houston Co.
 1835

January 24th 1835 Then Survey for Mr. Francis B. Conner one League of Land on the Nagal Bayou adjoining Reuter R. Russells Survey beginning at a post in a mound 5th corner from which a pine 12 Inches in diameter bears S 66 4/4 W distant a Hickory 12 Inches in diameter bears S 47 E 7 1/10 V. distant then is a diversion corner of Russells Survey Thence N 60 E a Bayou 2 V. wide C & R

700
 4400
 6600

set a post and made a mound 2nd corner from which a Post Oak 30 Inches in diameter bears N 31 1/2 W 12 V. distant another post Oak 35 Inches in diameter bears N 58 1/4 W 12 1/10 distant

2800
 3400

Thence North Bayou Nagal 4 V. wide C.S.C set a post and made a mound 3rd corner from which a pine 28 Inches in diameter bears East 4 6/10 V. distant another pine 24 Inches in diameter bears S 14 1/2 E 1/10 distant

1625

Thence S 60 W set a post and made a mound 4th corner from which a Post Oak 15 Inches in diameter bears N 44 1/2 E 6 2/10 distant another Post Oak 10 Inches in diameter bears N 45 E 9 V. distant

400
 800

Thence North set a post and made a mound 5th corner from which a Post Oak 12 Inches in diameter bears N 77 1/4 W 2 6/10 V. distant another Post Oak 14 Inches in diameter bears S 88 E 7 2/10 distant

3250

Thence S 60 W set a post and made a mound 6th corner from which a Post Oak 14 Inches in diameter bears N 74 E 4 V. distant a Post Oak 9 Inches in diameter bears S 2 1/2 E 8 V. distant

300
 400

Thence South a Branch 1 V. wide C.S.C set a post and made a mound 7th corner from which a Post Oak 14 Inches in diameter bears S 33 E 6 7/10 V. distant a Hickory 14 Inches in diameter bears N 70 E 4 V. distant

1725

Thence South set a post and made a mound 8th corner from which a Spanish Oak 15 Inches in diameter bears North 2 V. distant a Hickory 18 Inches in diameter bears S 70 W 5 V. distant

200
 2000
 3800

Thence South Russells Corner Bayou Nagal to place of beginning Timber pine Hickory Oak Gum Elm Gum &c. Cane bottoms but subject to Inundation, 4 Labors Arable Ballance Fertile Land
 Jeremiah Stodd
 Surveyor

Varras Timber June 3rd 1835 This Survey is for W. Miguel de las ^{5^{as}} _{Coas}

Miguel de las Coas
Site July 11th - Vol 19 p 169
Smith of Cherokee Co.

Scitis or League of Land Situate in D. G. Burnett's Grant on the waters of the Angilina Beginning at James Hamilton S. E. Corner a Post in a Mound 1st Corner from which a B. Oak 10 Inches in diameter bears S 71^o W 9 Varras distant another B. Oak 7 Inches in diameter bears S 64^o E 8 Varras distant
Thence East

5000

Set a post and made a mound 2nd Corner from which a Black Gum 10 Inches in diameter bears N 7^o E 5 Varras distant a White Oak 13 Inches in diameter bears S 36^o E 6 Varras distant
Thence North

3440

a Spring Branch 1 Varras wide S. E

3660

a Creek 2 Varras wide S. E

5000

Set a Post and made a Mound 3rd Corner from which a Willow 8 Inches in diameter bears S 16^o W 10 Varras distant a Sweet Gum 9 Inches in diameter bears N 62^o E 17 Varras distant
Thence West

5000

Set a Post and made a Mound 4th Corner from which a Red Oak 14 Inches in diameter bears N 3^o W 2 Varras distant a Post Oak 16 Inches in diameter bears S 70^o W 4 Varras distant
Thence South

5000

To the place of Beginning Timber Hickory Oak Ash Gum Elm Pine &c Creek Bottom cane 14 Laborers Arbores Myrsine Grazing Land

Jeremiah Stodd
Surveyor

Mr Arthur Hume

Secretary

11-11-11

Thomas R. Townsend
 Feb. 7/35 Vol. 18 p. 127
 Houston 20.40

35.
 January 7th 1835 - Then Surveyed for Thomas
 Townsend one League of Land on the waters
 of Trinity River including the place where he
 lives Set a post and made a Mound 5th
 corner in Elisha Clapps N & E Boundary line
 from which Mound a B. Jack 10 Inches in
 diameter bears S 90° E 3 Varas distant another
 B Jack 12 Inches in diameter bears N 72° E
 10⁴/₁₀ Varas distant Thence N 54⁷/₂ East
 Road leading to American Bayou C. ~~S~~ North
 a Branch 1¹/₂ wide C.S.

3895
 4400
 5000

Set a post and made a mound 2nd corner
 from which a B Jack 9 Inches in diameter bears
 S 78° W 3 Varas distant another B Jack 24 Inches
 in diameter bears S 77° E 10 Varas distant
 Thence S 35⁷/₂ E

1900
 5000

The St. Antonio Road C.S.
 Set a post and made a mound 3rd corner
 from which a Red Oak 24 Inches in diameter
 bears S 15° W 5¹/₂ distant a Hickory 18 Inches
 in diameter bears ~~S 15° W~~ 5¹/₂ distant
 Thence S 54¹/₂ W

2400
 3400
 5000

a Spring Branch C.S.
 a Branch 1¹/₂ wide C.S.
 Set a post and made a mound 4th corner
 in Collan Aldridges line from which a B Jack
 14 Inches in diameter bears N 66° E 2 Varas distant
 a Red Oak 18 Inches in diameter bears S 74° W
 13 Varas distant

2155
 2555
 3650
 5000

Thence N 35⁷/₂ W with Aldridges line
 St. Antonio Road
 a Creek 2¹/₂ wide C.S.
 Aldridges an Clapps Corner
 To the place of beginning Timber Oak
 Hickory some pine 3 Laborer stable
 Ballance grazing Land

Jeremiah Shode
 Surveyor

th
 June 11th 1735 Then Surveyed for Mr. Larkin Baker one
 Section or League of Land Situate on the Waters of
 the Angilena Beginning at Isaac Thindrichs N. 88
 corner ~~and~~ a post in a mound 1st corner from
 which a B. Jack 12 Inches in diameter bears N 29° E
 3 Varas distant another B. Jack 15 Inches in diameter
 bears S 67° W 12 Varas distant

Larkin Baker
 1738 June 11/35
 vol 18. p. 385

Cherokee Co

4000

Thence North with C. Hahitz line
 to His corner a post in a Mound 2nd corner from
 which a Hickory 9 Inches in diameter bears N 62° W 9 Var.
 distant another Hickory 6 Inches in diameter bears N 77° W
 4² Varas distant Thence ^{East} with ^{Hamilton's} Congledows line
 a Spring Branch 1 Varas wide S 88°
 passing his corner

2400
5000

6250

Set a Post and Made a Mound 3rd corner from
 which a B. Jack 9 Inches in diameter bears S 57° E 16
 distant another B. Jack 11 Inches in diameter bears
 N 75° E 11 Varas distant

4000

Thence South
 Adolph Sternes line Set a Post and made
 a Mound 4th corner from which a Red Oak
 7 Inches in diameter bears S 50° W 4 Varas distant
 a B. Jack 11 Inches in diameter bears S 12° E 12 Var.
 distant Thence West

6250

To the place of Beginning Timber Hickory
 Oak Ash Elm 16 Labors Arable Residence
 Grazing Land
 Jeremiah Strode
 Surveyor

6250
 4000

 25,00000

2587 I Burnett 124

Varra. Yuthy March 27th 1835 then Surveyed for ~~all~~ ~~the~~ ~~land~~
 one Sixth or League of Land Situate on the waters
 of Trinity on Boxes Creek set a Post and made 3rd
 Corner from which a B. Oak 30 Inches in diameter
 bears N 44^o W 5^o Varra distant a Hickory 7 Inches in
 diameter bears S 10^o E 1^o 10^o Varra distant

Thence S 65^o W

5500

Set a post and made a mound 2nd from which
 a B. Oak 9 Inches in diameter bears N 40^o E 3^o 10^o
 Varra distant another B. Oak 4 Inches in
 diameter bears S 57^o E 3^o Varra distant

Thence S 25^o E

3000

a Creek 2^o 10^o wide C. S. 44

4545

4/10 Set a Post and made a mound 3rd Corner
 from which a Pine 36 Inches in diameter
 bears N 78^o W 12^o 10^o Varra distant a Post oak
 20 Inches in diameter bears N 60^o E 4^o 10^o
 Varra distant

Thence N 65^o E

5500

Set a post and made a mound 4th Corner
 from which a Post Oak 22 Inches in diam.
 bears S 80^o E 6^o 10^o Varra distant a Pine 24
 Inches in diameter bears South 8^o 10^o Varra
 distant Thence N 25^o W

4545

4/10 To the place of beginning Timber
 Oak Hickory Ash Elm Gum Pine
 &c 6 laborer & rable Rypidue
 Grazing Land Jimmie Shool
 Surveyor

11-11

Reuben Brown
 5th May 20/35.
 10th 18th 275
 Anderson &
 1872

43

Samuel L. Post

7th May 8/35

vol 18. p. 239.

Anderson co

March 19 35
 C. Bax one League of Land Situated on Trinity Town
 adjoining on the lower line of his Brother's land
 W. Bax's Survey beginning at his lower corner
 a post in a mound 1st corner from which an
 Elm 20 Inches in diameter bears S 57 1/2 W 5 1/2 Dist^{ce}
 another Elm 19 Inches in diameter bears N 81 1/2 E
 4 1/10 Varas distant

38.

10305

in title 5.75 E

Thence N 75^o E with the W. Bax's line
 set a post and made a mound 2nd corner
 from which a B. Oak 15 Inches in diameter bears
 S 16 1/2 E 12 Varas distant and the B. Oak 18 Inches
 in diameter bears N 85 1/2 E 9 1/10 Varas distant

Thence S 15^o E

995

Lower Barnanah Trace

2500

Set a post and made a mound 3rd corner from
 which a B. Oak 15 Inches in diameter bears
 N 76^o W 2 1/10 Varas distant and the B. Oak 10
 Inches in diameter bears S 39 1/2 E 6 1/10 Varas distant

Thence S 75^o W

955

To the Margin of Trinity set a post and
 made a mound 4th corner from which an
 Elm 19 Inches in diameter bears N 52^o E 10 1/10 Varas distant
 Hickory 14 Inches in diameter bears S 69 1/2 W 4
 Varas distant

9855

Thence up the River with its alleys
 -ous as follows (to wit) N 40^o W 52 1/2 Varas thence
 N 13 1/2 W 1500 Varas thence N 28^o W 400 Varas
 thence N 77^o W 250 Varas to the place of
 beginning Timber Ash Elm Oak Hickory
 &c. a Laborer Able Repidus Grazing
 Land

Jamieson Shode
 Surveyor

11-11

1835
 Surveyed for M. Steph
 Crist one League of Land Situated on a creek
 fork of Parker Creek about 3 miles above
 the Upper Camanche Trace 8 or 9 Miles above
 the junction of said Creek with the Trinity
 River Beginning on the West Side of said
 Fork Set a post and made a mound 1st
 Corner from which a B. Oak 9 Inches in
 diameter bears S 60° E 2 ⁴/₁₀ Var. distant an
 other B. Oak 10 Inches in diameter bears N 48°
 E 2 ⁶/₁₀ Var. distant

Stephen Crist

file May 21/35
100.18 p 285 Andersons Co

Thence North

6500

Set a post and made a mound 2nd Corner
 from which a Hickory 20 Inches in diameter
 bears S 57° E 2 ⁵/₁₀ Var. distant a B. Oak 14 Inches
 in diameter bears S 13° E 8 ²/₁₀ Var. distant

Thence East

3846

²/₁₀

Set a post and made a mound 3rd Corner
 from which a Hickory 19 Inches in diameter
 bears N 62° E 9 ²/₁₀ Var. distant a B. Oak 22 Inches
 in diameter bears S 57 ⁵/₂ E 14 ⁶/₁₀ Var. distant

Thence South

6500

Set a post and made a mound 4th Corner
 from which a B. Oak 19 Inches in diameter
 bears N 14° W 9 ²/₁₀ Var. distant a B. Oak 22 Inches
 in diameter bears S 74° W 9 ²/₁₀ Var. distant

Thence West

442

3846

²/₁₀

a Creek Cuts Fork 2 ¹/₂ miles C. S. E
 To the place of Beginning Timber Hickory
 Oak ash sycamore bottoms narrow upland broken
 3 Laborer Arable pipedue grazing
 Land

Jeremiah Stocke
 Surveyor
 11 ————— 11

45
Donas June 16th 1835 Then Survey for Mr. George May one
Section or League of Land Situate in D. G. Barnets Grant
on the Waters of the Angelina Beginning on the
margin of the Branch of Saide Creek on the N. W
Side thereof in the S. E Boundary line of
Survey Set a Post and made a Mound
1st Corner from which a Pine 7 Inches in diameter bears
N 32° W 4 Varas distant a white Oak 17 Inches in diam-
-eter S 34° W 9 Varas distant

Thence S 24° W

2450

Set a Post and made a mound 2nd Corner from
which a Sweet Gum 16 Inches in diameter bears N 40° E
4 Varas distant a Hickory 18 Inches in diameter bears
S 10° E 5 Varas distant

Thence N 65° W

420

a Creek 2 Varas wide S. E
Set a post and made a Mound 3 Corner from which
a Post Oak 23 Inches in diameter bears S 36° E
3 Varas distant an other Post Oak 15 Inches in
diameter bears N 75° W 10 Varas distant

Thence N 24° E

2450

Set a Post and made a mound 4 Corner from which
a Post Oak 20 Inches in diameter bears N 27° W 2 Var.
distant a B. Oak 10 Inches in diameter bears N 61° E
3 Varas distant

Thence S 65° E

790

a Corner of Survey
thence with his line and the line of an other survey
To the place of beginning 20 Laborers Able
Residue Graying Land Timber Hickory
Sugar Gum Oak ash &c

9090

Jeremiah Stone
Surveyor
" "

George May
17th June 20/35
page 18 p 445

Book 3
p 119

B 46 J 110

Mr. Arthur Ferris

Haystack

" "

Jesse H. Chambers
7th May 1835
Vol 18. P. 335.

46
Rowk Co.
pms

April 30th 1835. Then Surveyed for Jesse H. Chambers
one fourth of a Section or League of Land Near Joseph Durt
Survey on the waters of The Angilena Beginning at Mrs
Maria Sofonia Gonzalez N. W. Corner a post in a mound
1st Corner from which a post Oak 24 Inches in diameter bears
S 72° E 4 Vars distant an other Post oak 26 Inches in diameter
bears N 47° W 10 Varras distant

Thence N 24° E

a Branch 2 Vars wide C. S. W

Set a post and made a mound 2nd Corner from which a
White Oak 10 Inches in diameter bears N 24 1/2° E 8 Varras
distant a Black Oak 8 Inches in diameter bears South
3 Varras distant

Thence ~~S 65° E~~ N 65 1/2° W

Set a post and made a mound 3rd Corner from which
a Willow a Post oak 24 Inches in diameter bears N 30° E 5 1/2
distant an other Post oak 24 Inches in diameter bears S 75° E
4 Varras distant

Thence S 24 1/2° W

Set a post and made a mound 4th Corner from which
a Willow Oak 20 Inches in diameter bears N 40° W 3 Varras
distant a Hickory 9 Inches in diameter bears S 72° E 12 Vars
distant

Thence S 65 1/2° E

a Branch of Angilena 4 Vars wide C. S.
To the place of Beginning Timber Oak Hickory
B. Walnut Ash Elm Gum &c & Labors Arable
Meyside Grazing Land

Jeremiah Stode
Surveyor



1600

2500

2500

2500

800

2500

47
Varias, June 11th 1835 Then Surveyed for W. Isaac

Hindrick one Section or League of Land Situate in
D. G. Burnett's Grant on the waters of the Angelina about
6 Miles West of Shickers Village including an Improvement
Made by William Williams and George May in the Month
of November last at the Forks of a Path leading from the Spring
on the Naches to Shickers Village Beginning ^{by a line} at a post and
making a Mound 5th Corner from which a Post Oak 14
Inches in diameter bears S 70° W 4 Varas distant a Hickory
10 Inches in diameter bears S 41° W 4 Varas distant

Thence North

a Creek 2 Varas wide C. E
Set a Post and made a Mound 2nd Corner from which
a Post Oak 12 Inches in diameter bears N 29° E 3 Varas distant
another Post Oak 15 Inches in diameter bears S 67° W 12 Varas
distant Thence West

Set a Post and made a Mound 3rd Corner from which
a Post Oak 9 Inches in diameter bears N 43° W 3 Varas
distant another Post Oak 12 Inches in diameter bears
S 96° W 7 Varas distant

Thence South

Set a post and made a Mound 4th Corner from which
a Post Oak 10 Inches in diameter bears S 57° W 25 Varas
distant another Post Oak 19 Inches in diameter bears N 98°
W 40 Varas distant

Thence East

To the Place of Beginning Timber Oak Hickory
Lynn Walnut Elm &c 19 Laborers unable to reside
Grazing Land
Jeremiah Stode
Surveyor
" "

Notes Sent

705
5000
5000

5000
5000

5000
5000

5000

Faci Hindrick
7th June 1835
Vol 18 p. 333
Hindrick

12

Mr. John Harris

Scagdale

11

Caras Entire March 14th 1835 Then Surveyed for Mr. David

Stephen Rogers
Total Dec 30/34
Vol 18. p. 31.

~~Booker~~ Stephen Rogers one League or Section
of Land Situate in David G. Burnetts Grant
on the waters of San Pedro Creek and
adjoining the Survey of Martin Murchison
and including the Grass house Strains
and Colony and bounded as follows
Beginning at a Stone Colony corner in
S. Murchison's line around which made a
Mound 5th Corner from which a Post oak
24 Inches in diameter bears N 12^o W 49^o/₁₀ Dist.
distant a Post oak 24 Inches in diameter bears
S 22^o W 45^o Varas distant

1055

Thence West with Murchison's line
to Murchison's S. W. Corner a Stone 2nd
Corner from which a Post oak 8 Inches in dia-
meter bears N 35^o W 9^o/₁₀ Var distant another
Post oak 16 Inches in diameter bears S 39^o
13^o/₁₀ Varas distant

2000

Thence North with another of
Murchison's lines
Set a post and made a Mound 3rd Corner
from which a Post oak 14 Inches in diameter
bears N 65^o W 3^o/₁₀ Varas distant a Hickory
12 Inches in diameter bears S 18^o W 18^o/₁₀ Dist.

2100

Thence West
Set a Post and made a Mound 4th Corner
from which a Post oak 14 Inches in diameter
bears S 12^o W 75^o/₁₀ Varas distant a Post oak
4 Inches in diameter bears S 6^o E 39^o/₁₀ Var
distant

1000

Thence South
Set a post and made a Mound 5th Corner
from which a Post oak 16 Inches in diameter
bears S 44^o W 66^o/₁₀ Varas distant a Post oak
6 Inches in diameter bears S 18^o W 67^o/₁₀ Dist.

1420
2025

Thence West
a Creek etc. Var. wide C. S. E.
Set Post and made a Mound 6th Corner
Turn over

Claras ~~Entr~~

from which a B Oak 20 Inches in diameter
bear S 59° E 110² Claras distant a post Oak 9
Inches in diameter bear, N 35° W 1⁸/₁₀ Claras distant
Thence South

4622

Set a post and made a Mound 7^m Corner from
which a B Oak 24 Inches in diameter bear
S 17° E 12⁴/₁₀ Claras distant a post Oak 6 Inches
in diameter bear, South of Claras distant

Thence East

5189

5120

Set a Post and made a Mound 8^m Corner
from which a B Oak 17 Inches in diameter
bear, N 77° E 1¹/₁₀ Claras distant and the B Oak
16 Inches in diameter bear, N 39° W 5⁶/₁₀ P. distant

Thence North

24

⁴/₁₀

To Eden's S W Corner

3622

With Eden's line to the place of Beginning
Vineyard Hickory Oak Ash Elm Pine &c
4 ~~Woods~~ ^{Labors} Arable Peppercorn Grazing
Juniper Stodd

Mr Arthur Merrick

Surveyor Inspector

Washington D.C.

50
 Martin Murchison December 14th Surveyed for Martin Murchison
 Dec 30/34
 Vol. 18. p. 38.
 Houston Co. a Hackberry 20 Inches in diameter bears N 57^o W 48 10^o distant
 another Hackberry 12 Inches in diameter bears S 70^o E 66^o distant

Distance in fms

4908
 corner to John Correll then N 45^o E 7000
 passed John Correll's corner

9600
 Planted a post and made a mound 2nd corner
 from which a Double B Oak 30 Inches in
 diameter bears N 44^o W 10^o distant and other
 B Oak 32 Inches in diameter bears S 21^o W
 12^o 10^o distant

2300
 Thence N 45^o W
 Set a post and made a mound 3rd corner
 from which a B Jack 15 Inches in diameter bears
 S 75^o E 5^o distant and other B Jack 10^o in
 diameter bears N 38^o W 3^o distant

6700
 Thence N 45^o W
 a creek 5 Var wide E South

10400
 Trinity, Set a post and made a mound 4th corner
 Thence down the River with its several Meanders

240 - 1 S 66^o E
 130 - 2 S 74^o E
 200 - 3 S 64^o E
 100 - 4 S 54^o 1/2 W

(200) - 5 South Crossed Shodes Creek at the Mouth

500 - 6 Course continued

250 - 7 S 45^o E
 300 - 8 East
 250 - 9 N 60^o E
 300 - 10 North
 250 - 11 N 57^o E
 300 - 12 S 41^o E
 400 - 13 S 22^o E
 200 - 14 S 46^o 1/2 E
 100 - 15 S 56^o E
 325 - 16 S 64^o E to the place of Beginning

The River better
 Subject to Inundation
 - than Summer
 - Gum Sider and
 - Hackberry Oak
 &c
 3 Labours is
 available the best
 - for Grazing
 Land
 Jeremiah Shad
 Surveyor

Mr Arthur Thomas

Examining Surgeon

St George's Hill

51
Jacob Roth
17th June 1835
we 18. p. 377

May 12. 1835 Then Surveyor for Jacob Roth
one Section or League of Land in D. G. Burnetts Grant
Beginning at ~~the~~ N. W. Corner
on the waters of Angelina a post in a Mound from which
a B. Oak 18 Inches in diameter bears N 74° E 7 ²/₁₀ Varas distant
an other B. Oak 6 Inches in diameter bears N 80° W 6 ⁷/₁₀
Varas distant Thence N 65 ¹/₂ W

5000

Set a Post and Made a Mound 2nd Corner from which
a Post Oak 30 Inches in diameter bears S 57° W 4 Varas
distant an other Post Oak 32 Inches in diameter
bears N 74° W 7 Varas distant
Thence N 24 ¹/₂ E

3300

a Branch 1 Varra wide C. N. E.

4400

a Spring Branch 1 ¹/₂ Var. wide C. N. E.

5000

Set a Post and Made a Mound 3rd Corner from which
a B. Oak 10 Inches in diameter bears N 71° W 4 Varas
distant an other B. Oak 7 Inches in diameter bears S 52° E
4 Var. distant Thence S 65 ¹/₂ E

2400

a Creek 3 Varas wide C. S. E.

5000

with ~~the~~ line a Post in a Mound 4th Corner
from which a B. Oak 20 Inches in diameter bears E ~~60~~
7 ⁶/₁₀ Varas distant an other B. Oak 30 Inches in diameter
bears N 24° E 2 ⁴/₁₀ Varas distant

5000

Thence S 24 ¹/₂ W with ~~the~~ line
To the place of Beginning Timber Hickory Oak
ash Elm Walnut 14 Labors Arable residue
Grazing Land Jeremiah Shode
Surveyor

B. 131.

María Simforosa Gonzales

Varras Timber
María Simforosa Gonzales
9th May 1935. Vol. 18. p. 325
Buck Co. Ky

April 29th 1835. Then Surveyed for M^{rs} ~~María~~ Gonzales
one Section of League of Land adjoining M^{rs} Joseph
Perez Falcon beginning at her N.W. Corner a post
in Stone Maund 1st Corner from which a Black Oak
4 Inches in diameter bears S 71° 46' 20" Varas distant a
Black Oak 15 Inches in diameter bears N 35° 48' 10" distant

Thence N 65 1/2 W

a Branch 1 1/2 V^s wide C. S

Set a post and made a Maund 2nd Corner from
which a post Oak 24 Inches in diameter bears
S 7° E 4 Varas distant another post Oak 26 Inches
in diameter bears N 47° W 10 Varas distant

Thence N 24 1/2 E

a Branch 1 1/2 V^s wide C. S. W

Planted
Set a post and made a Maund 3rd Corner from
which a post Oak 24 Inches in diameter bears
N 15° E 14 Varas distant a Red Oak 24 Inches in diam
bears S 10° E 9 Varas distant

Thence South 65 1/2 E

M^{rs} Joseph Perez Falcon Corner a post in a
Maund 4th Corner from which a Post Oak 20 In^{ch}
in diameter bears N 35° W 25 V^s distant another post Oak
17 Inches in diameter bears S 8° E 60 Varas distant

Thence S 24 1/2 W with M^{rs} Falcon's line

To the place of Beginning Timber Hickory Oak
ash Elm Gum G. c. ~~12~~ 15 Labors Able
Residue Grazing Land

Jeremiah Stodd
Surveyor

2200

5000

1600

5000

5000

5000

Garrison Greenwood
Title Map 535. vol. 18, p. 183.
Houston Co. N.D. 1835

February 25. 1835 Then Surveyed for Garrison Greenwood one League of Land adjoining John La Riviere on the North Fork of Elk Hart Creek beginning at his South West Corner a post in a mound 1st Corner from which a B. Jack 14 Inches in diameter bears N 37 4/10 W or Var distant another B. Jack 16 Inches in diameter bears N 75 7/10 E 9 8/10 Var distant Thence N 33 5/10 W

5580
5900
6700

4/10

Dividing Corner
North Fork of Elk Hart C.S.W
Set a post and made a mound 2nd Corner from which a B. Jack 9 Inches in diameter bears N 77 8/10 E 4 Var^s distant another B. Jack 7 Inches in diameter bears S 56 6/10 W or Var distant
Thence N 53 5/10 E

3791

3/10

Set a post and made a mound 3rd Corner from which a Red Oak 30 Inches in diameter bears S 42 4/10 W 19 2/10 Var distant another Red Oak 32 Inches in diameter bears S 4 4/10 W 24 6/10 Var distant
Thence S 35 5/10 E

246
6700

North Fork of Elk Hart 4th Row wide 6 3/4
Set a post and made a mound 4th Corner from which a Hickory 15 Inches in diameter bears N 69 3/4 W 25 4/10 Var distant a B. Jack 10 Inch in diameter bears N 49 4/10 W 19 6/10 Var distant
Thence S 55 5/10 W

3791

3/10

To the place of beginning Timber Hickory Oak &c. 6 Acre Bottoms gave 4 Laborer Noble Residence Grazing Land

Jeremiah Stodd
Surveyor
" - "

On record

Prepared

Wm Arthur Fennie

Surveyor of Land

Harrodsburg

Warrar
 Jose Maria Martin
 Title May 23/35
 Vol 18 p. 271
 Book 57
 1872

I B. 12 146
~~April 30~~ May 1. 1835 Then Survey one Section or League
 of Land for W^m Jose Maria Martin on the waters
 of The Angitina in D^y Burnets Grant Beginning
 at Joseph Darts & W^m Line Set a post and made a mound
 1st Corner from which a Hickory bears N 65^o W 10
 Warrar distant a post Oak 4 Inches in diameter bears
 N 45^o E 3 Warrar distant.

9500

Thence West passing ~~two~~ two of William
 Razans Corner and with the line of another Survey
 Set a post and made a mound 2^d Corner from which
 a ~~post~~ Gum 12 Inches in diameter bears S 78^o W 2 Warrar
 distant a Red Oak 24 Inches in diameter bears ~~S 63^o 55^o E 40^o 30^o~~
 Warrar distant

4450

Thence N 20^o W
 Jose Chambers Corner a post in a mound 3 Corner
 from which a post Oak 24 Inches in diameter bears
 S 12^o 48^o 4 Warrar distant another post Oak 24 Inches in
 diameter bears S 78^o W 9 Warrar distant

700

Thence S 65^o E
 a branch War wide G. South
 To the Place of Beginning Timber Hickory Pine
 Oak Elm G^o Labours arable Pysider grazing
 Land
 J. J. Shode
 Surveyor

12500

12500~~0~~ 73950
 1975
 12500

 98750
 3650
 1975

 2468750

Mr. William Harris

Georgetown

~~Handwritten signature~~
C. W. Harris

Distance South

ADP

November 19th 1734

Joseph Wecker
of Va. Nov 21/34
Nov 18 p. 7

Made a mound and set a Post at the beginning of Jose Wecker's Survey on the West bank of Bayou of what is known by the name of Branch of the Angilena about: above the crossing of the Cherry Tree Trace from which a B. Walnut 18 Inches in diameter bears N 58 W distant 24 Var; a B Oak 30 Inches dia bears N 58 ¹⁰ E distant ^{21 5} ~~24~~ Var

Thence East

3000
25
2450
3700
5000

Thence East crossed the Bayou at, Genl course of Bayou North crossed the Cherry Tree Trace at. the course of the trace here is North, crossed another Bayou course N 65 ² E in all

750
10 50
45 50
5000

2nd Corner Set a Post and made a Mound from which a B. Oak 20 Inches in diameter bears Sp 2 ¹ 2 W distant 32 Var; a Hickory 14 Inches in diameter bears N 18 W distant 8 ² ~~10~~ W^s Thence North crossed Small Running Bayou 2 Varas wide course N 45 E crossed a Spring Branch 1 Varas wide course West crossed a Bayou 2 Varas wide course N 30 E in all to the 3rd Corner

5000

Set a Post and made a Mound from which a B Oak 8 Inches in diameter bears S 6 E distant 23 ² ~~16~~ Va. a Hickory 12 Inches in diameter bears N 33 E distant 20 ² ~~10~~ Va. Thence West over a Ridge to the 4th Corner

Set a Post and made a Mound (in a cane bottom) from which a Maple 8 Inches in diameter bears N 10 ¹ 2 W distant 5 Va. a Lynn 12 Inches in diameter bears S 6 E distant 5 Va.

40
1730
5000

Thence South crossed the Bayou 5th named 2 ¹ ~~10~~ wide crossed the Cherry Tree Trace again course N W in all to the place of Beginning containing one League of Land one half of which is Arable. the balance Grazing Land

Jenniah Stodd Surveyor

56

John Parkers
972 May 21/35
Vol 18 p 369.
Anderson Co Ark

50

B. 95

March 28th 1835 Then surveyed for John Parker
one 40th section or League of Land Situate on the
East fork of Parkers Creek about 4 Miles below Stephen
Cristo Survey and on the upper Canioncha
Trail set a Post and made a Mound & Corn
from which a Sweet Gum 24 Inches in diameter
bears N 34 4/10 W. 46 Paces distant a Dogal 14 Inches
in diameter bears S 6 1/2 W. E 3 2/10 N. distant
Thence N 20° E

1796

1/10

Set a Post and made a Mound 2nd Corner from
which a B. Oak 10 Inches in diameter bears N 55° E
2 6/10 N. distant on the B. Oak 18 Inches in diameter
bears S 37 1/2 W. 9 6/10 Paces distant
Thence S 70° E

3600

Set a Post and made a Mound 3rd Corner from
which a Pine 14 Inches in diameter bears N 69° E
4 4/10 Paces distant a Post Oak 15 Inches in
diameter bears S 74 1/2 W. N 3 2/10 W. distant
Thence S 20° W

520

1736

1/10

a Parkers Creek 2 Var. wide 6.5 ft
Set a post and made a Mound 4th Corner
from which a B. Oak 10 Inches in diameter
bears S 65 1/2 E 5 Paces distant a Post Oak 15
Inches in diameter bears S 30° E 9 6/10 Paces
distant Thence S 70° W

3530

3600

a Creek 3 Paces wide 6.5 ft
To the Place of Beginning Timber Gum
Elm Oak Hickory &c &c 2 Labours or able
Persons Grazing Land

Jeremiah Stodd
Surveyor

11

John Parker Street

Mr Arthur Fenice

Surveyor Inspector

Harrogate

Varas 57
Romano Gonzales
Pise May 1755
Vol 18 Op. 307

April 29th
~~May 1755~~ Then survey for Romano Gonzales one
fourth of a Section of Land in D. G. Barnilla
Grant on the waters of the Guigilena 5 or 6 miles from
Joseph Ducta Survey beginning at Joseph I. Jose
H. Chamber S. West corner a Post in mound 5
corner from which a post Oak 24 Inches bear $S 12^{\circ} W$
4 Varas distant another Post oak 24 Inches in diameter
bear $N 48^{\circ} W$ 9 Varas distant
Thence ~~to~~ $S 71^{\circ} W$

700
2500

a Branch 1 Vara wide 6 1/4
Set a post and made a mound 2nd corner from
which a Red Oak 12 Inches in diameter bear $N 50^{\circ} W$
6 Varas distant a post Oak 24 Inches in diameter
bear $S 22^{\circ} W$ 6 Varas distant
Thence $S 19^{\circ} E$

600
2500

a Branch 7/8 Vara wide 6. 1/4
Set a post and made a mound 3rd corner from
which a Red Oak 24 Inches in diameter bear
 $S 29^{\circ} E$ 10 Varas distant another Red Oak 18 Inches
in diameter bear $N 11^{\circ} W$ 13 Varas distant
Thence $S 71^{\circ} E$

2500

Set a post and made a mound 4th corner from
which a Red Oak 30 Inches in diameter bear $N 56^{\circ} E$
25 Varas distant a Hickory 18 Inches in diameter
bear $S 46^{\circ} W$ 7 Varas distant
Thence $S 19^{\circ} W$

2500

To the place of beginning Timber Hickory Walnut
Oak ash Lynn &c 5th Labores arable & yssidua
grazing Land
Jueniah Strode
Surveyor

Mr Arthur Stansie

Stansie

John Kerby
706 June 135.
1821. P. 495.

Waco, Tex. Co.
1821

~~1821~~ November 19th 1834. Then Surveyd for John Kerby
one Sitio or League of Land adjoining Henry Baileys
Survey Beg in D. G. Burnetts Colony beginning at
said Baileys S. East Corner a post in a Mound at
1st Corner from which a Hickory 12 Inches in dia-
meter bears S 12^o E 6⁵/₁₀ Varas distant another Hickory
10 Inches in diameter bears S 40^o W 3⁵/₁₀ Varas distant

Thence S 12^o E

2500

Set a post and made a Mound 2nd Corner from
which a Hickory 10 Inches in diameter bears S 34^o E
3 Varas distant another Hickory 9 Inches in diameter
bears N 42^o W 3 Varas distant

Thence S 77^o W

1130

The Road

1130

Cherokee Trace

4490

7500

Set a post and made a Mound 3rd Corner from which
a B. Oak 18 Inches in diameter bears N 1^o W 20⁵/₁₀ Varas
distant a post Oak 12 Inches in diameter bears N 9^o W
22 Varas distant Thence N 12^o W

a Creek 2^o wide C. N. E

4330

5000

Set a post and made a Mound 4th Corner from which
a Red Oak 36 Inches in diameter bears N 12^o W
12 Varas distant another Red Oak 20 Inches in
diameter bears S 50^o E 10 Varas distant

Thence N 77^o E

2500

Set a post and made a Mound 5th Corner from
which a B Oak 9 Inches in diameter bears N 75^o E
11⁵/₁₀ Varas distant a black Oak 9 Inches in diameter
bears S 59^o W 10 Varas distant in Henry Baileys line

Thence S 12^o E

2500

Henry Baileys Corner a post in Mound 6th Corner
from which a B. Oak 8 Inches in diameter bears N 71^o E
6 Varas distant another B. Oak 16 Inches in diameter
bears N 42^o W 9⁵/₁₀ Varas distant

Thence S 77^o E another of Baileys line

5000

To the place of Beginning Timber Hickory
Oak & Laborer arable Republic grazing Land
Unionian Shell Summer

Mr. Arthur Pennic

Laigodochy

Varas Timber June 4th 1835 Then surveyed for Josephina Powell
 Section or League of Land Situate in D. G. Burnett's
 Grant on the Waters of the Angelina adjoining Eason
 Gees Survey beginning at his S. E. corner a
 Post in a Mound 1st Corner from which a Post Oak
 16 Inches in diameter bears N 85° 43' Varas distant
 an Other Post Oak 20 Inches in diameter bears
 S 47° E 4 Varas distant

Josephina Powell
 9th July 17/35
 vol 19. p. 737. - *Map of Cherokee Co.*

Thence East

3470 a Creek 1 Varas wide C. S. E
 5000 Set a post and Made a Mound 2nd Corner from which
 a Red Oak 14 Inches in diameter bears N 3° 48' 2 Varas
 distant a Post Oak 16 Inches in diameter bears S 70° W
 4 Varas distant Thence South

590 a Creek 2 Varas wide C. E
 5000 Set a Post and made a Mound 3rd Corner from
 which a B. Oak 10 Inches in diameter bears S 71° E
 9 Varas distant an Other B. Oak 9 Inches in diam.
 bears N 64° E 8 Varas distant

Thence West

5000 Eason Gees S. E. corner a ~~post~~ in a Mound
 4th Corner from which a Hickory 12 Inches in
 diameter bears S 77° W 6 Varas distant an Other Hickory
 14 Inches in diameter bears S 30° W 15 Varas distant

Thence North with Gees line

5000 To the place of Beginning Timber Hickory
 Oak Ash Elm Pine &c 12 Labors Arable
 residue grazing Land Jeremiah Strode
 Surveyor

Wm. Arthur Rennie
Hacagdoches

Wm. Arthur Rennie

Hacagdoches

60
 Distance
 John Carroll
 1798 Dec 30/34
 100 L 13 p 35
 Houston Co
 1839

300
 10.008

400
 624
 300
 7808

300
 500
 200
 600
 300
 500
 300
 300

December 13th 1834 Then Surveyed for W. John
 Carroll one fourth of a League of Land
 on the North East bank of Trinity River
 Set a post and made a Mound 5th Corner
 from which a B. Ash 12 Inches in diameter bears N 32th E
 2⁶/₁₀ Var. distant an other B. Ash 19 Inches in diameter bears
 S 66th East 46th Var. distant
 Thence N 45th E Thence Trace
 Set a post and made a mound 2nd Corner
 from which a B. Oak 20 Inches in diameter
 bears N 54th 45th/₁₀ Var. distant a B. Oak 13 Inches
 in diameter bears N 54th E 15th/₁₀ Var. distant
 Thence N 45th W a Creek
 Set a post and made a Mound 3rd Corner
 from which a Red Oak 30 Inches in diameter
 bears N 86th 48th Var. distant a Sweet gum
 18 Inches in diameter bears S 45th 44th/₁₀ Var. distant
 Thence S 45th W ~~7808~~ to the bank of
 the Trinity set a post and made a mound
 4th Corner from which

Thence with the meanders;

S 20th W
 West
 S 45th W
 S 30th W
 S 40th W
 S 20th W
 South

N 77th E To the place of Beginning Timber Gum
 Hickory Oak Ash &c, Bottom cane principally
 Subject to Inundation. 2 Laborers Arable the balance
 Grazing Land

Jimmie Shode
 Surveyor
 " - "

William Clark
File June 17/35
Vol 18. p. 381.
Round Co. Ark.

May 15th 1835 Then Survey for ^{Wm} Clark
one Section
or League of Land Situate in D. J. Burnett's Grant on the
waters of the Angelina adjoining Survey
Set a post and made a mound 1st Corner in his N.W
Boundary line from which a Hickory 16 Inches in diameter
bears S 57^o E 12 Varas distant a B. Oak 12 Inches in diameter
bears N 70^o E 12 Varas distant

Thence N 65^o 1/2 W

a Creek 1 Varas wide C. S.
Set a Post and made a Mound 2nd Corner from which
a B. Oak 13 Inches in diameter bears N 32^o E 12 Varas distant
on Other B. Oak 9 Inches in diameter bears S 25^o E
8 Varas distant Thence S 24^o 1/2 W

a Creek 1 Varas wide C. S. W
Set a Post and made a Mound 3rd Corner from
which a Red Oak 10 Inches in diameter bears S 31^o E
5 Varas distant a B. Oak 12 Inches in diameter
bears N 75^o E 9 Varas distant
Thence S 65^o 3/4 E

a Creek 1 Varas wide C. S. South
Set a Post and made a Mound 4th Corner in
N.W boundary of line
from which a Red Oak 10 Inches in diameter bears
N 60^o E 2 Varas distant on Other Red Oak 9 Inches in
diameter bears S 4^o E 9 Varas distant

Thence N 24^o 1/2 E with line
To the place of Beginning Timber B. Oak. W Oak
W Oak Hickory ash Elm &c 14 Laboris Arable
Residue Grazing Land

Jimmish Strodt
Surveyor

400
5000
2230
5000
2440
5000
5000

July 11th 1835

I - B. 50

Padro Bermilla

Varas

one fourth of a ~~Section~~ ~~of~~ ~~land~~ in D. G. Bermilla
belonging adjoining the land of A. M. Heath and Jacob
Mastee on the waters of ~~San Antonio~~ Bayou
Road Beginning ~~at~~ ~~the~~ ~~S. E.~~ corner the
~~N. 57th W. N. 54th E~~

Padro Bermilla
7th July 3/35
vol. 18. p. 525
Houston Tex.
A.M.S.

140

Set a post and made a mound 1st corner from
which a B. Pack 10 Inches in diameter bears N 63rd W 48th
distant a post Oak 24 Inches in diameter bears N 77th W
7 Varas distant

Thence N 35th W

1040

a small Creek 10th wide C. H. W

1700

a Spring Branch 7th wide C. H. W

2500

Set a post and made a mound 2nd corner from
which a post Oak 24 Inches in diameter bears N 83rd W
3rd corner distant another post Oak 24 Inches in
diameter bears N 5th E 3 Varas distant

Thence S 57th W

110

a Bayou 10th wide C. H. W

1650

a Spring branch C. H. W

2500

Set a post and made a mound 3rd corner from
a B. Pack ~~24~~ 30 Inches in diameter bears N 5th W
11th Varas distant another B. Pack 24 Inches in diameter
bears S 15th E 29 Varas distant

Thence S 35th E

2500

Set a post and made a mound ^{4th} from which a
B. Pack 12 Inches bears S 35th E 9 Varas distant
another B. Pack 14 Inches in diameter bears S 70th W
15th Varas distant

Thence N 54th E with a line

2500

passing starting corner to the place of begin-
ning Timber Hickory Oak B. Pack 8th
4 Laborers capable of raising
Land

J. M. Strode
Surveyor

~~Joseph Hartys Notes~~

Pedro Bormella

Sho due Lunter
on San Antoni Road
governing Hillasture

Mr. Arthur Ferris

Wacagadobing

63

James C. Boy
9th May 9/35
Vol 18 p 247

Houston Co
May

March 9th 1835 Then Surveyed for W. James
C. Boy and forth of a League of Land on Trinity
adjoining his Brother Samuel C. Boy's lower
line a post in a mound ^{the S.W. cor} 3rd corner from
which an Elm 14 Inches in diameter bears N 52 E
10⁸/₁₀ Varas distant a ~~Hackberry~~ ^{Red Oak} 14 Inches in diameter
bears S 64 4/4 Varas distant

Thence N 75 E

9625

Set a post and made a mound 2nd corner
from which a Red Oak 12 Inches in diameter bears
N 74 4/2 Varas distant another Red Oak 15 Inches
in diameter bears N 52 E 5²/₁₀ Varas distant

Thence S 15 East

625

Set a post and made a mound 3rd corner from
which a Red Oak 12 Inches in diameter bears S 65
4/4 8/10 Varas distant another Red Oak 10 Inches
in diameter bears N 42 E 4⁴/₁₀ Varas distant

Thence S 75 4/8

10375

To the Margin of the Trinity Set a post and
made a mound 4th corner Set a post and
made a mound from which an Elm 14 Inches
in diameter bears N 52 E 10²/₁₀ Varas distant a
Hackberry 14 Inches in diameter bears S 64 4/4
4 Varas distant.

Thence up the River N 37 1/2 E

950

To the place of beginning Timber Ash Elm
Oak Hickory &c 2 Laborer Able & 2
grazing Land

Jenniah Thode
Surveyor

Benija Safety
1706 June 22/35
1000 18 p 421
Smith 11002

Varras June 8th 1835 Then Survey for Mr Benjamin Lefferty
one Section or League of Land Situate in D. G. Burnett
Grant on the waters of The Angelina adjoining Smythe
& Ragans Survey Beginning at his S. W. Corner a
Post in a Mound 1st Corner from which a Hickory
12 Inches in diameter bears S 84° E & Varras distant another
Hickory 14 Inches in diameter bears N 73° W 13 Varras
distant Thence N 40° W

5000 Set a post and made a mound 2nd Corner from
which a Red Oak 14 Inches in diameter bears N 87° E
6 Varras distant another Red Oak 17 Inches in
diameter bears S 41° E & Varras distant
Thence N 10° E

330 a Creek 2 Varras wide S. W

5000 Set a Post and made a Mound 3rd Corner from
which a B. Sack 9 Inches in diameter bears S 42° E
4⁵/₁₀ Varras distant another B. Sack 12 Inches in diameter
bears N 28° E 6 Varras distant
Thence S 40° E

2500 Blans Corner N. W Corner his line
5000 to Smiths and Ragans Corner a post in a mound
4th Corner from which a

5000 Thence S 10° W with Smiths & Ragans
To the place of Beginning Timber Hickory Oak
Walnut Lyonn ash Elm &c 18 Laborers work
Residue Grazing Land
Jeremiah Stode
Surveyor

for Geo Green

Jame J. Jones. - 65-
17th July 1935
Noe 18. p. 155

Checked by
AMH

B. 223 59

January 1835 Then surveyed for Jesse
Jones one League of Land on the waters of
the Natch in D Bernets Colony beginning
at Joseph Coopers Survey a post in a Mound
1st Corner from which a B. Jack 10 Inches in
diamiter bears N 35 W 3 ⁴/₁₀ Varas distant another
B. Jack 13 Inches in diamiter bears S 70 E 10 ⁶/₁₀
Varas distant Thence S 79 W

3250
6250

a Creek 2nd V. wide C. W
Set a post and Made a Mound 2nd Corner from
which a B. Jack 12 Inches in diamiter bears
South 19 ⁶/₁₀ Var. distant a Hickory 7 Inches in
diamiter bears N 20 W 30 Varas distant
Thence S 1 E

4000

Set a post and made a Mound 3rd Corner
from which B. Jack 14 Inches in diamiter
bears N 30 E 14 ¹⁰/₁₀ Var. distant another B. Jack
10 Inches in diamiter bears N 60 E 7 ⁴/₁₀ V. distant
Thence N 79 E

6250

to Joseph Coopers S. W Corner a post in a
Mound 4th Corner from which a pine 20 In
in diamiter bears N 70 E 9 ⁴/₁₀ V. distant an
Other pine 22 Inches in diamiter bears S 67 E
9 Var. distant Thence with Coopers line
N 1 W

4000

To the place of beginning Timber Pine
Hickory Oak Gum &c & Labors, arable
Ballance Grazing Land

Jimmick Stodd
Surveyor

Prepared & Plotted

Elyah Gossett.
 7th July 1835
 vol. 18. p. 139
 Houston Co.
 MS.

1100
 5000

 2600
 5000

 4000
 5000

 1000
 1400
 3000
 5000

December 31 1834 Then Surveyed for
 Elyah Gossett one League of Land on the
 Hurricane Bayou including his Improve-
 ment where he now lives and bounded as
 follows Beginning at John Beaty's N. E.
 Corner a Post in a Mound 1. Corner from
 which a Pine 24 Inches in diameter bears
 N 74° W 4 $\frac{2}{10}$ Var. distant another Pine 24
 Inches in diameter bears S 57° W 4 $\frac{4}{10}$ distant
 Thence with Beaty's line South
 The Hurricane Bayou 3 V. wide C. W. at
 To a post in a Mound 2. Corner being
 Beaty's S. E. Corner from which a B. Ash
 8 Inches in diameter bears S 44° E 4 Var. distant
 a post Oak 10 Inches in diameter bears S 10° E
 4 Var. distant
 Thence East
 a Creek 2 V. wide C. W.
 Set a post and made a Mound 3. Corner
 from which a post Oak 24 Inches in diameter
 bears N 30° W 9 Var. distant another post Oak
 15 Inches in diameter bears S 59° W 2 $\frac{5}{10}$ distant
 Thence North
 The Hurricane Bayou C. W.
 Planted a post and made a Mound 4. Corner
 from which a pine 30 Inches in diameter
 bears S 33° E 12 $\frac{4}{10}$ Var. distant a B. Oak 20 Inches
 in diameter bears S 50° E 10 $\frac{6}{10}$ Var. distant
 Thence West passing over pine woods
 a Spring branch C. S.
 another branch C. S.
 another branch C. S.
 To the place of Beginning Timber Hickory
 Ash Oak Lyon pine &c Creek Bottoms
 Ground with large cane 2 Labour arable
 hollow grazing land
 Jeremiah Stone
 Surveyor

Varas 5
 Juan Baptista Gagne
 25th May 25/34
 noe 188p 295
 Smith
 Book 00

May 11th 1835 Then Survey for Juan Bap^a Gagne
 one Sitio or League of Land Situate in D. G. Burnett's
 Grant and on the Waters of the Angilena Beginning
 at William Williams's N W Corner a Post in
 a Mound 1st Corner from which a Hickory

Thence N 65^o W

1000
 1760
 5000

Jesse Robert W. Smith's Corner
 Branch of Angilena 3 Varas wide C. S.W.
 Set a Post and made a Mound 2nd Corner from which
 a B Oak 14 Inches in diameter bears N 14^o E 7^{to} 10 Varas distant
 another B Oak 6 Inches in diameter bears N 80^o W 6^{to} 10 Varas
 distant Thence N 24^o E

3070
 4700
 5000

a branch 2 Varas wide C. S. E
 a Spring Branch 1 Varas wide C. S. W
 Set a Post and made a Mound 3rd Corner from which
 a B Oak 20 Inches in diameter bears East 7^{to} 10 Varas distant
 another B Oak 30 Inches in diameter bears N 24^o E 2^{to} 10
 Varas distant Thence S 65^o E

4700
 5000

a branch of Angilena 3 Varas wide C. S. W
 Set a Post and made a Mound 4th Corner from which
 a B Oak 24 Inches in diameter bears S 3^o E 6 Varas distant
 a Post Oak 6 Inches in diameter bears N 70^o W 5 Varas
 distant Thence S 24^o W

200
 5000

Williams Corner
 with Williams line to the place of Beginning Timber
 Hickory Oak Elm Gum ash Pine &c 16 Laborers Able
 Residue Grazing Land Junior's Share

William Thorne

Secretary

No 3 19
 Varras In the
 William Gates
 976 June 29 1835
 No 18.9 265
 Cheroke Co
 N 112

June 2nd 1835 Then Surveyed for William Gates
 one Section or League of Land Situate in D. G. Bennetts
 Grant on the waters of the Angeline adjoining Isaac
 Survey Set a post and made a Mound 1st Corner
 from which a B. Oak 9 Inches in diameter bears N 3rd W
 6 Varras distant an other B. Oak 12 Inches in diameter
 bears S 64th W 7 Varras distant

Thence South

a Spring branch 7/8 wide C. W
 Set a post and made a Mound 2nd Corner from
 which a H. Oak 14 Inches in diameter bears N 66th W
 6 Varras distant a Post Oak 15 Inches in diameter bears
 S 10th E 7 Varras distant

Thence West

a Spring branch 1/2 wide C. S
 Set a post and made a Mound 3rd Corner from which
 a H. Oak 10 Inches in diameter bears N 56th E 7 Varras
 distant a Pine 16 Inches in diameter bears S 19th W
 5 Varras distant

Thence North

a Creek 2 Varras wide C. W
 Set a post and made a Mound 4th Corner from which
 a H. Oak 7 Inches in diameter bears North 2 Varras
 distant a Willow Oak 16 Inches in diameter bears
 S 30th W 6 Varras distant

Thence East

To the place of Beginning Timber Hickory
 Oak Elm Pine ash &c 15 Labours Arable
 Residue Grazing Land

Jeremiah Shode
 Surveyor

1485
 5000
 2550
 5000
 3450
 5000
 5000

Mr. Arthur Sewell

Carrollton, Va.

Distance

Perch

December the 6th 1834

B. 216

Jacobus Gibbs
7th July 1835
10th 1839

Shelburne Co.
April 2

Then surveyed for Jacobus Gibbs One League of
Land Bounded as follows ~~at~~^{1st} corner on the North
Planted a Post and made a mound ^{1st} corner a B.
Oak 26 Inches in diameter bears S. 10 E. 5^{to} 10^{to} V. distant, a Post
Oak 15 Inches in diameter bears S. 86 W. 12 V. distant
Thence South ^{S. 80 W.} 80 W.

1100

Cross a Creek C. S. E.

2500

Set a Post and made a mound 2nd corner
a Pine 24 Inches in diameter bears N. 10 W. 2^{to} 10^{to} V. distant
an Other Pine 24 Inches in diameter bears E. 9 V. distant
Thence N. 10 W.

5400

Cross the Aray trace

10000

Set a Post and made a mound 3rd corner
a B. Sack 14 Inches in diameter bears N. 25 E. 8^{to} 10^{to} V.
distant an Other B. Sack 5 Inches in diameter bears
N. 72 E. 3^{to} 10^{to} V. distant. Thence N. 80 E.

1600

Cross a Creek C. S. E.

2500

Set a Post and made a mound 4th corner
a B. Sack 5 Inches in diameter bears S. 70 E. 9^{to} 10^{to} V. distant
an Other B. Sack 10 Inches in diameter bears S. 31 W.
8 V. distant Thence S. 10 E. on random line

3530

Aray Trace to East

10,000

to the Place of Beginning fill 3 Vars, to the ^{East} bound
Timber Pine Hickory Oak &c. 12th Leagues
Arable Ballance Grazing Land

Jeremiah Stott
Surveyor

" "

71
 Varnas Smith
 Edson Gee
 Title June 20/35
 Vol 18. P 493
 Cherokee of with Co.

1835 P 139 I 64.

June 2nd 1835 Then Surveyed for Mr. Edson Gee one
 Sixties or League of Land adjoining Mr. John Engledow
 Survey beginning at his N.W. Corner a post in a Mound
 5th Corner from which a post Oak 30 Inches in diameter bears
 S 75° W 4 5/8 Varnas distant a B. Oak 30 Inches in diameter
 bears S 19° W 5 Varnas distant.

Thence North

2100
 3300
 5000

a Spring branch C. C.
 a Spring branch C. H.
 Set a post and made a Mound 2nd Corner from which
 a Hickory 14 Inches in diameter bears S 75° W 7 Varnas
 distant another Hickory 12 Inches in diameter bears
 S 25° W 9 Thence East

60
 1000
 2000
 5000

Spring branch C. N. W.
 Branch & Varnas wide C. N.
 Branch & Varnas wide C. N.
 Set a post and made a Mound 3 Corner from
 which a Post Oak 17 Inches in diameter bears West
 3 Varnas distant another Post Oak 24 Inches in
 diameter bears S 16° E 9 Varnas distant

Thence South

5000
 5000

John Engledow's N. E. Corner a post in a Mound
 4th Corner from which a Hickory 12 Inches in
 diameter bears S 77° W 6 Varnas distant another
 Hickory 18 Inches in diameter bears S 30° W 15 Varnas
 distant Thence West with Engledow's line
 To the place of Beginning Timber Hickory
 Oak Ash Elm Walnut &c 14 Acres arable & improved
 grazing Land

Jeremiah Stodd
 Surveyor

Mr. Arthur Fenwick

St. George's

Levi Jordan 2

1776 July 4/35
Vol 18. p 123

Shropshire Co
2nd

January 29th 1835 - Then Surveyed for Levi Jordan one League of Land adjoining Zachus Gibbs on the waters of the Cache and also adjoining Jesse Jones's Survey beginning at his 8th Corner ^{of Jesse Jones} a post in a mound from which a Red Oak 14 Inches in diameter bears N 30 E 14 1/10 V distant another Red Oak 10 Inches dia. bears N 60 E 9 10th Thence S 10 E

4390

Zachus Gibbs line set a post and made a mound 2nd Corner from which a Red Oak 20 Inches in diameter bears N 55 E 5 1/10 V distant another Red Oak 14 Inches in diameter bears N 65 E 50 V distant

Thence N 40 E with Gibbs line a Creek 4 Vars wide

560
1494
5694

Gibbs Corner

set a post and made a mound 3rd Corner from which a Red Oak 14 Inches in diameter bears S 70 E 8 1/10 V distant a Hickory 13 Inches in diameter bears N 65 W 13 1/10 V distant

Thence N 10 W

4390

set a post and made a mound 4th Corner in Jesse Jones's line from which Red Oak 6 Inches in diameter bears S 22 E 1 V distant a Pine 10 Inches in diameter bears S 40 W 7 V distant Thence S 40 W with Jones's line

5694

To place of Beginning Timber Hickory Oak Pine Lym Gum &c 6 Labors are all Ballance Grazing Land

Jumison Stone
Surveyor

5694
4390

510460
17082
22776

2499660

John Edens
1722
Apr 20/35
Vol 18. p 211

Houston Co.
N.M.

February 26th 1835 ~~Set a post~~ for Mr. John Edens
Warrant and agreeably to his Order of Survey and League of
Situate in D. G. Burnetts Grant on the North Fork
of Elkhart Creek Beginning in Garrison Greenwood's
S. E. boundary line Set a post and made a Mound
1st Corner from which a Hickory 20 Inches in diameter
bears N 90° E 4 10/100 Varas distant a B. Jack 24 Inches in
diameter bears N 65° E 7 8/100 Varas distant

Thence N 30° E

1810

N. Fork Elkhart Creek 4 P. wide C. S. 84

5240

Set a post and Made a Mound 2nd Corner
from which a B. Jack 14 Inches in diameter bears
N 40° E 6 Var. distant an Other B. Jack 15 Inches in
diameter bears S 60° W 5 5/100 Varas distant

Thence N 60° W

5000

Set a post and Made a Mound 3rd Corner from
which a B. Jack 15 Inches in diameter bears N 30° E
1 5/100 Varas distant an Other B. Jack 12 Inches in diam
bears S 75° W 1 5/100 Var. distant

Thence S 30° W

5240

Set a post and Made a mound 4th Corner from
which a B. Jack 8 Inches in diameter bears N 25° E
8 5/100 Var. distant an Other B. Jack 10 Inches in
diameter bears S 70° W 7 2/100 Var. distant

Thence S 60° E

2500

another of Greenwood's line Set a post and Made
a Mound 5th Corner from which a post Oak
22 Inches in diameter bears N 38° W 15 Varas distant
an Other post Oak 15 Inches in diameter bears S 74° W
5 Var. distant Thence N 55° E with Greenwood's line

1070

Greenwoods Corner a post in a Mound 6th Corner
from which a Red Oak 30 Inches in diameter bears
S 42° W 19 7/100 Varas distant an Other Red Oak 32 Inches
in diameter bears S 4° W 24 10/100 Var. distant

Thence S 35° E with another of Greenwood's line

2300

to place of Beginning Timber Hickory Oak ash Gum
4 laborers drable Bottoms grass Land
Indian Shoals

Mr. Arthur Tennyson
Empire or the Great
Sagadahoc

74
 Correspondence January 16th 1835 Then Surveyed for Mr. John Sheridan one Sitio or League of Land Situate on the waters of the Natche on the Branches of the Bay of Padro and including the place where he now lives Set a Post and made a Mound

John Sheridan
 738 June 11/35
 Vol 18 p 497

Co. Houston Range

1st Corner from which a Post Oak 12 Inches in diameter bears S 62° E ²¹/₁₀ Varas distant a B. Oak 6 Inches in diameter bears S 46° E 29° distant Thence S 50° E

4800
 4800

Set a post and made a mound 2nd Corner from which a B. Oak 14 Inches in diameter bears S 50° W 11 ⁴/₁₀ Varas distant another B. Oak 16 Inches in diameter bears S 32° W 12 ²/₁₀ Varas distant Thence S 40° W

700
 1155

a Branch 1 Var. wide C. South Set a Post and made a Mound 3rd Corner from which a B. Oak 17 Inches in diameter bears S 7° E 8 ²/₁₀ Varas distant another B. Oak 8 Inches in diameter bears S 34° E 9 ⁶/₁₀ Varas distant

Thence N 50° W

500

Set a Post and made a Mound 4th Corner from which a B. Oak 9 Inches in diameter bears S 44° W 2 ⁶/₁₀ Varas distant another B. Oak 7 Inches in diameter bears S 84° W 2 ²/₁₀ Varas distant

Thence S 57° W

1600

Set a post and made a Mound 5th Corner from which a B. Oak 9 Inches in diameter bears S 87° E 3 ²/₁₀ Varas distant another B. Oak 5 Inches in diameter bears N 66° W 3 ⁴/₁₀ Varas distant

Thence N 50° W

160

Set a Post and made a Mound 6th Corner from which a B. Oak 15 Inches in diameter bears N 78° W 4 Varas distant another B. Oak 20 Inches in diameter bears S 52° E 7 ⁷/₁₀ Varas distant

Thence S 69° W

700
 119

State of application by the Parties a Oak of San Pedro 2 1/2 wide C. S. E. 7 Station Thence S 21° E a Stake on conditional line of Station

Varrae Juntas Thence S 69° W
490 a Large Spring on Conditiona line between Station 9 & Station

3290 Thence S 77° W
Set a Post and Made a Mound 7th Corner
from which a B. Oak 20 Inches in diameter
bears N 39° W 4 Varas distant an other B. Oak
13 Inches in diameter bears N 39 1/2° E 1/2 Varas distant

450 Thence North
Set a post and Made a Mound 8th Corner from
which a B. Oak 5 Inches in diameter bears N 70° W
5 Varas distant an other B. Oak 5 Inches in diam^{ter}
bears N 48° W 10 Varas distant

1240 Thence West
Set a Post and Made a Mound 9th Corner in
Martin Murchison line from which a B. Oak
15 Inches in diameter bears N 48 1/2° W 3 1/2 Varas
distant a Red Oak 24 Inches in diameter bears
S 40° E 15 Varas distant

2000 Thence North with Murchison's line
Set a Post and made a mound 10th Corner from
which a Sweet Gum 30 Inches in diameter bears
N 77° E 10 Varas distant a Maple 10 Inches in
diameter bears S 50° W 4 Varas distant this is also
Radford Berrys

1510 Thence East with Berrys line
another of Berrys Corners 11th Corner to this
Survey from which a Sweet Gum 15 Inches in diam^{ter}
bears S 19° W 6 Varas distant an Elm 6 Inches in
diameter bears N 22° W 4 Varas distant

330 Thence N 60° E
Set a post and 2 Red Oaks another of Berrys Corners
Thence N 40° E

3190 Berrys S. E. Corner
4145 To the place of beginning Simla Hickory
Oak Ash Gum G. B. Labell Arable Ry. Land
Grazing Land

Junius Strode
Surveyor

J

96

Wanas

June 5th 1834 Then surveyed for Mr. John Englewood and Scitio
 1st League of Land Situate in Burnett's Grant adjoining a
 Survey of C. Hokit on the Highland fork of the Bigлена River
 beginning at Hokite N. W. Corner a Post in a Mound 3rd Corner
 from which a B. Oak 30 Inches in diameter bears S 72° E 50 Var.
 distant a post Oak 26 Inches in diameter bears N 16° E 6
 Var. distant Thence East with Hokite line
 a branch 1 Var wide C. S. W.
 Hokite N. E. Corner a post in a Mound 2nd Corner from
 which a Hickory 9 Inches in diameter bears N 62° W 9 Var. S.
 distant another Hickory 6 Inches in diameter bears N 79° E
 4th Var. distant Thence North
 a Spring Branch C. S. W.
 Set a post and made a Mound 3rd Corner from which
 a Hickory 12 Inches in diameter bears S 77° W 6 Var. distant
 another Hickory 17 Inches in diameter bears S 30° W 15 Var.
 distant Thence West
 a Creek 2 Var. wide C. S. W.
 a Creek 3 Var. wide C. S. W.
 Set a post and made a mound 4th Corner from which a
 Post Oak 30 Inches in diameter bears S 78° E 4th Var. distant
 a B. Oak 30 Inches in diameter bears S 19° W 5 Var. distant
 Thence South
 a Spring Branch 1 Var. wide C. S. E
 William J. Smith's N. E. Corner
 Highland Creek 3 Var. wide C. S. W.
 To the place of Beginning Simble's Hickory Oak
 ash Elm Walnut Lynn &c. 16 Labourable
 Reproduce Grazing Land - Junction Shode
 Surveyor

2730
 5000
 2400
 5000
 2500
 3300
 5000
 100
 2800
 4400
 5000

John Englewood
 Title June 18/35
 Vol. 18. p. 373
 Cheever & Co
 1839

9 96
 5.40
 32.00
 8.
 2
 47.40
~~48.00~~
 42.40

Mr. Arthur T. Smith

Harvard College

Cambridge, Mass.

76
 Distance in the
 John Beatty
 1776 July 29/35
 vol 9. p. 681.

December 30th 1734 Then surveyed for
 Mr John Beatty one League of Land on
 the Hurricane Bayou adjoining a Survey
 of Elisha Gossett on the East beginning
 on a branch North Side of the Hurricane
 Set a post and made a mound 1st corner
 from which a post Oak 30 Inches in diam-
 eter bears S 44 W 6 Varra distant another
 Post Oak 30 Inches in diameter bears N 45 W
 16 Varra distant

Thence East

1000
 5000

a brook 1 Varra wide C.S
 Set a post and made a mound 2nd corner from which a pine
 24 Inches in diameter bears N 74 W 4¹/₁₀ Varra distant and
 other Pine 24 Inches in diameter bears S 47¹/₂ W 4⁴/₁₀ distant

Thence South

1100
 2400
 5000

Hurricane Bayou 3rd corner wide C.W
 a brook 1¹/₂ Varra wide C.S.W
 Set a post and made a mound 3rd corner from which
 a black ash 7 Inches in diameter bears S 44 E 4 Varra distant
 a post Oak 10 Inches in diameter bears S 10 E 4 Varra distant

Thence West

5000

Set a post and made a mound 4th corner from which a
 B. Post Oak 17 Inches in diameter bears N 47 E 10 distant
 a Hickory 14 Inches in diameter bears N 82 E 4¹/₁₀ distant

Thence North

5000
 1400
 2900
 5000

Maril
 Timber
 Hurricane Bayou
 To the place of beginning Timber Lynn Elm Hickory
 Oak Pine & cane bottoms by subject to overflow in part
 C Laborer Arable Ballance Grazing Land
 Jeremiah Stodd
 Surveyor

306
Hiram B. Troutman
Title Mch. 3/35
Vol 18, p. 267
Chester Co.

May 30. 1835 Then Surveyed for Hiram B. Troutman
one Section or League of Land in Burnetts Grant Situate
on the waters of the anguilla adjoining Wm Gates Survey
beginning at the N. E. corner of a post in a mound 1st
corner from which a B. Oak 8 Inches in diameter bears
N 3 1/2 W 6 Varas distant and other B. Oak 12 Inches in diam-
eter bears S 64 W 4 Varas distant

Thence South with Gates line

3100

Set a Post and made a Mound 2nd corner from
which a post Oak 10 Inches in diameter bears S 62 E
4 Varas distant a Hickory 14 Inches in diameter
bears S 37 1/4 W 4 Varas distant

Thence East

7070

a Spring branch C. S.

8064

5/10

Set a post and made a Mound 3rd corner from which
a B. Oak 14 Inches in diameter bears S 48 E 15 Varas distant
a Hickory 12 Inches in diameter bears South 69 1/2 E
18 Varas distant

Thence North

1424

a Spring branch C. E.

2330

a Spring Branch 1 Var. wide C. E.

2420

a Creek 2 Var. wide C. S. E.

3100

Set a Post and made a Mound 4th corner from
which a Hickory 10 Inches in diameter bears S 50 1/4
5 Varas distant and other Hickory 8 Inches in diam-
eter bears S 46 E 4 Varas distant

Thence West

8064

5/10

To the place of beginning binding on a part of
3 other Surveys Timber Hickory Oak ash Linden
Hackberry Walnut &c 18 Labours arable & 1/2
Grazing land
Jennish Shode
Surveyor

Notes Sent B. 121.

7.13.57

Mr Arthur Linnic

Stourbridge

Mr. Arthur Tompkins

Surveyor General

Washington

~~1835~~ 1835 ~~John Spruce~~
Gardner & Co. ~~Badillo~~

Various Tracts
Gardner & Co.
Title June 6/35
Vol. 19. p. 629
Houston Co
MS 12

Beginning at
W. John Cedars Corner in Garrison's Green
woods line a Stake in a Mound 1st Corner
from which a Hickory 20 Inches in diameter
bears $N 93^{\circ} E \frac{1}{10}$ Paces distant a B. Oak 24
Inches in diameter bears $N 51^{\circ} E \frac{1}{10}$ Paces distant
Thence $S 30^{\circ} E$ with Cedars line

1800 The North Fork of Elk Creek 4 Paces wide C. S. W

4909 5th Set a post and made a Mound 2nd Corner
from which a Post Oak 20 Inches in diameter
bears $N 79^{\circ} W \frac{2}{10}$ Paces distant a B. Oak 10 Inches
in diameter bears $S 10^{\circ} E \frac{5}{10}$ Paces distant
Thence $S 60^{\circ} E$

5000 Set a post and made a Mound 3rd Corner
from which a Hickory 18 Inches in diameter bears
 $N 60^{\circ} E \frac{3}{10}$ Paces distant and then Hickory 10 Inches
in diameter bears $S 60^{\circ} W \frac{2}{10}$ Paces distant
Thence $S 30^{\circ} W$

1410 Elkport Creek 4 Paces wide C. S. W

4909 5th Set a post and made a Mound 4th Corner from
which a B. Oak 20 Inches in diameter bears $N 90^{\circ} W$
4 Paces distant a Hickory 12 Inches in diameter bears
 $N 42^{\circ} W \frac{3}{10}$ Paces distant Thence $N 60^{\circ} W$

5550 Set a post and made a Mound 5th Corner from
which a post Oak 22 Inches in diameter bears
 $S 34^{\circ} W \frac{10}{10}$ Paces distant a B. Oak 21 Inches in
diameter bears $S 62^{\circ} E \frac{10}{10}$ Paces distant
Thence $S 30^{\circ} W$

650 Set a post and made a Mound 6th Corner from
which a Hickory 14 Inches in diameter bears $S 83^{\circ} E$
6 Paces distant and then Hickory 12 Inches in diameter
bears $N 71^{\circ} W \frac{5}{10}$ Paces distant

1550 Thence $N 35^{\circ} W$ with Greenwood line
To the place of beginning Timber Hickory Oak
Ash Gum &c 4 Acres arable ^{regard grazing}
land ^{Quinn's Trade}
Surveyor

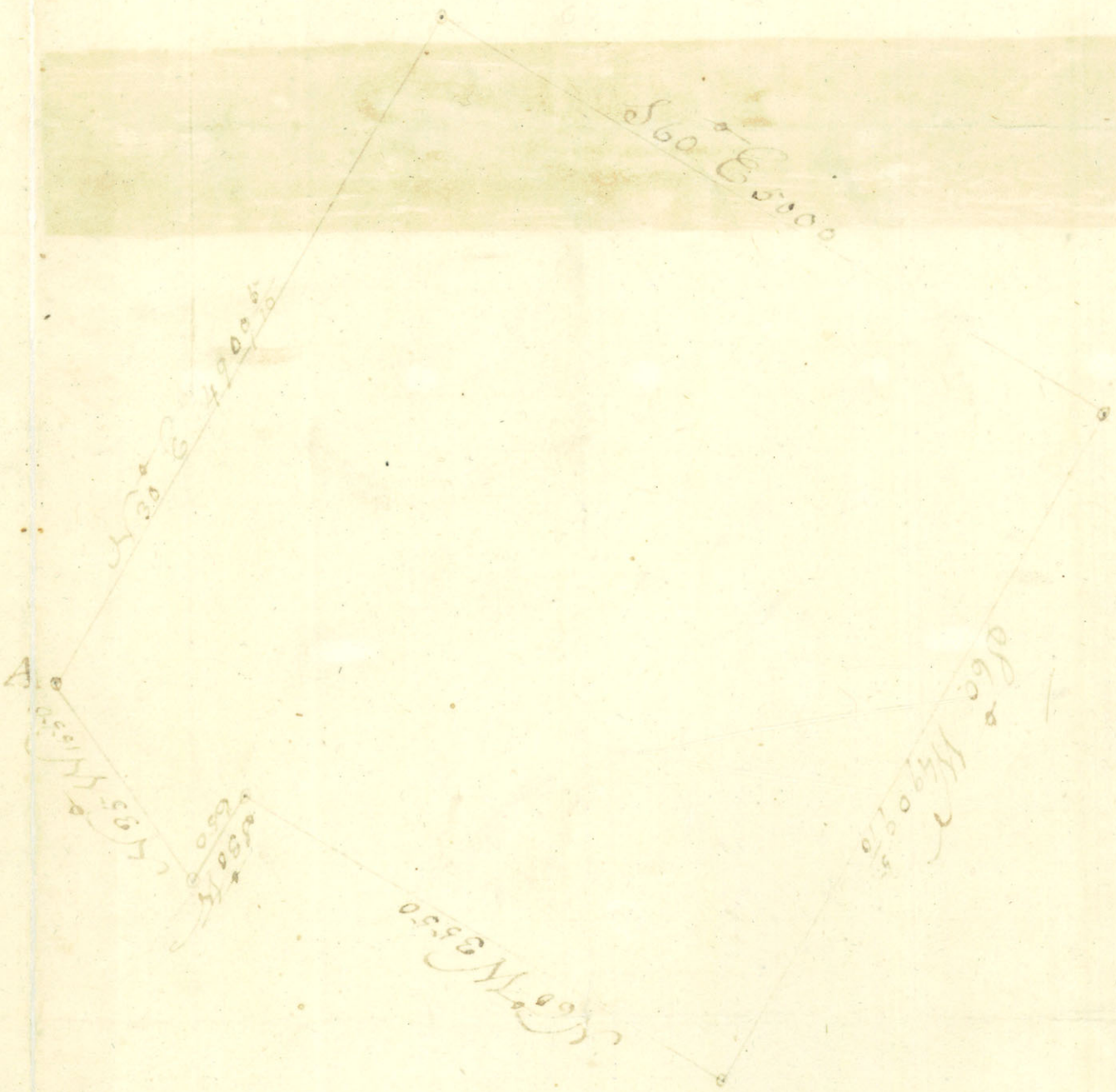

Varas th June 29. 1835 Then Survey for Mr Edward
 Mohit one Section or League of Land in D. G. Burnetts
 Grant Situate on the waters of the Angilina Beginning
 at the N. E. Corner of Isaac Needs Survey a Post in a Mound
 1st Corner from which a B. Oak 12 Inches in diameter bears N 47 1/2
 E 4 Varas distant and then B. Oak 12 Inches in diameter bears
 N 82 W 3 Varas distant

Edward W. Hocket
 77 1/2 June 3/35
 Vol 18. p 401
 Cherokee Co
 Ga

Thence North

970 passed the N. W. Corner of Isaac Needs Mr Isaac Kindricks
 Survey
 2700 a Spring Branch 1 1/2 wide C. 88
 5000 Set a Post and Made a Mound 2nd Corner from which a
 Hickory 9 Inches in diameter bears N 62 W 9 Varas distant an
 other Hickory 6 Inches in diameter bears N 77 1/2 E 4 1/2 Varas distant

Thence West

900 a Spring branch 1 1/2 wide C. 88
 1270 a Branch 1 Varas wide C. North
 5000 Set a Post and Made a Mound 3rd Corner from which
 a B. Oak 30 Inches in diameter bears S 7 1/2 E 5 Varas distant
 a Post Oak 26 Inches in diameter bears N 16 E 6 Varas distant

Thence South

2200 a Branch and pine Timber
 2600 a Dry Branch and Good Land open woods
 5000 Set a post and Made a Mound 4th Corner in
 Isaac Needs ~~North~~ North boundary line) from which
 a B. Oak 9 Inches in diameter bears S 25 W 5 Varas distant
 an other B. Oak 6 Inches in diameter bears S 76 W 8 Varas
 distant

Thence East with Needs line

5000 To the place of Beginning Timber Hickory Oak
 Oak Pine Elm &c 14 Acres Arable Residence
 grazing Land Jeremiah Stodd
 Survey

Notes Sent

Varras ^{1th} April 24th 1835 then Surveyed for Mr^r William Reagan
 one Section or League of Land on the waters of Angilina 6 or 7 Miles
 Below or West of Joseph ~~Point~~ ^{Dutch} Survey Beginning in a
 line of a former Survey on the South Side of said Creek
 Planted a Post and made a Mound ^{3rd} Corner from which
 a Black Oak ²⁴ Inches in diameter bears ~~N 65^o E~~ ^{N 65^o 44^o E} Varras distant
 a B. Oak 15 Inches in diameter bears ~~N 46^o E~~ ^{N 46^o 18^o E} Varras distant

Thence North

1040 Branch of Angilina 3 V. wide C S W
 4040 Branch Varras wide C S W

5000 Set a post and made a Mound 2nd Corner from which a
 B Oak 24 Inches in diameter bears South 4 Paces distant
 a B Oak 14 Inches in diameter bears ~~N 15^o W~~ ^{N 15^o 44^o W} distant

Thence East

60 a Branch 1/2 V. wide C S W
 1540 a Branch 1 V. wide C South
 2540 a Branch 1 Var. wide C S E
 3490 a Branch 1 Var. wide C South

5000 Set a post and made a Mound 3rd Corner from which
 a B Oak 24 Inches in diameter bears ~~S 75^o W~~ ^{S 75^o 44^o W} Varras distant
 a Hickory 26 Inches in diameter bears ~~N 6^o E~~ ^{N 6^o 10^o E} distant

Thence South

1240 a Branch 1 Var. wide C E
 2200 a Branch 1/2 V. wide C S E
 4920 a Branch of the Angilina
 5000 Set a post and made a Mound 4th Corner from which
 a B. Oak 14 Inches in diameter bears ~~N 41^o E~~ ^{N 41^o 18^o E} Varras distant
 a White Oak 10 Inches in diameter bears ~~S 62^o W~~ ^{S 62^o 10^o W}
 Varras distant Thence West

5000 To the place of Beginning Timber Hickory Oak
 Pine Ash Elm Gum & Labony Arable Myriad
 Grazing Land

Jumiah Shoda
 Surveyor

William Reagan
 File May 11/35
 Vol 18 p 337

Beck Co
 Aug

41 in Notes
11. 1834

B 200 74.

Set a Post and Made a Mound at
 The Beginning ~~Corner~~ of Henry Bailey
 Survey including what is known by
 the name of the nine Mill Spring and
 binding on the 20 border League line
 A Hickory bearing S 12 1/2 E 6 Var. diameter
 12 Inches an Other Hickory bearing
 S 40 W 3 1/2 also 12 Inches dia both is
 marked ^{near distant} BB from which Thence I ran
 with said border League line
 N 12 1/2 W passed the Spring branch at 190
 Vars in all 5000 to the 2nd corner
 Set a Post and made a mound a black
 Jack bearing N 75 E 15 Vars, 15 Inches dia
 another Black Jack bears N 46 W 25 Var
 20 Inches dia from thence S 77 1/2 W 5000
 Vars to the 3rd corner Set a Post and
 made a Mound from which a black
 Oak bears S 77 E 47 Var 20 Inches dia
 an Other Black Oak bears N 74 W
 11 Vars, 12 inches dia from thence S 77
 S 12 1/2 E 5000 Set a post and mad a
 mound from which a black Jack
 bears N 71 E 4 Inches dia distant
 6 Vars, another Black Jack bears N
 42 W 9 1/2 Var. 16 Inches diameter also
 a Post Oak bears S 26 E 4 Var 7 inch
 es diameter from thence S 77 1/2 E 3000
 Vars to the begining containing
 one League of Land Timber Hickory
 Oak &c Three fourth Arable one
 fourth Pasture Land

Henry Bailey - vol 18 p 11
 5-22-1834

Jeremiah Stode
 Deputy Surveyor

Field Notes of Henry Bailey
Survey

May^r Arthur Henry Surveysor Inspect

Corras Dentre

January 26th 1835 Then Surveyed for M Joseph J. Cook one League of Land Situate on the water of the Lake above Zachus Gibbs Survey on the Branch of the same Creek

Joseph J. Cook
File Feb 2/35
Vol 18 p. 151

Shenocke Co.
AMG

Set a post and made a mound 1st Corner from which a B. Jack 18 Inches in diameter bears N60° W 10 Varas distant another B. Jack 20 Inches in diameter bears S66° W 10 V. distant Thence S 1° E

1460
4000

a Creek, 10⁰ wide C.W
Set a post and made a mound 2nd Corner from which a pine 22 Inches in diameter bears N54° E 11 Var. distant another pine 18 Inches in diameter bears West 10 Var. distant

6250

Thence S89° W
Set a post and made a mound 3rd Corner from which a pine 20 Inches in diameter bears N90° E 9 1/10 Var. distant another Pine 22 Inches in diameter bears S67° E 9 Var. distant

1780
4000

Thence N 1° W
a Creek 2 V. wide C.W
Set a Post and made a mound 4 Corner from which a B. Jack 10 Inches in diameter bears N35° W 3 1/10 Var distant another B. Jack 15 Inches in diameter bears S70° E 10 1/10 Var. distant

3140
6250

Thence N 79° East
a Creek, 10⁰ wide C South
To the place of beginning Timber Pine
Hickory Gum Oak &c 4 Laborer Able
ballance grazing Land

Jemiah Strode
Surveyor

notes prepared
L. Platt

Coak Joseph T.

0780
0780

0841
0841

0820

0000
0000

[Faint, mirrored handwriting, likely bleed-through from the reverse side of the page]

49
 Elisha Clapp.
 17th Jan'y 14/35
 vol 18 p 95
 Houston Co

January 6^m 1835 Then Surveyed for Elisha Clapp one League of Land including the place where he lives Beginning at a Stake in a Mound in Commons, line and corner to Colton Aldridge which being S. 0 Clapp's 5th corner from which a post Oak 18 Inches in diameter bears N 80° E 205 Varas distant another post Oak 15 Inches in diameter bears N 73° E 155 Vars distant Thence with Commons line N 35 1/2 West passing his corner

3700
 5000

all prairie planted a post and made a Mound 2nd corner from which a post Oak 15 Inches in diameter bears S 88° E 4 7/10 Vars distant a post Oak 20 Inches in diameter bears N 88° W 17 Vars distant Thence N 54 1/2 E

3000
 5000

a Sandy Creek 1 Vars wide C. W. planted a post and made a Mound 3rd corner from which a post Oak 18 Inches in diameter bears S 7 1/2 W 9 6/10 Vars distant another post Oak 26 Inches in diameter bears N 66° E 6 10 Vars distant

6000

Thence S 35 1/2 East to C. Aldridge, N. E. corner Clapp's 4th corner a post in a Mound from which a post Oak 20 Inches in diameter bears N 83° E 4 7/10 Vars distant a post Oak 18 Inches in diameter bears S 19° W 5 Vars distant

5000

Thence S 54 1/2 W with Aldridge line to the place of Beginning Timber Hickory Oak pine all up hand & Lateral a trable bollance grazing land

Juniah Stode
 Surveyor

4
 13 30
 2.50
 2.00
 8.00
 30.30

84

N^o 3

77.

Thomas M^c Donnell
June 20/35
Vol 18 p 485
Buck Co.
Varras Ditch May 13. 1835 Then Survey for ~~Thomas M^c Donnell~~ one Section
League of Land Situate in D. G. Burnetts Grant on the waters of
the Angelina adjoining

Survey Beginning

at his S.W. Corner a Post in a Mound 1st Corner from
which a Black Oak 20 Inches in diameter bears East 6^o 10^o Varras
distant another B. Oak 30 Inches in diameter bears N 24^o E 2 1/2
Varras distant Thence N 24^o E

700

a branch, Varras wide C. S. E

3000

a Spring Branch 12 Varras wide C. S. E

5000

Set a Post and made a Mound 2nd Corner from which
a B. Oak 10 Inches in diameter bears S 3^o E 4 Varras distant
another B. Oak 12 Inches in diameter bears N 47^o E 7 Varras
distant Thence N 65^o W

1370

a Spring Branch 1/2 Varras wide C. S. W

2420

a branch, Varras wide C. S. W

4900

a Creek 2 Varras wide C. S. W

5000

Set a Post and made a Mound 3rd Corner from which
a Sarsaparil 12 Inches in diameter bears S 34^o E 4 Varras distant
a Hickory 18 Inches in diameter bears N 7^o W 5 Varras distant

Thence S 24^o W

600

a Creek 2 Varras wide C. S.

900

Same Creek C. S. E

2500

a Spring Branch 1 Varras wide C. S. E

5000

Corner a post in a Mound 4th Corner
from which a B. Oak 10 Inches in diameter bears N 47^o W 4
Varras distant another B. Oak 8 Inches in diameter bears
S 52^o E 4 Varras distant

Thence S 65^o E with line

5000

To the place of Beginning Timber Hickory Oak Pine
ash Elm Lynn Maple &c 12 Labors Arable Residue
grazing Land

Jremiah Shode
Surveyor

Distant South

January 10th 1835 Then Surveyd for Mr. John Haggan one League of Land Situate on the Stanton Road adjoining Mr. Thomas R. Townsends Survey Beginning at his N E Corner a post in a Mound 1st Corner from which a B. Oak 9 Inches in diameter bears S 75° W 3 ⁴/₁₀ Varas distant an other B. Oak 24 Inches in diameter bears N 77° E 10 Varas distant

John Hagan
Tore up 25/35
Dec 19. 1835

Houston Co. Survey

3800

Thence N 54 ¹/₂ East Set a post and made a mound 2nd Corner from which a B. Oak 12 Inches in diameter bears S 67 ¹/₂ W 6 ⁴/₁₀ Varas distant an other B. Oak 15 Inches in diameter bears N 53 ¹/₂ W 11 ¹/₁₀ Var. distant

2630

Thence S 35 ¹/₂ E Stanton Road C. W Set a Post and made a Mound 3rd Corner from which a B. Oak 14 Inches in diameter bears N 31 E 7 ⁶/₁₀ Var. distant an other B. Oak 10 Inches in diameter bears S 54 ¹/₂ W 8 ²/₁₀ Var. distant

760%

5/10

2300

Thence S 54 ¹/₂ W Set a post and made a Mound 4th Corner in John Moors line from which Corner a B. Oak 8 Inches in diameter bears N 77 ¹/₂ E 6 Var. distant another B. Oak 7 Inches in diameter bears N 70 ¹/₂ W 5 Var. distant

260%

5/10

Thence N 35 ¹/₂ W To Moors Corner a post in a mound from which a B. Oak 20 Inches in diameter bears S 50 E 10 Var. distant a B. Oak 6 Inches in diameter bears N 77 ¹/₂ W 7 Var. distant

1500

Thence S 54 ¹/₂ W with another of Moors line Thomas R. Townsends Corner a post in a Mound 6th Corner from which a B. Oak 24 Inches in dia. bears S 15 ¹/₂ W 5 Var. distant a Hickory 18 Inches in dia bears N 5 ¹/₂ W 12 Var. distant

5000

Thence N 35 ¹/₂ W with Townsends line To the place of Beginning Timber Hickory Oak Pine &c 2 Labour Arable ballance Grazing Land

Juniata Shobe
Surveyor

note sent

11 - 11

February 23rd 1835 Ten Surveys for John La Riviere
 one League and a Quarter of Land adjoining Daniel
 McNamee Survey Beginning in his line 20 Varas from
 his N.E. corner Set a Post and made a mound 5 Corners
 from which a B. Oak 14 Inches in diameter bears N 37 1/2
 10 Varas distant another B. Oak 16 Inches in diameter
 bears N 76 1/2 4 9 70 Varas distant

Juan La Riviere
 This Mch 5/35

Nov 18. p 179
 Hours to go
 1835

Thence S 55 W

4735
 5600
 5600

a creek the North fork of Elkhart 4 Varas wide S. E. E
 Set a post and made a Mound 2nd Corner from which
 a Hickory 12 Inches in diameter bears S 3 1/2 11 10 Varas
 distant another Hickory 10 Inches in diameter bears
 N 79 E. 12 Varas distant Thence S 35 W

5590 4/10
 5580 4/10

Set a Post and made a Mound 3rd Corner from
 which a post Oak 24 Inches in diameter bears S 38 E
 65 Varas distant another Post Oak 20 Inches in dia.
 bears S 41 E 69 Varas distant

Thence S 53 E
 North Fork Elkhart 4 Varas wide S. E. E

5000
 5600
 5600

Set a Post and made a Mound 4th Corner from
 which a post Oak 30 Inches in diameter bears S 4 E 15 1/2
 Varas distant a B. Oak 15 Inches in diameter bears
 S 33 1/2 W 4 1/2 10 Varas distant

5590 4/10
 5580 4/10

Thence S 35 E

To the place of Beginning Timber Hickory
 Oak &c cane on the creek bottoms 6 Labourers Able
 residue Grazing Land

Jeremiah Stode
 Surveyor

Prepared

James Hamilton
7th June 1735
Vol 18 p. 449
Shenandoe Co
1735
Varras June 4th 1735 Then Surveyed for Mr. James Hamilton
one Section or League of Land Situate on the waters of
the Angilena Beginning at the S E Corner of Provel's
Survey a Post in a Mound 5th Corner from

which a B. Oak 10 Inches in diameter bears S 71° W 9 Var:
distant another B. Oak 7 Inches in diameter bears N 64° E

8 Varras distant Thence South
a Creek 2 Var. wide S. E

Set a post and Made a Mound 2nd Corner from
which a B. Oak 13 Inches in diameter bears N 70° W

6 Varras distant a Red Oak 15 Inches in diameter
bears S 40° W 3 Varras distant

Thence West

Hokits and Engledows Cor a post in a Mound 3rd
Corner from which a Hickory 9 Inches in diameter
bears N 62° W 9 Varras distant another Hickory 6

Inches in diameter bears N 79° E 4¹⁰ Varras distant
Thence North Engledows line

a Spring Branch S W
Engledows and Gson Gees Corner a Post

in a Mound 4th Corner from which a Hickory
12 Inches in diameter bears S 77° W 6 Varras dist

ant another Hickory 18 Inches in diameter bears
S 30° W 15 Varras distant

Thence East Gee's line

To the place of Beginning Timber Hickory
Oak Ash Elm &c 12 Labors Arable
Residue Grazing Land

Jeremiah Stode
Surveyor

1700
5000

5000

2400
5000

5000

87
Varras
Maria Falcona Huegas
20th May 1835
10c 18 p 353

Book Co
1835

April 25th 1835 Then Surveyed for Mrs Maria Falcona
Huegas one League or Section of Land on the Waters of the
Angilena and adjoining Joseph Durt on the North West
and also William Ragans Survey of one League in
David G Burnetts Colony or Grant beginning at said
Ragans S.E. Corner a post in mound 1st Corner
from which a B. Oak 18 Inches in diameter bears N 81 E
4 Varras distant a white Oak 10 Inches in diameter bears
S 62 1/2 W 2 5/8 Varras distant Thence North with Ragans line
a Branch of Angilena C. S.W
a Branch 17 1/2 Varras wide C. S.E
a Branch 1 Varras wide C. S.E
a post in mound ^{2nd corner} Ragans N.E. Corner from which
a B. Oak 24 Inches in diameter bears S 70 1/2 W 4 Varras
distant a Hickory 26 Inches in diameter bears N 6 1/2 E 9 1/2
Varras distant Thence East
a Branch 1 Varras wide C. South
Set a Post and Made a Mound 3rd Corner from which
a B. Oak 24 Inches in diameter bears S 24 1/2 W Varras
distant another B. Oak 1 1/2 Inches in diameter bears
East 13 Varras distant
~~a Branch~~ Thence South
a Branch of Angilena 3 Varras wide C. S.W
a Branch 1 Varras wide C. West
Set a post and Made a Mound 4th Corner from
which a Post Oak 24 Inches in diameter bears N 57
E 5 Varras distant a Pine 19 Inches in diameter
bears North 4 Varras distant
Thence West passing through ^{our} Cambell
To the place of beginning Good Land Timber
and Water Timber Hickory Oak ash Elm
Gum & 16 Labors Arable Reside Grazing
Land

20
2800
3700
5000

1100
5000

1700
4200
5000

5000

Jeremiah Strodt
Surveyor
11 - 11

Distance South

Jeremiah Bennett
Total Nov 29/34 5
bol 18 p 23
Marquadoes &
WMS

Notes the
November the 24 - 1834 a Grant
then surveyed for General Bennett & ~~Company~~ of Land
set a Post and made a mound in Joseph Weeks S. Bormanys
line from which a Pine 18 Inches in diameter bears S 57 1/2 W 3 1/4
13 207 J 89

507
3743
5190

18 1/2 distant a Oak 6 Inches in diameter bears S 57 1/2 W 3 1/4
distant, Thence S 12 1/2 East
a drain C. S. W
a drain E Timber Pine Hickory Oak &
set a Post and made a mound 2 corner on the West bank of
a drain from which a Oak 25 Inches in diameter bears S 50 E
4 Has an other Oak 18 Inches in diameter bears S 16 W 10 1/2
assistant ~~Thence East~~

40
1100
2300
3970

Thence East a drain S. South
Drain S South
Road C. N. E
Chr. Town C. N. W Timber chiefly Hickory Oak Pine &
set a Stake and made a mound 3. corner in Lewis
Sanchez W. line from which a Pine 24 Inches in dia-
-ameter bears S. 82 W 2 1/4 V. distant an other Pine
14 Inches in diameter bears S. 23 E. 15 V. distant
Thence with Sanchez line S 10 1/2 W (90. 10. 10 W)

4660
5180
1400
4900

Planted a Post and made a Mound 4. corner a Hickory
16 Inches diameter bears S 79 West 10 V. distant another
Hickory 18 Inches diameter bears S 36 W 9 V. distant
Thence West past Joseph Weeks S. E corner
past Joseph Weeks S. E corner
To the place of Beginning containing 24,296,000 V. &
12 Labours is arable the Residue Grazing Land
Jeremiah Shode Surveyor
" " "

Notes den.
 James M. Cune
 17th July 1835
 ml 19 p 633
 Bunk Co
 1835

Varras June 16th 1835 Then surveyed for M. James M'cune
 one Section or League of Land Situate in D. G. Burnett
 Grant on the water of the Angilena Adjoining the
 Surveys of Henry Stockman and William Williams
 beginning at Stockmans N. E. Corner a Post in
 a mound 1st Corner from which a Hickory
 10 Inches in diameter bears S 36 E 6 Varras distant
 a B. Oak 14 Inches in diameter bears N 63 1/2 W
 8 Varras distant

2500
 2600 1/10
 Thence N 24 1/2 East with Williams
 Williams S. E. Corner
 Planted a Post and Made a Mound 2nd Corner
 from which a Red Oak 36 Inches in diameter
 bears N 67 E 9 Varras distant a Hickory 14 Inches
 in diameter bears N 6 1/2 W 4 Varras distant

300
 2300
 8570
 9612
 Thence S 65 1/2 E
 a Spring & branch C. & W.
 Trace Shawana Village C. & W.
 Spring Branch 1 Varras wide C. & E.
 Planted a Post and Made a Mound 3rd Corner
 from which a Red Oak 30 Inches in diameter
 bears N 68 E 15 Varras distant another Red Oak
 12 Inches in diameter bears S 24 E 14 1/2 Varras distant

2100
 2600 1/10
 Thence S 24 1/2 W
 a Creek 1 1/2 Varras wide C. & S
 Stockmans Corner a Post around which
 made a Mound 4th Corner from which a Chin-
 quemine 14 Inches in diameter bears S 52 1/2 E
 6 Varras distant a Dogwood 8 Inches in
 diameter bears S 15 1/2 W 7 Varras distant

9612
 Thence N 65 1/2 W with Stockmans
 line to the place of beginning Timber Line
 Hickory Oak & 5 Varras Variable Riparian
 Grazing Land
 James M. Cune
 Surveyor

Mr Arthur Hennis

Laogoches



91
 December 8th 1884] Then Surveyed for Jacob
 Pruitt one League of Land Situated on the S. W.
 of the Naches and bounded as follows.

Jacob Pruitt
 576 July 16/35
 vol 18 p. 147
 Houston & Trinity Cos
 1882

Set a post and made a Mound 1st Corner on
 the S W bank of the Naches from which Black
 Oak 36 Inches in diameter bears N 60 E 3 5/10
 distant a White Oak 20 Inches in diameter bears S 75 W 16 1/10

Thence S 23 West
 The Stanton Road S W
 a Branch S W 1 Vara in width
 another Branch S W 1 Vara in width

Set a post and made a Mound 2nd Corner
 from which a post Oak 18 Inches in diameter
 bears S 52 W 4 1/10 Varas distant another
 post Oak 18 Inches in diameter bears S 46 E
 11 Varas distant Thence S 67 E

Set a post and made a Mound 3rd Corner
 from which a White Oak 18 Inches in diameter
 bears S 25 W 5 Varas distant a Sweet Gum
 30 Inches in diameter bears N 34 E 9 1/10 Varas
 distant Thence N 23 E

to Leonard Williams corner

to William's corner on the S W bank of the Naches

Fourth corner a post in mound from which
 a Sweet Gum 36 Inches in diameter bears N 60 E
 10 V. distant a Hickory 18 Inches in diameter

bears South 3 1/10 V. distant thence with the second

Meadow N 22 W 32 1/2 V. thence S 81 W 27 1/2 V.

S 35 W 34 1/2 V. thence N 83 W 22 1/2 V. thence

N 40 W 26 1/2 V. thence S 68 W 25 1/2 V. thence S 46 W

35 1/2 V. thence S 73 W 20 1/2 V. thence S 5 W 20 1/2 V.

thence S 88 W 37 1/2 V. thence S 30 W 20 1/2 V. thence

South 40 1/2 V. thence N 80 1/2 W 25 1/2 V. thence S 61 W

26 1/2 V. thence N 27 W 44 1/2 V. thence S 7 W 25 1/2 V. to

1400
 6720
 7820
 9097

2500

1150

10365

10365

Notes prepared

The place of beginning Timber Ash Pine Hickory Oak &c
 Section subject to inundation 2 Laborers avail the balance
 90 acres land

Jacob Pruetts
by Trade Surveyor

[Faint, illegible handwritten text, likely bleed-through from the reverse side of the page.]

080
071
055
101
084
073
041

92 85
Varras on the

May 8th 1935 Then Surveyed for Juan Vargas one
Sectio or League of Land on the waters of the arroyo
near the Trace leading from the Big Shawana Village
to the Saline Salt works Set a Post and Made
a mound 1st Corner set a post from which a Red
Oak 30 Inches in diameter bears S 48° E 2 Varras distant
an Other Red Oak 17 Inches in diameter bears S 10° E 16
Varras distant Thence West

Juan Vargas
file May 13/35
vol. 18 p. 361.

Mitchell

1800

a creek 2 Varras wide C. S.

5000

Set a post and made a Mound 2nd Corner from which
a Post Oak 10 Inches in diameter bears S 27° W 8 Varras
distant a Red Oak 13 Inches in diameter bears N 43° W
9 Varras distant Thence South

5000

Set a post and made a Mound 3rd Corner from which
a Hickory 9 Inches in diameter bears N 69° W 2 Varras
distant a Red Oak 14 Inches in diameter bears S 34° E
10 Varras distant Thence East

3210

a Cree 3 Varras wide C. South

5000

Set a Post and Made a Mound 4th Corner from
which a Post Oak 12 Inches in diameter bears N 22° W
9 Varras distant an Other post Oak 14 Inches in diameter
bears S 5° E 22 Varras distant

Thence North

5000

To the place of Beginning Timber Hickory Oak Ash
Elm Pine & 10 Acres Arable Residence
Grazing Land

Jimmie Stodd
Surveyor

Aug 5. 62

Mr. Arthur Ferris

Nacogdoches

"